

1989 • TRAVEL • TRAILERS



All Over America

1989 • TRAVEL • TRAILERS



SKAMPER

All Over America

1989 • TRAVEL • TRAILERS

Standard Exterior Features:

Aluminum siding with baked enamel finish, stone shield, radius design front travel awning, large tubular steel main frame, not "C" channel, seamless Polymax® underbelly, 2" x 3" wood floor framing (except 1600T) with one piece Blandex® sub floor. One piece aluminum tapered roof. Georgia Pacific® fiberglass insulation (ceiling, walls, floor), metal reinforced joints, 2" x 3" tapered roof rafters, pre-framed and wired for roof air conditioner, most models. Wide track tandem axles, Goodyear® tires, beige slotted mag type wheels, electric brakes on all wheels. Two 30 lb. LP bottles with automatic change regulator, moulded LP bottle cover, except 1600T. Two holding tanks, 25 foot power cord, 30 amp rated. Campsite water hookup, outside baggage door(s), patio light, combination screen door(s), assist handle. Two and three tier black framed Hehr® jalousie type windows with removable screens, self-storing entrance step(s), sewer hose storage in bumper. Outside receptacle - ground fault protected. Break-away brake switch and dual safety chains. Adjustable front jack with dolly wheel.

Optional Features:

Two-door refrigerator, 2310T and larger models. Roof air conditioner, power roof vent, safety glass, storm windows, TV antenna with jack, antenna booster, spare tire/wheel/carrier and cover, battery and case, wall clock, carpeting, systems monitor panel, dead bolt door locks, high performance water heater, deluxe chair, AM/FM cassette with four speakers, Magic Chef® built-in microwave oven, attached stabilizer jacks and hide-a-bed, most models.

Standard Interior Features:

Poly coated wood paneling, radius style type cabinets featuring positive locking hardware and hollow core cabinet doors. Large gas/electric Norcold® refrigerator; 4 burner range with oven; except 1600T, range hood with light and power exhaust fan. Pilotless electronic ignition Duo Therm® furnace, 17-30,000 BTU depending upon model selection. Double basin stainless steel sink, all wood drawers with travel locks. 2 to 4 roof vents and 32 to 45 amp. power converter with built-in battery charger, depending upon model selection. Duplex bath receptacle ground fault protected. Button tufted 5" high density foam cushions, 100% nylon Scotchgard® treated velour upholstery with vinyl backing. Decorative non-shadowing window drapes with valances, pleated shade in kitchen. Marine toilet, recessed fire extinguisher, seamless no wax vinyl floor covering. Home-type innerspring mattress in all Models except 1600T and 1850T.



1600T



1850T



2310T PLAN A



2310T PLAN B



2330T PLAN A



2330T PLAN B



2330T PLAN C



2550T



2650T PLAN B



2650T PLAN C



2650T PLAN D



3100T



3400T

1989 • TRAVEL • TRAILERS

Standard Exterior Features:

Aluminum siding with baked enamel finish, stone shield, radius design front travel awning, large tubular steel main frame, not "C" channel, seamless Polymax® underbelly, 2" x 3" wood floor framing (except 1600T) with one piece Blandex® sub floor. One piece aluminum tapered roof. Georgia Pacific® fiberglass insulation (ceiling, walls, floor), metal reinforced joints, 2" x 3" tapered roof rafters, pre-framed and wired for roof air conditioner, most models. Wide track tandem axles, Goodyear® tires, beige slotted mag type wheels, electric brakes on all wheels. Two 30 lb. LP bottles with automatic change regulator, moulded LP bottle cover, except 1600T. Two holding tanks, 25 foot power cord, 30 amp rated. Campsite water hookup, outside baggage door(s), patio light, combination screen door(s), assist handle. Two and three tier black framed Hehr® jalousie type windows with removable screens, self-storing entrance step(s), sewer hose storage in bumper. Outside receptacle - ground fault protected. Break-away brake switch and dual safety chains. Adjustable front jack with dolly wheel.

Standard Interior Features:

Poly coated wood paneling, radius style type cabinets featuring positive locking hardware and hollow core cabinet doors. Large gas/electric Norcold® refrigerator; 4 burner range with oven; except 1600T, range hood with light and power exhaust fan. Pilotless electronic ignition Duo Therm® furnace, 17-30,000 BTU depending upon model selection. Double basin stainless steel sink, all wood drawers with travel locks. 2 to 4 roof vents and 32 to 45 amp. power converter with built-in battery charger, depending upon model selection. Duplex bath receptacle ground fault protected. Button tufted 5" high density foam cushions, 100% nylon Scotchgard® treated velour upholstery with vinyl backing. Decorative non-shadowing window drapes with valances, pleated shade in kitchen. Marine toilet, recessed fire extinguisher, seamless no wax vinyl floor covering. Home-type innerspring mattress in all Models except 1600T and 1850T.

Optional Features:

Two-door refrigerator, 2310T and larger models. Roof air conditioner, power roof vent, safety glass, storm windows, TV antenna with jack, antenna booster, spare tire/wheel/carrier and cover, battery and case, wall clock, carpeting, systems monitor panel, dead bolt door locks, high performance water heater, deluxe chair, AM/FM cassette with four speakers, Magic Chef® built-in microwave oven, attached stabilizer jacks and hide-a-bed, most models.

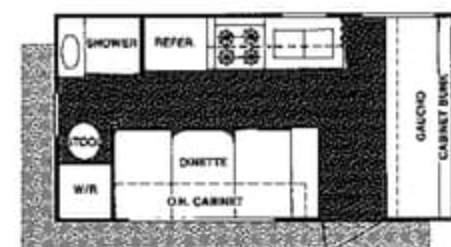

1600T



1850T

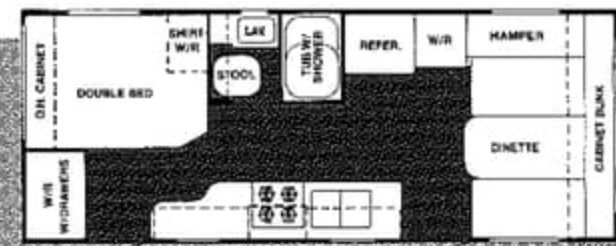

2310T PLAN A



2310T PLAN B

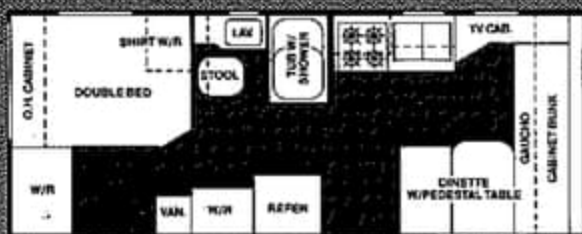

2330T PLAN A

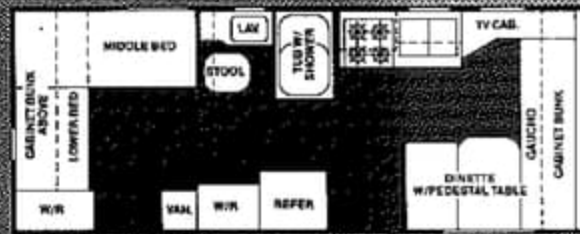

2330T PLAN B

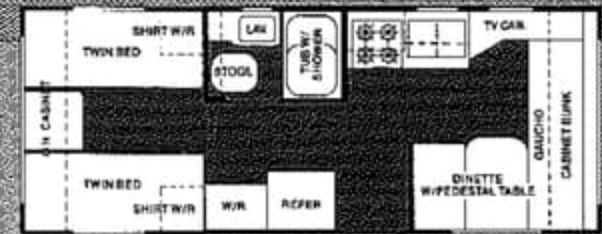

2330T PLAN C



2550T

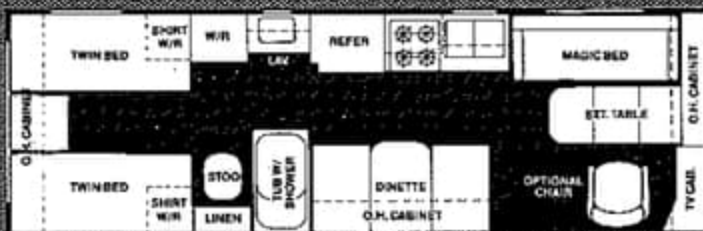

2650T PLAN B

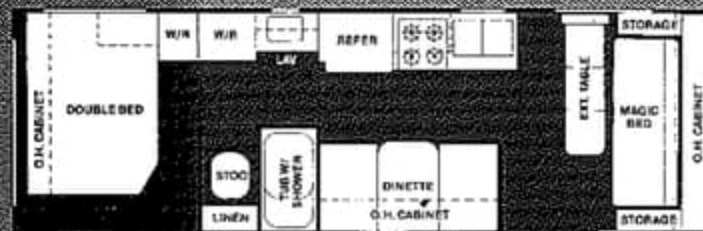

2650T PLAN C

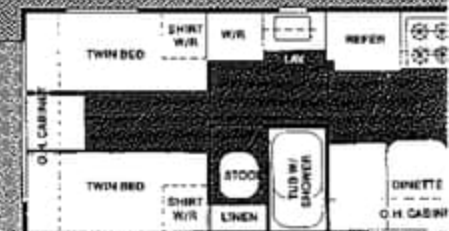

2650T PLAN D



3100T

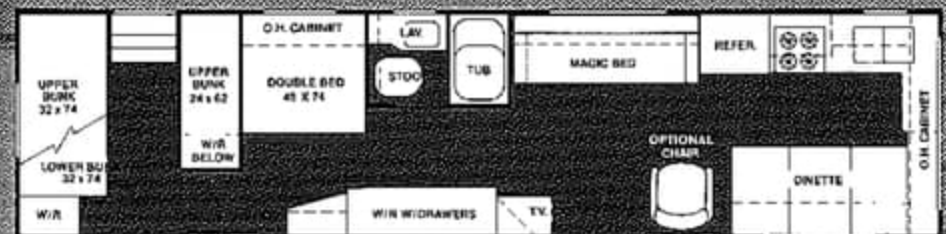

3400T



Color coordinated bedspreads, pillow shams and padded headboard, which are standard in most models, complete the camper's striking, well planned interiors.



Decorative hand-crafted glass doors are standard in the living room area of models 2550T and larger.



Many models feature color coordinated upholstered dinette backs with a convenient built-in magazine rack.

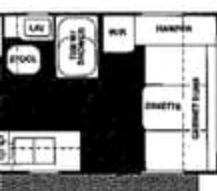

2000T PLAN A

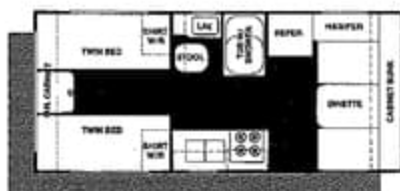

2000T PLAN B

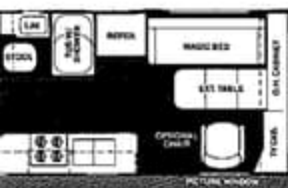

2310T PLAN C

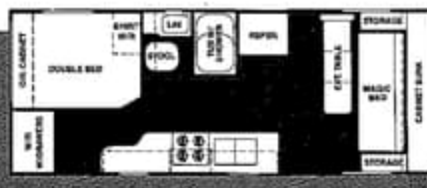

2310T PLAN D



2550T PLAN B

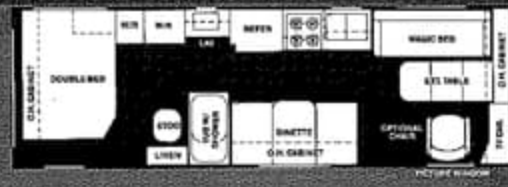

2650T PLAN A



2950T PLAN A



2950T PLAN B



3450T PLAN A

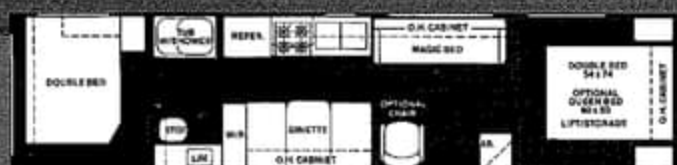

3450T PLAN B



Color coordinated bedspreads, pillow shams and padded headboard, which is standard in most models, complete camper's striking, well planned interiors.



Decorative hand-crafted glass doors are standard in the living room area of models 2550T and larger.



Many models feature color coordinated upholstered dinette backs with a convenient built-in magazine rack.

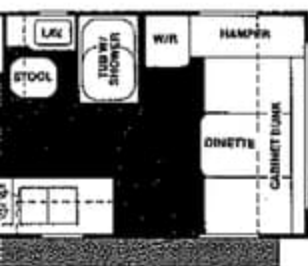

2000T PLAN A

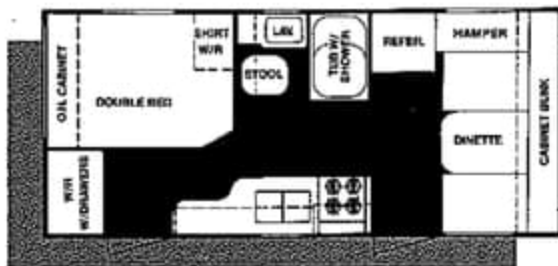

2000T PLAN B

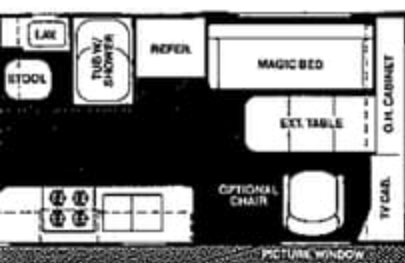
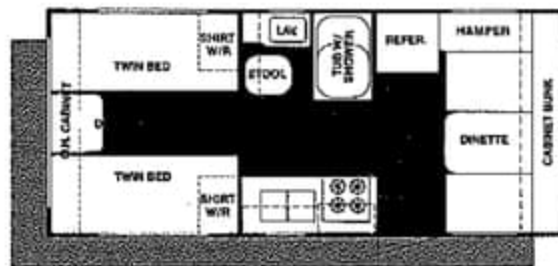

2000T PLAN D

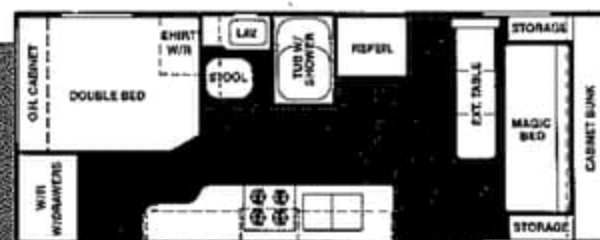
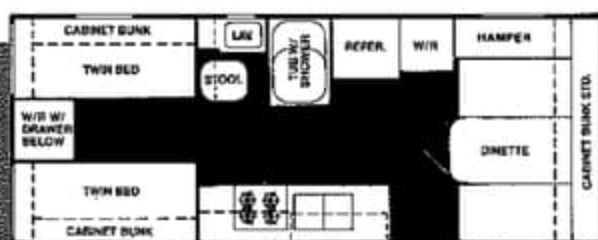

2310T PLAN C

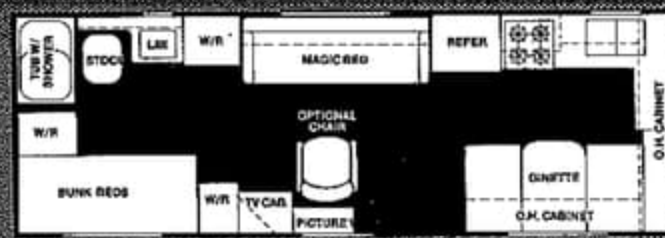
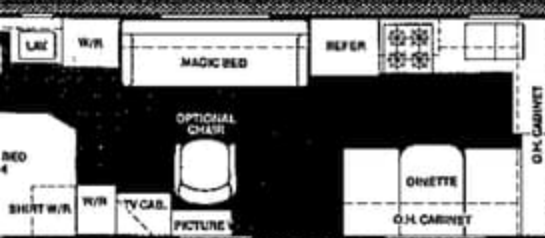

2550T PLAN B

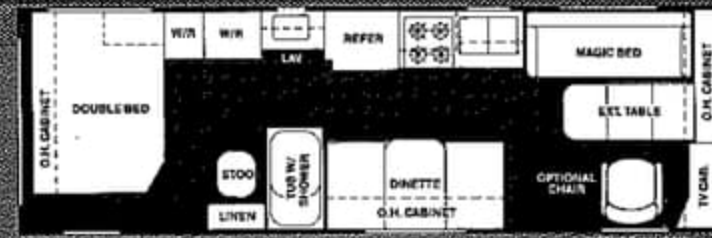

2550T PLAN D

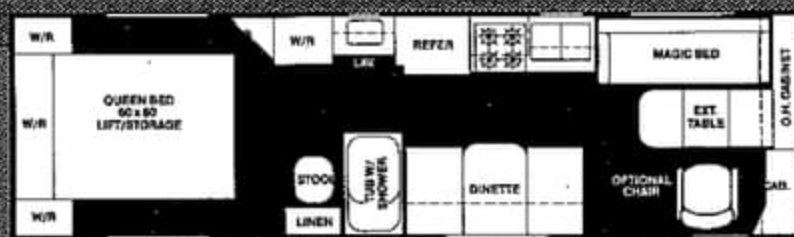
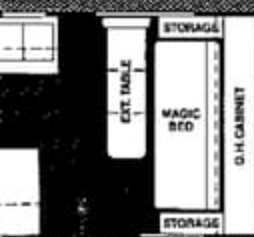

2650T PLAN A

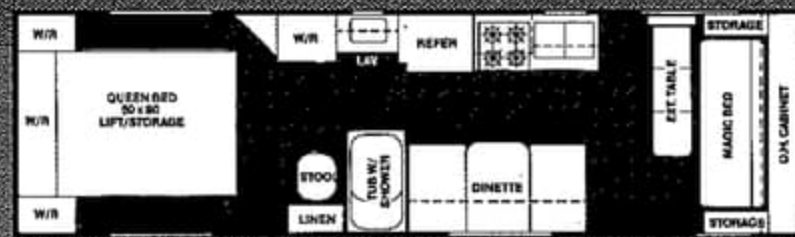

2650T PLAN C

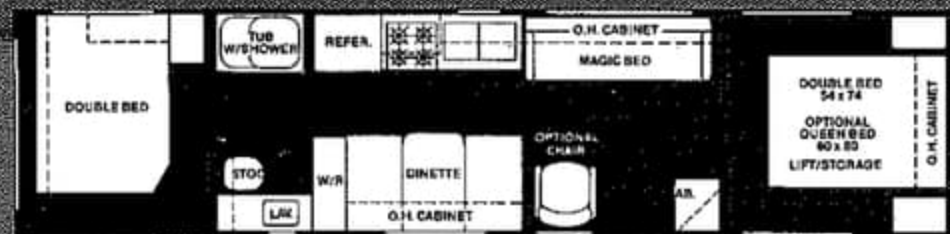
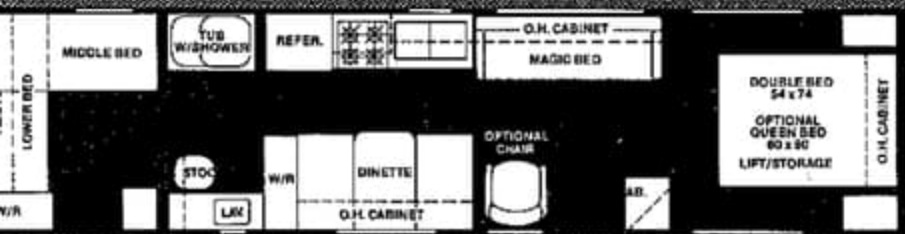

2950T PLAN A

2950T PLAN B

3450T PLAN A

3450T PLAN B

Specifications

Models	1600T	1850T	2000T	2310T	2330T	2550T	2650T	2950T	3100T	3400T	3450T
Overall Length	16'6"	18'9"	20'4"	23'1"	23'1"	25'4"	26'11"	29'11"	31'	34'	34'10"
Overall Width	7'2"	7'11"	7'11"	7'11"	7'11"	7'11"	7'11"	7'11"	7'11"	7'11"	7'11"
Overall Height	7'11"	8'8"	8'9"	8'9"	8'9"	8'10"	8'10"	8'10"	8'10"	8'10"	8'10"
Interior Height	6'3"	6'6"	6'6"	6'6"	6'6"	6'6"	6'6"	6'6"	6'6"	6'6"	6'6"
Hitch Weight	150	350	400	490	430	680	640	500	700	650	*625
Axle Weight	1950	2900	2940	3340	3360	3320	3600	4220	4280	4880	*4950
Gross Veh. Wt. Rating	3500	4900	5000	5000	5000	7000	7000	7000	7000	7400	7400
Tire Size	B78x13B	F78x13B	F78x15B	F78x15B	F78x15B	F78x15C	F78x15C	F78x15C	F78x15C	F78x15C	F78x15C
Hitch Height	14"	16"	17"	17"	17"	17"	18"	18"	18"	18"	18"
Sleeping Capacity	5	6	5	5 7 (C)	5 6 (B)	6	6	6	6	9	9 (A,C) 8 (B,D)
Demand Water System w/12V Pump	32 Gal.	33 Gal.	36 Gal.	36 Gal.	36 Gal.	36 Gal.	33 Gal.	36 Gal.	33 Gal.	33 Gal.	33 Gal.
Black/Gray Holding Tanks (gal)	30.5/12	23/19	23/19	23/19	23/19	32/26	40/30	40/30	40/30	40/30	40/30
Electronic Ignition LPG	17,000	17,000	20,000	20,000	20,000	20,000	25,000	30,000	30,000	30,000	30,000
Furnace (BTU)			Ducted	Ducted	Ducted	Ducted	Ducted	Ducted	Ducted	Ducted	Ducted
12V Converter w/Auto Battery Charger	32 amp	32 amp	32 amp	32 amp	32 amp	36 amp	36 amp	36 amp	36 amp	45 amp	45 amp
LP Gas	20#	2-30#	2-30#	2-30#	2-30#	2-30#	2-30#	2-30#	2-30#	2-30#	2-30#
Cabinet Bunks-STD.	1	2	1	1-(A,B,D) 3-(C)	1-(A,C) 2-(B)	N/A	N/A	N/A	N/A	N/A	1-(A)

Specifications comply with federal motor vehicle standards and RVIA standards. Due to continuous product improvement, specifications subject to change without notice and incurring obligations.

*estimated



Our 1 Year Full Warranty

All Skamper Travel Trailers and Fifth Wheels are warranted under normal use to be free of defects in materials and workmanship for a period of one (1) year from the date of purchase at retail.

Ask your dealer for a complete copy of this important benefit.

Sun Country R.V. Center

1312 E. Baker Street (Hwy. 92E)
Plant City, Florida 33566
1-813-752-8282



P.O. Box 338, Bristol, IN. 46507

Specifications

Models	1600T	1850T	2000T	2310T	2330T	2550T	2650T	2950T	3100T	3400T	3450T
Overall Length	16'6"	18'9"	20'4"	23'1"	23'1"	25'4"	26'11"	29'11"	31'	34'	34'10"
Overall Width	7'2"	7'11"	7'11"	7'11"	7'11"	7'11"	7'11"	7'11"	7'11"	7'11"	7'11"
Overall Height	7'11"	8'8"	8'9"	8'9"	8'9"	8'10"	8'10"	8'10"	8'10"	8'10"	8'10"
Interior Height	6'3"	6'6"	6'6"	6'6"	6'6"	6'6"	6'6"	6'6"	6'6"	6'6"	6'6"
Hitch Weight	150	350	400	490	430	680	640	500	700	650	*625
Axle Weight	1950	2900	2940	3340	3360	3320	3600	4220	4280	4880	*4950
Gross Veh. Wt. Rating	3500	4900	5000	5000	5000	7000	7000	7000	7000	7400	7400
Tire Size	B78x13B	F78x13B	F78x15B	F78x15B	F78x15B	F78x15C	F78x15C	F78x15C	F78x15C	F78x15C	F78x15C
Hitch Height	14"	16"	17"	17"	17"	17"	18"	18"	18"	18"	18"
Sleeping Capacity	5	6	5	5 7 (C)	5 6 (B)	6	6	6	6	9	9 (A,C) 8 (B,D)
Demand Water System w/12V Pump	32 Gal.	33 Gal.	36 Gal.	36 Gal.	36 Gal.	36 Gal.	33 Gal.	36 Gal.	33 Gal.	33 Gal.	33 Gal.
Black/Gray Holding Tanks (gal)	30.5/12	23/19	23/19	23/19	23/19	32/26	40/30	40/30	40/30	40/30	40/30
Electronic Ignition LPG	17,000	17,000	20,000	20,000	20,000	20,000	25,000	30,000	30,000	30,000	30,000
Furnace (BTU)			Ducted	Ducted	Ducted	Ducted	Ducted	Ducted	Ducted	Ducted	Ducted
12V Converter w/Auto Battery Charger	32 amp	32 amp	32 amp	32 amp	32 amp	36 amp	36 amp	36 amp	36 amp	45 amp	45 amp
LP Gas	20#	2-30#	2-30#	2-30#	2-30#	2-30#	2-30#	2-30#	2-30#	2-30#	2-30#
Cabinet Bunks-STD.	1	2	1	1-(A,B,D) 3-(C)	1-(A,C) 2-(B)	N/A	N/A	N/A	N/A	N/A	1-(A)

Specifications comply with federal motor vehicle standards and RVIA standards. Due to continuous product improvement, specifications subject to change without notice and incurring obligations.

*estimated



Our 1 Year Full Warranty

All Skamper Travel Trailers and Fifth Wheels are warranted under normal use to be free of defects in materials and workmanship for a period of one (1) year from the date of purchase at retail.

Ask your dealer for a complete copy of this important benefit.

Sun Country R.V. Center

1312 E. Baker Street (Hwy. 92E)
Plant City, Florida 33566
1-813-752-8282



P.O. Box 338, Bristol, IN. 46507