

# *Pleasure-Way*



# *Pleasure-Way*



## MODEL SPECIFICATIONS

**Dodge chassis standard for all models**

**Coach**

		VST	VRL	TW				
		VST	VRL	TW	VST	VRL	TW	
GROSS VEHICLE WEIGHT 6,400 LBS/2910 KGS	3-WAY REFRIGERATOR	✓	✓	✓	FRESH WATER TANK 63.6L/16.8 U.S. GAL.	✓	✓	✓
WHEELBASE 3241mm/127.6 in.	MICROWAVE OVEN	✓	✓	✓	DUAL HOLDING TANK 140L/37 U.S. GAL.	✓	✓	✓
LENGTH (bumper to bumper) 5486mm/18'10"	2-BURNER LP STOVE	✓	✓	✓	PROPANE TANK 30L/7.9 U.S. GAL.	✓	✓	✓
WIDTH 2032mm/6'8"	STAINLESS STEEL SINK	✓	✓	✓	CITY WATER CONNECTION	✓	✓	✓
HEIGHT 87"	AUTO FORCED AIR FURNACE	✓	✓	✓	LOCKING FRESH WATER FILL	✓	✓	✓
318 V8 FUEL INJECTED ENGINE	WATER FLUSH TOILET	✓	✓	✓	CAPTAIN'S CHAIRS (swivel & recline)	✓	✓	✓
FUEL CAPACITY 132L/34.8 U.S. GAL.	HOT WATER HEATER	✓	✓		REAR SEAT BELTS (2)		✓	
AUTOMATIC TRANSMISSION	11" COLOUR TV./VCP 110V/12V		✓		CONVERTIBLE REAR DINETTE (50" x 74")	✓	✓	
FACTORY AIR	BOOMERANG TV. ANTENNA		✓		REAR TWIN BEDS (28" x 74") or (74" x 74")			✓
TILT STEERING	AUXILIARY BATTERY	✓	✓	✓	EXTRA COCKTAIL TABLE w/STAND	✓	✓	✓
CRUISE CONTROL	110V/12V 30 AMP CONVERTER	✓	✓	✓	FIRE EXTINGUISHER	✓	✓	✓
STEEL BELTED RADIAL TIRES	3 110V RECEPTACLES	✓	✓	✓	SMOKE DETECTOR	✓	✓	✓
AM/FM STEREO CASSETTE	MONITOR PANEL	✓	✓		POWER ROOF VENT	✓	✓	✓
POWER WINDOWS	SLIDE OUT NIGHT TABLE			✓	VANITY	✓	✓	
POWER DOOR LOCKS								

## OPTIONS

360 FUEL INJECTED ENGINE

RUNNING BOARDS

T.V. ANTENNA

HOT WATER

CONTINENTAL SPARE TIRE CARRIER

AWNING

### NEW FOR 1991

With Pleasure-Way's  
commitment to building only  
the finest in Class B  
Motorhomes we have added  
three more models to our line:  
the VRL, VST and TW.

Each of these models has been  
designed with the quality,  
comfort and character that  
Pleasure-Way is recognized for.

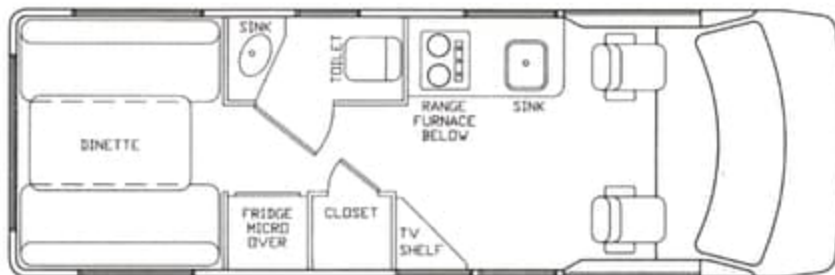

*PLEASURE-WAY VST rear dinette with vanity*

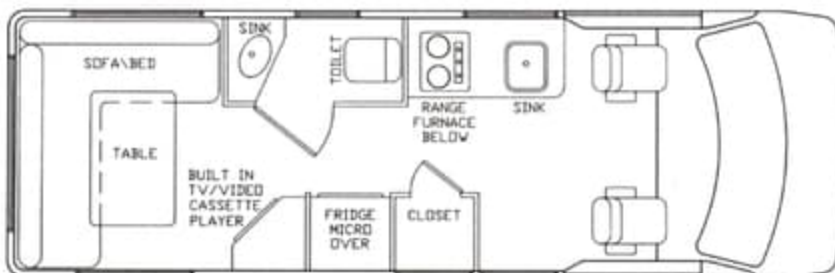

*PLEASURE-WAY VRL rear livingroom with vanity*

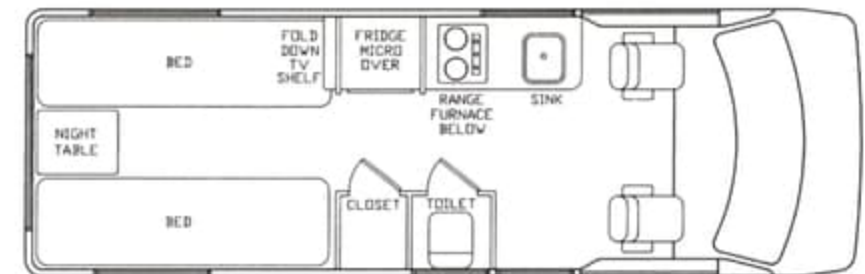

*PLEASURE-WAY TW twin bed*

## MODEL SPECIFICATIONS

**Dodge chassis standard for all models**

**Coach**

		VST	VRL	TW				VST	VRL	TW
GROSS VEHICLE WEIGHT 6,400 LBS/2910 KGS	3-WAY REFRIGERATOR	✓	✓	✓	FRESH WATER TANK 63.6L/16.8 U.S. GAL.	✓	✓	✓		
WHEELBASE 3241mm/127.6 in.	MICROWAVE OVEN	✓	✓	✓	DUAL HOLDING TANK 140L/37 U.S. GAL.	✓	✓	✓		
LENGTH (bumper to bumper) 5486mm/18'10"	2-BURNER LP STOVE	✓	✓	✓	PROPANE TANK 30L/7.9 U.S. GAL.	✓	✓	✓		
WIDTH 2032mm/6'8"	STAINLESS STEEL SINK	✓	✓	✓	CITY WATER CONNECTION	✓	✓	✓		
HEIGHT 8'1"	AUTO FORCED AIR FURNACE	✓	✓	✓	LOCKING FRESH WATER FILL	✓	✓	✓		
318 V8 FUEL INJECTED ENGINE	WATER FLUSH TOILET	✓	✓	✓	CAPTAIN'S CHAIRS (swivel & recline)	✓	✓	✓		
FUEL CAPACITY 132L/34.8 U.S. GAL.	HOT WATER HEATER	✓	✓		REAR SEAT BELTS (2)		✓			
AUTOMATIC TRANSMISSION	11" COLOUR T.V./VCP 110V/12V		✓		CONVERTIBLE REAR DINETTE (50" x 74")	✓	✓			
FACTORY AIR	BOOMERANG T.V. ANTENNA		✓		REAR TWIN BEDS (28" x 74" or (74" x 74")				✓	
TILT STEERING	AUXILIARY BATTERY	✓	✓	✓	EXTRA COCKTAIL TABLE w/STAND	✓	✓	✓		
CRUISE CONTROL	110V/12V 30 AMP CONVERTER	✓	✓	✓	FIRE EXTINGUISHER	✓	✓	✓		
STEEL BELTED RADIAL TIRES	3 110V RECEPTACLES	✓	✓	✓	SMOKE DETECTOR	✓	✓	✓		
AM/FM STEREO CASSETTE	MONITOR PANEL	✓	✓		POWER ROOF VENT	✓	✓	✓		
POWER WINDOWS	SLIDE OUT NIGHT TABLE			✓	VANITY	✓	✓			
POWER DOOR LOCKS										

## OPTIONS

360 FUEL INJECTED ENGINE

RUNNING BOARDS

T.V. ANTENNA

HOT WATER

CONTINENTAL SPARE TIRE CARRIER

AWNING

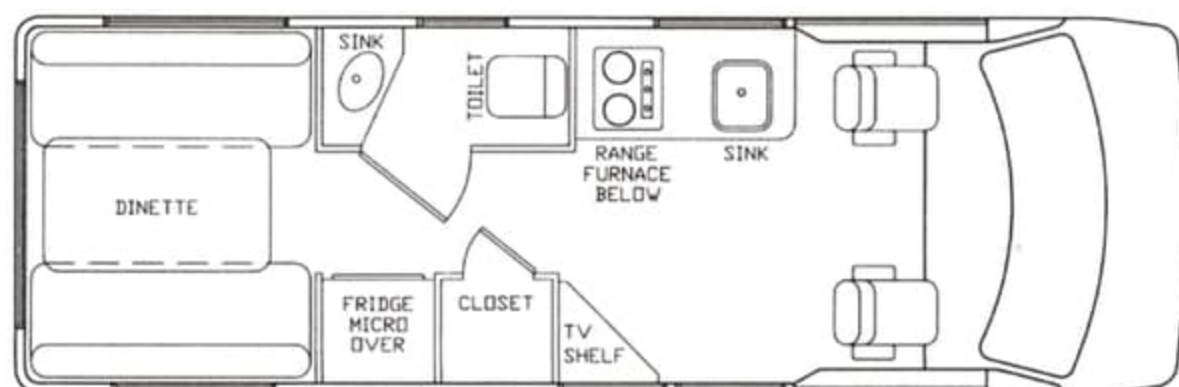

*PLEASURE-WAY VST rear dinette with vanity*

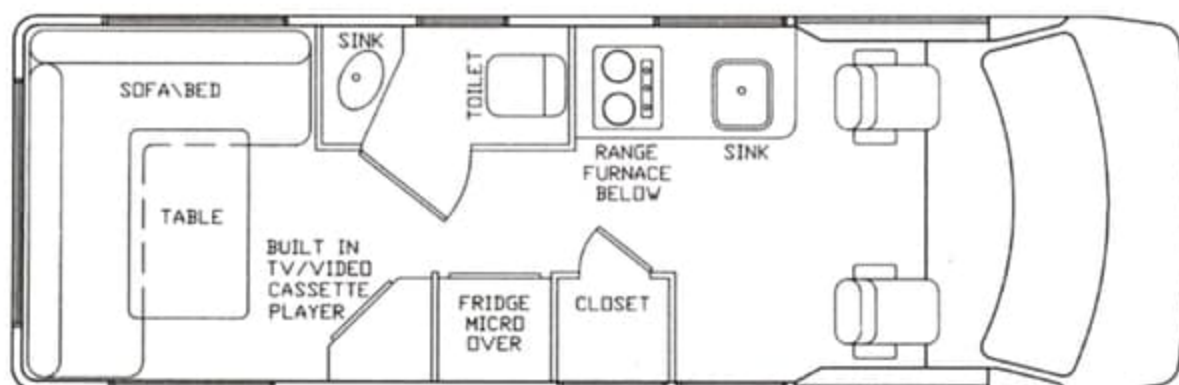

*PLEASURE-WAY VRL rear livingroom with vanity*

## NEW FOR 1991

With Pleasure-Way's commitment to building only the finest in Class B Motorhomes we have added three more models to our line: the VRL, VST and TW.

Each of these models has been designed with the quality, comfort and character that Pleasure-Way is recognized for.

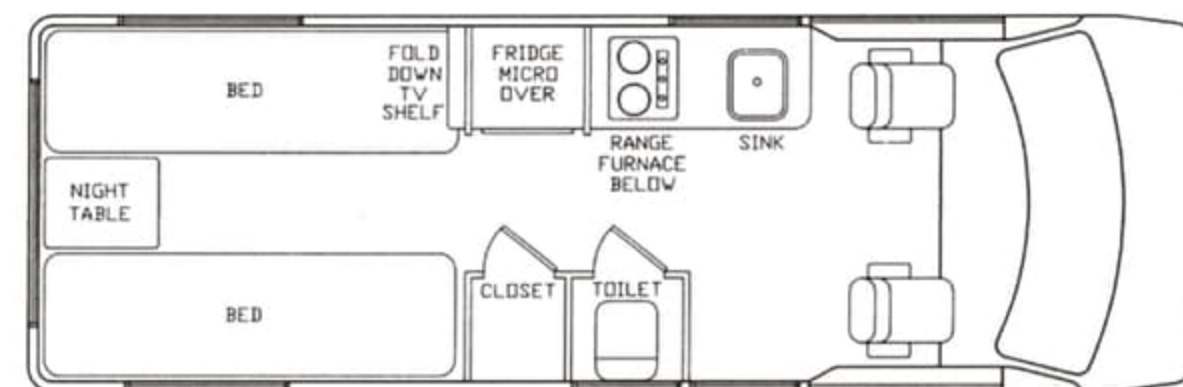

*PLEASURE-WAY TW twin bed*

## MODEL SPECIFICATIONS

**Dodge chassis standard for all models**

**Coach**

		VST	VRL	TW				VST	VRL	TW
GROSS VEHICLE WEIGHT 6,400 LBS/2910 KGS	3-WAY REFRIGERATOR	✓	✓	✓	FRESH WATER TANK 63.6L/16.8 U.S. GAL.	✓	✓	✓		
WHEELBASE 3241mm/127.6 in.	MICROWAVE OVEN	✓	✓	✓	DUAL HOLDING TANK 140L/37 U.S. GAL.	✓	✓	✓		
LENGTH (bumper to bumper) 5486mm/18'10"	2-BURNER LP STOVE	✓	✓	✓	PROPANE TANK 30L/7.9 U.S. GAL.	✓	✓	✓		
WIDTH 2032mm/6'8"	STAINLESS STEEL SINK	✓	✓	✓	CITY WATER CONNECTION	✓	✓	✓		
HEIGHT 8'1"	AUTO FORCED AIR FURNACE	✓	✓	✓	LOCKING FRESH WATER FILL	✓	✓	✓		
318 V8 FUEL INJECTED ENGINE	WATER FLUSH TOILET	✓	✓	✓	CAPTAIN'S CHAIRS (swivel & recline)	✓	✓	✓		
FUEL CAPACITY 132L/34.8 U.S. GAL.	HOT WATER HEATER	✓	✓		REAR SEAT BELTS (2)		✓			
AUTOMATIC TRANSMISSION	11" COLOUR TV./VCP 110V/12V		✓		CONVERTIBLE REAR DINETTE (50" x 74")	✓	✓			
FACTORY AIR	BOOMERANG TV. ANTENNA		✓		REAR TWIN BEDS (28" x 74") or (74" x 74")			✓		
TILT STEERING	AUXILIARY BATTERY	✓	✓	✓	EXTRA COCKTAIL TABLE w/STAND	✓	✓	✓		
CRUISE CONTROL	110V/12V 30 AMP CONVERTER	✓	✓	✓	FIRE EXTINGUISHER	✓	✓	✓		
STEEL BELTED RADIAL TIRES	3 110V RECEPTACLES	✓	✓	✓	SMOKE DETECTOR	✓	✓	✓		
AM/FM STEREO CASSETTE	MONITOR PANEL	✓	✓		POWER ROOF VENT	✓	✓	✓		
POWER WINDOWS	SLIDE OUT NIGHT TABLE			✓	VANITY	✓	✓			
POWER DOOR LOCKS										

## OPTIONS

360 FUEL INJECTED ENGINE

RUNNING BOARDS

T.V. ANTENNA

HOT WATER

CONTINENTAL SPARE TIRE CARRIER

AWNING

### NEW FOR 1991

With Pleasure-Way's  
commitment to building only  
the finest in Class B  
Motorhomes we have added  
three more models to our line:  
the VRL, VST and TW.

Each of these models has been  
designed with the quality,  
comfort and character that  
Pleasure-Way is recognized for.

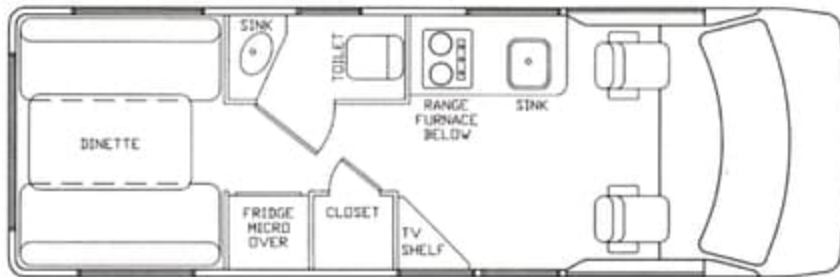

*PLEASURE-WAY VST rear dinette with vanity*

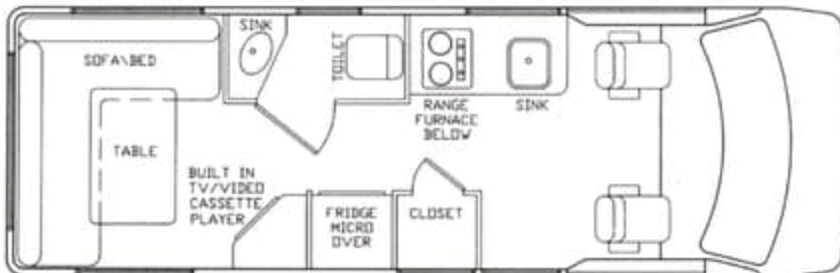

*PLEASURE-WAY VRL rear livingroom with vanity*

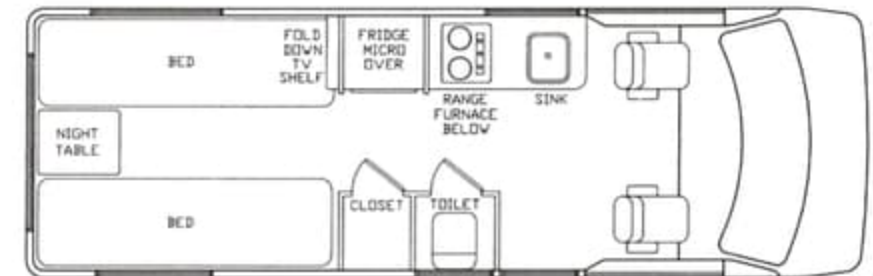

*PLEASURE-WAY TW twin bed*

## MODEL SPECIFICATIONS

**Dodge chassis standard for all models**

**Coach**

VST VRL TW

VST VRL TW

GROSS VEHICLE WEIGHT 6,400 LBS/2910 KGS	3-WAY REFRIGERATOR	✓	✓	✓	FRESH WATER TANK 63.6L/16.8 U.S. GAL.	✓	✓	✓
WHEELBASE 3241mm/127.6 in.	MICROWAVE OVEN	✓	✓	✓	DUAL HOLDING TANK 140L/37 U.S. GAL.	✓	✓	✓
LENGTH (bumper to bumper) 5486mm/18'10"	2-BURNER LP STOVE	✓	✓	✓	PROPANE TANK 30L/7.9 U.S. GAL.	✓	✓	✓
WIDTH 2032mm/6'8"	STAINLESS STEEL SINK	✓	✓	✓	CITY WATER CONNECTION	✓	✓	✓
HEIGHT 8'1"	AUTO FORCED AIR FURNACE	✓	✓	✓	LOCKING FRESH WATER FILL	✓	✓	✓
318 V8 FUEL INJECTED ENGINE	WATER FLUSH TOILET	✓	✓	✓	CAPTAIN'S CHAIRS (swivel & recline)	✓	✓	✓
FUEL CAPACITY 132L/34.8 U.S. GAL.	HOT WATER HEATER	✓	✓		REAR SEAT BELTS (2)		✓	
AUTOMATIC TRANSMISSION	11" COLOUR T.V./VCP 110V/12V		✓		CONVERTIBLE REAR DINETTE (50" x 74")	✓	✓	
FACTORY AIR	BOOMERANG T.V. ANTENNA		✓		REAR TWIN BEDS (28" x 74") or (74" x 74")			✓
TILT STEERING	AUXILIARY BATTERY	✓	✓	✓	EXTRA COCKTAIL TABLE w/STAND	✓	✓	✓
CRUISE CONTROL	110V/12V 30 AMP CONVERTER	✓	✓	✓	FIRE EXTINGUISHER	✓	✓	✓
STEEL BELTED RADIAL TIRES	3 110V RECEPTACLES	✓	✓	✓	SMOKE DETECTOR	✓	✓	✓
AM/FM STEREO CASSETTE	MONITOR PANEL	✓	✓		POWER ROOF VENT	✓	✓	✓
POWER WINDOWS	SLIDE OUT NIGHT TABLE			✓	VANITY	✓	✓	
POWER DOOR LOCKS								

## OPTIONS

360 FUEL INJECTED ENGINE

RUNNING BOARDS

T.V. ANTENNA

HOT WATER

CONTINENTAL SPARE TIRE CARRIER

AWNING

### NEW FOR 1991

With Pleasure-Way's  
commitment to building only  
the finest in Class B  
Motorhomes we have added  
three more models to our line:  
the VRL, VST and TW.

Each of these models has been  
designed with the quality,  
comfort and character that  
Pleasure-Way is recognized for.

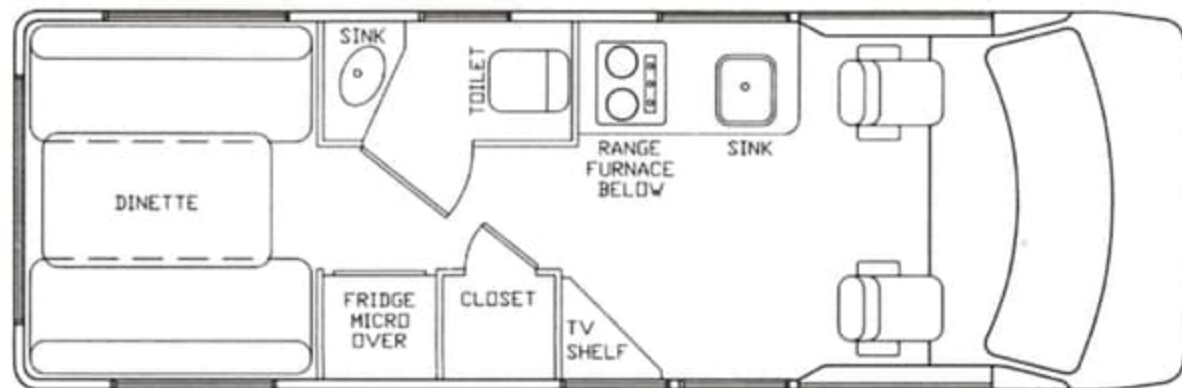

*PLEASURE-WAY VST rear dinette with vanity*

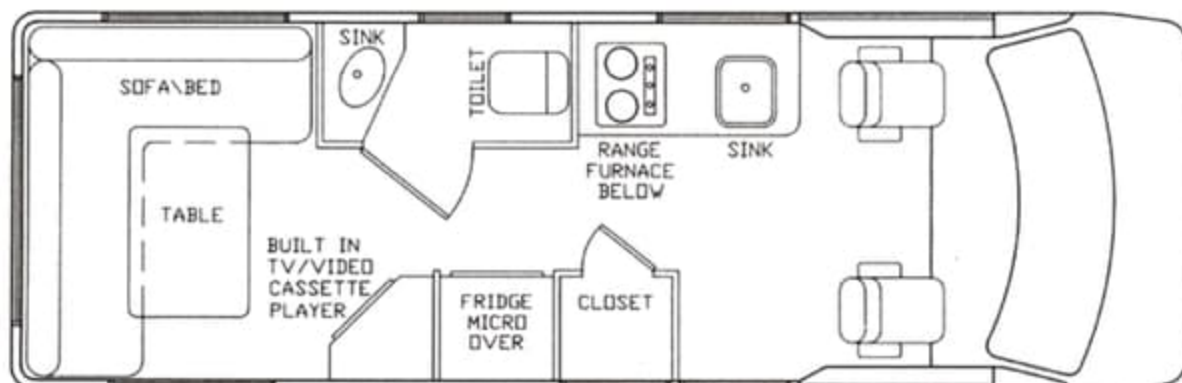

*PLEASURE-WAY VRL rear livingroom with vanity*

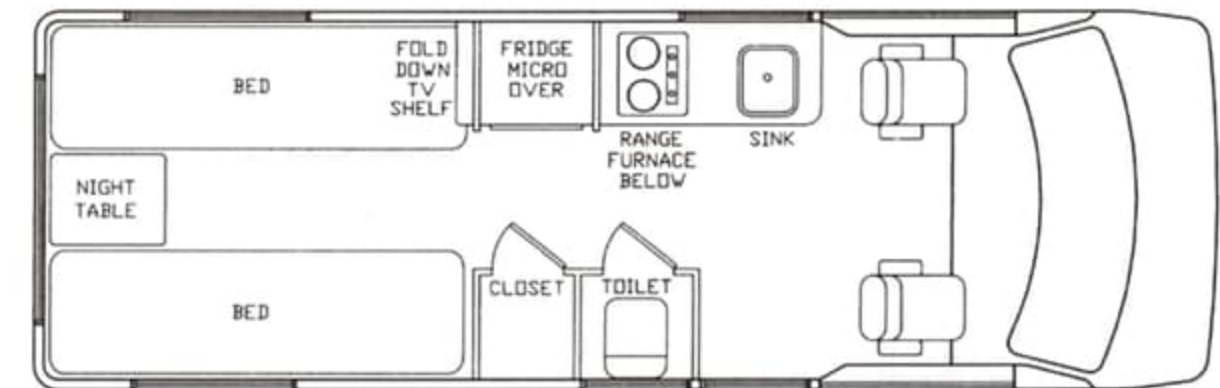

*PLEASURE-WAY TW twin bed*



**Pleasure-Way**

SASKATOON, SASK. CANADA S7L 6C5  
PHONE (306) 664-3404 FAX (306) 665-3302



AUTHORIZED DEALER

Because of our policy of continuous improvements *Pleasure-Way Ind.* reserves the right to make product changes at any time without prior notice and without incurring obligations.



**Pleasure-Way**

SASKATOON, SASK. CANADA S7L 6C5  
 PHONE (306) 664-3404 FAX (306) 665-3302



AUTHORIZED DEALER

Because of our policy of continuous improvements *Pleasure-Way Ind.* reserves the right to make product changes at any time without prior notice and without incurring obligations.