

P A L O M I N O



1994 CAMPING TRAILERS



P A L O M I N O



1994 CAMPING TRAILERS



THOROUGHBRED SERIES

Palomino's travel campers are designed to provide fuel efficient towing, ease of set-up in seconds with full height of camping comfort.

The low profile design, and light towing weight, will allow most family vehicles to trailer these units with ease.

Both the T-175 and the T-195 have been designed with your convenience in mind. The sofa pulls out to provide an extra sleeping area and an upper bunk option is available on all models.

Included on the long list of standard features are 13 inch tires, a three burner stove, radius windows, a four cubic foot refrigerator, 14" x 14" roof vent, and so much more. The T-195 includes a self contained toilet and shower for the complete amenities in camping comfort.

All of these features are offered to you at affordable prices. Take a look at the Thoroughbred Series today for the ultimate in fold down camping.



T-195

Travel Trailer comfort that sets up in seconds and tows with ease.

THOROUGHBRED SERIES

Palomino's travel campers are designed to provide fuel efficient towing, ease of set-up in seconds with full height of camping comfort.

The low profile design, and light towing weight, will allow most family vehicles to trailer these units with ease.

Both the T-175 and the T-195 have been designed with your convenience in mind. The sofa pulls out to provide an extra sleeping area and an upper bunk option is available on all models.

Included on the long list of standard features are 13 inch tires, a three burner stove, radius windows, a four cubic foot refrigerator, 14" x 14" roof vent, and so much more. The T-195 includes a self contained toilet and shower for the complete amenities in camping comfort.

All of these features are offered to you at affordable prices. Take a look at the Thoroughbred Series today for the ultimate in fold down camping.

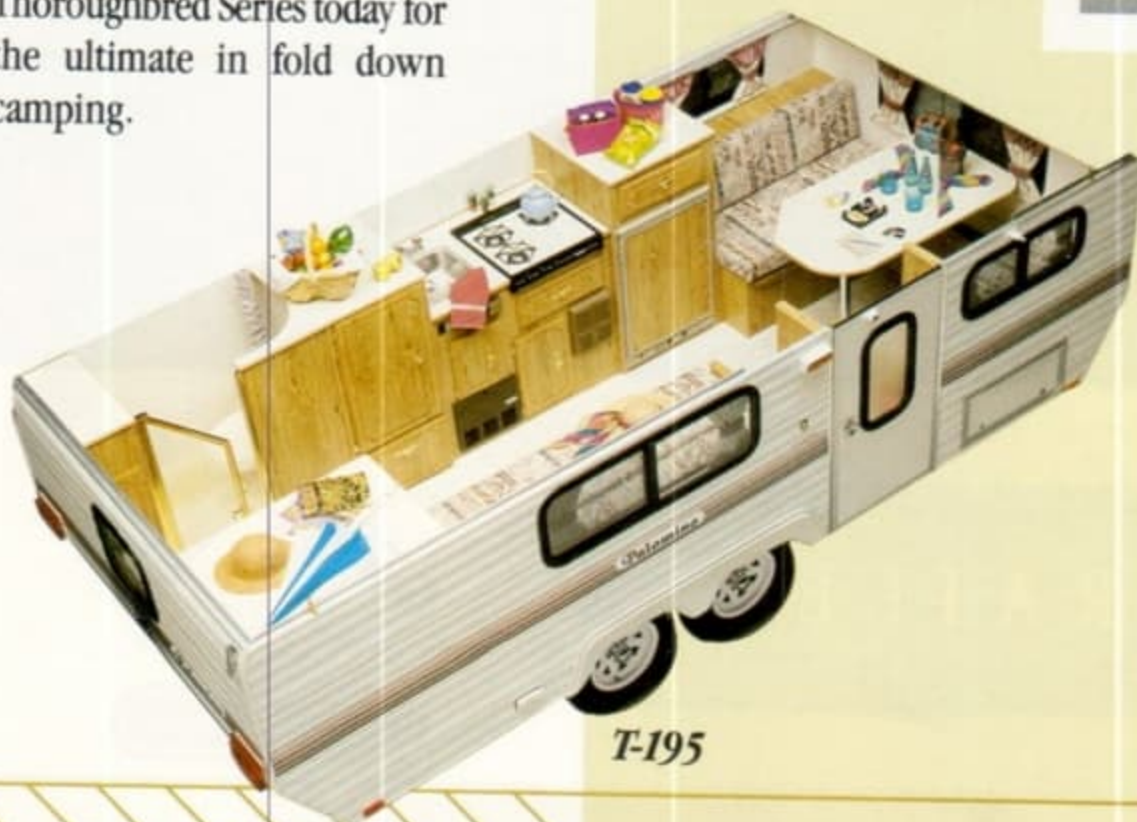

T-195

Travel Trailer comfort that sets up in seconds and tows with ease.

XL SERIES



Ultra-comfortable Fold-A-Wall trailers provide the comfort and feel of a travel trailer, with the towing convenience of a camping trailer.

The TXL series offers two different floor plans that provide a self contained toilet with a shower or the roomy front gaucho model.

Included as standard equipment on all models are 13-inch tires, electric brakes, four stabilizer jacks and independent suspension. Also included as standard items are window curtains, indoor/outdoor stove and a roomy wardrobe closet, plus a 14" x 14" roof vent

The sidewalls set up with ease as you raise the unit. Once the camper is raised you simply snap the walls in place.

The XL units provide the durability and security of a travel trailer yet they provide the feeling of outdoor camping.



TXL-SC

For over 19 years, Palomino has specialized in solid Fold-A-Wall construction.

XL SERIES



Ultra-comfortable Fold-A-Wall trailers provide the comfort and feel of a travel trailer, with the towing convenience of a camping trailer.

The TXL series offers two different floor plans that provide a self contained toilet with a shower or the roomy front gaucho model.

Included as standard equipment on all models are 13-inch tires, electric brakes, four stabilizer jacks and independent suspension. Also included as standard items are window curtains, indoor/outdoor stove and a roomy wardrobe closet, plus a 14" x 14" roof vent

The sidewalls set up with ease as you raise the unit. Once the camper is raised you simply snap the walls in place.

The XL units provide the durability and security of a travel trailer yet they provide the feeling of outdoor camping.

For over 19 years, Palomino has specialized in solid Fold-A-Wall construction.



TXL-SC

MUSTANG-LB & DD

Palomino's roomiest soft sided trailer with more than 23 feet of interior length is offered in two popular floor plans.

The double dinette model provides plenty of dining space for the whole family, plus a maximum amount of sleeping area.

The long bed model offers an 80" bed, plus a large wrap around seating area with a lift-up port-a-potti storage area. Included on the Mustang's long list of standard features are 13-inch tires with independent suspension, a handy indoor/outdoor three burner stove, four stabilizer jacks, 4" deluxe cushions, and a sturdy vinyl tent with tinted windows.

With two dinettes & a kingsize bed area it's even roomy on a rainy day



MUSTANG-DD

MUSTANG-LB & DD

Palomino's roomiest soft sided trailer with more than 23 feet of interior length is offered in two popular floor plans.

The double dinette model provides plenty of dining space for the whole family, plus a maximum amount of sleeping area.

The long bed model offers an 80" bed, plus a large wrap around seating area with a lift-up port-a-potti storage area. Included on the Mustang's long list of standard features are 13-inch tires with independent suspension, a handy indoor/outdoor three burner stove, four stabilizer jacks, 4" deluxe cushions, and a sturdy vinyl tent with tinted windows.

With two dinettes & a kingsize bed area it's even roomy on a rainy day



MUSTANG-DD

FILLY-LB & RG



Choose from the Filly Long Bed or Rear Gaucho to settle in for a great family vacation.

Both models have a standard three burner indoor/outdoor range, independent suspension, port-a-potti storage, ice chest, and a durable vinyl tent with tinted windows. If you're looking for a lightweight, affordable tent trailer with an incredible value look at the '94 Filly models.



The Filly models continue to lead the Palomino's in customer popularity at a very affordable price.



FILLY-RG

FILLY-LB & RG



Choose from the Filly Long Bed or Rear Gaucho to settle in for a great family vacation.

Both models have a standard three burner indoor/outdoor range, independent suspension, port-a-potti storage, ice chest, and a durable vinyl tent with tinted windows. If you're looking for a lightweight, affordable tent trailer with an incredible value look at the '94 Filly models.



The Filly models continue to lead the Palomino's in customer popularity at a very affordable price.



FILLY-RG

STALLION & PINTO

Finally, there is a fold down that meets all your expectations. Innovative design with storage in mind. The Stallion & Pinto enter the Palomino 1994 line-up to satisfy the camping family who desires a popular floor plan that allows for extra storage space and is still very affordable.

Both models allow easy access to the front storage area from inside or outside of the trailer. The Stallion has 22 cubic feet of storage space available and the Pinto offers 18 cubic feet of storage space.



Easy access from inside or outside makes for a quick set up at your favorite campsite.



PINTO



STALLION & PINTO

Finally, there is a fold down that meets all your expectations. Innovative design with storage in mind. The Stallion & Pinto enter the Palomino 1994 line-up to satisfy the camping family who desires a popular floor plan that allows for extra storage space and is still very affordable.

Both models allow easy access to the front storage area from inside or outside of the trailer. The Stallion has 22 cubic feet of storage space available and the Pinto offers 18 cubic feet of storage space.



Easy access from inside or outside makes for a quick set up at your favorite campsite.



PINTO



STALLION & PINTO

With two models available you can make the choice that will meet your family's camping requirements. Of course all of the standard Palomino features are included, such as our vinyl tent, large ice chest, 14" x 14" roof vent, and deluxe cushions and mattresses.

Other value features include a torsion axle, 12" tires and our laminated construction. Take a look at the Stallion series for affordable camping comfort with storage galore.

Crank-up Lift System

1. The drive system is enclosed for protection from weather and road conditions.
2. The underneath location of the system allows for easy inspection and maintenance. Grease zerks are located top and bottom of the main tube to allow yearly maintenance.
3. A single cable capable of 3,200 lbs. tensile strength rotates around the rear cable pulley and pushes the four flexible steel push rods up the lifter posts.
4. Flexible steel push rods.
5. Three stage plated lift post.

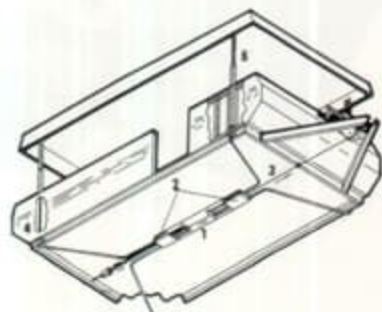

STALLION

STALLION & PINTO

With two models available you can make the choice that will meet your family's camping requirements. Of course all of the standard Palomino features are included, such as our vinyl tent, large ice chest, 14" x 14" roof vent, and deluxe cushions and mattresses.

Other value features include a torsion axle, 12" tires and our laminated construction. Take a look at the Stallion series for affordable camping comfort with storage galore.

Crank-up Lift System

1. The drive system is enclosed for protection from weather and road conditions.
2. The underneath location of the system allows for easy inspection and maintenance. Grease zerks are located top and bottom of the main tube to allow yearly maintenance.
3. A single cable capable of 3,200 lbs. tensile strength rotates around the rear cable pulley and pushes the four flexible steel push rods up the lifter posts.
4. Flexible steel push rods.
5. Three stage plated lift post.

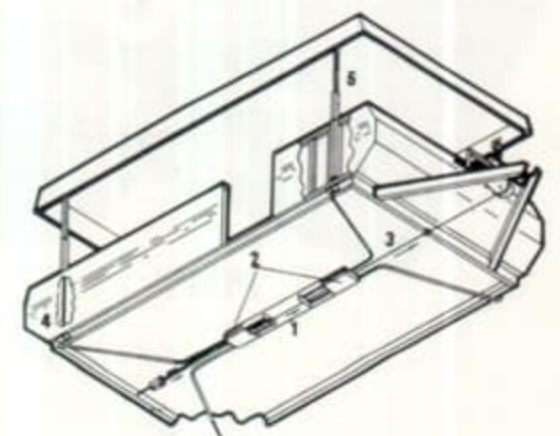

STALLION

PONY, COLT, YEARLING

These easy-towing units have an economical price and are well equipped to make ideal camping companions for veteran campers and first timers, too.

Easily towed with a four cylinder car, these lightweight trailers offer complete kitchens, top loading ice chest, vinyl tent, built in jacks, and independent suspension.

Check out the long list of convenience features that are standard with these three popular models.



PONY



COLT

PONY, COLT, YEARLING

These easy-towing units have an economical price and are well equipped to make ideal camping companions for veteran campers and first timers, too.

Easily towed with a four cylinder car, these lightweight trailers offer complete kitchens, top loading ice chest, vinyl tent, built in jacks, and independent suspension.

Check out the long list of convenience features that are standard with these three popular models.



*Optional Deluxe Package
(Pony - Colt) Radius Roof,
12" Tires, Bumper & Tire
Mount, 14 x 14 Roof Vent,
Outside Receptacle, Clothes
Bar, Patio Light, Valance.*



PONY



COLT

FLOOR PLANS

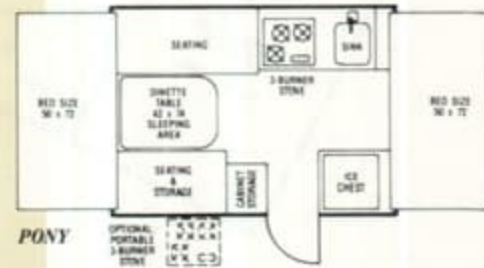
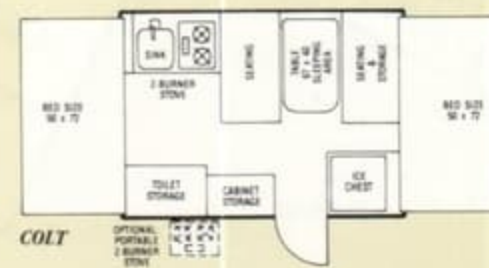
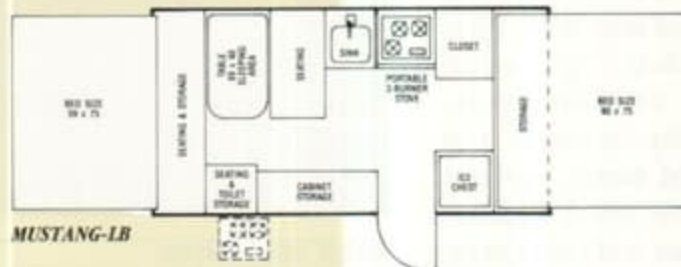
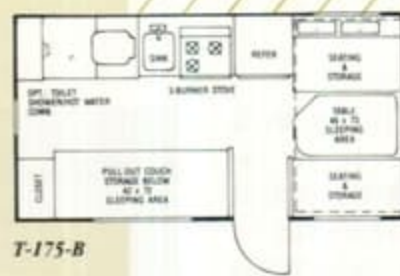

FLOOR PLANS

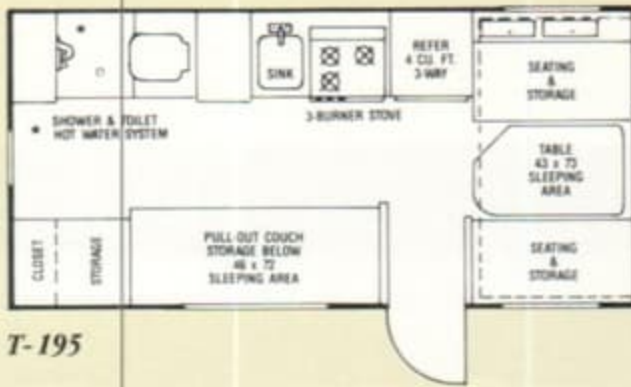

T-195

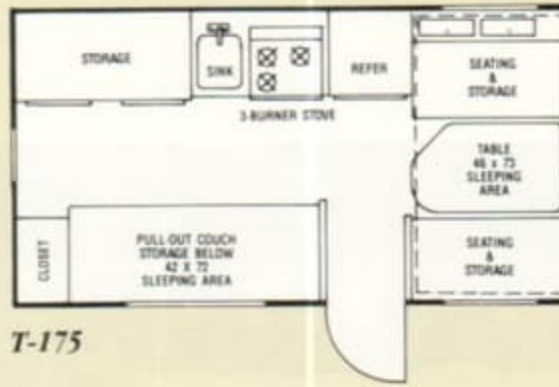

T-175

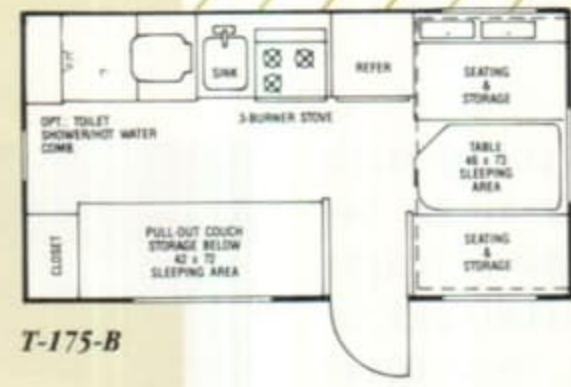

T-175-B

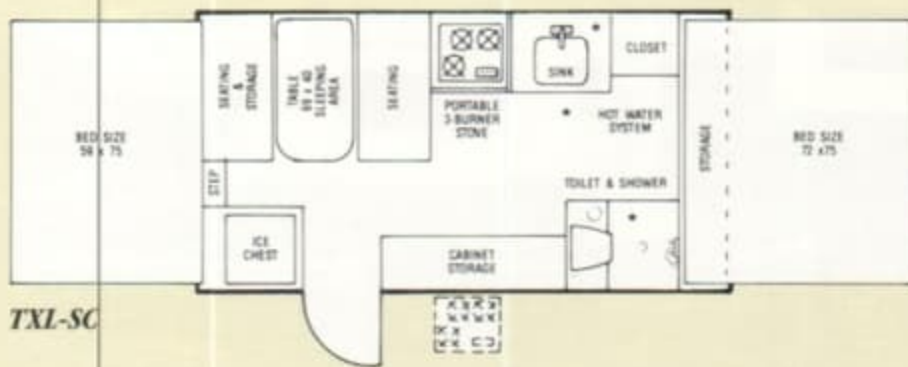

TXL-SC



TXL-FG



MUSTANG-DD

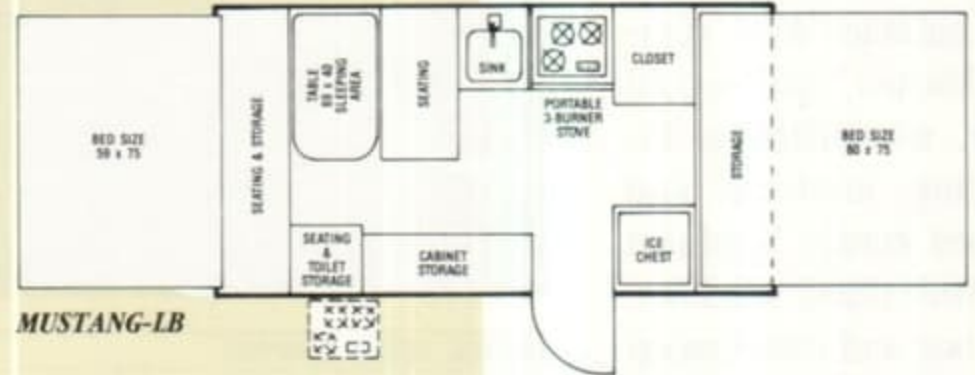

MUSTANG-LB

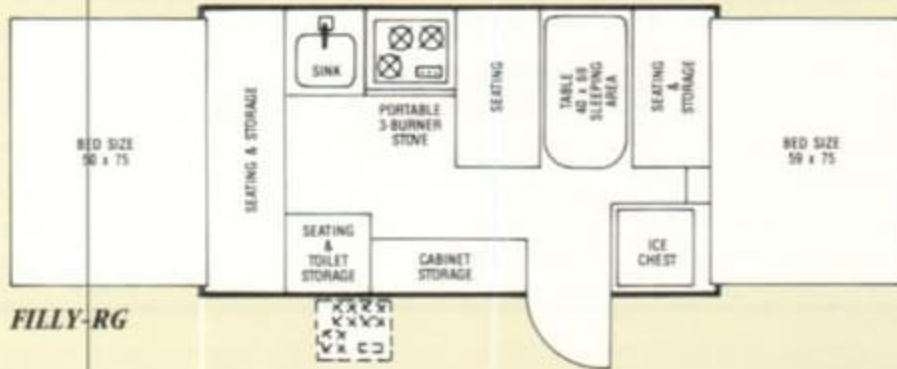

FILLY-RG



FILLY-LB



STALLION
(TRUNK)

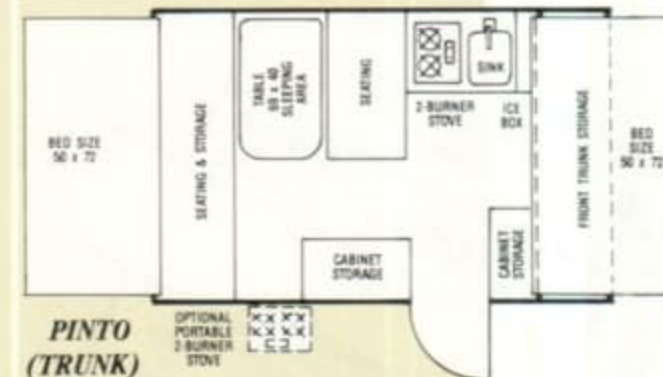

PINTO
(TRUNK)



YEARLING-LB

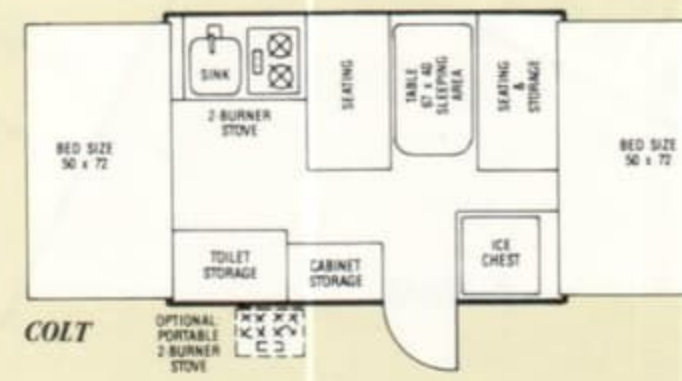

COLT

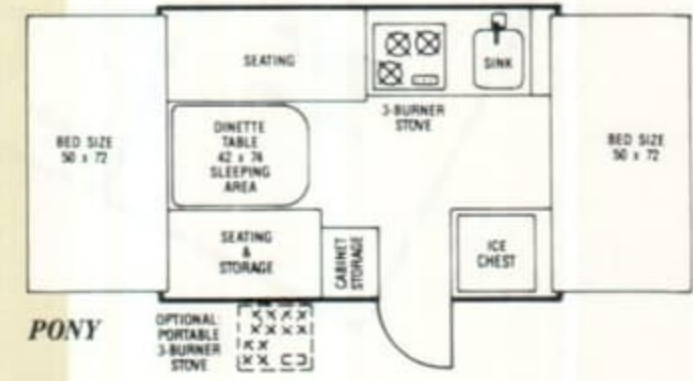

PONY

BRONCO TRUCK CAMPERS

Palomino pop-up truck campers—one of the industry's lightest weight lines—are the ideal match for today's trucks. The B-500 fits many of today's mini trucks—both imported and domestic—while the B-1000 is perfectly suited for most half-ton trucks.

Both models are well-equipped for maximum comfort. Standards include a full-height entrance door, complete kitchen, port-a-potti storage, a comfortable innerspring mattress and underbed storage. Vinyl tent fabric with tinted windows, an ice box and combination sliding/jalousie glass windows are also standard equipment.

When closed, Palomino truck campers have a low profile for greater fuel efficiency. A smooth-operating crank-up system raises and lowers the roof quickly and easily.

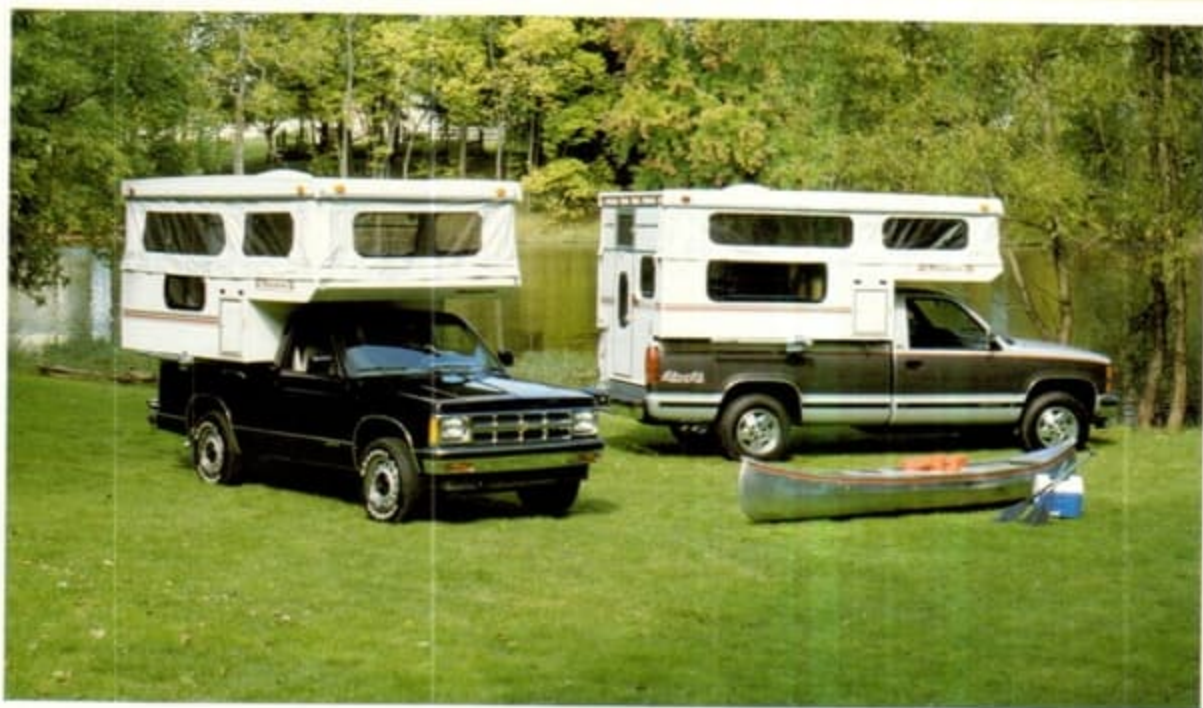

BRONCO TRUCK CAMPERS	B-500	B-1000
WEIGHT - POUNDS	740	935
BOX LENGTH	7'4"	8'
TOTAL LENGTH	10'7"	11'10"
WHEEL WELL WIDTH	36"	48"
TOTAL HEIGHT CLOSED	4'8"	5'4"
INTERIOR HEADROOM	6'4"	6'4"
BED SIZE	45" X 75"	49" X 83"
BED SIZE DINETTE	35" X 70"	36" X 73"
ENTRANCE DOOR HEIGHT	5'6"	5'7"

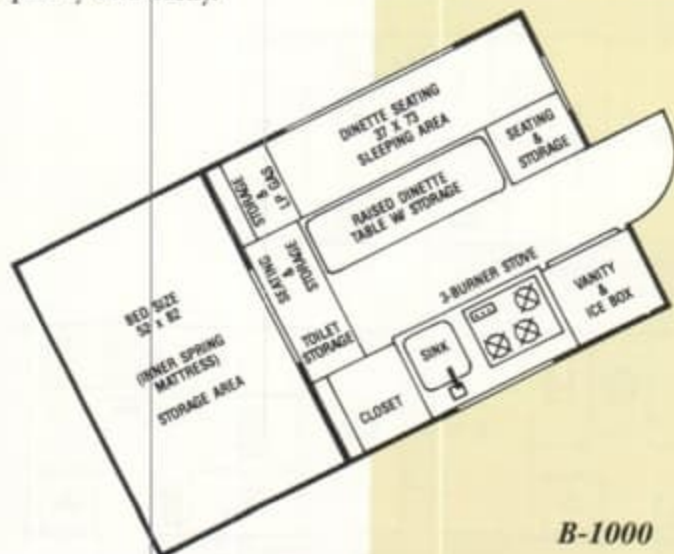

B-1000

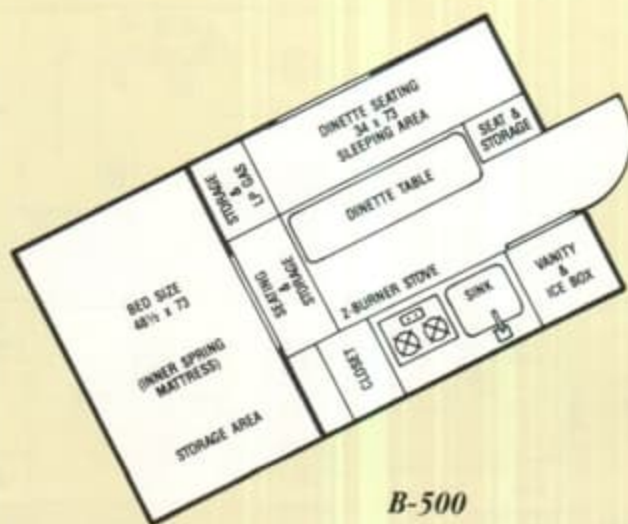

B-500

BRONCO TRUCK CAMPERS

Palomino pop-up truck campers—one of the industry's lightest weight lines—are the ideal match for today's trucks. The B-500 fits many of today's mini trucks—both imported and domestic—while the B-1000 is perfectly suited for most half-ton trucks.

Both models are well-equipped for maximum comfort. Standards include a full-height entrance door, complete kitchen, port-a-potti storage, a comfortable innerspring mattress and underbed storage. Vinyl tent fabric with tinted windows, an ice box and combination sliding/jalousie glass windows are also standard equipment.

When closed, Palomino truck campers have a low profile for greater fuel efficiency. A smooth-operating crank-up system raises and lowers the roof quickly and easily.



BRONCO TRUCK CAMPERS	B-500	B-1000
WEIGHT - POUNDS	740	935
BOX LENGTH	7'4"	8'
TOTAL LENGTH	10'7"	11'10"
WHEEL WELL WIDTH	36"	48"
TOTAL HEIGHT CLOSED	4'8"	5'4"
INTERIOR HEADROOM	6'4"	6'4"
BED SIZE	45" X 75"	49" X 83"
BED SIZE DINETTE	35" X 70"	36" X 73"
ENTRANCE DOOR HEIGHT	5'6"	5'7"

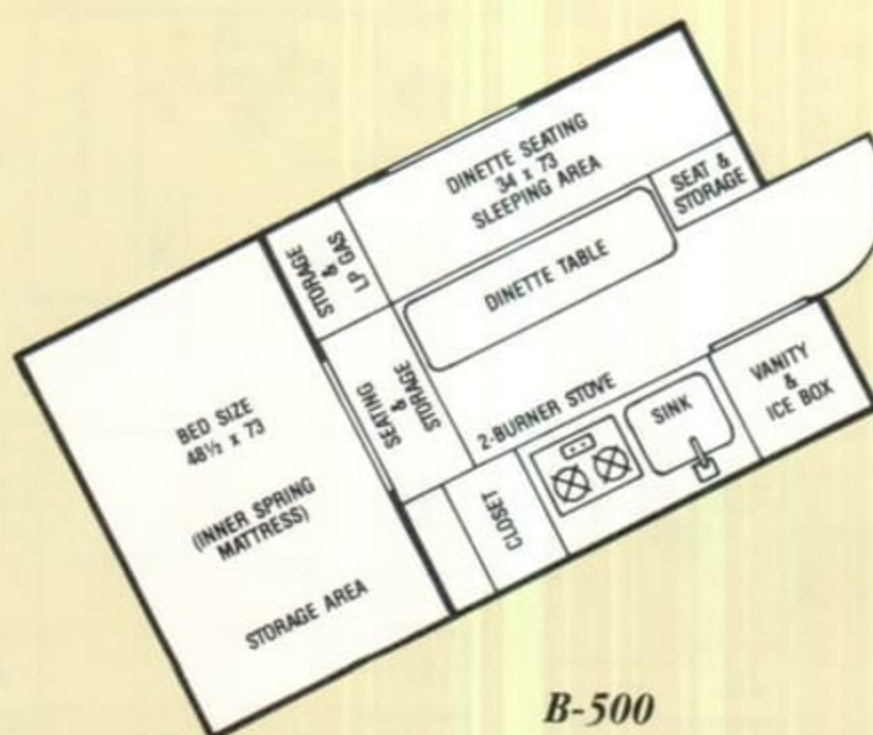
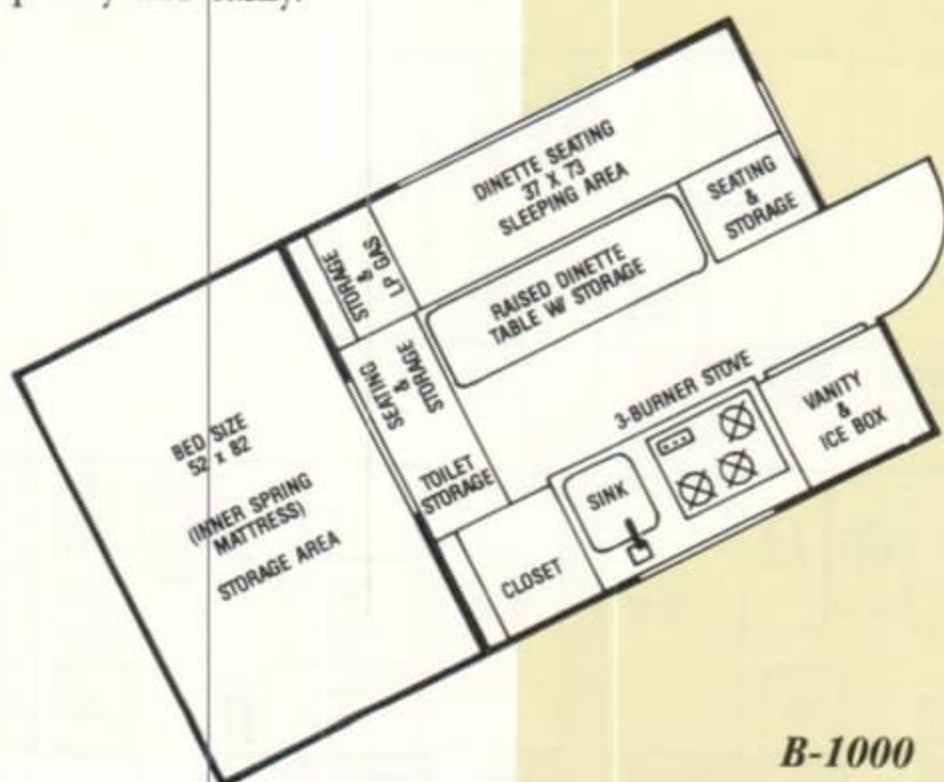

OPTIONAL & STANDARD FEATURES

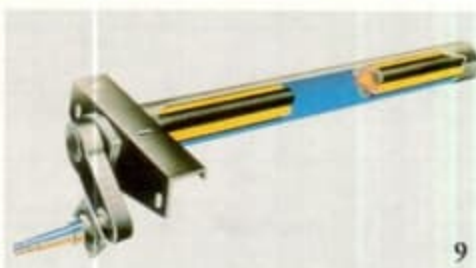

1. ATTACHABLE SCREEN ROOM - It attaches to your canopy in minutes and provides additional outdoor enjoyment.

2. CANOPY-IN-A-BAG -Free standing, sets up in minutes. Stores in its own vinyl bag.

3. WHEEL WELLS AND FLOORS - Open galvanized wheel wells allow for easy access to wheels when needed. Weyerhaeuser Structurwood® one-piece floor has limited lifetime warranty.

4. ROOF MOUNTED AIR CONDITIONER READY - Available for all models.

5. ROOF RACK - Available for all models. Includes mounting brackets. Ideal for canoes and other small boats.

6. REFRIGERATOR-DOMETIC - Two way system: LP Gas and 12-volt 3-way refrigerator option available on TXL-FG and TXL-SC only.

7. IN AND OUT STOVE -Have the convenience of inside or outside cooking. Available on most models.

8. SHOWER - Includes hot water system. Standard in T-195, TXL-SC. Optional in T-175.

9. AL-KO Axle - Allows for independent suspension, smoother towing, 5 year limited warranty.

Photography sites courtesy of **FUNCTION JUNCTION** Mendon, Michigan.

LIFETIME LIMITED WARRANTY - Vanguard Industries warrants a lifetime limited warranty to the original owner for: Lifter Systems, Beds, Frames and Floors. **TENT WARRANTY** - Vinyl Tents manufactured by Vanguard Industries are warranted for 5 years to original owner. Free from defects in materials and workmanship under normal use and service.

OPTIONAL & STANDARD FEATURES



1. ATTACHABLE SCREEN ROOM - It attaches to your canopy in minutes and provides additional outdoor enjoyment.

2. CANOPY-IN-A-BAG - Free standing, sets up in minutes. Stores in its own vinyl bag.



3. WHEEL WELLS AND FLOORS - Open galvanized wheel wells allow for easy access to wheels when needed. Weyerhaeuser Structurwood® one-piece floor has limited lifetime warranty.



4. ROOF MOUNTED AIR CONDITIONER READY - Available for all models.

5. ROOF RACK - Available for all models. Includes mounting brackets. Ideal for canoes and other small boats.



6. REFRIGERATOR-DOMETIC - Two way system: LP Gas and 12-volt 3-way refrigerator option available on TXL-FG and TXL-SC only.

7. IN AND OUT STOVE - Have the convenience of inside or outside cooking. Available on most models.

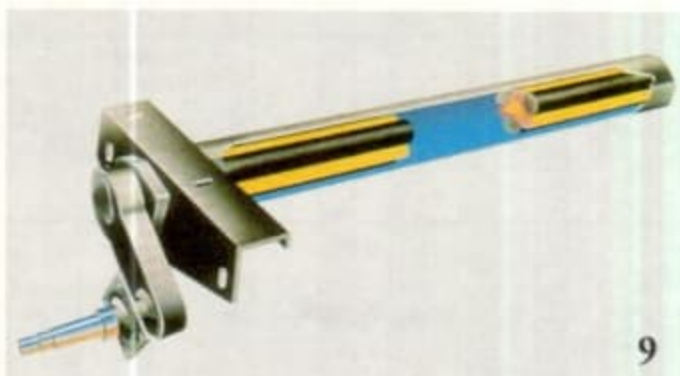

8. SHOWER - Includes hot water system. Standard in T-195, TXL-SC. Optional in T-175.

9. AL-KO Axle - Allows for independent suspension, smoother towing, 5 year limited warranty.

Photography sites courtesy of **FUNCTION JUNCTION** Mendon, Michigan.

LIFETIME LIMITED WARRANTY - Vanguard Industries warrants a lifetime limited warranty to the original owner for: Lifter Systems, Beds, Frames and Floors. **TENT WARRANTY** - Vinyl Tents manufactured by Vanguard Industries are warranted for 5 years to original owner. Free from defects in materials and workmanship under normal use and service.

SPECIFICATIONS

MODEL	T-195	T-175	TXL-SC	TXL-FG	MUST DD-LB	FILLY RG-LB	STALLION	PINTO	YEARLING	COLT	PONY
CLOSED BODY	7'1" X 15'5"	7'1" X 13'9"	6'9" X 13'5"	6'9" X 13'5"	6'9" X 13'5"	6'9" X 11'8"	6'9" X 12'	6'6" X 10'11"	6'6" X 10'2"	6'6" X 9'	6'6" X 9'
CLOSED OVERALL	18'8"	17'2"	6'10" X 16'6"	6'10" X 16'6"	6'10" X 16'6"	6'10" X 14'8"	6'10" X 15'6"	6'7" X 14'5"	6'7" X 13'2"	6'7" X 12'	6'7" X 12'
CLOSED HEIGHT	6'3"	6'3"	54½"	54½"	51"	48"	48"	48"	48"	47"	47"
OPEN LENGTH	N/A	N/A	23'6"	23'6"	23'4"	20'6"	19'	16'10"	18'6"	16'9"	16'9"
OPEN HEIGHT	6'5"	6'5"	6'5"	6'5"	6'3"	6'3"	6'3"	6'3"	6'3"	6'3"	6'3"
HITCH WEIGHT - POUNDS	250	210	180	175	160	150	105	100	140	120	120
AXLE WEIGHT - POUNDS	2,220	1,640	1,810	1,715	1,430	1,220	1,290	1,095	1,130	875	875
TIRE SIZE	13	13	13	13	13	12	12	12	12	8 (12 OPT.)	8 (12 OPT.)
SPARE TIRE	0	0	0	0	0	0	0	0	0	0	0
SPARE TIRE COVER	0	0	0	0	0	0	0	0	0	0	0
SPARE TIRE MOUNT AND BUMPER	S	S	S	S	S	S	S	S	S	0	0
ELECTRIC BRAKES	S	S	S	S	0	0	0	0	0	0	0
TORSION AXLE	S	S	S	S	S	S	S	S	S	S	S
OPEN WHEEL WELL	S	S	S	S	S	S	S	S	S	S	S
WATER TANK - GALLON CAPACITY	25	16 (25 HW)	16	10	10	10	10	5	10	5	5
CITY WATER HOOKUP	S	S	S	S	S	S	S	S	S	S	S
HOT WATER SYSTEM	S	0	S	0	0	—	—	—	—	—	—
SHOWER AND TOILET	S	0	S	—	—	—	—	—	—	—	—
DOMESTIC LIGHTS	S	S	S	S	S	S	S	S	S	S	S
9-AMP 12-VOLT POWER CONVERTER	25 Amp	S	25 Amp	S	S	S	S	S	S	S	S
110-VOLT OUTSIDE RECEPTACLE	S	S	S	S	S	S	S	S	S	0	0
LP/12-VOLT REFRIGERATOR	S (4 CU)	S (4 CU)	0	0	0	0	0	0	0	—	0
ICE CHEST	—	—	S	S	S	S	S	S	S	S	S
3-BURNER STOVE	S	S	S	S	S	S	S	(2)	S	(2)	S
IN/OUT STOVE	—	—	S	S	S	S	S	0	S	0	0
20-LB GAS BOTTLE AND REGULATOR	(2)	S	S	S	S	S	S	S	S	S	S
16,000 BTU FURNACE	0	0	0	0	0	0	0	0	0	0	0
LAMINATED CONSTRUCTION	S	S	S	S	S	S	S	S	S	S	S
ONE-PIECE UNDERCOATED FLOOR	S	S	S	S	S	S	S	S	S	S	S
RADIUS ROOF	S	S	S	S	S	S	S	S	S	0	0
ROOF VENT	S	S	S	S	S	S	S	S	S	0	0
AWNING RAIL	S	S	S	S	S	S	S	S	S	S	S
FRONT BED AREAS	—	—	72"	59"	LB 80" DD 59"	RG 59" LB 80"	59"	50"	50"	50"	50"
REAR BED AREAS	—	—	59"	59"	LB 59" DD 59"	RG 50" LB 50"	50"	50"	64"	50"	50"
DELUXE CUSHIONS AND MATTRESSES	S	S	S	S	S	S	S	S	S	S	S
WINDOW CURTAINS	S	S	S	S	S	0	0	0	0	0	0
BED END CURTAINS	0	0	0	0	0	0	0	0	0	0	0
VINYL TENT	S	S	S	S	S	S	S	S	S	S	S
CRANK LIFT SYSTEM	S	S	S	S	S	S	S	S	S	S	S
ROOF READY FOR AIR CONDITIONING	S	S	0	0	0	0	0	0	0	0	0
DELUXE STEP	S	S	0	0	0	0	0	0	0	0	0
CLOTHES RACK & SILVERWARE DRAWER UNDER TABLE	—	—	S	S	S	S	S	S	S	S	S
PATIO LIGHT	S	S	S	S	S	S	S	S	S	0	0
STAINLESS STEEL SINK	S	S	S	S	S	S	S	S	S	S	S
STONE SHIELD	—	—	S	S	S	S	S	S	—	—	—

S=STANDARD O=OPTIONAL —=NOT AVAILABLE

ALL PALOMINOS BUILT TO COMPLY WITH RVI CODES, AND AMERICAN NATIONAL STANDARDS INSTITUTE REGULATIONS. SPECIFICATIONS SUBJECT TO CHANGE WITHOUT NOTICE. SPECIFICATIONS IN THIS BROCHURE ARE BASED ON INFORMATION AT TIME OF PUBLICATION. VANGUARD INDUSTRIES OF MICHIGAN, INC., RESERVES THE RIGHT TO MAKE CHANGES IN MATERIALS, COMPONENTS AND SPECIFICATIONS AND TO DISCONTINUE MODELS AT ANY TIME WITHOUT NOTICE OR OBLIGATION. DEPENDING ON MATERIALS FROM TIME TO TIME, WEIGHTS MAY VARY PLUS OR MINUS FIVE PERCENT.



VANGUARD INDUSTRIES
OF MICHIGAN, INC.
Colon, Michigan 49040
Phone (616) 432-3271

PALOMINO

SPECIFICATIONS

MODEL	T-195	T-175	TXL-SC	TXL-FG	MUST DD-LB	FILLY RG-LB	STALLION	PINTO	YEARLING	COLT	PONY
CLOSED BODY	7'1" X 15'5"	7'1" X 13'9"	6'9" X 13'5"	6'9" X 13'5"	6'9" X 13'5"	6'9" X 11'8"	6'9" X 12	6'6" X 10'11"	6'6" X 10'2"	6'6" X 9'	6'6" X 9'
CLOSED OVERALL	18'8"	17'2"	6'10" X 16'6"	6'10" X 16'6"	6'10" X 16'6"	6'10" X 14'8"	6'10" X 15'6"	6'7" X 14'5"	6'7" X 13'2"	6'7" X 12'	6'7" X 12'
CLOSED HEIGHT	6'3"	6'3"	54½"	54½"	51	48"	48"	48"	48"	47"	47"
OPEN LENGTH	N/A	N/A	23'6"	23'6"	23'4"	20'6"	19'	16'10"	18'6"	16'9"	16'9"
OPEN HEIGHT	6'5"	6'5"	6'5"	6'5"	6'3"	6'3"	6'3"	6'3"	6'3"	6'3"	6'3"
HITCH WEIGHT - POUNDS	250	210	180	175	160	150	105	100	140	120	120
AXLE WEIGHT - POUNDS	2,220	1,640	1,810	1,715	1,430	1,220	1,290	1,095	1,130	875	875
TIRE SIZE	13	13	13	13	13	12	12	12	12	8 (12 OPT.)	8 (12 OPT.)
SPARE TIRE	0	0	0	0	0	0	0	0	0	0	0
SPARE TIRE COVER	0	0	0	0	0	0	0	0	0	0	0
SPARE TIRE MOUNT AND BUMPER	S	S	S	S	S	S	S	S	S	0	0
ELECTRIC BRAKES	S	S	S	S	0	0	0	0	0	0	0
TORSION AXLE	S	S	S	S	S	S	S	S	S	S	S
OPEN WHEEL WELL	S	S	S	S	S	S	S	S	S	S	S
WATER TANK - GALLON CAPACITY	25	16 (25 HW)	16	10	10	10	10	5	10	5	5
CITY WATER HOOKUP	S	S	S	S	S	S	S	S	S	S	S
HOT WATER SYSTEM	S	0	S	0	0	—	—	—	—	—	—
SHOWER AND TOILET	S	0	S	—	—	—	—	—	—	—	—
DOMES LIGHTS	S	S	S	S	S	S	S	S	S	S	S
9-AMP 12-VOLT POWER CONVERTER	25 Amp	S	25 Amp	S	S	S	S	S	S	S	S
110-VOLT OUTSIDE RECEPTACLE	S	S	S	S	S	S	S	S	S	0	0
LP/12-VOLT REFRIGERATOR	S (4 CU)	S (4 CU)	0	0	0	0	0	0	0	—	0
ICE CHEST	—	—	S	S	S	S	S	S	S	S	S
3-BURNER STOVE	S	S	S	S	S	S	S	(2)	S	(2)	S
IN/OUT STOVE	—	—	S	S	S	S	S	0	S	0	0
20-LB GAS BOTTLE AND REGULATOR	(2)	S	S	S	S	S	S	S	S	S	S
16,000 BTU FURNACE	0	0	0	0	0	0	0	0	0	0	0
LAMINATED CONSTRUCTION	S	S	S	S	S	S	S	S	S	S	S
ONE-PIECE UNDERCOATED FLOOR	S	S	S	S	S	S	S	S	S	S	S
RADIUS ROOF	S	S	S	S	S	S	S	S	S	0	0
ROOF VENT	S	S	S	S	S	S	S	S	S	0	0
AWNING RAIL	S	S	S	S	S	S	S	S	S	S	S
FRONT BED AREAS	—	—	72"	59"	LB-80" DD 59"	RG 59" LB 80"	59"	50"	50"	50"	50"
REAR BED AREAS	—	—	59"	59"	LB 59" DD 59"	RG 50" LB 50"	50"	50"	64"	50"	50"
DELUXE CUSHIONS AND MATTRESSES	S	S	S	S	S	S	S	S	S	S	S
WINDOW CURTAINS	S	S	S	S	S	0	0	0	0	0	0
BED END CURTAINS	0	0	0	0	0	0	0	0	0	0	0
VINYL TENT	S	S	S	S	S	S	S	S	S	S	S
CRANK LIFT SYSTEM	S	S	S	S	S	S	S	S	S	S	S
ROOF READY FOR AIR CONDITIONING	S	S	0	0	0	0	0	0	0	0	0
DELUXE STEP	S	S	0	0	0	0	0	0	0	0	0
CLOTHES RACK & SILVERWARE DRAWER UNDER TABLE	—	—	S	S	S	S	S	S	S	S	S
PATIO LIGHT	S	S	S	S	S	S	S	S	S	0	0
STAINLESS STEEL SINK	S	S	S	S	S	S	S	S	S	S	S
STONE SHIELD	—	—	S	S	S	S	S	S	—	—	—

S=STANDARD 0=OPTIONAL —=NOT AVAILABLE

ALL PALOMINOS BUILT TO COMPLY WITH RVI CODES, AND AMERICAN NATIONAL STANDARDS INSTITUTE REGULATIONS. SPECIFICATIONS SUBJECT TO CHANGE WITHOUT NOTICE. SPECIFICATIONS IN THIS BROCHURE ARE BASED ON INFORMATION AT TIME OF PUBLICATION. VANGUARD INDUSTRIES OF MICHIGAN, INC., RESERVES THE RIGHT TO MAKE CHANGES IN MATERIALS, COMPONENTS AND SPECIFICATIONS AND TO DISCONTINUE MODELS AT ANY TIME WITHOUT NOTICE OR OBLIGATION. DEPENDING ON MATERIALS FROM TIME TO TIME, WEIGHTS MAY VARY PLUS OR MINUS FIVE PERCENT.



VANGUARD INDUSTRIES
OF MICHIGAN, INC.
Colon, Michigan 49040
Phone (616) 432-3271

PALOMINO