

Carvi-Go[®]

BY DYNAMAX



TRAVEL HIGHWAYS TO ADVENTURE

The image shows the interior of a motorhome with light wood paneling. On the left is a kitchen counter with a white sink, a white microwave, and a stove with a blue pot. In the center is a rear corner bed with a patterned quilt and two pillows. On the right is a living area with a patterned sofa and a table set with a plate of food and two glasses of orange juice. A window with dark curtains is visible on the right side.

*Carri-Go 2310 shown
in Oxford Blue with an
easy living area featuring
a rear corner bed, corner
bath and ample kitchen.
Stay cool with an
optional 13,500 BTU
air conditioner.*

Carri-Go®

2510
2520

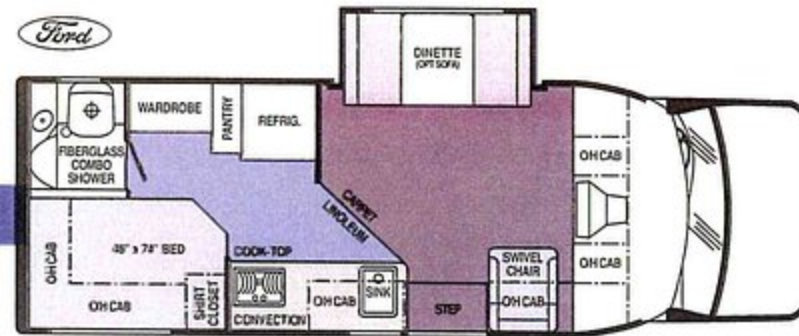

2510 Corner bed available with dinette and swivel chair or optional sofa.

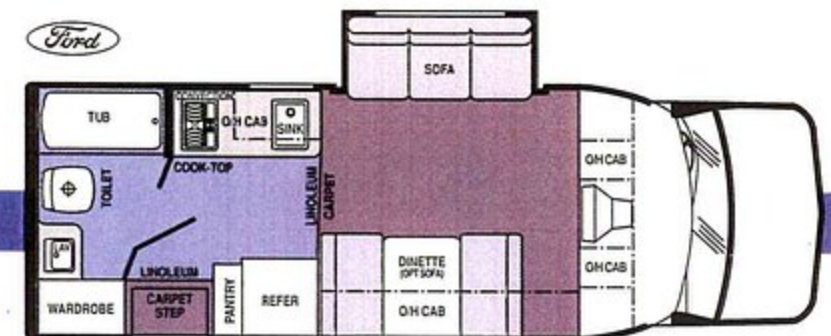

2520 Rear bath available with dinette or optional sofa.

The spacious Carri-Go 2520's slide-out is shown with standard iridescent striping and optional 13,500 BTU roof air conditioner, lower accent paint and exterior appearance package including a painted front bumper cover, fog lights, bumper step and painted grille.





At the push of a button, increase your living space over 14 square feet. This slide-out Carri-Go 2520 is shown Santa Fe Sage with sofa bed, dinette, optional 13,500 BTU roof air conditioner and 19" color TV.

CARRI-GO STANDARD FEATURES

CHASSIS & CAB FEATURES

- 2310 & 2320 Chassis: Ford E350
 - Engine: 6.8 Liter V-10
 - Wheelbase: 158 in.
 - GVWR: 11,500
 - GCWR: 20,000
 - Axle Ratio: 4:10
 - Driver & Passenger Air Bags
 - AM/FM Cassette CD Stereo
- 2310 & 2320 Chassis: Chevy 3500
 - Engine: 8.1 Liter V-8
 - Wheelbase: 159 in.
 - GVWR: 12,300
 - GCWR: 17,000
 - Axle Ratio: 4:10
 - AM/FM CD Stereo
- 2510 & 2520 Chassis: Ford E450
 - Engine: 6.8 Liter V-10
 - Wheelbase: 176 in.
 - GVWR: 14,050
 - GCWR: 20,000
 - Axle Ratio: 4:63
 - Driver & Passenger Air Bags
 - AM/FM Cassette CD Stereo
- Transmission: 4-speed Automatic
- Factory A/C
- Cruise Control
- Intermittent Windshield Wipers
- Power Steering
- Power Door Locks
- Power Windows
- 6-Way Power Driver's Seat
- Tilt Steering Column
- Fuel Capacity: 55 gallons

CONSTRUCTION

- Rugged Aluminum Welded Frame
- Block Foam Insulation Sidewalls & Roof
- Fiberglass Exterior Walls
- One-piece Rubber Roof
- Tube Steel Floor Assembly

EXTERIOR FEATURES

- 26" Wide Entrance Door
- Radius Corner Windows
- Power Entry Step
- Patio Light
- Entry Assist Handle
- Fiberglass Running Boards
- Roof Rack & Ladder
- Pre-wired & Prep for Generator
- Jack & Lug Wrench
- Stainless Steel Wheel Liners
- Valve Stem Extenders on Rear Dual Wheels
- Spare Tire & Continental Kit
- Trailer Hitch Class 3 - 5,000 lbs.

ELECTRICAL & WATER SYSTEMS

- System Monitor Panel
- Pre-wired for Roof Air Conditioning
- Demand Water Pump - 12V
- City Water Hook-up
- 120V/12V Power Converter - 45 Amp
- GFI 110V Receptacle in Bath
- GFI 110V Exterior Receptacle
- Auxiliary Battery with Isolator
- 30' 110V Power Cable
- Cable TV Hook-up
- TV Antenna with Power Booster
- Battery Shut Off (Inside Coach)

INTERIOR FEATURES

- White Enamel Sink
- Convection Microwave Oven
- Carpet with Pad
- Oak Framed Cabinets & Doors
- Marine Toilet
- Tub and Shower with Surround
- Valances with Day/Night Shades
- Innerspring Mattress (2310 & 2510)
- Bedspread (2310 & 2510)

HEATING & APPLIANCES

- 2 Burner Cook Top
- Power Range Hood
- Folding Range Cover
- Convection Microwave Oven
- 6 cu. ft. 2-Way Refrigerator
- Fantastic Roof Vent
- Electric Ignition 6 Gal. Water Heater
- 25,000 BTU Furnace

GENERAL SPECIFICATIONS

Fresh Water: 2310 & 2510	25 gal.
2320 & 2520	25 gal.
Grey Water Holding Tank: 2310 & 2510	26 gal.
2320 & 2520	23 gal.
Black Water Holding Tank: 2310 & 2510	23 gal.
2320 & 2520	26 gal.
LP Tank	12.2 gal./42 lb.
Overall Length	23 ft.
Overall Width	7 ft. 7 in.
Overall Height (Add 10" with AC)	9 ft. 7 in.
Interior Height	6 ft. 4 in.
Sleeping Capacities	4

DECORS

- Magnolia Plum
- Oxford Blue
- Santa Fe Sage
- Savannah Clay



Carri-Go 2520 slide-out shown with optional lower accent paint, 15' awning and 13,500 BTU air conditioning.

OPTIONAL EQUIPMENT

- 4 kilowatt Onan Generator
- 13,500 BTU Roof Air Conditioner
- 15,000 BTU Roof Air Conditioner
- Heat Strip for Air Conditioner
- 19" Color Television
- Video Cassette Player
- 6-Way Power Passenger Seat
- Sofa ILO Dinette
- Sofa ILO Swivel Chairs
- Power Remote & Heated Mirrors
- Heated & Enclosed - Holding Tanks
- Painted Bottom Skirt (Automotive Finish)
- 12' Box Awning (2310 & 2320)
- 15' Box Awning (2510 & 2520)
- Exterior Appearance Package:
Painted Front Bumper Cover, Fog Lights,
Bumper Step, Painted Grille

WARRANTY

- Conversion is warranted for 1 (one) year or 15,000 miles. Warranty service is available nationwide. Chassis, powertrain and automotive options are warranted by the chassis manufacturer (Ford or Chevrolet). Installed appliances and fixtures are warranted by their respective manufacturer.

DYNAMAX
CORPORATION

2745 Northland Drive ■ Elkhart, Indiana 46514
P.O. Box 1948 ■ Elkhart, Indiana 46515
Phone: 1-888-295-7859 ■ 1-219-262-3474
Fax: 1-219-262-1099 ■ www.dynamaxcorp.com

©2001 Floor plans, features and specifications of the Carri-Go are subject to change without notice.

Carri-Go