

2005 LAPALMA®

LAPALMA®
2005



MONACO



MONACO

DRIVING YOUR DREAM.™

2005 LAPALMA®

LAPALMA®
2005



MONACO™



MONACO™

DRIVING YOUR DREAM.™

If you're looking for the convenience and affordability of a gas motorhome with all the luxurious features of a high-end diesel, you've found it. It's truly the best of both worlds — the 2005 LaPalma. This year, we've given this popular coach many new upgrades, including deluxe full-body paint, for a showroom finish that will last for years to come. So climb aboard. This could be the ride of your life.

DRIVING YOUR DREAM.

Dreams. They're the way we write the story of our lives. Some are serious. Like raising kids or building a business. Others are pure fun. Like the dream you have early on a summer morning, sipping coffee and working on your life's next chapter. It's about making big plans and changing them on a whim. Or even better, following your heart without any plans at all. Yes, it's the dream of a lifetime. And with Monaco's legendary quality, reliability and innovation, we can make it all come true.



MONACO

DRIVING YOUR DREAM.™



The 2005 LaPalma

If you're looking for the convenience and affordability of a gas motorhome with all the luxurious features of a high-end diesel, you've found it. It's truly the best of both worlds — the 2005 LaPalma. This year, we've given this popular coach many new upgrades, including deluxe full-body paint, for a showroom finish that will last for years to come. So climb aboard. This could be the ride of your life.

DRIVING YOUR DREAM.

Dreams. They're the way we write the story of our lives. Some are serious. Like raising kids or building a business. Others are pure fun. Like the dream you have early on a summer morning, sipping coffee and working on your life's next chapter. It's about making big plans and changing them on a whim. Or even better, following your heart without any plans at all. Yes, it's the dream of a lifetime. And with Monaco's legendary quality, reliability and innovation, we can make it all come true.



MONACO

DRIVING YOUR DREAM.™



Slip behind the wheel of the LaPalma, and you'll experience the comfort and convenience that makes a long drive a snap. The automotive dash features an easy-to-read instrument panel, and all your controls and switches are at your fingertips. As you can see here, the monitor for the rear vision system is to your right — an excellent option that features audio and an adjustable camera. Soft touch vinyl cockpit seats come standard, and you may choose optional six-way power controls, as well as optional OptimaLeather™ coverings — specially designed to withstand all the wear and tear of life on the road.

Dash and cockpit, 37PCT, Vintage Oak, Romanesque.

Exterior, 37PCT, Romanesque.

A Our one-piece polyethylene storage compartments are easy to pack and easy to wash down, whenever necessary.

B Make the most of your time outdoors with this optional exterior entertainment center, featuring a radio, CD player and two speakers.

C A handy dash workstation makes the co-pilot's seat an excellent place for taking care of business or catching up on e-mail. Overhead, you'll find the new 24" flatscreen TV, as well as cabinets for the optional home theater system with DVD and VCR player combo with surround sound speakers.



Slip behind the wheel of the LaPalma, and you'll experience the comfort and convenience that makes a long drive a snap. The automotive dash features an easy-to-read instrument panel, and all your controls and switches are at your fingertips. As you can see here, the monitor for the rear vision system is to your right — an excellent option that features audio and an adjustable camera. Soft touch vinyl cockpit seats come standard, and you may choose optional six-way power controls, as well as optional OptimaLeather™ coverings — specially designed to withstand all the wear and tear of life on the road.

Dash and cockpit, 37PCT, Vintage Oak, Romanesque.

Exterior, 37PCT, Romanesque.

A Our one-piece polyethylene storage compartments are easy to pack and easy to wash down, whenever necessary.

B Make the most of your time outdoors with this optional exterior entertainment center, featuring a radio, CD player and two speakers.

C A handy dash workstation makes the co-pilot's seat an excellent place for taking care of business or catching up on e-mail. Overhead, you'll find the new 24" flatscreen TV, as well as cabinets for the optional home theater system with DVD and VCR player combo with surround sound speakers.

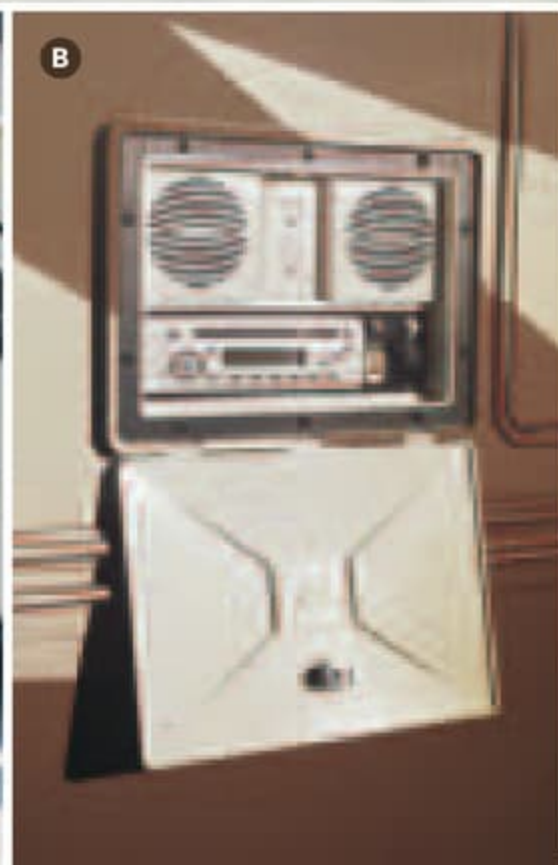

Each year, our designers create color and fabric combinations that lead the industry in warmth and style. This year, we're offering five beautiful decors and three stunning cabinet finishes.

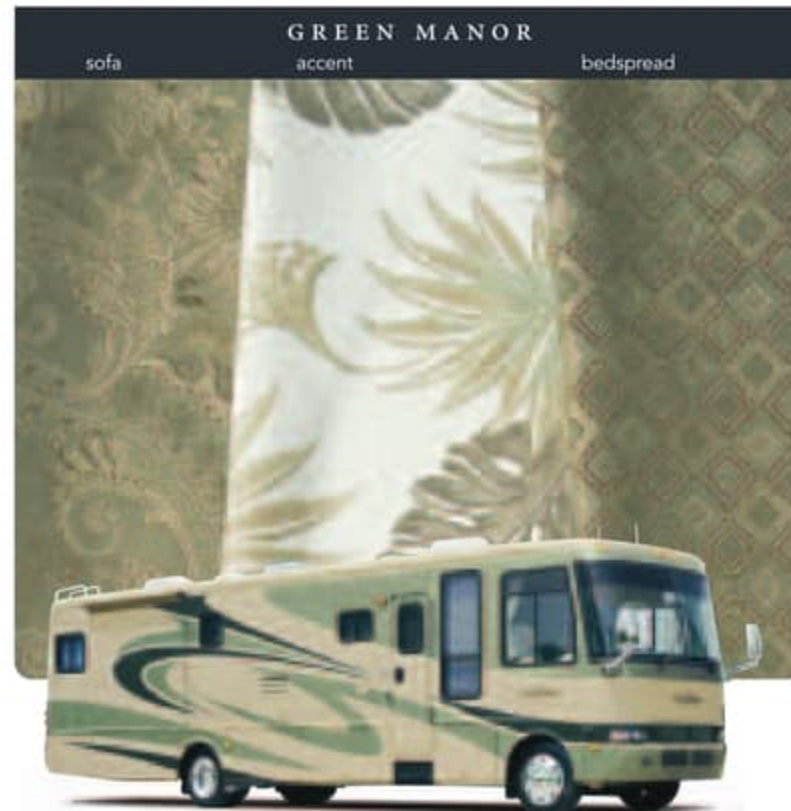
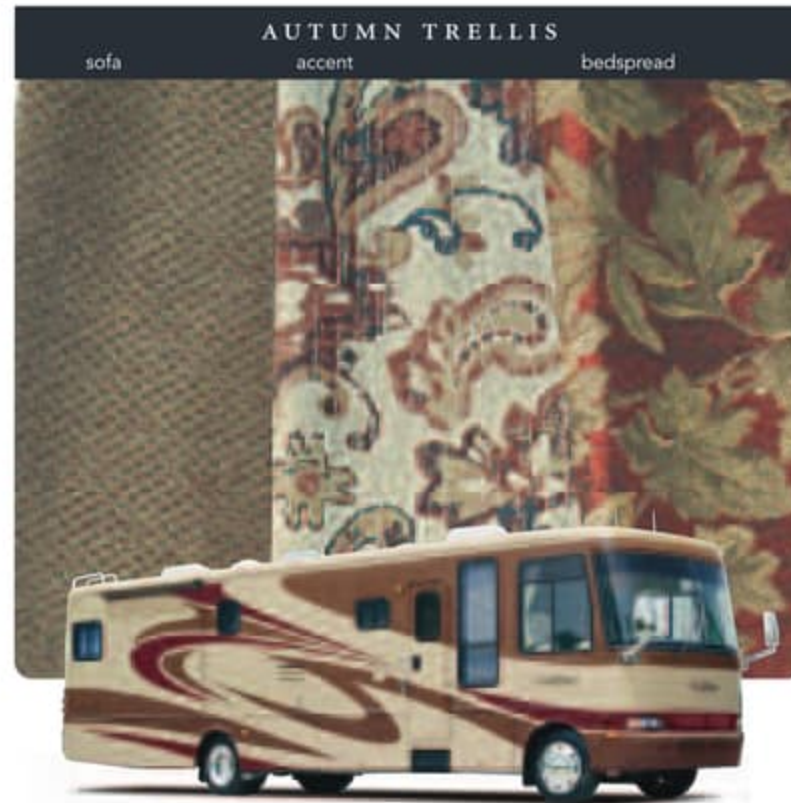

Manufactured in, not added on. For added protection against stains, Dupont Teflon® soil repellent is applied to virtually all upholstery fabric during the finishing process for superior coverage.*

*Brand and application of upholstery fabric protection may vary depending on date recreational vehicle was manufactured.

Note: Colors depicted are a reasonable representation though they may not be an exact match of the actual colors due to variances in processing and production. See your dealer for actual fabric and paint chip samples.

Each year, our designers create color and fabric combinations that lead the industry in warmth and style. This year, we're offering five beautiful decors and three stunning cabinet finishes.

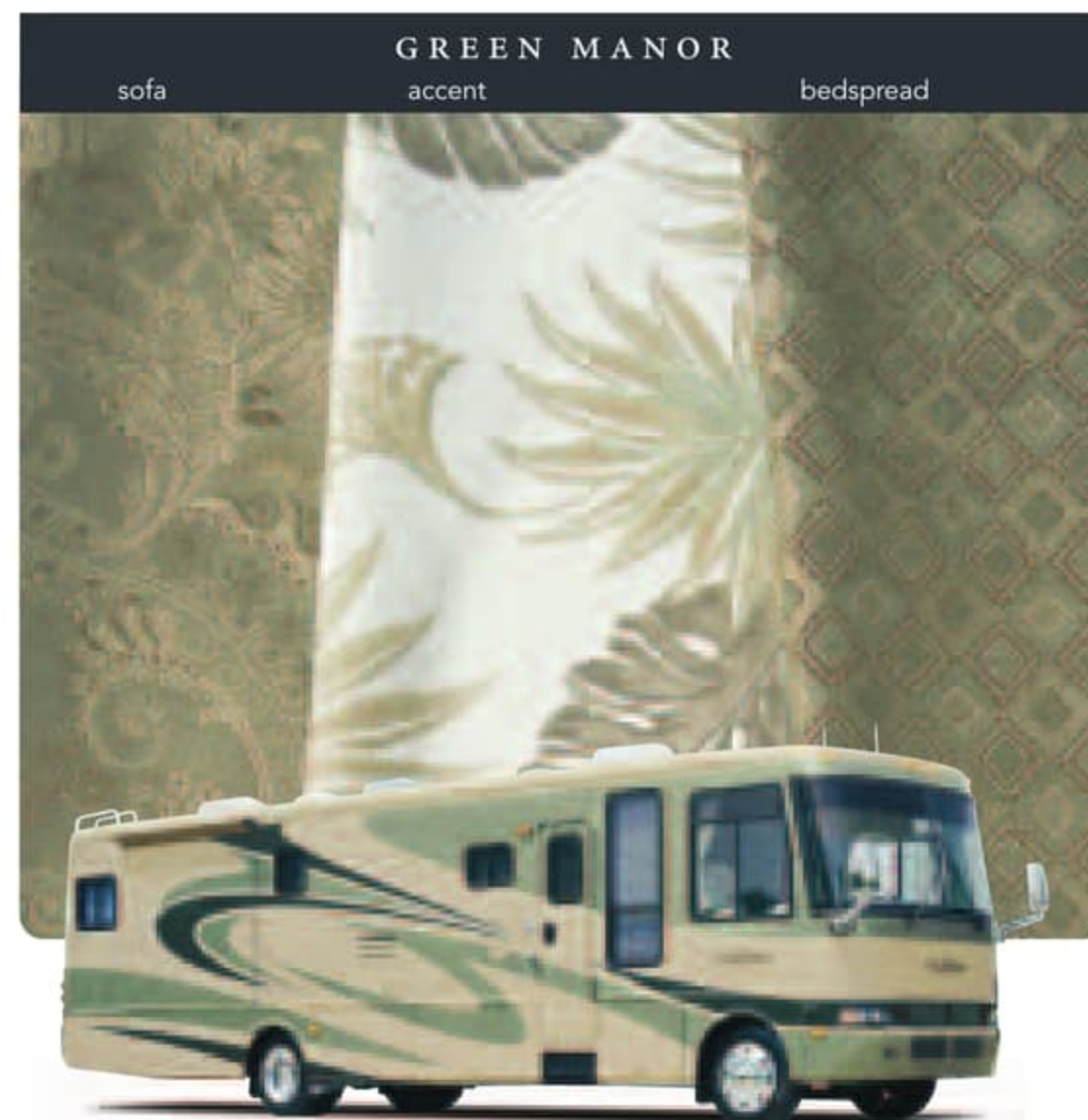
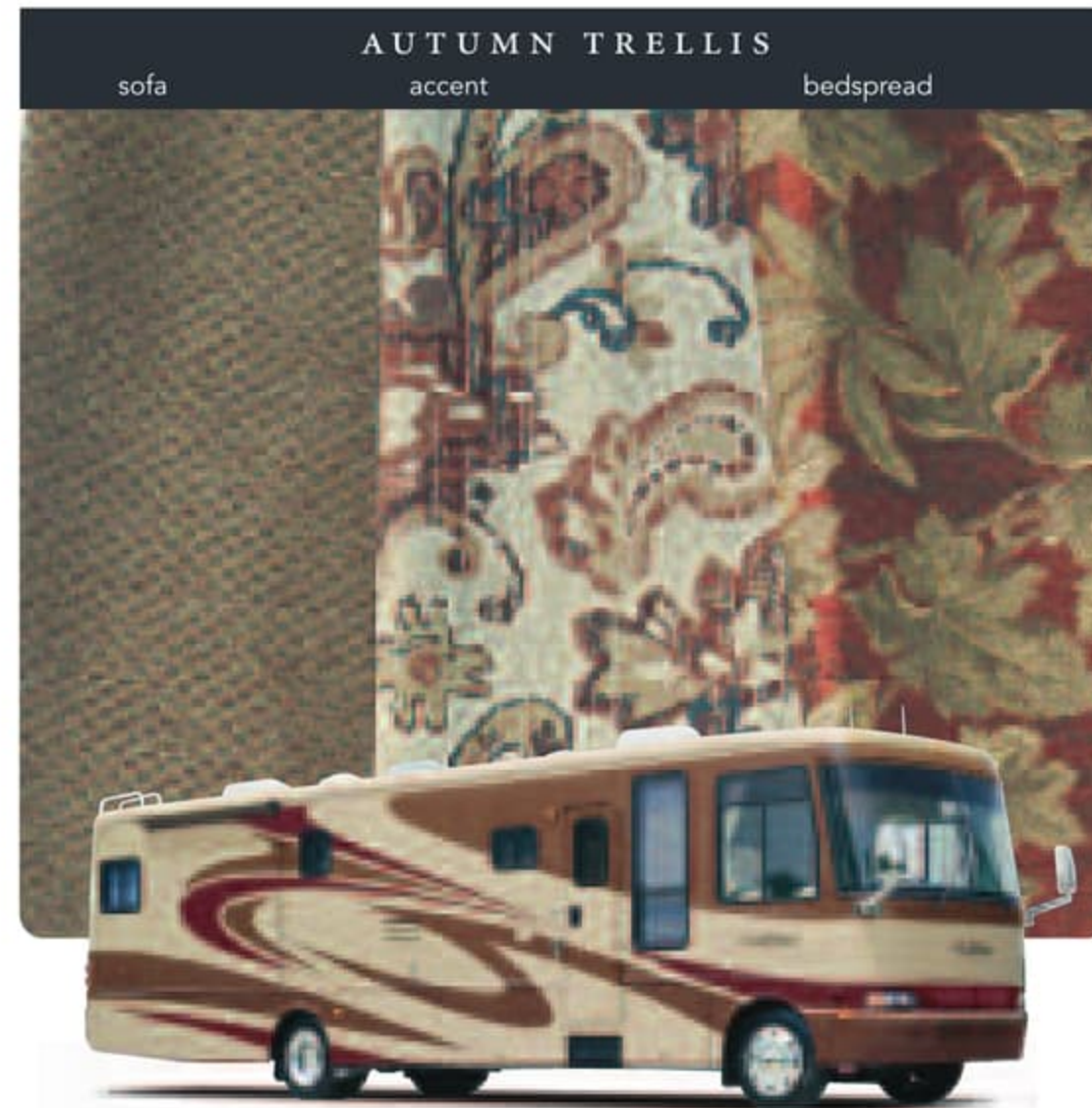

Manufactured in, not added on. For added protection against stains, Dupont Teflon® soil repellent is applied to virtually all upholstery fabric during the finishing process for superior coverage.*

*Brand and application of upholstery fabric protection may vary depending on date recreational vehicle was manufactured.

Note: Colors depicted are a reasonable representation though they may not be an exact match of the actual colors due to variances in processing and production. See your dealer for actual fabric and paint chip samples.



Back to front, 36DBD, Vintage Oak, Espresso.

As you choose your favorite style of woodwork, you can be confident that each selection is crafted to the highest standards. The LaPalma's cabinets feature solid wood raised panel doors with satin nickel hardware and hardwood end panels in the living room. The drawer boxes are also made of wood, and as you open and close the drawers, you'll feel the quality of the heavy-duty ball bearing guides.



Back to front, 36DBD, Vintage Oak, Espresso.



As you choose your favorite style of woodwork, you can be confident that each selection is crafted to the highest standards. The LaPalma's cabinets feature solid wood raised panel doors with satin nickel hardware and hardwood end panels in the living room. The drawer boxes are also made of wood, and as you open and close the drawers, you'll feel the quality of the heavy-duty ball bearing guides.

No other manufacturer gives you as many innovative floorplan choices as Monaco. The 2005 LaPalma offers double and triple slide-out models in lengths that range from 34' to 37'.



PLANK FLOORING



CARPET



Find all the latest product news and updates online: monacocoach.com

34SBD

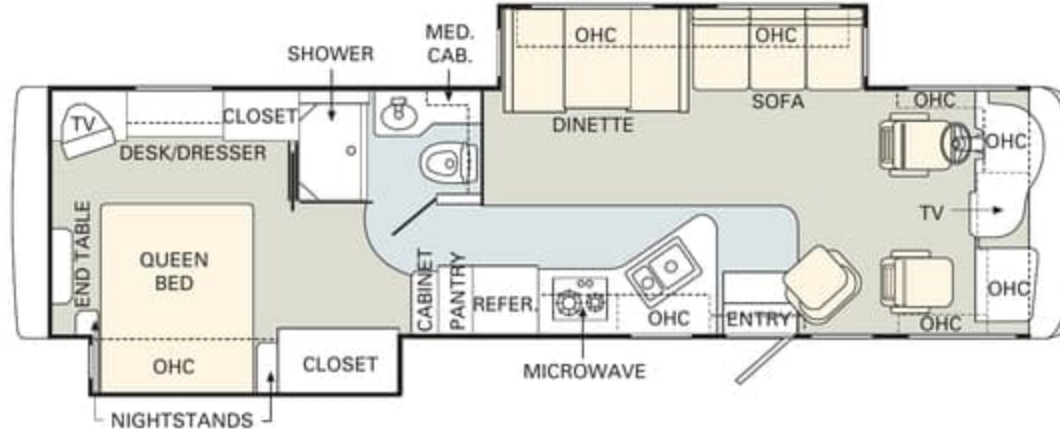

36WDD

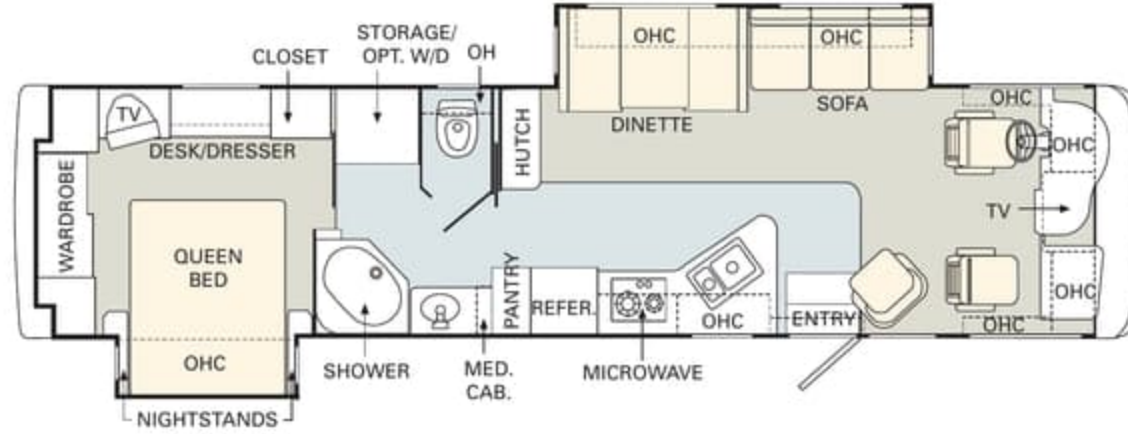

36DBD

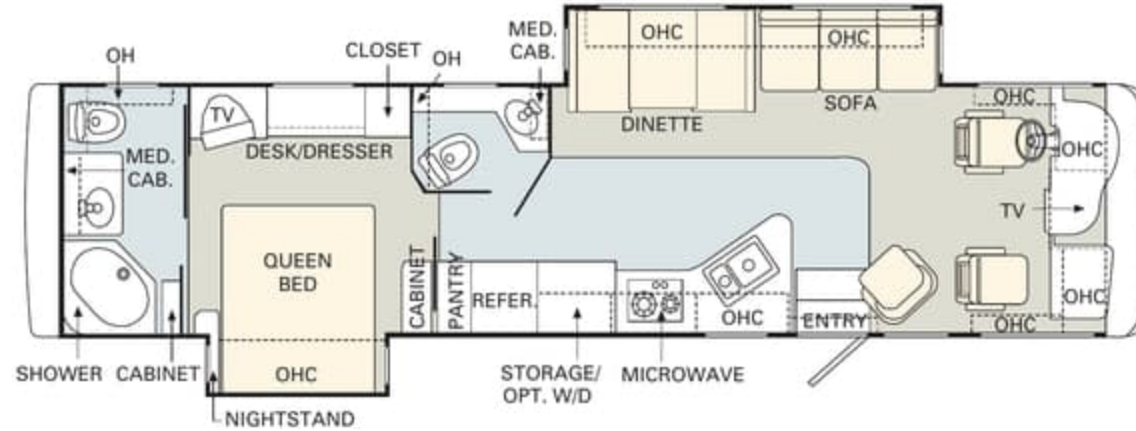

No other manufacturer gives you as many innovative floorplan choices as Monaco. The 2005 LaPalma offers double and triple slide-out models in lengths that range from 34' to 37'.



Find all the latest product news and updates online: monacocoach.com

34SBD

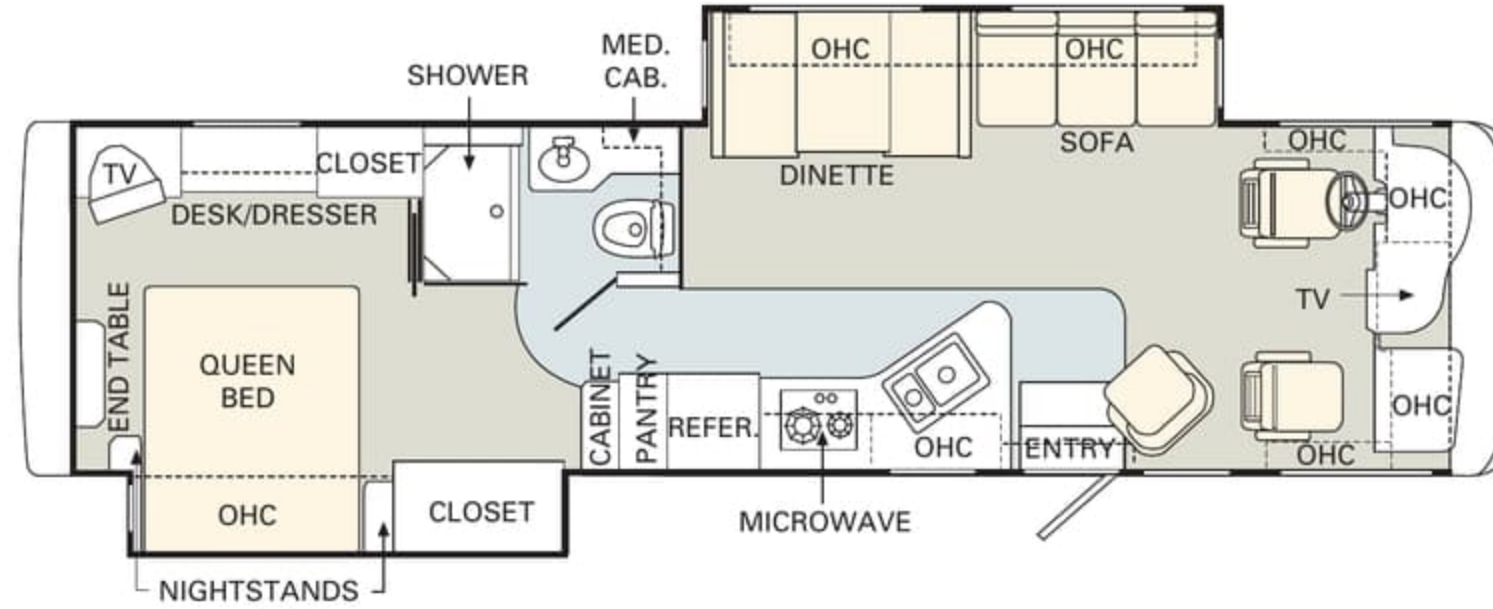

36WDD

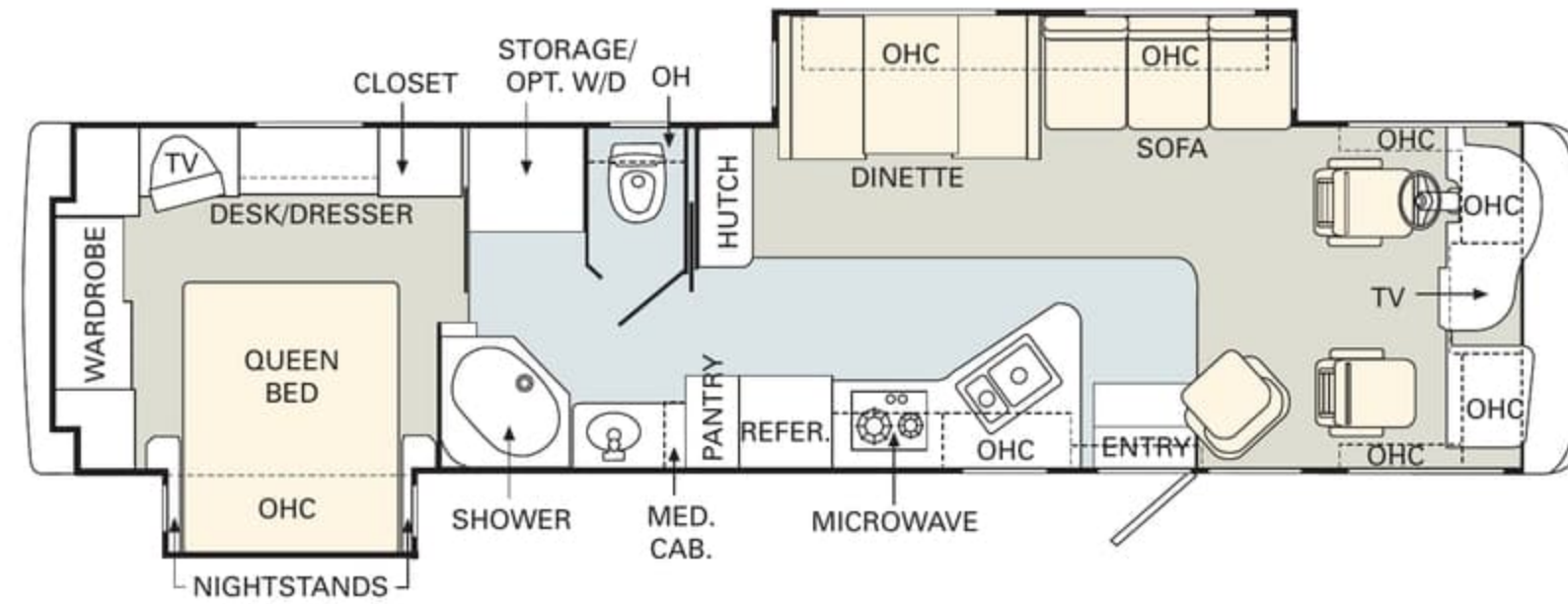

36DBD

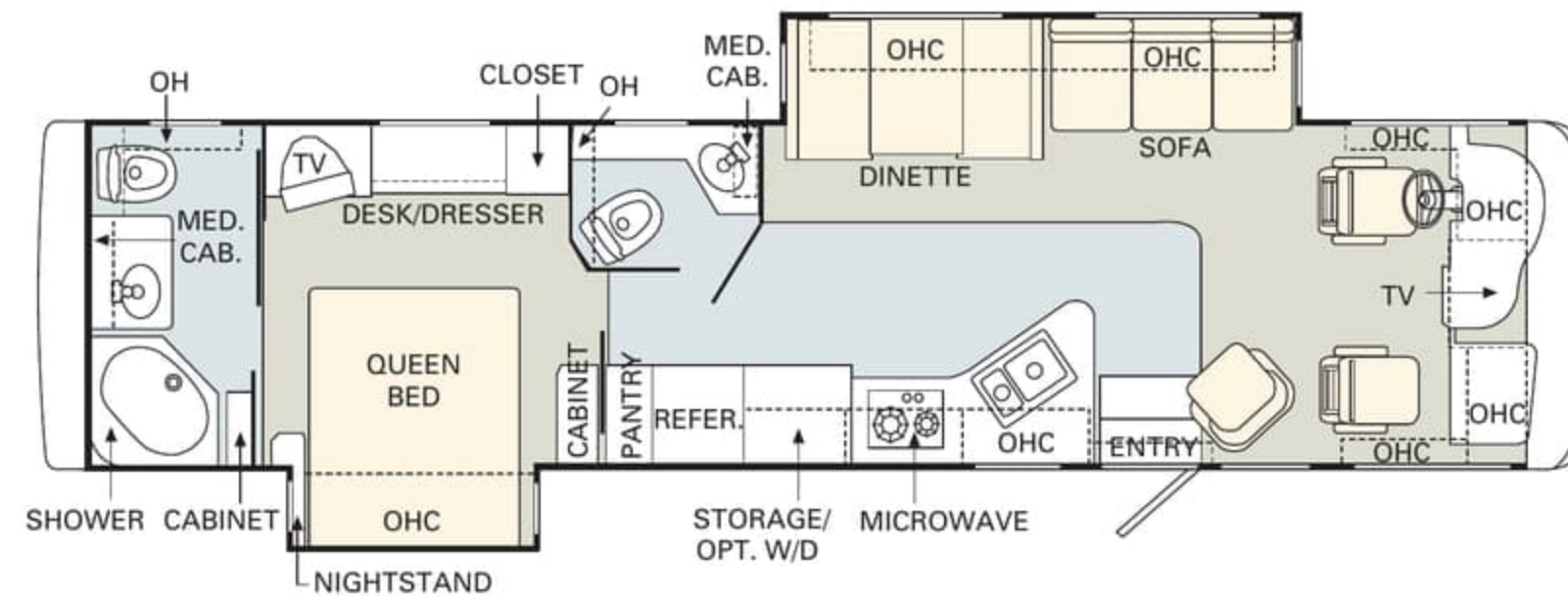

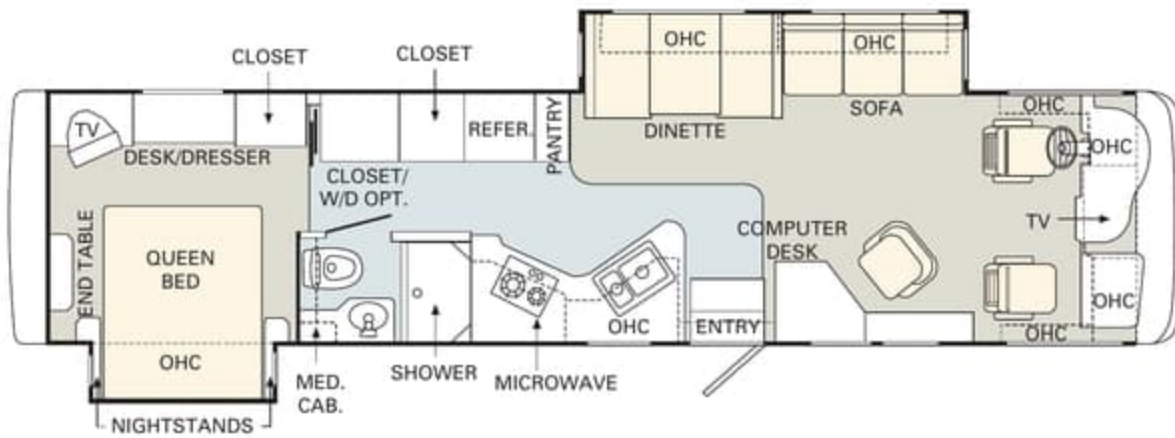

37PBD

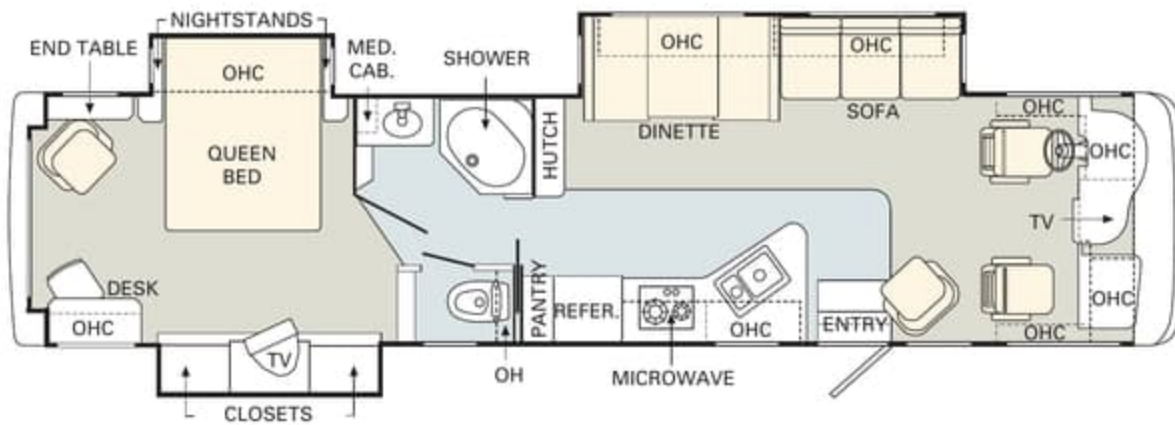

37PCT

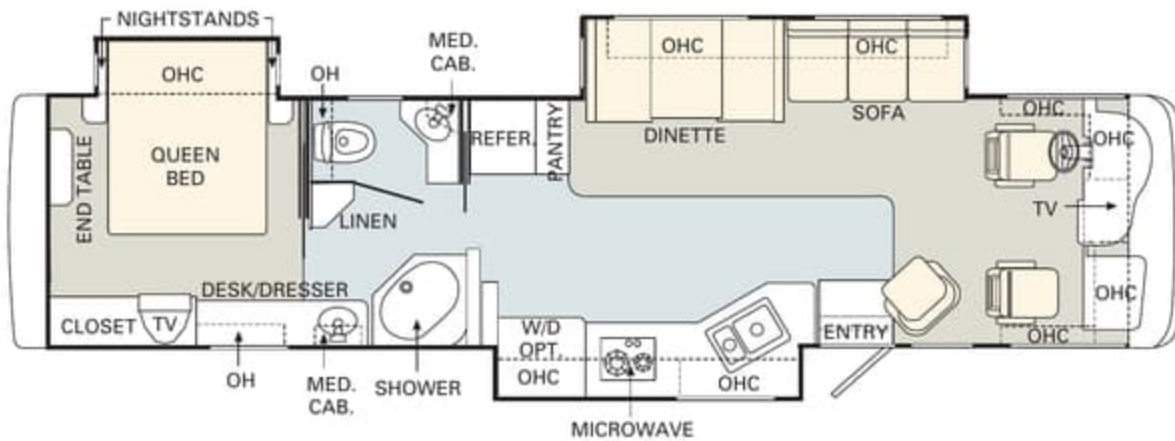

37PST

FURNITURE OPTIONS

Monaco gives you more ways to customize your motorhome to fit your lifestyle. Here are some furniture options you may wish to consider. (Please see page 15 for a full list of the options available on each floorplan.)

Hide-A-Bed Sofa

J-Lounge

Recliners

Adjustable Coffee Table

Legless Dinette with Wall Cabinet

Bedroom Desk



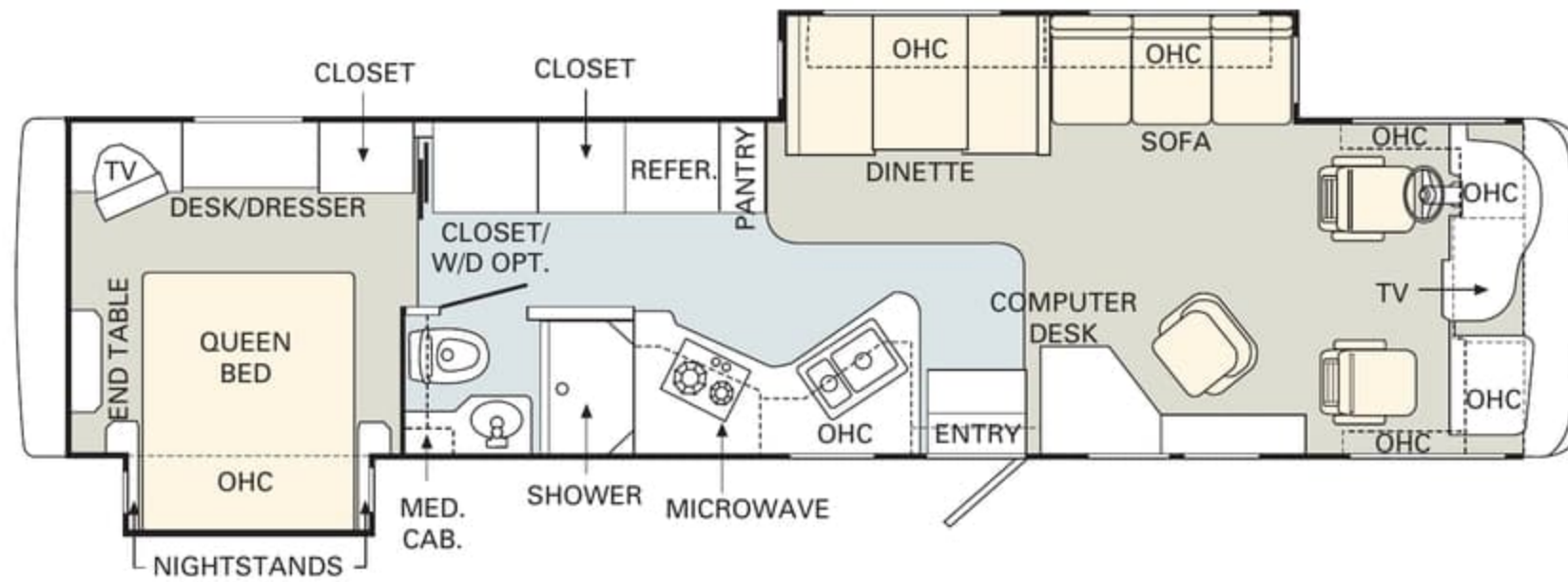

37PBD

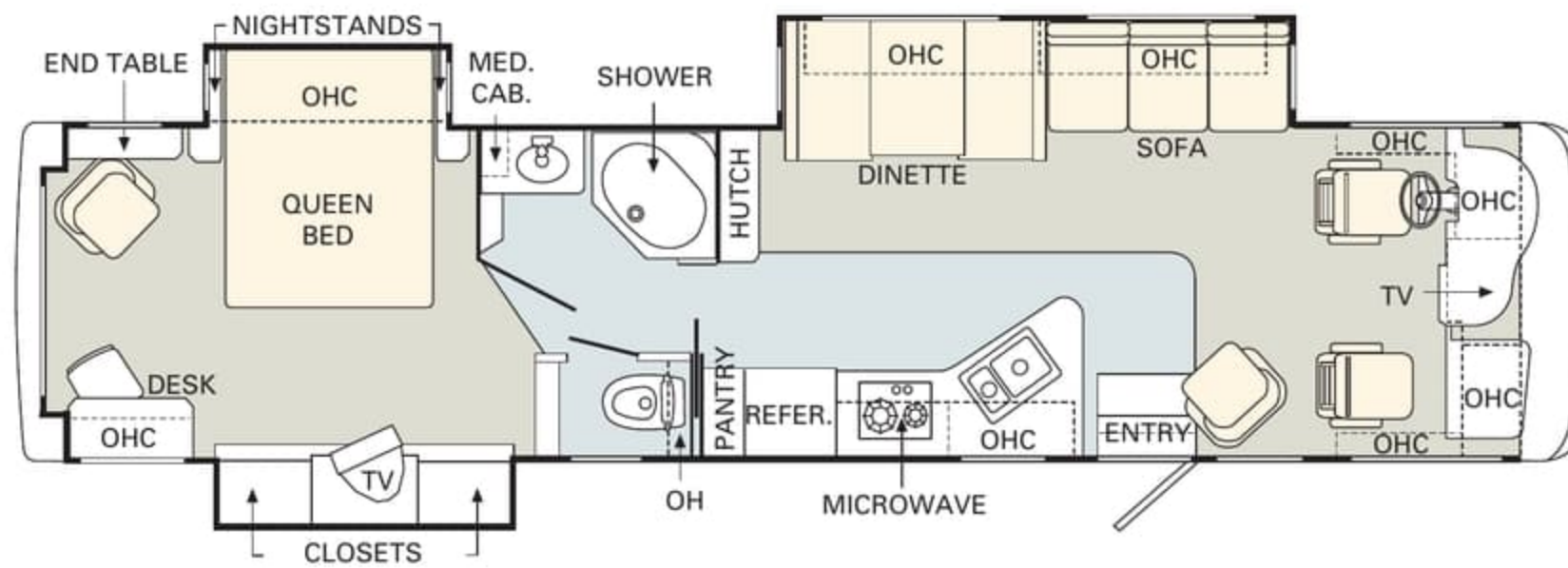

37PCT

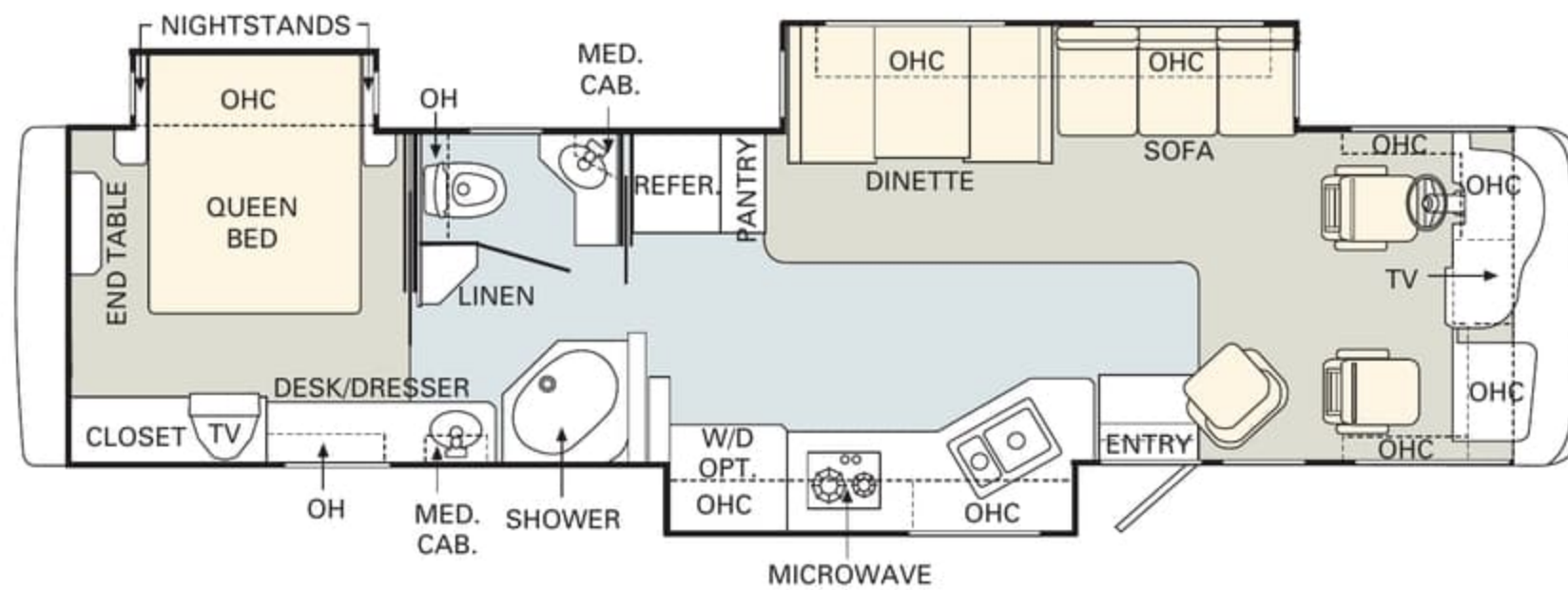

37PST

FURNITURE OPTIONS

Monaco gives you more ways to customize your motorhome to fit your lifestyle. Here are some furniture options you may wish to consider. (Please see page 15 for a full list of the options available on each floorplan.)

- Hide-A-Bed Sofa
- J-Lounge
- Recliners
- Adjustable Coffee Table
- Legless Dinette with Wall Cabinet
- Bedroom Desk



	WEIGHT RATINGS (LBS.) ¹				MEASUREMENTS						TANK CAPACITY (GAL.) ²				
	Gross vehicle	Gross combined ³	Front gross axle	Rear gross axle	Wheelbase	Overall length	Overall height (with A/C)	Interior height	Interior width	Exterior width	Water heater	Gray tank	Black tank	Fresh tank	LP tank ³
34SBD (FORD CHASSIS)	22,000	26,000	7,500	14,500	228"	35'5"	11'9"	6'6"	94 1/2"	100 1/2"	10	40	42	60	24
(W-22 CHASSIS)	22,000	26,000	8,000	14,500	228"	35'5"	12'	6'6"	94 1/2"	100 1/2"	10	40	42	60	24
36WDD (FORD CHASSIS)	22,000	26,000	7,500	14,500	242"	36'11"	11'9"	6'6"	94 1/2"	100 1/2"	10	45	54	60	24
(W-22 CHASSIS)	22,000	26,000	8,000	14,500	242"	36'11"	12'	6'6"	94 1/2"	100 1/2"	10	45	54	60	24
OPTIONAL (W-24 CHASSIS)	24,000	30,000	9,000	15,500	242"	36'11"	12'	6'6"	94 1/2"	100 1/2"	10	45	54	60	24
36DBD (FORD CHASSIS)	22,000	26,000	7,500	14,500	242"	36'11"	11'9"	6'6"	94 1/2"	100 1/2"	10	42/39	42/39	60	24
(W-22 CHASSIS)	22,000	26,000	8,000	14,500	242"	36'11"	12'	6'6"	94 1/2"	100 1/2"	10	42/39	42/39	60	24
OPTIONAL (W-24 CHASSIS)	24,000	30,000	9,000	15,500	242"	36'11"	12'	6'6"	94 1/2"	100 1/2"	10	42/39	42/39	60	24
37PBD (FORD CHASSIS)	22,000	26,000	7,500	14,500	242"	37'7"	11'9"	6'6"	94 1/2"	100 1/2"	10	42	42	70	24
(W-22 CHASSIS)	22,000	26,000	8,000	14,500	242"	37'7"	12'	6'6"	94 1/2"	100 1/2"	10	42	42	70	24
OPTIONAL (W-24 CHASSIS)	24,000	30,000	9,000	15,500	242"	37'7"	12'	6'6"	94 1/2"	100 1/2"	10	42	42	70	24
37PCT (FORD CHASSIS)	22,000	26,000	7,500	14,500	242"	37'7"	11'9"	6'6"	94 1/2"	100 1/2"	10	45	54	60	24
(W-22 CHASSIS)	22,000	26,000	8,000	14,500	242"	37'7"	12'	6'6"	94 1/2"	100 1/2"	10	45	54	60	24
OPTIONAL (W-24 CHASSIS)	24,000	30,000	9,000	15,500	242"	37'7"	12'	6'6"	94 1/2"	100 1/2"	10	45	54	60	24
37PST (FORD CHASSIS)	22,000	26,000	7,500	14,500	242"	37'7"	11'9"	6'6"	94 1/2"	100 1/2"	10	42	42	70	24
FORCED OPTION (W-24 CHASSIS)	24,000	30,000	9,000	15,500	242"	37'7"	12'	6'6"	94 1/2"	100 1/2"	10	42	42	70	24

1 Towing capacity is limited by GCWR; your vehicle's towing capacity is the difference between the GCWR and the actual vehicle weight, including all water, fuel, passengers and cargo. Your towed vehicle should be equipped with auxiliary brakes if the weight of the towed vehicle exceeds 1,000 lbs. Consult your owner's manual for further towing information.

2 Variances in the fabrication and installation of the tanks may cause the actual "usable capacity" to be greater or less than the capacities designated above.

3 Actual filled LP capacity is 80% of listing due to safety shut-off required on tank.

The actual overall length of the recreational vehicle may differ from that indicated in the brochure due to variances in the manufacturing process and/or installed components. The actual length may be greater or less than that indicated. Due to the large variety of options and floorplan arrangements available to our customers, actual weights for each unit can differ significantly. Monaco Coach provides a weight sticker on each unit we produce which includes that unit's tank capacities and approximate weight. Consult your local Monaco Coach dealer for unit availability and further information. The information printed in this brochure reflects product design, fabrication, and component parts at the date of printing. The manufacturer reserves the right, at any time, to make changes in product design or material or component specifications as its sole option, without notice. This includes the substitution of components of a different brand or trade name which will result in comparable performance. All information printed in this brochure is subject to change after the date of printing. Some features shown or mentioned in this brochure are optional and may only be available in selected floorplans. Photographs may show props or decorations that are not standard equipment on Monaco Coach models. Monaco Coach, the Monaco logo and its design, are registered trademarks. All other products and company names are trademarks and/or registered trademarks of their respective holders. While the color of the motorhome's exterior and the interior fabrics depicted in this sales brochure are fair and reasonable depictions, the colors depicted may not be an exact match of the actual colors because of the variances in photo-processing and variances caused by inserting the photographs within the sales brochure. Due to product improvements, changes during the model year and/or transcription errors that may occur, information represented within this brochure may not be accurate at the time of your purchase. If certain information is significant to your purchasing decision, please confirm the information with your dealer prior to submitting your order.

	WEIGHT RATINGS (LBS.)				MEASUREMENTS						TANK CAPACITY (GAL.) ²				
	Gross vehicle	Gross combined ¹	Front gross axle	Rear gross axle	Wheelbase	Overall length	Overall height (with A/C)	Interior height	Interior width	Exterior width	Water heater	Gray tank	Black tank	Fresh tank	LP tank ³
34SBD (FORD CHASSIS)	22,000	26,000	7,500	14,500	228"	35'5"	11'9"	6'6"	94 1/2"	100 1/2"	10	40	42	60	24
(W-22 CHASSIS)	22,000	26,000	8,000	14,500	228"	35'5"	12'	6'6"	94 1/2"	100 1/2"	10	40	42	60	24
36WDD (FORD CHASSIS)	22,000	26,000	7,500	14,500	242"	36'11"	11'9"	6'6"	94 1/2"	100 1/2"	10	45	54	60	24
(W-22 CHASSIS)	22,000	26,000	8,000	14,500	242"	36'11"	12'	6'6"	94 1/2"	100 1/2"	10	45	54	60	24
OPTIONAL (W-24 CHASSIS)	24,000	30,000	9,000	15,500	242"	36'11"	12'	6'6"	94 1/2"	100 1/2"	10	45	54	60	24
36DBD (FORD CHASSIS)	22,000	26,000	7,500	14,500	242"	36'11"	11'9"	6'6"	94 1/2"	100 1/2"	10	42/39	42/39	60	24
(W-22 CHASSIS)	22,000	26,000	8,000	14,500	242"	36'11"	12'	6'6"	94 1/2"	100 1/2"	10	42/39	42/39	60	24
OPTIONAL (W-24 CHASSIS)	24,000	30,000	9,000	15,500	242"	36'11"	12'	6'6"	94 1/2"	100 1/2"	10	42/39	42/39	60	24
37PBD (FORD CHASSIS)	22,000	26,000	7,500	14,500	242"	37'7"	11'9"	6'6"	94 1/2"	100 1/2"	10	42	42	70	24
(W-22 CHASSIS)	22,000	26,000	8,000	14,500	242"	37'7"	12'	6'6"	94 1/2"	100 1/2"	10	42	42	70	24
OPTIONAL (W-24 CHASSIS)	24,000	30,000	9,000	15,500	242"	37'7"	12'	6'6"	94 1/2"	100 1/2"	10	42	42	70	24
37PCT (FORD CHASSIS)	22,000	26,000	7,500	14,500	242"	37'7"	11'9"	6'6"	94 1/2"	100 1/2"	10	45	54	60	24
(W-22 CHASSIS)	22,000	26,000	8,000	14,500	242"	37'7"	12'	6'6"	94 1/2"	100 1/2"	10	45	54	60	24
OPTIONAL (W-24 CHASSIS)	24,000	30,000	9,000	15,500	242"	37'7"	12'	6'6"	94 1/2"	100 1/2"	10	45	54	60	24
37PST (FORD CHASSIS)	22,000	26,000	7,500	14,500	242"	37'7"	11'9"	6'6"	94 1/2"	100 1/2"	10	42	42	70	24
FORCED OPTION (W-24 CHASSIS)	24,000	30,000	9,000	15,500	242"	37'7"	12'	6'6"	94 1/2"	100 1/2"	10	42	42	70	24

1 Towing capacity is limited by GCWR; your vehicle's towing capacity is the difference between the GCWR and the actual vehicle weight, including all water, fuel, passengers and cargo. Your towed vehicle should be equipped with auxiliary brakes if the weight of the towed vehicle exceeds 1,000 lbs. Consult your owner's manual for further towing information.

2 Variances in the fabrication and installation of the tanks may cause the actual "usable capacity" to be greater or less than the capacities designated above.

3 Actual filled LP capacity is 80% of listing due to safety shut-off required on tank.

The actual overall length of the recreational vehicle may differ from that indicated in the brochure due to variances in the manufacturing process and/or installed components. The actual length may be greater or less than that indicated. Due to the large variety of options and floorplan arrangements available to our customers, actual weights for each unit can differ significantly. Monaco Coach provides a weight sticker on each unit we produce which includes that unit's tank capacities and approximate weight. Consult your local Monaco Coach dealer for unit availability and further information. The information printed in this brochure reflects product design, fabrication, and component parts at the date of printing. The manufacturer reserves the right, at any time, to make changes in product design or material or component specifications as its sole option, without notice. This includes the substitution of components of a different brand or trade name which will result in comparable performance. All information printed in this brochure is subject to change after the date of printing. Some features shown or mentioned in this brochure are optional and may only be available in selected floorplans. Photographs may show props or decorations that are not standard equipment on Monaco Coach models. Monaco Coach, the Monaco logo and its design, are registered trademarks. All other products and company names are trademarks and/or registered trademarks of their respective holders. While the color of the motorhome's exterior and the interior fabrics depicted in this sales brochure are fair and reasonable depictions, the colors depicted may not be an exact match of the actual colors because of the variances in photo-processing and variances caused by inserting the photographs within the sales brochure. Due to product improvements, changes during the model year and/or transcription errors that may occur, information represented within this brochure may not be accurate at the time of your purchase. If certain information is significant to your purchasing decision, please confirm the information with your dealer prior to submitting your order.

BODY CONSTRUCTION

Alumaframe® Superstructure
Steel Cage Cockpit Construction
Peaked Aluminum Roof with Fiberglass Insulation
Smooth Gel Coat Fiberglass Exterior Walls
Front and Rear Molded Fiberglass Caps
Aluminum Framed Floor on Steel Trusses
Laminated Structurwood™ Flooring
Interior Paneling with 3/4" Insulation
Foam Insulated Floor Framing with Underbelly
One-Piece Engine Cover
Power Heated Remote Exterior Mirrors
Headlamps with Turn Signals
Fog Lights
Taillights with Upgraded Styling
Streamlined Baggage Doors with Integrated Single Handle Latches
EasyStor Slide-Out Compartments
One-Piece Polyethylene Storage Compartment
Wheel Mud Flaps
Integrated Metal Fuel Door with Lock
Rear Ladder
Interior Rubber Entry Step
Exterior Triple Entry Steps
Undercoating

OPTIONS

3M® Film Front Mask
Chrome Power Heated Remote Exterior Mirrors
Deluxe Full-Body Paint, Forced Option
Full-Length Mud Flap

CHASSIS/ENGINE/SUSPENSION

FORD

6.8L V-10 Gasoline Engine with Electronic Fuel Injection
Engine Displacement: 6.8 Liters 415 Cu. In.
Power: 310 HP; Torque: 425 lbs./ft.
4-Speed Automatic Transmission with Overdrive
Fuel Tank Capacity 75 Gallon
130 Amp Alternator
Rear Axle Ratio 5.38:1
Radial Tires 235/80R 22.5G
Polished Aluminum Wheels
Leaf Spring Suspension
ABS Brake System
Hitch Receiver 4,000 Lb. with Dual Connector 4-Pin or 7-Pin
SmartStructure II

WORKHORSE

8.1L V-8 Gasoline Engine with Electronic Fuel Injection
Engine Displacement: 8.1 Liters 496 Cu. In.
Power: 340 HP; Torque: 455 lbs./ft.
5-Speed Automatic Transmission with Overdrive
Fuel Tank Capacity 75 Gallon
145 Amp Alternator
Rear Axle Ratio 5.38:1
Radial Tires 235/80R 22.5G
Leaf Spring Suspension
ABS Brake System
Stainless Steel Wheel Liners
Hitch Receiver 4,000 Lb. with Dual Connector 4-Pin or 7-Pin
SmartStructure II

OPTIONS

Fully Automatic Hydraulic Leveling System

WORKHORSE CHASSIS OPTION W-24 (36'-37' UNITS) (FORCED ON 37PST)

8.1L V-8 Gasoline Engine with Electronic Fuel Injection
Engine Displacement: 8.1 Liters 496 Cu. In.
Power: 340 HP; Torque: 455 lbs./ft.
5-Speed Allison® 2100 Automatic Transmission with Overdrive
Fuel Tank Capacity 75 Gallon
145 Amp Alternator
Rear Axle Ratio 5.86:1
Radial Tires 235/80R 22.5G
Leaf Spring Suspension
ABS Brake System
Polished Aluminum Wheels
5,000 Lb. Hitch Receiver with Dual Connector 4-Pin or 7-Pin
SmartStructure II

COCKPIT

Fiberglass Automotive Dash with Carbon Weave Instrumentation Panel
CD Player/Radio with Four Speakers
Multi-Positioned Sunvisors
Pleated Front Privacy Drape with Braided Tie Backs
Rear Vision System Prep
In-Dash Compass with Outside Temperature
Intermittent Windshield Wipers
Tilt Steering Wheel
Cruise Control
Power Steering
Electric Automotive Horn
Center Console with Cup Holder and Snack Tray
Two-Tier Side Cup Holders for Pilot Seat (N/A with Door Option)
Two-Tier Side Cup Holders for Co-Pilot Seat with Magazine Rack Below
Soft Touch Vinyl Pilot and Co-Pilot Recliner Seats
Carpeted Driver and Passenger Floor Mats
Dash Workstation
Wood Framed Cabinet Doors with Smoked Glass over Front Entertainment Center Systems
Secure Front Cab over TVs with Steel Framing

OPTIONS

Six-Way Power Pilot Seat
Six-Way Power Co-Pilot Seat
OptimaLeather™ Pilot and Co-Pilot Seats
Rear Vision System with Audio and Adjustable Camera
3-Camera Rear Vision System with Audio and Adjustable Center Camera
Power Sunvisors
Pilot and Co-Pilot Pull-Down Sunshades
CB Radio Prep
Air Horns Roof-Mount with Switch on Side Console
Driver's Side Door with Power Window
Cassette Radio Option includes AM/FM Tuner, CD Player, Weather Band

BODY CONSTRUCTION

Alumaframe® Superstructure
Steel Cage Cockpit Construction
Peaked Aluminum Roof with Fiberglass Insulation
Smooth Gel Coat Fiberglass Exterior Walls
Front and Rear Molded Fiberglass Caps
Aluminum Framed Floor on Steel Trusses
Laminated Structurwood™ Flooring
Interior Paneling with 3/4" Insulation
Foam Insulated Floor Framing with Underbelly
One-Piece Engine Cover
Power Heated Remote Exterior Mirrors
Headlamps with Turn Signals
Fog Lights
Taillights with Upgraded Styling
Streamlined Baggage Doors with Integrated Single Handle Latches
EasyStor Slide-Out Compartments
One-Piece Polyethylene Storage Compartment
Wheel Mud Flaps
Integrated Metal Fuel Door with Lock
Rear Ladder
Interior Rubber Entry Step
Exterior Triple Entry Steps
Undercoating

OPTIONS

3M® Film Front Mask
Chrome Power Heated Remote Exterior Mirrors
Deluxe Full-Body Paint, Forced Option
Full-Length Mud Flap

CHASSIS/ENGINE/SUSPENSION

FORD
6.8L V-10 Gasoline Engine with Electronic Fuel Injection
Engine Displacement: 6.8 Liters 415 Cu. In.
Power: 310 HP; Torque: 425 lbs./ft.
4-Speed Automatic Transmission with Overdrive
Fuel Tank Capacity 75 Gallon
130 Amp Alternator
Rear Axle Ratio 5.38:1
Radial Tires 235/80R 22.5G
Polished Aluminum Wheels
Leaf Spring Suspension
ABS Brake System
Hitch Receiver 4,000 Lb. with Dual Connector 4-Pin or 7-Pin SmartStructure II

WORKHORSE
8.1L V-8 Gasoline Engine with Electronic Fuel Injection
Engine Displacement: 8.1 Liters 496 Cu. In.
Power: 340 HP; Torque: 455 lbs./ft.
5-Speed Automatic Transmission with Overdrive
Fuel Tank Capacity 75 Gallon
145 Amp Alternator
Rear Axle Ratio 5.38:1
Radial Tires 235/80R 22.5G
Leaf Spring Suspension
ABS Brake System
Stainless Steel Wheel Liners
Hitch Receiver 4,000 Lb. with Dual Connector 4-Pin or 7-Pin SmartStructure II

OPTIONS

Fully Automatic Hydraulic Leveling System

**WORKHORSE CHASSIS OPTION W-24 (36'-37' UNITS)
(FORCED ON 37PST)**
8.1L V-8 Gasoline Engine with Electronic Fuel Injection
Engine Displacement: 8.1 Liters 496 Cu. In.
Power: 340 HP; Torque: 455 lbs./ft.
5-Speed Allison® 2100 Automatic Transmission with Overdrive
Fuel Tank Capacity 75 Gallon
145 Amp Alternator
Rear Axle Ratio 5.86:1
Radial Tires 235/80R 22.5G
Leaf Spring Suspension
ABS Brake System
Polished Aluminum Wheels
5,000 Lb. Hitch Receiver with Dual Connector 4-Pin or 7-Pin SmartStructure II

COCKPIT

Fiberglass Automotive Dash with Carbon Weave Instrumentation Panel
CD Player/Radio with Four Speakers
Multi-Positioned Sunvisors
Pleated Front Privacy Drape with Braided Tie Backs
Rear Vision System Prep
In-Dash Compass with Outside Temperature
Intermittent Windshield Wipers
Tilt Steering Wheel
Cruise Control
Power Steering
Electric Automotive Horn
Center Console with Cup Holder and Snack Tray
Two-Tier Side Cup Holders for Pilot Seat (N/A with Door Option)
Two-Tier Side Cup Holders for Co-Pilot Seat with Magazine Rack Below
Soft Touch Vinyl Pilot and Co-Pilot Recliner Seats
Carpeted Driver and Passenger Floor Mats
Dash Workstation
Wood Framed Cabinet Doors with Smoked Glass over Front Entertainment Center Systems
Secure Front Cab over TVs with Steel Framing

OPTIONS

Six-Way Power Pilot Seat
Six-Way Power Co-Pilot Seat
OptimaLeather™ Pilot and Co-Pilot Seats
Rear Vision System with Audio and Adjustable Camera
3-Camera Rear Vision System with Audio and Adjustable Center Camera
Power Sunvisors
Pilot and Co-Pilot Pull-Down Sunshades
CB Radio Prep
Air Horns Roof-Mount with Switch on Side Console
Driver's Side Door with Power Window
Cassette Radio Option includes AM/FM Tuner, CD Player, Weather Band

APPLIANCES & ACCESSORIES

Large Double-Door Refrigerator with Stainless Steel Fronts
Recessed High-Output Two-Burner Cooktop with Sealed Burners and Flush Mount Cover
Removable Solid Surface Range Covers
Spacesaver Microwave with Touch Control Stainless Steel
24" Flatscreen Stereo Color TV with Remote Control in Living Area
19" Stereo Color TV with Remote Control in Bedroom
Bedroom Radio with Single Disc CD Player
TV Antenna
VCR Prep and Video Control Box with Booster
Exterior Hook-Ups for DSS Dish and Cable
Interior Cable TV Hook-Up and Telephone Jacks
Digital Satellite System Prep
Exterior Gas Line Hook-Up Prep for LP Accessories

OPTIONS

Large Double-Door Refrigerator with Ice Maker and Stainless Steel Doors
Large Double-Door Refrigerator with Ice Maker and Stainless Steel Doors 10 Cu. Ft.
Large Four-Door Refrigerator with Ice Maker and Stainless Steel Doors (N/A with Pantry)
High-Output Three-Burner Range with Oven
Spacesaver Convection Microwave with Touch Control Stainless Steel
Washer/Dryer Prep, Requires 50 Amp Service Option (N/A: 34SBD, 37PCT)
Combination Washer/Dryer, Requires Washer/Dryer Prep Option (N/A: 34SBD, 37PCT)
Living Area Stereo TV Wired Through Ceiling Speakers
VCR (N/A with Home Theater Option)
DVD Player (N/A with Home Theater Option)
Home Theater System with DVD and VCR Player and Surround Sound Speakers
Exterior Entertainment Center, CD Player Radio with Two Speakers

INTERIOR

Vintage Oak Cabinetry
Raised Panel Hardwood Cabinet Doors
Hardwood Cabinet End Panels in Living Area
Refrigerator Stainless Steel Doors
Decorative Wallboard
Wallpaper Border to Bath Wall and Bedroom
Self-Supporting Top-Hinged Overhead Storage Doors and Positive Catches on All Other Doors
Heavy-Duty Ball Bearing Drawer Guides
Wood Cabinet Drawer Boxes
Wood Interior Grab Handle on Cabinet at Entry Door
Satin Finished Entry Rail for Step Well (N/A with Computer Desk Option) (37PBD)
Satin Nickel Cabinetry Hardware and Bath Accessories
Solid Surface Radius Profile Kitchen Countertop with Under-Mounted Plexus-Stone Sink with Two Sink Covers
Pullout Cutting Board under Cooktop
Toe Kicks with Rope Lighting in Kitchen and Bath Base Cabinets
Solid Surface Bath Lavatory Countertop with Integrated Bowl
All Other Countertops Laminated with Perm-Edge, Except Kitchen and Bath Lavatory
Kitchen Overhead Cabinets with Adjustable Shelf
Kitchen Pantry next to Refrigerator with Adjustable Shelves in Upper Cabinet and Three Drawers Below (N/A with Four-Door Refrigerator Option)
Silverware Drawer with Organizer Kitchen Base Cabinets (N/A with Range Option)
Trash Can inside Kitchen Base Cabinet
Smoked Mirrors behind Stove Area
Wilsonart® Plank Flooring in Kitchen, Bath and Entry
Upgraded Nylon Carpeting with Pad in Living Area and Bedroom

OPTIONS

Decors: Romanesque, Autumn Trellis, Espresso, Green Manor, Onyx
Wood Choice: Autumn Cherry and Maple

Soft Touch Padded Vinyl Ceiling
Hardwood Slide-Out Fascia Design with Metal Insert Accent
Arched Beveled Living Area or Bedroom Mirror, Wainscoting Accent under Mirrors Living Area (N/A: 36WDD; Bedroom Only on 37PCT N/A with wainscoting)
Hutch with Glass Doors/Back Light Glass (36WDD, 37PCT)
Picture in Bedroom Area (34SBD End of Shower Wall)
Hardwood Raised Panel Bathroom Door
Wood Louvers on Washer and Dryer Doors (N/A: 34SBD, 37PCT)
Magazine Rack Bathroom (N/A: 34SBD, 37PBD)
Wood Trim for Bath Door Opening Hallway Side
Accent Crown Molding in Bedroom and Living Area on All Open Walls
Medicine Cabinet with Shelves
Bathroom Lavatory Base Mirror with Wood Frame
Towel Bar on Back of Bath Door/Towel Bar in Rear Bath across from Shower (36DBD)
Two Towel Rings in Bathroom
Shadow Box Rear Bedroom Wall with Accent Lights in Header and Outlet; Wainscoting Accent under Shadow Box (Mirror N/A with Rear Window Option) (34SBD, 37PBD, 37PST)
Rear Wardrobe Closet with Deluxe Mirror Door Frames Satin Finish (36WDD)
Bedroom Swing-Away TV Cabinets
Bedspread with Three Decorative Pillows
Wood Headboard with Fabric Insert
Blackout Day/Night Pleated Shades in Living Area and in Bedroom
Mini Blinds in Kitchen and Bathroom
Soil Repellant on Fabric, Teflon® Fabric Protection

APPLIANCES & ACCESSORIES

Large Double-Door Refrigerator with Stainless Steel Fronts
Recessed High-Output Two-Burner Cooktop with Sealed Burners and Flush Mount Cover
Removable Solid Surface Range Covers
Spacesaver Microwave with Touch Control Stainless Steel
24" Flatscreen Stereo Color TV with Remote Control in Living Area
19" Stereo Color TV with Remote Control in Bedroom
Bedroom Radio with Single Disc CD Player
TV Antenna
VCR Prep and Video Control Box with Booster
Exterior Hook-Ups for DSS Dish and Cable
Interior Cable TV Hook-Up and Telephone Jacks
Digital Satellite System Prep
Exterior Gas Line Hook-Up Prep for LP Accessories

OPTIONS

Large Double-Door Refrigerator with Ice Maker and Stainless Steel Doors
Large Double-Door Refrigerator with Ice Maker and Stainless Steel Doors 10 Cu. Ft.
Large Four-Door Refrigerator with Ice Maker and Stainless Steel Doors (N/A with Pantry)
High-Output Three-Burner Range with Oven
Spacesaver Convection Microwave with Touch Control Stainless Steel
Washer/Dryer Prep, Requires 50 Amp Service Option (N/A: 34SBD, 37PCT)
Combination Washer/Dryer, Requires Washer/Dryer Prep Option (N/A: 34SBD, 37PCT)
Living Area Stereo TV Wired Through Ceiling Speakers
VCR (N/A with Home Theater Option)
DVD Player (N/A with Home Theater Option)
Home Theater System with DVD and VCR Player and Surround Sound Speakers
Exterior Entertainment Center, CD Player Radio with Two Speakers

INTERIOR

Vintage Oak Cabinetry
Raised Panel Hardwood Cabinet Doors
Hardwood Cabinet End Panels in Living Area
Refrigerator Stainless Steel Doors
Decorative Wallboard
Wallpaper Border to Bath Wall and Bedroom
Self-Supporting Top-Hinged Overhead Storage Doors and Positive Catches on All Other Doors
Heavy-Duty Ball Bearing Drawer Guides
Wood Cabinet Drawer Boxes
Wood Interior Grab Handle on Cabinet at Entry Door
Satin Finished Entry Rail for Step Well (N/A with Computer Desk Option) (37PBD)
Satin Nickel Cabinetry Hardware and Bath Accessories
Solid Surface Radius Profile Kitchen Countertop with Under-Mounted Plexus-Stone Sink with Two Sink Covers
Pullout Cutting Board under Cooktop
Toe Kicks with Rope Lighting in Kitchen and Bath Base Cabinets
Solid Surface Bath Lavatory Countertop with Integrated Bowl
All Other Countertops Laminated with Perm-Edge, Except Kitchen and Bath Lavatory
Kitchen Overhead Cabinets with Adjustable Shelf
Kitchen Pantry next to Refrigerator with Adjustable Shelves in Upper Cabinet and Three Drawers Below (N/A with Four-Door Refrigerator Option)
Silverware Drawer with Organizer Kitchen Base Cabinets (N/A with Range Option)
Trash Can inside Kitchen Base Cabinet
Smoked Mirrors behind Stove Area
Wilsonart® Plank Flooring in Kitchen, Bath and Entry
Upgraded Nylon Carpeting with Pad in Living Area and Bedroom

OPTIONS

Decors: Romanesque, Autumn Trellis, Espresso, Green Manor, Onyx
Wood Choice: Autumn Cherry and Maple

Soft Touch Padded Vinyl Ceiling
Hardwood Slide-Out Fascia Design with Metal Insert Accent
Arched Beveled Living Area or Bedroom Mirror, Wainscoting Accent under Mirrors Living Area (N/A: 36WDD; Bedroom Only on 37PCT N/A with wainscoting)
Hutch with Glass Doors/Back Light Glass (36WDD, 37PCT)
Picture in Bedroom Area (34SBD End of Shower Wall)
Hardwood Raised Panel Bathroom Door
Wood Louvers on Washer and Dryer Doors (N/A: 34SBD, 37PCT)
Magazine Rack Bathroom (N/A: 34SBD, 37PBD)
Wood Trim for Bath Door Opening Hallway Side
Accent Crown Molding in Bedroom and Living Area on All Open Walls
Medicine Cabinet with Shelves
Bathroom Lavatory Base Mirror with Wood Frame
Towel Bar on Back of Bath Door/Towel Bar in Rear Bath across from Shower (36DBD)
Two Towel Rings in Bathroom
Shadow Box Rear Bedroom Wall with Accent Lights in Header and Outlet; Wainscoting Accent under Shadow Box (Mirror N/A with Rear Window Option) (34SBD, 37PBD, 37PST)
Rear Wardrobe Closet with Deluxe Mirror Door Frames Satin Finish (36WDD)
Bedroom Swing-Away TV Cabinets
Bedsread with Three Decorative Pillows
Wood Headboard with Fabric Insert
Blackout Day/Night Pleated Shades in Living Area and in Bedroom
Mini Blinds in Kitchen and Bathroom
Soil Repellant on Fabric, Teflon® Fabric Protection

FURNITURE

Queen Bed with Nightstands
Rotocast Booth Dinette, with Drawer(s)
Fabric Hide-A-Bed Sofa with Three Pillows
Fabric Swivel Glider Barrel Chair
Fabric Swivel Glider Barrel Chair and Desk Chair
Bedroom (37PCT)

OPTIONS

Pillow Top Mattress
Fabric Hide-A-Bed Sofa with Air Mattress
and Three Pillows
OptimaLeather™ Hide-A-Bed Sofa
with Three Pillows
OptimaLeather™ Hide-A-Bed Sofa with Air Mattress
and Three Pillows
Fabric Electric Sofa IPO Hide-A-Bed Sofa
Curbside OptimaLeather™ J-Lounge IPO Swivel Glider
Barrel Chair and Computer Desk (37PBD)
New Style Fabric Swivel Recliner Chair IPO Fabric
Swivel Glider Barrel Chair
OptimaLeather™ New Style Swivel Recliner Chair IPO
Fabric Swivel Glider Barrel Chair
OptimaLeather™ Euro-Recliner Chair with Ottoman
IPO Swivel Glider Barrel Chair
Curbside Two Fabric Recliners IPO Swivel Glider Barrel
Chair and Computer Desk (37PBD)
Curbside Two OptimaLeather™ Euro-Recliners
with Ottomans IPO Swivel Glider Barrel Chair
and Computer Desk (37PBD)
Fabric Swivel Glider Barrel Chair IPO Desk Chair
Bedroom (37PCT)
Bedroom Desk (N/A: 37PBD, 37PCT, 37PST)
Adjustable Coffee Table
Legless Dinette with Wall Cabinet,
Two Freestanding Chairs and Two Folding Chairs

ELECTRICAL SYSTEMS & LIGHTS

30 Amp 120V Distribution Panel and Power Cord
55 Amp Electronic 12V Power Converter
Onan® 5.5 kW Gas Generator
Two 6V House Batteries
Battery Disconnect Switches
12V and 110V Outlet in Cockpit Area
Porch Light and Exterior Step Light on Same Switch
Exterior Power Entry Step, with Light
Interior Stepwell Entry Step Lights
Water Pump Switch in Service Bay Area
and System Panel
Lights in Outside Storage Compartments
120V Receptacles in Outside Storage Compartment
Underhood Utility Light
Receptacle and Phone Jack in Dinette Area
Directional Map Lights Pilot
and Co-Pilot Seats
Systems Control Center in Hallway
Fluorescent Light(s) under Kitchen Overhead
Fluorescent Ceiling Lights Throughout
Fluorescent Ceiling Lights inside Living Area
Slide-Out House
Rope Lighting under Toe Kicks in Kitchen
and Bath Lavatory
Decorative Wood Framed Galley Ceiling Fluorescent
Light with Skylight and Shade
Satin Nickel Decorative Lighting Living Room Wall
Light, Dinette Overhead, Bedroom Cosmetic, Bath
Vanity Light
Halogen Lights under Living Room and Dining Room
Overhead Cabinets (Satin Finish)
Bullet Lights over Bed Satin Finish
with His and Hers Switches
Wardrobe Closet Lights

OPTIONS

Energy Management System with or without
50 Amp Service
50 Amp 120V Distribution Panel and Cord
140 Watt Inverter (N/A with 2,000 Watt Inverter)
2,000 Watt Inverter with Two Additional Batteries
Storage Compartment Tank Monitor Gauge

PLUMBING & LP SYSTEMS

Kitchen Composite Under-Mounted Sink with Single
Lever Chrome Faucet with Pullout Sprayer
Separate Chrome Faucet for Filtered Water
Bath Lavatory Faucet Single Handle Platinum Chrome
Demand Water System and Water Pump
10 Gallon LP Gas/Electric Water Heater
with Electronic Ignition, DSI
Winterization Valving System
Water Heater By-Pass Valve
Porcelain Toilet with Sprayer
No-Fuss Flush Holding Tank Rinsing System
Insulated Systems Compartment with Easy Access
to Hook-Up
Shower inside Wet Bay with Hot/Cold Water
Soap Dispenser inside Utility
Gravity and Pressurized Water Fill
Contained Storage Area for Sewer Hose
One-Piece Fiberglass Shower
Shower Diverter, Hose and Head, Satin Finish,
with Satin Slide Bar for Shower Head with Soap Dish
Shower Light on Ceiling inside Shower
Satin Nickel Shower Door Frame with Decorative Glass
Chrome Shampoo/Conditioner/Soap Dispenser
in Shower

OPTIONS

RV Sani-Con 2 System, Holding Tank Flush System
Bathtub IPO Shower

FURNITURE

Queen Bed with Nightstands
Rotocast Booth Dinette, with Drawer(s)
Fabric Hide-A-Bed Sofa with Three Pillows
Fabric Swivel Glider Barrel Chair
Fabric Swivel Glider Barrel Chair and Desk Chair
Bedroom (37PCT)

OPTIONS

Pillow Top Mattress
Fabric Hide-A-Bed Sofa with Air Mattress
and Three Pillows
OptimaLeather™ Hide-A-Bed Sofa
with Three Pillows
OptimaLeather™ Hide-A-Bed Sofa with Air Mattress
and Three Pillows
Fabric Electric Sofa IPO Hide-A-Bed Sofa
Curbside OptimaLeather™ J-Lounge IPO Swivel Glider
Barrel Chair and Computer Desk (37PBD)
New Style Fabric Swivel Recliner Chair IPO Fabric
Swivel Glider Barrel Chair
OptimaLeather™ New Style Swivel Recliner Chair IPO
Fabric Swivel Glider Barrel Chair
OptimaLeather™ Euro-Recliner Chair with Ottoman
IPO Swivel Glider Barrel Chair
Curbside Two Fabric Recliners IPO Swivel Glider Barrel
Chair and Computer Desk (37PBD)
Curbside Two OptimaLeather™ Euro-Recliners
with Ottomans IPO Swivel Glider Barrel Chair
and Computer Desk (37PBD)
Fabric Swivel Glider Barrel Chair IPO Desk Chair
Bedroom (37PCT)
Bedroom Desk (N/A: 37PBD, 37PCT, 37PST)
Adjustable Coffee Table
Legless Dinette with Wall Cabinet,
Two Freestanding Chairs and Two Folding Chairs

ELECTRICAL SYSTEMS & LIGHTS

30 Amp 120V Distribution Panel and Power Cord
55 Amp Electronic 12V Power Converter
Onan® 5.5 kW Gas Generator
Two 6V House Batteries
Battery Disconnect Switches
12V and 110V Outlet in Cockpit Area
Porch Light and Exterior Step Light on Same Switch
Exterior Power Entry Step, with Light
Interior Stepwell Entry Step Lights
Water Pump Switch in Service Bay Area
and System Panel
Lights in Outside Storage Compartments
120V Receptacles in Outside Storage Compartment
Underhood Utility Light
Receptacle and Phone Jack in Dinette Area
Directional Map Lights Pilot
and Co-Pilot Seats
Systems Control Center in Hallway
Fluorescent Light(s) under Kitchen Overhead
Fluorescent Ceiling Lights Throughout
Fluorescent Ceiling Lights inside Living Area
Slide-Out House
Rope Lighting under Toe Kicks in Kitchen
and Bath Lavatory
Decorative Wood Framed Galley Ceiling Fluorescent
Light with Skylight and Shade
Satin Nickel Decorative Lighting Living Room Wall
Light, Dinette Overhead, Bedroom Cosmetic, Bath
Vanity Light
Halogen Lights under Living Room and Dining Room
Overhead Cabinets (Satin Finish)
Bullet Lights over Bed Satin Finish
with His and Hers Switches
Wardrobe Closet Lights

OPTIONS

Energy Management System with or without
50 Amp Service
50 Amp 120V Distribution Panel and Cord
140 Watt Inverter (N/A with 2,000 Watt Inverter)
2,000 Watt Inverter with Two Additional Batteries
Storage Compartment Tank Monitor Gauge

PLUMBING & LP SYSTEMS

Kitchen Composite Under-Mounted Sink with Single
Lever Chrome Faucet with Pullout Sprayer
Separate Chrome Faucet for Filtered Water
Bath Lavatory Faucet Single Handle Platinum Chrome
Demand Water System and Water Pump
10 Gallon LP Gas/Electric Water Heater
with Electronic Ignition, DSI
Winterization Valving System
Water Heater By-Pass Valve
Porcelain Toilet with Sprayer
No-Fuss Flush Holding Tank Rinsing System
Insulated Systems Compartment with Easy Access
to Hook-Up
Shower inside Wet Bay with Hot/Cold Water
Soap Dispenser inside Utility
Gravity and Pressurized Water Fill
Contained Storage Area for Sewer Hose
One-Piece Fiberglass Shower
Shower Diverter, Hose and Head, Satin Finish,
with Satin Slide Bar for Shower Head with Soap Dish
Shower Light on Ceiling inside Shower
Satin Nickel Shower Door Frame with Decorative Glass
Chrome Shampoo/Conditioner/Soap Dispenser
in Shower

OPTIONS

RV Sani-Con 2 System, Holding Tank Flush System
Bathtub IPO Shower

HEATING, VENTS & AIR CONDITIONING

One 13.5M BTU Air Conditioner with Ducted Air and Wall Digital Thermostat (34SBD)
One 13.5M BTU and One 11.0M BTU Air Conditioner with Ducted Air and Wall Digital Thermostat (N/A: 34SBD)
35M BTU Electronic Ignition Furnace
Electronic Dash AC/Heat Climate Control System
In-Floor Ducted Heating System with Metal Floor Registers
12V Attic Fan with Wall Thermostat in Kitchen (N/A with Single Air Conditioner)
12V Attic Fan with Wall Thermostat in Living Area (N/A with Twin Air Conditioners)
12V Attic Fan with Wall Thermostat in Bath, Walk-Through Area
12V Bath Fan inside Private Bath Area
Manual Roof Vent Bedroom (34SBD)
12V Heater in Wet Bay
Satin Nickel Finish Metal Air Return Grill for Furnace
Metal Floor Registers Satin Nickel

OPTIONS

Dual 13.5M BTU Air Conditioner, Requires 50 Amp Service (N/A: 34SBD)
One 13.5M BTU and One 11.0M BTU Air Conditioner (34SBD)
Dual 13.5M BTU Air Conditioner with Heat Pumps, Requires 50 Amp Service (N/A: 34SBD)
One 13.5M BTU Air Conditioner with Heat Pump (34SBD)
12V Attic Fan with Rain Sensor and Wall Thermostat in Kitchen (N/A with Single Air Conditioner)
12V Attic Fan with Rain Sensor and Wall Thermostat in Living Area (N/A with Twin Air Conditioners)
12V Attic Fan with Rain Sensor and Wall Thermostat in Bath, Walk-Through Area

WINDOWS, DOORS & AWNINGS

Radius Flush Mount Dual Pane Safety Glass Dark Tinted Slider Windows
Opera Window at Swivel Glider Barrel Chair Location (N/A: 37PBD)
Bathroom Window (N/A: 34SBD, 37PBD)
Radius Entrance Door with Clear Glass, Roller Shade, Screen Door and Anti-Skid Steps
Two Interior Grab Handles and One Exterior Grab Handle
Topper Slide-Out Awnings Living Area and Bedroom
Protecta Glaze Tinted Plexiglas® Skylight in Bathroom
Protecta Glaze Tinted Plexiglas® Skylight in Kitchen with Pleated Shade

OPTIONS

Acrylic Patio Awning with Metal Cover
Eclipse Automatic Patio Awning
Window Awnings Living Area Slide-Out House Windows
Rear Bedroom Window (34SBD, 37PBD, 37PST)
Sidewall Window Awning Bedroom (N/A: 37PCT)

SAFETY

Fire Extinguisher
Deadbolt Lock on Entrance Door
120V GFI Protected Circuit, Kitchen, Bath and Exterior
LP Gas Detector
Smoke Detector
Carbon Monoxide Detector
Pilot and Co-Pilot Three-Point Seat Belts
Third Brake Safety Light
Egress Windows

HEATING, VENTS & AIR CONDITIONING

One 13.5M BTU Air Conditioner with Ducted Air and Wall Digital Thermostat (34SBD)
One 13.5M BTU and One 11.0M BTU Air Conditioner with Ducted Air and Wall Digital Thermostat (N/A: 34SBD)
35M BTU Electronic Ignition Furnace
Electronic Dash AC/Heat Climate Control System
In-Floor Ducted Heating System with Metal Floor Registers
12V Attic Fan with Wall Thermostat in Kitchen (N/A with Single Air Conditioner)
12V Attic Fan with Wall Thermostat in Living Area (N/A with Twin Air Conditioners)
12V Attic Fan with Wall Thermostat in Bath, Walk-Through Area
12V Bath Fan inside Private Bath Area
Manual Roof Vent Bedroom (34SBD)
12V Heater in Wet Bay
Satin Nickel Finish Metal Air Return Grill for Furnace
Metal Floor Registers Satin Nickel

OPTIONS

Dual 13.5M BTU Air Conditioner, Requires 50 Amp Service (N/A: 34SBD)
One 13.5M BTU and One 11.0M BTU Air Conditioner (34SBD)
Dual 13.5M BTU Air Conditioner with Heat Pumps, Requires 50 Amp Service (N/A: 34SBD)
One 13.5M BTU Air Conditioner with Heat Pump (34SBD)
12V Attic Fan with Rain Sensor and Wall Thermostat in Kitchen (N/A with Single Air Conditioner)
12V Attic Fan with Rain Sensor and Wall Thermostat in Living Area (N/A with Twin Air Conditioners)
12V Attic Fan with Rain Sensor and Wall Thermostat in Bath, Walk-Through Area

WINDOWS, DOORS & AWNINGS

Radius Flush Mount Dual Pane Safety Glass Dark Tinted Slider Windows
Opera Window at Swivel Glider Barrel Chair Location (N/A: 37PBD)
Bathroom Window (N/A: 34SBD, 37PBD)
Radius Entrance Door with Clear Glass, Roller Shade, Screen Door and Anti-Skid Steps
Two Interior Grab Handles and One Exterior Grab Handle
Topper Slide-Out Awnings Living Area and Bedroom
Protecta Glaze Tinted Plexiglas® Skylight in Bathroom
Protecta Glaze Tinted Plexiglas® Skylight in Kitchen with Pleated Shade

OPTIONS

Acrylic Patio Awning with Metal Cover
Eclipse Automatic Patio Awning
Window Awnings Living Area Slide-Out House Windows
Rear Bedroom Window (34SBD, 37PBD, 37PST)
Sidewall Window Awning Bedroom (N/A: 37PCT)

SAFETY

Fire Extinguisher
Deadbolt Lock on Entrance Door
120V GFI Protected Circuit, Kitchen, Bath and Exterior
LP Gas Detector
Smoke Detector
Carbon Monoxide Detector
Pilot and Co-Pilot Three-Point Seat Belts
Third Brake Safety Light
Egress Windows