

2005 MONARCH SE®

MONARCH SE®
2005



MONACO



MONACO

DRIVING YOUR DREAM.™

2005 MONARCH SE®

MONARCH SE®
2005



MONACO®



MONACO®

DRIVING YOUR DREAM.™

The 2005 Monarch SE®

Welcome aboard the 2005 Monarch SE. This value-packed gas motorhome is the perfect way to experience Monaco's legendary quality. The coach's interior features many residential-style details, including beautiful cabinetry, accent crown molding and decorative slide-out fascia. You'll enjoy plush fabric furnishings, padded carpeting and either linoleum flooring or the optional laminate plank flooring, shown here. Above the cockpit, you'll find an exciting 24" flatscreen stereo TV, as well as cabinets for housing the optional VCR and DVD player.

DRIVING YOUR DREAM.

Dreams. They're the way we write the story of our lives. Some are serious. Like raising kids or building a business. Others are pure fun. Like the dream you have early on a summer morning, sipping coffee and working on your life's next chapter. It's about making big plans and changing them on a whim. Or even better, following your heart without any plans at all. Yes, it's the dream of a lifetime. And with Monaco's legendary quality, reliability and innovation, we can make it all come true.



MONACO

DRIVING YOUR DREAM.™



Welcome aboard the 2005 Monarch SE. This value-packed gas motorhome is the perfect way to experience Monaco's legendary quality. The coach's interior features many residential-style details, including beautiful cabinetry, accent crown molding and decorative slide-out fascia. You'll enjoy plush fabric furnishings, padded carpeting and either linoleum flooring or the optional laminate plank flooring, shown here. Above the cockpit, you'll find an exciting 24" flatscreen stereo TV, as well as cabinets for housing the optional VCR and DVD player.

DRIVING YOUR DREAM.

Dreams. They're the way we write the story of our lives. Some are serious. Like raising kids or building a business. Others are pure fun. Like the dream you have early on a summer morning, sipping coffee and working on your life's next chapter. It's about making big plans and changing them on a whim. Or even better, following your heart without any plans at all. Yes, it's the dream of a lifetime. And with Monaco's legendary quality, reliability and innovation, we can make it all come true.



MONACO

DRIVING YOUR DREAM.™





A The automotive-style dash puts everything you need within easy reach. Highlights include a **CD player/radio with four speakers**, a new **wood center console with cupholders** and a front drawer or tip door, depending on the chassis. A **three-camera rear vision system** with audio makes an attractive option — giving you eyes and ears for what's behind the motorhome.

B A **fold-out sofa** easily accommodates family or friends and adds versatility to your floorplan. A **jackknife sofa** comes standard, or you may choose an optional **hide-a-bed** in fabric or soft touch vinyl — with your choice of a standard mattress or an air mattress.

C The Monarch SE's **booth dinette** also easily converts into a comfortable sleeping area.

Interior, 37PBD, Vintage Oak, Park Lane.



A The automotive-style dash puts everything you need within easy reach. Highlights include a **CD player/radio with four speakers**, a new **wood center console with cupholders** and a front drawer or tip door, depending on the chassis. A **three-camera rear vision system** with audio makes an attractive option — giving you eyes and ears for what's behind the motorhome.



B A **fold-out sofa** easily accommodates family or friends and adds versatility to your floorplan. A **jackknife sofa** comes standard, or you may choose an optional **hide-a-bed** in fabric or soft touch vinyl — with your choice of a standard mattress or an air mattress.



C The Monarch SE's **booth dinette** also easily converts into a comfortable sleeping area.

Interior, 37PBD, Vintage Oak, Park Lane.

Each year, our designers create color and fabric combinations that lead the industry in warmth and style. This year, we're offering five beautiful decors and three stunning cabinet finishes.

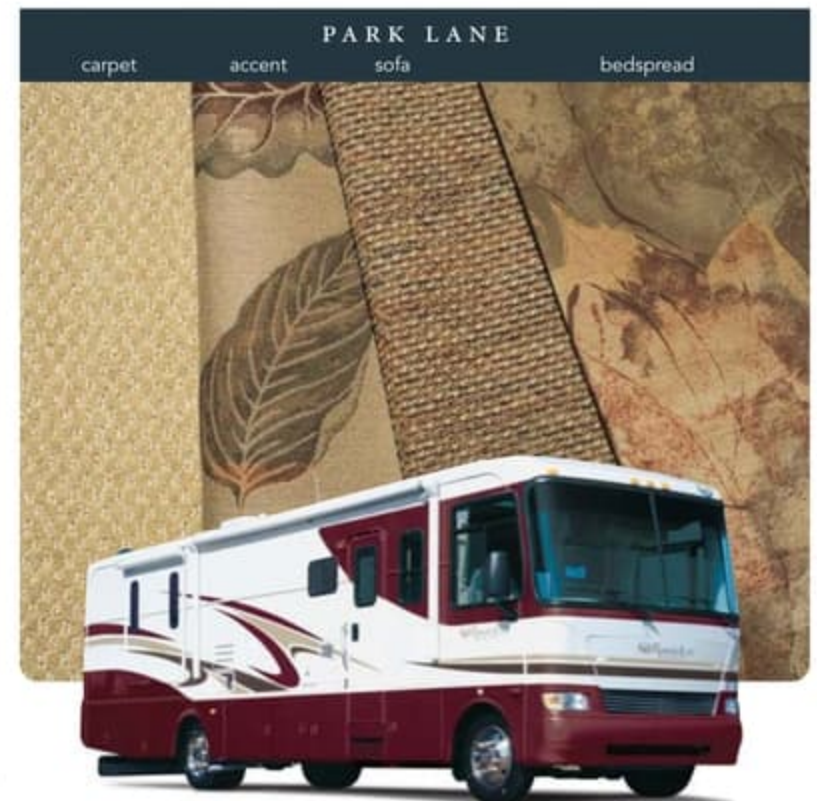
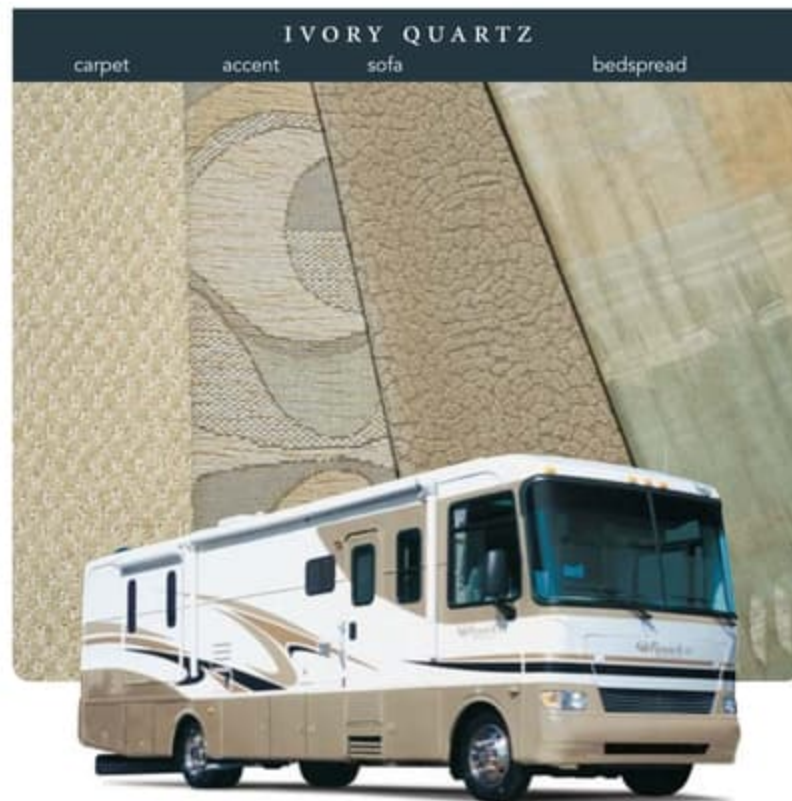
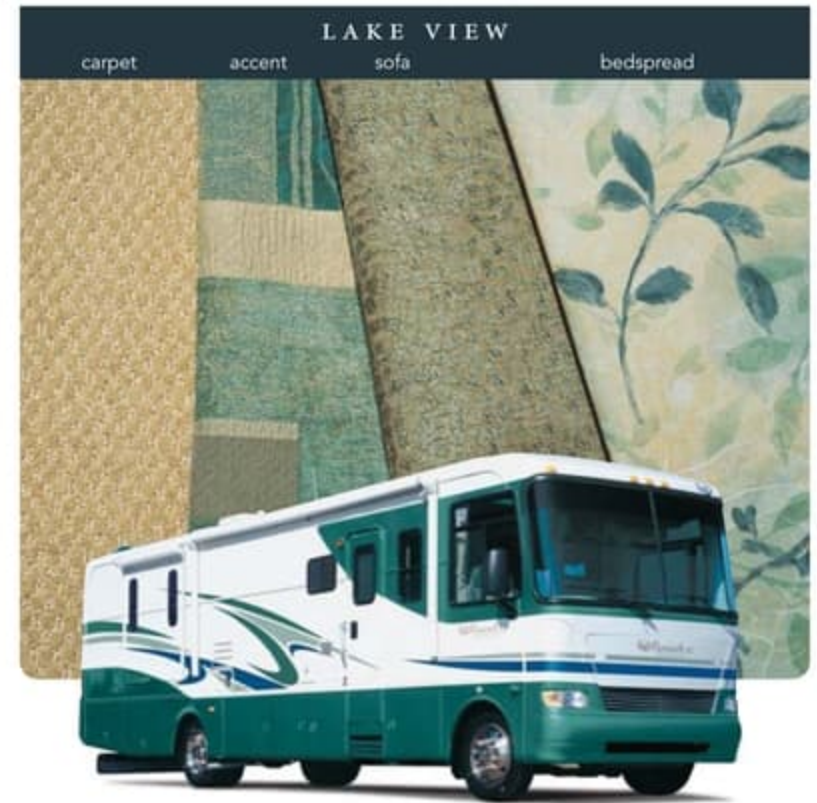

Manufactured in, not added on. For added protection against stains, Dupont Teflon® soil repellent is applied to virtually all upholstery fabric during the finishing process for superior coverage.*

*Brand and application of upholstery fabric protection may vary depending on date recreational vehicle was manufactured.

Note: Colors depicted are a reasonable representation though they may not be an exact match of the actual colors due to variances in processing and production. See your dealer for actual fabric and paint chip samples.

Each year, our designers create color and fabric combinations that lead the industry in warmth and style. This year, we're offering five beautiful decors and three stunning cabinet finishes.

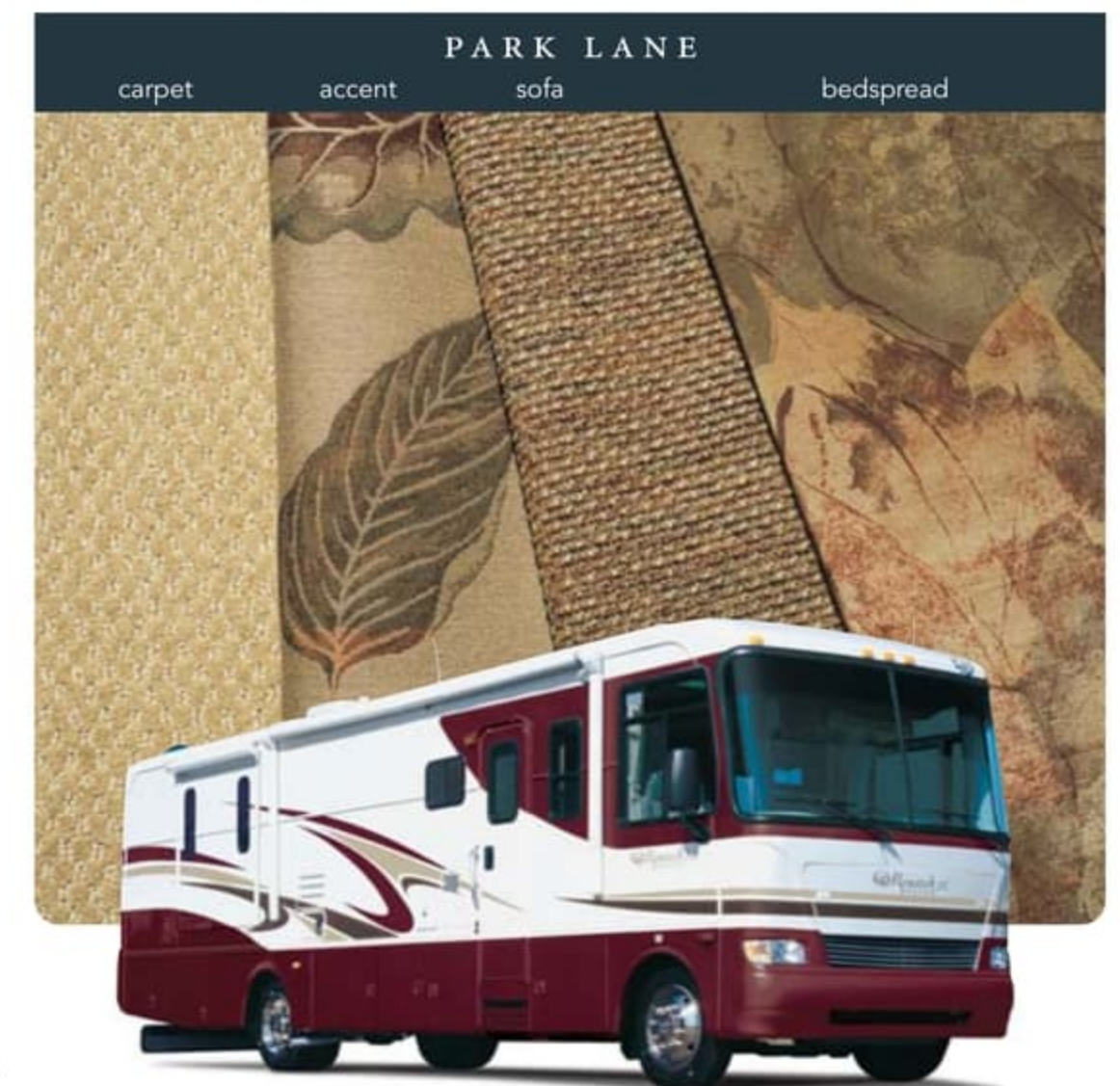
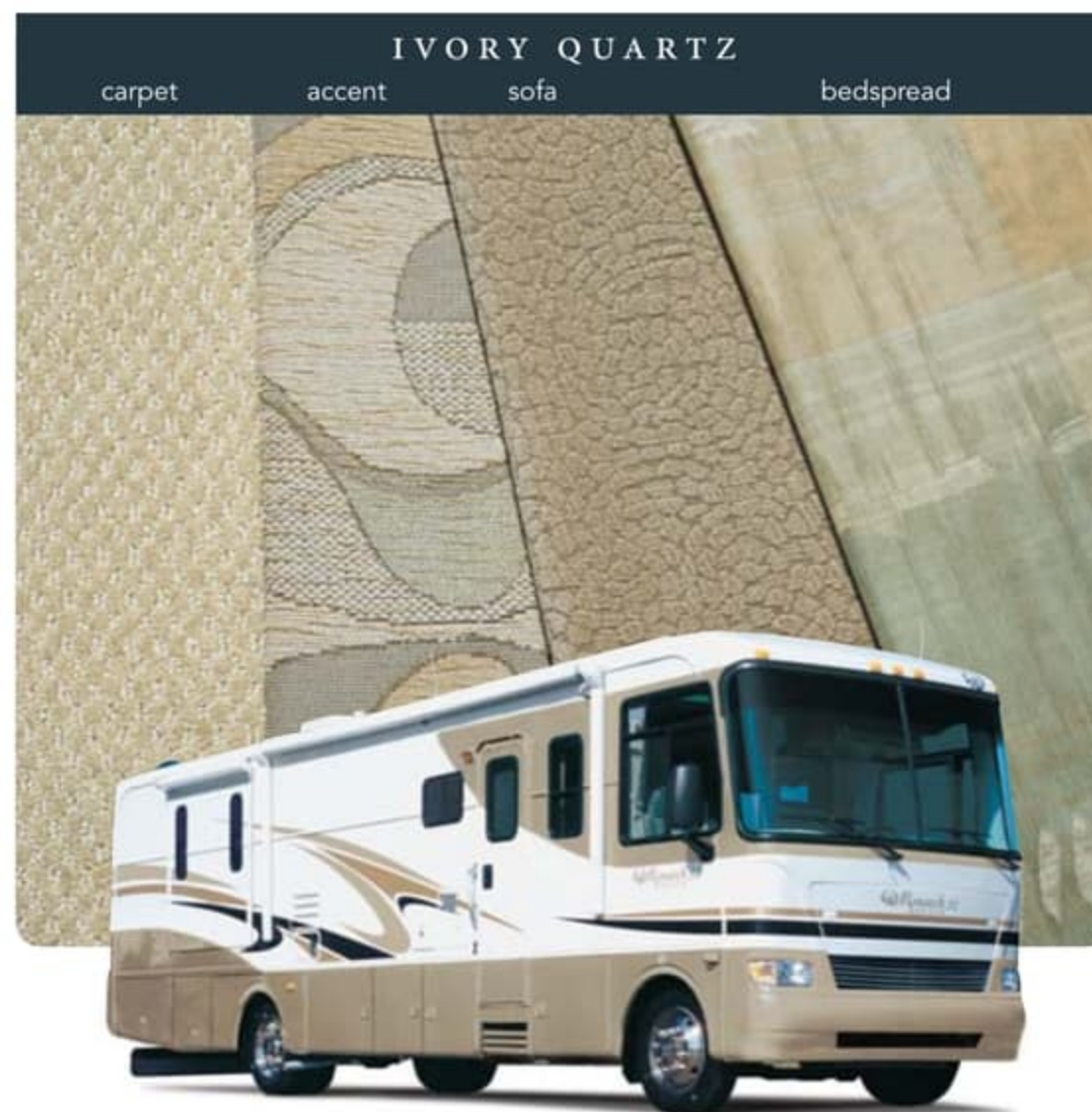
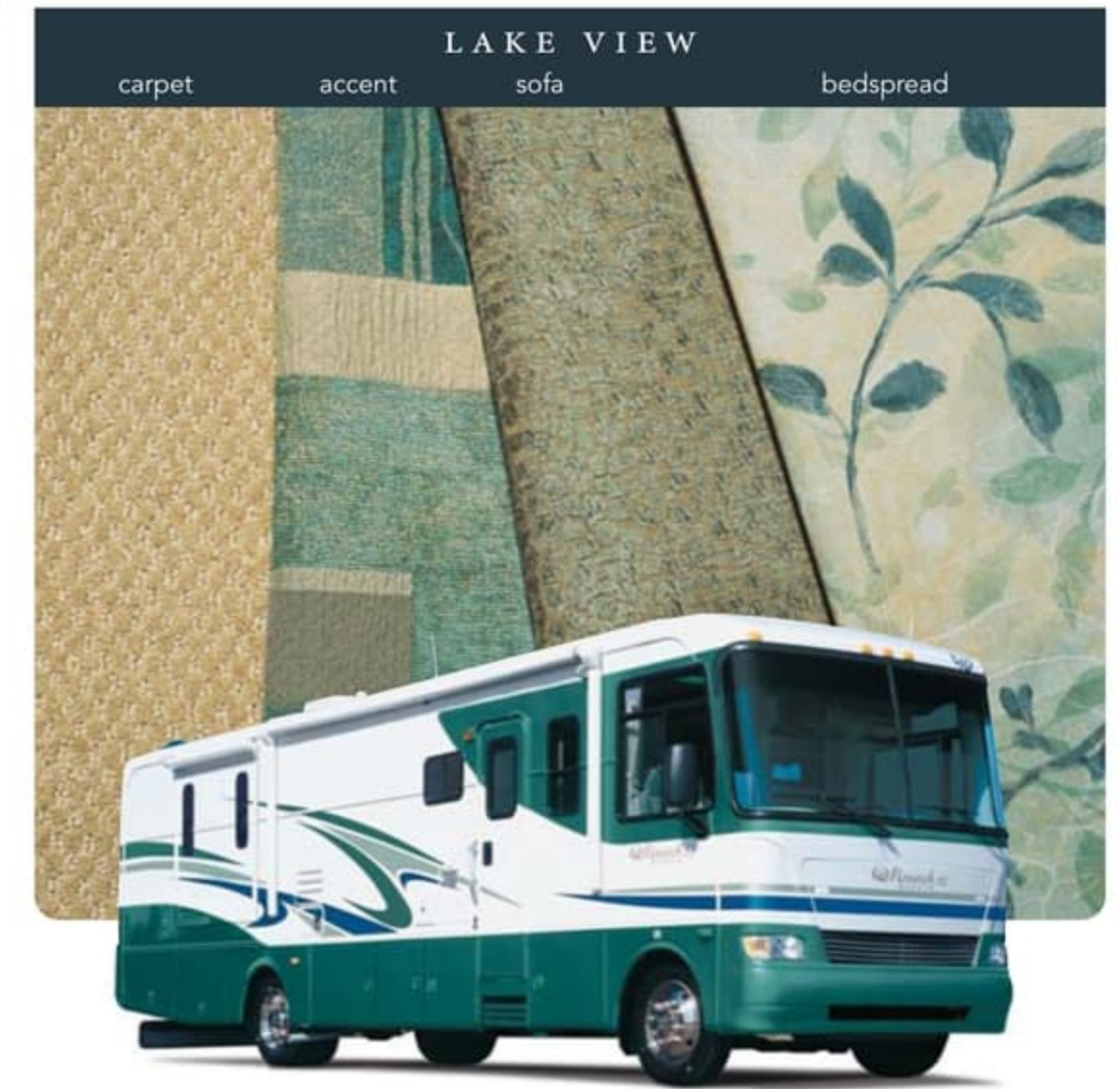

Manufactured in, not added on. For added protection against stains, Dupont Teflon® soil repellent is applied to virtually all upholstery fabric during the finishing process for superior coverage.*

*Brand and application of upholstery fabric protection may vary depending on date recreational vehicle was manufactured.

Note: Colors depicted are a reasonable representation though they may not be an exact match of the actual colors due to variances in processing and production. See your dealer for actual fabric and paint chip samples.

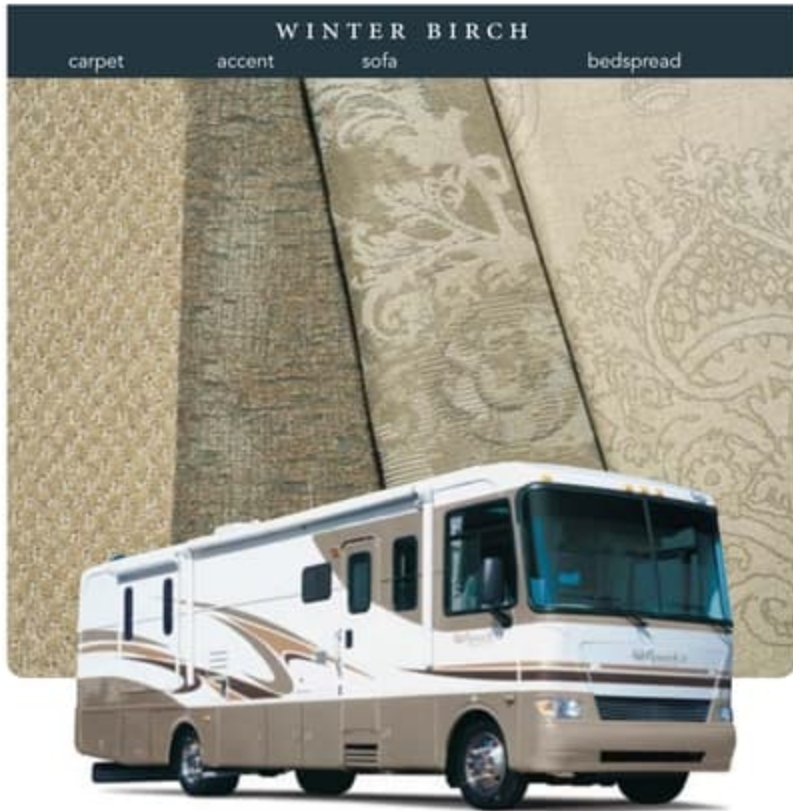

A Our insulated systems compartment gives you easy access to hook-up functions. Other wet bay conveniences include a hot and cold water shower and a soap dispenser.

B This year, the Monarch SE boasts a whopping 32% increase in storage capacity, with new pass-through bays under the slide-outs. New side-hinged baggage doors make it easier than ever to pack and unpack the items you stow down below.

C While you're enjoying the outdoors, you'll also enjoy catching up on the news or listening to your favorite music with this optional exterior entertainment center, featuring a CD player and radio with two speakers.

An optional patio awning adds a finishing touch and helps make your campground experiences more enjoyable.





A Our **insulated systems compartment** gives you easy access to hook-up functions. Other wet bay conveniences include a **hot and cold water shower** and a **soap dispenser**.



B This year, the Monarch SE boasts a whopping **32% increase in storage capacity**, with new **pass-through bays** under the slide-outs. New **side-hinged baggage doors** make it easier than ever to pack and unpack the items you stow down below.



C While you're enjoying the outdoors, you'll also enjoy catching up on the news or listening to your favorite music with this optional **exterior entertainment center**, featuring a **CD player** and **radio with two speakers**.



An optional **patio awning** adds a finishing touch and helps make your campground experiences more enjoyable.



No other manufacturer gives you as many innovative floorplan choices as Monaco. The 2005 Monarch SE offers double and triple slide-out models in lengths that range from 33' to 37'.



Find all the latest product news and updates online: monacocoach.com

33PBD

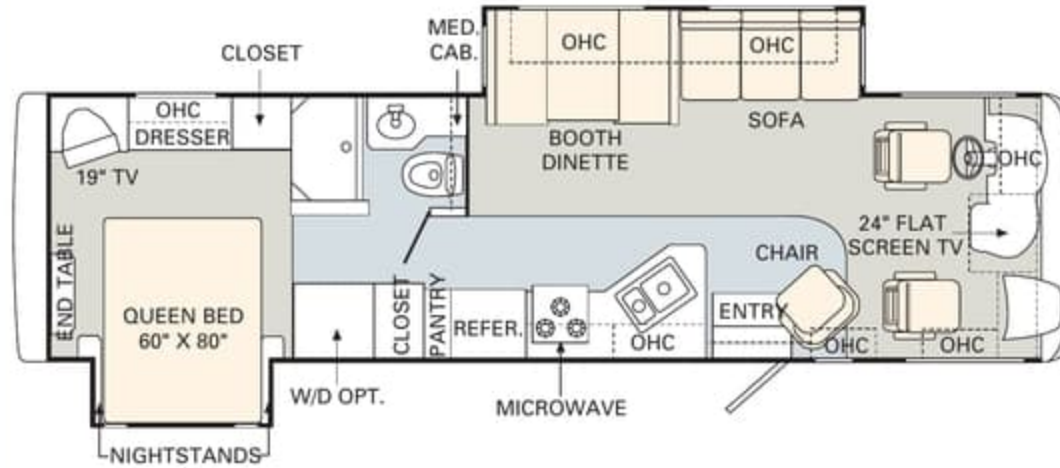

34SBD

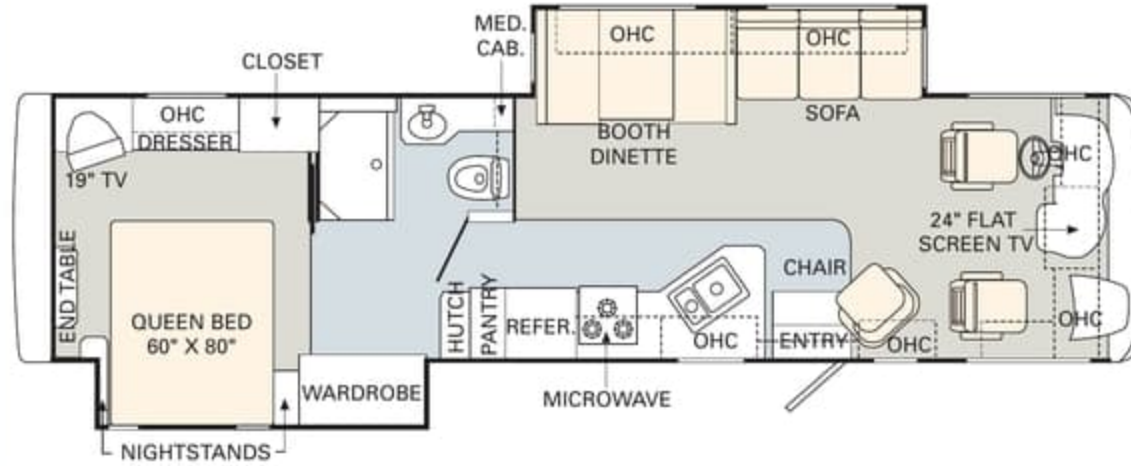

36WDD

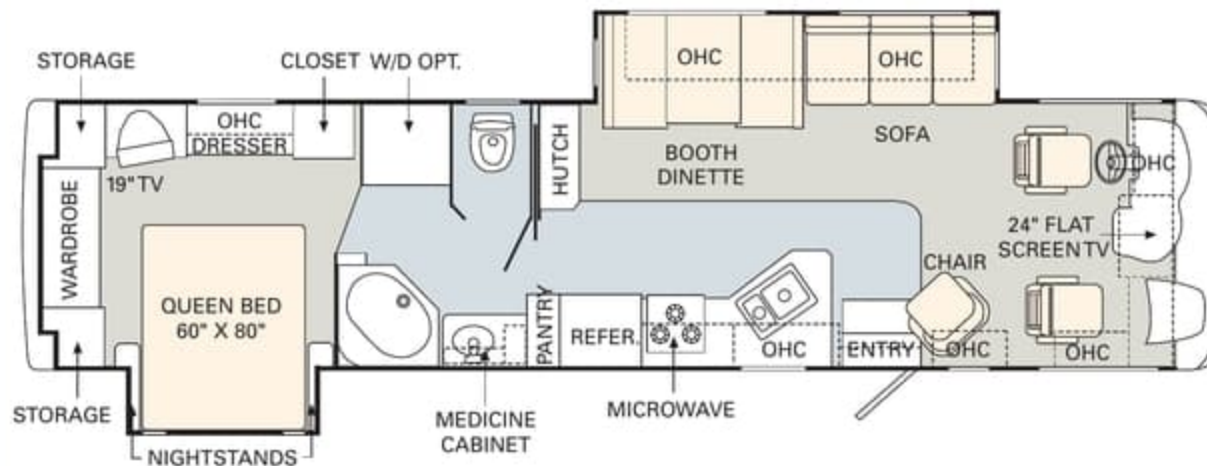

No other manufacturer gives you as many innovative floorplan choices as Monaco. The 2005 Monarch SE offers double and triple slide-out models in lengths that range from 33' to 37'.



LINOLEUM



PLANK FLOORING



CARPET



Find all the latest product news and updates online: monacocoach.com

33PBD

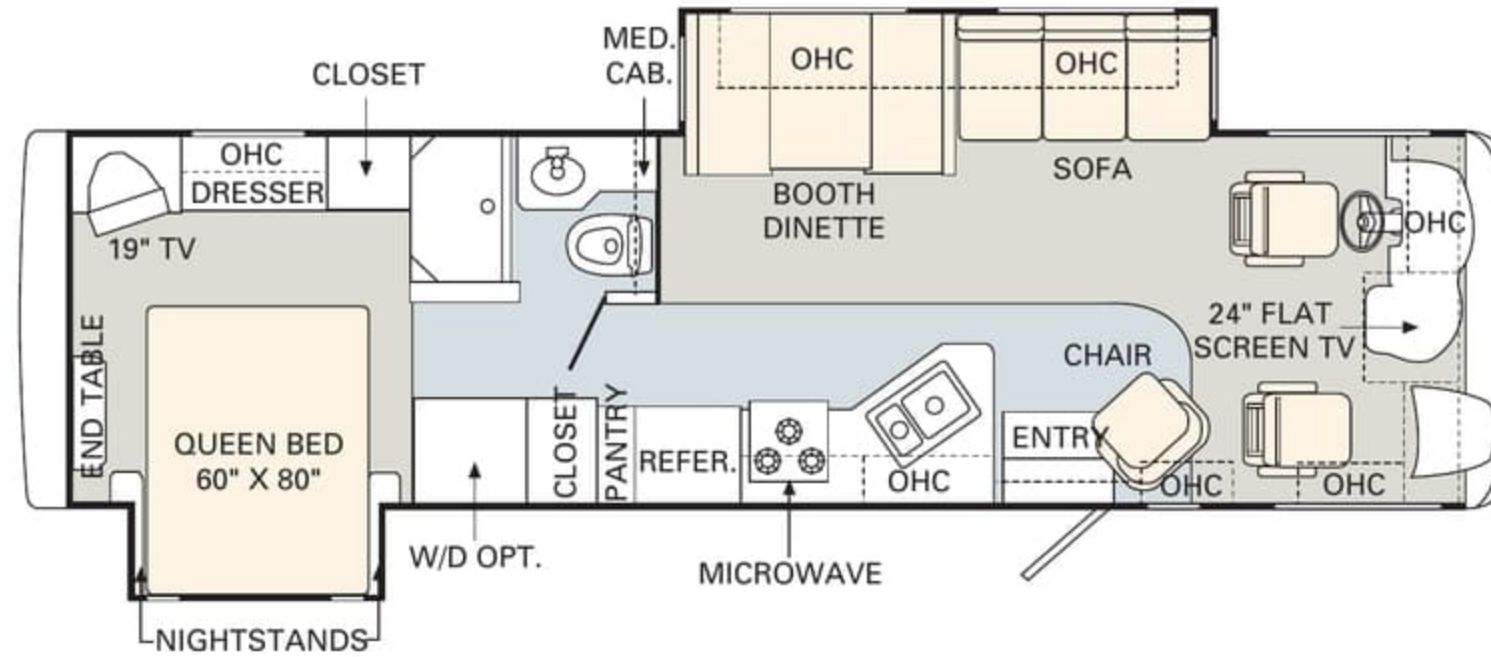

34SBD

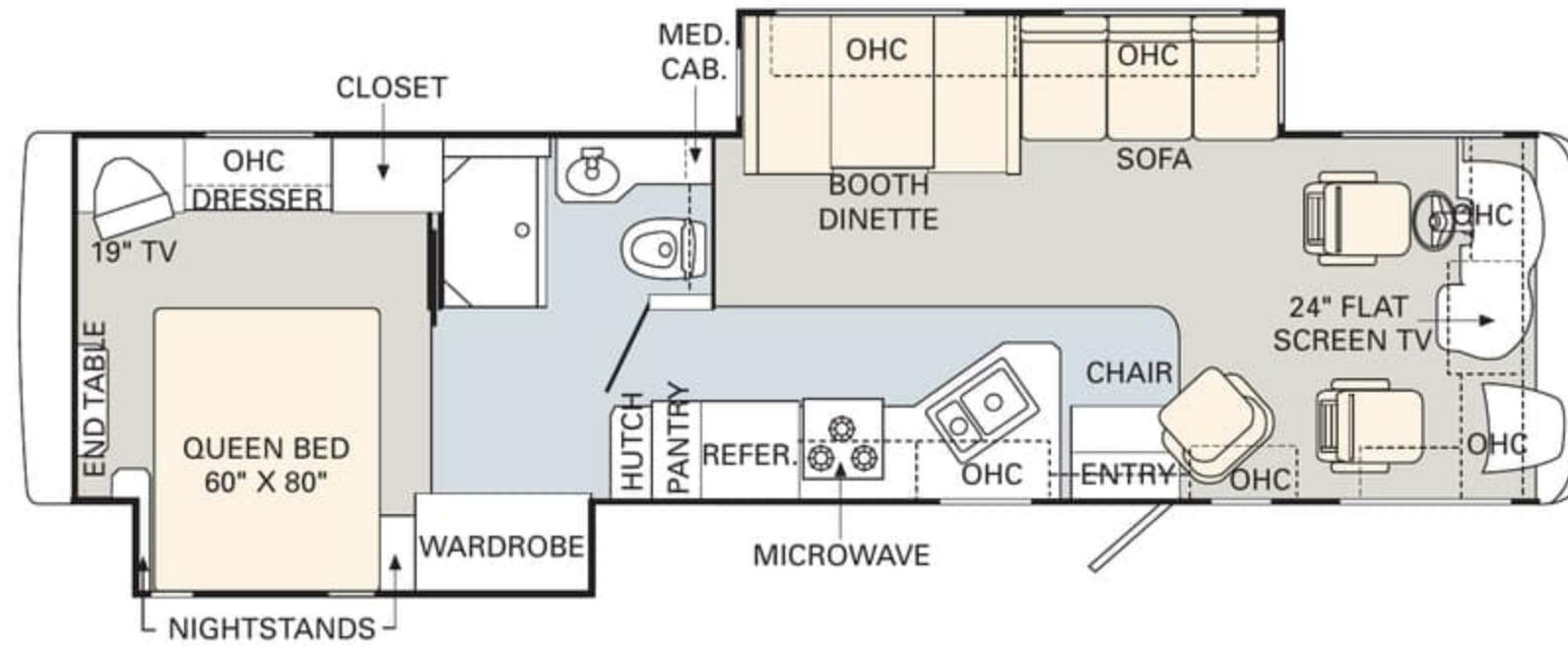

36WDD

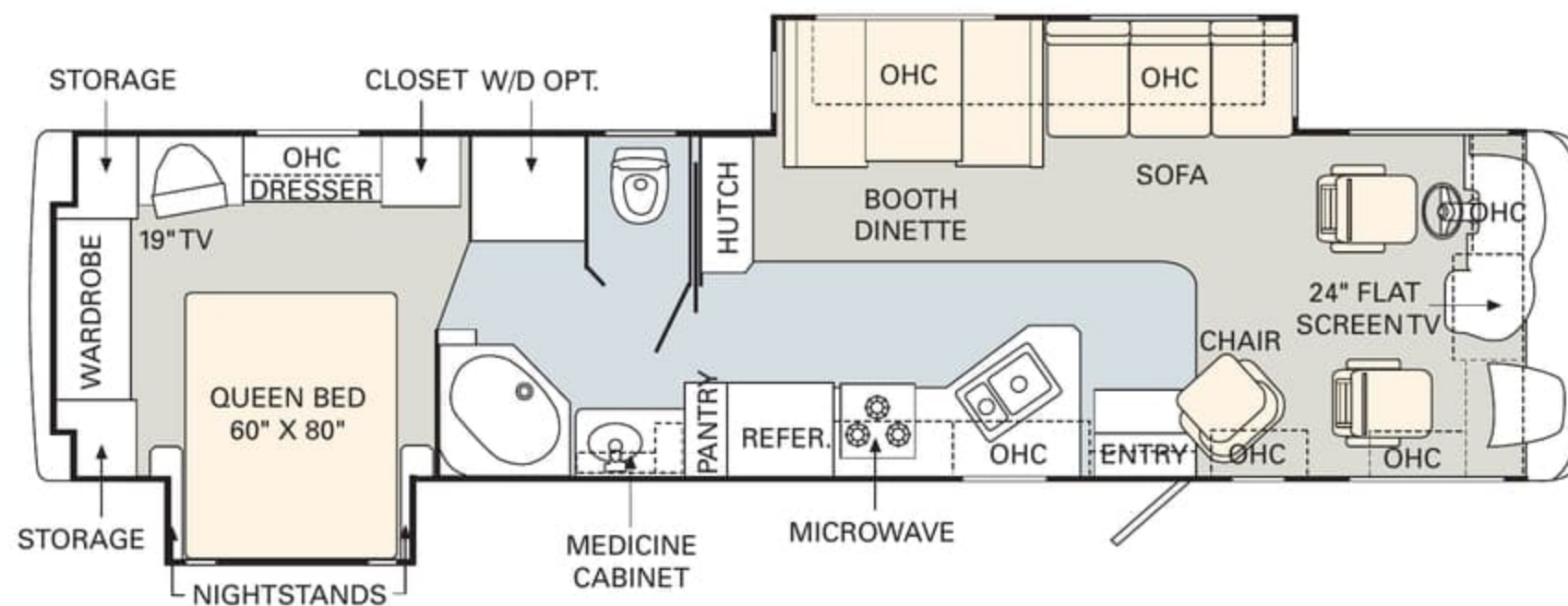

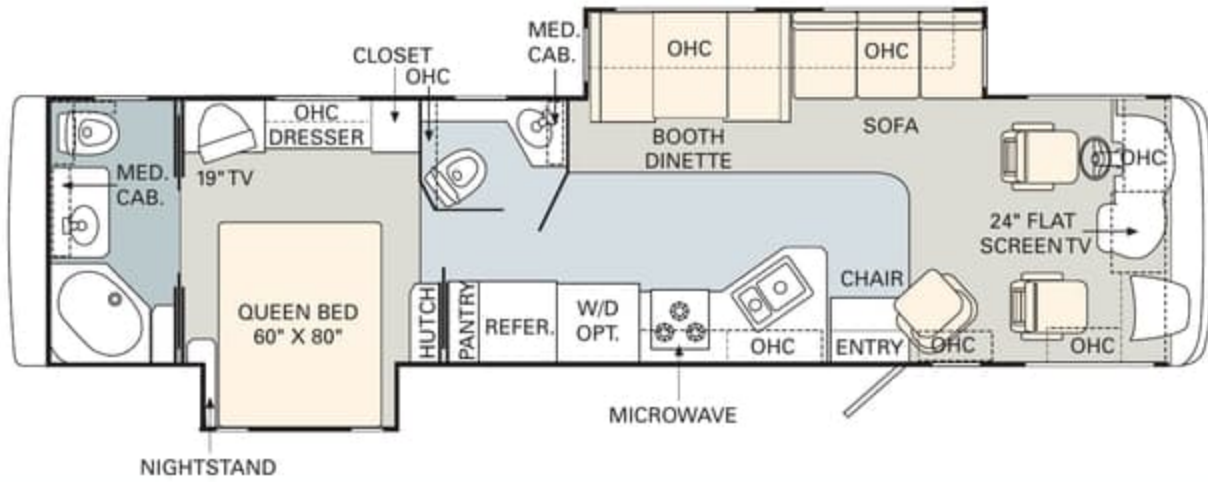

36DBD

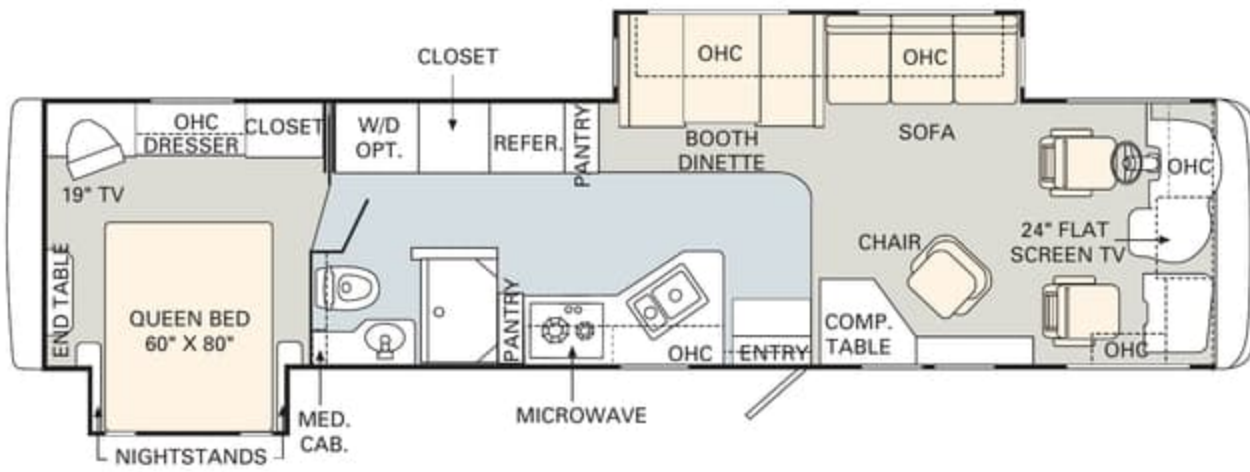

37PBD

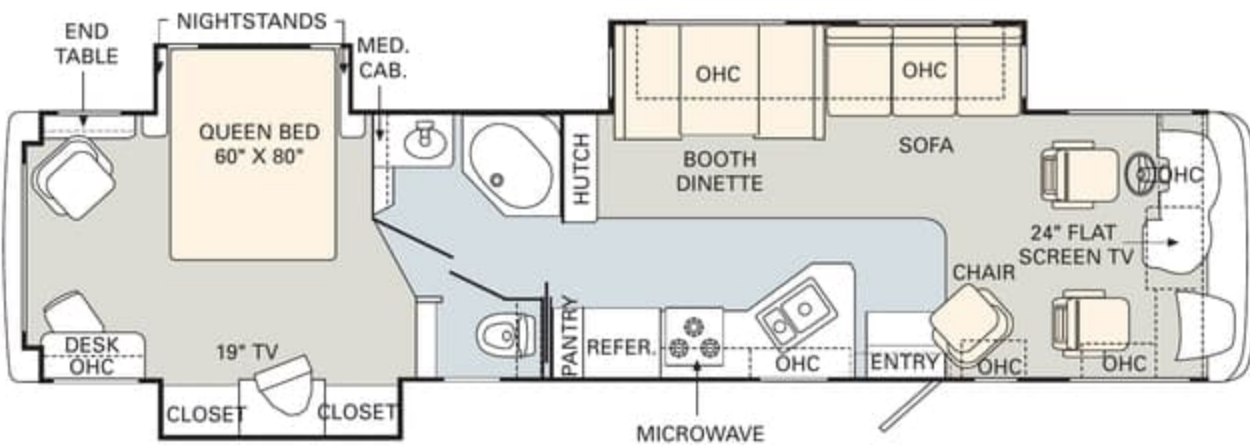

37PCT



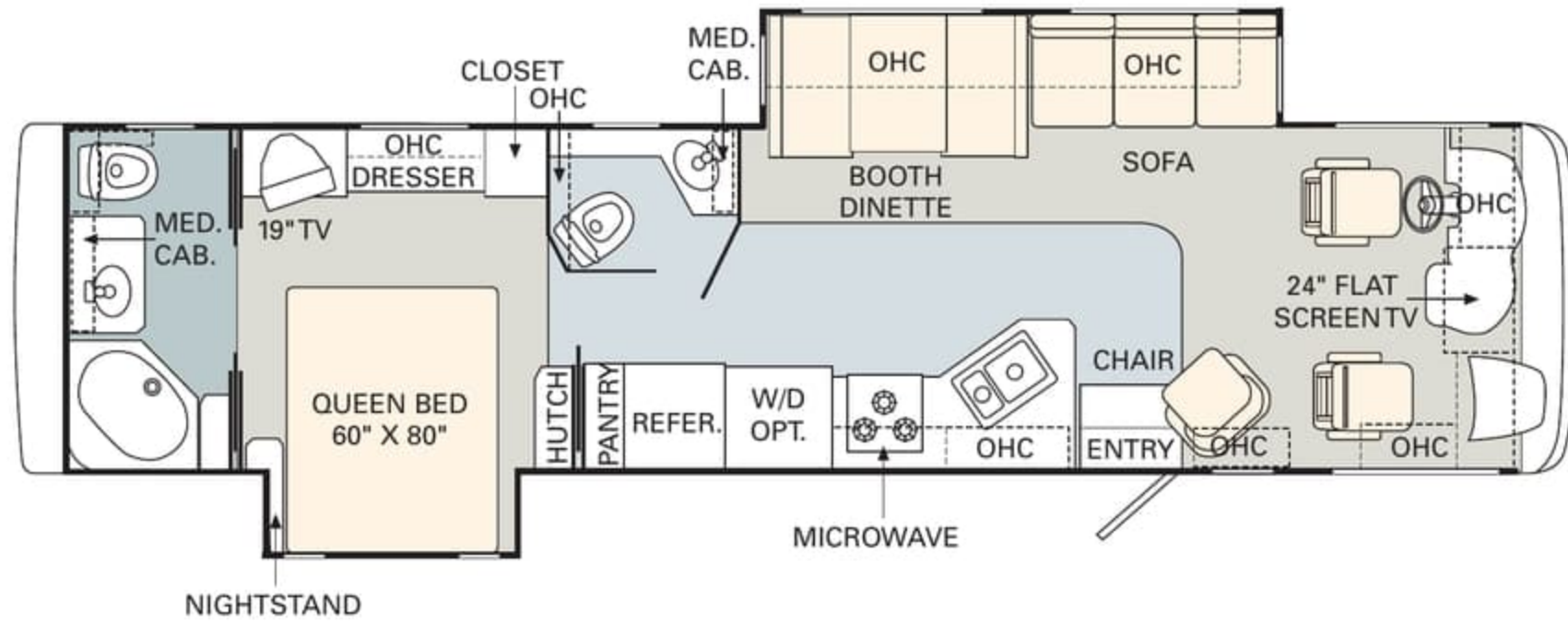

36DBD

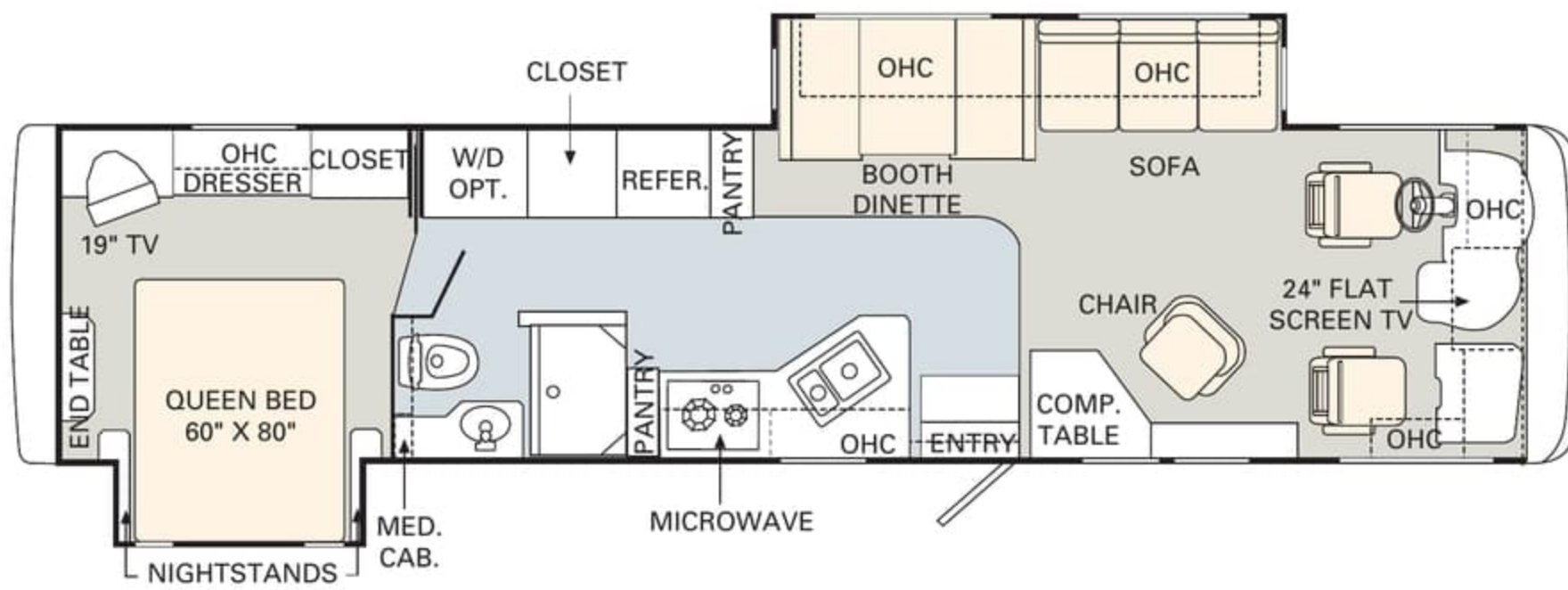

37PBD

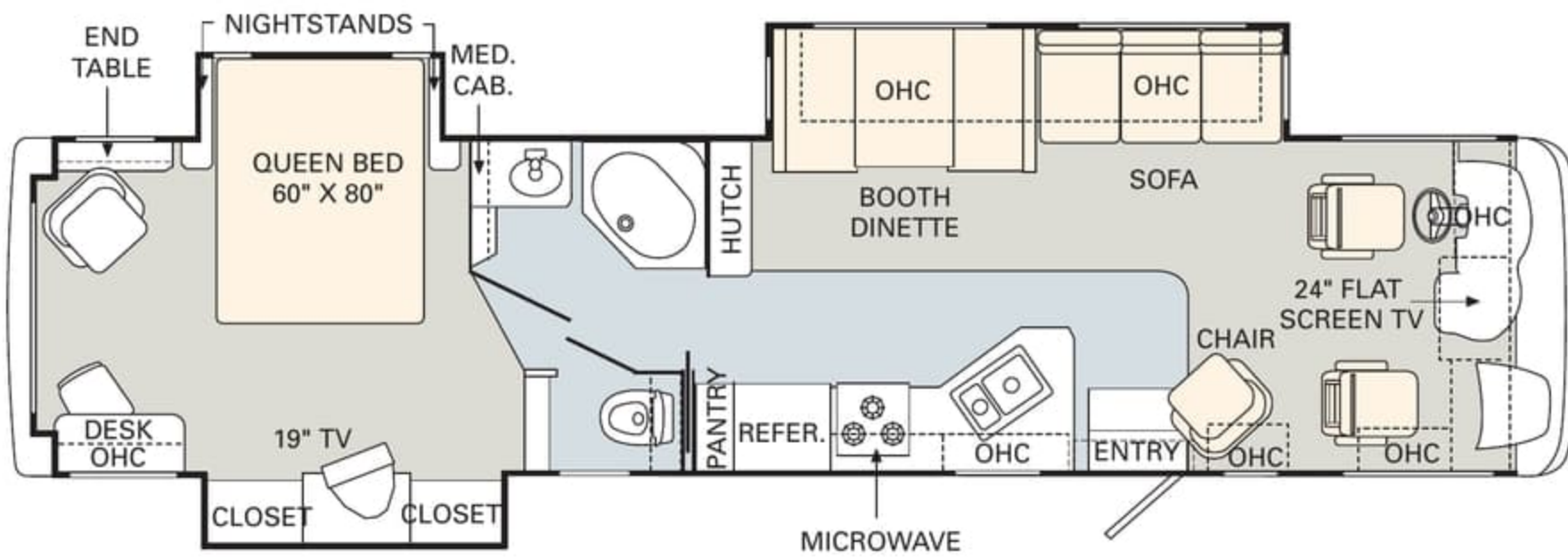

37PCT

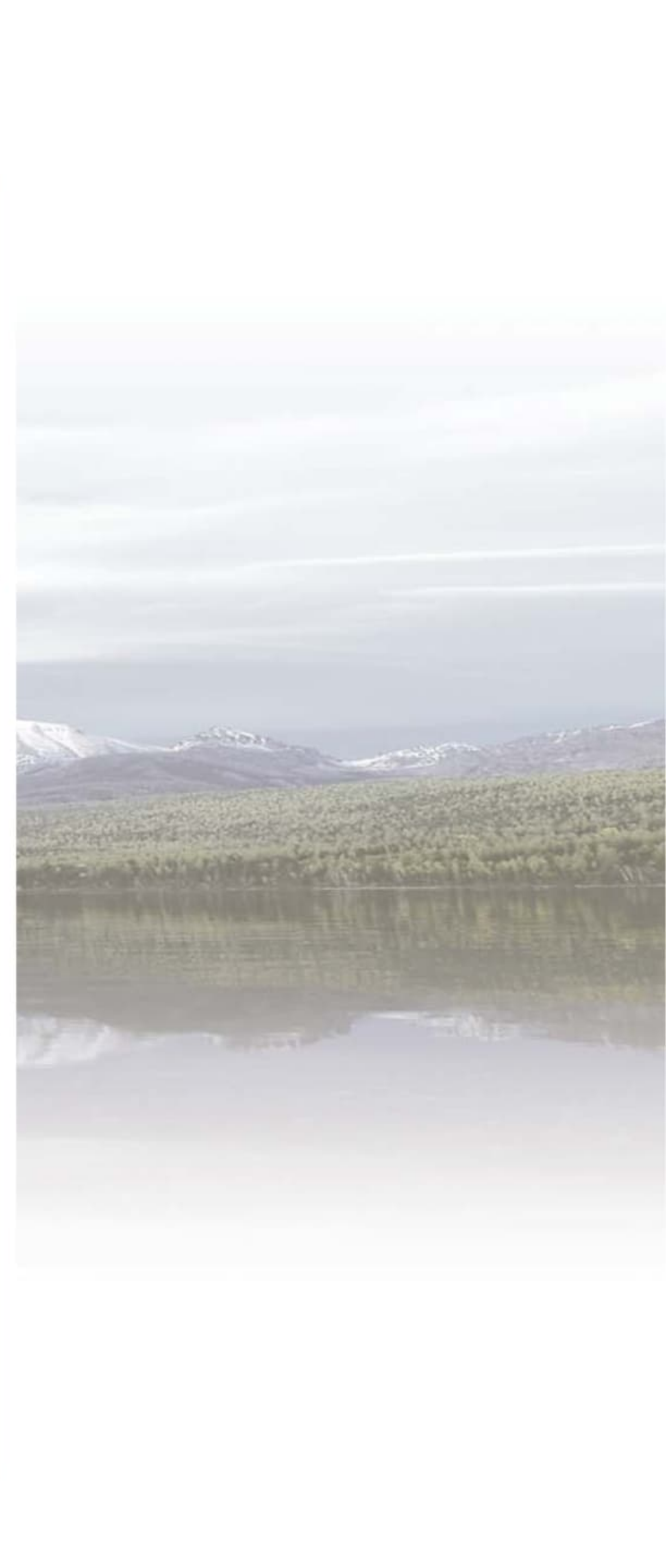

		WEIGHT RATINGS (LBS.)				MEASUREMENTS						TANK CAPACITY (GAL.) ¹				
		Gross vehicle	Gross combined ²	Front gross axle	Rear gross axle	Wheelbase	Overall length	Overall height (with A/C)	Interior height	Interior width	Exterior width	Water heater	Gray tank	Black tank	Fresh tank	LP tank ³
33PBD	(FORD)	22,000	26,000	7,500	14,500	228"	34'3"	11'9"	6'6"	94 1/2"	100 1/2"	10	45	54	60	24
	(WORKHORSE)	22,000	26,000	8,000	14,500	228"	34'3"	12'	6'6"	94 1/2"	100 1/2"	10	45	54	60	24
34SBD	(FORD)	22,000	26,000	7,500	14,500	228"	35'2"	11'9"	6'6"	94 1/2"	100 1/2"	10	40	42	60	24
	(WORKHORSE)	22,000	26,000	8,000	14,500	228"	35'2"	12'	6'6"	94 1/2"	100 1/2"	10	40	42	60	24
36WDD	(FORD)	22,000	26,000	7,500	14,500	242"	36'9"	11'9"	6'6"	94 1/2"	100 1/2"	10	45	54	60	24
	(WORKHORSE)	22,000	26,000	8,000	14,500	242"	36'9"	12'	6'6"	94 1/2"	100 1/2"	10	45	54	60	24
36DBD	(FORD)	22,000	26,000	7,500	14,500	242"	36'9"	11'9"	6'6"	94 1/2"	100 1/2"	10	42/39	42/39	60	24
	(WORKHORSE)	22,000	26,000	8,000	14,500	242"	36'9"	12'	6'6"	94 1/2"	100 1/2"	10	42/39	42/39	60	24
37PBD	(FORD)	22,000	26,000	7,500	14,500	242"	37'4"	11'9"	6'6"	94 1/2"	100 1/2"	10	42	42	60	24
	(WORKHORSE)	22,000	26,000	8,000	14,500	242"	37'4"	12'	6'6"	94 1/2"	100 1/2"	10	42	42	60	24
37PCT	(FORD)	22,000	26,000	7,500	14,500	242"	37'4"	11'9"	6'6"	94 1/2"	100 1/2"	10	45	54	60	24
	(WORKHORSE)	22,000	26,000	8,000	14,500	242"	37'4"	12'	6'6"	94 1/2"	100 1/2"	10	45	54	60	24

1 Towing capacity is limited by GCWR; your vehicle's towing capacity is the difference between the GCWR and the actual vehicle weight, including all water, fuel, passengers and cargo. Your towed vehicle should be equipped with auxiliary brakes if the weight of the towed vehicle exceeds 1,000 lbs. Consult your owner's manual for further towing information.

2 Variances in the fabrication and installation of the tanks may cause the actual "usable capacity" to be greater or less than the capacities designated above.

3 Actual filled LP capacity is 80% of listing due to safety shut-off required on tank.

The actual overall length of the recreational vehicle may differ from that indicated in the brochure due to variances in the manufacturing process and/or installed components. The actual length may be greater or less than that indicated. Due to the large variety of options and floorplan arrangements available to our customers, actual weights for each unit can differ significantly. Monaco Coach provides a weight sticker on each unit we produce which includes that unit's tank capacities and approximate weight. Consult your local Monaco Coach dealer for unit availability and further information. The information printed in this brochure reflects product design, fabrication, and component parts at the date of printing. The manufacturer reserves the right, at any time, to make changes in product design or material or component specifications as its sole option, without notice. This includes the substitution of components of a different brand or trade name which will result in comparable performance. All information printed in this brochure is subject to change after the date of printing. Some features shown or mentioned in this brochure are optional and may only be available in selected floorplans. Photographs may show props or decorations that are not standard equipment on Monaco Coach models. Monaco Coach, the Monaco logo and its design, are registered trademarks. All other products and company names are trademarks and/or registered trademarks of their respective holders. While the color of the motorhome's exterior and the interior fabrics depicted in this sales brochure are fair and reasonable depictions, the colors depicted may not be an exact match of the actual colors because of the variances in photo-processing and variances caused by inserting the photographs within the sales brochure. Due to product improvements, changes during the model year and/or transcription errors that may occur, information represented within this brochure may not be accurate at the time of your purchase. If certain information is significant to your purchasing decision, please confirm the information with your dealer prior to submitting your order.

		WEIGHT RATINGS (LBS.)				MEASUREMENTS						TANK CAPACITY (GAL.) ²				
		Gross vehicle	Gross combined ¹	Front gross axle	Rear gross axle	Wheelbase	Overall length	Overall height (with A/C)	Interior height	Interior width	Exterior width	Water heater	Gray tank	Black tank	Fresh tank	LP tank ³
33PBD	(FORD)	22,000	26,000	7,500	14,500	228"	34' 3"	11' 9"	6' 6"	94 1/2"	100 1/2"	10	45	54	60	24
	(WORKHORSE)	22,000	26,000	8,000	14,500	228"	34' 3"	12'	6' 6"	94 1/2"	100 1/2"	10	45	54	60	24
34SBD	(FORD)	22,000	26,000	7,500	14,500	228"	35' 2"	11' 9"	6' 6"	94 1/2"	100 1/2"	10	40	42	60	24
	(WORKHORSE)	22,000	26,000	8,000	14,500	228"	35' 2"	12'	6' 6"	94 1/2"	100 1/2"	10	40	42	60	24
36WDD	(FORD)	22,000	26,000	7,500	14,500	242"	36' 9"	11' 9"	6' 6"	94 1/2"	100 1/2"	10	45	54	60	24
	(WORKHORSE)	22,000	26,000	8,000	14,500	242"	36' 9"	12'	6' 6"	94 1/2"	100 1/2"	10	45	54	60	24
36DBD	(FORD)	22,000	26,000	7,500	14,500	242"	36' 9"	11' 9"	6' 6"	94 1/2"	100 1/2"	10	42/39	42/39	60	24
	(WORKHORSE)	22,000	26,000	8,000	14,500	242"	36' 9"	12'	6' 6"	94 1/2"	100 1/2"	10	42/39	42/39	60	24
37PBD	(FORD)	22,000	26,000	7,500	14,500	242"	37' 4"	11' 9"	6' 6"	94 1/2"	100 1/2"	10	42	42	60	24
	(WORKHORSE)	22,000	26,000	8,000	14,500	242"	37' 4"	12'	6' 6"	94 1/2"	100 1/2"	10	42	42	60	24
37PCT	(FORD)	22,000	26,000	7,500	14,500	242"	37' 4"	11' 9"	6' 6"	94 1/2"	100 1/2"	10	45	54	60	24
	(WORKHORSE)	22,000	26,000	8,000	14,500	242"	37' 4"	12'	6' 6"	94 1/2"	100 1/2"	10	45	54	60	24

1 Towing capacity is limited by GCWR; your vehicle's towing capacity is the difference between the GCWR and the actual vehicle weight, including all water, fuel, passengers and cargo. Your towed vehicle should be equipped with auxiliary brakes if the weight of the towed vehicle exceeds 1,000 lbs. Consult your owner's manual for further towing information.

2 Variances in the fabrication and installation of the tanks may cause the actual "usable capacity" to be greater or less than the capacities designated above.

3 Actual filled LP capacity is 80% of listing due to safety shut-off required on tank.

The actual overall length of the recreational vehicle may differ from that indicated in the brochure due to variances in the manufacturing process and/or installed components. The actual length may be greater or less than that indicated. Due to the large variety of options and floorplan arrangements available to our customers, actual weights for each unit can differ significantly. Monaco Coach provides a weight sticker on each unit we produce which includes that unit's tank capacities and approximate weight. Consult your local Monaco Coach dealer for unit availability and further information. The information printed in this brochure reflects product design, fabrication, and component parts at the date of printing. The manufacturer reserves the right, at any time, to make changes in product design or material or component specifications as its sole option, without notice. This includes the substitution of components of a different brand or trade name which will result in comparable performance. All information printed in this brochure is subject to change after the date of printing. Some features shown or mentioned in this brochure are optional and may only be available in selected floorplans. Photographs may show props or decorations that are not standard equipment on Monaco Coach models. Monaco Coach, the Monaco logo and its design, are registered trademarks. All other products and company names are trademarks and/or registered trademarks of their respective holders. While the color of the motorhome's exterior and the interior fabrics depicted in this sales brochure are fair and reasonable depictions, the colors depicted may not be an exact match of the actual colors because of the variances in photo-processing and variances caused by inserting the photographs within the sales brochure. Due to product improvements, changes during the model year and/or transcription errors that may occur, information represented within this brochure may not be accurate at the time of your purchase. If certain information is significant to your purchasing decision, please confirm the information with your dealer prior to submitting your order.

BODY CONSTRUCTION

Alumaframe® Superstructure
Steel Cage Cockpit Construction
Peaked Aluminum Roof with Fiberglass Insulation
Smooth Aluminum Exterior Walls
Front and Rear Molded Fiberglass Caps
Aluminum Framed Floor on Steel Trusses
Laminated Structurwood™ Flooring
Interior Paneling with 3/4" Insulation
Foam Insulated Floor Framing with 3-Ply Underbelly
One-Piece Engine Cover
Power Heated Remote Exterior Mirrors with Bottom Convex
Headlamps with Turn Signals
Pass-Through Storage Bays under Slide-Outs with New Roto Cast Boxes (32% Increased Storage from 2004)
Side-Hinged Baggage Doors, All Opening Doors between Front and Rear Tires (Where Applicable)
One-Piece Polyethylene Storage Compartment
Wheel Mud Flaps
Integrated Metal Fuel Door with Lock
Painted Mask and Skirt with Vinyl Exterior Graphics
Rear Ladder
Interior Rubber Entry Step
Exterior Triple Entry Steps (N/A: 30PDD)
Undercoating

OPTIONS

Smooth Gel Coat Fiberglass Exterior Walls
Full-Length Mud Flap

CHASSIS/ENGINE/SUSPENSION

FORD

6.8L V-10 Gasoline Engine with Electronic Fuel Injection
Engine Displacement: 6.8 Liters 415 Cu. In.
Power: 310 HP; Torque: 425 lbs./ft.
4-Speed Automatic Transmission with Overdrive
Fuel Tank Capacity 75 Gallon
130 Amp Alternator
Rear Axle Ratio 5.38:1
Radial Tires 235/80R 22.5G
Polished Aluminum Wheels
Leaf Spring Suspension
ABS Brake System
Hitch Receiver with Dual Connector 4-Pin or 7-Pin 4,000 Lb.
SmartStructure II

WORKHORSE

8.1L V-8 Gasoline Engine with Electronic Fuel Injection
Engine Displacement: 8.1 Liters 496 Cu. In.
Power: 340 HP; Torque: 455 lbs./ft.
5-Speed Automatic Transmission with Overdrive
Fuel Tank Capacity 75 Gallon
145 Amp Alternator
Rear Axle Ratio 5.38:1
Radial Tires 235/80R 22.5G
Stainless Steel Wheel Liners
Leaf Spring Suspension
ABS Brake System
Hitch Receiver with Dual Connector 4-Pin or 7-Pin 4,000 Lb.
SmartStructure II

OPTIONS

Fully Automatic Hydraulic Leveling System

COCKPIT

Fiberglass Automotive Dash with Beige Grid Instrument Panel and Two-Tone Dash Vinyl
CD Player/Radio with Four Speakers
Multi-Positioned Sunvisors
Pleated Front Privacy Drape with Braided Tie Backs
Rear Vision System Prep
Intermittent Windshield Wipers
Tilt Steering Wheel
Cruise Control
Power Steering
Electric Automotive Horn
Redesigned Wood Center Console on Engine Cover, Recess Tray with Rubber Mat and Plastic Two-Tier Cup Holders. Front Tip-Door Ford/Front Drawer Workhorse Chassis
Two-Tier Side Cup Holder for Pilot Seat (N/A with Door Option)
Two-Tier Side Cup Holder for Co-Pilot Seat with Magazine Rack Below
Fabric Pilot and Co-Pilot Recliner Seats
Carpeted Driver and Passenger Floor Mats
Dash Workstation
Wood Framed Cabinet Doors with Smoked Glass over Front Entertainment Center Systems
Secure Front Cab over TVs with Steel Framing

OPTIONS

Six-Way Power Pilot Seat
Six-Way Power Co-Pilot Seat
Soft Touch Vinyl Pilot and Co-Pilot Seats
Rear Vision System with Audio and Adjustable Camera
3-Camera Rear Vision System with Audio and Adjustable Center Camera
Pilot and Co-Pilot Pull-Down Sunshades
CB Radio Prep
Driver's Side Door with Power Window
Cassette Radio Option Includes AM/FM Tuner, CD Player, Weather Band

BODY CONSTRUCTION

Alumaframe® Superstructure
Steel Cage Cockpit Construction
Peaked Aluminum Roof with Fiberglass Insulation
Smooth Aluminum Exterior Walls
Front and Rear Molded Fiberglass Caps
Aluminum Framed Floor on Steel Trusses
Laminated Structurwood™ Flooring
Interior Paneling with 3/4" Insulation
Foam Insulated Floor Framing with 3-Ply Underbelly
One-Piece Engine Cover
Power Heated Remote Exterior Mirrors with Bottom Convex
Headlamps with Turn Signals
Pass-Through Storage Bays under Slide-Outs with New Roto Cast Boxes (32% Increased Storage from 2004)
Side-Hinged Baggage Doors, All Opening Doors between Front and Rear Tires (Where Applicable)
One-Piece Polyethylene Storage Compartment
Wheel Mud Flaps
Integrated Metal Fuel Door with Lock
Painted Mask and Skirt with Vinyl Exterior Graphics
Rear Ladder
Interior Rubber Entry Step
Exterior Triple Entry Steps (N/A: 30PDD)
Undercoating

OPTIONS

Smooth Gel Coat Fiberglass Exterior Walls
Full-Length Mud Flap

CHASSIS/ENGINE/SUSPENSION

FORD

6.8L V-10 Gasoline Engine with Electronic Fuel Injection
Engine Displacement: 6.8 Liters 415 Cu. In.
Power: 310 HP; Torque: 425 lbs./ft.
4-Speed Automatic Transmission with Overdrive
Fuel Tank Capacity 75 Gallon
130 Amp Alternator
Rear Axle Ratio 5.38:1
Radial Tires 235/80R 22.5G
Polished Aluminum Wheels
Leaf Spring Suspension
ABS Brake System
Hitch Receiver with Dual Connector 4-Pin or 7-Pin 4,000 Lb.
SmartStructure II

WORKHORSE

8.1L V-8 Gasoline Engine with Electronic Fuel Injection
Engine Displacement: 8.1 Liters 496 Cu. In.
Power: 340 HP; Torque: 455 lbs./ft.
5-Speed Automatic Transmission with Overdrive
Fuel Tank Capacity 75 Gallon
145 Amp Alternator
Rear Axle Ratio 5.38:1
Radial Tires 235/80R 22.5G
Stainless Steel Wheel Liners
Leaf Spring Suspension
ABS Brake System
Hitch Receiver with Dual Connector 4-Pin or 7-Pin 4,000 Lb.
SmartStructure II

OPTIONS

Fully Automatic Hydraulic Leveling System

COCKPIT

Fiberglass Automotive Dash with Beige Grid Instrument Panel and Two-Tone Dash Vinyl
CD Player/Radio with Four Speakers
Multi-Positioned Sunvisors
Pleated Front Privacy Drape with Braided Tie Backs
Rear Vision System Prep
Intermittent Windshield Wipers
Tilt Steering Wheel
Cruise Control
Power Steering
Electric Automotive Horn
Redesigned Wood Center Console on Engine Cover, Recess Tray with Rubber Mat and Plastic Two-Tier Cup Holders. Front Tip-Door Ford/Front Drawer Workhorse Chassis
Two-Tier Side Cup Holder for Pilot Seat (N/A with Door Option)
Two-Tier Side Cup Holder for Co-Pilot Seat with Magazine Rack Below
Fabric Pilot and Co-Pilot Recliner Seats
Carpeted Driver and Passenger Floor Mats
Dash Workstation
Wood Framed Cabinet Doors with Smoked Glass over Front Entertainment Center Systems
Secure Front Cab over TVs with Steel Framing

OPTIONS

Six-Way Power Pilot Seat
Six-Way Power Co-Pilot Seat
Soft Touch Vinyl Pilot and Co-Pilot Seats
Rear Vision System with Audio and Adjustable Camera
3-Camera Rear Vision System with Audio and Adjustable Center Camera
Pilot and Co-Pilot Pull-Down Sunshades
CB Radio Prep
Driver's Side Door with Power Window
Cassette Radio Option Includes AM/FM Tuner, CD Player, Weather Band

APPLIANCES & ACCESSORIES

Large Double-Door Refrigerator
High-Output 3-Burner Cooktop without Oven
Bi-Fold Range Cover
Spacesaver Microwave with Touch Control
24" Flatscreen Stereo Color TV with Remote Control in Living Area
TV Antenna
VCR Prep and Video Control Box with Booster
Exterior Hook-Ups for DSS Dish and Cable
Interior Cable TV Hook-Up and Telephone Jacks
Digital Satellite System Prep
Exterior Gas Line Hook-Up Prep for LP Accessories

OPTIONS

Large Double-Door Refrigerator with Ice Maker
Large Double-Door Refrigerator with Ice Maker 10 Cu. Ft.
Large Four-Door Refrigerator with Ice Maker (N/A Pantry)
High-Output Three-Burner Range with Oven
Spacesaver Convection Microwave with Touch Control
Washer/Dryer Prep, Requires 50 Amp Service Option (N/A: 34SBD, 37PCT)
Combination Washer/Dryer, Requires Washer/Dryer Prep Option (N/A: 34SBD, 37PCT)
Living Area Stereo TV Wired through Ceiling Speakers
19" Color TV with Remote Control in Bedroom
VCR
DVD Player
Exterior Entertainment Center, CD Player Radio with Two Speakers

INTERIOR

Vintage Oak Cabinetry
Raised Panel Cabinet Doors on Overhead Cabinets, Flat Panel Doors on Base Cabinets and Wardrobes
Cabinet End Panels
Black ABS Refrigerator Insert
Decorative Wallboard
Wallpaper Border Kitchen and Bath
Self-Supporting Top-Hinged Overhead Storage Doors and Positive Catches on all Other Doors
Heavy-Duty Ball Bearing Drawer Guides
Wood Cabinet Drawer Boxes
Wood Interior Grab Handle on Cabinet at Entry Door
Satin Nickel Finished Entry Rail for Stepwell (N/A with Computer Desk Option)
Satin Nickel Cabinetry Hardware and Bath Accessories
Integrated Cup Holder to Slide-Out next to Sofa
Laminate Kitchen Countertop with Stainless Steel Sink, Brushed Nickel Faucet and Two Sink Covers
Toe Kicks Kitchen and Bath Base Cabinets
Laminate Bathroom Countertop with Laminate Perm-Edge
All Other Countertops are Laminate with Perm-Edge
Kitchen Overhead Cabinets with Adjustable Shelf
Kitchen Pantry next to Refrigerator with Adjustable Shelves in Upper Cabinet and Three Drawers Below (N/A with Four-Door Refrigerator Option)
Silverware Drawer with Organizer in Kitchen Base Cabinets (N/A with Range Option)
Trash Can in Kitchen Base Cabinet
Linoleum Flooring in Kitchen Flooring to Include Entry Door
Linoleum Flooring in Center Bathroom
Wilsonart® Plank Flooring in Rear Bath (36DBD)

OPTIONS

New Decors: Park Lane, Ivory Quartz, Winter Birch, Lake View, Chateau Stone
Wood Choice: Autumn Cherry and Maple
Laminate Plank Flooring in Kitchen, Bath and Entry. Laminated Plank Flooring or Armstrong Laminated Tile is a Required Option Selection.

Upgraded Nylon Carpeting with Pad in Living Area and Bedroom
Soft Touch Padded Vinyl Ceiling
New Wood Slide-Out Fascia with Fabric Inserts
Arched Beveled Living Area or Bedroom Mirror, with Border under Mirrors, Living Area Location (N/A: 36WDD)
Picture Living or Bedroom Area, 34SBD End of Shower Wall (N/A: 36DBD, 37PCT)
Bath Door with Accent Trim on Hallway Side
Wood Trim for Bath Door Opening Hallway Side
Wood Louvers on Washer and Dryer Doors (N/A: 34SBD, 37PCT)
Magazine Rack Bathroom (N/A: 33PBD, 34SBD, 37PBD)
Accent Crown Molding in Bedroom and Living Area on all Open Walls
Medicine Cabinet with Adjustable Shelves
Bathroom Lavatory Base Mirror with Wood Frame
Towel Rack on Back of Bath Door
Satin Nickel; Two Towel Rings in Bathroom
Accent Mirror with Wood Trim on Rear Wall with Wall Border under Mirror (N/A: 36WDD, 36DBD, 37PCT)
Rear Wardrobe Closet with Deluxe Mirror Door Frames Satin Nickel Finish (36WDD)
Bedroom Swing-Away TV Cabinets
Bedspread with Two Decorative Pillows
Fabric Headboard
Blackout Day/Night Pleated Shades in Living Area and in Bedroom
Mini Blinds in Kitchen and Bathroom (Where Applicable)
Soil Repellant on Fabric, Teflon® Fabric Protection
Satin Nickel Clock above Entry Door

Armstrong Laminated Tile Flooring Kitchen, Bath and Entry. Armstrong Laminated Tile or Laminated Plank Flooring is a Required Option Selection.
Hardwood Raised Panel Doors on Refrigerator

APPLIANCES & ACCESSORIES

Large Double-Door Refrigerator
High-Output 3-Burner Cooktop without Oven
Bi-Fold Range Cover
Spacesaver Microwave with Touch Control
24" Flatscreen Stereo Color TV with Remote Control in Living Area
TV Antenna
VCR Prep and Video Control Box with Booster
Exterior Hook-Ups for DSS Dish and Cable
Interior Cable TV Hook-Up and Telephone Jacks
Digital Satellite System Prep
Exterior Gas Line Hook-Up Prep for LP Accessories

OPTIONS

Large Double-Door Refrigerator with Ice Maker
Large Double-Door Refrigerator with Ice Maker 10 Cu. Ft.
Large Four-Door Refrigerator with Ice Maker (N/A Pantry)
High-Output Three-Burner Range with Oven
Spacesaver Convection Microwave with Touch Control
Washer/Dryer Prep, Requires 50 Amp Service Option (N/A: 34SBD, 37PCT)
Combination Washer/Dryer, Requires Washer/Dryer Prep Option (N/A: 34SBD, 37PCT)
Living Area Stereo TV Wired through Ceiling Speakers
19" Color TV with Remote Control in Bedroom
VCR
DVD Player
Exterior Entertainment Center, CD Player Radio with Two Speakers

INTERIOR

Vintage Oak Cabinetry
Raised Panel Cabinet Doors on Overhead Cabinets, Flat Panel Doors on Base Cabinets and Wardrobes
Cabinet End Panels
Black ABS Refrigerator Insert
Decorative Wallboard
Wallpaper Border Kitchen and Bath
Self-Supporting Top-Hinged Overhead Storage Doors and Positive Catches on all Other Doors
Heavy-Duty Ball Bearing Drawer Guides
Wood Cabinet Drawer Boxes
Wood Interior Grab Handle on Cabinet at Entry Door
Satin Nickel Finished Entry Rail for Stepwell (N/A with Computer Desk Option)
Satin Nickel Cabinetry Hardware and Bath Accessories
Integrated Cup Holder to Slide-Out next to Sofa
Laminate Kitchen Countertop with Stainless Steel Sink, Brushed Nickel Faucet and Two Sink Covers
Toe Kicks Kitchen and Bath Base Cabinets
Laminate Bathroom Countertop with Laminate Perm-Edge
All Other Countertops are Laminate with Perm-Edge
Kitchen Overhead Cabinets with Adjustable Shelf
Kitchen Pantry next to Refrigerator with Adjustable Shelves in Upper Cabinet and Three Drawers Below (N/A with Four-Door Refrigerator Option)
Silverware Drawer with Organizer in Kitchen Base Cabinets (N/A with Range Option)
Trash Can in Kitchen Base Cabinet
Linoleum Flooring in Kitchen Flooring to Include Entry Door
Linoleum Flooring in Center Bathroom
Wilsonart® Plank Flooring in Rear Bath (36DBD)

OPTIONS

New Decors: Park Lane, Ivory Quartz, Winter Birch, Lake View, Chateau Stone
Wood Choice: Autumn Cherry and Maple
Laminate Plank Flooring in Kitchen, Bath and Entry.
Laminated Plank Flooring or Armstrong Laminated Tile is a Required Option Selection.

Upgraded Nylon Carpeting with Pad in Living Area and Bedroom
Soft Touch Padded Vinyl Ceiling
New Wood Slide-Out Fascia with Fabric Inserts
Arched Beveled Living Area or Bedroom Mirror, with Border under Mirrors, Living Area Location (N/A: 36WDD)
Picture Living or Bedroom Area, 34SBD End of Shower Wall (N/A: 36DBD, 37PCT)
Bath Door with Accent Trim on Hallway Side
Wood Trim for Bath Door Opening Hallway Side
Wood Louvers on Washer and Dryer Doors (N/A: 34SBD, 37PCT)
Magazine Rack Bathroom (N/A: 33PBD, 34SBD, 37PBD)
Accent Crown Molding in Bedroom and Living Area on all Open Walls
Medicine Cabinet with Adjustable Shelves
Bathroom Lavatory Base Mirror with Wood Frame
Towel Rack on Back of Bath Door
Satin Nickel; Two Towel Rings in Bathroom
Accent Mirror with Wood Trim on Rear Wall with Wall Border under Mirror (N/A: 36WDD, 36DBD, 37PCT)
Rear Wardrobe Closet with Deluxe Mirror Door Frames Satin Nickel Finish (36WDD)
Bedroom Swing-Away TV Cabinets
Bedsread with Two Decorative Pillows
Fabric Headboard
Blackout Day/Night Pleated Shades in Living Area and in Bedroom
Mini Blinds in Kitchen and Bathroom (Where Applicable)
Soil Repellant on Fabric, Teflon® Fabric Protection
Satin Nickel Clock above Entry Door

Armstrong Laminated Tile Flooring Kitchen, Bath and Entry. Armstrong Laminated Tile or Laminated Plank Flooring is a Required Option Selection.
Hardwood Raised Panel Doors on Refrigerator

FURNITURE

Queen Bed with Nightstands
Arched Back Wood Booth Dinette
with Side-Sliding Table Top and Drawers
Fabric Jackknife Sofa, Two Pillows on all Sofas
Fabric Swivel Glider Barrel Chair
Fabric Swivel Glider Barrel Chair and Desk Chair
Bedroom (37PCT)

OPTIONS

Fabric Hide-A-Bed Sofa with Two Pillows
Fabric Hide-A-Bed Sofa with Air Mattress
and Two Pillows
Soft Touch Vinyl Hide-A-Bed Sofa with Two Pillows
Soft Touch Vinyl Hide-A-Bed Sofa with Air Mattress
and Two Pillows
Curbside Soft Touch Vinyl J-Lounge IPO Swivel Glider
Barrel Chair and Computer Desk (37PBD)
Fabric Electric Sofa IPO Jackknife Sofa
Fabric Swivel Recliner Chair IPO Fabric Swivel Glider
Barrel Chair
Soft Touch Vinyl Swivel Recliner Chair IPO Fabric
Swivel Glider Barrel Chair
Fabric Swivel Glider Barrel Chair IPO Desk Chair
Bedroom (37PCT)
Curbside Two Fabric Recliners IPO Swivel Glider Barrel
Chair and Computer Desk (37PBD)
Curbside Two Soft Touch Vinyl Recliners IPO
Swivel Glider Barrel Chair and Computer Desk (37PBD)
Bedroom Desk (N/A: 37PCT)
Adjustable Coffee Table
Freestanding Dinette with Two Freestanding Chairs
and Two Folding Chairs

ELECTRICAL SYSTEMS & LIGHTS

30 Amp 120V Distribution Panel and Power Cord
55 Amp Electronic 12V Power Converter
Onan® 5.5 kW Gas Generator
Two 6V House Batteries
Battery Disconnect Switches
12V and 110V Outlet in Cockpit Area
Porch Light and Exterior Step Light on Same Switch
Exterior Power Entry Step with Light
Interior Stepwell Entry Step Lights
Water Pump Switch in Service Bay Area
and Interior Systems Panel
Lights in Outside Storage Compartments
120V Receptacles in Outside Storage Compartment
Underhood Utility Light
Receptacle and Phone Jack in Dinette Area
Directional Map Lights for Pilot and Co-Pilot Seats
Systems Control Center in Hallway
Fluorescent Light(s) with Night Light Function,
under Kitchen Overhead
Fluorescent Ceiling Lights Throughout
Fluorescent Ceiling Lights inside Living Area Slide-Out House
Decorative Wood Framed Galley Ceiling
Fluorescent Light
Decorative Satin Nickel Lighting Living Room Wall Light,
Dinette Overhead, Bedroom Cosmetic Vanity Light
Satin Nickel Decorative Bathroom Cabinet Light
with Cover
Halogen Lights under Living Room and Dining Room
Overhead Cabinets (Satin Nickel)
Bullet Lights over Bed Satin Nickel Brass Finish
with His and Hers Switches
Decorative Side Lights inside Bedroom Slide-Out,
on End Walls

OPTIONS

Energy Management System with or without
50 Amp Service
50 Amp 120V Distribution Panel and Cord
140 Watt Inverter
Storage Compartment Tank Monitor Gauge

PLUMBING & LP SYSTEMS

Kitchen Stainless Steel Sink with Single Lever Brushed
Nickel Faucet
Separate Brushed Chrome Faucet for Filtered Water
Bath Lavatory Faucet Single Handle Satin Nickel Finish
Demand Water System and Water Pump
10 Gallon LP Gas/Electric Water Heater
with Electronic Ignition, DSI
Winterization Valving System
Water Heater Bypass Valve
Toilet with Sprayer
No-Fuss Flush Holding Tank Rinsing System
Insulated Systems Compartment with Easy Access
to Hook-Up
Shower inside Wet Bay with Hot/Cold Water
Soap Dispenser inside Utility Bay
Gravity and Pressurized Water Fill
Contained Storage Area for Sewer Hose
One-Piece Fiberglass Shower
Shower Diverter, Shower Hose and Head
Shower Light on Ceiling inside Shower
Satin Nickel Shower Door Frame with Obscure Glass

OPTIONS

RV Sani-Con 2 System, Holding Tank Flush System
Bathtub IPO Shower

FURNITURE

Queen Bed with Nightstands
Arched Back Wood Booth Dinette
with Side-Sliding Table Top and Drawers
Fabric Jackknife Sofa, Two Pillows on all Sofas
Fabric Swivel Glider Barrel Chair
Fabric Swivel Glider Barrel Chair and Desk Chair
Bedroom (37PCT)

OPTIONS

Fabric Hide-A-Bed Sofa with Two Pillows
Fabric Hide-A-Bed Sofa with Air Mattress
and Two Pillows
Soft Touch Vinyl Hide-A-Bed Sofa with Two Pillows
Soft Touch Vinyl Hide-A-Bed Sofa with Air Mattress
and Two Pillows
Curbside Soft Touch Vinyl J-Lounge IPO Swivel Glider
Barrel Chair and Computer Desk (37PBD)
Fabric Electric Sofa IPO Jackknife Sofa
Fabric Swivel Recliner Chair IPO Fabric Swivel Glider
Barrel Chair
Soft Touch Vinyl Swivel Recliner Chair IPO Fabric
Swivel Glider Barrel Chair
Fabric Swivel Glider Barrel Chair IPO Desk Chair
Bedroom (37PCT)
Curbside Two Fabric Recliners IPO Swivel Glider Barrel
Chair and Computer Desk (37PBD)
Curbside Two Soft Touch Vinyl Recliners IPO
Swivel Glider Barrel Chair and Computer Desk (37PBD)
Bedroom Desk (N/A: 37PCT)
Adjustable Coffee Table
Freestanding Dinette with Two Freestanding Chairs
and Two Folding Chairs

ELECTRICAL SYSTEMS & LIGHTS

30 Amp 120V Distribution Panel and Power Cord
55 Amp Electronic 12V Power Converter
Onan® 5.5 kW Gas Generator
Two 6V House Batteries
Battery Disconnect Switches
12V and 110V Outlet in Cockpit Area
Porch Light and Exterior Step Light on Same Switch
Exterior Power Entry Step with Light
Interior Stepwell Entry Step Lights
Water Pump Switch in Service Bay Area
and Interior Systems Panel
Lights in Outside Storage Compartments
120V Receptacles in Outside Storage Compartment
Underhood Utility Light
Receptacle and Phone Jack in Dinette Area
Directional Map Lights for Pilot and Co-Pilot Seats
Systems Control Center in Hallway
Fluorescent Light(s) with Night Light Function,
under Kitchen Overhead
Fluorescent Ceiling Lights Throughout
Fluorescent Ceiling Lights inside Living Area Slide-Out House
Decorative Wood Framed Galley Ceiling
Fluorescent Light
Decorative Satin Nickel Lighting Living Room Wall Light,
Dinette Overhead, Bedroom Cosmetic Vanity Light
Satin Nickel Decorative Bathroom Cabinet Light
with Cover
Halogen Lights under Living Room and Dining Room
Overhead Cabinets (Satin Nickel)
Bullet Lights over Bed Satin Nickel Brass Finish
with His and Hers Switches
Decorative Side Lights inside Bedroom Slide-Out,
on End Walls

OPTIONS

Energy Management System with or without
50 Amp Service
50 Amp 120V Distribution Panel and Cord
140 Watt Inverter
Storage Compartment Tank Monitor Gauge

PLUMBING & LP SYSTEMS

Kitchen Stainless Steel Sink with Single Lever Brushed
Nickel Faucet
Separate Brushed Chrome Faucet for Filtered Water
Bath Lavatory Faucet Single Handle Satin Nickel Finish
Demand Water System and Water Pump
10 Gallon LP Gas/Electric Water Heater
with Electronic Ignition, DSI
Winterization Valving System
Water Heater Bypass Valve
Toilet with Sprayer
No-Fuss Flush Holding Tank Rinsing System
Insulated Systems Compartment with Easy Access
to Hook-Up
Shower inside Wet Bay with Hot/Cold Water
Soap Dispenser inside Utility Bay
Gravity and Pressurized Water Fill
Contained Storage Area for Sewer Hose
One-Piece Fiberglass Shower
Shower Diverter, Shower Hose and Head
Shower Light on Ceiling inside Shower
Satin Nickel Shower Door Frame with Obscure Glass

OPTIONS

RV Sani-Con 2 System, Holding Tank Flush System
Bathtub IPO Shower

HEATING, VENTS & AIR CONDITIONING

One 13.5M BTU Air Conditioner with Ducted Air and Analog Wall Thermostat, Low-Profile Ford and Workhorse (33PBD, 34SBD)

One 13.5M BTU and One 11.0M BTU Air Conditioner with Ducted Air and Wall Analog Thermostat, Low-Profile Ford and Workhorse (N/A: 33PBD, 34SBD)

35M BTU Electronic Ignition Furnace

Electronic Dash AC/Heat Climate Control System
In-Floor Ducted Heating System with Metal Floor Registers

Manual Roof Vent Kitchen (N/A: 33PBD, 34SBD)

Manual Roof Vent Living Area (33PBD, 34SBD)

12V Roof Vent Bathroom

Manual Roof Vent Bedroom (33PBD, 34SBD)

Metal Air Return Grill Furnace Satin Nickel Finish

Metal Floor Registers Satin Nickel

OPTIONS

Dual 13.5M BTU Air Conditioner, Requires 50 Amp Service, Low-Profile Ford and Workhorse (N/A: 33PBD, 34SBD)

One 13.5M BTU and One 11.0M BTU Air Conditioner, Low-Profile Ford and Workhorse (33PBD, 34SBD)

Dual 13.5M BTU Air Conditioner with Heat Pumps, Requires 50 Amp Service, Low-Profile Ford and Workhorse

One 13.5M BTU Air Conditioner with Heat Pump, Kitchen (N/A with Twin A/C, Low-Profile Ford and Workhorse) (33PBD, 34SBD)

12V Attic Fan Kitchen (N/A with Single A/C)

12V Attic Fan Living Area (N/A with Twin A/Cs)

12V Heater in Wet Bay, Heat Pad on Fresh Tank (N/A: 36DBD)

WINDOWS, DOORS & AWNINGS

Radius Flush Mount Single Pane Safety Glass Dark Tinted Slider Windows

Bathroom Window (36WDD, 36DBD, 37PCT)

Radius Entrance Door with Clear Glass, Roller Shade, Screen Door and Anti-Skid Steps

Two Interior Grab Handles and One Exterior Grab Handle

Topper Slide-Out Awnings Living Area and Bedroom

Protecta Glaze Tinted Plexiglas® Skylight in Bathroom

Awning Rail

OPTIONS

Radius Flush Mount Dual Pane Safety Glass Dark Tinted Slider Windows

Textured Vinyl Patio Awning

Eclipse Textured Vinyl Automatic Patio Awning

Textured Vinyl Window Awnings Living Area Slide-Out House Windows

Textured Vinyl Side Window Awning Bedroom (N/A: 37PCT)

SAFETY

Fire Extinguisher

Deadbolt Lock on Entrance Door

120V GFI Protected Circuit, Kitchen, Bath and Exterior

LP Gas Detector

Smoke Detector

Carbon Monoxide Detector

Pilot and Co-Pilot Three-Point Seat Belts

Third Brake Safety Light

Egress Windows

HEATING, VENTS & AIR CONDITIONING

One 13.5M BTU Air Conditioner with Ducted Air and Analog Wall Thermostat, Low-Profile Ford and Workhorse (33PBD, 34SBD)

One 13.5M BTU and One 11.0M BTU Air Conditioner with Ducted Air and Wall Analog Thermostat, Low-Profile Ford and Workhorse (N/A: 33PBD, 34SBD)

35M BTU Electronic Ignition Furnace

Electronic Dash AC/Heat Climate Control System

In-Floor Ducted Heating System with Metal Floor Registers

Manual Roof Vent Kitchen (N/A: 33PBD, 34SBD)

Manual Roof Vent Living Area (33PBD, 34SBD)

12V Roof Vent Bathroom

Manual Roof Vent Bedroom (33PBD, 34SBD)

Metal Air Return Grill Furnace Satin Nickel Finish

Metal Floor Registers Satin Nickel

OPTIONS

Dual 13.5M BTU Air Conditioner, Requires 50 Amp Service, Low-Profile Ford and Workhorse (N/A: 33PBD, 34SBD)

One 13.5M BTU and One 11.0M BTU Air Conditioner, Low-Profile Ford and Workhorse (33PBD, 34SBD)

Dual 13.5M BTU Air Conditioner with Heat Pumps, Requires 50 Amp Service, Low-Profile Ford and Workhorse

One 13.5M BTU Air Conditioner with Heat Pump, Kitchen (N/A with Twin A/C, Low-Profile Ford and Workhorse) (33PBD, 34SBD)

12V Attic Fan Kitchen (N/A with Single A/C)

12V Attic Fan Living Area (N/A with Twin A/Cs)

12V Heater in Wet Bay, Heat Pad on Fresh Tank (N/A: 36DBD)

WINDOWS, DOORS & AWNINGS

Radius Flush Mount Single Pane Safety Glass Dark Tinted Slider Windows

Bathroom Window (36WDD, 36DBD, 37PCT)

Radius Entrance Door with Clear Glass, Roller Shade, Screen Door and Anti-Skid Steps

Two Interior Grab Handles and One Exterior Grab Handle

Topper Slide-Out Awnings Living Area and Bedroom

Protecta Glaze Tinted Plexiglas® Skylight in Bathroom

Awning Rail

OPTIONS

Radius Flush Mount Dual Pane Safety Glass Dark Tinted Slider Windows

Textured Vinyl Patio Awning

Eclipse Textured Vinyl Automatic Patio Awning

Textured Vinyl Window Awnings Living Area Slide-Out House Windows

Textured Vinyl Side Window Awning Bedroom (N/A: 37PCT)

SAFETY

Fire Extinguisher

Deadbolt Lock on Entrance Door

120V GFI Protected Circuit, Kitchen, Bath and Exterior

LP Gas Detector

Smoke Detector

Carbon Monoxide Detector

Pilot and Co-Pilot Three-Point Seat Belts

Third Brake Safety Light

Egress Windows