

Discover the Back Roads

WEST



Palomino

CAMPING TRAILERS

Pony • Yearling • Mustang



Discover the Back Roads



Palomino

CAMPING TRAILERS

Pony • Yearling • Mustang





Mustang XL

Venture off the beaten path to new discoveries with the Mustang XL series by Palomino. These exceptional camping trailers feature hard walls that fold down into a compact, easy-towing unit while the built-in electric power lift system makes set-up effortless. The Mustang XL is endowed with more comfort and convenience than ever thought possible in a folding camper. A fully equipped galley, spacious sleeping quarters, comfortable furnishings, built-in storage, and even shower facilities are just some of the features that make the Mustang XL such a remarkable value for a great camping experience.



Model 8146XL

Standards

- Bunk Light w/Fan
- Kitchen Faucet w/Pump
- Water Filter
- Wired for Cable/Satellite
- Awning
- Electric Brakes
- One-Piece Filon Fiberglass Roof
- Roof Air Ready
- Clothes Bar
- Exterior 120V Outlet
- Inside/Outside Stove
- B.A.L. Jacks w/Sand Pads
- Window and Bed End Curtains
- Spare Tire, Bracket and Cover
- LP Bottle and Cover
- Entry Step
- 23 Gal. Water Tank
- Sliding ABS Storage Tray
- Entrance Door Caddy
- Torsion Independent Axle
- Powder Coated Steel Frame
- Electric Lift
- Laminated Fiberglass Sidewalls

Options

- 17,000 BTU Furnace
- 2.5 Cubic Foot Dometic Refrigerator-3 Way
- Outside Gas Grill
- Battery Box
- Double LP Bottles
- Create-A-Breeze Fan
- Potty Privacy Drape
- Pro Rack System
- AM/FM CD Player
- Microwave Oven
- Hot Water & Outside Shower
- Screen Room w/Privacy Flaps

Mustang XL	8128XL	8143XL	8146XL	8147XL	8148XL	8149XL
Box Length	12	14	14	14	14	14
Closed Overall	17'10"	19'10"	19'10"	19'10"	19'10"	19'10"
Closed Height	59"	59"	59"	59"	59"	59"
Travel Width	85"	85"	85"	85"	85"	85"
Open Length	23'10"	25'4"	25'4"	25'4"	25'4"	25'4"
Interior Height	6'7"	6'7"	6'7"	6'7"	6'7"	6'7"
Hitch Weight	206 lbs.	239 lbs.	243 lbs.	314 lbs.	265 lbs.	289 lbs.
Axle Weight	1986 lbs.	2180 lbs.	2293 lbs.	2160 lbs.	2397 lbs.	2384 lbs.
Total Weight	2192 lbs.	2419 lbs.	2536 lbs.	2474 lbs.	2662 lbs.	2673 lbs.
GVWR	3214 lbs.	3567 lbs.	3572 lbs.	3646 lbs.	3588 lbs.	3615 lbs.
Tire Size	13"	13"	13"	13"	13"	13"
Fresh Water	23 Gal.	23 Gal.	23 Gal.	23 Gal.	23 Gal.	23 Gal.



Ghost town near Rhyolite, Nevada



Venture off the beaten path to new discoveries with the Mustang XL series by Palomino. These exceptional camping trailers feature hard walls that fold down into a compact, easy-towing unit while the built-in electric power lift system makes set-up effortless. The Mustang XL is endowed with more comfort and convenience than ever thought possible in a folding camper. A fully equipped galley, spacious sleeping quarters, comfortable furnishings, built-in storage, and even shower facilities are just some of the features that make the Mustang XL such a remarkable value for a great camping experience.

Mustang XL



Model 8146XL

Standards

Bunk Light w/Fan
Kitchen Faucet w/Pump
Water Filter
Wired for Cable/Satellite
Awning
Electric Brakes
One-Piece Filton Fiberglass Roof
Roof Air Ready
Clothes Bar
Exterior 120V Outlet
Inside/Outside Stove
B.A.L. Jacks w/Sand Pads
Window and Bed End Curtains
Spare Tire, Bracket and Cover
LP Bottle and Cover
Entry Step
23 Gal. Water Tank
Sliding ABS Storage Tray
Entrance Door Caddy
Torsion Independent Axle
Powder Coated Steel Frame
Electric Lift
Laminated Fiberglass Sidewalls

Options

17,000 BTU Furnace
2.5 Cubic Foot Dometic
Refrigerator-3 Way
Outside Gas Grill
Battery Box
Double LP Bottles
Create-A-Breeze Fan
Potty Privacy Drape
Pro Rack System
AM/FM CD Player
Microwave Oven
Hot Water & Outside Shower
Screen Room w/Privacy Flaps

Mustang XL	8128XL	8143XL	8146XL	8147XL	8148XL	8149XL
Box Length	12	14	14	14	14	14
Closed Overall	17'10"	19'10"	19'10"	19'10"	19'10"	19'10"
Closed Height	59"	59"	59"	59"	59"	59"
Travel Width	85"	85"	85"	85"	85"	85"
Open Length	23'10"	25'4"	25'4"	25'4"	25'4"	25'4"
Interior Height	6'7"	6'7"	6'7"	6'7"	6'7"	6'7"
Hitch Weight	206 lbs.	239 lbs.	243 lbs.	314 lbs.	265 lbs.	289 lbs.
Axle Weight	1986 lbs.	2180 lbs.	2293 lbs.	2160 lbs.	2397 lbs.	2384 lbs.
Total Weight	2192 lbs.	2419 lbs.	2536 lbs.	2474 lbs.	2662 lbs.	2673 lbs.
GVWR	3214 lbs.	3567 lbs.	3572 lbs.	3646 lbs.	3588 lbs.	3615 lbs.
Tire Size	13"	13"	13"	13"	13"	13"
Fresh Water	23 Gal.	23 Gal.	23 Gal.	23 Gal.	23 Gal.	23 Gal.



Ghost town near Rhyolite, Nevada

Mustang

Standards

Bunk Light w/Fan
Kitchen Faucet w/Pump
Wired for Cable/Satellite
Awning
Electric Brakes
One-Piece Filon Fiberglass Roof
Roof Air Ready
Clothes Bar
Exterior 120V Outlet
Inside/Outside Stove
Five Piece Tent
B.A.L. Jacks w/Sand Pads
Window and Bed End Curtains
Spare Tire, Bracket and Cover
LP Bottle and Cover
Entry Step
23 Gal. Water Tank
Sliding ABS Storage Tray*
Entrance Door Caddy
Torsion Independent Axle
Powder Coated Steel Frame
Water Filter
Laminated Fiberglass Sidewalls

Options

17,000 BTU Furnace
Dometic Refrigerator-3 Way
Outside Gas Grill
Hot Water & Outside Shower
Battery Box
Double LP Bottles
Create-A-Breeze Fan
Potty Privacy Drape
Pro Rack System
Electric Lift
AM/FM CD Player
Screen Room w/Privacy Flaps

*Available on select models



Model 6149



Oregon Trail, Scott's Bluff,
Nebraska

Go the way of the Mustang and explore new country. These folding tent campers are outfitted to give you the best in family camping with roomy, fully furnished interiors. Some models even include slide-outs for greater living space, and special design features make set up fast and easy. With a choice of six floor plans and a long list of standard features and popular options, the Mustang can accommodate all your needs while in camp or on the road.



Mustang	6128	6140	6143	6147	6148	6149
Box Length	12	14	14	14	14	14
Closed Overall	17'10"	17'10"	19'10"	19'10"	19'10"	19'10"
Closed Height	56"	56"	56"	56"	56"	56"
Travel Width	85"	85"	85"	85"	85"	85"
Open Length	23'10"	25'4"	25'4"	25'4"	25'4"	25'4"
Interior Height	6'7"	6'7"	6'7"	6'7"	6'7"	6'7"
Hitch Weight	206 lbs.	291 lbs.	227 lbs.	314 lbs.	244 lbs.	289 lbs.
Axle Weight	1986 lbs.	1905 lbs.	2110 lbs.	2160 lbs.	2198 lbs.	2384 lbs.
Total Weight	2192 lbs.	2096 lbs.	2337 lbs.	2474 lbs.	2442 lbs.	2673 lbs.
GVWR	3214 lbs.	3628 lbs.	3553 lbs.	3646 lbs.	3570 lbs.	3615 lbs.
Tire Size	13"	13"	13"	13"	13"	13"
Fresh Water	23 Gal.	23 Gal.	23 Gal.	23 Gal.	23 Gal.	23 Gal.

Mustang

Standards

Bunk Light w/Fan
Kitchen Faucet w/Pump
Wired for Cable/Satellite
Awning
Electric Brakes
One-Piece Filon Fiberglass Roof
Roof Air Ready
Clothes Bar
Exterior 120V Outlet
Inside/Outside Stove
Five Piece Tent
B.A.L. Jacks w/Sand Pads
Window and Bed End Curtains
Spare Tire, Bracket and Cover
LP Bottle and Cover
Entry Step
23 Gal. Water Tank
Sliding ABS Storage Tray*
Entrance Door Caddy
Torsion Independent Axle
Powder Coated Steel Frame
Water Filter
Laminated Fiberglass Sidewalls

Options

17,000 BTU Furnace
Dometic Refrigerator-3 Way
Outside Gas Grill
Hot Water & Outside Shower
Battery Box
Double LP Bottles
Create-A-Breeze Fan
Potty Privacy Drape
Pro Rack System
Electric Lift
AM/FM CD Player
Screen Room w/Privacy Flaps

*Available on select models



Model 6149

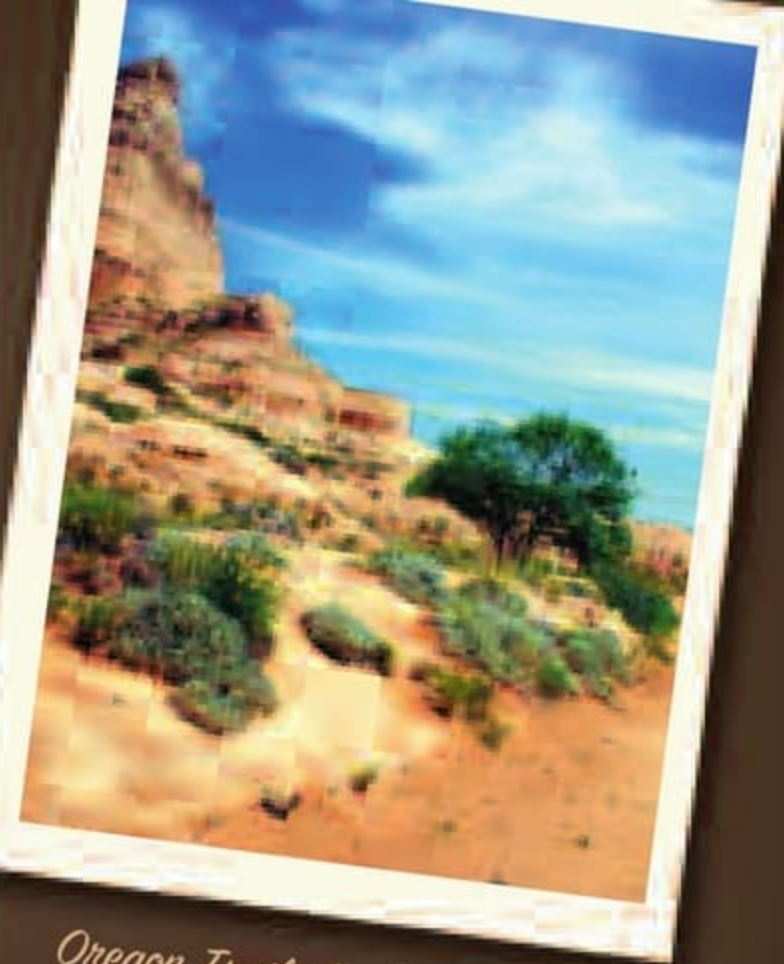

Oregon Trail, Scott's Bluff,
Nebraska

Go the way of the Mustang and explore new country. These folding tent campers are outfitted to give you the best in family camping with roomy, fully furnished interiors. Some models even include slide-outs for greater living space, and special design features make set up fast and easy. With a choice of six floor plans and a long list of standard features and popular options, the Mustang can accommodate all your needs while in camp or on the road.



Mustang	6128	6140	6143	6147	6148	6149
Box Length	12	14	14	14	14	14
Closed Overall	17'10"	17'10"	19'10"	19'10"	19'10"	19'10"
Closed Height	56"	56"	56"	56"	56"	56"
Travel Width	85"	85"	85"	85"	85"	85"
Open Length	23'10"	25'4"	25'4"	25'4"	25'4"	25'4"
Interior Height	6'7"	6'7"	6'7"	6'7"	6'7"	6'7"
Hitch Weight	206 lbs.	291 lbs.	227 lbs.	314 lbs.	244 lbs.	289 lbs.
Axle Weight	1986 lbs.	1905 lbs.	2110 lbs.	2160 lbs.	2198 lbs.	2384 lbs.
Total Weight	2192 lbs.	2096 lbs.	2337 lbs.	2474 lbs.	2442 lbs.	2673 lbs.
GVWR	3214 lbs.	3628 lbs.	3553 lbs.	3646 lbs.	3570 lbs.	3615 lbs.
Tire Size	13"	13"	13"	13"	13"	13"
Fresh Water	23 Gal.	23 Gal.	23 Gal.	23 Gal.	23 Gal.	23 Gal.



Yearling

You'll want to kick up the dust and head out for uncharted territory with this midsize affordable camping trailer. The Yearling is built for adventure with a sturdy, yet lightweight, design that's road tough and easy to tow. Packed with easy living features and quality components, these family-friendly units offer incredible value for carefree travel and long-lasting enjoyment. When you want comfort and affordability, the Yearling gives you both.



Model 4103

Standards

Kitchen Faucet w/Pump
Awning
Electric Brakes**
One-Piece Filon Fiberglass Roof
Roof Air Ready
Clothes Bar
Exterior 120V Outlet
Inside/Outside Stove
Five Piece Tent
B.A.L. Jacks w/Sand Pads
Window and Bed End Curtains
Spare Tire, Bracket and Cover
LP Bottle and Cover
Entry Step
23 Gal. Water Tank
Sliding ABS Storage Tray*
Entrance Door Caddy
Torsion Independent Axle
Powder Coated Steel Frame
Laminated Fiberglass Sidewalls

Options

17,000 BTU Furnace
Dometic Refrigerator-3 Way
Outside Gas Grill
Battery Box
Double LP Bottles
Bunk Light w/Fan
Create-A-Breeze Fan
Electric Brakes**
Potty Privacy Drape
Pro Rack System
Electric Lift
AM/FM CD Player
Hot Water w/Outside Shower
Screen Room w/Privacy Flaps

Yearling	4100	4101	4102	4103	4120	4124	4127
Box Length	10	10	10	10	12	12	12
Closed Overall	13'10"	13'10"	13'10"	15'10"	15'10"	15'10"	17'10"
Closed Height	52"	52"	52"	56"	56"	56"	56"
Travel Width	85"	85"	85"	85"	85"	85"	85"
Open Length	20'2"	20'2"	20'2"	20'2"	23'10"	23'10"	23'10"
Interior Height	6'7"	6'7"	6'7"	6'7"	6'7"	6'7"	6'7"
Hitch Weight	248 lbs.	223 lbs.	247 lbs.	119 lbs.	154 lbs.	144 lbs.	204 lbs.
Axle Weight	1302 lbs.	1451 lbs.	1422 lbs.	1705 lbs.	1732 lbs.	1914 lbs.	2113 lbs.
Total Weight	1550 lbs.	1674 lbs.	1669 lbs.	1824 lbs.	1886 lbs.	2058 lbs.	2317 lbs.
GVWR	2352 lbs.	2322 lbs.	2347 lbs.	2846 lbs.	2883 lbs.	2873 lbs.	3533 lbs.
Tire Size	12"	12"	12"	13"	13"	13"	13"
Fresh Water	20 Gal.	20 Gal.	20 Gal.	20 Gal.	23 Gal.	23 Gal.	23 Gal.

*Available on select models

**Available on all models, standard on select models



Old gas station, Chavez, New Mexico





You'll want to kick up the dust and head out for uncharted territory with this midsize affordable camping trailer. The Yearling is built for adventure with a sturdy, yet lightweight, design that's road tough and easy to tow. Packed with easy living features and quality components, these family-friendly units offer incredible value for carefree travel and long-lasting enjoyment. When you want comfort and affordability, the Yearling gives you both.

Yearling



Model 4103

Standards

- Kitchen Faucet w/Pump
- Awning
- Electric Brakes**
- One-Piece Filon Fiberglass Roof
- Roof Air Ready
- Clothes Bar
- Exterior 120V Outlet
- Inside/Outside Stove
- Five Piece Tent
- B.A.L. Jacks w/Sand Pads
- Window and Bed End Curtains
- Spare Tire, Bracket and Cover
- LP Bottle and Cover
- Entry Step
- 23 Gal. Water Tank
- Sliding ABS Storage Tray*
- Entrance Door Caddy
- Torsion Independent Axle
- Powder Coated Steel Frame
- Laminated Fiberglass Sidewalls

Options

- 17,000 BTU Furnace
- Dometic Refrigerator-3 Way
- Outside Gas Grill
- Battery Box
- Double LP Bottles
- Bunk Light w/Fan
- Create-A-Breeze Fan
- Electric Brakes**
- Potty Privacy Drape
- Pro Rack System
- Electric Lift
- AM/FM CD Player
- Hot Water w/Outside Shower
- Screen Room w/Privacy Flaps

Yearling	4100	4101	4102	4103	4120	4124	4127
Box Length	10	10	10	10	12	12	12
Closed Overall	13'10"	13'10"	13'10"	15'10"	15'10"	15'10"	17'10"
Closed Height	52"	52"	52"	56"	56"	56"	56"
Travel Width	85"	85"	85"	85"	85"	85"	85"
Open Length	20'2"	20'2"	20'2"	20'2"	23'10"	23'10"	23'10"
Interior Height	6'7"	6'7"	6'7"	6'7"	6'7"	6'7"	6'7"
Hitch Weight	248 lbs.	223 lbs.	247 lbs.	119 lbs.	154 lbs.	144 lbs.	204 lbs.
Axle Weight	1302 lbs.	1451 lbs.	1422 lbs.	1705 lbs.	1732 lbs.	1914 lbs.	2113 lbs.
Total Weight	1550 lbs.	1674 lbs.	1669 lbs.	1824 lbs.	1886 lbs.	2058 lbs.	2317 lbs.
GVWR	2352 lbs.	2322 lbs.	2347 lbs.	2846 lbs.	2883 lbs.	2873 lbs.	3533 lbs.
Tire Size	12"	12"	12"	13"	13"	13"	13"
Fresh Water	20 Gal.	20 Gal.	20 Gal.	20 Gal.	23 Gal.	23 Gal.	23 Gal.

*Available on select models
 **Available on all models, standard on select models



Old gas station, Chavez, New Mexico



Standards

Awning
One-Piece Filton Fiberglass Roof
Roof Air Ready
Clothes Bar
Exterior 120V Outlet
Inside/Outside Stove
Five Piece Tent
B.A.L. Jacks w/Sand Pads
Window and Bed End Curtains
Spare Tire, Bracket and Cover
LP Bottle and Cover
Entry Step
20 Gal. Under Floor Water Tank
Sliding ABS Storage Tray*
Entrance Door Caddy
Torsion Independent Axle
Powder Coated Steel Frame

Options

17,000 BTU Furnace
Dometic Refrigerator-3 Way
Outside Gas Grill
Battery Box
Double LP Bottles
Bunk Light w/Fan
Create-A-Breeze Fan
Electric Brakes
Potty Privacy Drape
Pro Rack System
Electric Lift
Screen Room w/Privacy Flaps

*Available on select models

Pony	280	283	2100
Box Length	8	8	10
Closed Overall	11'10"	13'10"	13'10"
Closed Height	52"	52"	52"
Travel Width	85"	85"	85"
Open Length	16'8"	16'8"	20'2"
Interior Height	6'7"	6'7"	6'7"
Hitch Weight	109 lbs.	128 lbs.	244 lbs.
Axle Weight	1176 lbs.	1410 lbs.	1227 lbs.
Total Weight	1285 lbs.	1538 lbs.	1471 lbs.
GVWR	2207 lbs.	2224 lbs.	2331 lbs.
Tire Size	12"	12"	12"
Fresh Water	20 Gal.	20 Gal.	20 Gal.



Model 280



Pony



Windmill at sunset. San Angelo, Texas

PALOMINO
PONY

The Pony is made for wandering the byways thanks to its compact, easy towing size. Very affordable, this economical camping trailer is ideal for families who want value without sacrificing quality and comfort. Available in three roomy floor plans, the Pony is equipped with all you need for fun family vacations and weekend outings. Close inspection will reveal the Pony is all that it promises and more.

Standards

Awning
 One-Piece Filon Fiberglass Roof
 Roof Air Ready
 Clothes Bar
 Exterior 120V Outlet
 Inside/Outside Stove
 Five Piece Tent
 B.A.L. Jacks w/Sand Pads
 Window and Bed End Curtains
 Spare Tire, Bracket and Cover
 LP Bottle and Cover
 Entry Step
 20 Gal. Under Floor Water Tank
 Sliding ABS Storage Tray*
 Entrance Door Caddy
 Torsion Independent Axle
 Powder Coated Steel Frame

Options

17,000 BTU Furnace
 Dometic Refrigerator-3 Way
 Outside Gas Grill
 Battery Box
 Double LP Bottles
 Bunk Light w/Fan
 Create-A-Breeze Fan
 Electric Brakes
 Potty Privacy Drape
 Pro Rack System
 Electric Lift
 Screen Room w/Privacy Flaps

*Available on select models

Pony	280	283	2100
Box Length	8	8	10
Closed Overall	11'10"	13'10"	13'10"
Closed Height	52"	52"	52"
Travel Width	85"	85"	85"
Open Length	16'8"	16'8"	20'2"
Interior Height	6'7"	6'7"	6'7"
Hitch Weight	109 lbs.	128 lbs.	244 lbs.
Axle Weight	1176 lbs.	1410 lbs.	1227 lbs.
Total Weight	1285 lbs.	1538 lbs.	1471 lbs.
GVWR	2207 lbs.	2224 lbs.	2331 lbs.
Tire Size	12"	12"	12"
Fresh Water	20 Gal.	20 Gal.	20 Gal.

Pony



Model 280



Windmill at sunset, San Angelo, Texas

PALOMINO
PONY

The Pony is made for wandering the byways thanks to its compact, easy towing size. Very affordable, this economical camping trailer is ideal for families who want value without sacrificing quality and comfort. Available in three roomy floor plans, the Pony is equipped with all you need for fun family vacations and weekend outings. Close inspection will reveal the Pony is all that it promises and more.

Mustang XL

8128
XL



8143
XL

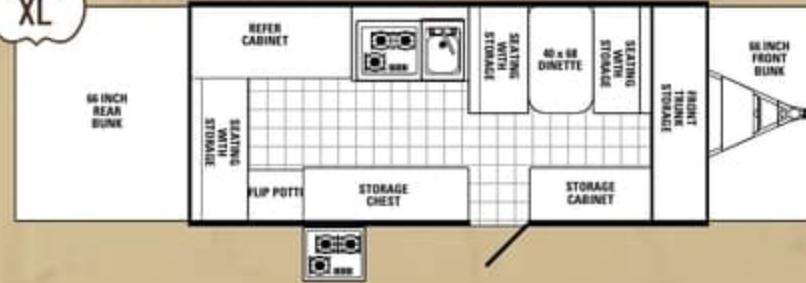

8146
XL

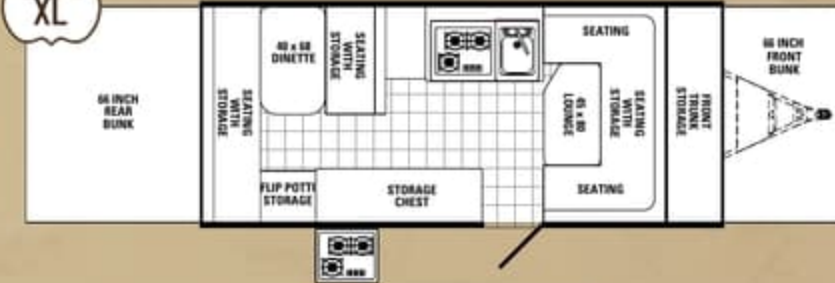

8147
XL

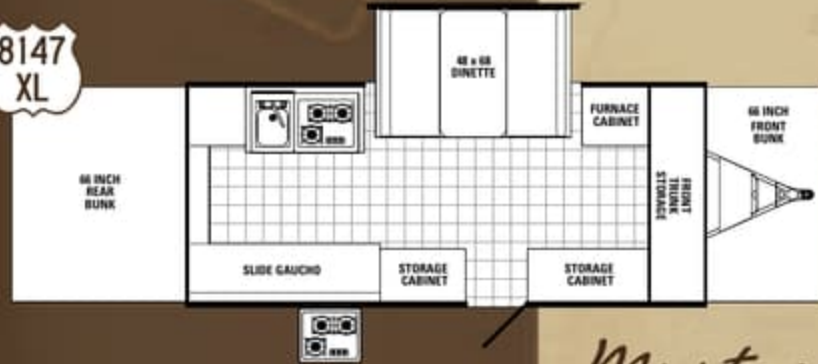

8148
XL

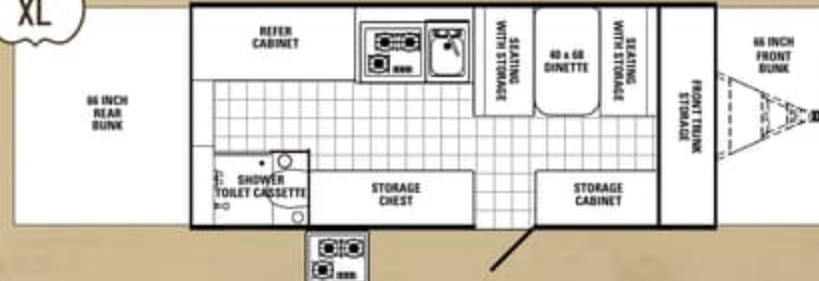

8149
XL

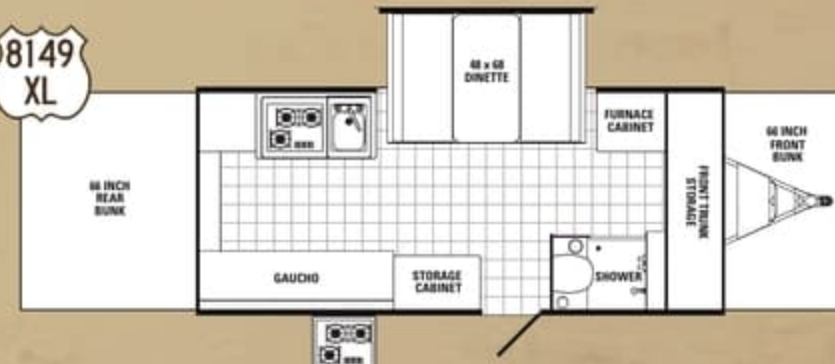

Mustang

6128

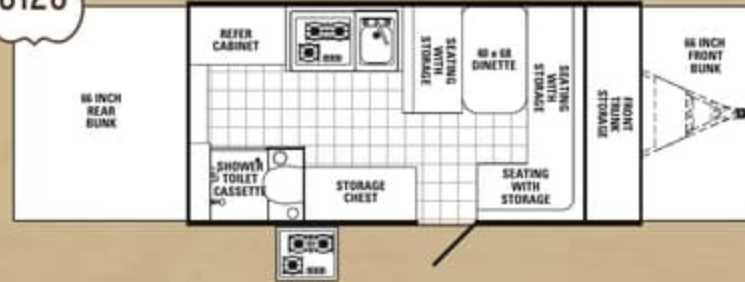

6140



6143

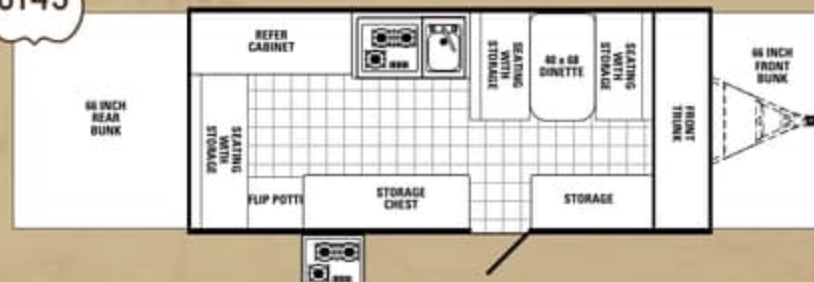

6147

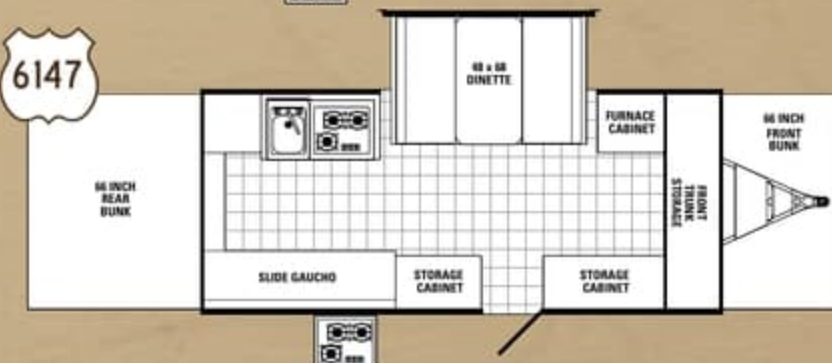

6148

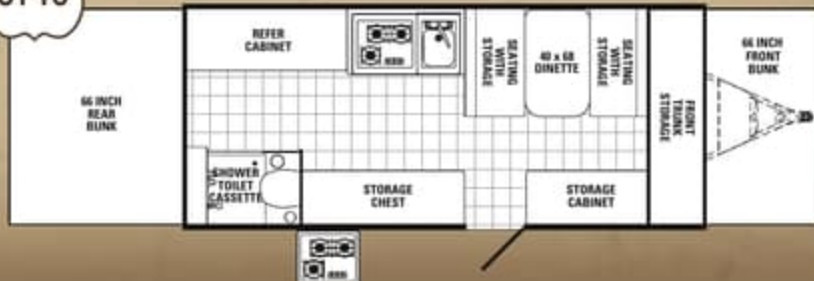

6149

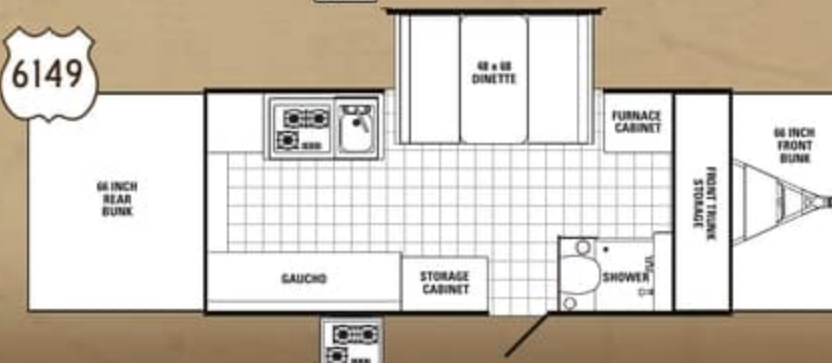

Mustang XL
Fabric



Mustang Fabric



Picturesque scene, Monument Valley, Utah

Mustang XL

8128
XL

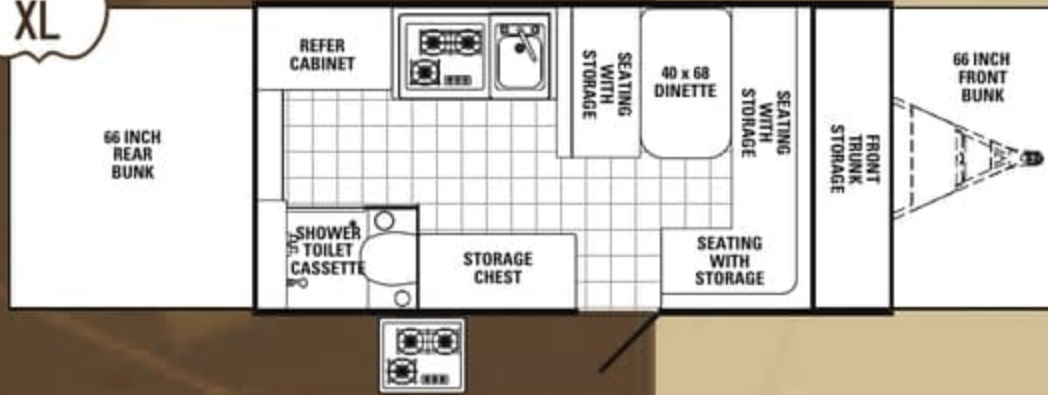

8143
XL

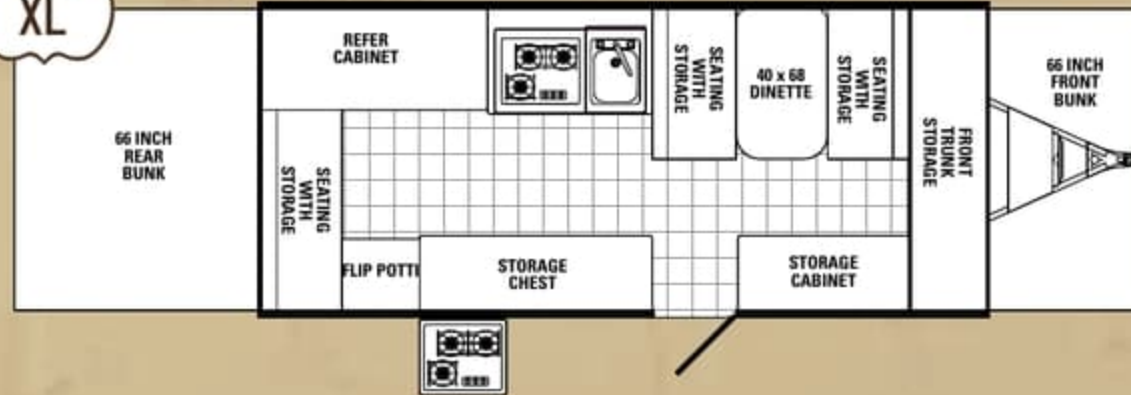

8146
XL

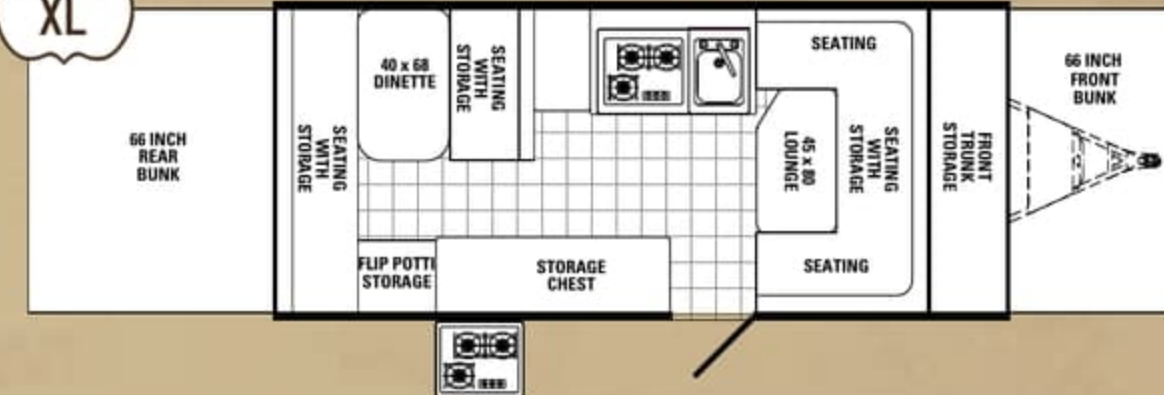

8147
XL

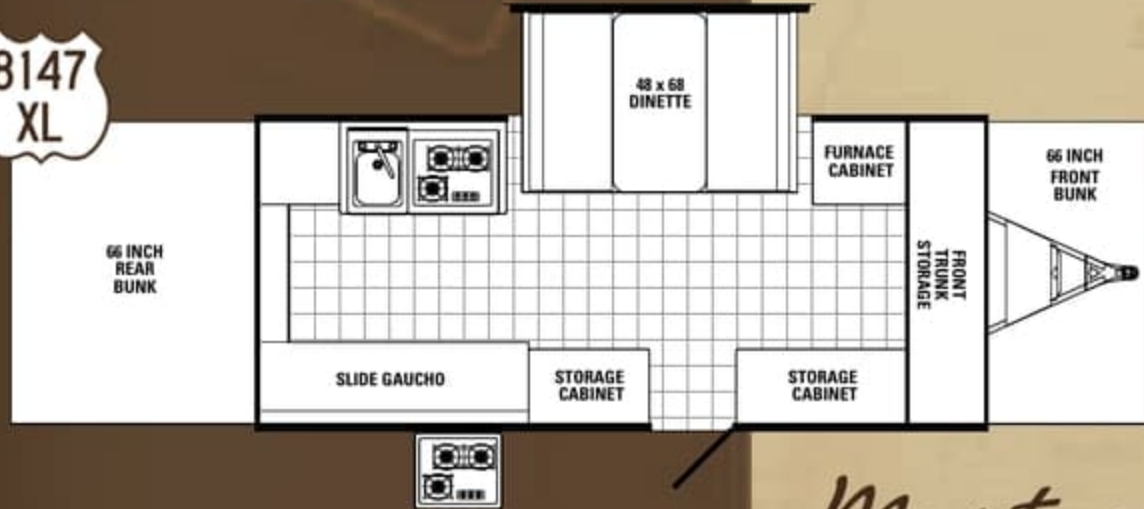

8148
XL

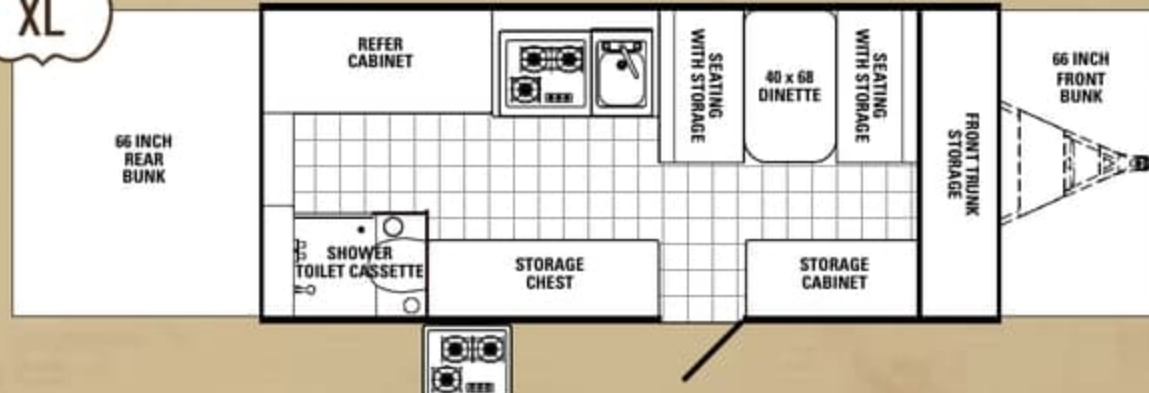

8149
XL

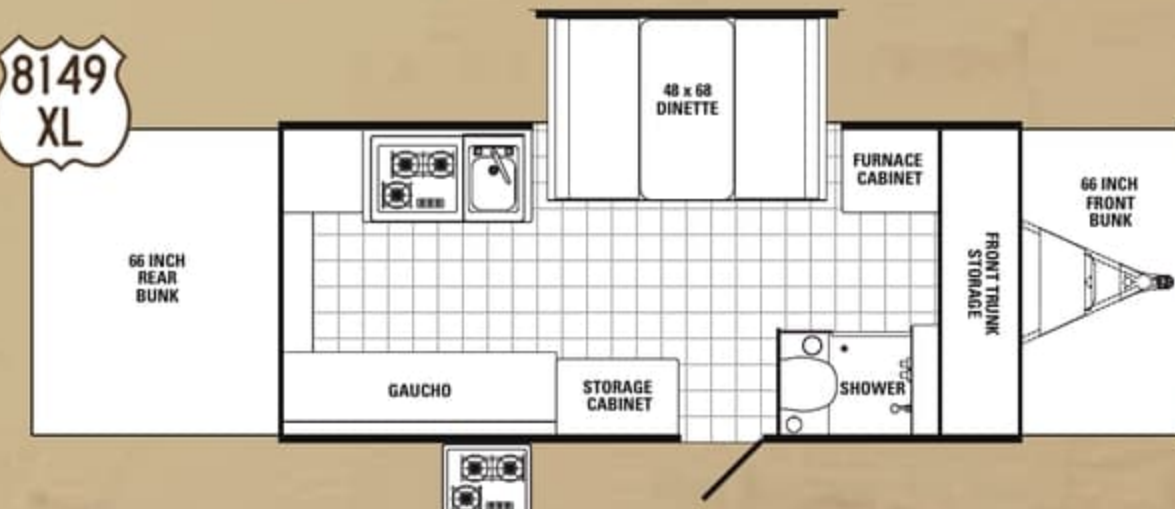

Mustang

6128

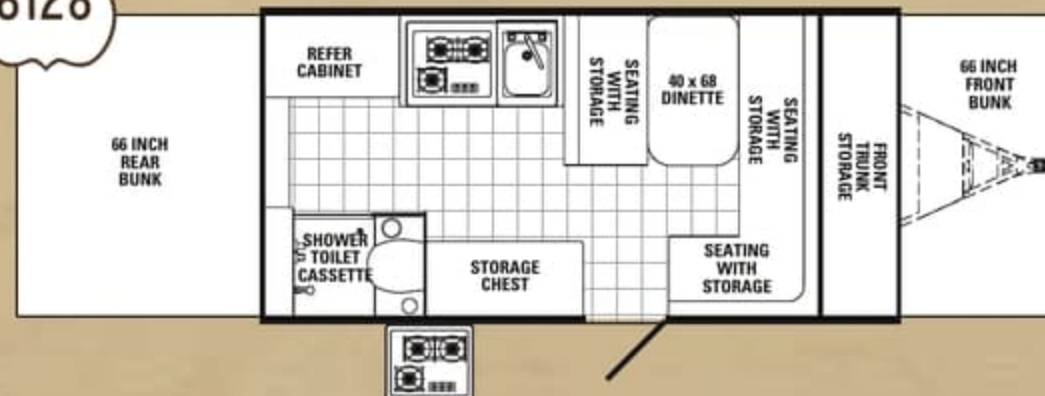

6140

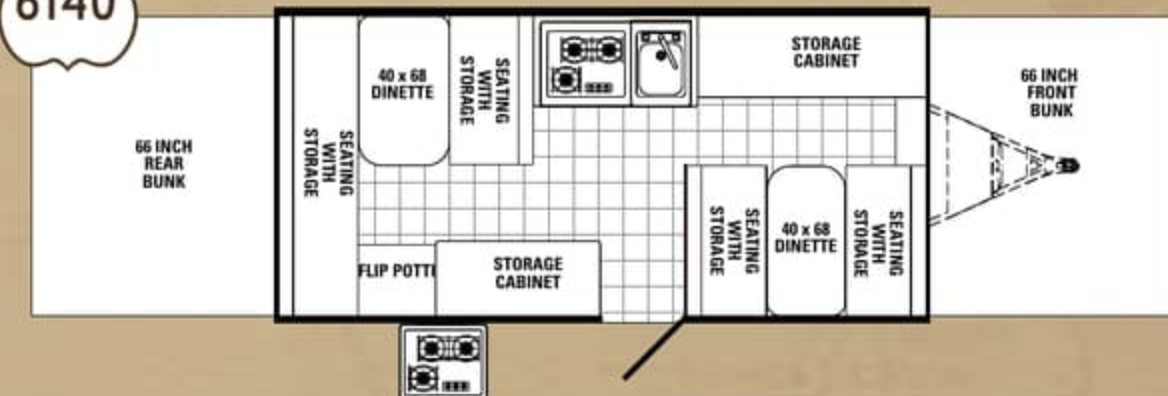

6143

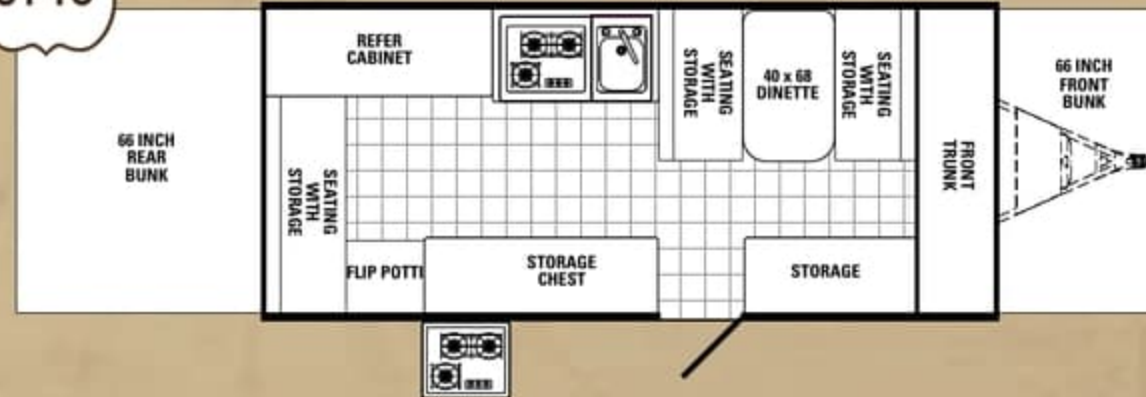

6147

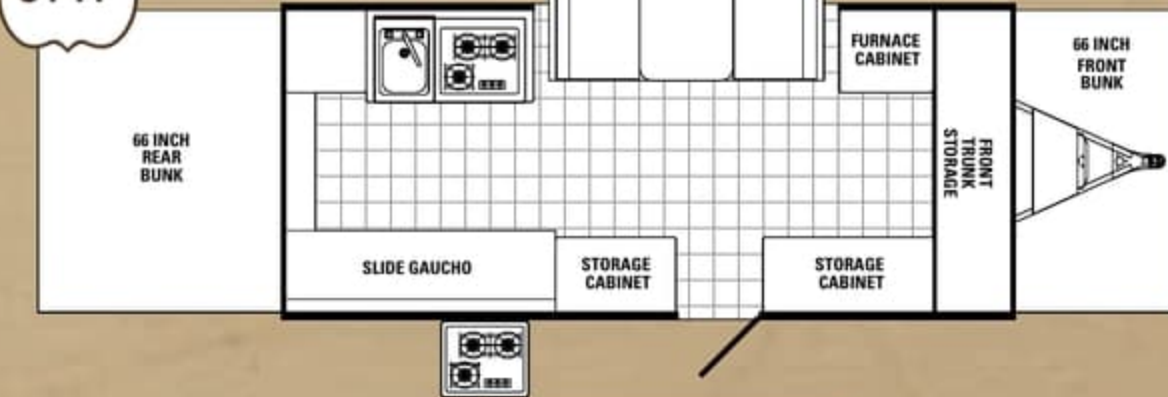

6148

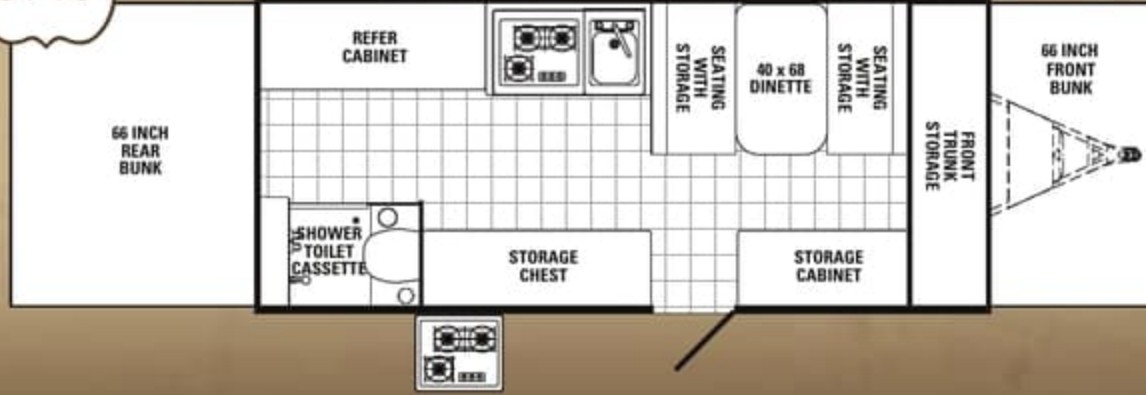

6149

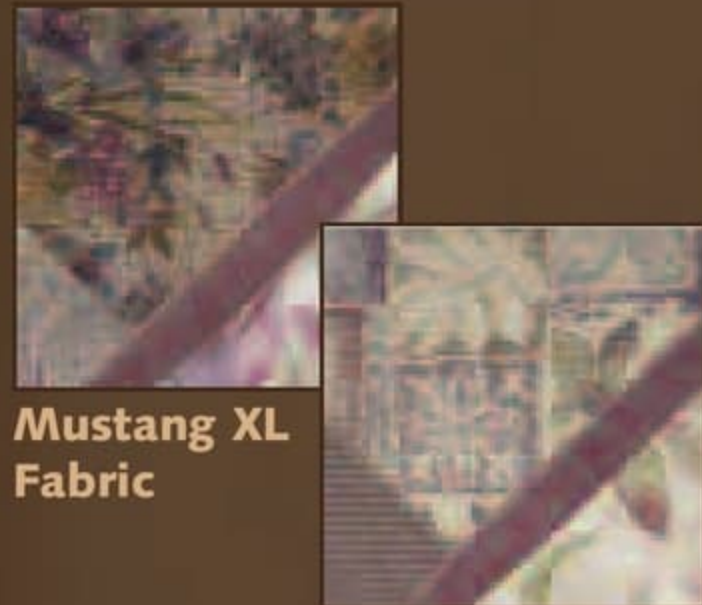
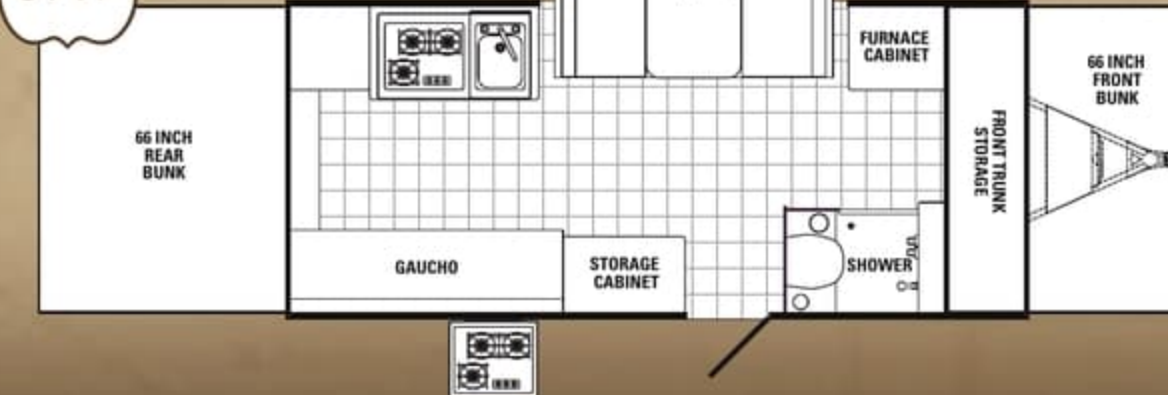

Picturesque scene, Monument Valley, Utah

Yearling

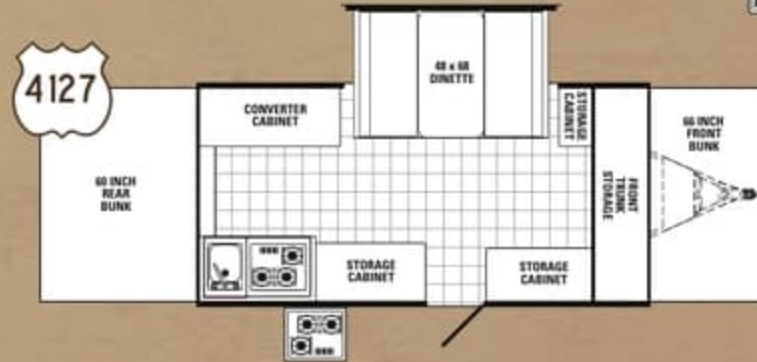
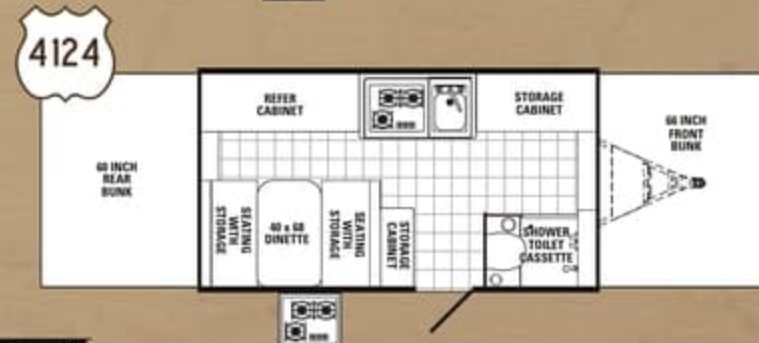
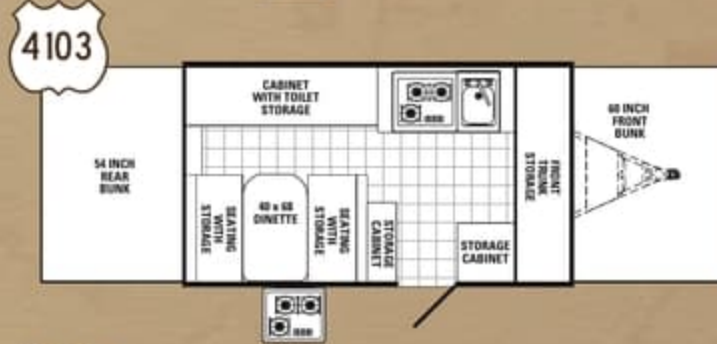
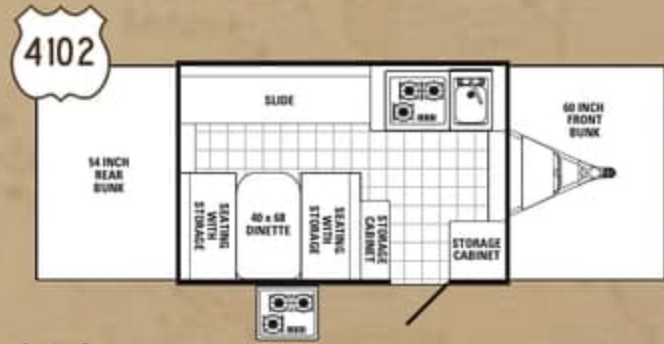
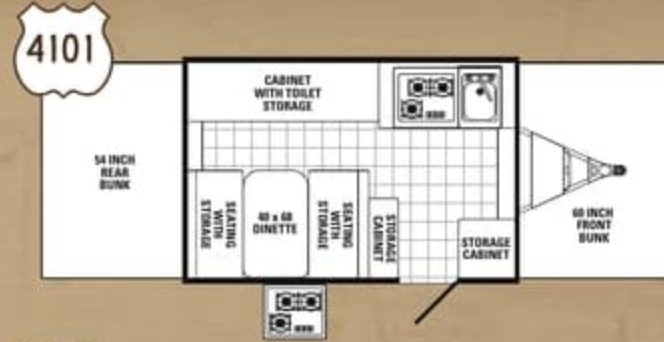
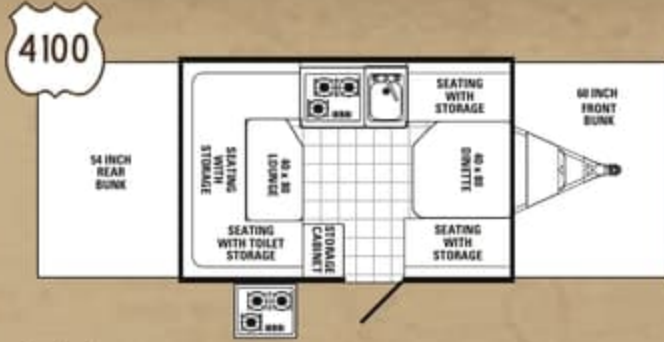

Superstition Mountain, Arizona



Yearling Fabric



Pony Fabric

Pony

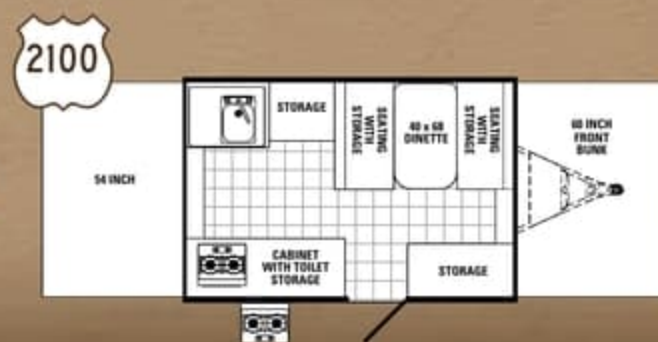
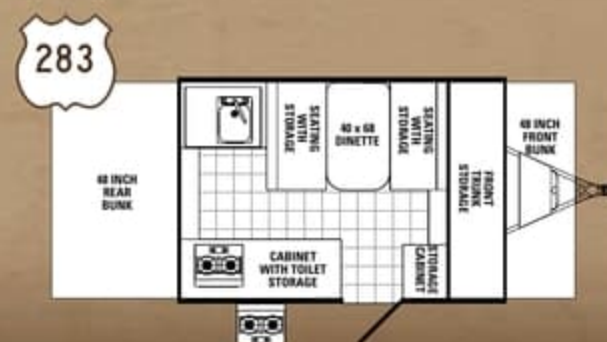
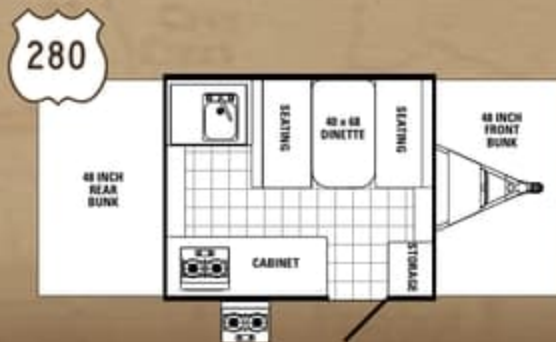

44

Yearling

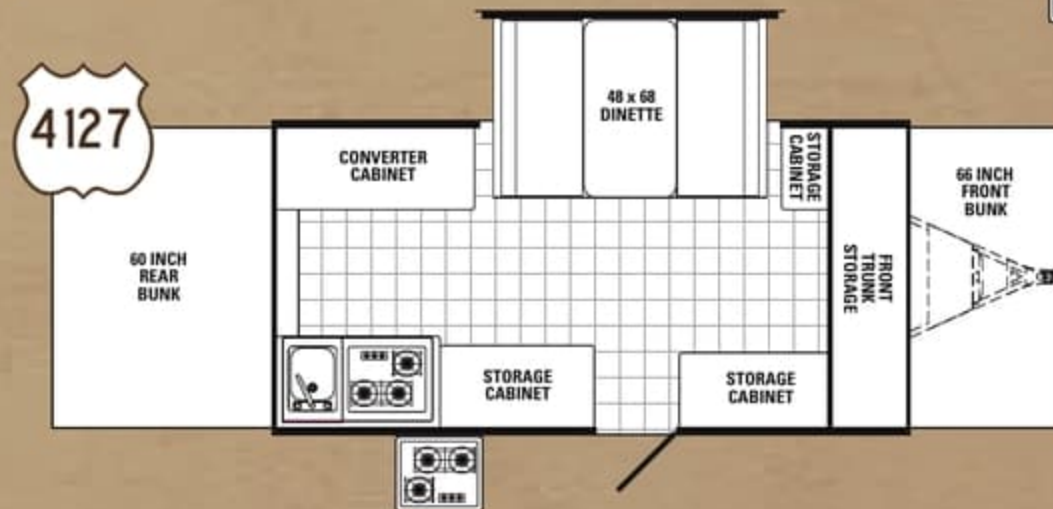
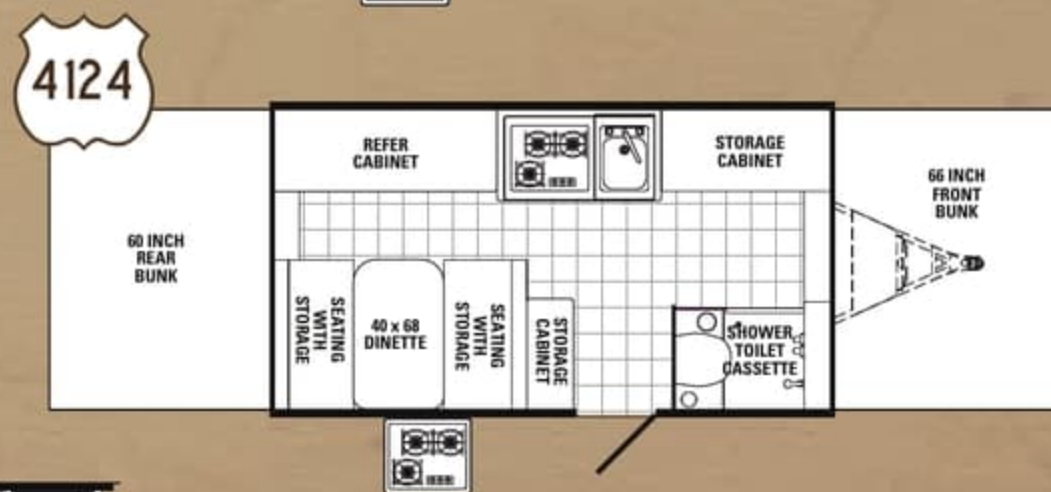
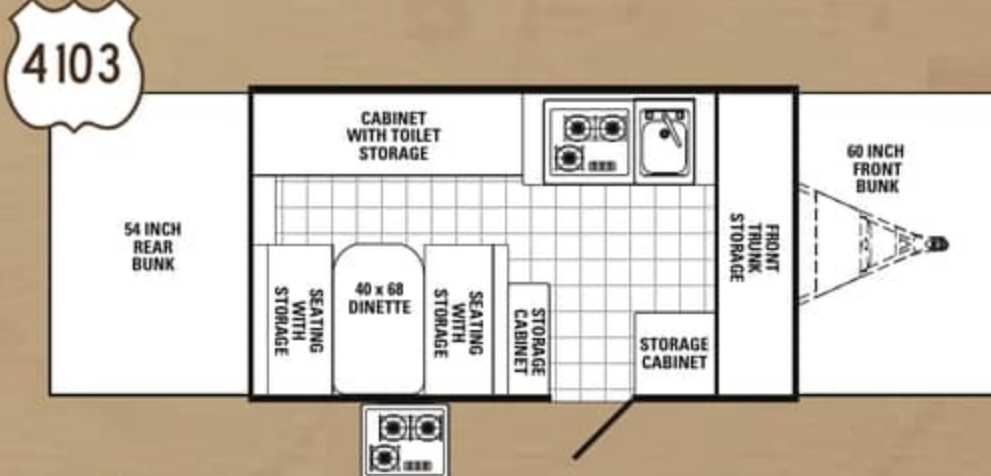
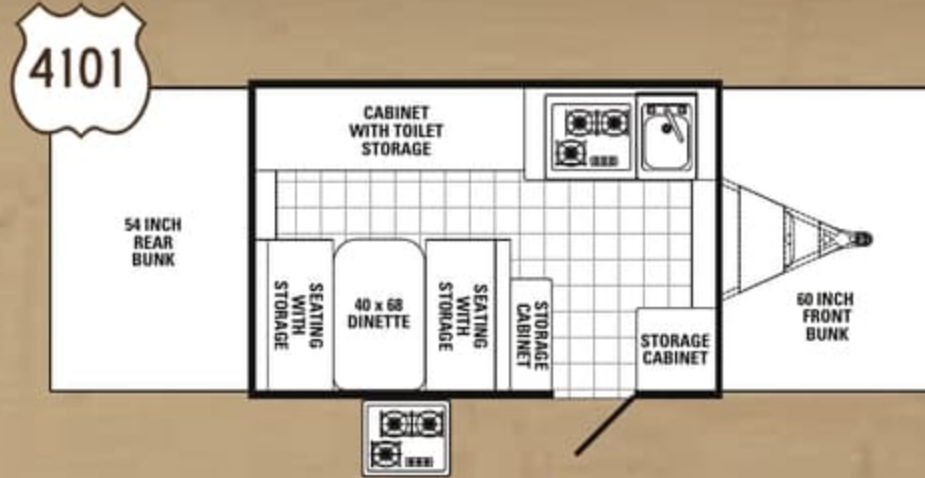
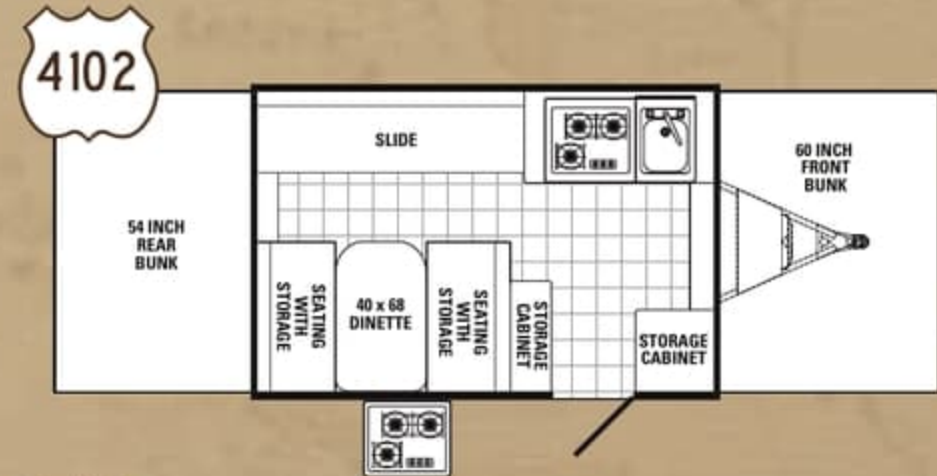
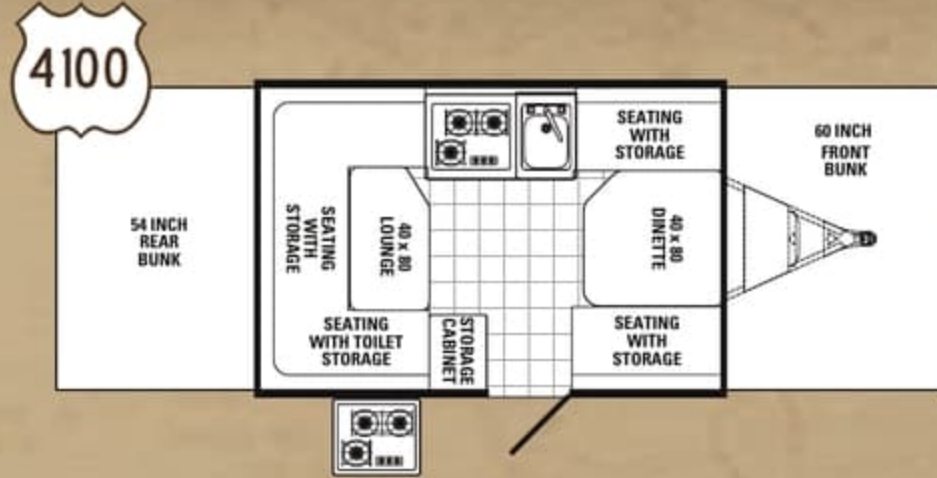

Superstition Mountain, Arizona



Yearling Fabric



Pony Fabric

Pony

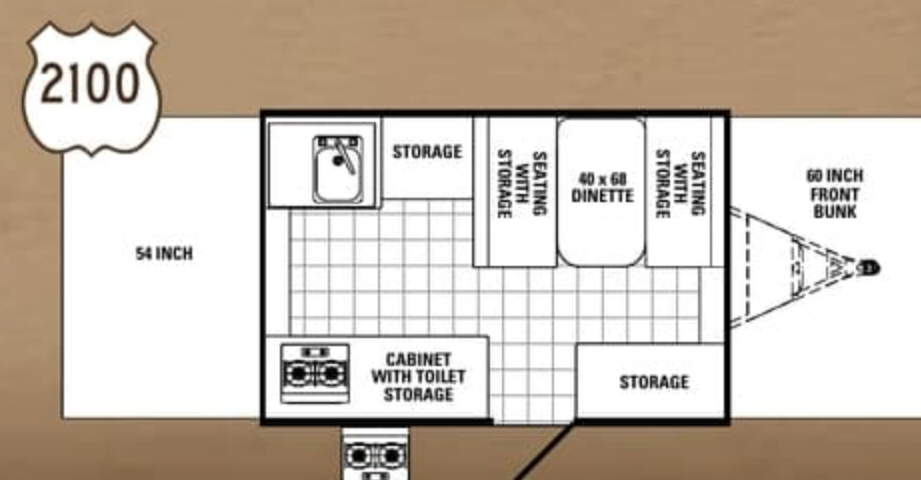
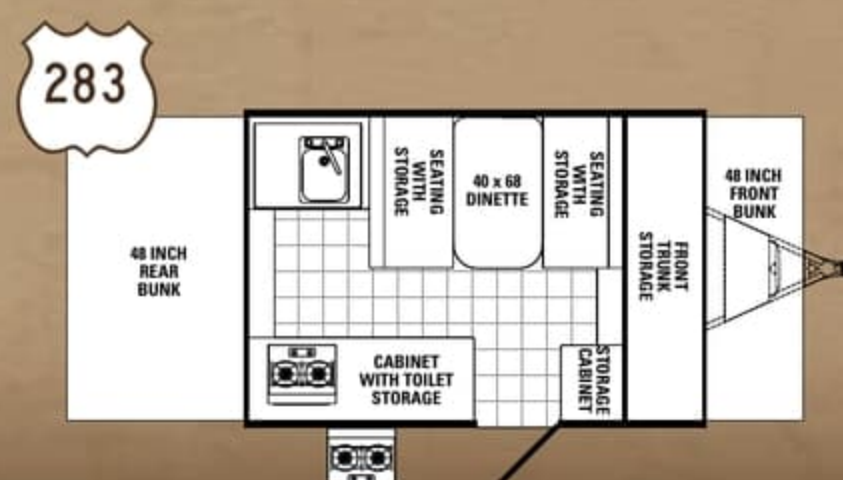
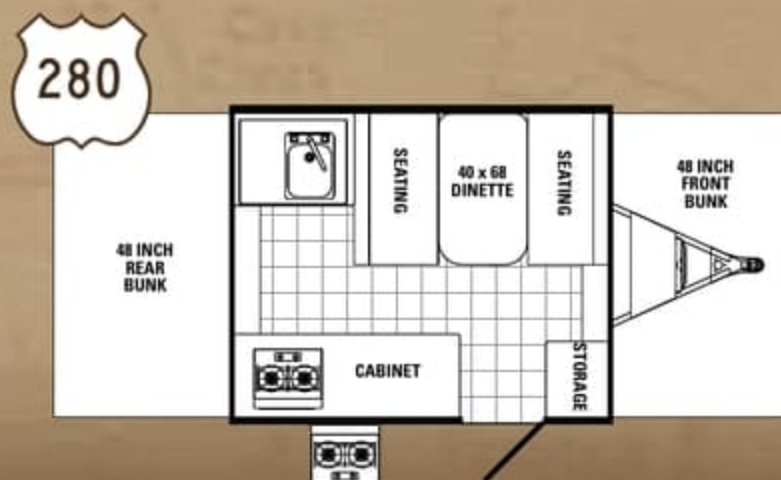

44

Features & Options

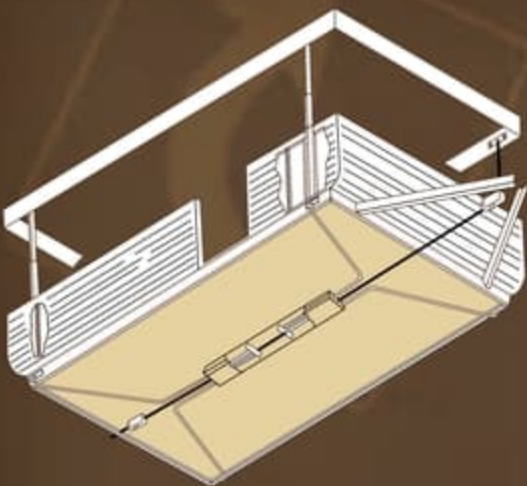

CRANK-UP LIFT SYSTEM

1. The drive system is enclosed for protection from weather and road conditions.
2. The underneath location of the system allows for easy inspection and maintenance. Grease zerks are located top and bottom of the main tube to allow yearly maintenance.
3. A single cable capable of 3,200 lbs. tensile strength rotates around the rear cable pulley and pushes the four flexible steel push rods up the lifter posts.
4. Flexible steel push rods.
5. Three stage plated lift post.



Standard inside/outside stove



Exclusive three flap tent assembly system



Retractable clothes rod and bunk light with fan



Built-in entrance door parts caddy



Optional outside grill and work table



Sliding A.B.S. storage tubs



Optional outside shower



Roomy low step slide system for easy access and increased head room



An optional 10 bladed, 3 speed Create-A-Breeze™ Fantastic Vent



Optional screen room

All illustrations and specifications contained in this literature are based on the latest product information at time of publication. Vanguard LLC reserves the right to make changes in prices, colors, materials, equipment and specifications and to discontinue models at anytime without notice or obligation and assumes no responsibility for any error in this literature.

Palomino camping trailers are designed to meet the varied needs of the customer. It is the responsibility of the owner to select the proper load combination for their individual needs without exceeding the listed axle weight capacities.

LIFETIME LIMITED WARRANTY – Vanguard LLC offers a lifetime limited warranty to the original owner for: Lifter Systems, Bed Boards, Frames and Floor Board. **TENT WARRANTY** – Vanguard LLC warrants its Vinyl tents to be free from defect in materials and workmanship for 5 years, under normal use and service, to the original owner.

LIMITED ROOF WARRANTY – Vanguard LLC warrants the Palomino Roof Assembly to be free from substantial defects in materials and workmanship for a period of 5 years, excluding any modification or alterations. There are certain other exclusions to this limited warranty, details of which are included in the actual printed warranty statement. Ask your dealer to let you inspect it.

DEALER



Vanguard LLC

31450 M-86 West • Colon, MI 49040

Phone: (269) 432-3271 • Fax: (269) 432-2516

www.palominorv.com

V-100-092

©2004 Vanguard LLC

Litho U.S.A.

Old Mission Building, San Antonio, Texas

Features & Options

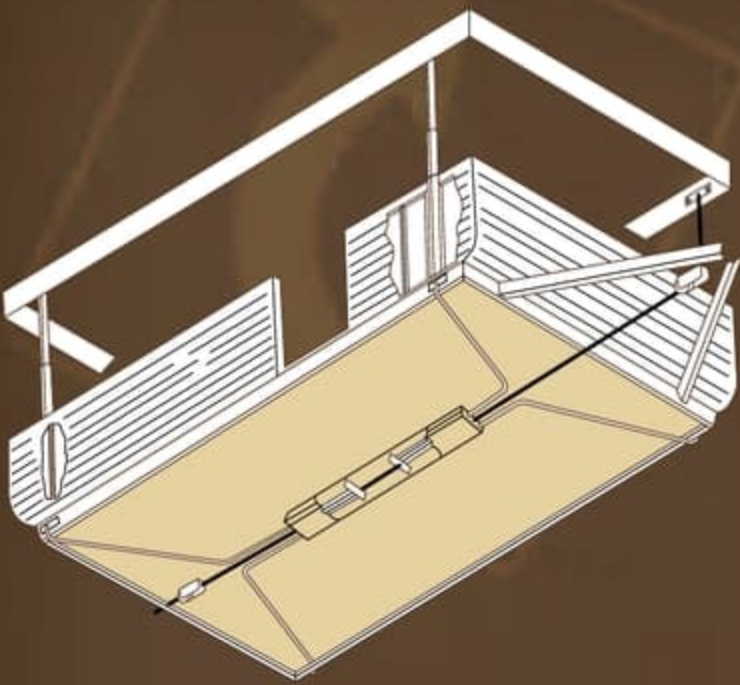

CRANK-UP LIFT SYSTEM

1. The drive system is enclosed for protection from weather and road conditions.
2. The underneath location of the system allows for easy inspection and maintenance. Grease zerks are located top and bottom of the main tube to allow yearly maintenance.
3. A single cable capable of 3,200 lbs. tensile strength rotates around the rear cable pulley and pushes the four flexible steel push rods up the lifter posts.
4. Flexible steel push rods.
5. Three stage plated lift post.



Old Mission Building, San Antonio, Texas



Standard inside/outside stove



Exclusive three flap tent assembly system



Retractable clothes rod and bunk light with fan



Built-in entrance door parts caddy



Optional outside grill and work table



Sliding A.B.S. storage tubs



Optional outside shower



Roomy low step slide system for easy access and increased head room



An optional 10 bladed, 3 speed Create-A-Breeze™ Fantastic Vent



Optional screen room

All illustrations and specifications contained in this literature are based on the latest product information at time of publication. Vanguard LLC reserves the right to make changes in prices, colors, materials, equipment and specifications and to discontinue models at anytime without notice or obligation and assumes no responsibility for any error in this literature.

Palomino camping trailers are designed to meet the varied needs of the customer. It is the responsibility of the owner to select the proper load combination for their individual needs without exceeding the listed axle weight capacities.

LIFETIME LIMITED WARRANTY – Vanguard LLC offers a lifetime limited warranty to the original owner for: Lifter Systems, Bed Boards, Frames and Floor Board. **TENT WARRANTY** – Vanguard LLC warrants its Vinyl tents to be free from defect in materials and workmanship for 5 years, under normal use and service, to the original owner.

LIMITED ROOF WARRANTY – Vanguard LLC warrants the Palomino Roof Assembly to be free from substantial defects in materials and workmanship for a period of 5 years, excluding any modification or alterations. There are certain other exclusions to this limited warranty, details of which are included in the actual printed warranty statement. Ask your dealer to let you inspect it.

DEALER



Vanguard LLC

31450 M-86 West • Colon, MI 49040
Phone: (269) 432-3271 • Fax: (269) 432-2516
www.palominorv.com

V-100-092

©2004 Vanguard LLC

Litho U.S.A.