

# ZEPHYR



TIFFIN MOTORHOMES



'05

WHEREVER  
YOU GO, WE GO.





Whether you're traveling to the Mason-Dixon Line in Manchester, Maryland, or the car pool line in Manchester, Georgia, with a Tiffin motorhome, **every trip is a vacation.**

With this kind of quality and luxury, you'll be tempted to take your Tiffin everywhere.



## ZEPHYR COCKPIT



The QUALITY and LUXURY of the Zephyr starts right up front in the cockpit. The EASY-TO-READ GAUGES are all within easy reach of both the driver and front passenger, including the button for ONSTAR<sup>®</sup> service—



just another way to feel confident behind the wheel of a Tiffin. The Ultra leather Flexsteel® captains chairs not only provide unparalleled COMFORT on the road, but they also have integrated seat belts and can be swiveled around for ADDITIONAL SEATING in the living room.

## ZEPHYR LIVING AREA



NOB HILL

Rivaling most home living rooms, the ELEGANT LIVING AREA offers luxury and convenience at their very best, with far MORE CABINETS than those offered by other manufacturers. And each of the cabinets has a SOLID HARDWOOD door.



The BRUSHED NICKEL faucet adds to the durability and appearance of the gourmet galley that houses a convection microwave, SOLID SURFACE countertops and a side-by-side STAINLESS STEEL refrigerator.

## ZEPHYR BEDROOM



Not to be outdone by the rest of the coach, the bedroom in the Zephyr is just as opulent as the rest of the vehicle. A huge KING-SIZE bed, surrounded by meticulously crafted cabinetry and woodwork, dominates the space, while leaving PLENTY OF ROOM to move about.



A sink and vanity are strategically situated along one wall for CONVENIENCE without being a hindrance. A CEDAR-LINED WARDROBE gives you plenty of storage space for your clothes, while the mirrored doors gives the room a more SPACIOUS feel.

## ZEPHYR BATHROOM



The MOEN® accessory package in the bathroom has brushed nickel accents and the separate shower stall and toilet afford PLENTY OF PRIVACY. Along with our frames and cabinets, all fiberglass parts are manufactured locally, helping to ensure the most stringent quality control.

## FABRICS & CABINETS

### GOLDEN GATE



Bedroom



Bedroom Accent



Bedroom Throw

### NOB HILL



Bedroom



Bedroom Accent



Bedroom Throw



Sofa



Living Area Accent



Dinette



Sofa



Living Area Accent



Dinette



Carpet



Carpet



Natural Cherry



Cherry Bark

Our fabric designs and choices of wood grain are sure to suit every taste. All cabinet finishes are available in combination with all fabric schemes.

# EXTERIOR PAINT COLORS



NASA FULL BODY

## ZEPHYR FLOORPLAN '05

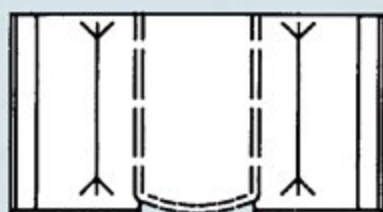

OPTIONAL BOOTH DINETTE



OPTIONAL RECLINER WITH END TABLE / COMPUTER DESK



DRAWERS  
BELOW

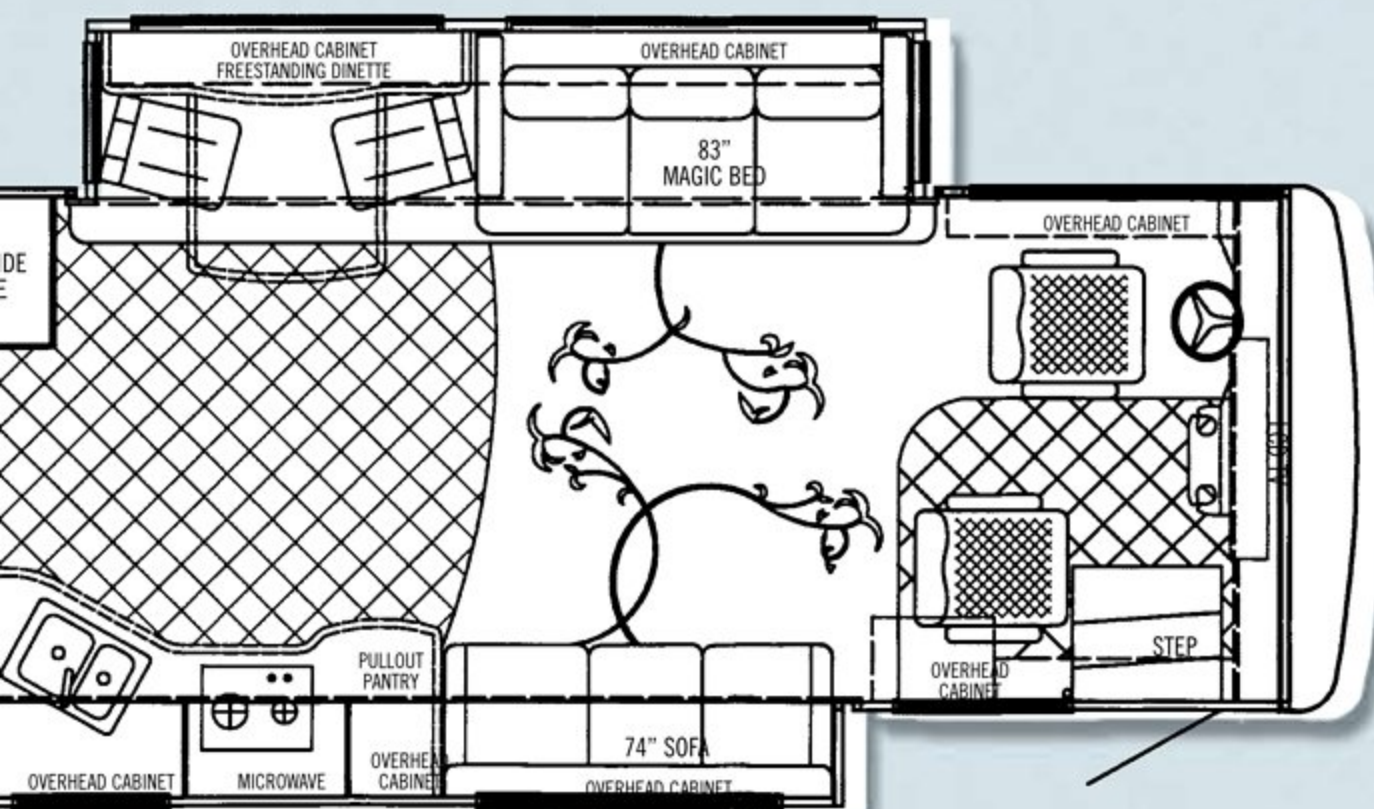

45 QDZ

ADDITIONAL FLOORPLANS MAY BE AVAILABLE ON OUR WEBSITE.  
[www.tiffinmotorhomes.com](http://www.tiffinmotorhomes.com)



SUNLIT SAND FULL BODY

# ZEPHYR SPECIFICATIONS

## AUTOMOTIVE

### STANDARD EQUIPMENT

- 500 HP @ 1,900-2,000 rpm Cummins ISM Engine
- Tag Axle 10,000 lb.
- Michelin Tires
- Aluminum wheels

### STANDARD EQUIPMENT

#### MODEL

#### 45 QDZ

Torque (Lb.-Ft. Max. Net)	1550 @ 1,300
GVWR	44,600
GAWR-Front	14,600
GAWR-Rear	20,000
GCWR	54,600
UVW	36,420
Fuel Tank (gallons)	150
Wheel Base	306"
Tire Size	295/80R22.5
Alternator Amps	270

## OVERALL

#### MODEL

#### 45 QDZ

Overall Length – Approximately	44' 9"
Overall Height with Roof Air (Maximum)	12' 10"
Interior Height	84"
Overall Width	101"
Interior Width	96"
Fresh Water (Gallons)	90
Black Water (Gallons)	46
Grey Water (Gallons)	70
LPG Tank (Gallons; can only be filled to 80% capacity)	24.4
Minimum Garage Height	13'

## STRUCTURAL

### STANDARD EQUIPMENT

- Steel Cockpit Overhead Support Structure
- Steel / Aluminum Laminated Side Walls, Floor & Roof
- Steel Basement Construction
- Seamless One Piece Gel Coat Fiberglass Molded Roof Cap
- 1/2" Laminated Floor Decking
- Insulated Firewall
- One Piece Molded Gel Coat Fiberglass Front & Rear Caps with Integrated Air Intake
- Insulated Roof Duct Laminated into Roof Construction
- Insulated Steel Cage Engine Cover
- Laminated Gel Coat Fiberglass Sidewalls

## EXTERIOR

### STANDARD EQUIPMENT

- One Piece Fiberglass Gel Coat Front & Rear Fenders with Integrated Storage
- Fiberglass Gel Coat Engine Access Door with Swing Out Hinges & Shocks
- One Piece Aluminum Face Baggage Doors with Integrated Power Locks
- Vented Fresh Water Tank for Portable Water Fill
- Pass Through Basement with Pull Out Storage Tray (Both Sides)
- Power Garden Hose Reel
- Phone, 120v & 12v Outlets Inside Storage Compartment
- Outside Shower
- One Piece Pull Out Generator Access Door
- Recessed Docking Lights
- Fiberglass Water Service Center Panel & Compartment
- Recessed Fog Lights
- Three Low Profile Roof Air Conditioners with Heat Pumps
- Spot Light Mounted on Roof
- Easy Hook-Up Water Compartment with Built-in Hose Exits
- Roof Mounted Air Horns
- Multi-Port Manifold System for Hot & Cold Water Lines
- Basement & Outside Compartment Lights
- Hydraulic Heating System with Continuous Hot Water
- Porch Light
- Water Pump Switch Located at Galley, Lavatories & Water Service Compartment
- Lighted Exterior Grab Handles
- Deadbolt Entrance Door Lock
- Keyless Entry System
- Air Gliding Step Cover
- Rear Roof Ladder
- Heavy Duty Rear Hitch
- Full Length "ZEPHYR" Mud Flap
- Side View & Rear Cameras
- TV Antenna
- Electric Power Cord Reel
- 10 KW Generator with Bedroom & Cockpit Start Switches
- 3000 Watt Invertor with Generator Start

## DRIVER'S COMPARTMENT

### STANDARD EQUIPMENT

- Ergonomic Wrap Around Dash with Burl Instrumentation Panels
- Power Steering
- Back Light Lettering for Dash Controls
- Power Sun Visors
- Built-in Driver & Passenger Consoles with Controls
- Driver & Passenger Overhead Fans
- 6-Way Power Driver & Passenger Seating with Co-Pilot Power Footrest
- Pull Down Black-out Screens on Driver/Passenger Windows
- Integrated Pilot & Co-Pilot Seat Belts
- Diamond Pattern Chrome Step Well Area
- Storage Drawers with Built-in Beverage Tray
- ON STAR System
- Smart Wheel with Controls for ICC, Cruise & Windshield Wipers
- Pilot & Co-Pilot Map Lights
- Adjustable Accelerator & Brake Pedals
- Dual 12v Outlets in Dash Area
- Compass with Outside Temperature
- Color Rear Vision Monitor System
- CB Radio with Antenna
- Cellular Phone Antenna
- In-Dash AM/FM Radio & 6-Disc CD Player
- 32" LCD TV over Cockpit Area
- Quick Power Disconnect
- Fire Extinguisher

## LIVING AREA / DINETTE

### STANDARD EQUIPMENT

- Built In Dinette Cabinets with Storage (with free standing table)
- 83" Magic Bed on Driver Side-Cloth
- 74" Ultra Leather Magic Bed on Passenger Side
- Sculptured Carpet in Living Area
- Decorative Wall & Dinette Lighting Package
- Full Length Mirrors in Living Area
- Home Theater System with DVD Player
- VCR & Switching Box
- Carbon Monoxide Detector

MODEL 45 QDZ

- Booth Dinette 0
- Recliner & Computer/End Table on Driver Side 0

## KITCHEN

### STANDARD EQUIPMENT

- Solid Surface Counter Tops with Accent Colors
- 14 Cu. Ft. Side-by-side Refrigerator with Stainless Front & Ice Maker
- Recessed Princess 2-Burner Cook Top with Solid Surface Covers
- Convection Microwave with Stainless Front
- Integrated Solid Surface Galley Sink with Solid Surface Covers
- Solid Surface Splash Guards with Metal Deco Inlays
- Pull-Out Hardwood Pantry with Solid Surface Cutting Board
- Mini Blinds & Hardwood Valance
- Hardwood A/C Return & Galley Light Covers
- Triple Fluorescent Galley Light

MODEL 45 QDZ

- Dishwasher with Hardwood Front 0

## BATH

### STANDARD EQUIPMENT

- Two Lavatories with Medicine Cabinets and Drawers
- Electric Flush Commode
- Integrated Solid Surface Lavatory Sinks
- Mini Blinds & Hardwood Valance
- Solid Surface Shower Walls with Molded Fiberglass Base
- Cosmetic Lights over Lavatories
- Towel Holders, Robe Hook, & Lavatory Accessories Package
- Raised Panel Bath and Pocket Doors

## BEDROOM

### STANDARD EQUIPMENT

- King Bed with Nightstand
- Duvet Package with Pillows
- 22" LCD TV
- Large Wardrobe Closet with Built-in Shelf & Sliding Hardwood/Mirror Doors
- Shirt Closet with Drawers
- Built-in Radio with Clock & CD Player
- Large Carpeted Storage Area beneath Bed
- LP Detector
- Combination Washer/Dryer

MODEL 45 QDZ

- Queen Bed with Chair & Sliding Table 0

## GENERAL INTERIOR

### STANDARD EQUIPMENT

- Wall Mounted Thermostats
- 12 Volt Attic Fans with Wall Mounted Controls
- Cable TV Hook-Up and Phone Jacks
- Solid Hardwood Arch/Raised Panel Doors
- Carpeted Cabinet Shelves
- Ball Bearing Drawer Slides
- In-Motion Digital Satellite System
- Wallpaper Covering on Sidewalls
- Padded Soft Touch Vinyl Ceiling with Recessed & Fluorescent Lights
- Day/Night Pleated Shades with Hardwood Valances Accented with Fabric
- High-gloss Tile Flooring with Metal Deco Inlays
- Built-in Speakers with Matching Hardwood Louvers
- Wall Mounted Switches for Lights & Accessories
- Rope Lights Beneath Galley and Bedroom Vanity Area
- Rope Lights in Window Valances
- 50 Amp Distribution with Surge Protection
- 12 Volt Fuse Panel
- Battery Disconnect Switch
- Smoke Alarm
- GFI Outlets at Galley & Lavatories
- Lighted Interior Grab Handles

MODEL 45 QDZ

- Natural Cherry Cabinetry 0
- Cherry Bark Cabinetry 0

# WHY BUY A TIFFIN MOTORHOME?

## The Best Limited Warranty in the Business

### 10-YEAR UNITIZED CONSTRUCTION WARRANTY

THE STRUCTURAL INTEGRITY OF THE ENTIRE COACH IS GUARANTEED FOR THE NEXT 10 YEARS. THIS INCLUDES WALL SEPARATION AND INNER FRAME WEAKNESS.

### 5-YEAR “HYDRA-VAC” LAMINATION WARRANTY

WE GUARANTEE AGAINST ALL EXTERIOR FIBERGLASS DELAMINATION OR WALL SEPARATION.

We can make these guarantees, and no one else can come close to these, because we take the extra steps and make the extra investment in the building methods and materials that support these extraordinary guarantees. It's not the cheapest way to build motorhomes, but it is the best way. It's the Tiffin way.

## Service After the Sale

The feeling of freedom, of being able to go anywhere you want, is something that can't really be put into words. It's kind of like the feeling you get when buying a Tiffin. It's a freedom, too. A kind of confidence and peace of mind that you just can't get from other manufacturers. We not only stand behind every coach we sell, but we stand behind every customer as well. Because we don't want anything to detract from your unique experiences exploring the world in a Tiffin. So when you slide behind the wheel of one of our motorhomes, just look over your shoulder. There's an entire company riding right there behind you—every mile of the way.

DEALER:

[www.tiffinmotorhomes.com](http://www.tiffinmotorhomes.com)