

# *Grand Sport*

M2 TOURING COACH





350SL, Natural Maple, Terra Cotta  
Shown with optional fabric dinette

**Why settle for ordinary?**

We certainly didn't. Our goal from day one was to design a vehicle that was like no other — one that looks better, drives better and actually is better than the world of look-a-like, box-like buses. And we succeeded. In fact, the Grand Sport M2 has even exceeded our own expectations. It's more drivable, has more power and is more maneuverable than any bus. This is truly a motor coach that's extraordinary.

The Grand Sport M2 Touring Coach.



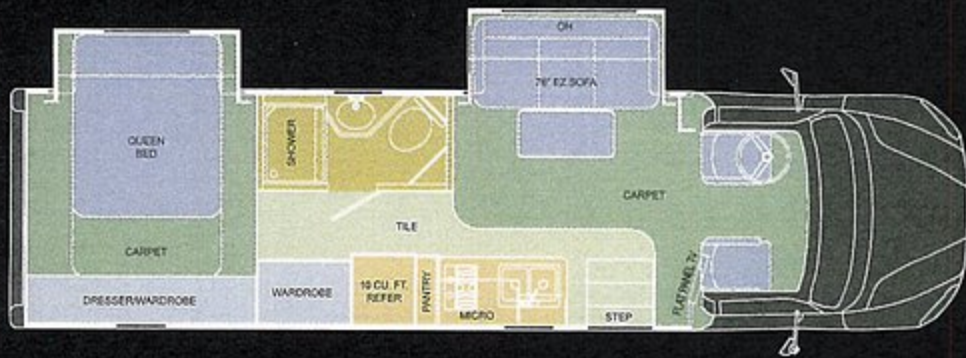

320SL

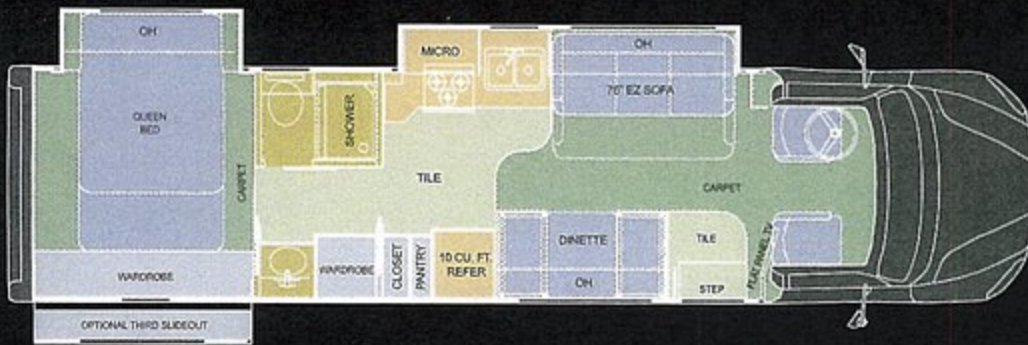

350SL



380SL

Whichever floor plan you choose, you can be sure it's been thoughtfully designed to provide a beautiful, comfortable, convenient living experience — just like home.

The cockpit of the Grand Sport M2 is designed by engineers who understand long distance driving. You can take comfort in the ergonomic seating system, the convenience of having controls close at hand, and the exceptional visibility provided by the panoramic windshield and well-lit dashboard. And the optional GPS navigation system will keep you on the road to your destination.





Cherry



Oak



Natural Maple

**Craftsmanship is in the details.**

Our beautiful cabinetry and wood accents are comparable to what you'd find in the finest homes — made of solid hardwood and crafted with discriminating styling for durability and long-lasting beauty.

**Inner beauty**

Grand Sport engineers and interior designers have created a choice of beautiful fabric environments that not only make you feel at home, but also lend a sense of your personality.

Our engineers and interior designers have also created many beautiful exterior full-body paint packages and interior design environments to help you feel right at home. You can opt to match a full-body paint package with interior upholstery, carpeting, Corian® countertops, window valances and Armstrong® flooring to create one beautifully coordinated package. Or, you can pick and choose from our colors, fabrics and swatches to customize your Grand Sport with a sense of your own personality.



Carpet

Armstrong®  
Flooring

Fabric

Soft Touch  
Upholstery



Terra Cotta



Mink



Stoney Ridge



Whispering Willow



Tan



Terra Cotta

### Color Scheme

Triple the double takes. Our stunning full-body paint packages feature automotive base coat/clear coat technology and are available in your choice of five contemporary color combinations.



Mink



Whispering Willow



Stoney Ridge



Tan

## EXTERIOR FEATURES & CONSTRUCTION

Steel-structured floor framing and cab reinforcement  
Steel floor mounted on rubber isolators  
Square-tube aluminum-framed sidewalls and roof with frame boxes for all through-wall cutouts  
Smooth, fiberglass, vacuum-laminated exterior sidewall panels  
Full fiberglass transition and rear cap  
Exterior four-color base coat/clear-coat paint and graphics  
One-piece radiused, fiberglass roof  
Power step at entry door with automotive-style latch and dead bolt  
Lighted grab handle at entry door  
Screen door at entry door  
Exterior, locking, lighted, storage compartments  
Panoramic bonded/tinted crank-out awning-style windows with screens in coach area  
Four-point fully automatic leveling jacks  
Exterior-rinse hose with soap dispenser and paper-towel holder  
16-ft. patio box awning  
Selected window awnings  
Heated water and holding tanks  
Remote entry for coach entry door  
Power-reel system for 50-amp power cord and fresh-water hose  
Docking lights (8): one left side, one right side, one left rear corner, one right rear corner, two top rear, one left and one right side of license plate  
Outdoor entertainment center  
Air-service line  
Trailer hitch — 14,000-lb. capacity

## DRIVING COMPARTMENT FEATURES

Premium "Soft Touch" driver and passenger Bostrom® air ride captain's chairs  
Power driver and passenger windows  
Intermittent wipers  
Dash-mounted AM/FM/CD/DVD player with motorized monitor and backup camera  
Sirius® satellite radio Plug 'n' Play™ receiver  
Dual, bright, west-coast mirrors; heated and remote (driver and passenger sides)

Tinted windows  
Driver and passenger doors with manual door-wing windows  
Power door locks on driver, passenger and entry doors  
Cruise control  
Air horn  
Tilt and telescope steering column  
Full front-cab sound insulation  
Full instrumentation: speedometer, tachometer, engine-oil temperature, engine-coolant temperature, oil pressure, fuel, ammeter primary and secondary air-pressure gauges, digital volt meter, brake-application air gauge  
Dash-mounted air-restriction indicator  
Trailer-brake hand-control valve  
Hand-held CB radio with mirror-mounted antenna  
Manual air-dump switch  
18-in. charcoal LK™ steering wheel — leather wrapped

## LIVING SPACE FEATURES

23-in. flat-screen TV with remote  
Bose® Life Style™ DVD/Surroundsound system®  
15-in. flat-screen TV with remote in bedroom  
Fully automatic, digital satellite system  
Dometic® 10-cu.-ft. LP/electric double-door refrigerator  
Electric deluxe, three-burner, recessed cook top  
Built-in convection/microwave oven  
Dinette with "Soft Touch" upholstery and hardwood table  
Corian® galley top, large double-bowl sink, sink covers and range cover  
Corian® lavatory sink and countertops  
Choice of: Whispering Willow (Green), Tan, Mink, Terra Cotta (Rust) or Stoney Ridge (Grey) high-style interior-decor packages  
Single-handle galley faucet with pull-out spray head  
120-volt outlet and telephone jack at dinette  
Deluxe, sculpted, wall-to-wall carpet in living and bedroom areas  
Deluxe fabric ceiling  
Day/night pleated shades  
Lambrequin window treatments  
Armstrong® flooring, kitchen/bath  
Flexsteel® premium "Soft Touch" EZ Bed sofa  
Flexsteel® premium "Soft Touch" Euro Lounger with ottoman (380SL)

Choice of oak, cherry or natural-maple cabinetry  
Posi-Lock® door latches  
Nickel bath accessories  
Deluxe medicine cabinet  
One-piece fiberglass shower and surround with skylight  
Glass/nickel-finish shower enclosure and door  
Bedspread and pillows  
Hardwood bedroom and bath doors  
Hardwood night stands  
Night floor lighting throughout  
TV/cable ready  
Safety Features: LPG-leak detector, 12-volt carbon-monoxide detector, smoke detector, fire extinguisher

## COMFORT CONTROL, ENVIRONMENTAL SYSTEMS

Single, digital thermostat for heating and cooling  
Fantastic® vent fan in living area and bedroom — wall controlled, 3 speed and reversible, with temperature control, rain sensor  
Fantastic® vent fan in bathroom and kitchen — wall controlled, 3 speed with rain sensor  
Onan® 7.5 KW Quiet Diesel™ generator  
12-volt water pump  
50-amp, 120-volt service  
Power inverter (2,000 watt)  
Porcelain toilet  
Multi-point water-pump switching  
10-gal. water heater with direct-spark ignition, LP 120-volt  
Dual, low-profile roof AC — 15,000-BTU (each)  
Furnace BTU ratings (320SL- 42k, 350SL- 50k, 380SL- 60k)  
Cable TV and telephone ready

## CHASSIS FEATURES

Freightliner® M-2 conventional cab chassis  
CAT® C7 300-hp @ 2,200 RPM 860 lb./ft. of torque @ 1,440 RPM  
Pac-brake exhaust brake  
1500-watt/115-volt block heater  
Allison® 3,000 TRV automatic six-speed push-button electronic-shift control — dash mounted  
Front — 12,000-lb. front axle with taper-leaf front suspension  
Rear — 21,000-lb. rear axle with Airliner® rear suspension

Rear axle ratio 4.88  
Power steering  
Cast-aluminum wheels (6)  
Full air brakes with Wabco® 4S/4M (ABS)  
Driver-controlled traction differential  
Michelin® XZE 275/80 R22.5 14-ply radial tires  
Daytime running lights  
ICC light switch  
Auxiliary driving lights  
Battery disconnects  
Driver and passenger map lights  
Two (2) 12-volt chassis batteries — 2445 CCA  
Three (3) 12-volt house batteries — 100 amps each  
Electronic battery-control center  
Auxiliary 12-volt dash receptacle  
Engine air conditioning

## OPTIONS

GPS navigation system  
AC/DC portable refrigerator/freezer on slides  
Gerard® power awning with wind sensor  
Fully automatic, digital, in-motion satellite system  
Automatic generator-start control system  
Dual low-profile roof A/C — 15,000-BTU (each) w/heat pumps  
Drawer dishwasher  
Ceramic tile floor  
Washer/dryer combination  
Other options are available — contact your Grand Sport dealer for more information.

## WARRANTY

Conversion has a limited warranty for 3 (three) years or 36,000 miles. Warranty service is available nationwide.  
Chassis — basic vehicle, drivetrain 2 yr./unlimited; cab, frame 5 (five) yr./unlimited. Engine — MBE 250-HP, CAT 300-HP. 5 (five) yr./unlimited miles. (see Freightliner warranty for details).  
Installed appliances and fixtures are warranted by their respective manufacturer.  
Ask your dealer to see a copy of the Dynamax warranty for details.

KEY DIMENSIONS	380SL	350SL	320SL
<b>GVWR:</b>	33,000 lb.	33,000 lb.	33,000 lb.
<b>GCWR:</b>	40,000 lb.	40,000 lb.	40,000 lb.
<b>Overall Length:</b>	38' 0"	35' 0"	32' 4"
<b>Exterior Width:</b>	8' 5"	8' 5"	8' 5"
<b>Wheelbase:</b>	246"	226"	206"
<b>Overall Exterior Height:</b> (includes standard 13,500-BTU roof air conditioner)	11' 8"	11' 8"	11' 8"
<b>Interior Height:</b>	6' 6"	6' 6"	6' 6"
<b>Fuel Capacity:</b>	100 gal.	100 gal.	100 gal.
<b>Water Capacities:</b> Fresh	95 gal.	95 gal.	95 gal.
Grey	43 gal.	43 gal.	43 gal.
Black	43 gal.	43 gal.	43 gal.
<b>LPG Capacity:</b>	38 gal./171 lb.	38 gal./171 lb.	38 gal./171 lb.



A manufacturer of luxury touring vehicles

2745 Northland Dr • P.O. Box 1948 • Elkhart IN 46515  
888-295-7859  
www.dynamaxcorp.com

Actual towing capacity is dependant on your particular loading and towing circumstances, which includes GVWR, GAWR and GCWR, as well as adequate trailer brakes. Please refer to the Owners Manual of your vehicle for further information. Floor plans, features and specifications of the Grand Sport M2 are subject to change without notice.