



MONACO[®]

DRIVING YOUR DREAM.

2006 SIGNATURE SERIES





MONACO[®]

DRIVING YOUR DREAM.

2006 SIGNATURE SERIES







**EPIC LUXURY. LYRICAL STYLING.
DRAMATIC PERFORMANCE. THIS IS POETRY IN MOTION.**

Beyond every wow — beyond every ooh and ah — there is the wordless admiration you save for those rare occasions when you've seen the very best there is. In the world of luxury diesel motorcoaches, this is it. The Signature Series. Yes, it inspires awe. Who knows, it could even inspire you to write a sonnet.

You'll marvel at the spacious interior which is beautifully enhanced by the unique radius ceiling design with Imagicor accent. The floors gleam with high gloss tile, and optional sculptured carpet adds a graceful flourish in the living area.

Power Silhouette® shades raise and lower at the touch of a button.

Throughout the coach you'll enjoy Corian® surfaces and the impeccable ambience of halogen lighting.

- 1 Luxury comes standard on this plush fabric J-lounge with drawer. The matching ottoman also offers generous storage space for games, blankets and other carry-alongs. *(45 Castle IV, Natural Cherry, Tropic Wine)*
- 2 The woodwork reflects Monaco's singular craftsmanship, with hardwood raised panel cabinet doors and decorative hardwood slide-out fascia. *(45 Castle IV, Natural Cherry, Tropic Wine)*





**EPIC LUXURY. LYRICAL STYLING.
DRAMATIC PERFORMANCE. THIS IS POETRY IN MOTION.**

Beyond every wow — beyond every ooh and ah — there is the wordless admiration you save for those rare occasions when you've seen the very best there is. In the world of luxury diesel motorcoaches, this is it. The Signature Series. Yes, it inspires awe. Who knows, it could even inspire you to write a sonnet.

You'll marvel at the spacious interior which is beautifully enhanced by the unique radius ceiling design with Imagicor accent. The floors gleam with high gloss tile, and optional sculptured carpet adds a graceful flourish in the living area.

Power Silhouette® shades raise and lower at the touch of a button.

Throughout the coach you'll enjoy Corian® surfaces and the impeccable ambience of halogen lighting.

- 1 Luxury comes standard on this plush fabric J-lounge with drawer. The matching ottoman also offers generous storage space for games, blankets and other carry-alongs. *(45 Castle IV, Natural Cherry, Tropic Wine)*
- 2 The woodwork reflects Monaco's singular craftsmanship, with hardwood raised panel cabinet doors and decorative hardwood slide-out fascia. *(45 Castle IV, Natural Cherry, Tropic Wine)*





 PANAVIEW™

1-PIECE WINDSHIELD



Our exclusive Panaview™ 1-piece windshield gives you the largest unobstructed view of the road ahead. The wipers are discreetly mounted below your sightline, and the side pillars are more slender, for a wraparound effect. Also conveniently mounted on the front cap are the triple head, heated chrome mirrors with security cameras and turn indicator lights.



 PANAVIEW™

1-PIECE WINDSHIELD



Our exclusive Panaview™ 1-piece windshield gives you the largest unobstructed view of the road ahead. The wipers are discreetly mounted below your sightline, and the side pillars are more slender, for a wraparound effect. Also conveniently mounted on the front cap are the triple head, heated chrome mirrors with security cameras and turn indicator lights.

EVEN THE HIGH TECHNOLOGY IS A HIGHER ART FORM.

In the Signature Series, even the bells and whistles are elegant. As you take control of 500, or even 600 horsepower, you'll have every imaginable advanced system at your fingertips. From GPS navigation to Eaton® VORAD® collision avoidance to the Aladdin™ video coach monitoring, you'll have a heightened perception of every aspect of the coach's performance.

With a Sirius or XM satellite radio, countless varieties of music, news and sports programming will follow you across the country (requires subscription).

We've pulled out all the stops for your entertainment, with a 37" LCD TV mounted in the ceiling, a fully automatic digital satellite system and a Bose® system with DVD player and recessed surround sound speakers.

- 1 Supreme comfort awaits you in the leather heated cockpit seats with six-way power controls, adjustable armrests and electric headrests. The pilot's seat features an electric sliding seat cushion and memory capabilities, while the co-pilot's has an electric footrest. (45 Castle IV, Natural Cherry, Tropic Wine)



EVEN THE HIGH TECHNOLOGY IS A HIGHER ART FORM.

In the Signature Series, even the bells and whistles are elegant. As you take control of 500, or even 600 horsepower, you'll have every imaginable advanced system at your fingertips. From GPS navigation to Eaton® VORAD® collision avoidance to the Aladdin™ video coach monitoring, you'll have a heightened perception of every aspect of the coach's performance.

With a Sirius or XM satellite radio, countless varieties of music, news and sports programming will follow you across the country (requires subscription).

We've pulled out all the stops for your entertainment, with a 37" LCD TV mounted in the ceiling, a fully automatic digital satellite system and a Bose® system with DVD player and recessed surround sound speakers.

- 1 Supreme comfort awaits you in the leather heated cockpit seats with six-way power controls, adjustable armrests and electric headrests. The pilot's seat features an electric sliding seat cushion and memory capabilities, while the co-pilot's has an electric footrest. *(45 Castle IV, Natural Cherry, Tropic Wine)*



IN HERE, YOU'LL FORGET YOU'RE ON WHEELS.

In the luxurious private quarters, we've fashioned every possible detail with residential styling. A bedroom dresser with raised panel drawer faces. A large wardrobe closet. And stunning window treatments with Duette® shades.

A queen island bed with a hinged pillow top mattress is a standard feature, or you may choose the optional king size version. To give you precision control of your bed's firmness, we offer an optional air mattress with digital remote, in either queen or king size.

Naturally, the bedroom also features a remarkable entertainment center, with a 22" LCD TV, a DVD player and a second receiver for the digital satellite system. You'll also enjoy the combination clock radio/stereo/MP3 CD player.

- 1 The beautiful bathroom vanity has a Corian® top with a stylish, integrated sink and ceramic tile backsplash. You'll also appreciate the large Corian® shower with ceramic tile accents, a caddy, and a shower head with volume control.

(45 Castle IV, Natural Cherry, Tropic Wine)



IN HERE, YOU'LL FORGET YOU'RE ON WHEELS.

In the luxurious private quarters, we've fashioned every possible detail with residential styling. A bedroom dresser with raised panel drawer faces. A large wardrobe closet. And stunning window treatments with Duette® shades.

A queen island bed with a hinged pillow top mattress is a standard feature, or you may choose the optional king size version. To give you precision control of your bed's firmness, we offer an optional air mattress with digital remote, in either queen or king size.

Naturally, the bedroom also features a remarkable entertainment center, with a 22" LCD TV, a DVD player and a second receiver for the digital satellite system. You'll also enjoy the combination clock radio/stereo/MP3 CD player.

- 1 The beautiful bathroom vanity has a Corian® top with a stylish, integrated sink and ceramic tile backsplash. You'll also appreciate the large Corian® shower with ceramic tile accents, a caddy, and a shower head with volume control.

(45 Castle IV, Natural Cherry, Tropic Wine)







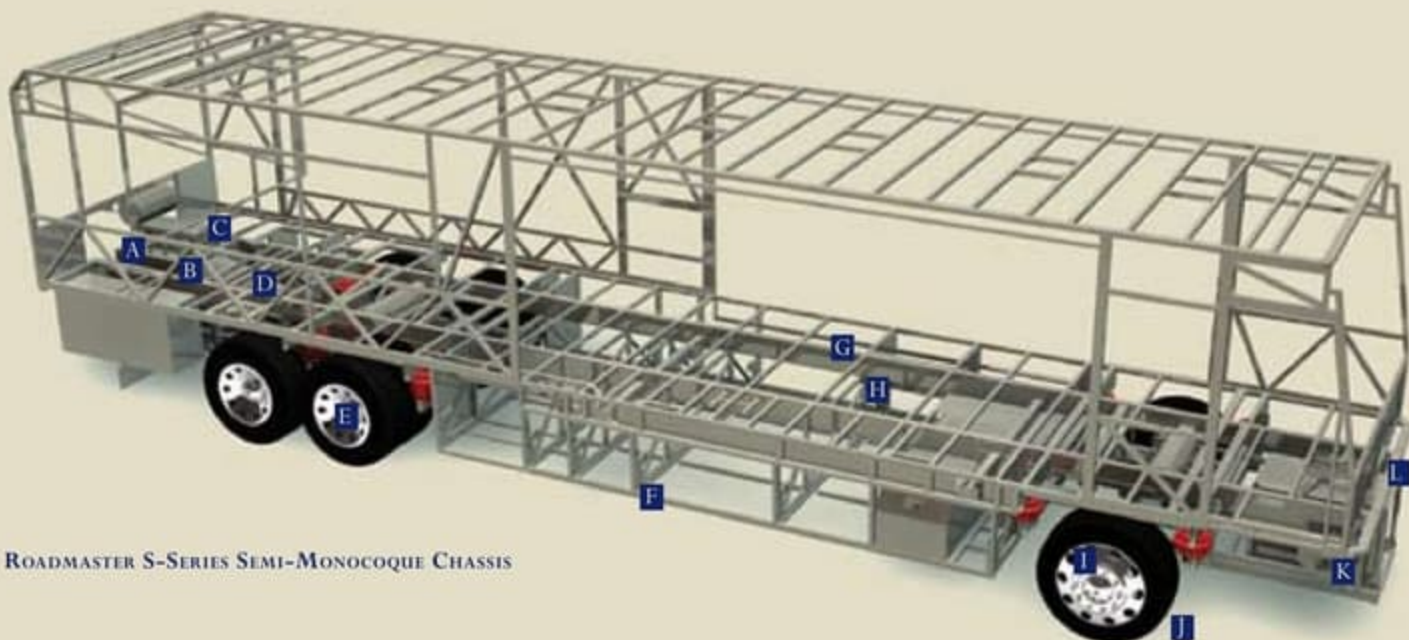

ROADMASTER S-SERIES SEMI-MONOCOQUE CHASSIS

A 10,000 lb. hitch receiver offers powerful towing capacity with 7/4-way trailer plug.

B The three-point engine mounting system lowers the coach's center of gravity and reduces the amount of vibration that reaches the coach. The mounting also makes the engine easier to service by allowing the engine to be easily lowered through the bottom of the coach.

C Cummins® ISM 500 HP engine. The highest power-to-weight ratio in its class and patented Variable Geometry Turbocharger (VG Turbo) give you peak performance at every RPM. For added power, you can choose the optional Series 60 Detroit Diesel 515 engine, Cummins® ISX 525, or Cummins® ISX 600.



D Allison® 4000 MH 6-speed transmission for smooth shifting; our exclusive use of synthetic transmission fluid allows for up to three-year maintenance intervals.

E Cushion Air Glide suspension system positions ten Bilstein® shocks and ten air bags, eight of which are outboard mounted with auto-leveling for greater stability, a smoother ride and the best handling in its class.



Unique three-degree rear axle tilt aligns the engine, transmission and differential, minimizing stress on the drive-train and reducing noise in the coach.

Automatic Traction Control (ATC) eliminates wheel slippage in slick conditions and heightens control.

Tag axle lifts for added maneuverability in tight spots.

F Basement structure rust inhibitor. To prevent corrosion, the basement storage area is constructed with pre-primed steel with rust-inhibiting paint.

G Full-length frame rails fabricated from 3" by 8" by 1/4" 60,000 PSI structural steel; rails are spaced 44" on center for a wider stance and unmatched strength.

H The semi-monocoque design, with trussed superstructure, distributes stress evenly throughout the entire chassis and adds strength to sidewalls and bays.

I Two-stage Jake brake system assures you of safely traveling steep grades while 6-wheel anti-lock brakes with disc brakes in front help you maintain control in severe road conditions.

J P295/80R/22.5 Goodyear steel belted all-season tires ensure a safe and quiet ride (G670 RV tire).

K The truss power steering box allows for a 50-degree front wheel turn angle in both directions for better maneuverability and returns the steering wheel back to its center position to eliminate driver fatigue.

L All chassis are equipped with steel cage construction, steel firewall and steel stepwell for added safety.

OUTBOARD AIR BAG SUSPENSION

The outboard-mounted air bags are protected by two steel plates and are placed approximately 7-1/2 feet apart, providing a wider and more stable platform for the coach. The active suspension automatically adjusts the pressure of the air bags as you drive and virtually eliminates nose-diving and the side-to-side body sway associated with high wind conditions, curvy roads and emergency maneuvers.



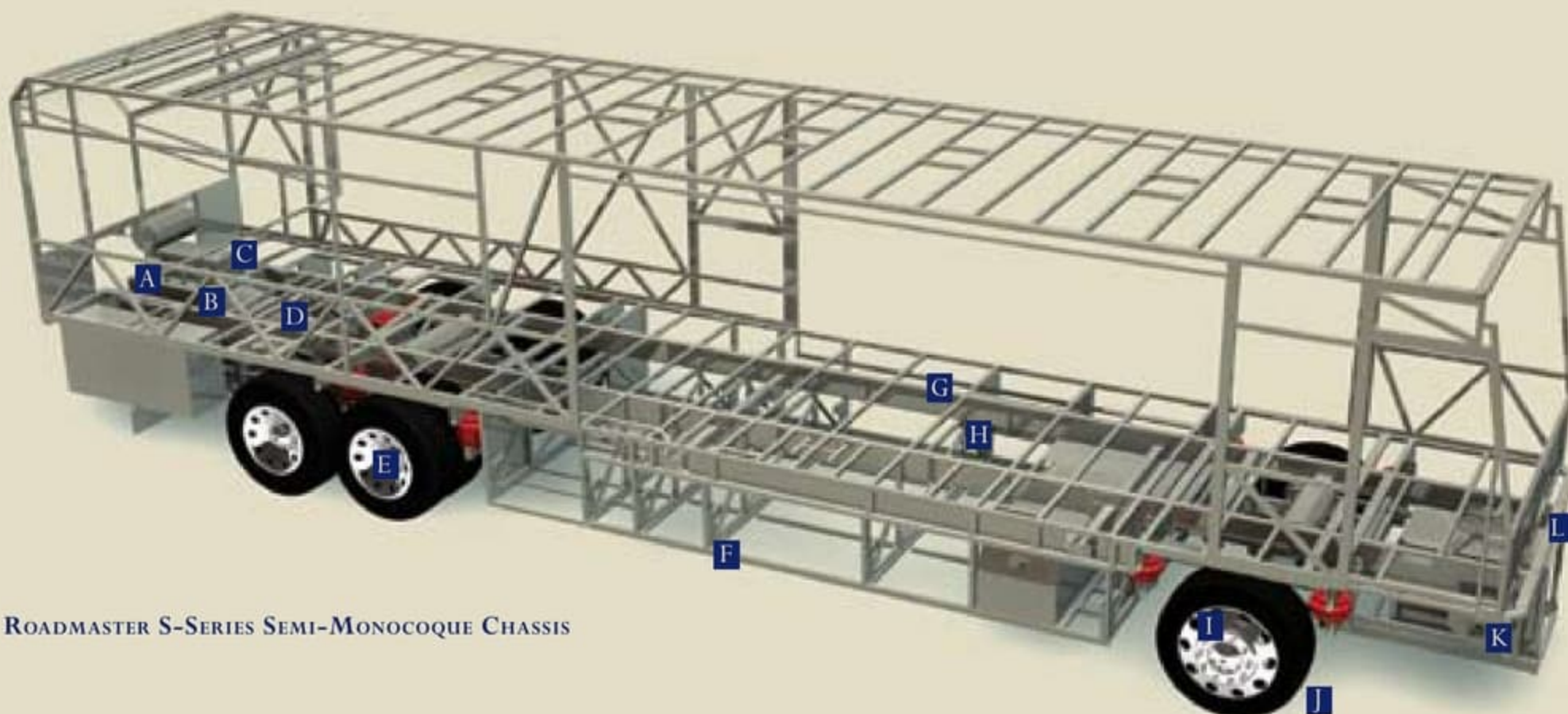

ROADMASTER S-SERIES SEMI-MONOCOQUE CHASSIS

A 10,000 lb. hitch receiver offers powerful towing capacity with 7/4-way trailer plug.

B The three-point engine mounting system lowers the coach's center of gravity and reduces the amount of vibration that reaches the coach. The mounting also makes the engine easier to service by allowing the engine to be easily lowered through the bottom of the coach.

C Cummins® ISM 500 HP engine. The highest power-to-weight ratio in its class and patented Variable Geometry Turbocharger (VG Turbo) give you peak performance at every RPM. For added power, you can choose the optional Series 60 Detroit Diesel 515 engine, Cummins® ISX 525, or Cummins® ISX 600.



D Allison® 4000 MH 6-speed transmission for smooth shifting; our exclusive use of synthetic transmission fluid allows for up to three-year maintenance intervals.

E Cushion Air Glide suspension system positions ten Bilstein® shocks and ten air bags, eight of which are outboard mounted with auto-leveling for greater stability, a smoother ride and the best handling in its class.



Unique three-degree rear axle tilt aligns the engine, transmission and differential, minimizing stress on the drive-train and reducing noise in the coach.

Automatic Traction Control (ATC) eliminates wheel slippage in slick conditions and heightens control.

Tag axle lifts for added maneuverability in tight spots.

F Basement structure rust inhibitor. To prevent corrosion, the basement storage area is constructed with pre-primed steel with rust-inhibiting paint.

G Full-length frame rails fabricated from 3" by 8" by 1/4" 60,000 PSI structural steel; rails are spaced 44" on center for a wider stance and unmatched strength.

H The semi-monocoque design, with trussed superstructure, distributes stress evenly throughout the entire chassis and adds strength to sidewalls and bays.

I Two-stage Jake brake system assures you of safely traveling steep grades while 6-wheel anti-lock brakes with disc brakes in front help you maintain control in severe road conditions.

J P295/80R/22.5 Goodyear steel belted all-season tires ensure a safe and quiet ride (G670 RV tire).

K The truss power steering box allows for a 50-degree front wheel turn angle in both directions for better maneuverability and returns the steering wheel back to its center position to eliminate driver fatigue.

L All chassis are equipped with steel cage construction, steel firewall and steel stepwell for added safety.

OUTBOARD AIR BAG SUSPENSION

The outboard-mounted air bags are protected by two steel plates and are placed approximately 7-1/2 feet apart, providing a wider and more stable platform for the coach. The active suspension automatically adjusts the pressure of the air bags as you drive and virtually eliminates nose-diving and the side-to-side body sway associated with high wind conditions, curvy roads and emergency maneuvers.



5-LAYER FLOORING: (top to bottom)

- Tile, or 1/2" carpet pad and carpeting
- OSB flooring
- Decibel paper
- OSB flooring
- Waterproof Darco underbelly

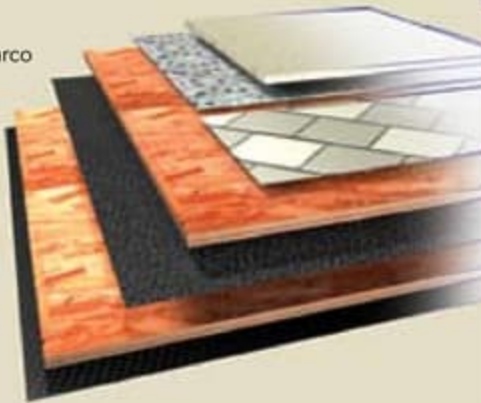

LAMINATED GEL COAT FIBERGLASS SIDEWALLS: (left to right)

- Gel coat fiberglass outer wall
- Luaun paneling
- R 7.5 closed cel foam seals every nook and crevice
- Heavy-gauge tubular steel and 4" sheet metal backers
- Luaun paneling; walls are Vac-U-Bonded together
- Decorative wall coverings



ALL SEASON FOAM INSULATED ROOF: (top to bottom)

- One-piece 1/4" thick fiberglass roof, crowned for water runoff and seamlessly joined with front and rear end caps; non-skid walkways for added convenience
- Vapor barrier
- 3-1/2" tapered bead foam supports the crowned roof; the center tunnel houses wiring and air conditioner ducts
- 1/4" marine grade plywood sheeting
- Tubular steel framework
- R 7.5 closed cel foam seals every nook and crevice
- Luaun and vinyl paneling are Vac-U-Bonded
- Sound-absorbing, easy-to-clean padded vinyl interior headliner

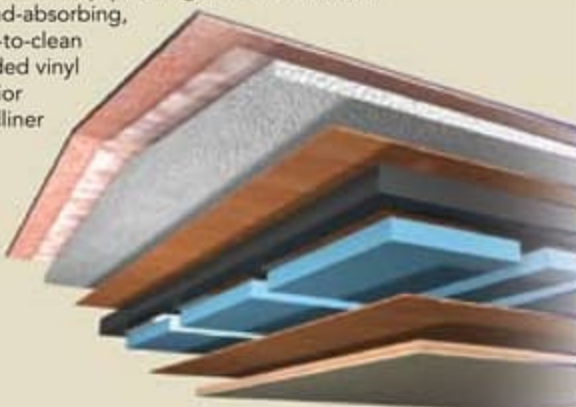

**OUR PHILOSOPHY: DO ONE THING,
AND DO IT BETTER THAN ANYONE.**

The quality of your coach all starts with the chassis on which it's built. Everything from safety and reliability to performance and convenience begins with the chassis you're driving. A division of Monaco Coach Corporation, Roadmaster is the leading high-end diesel chassis manufacturer — because that's all we do. Yes, we have a 100% commitment to producing only chassis for motorhomes. And that's something no other chassis manufacturer can say.

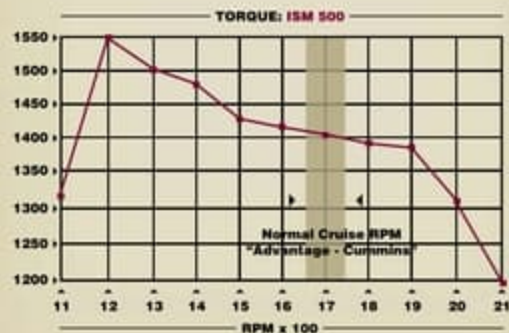

The Signature Series's standard Cummins® ISM 500 HP engine delivers more torque and horsepower when you need it most – for the mountain pass or the passing lane.

5-LAYER FLOORING: (top to bottom)

- Tile, or 1/2" carpet pad and carpeting
- OSB flooring
- Decibel paper
- OSB flooring
- Waterproof Darco underbelly

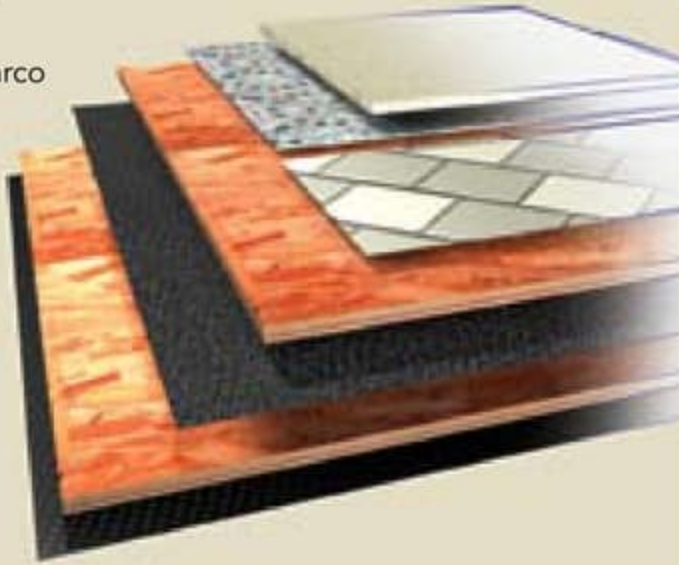

LAMINATED GEL COAT FIBERGLASS SIDEWALLS: (left to right)

- Gel coat fiberglass outer wall
- Luaun paneling
- R 7.5 closed cel foam seals every nook and crevice
- Heavy-gauge tubular steel and 4" sheet metal backers
- Luaun paneling; walls are Vac-U-Bonded together
- Decorative wall coverings



ALL SEASON FOAM INSULATED ROOF: (top to bottom)

- One-piece 1/4" thick fiberglass roof, crowned for water runoff and seamlessly joined with front and rear end caps; non-skid walkways for added convenience
- Vapor barrier
- 3-1/2" tapered bead foam supports the crowned roof; the center tunnel houses wiring and air conditioner ducts
- 1/4" marine grade plywood sheeting
- Tubular steel framework
- R 7.5 closed cel foam seals every nook and crevice
- Luaun and vinyl paneling are Vac-U-Bonded
- Sound-absorbing, easy-to-clean padded vinyl interior headliner

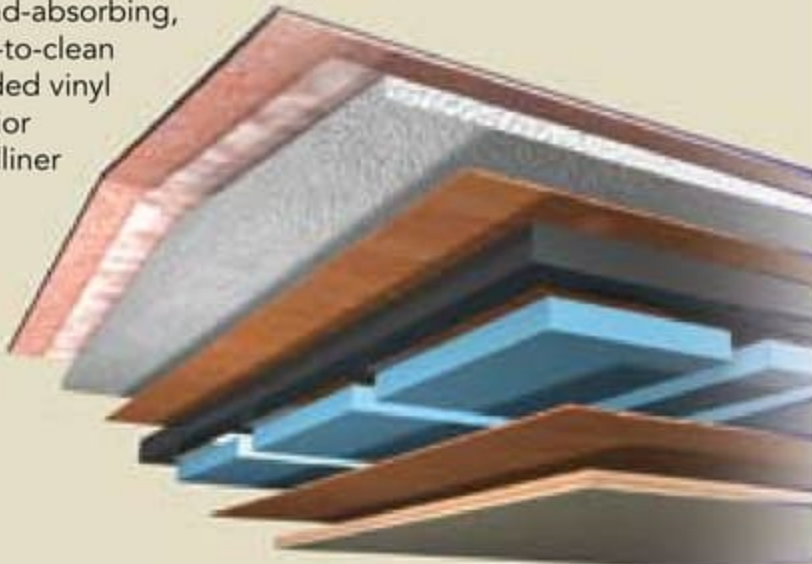

OUR PHILOSOPHY: DO ONE THING,
AND DO IT BETTER THAN ANYONE.

The quality of your coach all starts with the chassis on which it's built. Everything from safety and reliability to performance and convenience begins with the chassis you're driving. A division of Monaco Coach Corporation, Roadmaster is the leading high-end diesel chassis manufacturer — because that's all we do. Yes, we have a 100% commitment to producing only chassis for motorhomes. And that's something no other chassis manufacturer can say.

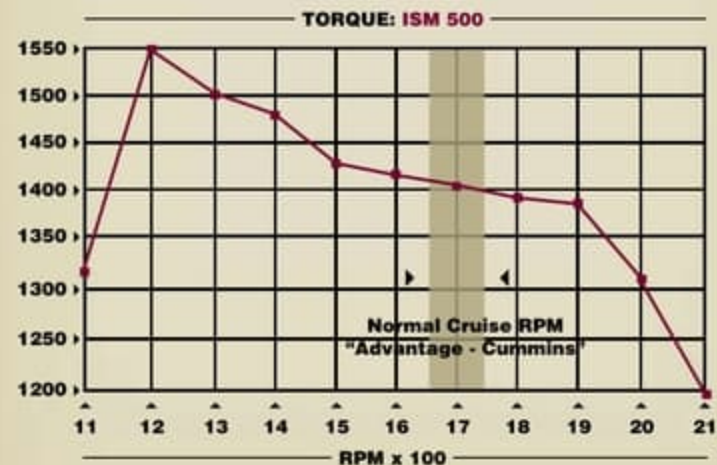
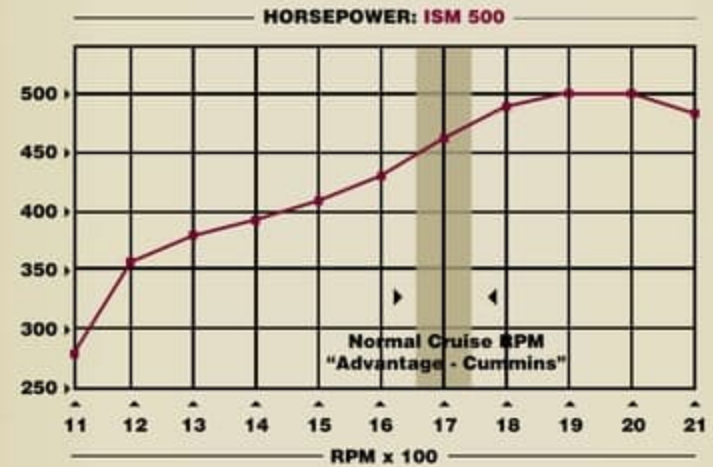

The Signature Series's standard Cummins® ISM 500 HP engine delivers more torque and horsepower when you need it most – for the mountain pass or the passing lane.

**EVERY SWITCH, EVERY LATCH,
EVERY HANDLE CLICKS WITH PRECISION.**

With the Signature Series, Monaco leads the industry to new levels of engineering. Even the less-than-glamorous details remind you of a high performance sports car. We invite you to take a closer look at all the elements of the ultimate motorcoach experience.

Our deluxe full-body paint process gives the coach a rich luster and superior durability. A 3M film front mask comes standard, for additional protection on the road.

A seamless one-piece molded, crowned fiberglass roof offers unbeatable strength and features all-season foam insulation.

Even the chores go more smoothly, thanks to the Super Service Center with hot and cold water faucet, a power water hose reel and the optional RV Sani-Con tank drainage system.

- 1 You'll enjoy the added convenience and security of a keyless entry system with pocket remote. (45 Castle IV, Tropic Wine)
- 2 Thanks to the slide-out trays, there's no need to stretch or strain to reach your items stowed in the large basement storage compartments. (45 Castle IV, Tropic Wine)



**AN IDEA SO SIMPLE,
IT'S AHEAD OF ITS TIME.**

Monaco Coach is proud to be among the first to offer sophisticated Multiplex wiring. This state-of-the-art system utilizes computer technology to streamline the wiring and connect many of the coach's electronic features. This illustration explains how it works, but all you really need to know is that you're going to love the convenience.



BAGGAGE DOORS

The insulated aluminum baggage doors feature the convenience of power locks.

**EVERY SWITCH, EVERY LATCH,
EVERY HANDLE CLICKS WITH PRECISION.**

With the Signature Series, Monaco leads the industry to new levels of engineering. Even the less-than-glamorous details remind you of a high performance sports car. We invite you to take a closer look at all the elements of the ultimate motorcoach experience.

**AN IDEA SO SIMPLE,
IT'S AHEAD OF ITS TIME.**

Monaco Coach is proud to be among the first to offer sophisticated Multiplex wiring. This state-of-the-art system utilizes computer technology to streamline the wiring and connect many of the coach's electronic features. This illustration explains how it works, but all you really need to know is that you're going to love the convenience.



Our deluxe full-body paint process gives the coach a rich luster and superior durability. A 3M film front mask comes standard, for additional protection on the road.

A seamless one-piece molded, crowned fiberglass roof offers unbeatable strength and features all-season foam insulation.

Even the chores go more smoothly, thanks to the Super Service Center with hot and cold water faucet, a power water hose reel and the optional RV Sani-Con tank drainage system.

- 1 You'll enjoy the added convenience and security of a keyless entry system with pocket remote. *(45 Castle IV, Tropic Wine)*
- 2 Thanks to the slide-out trays, there's no need to stretch or strain to reach your items stowed in the large basement storage compartments. *(45 Castle IV, Tropic Wine)*



BAGGAGE DOORS

The insulated aluminum baggage doors feature the convenience of power locks.

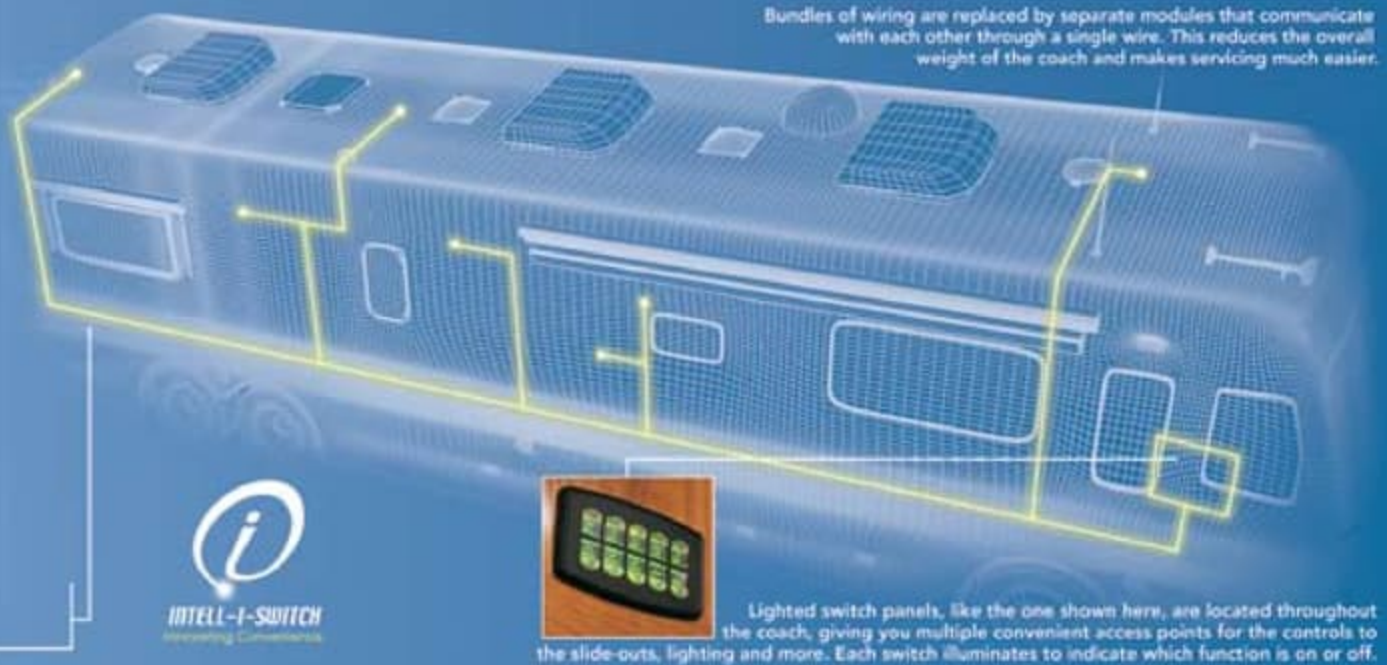

AWNINGS

The full complement of awnings features a roof-mounted Girard® automatic front patio awning. An automatic rear patio awning is just one of the attractive options.

SLIDE-OUTS

You can count on Monaco for the most reliable slide-out construction, with our exclusive interlocking aluminum frame design and multi-layer insulation.

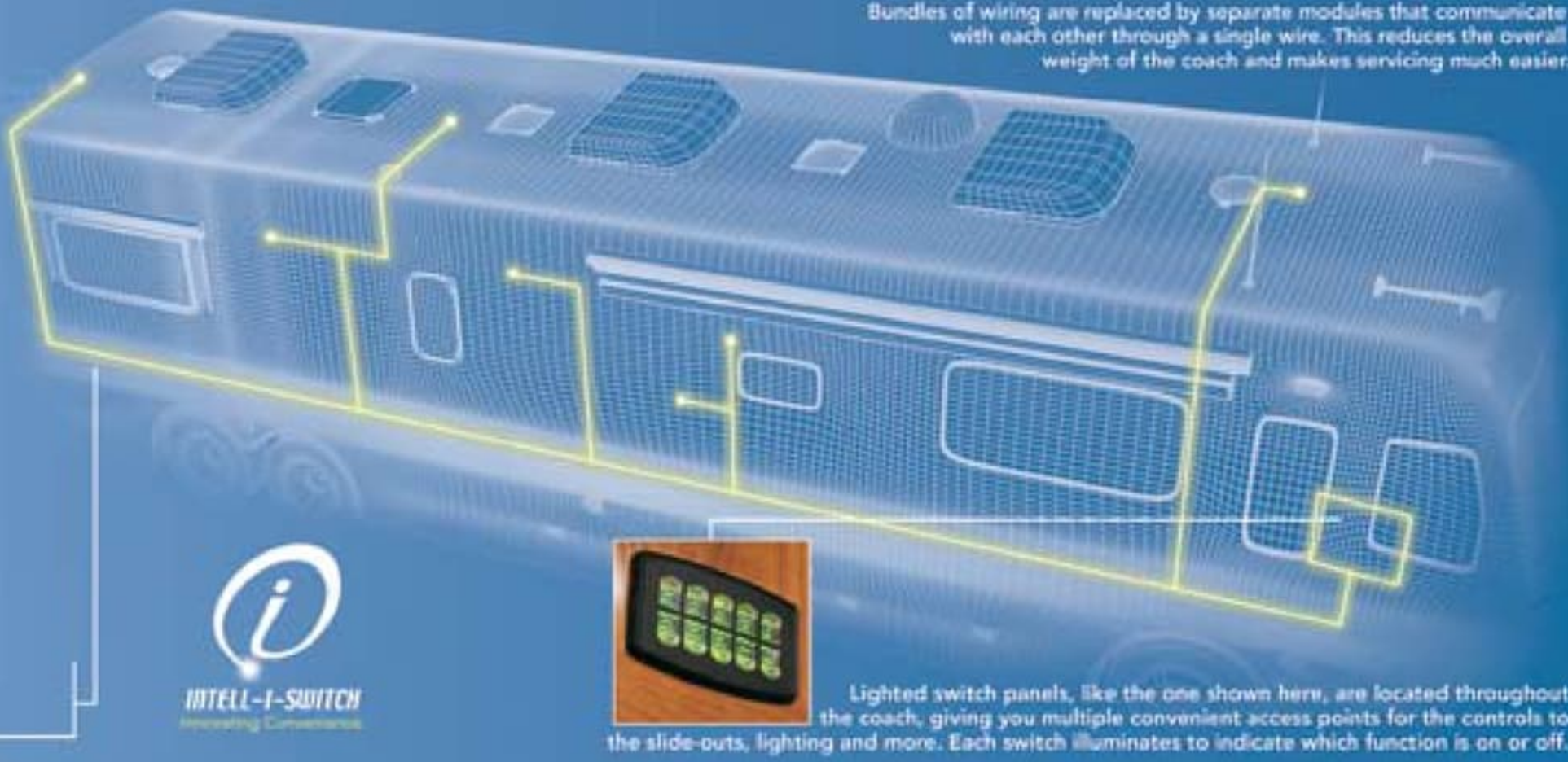

AWNINGS

The full complement of awnings features a roof-mounted Girard® automatic front patio awning. An automatic rear patio awning is just one of the attractive options.

SLIDE-OUTS

You can count on Monaco for the most reliable slide-out construction, with our exclusive interlocking aluminum frame design and multi-layer insulation.

The 2006 Signature Series is available in a remarkable selection of innovative floorplans ranging from 40' to 45', with triple and quad slide-outs. No matter which one you choose, you'll enjoy more livable interior space and more easy-to-reach storage than any other manufacturer has to offer.

 TILE  CARPET

Furniture Options:

- King Island Bed with Pillowtop Hinged Mattress
- Roadside: Glider Recliner with Ottoman
- Roadside: Computer Desk with Leather Euro-Recliner with Cable for Computer Display on TV
- Curbside: Computer Desk with 37" LCD TV (N/A: 44 Conquest III)
- Bathtub

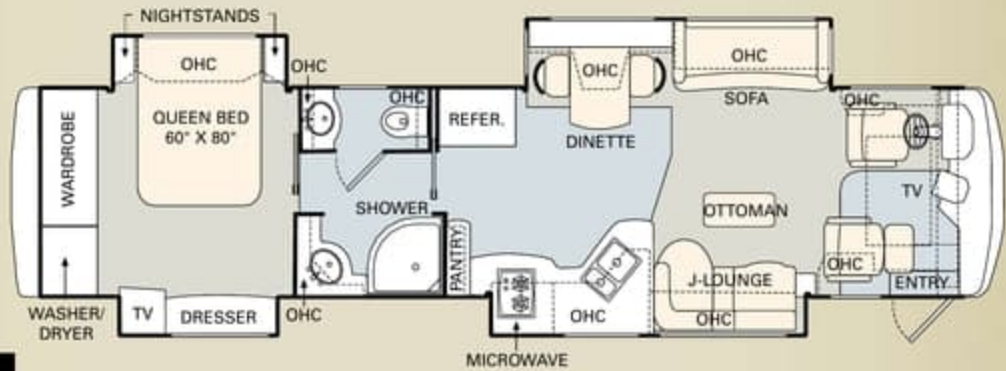

40 PLATINUM IV

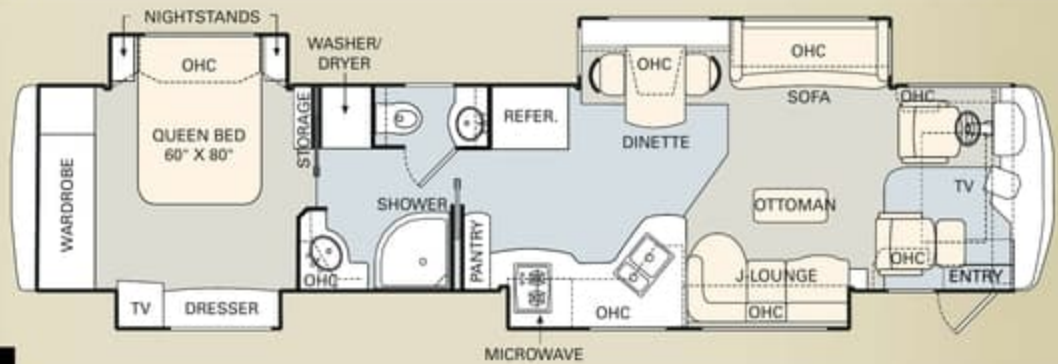

42 CHATEAU IV



44 CARDINAL III

2006 SIGNATURE SERIES

The 2006 Signature Series is available in a remarkable selection of innovative floorplans ranging from 40' to 45', with triple and quad slide-outs. No matter which one you choose, you'll enjoy more livable interior space and more easy-to-reach storage than any other manufacturer has to offer.

TILE
 CARPET

Furniture Options:

- King Island Bed with Pillowtop Hinged Mattress
- Roadside: Glider Recliner with Ottoman
- Roadside: Computer Desk with Leather Euro-Recliner with Cable for Computer Display on TV
- Curbside: Computer Desk with 37" LCD TV (N/A: 44 Conquest III)
- Bathtub

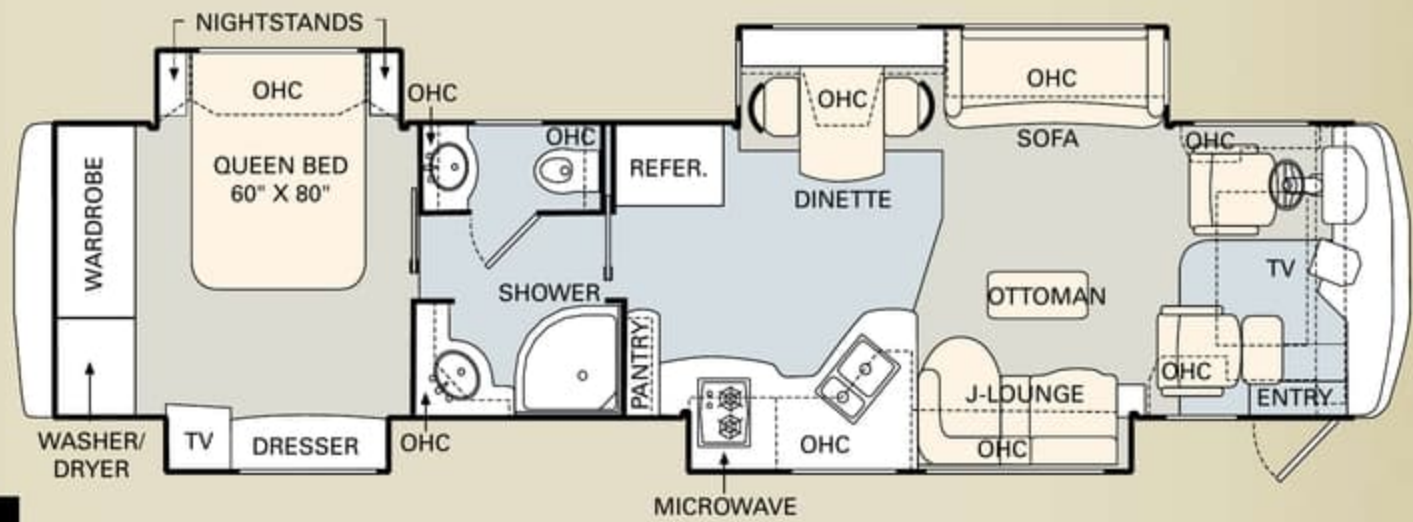

40 PLATINUM IV

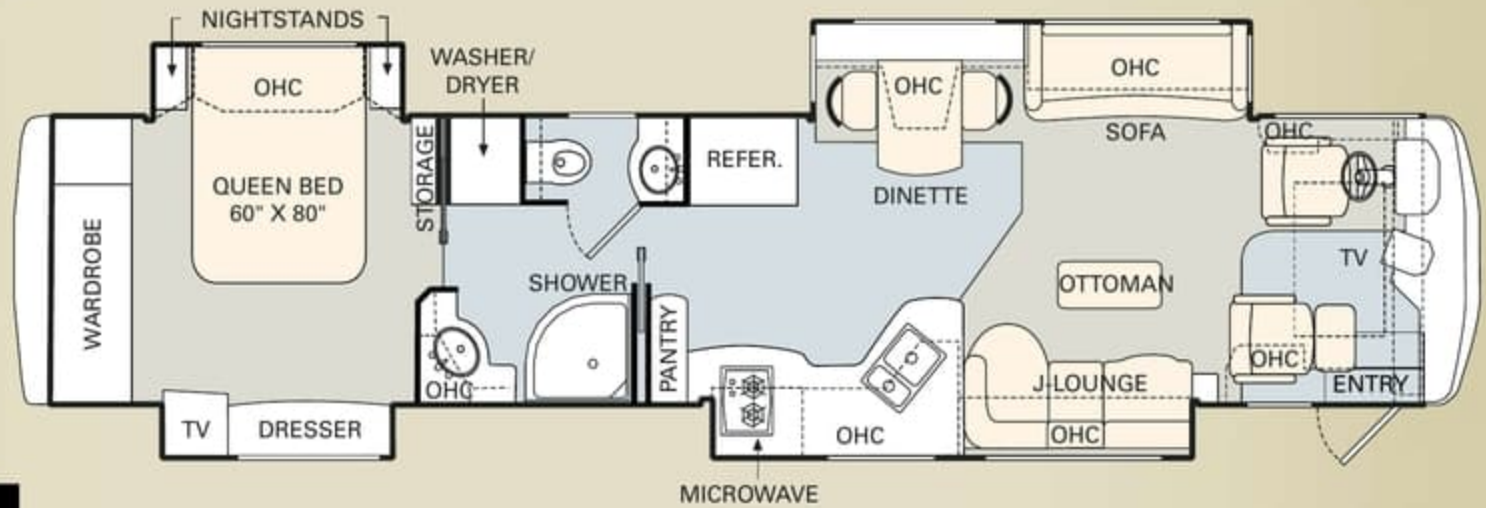

42 CHATEAU IV

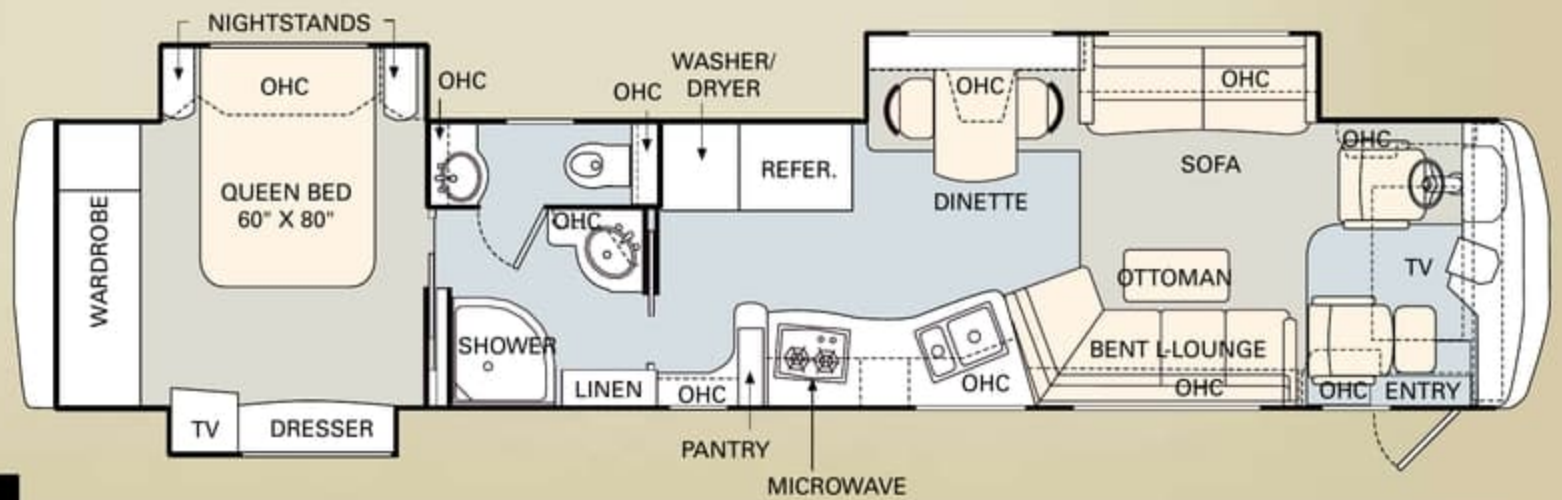

44 CARDINAL III

**WE'RE NEVER MORE THAN
A CLICK AWAY.**

A great way to get the latest product news and updates is by visiting our website at monacocoach.com. The site includes many features, including factory tours, a dealer locator function and information on scheduled club events. Plus, through the site, you may contact us directly at any time.



www.monacocoach.com

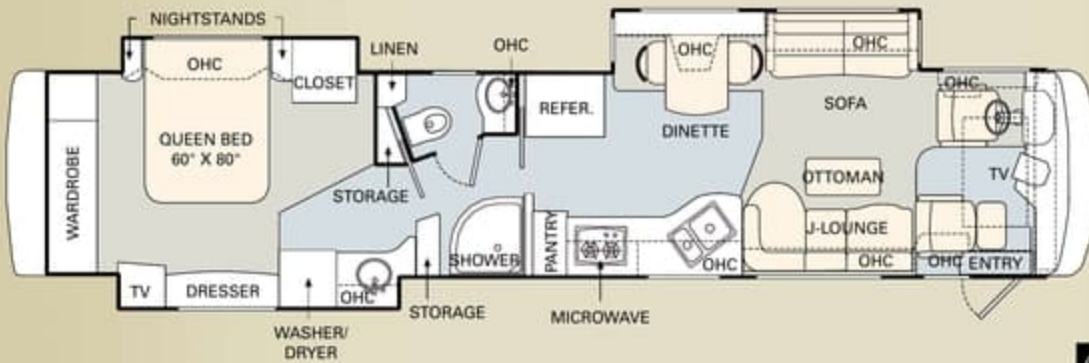

44 CONQUEST III



45 CASTLE IV

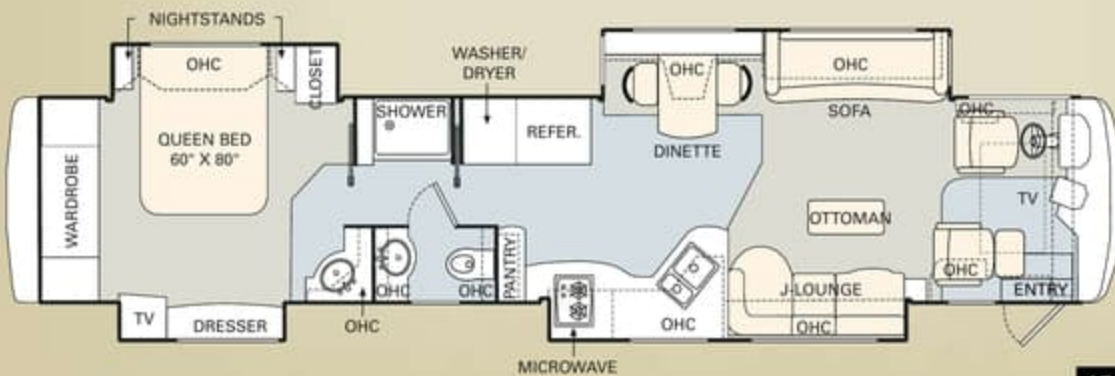

45 COMMANDER IV

**WE'RE NEVER MORE THAN
A CLICK AWAY.**

A great way to get the latest product news and updates is by visiting our website at monacocoach.com. The site includes many features, including factory tours, a dealer locator function and information on scheduled club events. Plus, through the site, you may contact us directly at any time.

www.monacocoach.com

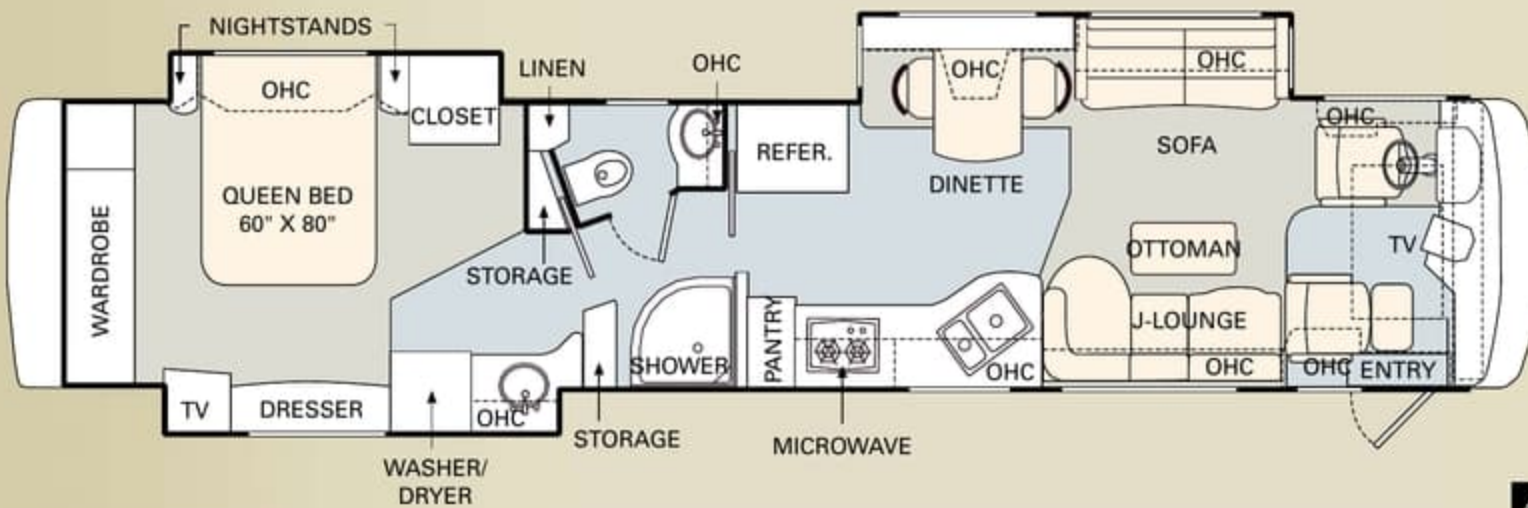

44 CONQUEST III



45 CASTLE IV

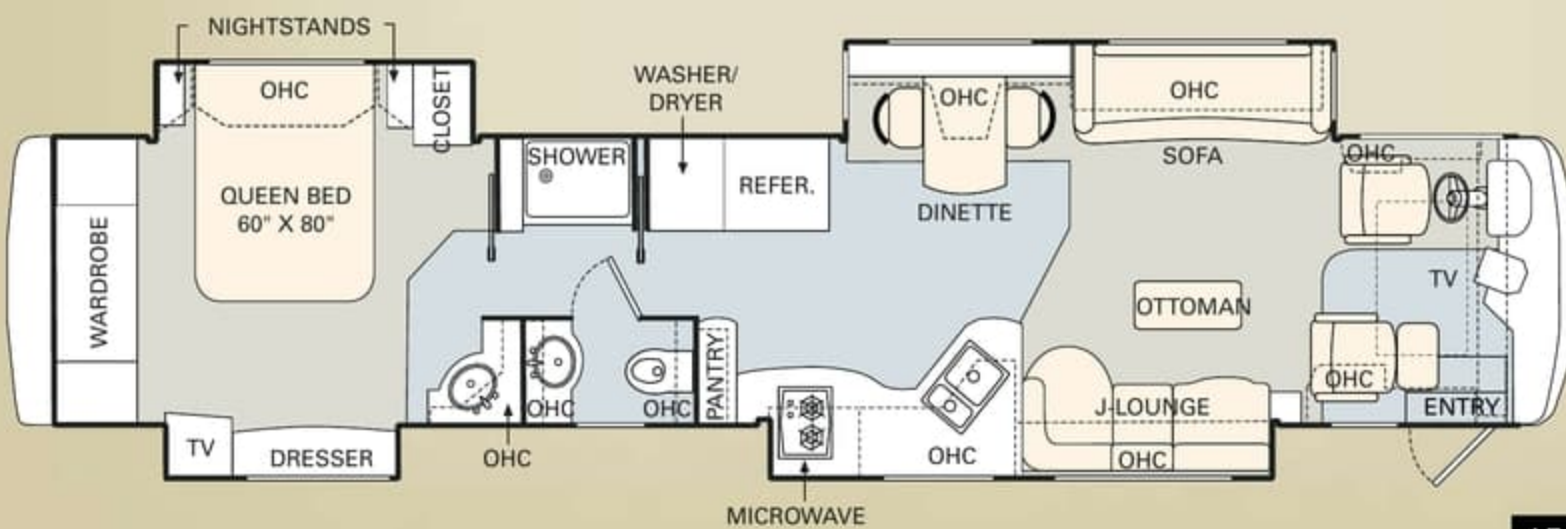

45 COMMANDER IV

2006 SIGNATURE SERIES

When you think Monaco, you think impeccable styling. And 2006 is no exception. No matter where your tastes lie — from traditional to contemporary, conservative to bold — we give you more ways to turn your motorhome into your dream home. The Signature Series is proud to offer the Landsdown II and Black Pearl decors by Ralph Lauren.



- A Carpet
- B Dinette
- C Sofa
- D Bedspread



MALIBU SAND

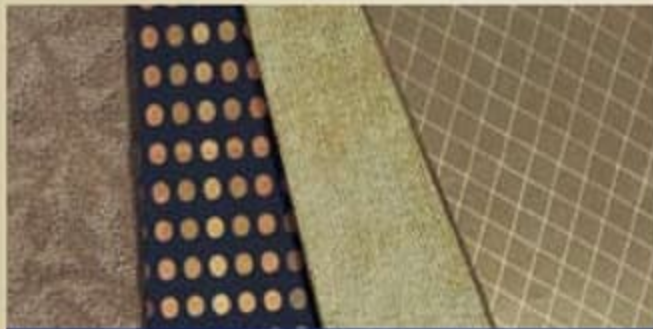

MOSSY GLEN



STERLING SILVER II



NATURAL OAK



STAINED OAK



NATURAL CHERRY



STAINED CHERRY

2006 SIGNATURE SERIES

When you think Monaco, you think impeccable styling. And 2006 is no exception. No matter where your tastes lie — from traditional to contemporary, conservative to bold — we give you more ways to turn your motorhome into your dream home. The Signature Series is proud to offer the Landsdown II and Black Pearl decors by Ralph Lauren.



- A Carpet
- B Dinette
- C Sofa
- D Bedspread



MALIBU SAND



MOSSY GLEN



STERLING SILVER II



NATURAL OAK



STAINED OAK



NATURAL CHERRY



STAINED CHERRY



TROPIC WINE

Coming Soon!



RALPH LAUREN BLACK PEARL



RALPH LAUREN LANDSDOWN II

Note: Colors depicted are a reasonable representation though they may not be an exact match of the actual colors due to variances in processing and production. See your dealer for actual fabric and paint chip samples.



CLASSIC CHERRY



NATURAL MAPLE



SPICED MAPLE

Better Stain Protection

Manufactured in, not added on. For added protection against stains, soil repellent is applied to virtually all upholstery fabric during the finishing process for superior coverage.*

* Brand and application of upholstery fabric protection may vary depending on date recreational vehicle was manufactured.





TROPIC WINE

Coming Soon!



RALPH LAUREN BLACK PEARL



RALPH LAUREN LANDSDOWN II

Note: Colors depicted are a reasonable representation though they may not be an exact match of the actual colors due to variances in processing and production. See your dealer for actual fabric and paint chip samples.



CLASSIC CHERRY



NATURAL MAPLE



SPICED MAPLE

Better Stain Protection

Manufactured in, not added on. For added protection against stains, soil repellent is applied to virtually all upholstery fabric during the finishing process for superior coverage.*



* Brand and application of upholstery fabric protection may vary depending on date recreational vehicle was manufactured.

	Weight Ratings (Lbs.)					Measurements	Tank Capacity (Gal.) ³									
	Gross Vehicle	Gross Combined ¹	Front Gross Axle	Rear Gross Axle	Tag Axle		Wheelbase	Overall Length	Overall Height (with A/C (add 5" for satellite option))	Interior Height	Interior Width	Exterior Width	Gray Tank	Black Tank	Fresh Tank	LP Tank ²
40 PLATINUM IV	47,600	57,600	15,160	23,000	10,000	250.75"	41' 7"	11' 3.5"	82"	96"	100.5"	56	56	100	25	150
42 CHATEAU IV	47,600	57,600	15,160	23,000	10,000	271"	43' 1"	11' 3.5"	82"	96"	100.5"	56	56	100	25	150
44 CARDINAL III	47,600	57,600	15,160	23,000	10,000	278"	44' 7"	11' 3.5"	82"	96"	100.5"	56	56	100	25	150
44 CONQUEST III	47,600	57,600	15,160	23,000	10,000	278"	44' 7"	11' 3.5"	82"	96"	100.5"	56	56	100	25	150
45 CASTLE IV	47,600	57,600	15,160	23,000	10,000	280"	44' 11"	11' 3.5"	82"	96"	100.5"	56	56	100	25	150
45 COMMANDER IV	47,600	57,600	15,160	23,000	10,000	280"	44' 11"	11' 3.5"	82"	96"	100.5"	56	56	100	25	150

1. Towing capacity is limited by GCWR; your vehicle's towing capacity is the difference between the GCWR and the actual vehicle weight, including all water, fuel, passengers and cargo. Your towed vehicle should be equipped with auxiliary brakes if the weight of the towed vehicle exceeds 1,000 lbs. Consult your owner's manual for further towing information.
2. All tank capacities are estimated based upon calculations provided by the tank manufacturers and represent approximate capacities. The actual "usable capacity" may be greater or less than the estimated capacities based upon fabrication and installation of the tanks.
3. Actual filled LP capacity is 80% of listing due to safety shut-off required on tank.

The actual overall length of the recreational vehicle may differ from that indicated in the brochure due to variances in the manufacturing process and/or installed components. The actual length may be greater or less than that indicated. Due to the large variety of options and floorplan arrangements available to our customers, actual weights for each unit can differ significantly. Monaco Coach provides a weight sticker on each unit we produce which includes that unit's tank capacities and approximate weight. Consult your local Monaco Coach dealer for unit availability and further information. The information printed in this brochure reflects product design, fabrication, and component parts at the date of printing. The manufacturer reserves the right, at any time, to make changes in product design or material or component specifications as its sole option, without notice. This includes the substitution of components of a different brand or trade name which will result in comparable performance. All information printed in this brochure is subject to change after the date of printing. Some features shown or mentioned in this brochure are optional and may only be available in selected floorplans. Photographs may show props or decorations that are not standard equipment on Monaco Coach models. Monaco Coach, the Monaco logo and its design, are registered trademarks. All other products and company names are trademarks and/or registered trademarks of their respective holders. While the color of the motorhome's exterior and the interior fabrics depicted in this sales brochure are fair and reasonable depictions, the colors depicted may not be an exact match of the actual colors because of the variances in photo-processing and variances caused by inserting the photographs within the sales brochure. Due to product improvements, changes during the model year and/or transcription errors that may occur, information represented within this brochure may not be accurate at the time of your purchase. If certain information is significant to your purchasing decision, please confirm the information with your dealer prior to submitting your order. Component part and appliance manufacturers issue limited warranties covering those portions of the recreational vehicle not covered by the Limited Warranties issued by Monaco Coach Corporation. To learn which specific component parts and appliances are excluded from the Limited Warranties issued by Monaco Coach Corporation, please contact your selling dealership or Monaco Coach Corporation directly, or review the warranty packet inside the recreational vehicle.

WARRANTIES

12 month/24,000 mile
basic limited warranty

5 year/50,000 mile
limited warranty on aluminum or steel frame
structure of sidewall, roof, front and rear cap

3 year/36,000 mile
limited warranty on Roadmaster chassis

Applies to certain models. See owner's manual for complete details.



THERE'S STRENGTH IN OUR NUMBERS.

As you consider your RV purchase, there's one thing we'd like you to keep in mind: Nobody does customer service like Monaco. Period. Our staff is available 24/7/365 to help you with virtually any situation that may arise — with troubleshooting, operational instruction or facilitating repairs at the nearest of our 350 nationwide service centers. In addition, you'll be enrolled in our Owner Advantage Roadside Assistance Program free of charge for your first year of ownership — providing additional emergency assistance, including towing, tire repairs and many more services around the clock. In short, when you purchase an RV from Monaco Coach Corporation, you get a wider array of benefits than any other manufacturer can offer. To see it all for yourself, call 1-800-634-0855 or 1-800-650-7337 to arrange a tour of one of our state-of-the-art production facilities in Oregon or Indiana.

	Weight Ratings (Lbs.)					Measurements						Tank Capacity (Gal.) ²				
	Gross Vehicle	Gross Combined ¹	Front Gross Axle	Rear Gross Axle	Tag Axle		Wheelbase	Overall Length	Overall Height (with A/C) (add 5" for satellite option)	Interior Height	Interior Width	Exterior Width	Gray Tank	Black Tank	Fresh Tank	LP Tank ³
40 PLATINUM IV	47,600	57,600	15,160	23,000	10,000	250.75"	41' 7"	11' 3.5"	82"	96"	100.5"	56	56	100	25	150
42 CHATEAU IV	47,600	57,600	15,160	23,000	10,000	271"	43' 1"	11' 3.5"	82"	96"	100.5"	56	56	100	25	150
44 CARDINAL III	47,600	57,600	15,160	23,000	10,000	278"	44' 7"	11' 3.5"	82"	96"	100.5"	56	56	100	25	150
44 CONQUEST III	47,600	57,600	15,160	23,000	10,000	278"	44' 7"	11' 3.5"	82"	96"	100.5"	56	56	100	25	150
45 CASTLE IV	47,600	57,600	15,160	23,000	10,000	280"	44' 11"	11' 3.5"	82"	96"	100.5"	56	56	100	25	150
45 COMMANDER IV	47,600	57,600	15,160	23,000	10,000	280"	44' 11"	11' 3.5"	82"	96"	100.5"	56	56	100	25	150

- 1 Towing capacity is limited by GCWR; your vehicle's towing capacity is the difference between the GCWR and the actual vehicle weight, including all water, fuel, passengers and cargo. Your towed vehicle should be equipped with auxiliary brakes if the weight of the towed vehicle exceeds 1,000 lbs. Consult your owner's manual for further towing information.
- 2 All tank capacities are estimated based upon calculations provided by the tank manufacturers and represent approximate capacities. The actual "usable capacity" may be greater or less than the estimated capacities based upon fabrication and installation of the tanks.
- 3 Actual filled LP capacity is 80% of listing due to safety shut-off required on tank.

The actual overall length of the recreational vehicle may differ from that indicated in the brochure due to variances in the manufacturing process and/or installed components. The actual length may be greater or less than that indicated. Due to the large variety of options and floorplan arrangements available to our customers, actual weights for each unit can differ significantly. Monaco Coach provides a weight sticker on each unit we produce which includes that unit's tank capacities and approximate weight. Consult your local Monaco Coach dealer for unit availability and further information. The information printed in this brochure reflects product design, fabrication, and component parts at the date of printing. The manufacturer reserves the right, at any time, to make changes in product design or material or component specifications as its sole option, without notice. This includes the substitution of components of a different brand or trade name which will result in comparable performance. All information printed in this brochure is subject to change after the date of printing. Some features shown or mentioned in this brochure are optional and may only be available in selected floorplans. Photographs may show props or decorations that are not standard equipment on Monaco Coach models. Monaco Coach, the Monaco logo and its design, are registered trademarks. All other products and company names are trademarks and/or registered trademarks of their respective holders. While the color of the motorhome's exterior and the interior fabrics depicted in this sales brochure are fair and reasonable depictions, the colors depicted may not be an exact match of the actual colors because of the variances in photo-processing and variances caused by inserting the photographs within the sales brochure. Due to product improvements, changes during the model year and/or transcription errors that may occur, information represented within this brochure may not be accurate at the time of your purchase. If certain information is significant to your purchasing decision, please confirm the information with your dealer prior to submitting your order. Component part and appliance manufacturers issue limited warranties covering those portions of the recreational vehicle not covered by the Limited Warranties issued by Monaco Coach Corporation. To learn which specific component parts and appliances are excluded from the Limited Warranties issued by Monaco Coach Corporation, please contact your selling dealership or Monaco Coach Corporation directly, or review the warranty packet inside the recreational vehicle.

WARRANTIES

12 month/24,000 mile
basic limited warranty

5 year/50,000 mile
limited warranty on aluminum or steel frame
structure of sidewall, roof, front and rear cap

3 year/36,000 mile
limited warranty on Roadmaster chassis

Applies to certain models. See owner's manual for complete details.



THERE'S STRENGTH IN OUR NUMBERS.

As you consider your RV purchase, there's one thing we'd like you to keep in mind: Nobody does customer service like Monaco. Period. Our staff is available 24/7/365 to help you with virtually any situation that may arise — with troubleshooting, operational instruction or facilitating repairs at the nearest of our 350 nationwide service centers. In addition, you'll be enrolled in our Owner Advantage Roadside Assistance Program free of charge for your first year of ownership — providing additional emergency assistance, including towing, tire repairs and many more services around the clock. In short, when you purchase an RV from Monaco Coach Corporation, you get a wider array of benefits than any other manufacturer can offer. To see it all for yourself, call 1-800-634-0855 or 1-800-650-7337 to arrange a tour of one of our state-of-the-art production facilities in Oregon or Indiana.

BODY CONSTRUCTION

Heavy-Duty Steel Superstructure with Steel Cage Cockpit Construction
Seamless One-Piece Molded Crowned Fiberglass Roof

All-Season Foam Insulated Roof
Laminated Gel Coat Fiberglass Walls
Five-Layer Flooring with Two Layers OSB Flooring

Deluxe Full-Body Paint
One-Piece Windshield

Triple Head Power Controlled Heated Chrome Exterior Mirrors with Security Cameras and Turn Indicator Lights

Halogen Fog Lamps
Daytime Running Lights
Recessed Side Docking Lights
Dual Trumpet Air Horns
Insulated Aluminum Baggage Doors with Power Locks
Lined Pass-Through Storage Compartments
Interlocking Aluminum Framed Slide-Out Houses
Interior Paneling with 1-1/2" Insulation
Storage Bay Slide-Out Tray (One Side)

Storage Bay Slide-Out Tray (Full Pass-Through)
Rear Ladder
Monaco Full-Length Mud Flap with Stainless Steel Logo
Electric Bay Door Latches
3M Film Front Mask

OPTIONS

Electric Slide-Out Storage Trays (Complete Pass-Through)
Exterior Sunscreens

CHASSIS/ENGINE/SUSPENSION

Roadmaster S-Series:

Semi-Monocoque Chassis

Cummins® ISM 500 HP Engine with Allison® 4000 MH 6-Speed World Transmission and Electronic Shifter
Torque: (@1,300 RPM) 1,450 lbs./ft.
Max. Net (Torque will be 1,550 lbs./ft. built after August 2005)

Engine Displacement: 661" / 11.0L

Dual Fuel Fill

270 Amp Alternator

Rear Axle Ratio: 4.30:1

Tires: 295/80R/22.5

Polished Aluminum Wheels

Full-Cushion Air Glide Suspension with Ten Outboard Air Bags and Ten Bilstein® Shock Absorbers

Air Suspension with Ping Tank

Automatic Traction Control

Air Disc Brake System with ABS
Tag Axle with Anti-Lock Braking System
Auto Slack Adjusters on Brakes
Two-Stage Jacobs Engine Brake
Pre-Wire for Supplemental Braking System
Engine Block Heater with Switch on Dash
Automatic Air Leveling System
Undercoating
10,000 Lb. Hitch Receiver and 7/4-Way Trailer Plug
Remote Inflation Connector

OPTIONS

Series 60 Detroit Diesel 515 HP Engine with Allison® 4000 MH 6-Speed World Transmission and Electronic Shifter; Torque: 1,650 lbs./ft.; Engine Displacement: 858" Cu. In.

Cummins® ISX 525 HP Engine with Allison® 4000 MH 6-Speed World Transmission and Electronic Shifter; Torque: 1,650 lbs./ft.; Engine Displacement: 912" Cu. In.

Cummins® ISX 600 HP Engine with Allison® 4000 MH 6-Speed World Transmission and Electronic Shifter; Torque: 1,850 lbs./ft.; Engine Displacement: 912" Cu. In.

ADC RV 2-Position Adjustable Shock System

Hydraulic Leveling System

Dual Leveling System (Air/Hydraulic)

COCKPIT

Fiberglass Automotive Dash with Eagle Burl Instrumentation Panel, White Dash Gauges with Black Lettering and Gold Bezels

In-Dash Stereo with AM/FM Stereo with Multi-Disc CD Changer

GPS Navigational System

Color Rear Vision System

Rear Vision Camera with Airline to Eliminate View Obstruction

Aladdin™ Video Coach System with On/Momentary Switch with Security Cameras, Integrated Compass and Temperature Gauge

CB Radio Prep

Vienna by Verosol Power Window Blinds

Power Sunvisors

Pilot and Co-Pilot Side Window

Manual Sunscreens

Adjustable Brake and Accelerator Pedals

Lighted VIP Smartwheel® with Controls for Windshield Wiper System, ICC and Cruise Control

Audible Turn Signals

Cruise Control Light on Dash

Leather Pilot and Co-Pilot Seats with 6-Way Power Adjustments/Heated/Integrated 3-Point Seat Belts/Adjustable Armrests, Electric Headrests; Power Footrest on Co-Pilot Seat; Electric Sliding Seat Cushion and Memory Capabilities on Pilot Seat

12V and 110V Outlet at Dash

Carpeted Driver and Passenger Floor Mats

OPTIONS

Extra-Wide Co-Pilot Seat with Power Footrest

CB Radio with Antenna

XM Satellite Stereo (Requires Subscription)

Sirius Satellite Radio System (Requires Subscription)

BODY CONSTRUCTION

Heavy-Duty Steel Superstructure with Steel Cage Cockpit Construction
Seamless One-Piece Molded Crowned Fiberglass Roof
All-Season Foam Insulated Roof
Laminated Gel Coat Fiberglass Walls
Five-Layer Flooring with Two Layers OSB Flooring
Deluxe Full-Body Paint
One-Piece Windshield
Triple Head Power Controlled Heated Chrome Exterior Mirrors with Security Cameras and Turn Indicator Lights

Halogen Fog Lamps
Daytime Running Lights
Recessed Side Docking Lights
Dual Trumpet Air Horns
Insulated Aluminum Baggage Doors with Power Locks
Lined Pass-Through Storage Compartments
Interlocking Aluminum Framed Slide-Out Houses
Interior Paneling with 1-1/2" Insulation
Storage Bay Slide-Out Tray (One Side)

Storage Bay Slide-Out Tray (Full Pass-Through)
Rear Ladder
Monaco Full-Length Mud Flap with Stainless Steel Logo
Electric Bay Door Latches
3M Film Front Mask

OPTIONS

Electric Slide-Out Storage Trays (Complete Pass-Through)
Exterior Sunscreens

CHASSIS/ENGINE/SUSPENSION

Roadmaster S-Series:
Semi-Monocoque Chassis
Cummins® ISM 500 HP Engine with Allison® 4000 MH 6-Speed World Transmission and Electronic Shifter
Torque: (@1,300 RPM) 1,450 lbs./ft. Max. Net (Torque will be 1,550 lbs./ft. built after August 2005)
Engine Displacement: 661"/ 11.0L
Dual Fuel Fill
270 Amp Alternator
Rear Axle Ratio: 4.30:1
Tires: 295/80R/22.5
Polished Aluminum Wheels
Full-Cushion Air Glide Suspension with Ten Outboard Air Bags and Ten Bilstein® Shock Absorbers
Air Suspension with Ping Tank
Automatic Traction Control

Air Disc Brake System with ABS
Tag Axle with Anti-Lock Braking System
Auto Slack Adjusters on Brakes
Two-Stage Jacobs Engine Brake
Pre-Wire for Supplemental Braking System
Engine Block Heater with Switch on Dash
Automatic Air Leveling System
Undercoating
10,000 Lb. Hitch Receiver and 7/4-Way Trailer Plug
Remote Inflation Connector

OPTIONS

Series 60 Detroit Diesel 515 HP Engine with Allison® 4000 MH 6-Speed World Transmission and Electronic Shifter; Torque: 1,650 lbs./ft.; Engine Displacement: 858" Cu. In.
Cummins® ISX 525 HP Engine with Allison® 4000 MH 6-Speed World Transmission and Electronic Shifter; Torque: 1,650 lbs./ft.; Engine Displacement: 912" Cu. In.
Cummins® ISX 600 HP Engine with Allison® 4000 MH 6-Speed World Transmission and Electronic Shifter; Torque: 1,850 lbs./ft.; Engine Displacement: 912" Cu. In.
ADC RV 2-Position Adjustable Shock System
Hydraulic Leveling System
Dual Leveling System (Air/Hydraulic)

COCKPIT

Fiberglass Automotive Dash with Eagle Burl Instrumentation Panel, White Dash Gauges with Black Lettering and Gold Bezels
In-Dash Stereo with AM/FM Stereo with Multi-Disc CD Changer
GPS Navigational System
Color Rear Vision System
Rear Vision Camera with Airline to Eliminate View Obstruction
Aladdin™ Video Coach System with On/Momentary Switch with Security Cameras, Integrated Compass and Temperature Gauge
CB Radio Prep
Vienna by Verosol Power Window Blinds
Power Sunvisors

Pilot and Co-Pilot Side Window
Manual Sunscreens
Adjustable Brake and Accelerator Pedals
Lighted VIP Smartwheel® with Controls for Windshield Wiper System, ICC and Cruise Control
Audible Turn Signals
Cruise Control Light on Dash
Leather Pilot and Co-Pilot Seats with 6-Way Power Adjustments/Heated/Integrated 3-Point Seat Belts/Adjustable Armrests, Electric Headrests; Power Footrest on Co-Pilot Seat; Electric Sliding Seat Cushion and Memory Capabilities on Pilot Seat
12V and 110V Outlet at Dash
Carpeted Driver and Passenger Floor Mats

OPTIONS

Extra-Wide Co-Pilot Seat with Power Footrest
CB Radio with Antenna
XM Satellite Stereo (Requires Subscription)
Sirius Satellite Radio System (Requires Subscription)

APPLIANCES AND ACCESSORIES

Four-Door Refrigerator with Ice Maker and Raised Panel Doors
 Recessed High-Output 2-Burner Cooktop with Flush-Mount Covers
 Spacesaver Convection Microwave with Touch Control
 Manual TV Antenna with "Antenna Up" Light on Dash
 Fully Automatic Digital Satellite System Second Receiver in Bedroom

37" LCD TV Mounted in Living Area Ceiling
 22" LCD Flatscreen TV with Built-In Tuner in Bedroom
 Bedroom Stereo/CD/Clock Radio
 Bose® Sound System with DVD Player and Recessed Surround Sound Speakers
 Bedroom DVD Player
 Universal Remote System
 Combination Washer/Dryer

OPTIONS

Residential Refrigerator with 4 Additional Batteries
 Stack Washer/Dryer (N/A: 40 Platinum IV, 44 Conquest III)
 Dishwasher Drawer
 In-Motion Digital Satellite System
 Exterior Entertainment Center with 20" LCD TV with IR Repeater, AM/FM/CD/DVD/MP3 Player, Two 4" Speakers

INTERIOR

Stained or Natural Oak Cabinetry
 Lined Cabinet Shelves
 Dinette Wall Cabinet with Solid Surface Top
 Built-In Storage Area for Kitchen Countertop Covers
 Bedroom Dresser with Raised Panel Drawer Faces
 Clothing Hamper in Bedroom
 Low-Friction Roller Drawer Guides
 Radiused Padded Vinyl Ceiling Design with Imagicor Accent in Living Room and Bedroom
 Corian® Countertops Throughout with Serpentine, Dripless Edge
 Integrated Corian® Sinks in Vanity and Galley
 Ceramic Tile Backsplash in Galley and Bath Areas

Glass Splash Guard at Living Room Side of Kitchen Countertop
 Power Silhouette® Shades in Living Room and Dining Area
 Duette® Day/Night Shades, Valances and Lambrequins in Bedroom
 Designer Vinyl Wallpaper Throughout
 Corian® Cutting Board
 Two-Tiered Silverware Drawer Divider
 Designer Textured Carpet in Living Area and Bedroom
 High-Gloss Tile Floors in Galley and Bath
 High-Gloss Tile Flooring in Cockpit Area
 Raised Panel Door for Private Bath
 Bedspread and Pillows
 Nightstands with Corian® Countertops
 Corian® Windowsills in Living Area
 Decorative Cabinetry Hardware
 Decorative Hardwood Slide-Out Fascia

OPTIONS

Interior Decors: Sterling Silver II, Malibu Sand, Mossy Glen, Tropic Wine
 Ralph Lauren Decors: Landsdown II, Black Pearl
 Spiced or Natural Maple, and Natural, Stained or Classic Cherry Cabinetry
 Large Bay Window in Living Area (Replaces Living Area Overheads on Driver and Passenger Sides)
 Sculptured Carpet Design in Living Room
 Plank Flooring in Kitchen and Bath
 Open Bath (42 Chateau IV)
 Above-Countertop Vanity Sink
 Bathtub

FURNITURE

Legless Side-Slide Solid Surface Dinette Table with Two Freestanding Dinette Chairs and Two Folding Chairs
 Roadside: Fabric Sleeper Sofa
 Curbside: Fabric J-Lounge with Drawer and Ottoman with Storage
 Additional Bedroom Wardrobe (44 Conquest III)
 Queen Island Bed with Pillowtop Hinged Mattress

OPTIONS

King Island Bed with Pillowtop Hinged Mattress (44 Conquest III)
 Queen Air Mattress with Digital Remote
 King Air Mattress with Digital Remote (44 Conquest III)
 Roadside: Leather Euro-Recliner with Ottoman
 Roadside: Glider Recliner with Ottoman
 Curbside: Leather J-Lounge with Drawer
 Roadside: Leather Sleeper Sofa with Drawer

Roadside: Computer Desk with Leather Euro-Recliner with Cable for Computer Display on TV
 Curbside: Computer Desk with 37" LCD TV (N/A: 44 Conquest III)
 Bank of Drawers with Shelves Above (44 Conquest III, 45 Commander IV)
 Booth Dinette
 Sectional Booth Dinette and New Galley
 Computer Desk in Bedroom with Bedroom Chair (44 Conquest III)

APPLIANCES AND ACCESSORIES

Four-Door Refrigerator with Ice Maker and Raised Panel Doors
 Recessed High-Output 2-Burner Cooktop with Flush-Mount Covers
 Spacesaver Convection Microwave with Touch Control
 Manual TV Antenna with "Antenna Up" Light on Dash
 Fully Automatic Digital Satellite System
 Second Receiver in Bedroom

37" LCD TV Mounted in Living Area Ceiling
 22" LCD Flatscreen TV with Built-In Tuner in Bedroom
 Bedroom Stereo/CD/Clock Radio
 Bose® Sound System with DVD Player and Recessed Surround Sound Speakers
 Bedroom DVD Player
 Universal Remote System
 Combination Washer/Dryer

OPTIONS

Residential Refrigerator with 4 Additional Batteries
 Stack Washer/Dryer (N/A: 40 Platinum IV, 44 Conquest III)
 Dishwasher Drawer
 In-Motion Digital Satellite System
 Exterior Entertainment Center with 20" LCD TV with IR Repeater, AM/FM/CD/DVD/MP3 Player, Two 4" Speakers

INTERIOR

Stained or Natural Oak Cabinetry
 Lined Cabinet Shelves
 Dinette Wall Cabinet with Solid Surface Top
 Built-In Storage Area for Kitchen Countertop Covers
 Bedroom Dresser with Raised Panel Drawer Faces
 Clothing Hamper in Bedroom
 Low-Friction Roller Drawer Guides
 Radiused Padded Vinyl Ceiling Design with Imagicor Accent in Living Room and Bedroom
 Corian® Countertops Throughout with Serpentine, Dripless Edge
 Integrated Corian® Sinks in Vanity and Galley
 Ceramic Tile Backsplash in Galley and Bath Areas

Glass Splash Guard at Living Room Side of Kitchen Countertop
 Power Silhouette® Shades in Living Room and Dining Area
 Duette® Day/Night Shades, Valances and Lambrequins in Bedroom
 Designer Vinyl Wallpaper Throughout
 Corian® Cutting Board
 Two-Tiered Silverware Drawer Divider
 Designer Textured Carpet in Living Area and Bedroom
 High-Gloss Tile Floors in Galley and Bath
 High-Gloss Tile Flooring in Cockpit Area
 Raised Panel Door for Private Bath
 Bedspread and Pillows
 Nightstands with Corian® Countertops
 Corian® Windowsills in Living Area
 Decorative Cabinetry Hardware
 Decorative Hardwood Slide-Out Fascia

OPTIONS

Interior Decors: Sterling Silver II, Malibu Sand, Mossy Glen, Tropic Wine
 Ralph Lauren Decors: Landsdown II, Black Pearl
 Spiced or Natural Maple, and Natural, Stained or Classic Cherry Cabinetry
 Large Bay Window in Living Area (Replaces Living Area Overheads on Driver and Passenger Sides)
 Sculptured Carpet Design in Living Room
 Plank Flooring in Kitchen and Bath
 Open Bath (42 Chateau IV)
 Above-Countertop Vanity Sink
 Bathtub

FURNITURE

Legless Side-Slide Solid Surface Dinette Table with Two Freestanding Dinette Chairs and Two Folding Chairs
 Roadside: Fabric Sleeper Sofa
 Curbside: Fabric J-Lounge with Drawer and Ottoman with Storage
 Additional Bedroom Wardrobe (44 Conquest III)
 Queen Island Bed with Pillowtop Hinged Mattress

OPTIONS

King Island Bed with Pillowtop Hinged Mattress (44 Conquest III)
 Queen Air Mattress with Digital Remote
 King Air Mattress with Digital Remote (44 Conquest III)
 Roadside: Leather Euro-Recliner with Ottoman
 Roadside: Glider Recliner with Ottoman
 Curbside: Leather J-Lounge with Drawer
 Roadside: Leather Sleeper Sofa with Drawer

Roadside: Computer Desk with Leather Euro-Recliner with Cable for Computer Display on TV
 Curbside: Computer Desk with 37" LCD TV (N/A: 44 Conquest III)
 Bank of Drawers with Shelves Above (44 Conquest III, 45 Commander IV)
 Booth Dinette
 Sectional Booth Dinette and New Galley
 Computer Desk in Bedroom with Bedroom Chair (44 Conquest III)

ELECTRICAL SYSTEMS AND LIGHTS

50 Amp 120/240V Distribution Panel and Power Cord with Quick Disconnect
 Onan® 12.5 kW QD Generator on Power Slide-Out Tray with Auxiliary Start Switch and Automatic Temperature Start
 2,800 Watt Pure Sine Wave Inverter with Auto Genstart and Auto Temp Start
 Halogen Map Lights Above Driver/Passenger Seating
 Decorative Lighting in Living Area and Bedroom
 Cosmetic Vanity Lights in Bathroom
 Bullet/Swivel Bedroom Overhead Lights with Switch ILO Gem Light
 Recessed Halogen Lighting under Living Room and Dinette Overhead

Halogen Lighting in Ceiling Throughout
 Accent Rope Lighting Throughout Coach
 Lighted Utility Center
 Underhood Utility Light
 120V Outlet in Private Bath
 120V Outlet in Bed Base
 120V Receptacles inside Storage Compartment
 Porch Light
 Doorbell
 Lights in Outside Storage Compartments
 Four 6V House Batteries
 Two 12V Chassis Batteries
 Surge Guard™ Automatic Transfer Switch

Multiplex 12V Wiring for Dash and Throughout Interior of Coach
 RV45D Solar Controller
 100 Watt Solar Panel

OPTIONS

All Electric Coach: (N/A: 44' and 45' Floorplans) 2,800 Watt Pure Sine Wave Inverters, 5 AGM Batteries on Super Slide Battery Tray, Residential Refrigerator, Princess Two-Burner Cooktop and 2 Solar Panels
 Glass Matt Batteries
 Four Additional 6V House Batteries

PLUMBING AND LP SYSTEMS

Central Water Purifier in Service Compartment
 Manabloc Water System for Entire Coach
 Insulated Systems Compartment with Easy Access to Hook-Up
 Water Pump Switch in Galley, Bathroom, and Service Bay
 Winterization Valving System

China Toilet
 Super Service Center
 Corian® Shower with Tile Accents and Shower Caddy
 Shower Head Volume Control
 Black Holding Tank Rinsing System
 Outside Faucet with Hot and Cold Water
 Power Water Hose Reel

Soap Dispenser in Kitchen
 Insta-Hot® Water System in Kitchen

OPTIONS

RV Sani-Con Tank Drainage System
 Ozone Water Filter at Kitchen Sink
 Bathtub

HEATING, VENTS AND AIR CONDITIONING

Aqua-Hot® Heating System
 Three Low-Profile Ducted 15M BTU Roof Air Conditioners with Wall Thermostat and Heat Pump
 Electronic AC/Heat Climate Control System

Center Defroster Vents
 12V Attic Fan in Bathroom and Private Lavatory
 12V Attic Fan with Wall Thermostat in Kitchen

OPTIONS

One Low-Profile 110V Baseboard Heater (N/A: 40 Platinum IV)

WINDOWS, DOORS AND AWNINGS

Flush-Mount Radius Dual Pane Safety Glass Dark Tinted Windows
 Front Entry Door with Air Seal and Removable Top Screen
 Keyless Remote Entry System with Pocket Remote

Tinted Skylight in Bathroom – Plexiglas®
 Topper Slide-Out Awnings all Houses
 Roof-Mounted Girard® Automatic Front Patio Awning

OPTIONS

Roof-Mounted Girard® Automatic Rear Patio Awning
 Girard® Front Door Awning
 Girard® Window Awnings

SAFETY

Back-Up Alarm
 Fire Extinguisher
 Deadbolt Lock on Entrance Door
 Lighted Interior and Exterior Grab Handles
 120V GFI Protected Circuit

LP Gas Detector
 Smoke Detector
 Carbon Monoxide Detector
 Integrated Pilot and Co-Pilot Three Point Seat Belts
 Third Brake Safety Light

Egress Window
 Security Safe
 Deluxe Security System

OPTIONS

Collision Avoidance System

ELECTRICAL SYSTEMS AND LIGHTS

50 Amp 120/240V Distribution Panel and Power Cord with Quick Disconnect
 Onan® 12.5 kW QD Generator on Power Slide-Out Tray with Auxiliary Start Switch and Automatic Temperature Start
 2,800 Watt Pure Sine Wave Inverter with Auto Genstart and Auto Temp Start
 Halogen Map Lights Above Driver/Passenger Seating
 Decorative Lighting in Living Area and Bedroom
 Cosmetic Vanity Lights in Bathroom
 Bullet/Swivel Bedroom Overhead Lights with Switch ILO Gem Light
 Recessed Halogen Lighting under Living Room and Dinette Overhead

Halogen Lighting in Ceiling Throughout
 Accent Rope Lighting Throughout Coach
 Lighted Utility Center
 Underhood Utility Light
 120V Outlet in Private Bath
 120V Outlet in Bed Base
 120V Receptacles inside Storage Compartment
 Porch Light
 Doorbell
 Lights in Outside Storage Compartments
 Four 6V House Batteries
 Two 12V Chassis Batteries
 Surge Guard™ Automatic Transfer Switch

Multiplex 12V Wiring for Dash and Throughout Interior of Coach
 RV45D Solar Controller
 100 Watt Solar Panel

OPTIONS

All Electric Coach: (N/A: 44' and 45' Floorplans) 2,800 Watt Pure Sine Wave Inverters, 5 AGM Batteries on Super Slide Battery Tray, Residential Refrigerator, Princess Two-Burner Cooktop and 2 Solar Panels
 Glass Matt Batteries
 Four Additional 6V House Batteries

PLUMBING AND LP SYSTEMS

Central Water Purifier in Service Compartment
 Manabloc Water System for Entire Coach
 Insulated Systems Compartment with Easy Access to Hook-Up
 Water Pump Switch in Galley, Bathroom, and Service Bay
 Winterization Valving System

China Toilet
 Super Service Center
 Corian® Shower with Tile Accents and Shower Caddy
 Shower Head Volume Control
 Black Holding Tank Rinsing System
 Outside Faucet with Hot and Cold Water
 Power Water Hose Reel

Soap Dispenser in Kitchen
 Insta-Hot® Water System in Kitchen

OPTIONS

RV Sani-Con Tank Drainage System
 Ozone Water Filter at Kitchen Sink
 Bathtub

HEATING, VENTS AND AIR CONDITIONING

Aqua-Hot® Heating System
 Three Low-Profile Ducted 15M BTU Roof Air Conditioners with Wall Thermostat and Heat Pump
 Electronic AC/Heat Climate Control System

Center Defroster Vents
 12V Attic Fan in Bathroom and Private Lavatory
 12V Attic Fan with Wall Thermostat in Kitchen

OPTIONS

One Low-Profile 110V Baseboard Heater (N/A: 40 Platinum IV)

WINDOWS, DOORS AND AWNINGS

Flush-Mount Radius Dual Pane Safety Glass Dark Tinted Windows
 Front Entry Door with Air Seal and Removable Top Screen
 Keyless Remote Entry System with Pocket Remote

Tinted Skylight in Bathroom – Plexiglas®
 Topper Slide-Out Awnings all Houses
 Roof-Mounted Girard® Automatic Front Patio Awning

OPTIONS

Roof-Mounted Girard® Automatic Rear Patio Awning
 Girard® Front Door Awning
 Girard® Window Awnings

SAFETY

Back-Up Alarm
 Fire Extinguisher
 Deadbolt Lock on Entrance Door
 Lighted Interior and Exterior Grab Handles
 120V GFI Protected Circuit

LP Gas Detector
 Smoke Detector
 Carbon Monoxide Detector
 Integrated Pilot and Co-Pilot Three Point Seat Belts
 Third Brake Safety Light

Egress Window
 Security Safe
 Deluxe Security System

OPTIONS

Collision Avoidance System



SIGNATURE SERIES

THE EXECUTIVE®

DYNASTY®

WINDSOR®

CAMELOT™

DIPLOMAT®

KNIGHT®

CAYMAN®

LAPALMA®

MONARCH SE®

ESQUIRE™

Welcome to the first step toward living your dream. You'll discover that it's not so far from here to there. Because Monaco has a coach that's right for every dreamer. Look closely, and you'll find the high-tech, high-style luxury you've dreamed about is also the very best deal under the sun. Point by point, in every price range, Monaco leads the way in performance, comfort and safety. Yes, you're headed for a dream come true. Just take your first step, and climb aboard.

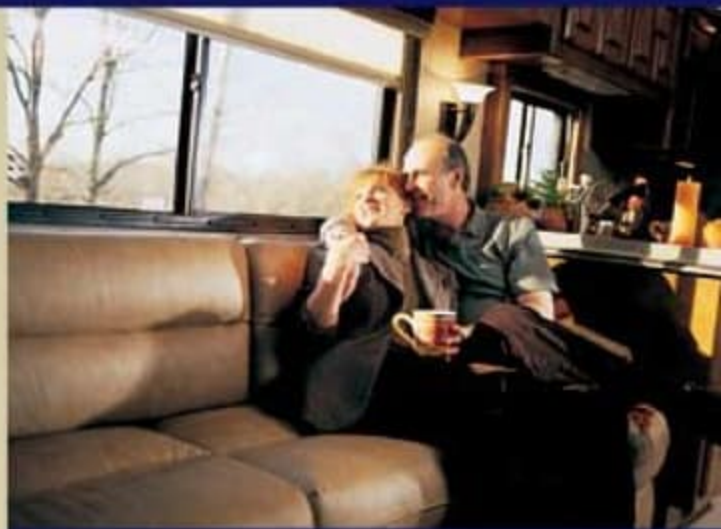

91320 Coburg Industrial Way, Coburg, OR 97408
800 634-0855

606 Nelson's Pkwy., Wakarusa, IN 46573
800 650-7337

www.monacocoach.com

Monaco Coach Corporation is traded on the NYSE under the listing MNC.
0705 NPN: BROMSIG



SIGNATURE SERIES

THE EXECUTIVE[®]

DYNASTY[®]

WINDSOR[®]

CAMELOT[™]

DIPLOMAT[®]

KNIGHT[®]

CAYMAN[®]

LAPALMA[®]

MONARCH SE[®]

ESQUIRE[™]

Welcome to the first step toward living your dream. You'll discover that it's not so far from here to there. Because Monaco has a coach that's right for every dreamer. Look closely, and you'll find the high-tech, high-style luxury you've dreamed about is also the very best deal under the sun. Point by point, in every price range, Monaco leads the way in performance, comfort and safety. Yes, you're headed for a dream come true. Just take your first step, and climb aboard.

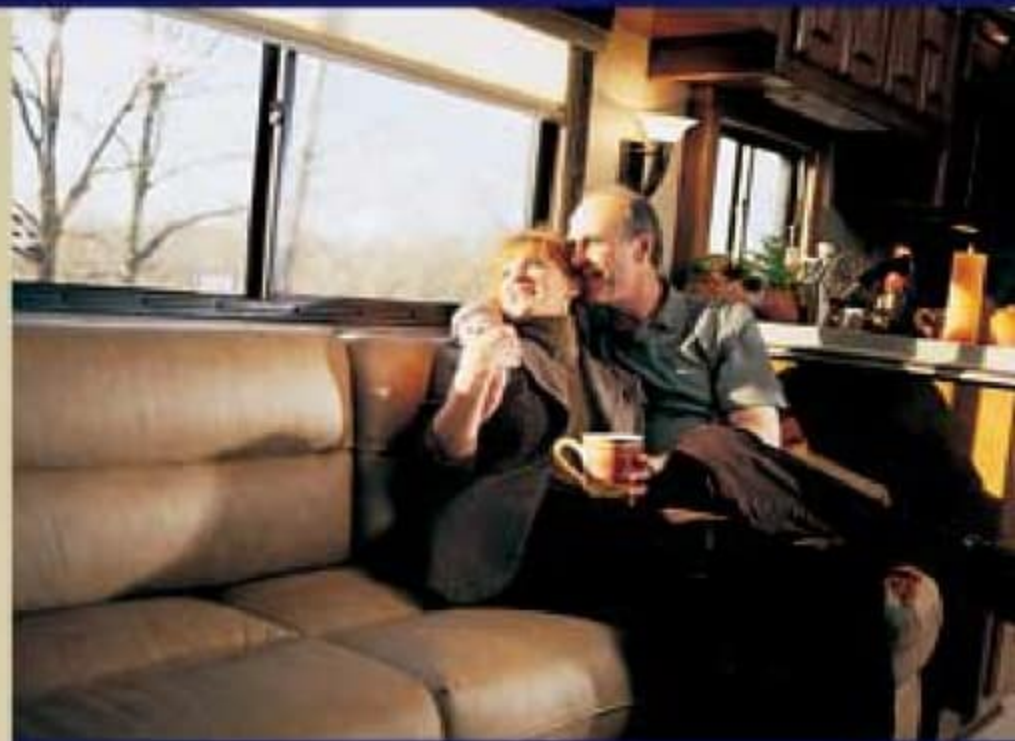

91320 Coburg Industrial Way, Coburg, OR 97408
800 634-0855

606 Nelson's Pkwy., Wakarusa, IN 46573
800 650-7337

www.monacocoach.com

Monaco Coach Corporation is traded on the NYSE under the listing MNC.
0705 NPN: BROMSIG