



More than a GARAGE!

- ✓ **GUIDE FUSION TOP** with hood, high lights and grill, elevates to best viewing position for your favorite TV's
- ✓ **THE FUSION ZION** extra long fold down ramp gives you the best access
- ✓ **WATER AND GREASE** The Fuzion garage comes prepared for
- ✓ **THE FUSION MAW** motorhome with screen gives you multiple areas for your screen, each screen is a TV
- ✓ **FUSION SOUND** night tech design great speakers with 26 inch LCD TV, DVD, CD player, and MP3/USB connection

FUZION

STANDARD "RAMP IT UP" PACKAGES

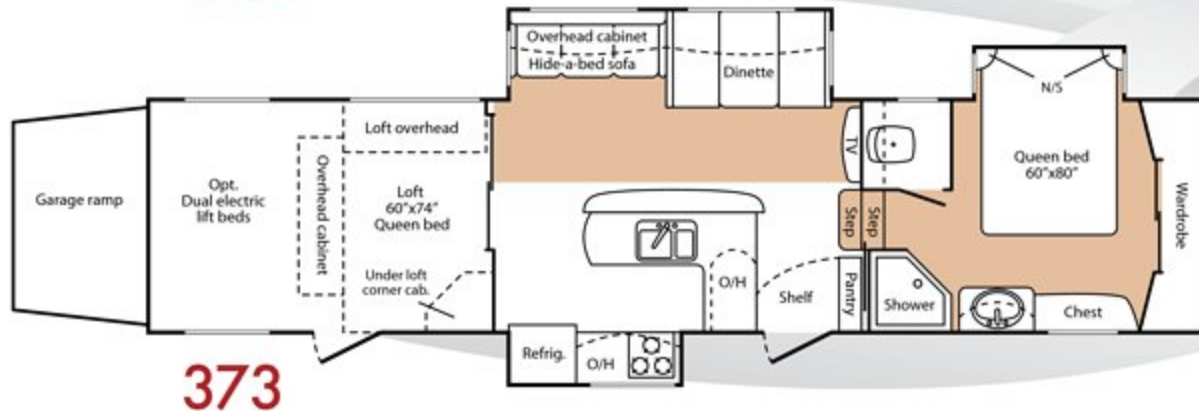
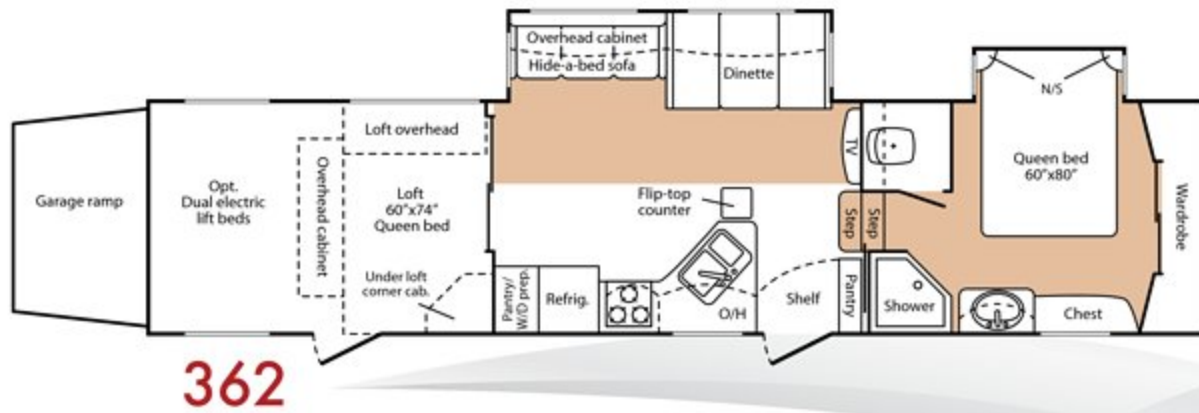

"Intense" Interior

- "Fuzion Sound" Stereo (26" LCD TV Stereo w/ DVD, 4 Interior, 2 Exterior Speakers, Amplifier, Sub Woofer, IPOD, MP3, A,B&C Speaker Switch)
- 15,000 BTU A/C w/ H-Duct
- OTR Microwave
- H2O Heater w/ Mixer Valve
- Hide-a-Bed Sofa
- Day/Night Shades
- Queen Bed
- Deluxe Innerspring Mattress
- Ceiling Fan
- 3 Burner Range and 22" Oven
- Large 8 cu. ft. Refrigerator
- Pre-wired for 2nd A/C (bedroom)
- 50 AMP Service w/ Marine Cord
- Cable/Satellite Hook Ups
- Mini Blinds Kitchen & Garage
- Water Heater By-pass
- TV Antenna
- Skylight over Shower
- Power Bath Vent
- Sink Cover
- Loft Bunk Ladder
- LP Leak Detector
- Carbon Monoxide Detector

Options

- 5500 Watt Generator
- Free Standing Table & 4 Chairs
- Electric Lift Beds in Garage
- Medallion High Gloss Exterior

"Extreme" Exterior

- Fiberglass Front Cap w/ cargo lights and extreme Turning radius
- Utility Center: one convenient place to connect your utilities
- Attic Vents
- Step Light
- Patio Awning
- Rear Stabilizer Jacks
- Electric Front Jacks
- Tinted Safety Glass Windows
- Aluminum Wheels
- Detachable Ladder
- Security Lights
- Cargo Loading Lights
- Spare Tire
- Generator Prep w/ Start, Hour Meter & Switching
- Folding Entry Assist Handle

"Gear It Up" Garage

- Washer/Dryer Prep
- 5' Patio Door w/ Screen
- Flip up Work Shelf
- 16" on Center Studded Wall (Customize your garage)
- Overhead Cabinets
- Exhaust Vent
- Rear Screen Wall Enclosure
- 1200 lb Recessed D-Rings
- Fuel Station w/ 12 V Pump and 30 gal Tank

SPECIFICATIONS	362	373
Shipping Weight	11450	TBD
Carrying Capacity	4050	TBD
Hitch	2790	TBD
Exterior Length	37' 9"	TBD
Exterior Width	8' 6"	TBD
Ext Height - Top of A/C	12' 10"	TBD
Fresh Water Capacity	133	133
Waste Water Capacity	43	43
Grey Water Capacity	86	86
LPG Capacity	80	80
Tire Size	225/ 75D15D	225/ 75D15D
Garage / Cargo	12'	12'

keystone-fuzion.com

Product information is as accurate as possible as of the date of publication of this brochure. Features, floor plans, and specifications are subject to change without notice. Please also consult Keystone's web site at www.keystonev.com for more current product information and specifications. Tow Vehicle disclaimer. CAUTION: Owners of Keystone recreational vehicles are solely responsible for the selection and proper use of tow vehicles. All customers should consult with a motor vehicle manufacturer or their dealer concerning the purchase and use of suitable tow vehicles for Keystone products. Keystone disclaims any liability or damages suffered as a result of the selection, operation, use or misuse of a tow vehicle. KEYSTONE'S LIMITED WARRANTY DOES NOT COVER DAMAGE TO THE RECREATIONAL VEHICLE OR THE TOW VEHICLE AS A RESULT OF THE SELECTION, OPERATION, USE OR MISUSE OF THE TOW VEHICLE. 5/2006



FUZION



FUZION

**Introducing the
ALL NEW
Fuzion.
It's HOT
inside and out!**



FUZION

IS A PRODUCT OF:



2642 Hackberry Drive
Goshen, Indiana 46526
(574) 535-2100
www.keystone-fuzion.com

Your Fuzion Dealer:

Blank space for the dealer name.