



MONACO®

DRIVING YOUR DREAM.

MONARCH®

 | 07





MONACO®

DRIVING YOUR DREAM.

MONARCH®

 | 07





MONARCH®

VALUE IN MOTION.

Well, what do you know. Moving up to Monaco quality is easier than you thought. Step into the affordable new 2007 Monarch or Monarch SVE. These value-priced beauties are your ticket to the good life — with top quality furnishings, gorgeous woodwork with raised panels, seven-foot ceilings, and even our spectacular new full-wall slides. How's *that* for value?

GALLEY. Storage abounds in this well-designed galley, including adjustable cabinet shelves and a pantry with roll-outs and drawers. A microwave oven, double-door refrigerator, and three-burner cooktop complete the culinary quarters.

BEDROOM. Relax and put your feet up. All Monarch bedrooms feature a queen bed, nightstands, and blackout day/night pleated shades. You can also opt for the 20" color TV shown here.



FULL-WALL SLIDE

▼ PANASUITE™

ENJOY LIFE TO THE FULLEST.

Here's a big idea. What if, instead of having two slides side-by-side, you had one luxurious long one? Introducing PanaSuite™, the new full-wall slide from Monaco Coach Corporation. Just imagine it. Wide open aisles. No obstructions or tight corners. And more livability at every turn. Ahhh yes, we *thought* you'd like that.

PanaSuite™ is standard on the new 33SFS (shown here) and 30SFS floorplans.





MONARCH®

VALUE IN MOTION.

Well, what do you know. Moving up to Monaco quality is easier than you thought. Step into the affordable new 2007 Monarch or Monarch SVE. These value-priced beauties are your ticket to the good life — with top quality furnishings, gorgeous woodwork with raised panels, seven-foot ceilings, and even our spectacular new full-wall slides. How's *that* for value?

GALLEY. Storage abounds in this well-designed galley, including adjustable cabinet shelves and a pantry with roll-outs and drawers. A microwave oven, double-door refrigerator, and three-burner cooktop complete the culinary quarters.

BEDROOM. Relax and put your feet up. All Monarch bedrooms feature a queen bed, nightstands, and blackout day/night pleated shades. You can also opt for the 20" color TV shown here.



FULL-WALL SLIDE

▼ PANASUITE™

ENJOY LIFE TO THE FULLEST.

Here's a big idea. What if, instead of having two slides side-by-side, you had one luxurious long one? Introducing PanaSuite™, the new full-wall slide from Monaco Coach Corporation. Just imagine it. Wide open aisles. No obstructions or tight corners. And more livability at every turn. Ahhh yes, we *thought* you'd like that.

PanaSuite™ is standard on the new 33SFS (shown here) and 30SFS floorplans.



QUALITY. INNOVATION. HAPPY TRAVELERS. IT ALL SAYS MONACO.

INTERIOR



Wherever you travel across America, it's easy to spot the Monaco owners. They're the ones with the smug, happy grins on their faces. And who could blame them? When you own a Monaco, you own the best. The best in quality, performance, safety, technology and comfort. It's all here. And it's all yours for the taking. Come on, freedom lovers. Make your move to Monaco quality. After all, you already know how to grin.



NEWPORT CHERRY | SAND DUNE

335FS

QUALITY. INNOVATION. HAPPY TRAVELERS. IT ALL SAYS MONACO.

INTERIOR



Wherever you travel across America, it's easy to spot the Monaco owners. They're the ones with the smug, happy grins on their faces. And who could blame them? When you own a Monaco, you own the best. The best in quality, performance, safety, technology and comfort. It's all here. And it's all yours for the taking. Come on, freedom lovers. Make your move to Monaco quality. After all, you already know how to grin.



33SFS | NEWPORT CHERRY | SAND DUNE

MONARCH®



30PDD | CHAMPAGNE SELECT | SAND DUNE

READY, SET, GO MONACO.



MONARCH®



30PDD | CHAMPAGNE SELECT | SAND DUNE

READY, SET, GO MONACO.





Climb aboard. It's all waiting for you. The soft touch vinyl captain's chair. The tilt wheel and cruise control. The easy-to-read gauges. We know what you like. The Monarch is also prepped for an optional rear vision system with audio. And this year, you can tune in to optional Sirius satellite radio for coast-to-coast music, news and sports programming.

COCKPIT. There's plenty of seating onboard, including a barrel chair that swivels *and* glides, a jackknife sofa, and of course, the comfy captain's chairs that double as recliners. For your entertainment, we've included a 24" color TV and a CD player/radio with DVD player.

EXTERIOR CD PLAYER/RADIO. Listen to the ballgame or your favorite tunes while relaxing on the patio. The optional exterior entertainment center features a CD player, radio and two speakers (N/A on Monarch SVE).

SIDE-SWING BAGGAGE DOORS. Our baggage doors open from the side — not the top — for easier loading and a clearer view of what's inside. The Monarch also features pass-through storage and one-piece slide-out boxes for easy washdowns.



NO SEAMS. ADDED SAFETY.

When you're driving, you need to see everything in front of you — pedestrians, potholes, possums scurrying across the road. With our exclusive Panaview™ 1-Piece Windshield, you can. There's no annoying black rubber seam running down the middle of your windshield. It's the largest unobstructed view in the industry. That's big!

PANAVIEW™

1-PIECE WINDSHIELD





Climb aboard. It's all waiting for you. The soft touch vinyl captain's chair. The tilt wheel and cruise control. The easy-to-read gauges. We know what you like. The Monarch is also prepped for an optional rear vision system with audio. And this year, you can tune in to optional Sirius satellite radio for coast-to-coast music, news and sports programming.

COCKPIT. There's plenty of seating onboard, including a barrel chair that swivels *and* glides, a jackknife sofa, and of course, the comfy captain's chairs that double as recliners. For your entertainment, we've included a 24" color TV and a CD player/radio with DVD player.

EXTERIOR CD PLAYER/RADIO. Listen to the ballgame or your favorite tunes while relaxing on the patio. The optional exterior entertainment center features a CD player, radio and two speakers (N/A on Monarch SVE).

SIDE-SWING BAGGAGE DOORS. Our baggage doors open from the side — not the top — for easier loading and a clearer view of what's inside. The Monarch also features pass-through storage and one-piece slide-out boxes for easy washdowns.

NO SEAMS. ADDED SAFETY.

When you're driving, you need to see everything in front of you — pedestrians, potholes, possums scurrying across the road. With our exclusive Panaview™ 1-Piece Windshield, you can. There's no annoying black rubber seam running down the middle of your windshield. It's the largest unobstructed view in the industry. That's big!



1-PIECE WINDSHIELD



MONARCH®



SMARTSTRUCTURE II

SmartStructure II adapts the principles of our diesel chassis technology for use with a gas chassis. While other motorhomes use outriggers to hang the walls and storage compartments, our exclusive truss system is

integrated with the chassis rails to provide a solid platform. The floor and storage bays are all one piece, and the truss system works with the chassis rails to channel weight toward the center of the motorhome. Greater strength. Better weight distribution. A solid foundation. That's SmartStructure II.

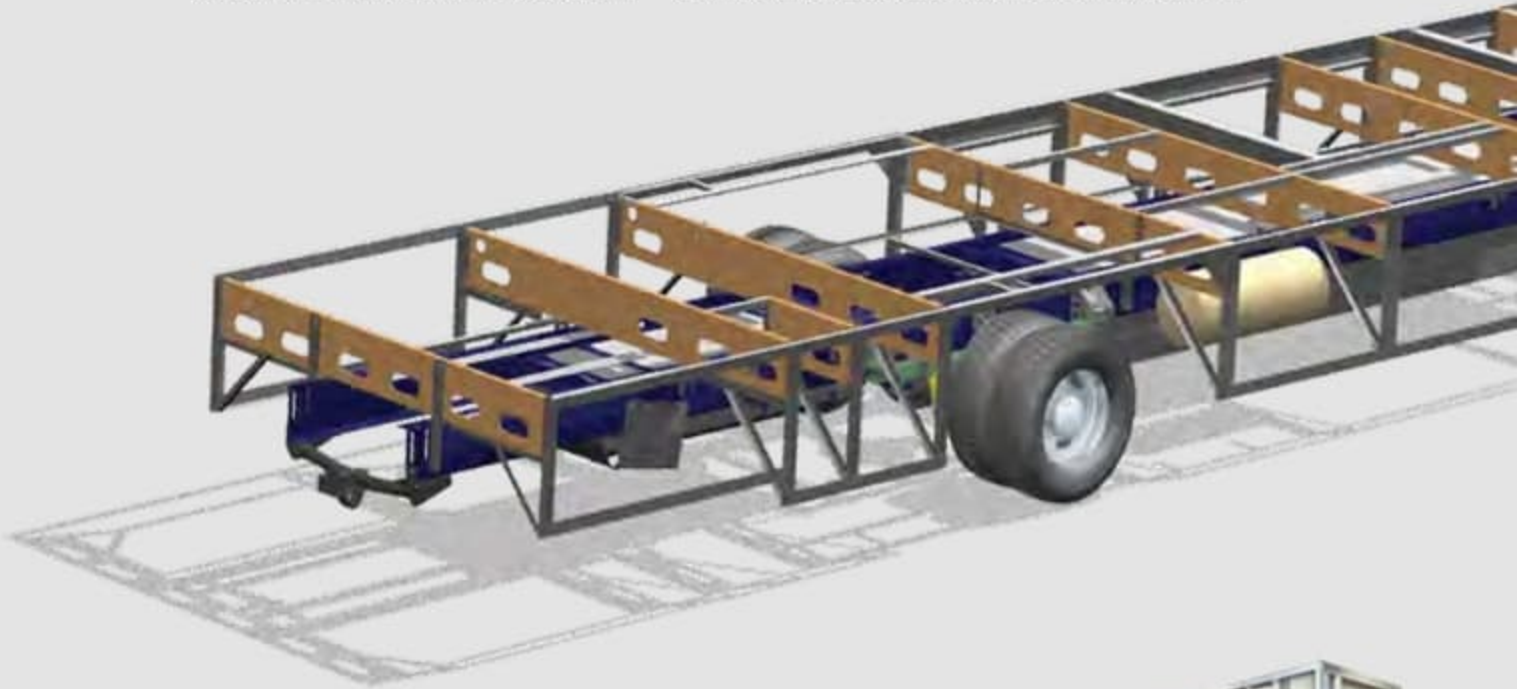

SLIDE-OUT CONSTRUCTION:

When you purchase a Monaco coach, you can be sure the slide-out boxes are some of the strongest and most reliable you'll find anywhere. They feature our exclusive multi-layer construction to give you maximum insulation and to reduce the chance of warping, twisting or shifting.



THE STRENGTH IS IN THE CONSTRUCTION.

Thanks to our Alumaframe® Superstructure, your Monaco coach is built to take on anything the road can dish out. We revolutionized the industry by replacing outdated wood and tubular aluminum construction with our exclusive system of aluminum C-Channel

crossmembers. These run the full length of the coach, with double-welded intersections for superior strength. This makes your Monaco lighter and sturdier than other coaches and gives you reliability you can count on down the road.



Alumaframe®
(C-Channel)

MONARCH®



SMARTSTRUCTURE II

SmartStructure II adapts the principles of our diesel chassis technology for use with a gas chassis. While other motorhomes use outriggers to hang the walls and storage compartments, our exclusive truss system is

integrated with the chassis rails to provide a solid platform. The floor and storage bays are all one piece, and the truss system works with the chassis rails to channel weight toward the center of the motorhome. Greater strength. Better weight distribution. A solid foundation. That's SmartStructure II.

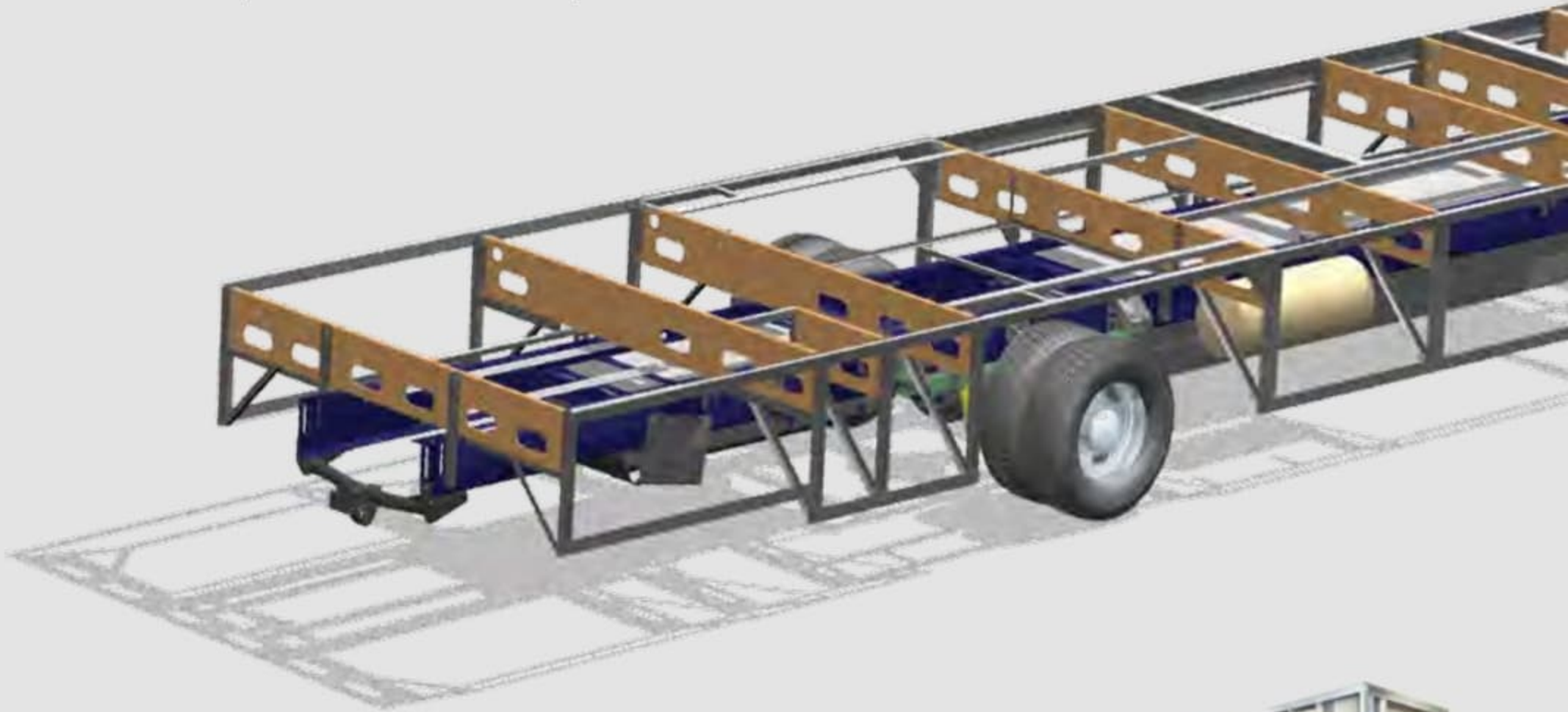

SLIDE-OUT CONSTRUCTION:

When you purchase a Monaco coach, you can be sure the slide-out boxes are some of the strongest and most reliable you'll find anywhere. They feature our exclusive multi-layer construction to give you maximum insulation and to reduce the chance of warping, twisting or shifting.

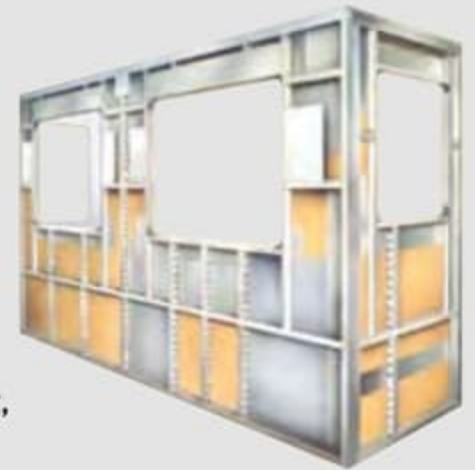

THE STRENGTH IS IN THE CONSTRUCTION.

Thanks to our Alumaframe® Superstructure, your Monaco coach is built to take on anything the road can dish out. We revolutionized the industry by replacing outdated wood and tubular aluminum construction with our exclusive system of aluminum C-Channel

crossmembers. These run the full length of the coach, with double-welded intersections for superior strength. This makes your Monaco lighter and sturdier than other coaches and gives you reliability you can count on down the road.



Alumaframe®
(C-Channel)



VORTEC™ 8100 ENGINE:

This Workhorse chassis, 8.1L V-8 engine features 340 HP and 455 lbs./ft. torque. The Ford chassis comes standard with a 6.8L 3-valve V-10 engine with 362 HP and 457 lbs./ft. torque.



9-LAYER ROOF CONSTRUCTION:

(top to bottom)

- One-piece peaked fiberglass roof
- Luau backing
- Thick, tapered bead foam insulation
- Aluminum double I-beam superstructure filled with fiberglass insulation
- Vapor barrier
- Structure foam: thermal insulative barrier
- 1/2" bead foam insulation
- Foam padding for extra insulation
- Padded vinyl ceiling

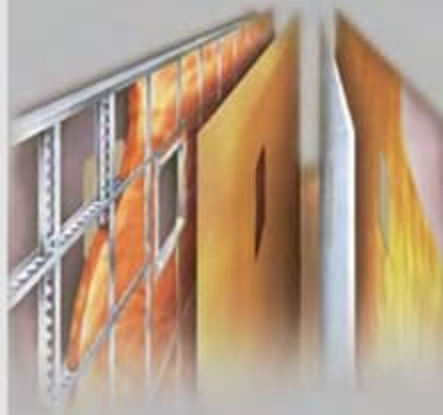

5-LAYER SIDEWALL CONSTRUCTION:

(left to right)

- Smooth gel coat fiberglass (Smooth aluminum on Monarch SVE)
- Interlocking C-Channel filled with 1-1/2" fiberglass insulation bonded in place so it doesn't sag or leave spaces uninsulated
- Vapor barrier
- Bead foam adds comfort, saves energy and provides a thermal insulative barrier
- Interior paneling



4-LAYER FLOOR CONSTRUCTION:

(top to bottom)

- Structurwood™
- Blue foam insulation
- 1-1/2" aluminum tube
- Three-ply poly underbelly



ASSISTANCE

SALES • TECH • ROADSIDE

1-877-4MONACO

WE'RE HERE. ANYTIME, EVERY TIME.

- Reach us anytime — literally — via our live customer support line.
- Drive in to one of our 350 Service Centers.
- Enjoy the first year free when you enroll in our Owner Advantage Roadside Assistance Program.
- See where it all begins with a tour of one of our facilities in Indiana or Oregon. Call 1-800-650-7337 or 1-800-634-0855 to find out more.



VORTEC™ 8100 ENGINE:

This Workhorse chassis, 8.1L V-8 engine features 340 HP and 455 lbs./ft. torque. The Ford chassis comes standard with a 6.8L 3-valve V-10 engine with 362 HP and 457 lbs./ft. torque.



9-LAYER ROOF CONSTRUCTION:
(top to bottom)

- One-piece peaked fiberglass roof
- Luaun backing
- Thick, tapered bead foam insulation
- Aluminum double I-beam superstructure filled with fiberglass insulation
- Vapor barrier
- Structure foam: thermal insulative barrier
- 1/2" bead foam insulation
- Foam padding for extra insulation
- Padded vinyl ceiling

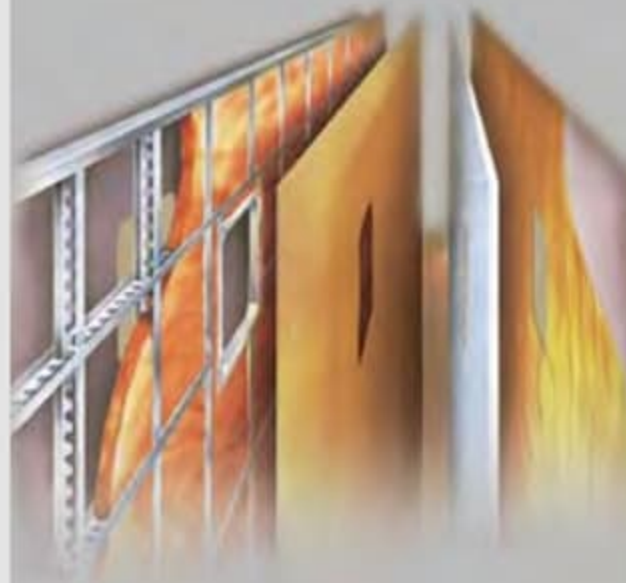

5-LAYER SIDEWALL CONSTRUCTION:
(left to right)

- Smooth gel coat fiberglass (Smooth aluminum on Monarch SVE)
- Interlocking C-Channel filled with 1-1/2" fiberglass insulation bonded in place so it doesn't sag or leave spaces uninsulated
- Vapor barrier
- Bead foam adds comfort, saves energy and provides a thermal insulative barrier
- Interior paneling



4-LAYER FLOOR CONSTRUCTION:
(top to bottom)

- Structurwood™
- Blue foam insulation
- 1-1/2" aluminum tube
- Three-ply poly underbelly



ASSISTANCE

SALES • TECH • ROADSIDE

1-877-4MONACO

WE'RE HERE. ANYTIME, EVERY TIME.

- Reach us anytime — literally — via our live customer support line.
- Drive in to one of our 350 Service Centers.
- Enjoy the first year free when you enroll in our Owner Advantage Roadside Assistance Program.
- See where it all begins with a tour of one of our facilities in Indiana or Oregon. Call 1-800-650-7337 or 1-800-634-0855 to find out more.

MONARCH®

NEW VINTAGE OAK



NEWPORT CHERRY



CHAMPAGNE SELECT



WHICH WAY WILL YOU GO?

We know you love choices. That's why our designers give you so many tempting options. From mild to wild, discriminating to daring, Monaco offers lots of fun ways to go.



STANDARD GRAPHICS



STANDARD GRAPHICS



FAUX PAINT



FAUX PAINT



SVE STANDARD GRAPHICS



SVE STANDARD GRAPHICS

BUTTERNUT



ENGLISH WALNUT



MONARCH[®]

NEW VINTAGE OAK



NEWPORT CHERRY



CHAMPAGNE SELECT



WHICH WAY WILL YOU GO?

We know you love choices. That's why our designers give you so many tempting options. From mild to wild, discriminating to daring, Monaco offers lots of fun ways to go.



STANDARD GRAPHICS



STANDARD GRAPHICS



FAUX PAINT



FAUX PAINT



SVE STANDARD GRAPHICS



SVE STANDARD GRAPHICS

BUTTERNUT



ENGLISH WALNUT





Better Stain Protection

Manufactured in, not added on. For added protection against stains, soil repellent is applied to virtually all upholstery fabric during the finishing process for superior coverage.*

* Brand and application of upholstery fabric protection may vary depending on date recreational vehicle was manufactured.



- Carpet A
- Dinette B
- Sofa C
- Bedsread D

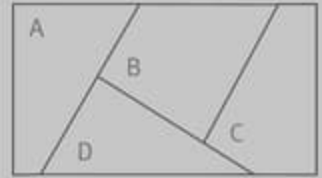

STANDARD GRAPHICS



STANDARD GRAPHICS



FAUX PAINT



FAUX PAINT



SVE STANDARD GRAPHICS



SVE STANDARD GRAPHICS

LAUREL SQUARE



SAND DUNE



Note: Colors depicted are a reasonable representation though they may not be an exact match of the actual colors due to variances in processing and production. See your dealer for actual fabric and paint chip samples.



Better Stain Protection

Manufactured in, not added on. For added protection against stains, soil repellent is applied to virtually all upholstery fabric during the finishing process for superior coverage.*

* Brand and application of upholstery fabric protection may vary depending on date recreational vehicle was manufactured.



- Carpet A
- Dinette B
- Sofa C
- Bedsread D

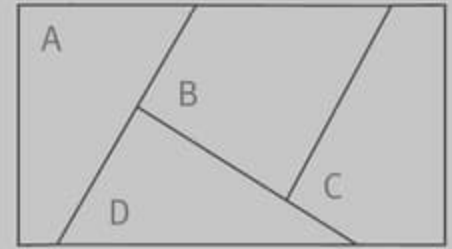

STANDARD GRAPHICS



STANDARD GRAPHICS



FAUX PAINT



FAUX PAINT



SVE STANDARD GRAPHICS

LAUREL SQUARE



SVE STANDARD GRAPHICS

SAND DUNE



Note: Colors depicted are a reasonable representation though they may not be an exact match of the actual colors due to variances in processing and production. See your dealer for actual fabric and paint chip samples.

MONARCH[®]

33PBD

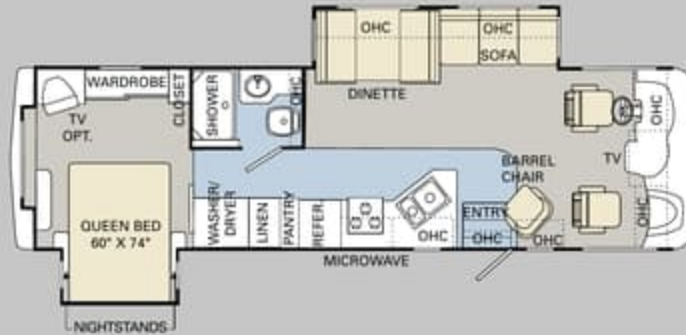

33SFS

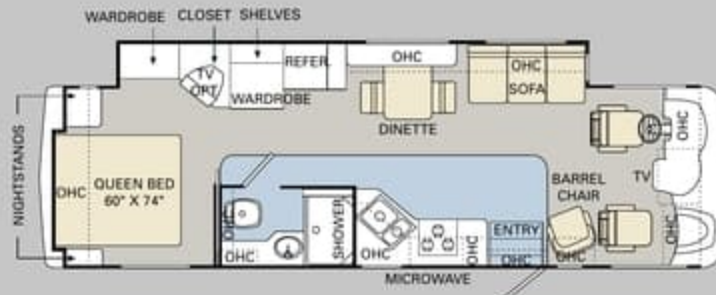

34SBD

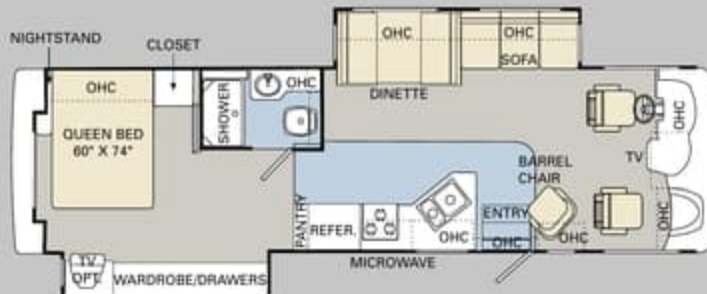

36PCT



Ready to choose? The 2007 Monarch is available in a wide selection of floorplans from 33 to 37 feet, with double or triple slide-outs. This year, we're also offering the new 33SFS featuring our luxurious PanaSuite™ full-wall slide. It provides maximum uninterrupted living space on the driver's side of the coach.

FURNITURE OPTIONS:

- Roadside Front of Coach: Fabric Hide-A-Bed Sofa with Air Mattress and Two Pillows
- Bedroom Desk IPO Dresser (36DBD)
- OptimaLeather™ Euro-Recliner Chair with Ottoman IPO Barrel Chair
- Soft Touch Vinyl Swivel Recliner IPO Barrel Chair
- Hallway Bunks with LCD TV Built into Outside of Bath Wall (34SBD)

■ TILE ■ CARPET

MONARCH®

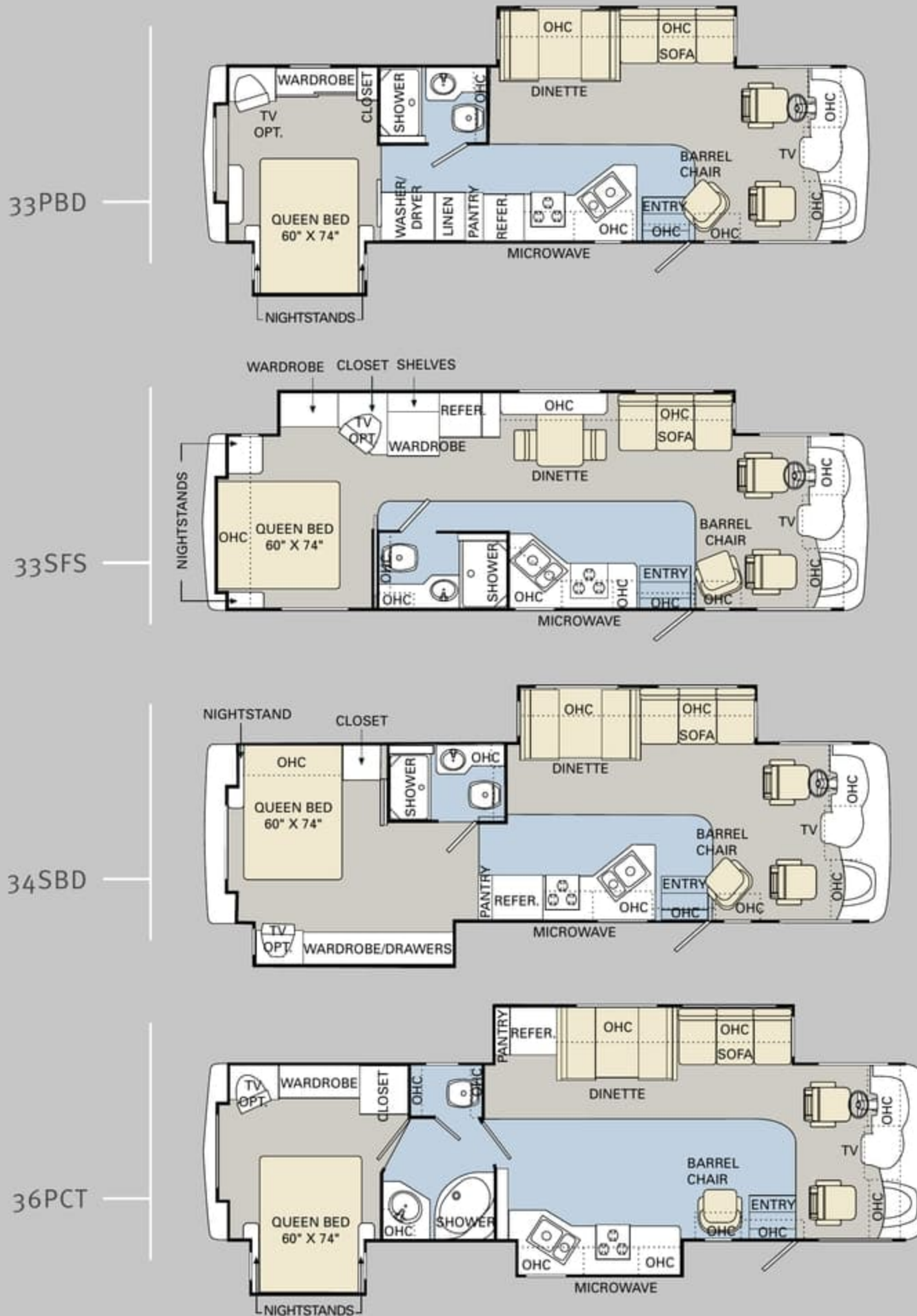

TILE CARPET

Ready to choose? The 2007 Monarch is available in a wide selection of floorplans from 33 to 37 feet, with double or triple slide-outs. This year, we're also offering the new 33SFS featuring our luxurious PanaSuite™ full-wall slide. It provides maximum uninterrupted living space on the driver's side of the coach.

FURNITURE OPTIONS:

- Roadside Front of Coach: Fabric Hide-A-Bed Sofa with Air Mattress and Two Pillows
- Bedroom Desk IPO Dresser (36DBD)
- OptimaLeather™ Euro-Recliner Chair with Ottoman IPO Barrel Chair
- Soft Touch Vinyl Swivel Recliner IPO Barrel Chair
- Hallway Bunks with LCD TV Built into Outside of Bath Wall (34SBD)



36DBD

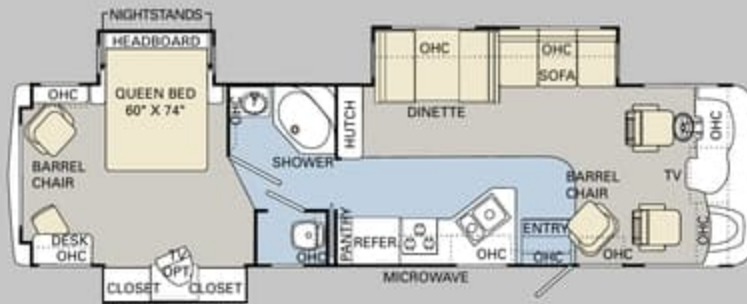

37PCT

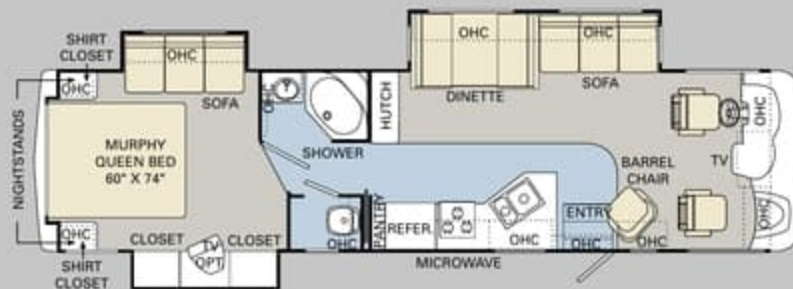

37PRT

ALL ROADS LEAD TO WWW.MONACOCOACH.COM.

Wherever the road takes you, you're never more than a click away from your friends at Monaco. Just go to www.monacocoach.com for all the latest product news, club dates and destinations, a dealer locator function, and factory tour information. You can also e-mail us directly through the site at any time.



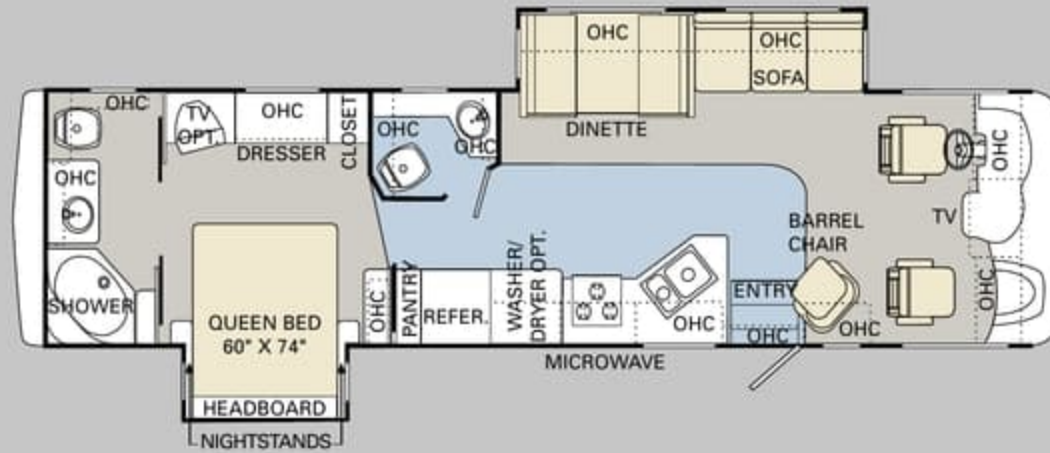

36DBD

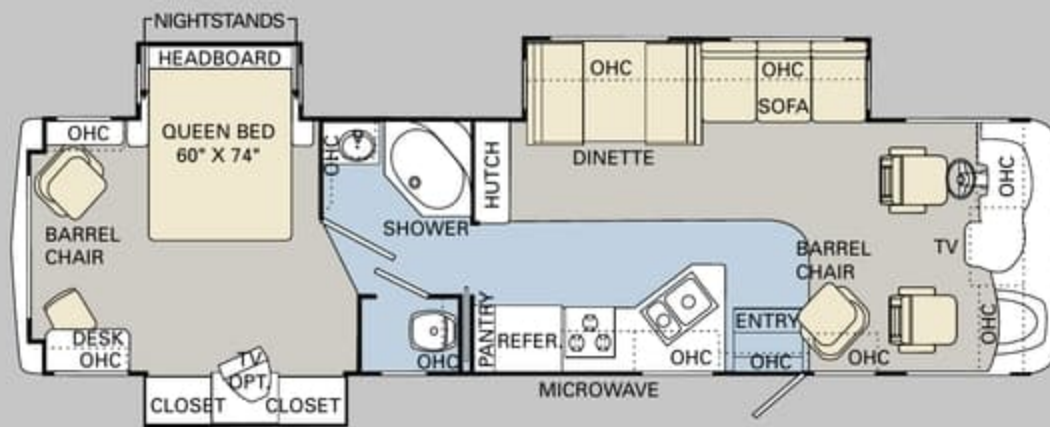

37PCT

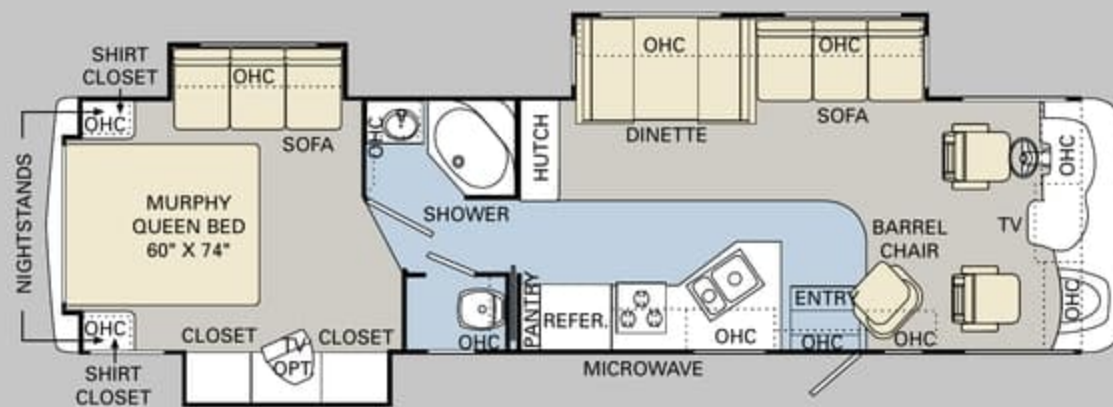

37PRT

ALL ROADS LEAD TO WWW.MONACOCOACH.COM.

Wherever the road takes you, you're never more than a click away from your friends at Monaco. Just go to www.monacocoach.com for all the latest product news, club dates and destinations, a dealer locator function, and factory tour information. You can also e-mail us directly through the site at any time.



		Weight Ratings (Lbs.)				Measurements							Tank Capacity (Gals.) ¹					
		Gross Vehicle	Gross Combined ²	Front Gross Axle	Rear Gross Axle	Wheelbase	Overall Length	Overall Height (with A/C) (add 5" for satellite option)	Interior Height	Interior Width	Exterior Width	Water Heater	Gray Tank	Black Tank	Fresh Tank	LP Tank ³	Fuel Tank	
33PBD	Ford Chassis	22,000	26,000	7,500	14,500	228"	34' 3"	12' 6"	84"	94.5"	100.5"	10	45	54	60	24	75	
	W22 Chassis	22,000	26,000	8,000	14,500	228"	34' 3"	12' 6"	84"	94.5"	100.5"	10	45	54	60	24	75	
33SFS	Ford Chassis	N/A	N/A	N/A	N/A	N/A	N/A	N/A	N/A	N/A	N/A	N/A	N/A	N/A	N/A	N/A	N/A	
	W22 Chassis	22,000	26,000	8,000	14,500	228"	34' 3"	12' 6"	84"	94.5"	100.5"	10	54	42	60	24	75	
34SBD	Ford Chassis	22,000	26,000	7,500	14,500	228"	35' 2"	12' 6"	84"	94.5"	100.5"	10	40	42	60	24	75	
	W22 Chassis	22,000	26,000	8,000	14,500	228"	35' 2"	12' 6"	84"	94.5"	100.5"	10	40	42	60	24	75	
36PCT	Ford Chassis	22,000	26,000	7,500	14,500	242"	36' 9"	12' 6"	84"	94.5"	100.5"	10	TBD	TBD	60	24	75	
	W22 Chassis	22,000	26,000	8,000	14,500	242"	36' 9"	12' 6"	84"	94.5"	100.5"	10	TBD	TBD	60	24	75	
36DBD	Ford Chassis	22,000	26,000	7,500	14,500	242"	36' 9"	12' 6"	84"	94.5"	100.5"	10	42/39	42/39	60	24	75	
	W22 Chassis	22,000	26,000	8,000	14,500	242"	36' 9"	12' 6"	84"	94.5"	100.5"	10	42/39	42/39	60	24	75	
37PCT	Ford Chassis	22,000	26,000	7,500	14,500	242"	37' 4"	12' 6"	84"	94.5"	100.5"	10	45	54	60	24	75	
	W22 Chassis	22,000	26,000	8,000	14,500	242"	37' 4"	12' 6"	84"	94.5"	100.5"	10	45	54	60	24	75	
37PRT	Ford Chassis	22,000	26,000	7,500	14,500	242"	37' 4"	12' 6"	84"	94.5"	100.5"	10	45	54	60	24	75	
	W22 Chassis	22,000	26,000	8,000	14,500	242"	37' 4"	12' 6"	84"	94.5"	100.5"	10	45	54	60	24	75	

¹Towing capacity is limited by GCWR; your vehicle's towing capacity is the difference between the GCWR and the actual vehicle weight, including all water, fuel, passengers and cargo. Your towed vehicle should be equipped with auxiliary brakes if the weight of the towed vehicle exceeds 1,000 lbs. Consult your owner's manual for further towing information.

The actual overall length of the recreational vehicle may differ from that indicated in the brochure due to variances in the manufacturing process and/or installed components. The actual length may be greater or less than that indicated. Due to the large variety of options and floorplan arrangements available to our customers, actual weights for each unit can differ significantly. Monaco Coach provides a weight sticker on each unit we produce which includes that unit's tank capacities and approximate weight. Consult your local Monaco Coach dealer for unit availability and further information. The information printed in this brochure reflects product design, fabrication, and component parts at the date of printing. The manufacturer reserves the right, at any time, to make changes in product design or material or component specifications as its sole option, without notice. This

²All tank capacities are estimated based upon calculations provided by the tank manufacturers and represent approximate capacities. The actual "usable capacity" may be greater or less than the estimated capacities based upon fabrication and installation of the tanks.

includes the substitution of components of a different brand or trade name which will result in comparable performance. All information printed in this brochure is subject to change after the date of printing. Some features shown or mentioned in this brochure are optional and may only be available in selected floorplans. Photographs may show props or decorations that are not standard equipment on Monaco Coach models. Monaco Coach, the Monaco logo and its design, are registered trademarks. All other products and company names are trademarks and/or registered trademarks of their respective holders. While the color of the motorhome's exterior and the interior fabrics depicted in this sales brochure are fair and reasonable depictions, the colors depicted may not be an exact match of the actual colors because of the variances in photo-processing and variances caused by inserting the

³Actual filled LP capacity is 80% of listing due to safety shut-off required on tank.

photographs within the sales brochure. Due to product improvements, changes during the model year and/or transcription errors that may occur, information represented within this brochure may not be accurate at the time of your purchase. If certain information is significant to your purchasing decision, please confirm the information with your dealer prior to submitting your order. Component part and appliance manufacturers issue limited warranties covering those portions of the recreational vehicle not covered by the Limited Warranties issued by Monaco Coach Corporation. To learn which specific component parts and appliances are excluded from the Limited Warranties issued by Monaco Coach Corporation, please contact your selling dealership or Monaco Coach Corporation directly, or review the warranty packet inside the recreational vehicle.

BODY CONSTRUCTION

- Alumaframe® Superstructure
- Steel Cage Cockpit Construction
- Peaked One-Piece Fiberglass Roof with Fiberglass Insulation
- Smooth Gel Coat Fiberglass Exterior Walls
- Front and Rear Molded Fiberglass Caps
- Panaview™ 1-Piece Front Windshield
- Interior Height 84"
- Aluminum Framed Floor on Steel Trusses
- Laminated Structurwood™ Flooring
- Interior Paneling with 3/4" Insulation
- Foam Insulated Floor Framing with 3-Ply Underbelly
- One-Piece Engine Cover
- Power Heated Remote Exterior Mirrors
- Low-Profile Sealed LED Marker Lights
- Automotive Style Taillights
- Integrated Metal Fuel Door with Lock
- 30" Deep Bedroom Slide-Out Houses (N/A: 33SFS, 34SBD, 37PRT)
- Pass-Through Storage Bays under Slide-Outs with Polyethylene Boxes
- Side-Hinged Baggage Doors, All Door Locations
- One-Piece Polyethylene Storage Compartments
- Painted Mask and Skirt with Vinyl Exterior Graphics
- Rear Ladder
- Interior Rubber Entry Steps with Built-In Stepwell Storage Bucket
- Exterior Triple Entry Steps
- Undercoating

OPTIONS

- Deluxe Full-Body Paint with Vinyl Graphics
- 3M Film Front Mask
- Standard Run Savings Package: Deluxe Full-Body Paint with Vinyl Graphics, 3M Film Front Mask, Soft Touch Vinyl Pilot and Co-Pilot Seats, 3-Camera Rear Vision System, Power Sunvisors, Pilot and Co-Pilot Side Window Pull-Down Sunshades, 20" Color TV with Remote Control in Bedroom, Home Theater Surround Sound System with Sub-Woofers, Hardwood Raised Panel Doors on Refrigerator, Energy Management System, 600 Watt Inverter, Storage Compartment Tank Monitor Gauge, Fantastic 12V Attic Fan with Rain Sensor with Electronic Wall Thermostat in Bath, 12V Heater in Wet Bay, Poly-Weave Patio Awning

		Weight Ratings (Lbs.)				Measurements							Tank Capacity (Gal.) ²					
		Gross Vehicle	Gross Combined ¹	Front Gross Axle	Rear Gross Axle	Wheelbase	Overall Length	Overall Height (with A/C) (add 5" for satellite option)	Interior Height	Interior Width	Exterior Width	Water Heater	Gray Tank	Black Tank	Fresh Tank	LP Tank ³	Fuel Tank	
33PBD	Ford Chassis	22,000	26,000	7,500	14,500	228"	34' 3"	12' 6"	84"	94.5"	100.5"	10	45	54	60	24	75	
	W22 Chassis	22,000	26,000	8,000	14,500	228"	34' 3"	12' 6"	84"	94.5"	100.5"	10	45	54	60	24	75	
33SFS	Ford Chassis	N/A	N/A	N/A	N/A	N/A	N/A	N/A	N/A	N/A	N/A	N/A	N/A	N/A	N/A	N/A	N/A	
	W22 Chassis	22,000	26,000	8,000	14,500	228"	34' 3"	12' 6"	84"	94.5"	100.5"	10	54	42	60	24	75	
34SBD	Ford Chassis	22,000	26,000	7,500	14,500	228"	35' 2"	12' 6"	84"	94.5"	100.5"	10	40	42	60	24	75	
	W22 Chassis	22,000	26,000	8,000	14,500	228"	35' 2"	12' 6"	84"	94.5"	100.5"	10	40	42	60	24	75	
36PCT	Ford Chassis	22,000	26,000	7,500	14,500	242"	36' 9"	12' 6"	84"	94.5"	100.5"	10	TBD	TBD	60	24	75	
	W22 Chassis	22,000	26,000	8,000	14,500	242"	36' 9"	12' 6"	84"	94.5"	100.5"	10	TBD	TBD	60	24	75	
36DBD	Ford Chassis	22,000	26,000	7,500	14,500	242"	36' 9"	12' 6"	84"	94.5"	100.5"	10	42/39	42/39	60	24	75	
	W22 Chassis	22,000	26,000	8,000	14,500	242"	36' 9"	12' 6"	84"	94.5"	100.5"	10	42/39	42/39	60	24	75	
37PCT	Ford Chassis	22,000	26,000	7,500	14,500	242"	37' 4"	12' 6"	84"	94.5"	100.5"	10	45	54	60	24	75	
	W22 Chassis	22,000	26,000	8,000	14,500	242"	37' 4"	12' 6"	84"	94.5"	100.5"	10	45	54	60	24	75	
37PRT	Ford Chassis	22,000	26,000	7,500	14,500	242"	37' 4"	12' 6"	84"	94.5"	100.5"	10	45	54	60	24	75	
	W22 Chassis	22,000	26,000	8,000	14,500	242"	37' 4"	12' 6"	84"	94.5"	100.5"	10	45	54	60	24	75	

¹Towing capacity is limited by GCWR; your vehicle's towing capacity is the difference between the GCWR and the actual vehicle weight, including all water, fuel, passengers and cargo. Your towed vehicle should be equipped with auxiliary brakes if the weight of the towed vehicle exceeds 1,000 lbs. Consult your owner's manual for further information.

²All tank capacities are estimated based upon calculations provided by the tank manufacturers and represent approximate capacities. The actual "usable capacity" may be greater or less than the estimated capacities based upon fabrication and installation of the tanks.

³Actual filled LP capacity is 80% of listing due to safety shut-off required on tank.

The actual overall length of the recreational vehicle may differ from that indicated in the brochure due to variances in the manufacturing process and/or installed components. The actual length may be greater or less than that indicated. Due to the large variety of options and floorplan arrangements available to our customers, actual weights for each unit can differ significantly. Monaco Coach provides a weight sticker on each unit we produce which includes that unit's tank capacities and approximate weight. Consult your local Monaco Coach dealer for unit availability and further information. The information printed in this brochure reflects product design, fabrication, and component parts at the date of printing. The manufacturer reserves the right, at any time, to make changes in product design or material or component specifications as its sole option, without notice. This

includes the substitution of components of a different brand or trade name which will result in comparable performance. All information printed in this brochure is subject to change after the date of printing. Some features shown or mentioned in this brochure are optional and may only be available in selected floorplans. Photographs may show props or decorations that are not standard equipment on Monaco Coach models. Monaco Coach, the Monaco logo and its design, are registered trademarks. All other products and company names are trademarks and/or registered trademarks of their respective holders. While the color of the motorhome's exterior and the interior fabrics depicted in this sales brochure are fair and reasonable depictions, the colors depicted may not be an exact match of the actual colors because of the variances in photo-processing and variances caused by inserting the

photographs within the sales brochure. Due to product improvements, changes during the model year and/or transcription errors that may occur, information represented within this brochure may not be accurate at the time of your purchase. If certain information is significant to your purchasing decision, please confirm the information with your dealer prior to submitting your order. Component part and appliance manufacturers issue limited warranties covering those portions of the recreational vehicle not covered by the Limited Warranties issued by Monaco Coach Corporation. To learn which specific component parts and appliances are excluded from the Limited Warranties issued by Monaco Coach Corporation, please contact your selling dealership or Monaco Coach Corporation directly, or review the warranty packet inside the recreational vehicle.

BODY CONSTRUCTION

- › Alumaframe® Superstructure
- › Steel Cage Cockpit Construction
- › Peaked One-Piece Fiberglass Roof with Fiberglass Insulation
- › Smooth Gel Coat Fiberglass Exterior Walls
- › Front and Rear Molded Fiberglass Caps
- › Panaview™ 1-Piece Front Windshield
- › Interior Height 84"
- › Aluminum Framed Floor on Steel Trusses
- › Laminated Structurwood™ Flooring
- › Interior Paneling with 3/4" Insulation
- › Foam Insulated Floor Framing with 3-Ply Underbelly
- › One-Piece Engine Cover
- › Power Heated Remote Exterior Mirrors
- › Low-Profile Sealed LED Marker Lights
- › Automotive Style Taillights
- › Integrated Metal Fuel Door with Lock
- › 30" Deep Bedroom Slide-Out Houses (N/A: 33SFS, 34SBD, 37PRT)
- › Pass-Through Storage Bays under Slide-Outs with Polyethylene Boxes
- › Side-Hinged Baggage Doors, All Door Locations
- › One-Piece Polyethylene Storage Compartments
- › Painted Mask and Skirt with Vinyl Exterior Graphics
- › Rear Ladder
- › Interior Rubber Entry Steps with Built-In Stepwell Storage Bucket
- › Exterior Triple Entry Steps
- › Undercoating

OPTIONS

- › Deluxe Full-Body Paint with Vinyl Graphics
- › 3M Film Front Mask
- › Standard Run Savings Package: Deluxe Full-Body Paint with Vinyl Graphics, 3M Film Front Mask, Soft Touch Vinyl Pilot and Co-Pilot Seats, 3-Camera Rear Vision System, Power Sunvisors, Pilot and Co-Pilot Side Window Pull-Down Sunshades, 20" Color TV with Remote Control in Bedroom, Home Theater Surround Sound System with Sub-Woofer, Hardwood Raised Panel Doors on Refrigerator, Energy Management System, 600 Watt Inverter, Storage Compartment Tank Monitor Gauge, Fantastic 12V Attic Fan with Rain Sensor with Electronic Wall Thermostat in Bath, 12V Heater in Wet Bay, Poly-Weave Patio Awning



FORD 22,000 LB. CHASSIS/ENGINE/SUSPENSION (N/A: 33SFS)

- 6.8L 3-Valve V-10 Gasoline Engine with Electronic Fuel Injection
- Engine Displacement: 6.8 Liters 415 Cu. In.
- Power: 362 HP; Torque: 457 lbs./ft.
- TorqShift 5-Speed Automatic Overdrive Transmission with Tow/Haul Mode
- New Transmission Oil Temperature Gauge
- Fuel Tank Capacity 75 Gallon
- 130 Amp Alternator
- Rear Axle Ratio 5.38:1
- Radial Tires 235/80R x 22.5G
- Wheel/Rims (Polished Aluminum Wheels)
- Leaf Spring Suspension
- Front and Rear Disc, 4-Wheel Anti-Lock Brakes
- Heavy-Duty Front Track Bar with Bilstein® Shock Absorbers
- Fully Automatic Hydraulic Leveling System
- Pre-Wire for Supplemental Braking System
- 4,000 Lb. Hitch Receiver with Dual Connector 4-Pin or 7-Pin
- SmartStructure II

WORKHORSE 22,000 LB. CHASSIS/ENGINE/SUSPENSION

- 8.1L V-8 Gasoline Engine with Electronic Fuel Injection
- Engine Displacement: 8.1 Liters 496 Cu. In.
- Power: 340 HP; Torque: 455 lbs./ft.
- 6-Speed Automatic Transmission with Overdrive
- Fuel Tank Capacity 75 Gallon
- 145 Amp Alternator
- Rear Axle Ratio 5.86:1
- Radial Tires 235/80R x 22.5G
- Stainless Steel Wheel Liners
- Leaf Spring Suspension
- ABS Brake System
- Fully Automatic Hydraulic Leveling System
- Pre-Wire for Supplemental Braking System
- 4,000 Lb. Hitch Receiver with Dual Connector 4-Pin or 7-Pin
- SmartStructure II

COCKPIT

- Fiberglass Automotive Dash with Vinyl Covering with Silver Graphite Metallic Instrument Panel
- CD Player/Radio with DVD Player, Sirius-Ready Compatibility, Weather Band, Remote and Six Speakers
- Multi-Positioned Sunvisors
- Rear Vision System Prep
- Intermittent Windshield Wipers
- Tilt Steering Wheel
- Cruise Control
- Power Steering
- Electric Automotive Horn
- Wood Center Console on Engine Cover, Recess Tray with Rubber Mat and Plastic Two-Tier Cupholders, Front Tip-Door Ford/Front Drawer Workhorse Chassis
- Fabric Pilot and Co-Pilot Recliner Seats
- Six-Way Power Pilot Seat
- Carpeted Driver and Passenger Floor Mats
- Dash Workstation
- Wood Framed Cabinet Doors with Smoked Glass over Front Entertainment Center Systems
- Secure Front Cab over Television with Steel Framing

OPTIONS

- Six-Way Power Co-Pilot Seat
- Soft Touch Vinyl Pilot and Co-Pilot Seats
- Sirius Radio Satellite System with 6 Months Pre-Paid Activation
- GPS System High Speed DVD Navigation System (Requires Rear Vision System Selection)
- Single Camera Rear Vision System with Audio and Adjustable Camera
- 3-Camera Rear Vision System with Audio and Adjustable Center Camera
- Power Sunvisors
- Pilot and Co-Pilot Side Window Pull-Down Sunshades
- Interior Solar Privacy Sunscreens (Manual)
- CB Radio Prep
- Driver's Side Door with Power Window

APPLIANCES AND ACCESSORIES

- Large Double-Door Refrigerator
- High-Output 3-Burner Cooktop without Oven
- Bi-Fold Range Cover
- Spacesaver Convection Microwave with Touch Control
- 24" Stereo Color TV with Remote Control in Cockpit Overhead
- TV Antenna
- DVD and Video Control Box with Booster and RF Modulator; Control Boxes Allow DVD Player to Play Video in Bedroom TV
- Wiring for DVD Player Hook-Up to Both TV Locations
- Exterior Hook-Ups for DSS Dish and Cable
- Interior Cable TV Hook-Up and Telephone Jacks
- Digital Satellite System Prep
- Exterior Gas Line Hook-Up Prep for LP Accessories

OPTIONS

- Large Double-Door Refrigerator with Ice Maker
- Large Double-Door Refrigerator with Ice Maker 10 Cu. Ft.
- Large Four-Door Refrigerator with Ice Maker (N/A with Pantry) (N/A: 33SFS)
- High-Output 3-Burner Range with Oven
- Washer/Dryer Prep (N/A: 33SFS, 34SBD, 37PRT, 37PCT)
- Combination Washer/Dryer, Requires Washer/Dryer Prep Option (N/A: 33SFS, 34SBD, 37PRT, 37PCT)
- Central Vacuum System
- 20" Color TV with Remote Control in Bedroom
- Home Theater Surround Sound System with Sub-Woofer, Added to In-Dash Stereo with DVD Player
- Exterior Entertainment Center, CD Player Radio with Two Speakers



FORD 22,000 LB. CHASSIS/ENGINE/SUSPENSION (N/A: 33SFS)

- › 6.8L 3-Valve V-10 Gasoline Engine with Electronic Fuel Injection
- › Engine Displacement: 6.8 Liters 415 Cu. In.
- › Power: 362 HP; Torque: 457 lbs./ft.
- › TorqShift 5-Speed Automatic Overdrive Transmission with Tow/Haul Mode
- › New Transmission Oil Temperature Gauge
- › Fuel Tank Capacity 75 Gallon
- › 130 Amp Alternator
- › Rear Axle Ratio 5.38:1
- › Radial Tires 235/80R x 22.5G
- › Wheel/Rims (Polished Aluminum Wheels)
- › Leaf Spring Suspension
- › Front and Rear Disc, 4-Wheel Anti-Lock Brakes
- › Heavy-Duty Front Track Bar with Bilstein® Shock Absorbers
- › Fully Automatic Hydraulic Leveling System
- › Pre-Wire for Supplemental Braking System
- › 4,000 Lb. Hitch Receiver with Dual Connector 4-Pin or 7-Pin
- › SmartStructure II

WORKHORSE 22,000 LB. CHASSIS/ENGINE/SUSPENSION

- › 8.1L V-8 Gasoline Engine with Electronic Fuel Injection
- › Engine Displacement: 8.1 Liters 496 Cu. In.
- › Power: 340 HP; Torque: 455 lbs./ft.
- › 6-Speed Automatic Transmission with Overdrive
- › Fuel Tank Capacity 75 Gallon
- › 145 Amp Alternator
- › Rear Axle Ratio 5.86:1
- › Radial Tires 235/80R x 22.5G
- › Stainless Steel Wheel Liners
- › Leaf Spring Suspension
- › ABS Brake System
- › Fully Automatic Hydraulic Leveling System
- › Pre-Wire for Supplemental Braking System
- › 4,000 Lb. Hitch Receiver with Dual Connector 4-Pin or 7-Pin
- › SmartStructure II

COCKPIT

- › Fiberglass Automotive Dash with Vinyl Covering with Silver Graphite Metallic Instrument Panel
- › CD Player/Radio with DVD Player, Sirius-Ready Compatibility, Weather Band, Remote and Six Speakers
- › Multi-Positioned Sunvisors
- › Rear Vision System Prep
- › Intermittent Windshield Wipers
- › Tilt Steering Wheel
- › Cruise Control
- › Power Steering
- › Electric Automotive Horn
- › Wood Center Console on Engine Cover, Recess Tray with Rubber Mat and Plastic Two-Tier Cupholders, Front Tip-Door Ford/ Front Drawer Workhorse Chassis
- › Fabric Pilot and Co-Pilot Recliner Seats
- › Six-Way Power Pilot Seat
- › Carpeted Driver and Passenger Floor Mats
- › Dash Workstation
- › Wood Framed Cabinet Doors with Smoked Glass over Front Entertainment Center Systems
- › Secure Front Cab over Television with Steel Framing

OPTIONS

- › Six-Way Power Co-Pilot Seat
- › Soft Touch Vinyl Pilot and Co-Pilot Seats
- › Sirius Radio Satellite System with 6 Months Pre-Paid Activation
- › GPS System High Speed DVD Navigation System (Requires Rear Vision System Selection)
- › Single Camera Rear Vision System with Audio and Adjustable Camera
- › 3-Camera Rear Vision System with Audio and Adjustable Center Camera
- › Power Sunvisors
- › Pilot and Co-Pilot Side Window Pull-Down Sunshades
- › Interior Solar Privacy Sunscreens (Manual)
- › CB Radio Prep
- › Driver's Side Door with Power Window

APPLIANCES AND ACCESSORIES

- › Large Double-Door Refrigerator
- › High-Output 3-Burner Cooktop without Oven
- › Bi-Fold Range Cover
- › Spacesaver Convection Microwave with Touch Control
- › 24" Stereo Color TV with Remote Control in Cockpit Overhead
- › TV Antenna
- › DVD and Video Control Box with Booster and RF Modulator; Control Boxes Allow DVD Player to Play Video in Bedroom TV
- › Wiring for DVD Player Hook-Up to Both TV Locations
- › Exterior Hook-Ups for DSS Dish and Cable
- › Interior Cable TV Hook-Up and Telephone Jacks
- › Digital Satellite System Prep
- › Exterior Gas Line Hook-Up Prep for LP Accessories

OPTIONS

- › Large Double-Door Refrigerator with Ice Maker
- › Large Double-Door Refrigerator with Ice Maker 10 Cu. Ft.
- › Large Four-Door Refrigerator with Ice Maker (N/A with Pantry) (N/A: 33SFS)
- › High-Output 3-Burner Range with Oven
- › Washer/Dryer Prep (N/A: 33SFS, 34SBD, 37PRT, 37PCT)
- › Combination Washer/Dryer, Requires Washer/Dryer Prep Option (N/A: 33SFS, 34SBD, 37PRT, 37PCT)
- › Central Vacuum System
- › 20" Color TV with Remote Control in Bedroom
- › Home Theater Surround Sound System with Sub-Woofer, Added to In-Dash Stereo with DVD Player
- › Exterior Entertainment Center, CD Player Radio with Two Speakers

INTERIOR

- New Vintage Oak Cabinetry
- Raised Panel Cabinet Doors on Overhead Cabinets and Wardrobes, Flat Panel Doors on Base Cabinets
- Cabinet End Panels
- Black ABS Refrigerator Insert
- Wallpaper Border Kitchen and Bath
- Mini Struts Top-Hinged Overhead Storage Doors and Positive Catches on All Other Doors
- Heavy-Duty Ball Bearing Drawer Guides
- Wood Cabinet Drawer Boxes
- Wood Interior Grab Handle with Satin Nickel End Brackets Mounted to Cabinet at Entry Door
- Satin Nickel Finished Entry Rail for Stepwell
- Satin Nickel Cabinetry Hardware and Bath Accessories
- Integrated Cup Holder to Slide-Out next to Sofa
- Rigid Vinyl Laminated Kitchen Countertop, Stainless Steel Sink, Brushed Nickel Faucet and Two Sink Covers
- Kitchen Countertop Extension with Two Drawers Below (N/A: 33SFS, 36PCT)
- Toe Kicks Kitchen and Bath Base Cabinets
- Rigid Vinyl Laminated Bath Lavatory Countertop
- All Other Countertops are Rigid Vinyl Laminated
- Kitchen Overhead Cabinets with Adjustable Shelf
- Kitchen Pantry next to Refrigerator with Full-Height Roll-Out Storage in Cabinet (N/A with Four-Door Refrigerator Option)
- Kitchen: Smoked Mirrors behind Stove Area (33SFS)
- Laminate Tile Flooring Kitchen, Bath and Entry
- Rear Bath Flooring to Match Flooring Selection of Kitchen and Front Bath (36DBD)
- Upgrade Nylon Carpeting with Pad in Living Area and Bedroom
- Soft Touch Padded Vinyl Ceiling
- Wood Slide-Out Fascia with Fabric Inserts on Legs
- Arched Beveled Living Area or Bedroom Mirror (N/A: 33SFS, 37PRT)
- Hutch with Glass Doors/Back Lighted Glass (37PRT, 37PCT)
- Bath Door with Accent Trim on Hallway Side
- Wood Trim on Bath Door Opening Hallway Side (Door Casing Trim)
- French Style Door into Bedroom (37PRT, 37PCT)
- Magazine Rack Bathroom (N/A: 33PBD, 33SFS, 34SBD)
- Accent Crown Molding in Bedroom and Living Area on All Open Walls
- Bathroom Lavatory Base Mirror with Wood Frame
- Side Wardrobe Closet with Deluxe Mirror Door Frames Satin Nickel Finish (33PBD, 36PCT)
- Bedroom Swing-Away TV Cabinets (Stationary 33SFS, 36DBD)
- Bedspread with Two Decorative Pillows
- Decorative Fabric Headboard (N/A: 37PRT)
- Blackout Day/Night Pleated Shades in Living Area and Bedroom, Mini Blinds in Kitchen and Bathroom, Where Applicable
- Soil Repellant on Fabric, Teflon® Fabric Protection
- Satin Nickel Clock above Entry Door

OPTIONS

- New Decors: Sand Dune, English Walnut, Butternut, Laurel Square
- Wood Choice: Newport Cherry, Champagne Select
- Hardwood Raised Panel Doors on Refrigerator IPO Black ABS Refrigerator Insert

FURNITURE

- Queen Bed with Nightstands (N/A: 37PRT)
- Murphy Bed with Side Cabinets, Fabric Jackknife Sofa Located on Bottom Side of Murphy Bed (37PRT)
- Roadside Bedroom Slide-Out, Fabric Jackknife Sofa, Two Pillows (37PRT)
- Arched Back Wood Booth Dinette with Legless Dream Dinette Countertop and 30" Drawer (N/A: 33SFS)
- Forward-Facing Seatbelts in Booth Dinette inside Living Area Slide-Out (N/A: 33SFS)
- Freestanding Dinette with Two Freestanding Chairs and Two Folding Chairs (33SFS)
- Roadside: Fabric Jackknife Sofa, Two Pillows on All Sofas
- Fabric Swivel Glider Barrel Chair
- Roadside Dresser below Bedroom Window (36DBD)
- Fabric Swivel Glider Barrel Chair with Desk and Desk Chair Bedroom (37PCT)

OPTIONS

- Roadside Front of Coach: Fabric Hide-A-Bed Sofa with Two Pillows
- Roadside Front of Coach: Fabric Hide-A-Bed Sofa with Air Mattress and Two Pillows
- Soft Touch Vinyl Swivel Recliner Chair IPO Fabric Swivel Glider Barrel Chair
- OptimaLeather™ Euro-Recliner Chair with Ottoman IPO Barrel Chair
- (2) Fabric Swivel Glider Barrel Chairs with Center Lift-Up Table IPO Desk and Desk Chair Bedroom (37PCT)
- Bedroom Desk IPO Dresser (36DBD)
- Hallway Bunks with LCD TV and AV Game Plate Built into Outside of Bath Wall with Bunk Ladder (34SBD)
- Freestanding Dinette with Two Freestanding Chairs and Two Folding Chairs (N/A: 33SFS)

SAFETY

- Fire Extinguisher
- Deadbolt Lock on Entrance Door
- 120V GFI Protected Circuit, Kitchen, Bath and Exterior
- LP Gas Detector
- Smoke Detector
- Carbon Monoxide Detector
- Pilot and Co-Pilot Three-Point Seatbelts
- Third Brake Safety Light
- Egress Windows

INTERIOR

- › New Vintage Oak Cabinetry
- › Raised Panel Cabinet Doors on Overhead Cabinets and Wardrobes, Flat Panel Doors on Base Cabinets
- › Cabinet End Panels
- › Black ABS Refrigerator Insert
- › Wallpaper Border Kitchen and Bath
- › Mini Struts Top-Hinged Overhead Storage Doors and Positive Catches on All Other Doors
- › Heavy-Duty Ball Bearing Drawer Guides
- › Wood Cabinet Drawer Boxes
- › Wood Interior Grab Handle with Satin Nickel End Brackets Mounted to Cabinet at Entry Door
- › Satin Nickel Finished Entry Rail for Stepwell
- › Satin Nickel Cabinetry Hardware and Bath Accessories
- › Integrated Cup Holder to Slide-Out next to Sofa
- › Rigid Vinyl Laminated Kitchen Countertop, Stainless Steel Sink, Brushed Nickel Faucet and Two Sink Covers
- › Kitchen Countertop Extension with Two Drawers Below (N/A: 33SFS, 36PCT)
- › Toe Kicks Kitchen and Bath Base Cabinets
- › Rigid Vinyl Laminated Bath Lavatory Countertop
- › All Other Countertops are Rigid Vinyl Laminated
- › Kitchen Overhead Cabinets with Adjustable Shelf
- › Kitchen Pantry next to Refrigerator with Full-Height Roll-Out Storage in Cabinet (N/A with Four-Door Refrigerator Option)
- › Kitchen: Smoked Mirrors behind Stove Area (33SFS)
- › Laminate Tile Flooring Kitchen, Bath and Entry
- › Rear Bath Flooring to Match Flooring Selection of Kitchen and Front Bath (36DBD)
- › Upgrade Nylon Carpeting with Pad in Living Area and Bedroom
- › Soft Touch Padded Vinyl Ceiling
- › Wood Slide-Out Fascia with Fabric Inserts on Legs
- › Arched Beveled Living Area or Bedroom Mirror (N/A: 33SFS, 37PRT)
- › Hutch with Glass Doors/Back Lighted Glass (37PRT, 37PCT)
- › Bath Door with Accent Trim on Hallway Side
- › Wood Trim on Bath Door Opening Hallway Side (Door Casing Trim)
- › French Style Door into Bedroom (37PRT, 37PCT)
- › Magazine Rack Bathroom (N/A: 33PBD, 33SFS, 34SBD)
- › Accent Crown Molding in Bedroom and Living Area on All Open Walls
- › Bathroom Lavatory Base Mirror with Wood Frame
- › Side Wardrobe Closet with Deluxe Mirror Door Frames Satin Nickel Finish (33PBD, 36PCT)
- › Bedroom Swing-Away TV Cabinets (Stationary 33SFS, 36DBD)
- › Bedspread with Two Decorative Pillows
- › Decorative Fabric Headboard (N/A: 37PRT)
- › Blackout Day/Night Pleated Shades in Living Area and Bedroom, Mini Blinds in Kitchen and Bathroom, Where Applicable
- › Soil Repellent on Fabric, Teflon® Fabric Protection
- › Satin Nickel Clock above Entry Door

OPTIONS

- › New Decors: Sand Dune, English Walnut, Butternut, Laurel Square
- › Wood Choice: Newport Cherry, Champagne Select
- › Hardwood Raised Panel Doors on Refrigerator IPO Black ABS Refrigerator Insert

FURNITURE

- › Queen Bed with Nightstands (N/A: 37PRT)
- › Murphy Bed with Side Cabinets, Fabric Jackknife Sofa Located on Bottom Side of Murphy Bed (37PRT)
- › Roadside Bedroom Slide-Out, Fabric Jackknife Sofa, Two Pillows (37PRT)
- › Arched Back Wood Booth Dinette with Legless Dream Dinette Countertop and 30" Drawer (N/A: 33SFS)
- › Forward-Facing Seatbelts in Booth Dinette inside Living Area Slide-Out (N/A: 33SFS)
- › Freestanding Dinette with Two Freestanding Chairs and Two Folding Chairs (33SFS)
- › Roadside: Fabric Jackknife Sofa, Two Pillows on All Sofas
- › Fabric Swivel Glider Barrel Chair
- › Roadside Dresser below Bedroom Window (36DBD)
- › Fabric Swivel Glider Barrel Chair with Desk and Desk Chair Bedroom (37PCT)

OPTIONS

- › Roadside Front of Coach: Fabric Hide-A-Bed Sofa with Two Pillows
- › Roadside Front of Coach: Fabric Hide-A-Bed Sofa with Air Mattress and Two Pillows
- › Soft Touch Vinyl Swivel Recliner Chair IPO Fabric Swivel Glider Barrel Chair
- › OptimaLeather™ Euro-Recliner Chair with Ottoman IPO Barrel Chair
- › (2) Fabric Swivel Glider Barrel Chairs with Center Lift-Up Table IPO Desk and Desk Chair Bedroom (37PCT)
- › Bedroom Desk IPO Dresser (36DBD)
- › Hallway Bunks with LCD TV and AV Game Plate Built into Outside of Bath Wall with Bunk Ladder (34SBD)
- › Freestanding Dinette with Two Freestanding Chairs and Two Folding Chairs (N/A: 33SFS)

SAFETY

- › Fire Extinguisher
- › Deadbolt Lock on Entrance Door
- › 120V GFI Protected Circuit, Kitchen, Bath and Exterior
- › LP Gas Detector
- › Smoke Detector
- › Carbon Monoxide Detector
- › Pilot and Co-Pilot Three-Point Seatbelts
- › Third Brake Safety Light
- › Egress Windows



ELECTRICAL SYSTEMS AND LIGHTS

- 50 Amp 120V Distribution Panel and Cord
- 60 Amp Electronic 12V Power Converter
- Onan® 5.5 kW Gas Generator
- Two 6V House Batteries
- Battery Disconnect Switches
- 12V and 110V Outlet in Cockpit Area
- Porch Light and Exterior Step Light on Same Switch
- Exterior Power Entry Step with Light
- Interior Stepwell Entry Step Lights
- Water Pump Switch in Service Bay Area and Convenience Center
- Lights in Outside Storage Compartments
- 120V Receptacles in Outside Storage Compartment
- Underhood Utility Light
- Receptacle and Phone Jack in Dinette Area
- Directional Map Lights Pilot and Co-Pilot Seats
- Hallway Convenience Center
- Fluorescent Light(s) with Night Light Function under Kitchen and Living Room Hutch Cabinets
- Fluorescent Ceiling Lights Throughout
- Fluorescent Ceiling Lights inside Living Area Slide-Out House
- Decorative Wood Framed Galley Ceiling Fluorescent Light
- Decorative Satin Nickel Lighting, Living Room Wall Light, Dinette Overhead Light, Bathroom Lavatory Light with Lens Cover and Bedroom Cosmetic Vanity Light

- Satin Nickel Halogen Lights under Living Room and Dining Room Overhead Cabinets
- Satin Nickel Finish Bullet Lights over Bed with His and Hers Switches (On Each Side above Nightstands)
- Wardrobe Closet Lights (N/A: 33PBD)

OPTIONS

- 50 Amp Energy Management System
- 600 Watt Inverter
- Storage Compartment Tank Monitor Gauge

PLUMBING AND LP SYSTEMS

- Kitchen Stainless Steel Sink with Single Lever Brushed Nickel Faucet
- Separate Brushed Chrome Faucet for Filtered Water
- New Satin Nickel Bath Lavatory Faucet
- Demand Water System and Water Pump
- 10 Gallon LP Gas/Electric Water Heater with Electronic Ignition, DSI
- Winterization Valving System
- Water Heater Bypass Valve
- Toilet with Sprayer
- No-Fuss Flush Holding Tank Rinsing System
- Insulated Systems Compartment with Easy Access to Hook-Up
- Shower inside Wet Bay with Hot/Cold Water, Shower Head with Shut-Off
- Soap Dispenser inside Utility Bay
- Gravity and Pressurized Water Fill
- Contained Storage Area for Sewer Hose
- One-Piece Fiberglass Shower
- Shower Faucet with Shower Hose and Head with Shut-Off
- Shower Light on Wall inside Shower Area
- Satin Nickel Shower Door Frame with Obscure Glass, Increased Height (N/A: 36PCT)
- Rounded Satin Nickel Shower Door Frame with Decorative Glass (36PCT)

OPTIONS

- RV Sani-Con 2 System, Holding Tank Flush System with Hanging Bracket for Hose
- Bathtub IPO Shower (Rounded Shower Stalls are Neo-Angled with Tub Option)

HEATING, VENTS AND AIR CONDITIONING

- Dual 13.5M BTU Air Conditioner, with Ducted Air and Wall Thermostats
- 35M BTU Electronic Ignition Furnace
- Electronic Dash AC/Heat Climate Control System
- In-Floor Ducted Heating System with Metal Floor Registers
- Kitchen Powered Attic Fan with Wall Control of Automatic Dome and Fan Power
- Bath Powered Attic Fan with Wall Control of Automatic Dome and Fan Power
- Metal Air Return Grill Furnace Satin Nickel Finish
- Metal Floor Registers Satin Nickel

OPTIONS

- Dual 13.5M BTU Air Conditioner with Heat Pumps
- Fantastic 12V Attic Fan with Rain Sensor with Electronic Wall Thermostat, Kitchen
- Fantastic 12V Attic Fan with Rain Sensor with Electronic Wall Thermostat, Bath
- 12V Heater in Wet Bay, Heat Pad on Fresh Tank

WINDOWS, DOORS AND AWNINGS

- Radius Flush-Mounted Dual Pane Windows Safety Glass Dark Tinted
- Rear Wall Bedroom Window (N/A: 33SFS, 36DBD)
- Bathroom Window (N/A: 33PBD, 33SFS, 34SBD)
- Radius Entrance Door with Clear Glass, Roller Shade, Screen Door and Anti-Skid Steps
- Two Interior Grab Handles and One Exterior Grab Handle
- Topper Slide-Out Awnings Living Area and Bedroom
- Protecta Glaze Tinted Plexiglas® Skylight in Bathroom
- Awning Rail

OPTIONS

- Poly-Weave Patio Awning
- Eclipse Poly-Weave Automatic Patio Awning
- Poly-Weave Window Awnings Living Area Slide-Out House Windows
- Bedroom Skylight 30" x 30" Decorative Wood Framed with Shade (37PCT)
- Poly-Weave Side Window Awning Bedroom (33SFS, 34SBD, 36DBD)



ELECTRICAL SYSTEMS AND LIGHTS

- › 50 Amp 120V Distribution Panel and Cord
- › 60 Amp Electronic 12V Power Converter
- › Onan® 5.5 kW Gas Generator
- › Two 6V House Batteries
- › Battery Disconnect Switches
- › 12V and 110V Outlet in Cockpit Area
- › Porch Light and Exterior Step Light on Same Switch
- › Exterior Power Entry Step with Light
- › Interior Stepwell Entry Step Lights
- › Water Pump Switch in Service Bay Area and Convenience Center
- › Lights in Outside Storage Compartments
- › 120V Receptacles in Outside Storage Compartment
- › Underhood Utility Light
- › Receptacle and Phone Jack in Dinette Area
- › Directional Map Lights Pilot and Co-Pilot Seats
- › Hallway Convenience Center
- › Fluorescent Light(s) with Night Light Function under Kitchen and Living Room Hutch Cabinets
- › Fluorescent Ceiling Lights Throughout
- › Fluorescent Ceiling Lights inside Living Area Slide-Out House
- › Decorative Wood Framed Galley Ceiling Fluorescent Light
- › Decorative Satin Nickel Lighting, Living Room Wall Light, Dinette Overhead Light, Bathroom Lavatory Light with Lens Cover and Bedroom Cosmetic Vanity Light
- › Satin Nickel Halogen Lights under Living Room and Dining Room Overhead Cabinets
- › Satin Nickel Finish Bullet Lights over Bed with His and Hers Switches (On Each Side above Nightstands)
- › Wardrobe Closet Lights (N/A: 33PBD)

OPTIONS

- › 50 Amp Energy Management System
- › 600 Watt Inverter
- › Storage Compartment Tank Monitor Gauge

PLUMBING AND LP SYSTEMS

- › Kitchen Stainless Steel Sink with Single Lever Brushed Nickel Faucet
- › Separate Brushed Chrome Faucet for Filtered Water
- › New Satin Nickel Bath Lavatory Faucet
- › Demand Water System and Water Pump
- › 10 Gallon LP Gas/Electric Water Heater with Electronic Ignition, DSI
- › Winterization Valving System
- › Water Heater Bypass Valve
- › Toilet with Sprayer
- › No-Fuss Flush Holding Tank Rinsing System
- › Insulated Systems Compartment with Easy Access to Hook-Up
- › Shower inside Wet Bay with Hot/Cold Water, Shower Head with Shut-Off
- › Soap Dispenser inside Utility Bay
- › Gravity and Pressurized Water Fill
- › Contained Storage Area for Sewer Hose
- › One-Piece Fiberglass Shower
- › Shower Faucet with Shower Hose and Head with Shut-Off
- › Shower Light on Wall inside Shower Area
- › Satin Nickel Shower Door Frame with Obscure Glass, Increased Height (N/A: 36PCT)
- › Rounded Satin Nickel Shower Door Frame with Decorative Glass (36PCT)

OPTIONS

- › RV Sani-Con 2 System, Holding Tank Flush System with Hanging Bracket for Hose
- › Bathtub IPO Shower (Rounded Shower Stalls are Neo-Angled with Tub Option)

HEATING, VENTS AND AIR CONDITIONING

- › Dual 13.5M BTU Air Conditioner, with Ducted Air and Wall Thermostats
- › 35M BTU Electronic Ignition Furnace
- › Electronic Dash AC/Heat Climate Control System
- › In-Floor Ducted Heating System with Metal Floor Registers
- › Kitchen Powered Attic Fan with Wall Control of Automatic Dome and Fan Power
- › Bath Powered Attic Fan with Wall Control of Automatic Dome and Fan Power
- › Metal Air Return Grill Furnace Satin Nickel Finish
- › Metal Floor Registers Satin Nickel

OPTIONS

- › Dual 13.5M BTU Air Conditioner with Heat Pumps
- › Fantastic 12V Attic Fan with Rain Sensor with Electronic Wall Thermostat, Kitchen
- › Fantastic 12V Attic Fan with Rain Sensor with Electronic Wall Thermostat, Bath
- › 12V Heater in Wet Bay, Heat Pad on Fresh Tank

WINDOWS, DOORS AND AWNINGS

- › Radius Flush-Mounted Dual Pane Windows Safety Glass Dark Tinted
- › Rear Wall Bedroom Window (N/A: 33SFS, 36DBD)
- › Bathroom Window (N/A: 33PBD, 33SFS, 34SBD)
- › Radius Entrance Door with Clear Glass, Roller Shade, Screen Door and Anti-Skid Steps
- › Two Interior Grab Handles and One Exterior Grab Handle
- › Topper Slide-Out Awnings Living Area and Bedroom
- › Protecta Glaze Tinted Plexiglas® Skylight in Bathroom
- › Awning Rail

OPTIONS

- › Poly-Weave Patio Awning
- › Eclipse Poly-Weave Automatic Patio Awning
- › Poly-Weave Window Awnings Living Area Slide-Out House Windows
- › Bedroom Skylight 30" x 30" Decorative Wood Framed with Shade (37PCT)
- › Poly-Weave Side Window Awning Bedroom (33SFS, 34SBD, 36DBD)

MONARCH® SVE



SMALLER SIZE. BIGGER VALUE.

NEW VINTAGE OAK



NEWPORT CHERRY



CHAMPAGNE SELECT



Folks loved our shorter 30PDD floorplan so much last year, we decided to add to the lineup. Introducing the Monarch SVE series. It's a whole new line of shorter coaches with a special value edition price. But even though it's priced for smaller budgets, the SVE is still loaded with Monaco quality. There's even a PanaSuite™ full-wall slide on the 30SFS.

30PBS



TILE CARPET

30SFS

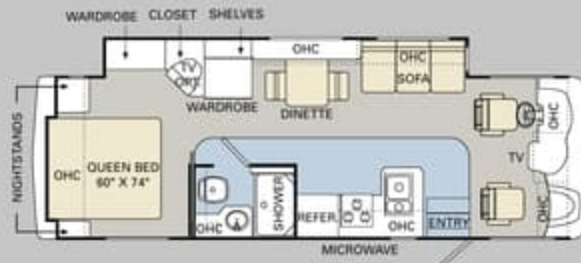

30PDD

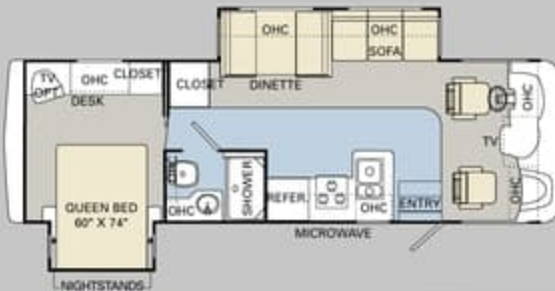

33PBD

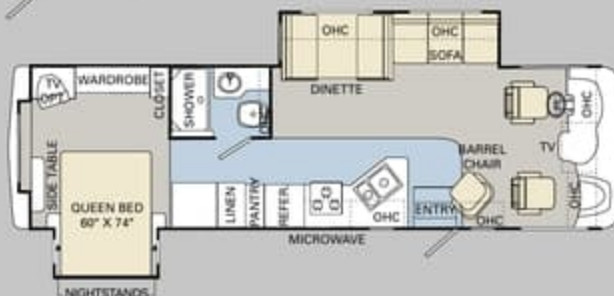

MONARCH® SVE



SMALLER SIZE. BIGGER VALUE.

NEW VINTAGE OAK



NEWPORT CHERRY



CHAMPAGNE SELECT



Folks loved our shorter 30PDD floorplan so much last year, we decided to add to the lineup. Introducing the Monarch SVE series. It's a whole new line of shorter coaches with a special value edition price. But even though it's priced for smaller budgets, the SVE is still loaded with Monaco quality. There's even a PanaSuite™ full-wall slide on the 30SFS.

30PBS

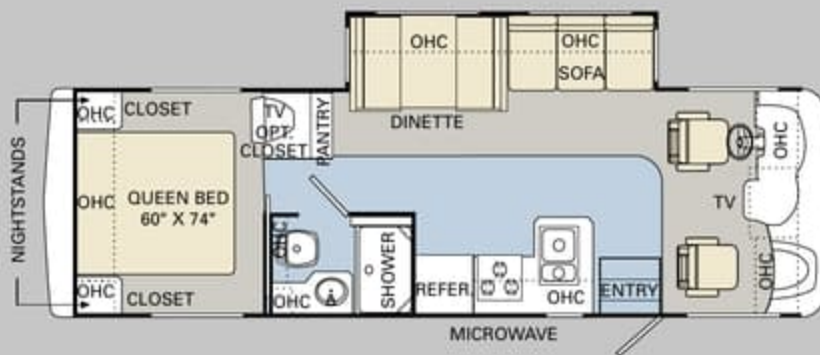

TILE CARPET

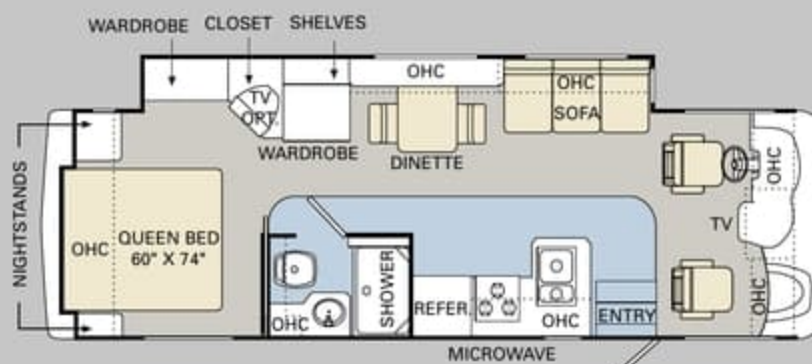

30SFS

30PDD

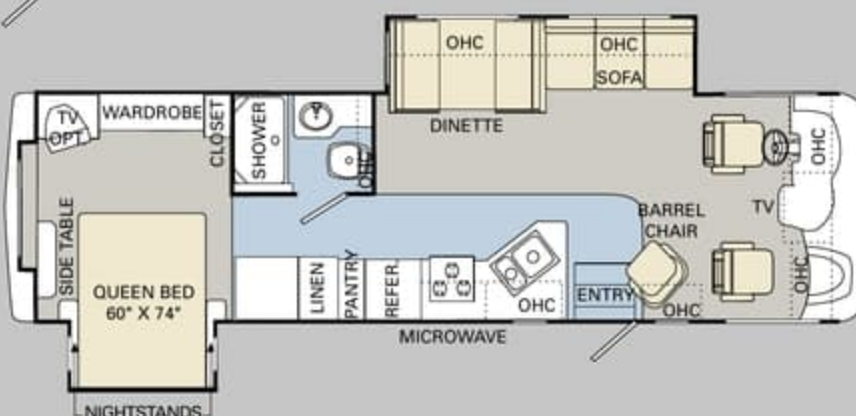
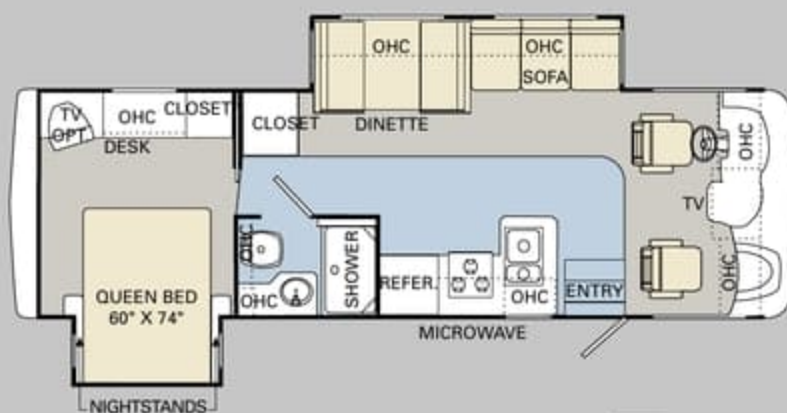

33PBD



The Monarch SVE is everything you love about the Monarch, but with extra savings thrown in. It boasts the same exclusive Panaview™ 1-Piece Windshield, side-hinged baggage doors, and one-piece peaked fiberglass roof as our larger models. And on the inside, it's a quality Monaco coach all the way.

		Weight Ratings (Lbs.)				Measurements	Tank Capacity (Gal.) ¹										
		Gross Vehicle	Gross Combined ²	Front Gross Axle	Rear Gross Axle		Wheelbase	Overall Length	Overall Height (with A/O load ³ for satellite option)	Interior Height	Interior Width	Exterior Width	Water Heater	Gray Tank	Black Tank	Fresh Tank	LP Tank ⁴
30PBS	Ford Chassis	20,500	25,500	7,000	13,500	190"	31'	12' 6"	84"	94.5"	100.5"	6	42	42	60	18	75
	Workhorse Chassis	20,700	25,700	7,500	13,500	190"	31'	12' 6"	84"	94.5"	100.5"	6	42	42	60	18	75
30PDD	Ford Chassis	20,500	25,500	7,000	13,500	190"	31'	12' 6"	84"	94.5"	100.5"	6	43	45	60	18	75
	Workhorse Chassis	20,700	25,700	7,500	13,500	190"	31'	12' 6"	84"	94.5"	100.5"	6	42	42	60	18	75
30SFS	Ford Chassis	20,500	25,500	7,000	13,500	190"	31'	12' 6"	84"	94.5"	100.5"	6	43	45	60	18	75
	Workhorse Chassis	20,700	25,700	7,500	13,500	190"	31'	12' 6"	84"	94.5"	100.5"	6	42	42	60	18	75
33PBD	Ford Chassis	22,000	26,000	7,500	14,500	228"	34' 3"	12' 6"	84"	94.5"	100.5"	6	42	42	60	18	75
	W22 Chassis	22,000	26,000	8,000	14,500	228"	34' 3"	12' 6"	84"	94.5"	100.5"	6	42	42	60	18	75

¹Towing capacity is limited by GCWR; your vehicle's towing capacity is the difference between the GCWR and the actual vehicle weight, including all water, fuel, passengers and cargo. Your towed vehicle should be equipped with auxiliary brakes if the weight of the towed vehicle exceeds 1,000 lbs. Consult your owner's manual for further towing information.

²All tank capacities are estimated based upon calculations provided by the tank manufacturers and represent approximate capacities. The actual "usable capacity" may be greater or less than the estimated capacities based upon fabrication and installation of the tanks.

³Actual filled LP capacity is 80% of listing due to safety shut-off required on tank.

BODY CONSTRUCTION

- Alumaframe® Superstructure
- Steel Cage Cockpit Construction
- Peaked One-Piece Fiberglass Roof with Fiberglass Insulation
- Smooth Aluminum Exterior Walls
- Front and Rear Molded Fiberglass Caps
- Panaview™ 1-Piece Front Windshield
- Interior Height 84"
- Aluminum Framed Floor on Steel Trusses
- Laminated Structurwood™ Flooring
- Interior Paneling with 3/4" Insulation
- Foam Insulated Floor Framing with 3-Ply Underbelly
- One-Piece Engine Cover
- Black Front-Mounted Exterior Mirrors
- Low-Profile Sealed LED Marker Lights
- Automotive Style Taillights
- Integrated Metal Fuel Door with Lock
- 30" Deep Bedroom Slide-Out Houses (30PDD, 33PBD)
- Pass-Through Storage Bays under Slide-Outs with Polyethylene Boxes
- Side-Hinged Baggage Doors, All Door Locations
- One-Piece Polyethylene Storage Compartments
- New Painted Skirt and Mask with Vinyl Exterior Graphics
- Interior Rubber Entry Steps
- Exterior Double Entry Steps (N/A: 33PBD)
- Exterior Triple Entry Steps (33PBD)
- Undercoating

OPTIONS

- Rear Ladder
- Standard Run Savings Package: Rear Ladder, Fully Automatic Hydraulic Leveling System, Rear Vision System with Audio and Adjustable Camera, Six-Way Power Pilot Seat, Bi-Fold Range Cover, 20" Stereo Color TV with Remote Control in Bedroom, 6-Gallon LP Gas/Electric Water Heater with Electronic Ignition, DSI, 12V Heater in Wet Bay, Vinyl Patio Awning

FORD 20,500 LB. CHASSIS/ENGINE/SUSPENSION (N/A: 33PBD)

- 6.8L 3-Valve V-10 Gasoline Engine with Electronic Fuel Injection
- Engine Displacement: 6.8 Liters 415 Cu. In.
- Power: 362 HP; Torque: 457 lbs./ft.
- TorqShift 5-Speed Automatic Overdrive Transmission with Tow/Haul Mode
- New Transmission Oil Temperature Gauge
- Fuel Tank Capacity 75 Gallon
- 130 Amp Alternator
- Rear Axle Ratio 5.38:1
- Radial Tires 245/70R x 19.5F
- Wheel/Rims (Chrome Wheel Covers)
- Leaf Spring Suspension
- Front and Rear Disc, 4-Wheel Anti-Lock Brakes
- Heavy-Duty Front Track Bar with Bilstein® Shock Absorbers
- Pre-Wire for Supplemental Braking System
- Hitch Receiver with Dual Connector 4-Pin or 7-Pin (5,000 Lb.)
- SmartStructure II

OPTIONS

- Fully Automatic Hydraulic Leveling System
- Stainless Steel Wheel Simulators, Standard on Workhorse Chassis

WORKHORSE 20,700 LB. CHASSIS/ENGINE/SUSPENSION (N/A: 33PBD)

- 8.1L V-8 Gasoline Engine with Electronic Fuel Injection
- Engine Displacement: 8.1 Liters 496 Cu. In.
- Power: 340 HP; Torque: 455 lbs./ft.
- 6-Speed Automatic Transmission with Overdrive
- Fuel Tank Capacity 75 Gallon
- 145 Amp Alternator
- Rear Axle Ratio 5.13:1
- Radial Tires 245/70R x 19.5F
- Stainless Steel Wheel Liners
- Leaf Spring Suspension
- ABS Brake System
- Pre-Wire for Supplemental Braking System
- Hitch Receiver with Dual Connector 4-Pin or 7-Pin (5,000 Lb.)
- SmartStructure II

OPTIONS

- Fully Automatic Hydraulic Leveling System



The Monarch SVE is everything you love about the Monarch, but with extra savings thrown in. It boasts the same exclusive Panaview™ 1-Piece Windshield, side-hinged baggage doors, and one-piece peaked fiberglass roof as our larger models. And on the inside, it's a quality Monaco coach all the way.

		Weight Ratings (Lbs.)				Measurements							Tank Capacity (Gal.) ²					
		Gross Vehicle	Gross Combined ¹	Front Gross Axle	Rear Gross Axle	Wheelbase	Overall Length	Overall Height (with A/C add 5" for satellite option)	Interior Height	Interior Width	Exterior Width	Water Heater	Gray Tank	Black Tank	Fresh Tank	LP Tank ³	Fuel Tank	
30PBS	Ford Chassis	20,500	25,500	7,000	13,500	190"	31'	12' 6"	84"	94.5"	100.5"	6	42	42	60	18	75	
	Workhorse Chassis	20,700	25,700	7,500	13,500	190"	31'	12' 6"	84"	94.5"	100.5"	6	42	42	60	18	75	
30PDD	Ford Chassis	20,500	25,500	7,000	13,500	190"	31'	12' 6"	84"	94.5"	100.5"	6	43	45	60	18	75	
	Workhorse Chassis	20,700	25,700	7,500	13,500	190"	31'	12' 6"	84"	94.5"	100.5"	6	42	42	60	18	75	
30SFS	Ford Chassis	20,500	25,500	7,000	13,500	190"	31'	12' 6"	84"	94.5"	100.5"	6	43	45	60	18	75	
	Workhorse Chassis	20,700	25,700	7,500	13,500	190"	31'	12' 6"	84"	94.5"	100.5"	6	42	42	60	18	75	
33PBD	Ford Chassis	22,000	26,000	7,500	14,500	228"	34' 3"	12' 6"	84"	94.5"	100.5"	6	42	42	60	18	75	
	W22 Chassis	22,000	26,000	8,000	14,500	228"	34' 3"	12' 6"	84"	94.5"	100.5"	6	42	42	60	18	75	

¹Towing capacity is limited by GCWR; your vehicle's towing capacity is the difference between the GCWR and the actual vehicle weight, including all water, fuel, passengers and cargo. Your towed vehicle should be equipped with auxiliary brakes if the weight of the towed vehicle exceeds 1,000 lbs. Consult your owner's manual for further towing information.

²All tank capacities are estimated based upon calculations provided by the tank manufacturers and represent approximate capacities. The actual "usable capacity" may be greater or less than the estimated capacities based upon fabrication and installation of the tanks.

³Actual filled LP capacity is 80% of listing due to safety shut-off required on tank.

BODY CONSTRUCTION

- › Alumaframe® Superstructure
- › Steel Cage Cockpit Construction
- › Peaked One-Piece Fiberglass Roof with Fiberglass Insulation
- › Smooth Aluminum Exterior Walls
- › Front and Rear Molded Fiberglass Caps
- › Panaview™ 1-Piece Front Windshield
- › Interior Height 84"
- › Aluminum Framed Floor on Steel Trusses
- › Laminated Structurwood™ Flooring
- › Interior Paneling with 3/4" Insulation
- › Foam Insulated Floor Framing with 3-Ply Underbelly
- › One-Piece Engine Cover
- › Black Front-Mounted Exterior Mirrors
- › Low-Profile Sealed LED Marker Lights
- › Automotive Style Taillights
- › Integrated Metal Fuel Door with Lock
- › 30" Deep Bedroom Slide-Out Houses (30PDD, 33PBD)
- › Pass-Through Storage Bays under Slide-Outs with Polyethylene Boxes
- › Side-Hinged Baggage Doors, All Door Locations
- › One-Piece Polyethylene Storage Compartments
- › New Painted Skirt and Mask with Vinyl Exterior Graphics
- › Interior Rubber Entry Steps
- › Exterior Double Entry Steps (N/A: 33PBD)
- › Exterior Triple Entry Steps (33PBD)
- › Undercoating

OPTIONS

- › Rear Ladder
- › Standard Run Savings Package: Rear Ladder, Fully Automatic Hydraulic Leveling System, Rear Vision System with Audio and Adjustable Camera, Six-Way Power Pilot Seat, Bi-Fold Range Cover, 20" Stereo Color TV with Remote Control in Bedroom, 6-Gallon LP Gas/Electric Water Heater with Electronic Ignition, DSI, 12V Heater in Wet Bay, Vinyl Patio Awning

FORD 20,500 LB. CHASSIS/ENGINE/SUSPENSION (N/A: 33PBD)

- › 6.8L 3-Valve V-10 Gasoline Engine with Electronic Fuel Injection
- › Engine Displacement: 6.8 Liters 415 Cu. In.
- › Power: 362 HP; Torque: 457 lbs./ft.
- › TorqShift 5-Speed Automatic Overdrive Transmission with Tow/Haul Mode
- › New Transmission Oil Temperature Gauge
- › Fuel Tank Capacity 75 Gallon
- › 130 Amp Alternator
- › Rear Axle Ratio 5.38:1
- › Radial Tires 245/70R x 19.5F
- › Wheel/Rims (Chrome Wheel Covers)
- › Leaf Spring Suspension
- › Front and Rear Disc, 4-Wheel Anti-Lock-Brakes
- › Heavy-Duty Front Track Bar with Bilstein® Shock Absorbers
- › Pre-Wire for Supplemental Braking System
- › Hitch Receiver with Dual Connector 4-Pin or 7-Pin (5,000 Lb.)
- › SmartStructure II

OPTIONS

- › Fully Automatic Hydraulic Leveling System
- › Stainless Steel Wheel Simulators, Standard on Workhorse Chassis

WORKHORSE 20,700 LB. CHASSIS/ENGINE/SUSPENSION (N/A: 33PBD)

- › 8.1L V-8 Gasoline Engine with Electronic Fuel Injection
- › Engine Displacement: 8.1 Liters 496 Cu. In.
- › Power: 340 HP; Torque: 455 lbs./ft.
- › 6-Speed Automatic Transmission with Overdrive
- › Fuel Tank Capacity 75 Gallon
- › 145 Amp Alternator
- › Rear Axle Ratio 5.13:1
- › Radial Tires 245/70R x 19.5F
- › Stainless Steel Wheel Liners
- › Leaf Spring Suspension
- › ABS Brake System
- › Pre-Wire for Supplemental Braking System
- › Hitch Receiver with Dual Connector 4-Pin or 7-Pin (5,000 Lb.)
- › SmartStructure II

OPTIONS

- › Fully Automatic Hydraulic Leveling System

MONARCH® SVE

FORD 22,000 LB. CHASSIS/ENGINE/SUSPENSION (33PBD Only)

- 6.8L 3-Valve V-10 Gasoline Engine with Electronic Fuel Injection
- Engine Displacement: 6.8 Liters 415 Cu. In.
- Power: 362 HP; Torque: 457 lbs./ft.
- TorqShift 5-Speed Automatic Overdrive Transmission with Tow/Haul Mode
- New Transmission Oil Temperature Gauge
- Fuel Tank Capacity 75 Gallon
- 130 Amp Alternator
- Rear Axle Ratio 5.38:1
- Radial Tires 235/80R x 22.5G
- Wheel/Rims (Polished Aluminum Wheels)
- Leaf Spring Suspension
- Front and Rear Disc, 4-Wheel Anti-Lock Brakes
- Heavy-Duty Front Track Bar with Bilstein® Shock Absorbers
- Pre-Wire for Supplemental Braking System
- Hitch Receiver with Dual Connector 4-Pin or 7-Pin (4,000 Lb.)
- SmartStructure II

OPTIONS

- Fully Automatic Hydraulic Leveling System

WORKHORSE 22,000 LB. CHASSIS/ENGINE/SUSPENSION (33PBD Only)

- 8.1L V-8 Gasoline Engine with Electronic Fuel Injection
- Engine Displacement: 8.1 Liters 496 Cu. In.
- Power: 340 HP; Torque: 455 lbs./ft.
- 6-Speed Automatic Transmission with Overdrive
- Fuel Tank Capacity 75 Gallon
- 145 Amp Alternator
- Rear Axle Ratio 5.86:1
- Radial Tires 235/80R x 22.5G
- Stainless Steel Wheel Liners
- Leaf Spring Suspension
- ABS Brake System
- Pre-Wire for Supplemental Braking System
- Hitch Receiver with Dual Connector 4-Pin or 7-Pin (4,000 Lb.)
- SmartStructure II

OPTIONS

- Fully Automatic Hydraulic Leveling System

COCKPIT

- Fiberglass Automotive Dash with Vinyl Covering with Silver Graphite Metallic Instrument Panel
- CD Player/Radio with DVD Player, Sirius-Ready Compatibility, Weather Band, Remote and Six Speakers
- Multi-Positioned Sunvisors
- Rear Vision System Prep
- Intermittent Windshield Wipers
- Tilt Steering Wheel
- Cruise Control
- Power Steering
- Electric Automotive Horn
- Soft Touch Vinyl Pilot and Co-Pilot Recliner Seats
- Carpeted Driver and Passenger Floor Mats
- Wood Framed Cabinet Doors with Smoked Glass over Front Entertainment Center Systems
- Secure Front Cab over Television with Steel Framing

OPTIONS

- Six-Way Power Pilot Seat
- Sirius Radio Satellite System with 6 Months Pre-Paid Activation
- GPS System High Speed DVD Navigation System (Requires Rear Vision System Selection)
- Single Camera Rear Vision System with Audio and Adjustable Camera
- Interior Solar Privacy Sunscreens (Manual)

APPLIANCES AND ACCESSORIES

- Double-Door Refrigerator
- High-Output 3-Burner Cooktop without Oven
- Microwave with Touch Control and Under-Mounted Range Hood
- 24" Stereo Color TV with Remote Control in Cockpit
- TV Antenna
- DVD and Video Control Box with Booster and RF Modulator; Control Boxes Allow DVD Player to Play Video in Bedroom TV
- Exterior Hook-Ups Cable TV
- Digital Satellite Systems Prep
- Interior Cable TV Hook-Up and Telephone Jacks
- Exterior Gas Line Hook-Up Prep for LP Accessories

OPTIONS

- Large Double-Door Refrigerator
- High-Output Three-Burner Range with Oven
- Bi-Fold Range Cover
- Convection Microwave with Touch Control and Under-Mounted Range Hood
- Central Vacuum System
- 20" Stereo Color TV with Remote Control in Bedroom

INTERIOR

- New Vintage Oak Cabinetry
- Flat Panel Cabinet Doors on Overhead Cabinets, Base Cabinets and Wardrobes
- Cabinet End Panels
- Wood Grain Refrigerator Panel Insert
- Wallpaper Border Bath
- Mini Struts on Top-Hinged Overhead Storage Doors and Positive Catches on All Other Doors
- Heavy-Duty Ball Bearing Drawer Guides
- Wood Cabinet Drawer Boxes
- Wood Interior Grab Handle on Cabinet at Entry Door
- Satin Nickel Cabinetry Hardware and Bath Accessories
- Ridged Vinyl Laminated Kitchen Countertop with White Sink, Chrome High-Profile Double Handle Faucet and One Sink Cover
- Toe Kicks Kitchen and Bath Base Cabinets
- Kitchen Countertop Extension (N/A: 33PBD)
- Rigid Vinyl Laminated Bath Lavatory Countertop
- All Other Countertops are Rigid Vinyl Laminated
- Kitchen Overhead Cabinets with Adjustable Shelf
- Kitchen Pantry next to Refrigerator with Adjustable Shelf Storage in Upper Cabinet and Three Drawers Below (33PBD) (N/A with Four-Door Refrigerator Option)
- Linoleum Flooring in Kitchen, Bath and Entry
- Upgrade Nylon Carpeting with Pad in Living Area and Bedroom
- Soft Touch Padded Vinyl Ceiling
- Wood Slide-Out Fascia with Fabric Inserts
- Bathroom Lavatory Base Mirror with Wood Frame
- Bedroom Swing-Away TV Cabinets with TV Option (N/A: 33SFS)
- Bedspread
- Fabric Headboard
- Blackout Day/Night Pleated Shades in Living Area and Bedroom
- Soil Repellant on Fabric, Teflon® Fabric Protection

OPTIONS

- New Decors: Sand Dune, English Walnut, Butternut, Laurel Square
- Wood Choice: Newport Cherry, Champagne Select

MONARCH® SVE

FORD 22,000 LB. CHASSIS/ENGINE/SUSPENSION (33PBD Only)

- › 6.8L 3-Valve V-10 Gasoline Engine with Electronic Fuel Injection
- › Engine Displacement: 6.8 Liters 415 Cu. In.
- › Power: 362 HP; Torque: 457 lbs./ft.
- › TorqShift 5-Speed Automatic Overdrive Transmission with Tow/Haul Mode
- › New Transmission Oil Temperature Gauge
- › Fuel Tank Capacity 75 Gallon
- › 130 Amp Alternator
- › Rear Axle Ratio 5.38:1
- › Radial Tires 235/80R x 22.5G
- › Wheel/Rims (Polished Aluminum Wheels)
- › Leaf Spring Suspension
- › Front and Rear Disc, 4-Wheel Anti-Lock Brakes
- › Heavy-Duty Front Track Bar with Bilstein® Shock Absorbers
- › Pre-Wire for Supplemental Braking System
- › Hitch Receiver with Dual Connector 4-Pin or 7-Pin (4,000 Lb.)
- › SmartStructure II

OPTIONS

- › Fully Automatic Hydraulic Leveling System

WORKHORSE 22,000 LB. CHASSIS/ENGINE/SUSPENSION (33PBD Only)

- › 8.1L V-8 Gasoline Engine with Electronic Fuel Injection
- › Engine Displacement: 8.1 Liters 496 Cu. In.
- › Power: 340 HP; Torque: 455 lbs./ft.
- › 6-Speed Automatic Transmission with Overdrive
- › Fuel Tank Capacity 75 Gallon
- › 145 Amp Alternator
- › Rear Axle Ratio 5.86:1
- › Radial Tires 235/80R x 22.5G
- › Stainless Steel Wheel Liners
- › Leaf Spring Suspension
- › ABS Brake System
- › Pre-Wire for Supplemental Braking System
- › Hitch Receiver with Dual Connector 4-Pin or 7-Pin (4,000 Lb.)
- › SmartStructure II

OPTIONS

- › Fully Automatic Hydraulic Leveling System

COCKPIT

- › Fiberglass Automotive Dash with Vinyl Covering with Silver Graphite Metallic Instrument Panel
- › CD Player/Radio with DVD Player, Sirius-Ready Compatibility, Weather Band, Remote and Six Speakers
- › Multi-Positioned Sunvisors
- › Rear Vision System Prep
- › Intermittent Windshield Wipers
- › Tilt Steering Wheel
- › Cruise Control
- › Power Steering
- › Electric Automotive Horn
- › Soft Touch Vinyl Pilot and Co-Pilot Recliner Seats
- › Carpeted Driver and Passenger Floor Mats
- › Wood Framed Cabinet Doors with Smoked Glass over Front Entertainment Center Systems
- › Secure Front Cab over Television with Steel Framing

OPTIONS

- › Six-Way Power Pilot Seat
- › Sirius Radio Satellite System with 6 Months Pre-Paid Activation
- › GPS System High Speed DVD Navigation System (Requires Rear Vision System Selection)
- › Single Camera Rear Vision System with Audio and Adjustable Camera
- › Interior Solar Privacy Sunscreens (Manual)

APPLIANCES AND ACCESSORIES

- › Double-Door Refrigerator
- › High-Output 3-Burner Cooktop without Oven
- › Microwave with Touch Control and Under-Mounted Range Hood
- › 24" Stereo Color TV with Remote Control in Cockpit
- › TV Antenna
- › DVD and Video Control Box with Booster and RF Modulator; Control Boxes Allow DVD Player to Play Video in Bedroom TV
- › Exterior Hook-Ups Cable TV
- › Digital Satellite Systems Prep
- › Interior Cable TV Hook-Up and Telephone Jacks
- › Exterior Gas Line Hook-Up Prep for LP Accessories

OPTIONS

- › Large Double-Door Refrigerator
- › High-Output Three-Burner Range with Oven
- › Bi-Fold Range Cover
- › Convection Microwave with Touch Control and Under-Mounted Range Hood
- › Central Vacuum System
- › 20" Stereo Color TV with Remote Control in Bedroom

INTERIOR

- › New Vintage Oak Cabinetry
- › Flat Panel Cabinet Doors on Overhead Cabinets, Base Cabinets and Wardrobes
- › Cabinet End Panels
- › Wood Grain Refrigerator Panel Insert
- › Wallpaper Border Bath
- › Mini Struts on Top-Hinged Overhead Storage Doors and Positive Catches on All Other Doors
- › Heavy-Duty Ball Bearing Drawer Guides
- › Wood Cabinet Drawer Boxes
- › Wood Interior Grab Handle on Cabinet at Entry Door
- › Satin Nickel Cabinetry Hardware and Bath Accessories
- › Ridged Vinyl Laminated Kitchen Countertop with White Sink, Chrome High-Profile Double Handle Faucet and One Sink Cover
- › Toe Kicks Kitchen and Bath Base Cabinets
- › Kitchen Countertop Extension (N/A: 33PBD)
- › Rigid Vinyl Laminated Bath Lavatory Countertop
- › All Other Countertops are Rigid Vinyl Laminated
- › Kitchen Overhead Cabinets with Adjustable Shelf
- › Kitchen Pantry next to Refrigerator with Adjustable Shelf Storage in Upper Cabinet and Three Drawers Below (33PBD) (N/A with Four-Door Refrigerator Option)
- › Linoleum Flooring in Kitchen, Bath and Entry
- › Upgrade Nylon Carpeting with Pad in Living Area and Bedroom
- › Soft Touch Padded Vinyl Ceiling
- › Wood Slide-Out Fascia with Fabric Inserts
- › Bathroom Lavatory Base Mirror with Wood Frame
- › Bedroom Swing-Away TV Cabinets with TV Option (N/A: 33SFS)
- › Bedspread
- › Fabric Headboard
- › Blackout Day/Night Pleated Shades in Living Area and Bedroom
- › Soil Repellant on Fabric, Teflon® Fabric Protection

OPTIONS

- › New Decors: Sand Dune, English Walnut, Butternut, Laurel Square
- › Wood Choice: Newport Cherry, Champagne Select



FURNITURE

- Queen Bed with Nightstands
- Bedroom Desk (30PDD)
- Arched Back Wood Booth Dinette with Side Sliding Table Top (N/A: 30SFS)
- Freestanding Dinette with Two Freestanding Chairs and Two Folding Chairs (30SFS)
- Roadside Fabric Jackknife Sofa with Pillow
- Fabric Swivel Glider Barrel Chair (33PBD)

OPTIONS

- Forward Facing Seat Belts in Booth Dinette inside Living Area Slide-Out (N/A: 30SFS)
- Roadside Fabric Hide-A-Bed Sofa with One Pillow

ELECTRICAL SYSTEMS AND LIGHTS

- 30 Amp 120V Distribution Panel and Power Cord
- 60 Amp Electronic 12V Power Converter
- Onan® 4.0 kW Gas Generator
- Two 6V House Batteries
- Battery Disconnect Switches
- 12V and 110V Outlet in Cockpit Area
- Porch Light and Exterior Step Light on Same Switch
- Exterior Power Entry Step with Light
- Water Pump Switch in Service Bay Area and Convenience Center
- Lights in Outside Storage Compartments
- 120V Receptacles in Outside Storage Compartment
- Underhood Utility Light
- Receptacle and Phone Jack in Dinette Area
- Directional Map Lights Pilot and Co-Pilot Seats
- Hallway Convenience Center
- Decorative Satin Nickel Sofa Wall Light
- Decorative Satin Nickel Dinette Overhead
- Satin Nickel Decorative Bathroom Wall Light
- Two Single Pancake Lights under Living Room Overhead Cabinets
- Satin Nickel Bullet Lights over Bed with His and Hers Switches

PLUMBING AND LP SYSTEMS

- Kitchen White Double Bowl Sink with Chrome High-Profile Double Handle Faucet
- New Satin Nickel Bath Lavatory Faucet
- Demand Water System and Water Pump
- 6 Gallon LP with Electronic Ignition, DSI
- Winterization Valving System
- Water Heater Bypass Valve
- Toilet
- No-Fuss Flush Holding Tank Rinsing System
- Insulated Systems Compartment with Easy Access to Hook-Up
- Shower inside Wet Bay with Hot/Cold Water, Shower Head with Shut-Off
- Gravity and Pressurized Water Fill
- Contained Storage Area for Sewer Hose
- ABS Shower with Surround
- Shower Faucet with Shower Hose and Head with Shut-Off
- Folding Shower Door

OPTIONS

- 6 Gallon LP Gas/Electric Water Heater with Electronic Ignition, DSI
- Satin Nickel Shower Door Frame with Obscure Glass

HEATING, VENTS AND AIR CONDITIONING

- One 13.5M BTU Air Conditioner with Ducted Air and Analog Wall Thermostat, Low-Profile Ford and Workhorse (N/A: 33PBD)
- One 13.5M BTU and One 11.0M BTU Air Conditioner with Ducted Air and Wall Analog Thermostat, Low-Profile Ford and Workhorse (33PBD)
- Electronic Ignition Furnace (31M BTU — 30PBS, 30PDD, 30SFS) (35M BTU — 33PBD)
- Electronic Dash AC/Heat Climate Control System
- In-Floor Ducted Heating System with Metal Floor Registers
- Living Area 12V Roof Vent
- Bath 12V Roof Vent
- Metal Air Return Grill Furnace Satin Nickel Finish
- Metal Floor Registers Satin Nickel

OPTIONS

- One 15M BTU Air Conditioner with Ducted Air and Analog Wall Thermostat, Low-Profile Ford and Workhorse (N/A: 33PBD)
- Living Area Powered Attic Fan with Wall Control of Automatic Dome and Fan Power
- Bath Powered Attic Fan with Wall Control of Automatic Dome and Fan Power
- 12V Heater in Wet Bay

WINDOWS, DOORS AND AWNING

- Radius Flush-Mount Single Pane Safety Glass Dark Tinted Slider Windows
- Radius Entrance Door with Clear Glass, Roller Shade, Screen Door and Anti-Skid Steps
- One Interior Grab Handle and One Exterior Grab Handle
- Topper Slide-Out Awnings
- Protecta Glaze Tinted Plexiglas® Skylight in Bathroom
- Awning Rail

OPTIONS

- Poly-Weave Patio Awning
- Rear Wall Bedroom Window (30PDD, 33PBD)

SAFETY

- Fire Extinguisher
- Deadbolt Lock on Entrance Door
- 120V GFI Protected Circuit, Kitchen, Bath, Exterior
- LP Gas Detector
- Smoke Detector
- Carbon Monoxide Detector
- Pilot and Co-Pilot Three-Point Seatbelts
- Third Brake Safety Light
- Egress Windows



FURNITURE

- › Queen Bed with Nightstands
- › Bedroom Desk (30PDD)
- › Arched Back Wood Booth Dinette with Side Sliding Table Top (N/A: 30SFS)
- › Freestanding Dinette with Two Freestanding Chairs and Two Folding Chairs (30SFS)
- › Roadside Fabric Jackknife Sofa with Pillow
- › Fabric Swivel Glider Barrel Chair (33PBD)

OPTIONS

- › Forward Facing Seat Belts in Booth Dinette inside Living Area Slide-Out (N/A: 30SFS)
- › Roadside Fabric Hide-A-Bed Sofa with One Pillow

ELECTRICAL SYSTEMS AND LIGHTS

- › 30 Amp 120V Distribution Panel and Power Cord
- › 60 Amp Electronic 12V Power Converter
- › Onan® 4.0 kW Gas Generator
- › Two 6V House Batteries
- › Battery Disconnect Switches
- › 12V and 110V Outlet in Cockpit Area
- › Porch Light and Exterior Step Light on Same Switch
- › Exterior Power Entry Step with Light
- › Water Pump Switch in Service Bay Area and Convenience Center
- › Lights in Outside Storage Compartments
- › 120V Receptacles in Outside Storage Compartment
- › Underhood Utility Light
- › Receptacle and Phone Jack in Dinette Area
- › Directional Map Lights Pilot and Co-Pilot Seats
- › Hallway Convenience Center
- › Decorative Satin Nickel Sofa Wall Light
- › Decorative Satin Nickel Dinette Overhead
- › Satin Nickel Decorative Bathroom Wall Light
- › Two Single Pancake Lights under Living Room Overhead Cabinets
- › Satin Nickel Bullet Lights over Bed with His and Hers Switches

PLUMBING AND LP SYSTEMS

- › Kitchen White Double Bowl Sink with Chrome High-Profile Double Handle Faucet
- › New Satin Nickel Bath Lavatory Faucet
- › Demand Water System and Water Pump
- › 6 Gallon LP with Electronic Ignition, DSI
- › Winterization Valving System
- › Water Heater Bypass Valve
- › Toilet
- › No-Fuss Flush Holding Tank Rinsing System
- › Insulated Systems Compartment with Easy Access to Hook-Up
- › Shower inside Wet Bay with Hot/Cold Water, Shower Head with Shut-Off
- › Gravity and Pressurized Water Fill
- › Contained Storage Area for Sewer Hose
- › ABS Shower with Surround
- › Shower Faucet with Shower Hose and Head with Shut-Off
- › Folding Shower Door

OPTIONS

- › 6 Gallon LP Gas/Electric Water Heater with Electronic Ignition, DSI
- › Satin Nickel Shower Door Frame with Obscure Glass

HEATING, VENTS AND AIR CONDITIONING

- › One 13.5M BTU Air Conditioner with Ducted Air and Analog Wall Thermostat, Low-Profile Ford and Workhorse (N/A: 33PBD)
- › One 13.5M BTU and One 11.0M BTU Air Conditioner with Ducted Air and Wall Analog Thermostat, Low-Profile Ford and Workhorse (33PBD)
- › Electronic Ignition Furnace (31M BTU — 30PBS, 30PDD, 30SFS) (35M BTU — 33PBD)
- › Electronic Dash AC/Heat Climate Control System
- › In-Floor Ducted Heating System with Metal Floor Registers
- › Living Area 12V Roof Vent
- › Bath 12V Roof Vent
- › Metal Air Return Grill Furnace Satin Nickel Finish
- › Metal Floor Registers Satin Nickel

OPTIONS

- › One 15M BTU Air Conditioner with Ducted Air and Analog Wall Thermostat, Low-Profile Ford and Workhorse (N/A: 33PBD)
- › Living Area Powered Attic Fan with Wall Control of Automatic Dome and Fan Power
- › Bath Powered Attic Fan with Wall Control of Automatic Dome and Fan Power
- › 12V Heater in Wet Bay

WINDOWS, DOORS AND AWNING

- › Radius Flush-Mount Single Pane Safety Glass Dark Tinted Slider Windows
- › Radius Entrance Door with Clear Glass, Roller Shade, Screen Door and Anti-Skid Steps
- › One Interior Grab Handle and One Exterior Grab Handle
- › Topper Slide-Out Awnings
- › Protecta Glaze Tinted Plexiglas® Skylight in Bathroom
- › Awning Rail

OPTIONS

- › Poly-Weave Patio Awning
- › Rear Wall Bedroom Window (30PDD, 33PBD)

SAFETY

- › Fire Extinguisher
- › Deadbolt Lock on Entrance Door
- › 120V GFI Protected Circuit, Kitchen, Bath, Exterior
- › LP Gas Detector
- › Smoke Detector
- › Carbon Monoxide Detector
- › Pilot and Co-Pilot Three-Point Seatbelts
- › Third Brake Safety Light
- › Egress Windows

MONARCH™



COME ON, FELLOW TRAVELERS. Haven't you waited long enough to drive your dream? It's your turn now. And Monaco is here to make it all happen. With high-line, high-performing coaches that lead the way in quality, comfort and safety. So grab a road atlas and climb aboard. The coach of your dreams is just ahead.



DEALER:



MONACO™

DRIVING YOUR DREAM.

91320 Coburg Industrial Way, Coburg, OR 97408 | 800 634-0855

www.monacocoach.com

Monaco Coach Corporation is traded on the NYSE under the listing MNC. | 0956 NPN: BROMMON

MONARCH®



COME ON, FELLOW TRAVELERS. Haven't you waited long enough to drive your dream? It's your turn now. And Monaco is here to make it all happen. With high-line, high-performing coaches that lead the way in quality, comfort and safety. So grab a road atlas and climb aboard. The coach of your dreams is just ahead.



DEALER:



MONACO®

DRIVING YOUR DREAM.

91320 Coburg Industrial Way, Coburg, OR 97408 | 800 634-0855

www.monacocoach.com

Monaco Coach Corporation is traded on the NYSE under the listing MNC. | 0906 NPN: BROMMON