



BIGFOOTRV.COM

NEW for 2008



25B25FB



*Shown with optional Fiberglass Front Cargo Box

Standard Features

Exterior:

- ❖ Lightweight Two Piece Fiberglass Exterior Shell
- ❖ 1 1/2" High Density EPS Insulation (R8)
- ❖ Radius Corner Safety Glass Windows (c/w Screens)
- ❖ Folding Assist Handle
- ❖ Aluminum Covered Rear Bumper (c/w Sewer Hose Storage)
- ❖ Wide Track Tandem Axle
- ❖ 3500 lbs. Axle Rating (Per Axle)
- ❖ 15" Radial Tires with White Spoke Wheels
- ❖ Electric Brakes
- ❖ Break Away Switch
- ❖ LED Exterior Clearance and Directional Lighting
- ❖ Molded Fiberglass Propane Tank Cover
- ❖ Radius Corner Compartment Doors
- ❖ Radius Corner Entry Doors (c/w Deadbolt Lock and Gas Strut)
- ❖ Blocking for Roof Rack & Ladder
- ❖ Awning Rail
- ❖ Folding Entry Step (3 Step)
- ❖ Shock Absorbers

Interior:

- ❖ Washable Vinyl Wall Paneling
- ❖ Marine Quality Fabric Headliner
- ❖ Face Framed Double Screwed Oak Styled Cabinets
- ❖ Spring Filled Foam Mattress (60" x 74")
- ❖ Day/Night Shades
- ❖ Venetian Blind in Galley
- ❖ TV Hook-up

Kitchen and Appliances:

- ❖ 3 Burner Cooktop
- ❖ 30,000 BTU Electronic Ignition Ducted Forced Air Furnace
- ❖ Fluorescent Light in Galley
- ❖ 12-Volt Rangehood
- ❖ Monitor Panel
- ❖ Stainless Steel Double Sink
- ❖ Cutting Board
- ❖ Single Lever Faucet
- ❖ Dual 20 lb. Propane Tanks (c/w OPD Valve)
- ❖ 2-Way 6 cu. ft. Refrigerator

Electrical:

- ❖ Electrical 120-VAC/30-Amp Service
- ❖ 45 Amp. DC Power Converter (c/w Battery Charger)

- ❖ Pre-Wire for Roof Air and Microwave
- ❖ Power Fan in Bathroom
- ❖ Stereo Pre-Wire (c/w 2 Speakers & Antenna)
- ❖ Battery Ready
- ❖ Porch, Hitch and Roadside Lights

Plumbing:

- ❖ City Water Hookup
- ❖ 12-Volt Demand Water Pump System
- ❖ Molded Fiberglass Shower Enclosure
- ❖ Water Heater By-Pass System
- ❖ RV Anti-Freeze Pickup System
- ❖ Footflush RV Toilet
- ❖ Enclosed Heated & Insulated Holding Tanks
- ❖ Electronic Ignition Hot Water Heater (6 Gallon)

Safety:

- ❖ MVSS 302 Fire Rated Automotive Fabric
- ❖ Smoke & Carbon Monoxide Detector
- ❖ Propane Detector
- ❖ Fire Extinguisher
- ❖ Egress Window

Optional Features

- ❖ AC Roof - 11,000 BTU
- ❖ Aluminum Wheels
- ❖ Battery Disconnect (Electronic)
- ❖ Bedroom Décor Package
- ❖ Black Tank Rinse System
- ❖ Continental Tire Kit
- ❖ Exterior Stereo Speakers
- ❖ Fantastic Fan, Bathroom (Exhaust)
- ❖ Fantastic Fan, Bedroom (2-Way)
- ❖ Fantastic Fan, Galley (Exhaust)
- ❖ Fiberglass Front Cargo Box (Adds 2' to length of Trailer)
- ❖ Generator, Onan (2.5 kw Propane - Requires Gen Ready Pkg.)
- ❖ Generator Ready Package
- ❖ LCD TV Prep. Package (c/w Swing Arm)
- ❖ LCD TV (12 Volt c/w LCD TV Prep. Package)
- ❖ Microwave Oven (1.0 cu. ft.)
- ❖ Painted Skirts
- ❖ Porcelain Toilet Upgrade
- ❖ Power Tongue Jack
- ❖ Rack and Ladder
- ❖ Raised Oak Fridge Inserts
- ❖ Roll Away Shower Door
- ❖ RV BBQ Hookup
- ❖ Self Storing Awning (18')

- ❖ Skylight (c/w Pleated Shade)
- ❖ Solar Energy System (RV50 - c/w Solar Panel Pre-Wire)
- ❖ Solar Panel Pre-Wire
- ❖ Stabilizer Jacks (Front & Rear)
- ❖ Stabilizer Jacks (Rear Only)
- ❖ Stereo AM/FM - CD/DVD Player (Satellite Ready)
- ❖ Stereo AM/FM - CD Player (Satellite Ready)
- ❖ Solar Reflective Thermal Pane Windows
- ❖ Twin Beds (30" x 74")
- ❖ Water Heater - LP/110V

Preferred Option Package:

- ❖ Auto Change Over (Propane Regulator)
- ❖ Bifold Range Cover
- ❖ Dual Propane Tanks (30lb. ea.)
- ❖ Exterior Shower (c/w Winterizing Valves)
- ❖ Hidden TV Antenna (c/w TV Booster)
- ❖ Oven (c/w 3 Burner Cooktop & Bifold Cover)
- ❖ Spare Tire and Carrier





BIGFOOTRV.COM



25B25FB

PASS-THRU STORAGE

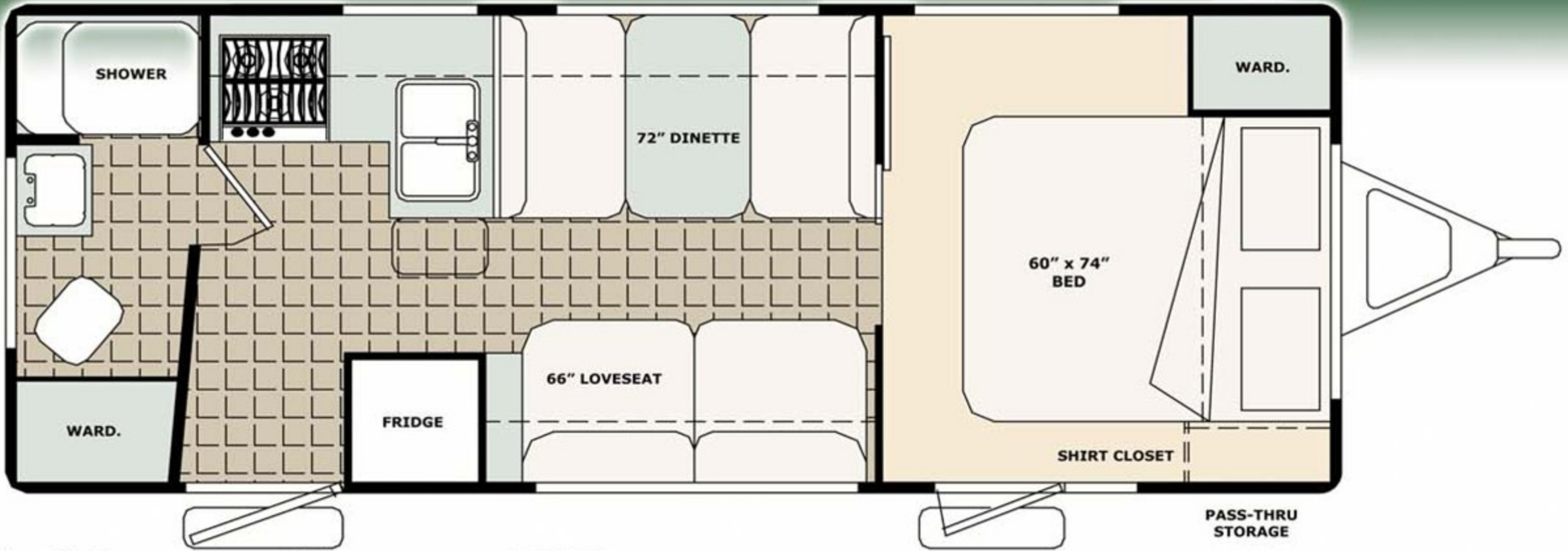

Specifications	Units		25B25FB	
Overall Length**	ft-in	mtr	25'-6"	7.77
Overall Height*	ft-in	mtr	9'-2"	2.79
Overall Width	ft-in	mtr	8'-4"	2.54
Interior Headroom	ft-in	mtr	6'-4"	1.93
Base Dry Weight	lbs	kg	5430	2464
Average Hitch Weight	lbs	kg	612	277
Axle Weight Rating	lbs	kg	2 x 3500	2 x 1588
GVWR	lbs	kg	7500	3400
Tires	Size		ST225/75R15	
Fresh Water	US Gallon	litres	45	171
Grey Water	US Gallon	litres	45	171
Black Water	US Gallon	litres	45	171
LPG Capacity	lbs	litres	2 x 20	2 x 9
Water Heater	US Gallon	litres	6	23
Furnace	BTU		30,000	
Refrigerator (2 Way)	cu. ft.	litres	6	169

*To top of Refrigerator Vent

** Not including optional Front Cargo Box (Add 2' for the FCB)

BIGFOOT WARRANTY

Bigfoot Industries provides a one-year limited warranty on all Bigfoot Products. In addition, Bigfoot Industries offers a three-year limited structural integrity warranty on all 1500 and 2500 Series models and a five-year limited structural integrity warranty on all 3000 and 4000 Series models.

Appliance warranties vary and are set by the respective manufacturer. Please contact your dealer for complete details regarding warranty policies.

The information contained herein is as accurate as possible at the time of publication. Subsequent refinements and improvements may be evident in the actual products. All liquid capacities are approximate and dimensions are nominal. Some equipment and features illustrated may be optional, or for presentation purposes only.

This brochure may not be used for contractual purposes. Bigfoot Industries reserves the right to improve or modify its products without prior written notice.



▲ Dinette and Love Seat



▲ Dinette



Go RVing.

~ your local Bigfoot specialist ~

Bigfoot Industries

4114 Crozier Road, Armstrong, British Columbia, Canada, V0E 1B6 • Phone: 250-546-2177

Please visit our website at: www.bigfootrv.com or www.BigfootOwners.com