

NEPTUNE[®]
2008

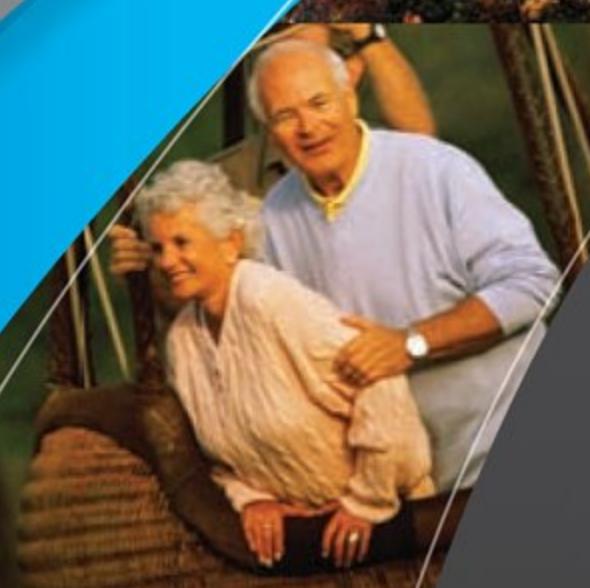

HOLIDAY RAMBLER[®]

This is Living[®]





This is Living®





38PBD | SPRING MIST | NEWPORT CHERRY

THE PEOPLE'S CHOICE. YEAR AFTER YEAR.

If you've never experienced Holiday Rambler's Neptune, this should be the year. The 2008 model has more of what makes Neptune one of the most popular RVs on the road. We've introduced four all-new floorplans, each with its own attitude and advantages. Looking for more room? Then the 39PBT might be right for you. It has a long, roadside easy-bed sofa and a curbside loveseat, while the 37PDQ features a stylish, fashionable leatherette swivel rocker barrel chair. All the 2008 floorplans come with two LCD televisions, a big 26-inch

model in the cockpit overhead and a 20-inch TV in the bedroom. Other new standard features include dinette and nightstand countertops and a central water filtration system located in the service bay. Every floorplan offers great options, including a washer/dryer, home theater surround sound system and central vacuum system. When you consider everything it offers, then look at its affordable price, it's easy to see why so many people trust Neptune, year after year.



This is Living®

▶▶ PANAVIEW™

1-PIECE WINDSHIELD



38PBD | SPRING MIST | NEWPORT CHERRY

SOMETHING FOR EVERYONE.

So what are you looking for in your dream RV? A fabulous kitchen? Neptune's got it. Stunning cabinetry with raised panel doors and new oil rubbed bronze hardware. Full-size appliances with the option of stainless steel. And, new for 2008, beautifully durable laminated tile flooring. Or, maybe you like your privacy. Neptune scores there as well, with a sparkling bath and comfortable bedroom with a queen-size bed and optional ceiling fan. If the engine is your thing, get a load of the powerful Cummins® 325 HP engine with

an Allison® 2500 MH 6-speed transmission. All that power is contrasted with the comfort of the cockpit, complete with recliner seats, an automotive dash and plenty of options — like a 3-camera rear vision system. And finally, if what you're looking for is room for all your stuff, Neptune has plenty of space with pass-through storage compartments with optional slide-out trays. So whatever you're looking for, Neptune has it — with plenty of style to spare.

MAKE IT YOUR OWN.

While Neptune may be one of the most popular RVs on the road, you can make it your own by selecting the floorplan, color and decor that best match your style. Stunning exterior graphics in your choice of three color schemes coordinate perfectly with sophisticated decor options. Once you decide which is the right look for you, pair it with either of our wood finishes — a light, sophisticated Champagne Select or deep, rich Newport Cherry.

- A. BEDSPREAD
- B. SOFA
- C. ACCENT
- D. CARPET

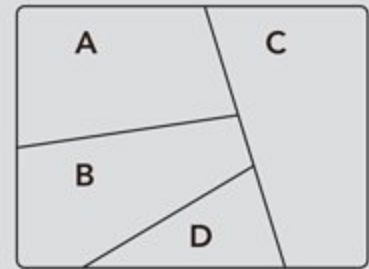

STARDUST

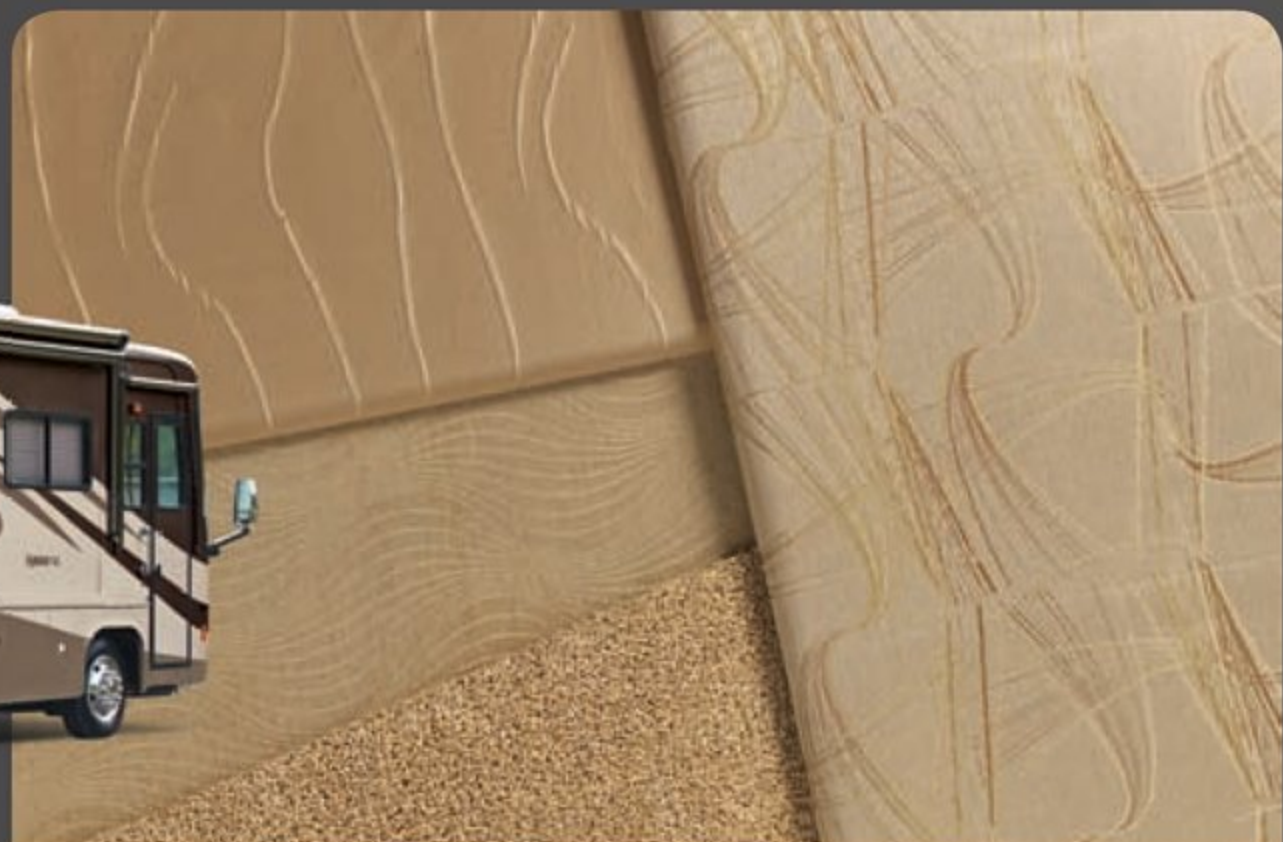

SUPER NATURAL



BETTER
STAIN
PROTECTION

Manufactured in, not added on. For added protection against stains, soil repellent is applied to virtually all upholstery fabric during the finishing process for superior coverage.*

*Brand and application of upholstery fabric protection may vary depending on date recreational vehicle was manufactured.



NEWPORT CHERRY



CHAMPAGNE SELECT



SPRING MIST



ASSISTANCE

SALES • TECH • ROADSIDE



WE'RE HERE. ANYTIME, EVERY TIME.

- Reach us anytime — literally — via our live customer support line.
- Drive in to one of our 350 Service Centers.
- Enjoy the first year free when you enroll in our Owner Advantage Roadside Assistance Program.
- See where it all begins with a tour of one of our facilities in Indiana or Oregon. Call 1-800-650-7337 or 1-800-634-0855 to find out more.



Alumaframe®



Aluminum
(Butt-Welded)



Alumaframe®
(C-Channel)

Thanks to our Alumaframe® Superstructure, your Holiday Rambler coach is built to take on anything the road can dish out. We revolutionized the industry by replacing outdated tubular aluminum construction with our exclusive system of aluminum C-Channel crossmembers. These run the full length of the coach, with double-welded intersections for superior strength. This makes your Holiday Rambler lighter and sturdier than other coaches and gives you reliability you can count on down the road.

- 1 The Neptune features a rear-mounted aluminum radiator with stacked aluminum charged air cooler, for increased cooling capacity.
- 2 A 7,000 lb. hitch receiver gives the coach powerful towing capacity.
- 3 Dual fuel fills provide the convenience of filling the fuel tank from either side of the coach.
- 4 A larger 34" spacing between the frame rails offers greater side-to-side stability.

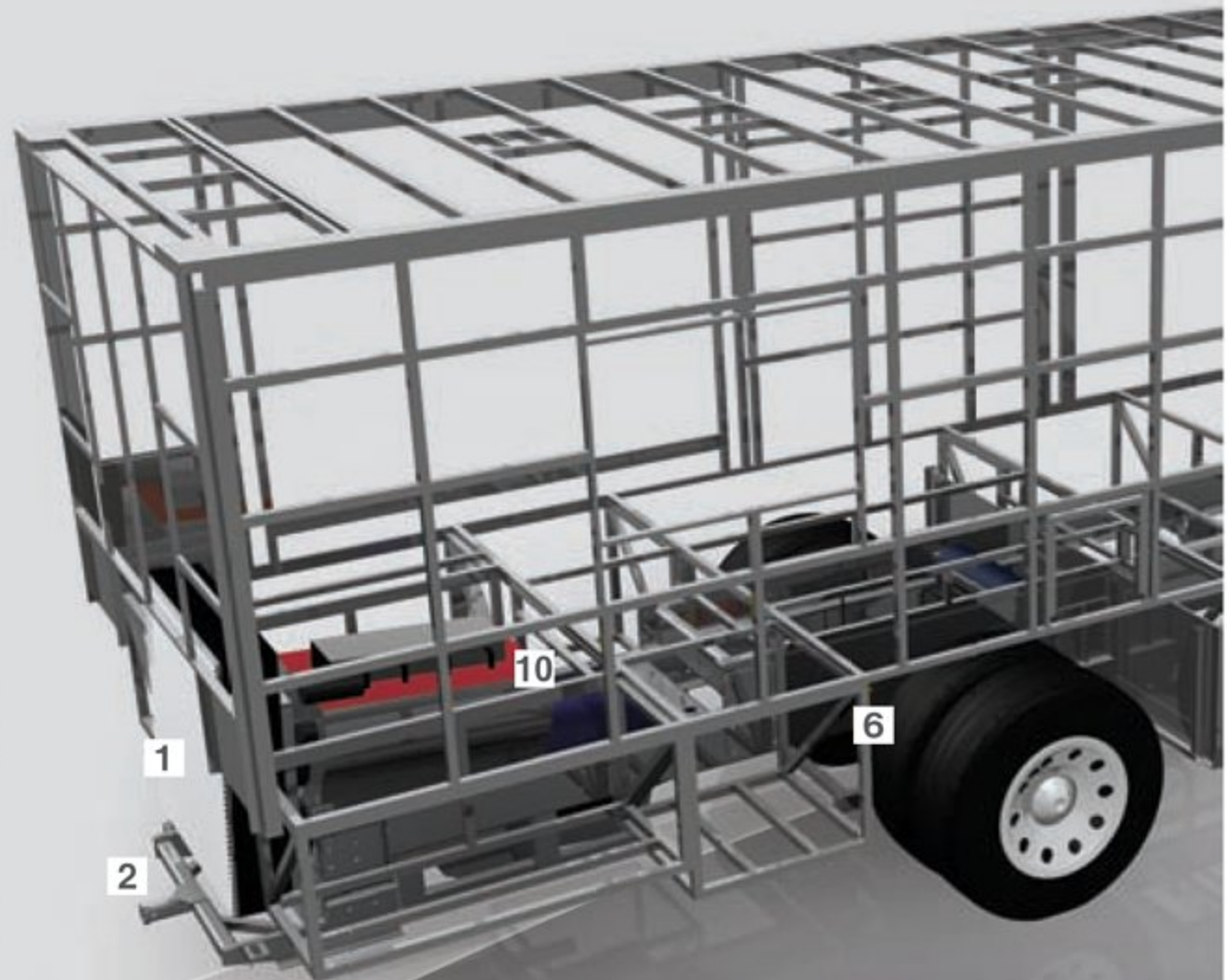

ROADMASTER RAIL RR4R CHASSIS

The 2008 Neptune owes its remarkable performance to the Roadmaster Raised Rail RR4R Series chassis. You'll marvel at the seamless ride and handling that's only possible in a chassis that's designed exclusively for a luxury motorcoach and custom-built to the exact specifications of each floorplan. We invite you to take a few minutes and discover all the ways Roadmaster offers you the very best in safety, reliability, comfort and convenience.



9-LAYER ROOF (top to bottom)

- One-piece peaked fiberglass roof
- Luaun backing
- Thick, tapered bead foam insulation
- Aluminum double I-beam superstructure filled with fiberglass insulation
- Vapor barrier
- Structure foam: thermal insulative barrier
- 1/2" bead foam insulation
- Foam padding for extra insulation
- Padded vinyl ceiling

5 The Roadmaster chassis provides for full pass-through storage spaces, accommodating larger items with ease.

6 Cushion Air Glide Suspension provides a smoother ride with excellent handling and cornering.

7 Steel cage cockpit construction offers added safety.

8 The full-air anti-lock braking system (ABS) maintains traction and steering when braking on slick surfaces.

9 Heavy-duty steel undercarriage and firewall for unsurpassed safety, strength and durability.

10 Master the highways and byways with Neptune's rugged Cummins® ISB 325 HP engine with 610 lbs./ft. of torque and an Allison® 2500 MH 6-speed World Transmission. The new electronic shift pad offers added convenience.

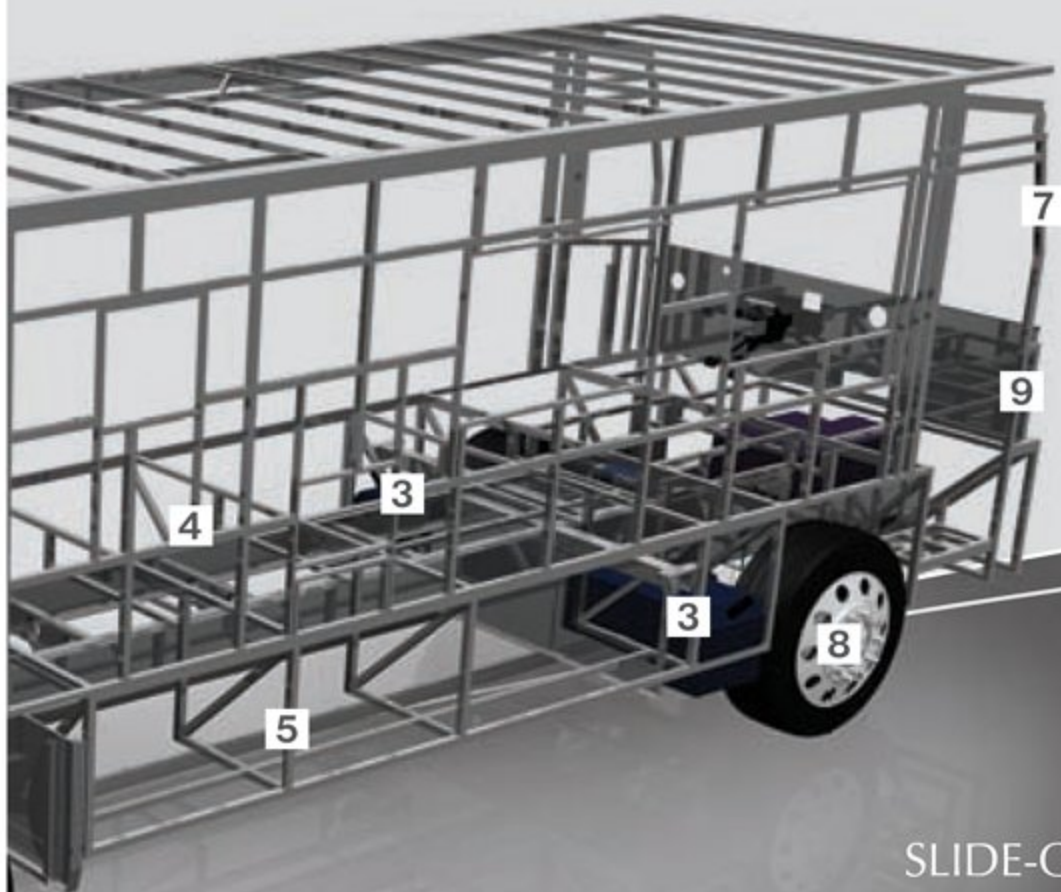

SLIDE-OUT CONSTRUCTION

When you purchase a Holiday Rambler, you can be sure the slide-out boxes are some of the strongest and most reliable you'll find anywhere. They feature our exclusive multi-layer construction to give you maximum insulation and to reduce the chance of warping, twisting or shifting.

5-LAYER EXTERIOR WALL (left to right)

- Smooth gel coat fiberglass is standard
- Interlocking C-Channel filled with 1-1/2" fiberglass insulation bonded in place so it doesn't sag or leave spaces uninsulated
- Vapor barrier
- Bead foam adds comfort, saves energy and provides a thermal insulative barrier
- Interior paneling

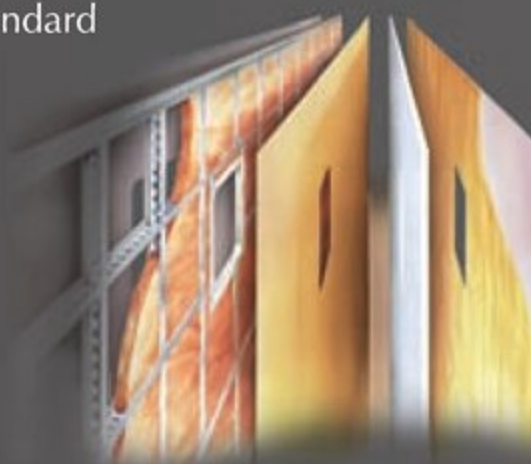

4-LAYER FLOOR (top to bottom)

- Structurwood™
- Blue foam insulation
- 1-1/2" aluminum tube
- Three-ply poly underbelly

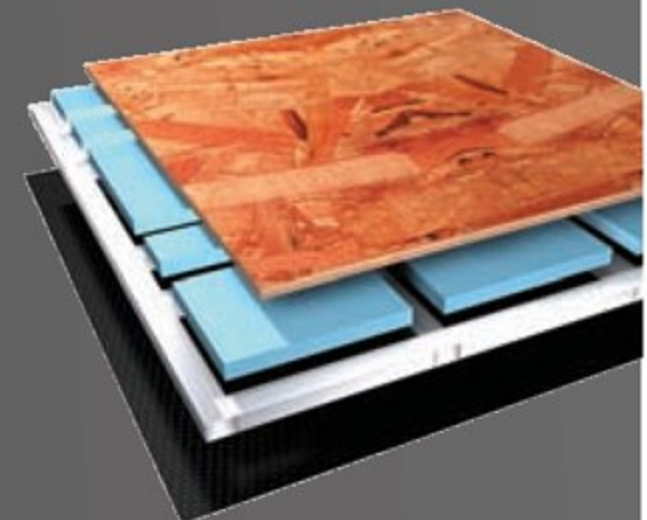

BODY CONSTRUCTION: FEATURES

- Alumaframe® Superstructure
- Steel Cage Cockpit Construction
- Smooth Gel Coat Fiberglass Exterior Walls
- Front and Rear Fiberglass Caps
- One-Piece Generator Access Door
- Rear Engine Doors and Center Grille
- Fiberglass Engine Cover
- Panaview™ 1-Piece Front Windshield
- Interior Height 84"
- 17.5" Chrome Head Exterior Mirror
- Metal Fuel Door with Lock
- 30" Deep Bedroom Slide-Out Houses (37PDQ, 39PBT)
- Side-Hinged Baggage Doors
- One-Piece Polyethylene Pass-Through Storage Compartments
- Full-Body Paint with Painted Graphics
- 3M Film Front Mask
- Carpeted Electric Flush-Floor Stepwell Cover
- Exterior Double Entry Steps
- Rear Ladder
- Full-Length Mud Flap
- Undercoating

OPTIONS

- Storage Bay Slide-Out Tray, Pass-Through
- Standard Run Savings Package: 3-Camera Rear Vision System with Audio and Adjustable Center Camera, Select Comfort Bed, 2,000 Watt Inverter with Two Additional Batteries

CHASSIS/ENGINE/SUSPENSION: FEATURES

- Roadmaster Raised Rail Chassis RR4R
- Cummins® ISB 325 HP Engine with Allison® 2500 MH 6-Speed World Transmission
- Pushbutton Shift Pad on 2500 MH Transmission
- Engine Displacement: 5.9L/359 Cu. In.
- Torque: 610 lbs./ft. Max. Net at 1,600 RPM
- Block Heater
- Chrome Exhaust Tip (Engine)
- 75-Gallon Fuel Tank
- Dual Fuel Fill
- 160 Amp Alternator
- Rear Axle Ratio: 4.78:1
- Radial Tires: 255/70R/22.5
- Stainless Steel Wheel Simulators
- Four Gas Shock Absorbers
- Four Air Bags
- Anti-Lock Braking System with Full Air Brake
- Automatic Traction Control
- Prewire for Supplemental Braking System
- Air Cleaner Restriction Indicator
- Fuel/Water Separator
- Remote Transmission Fill
- Fully Automatic Hydraulic Leveling System
- 7,000 Lb. Hitch Receiver with Dual Connector (4-Pin or 7-Pin)

COCKPIT: FEATURES

- Fiberglass Automotive Dash with Oxford Burl Instrumentation Panel
- CD Player/Radio with Sirius-Ready Compatibility, Weather Band and Six Speakers
- Power Sunvisors
- Pilot and Co-Pilot Side Window Pull-Down Sunshades
- Rear Vision System with Audio and Adjustable Camera
- Intermittent Windshield Wipers
- 18" 4-Spoke Steering Wheel
- Tilt/Telescopic Steering Wheel
- 6-Quart Tank for Windshield Fluid
- Air Horns
- Molded Co-Pilot Side Console with Two-Tier Cup Holder
- Molded Pilot Side Console with Two-Tier Cup Holder
- Leatherette Pilot and Co-Pilot Cockpit Recliner Seats
- Six-Way Power Pilot Seat
- Carpeted Driver and Passenger Floor Mats

OPTIONS

- Auxiliary Blower for Header Area of Front Windshield
- Six-Way Power Co-Pilot Seat
- 3-Camera Rear Vision System with Audio and Adjustable Center Camera
- Sirius Radio Satellite System (Requires Subscription)
- GPS Navigation System
- Interior Solar Privacy Sunscreens

APPLIANCES AND ACCESSORIES: FEATURES

- Large Double-Door Refrigerator with Ice Maker 8 Cu. Ft.
- Stainless Steel High-Output 3-Sealed-Burner Cooktop
- Removable Solid Surface Range Covers
- Spacesaver Convection Microwave
- 26" LCD Stereo Color TV with Remote Control in Cockpit Overhead
- 20" LCD TV in Bedroom
- Washer/Dryer Prep
- Curbside: Exterior Hook-Ups for DSS Dish, Cable, 110V Outlet, with Hatch Door to Exterior
- Digital Satellite System Prep

OPTIONS

- Large Double-Door Refrigerator with Ice Maker 10 Cu. Ft. (N/A: 35SBD)
- Large Four-Door Refrigerator with Ice Maker (N/A with Pantry)
- Stainless Steel High-Output Sealed Burner, 3-Burner Cooktop with Oven
- Stainless Steel Spacesaver Microwave and Refrigerator, Any Combination (N/A with Hardwood Raised Panel Doors on Refrigerator)

- Combination Washer/Dryer
- Central Vacuum System
- 32" Flatscreen LCD TV in Front Cockpit Overhead IPO 26" LCD Stereo Color TV
- Home Theater Surround Sound System with Sub-Woofer
- Bedroom DVD Player
- Semi-Automatic Digital Satellite Dish
- Exterior Entertainment Center, CD Player Radio with Two Speakers

INTERIOR: FEATURES

- Raised Panel Cabinet Doors
- Hardwood Raised Panel Doors on Refrigerator
- Heavy-Duty Ball-Bearing Drawer Guides
- Wood Cabinet Drawer Boxes
- Integrated Cup Holder in Slide-Out next to Sofa
- Solid Surface Kitchen Countertop and Backsplash with Under-Mounted Stainless Steel Sink with Two Sink Covers
- Kitchen Countertop Extension with Two Drawers Below (N/A with Drawers 38PBD) (N/A: 37PDQ)
- Kitchen Countertop End Splash (37PDQ)
- Solid Surface Bath Lavatory Countertop with Integrated Bowl and Solid Surface Backsplash
- Dinette Countertops, Laminate Countertop with Solid Surface Countertop Edge Treatment
- Nightstand Laminated Countertops with Solid Surface Countertop Edge Treatment
- Kitchen Pantry next to Refrigerator with Full-Height Roll-Out Storage Cabinet (N/A with Four-Door Refrigerator Option) (N/A: 35SBD)
- Kitchen Pantry next to Refrigerator with Adjustable Shelves in Upper Cabinet and Three Drawers Below (N/A with Four-Door Refrigerator Option) (35SBD)
- Second Kitchen Pantry next to Refrigerator with Roll-Out Storage in Upper Cabinet and Three Drawers Below (38PBD)
- Raised Solid Surface Backsplash behind Cooktop
- Laminate Tile Flooring Kitchen, Bath and Entryway
- Carpeting with Pad in Living Area and Bedroom
- Engine Rug Cover (37PDQ, 39PBT)
- Soft Touch Padded Vinyl Ceiling

- Wood Slide-Out Fascia with Satin Brushed Bronze Inserts into Fascia Legs
- Wood Grain Crown Molding in Bedroom and Living Area on All Open Walls
- Oil Rubbed Bronze Cabinetry Hardware and Bath Accessories
- Hardwood Framed Pocket Doors with Flat Panel Insert
- Oversized Rear Wardrobe Closet with Deluxe Mirrored Door Frames Satin Nickel (37PDQ, 39PBT)
- Blackout Day/Night Pleated Shades in Living Area and in Bedroom
- Soil Repellant on Fabric

OPTIONS

- Decors: Stardust, Super Natural, and Spring Mist
- Full-Width Laminated Tile Flooring Cockpit, Living Room Area and Kitchen
- Wood Choice: Newport Cherry, Champagne Select

FURNITURE: FEATURES

- Queen Bed with Overhead Cabinet and Nightstands
- Arched Back Wood Booth Dinette with Side-Sliding Dinette Tabletop with Storage in Seat Base
- Forward-Facing Seatbelts in Booth Dinette inside Living Area Slide-Out (N/A: 37PDQ)
- Roadside: Fabric Easy Bed Sofa (N/A with 37PDQ)
- Roadside: Leatherette Swivel Rocker Barrel Chair (37PDQ)
- Curbside: Fabric Easy Bed Sofa (N/A with 39PBT)
- Curbside: Fabric Love Seat (39PBT)
- Bedroom: Select Comfort Bed IPO Standard Mattress
- Roadside: New Style Leatherette Swivel Recliner IPO Leatherette Swivel Rocker Barrel Chair (37PDQ)
- Roadside: Leatherette Euro-Recliner Chair with Ottoman IPO Leatherette Swivel Rocker Barrel Chair (37PDQ)
- Roadside: Fabric Hide-A-Bed Sofa with Air Mattress (N/A with 37PDQ)
- Roadside: Leatherette Hide-A-Bed Sofa with Air Mattress (N/A with 37PDQ)
- Roadside: Leatherette Ensemble Booth Dinette (Includes Leatherette Hide-A-Bed Sofa Selection with Air Mattress) (N/A: 37PDQ)

OPTIONS

- Curbside: One Leatherette Euro-Recliner Chair with Ottoman and Wall-Mounted Table with Pullout Countertop (35SBD, 38PBD)
- Curbside: One Leatherette Euro-Recliner Chair with Ottoman and Desk Work Area IPO Love Seat (39PBT)
- Curbside: Leatherette Easy Bed Sofa IPO Fabric Easy Bed Sofa (N/A with 39PBT)
- Curbside: Leatherette Love Seat IPO Fabric Love Seat (39PBT)
- Curbside: Fabric Hide-A-Bed Sofa with Air Mattress (37PDQ)
- Curbside: Leatherette Hide-A-Bed Sofa with Air Mattress (37PDQ)
- Freestanding Dinette with Two Freestanding Chairs and Two Folding Chairs

ELECTRICAL SYSTEMS AND LIGHTS: FEATURES

- 50 Amp 120V Distribution Panel and Power Cord
- Energy Management System
- 60 Amp Electronic 12V Power Converter
- Onan® 6.0 kW Diesel Generator
- Two 6V House Batteries
- Two 12V Heavy-Duty Chassis Batteries
- Battery Disconnect Switch at Front Door
- Exterior Power Entry Step, with Light
- Interior Stepwell Entry Step Lights
- Water Pump Switch in Service Bay Area and Convenience Center
- Lights in Outside Storage Compartments
- Underhood Utility Light
- Two Recessed Ceiling Map Lights above Cockpit Seats
- Hallway Convenience Center
- Obscure Lens Halogen Light under Kitchen and Living Room Hutch Overhead Cabinets
- Three Recessed Ceiling Lights above Countertop Work Area Kitchen
- One Recessed Ceiling Light above Refrigerator (37PDQ, 39PBT)
- Decorative Lighting Oil Rubbed Bronze Living Room Wall Light, Dinette Overhead and Cosmetic Vanity Light

OPTIONS

- 2,000 Watt Inverter with Two Additional Batteries (4 Total, 6 Volt Batteries)
- Storage Compartment Tank Monitor Gauge
- Manual Retracting Power Cord Reel
- Onan® 8.0 kW Quiet Diesel Generator

PLUMBING AND LP SYSTEMS: FEATURES

- Kitchen Stainless Steel Under-Mounted Sink with Single Lever Satin Nickel Faucet with Pullout Sprayer
- Central Water Filtration System
- New Bath Lavatory Faucet (Satin Nickel Finish)
- Demand Water System and Water Pump
- 10-Gallon LP Gas/Electric Water Heater with Electronic Ignition (DSI)
- Winterization Valving System
- Water Heater Bypass Valving
- China Toilet with Sprayer
- No-Fuss Flush Holding Tank Rinsing System
- Insulated Systems Compartment with Easy Access to Hook-Up
- Shower inside Wet Bay with Hot/Cold Water Shower Head with Shut-Off
- Soap Dispenser inside Utility Bay
- Gravity and Pressurized Water Fill
- Contained Storage Area for Sewer Hose
- One-Piece Fiberglass Shower
- Shower Diverter, Hose and Head with Shut-Off, Satin Finish with Satin Slide Bar for Shower Head with Metal Soap Dispenser
- Satin Nickel Shower Door Frame with Obscure Glass (35SBD)
- Rounded Satin Nickel Shower Door Frame with Decorative Glass (N/A: 35SBD)

OPTIONS

- RV Sani-Con 1 System, Holding Tank Flush System
- Bathtub Option IPO Shower (Rounded Shower Stalls Will Be Neo-Angled with Tub Option)

HEATING, VENTS AND AIR CONDITIONING: FEATURES

- Dual 13.5M BTU Air Conditioners with Ducted Air and Digital Wall Thermostat
- Electronic Ignition Furnace (35M BTU 35SBD) (One 20M BTU and One 31M BTU 37PDQ, 39PBT) (One 40M BTU 38PBD)
- Kitchen Powered Attic Fan with Wall Control of Automatic Dome and Fan Power
- Bath Powered Attic Fan with Wall Control of Automatic Dome and Fan Power
- 12V Heater in Wet Bay; Heat Pad on Fresh Tank
- Wood Louver Air Return Grill for Furnace
- Metal Floor Registers (Satin Nickel)

OPTIONS

- Dual 13.5M BTU Air Conditioner with Heat Pumps and Digital Thermostat Control
- Ceiling Fan in Bedroom

WINDOWS, DOORS AND AWNINGS: FEATURES

- Radius Flush-Mounted Dual Pane Safety Glass Dark Tinted Slider Windows
- Exterior Entry Door Grab Handle
- Eclipse Automatic Patio Awning
- Front Door Awning
- Topper Slide-Out Awnings Living Area and Bedroom
- Tinted Skylight in Bathroom with Protecta Glaze

OPTIONS

- Sidewall Bedroom Window Awning with Metal Cover and Painted Hardware (N/A: 37PDQ)
- Window Awning Living Area Slide-Out House Windows with Metal Cover and Painted Hardware
- Window Awnings Bedroom Wardrobe Slide-Out House (N/A: 39PBT)

SAFETY: FEATURES

- Fire Extinguisher
- Deadbolt Lock on Entrance Door
- 120V GFI Protected Circuit Kitchen, Bath and Exterior
- LP Gas Detector
- Smoke Detector
- Carbon Monoxide Detector
- Driver and Passenger Three-Point Seatbelts
- Third Brake Safety Light
- Egress Window

Due to continuous product improvement, please see the website for the latest in standards and options, specifications, and technical data. Go to www.holidayrambler.com.

Weights (Lbs.)*	35SBD	37PDQ	38PBD	39PBT
Gross Vehicle Weight Rating	29,000	29,000	29,000	29,000
Gross Combined Weight Rating	33,000	33,000	33,000	33,000
Gross Axle Weight Rating (Front)	11,000	11,000	11,000	11,000
Gross Axle Weight Rating (Rear)	18,000	18,000	18,000	18,000
Measurements				
Wheelbase	204"	228"	240"	252"
Overall Length	35' 5"	37' 5"	38' 5"	39' 5"
Overall Height (Including A/C)	12' 8"	12' 8"	12' 8"	12' 8"
Interior Height (Increased Height to 84")	84"	84"	84"	84"
Interior Width	94.5"	94.5"	94.5"	94.5"
Exterior Width	100.5"	100.5"	100.5"	100.5"
Tank Capacity (Gal.)**				
Water Heater	10	10	10	10
Gray Tank	55	55	55	55
Black Tank	39	39	39	39
Fresh Tank	95	95	95	95
Fuel Tank	75	75	75	75
LP Tank***	39	39	39	39

* Towing capacity is limited by GCWR; your vehicle's towing capacity is the difference between the GCWR and the actual vehicle weight, including all water, fuel, passengers and cargo. Your towed vehicle should be equipped with auxiliary brakes if the weight of the towed vehicle exceeds 1,000 lbs. Consult your Owner's Manual for further towing information.

** All tank capacities are estimated based upon calculations provided by the tank manufacturers and represent approximate capacities. The actual "usable capacity" may be greater or less than the estimated capacities based upon fabrication and installation of the tanks.

*** Actual filled LP capacity is 80% of listing due to safety shut-off required on tank.

The actual overall length of the recreational vehicle may differ from that indicated in the brochure due to variances in the manufacturing process and/or installed components. The actual length may be greater or less than that indicated. Due to the large variety of options and floorplan arrangements available to our customers, actual weights for each unit can differ significantly. Holiday Rambler provides a weight sticker on each unit we produce which includes that unit's tank capacities and approximate weight. Consult your local Holiday Rambler dealer for unit availability and further information. The information printed in this brochure reflects product design, fabrication, and component parts at the date of printing. The manufacturer reserves the right, at any time, to make changes in product design or material or component specifications as its sole option, without notice. This includes the substitution of components of a different brand or trade name which will result in comparable performance. All information printed in this brochure is subject to change after the date of printing. Some features shown or mentioned in this brochure are optional and may only be available in selected floorplans. Photographs may show props or decorations that are not standard equipment on Holiday Rambler models. Holiday Rambler, the Holiday Rambler logo and its design, are registered trademarks. All other products and company names are trademarks and/or registered trademarks of their respective holders. While the color of the motorhome's exterior and the interior fabrics depicted in this sales brochure are fair and reasonable depictions, the colors depicted may not be an exact match of the actual colors because of the variances in photo-processing and variances caused by inserting the photographs within the sales brochure. Due to product improvements, changes during the model year and/or transcription errors that may occur, information represented within this brochure may not be accurate at the time of your purchase. If certain information is significant to your purchasing decision, please confirm the information with your dealer prior to submitting your order. Component part and appliance manufacturers issue limited warranties covering those portions of the recreational vehicle not covered by the Limited Warranties issued by Monaco Coach Corporation. To learn which specific component parts and appliances are excluded from the Limited Warranties issued by Monaco Coach Corporation, please contact your selling dealership or Monaco Coach Corporation directly, or review the warranty packet inside the recreational vehicle.

2008 FLOORPLANS ■ CARPET ■ TILE

35 SBD

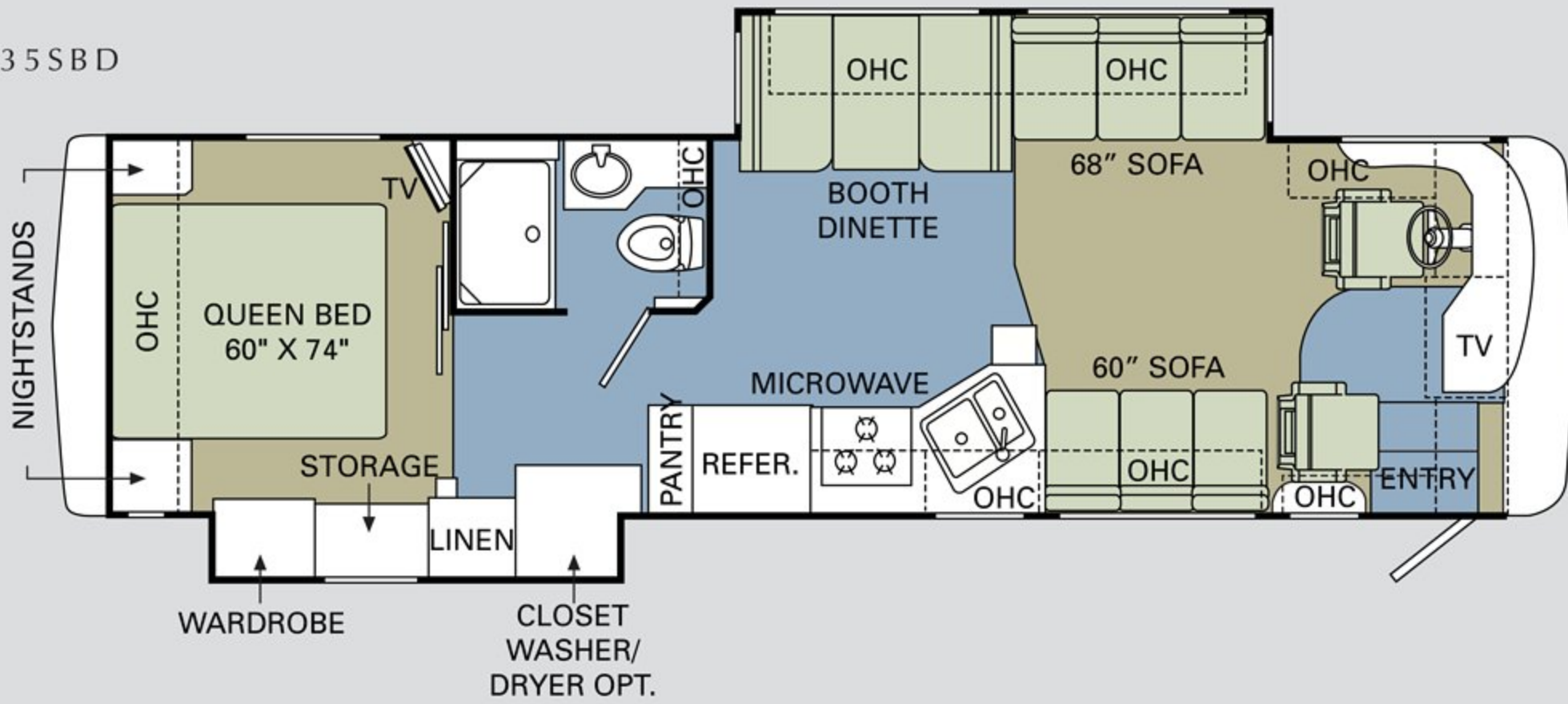

37 PDQ

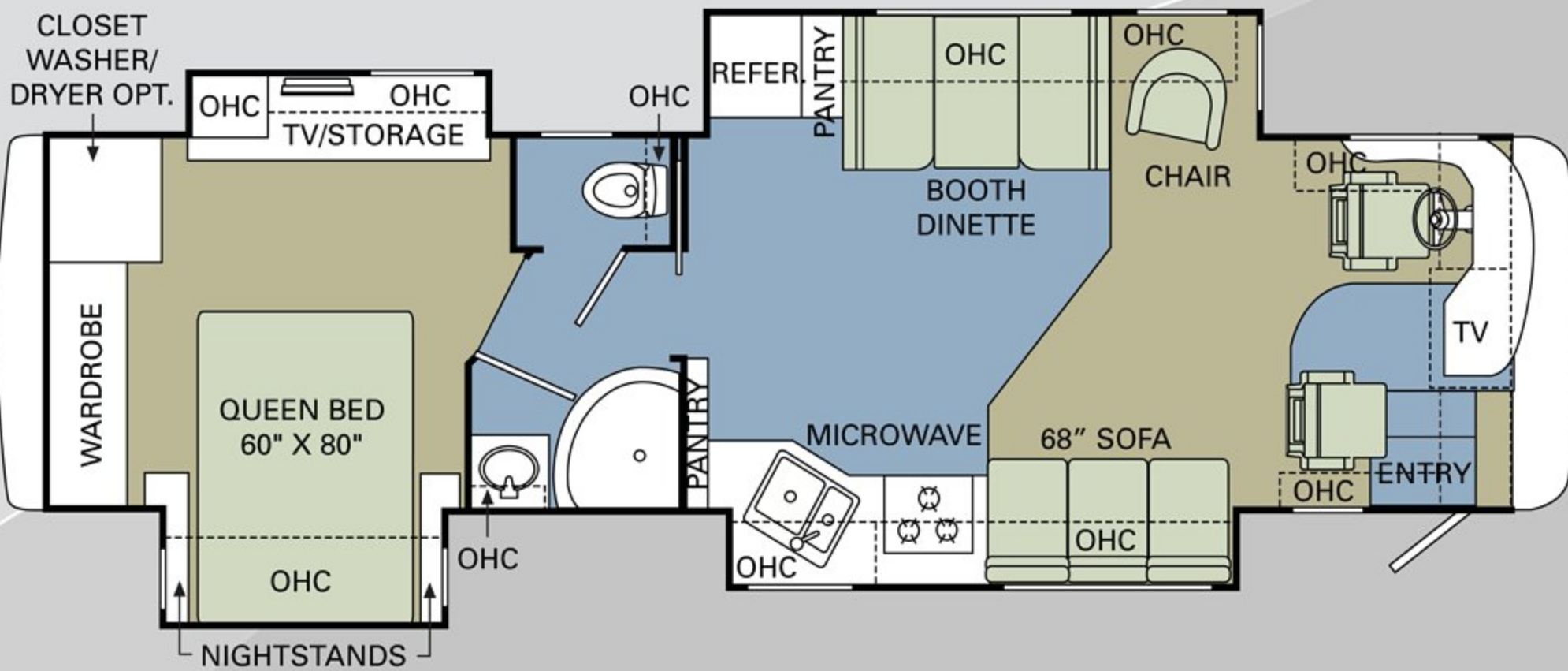

38PBD

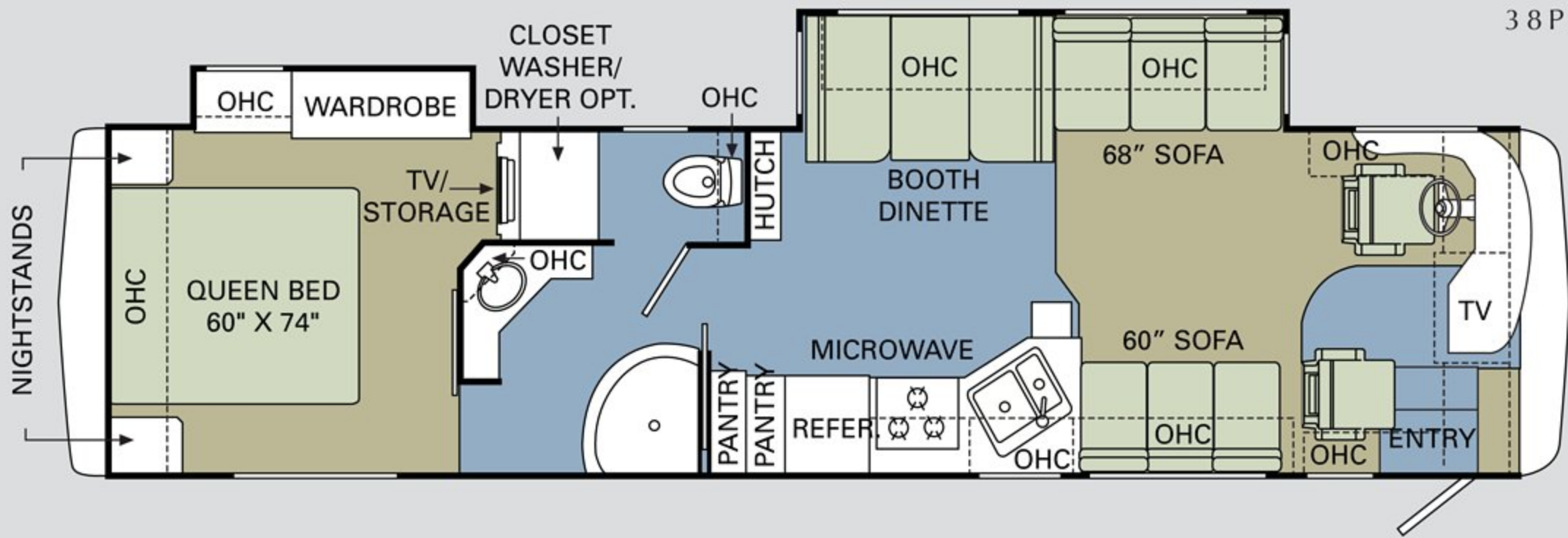

39PBT

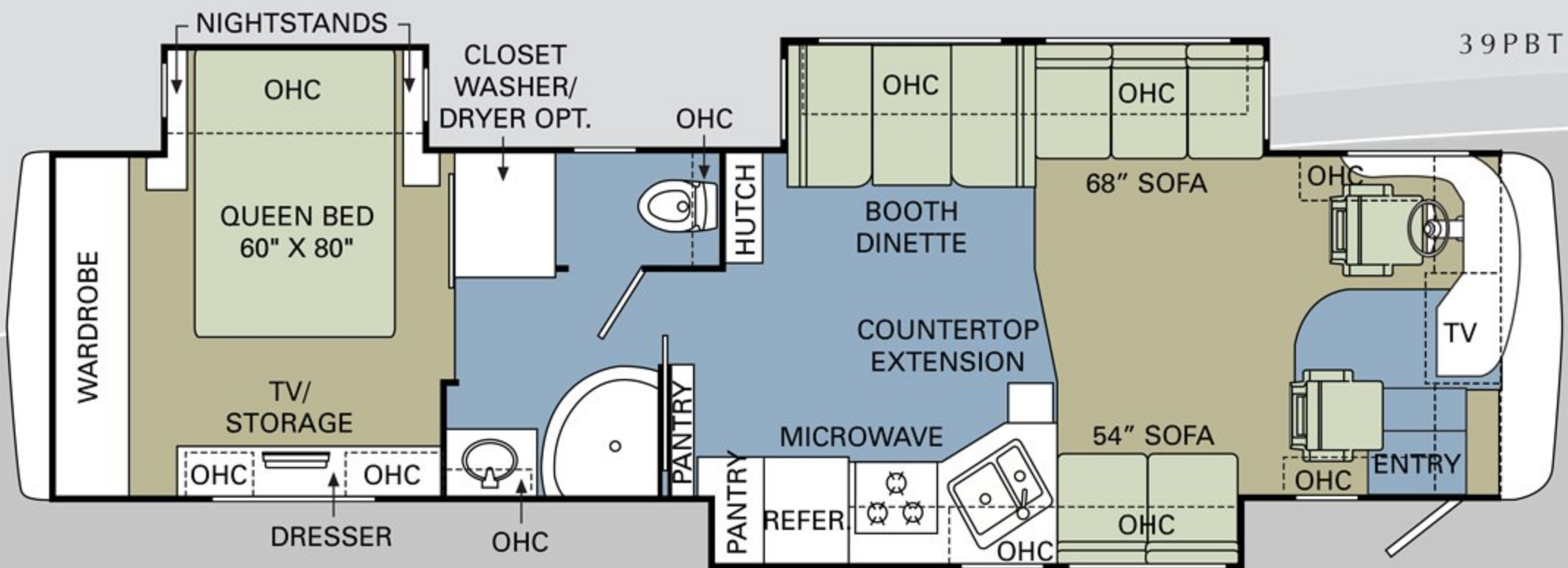

HOLIDAYRAMBLER.COM

Log on to our website anytime, night or day. It's your link to everything Holiday Rambler, including product news and updates, club events, dealer and service center info and much more. Take it for a test drive today.





NEPTUNE[®]
2008

BEING DIFFERENT MAKES ALL THE DIFFERENCE.

At Monaco Coach Corporation, we always strive to be the best. And that means thinking outside the box. Giving you more of what you want in an RV. Like our exclusive Roadmaster chassis. PanaSuite™ full-wall slides. And programs like Monaco Financial Services and 24/7 roadside assistance. No other manufacturer can match Monaco's offerings. No one even comes close. Why not discover the difference for yourself? Visit www.monacodifferent.com.

**"No other manufacturer can match Monaco's offerings.
No one even comes close."**

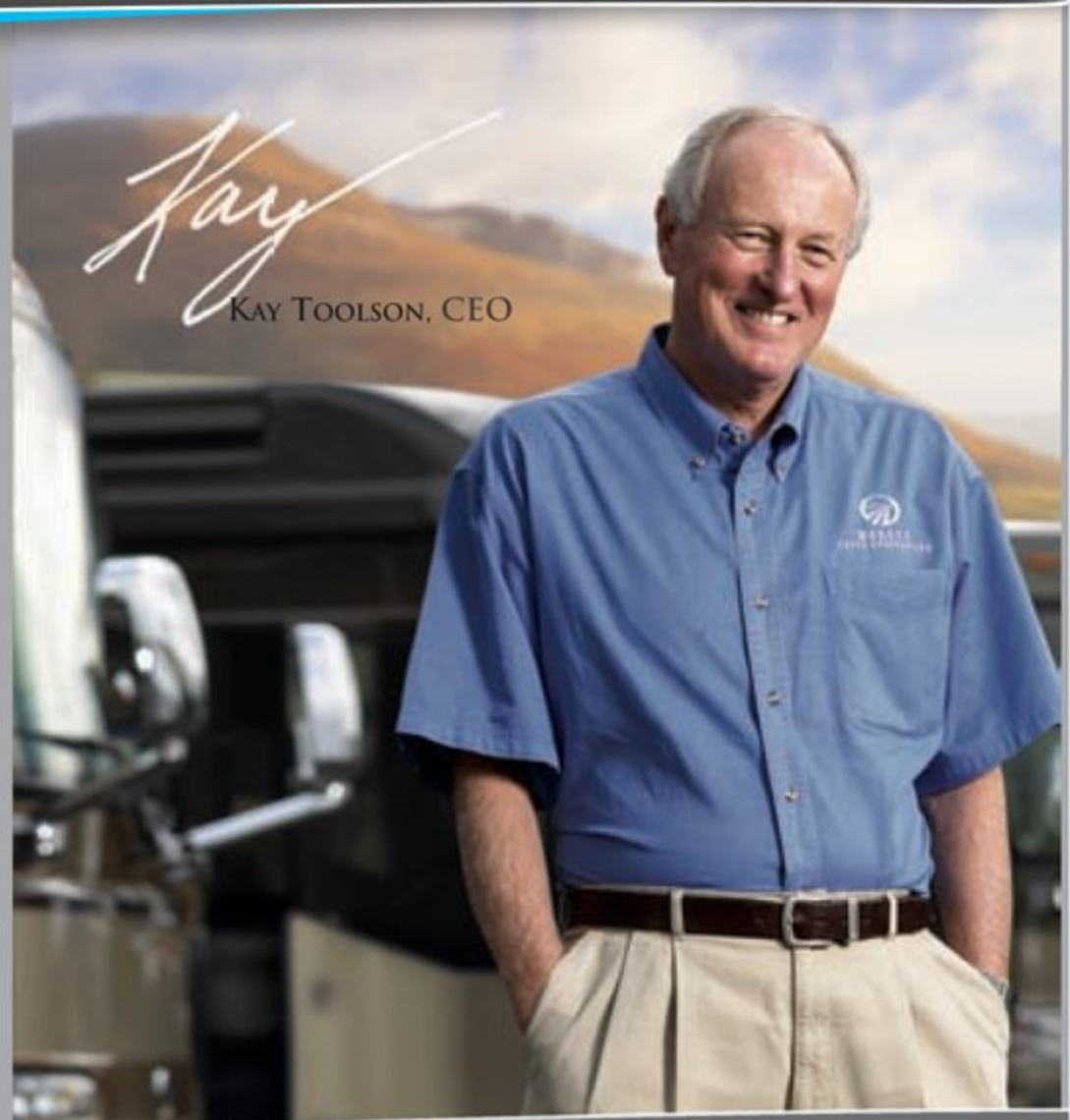

WARRANTIES

12 MONTH/24,000 MILE basic limited warranty

5 YEAR/50,000 MILE limited warranty on aluminum or steel frame structure of sidewall, roof, front and rear cap

3 YEAR/50,000 MILE limited warranty on Roadmaster chassis

Applies to certain models. See owner's manual for complete details.



HOLIDAY RAMBLER[®]

This is Living.



MONACO COACH CORPORATION

606 Nelson's Parkway Wakarusa, IN 46573
www.holidayrambler.com | 800-245-4778



Monaco is traded on the New York Stock Exchange under the listing MNC.
© 2007, Monaco Coach Corporation 07/07 NPN:BROHNEP Litho in USA.