

# PANAMERICA



## PANAMERICA TRAVEL TRAILER: 1 FLOORPLAN, 34

The PanAmerica invites you to travel in style and comfort – and carry your passions with you. This new 34-foot Airstream travel trailer features the ultimate built-in garage, complete with a durable aluminum interior skin and textured floor.

The rear 11 feet of the trailer can haul motorcycles, ATVs, or other action/adventure gear – up to 2,500 pounds worth. Or, use the garage bay as a mobile office, a base for show dogs, or even an artist's studio. The PanAmerica's possibilities are limited only by your imagination and desires.

Optional Cabinets and Track  
▼ Cargo Tie-Down System.



▲ Large Queen Size Bed.

▼ Dining and Galley Area in the PanAmerica



A gull-wing exterior door with slide-out ramp is incorporated into the trailer's tail, and a pass-through door in the bulkhead with porthole window offers easy access to the living quarters. Choose to equip your garage bay with any combination of storage lockers, cabinets, tabletop work areas and tie downs. And of course, electrical outlets and speakers linked to the trailer's crystal-clear sound system come standard.

But this Airstream offers more than high function and durability. Surrounding you with contemporary design throughout, the PanAmerica features flush cabinetry, flowing lines, and indirect lighting. And after a day of riding or kayaking, return to four star accommodations with a spacious bathroom, a separate luxurious shower and a queen sized bed. Stainless steel appliances and trim, leather appointments and a flush-mount flat screen television, this travel trailer makes a luxurious home away from home.

*So get out there – your adventure awaits!*



## TIRED OF COMPANIES TRUMPETING THEIR NEW-FOUND “GREEN-NESS”? US TOO.

So we're happy to note that we're still taking the same environmentally friendly approach that has sustained us, and our planet, for nearly 80 years. Simply put, Airstream has been green as long as it has been silver.

Airstreams are designed to spend time on the road, not in the landfills. As such, nearly 70% of all Airstream trailers ever produced are still on the road! While other products are designed to wear out, Airstreams are designed to be handed down through the generations.

We also work with nature, not against it. Airstream's founder, Wally Byam, knew that a low profile and a rounded, slippery shape would make for better towing in every respect. As a result, Airstreams enjoy a 20% advantage in

towing efficiency over standard “white box” trailers. And over the life of your Airstream, that's a lot of fuel saved.

And should your Airstream come to the end of its life after many decades of service, its primary components (aluminum, steel, and wood) are easily recycled.

So go ahead and enjoy your Airstream with a sense of global responsibility, and comfort in the fact that you are adventuring in one of the most environmentally friendly travel trailers in the world. And always remember that Airstreamers leave a place better than they found it.

*Silver is indeed Green.*

# PANAMERICA

## PANAMERICA TECHNICAL SPECIFICATIONS

Exterior Length	34'7"	A/C w/Heat Pump (BTU)	15,000
Width Exterior	8'5.5"	Furnace W/Electric Ignition (BTU)	34,000
Width Interior	8'1"	LPG (Lbs) (2-30# Tanks)	60
Height Exterior w/ A/C	9'7.5"	Deep Cycle Battery (Lead Acid)	2
Height Interior w/ A/C	6'5"	Sleeping Capacity	3-4
Hitch Ball Height	19.75"		
Hitch Weight w/o Options	1,260	<b>Utility Garage</b>	
Or Variable Weight		94" Width X 132" Depth	Std
UBW (Unit Base Weight)	7,288	Overhead Locker	Opt
NCC (Net Carrying Capacity)	4,212	Utility/Garage Storage (Right Side/Left Side)	Opt
w/o Options Fluids Or Cargo		Floor Track Cargo System (2 Tracks)	Opt
GVWR (Gross Vehicle Weight Rating) (U.S.)	11,500	With 4 Adjustable Cargo Tie Downs	
Water Tank /Drain Valve	54	Retractable Screen For Rear Gull Wing Door	Opt
Blackwater Tank (Gal)	39		
Graywater Tank (Gal)	37		
Water Heater (Gal) Gas/Electric	6		



Please visit [www.airstream.com](http://www.airstream.com) to see a full set of model specifications, floorplans, features and options, and to find your nearest Airstream dealer.

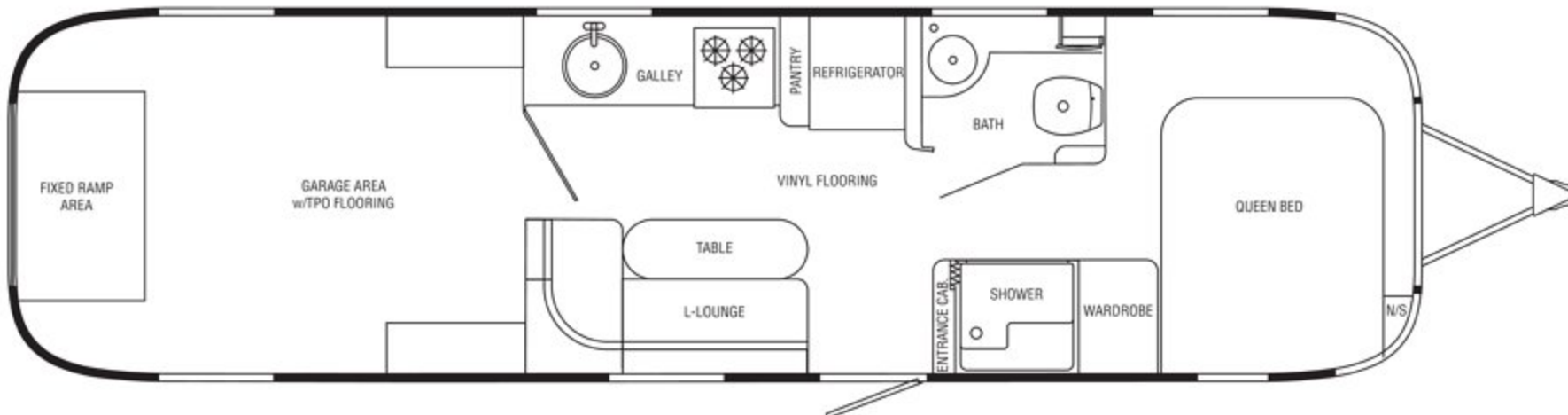

**AIRSTREAM**



# AIRSTREAM

TRAVEL TRAILERS



## TO THE RESTLESS SPIRIT

The Airstream Travel Trailer beckons to those driven by an insatiable desire to see more, to do more, and to learn more. It calls to those who understand the allure of the open road, and the discovery of what lies beyond the next bend. And, it appeals to those who value independence and inspired design, and to those who recognize the quality and craftsmanship that have allowed one brand to stand the toughest test of all – *TIME*.

## ADVENTURE, INSPIRED BY AIRSTREAM

Airstream, Inc.  
419 West Pike Street  
Jackson Center, OH  
45334 USA  
937-596-6111  
www.airstream.com

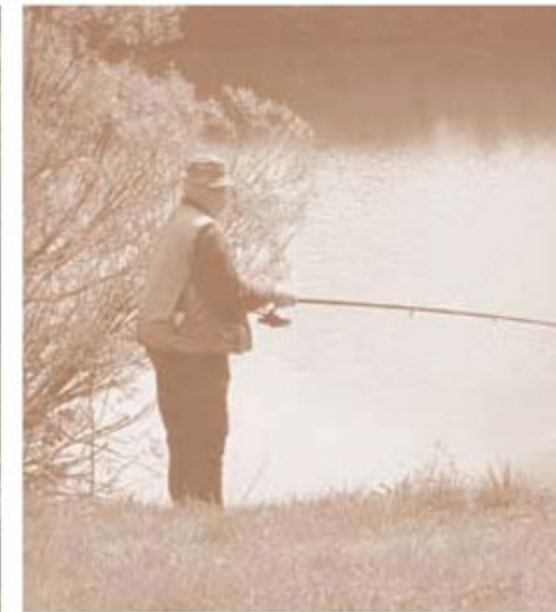

Product information, specifications, and photography in this brochure were as accurate as possible at time of printing. Photographs may contain some features that are optional on your vehicle. Since we continually strive to improve our products, actual products may differ. Prices and specifications are subject to change without notice. All capacities are approximate and dimensions are nominal. Some features or options may be different or unavailable in Canada.

Vehicle Loading – Every effort has been made to provide the greatest number of options for the recreation vehicle owner. Along with these choices comes the responsibility to manage the loads that are imposed by the choices so that they remain within the manufacturer's specified chassis weight limits. Do not overload the recreation vehicle.

Dry Weights – Based on standard features; optional equipment not included. Net carrying capacity (NCC) determined by subtracting unloaded vehicle weight (UWV) from gross vehicle weight (GVWR) and includes fluids, options, and cargo. Liquid capacities and weights are approximations only.

Warning – This information is intended as a guide only. Weights of individual vehicles may vary. Consult your owner's manual for complete loading, weighing, and towing instructions.

**THOR**  
INDUSTRIES, INC.

All content and images © Airstream 2009

Travel Trailers 08/09 10K