

 MONARCH[®]
2010

"Every day is a celebration."



MONACO[®]

DRIVING YOUR DREAM.



 MONARCH®
2010



"Every day is a celebration."



MONACO®

DRIVING YOUR DREAM.

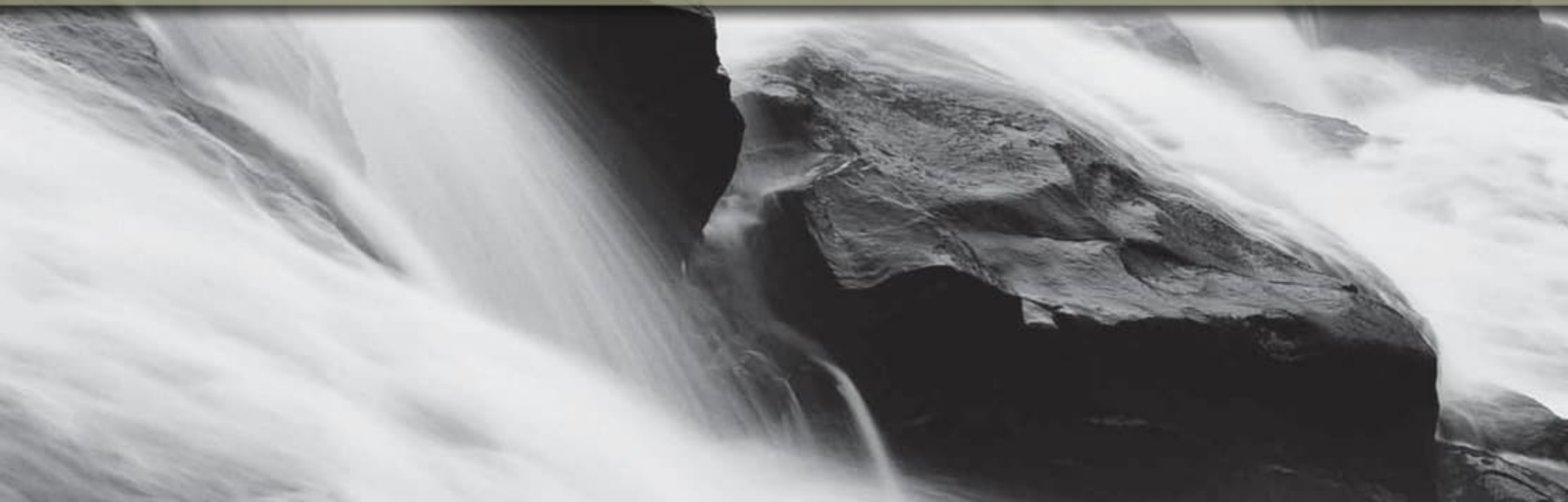



C'MON, GET HAPPY.

Hop aboard the 2010 Monarch, and it's time to celebrate. This is the gas-powered Monaco you've always wanted — at a price that'll make even your wallet happy. Just check out the beautiful new interiors. The top-quality appliances. Not to mention the state-of-the-art options like Sirius satellite radio, GPS, and a new three-camera vision system. For 2010, you'll also notice a new, more powerful dash climate control system, a 32-inch LCD TV (33SDD, 34SBD), and other niceties throughout. What a joy ride.





C'MON, GET HAPPY.

Hop aboard the 2010 Monarch, and it's time to celebrate. This is the gas-powered Monaco you've always wanted — at a price that'll make even your wallet happy. Just check out the beautiful new interiors. The top-quality appliances. Not to mention the state-of-the-art options like Sirius satellite radio, GPS, and a new three-camera vision system. For 2010, you'll also notice a new, more powerful dash climate control system, a 32-inch LCD TV (33SDD, 34SBD), and other niceties throughout. What a joy ride.





355FD | NEWPORT CHERRY II | URBAN LOFT III



MONACO®

DRIVING YOUR DREAM.

For some folks, there's just no fun in getting up and facing another day. Poor things. They obviously don't own a 2010 Monaco. When you're cruising the country in one of these beauties, it's hard not to grin. After all, you're living the good life. Sleeping in as long as you want. Eating blueberry pancakes with real maple syrup. Going places without a roadmap. Discovering the joys of swimming and biking again. Yes, this is life as it was meant to be lived. Happy. Worry-free. Humming down the highway in a 2010 Monaco.





35SFD | NEWPORT CHERRY II | URBAN LOFT III



MONACO®

DRIVING YOUR DREAM.

For some folks, there's just no fun in getting up and facing another day. Poor things. They obviously don't own a 2010 Monarch. When you're cruising the country in one of these beauties, it's hard not to grin. After all, you're living the good life. Sleeping in as long as you want. Eating blueberry pancakes with real maple syrup. Going places without a roadmap. Discovering the joys of swimming and biking again. Yes, this is life as it was meant to be lived. Happy. Worry-free. Humming down the highway in a 2010 Monarch.





SMARTSTRUCTURE II

SmartStructure II adapts the principles of our diesel chassis technology for use with a gas chassis. While other motorhomes use outriggers to hang the walls and storage compartments, our exclusive truss system is integrated with the chassis rails to provide a solid platform. The floor and storage bays are all one piece, and the truss system works with the chassis rails to channel weight toward the center of the motorhome. Greater strength. Better weight distribution. A solid foundation. That's SmartStructure II.

VORTEC™ 8100 ENGINE

The Workhorse chassis with a 8.1L V-8 engine features 340 HP and 455 lbs./ft. torque. The Ford chassis comes standard with a 6.8L 3-valve V-10 engine with 362 HP and 457 lbs./ft. torque.



9-LAYER ROOF CONSTRUCTION: (top to bottom)

- One-piece peaked fiberglass roof
- Luaun backing
- Thick, tapered bead foam insulation
- Aluminum double I-beam superstructure filled with fiberglass insulation
- Vapor barrier
- Structure foam: thermal insulative barrier
- 1/2" bead foam insulation
- Foam padding for extra insulation
- Padded vinyl ceiling



4-LAYER SIDEWALL CONSTRUCTION: (left to right)

- Interior paneling
- 1-1/2" x 1-1/2" square tubular aluminum frame
- 1-1/2" thick foam insulation
- Smooth gel coat fiberglass wall



4-LAYER FLOOR CONSTRUCTION: (top to bottom)

- Structurwood™
- High-performance thermal insulation foam
- 1-1/2" aluminum tube
- Three-ply poly underbelly



THE DIFFERENCE IS IN THE DETAILS.

The 2010 Monarch models are matched with rugged, reliable chassis by Ford and Workhorse. Whichever you choose, you'll have the added safety of anti-lock braking (ABS) and the convenience of fully automatic hydraulic leveling. Each chassis features a 5,000 lb. hitch for excellent towing capacity and is prewired for supplemental braking for your towed vehicle.



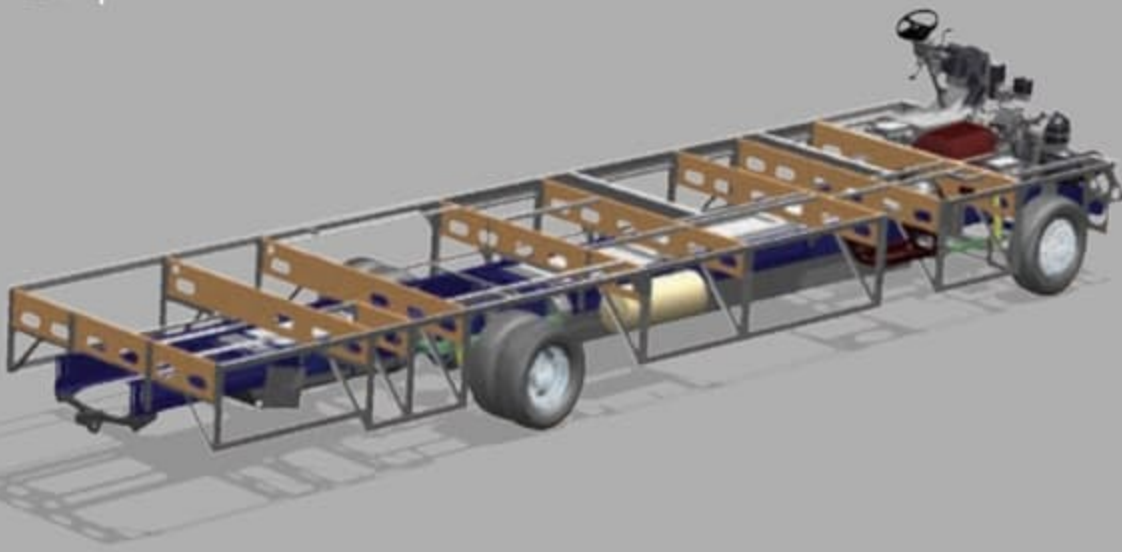

SMARTSTRUCTURE II

SmartStructure II adapts the principles of our diesel chassis technology for use with a gas chassis. While other motorhomes use outriggers to hang the walls and storage compartments, our exclusive truss system is integrated with the chassis rails to provide a solid platform. The floor and storage bays are all one piece, and the truss system works with the chassis rails to channel weight toward the center of the motorhome. Greater strength. Better weight distribution. A solid foundation. That's SmartStructure II.

VORTEC™ 8100 ENGINE

The Workhorse chassis with a 8.1L V-8 engine features 340 HP and 455 lbs./ft. torque. The Ford chassis comes standard with a 6.8L 3-valve V-10 engine with 362 HP and 457 lbs./ft. torque.



THE DIFFERENCE IS IN THE DETAILS.

The 2010 Monarch models are matched with rugged, reliable chassis by Ford and Workhorse. Whichever you choose, you'll have the added safety of anti-lock braking (ABS) and the convenience of fully automatic hydraulic leveling. Each chassis features a 5,000 lb. hitch for excellent towing capacity and is prewired for supplemental braking for your towed vehicle.

9-LAYER ROOF CONSTRUCTION: (top to bottom)

- One-piece peaked fiberglass roof
- Luaun backing
- Thick, tapered bead foam insulation
- Aluminum double I-beam superstructure filled with fiberglass insulation
- Vapor barrier
- Structure foam: thermal insulative barrier
- 1/2" bead foam insulation
- Foam padding for extra insulation
- Padded vinyl ceiling



4-LAYER SIDEWALL CONSTRUCTION: (left to right)

- Interior paneling
- 1-1/2" x 1-1/2" square tubular aluminum frame
- 1-1/2" thick foam insulation
- Smooth gel coat fiberglass wall



4-LAYER FLOOR CONSTRUCTION: (top to bottom)

- Structurwood™
- High-performance thermal insulation foam
- 1-1/2" aluminum tube
- Three-ply poly underbelly



NEWPORT CHERRY II



NOW FOR THE HARD PART.

Choosing the Monarch was easy. Now, it's time to make it your own. For 2010, our designers are pleased to present a stunning array of standard and optional decors and the hardwood raised panel style cabinetry. But don't worry. Even if you end up flipping a coin, you always win with Monaco.

AUTUMN TRAIL IV



URBAN LOFT III



VINTAGE GOLD



- Carpet A
- Dinette B
- Sofa C
- Bedspread D



Note: Colors depicted are a reasonable representation though they may not be an exact match of the actual colors due to variances in processing and production. See your dealer for actual fabric and paint chip samples.

NEWPORT CHERRY II



NOW FOR THE HARD PART.

Choosing the Monarch was easy. Now, it's time to make it your own. For 2010, our designers are pleased to present a stunning array of standard and optional decors and the hardwood raised panel style cabinetry. But don't worry. Even if you end up flipping a coin, you always win with Monaco.

AUTUMN TRAIL IV



URBAN LOFT III



VINTAGE GOLD



- Carpet A
- Dinette B
- Sofa C
- Bedspread D

A	B	C	D

Note: Colors depicted are a reasonable representation though they may not be an exact match of the actual colors due to variances in processing and production. See your dealer for actual fabric and paint chip samples.

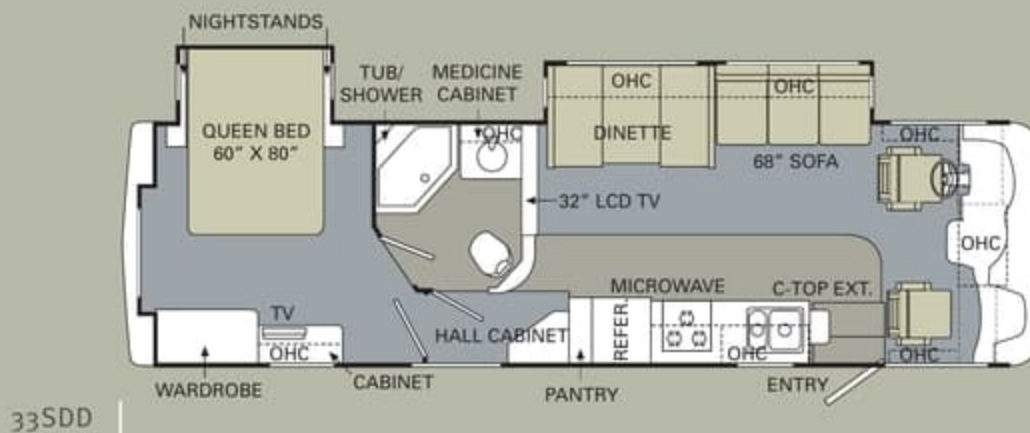
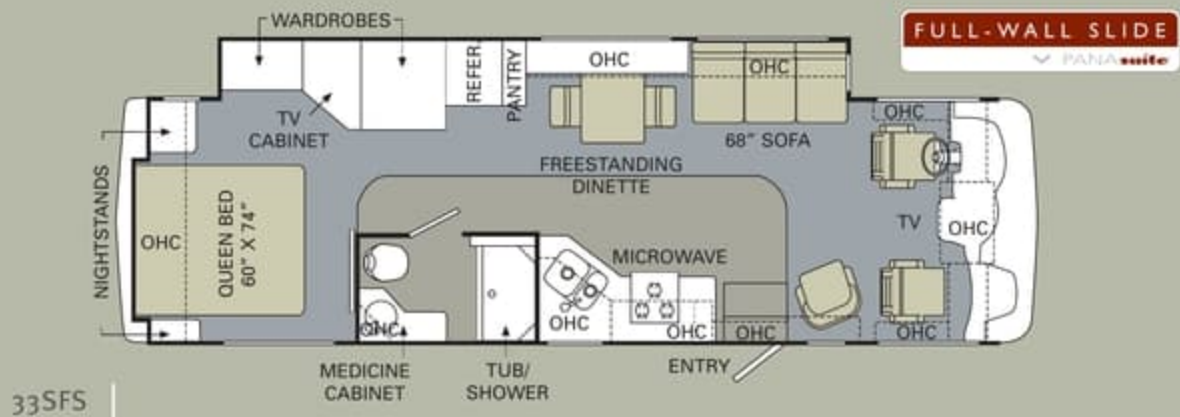
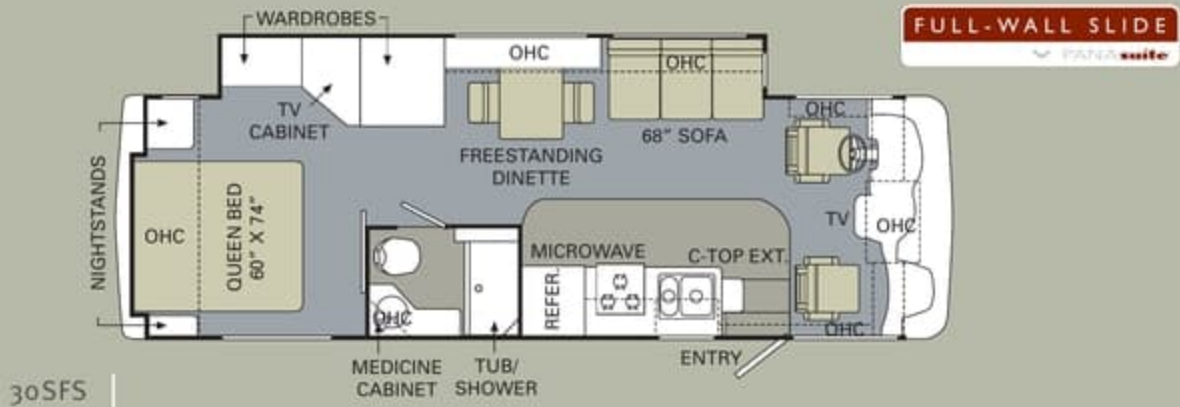

BUY LOCALLY. ENJOY EVERYWHERE.

Monaco RV strongly encourages our retail customers to purchase from their local dealerships whenever possible. Buying a new Monaco RV locally allows a customer to establish a relationship with a dealer close to home and provides convenient service and support from product-trained technicians. On our end, Monaco RV will continue to provide our dealer partners and customers with the finest recreational vehicles in the industry.

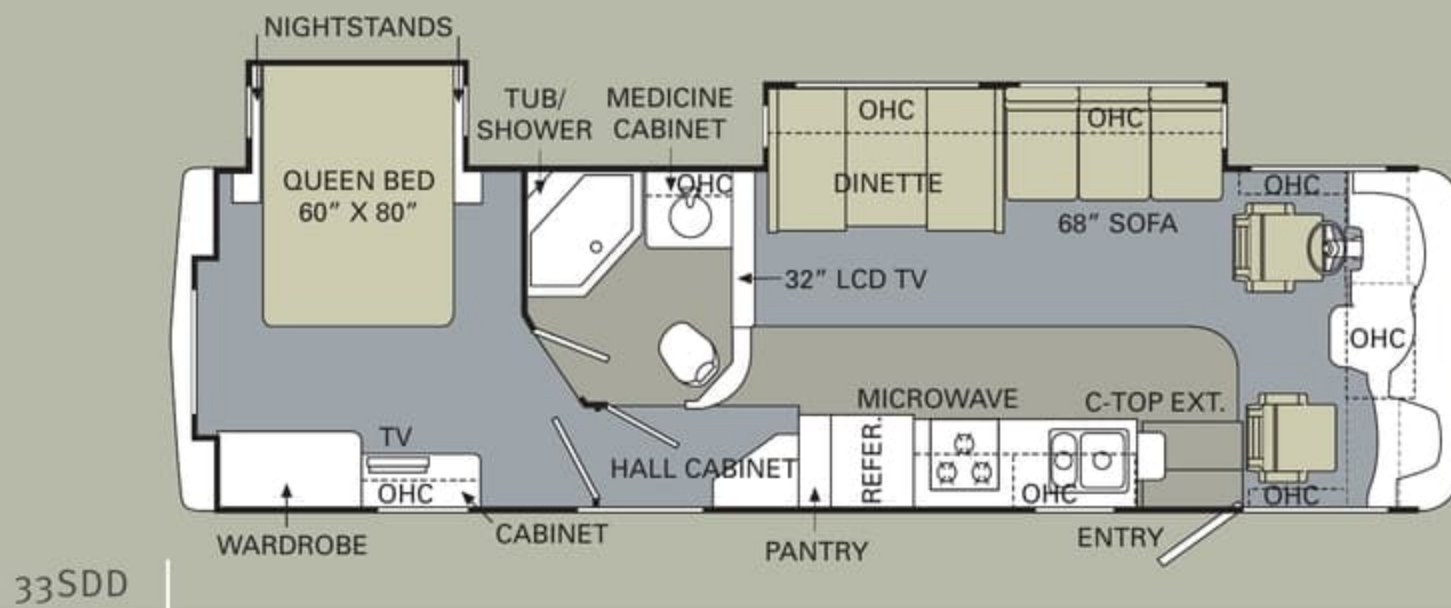
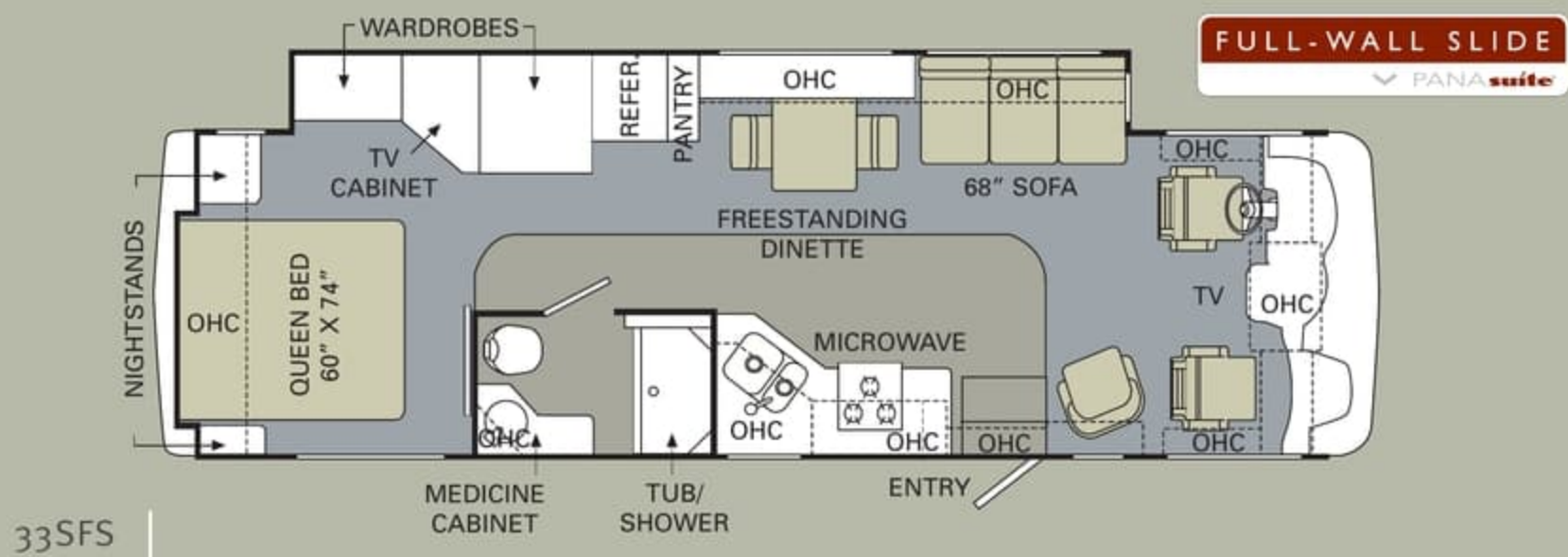
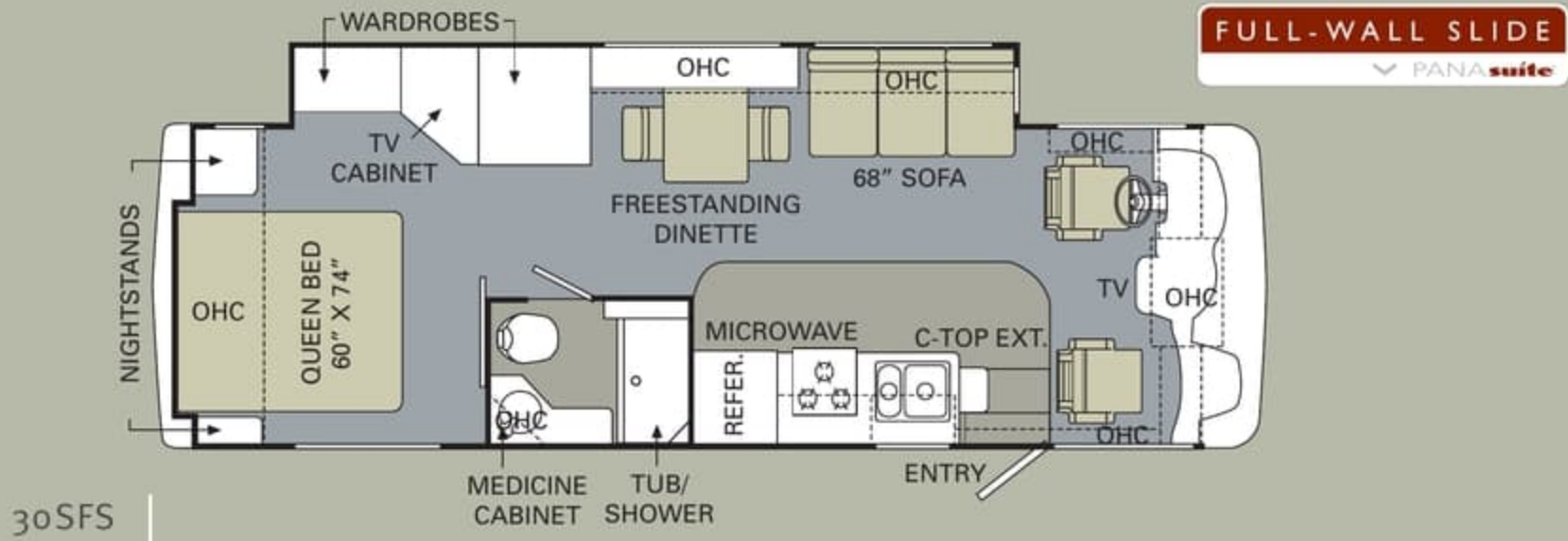

BUY LOCALLY. ENJOY EVERYWHERE.

Monaco RV strongly encourages our retail customers to purchase from their local dealerships whenever possible. Buying a new Monaco RV locally allows a customer to establish a relationship with a dealer close to home and provides convenient service and support from product-trained technicians. On our end, Monaco RV will continue to provide our dealer partners and customers with the finest recreational vehicles in the industry.

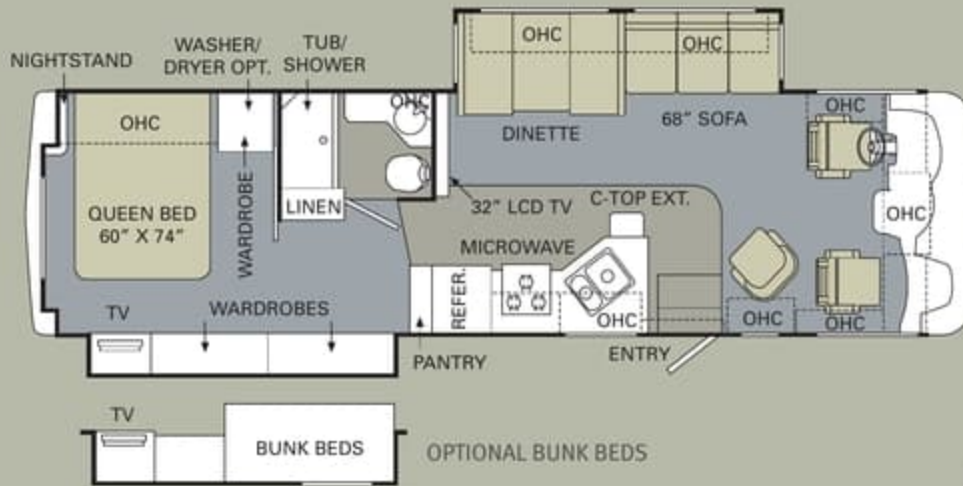

34SBD

FULL-WALL SLIDE
PANA 

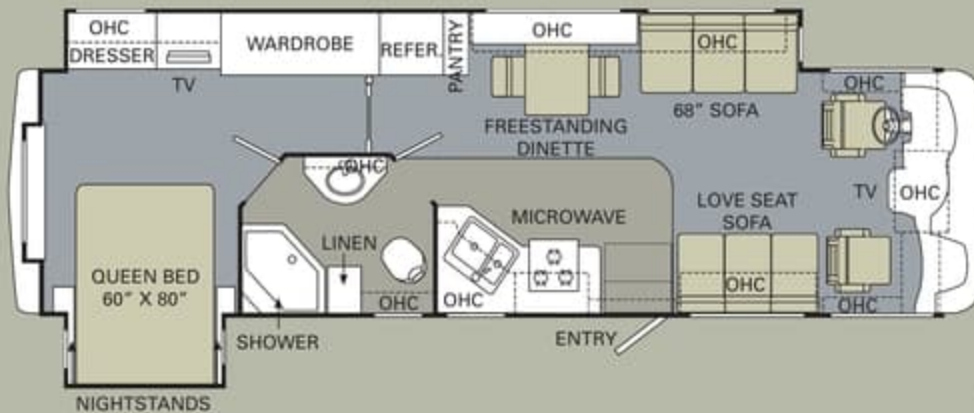

35SFD

 TILE  CARPET

ALL ROADS LEAD TO WWW.MONACOCOACH.COM.

Wherever the road takes you, you're never more than a click away from your friends at Monaco. Just go to www.monacocoach.com for all the latest product news, club dates and destinations, a dealer locator function, and factory tour information. You can also e-mail us directly through the site at any time.



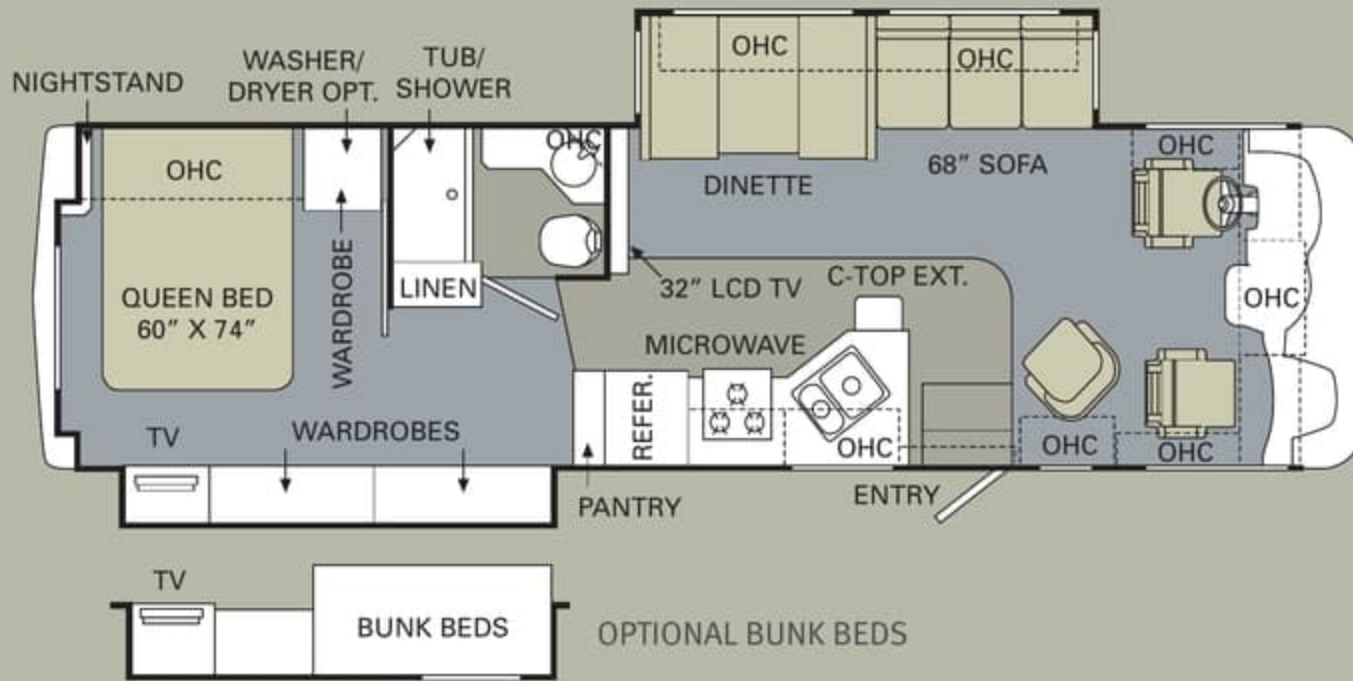

34SBD

FULL-WALL SLIDE

▼ PANASUITE

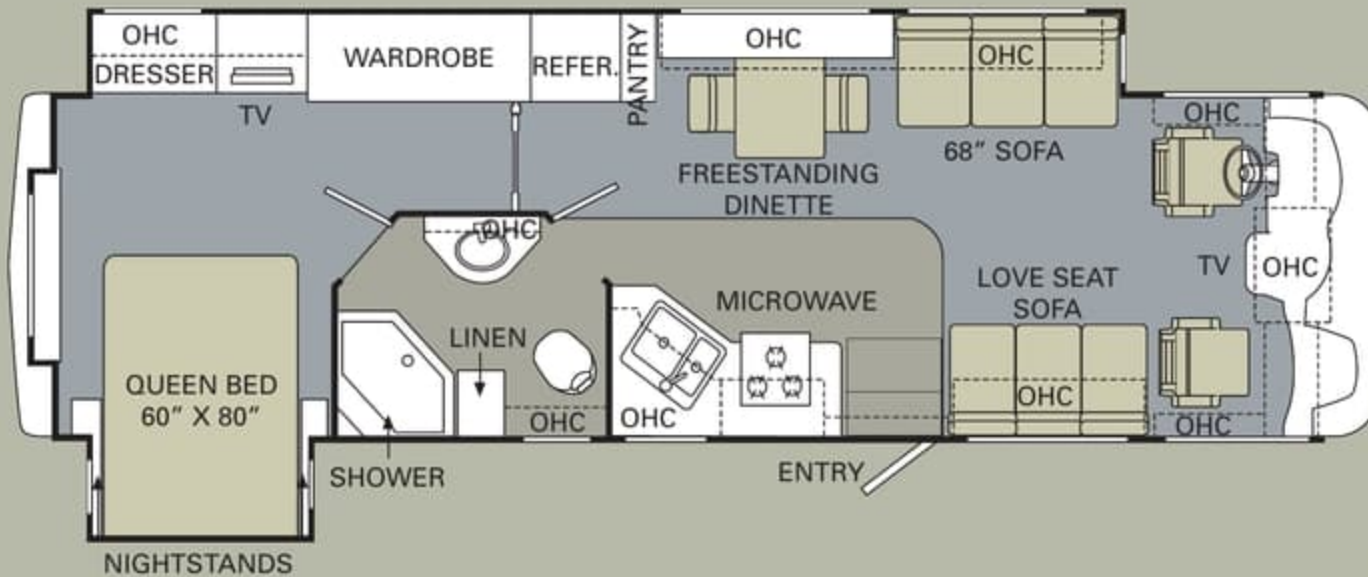

35SFD

 TILE  CARPET

ALL ROADS LEAD TO WWW.MONACOCOACH.COM.

Wherever the road takes you, you're never more than a click away from your friends at Monaco. Just go to www.monacocoach.com for all the latest product news, club dates and destinations, a dealer locator function, and factory tour information. You can also e-mail us directly through the site at any time.



Due to continuous product improvement, please visit www.monacocoach.com for the latest in standards and options, specifications, and technical data.

		Weight Ratings (Lbs.)				Measurements				Tank Capacity (Gall.) ³							
		Gross Vehicle	Gross Combined ¹	Front Gross Axle	Rear Gross Axle	Wheelbase	Overall Length	Overall Height (with A/C)	Interior Height	Interior Width	Exterior Width	Water Heater	Gray Tank	Black Tank	Fresh Tank	LP Tank ²	Fuel Tank
30SFS	FORD 20,500 LB. CHASSIS	20,500	25,500	7,500	13,500	190"	31'	12' 6"	84"	96"	100.5"	10	54	45	80	20	75
	WORKHORSE 20,700 LB. CHASSIS	20,700	25,700	7,500	13,500	190"	31'	12' 6"	84"	96"	100.5"	10	54	45	80	20	75
33SFS	WORKHORSE 22,000 LB. CHASSIS	22,000	26,000	8,000	14,500	228"	34' 3"	12' 9"	84"	96"	100.5"	10	54	45	80	20	75
33SDD	FORD 22,000 LB. CHASSIS	22,000	26,000	7,500	14,500	208"	34' 3"	12' 9"	84"	96"	100.5"	10	57	40	80	21	75
	WORKHORSE 22,000 LB. CHASSIS	22,000	26,000	8,000	14,500	208"	34' 3"	12' 9"	84"	96"	100.5"	10	57	40	80	21	75
34SBD	FORD 22,000 LB. CHASSIS	22,000	26,000	7,500	14,500	228"	35' 2"	12' 9"	84"	96"	100.5"	10	55	42	80	20	75
	WORKHORSE 22,000 LB. CHASSIS	22,000	26,000	8,000	14,500	228"	35' 2"	12' 9"	84"	96"	100.5"	10	55	42	80	20	75
35SFD	FORD 22,000 LB. CHASSIS	22,000	26,000	7,500	14,500	228"	36' 1"	12' 9"	84"	96"	100.5"	10	57	42	80	20	75
	WORKHORSE 22,000 LB. CHASSIS	22,000	26,000	8,000	14,500	228"	36' 1"	12' 9"	84"	96"	100.5"	10	57	42	80	20	75

¹Towing capacity is limited by GCWR; your vehicle's towing capacity is the difference between the GCWR and the actual vehicle weight, including all water, fuel, passengers and cargo. Your towed vehicle should be equipped with auxiliary brakes if the weight of the towed vehicle exceeds 1,000 lbs. Consult your owner's manual for further towing information.

²All tank capacities are estimated based upon calculations provided by the tank manufacturers and represent approximate capacities. The actual "usable capacity" may be greater or less than the estimated capacities based upon fabrication and installation of the tanks.

³Actual filled LP capacity is 80% of listing due to safety shut-off required on tank.

The actual overall length of the recreational vehicle may differ from that indicated in the brochure due to variances in the manufacturing process and/or installed components. The actual length may be greater or less than that indicated. Due to the large variety of options and floorplan arrangements available to our customers, actual weights for each unit can differ significantly. Monaco provides a weight sticker on each unit we produce which includes that unit's tank capacities and approximate weight. Consult your local Monaco dealer for unit availability and further information. The information printed in this brochure reflects product design, fabrication, and component parts at the date of printing. The manufacturer reserves the right, at any time, to make changes in product design or material or component specifications as its sole option, without

notice. This includes the substitution of components of a different brand or trade name which will result in comparable performance. All information printed in this brochure is subject to change after the date of printing. Some features shown or mentioned in this brochure are optional and may only be available in selected floorplans. Photographs may depict a floorplan option that has been discontinued or is no longer available at the time of your purchase. Photographs may show props or decorations that are not standard equipment. Monaco, the Monaco logo and its design, are registered trademarks. Other products and company names are trademarks and/or registered trademarks of their respective holders. While the color of the motorhome's exterior and the interior fabrics depicted in this sales brochure are fair and reasonable depictions,

the colors depicted may not be an exact match of the actual colors because of the variances in photo-processing and printing. Due to product improvements, changes during the model year and/or transcription errors that may occur, information represented within this brochure may not be accurate at the time of your purchase. If certain information is significant to your purchasing decision, please confirm the information with your dealer. Component part and appliance manufacturers issue limited warranties covering portions of the recreational vehicle not covered under the Limited Warranties issued by Monaco RV, LLC. To learn specific details regarding warranty coverage, please contact your selling dealership or review the warranty packet inside the recreational vehicle.

BODY CONSTRUCTION

- Laminated Sidewall Construction
- Smooth Gel Coat Fiberglass Exterior Walls
- Front Molded Fiberglass Caps
- Panaview™ 1-Piece Front Windshield
- Large Chrome Front Grille
- Rear Cap with Large Automotive Style Taillights
- Interior Height 84"
- One-Piece Interior Engine Cover
- Metal Fuel Door with Lock

- Chrome Exterior Mirrors w/ Power Control Head and Heat
- One-Piece Polyethylene Pass-Through Storage Compartment
- Side-Hinged Baggage Doors, All Door Locations
- 4-Color Full-Body Paint with New Graphics
- Awning with Metal Covers
- Undercoating

OPTIONS

- Film Front Protection Mask
- Standard Run Savings Package: Film Front Protection Mask, Kitchen Powered Attic Fan w/ Wall Control of Automatic Dome and Fan Power, 3-Camera Rear Vision System, Central Vacuum System, Front Living Room DVD Player, RV Sani-Con 2 System, 12V Heater in Wet Bay

Due to continuous product improvement, please visit www.monacocoach.com for the latest in standards and options, specifications, and technical data.

		Weight Ratings (Lbs.)				Measurements					Tank Capacity (Gal.) ²						
		Gross Vehicle	Gross Combined ¹	Front Gross Axle	Rear Gross Axle	Wheelbase	Overall Length	Overall Height (with A/C)	Interior Height	Interior Width	Exterior Width	Water Heater	Gray Tank	Black Tank	Fresh Tank	LP Tank ³	Fuel Tank
30SFS	FORD 20,500 LB. CHASSIS	20,500	25,500	7,500	13,500	190"	31'	12' 6"	84"	96"	100.5"	10	54	45	80	20	75
	WORKHORSE 20,700 LB. CHASSIS	20,700	25,700	7,500	13,500	190"	31'	12' 6"	84"	96"	100.5"	10	54	45	80	20	75
33SFS	WORKHORSE 22,000 LB. CHASSIS	22,000	26,000	8,000	14,500	228"	34' 3"	12' 9"	84"	96"	100.5"	10	54	45	80	20	75
33SDD	FORD 22,000 LB. CHASSIS	22,000	26,000	7,500	14,500	208"	34' 3"	12' 9"	84"	96"	100.5"	10	57	40	80	21	75
	WORKHORSE 22,000 LB. CHASSIS	22,000	26,000	8,000	14,500	208"	34' 3"	12' 9"	84"	96"	100.5"	10	57	40	80	21	75
34SBD	FORD 22,000 LB. CHASSIS	22,000	26,000	7,500	14,500	228"	35' 2"	12' 9"	84"	96"	100.5"	10	55	42	80	20	75
	WORKHORSE 22,000 LB. CHASSIS	22,000	26,000	8,000	14,500	228"	35' 2"	12' 9"	84"	96"	100.5"	10	55	42	80	20	75
35SFD	FORD 22,000 LB. CHASSIS	22,000	26,000	7,500	14,500	228"	36' 1"	12' 9"	84"	96"	100.5"	10	57	42	80	20	75
	WORKHORSE 22,000 LB. CHASSIS	22,000	26,000	8,000	14,500	228"	36' 1"	12' 9"	84"	96"	100.5"	10	57	42	80	20	75

¹Towing capacity is limited by GCWR; your vehicle's towing capacity is the difference between the GCWR and the actual vehicle weight, including all water, fuel, passengers and cargo. Your towed vehicle should be equipped with auxiliary brakes if the weight of the towed vehicle exceeds 1,000 lbs. Consult your owner's manual for further towing information.

²All tank capacities are estimated based upon calculations provided by the tank manufacturers and represent approximate capacities. The actual "usable capacity" may be greater or less than the estimated capacities based upon fabrication and installation of the tanks.

³Actual filled LP capacity is 80% of listing due to safety shut-off required on tank.

The actual overall length of the recreational vehicle may differ from that indicated in the brochure due to variances in the manufacturing process and/or installed components. The actual length may be greater or less than that indicated. Due to the large variety of options and floorplan arrangements available to our customers, actual weights for each unit can differ significantly. Monaco provides a weight sticker on each unit we produce which includes that unit's tank capacities and approximate weight. Consult your local Monaco dealer for unit availability and further information. The information printed in this brochure reflects product design, fabrication, and component parts at the date of printing. The manufacturer reserves the right, at any time, to make changes in product design or material or component specifications as its sole option, without

notice. This includes the substitution of components of a different brand or trade name which will result in comparable performance. All information printed in this brochure is subject to change after the date of printing. Some features shown or mentioned in this brochure are optional and may only be available in selected floorplans. Photographs may depict a floorplan option that has been discontinued or is no longer available at the time of your purchase. Photographs may show props or decorations that are not standard equipment. Monaco, the Monaco logo and its design, are registered trademarks. Other products and company names are trademarks and/or registered trademarks of their respective holders. While the color of the motorhome's exterior and the interior fabrics depicted in this sales brochure are fair and reasonable depictions,

the colors depicted may not be an exact match of the actual colors because of the variances in photo-processing and printing. Due to product improvements, changes during the model year and/or transcription errors that may occur, information represented within this brochure may not be accurate at the time of your purchase. If certain information is significant to your purchasing decision, please confirm the information with your dealer. Component part and appliance manufacturers issue limited warranties covering portions of the recreational vehicle not covered under the Limited Warranties issued by Monaco RV, LLC. To learn specific details regarding warranty coverage, please contact your selling dealership or review the warranty packet inside the recreational vehicle.

BODY CONSTRUCTION

- › Laminated Sidewall Construction
- › Smooth Gel Coat Fiberglass Exterior Walls
- › Front Molded Fiberglass Caps
- › Panaview™ 1-Piece Front Windshield
- › Large Chrome Front Grille
- › Rear Cap with Large Automotive Style Taillights
- › Interior Height 84"
- › One-Piece Interior Engine Cover
- › Metal Fuel Door with Lock
- › Chrome Exterior Mirrors w/ Power Control Head and Heat
- › One-Piece Polyethylene Pass-Through Storage Compartment
- › Side-Hinged Baggage Doors, All Door Locations
- › 4-Color Full-Body Paint with New Graphics
- › Awning with Metal Covers
- › Undercoating

OPTIONS

- › Film Front Protection Mask
- › Standard Run Savings Package: Film Front Protection Mask, Kitchen Powered Attic Fan w/ Wall Control of Automatic Dome and Fan Power, 3-Camera Rear Vision System, Central Vacuum System, Front Living Room DVD Player, RV Sani-Con 2 System, 12V Heater in Wet Bay

FORD 20,500 LB. CHASSIS/ENGINE/SUSPENSION (30SF5)

- › 6.8L 3-Valve V-10 Gasoline Engine with Electronic Fuel Injection
- › Engine Displacement: 6.8 Liters 415 Cu. In.
- › Power: 362 HP; Torque: 457 lbs./ft. Max. Net
- › TorqShift 5-Speed Automatic Overdrive Transmission with Tow/Haul Mode
- › Transmission Oil Temperature Gauge
- › Fuel Tank Capacity 75 Gallon
- › 130 Amp Alternator
- › Rear Axle Ratio: 5.38:1
- › Stainless Steel Wheel Liners
- › Leaf Spring Suspension
- › Front and Rear Disc, 4-Wheel Anti-Lock Brakes
- › Heavy-Duty Front Track Bar with Shock Absorbers
- › Fully Automatic Hydraulic Leveling System
- › Rewire for Supplemental Braking System
- › 5,000 lb. Hitch Receiver with Dual Connector 4-Pin or 7-Pin
- › SmartStructure II

WORKHORSE 20,700 LB. CHASSIS/ENGINE/SUSPENSION (30SF5)

- › 8.1L V-8 Gasoline Engine with Electronic Fuel Injection
- › Engine Displacement: 8.1 Liters 496 Cu. In.
- › Power: 340 HP; Torque: 455 lbs./ft. Max. Net
- › 6-Speed Automatic Transmission with Overdrive
- › Fuel Tank Capacity 75 Gallon
- › 145 Amp Alternator
- › Rear Axle Ratio: 5.13:1
- › Stainless Steel Wheel Liners
- › Leaf Spring Suspension
- › ABS Brake System
- › Fully Automatic Hydraulic Leveling System with Aluminum Legs
- › Rewire for Supplemental Braking System
- › 5,000 lb. Hitch Receiver with Dual Connector 4-Pin or 7-Pin
- › SmartStructure II

FORD 22,000 LB. CHASSIS/ENGINE/SUSPENSION (33SDD, 34SBD, 355FD)

- › 6.8L 3-Valve V-10 Gasoline Engine with Electronic Fuel Injection
- › Engine Displacement: 6.8 Liters 415 Cu. In.
- › Power: 362 HP; Torque: 457 lbs./ft. Max. Net
- › TorqShift 5-Speed Automatic Overdrive Transmission with Tow/Haul Mode
- › Transmission Oil Temperature Gauge
- › Fuel Tank Capacity 75 Gallon
- › 130 Amp Alternator
- › Rear Axle Ratio 5.38:1
- › Wheel/Rims Polished Aluminum Wheels
- › Leaf Spring Suspension
- › Front and Rear Disc, 4-Wheel Anti-Lock Brakes
- › Heavy-Duty Front Track Bar with Shock Absorbers
- › Fully Automatic Hydraulic Leveling System with Aluminum Legs
- › Rewire for Supplemental Braking System
- › 5,000 lb. Hitch Receiver with Dual Connector 4-Pin or 7-Pin
- › SmartStructure II

WORKHORSE 22,000 LB. CHASSIS/ENGINE/SUSPENSION (33SF5, 33SDD, 34SBD, 355FD)

- › 8.1L V-8 Gasoline Engine with Electronic Fuel Injection
- › Engine Displacement: 8.1 Liters 496 Cu. In.
- › Power: 340 HP; Torque: 455 lbs./ft. Max. Net
- › 6-Speed Automatic Transmission with Overdrive
- › Fuel Tank Capacity 75 Gallon
- › 145 Amp Alternator
- › Rear Axle Ratio: 5.86:1
- › Aluminum Wheels
- › Leaf Spring Suspension
- › ABS Brake System
- › Fully Automatic Hydraulic Leveling System with Aluminum Legs
- › Rewire for Supplemental Braking System
- › 5,000 lb. Hitch Receiver with Dual Connector 4-Pin or 7-Pin
- › SmartStructure II

COCKPIT

- › Fiberglass Automotive Dash with Vinyl Covering, Silver Graphite Metallic Instrument Panel
- › In-Dash AM/FM/CD Stereo Radio with Sirius-Ready Compatibility, Aux-in-Conn, SD Card Slot and Weather Band
- › Front Power Sunvisors
- › Rear Vision System Prep
- › Leatherette Pilot and Co-Pilot Cockpit Recliner Seats
- › 6-Way Power Pilot Seat
- › Carpeted Driver and Passenger Floor Mats

OPTIONS

- › GPS Navigation System
- › Sirius Satellite Radio Tuner with Antenna
- › LCD Single Camera Rear Vision System
- › LCD 3-Camera Rear Vision System with Cameras in Exterior Mirrors
- › Interior Solar Privacy Sunscreens
- › Driver-Side Door with Electric Window

FORD 20,500 LB. CHASSIS/ENGINE/SUSPENSION (30SFS)

- › 6.8L 3-Valve V-10 Gasoline Engine with Electronic Fuel Injection
- › Engine Displacement: 6.8 Liters 415 Cu. In.
- › Power: 362 HP; Torque: 457 lbs./ft. Max. Net
- › TorqShift 5-Speed Automatic Overdrive Transmission with Tow/Haul Mode
- › Transmission Oil Temperature Gauge
- › Fuel Tank Capacity 75 Gallon
- › 130 Amp Alternator
- › Rear Axle Ratio: 5.38:1
- › Stainless Steel Wheel Liners
- › Leaf Spring Suspension
- › Front and Rear Disc, 4-Wheel Anti-Lock Brakes
- › Heavy-Duty Front Track Bar with Shock Absorbers
- › Fully Automatic Hydraulic Leveling System
- › Prewire for Supplemental Braking System
- › 5,000 lb. Hitch Receiver with Dual Connector 4-Pin or 7-Pin
- › SmartStructure II

WORKHORSE 20,700 LB. CHASSIS/ENGINE/SUSPENSION (30SFS)

- › 8.1L V-8 Gasoline Engine with Electronic Fuel Injection
- › Engine Displacement: 8.1 Liters 496 Cu. In.
- › Power: 340 HP; Torque: 455 lbs./ft. Max. Net
- › 6-Speed Automatic Transmission with Overdrive
- › Fuel Tank Capacity 75 Gallon
- › 145 Amp Alternator
- › Rear Axle Ratio: 5.13:1
- › Stainless Steel Wheel Liners
- › Leaf Spring Suspension
- › ABS Brake System
- › Fully Automatic Hydraulic Leveling System with Aluminum Legs
- › Prewire for Supplemental Braking System
- › 5,000 lb. Hitch Receiver with Dual Connector 4-Pin or 7-Pin
- › SmartStructure II

FORD 22,000 LB. CHASSIS/ENGINE/SUSPENSION (33SDD, 34SBD, 35SFD)

- › 6.8L 3-Valve V-10 Gasoline Engine with Electronic Fuel Injection
- › Engine Displacement: 6.8 Liters 415 Cu. In.
- › Power: 362 HP; Torque: 457 lbs./ft. Max. Net
- › TorqShift 5-Speed Automatic Overdrive Transmission with Tow/Haul Mode
- › Transmission Oil Temperature Gauge
- › Fuel Tank Capacity 75 Gallon
- › 130 Amp Alternator
- › Rear Axle Ratio 5.38:1
- › Wheel/Rims Polished Aluminum Wheels
- › Leaf Spring Suspension
- › Front and Rear Disc, 4-Wheel Anti-Lock Brakes
- › Heavy-Duty Front Track Bar with Shock Absorbers
- › Fully Automatic Hydraulic Leveling System with Aluminum Legs
- › Prewire for Supplemental Braking System
- › 5,000 lb. Hitch Receiver with Dual Connector 4-Pin or 7-Pin
- › SmartStructure II

WORKHORSE 22,000 LB. CHASSIS/ENGINE/SUSPENSION (33SFS, 33SDD, 34SBD, 35SFD)

- › 8.1L V-8 Gasoline Engine with Electronic Fuel Injection
- › Engine Displacement: 8.1 Liters 496 Cu. In.
- › Power: 340 HP; Torque: 455 lbs./ft. Max. Net
- › 6-Speed Automatic Transmission with Overdrive
- › Fuel Tank Capacity 75 Gallon
- › 145 Amp Alternator
- › Rear Axle Ratio: 5.86:1
- › Aluminum Wheels
- › Leaf Spring Suspension
- › ABS Brake System
- › Fully Automatic Hydraulic Leveling System with Aluminum Legs
- › Prewire for Supplemental Braking System
- › 5,000 lb. Hitch Receiver with Dual Connector 4-Pin or 7-Pin
- › SmartStructure II

COCKPIT

- › Fiberglass Automotive Dash with Vinyl Covering, Silver Graphite Metallic Instrument Panel
- › In-Dash AM/FM/CD Stereo Radio with Sirius-Ready Compatibility, Aux-in-Conn, SD Card Slot and Weather Band
- › Front Power Sunvisors
- › Rear Vision System Prep
- › Leatherette Pilot and Co-Pilot Cockpit Recliner Seats
- › 6-Way Power Pilot Seat
- › Carpeted Driver and Passenger Floor Mats

OPTIONS

- › GPS Navigation System
- › Sirius Satellite Radio Tuner with Antenna
- › LCD Single Camera Rear Vision System
- › LCD 3-Camera Rear Vision System with Cameras in Exterior Mirrors
- › Interior Solar Privacy Sunscreens
- › Driver-Side Door with Electric Window

APPLIANCES AND ACCESSORIES

- Large Double-Door Refrigerator
- High-Output 3-Burner Cooktop without Oven
- Bi-Fold Range Cover
- Spacesaver Convection Microwave with Touch Control
- 26" LCD Stereo TV with Remote Control in Cockpit Overhead (N/A 33SDD, 34SBD)
- 32" LCD TV with Remote Control on Living Room Wall (33SDD, 34SBD)
- 19" Bedroom Widescreen LCD TV
- Curbside: Exterior Hookups for DSS Dish, Cable, 110V Outlet, Hatch Door to Exterior
- Digital Satellite System Prep
- Curbside: Exterior Gas Line Hookup Prep for LP Accessories

OPTIONS

- Large Double-Door Refrigerator with Ice Maker 10 Cu. Ft.
- Large Four-Door Refrigerator with Ice Maker (N/A with Pantry) (N/A 30SFS, 33SFS)
- High-Output Three-Burner Range with Oven
- Washer/Dryer Prep (34SBD Only)
- Combination Washer/Dryer (Requires Washer/Dryer Prep) (34SBD Only)
- Central Vacuum System
- Front Living Room DVD Player
- Bedroom DVD Player
- 26" Exterior Storage Bay Pull-Out TV with Stereo, CD, DVD and Subwoofer

INTERIOR

- Hardwood Cabinetry in Newport Cherry II
- Raised Panel Cabinet Doors
- Hardwood Raised Panel Refrigerator Doors
- Wallpaper Border Kitchen and Bath
- Heavy-Duty Ball-Bearing Drawer Guides
- Wood Cabinet Drawer Boxes
- Solid Surface Kitchen Countertop, with Solid Surface Edge Treatment and Backsplash
- Kitchen Countertop Extension with Two Drawers below and 110V Outlet (34SBD)
- Kitchen Countertop Extension w/ 2 Drawers and 110V Outlet Below (34SBD Only)
- Kitchen Countertop Extension (30SFS, 33SDD)
- All Other Countertops (except Kitchen) Laminated with Wood Grain Rubber Edge Treatments
- Kitchen Pantry Next to Refrigerator with Full-Height Wire Roll-Out Storage (N/A with Four-Door Refrigerator Option) (N/A 30SFS)
- Carpeting with Pad in Living Area and Bedroom
- Soft Touch Padded Vinyl Ceiling
- Wood Grain Crown Molding in Bedroom and Living Area
- Wood Slide-Out Fascia with Wood Inserts
- Satin Nickel Cabinetry Hardware and Bath Accessories
- Hardwood Framed Pocket Doors with Flat Panel Insert, Slide-Bolt Door Latch (N/A 33SDD, 35SFD)
- Blackout Day/Night Pleated Shades in Living Area and in Bedroom

OPTIONS

- New Décors: Urban Loft III, Autumn Trail IV and Vintage Gold

FURNITURE

- Queen Bed with Nightstands (60" X 74" - 30SFS, 33SFS, 34SBD) (60" X 80" - 33SDD, 35SFD)
- Arched Back Wood Booth Dinette with Side-Sliding Dinette Tabletop (33SDD, 34SBD)
- Freestanding Dinette with Two Freestanding Chairs and Two Folding Chairs (30SFS, 33SFS, 35SFD)
- Roadside: Fabric Hide-A-Bed Sofa with Air Mattress
- Curbside: Fabric Love Seat Sofa (35SFD)
- Leatherette Swivel-Rocker Barrel Chair (33SFS, 34SBD)

OPTIONS

- Roadside: Leatherette Hide-A-Bed Sofa with Air Mattress
- Roadside: Leatherette Ensemble Booth Dinette Includes Leatherette Hide-A-Bed Sofa Selection with Air Mattress (Forward-Facing Seatbelts at Booth Dinette Location N/A with This Option) (33SDD, 34SBD)
- Curbside: Leatherette Love Seat Sofa In Place of Fabric Love Seat Sofa (35SFD)
- Curbside: One Leatherette Euro-Recliner with Ottoman and Wall-Mounted Table in Place of Sofa (35SFD)
- Narrow Arched Back Booth with Side Slide Dinette Tabletop (30SFS, 33SFS, 35SFD)
- Curbside: Leatherette Swivel Recliner in Place of Swivel Rocker Barrel Chair (33SFS, 34SBD)
- Curbside: Leatherette Euro-Recliner with Ottoman in Place of Leatherette Swivel Rocker Barrel Chair (33SFS, 34SBD)
- King Bed with King Bed Headboard and Bedspread (33SDD Only)
- Hallway Bunks with Two Fold-Down DVD Players with Game Hookups and Lights at Each Bunk Location, Two Wireless Headphones and Bunk Ladder Included (34SBD Only)
- Freestanding Dinette with Two Freestanding Chairs and Two Folding Chairs (33SDD, 34SBD)

APPLIANCES AND ACCESSORIES

- › Large Double-Door Refrigerator
- › High-Output 3-Burner Cooktop without Oven
- › Bi-Fold Range Cover
- › Spacesaver Convection Microwave with Touch Control
- › 26" LCD Stereo TV with Remote Control in Cockpit Overhead (N/A 33SDD, 34SBD)
- › 32" LCD TV with Remote Control on Living Room Wall (33SDD, 34SBD)
- › 19" Bedroom Widescreen LCD TV
- › Curbside: Exterior Hookups for DSS Dish, Cable, 110V Outlet, Hatch Door to Exterior
- › Digital Satellite System Prep
- › Curbside: Exterior Gas Line Hookup Prep for LP Accessories

OPTIONS

- › Large Double-Door Refrigerator with Ice Maker 10 Cu. Ft.
- › Large Four-Door Refrigerator with Ice Maker (N/A with Pantry) (N/A 30SFS, 33SFS)
- › High-Output Three-Burner Range with Oven
- › Washer/Dryer Prep (34SBD Only)
- › Combination Washer/Dryer (Requires Washer/Dryer Prep) (34SBD Only)
- › Central Vacuum System
- › Front Living Room DVD Player
- › Bedroom DVD Player
- › 26" Exterior Storage Bay Pull-Out TV with Stereo, CD, DVD and Subwoofer

INTERIOR

- › Hardwood Cabinetry in Newport Cherry II
- › Raised Panel Cabinet Doors
- › Hardwood Raised Panel Refrigerator Doors
- › Wallpaper Border Kitchen and Bath
- › Heavy-Duty Ball-Bearing Drawer Guides
- › Wood Cabinet Drawer Boxes
- › Solid Surface Kitchen Countertop, with Solid Surface Edge Treatment and Backsplash
- › Kitchen Countertop Extension with Two Drawers below and 110V Outlet (34SBD)
- › Kitchen Countertop Extension w/ 2 Drawers and 110V Outlet Below (34SBD Only)
- › Kitchen Countertop Extension (30SFS, 33SDD)
- › All Other Countertops (except Kitchen) Laminated with Wood Grain Rubber Edge Treatments
- › Kitchen Pantry Next to Refrigerator with Full-Height Wire Roll-Out Storage (N/A with Four-Door Refrigerator Option) (N/A 30SFS)
- › Carpeting with Pad in Living Area and Bedroom
- › Soft Touch Padded Vinyl Ceiling
- › Wood Grain Crown Molding in Bedroom and Living Area
- › Wood Slide-Out Fascia with Wood Inserts
- › Satin Nickel Cabinetry Hardware and Bath Accessories
- › Hardwood Framed Pocket Doors with Flat Panel Insert, Slide-Bolt Door Latch (N/A 33SDD, 35SFD)
- › Blackout Day/Night Pleated Shades in Living Area and in Bedroom

OPTIONS

- › New Décors: Urban Loft III, Autumn Trail IV and Vintage Gold

FURNITURE

- › Queen Bed with Nightstands (60" X 74" – 30SFS, 33SFS, 34SBD) (60" X 80" – 33SDD, 35SFD)
- › Arched Back Wood Booth Dinette with Side-Sliding Dinette Tabletop (33SDD, 34SBD)
- › Freestanding Dinette with Two Freestanding Chairs and Two Folding Chairs (30SFS, 33SFS, 35SFD)
- › Roadside: Fabric Hide-A-Bed Sofa with Air Mattress
- › Curbside: Fabric Love Seat Sofa (35SFD)
- › Leatherette Swivel-Rocker Barrel Chair (33SFS, 34SBD)

OPTIONS

- › Roadside: Leatherette Hide-A-Bed Sofa with Air Mattress
- › Roadside: Leatherette Ensemble Booth Dinette Includes Leatherette Hide-A-Bed Sofa Selection with Air Mattress (Forward-Facing Seatbelts at Booth Dinette Location N/A with This Option) (33SDD, 34SBD)
- › Curbside: Leatherette Love Seat Sofa In Place of Fabric Love Seat Sofa (35SFD)
- › Curbside: One Leatherette Euro-Recliner with Ottoman and Wall-Mounted Table in Place of Sofa (35SFD)
- › Narrow Arched Back Booth with Side Slide Dinette Tabletop (30SFS, 33SFS, 35SFD)
- › Curbside: Leatherette Swivel Recliner in Place of Swivel Rocker Barrel Chair (33SFS, 34SBD)
- › Curbside: Leatherette Euro-Recliner with Ottoman in Place of Leatherette Swivel Rocker Barrel Chair (33SFS, 34SBD)
- › King Bed with King Bed Headboard and Bedspread (33SDD Only)
- › Hallway Bunks with Two Fold-Down DVD Players with Game Hookups and Lights at Each Bunk Location, Two Wireless Headphones and Bunk Ladder Included (34SBD Only)
- › Freestanding Dinette with Two Freestanding Chairs and Two Folding Chairs (33SDD, 34SBD)

ELECTRICAL SYSTEMS AND LIGHTS

- 30 Amp 120V Distribution Panel and Cord (30SFS)
- 50 Amp 120V Distribution Panel and Cord (N/A 30SFS)
- 60 Amp Electronic 12V Power Converter
- Onan® 4.0 kW Generator (30SFS)
- Onan® 5.5 kW Gas Generator (33SFS, 33SDD, 34SBD, 35SFD)
- Two 6V House Batteries
- Battery Disconnect Switches
- Exterior Power Entry Step with Light
- Water Pump Switch in Service Bay Area and Convenience Center
- Lights in Outside Storage Compartments
- Underhood Utility Light
- Recessed Ceiling Map Light Above Each Cockpit Seat
- Hallway Convenience Center
- Decorative Satin Nickel Lighting: Living Room Wall Light, Dinette Overhead Light, and Bath Vanity Light

OPTIONS

- 50 Amp Energy Management System (N/A 30SFS)
- 600 Watt Inverter (N/A 30SFS)

PLUMBING AND LP SYSTEMS

- Two-Hole Hi-Rise Kitchen Faucet with Soap Dispenser
- Central Water Filtration System
- Stainless Steel Bath Lavatory Bowl
- Satin Nickel Bath Lavatory Faucet
- Demand Water System and Water Pump
- 10-Gallon LP Gas/Electric Water Heater with Electronic Ignition
- Winterization Valving System
- Water Heater Bypass Valve
- China Toilet with Sprayer
- Holding Tank Rinsing System
- Insulated Systems Compartment with Easy Access to Hookup
- Shower Inside Wet Bay with Hot/Cold Water, Shower Head with Shut-Off
- Gravity and Pressurized Water Fill (N/A 35SFD)
- Contained Storage Area for Sewer Hose
- Shower Faucet with Hose and Head with Shut-Off

OPTIONS

- RV Sani-Con 2 System
- Bathtub Option in Place of Shower

HEATING, VENTS AND AIR CONDITIONING

- Dual 13.5M BTU Air Conditioners with Ducted Air (N/A 30SFS)
- Single 13.5M BTU Air Conditioner with Ducted Air (30SFS)
- 31M BTU Electronic Ignition Furnace (30SFS Only)
- 35M BTU Electronic Ignition Furnace (33SFS, 33SDD, 34SBD, 35SFD)
- New Electronic Dash AC/Heat Climate Control System
- Kitchen 12v Roof Vent
- Bath 12v Roof Vent

OPTIONS

- Dual 15M BTU Air Conditioners with Heat Pumps in Place of 13.5 (N/A 30SFS)
- Single 15M BTU Air Conditioner with Heat Pump in Place of 13.5 (30SFS)
- Kitchen Powered Attic Fan with Wall Control of Automatic Dome and Fan Power
- Bath Powered Attic Fan with Wall Control of Automatic Dome and Fan Power
- 12V Heater in Wet Bay, Heat Pad on Fresh Tank

WINDOWS, DOORS AND AWNINGS

- Radius Flush-Mounted Dual Pane Windows (Safety Glass, Dark Tinted)
- Rear Wall Bedroom Window (33SDD, 34SBD, 35SFD)
- Bathroom Window (35SFD Only)
- 30" Wide Radius Entrance Door with Clear Glass, Roller Shade, Screen Door and Anti-Skid Steps
- Patio Awning with Metal Cover
- Topper Slide-Out Awnings in Living Area and Bedroom
- Protecta Glaze Tinted Plexiglas® Skylight in Bathroom
- Awning Rail

OPTIONS

- Eclipse Poly-Weave Automatic Patio Awning with Metal Cover
- Poly-Weave Window Awnings Living Area Slide-Out House Windows
- Poly-Weave Side Window Awning Bedroom (N/A 34SBD, 35SFD)

SAFETY

- Fire Extinguisher
- Deadbolt Lock on Entrance Door
- 120V GFI Protected Circuit, Kitchen, Bath and Exterior
- LP Gas Detector
- Smoke Detector
- Carbon Monoxide Detector
- Pilot and Co-Pilot Three-Point Seatbelts
- Third Brake Safety Light
- Egress Window(s)

ELECTRICAL SYSTEMS AND LIGHTS

- › 30 Amp 120V Distribution Panel and Cord (30SFS)
- › 50 Amp 120V Distribution Panel and Cord (N/A 30SFS)
- › 60 Amp Electronic 12V Power Converter
- › Onan® 4.0 kW Generator (30SFS)
- › Onan® 5.5 kW Gas Generator (33SFS, 33SDD, 34SBD, 35SFD)
- › Two 6V House Batteries
- › Battery Disconnect Switches
- › Exterior Power Entry Step with Light
- › Water Pump Switch in Service Bay Area and Convenience Center
- › Lights in Outside Storage Compartments
- › Underhood Utility Light
- › Recessed Ceiling Map Light Above Each Cockpit Seat
- › Hallway Convenience Center
- › Decorative Satin Nickel Lighting: Living Room Wall Light, Dinette Overhead Light, and Bath Vanity Light

OPTIONS

- › 50 Amp Energy Management System (N/A 30SFS)
- › 600 Watt Inverter (N/A 30SFS)

PLUMBING AND LP SYSTEMS

- › Two-Hole Hi-Rise Kitchen Faucet with Soap Dispenser
- › Central Water Filtration System
- › Stainless Steel Bath Lavatory Bowl
- › Satin Nickel Bath Lavatory Faucet
- › Demand Water System and Water Pump
- › 10-Gallon LP Gas/Electric Water Heater with Electronic Ignition
- › Winterization Valving System
- › Water Heater Bypass Valve
- › China Toilet with Sprayer
- › Holding Tank Rinsing System
- › Insulated Systems Compartment with Easy Access to Hookup
- › Shower Inside Wet Bay with Hot/Cold Water, Shower Head with Shut-Off
- › Gravity and Pressurized Water Fill (N/A 35SFD)
- › Contained Storage Area for Sewer Hose
- › Shower Faucet with Hose and Head with Shut-Off

OPTIONS

- › RV Sani-Con 2 System
- › Bathtub Option in Place of Shower

HEATING, VENTS AND AIR CONDITIONING

- › Dual 13.5M BTU Air Conditioners with Ducted Air (N/A 30SFS)
- › Single 13.5M BTU Air Conditioner with Ducted Air (30SFS)
- › 31M BTU Electronic Ignition Furnace (30SFS Only)
- › 35M BTU Electronic Ignition Furnace (33SFS, 33SDD, 34SBD, 35SFD)
- › New Electronic Dash AC/Heat Climate Control System
- › Kitchen 12v Roof Vent
- › Bath 12v Roof Vent

OPTIONS

- › Dual 15M BTU Air Conditioners with Heat Pumps in Place of 13.5 (N/A 30SFS)
- › Single 15M BTU Air Conditioner with Heat Pump in Place of 13.5 (30SFS)
- › Kitchen Powered Attic Fan with Wall Control of Automatic Dome and Fan Power
- › Bath Powered Attic Fan with Wall Control of Automatic Dome and Fan Power
- › 12V Heater in Wet Bay, Heat Pad on Fresh Tank

WINDOWS, DOORS AND AWNINGS

- › Radius Flush-Mounted Dual Pane Windows (Safety Glass, Dark Tinted)
- › Rear Wall Bedroom Window (33SDD, 34SBD, 35SFD)
- › Bathroom Window (35SFD Only)
- › 30" Wide Radius Entrance Door with Clear Glass, Roller Shade, Screen Door and Anti-Skid Steps
- › Patio Awning with Metal Cover
- › Topper Slide-Out Awnings in Living Area and Bedroom
- › Protecta Glaze Tinted Plexiglas® Skylight in Bathroom
- › Awning Rail

OPTIONS

- › Eclipse Poly-Weave Automatic Patio Awning with Metal Cover
- › Poly-Weave Window Awnings Living Area Slide-Out House Windows
- › Poly-Weave Side Window Awning Bedroom (N/A 34SBD, 35SFD)

SAFETY

- › Fire Extinguisher
- › Deadbolt Lock on Entrance Door
- › 120V GFI Protected Circuit, Kitchen, Bath and Exterior
- › LP Gas Detector
- › Smoke Detector
- › Carbon Monoxide Detector
- › Pilot and Co-Pilot Three-Point Seatbelts
- › Third Brake Safety Light
- › Egress Window(s)



MONACO[®]

DRIVING YOUR DREAM.

At Monaco RV it's our goal for all our customers to enjoy their RV experience from the beginning. We have forged strong, reliable relationships with our dealer partners, and we encourage our customers to do the same. We're proud to boast a network of over 350 dealership partners and service centers across North America. We're confident that this relationship will only enhance your RV experience and provide the added peace of mind you desire, so you can focus on the important stuff. After all, we're not just selling a world-class product, we're selling "fun." You can rest assured, Monaco RV will be along for the ride, every mile your RV adventure takes you.

SIGNATURE SERIES



DYNASTY[®]



CAMELOT[®]



DIPLOMAT[®]



CAYMAN[®]



MONARCH[®]



RIPTIDE[®]



MONTCLAIR





MONACO®

DRIVING YOUR DREAM.

At Monaco RV it's our goal for all our customers to enjoy their RV experience from the beginning. We have forged strong, reliable relationships with our dealer partners, and we encourage our customers to do the same. We're proud to boast a network of over 350 dealership partners and service centers across North America. We're confident that this relationship will only enhance your RV experience and provide the added peace of mind you desire, so you can focus on the important stuff. After all, we're not just selling a world-class product, we're selling "fun." You can rest assured, Monaco RV will be along for the ride, every mile your RV adventure takes you.

SIGNATURE SERIES



DYNASTY®



CAMELOT™



DIPLOMAT®



CAYMAN®



MONARCH®



RIPTIDE®



MONTCLAIR

