

adventure, inspired by
AIRSTREAM

ADVANCED ENGINEERING.

UNSURPASSED LUXURY.

Airstream's tradition of extraordinary design and handcrafted quality extends beyond its world-renowned travel trailers. Since 1974, Airstream has produced a premium line of motorhomes, including those chosen by NASA to transport astronauts to its heralded launching pad.

In 1988, Airstream entered the Class "B" marketplace with an unwavering commitment to engineering and luxury. Over twenty years have passed and Airstream remains the gold standard with its newest duo: the all new Chevrolet Avenue and the Mercedes Benz Interstate 3500.

By combining the performance and driving ease of a luxury car with the comfort and convenience of an Airstream, these two touring coaches are custom-tailored for today's adventures.

Engineered luxury by Airstream.



AVENUE

VALUE, PERFORMANCE & COMFORT

The Avenue sets a new standard for touring coaches with its distinctive combination of two classic American brands.

Despite its nimble appearance, the Avenue is built on a powerful Chevrolet 3500 Series Express chassis. Its L96 V8 engine and 6L90 transmission has a towing capacity of nearly 8,000 pounds. It's also the only Class B motorhome that is equipped with side-impact airbags.

In keeping with Airstream's history of handcrafted quality and sophisticated styling, the Avenue, which seats seven, features Ultraleather seating and stainless steel appliances. Swiveling front captain chairs are designed so that meals can be enjoyed at a central table for four.

Equipped with a kitchen, bathroom and lounge area that converts into a bed for two, the Avenue also has a standard 19" flat panel television, a 13,500 BTU air conditioning unit, and 16,000 BTU furnace – all features designed to truly make it a home-away-from-home.



Airstream, Inc.
419 West Pike Street
Jackson Center, OH 45334 USA
937-596-6111
www.airstream.com

adventure, inspired by
AIRSTREAM

AVENUE TECHNICAL SPECIFICATIONS

Chassis	
Specifications	Chevy 3500 Series 155" wheelbase
Engine	6.0 liter Vortec L96 V8 gasoline engine 323 hp/373 lb.-ft. torque
Transmission	6L90 six-speed automatic
Gross Vehicle Weight Rating (lbs.)	9,600
Gross Combined Weight Rating (lbs.)	16,000
Unloaded Vehicle Weight (lbs.)	8,075
Occupant and Cargo Carrying Capacity (lbs.)	1,525
Towing Capacity - draw bar (lbs.)	7,925
Towing Capacity - vertical tongue weight (lbs.)	792
Dimensions and Capacities	
Overall Length	21' 1"
Overall Height (w/ A/C)	9' 1"
Overall Width	6' 7.4"
Interior Height	6'
Interior Width	6'
Sleeping Capacity	2
Seating Capacity	7
Fresh Water (total usable capacity) (gal.)	34
Grey Water Tank Capacity (gal.)	21
Black Water Tank Capacity (gal.)	10
LPG Tank Capacity (gal.)	9.9
Gasoline Fuel Tank Capacity (gal.)	31
Systems	
Air Conditioner w/ wall thermostat (BTU)	13,500
Furnace (BTU)	16,000
Refrigerator (energy efficient compressor style)	3.1 cu. ft. 12 volt / 110 volt
Converter/Inverter	45 amp multi-stage charger 750 watt inverter
Generator	gasoline 2.8 kW Onan®
Auxiliary (coach) Batteries	Two 12 volt deep cycle maintenance free Group 24 AGMs
Shore Power	30 amp/110 volt service w/Energy Management System



▲ Front-to-back interior in Onyx decor



▲ Galley in Light Camel decor



▲ Wet bath

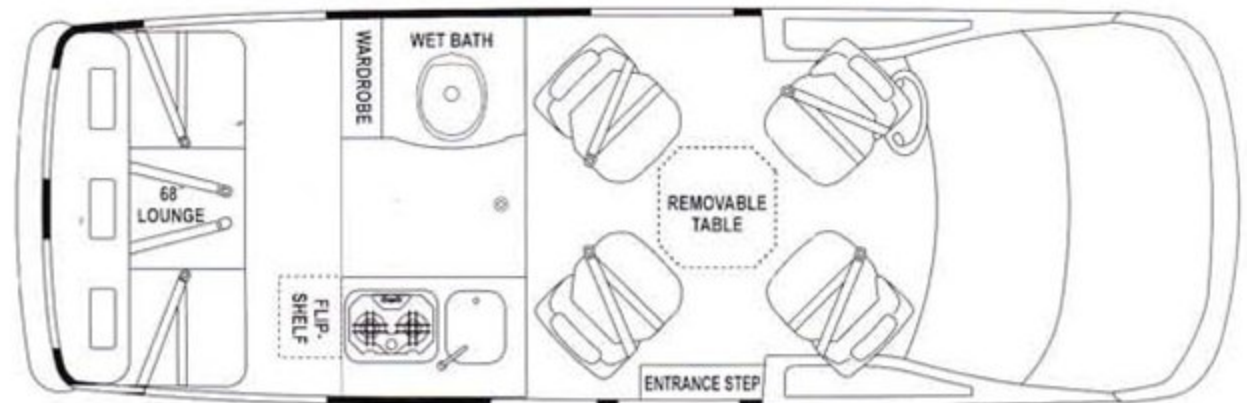

Product information, specifications, and photography in this brochure were as accurate as possible at time of printing. Photographs may contain some features that are optional on your vehicle. Since we continually strive to improve our products, actual products may differ. Prices and specifications are subject to change without notice. All capacities are approximate and dimensions are nominal. Some features or options may be different or unavailable in Canada.

Vehicle Loading - Every effort has been made to provide the greatest number of options for the recreation vehicle owner. Along with these choices comes the responsibility to manage the loads that are imposed by the choices so that they remain within the manufacturer's specified chassis weight limits. Do not overload the recreation vehicle.

Dry Weights - Based on standard features; optional equipment not included. Net carrying capacity (NCC) determined by subtracting unloaded vehicle weight (UVW) from gross vehicle weight (GVWR) and includes fluids, options, and cargo. Liquid capacities and weights are approximations only.

Warning - This information is intended as a guide only. Weights of individual vehicles may vary. Consult your owner's manual for complete loading, weighing, and towing instructions.