

2011 CORNERSTONE



ENTEGR A
COACH®

When top-of-the-line
is your starting point.



CORNERSTONE

ENTEGR A COACH Without compromise.

THE *Bontrager* FAMILY PROMISE

After 40 years of building Jayco, the world's largest privately-owned RV manufacturer, our family is proud to stand behind every Entegra Coach we build with the Bontrager Family Promise. It's a promise to provide unfailing customer service—before, during and after the sale. To learn more, visit us online or see your local Entegra Coach dealership.

Derald L. Bontrager *Wilbur L. Bontrager*

DERALD & WILBUR BONTRAGER
Entegra Coach Founders



Beautifully Powerful.

THE 2011 CORNERSTONE is the benchmark for luxury. Its impeccable allure can't be emulated. Its unbridled power can't be rivaled.

Illustrious touches, like solid granite countertops, Amish-crafted hardwoods and custom-laid porcelain tile floors, elevate the Cornerstone to a class of its own where only it—and you—belong.

And with a Cummins 500 HP engine, exclusivity takes on a whole new meaning, putting you in a power bracket of your own design. With Cornerstone, you rule the road—not the other way around.

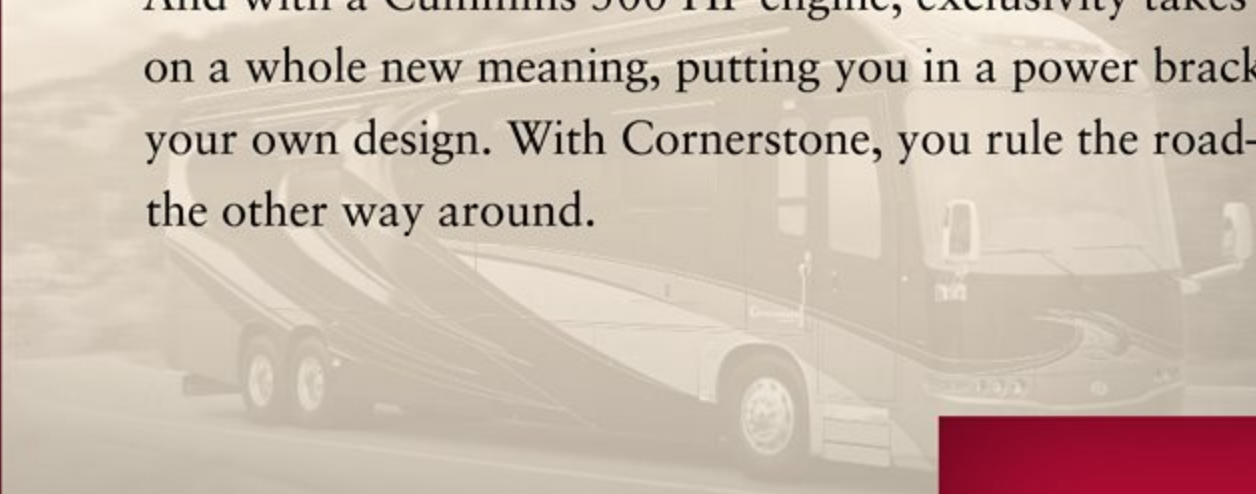

CORNERSTONE®



Cornerstone brandishes timeless style and unrivaled allure with natural leather furniture, a choice of Washington Glazed Maple or Mocha Glazed Maple hardwood cabinetry, a 40-inch LCD HDTV with theatre surround sound and an electric fireplace.

EXPANSIVE LIVING



SPACIOUS

You'll be infatuated with Cornerstone's King Select Comfort air mattress and classic bedspread with pillow shams, while its cedar-lined, mirrored wardrobe closet has ample room for all your garmets.



SOPHISTICATED

Two vessel sinks, sprawling solid granite countertops and heated porcelain flooring create unsurpassable elegance, while Cornerstone's radius shower with beautiful hand-laid porcelain tile and convenient integrated seat give you the luxury you need to unwind.



A



B



C

LUXURY AND FUNCTION

(A) You're always in control thanks to the Multiplex lighting panel, which gives you all-shade control and puts the living area, porch and security lighting right at your fingertips. (B) L.E.D. recessed lighting throughout gives the Cornerstone a warm ambiance. (C) Forget you're in a motor coach with the Fisher/Paykel dishwashing drawer.



Cornerstone's kitchen is a Class A paragon with its 1-inch residential-grade granite countertops, a solid porcelain tile backsplash, high-rise satin nickel dual-lever faucet and Amish handcrafted cabinetry. Stainless-steel Jenn-Air appliances, including a convection microwave and 22 cu. ft. double-door refrigerator, add to Cornerstone's luxurious feel.

REFINED CRAFTSMANSHIP



CONVENIENCE AND RIGIDITY

Carpeted and lighted electric slideout cargo trays provide plenty of storage, while the X-Bridge system keeps Cornerstone from flexing, increasing the construction's overall integrity.



SEAMLESS

The sleek design of the flush-mount slideout is only a small reflection of Cornerstone's well-assembled, seamless design.



ENTERTAINING

Regale your guests with Cornerstone's exterior entertainment system, featuring a 32" LCD HDTV, DVD player and outdoor speakers.



ENGINEERING AND STYLE

(A) A convenient slideout tray gives you easy access to the 12,500-watt Onan diesel generator, (B) while a steel reinforced front cap and windshield frame provide extra strength, delivering added protection when driving. (C) Save money and energy with the Manabloc water distribution system, which delivers hot water up to four times faster.



You'll conquer and command every open road in sheer comfort thanks to Cornerstone's six-way power driver and passenger seats with integrated seat belts, adjustable foot pedals, navigation system and SmartWheel multiplexed steering wheel. An Ultra-Vision one-piece wrap-around windshield ensures a clear view of the journey ahead.

DRIVING COMFORT

CORNERSTONE

Unwavering beauty in a bold design.

From its sleek design to its meticulous full-body paint package, every detail elevates the Cornerstone to the peak of perfection. And thanks to a 15,000-pound towing capacity, you can take the fun with you while driving the most luxurious Class A on the road.







Construction

Cornerstone is built to last with Aluma-Tru Superstructure construction on 16" centers, one-piece molded fiberglass roof and Polar Pack insulation package.

STRENGTH

A structure's foundation should never be compromised, which is why Cornerstone is built on a Spartan K2 tag axle chassis and Entegra Coach's exclusive X-Bridge frame. Ingeniously crafted with strength in mind, Cornerstone's fully integrated design provides superior support and stabilization, plus easy steering and smooth braking for a comfortable, exceptionally safe ride.

POWER

Boasting a Cummins ISM turbocharged 500 horsepower engine with Allison 4000 MH six-speed transmission and electronic shifter, Cornerstone has power to spare, while its muffled Jake brake system provides quieter, more efficient braking.



500 ISM

1. Ultra-Vision one-piece, wrap-around windshield
2. X-Bridge frames engineered into chassis
3. Aluma-Tru Superstructure construction on 16" centers
4. Daytime running lights
5. Premium full-body paint package
6. Extra large basement storage
7. Side-hinged baggage doors
8. Power slideout cargo trays (2)
9. Frameless tinted dual-pane safety-glass windows
10. Flush-mounted slideout rooms

11. Rear-molded fiberglass cap with high mounted integrated air intake
12. Porcelain tile with 4" granite inlays throughout
13. Steel tubular floor joists
14. Wood truss floor risers
15. Floor and underbelly fiberglass and Flexfoil insulation (R-33)
16. 5/8" plywood floor decking
17. 1/2" foam insulation laminated to sidewall
18. Reflective Flexfoil insulation on all 6 sides
19. Sidewall fiberglass and Flexfoil insulation (R-20)
20. Smooth gel-coat fiberglass sidewalls

21. Front molded fiberglass cap
22. Welded crowned aluminum truss rafters 16" on center
23. Roof fiberglass and Flexfoil insulation (R-24)
24. 3/8" plywood roof decking
25. Seamless fiberglass roof
26. (3) 15,000-BTU low-profile roof A/Cs with heat pumps and drain tubes
27. Vinyl padded ceiling
28. Entry door with Sur-Seal air lock
29. Onan 12,500-watt diesel generator on air-powered sliding tray

EXTERIOR GRAPHIC OPTIONS



WHITE DIAMOND PEARL



GOLDEN SPLENDOR

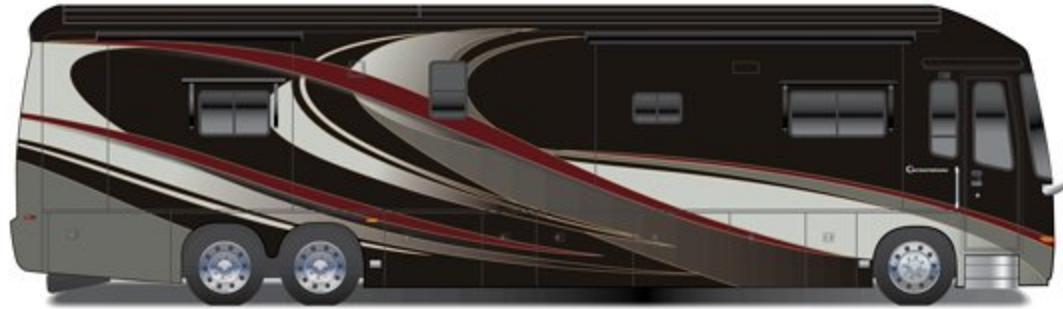

MOLTEN METAL



OPULENCE BLACK CHERRY



OPULENCE GOLDEN SPLENDOR

FABRIC OPTIONS



CAVIAR



CHAMPAGNE



MANHATTAN

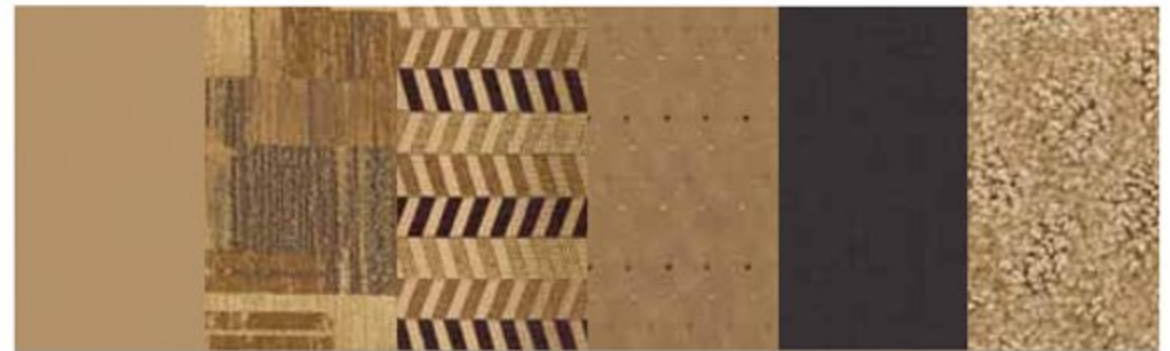

CASHMERE

WOOD



WASHINGTON GLAZED MAPLE



MOCHA GLAZED MAPLE



CARAMEL GLAZED MAPLE*

*Standard bathroom wood for 45DLQ and 45RBQ

THOUGHTFUL DETAIL

We use only the highest quality solid hardwoods (shown here in Mocha Glazed Maple), carefully hand-hewn by Amish craftsmen. From interior doors to slideout fascia, from cabinetry and drawers to crown molding and sconces, all are fashioned by craftsmen who have an eye for beauty and elegance.



FLOORPLANS

WARD = wardrobe MICRO = microwave FRIDGE = refrigerator
 LAV = bathroom sink OHC = overhead cabinets MED = medicine cabinet

CORNERSTONE | 45DLQ

Ext. Length: 45' 1" Ext. Height: 12' 11"



CORNERSTONE | 45RBQ

Ext. Length: 45' 1" Ext. Height: 12' 11"



CORNERSTONE | 45SL

Ext. Length: 45' 1" Ext. Height: 12' 11"

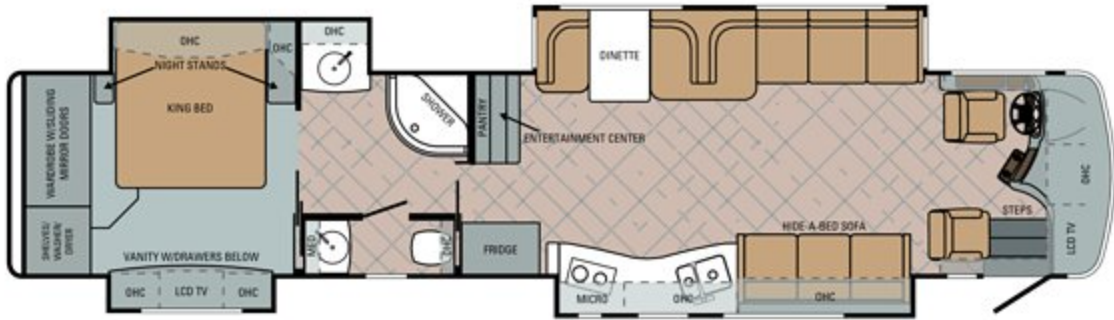

SPECIFICATIONS

FLOORPLAN	GVWR (LBS.)	GCWR (LBS.)	FRONT GAWR (LBS.)	REAR GAWR (LBS.)	TAG AXLE GAWR (LBS.)	WHEEL BASE	OVERALL LENGTH	OVERALL HEIGHT WITH AIR & SATELLITE	EXTERIOR WIDTH	INTERIOR HEADROOM	FRESH WATER CAPACITY (GALS.)	GREY WASTE WATER CAPACITY (GALS.)	BLACK WASTE WATER CAPACITY (GALS.)
45DLQ	46,600	61,600	16,600	20,000	10,000	320"	45' 1"	12' 11"	101"	84"	100	60	60
45RBQ	46,600	61,600	16,600	20,000	10,000	320"	45' 1"	12' 11"	101"	84"	100	60	60
45SL	46,600	61,600	16,600	20,000	10,000	320"	45' 1"	12' 11"	101"	84"	100	60	60

STANDARDS AND OPTIONS

STANDARD BATHROOM EQUIPMENT

2-panel residential-style solid hardwood passage doors
16" x 16" porcelain tile floor with 4" granite inlays
120V G.F.C.I. protected receptacle
Bathroom power vent
Overhead cabinet above stool
Porcelain tile shower with integrated seat
Residential medicine cabinet with mirror
Satin nickel fixtures
Skylight in shower
Solid granite residential-grade countertops
Thetford Aria porcelain stool with push-button flush
Toilet paper holder
Towel holder and ring
Vanity light fixture
Vessel sink(s)
Window in commode area

STANDARD BEDROOM EQUIPMENT

32" LCD HDTV
All-in-one home theater remote
Ceiling mirror feature
Decorative headboard
Halogen satin nickel reading lights
Home theater system, Dolby Digital 5.1 Surround Sound with DVD
In-bed remote secure coach locking system
King Select Comfort air mattress
Large cedar-lined wardrobe
Quilted bedspread with 2 pillow shams

STANDARD KITCHEN EQUIPMENT

16" x 16" porcelain tile floor in kitchen with 4" granite inlays
120V G.F.C.I. protected receptacle
Fisher/Paykel dishwasher drawer
High-rise satin nickel dual-lever faucet
Jenn-Air 1.6-cu. ft. convection microwave oven with carousel
Jenn-Air 22 cu. ft. 2-door residential refrigerator with in-door ice and water dispenser
Jenn-Air flush-mounted, electric 2-burner touch control range
Mini blind
Porcelain tile backsplash with granite inlays
Silverware drawer, divided for utensils
Solid granite residential-grade countertops with undermounted stainless-steel sink
Solid granite sink covers/cutting boards (4)
Under-sink, sink cover storage compartment

DRIVER COMPARTMENT AMENITIES

12V auxiliary in-dash receptacle (2)
16" x 16" porcelain tile in driver compartment with 4" granite inlays
26" digital LCD HDTV
A/C/heater vents by foot pedals
Adjustable foot pedal
Auxiliary start switch
Battery boost switch
CB radio with antenna
Chassis battery disconnect
Color back-up camera and monitor
Color-coordinated carpeted floor mats
Cruise control (SmartWheel controlled)
Fog lights
High-output dash heater and A/C
In-dash compass and exterior temperature gauge
Intermittent windshield wipers, single motor (SmartWheel controlled)

Natural leather power adjustable driver and passenger seats with integrated 3-point, lap and shoulder safety belts
Powered roller side sun visors and privacy shades
Powered stepwell cover with pinch resistance technology
Push button shift control
Side cameras with turn signals
Spartan Message Center with LCD display featuring: odometer, tachometer, instantaneous fuel economy, fuel remaining, outside air temp., coolant temp., engine oil temp. and pressure, transmission temp., turbo boost pressure, air pressure, diagnostic functions, fault codes, service reminders, percentage of engine load, trip meter, speed and voltage
Storage compartment(s) beside passenger seat
Tilt and telescoping steering
Touch control for hydraulic automatic leveling jack system
Touch-screen AM/FM/CD/DVD with GPS navigation and Bluetooth
Trip-Tek Information Center
Ultra-Vision one-piece wrap-around tinted windshield
VIP SmartWheel steering integrated controls for systems
VIP soft-touch, wood-grain, leather-wrapped steering wheel

STANDARD CHASSIS EQUIPMENT

2 chassis batteries
4.33:1 "Quiet-Gear" rear axle ratio
55-degree turning radius
150-gal. fuel tank (dual fill)
200-amp alternator
15,000-lb. hitch with 7-pin plug
Allison GEN 4 4000 MH 6-speed shift pad electronic transmission
All-wheel ABS brakes
Automatic heated moisture ejectors
Automatic Traction Control (ATC)
Bilstein shocks (front/rear)
Cummins ISM turbocharged 500 HP engine 1,550 lb. ft. torque at 1,200 RPM
Daytime running lights
Engine block heater
Full-air front disc and rear drum brakes
Hadley Air Leveling "Smart Air" management system
Hendrickson HTB rear air suspension
Hidden safe
Meritor rear axle 20,000-lbs., tag axle 10,000-lbs.
Michelin 315/80R 22.5" radial tires
Polished aluminum wheels
Pre-wired for supplemental braking system
Raised rail for maximum storage
Remote air fill with air hose
Side-mounted radiator
Spartan K2 tag axle chassis
Tag axle auto weight release
Tuthill IFS 16,600 front axle wide track
Tuthill IFS independent front air suspension
Two-stage Jake brake system

STANDARD CONSTRUCTION FEATURES

5/8" plywood main floor decking
2-3/4" welded tubular-aluminum sidewall construction
2" x 4" floor trusses
3M front protective film mask
4-1/2" arched aluminum truss roof (R-24)
Aluma-Tru Superstructure construction on 16" centers
Cabinetry crafted with screwed hardwood stile construction
Deluxe hidden cabinet hinges
Electric-powered slideouts
Enclosed, insulated and heated floor and underbelly (R-33)

Frameless flush-mounted slideout rooms
Fully decked roof with 3/8" plywood
One-piece fiberglass roof
Polar Pack insulation with reflective Flexfoil floor (R-33), roof (R-24), sidewalls (R-16)
Reli-torq slideout system
Sidewalls bolted to frame
Smooth gel-coat fiberglass exterior walls
Steel-reinforced front cap and windshield frame
X-Bridge frames engineered into chassis

STANDARD EXTERIOR EQUIPMENT

120V G.F.C.I.-protected exterior receptacle
Aerodynamic front cap
Carefree armored power entrance door awning
Carefree armored slideout awnings
CB antenna
Chrome, heated, remote control, side-view mirrors
Docking lights
Door for dump valve access
Driving lamps
Electric-powered, double entrance step
Entry door with Sur-Seal air lock
Exterior 32" LCD HDTV with CD/DVD player and speakers
Frameless tinted dual-pane safety-glass windows
Full-body premium paint package
Full-width rear mudflap
Girard roof-integrated, armored, and powered roof awning
Hadley air horns
Hydraulic automatic leveling jacks (dual positive)
Keyless entry key fob and keypad system
Lighted heavy-duty grab handle
One-piece pass-through storage compartments
Patio light with inside switch
Power bay door locks integrated with key fob and touch pad
Power slideout cargo trays (2)
Rear-molded fiberglass cap with integrated rear intake
Roof ladder
Security lights (2)
Side-hinged baggage doors
Sliding battery tray (2 positions)
Uni-Dock exterior utility center, heated and enclosed with second system monitor panel
Xenon high visibility headlights

STANDARD INTERIOR EQUIPMENT

2-panel residential-style solid hardwood passage doors throughout
16" x 16" heated porcelain tile floor with 4" granite inlays
40" LCD HDTV in living area
Aire-Secure travel locks for all passage doors
All-in-one home theater remote
Ball bearing drawer guides 75-lb. capacity with full-drawer extension
Cable TV hookup with RG6 coax
Ceiling mirror feature
Central vacuum system
Crank-up HDTV antenna with signal booster
Decorative pillows for comfort lounge and hide-a-bed
Decorative satin nickel lighting throughout
Decorative trim package
Electric fireplace
Fabric and wood-covered box valances with lambrequin legs
Hardwood cabinets
Hardwood fascia boards
Home theater system, Dolby Digital 5.1 Surround Sound with DVD

L.E.D. recessed lighting package
Lights at entrance steps
Multiplex lighting
Natural leather booth dinette/comfort lounge sofa ensemble
Natural leather hide-a-bed sofa
Padded vinyl ceiling throughout
Phone jack
Power day/night roller shades throughout
Residential-style trim and molding
Solid hardwood cabinetry and miter-cornered raised-panel doors throughout
Stackable washer and dryer
Winegard in-motion roof-mounted satellite dome (HD-ready)

HEAT, POWER AND WATER EQUIPMENT

5-watt solar panel (for chassis batteries)
12V demand water pump
12V electrical system
50-amp electric service
50-amp quick-connect power cord with electric reel
2,800-watt inverter with 8-6V batteries (2)
15,000-BTU low profile central A/Cs (3) with heat pump, digital thermostat, Chillgrille and drain tubes
Aqua-Hot 450-D water and heating system with in-floor radiant heating throughout
Black holding tank sprayer
Conveniently placed water pump switches
Dual insulated ceiling air ducts with adjustable air vents
Holding and fresh water tanks, radiant-heated
Hookup for city water
Manabloc water system
Onan 12,500-watt diesel generator with auto-changeover on sliding tray
Onan auto generator and temperature start system
Outside shower
Power auto rewind water hose
Surge suppressor
Systems monitor panel
Water heater bypass system
Water purifier with faucet and ice maker
Winterizing kit

STANDARD SAFETY EQUIPMENT

Carbon monoxide alarm
Deadbolt lock on entrance door
Egress window
Fire extinguisher
Hidden safe
Lap safety belts in living area
Propane alarm
Security system
Smoke alarm
Third brake light
Tire pressure monitor system

OPTIONS

60-watt solar panels (2)
Black porcelain toilet (2 in 45RBQ)
Exterior freezer in slideout tray
Free-standing table with 4 chairs and sofa
Glass mat batteries
Waste Master sewer connection

2-YEAR WARRANTY (5-YEAR STRUCTURAL)

Our family is proud to stand behind every Entegra Coach we build. That's why we back our motor coaches with a manufacturer's limited warranty, warranted to the original purchaser for two years (five years structural) from the original date of purchase or 24,000 miles of use, whichever comes first, against defects in materials and workmanship. Our commitment is to provide you with the highest level of products and services possible. We invite you to compare us with other manufacturers—we think you'll find that our passion for your satisfaction is unmatched. For a copy of the limited warranty with full terms and conditions, ask your local Entegra Coach dealer.

3-YEAR PLATINUM-LEVEL ROADSIDE ASSISTANCE

Travel worry-free in your Cornerstone motor coach with the Entegra Coach Customer First Roadside Assistance program, yours at no cost during your first three years of ownership. This program is offered through Coach-Net, the largest RV emergency road service in the country and gives you immediate access to dependable roadside assistance and support services with a simple phone call.

- Free jump starts
- Free tire changes
- Free fuel delivery
- Free lockout service
- Free travelers checks
- Toll-free nationwide service appointment assistance
- 24-hour toll-free emergency message service
- Free custom trip routing and full-color map service
- Free dispatch of on-site mechanical service
- \$2,000 trip-interruption reimbursement
- RV technical assistance hotline
- Free towing to nearest qualified service

YOUR ENTEGRA COACH DEALER



GROSS VEHICLE WEIGHT RATING (GVWR): The maximum permissible weight of the motor coach, including the Unloaded Vehicle Weight (UVW) plus passengers, personal items, all cargo, fluids, options and dealer-installed accessories. The GVWR is equal to or greater than the sum of the UVW and the Cargo Carrying Capacity.

GROSS AXLE WEIGHT RATING (GAWR): The maximum allowable weight each axle assembly is designed to carry, as measured at the tires, therefore including the weight of the axle assembly itself.

GROSS COMBINED WEIGHT RATING (GCWR): The maximum allowable combined weight of the motor coach used as a tow vehicle and the attached towed vehicle.

It is important for your safety and enjoyment that you are aware of the weights and tow ratings of the RV you select. Consult a competent advisor for questions or advice. Whether you are new to RVing or a veteran, get a feel for the performance of your RV before heading out on the roadways. When you tow a vehicle with your RV, you must drive differently than when you drive a single vehicle. Practice hooking up, driving, backing up and braking in a safe environment or seek out professional instruction. Entegra Coach affixes a weight label to each RV which lists weight information for that vehicle. Refer to that label to verify the vehicle will meet your requirements. See specifications chart inside.

See dealer for further information and prices. All information in this brochure is the latest available at the time of publication approval. Entegra Coach reserves the right to make changes and to discontinue models without notice or obligation. Photos in this brochure may show optional equipment and props for photography purposes. RVs built for sale in Canada may differ to conform to Canadian codes. ©2010 Entegra Coach, Inc. 11-CSTN-PL0910-10K Printed in U.S.A.

Entegra Coach, Inc., P.O. Box 460, Middlebury, IN 46540 | www.entegracoach.com



ENTEGR A
COACH®

A reputation for integrity isn't built overnight. It happens only after years of doing what you say you will do—and by practicing the Golden Rule.

Over the last 40 years, the Bontrager family has worked hard to establish a reputation of integrity in the RV business. Through ups and downs, successes and failures, these four decades have taught us the importance of doing our best to meet our customers' expectations. And that is why we are excited to introduce the finest line of RVs we have ever built—the motor coaches from Entegra Coach.

We believe Entegra Coach captures everything we stand for, from its structural quality and old-world craftsmanship, to unmatched customer service. We hope you'll take some time with your local dealer to understand why our family stands so strongly behind Entegra Coach.

Without compromise.