

ROAD WARRIOR

BY HEARTLAND

LOUISVILLE
2009
SPECIAL
PREVIEW
LITERATURE



Look to Road Warrior for an endless variety of payload possibilities.

CHAMPION OF THE ROAD...

ROAD WARRIOR

BY HEARTLAND

LOUISVILLE
2009
SPECIAL
PREVIEW
LITERATURE



**Endless
Possibilities**

Look to Road Warrior for an endless variety of payload possibilities.

CHAMPION OF THE ROAD...

ROAD WARRIOR

BY HEARTLAND



ROAD WARRIOR

BY HEARTLAND









ROAD WARRIOR

BY HEARTLAND

STANDARDS

EXTERIOR

- 12" I-Beam Powder Coated Steel Frame (10" I-Beam 305RW, 281RW)
- 16" Tires Load E Range With Aluminum Rims
- Radius, Mirrored Safety Glass Windows
- Fiberglass Front Cap w/ 88 Degree Turning Radius
- Detachable Ladder
- Manual 20' Awning
- 15k BTU AC With Quick Cool Vents
- 50 Amp service (30 Amp 281RW) With Detachable Cord
- Enclosed and Heated Under Belly
- Scare Lights 1 front DS / 1 rear ODS
- Flood Lights Rear
- Exterior Shower w/Hot & Cold High Pressure Nozzle
- Gen Prep w/Fuel Station & Timer
- Universal Docking Center (All System Hook-Ups Located In One, Convenient, Concealed Compartment)
- Radius, 1" Thick Slam Baggage Doors Keyed Unique to Road Warrior
- Hydraulic Slide-Outs
- One-Piece Walk-On EPDM Roof
- Welded Tubular Aluminum Construction
- Stunning Exterior Graphics
- Triple 6,000 lb. Axles w/Adjustable Shackle (N/A 305, 281) (305RW - Two 7,000 lb. Axles) (281RW - Two 6,000 lb. Axles)
- E-Z Flex Suspension
- Large, Unobstructed Pass-Through Storage With Cargo Tie Downs
- Built-In Diamond Plate Tool Box
- Easy Grip Triple Entry Steps
- Entry Assist Handle
- 30 Gallon Fuel Station With Static Line
- 75 Amp Power Converter (55 Amp Model 281)
- Hi-Flow Water Pump
- Rain Gutters w/Spouts
- Wide Body Design
- Huge 94" Wide Door Opening
- Enclosed Gooseneck
- Dual 30 lb. LP Tanks

INTERIOR

- All Hardware Oiled Bronze including shower door
- Chestnut Maple Cabinetry w/Glazed Doors
- Residential Solid Surface Counter tops
- Microwave
- Three Burner Cook Top with Oven
- 8 cu. Ft. Refer
- Full Length Ball Bearing Drawer Glides
- Three Décors - Sand Dune, Kona, Midnight
- 12 gal Gas/Electric DSI Water Heater
- Power Vent - Kitchen, Bedroom, Bathroom, Loft, Cargo Area
- Night Shades
- Mini Blinds Cargo Area
- Counter Top Extension (305RW)
- Chestnut Maple Head Board
- Residential style Beauflor™ linoleum
- High end residential carpet

12' GARAGE

GVWR: 18,000 lb.
Dry: 12,927 lb.
Hitch: 2,981 lb.
Axles: 3 x 6,000
Length: 40'-10"
Height w/AC: 13'-2"



RW 405

12' GARAGE

GVWR: 18,000 lb.
Dry: 13,272 lb.
Hitch: 3,191 lb.
Axles: 3 x 6,000
Length: 41'-2"
Height w/AC: 13'-2"



RW 395

12' GARAGE

GVWR: 18,000 lb.
Dry: 12,825 lb.
Hitch: 3,050 lb.
Axles: 3 x 6,000
Length: 40'-4"
Height w/AC: 13'-2"



RW 385



ROAD WARRIOR

BY HEARTLAND

STANDARDS

EXTERIOR

- 12" I-Beam Powder Coated Steel Frame (10" I-Beam 305RW, 281RW)
- 16" Tires Load E Range With Aluminum Rims
- Radius, Mirrored Safety Glass Windows
- Fiberglass Front Cap w/ 88 Degree Turning Radius
- Detachable Ladder
- Manual 20' Awning
- 15k BTU AC With Quick Cool Vents
- 50 Amp service (30 Amp 281RW) With Detachable Cord
- Enclosed and Heated Under Belly
- Scare Lights 1 front DS / 1 rear ODS
- Flood Lights Rear
- Exterior Shower w/Hot & Cold High Pressure Nozzle
- Gen Prep w/Fuel Station & Timer
- Universal Docking Center (All System Hook-Ups Located In One, Convenient, Concealed Compartment)
- Radius, 1" Thick Slam Baggage Doors Keyed Unique to Road Warrior
- Hydraulic Slide-Outs
- One-Piece Walk-On EPDM Roof
- Welded Tubular Aluminum Construction
- Stunning Exterior Graphics
- Triple 6,000 lb. Axles w/Adjustable Shackle (N/A 305, 281) (305RW - Two 7,000 lb. Axles) (281RW - Two 6,000 lb. Axles)
- E-Z Flex Suspension
- Large, Unobstructed Pass-Through Storage With Cargo Tie Downs
- Built-In Diamond Plate Tool Box
- Easy Grip Triple Entry Steps
- Entry Assist Handle
- 30 Gallon Fuel Station With Static Line
- 75 Amp Power Converter (55 Amp Model 281)
- Hi-Flow Water Pump
- Rain Gutters w/Spouts
- Wide Body Design
- Huge 94" Wide Door Opening
- Enclosed Gooseneck
- Dual 30 lb. LP Tanks

INTERIOR

- All Hardware Oiled Bronze including shower door
- Chestnut Maple Cabinetry w/Glazed Doors
- Residential Solid Surface Counter tops
- Microwave
- Three Burner Cook Top with Oven
- 8 cu. Ft. Refer
- Full Length Ball Bearing Drawer Glides
- Three Décors - Sand Dune, Kona, Midnight
- 12 gal Gas/Electric DSI Water Heater
- Power Vent - Kitchen, Bedroom, Bathroom, Loft, Cargo Area
- Night Shades
- Mini Blinds Cargo Area
- Counter Top Extension (305RW)
- Chestnut Maple Head Board
- Residential style Beauflor™ linoleum
- High end residential carpet

12' GARAGE

GVWR: 18,000 lb.
Dry: 12,927 lb.
Hitch: 2,981 lb.
Axles: 3 x 6,000
Length: 40'-10"
Height w/AC: 13'-2"



RW 405

12' GARAGE

GVWR: 18,000 lb.
Dry: 13,272 lb.
Hitch: 3,191 lb.
Axles: 3 x 6,000
Length: 41'-2"
Height w/AC: 13'-2"



RW 395

12' GARAGE

GVWR: 18,000 lb.
Dry: 12,825 lb.
Hitch: 3,050 lb.
Axles: 3 x 6,000
Length: 40'-4"
Height w/AC: 13'-2"



RW 385

12' GARAGE



RW 365

GVWR: 18,000 lb.
 Dry: 13,555 lb.
 Hitch: 2,982 lb.
 Axles: 3 x 6,000
 Length: 38'-2"
 Height w/AC: 13'-2"

14' GARAGE

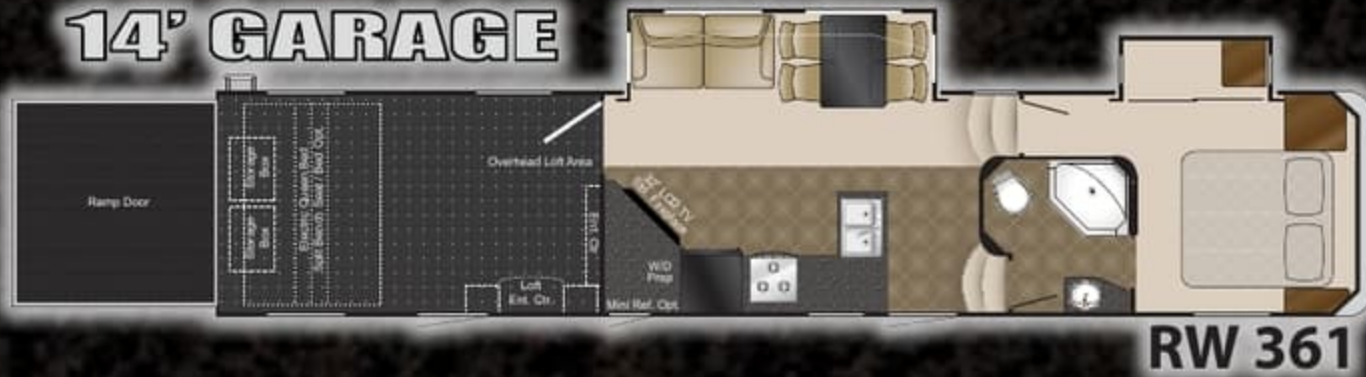

RW 361

GVWR: 18,000 lb.
 Dry: 13,530 lb.
 Hitch: 3,060 lb.
 Axles: 3 x 6,000
 Length: 41'-0"
 Height w/AC: 13'-3"

10' GARAGE



RW 305

GVWR: 14,000 lb.
 Dry: 11,525 lb.
 Hitch: 2,533 lb.
 Axles: 2 x 7,000
 Length: 36'-0"
 Height w/AC: 12'-6"

12' GARAGE



RW 281

GVWR: 14,000 lb.
 Dry: 9,500 lb.
 Hitch: 2,025 lb.
 Axles: 2 x 6,000
 Length: 31'-0"
 Height w/AC: 12'-6"



- Dinette table with pedestal mounts
- Large Pantry (most models)
- Large Cabinet Storage
- Prewired for Cable TV and Satellite
- Custom Control Panel
- Multi-Zone Entertainment System
 - JENSEN™ JenX Ceiling Speakers (4 in living area) (2 in Garage);
 - Two Marine Grade Exterior Speakers; DVD Player with Front A/V Jacks; MP3; MP4; iPod Station; Bass Control; Rear A/V Input;
- 32" Flat Screen TV with Swing Arm (26" in 281RW)
- Air Vent in Loft
- Reading Lights in Loft
- Deluxe Hide-a-Bed Sofa w/Inflatable Air Mattress (N/A 281)

AV EQUIPMENT

- 32" LCD Flat Screen TV
- 12v AM/FM Stereo w/CD/DVD/MP3
- 6 Ceiling Speakers (4 in Living Room / 2 in Garage)
- 2 Exterior speakers

BATH & BED

- Single Level Master Suite
- Residential Neo-Angle Shower With Glass Enclosure
- Separate Commode Room
- Foot Flush Porcelain Commode
- Heat and A/C Vents in Main Bathroom
- Full 60 X 80 Queen Memory Foam Pillowtop Mattress
- Bedroom TV Hookup with Booster
- Huge Front Wardrobe
- Recessed Front Cap Storage in Wardrobe
- Large Vanity Drawers
- Skylight Over Shower
- Power Bath Vent
- Washer Dryer Prep in Front Wardrobe (N/A 385RW, 281RW) (361 RW Washer Dryer Prep in Garage)

GARAGE AREA

- 1" Thick Plywood Garage Floor
- Steel D-Ring Tie Downs
- 3000 lb. Rated Ultra-Light Ramp Door (No Cables)
- 10', 12' and 14' Garage Layouts
- Gen. Prep w/Fuel Station, Timer, and Static Line
- Large 8' Garage Ramp Door (305RW, 281RW - 7' Garage Door Ramp)
- Fantastic Fan With Thermostat
- D-rings Cargo Area & Exterior Basement Storage Floor
- 2,500 lb. Garage Storage Rating
- Two JENSEN™ JenX Ceiling Speakers in Garage

OPTIONS

- Hydraulic Front Landing Gear
- Warrior Graphics Package (Blue and Silver Graphics)
- Onan Generator (5.5 KW) (4.0 in 281RW)
- Onan Generator (5.5 KW Carb Certified) (4.0 in 281RW)
- 20' Power Electric Awning
- Patio Slider Door (Most floor plans)
- Toy Lock
- ABS Hitch Cover
- Central Vacuum
- Fantastic Fan w/Rain Sensor in Kitchen
- Pull Down Rear Screen
- Rear Electric Queen Beds
- Rear Electric Queen Bed w/ Rear Convertible Sofa
- Two recessed beaver tail storage lids
- Electric Rear Jacks

12' GARAGE



GVWR: 18,000 lb.
 Dry: 13,555 lb.
 Hitch: 2,982 lb.
 Axles: 3 x 6,000
 Length: 38'-2"
 Height w/AC: 13'-2"

- Dinette table with pedestal mounts
- Large Pantry (most models)
- Large Cabinet Storage
- Prewired for Cable TV and Satellite
- Custom Control Panel
- Multi-Zone Entertainment System
 - JENSEN™ JenX Ceiling Speakers (4 in living area) (2 in Garage);
 - Two Marine Grade Exterior Speakers; DVD Player with Front A/V Jacks; MP3; MP4; iPod Station; Bass Control; Rear A/V Input;
- 32" Flat Screen TV with Swing Arm (26" in 281RW)
- Air Vent in Loft
- Reading Lights in Loft
- Deluxe Hide-a-Bed Sofa w/Inflatable Air Mattress (N/A 281)

14' GARAGE

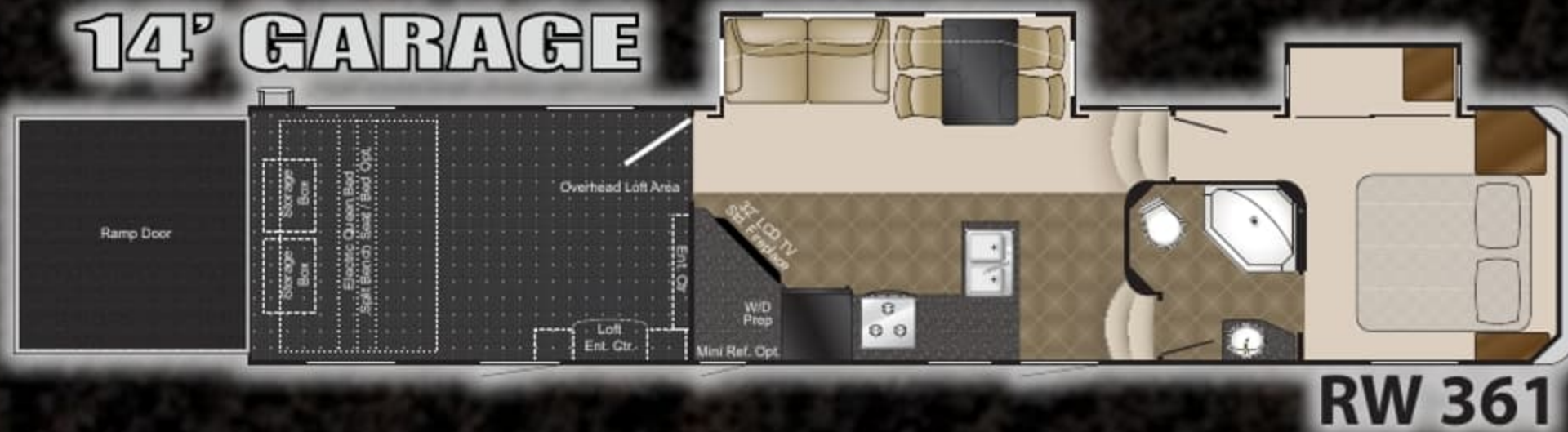

GVWR: 18,000 lb.
 Dry: 13,530 lb.
 Hitch: 3,060 lb.
 Axles: 3 x 6,000
 Length: 41'-0"
 Height w/AC: 13'-3"

AV EQUIPMENT

- 32" LCD Flat Screen TV
- 12v AM/FM Stereo w/CD/DVD/MP3
- 6 Ceiling Speakers (4 in Living Room / 2 in Garage)
- 2 Exterior speakers

BATH & BED

- Single Level Master Suite
- Residential Neo-Angle Shower With Glass Enclosure
- Separate Commode Room
- Foot Flush Porcelain Commode
- Heat and A/C Vents in Main Bathroom
- Full 60 X 80 Queen Memory Foam Pillowtop Mattress
- Bedroom TV Hookup with Booster
- Huge Front Wardrobe
- Recessed Front Cap Storage in Wardrobe
- Large Vanity Drawers
- Skylight Over Shower
- Power Bath Vent
- Washer Dryer Prep in Front Wardrobe (N/A 385RW, 281RW) (361 RW Washer Dryer Prep in Garage)

10' GARAGE



GVWR: 14,000 lb.
 Dry: 11,525 lb.
 Hitch: 2,533 lb.
 Axles: 2 x 7,000
 Length: 36'-0"
 Height w/AC: 12'-6"

GARAGE AREA

- 1" Thick Plywood Garage Floor
- Steel D-Ring Tie Downs
- 3000 lb. Rated Ultra-Light Ramp Door (No Cables)
- 10', 12' and 14' Garage Layouts
- Gen. Prep w/Fuel Station, Timer, and Static Line
- Large 8' Garage Ramp Door (305RW, 281RW - 7' Garage Door Ramp)
- Fantastic Fan With Thermostat
- D-rings Cargo Area & Exterior Basement Storage Floor
- 2,500 lb. Garage Storage Rating
- Two JENSEN™ JenX Ceiling Speakers in Garage

12' GARAGE



GVWR: 14,000 lb.
 Dry: 9,500 lb.
 Hitch: 2,025 lb.
 Axles: 2 x 6,000
 Length: 31'-0"
 Height w/AC: 12'-6"



OPTIONS

- Hydraulic Front Landing Gear
- Warrior Graphics Package (Blue and Silver Graphics)
- Onan Generator (5.5 KW) (4.0 in 281RW)
- Onan Generator (5.5 KW Carb Certified) (4.0 in 281RW)
- 20' Power Electric Awning
- Patio Slider Door (Most floor plans)
- Toy Lock
- ABS Hitch Cover
- Central Vacuum
- Fantastic Fan w/Rain Sensor in Kitchen
- Pull Down Rear Screen
- Rear Electric Queen Beds
- Rear Electric Queen Bed w/ Rear Convertible Sofa
- Two recessed beaver tail storage lids
- Electric Rear Jacks

ROAD WARRIOR

BY HEARTLAND



ROAD WARRIOR

BY HEARTLAND









Heartland Recreational Vehicles
1001 All-Pro Drive • Elkhart, IN 46514 • 574-262-5992

Community. Convenience. Close-to-home.

Where you purchase your recreational vehicle is ultimately your decision but Heartland urges you to consider buying at your local dealer. Dealers are part of your community, providing jobs and contributing to your local economy. These dealers are under obligation to provide warranty service for products they sell, but are not legally required to service products purchased from other dealers. At some point, you may need to return to the dealer you buy from - why not stay close to home? After all, home is where your Heartland is!

BENEFITS OF PURCHASING YOUR RV LOCALLY:

- You enjoy valuable relationship building with Dealer Representatives, close to your home, who will explain the features and benefits of the product.
- You receive a full product orientation prior to delivery, which includes hands-on directions for many of the coach's systems and functions. You are also introduced to the Dealership's Service/Parts/Warranty personnel who are at the ready to help you with any issues you may encounter, now and in the future.
- You enjoy customer PRIORITY. Dealerships generally service their purchasing customers first - others may experience long delays and miss opportunities to use their RV. What is it worth for you to have a dealership's full attention and motivation to satisfy you when you need service - in a timely manner?
- Valuable TAX dollars and jobs stay in YOUR community which pays for your roads, schools, police and fire departments.

DON'T UNDERESTIMATE CUSTOMER SERVICE AND PERSONAL CARE!

For Canadian Residents: If you purchase an RV out-of-country, there are additional fees, taxes and inspections that must be met before bringing your product home. Your local Canadian dealers are experts in these provisions.

Your Authorized Heartland Dealer:

ROAD WARRIOR

BY HEARTLAND

| VENDOR 800# | |
|-------------------------------------|----------------|
| CALL DIRECT FOR DIRECT RESULTS! | |
| TOLL FREE & WARRANTY PHONE NUMBERS: | |
| USA (Toll Free) | 1.800.524.7821 |
| USA (Warranty) | 1.800.544.4881 |
| DOMESTIC (Warranty) | 1.800.544.4881 |
| INTERNATIONAL (Warranty) | 1.800.544.4881 |
| USA (Toll Free) | 1.800.547.2232 |
| USA (Warranty) | 1.800.634.3216 |
| USA (Toll Free) | 1.800.643.1218 |
| USA (Warranty) | 1.800.230.7091 |
| USA (Toll Free) | 1.800.537.2828 |
| USA (Warranty) | 1.800.688.3136 |
| USA (Toll Free) | 1.288.781.4241 |
| USA (Warranty) | 1.877.234.8897 |
| USA (Toll Free) | 1.800.809.3116 |
| USA (Warranty) | 1.423.775.2131 |
| USA (Toll Free) | 1.800.238.7926 |
| USA (Warranty) | 1.574.259.7838 |

Call Direct, Fast Results! 800# LABEL IN EVERY HEARTLAND

We provide a convenient sticker in each coach listing the warranty phone numbers of our most common vendor partners so that if you choose to, you may work directly with them to more quickly resolve issues or obtain replacement items.



HEARTLAND CUSTOMER SERVICE WE'VE GOT YOUR BACK!

Over 40 men and women located in a dedicated facility servicing our customers every day. With a dealer network of over 400 locations across the U.S. and Canada, you're never far from an authorized Heartland dealer.

www.HEARTLANDRVS.com



- Experience:
- Product Walk-Through Videos
 - Side By Side Comparisons
 - Feature Videos • Photo Galleries
 - Virtual 360° Tours
 - Detailed Floor Plans
 - News • Testimonials
 - Customer Service
 - Service Locator
 - Owners Club • More at our Informative Web Site



Product information is as accurate as possible as of the date of publication of this brochure. Due to Heartland's commitment to continuous product improvement - floorplans, materials, components, features, specifications, options, etc. are subject to change without notice or obligation to Heartland Recreational Vehicles. 2010 model year ROAD WARRIOR specifications apply to coaches with VIN numbers ending with 205216 and higher.
Tow Vehicle Caution: Owners of Heartland recreational vehicles are solely responsible for the selection and proper use of tow vehicles. All customers should consult with a motor vehicle manufacturer or their dealer concerning the purchase and use of suitable tow vehicles for Heartland products. Heartland disclaims any liability or damages suffered as a result of the selection, operation, use or misuse of a tow vehicle. Heartland's limited warranty does not cover damage to the recreational vehicle or the tow vehicle as a result of the selection of the tow vehicle.
See your nearest Heartland dealer to review a current model. 10,000 LITHO 4/09



Heartland Recreational Vehicles
1001 All-Pro Drive • Elkhart, IN 46514 • 574-262-5992

Community. Convenience. Close-to-home.

Where you purchase your recreational vehicle is ultimately your decision but Heartland urges you to consider buying at your local dealer. Dealers are part of your community, providing jobs and contributing to your local economy. These dealers are under obligation to provide warranty service for products they sell, but are not legally required to service products purchased from other dealers. At some point, you may need to return to the dealer you buy from - why not stay close to home? After all, home is where your Heartland is!

BENEFITS OF PURCHASING YOUR RV LOCALLY:

- You enjoy valuable relationship building with Dealer Representatives, close to your home, who will explain the features and benefits of the product.
- You receive a full product orientation prior to delivery, which includes hands-on directions for many of the coach's systems and functions. You are also introduced to the Dealership's Service/Parts/Warranty personnel who are at the ready to help you with any issues you may encounter, now and in the future.
- You enjoy customer PRIORITY. Dealerships generally service their purchasing customers first - others may experience long delays and miss opportunities to use their RV. What is it worth for you to have a dealership's full attention and motivation to satisfy you when you need service - in a timely manner?
- Valuable TAX dollars and jobs stay in YOUR community which pays for your roads, schools, police and fire departments.

DON'T UNDERESTIMATE CUSTOMER SERVICE AND PERSONAL CARE!

For Canadian Residents: If you purchase an RV out-of-country, there are additional fees, taxes and inspections that must be met before bringing your product home. Your local Canadian dealers are experts in these provisions.

Your Authorized Heartland Dealer:

ROAD WARRIOR

BY HEARTLAND

www.HEARTLANDRVS.com

Experience:
 Product Walk-Through Videos
 Side By Side Comparisons
 Feature Videos • Photo Galleries
 Virtual 360° Tours
 Detailed Floor Plans
 News • Testimonials
 Customer Service
 Service Locator
 Owners Club • More
 at our Informative Web Site

VENDOR 800#
CALL DIRECT FOR DIRECT RESULTS!
TOLL FREE & WARRANTY PHONE NUMBERS:

| | |
|---|----------------|
| LIPPERT | 1.866.524.7821 |
| DOMESTIC | 1.800.544.4881 |
| DOMESTIC, For Customers, Settings, Comments | |
| DOMESTIC | 1.800.347.2232 |
| SHUR-FLOW | 1.800.854.3218 |
| THEFORD | 1.800.543.1219 |
| KOB | 1.800.250.7051 |
| TRENT TIRE | 1.800.537.2925 |
| A.S.A. | 1.800.888.3135 |
| PROGRESSIVE | 1.202.781.4241 |
| CHENG | 1.877.294.8997 |
| ATWOOD | 1.888.880.3118 |
| SUBURBAN | 1.423.775.2131 |
| SWAN | 1.800.228.7028 |
| S & B | 1.574.259.7838 |

Call Direct, Fast Results! 800# LABEL IN EVERY HEARTLAND

We provide a convenient sticker in each coach listing the warranty phone numbers of our most common vendor partners so that if you choose to, you may work directly with them to more quickly resolve issues or obtain replacement items.



HEARTLAND CUSTOMER SERVICE WE'VE GOT YOUR BACK!

Over 40 men and women located in a dedicated facility servicing our customers every day. With a dealer network of over 400 locations across the U.S. and Canada, you're never far from an authorized Heartland dealer.

Product information is as accurate as possible as of the date of publication of this brochure. Due to Heartland's commitment to continuous product improvement - floorplans, materials, components, features, specifications, options, etc. are subject to change without notice or obligation to Heartland Recreational Vehicles. 2010 model year ROAD WARRIOR specifications apply to coaches with VIN numbers ending with 205216 and higher.

Tow Vehicle Caution: Owners of Heartland recreational vehicles are solely responsible for the selection and proper use of tow vehicles. All customers should consult with a motor vehicle manufacturer or their dealer concerning the purchase and use of suitable tow vehicles for Heartland products. Heartland disclaims any liability or damages suffered as a result of the selection, operation, use or misuse of a tow vehicle. Heartland's limited warranty does not cover damage to the recreational vehicle or the tow vehicle as a result of the selection of the tow vehicle.

See your nearest Heartland dealer to review a current model. 10,000 LITHO 4/09