



Sportsmen Classic



16RBT

Simple pleasures are always the best. With 3 floor plans that now feature expandable sleeping areas and a new toy hauler model. The Sportsmen Classic is ready to share the good times.





Sportsmen Classic



16RBT

Simple pleasures are always the best. With 3 floor plans that now feature expandable sleeping areas and a new toy hauler model. The Sportsmen Classic is ready to share the good times.





13FK



13FKT

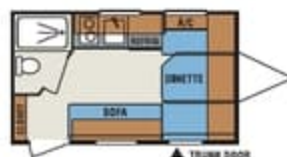

14RB



16BH

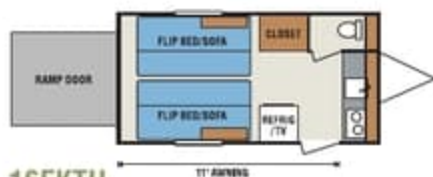

16FKTH

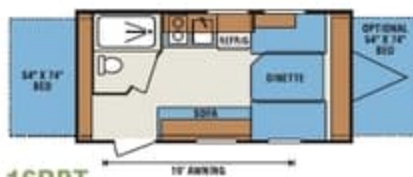

16RBT



19BH



19BH - U-Shape Dinette Option



19SB



19SBT

SPECIFICATIONS	13FK	13FKT	14RB	16BH	16FKTH	16RBT	19BH	19SB	19SBT
UVW (Unloaded Vehicle Weight)	1,854	1,989	2,103	2,250	2,271	2,338	2,609	2,776	2,754
Dry Hitch Weight	198	184	284	304	354	302	286	365	319
Dry Axle Weight	1,656	1,805	1,819	1,946	1,917	2,036	2,323	2,411	2,435
NCC (Net Carrying Capacity)	845	711	597	450	1,229	362	891	852	746
GVWR	2,700	2,700	2,700	2,700	3,500	2,700	3,500	3,500	3,500
Interior Height	73"	73"	73"	73"	73"	73"	73"	73"	73"
Exterior Height	8' 1"	8' 1"	8'	8' 1"	8' 4"	8'	8' 2"	8' 2"	8' 2"
Exterior Width	84"	84"	84"	84"	84"	84"	84"	84"	84"
Exterior Length	13' 9"	13' 9"	15' 10"	17' 2"	17'	17' 2"	20' 6"	20' 6"	20' 6"
Refrigerator (cu. feet)	4.6	4.6	4.6	4.6	4.6	4.6	4.6	4.6	4.6
Water Heater Cap. (gal. Gas) <i>OPTIONAL</i>	6	6	6	6	6	6	6	6	6
Fresh Water Cap. (gal.)	10	10	10	10	10	10	20	20	20
Waste Water Cap. (gal.)	5	5	9	9	5	9	9	15	15
Gray Water Cap. (gal.)	9	9	15	15	9	15	15	15	15
LP Gas Cap. (lbs.) <i>OPTIONAL</i>	20	20	20	20	20	20	20	20	20
Furnace BTUs (1,000's) <i>OPTIONAL</i>	16	16	16	16	16	16	16	16	16
Tire Size	13"	13"	13"	13"	14"	13"	14"	14"	14"
Awning <i>OPTIONAL</i>	9'	9'	10'	10'	10'	10'	10'	10'	10'

*This weight reflects the average unit weight for a 5 month period for each model. Your trailer weight will vary according to optional equipment.

Standard Features

- 4.6 Cu. Ft. Electric Refrigerator
- 2 Burner Electric Hot Plate
- Single Bowl Sink
- 54" Dinette Seats
- Overhead Cabinets
- 10 Gallon Fresh Water Tank
- Tinted Windows
- City Water Fill
- 12 V Water Pump
- 12 V Converter with Charger
- 13" Tires
- 1 Piece Aluminum Roof
- R-7 Insulation

Regular Package

- TV Antenna
- Awning with Hardware
- Toilet
- Spare Tire
- 2 Stabilizer Jacks

Options

- 16,000 BTU Furnace
- 5,000 BTU Air Conditioner
- Spare Tire
- 4 Stabilizer Jacks
- 2 Stabilizer Jacks

Full Package Option

- Gas Hot Plate in Lieu of Electric Hot Plate
- Microwave
- TV Antenna

- Microwave
- Radio
- Toilet and Tank
- TV Antenna
- Awning and Hardware
- 3 Cu. Ft. Gas/Electric Refrigerator

- 3 Cu. Ft. Gas/Electric Refrigerator in Lieu of Electric Refrigerator
- 6 Gallon Gas Water Heater

- Surge Brakes
- Shower and Toilet (Forced Option 14RB, 16BH, 19SB and 19BH)
- Single Gas Bottle (Forced Option 14RB, 16BH, 19SB and 19BH)

- Single Gas Bottle
- Spare Tire
- 2 Stabilizer Jacks
- Awning with Hardware
- Shower and Toilet

- Front Window (N/A 13FKT and 16FKTH)
- 6 Gallon Gas Water Heater (Forced Option 14RB, 16BH, 19SB and 19BH)
- Front Tent (16RBT)
- Rear Tent (19SBT)



**ASK ABOUT
OUR 1-YEAR
WARRANTY!**

Dealer:

For more product details and in-depth information, visit us on the web at www.kz-rv.com



13FK

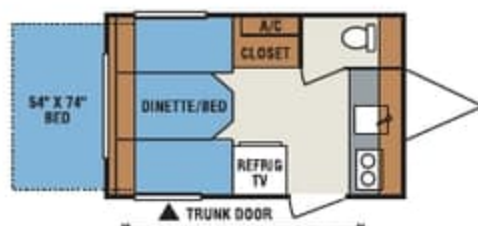

13FKT

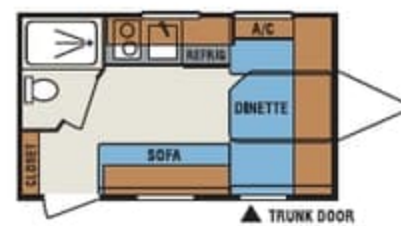

14RB



16BH

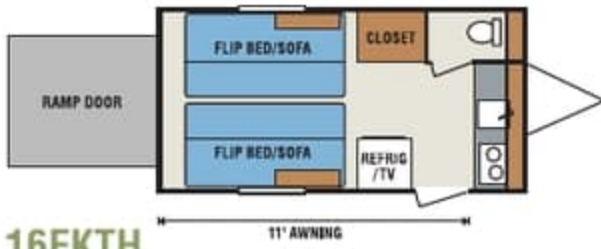

16FKTH

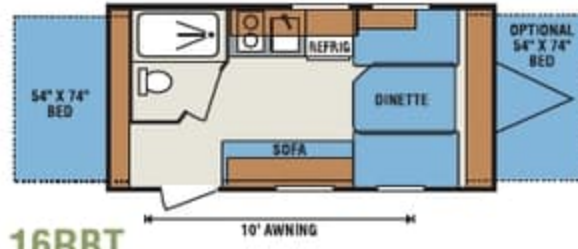

16RBT



19BH

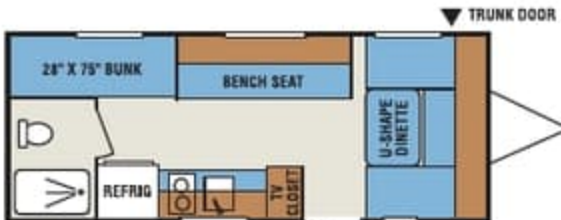

19BH - U-Shape Dinette Option

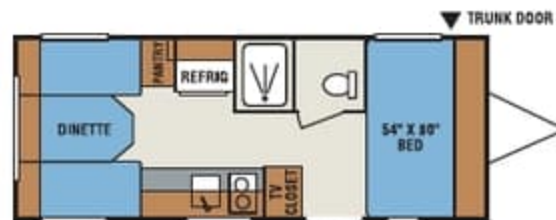

19SB

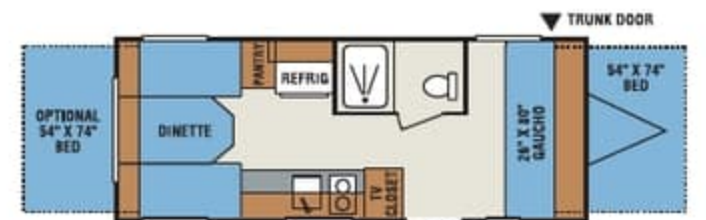

19SBT

SPECIFICATIONS	13FK	13FKT	14RB	16BH	16FKTH	16RBT	19BH	19SB	19SBT
UVW (Unloaded Vehicle Weight)	1,854	1,989	2,103	2,250	2,271	2,338	2,609	2,776	2,754
Dry Hitch Weight	198	184	284	304	354	302	286	365	319
Dry Axle Weight	1,656	1,805	1,819	1,946	1,917	2,036	2,323	2,411	2,435
NCC (Net Carrying Capacity)	845	711	597	450	1,229	362	891	852	746
GVWR	2,700	2,700	2,700	2,700	3,500	2,700	3,500	3,500	3,500
Interior Height	73"	73"	73"	73"	73"	73"	73"	73"	73"
Exterior Height	8' 1"	8' 1"	8'	8' 1"	8' 4"	8'	8' 2"	8' 2"	8' 2"
Exterior Width	84"	84"	84"	84"	84"	84"	84"	84"	84"
Exterior Length	13' 9"	13' 9"	15' 10"	17' 2"	17'	17' 2"	20' 6"	20' 6"	20' 6"
Refrigerator (cu. feet)	4.6	4.6	4.6	4.6	4.6	4.6	4.6	4.6	4.6
Water Heater Cap. (gal. Gas) <i>OPTIONAL</i>	6	6	6	6	6	6	6	6	6
Fresh Water Cap. (gal.)	10	10	10	10	10	10	20	20	20
Waste Water Cap. (gal.)	5	5	9	9	5	9	9	15	15
Gray Water Cap. (gal.)	9	9	15	15	9	15	15	15	15
LP Gas Cap. (lbs.) <i>OPTIONAL</i>	20	20	20	20	20	20	20	20	20
Furnace BTUs (1,000's) <i>OPTIONAL</i>	16	16	16	16	16	16	16	16	16
Tire Size	13"	13"	13"	13"	14"	13"	14"	14"	14"
Awning <i>OPTIONAL</i>	9'	9'	10'	10'	10'	10'	10'	10'	10'

*This weight reflects the average unit weight for a 5 month period for each model. Your trailer weight will vary according to optional equipment.

Standard Features

- 4.6 Cu. Ft. Electric Refrigerator
- 2 Burner Electric Hot Plate
- Single Bowl Sink
- 54" Dinette Seats
- Overhead Cabinets
- 10 Gallon Fresh Water Tank
- Tinted Windows
- City Water Fill
- 12 V Water Pump
- 12 V Converter with Charger
- 13" Tires
- 1 Piece Aluminum Roof
- R-7 Insulation

Regular Package

- TV Antenna
- Awning with Hardware
- Toilet
- Spare Tire
- 2 Stabilizer Jacks

Options

- 16,000 BTU Furnace
- 5,000 BTU Air Conditioner
- Spare Tire
- 4 Stabilizer Jacks
- 2 Stabilizer Jacks

Full Package Option

- Gas Hot Plate in Lieu of Electric Hot Plate
- Microwave
- TV Antenna

- Microwave
- Radio
- Toilet and Tank
- TV Antenna
- Awning and Hardware
- 3 Cu. Ft. Gas/Electric Refrigerator

- 3 Cu. Ft. Gas/Electric Refrigerator in Lieu of Electric Refrigerator
- 6 Gallon Gas Water Heater

- Surge Brakes
- Shower and Toilet (Forced Option 14RB, 16BH, 19SB and 19BH)
- Single Gas Bottle (Forced Option 14RB, 16BH, 19SB and 19BH)

- Single Gas Bottle
- Spare Tire
- 2 Stabilizer Jacks
- Awning with Hardware
- Shower and Toilet

- Front Window (N/A 13FKT and 16FKTH)
- 6 Gallon Gas Water Heater (Forced Option 14RB, 16BH, 19SB and 19BH)
- Front Tent (16RBT)
- Rear Tent (19SBT)



ASK ABOUT OUR 1-YEAR WARRANTY!

Dealer:

For more product details and in-depth information, visit us on the web at www.kz-rv.com