



Spree ESCAPE



Introducing the *All New Spree Escape*

The name says it all... the all new Spree Escape is ready to go when you are, even if it's a last minute decision. The Escape is lightweight, nicely equipped with a bright interior décor, and is built with KZ quality.



E14RB



The Escape floorplans use all of the available space for amenities and storage with plenty of room to relax. "Spree Escape... Camping Made Easy."

Standard Features

- 2 Burner Cooktop
- 3 Cubic Foot Gas/Electric Refrigerator
- Microwave
- TV Antenna
- 6 Gallon Gas Water Heater
- 20# Gas Bottle
- Spare Tire
- 2 Stabilizer Jacks
- Awning
- Shower & Toilet
- Single Bowl Sink
- 54" Dinette Seats
- Overhead Cabinets
- 10 Gallon Fresh Water Tank
- Tinted Windows
- City Water Fill
- 12V Convertor with Charger
- 14" Tires
- AM/FM/MP3/iPod Radio
- R-7 Insulation
- Cable Hook Up

Options

- 16,000 BTU Furnace
- 5,000 BTU Air Conditioner (13 & 14 Only)
- 6,000 BTU Air Conditioner (16 & 19 Only)
- 8,000 BTU Air Conditioner (16 & 19 Only)
- 13,500 BTU Air Conditioner (16 & 19 Only)
- Aluminum Wheels (2)
- 2 Additional Stabilizer Jacks
- Front Window
- Surge Brakes
- Front Tent (E16RBT)
- Rear Tent (E19SBT)



Amaretto Décor



Earth Décor



Wheat Décor

| SPECIFICATIONS | E14RB | E16BH | E16RBT | E19BH | E19SB | E19SBT |
|-----------------------------|-------|--------|--------|--------|--------|--------|
| UVW (Unloaded Veh. Wt.)* | 2,172 | 2,330 | 2,421 | 2,702 | 2,700 | 2,815 |
| Dry Hitch Weight* | 286 | 272 | 309 | 308 | 337 | 318 |
| Dry Axle Weight* | 1,886 | 2,058 | 2,112 | 2,394 | 2,363 | 2,497 |
| NCC (Net Carrying Cap.) | 528 | 370 | 379 | 798 | 800 | 685 |
| GVWR | 2,700 | 2,700 | 2,800 | 3,500 | 3,500 | 3,500 |
| Interior Height | 75" | 75" | 75" | 75" | 75" | 75" |
| Exterior Height w/out AC | 99" | 99" | 99" | 100" | 100" | 100" |
| Exterior Width | 84" | 84" | 84" | 84" | 84" | 84" |
| Exterior Length | 16' | 17' 4" | 17' 4" | 20' 9" | 20' 9" | 20' 9" |
| Refrigerator (cu. feet) | 3 | 3 | 3 | 4 | 4 | 4 |
| Wtr. Htr. Cap. (gal. Gas) | 6 | 6 | 6 | 6 | 6 | 6 |
| Fresh Water Cap. (gal.) | 10 | 10 | 10 | 20 | 20 | 20 |
| Waste Water Cap. (gal.) | 9 | 9 | 9 | 9 | 15 | 15 |
| Gray Water Cap. (gal.) | 15 | 15 | 15 | 15 | 15 | 15 |
| LP Gas Cap. (lbs.) | 20 | 20 | 20 | 20 | 20 | 20 |
| Furnace BTUs (1,000's) Opt. | 16 | 16 | 16 | 16 | 16 | 16 |
| Tire Size | 13" | 13" | 13" | 14" | 14" | 14" |
| Awning | 10' | 10' | 10' | 10' | 10' | 10' |

*This weight reflects the average unit weight for a 5 month period for each model. Your trailer weight will vary according to optional equipment.

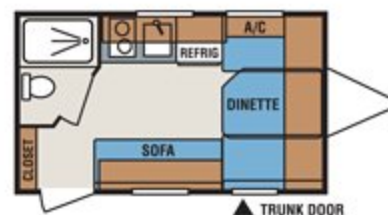

E14RB



E16BH

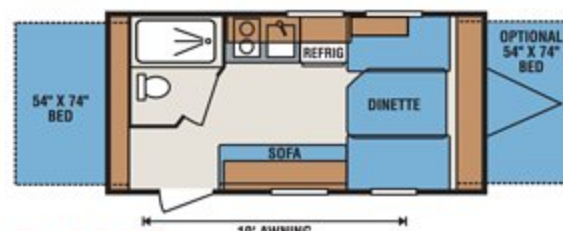

E16RBT



E19BH

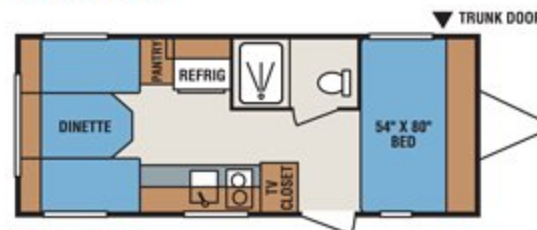

E19SB

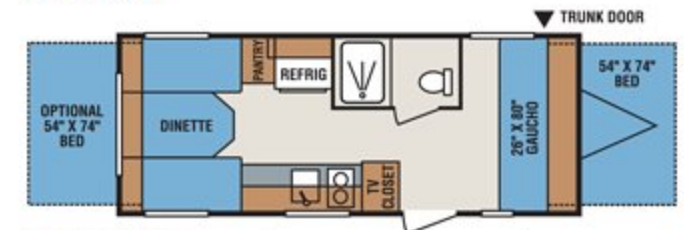

E19SBT

Dealer: _____

ASK ABOUT OUR 1-YEAR WARRANTY!

For more product details and in-depth information, visit us on the web at www.kz-rv.com