



MONACO®

DRIVING YOUR DREAM.



MONACO®

DRIVING YOUR DREAM.





LIVING THE DREAM.

Meet the 2011 Riptide. With a choice of three interior décors, two exterior graphics packages, and four creative floorplans in lengths of 30 to 34 feet, it's no wonder RV shoppers are buzzing over Riptide. A Ford chassis with 6.8L Triton[®] V-10 gasoline engine supplies plenty of power and durability. And inside, get more bang for your buck with standard features like a queen bed, booth dinette, hide-a-bed sofa, double-door refrigerator and LCD TVs in the living area and bedroom. *(Pictured: 33SDD/Autumn Trail II/Newport Cherry)*



LIVING THE DREAM.

Meet the 2011 Riptide. With a choice of three interior décors, two exterior graphics packages, and four creative floorplans in lengths of 30 to 34 feet, it's no wonder RV shoppers are buzzing over Riptide. A Ford chassis with 6.8L Triton® V-10 gasoline engine supplies plenty of power and durability. And inside, get more bang for your buck with standard features like a queen bed, booth dinette, hide-a-bed sofa, double-door refrigerator and LCD TVs in the living area and bedroom. *(Pictured: 33SDD/Autumn Trail II/Newport Cherry)*



AUTUMN TRAIL II

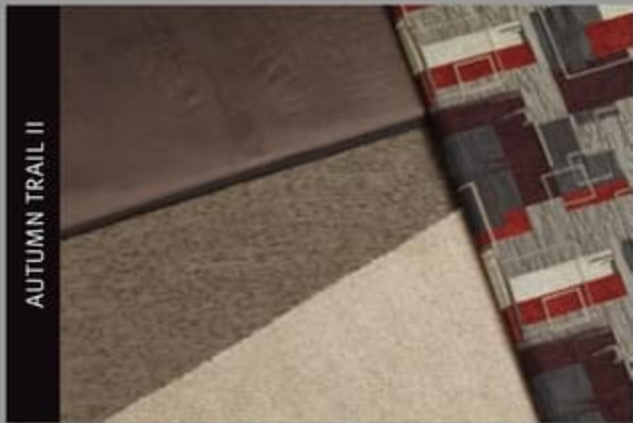

BRASS RING

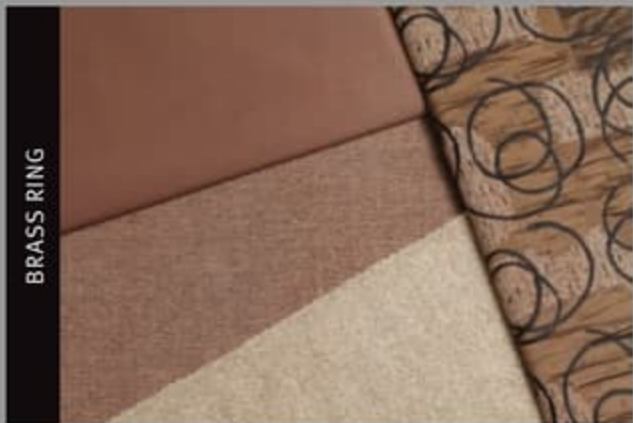

AMBER FUSION



MAKE IT ALL YOUR OWN.

Choosing the Riptide was easy. Now, it's time to make it all your own. Choose from three stylish décor options and two graphics packages, including a partial paint option, not to mention four creative floorplans in lengths from 30 to 34 feet.



STANDARD GRAPHICS PACKAGE (vinyl graphics)



OPTIONAL GRAPHICS PACKAGE (vinyl graphics with partial paint)



NEWPORT CHERRY

- A. BEDSPREAD
- B. SOFA
- C. ACCENT
- D. CARPET



Note: Colors depicted are a reasonable representation though they may not be an exact match of the actual colors due to variances in processing and production. See your dealer for actual fabric and paint chip samples.



AROUND-THE-CLOCK SERVICE AND SUPPORT

When you take delivery of your new RV, it's just the beginning of our exclusive around-the-clock Owner Advantage Program. We offer an extensive support program that provides complete roadside assistance and special motor club benefits that follow you wherever your travels take you. We've teamed up with the largest RV emergency road service company in the country to give you immediate access to fast, dependable service when and where you need it. Add our toll-free service appointment assistance, plus a technical assistance hotline, and you have the security of full-time support at your fingertips.

For details, call toll-free (877) 211-8135



AUTUMN TRAIL II



BRASS RING



AMBER FUSION

MAKE IT ALL YOUR OWN.

Choosing the Riptide was easy. Now, it's time to make it all your own. Choose from three stylish décor options and two graphics packages, including a partial paint option, not to mention four creative floorplans in lengths from 30 to 34 feet.



STANDARD GRAPHICS PACKAGE (vinyl graphics)



OPTIONAL GRAPHICS PACKAGE (vinyl graphics with partial paint)



NEWPORT CHERRY

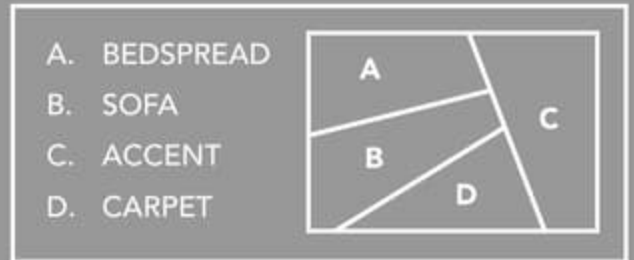

Note: Colors depicted are a reasonable representation though they may not be an exact match of the actual colors due to variances in processing and production. See your dealer for actual fabric and paint chip samples.



AROUND-THE-CLOCK SERVICE AND SUPPORT

When you take delivery of your new RV, it's just the beginning of our exclusive around-the-clock Owner Advantage Program. We offer an extensive support program that provides complete roadside assistance and special motor club benefits that follow you wherever your travels take you. We've teamed up with the largest RV emergency road service company in the country to give you immediate access to fast, dependable service when and where you need it. Add our toll-free service appointment assistance, plus a technical assistance hotline, and you have the security of full-time support at your fingertips.

For details, call toll-free (877) 211-8135

Carpet Tile

30PBS

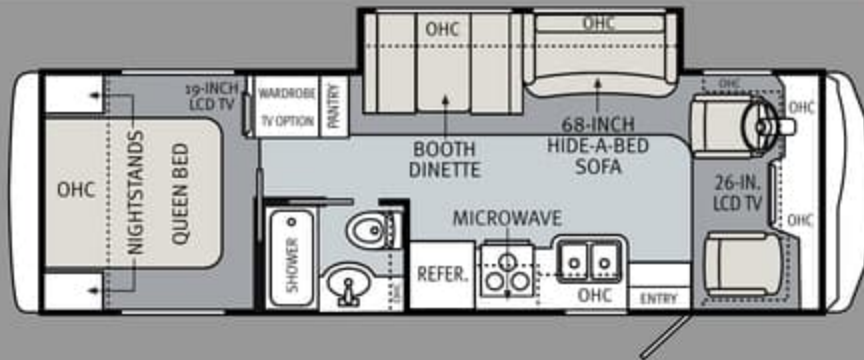

32SBT

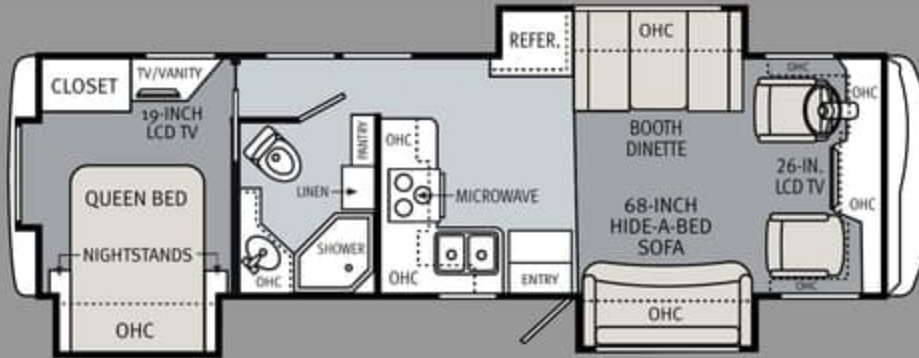

33SDD

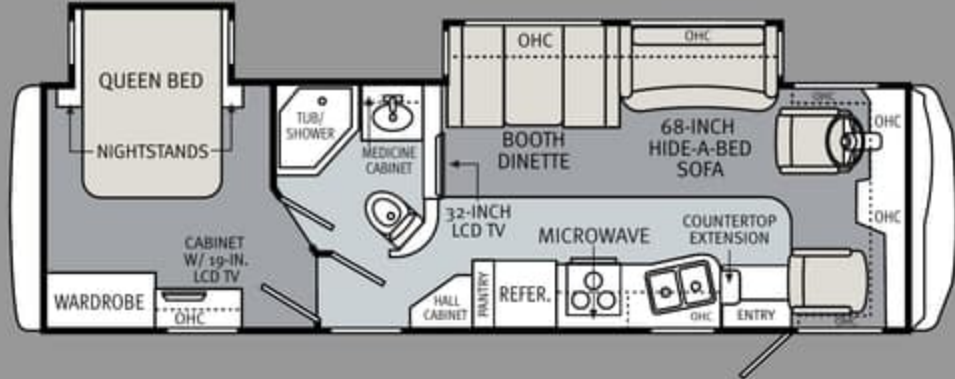

34SBD

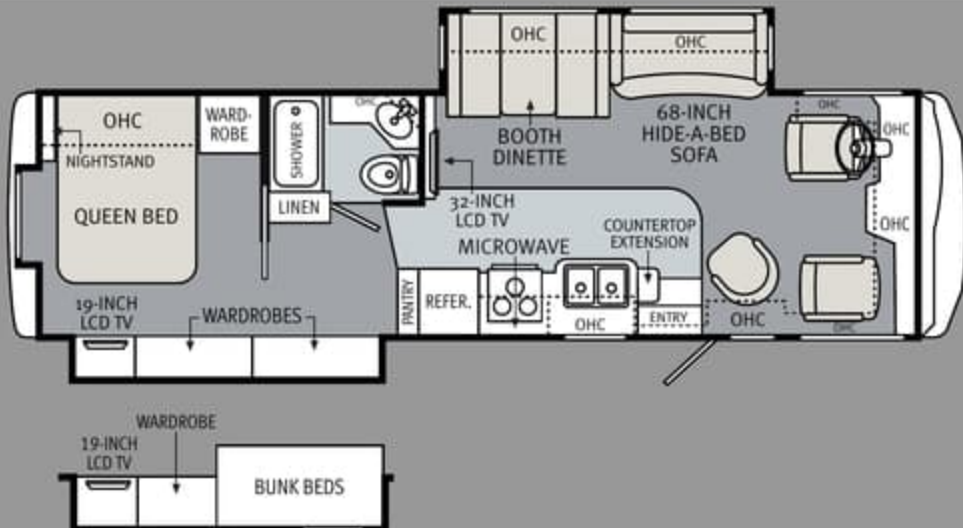

Carpet Tile

30PBS

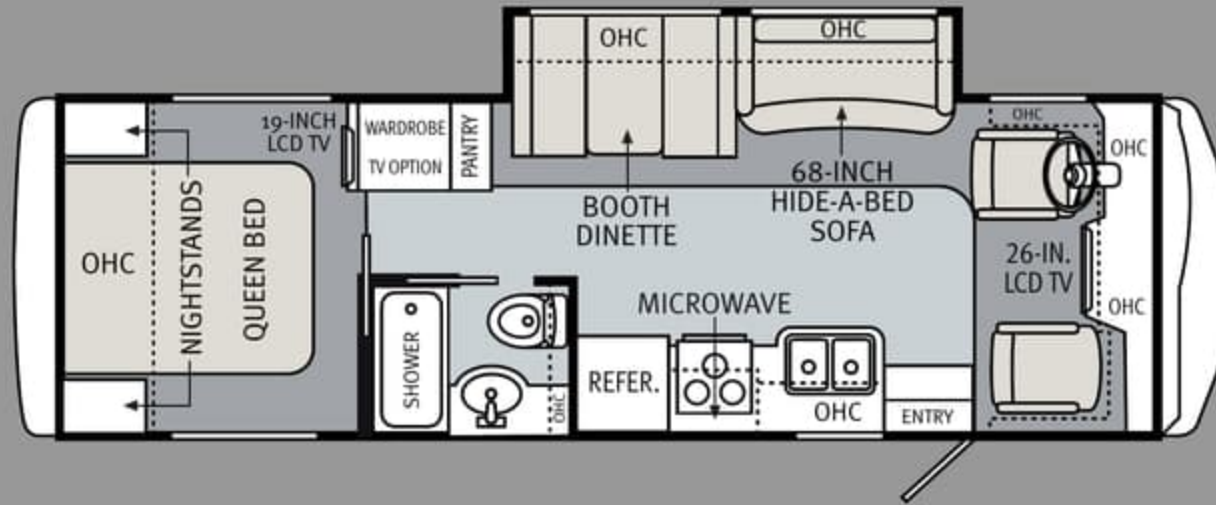

32SBT

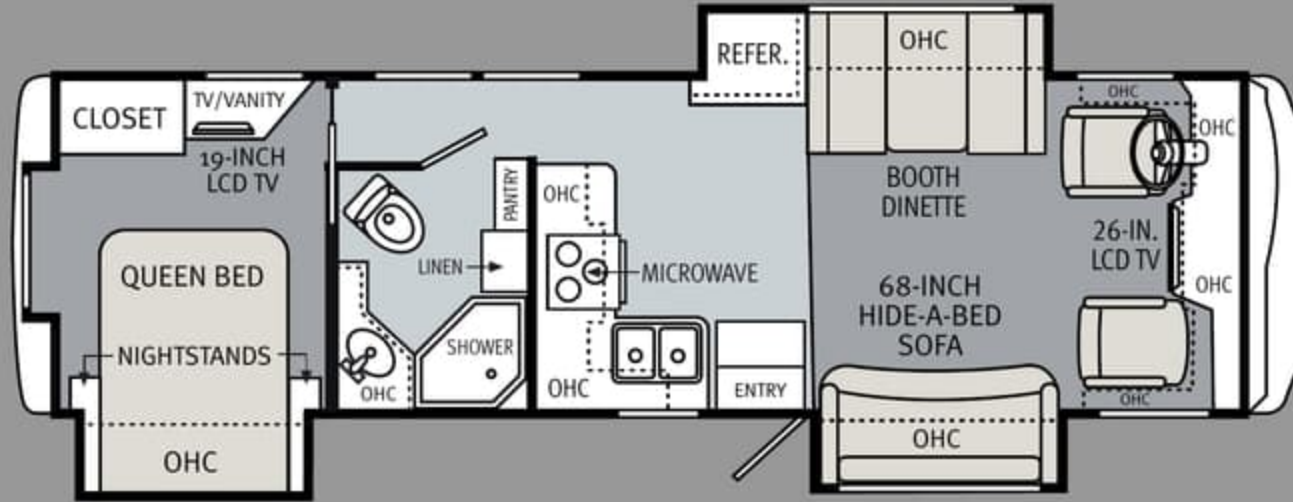

33SDD

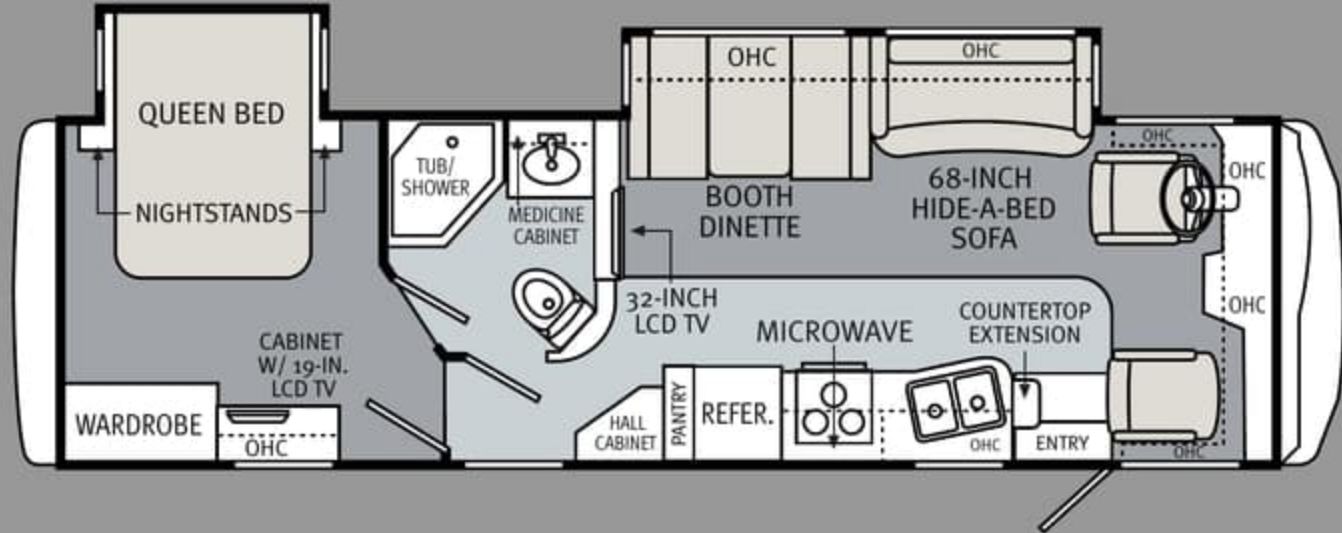

34SBD

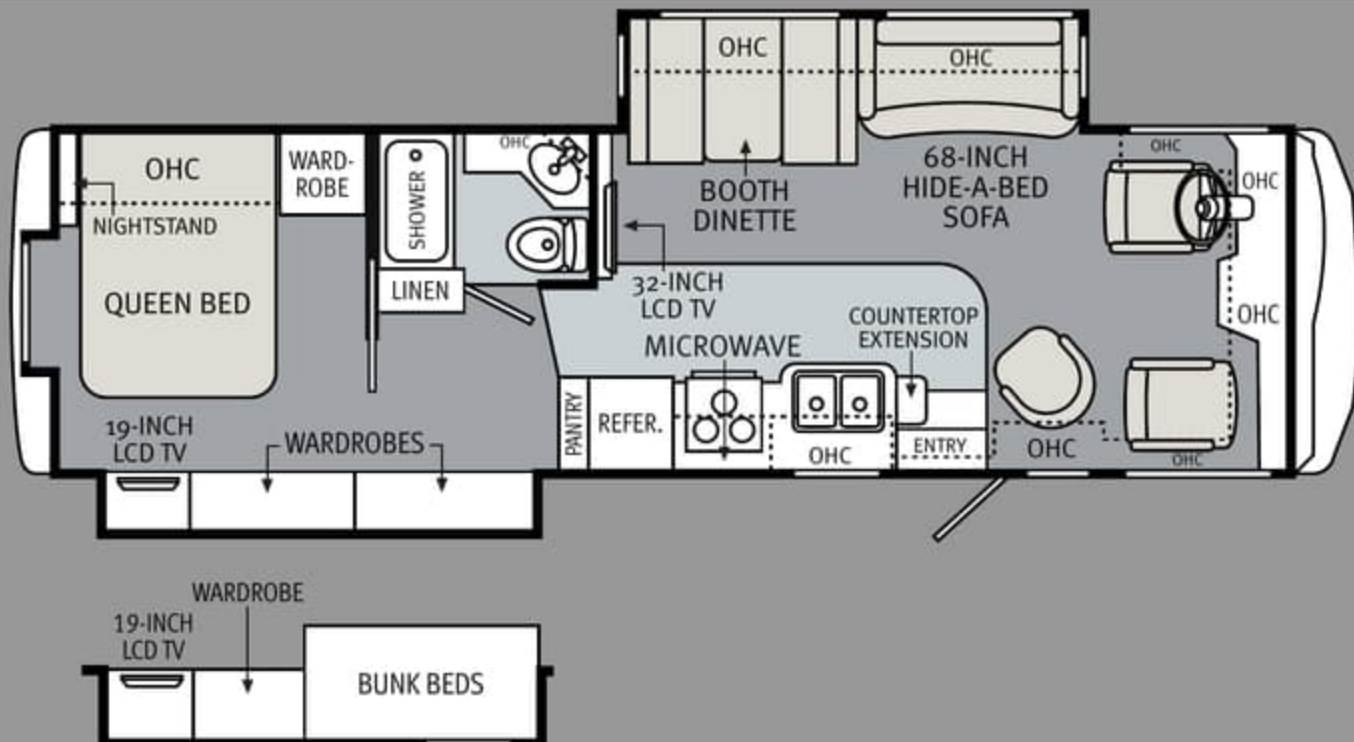

Due to continuous product improvement, visit monacocoach.com for the latest in standards and options, specifications, and technical data.

		30PBS	32SBD	33SDD	34SBD
WEIGHTS FORD	Gross Vehicle Weight Rating (Lbs.)	18,000	18,000	20,500	20,500
	Gross Combined Weight Rating ¹ (Lbs.)	26,000	26,000	26,000	26,000
	Front Gross Axle Weight Rating (Lbs.)	7,000	7,000	7,500	7,500
	Rear Gross Axle Weight Rating (Lbs.)	11,000	11,000	13,500	13,500
MEASUREMENTS	Wheelbase	190"	208"	208"	228"
	Overall Length w/o Ladder/Spare Tire	31'	33' 4"	33' 11"	34' 8"
	Overall Height, Including AC	11' 8"	11' 8"	11' 8"	11' 8"
	Interior Height	79"	79"	79"	79"
	Interior Width	95.5"	95.5"	95.5"	95.5"
	Exterior Width	99"	99"	99"	99"
TANK CAPACITIES²	Gray Tank (Gal.)	40	40	40	40
	Black Tank (Gal.)	40	40	48	40
	Fresh Tank (Gal.)	50	50	50	50
	LP Tank (Gal.)	68/16	68/16	68/16	68/16
	Fuel Tank (Gal.)	80	80	75	75

¹Towing capacity is limited by GCWR; your vehicle's towing capacity is the difference between the GCWR and the actual vehicle weight, including all water, fuel, passengers and cargo. Your towed vehicle should be equipped with auxiliary brakes if the weight of the towed vehicle exceeds 1,000 lbs. Consult your owner's manual for further towing information.

The actual overall length of the recreational vehicle may differ from that indicated in the brochure due to variances in the manufacturing process and/or installed components. The actual length may be greater or less than that indicated. Due to the large variety of options and floorplan arrangements available to our customers, actual weights for each unit can differ significantly. Monaco provides a weight sticker on each unit we produce which includes that unit's tank capacities and approximate weight. Consult your local Monaco dealer for unit availability and further information. The information printed in this brochure reflects product design, fabrication, and component parts at the date of printing. The manufacturer reserves the right, at any time, to make changes in product design or material or component specifications

²All tank capacities are estimated based upon calculations provided by the tank manufacturers and represent approximate capacities. The actual "usable capacity" may be greater or less than the estimated capacities based upon fabrication and installation of the tanks.

³Actual filled LP capacity is 80% of listing due to safety shut-off required on tank.

as its sole option, without notice. This includes the substitution of components of a different brand or trade name which will result in comparable performance. All information printed in this brochure is subject to change after the date of printing. Some features shown or mentioned in this brochure are optional and may only be available in selected floorplans. Photographs may depict a floorplan option that has been discontinued or is no longer available at the time of your purchase. Photographs may show props or decorations that are not standard equipment. Monaco, the Monaco logo and its design, are registered trademarks. Other products and company names are trademarks and/or registered trademarks of their respective holders. While the color of the motorhome's exterior and the interior fabrics depicted in this sales brochure are fair and

reasonable depictions, the colors depicted may not be an exact match of the actual colors because of the variances in photo-processing and printing. Due to product improvements, changes during the model year and/or transcription errors that may occur, information represented within this brochure may not be accurate at the time of your purchase. If certain information is significant to your purchasing decision, please confirm the information with your dealer. Component part and appliance manufacturers issue limited warranties covering portions of the recreational vehicle not covered under the Limited Warranties issued by Monaco RV, LLC. To learn specific details regarding warranty coverage, please contact your selling dealership or review the warranty packet inside the recreational vehicle.

WARRANTIES

12 month/24,000 mile basic limited warranty, 5 year/50,000 mile limited structural warranty. *Review your coach's limited warranty in full for complete terms and conditions. Review your chassis manufacturer's limited warranty in full for complete terms and conditions.

BUY LOCALLY. ENJOY EVERYWHERE.

Monaco RV strongly encourages its retail customers to purchase from their local dealerships whenever possible. Buying a new Monaco RV locally allows a customer to establish a relationship with a dealer close to home and provides convenient service and support from product-trained technicians. On our end, Monaco RV will continue to provide our dealer partners and customers with the finest recreational vehicles in the industry.

Due to continuous product improvement, visit monacocoach.com for the latest in standards and options, specifications, and technical data.

		30PBS	32SBD	33SDD	34SBD
WEIGHTS FORD	Gross Vehicle Weight Rating (Lbs.)	18,000	18,000	20,500	20,500
	Gross Combined Weight Rating ¹ (Lbs.)	26,000	26,000	26,000	26,000
	Front Gross Axle Weight Rating (Lbs.)	7,000	7,000	7,500	7,500
	Rear Gross Axle Weight Rating (Lbs.)	11,000	11,000	13,500	13,500
MEASUREMENTS	Wheelbase	190"	208"	208"	228"
	Overall Length w/o Ladder/Spare Tire	31'	33' 4"	33' 11"	34' 8"
	Overall Height, Including AC	11' 8"	11' 8"	11' 8"	11' 8"
	Interior Height	79"	79"	79"	79"
	Interior Width	95.5"	95.5"	95.5"	95.5"
	Exterior Width	99"	99"	99"	99"
TANK CAPACITIES ²	Gray Tank (Gal.)	40	40	40	40
	Black Tank (Gal.)	40	40	48	40
	Fresh Tank (Gal.)	50	50	50	50
	LP Tank (Gal.)	68/16	68/16	68/16	68/16
	Fuel Tank (Gal.)	80	80	75	75

¹Towing capacity is limited by GCWR; your vehicle's towing capacity is the difference between the GCWR and the actual vehicle weight, including all water, fuel, passengers and cargo. Your towed vehicle should be equipped with auxiliary brakes if the weight of the towed vehicle exceeds 1,000 lbs. Consult your owner's manual for further towing information.

The actual overall length of the recreational vehicle may differ from that indicated in the brochure due to variances in the manufacturing process and/or installed components. The actual length may be greater or less than that indicated. Due to the large variety of options and floorplan arrangements available to our customers, actual weights for each unit can differ significantly. Monaco provides a weight sticker on each unit we produce which includes that unit's tank capacities and approximate weight. Consult your local Monaco dealer for unit availability and further information. The information printed in this brochure reflects product design, fabrication, and component parts at the date of printing. The manufacturer reserves the right, at any time, to make changes in product design or material or component specifications

²All tank capacities are estimated based upon calculations provided by the tank manufacturers and represent approximate capacities. The actual "usable capacity" may be greater or less than the estimated capacities based upon fabrication and installation of the tanks.

as its sole option, without notice. This includes the substitution of components of a different brand or trade name which will result in comparable performance. All information printed in this brochure is subject to change after the date of printing. Some features shown or mentioned in this brochure are optional and may only be available in selected floorplans. Photographs may depict a floorplan option that has been discontinued or is no longer available at the time of your purchase. Photographs may show props or decorations that are not standard equipment. Monaco, the Monaco logo and its design, are registered trademarks. Other products and company names are trademarks and/or registered trademarks of their respective holders. While the color of the motorhome's exterior and the interior fabrics depicted in this sales brochure are fair and

³Actual filled LP capacity is 80% of listing due to safety shut-off required on tank.

reasonable depictions, the colors depicted may not be an exact match of the actual colors because of the variances in photo-processing and printing. Due to product improvements, changes during the model year and/or transcription errors that may occur, information represented within this brochure may not be accurate at the time of your purchase. If certain information is significant to your purchasing decision, please confirm the information with your dealer. Component part and appliance manufacturers issue limited warranties covering portions of the recreational vehicle not covered under the Limited Warranties issued by Monaco RV, LLC. To learn specific details regarding warranty coverage, please contact your selling dealership or review the warranty packet inside the recreational vehicle.

WARRANTIES

12 month/24,000 mile basic limited warranty. 5 year/50,000 mile limited structural warranty. *Review your coach's limited warranty in full for complete terms and conditions. Review your chassis manufacturer's limited warranty in full for complete terms and conditions.

BUY LOCALLY. ENJOY EVERYWHERE.

Monaco RV strongly encourages its retail customers to purchase from their local dealerships whenever possible. Buying a new Monaco RV locally allows a customer to establish a relationship with a dealer close to home and provides convenient service and support from product-trained technicians. On our end, Monaco RV will continue to provide our dealer partners and customers with the finest recreational vehicles in the industry.

BODY CONSTRUCTION

- † Fully Welded Tubular Aluminum Roof, Sidewalls and Floor
- † Fully Laminated Roof, Walls and Floors with High-Density Block Foam Insulation
- † Seamless Fiberglass Exterior Sidewalls
- † Rubber Roof with Metal Radius Cap
- † One-Piece Fiberglass Front Cap
- † Deluxe Black Exterior Mirrors
- † Fog Lights
- † One-Piece Rear Cap with Large Auto-Style Taillights
- † Flush-Mount Radius Baggage Doors
- † Pass-Through Storage Areas
- † One-Piece Polyethylene Storage Compartments
- † Rear Wheel Mudflaps
- † Deluxe Vinyl Graphics Package
- † Rear Ladder
- † Automatic Electric Exterior Entrance Step
- † Undercoating

FORD CHASSIS/ENGINE (GAS)/SUSPENSION

- † 6.8L Triton® V-10 Gasoline Engine w/ Electronic Fuel Injection; 326 HP @ 457 lbs./ft. Torque
- † 5-Speed TorqShift® Automatic Overdrive Transmission with Tow/Haul Mode
- † Transmission Oil Temperature Gauge
- † 130 Amp Alternator
- † Rear Axle Ratio 5.38:1
- † Radial Tires
- † Stainless Steel Wheel Liners with Valve Extenders
- † Rear Multi-Leaf Spring Suspension
- † Automatic Hydraulic Leveling Jacks
- † Front and Rear Disc, 4-Wheel Antilock Brakes
- † Heavy Duty Front Track Bar with Shock Absorbers
- † 5,000 lb. Hitch Receiver with Dual Connector 4-Pin or 7-Pin
- † One 12V Chassis Battery
- † Battery Boost Start Switch

COCKPIT

- † Auto-Style Dash with Wood Grain Dash Kit
- † In-Dash AM/FM/CD Stereo Radio; Sirius Satellite Ready w/ SD Card Slot, and Weather Band
- † Dash Fans
- † Multi-Positioned Sun Visors
- † Factory Heat/AC, Cruise Control, Tilt Steering Wheel
- † Recessed Pilot/Copilot Ceiling Map Lights
- † Leatherette Pilot/Copilot Cockpit Recliner Seats

APPLIANCES AND ACCESSORIES

- † Double-Door Refrigerator
- † Stainless Steel 3-Burner Cooktop with Oven
- † Microwave Oven
- † Lighted Power Range Hood
- † 32" LCD TV in Main Living Area (33SDD, 34SBD)
- † 26" LCD TV in Cockpit Overhead (30PBS, 32SBT)
- † 19" LCD TV in Bedroom
- † TV and Dash Stereo Combined Antenna
- † Cable TV and Satellite Dish Prep

INTERIOR

- † Newport Cherry Cabinetry
- † Cabinet Doors: Upper Doors in Kitchen and Living Area with Raised Panel and Top Arch; Lower Doors Square-Framed with Flat Panel Inserts; Upper Doors in Bath and Bedroom with Flat Panel Arched
- † Black Smoked Inserts on Refrigerator Doors
- † Wallpaper Border in Kitchen and Bath
- † Satin Nickel Cabinet Door Pulls
- † Heavy Duty Ball Bearing Drawer Guides
- † Sidewall-Mounted Interior Grab Handle
- † Wood Cabinet Drawer Boxes
- † Laminate Kitchen Countertops with Stainless Steel Sink, High-Rise Faucet and Two Sink Covers
- † Kitchen Pantry w/ Roll-Out Storage (33SDD, 34SBD)
- † Kitchen Countertop Extension (33SDD, 34SBD)
- † Laminate Bath Countertops with Stainless Steel Sink
- † Linoleum in Bath, Galley, and Entryway
- † Carpet with Padding in Living Area and Bedroom
- † Soft-Touch Padded Vinyl Ceiling (NA: 30PBS)
- † Wood Slideout Fascia with Wood Inserts
- † Bath and Bedroom Swing Doors (33SDD, 34SBD)
- † TV Cabinet in Bedroom
- † Two Decorative Sofa Pillows in Living Area
- † Decorative Headboard, Bedspread and Pillows
- † Mini Blinds with Valances and Lambrequins

FURNITURE

- † Queen Bed with Innerspring Mattress
- † Fabric Barrel Chair (34SBD Only)
- † Fabric Booth Dinette
- † Fabric Hide-A-Bed Sofa

ELECTRICAL SYSTEMS AND LIGHTS

- † 30 Amp 120V Distribution Panel (30PBS, 32SBT)
- † 50 Amp 120V Distribution Panel (33SDD, 34SBD)
- † 50 Amp Electronic 12V Power Converter

- † Onan® 4.0 kW Generator (30PBS, 32SBT)
- † Onan® 5.5 kW Gas Generator (33SDD, 34SBD)
- † 12V Auxiliary Battery
- † Slide-Out Battery Tray
- † Battery Disconnect Switch
- † 12V Outlet Switch in Cockpit Area
- † Exterior Power Entry Step with Light
- † Water Pump Switch Convenience Center
- † Hallway Convenience Center
- † Lights in Outside Storage Compartments

PLUMBING AND LP SYSTEMS

- † 12V Demand Water System and Water Pump
- † 6-Gallon LP Gas Water Heater (30PBS, 32SBT)
- † 6-Gallon LP Gas/Electric Water Heater with Electronic Ignition and DSI (33SDD, 34SBD)
- † Water Heater Bypass Kit
- † Exterior Shower
- † China Toilet Bowl
- † Gravity Water Fill
- † Contained Storage Area for Sewer Hose
- † Exterior Utility Center
- † Rectangle Shower with Glass Door (30PBS, 34SBD)
- † Neo-Angled Shower with Glass Door (32SBT, 33SDD)

HEATING, VENTS AND AC

- † Single 13.5M BTU AC w/ Ducted Air – Front
- † In-Floor Rigid Heat Ducts
- † 31M BTU Electronic Ignition Furnace (30PBS Only)
- † 35M BTU Electronic Ignition Furnace (NA: 30PBS)
- † Non-Power Roof Vent in Kitchen and Bedroom
- † 12V Power Roof Vent in Bath

WINDOWS, DOORS AND AWNINGS

- † Dark Tinted Safety Glass Radius Flush-Mount Windows
- † Dual-Pane Windows
- † Patio Awning
- † Topper Slideout Awnings
- † Tinted Plexiglas Skylight in Bath

SAFETY

- † Fire Extinguisher
- † Deadbolt Lock on Entrance Door
- † LP Gas, Smoke and Carbon Monoxide Detectors
- † Pilot/Copilot 3-Point Seatbelts
- † Seatbelts Throughout

BODY CONSTRUCTION

- † Partial Paint (Front Mask and Lower Skirt Painted, Smooth Fiberglass Walls with Paint Option)
- † Deluxe Black Power Heated Exterior Mirrors
- † Canadian RV Certification

COCKPIT

- † Single Camera Rear Vision System
- † 3-Camera Rear Vision System (Requires selection of Single Camera Rear Vision System)
- † Six-Way Power Driver's Seat

APPLIANCES AND ACCESSORIES

- † Half-Time Microwave Oven
- † High-Output 3-Burner Cooktop
- † DVD Player in Living Area
- † Home Theater Surround Sound System w/ DVD Player

- † Exterior Entertainment Center, CD Player w/ Radio and 2 Speakers

INTERIOR

- † Décor: Brass Ring, Autumn Trail II, Amber Fusion
- † Full-Width Linoleum Option
- † Day/Night Shades On All But Kitchen Window

FURNITURE

- † Leatherette Hide-A-Bed Sofa
- † King Bed with Innerspring Mattress (34SBD Only) (N/A with Bunk Bed Option)
- † Hallway Bunk Beds with Two Fold-Down DVD Players w/ Game Hookups and Lights; Wireless Headphones, Bunk Ladder and Two-Drawer Storage Below (34SBD Only) (N/A with King Bed Option)
- † Leatherette Euro Recliner with Ottoman (34SBD Only)

ELECTRICAL SYSTEMS AND LIGHTS

- † 50 Amp Service w/ 6 Gallon Gas/Electric Water Heater (30PBS, 32SBT) (Req. 5.5 kW Gas Generator Option)
- † Onan® 5.5 kW Gas Generator (30PBS, 32SBT) (Req. 50 Amp Service Option)
- † Second Auxiliary Battery

PLUMBING AND LP SYSTEMS

- † 6-Gallon LP Gas/Electric Water Heater with Electronic Ignition and DSI (30PBS, 32SBT) (Req. 50 Amp Service and 5.5 kW Gas Generator Option)

HEATING, VENTS AND AC

- † Single 13.5M BTU AC with Ducted Air in Bedroom
- † 12V Power Roof Vent in Kitchen

ALL ROADS LEAD TO MONACOCOACH.COM

Wherever the road takes you, you're never more than a click away from your friends at Monaco. Just go to monacocoach.com for all the latest product news, club dates and destinations, a dealer locator function, and factory tour information. You can also e-mail us directly through the site at any time.



BODY CONSTRUCTION

- › Fully Welded Tubular Aluminum Roof, Sidewalls and Floor
- › Fully Laminated Roof, Walls and Floors with High-Density Block Foam Insulation
- › Seamless Fiberglass Exterior Sidewalls
- › Rubber Roof with Metal Radius Cap
- › One-Piece Fiberglass Front Cap
- › Deluxe Black Exterior Mirrors
- › Fog Lights
- › One-Piece Rear Cap with Large Auto-Style Taillights
- › Flush-Mount Radius Baggage Doors
- › Pass-Through Storage Areas
- › One-Piece Polyethylene Storage Compartments
- › Rear Wheel Mudflaps
- › Deluxe Vinyl Graphics Package
- › Rear Ladder
- › Automatic Electric Exterior Entrance Step
- › Undercoating

FORD CHASSIS/ENGINE (GAS)/SUSPENSION

- › 6.8L Triton® V-10 Gasoline Engine w/ Electronic Fuel Injection; 326 HP @ 457 lbs./ft. Torque
- › 5-Speed TorqShift® Automatic Overdrive Transmission with Tow/Haul Mode
- › Transmission Oil Temperature Gauge
- › 130 Amp Alternator
- › Rear Axle Ratio 5.38:1
- › Radial Tires
- › Stainless Steel Wheel Liners with Valve Extenders
- › Rear Multi-Leaf Spring Suspension
- › Automatic Hydraulic Leveling Jacks
- › Front and Rear Disc, 4-Wheel Antilock Brakes
- › Heavy Duty Front Track Bar with Shock Absorbers
- › 5,000 lb. Hitch Receiver with Dual Connector 4-Pin or 7-Pin
- › One 12V Chassis Battery
- › Battery Boost Start Switch

COCKPIT

- › Auto-Style Dash with Wood Grain Dash Kit
- › In-Dash AM/FM/CD Stereo Radio; Sirius Satellite Ready w/ SD Card Slot, and Weather Band
- › Dash Fans
- › Multi-Positioned Sun Visors
- › Factory Heat/AC, Cruise Control, Tilt Steering Wheel
- › Recessed Pilot/Copilot Ceiling Map Lights
- › Leatherette Pilot/Copilot Cockpit Recliner Seats

APPLIANCES AND ACCESSORIES

- › Double-Door Refrigerator
- › Stainless Steel 3-Burner Cooktop with Oven
- › Microwave Oven
- › Lighted Power Range Hood
- › 32" LCD TV in Main Living Area (33SDD, 34SBD)
- › 26" LCD TV in Cockpit Overhead (30PBS, 32SBT)
- › 19" LCD TV in Bedroom
- › TV and Dash Stereo Combined Antenna
- › Cable TV and Satellite Dish Prep

INTERIOR

- › Newport Cherry Cabinetry
- › Cabinet Doors: Upper Doors in Kitchen and Living Area with Raised Panel and Top Arch; Lower Doors Square-Framed with Flat Panel Inserts; Upper Doors in Bath and Bedroom with Flat Panel Arched
- › Black Smoked Inserts on Refrigerator Doors
- › Wallpaper Border in Kitchen and Bath
- › Satin Nickel Cabinet Door Pulls
- › Heavy Duty Ball Bearing Drawer Guides
- › Sidewall-Mounted Interior Grab Handle
- › Wood Cabinet Drawer Boxes
- › Laminate Kitchen Countertops with Stainless Steel Sink, High-Rise Faucet and Two Sink Covers
- › Kitchen Pantry w/ Roll-Out Storage (33SDD, 34SBD)
- › Kitchen Countertop Extension (33SDD, 34SBD)
- › Laminate Bath Countertops with Stainless Steel Sink
- › Linoleum in Bath, Galley, and Entryway
- › Carpet with Padding in Living Area and Bedroom
- › Soft-Touch Padded Vinyl Ceiling (NA: 30PBS)
- › Wood Slideout Fascia with Wood Inserts
- › Bath and Bedroom Swing Doors (33SDD, 34SBD)
- › TV Cabinet in Bedroom
- › Two Decorative Sofa Pillows in Living Area
- › Decorative Headboard, Bedspread and Pillows
- › Mini Blinds with Valances and Lambrequins

FURNITURE

- › Queen Bed with Innerspring Mattress
- › Fabric Barrel Chair (34SBD Only)
- › Fabric Booth Dinette
- › Fabric Hide-A-Bed Sofa

ELECTRICAL SYSTEMS AND LIGHTS

- › 30 Amp 120V Distribution Panel (30PBS, 32SBT)
- › 50 Amp 120V Distribution Panel (33SDD, 34SBD)
- › 50 Amp Electronic 12V Power Converter

- › Onan® 4.0 kW Generator (30PBS, 32SBT)
- › Onan® 5.5 kW Gas Generator (33SDD, 34SBD)
- › 12V Auxiliary Battery
- › Slide-Out Battery Tray
- › Battery Disconnect Switch
- › 12V Outlet Switch in Cockpit Area
- › Exterior Power Entry Step with Light
- › Water Pump Switch Convenience Center
- › Hallway Convenience Center
- › Lights in Outside Storage Compartments

PLUMBING AND LP SYSTEMS

- › 12V Demand Water System and Water Pump
- › 6-Gallon LP Gas Water Heater (30PBS, 32SBT)
- › 6-Gallon LP Gas/Electric Water Heater with Electronic Ignition and DSI (33SDD, 34SBD)
- › Water Heater Bypass Kit
- › Exterior Shower
- › China Toilet Bowl
- › Gravity Water Fill
- › Contained Storage Area for Sewer Hose
- › Exterior Utility Center
- › Rectangle Shower with Glass Door (30PBS, 34SBD)
- › Neo-Angled Shower with Glass Door (32SBT, 33SDD)

HEATING, VENTS AND AC

- › Single 13.5M BTU AC w/ Ducted Air – Front
- › In-Floor Rigid Heat Ducts
- › 31M BTU Electronic Ignition Furnace (30PBS Only)
- › 35M BTU Electronic Ignition Furnace (N/A: 30PBS)
- › Non-Power Roof Vent in Kitchen and Bedroom
- › 12V Power Roof Vent in Bath

WINDOWS, DOORS AND AWNINGS

- › Dark Tinted Safety Glass Radius Flush-Mount Windows
- › Dual-Pane Windows
- › Patio Awning
- › Topper Slideout Awnings
- › Tinted Plexiglas Skylight in Bath

SAFETY

- › Fire Extinguisher
- › Deadbolt Lock on Entrance Door
- › LP Gas, Smoke and Carbon Monoxide Detectors
- › Pilot/Copilot 3-Point Seatbelts
- › Seatbelts Throughout

BODY CONSTRUCTION

- › Partial Paint (Front Mask and Lower Skirt Painted; Smooth Fiberglass Walls with Paint Option)
- › Deluxe Black Power Heated Exterior Mirrors
- › Canadian RV Certification

COCKPIT

- › Single Camera Rear Vision System
- › 3-Camera Rear Vision System (Requires selection of Single Camera Rear Vision System)
- › Six-Way Power Driver's Seat

APPLIANCES AND ACCESSORIES

- › Half-Time Microwave Oven
- › High-Output 3-Burner Cooktop
- › DVD Player in Living Area
- › Home Theater Surround Sound System w/ DVD Player

- › Exterior Entertainment Center, CD Player w/ Radio and 2 Speakers

INTERIOR

- › Décor: Brass Ring, Autumn Trail II, Amber Fusion
- › Full-Width Linoleum Option
- › Day/Night Shades On All But Kitchen Window

FURNITURE

- › Leatherette Hide-A-Bed Sofa
- › King Bed with Innerspring Mattress (34SBD Only) (N/A with Bunk Bed Option)
- › Hallway Bunk Beds with Two Fold-Down DVD Players w/ Game Hookups and Lights; Wireless Headphones, Bunk Ladder and Two-Drawer Storage Below (34SBD Only) (N/A with King Bed Option)
- › Leatherette Euro Recliner with Ottoman (34SBD Only)

ELECTRICAL SYSTEMS AND LIGHTS

- › 50 Amp Service w/ 6 Gallon Gas/Electric Water Heater (30PBS, 32SBT) (Req. 5.5 kW Gas Generator Option)
- › Onan® 5.5 kW Gas Generator (30PBS, 32SBT) (Req. 50 Amp Service Option)
- › Second Auxiliary Battery

PLUMBING AND LP SYSTEMS

- › 6-Gallon LP Gas/Electric Water Heater with Electronic Ignition and DSI (30PBS, 32SBT) (Req. 50 Amp Service and 5.5 kW Gas Generator Options)

HEATING, VENTS AND AC

- › Single 13.5M BTU AC with Ducted Air in Bedroom
- › 12V Power Roof Vent in Kitchen

ALL ROADS LEAD TO MONACOCOACH.COM

Wherever the road takes you, you're never more than a click away from your friends at Monaco. Just go to monacocoach.com for all the latest product news, club dates and destinations, a dealer locator function, and factory tour information. You can also e-mail us directly through the site at any time.





MONACO®

DRIVING YOUR DREAM.

91320 Coburg Industrial Way, Coburg, OR 97408 | monacocoach.com | 877 252 4666**NAVISTAR****STRONGER THAN EVER.**

When you buy a new Monaco RV, you get all the great things you expect: state-of-the-art products, innovative floorplans and first-class customer service. You also get the confidence that comes with being part of a 175-year-old parent company like Navistar, a world leader in transportation. To learn more about Navistar and its affiliates, visit navistar.com.



MONACO®

DRIVING YOUR DREAM.

91320 Coburg Industrial Way, Coburg, OR 97408 | monacocoach.com | 877 252 4666**NAVISTAR®****STRONGER THAN EVER.**

When you buy a new Monaco RV, you get all the great things you expect: state-of-the-art products, innovative floorplans and first-class customer service. You also get the confidence that comes with being part of a 175-year-old parent company like Navistar, a world leader in transportation. To learn more about Navistar and its affiliates, visit navistar.com.