

STANDARD AND OPTIONAL EQUIPMENT

Specifications	GT24MB
GWR - lbs. (kg)	14500 (6579)
UVW - lbs. (kg)	10646 (4829)
NCC - lbs. (kg)	3854 (1748)
Wheelbase - in. (mm)	167" (4242)
Length Not Incl. Spare - ft. (mm)	24'6" (7467)
Width - ft. (mm)	7'11" (2420)
Height Incl. A/C - ft. (mm)	10'6.5" (3213)
*Fresh Water Cap. - Gal. (L)	36 (137)
Black Holding Tank Cap. - Gal. (L)	32 (122)
Grey Holding Tank Cap. - Gal. (L)	38 (145)
Fuel Cap. - Gal. (L)	40 (151)
Propane Cap. - Gal. (L)	17.5 (66)
Exterior Storage Capacity	30 CU. FT.
<i>* Includes 6 gal. Water Heater - Add 7" to Length for Spare Tire - All Capacities in U.S. Gallons</i>	
Chassis and Suspension	GT24MB
Air Compressor w/ Individual Gauges (Wireless)	0
Block Heater	5
Chassis - Ford 14,500 GVW, E-450, 6.8L EFI V-10 Triton w/ Gas Generator Ready	5
Concealed Locking Fuel Filler	5
Hitch - Trailer Hitch Receiver w/ wiring - 500/5000 lb	5
Rear Airbag Assist Suspension	5
Spare Tire w/Carrier and Continental Cover	5
Tires - Radial Ply	5
Transmission - Automatic 5 Speed c/w Overdrive and Tow Haul Mode	5
Wheel Simulators	5
Drivers Area Conveniences	
Air Conditioning - Chassis	5
Auto Energy Source for Radio	5
Cruise Control and Tilt Steering Wheel	5
Mirror - Interior Rear View Mirror	5
Mirrors - Heated Remote Mirrors	5
Power Windows and Door Locks	5
Radio - In-Dash AM/FM/CD/DVD/GPS Nav./Blue Tooth/Rear View Camera	5
Satellite Radio Prewire - including Antenna	5
Seat - Power Driver's Seat	5
Seat - Ultra Leather Driver's and Passenger's Chairs	5
Wood Grain Dash Trim	5
Vehicular	
Jacks - Stabilizer Electric (2 only)	5
Rust Protection	0
Undercoating - Chassis	5
Construction	
Floor - Steel Framed Vacuum Bonded Insulated Construction	5
Roof - Domed Vacuum Bonded Aluminum Framed Insulated Kermite FRP	5
Sidewalls - Vacuum Bonded Aluminum Framed Insulated with Thermal Break Gel Coat Fiberglass	5
Windows - Frameless Thermal Tinted All Glass Awning Style	5

Exterior	GT24MB
Doors - Flush Radiused Style Baggage Doors	5
Assist Handle - Monogrammed	5
Light - Scare Light w/ Interior Wall Switch	5
Running Boards and Flares - Fiberglass	5
Ladder	5
Paint - Full Body w/ Clear Coat	5
Large Rear Storage Compartment	5
Interior	
Cabinets - Cherry Finished Construction with Contoured Euro Style Doors and Cabinet Ends	5
Ceiling - Flat Padded Vinyl Headliner	5
Detectors - Electronic Smoke, LP and CO	5
Drawers - Full Extension Ball Bearing Tracks	5
Fire Extinguisher - Dry Chemical	5
Flooring - Easy Clean Vinyl Throughout	5
Lighting - Fluorescent and Halogen Accent	5
Privacy Drape - Cab	5
Shades - Pleated Day/Night	5
Skylight - Living Area	5
Furniture	
Desk w/ folding chair	5
Murphy Bed with Residential Quality Queen Bed - 60" x 80"	5
U-Lounge Dinette	5
Galley	
Blind - Venetian Blind in Galley	5
Convection Microwave - OTR c/w Light & Vent Fan	5
Cooktop 3 Burner Glass Top	5
Countertop - Contoured with Wood Bevel & Laminate Edge	5
Faucet - Brushed Nickel Galley Faucet with Pull out Sprayer	5
Garbage Can - Recessed in Counter Top w/ Flush Lid	5
Range Hood	5
Refrigerator - Dometic Double Door LP/Electric 7 Cu. Ft. w/ Raised Panel Inserts	5
Sink - Large Round Stainless Steel Deep Bowl	5
Lavatory	
China Toilet - Foot Flush w/ Sprayer	5
Medicine Cabinets with Swing-Out Double Mirrored Doors	5
Shower c/w Glass Door	5
Sink in Vanity	5
Skylight in Shower	5
Bedroom	
Mattress - Queen Innerspring	5
Shades - Pleated Day/Night/Black Out	5

Entertainment	GT24MB
Entertainment Console - Over Cab with 26" LCD Flat Screen AC TV	5
Satellite Dish - Prewire	5
Satellite Dish - Winegard with Electronic Elevation Sensor	0
Stereo - AM/FM/DVD/CD/Tuner Home Theater	5
TV Antenna - Roof Top Retractable Antenna c/w Booster	5
Heating, Ventilating & A/C	
Air Conditioner - Low Profile 13,500 BTU Ducted c/w Heat Pump	5
Fan - Non Reversible Thermal Controlled Create A Breeze Fan in Galley or Living Area	5
Furnace - 35,000 BTU	5
Vent - 12 Volt Power Roof Exhaust in Lavatory	5
Electrical	
Battery - Second RV Coach (1 Standard)	0
Bi-Directional Isolator Relay Delay (BIRD) Battery Charging	5
Cable TV Hook-up	5
Converter - Power Converter c/w Battery Charger (45 Amp)	5
Cord - 25 Ft. Power Cord	5
Generator - 4.0 KW Onan MicroQuiet* w/ Auto Changeover Switch	5
GFI Receptacle - 110 Volt - Patio, Galley, Lavatory	5
Inverter - 600 watt for Entertainment (requires Second Battery Option)	0
Switch - 12 Volt Battery Disconnect - Manual	5
Plumbing and LP Systems	
Black Tank Flush	5
Exterior Shower w/ Shut Off Valves for Winterizing	5
Macerator - RV Sanicon System	0
Monitor Panel - Grey, Black, Fresh Water and Battery Charge	5
Pick Up Kit - Antifreeze Pick Up Kit	5
Valve - Water Heater By-Pass Valve	5
Water Heater - Electronic Ignition LP/ Electric/ Motoraid	5
Awning Packages	
Patio Awning - A&E 9000 with Aluminum Weather Shield	5
Slide Topper Awning - 1	0
Other	
Factory PDI	0
CSA Certification - Mandatory for Canada	0
RVIA Certification - Mandatory for USA	0

WWW.TRIPLEERV.COM



REGENCY GT GT24MB



ENJOY THE JOURNEY.

Triple E Recreational Vehicles 301 Roblin Boulevard, Winkler, MB, Canada R6W 4C4 Telephone: 204-325-4361 Fax: 204-325-5241

*Product improvement is a continuing process at Triple E RV. Thus we reserve the right to change the specifications on any and all products without prior notice; errors and omissions excepted. Triple E RV is under no obligation to undertake modifications to units manufactured prior to changes in specifications. Units shown with optional equipment. Brochure printed in Canada. 11/2010.

STANDARD AND OPTIONAL EQUIPMENT

Specifications	GT24MB
GWR - lbs. (kg)	14500 (6579)
UVW - lbs. (kg)	10646 (4829)
NCC - lbs. (kg)	3854 (1748)
Wheelbase - in. (mm)	167" (4242)
Length Not Incl. Spare - ft. (mm)	24' 6" (7467)
Width - ft. (mm)	7' 11" (2420)
Height Incl. A/C - ft. (mm)	10' 6.5" (3213)
*Fresh Water Cap. - Gal. (L)	36 (137)
Black Holding Tank Cap. - Gal. (L)	32 (122)
Grey Holding Tank Cap. - Gal. (L)	38 (145)
Fuel Cap. - Gal. (L)	40 (151)
Propane Cap. - Gal. (L)	17.5 (66)
Exterior Storage Capacity	30 CU. FT.
<i>* Includes 6 gal. Water Heater - Add 7" to Length for Spare Tire - All Capacities in U.S. Gallons</i>	
Chassis and Suspension	GT24MB
Air Compressor w/ Individual Gauges (Wireless)	0
Block Heater	S
Chassis - Ford 14,500 GVW, E-450, 6.8L EFI V-10 Triton w/ Gas Generator Ready	S
Concealed Locking Fuel Filler	S
Hitch - Trailer Hitch Receiver w/ wiring - 500/5000 lb	S
Rear Airbag Assist Suspension	S
Spare Tire w/Carrier and Continental Cover	S
Tires - Radial Ply	S
Transmission - Automatic 5 Speed c/w Overdrive and Tow Haul Mode	S
Wheel Simulators	S
Drivers Area Conveniences	
Air Conditioning - Chassis	S
Auto Energy Source for Radio	S
Cruise Control and Tilt Steering Wheel	S
Mirror - Interior Rear View Mirror	S
Mirrors - Heated Remote Mirrors	S
Power Windows and Door Locks	S
Radio - In-Dash AM/FM/CD/DVD/GPS Nav./Blue Tooth/Rear View Camera	S
Satellite Radio Prewire - including Antenna	S
Seat - Power Driver's Seat	S
Seat - Ultra Leather Driver's and Passenger's Chairs	S
Wood Grain Dash Trim	S
Vehicular	
Jacks - Stabilizer Electric (2 only)	S
Rust Protection	0
Undercoating - Chassis	S
Construction	
Floor - Steel Framed Vacuum Bonded Insulated Construction	S
Roof - Domed Vacuum Bonded Aluminum Framed Insulated Kemplite FRP	S
Sidewalls - Vacuum Bonded Aluminum Framed Insulated with Thermal Break Gel Coat Fiberglass	S
Windows - Frameless Thermal Tinted All Glass Awning Style	S

Exterior	GT24MB
Doors - Flush Radiused Style Baggage Doors	S
Assist Handle - Monogrammed	S
Light - Scare Light w/ Interior Wall Switch	S
Running Boards and Flares - Fiberglass	S
Ladder	S
Paint - Full Body w/ Clear Coat	S
Large Rear Storage Compartment	S
Interior	
Cabinets - Cherry Finished Construction with Contoured Euro Style Doors and Cabinet Ends	S
Ceiling - Flat Padded Vinyl Headliner	S
Detectors - Electronic Smoke, LP and CO	S
Drawers - Full Extension Ball Bearing Tracks	S
Fire Extinguisher - Dry Chemical	S
Flooring - Easy Clean Vinyl Throughout	S
Lighting - Fluorescent and Halogen Accent	S
Privacy Drape - Cab	S
Shades - Pleated Day/Night	S
Skylight - Living Area	S
Furniture	
Desk w/ folding chair	S
Murphy Bed with Residential Quality Queen Bed - 60" x 80"	S
U-Lounge Dinette	S
Galley	
Blind - Venetian Blind in Galley	S
Convection Microwave - OTR c/w Light & Vent Fan	S
Cooktop 3 Burner Glass Top	S
Countertop - Contoured with Wood Bevel & Laminate Edge	S
Faucet - Brushed Nickel Galley Faucet with Pull out Sprayer	S
Garbage Can - Recessed in Counter Top w/ Flush Lid	S
Range Hood	S
Refrigerator - Dometic Double Door LP/Electric 7 Cu. Ft. w/ Raised Panel Inserts	S
Sink - Large Round Stainless Steel Deep Bowl	S
Lavatory	
China Toilet - Foot Flush w/ Sprayer	S
Medicine Cabinets with Swing-Out Double Mirrored Doors	S
Shower c/w Glass Door	S
Sink in Vanity	S
Skylight in Shower	S
Bedroom	
Mattress - Queen Innerspring	S
Shades - Pleated Day/Night/Black Out	S

Entertainment	GT24MB
Entertainment Console - Over Cab with 26" LCD Flat Screen AC TV	S
Satellite Dish - Prewire	S
Satellite Dish - Winegard with Electronic Elevation Sensor	0
Stereo - AM/FM/DVD/CD/Tuner Home Theater	S
TV Antenna - Roof Top Retractable Antenna c/w Booster	S
Heating, Ventilating & A/C	
Air Conditioner - Low Profile 13,500 BTU Ducted c/w Heat Pump	S
Fan - Non Reversible Thermal Controlled Create A Breeze Fan in Galley or Living Area	S
Furnace - 35,000 BTU	S
Vent - 12 Volt Power Roof Exhaust in Lavatory	S
Electrical	
Battery - Second RV Coach (1 Standard)	0
Bi-Directional Isolator Relay Delay (BIRD) Battery Charging	S
Cable TV Hook-up	S
Converter - Power Converter c/w Battery Charger (45 Amp)	S
Cord - 25 Ft. Power Cord	S
Generator - 4.0 KW Onan MicroQuiet* w/ Auto Changeover Switch	S
GFI Receptacle - 110 Volt - Patio, Galley, Lavatory	S
Inverter - 600 watt for Entertainment (requires Second Battery Option)	0
Switch - 12 Volt Battery Disconnect - Manual	S
Plumbing and LP Systems	
Black Tank Flush	S
Exterior Shower w/ Shut Off Valves for Winterizing	S
Macerator - RV Sanicon System	0
Monitor Panel - Grey, Black, Fresh Water and Battery Charge	S
Pick Up Kit - Antifreeze Pick Up Kit	S
Valve - Water Heater By-Pass Valve	S
Water Heater - Electronic Ignition LP/ Electric/ Motoraid	S
Awning Packages	
Patio Awning - A&E 9000 with Aluminum Weather Shield	S
Slide Topper Awning - 1	0
Other	
Factory PDI	0
CSA Certification - Mandatory for Canada	0
RVIA Certification - Mandatory for USA	0

WWW.TRIPLEERV.COM



REGENCY GT GT24MB



ENJOY THE JOURNEY.

Triple E Recreational Vehicles 301 Roblin Boulevard, Winkler, MB, Canada R6W 4C4 Telephone: 204-325-4361 Fax: 204-325-5241

*Product improvement is a continuing process at Triple E RV. Thus we reserve the right to change the specifications on any and all products without prior notice; errors and omissions excepted. Triple E RV is under no obligation to undertake modifications to units manufactured prior to changes in specifications. Units shown with optional equipment. Brochure printed in Canada. 11/2010.



Savour the offerings of this fully equipped galley, complete with 3 burner glass top cooktop and convection microwave set in an abundance of cherry finished cabinetry.

ADVENTURE AWAITS

They say that good things come in small packages, and at 24'; this motorhome proves it's true! From front to back, you'll find that every available space has been carefully designed to ensure you maintain all the luxuries of a bigger RV, while offering exceptional maneuverability on the highway or in the city. Treat yourself to the gift of freedom today!



Monochrome Exterior Colour



Shiraz Exterior Colour



Next to the 7.0 cu ft Dometic refrigerator, you'll find a hidden jewel – a large pullout pantry for additional food storage!



The spacious design of the GT24MB is outstanding! The cozy workstation is a great place to surf the net on your laptop, while the luxurious u-lounge dinette provides comfortable dinner seating for 4, accented by tasteful art mounted on the wall behind it.



The washroom just might be the piece de resistance of the GT24MB floorplan! Boasting a large shower with glass doors and skylight, mirrored door medicine cabinet, and more storage space than you could imagine, you'll have to see it to believe it!



A hanging wardrobe assists in keeping your clothes organized and wrinkle-free.



At night, convert the living area to this beautiful sleeping space by lowering the Murphy Bed onto the base created by folding down the dinette. You're sure to enjoy a great night's rest on the comfortable 60" x 80" queen bed.

FLOORPLAN

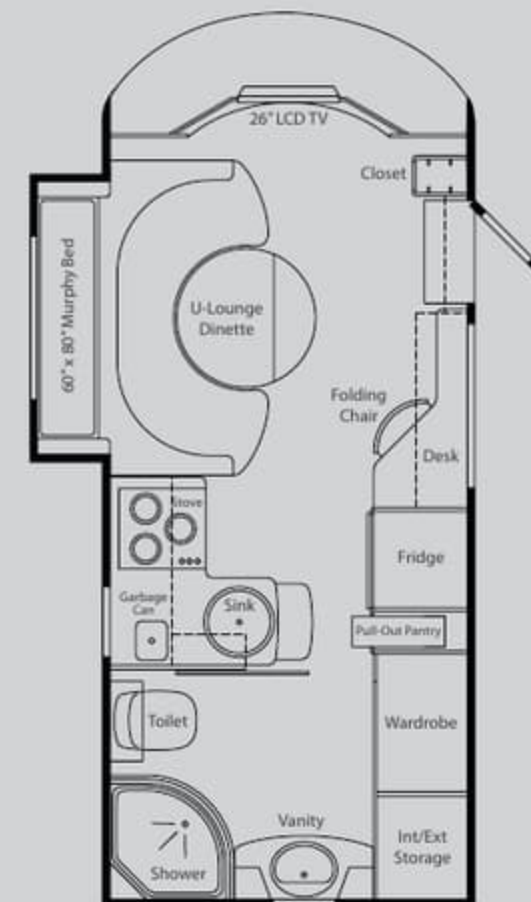

Enjoy the convenience of a coat closet next to the front door, providing easy access to jackets, flashlights, and other items you may want to grab on your way out.

ADVENTURE AWAITS

They say that good things come in small packages, and at 24'; this motorhome proves it's true! From front to back, you'll find that every available space has been carefully designed to ensure you maintain all the luxuries of a bigger RV, while offering exceptional maneuverability on the highway or in the city. Treat yourself to the gift of freedom today!



Monochrome Exterior Colour



Shiraz Exterior Colour



Savour the offerings of this fully equipped galley, complete with 3 burner glass top cooktop and convection microwave set in an abundance of cherry finished cabinetry.



Next to the 7.0 cu ft Dometic refrigerator, you'll find a hidden jewel - a large pullout pantry for additional food storage!



The spacious design of the GT24MB is outstanding! The cozy workstation is a great place to surf the net on your laptop, while the luxurious u-lounge dinette provides comfortable dinner seating for 4, accented by tasteful art mounted on the wall behind it.



The washroom just might be the piece de resistance of the GT24MB floorplan! Boasting a large shower with glass doors and skylight, mirrored door medicine cabinet, and more storage space than you could imagine, you'll have to see it to believe it!



A hanging wardrobe assists in keeping your clothes organized and wrinkle-free.



At night, convert the living area to this beautiful sleeping space by lowering the Murphy Bed onto the base created by folding down the dinette. You're sure to enjoy a great night's rest on the comfortable 60" x 80" queen bed.

FLOORPLAN

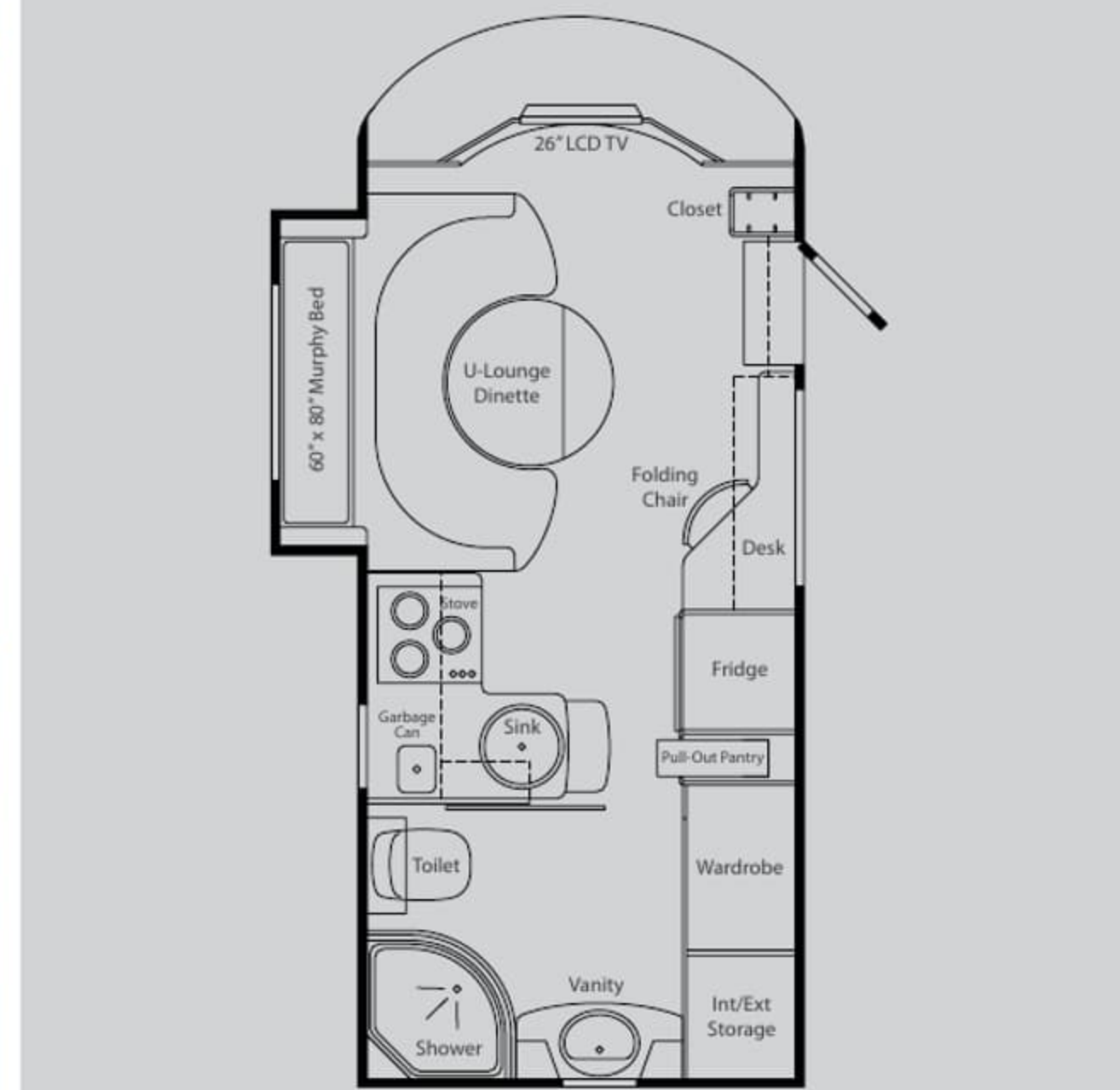

Enjoy the convenience of a coat closet next to the front door, providing easy access to jackets, flashlights, and other items you may want to grab on your way out.



Savour the offerings of this fully equipped galley, complete with 3 burner glass top cooktop and convection microwave set in an abundance of cherry finished cabinetry.

ADVENTURE AWAITS

They say that good things come in small packages, and at 24'; this motorhome proves it's true! From front to back, you'll find that every available space has been carefully designed to ensure you maintain all the luxuries of a bigger RV, while offering exceptional maneuverability on the highway or in the city. Treat yourself to the gift of freedom today!



Monochrome Exterior Colour



Shiraz Exterior Colour



Next to the 7.0 cu ft Dometic refrigerator, you'll find a hidden jewel – a large pullout pantry for additional food storage!



The spacious design of the GT24MB is outstanding! The cozy workstation is a great place to surf the net on your laptop, while the luxurious u-lounge dinette provides comfortable dinner seating for 4, accented by tasteful art mounted on the wall behind it.



The washroom just might be the piece de resistance of the GT24MB floorplan! Boasting a large shower with glass doors and skylight, mirrored door medicine cabinet, and more storage space than you could imagine, you'll have to see it to believe it!



A hanging wardrobe assists in keeping your clothes organized and wrinkle-free.



At night, convert the living area to this beautiful sleeping space by lowering the Murphy Bed onto the base created by folding down the dinette. You're sure to enjoy a great night's rest on the comfortable 60" x 80" queen bed.

FLOORPLAN

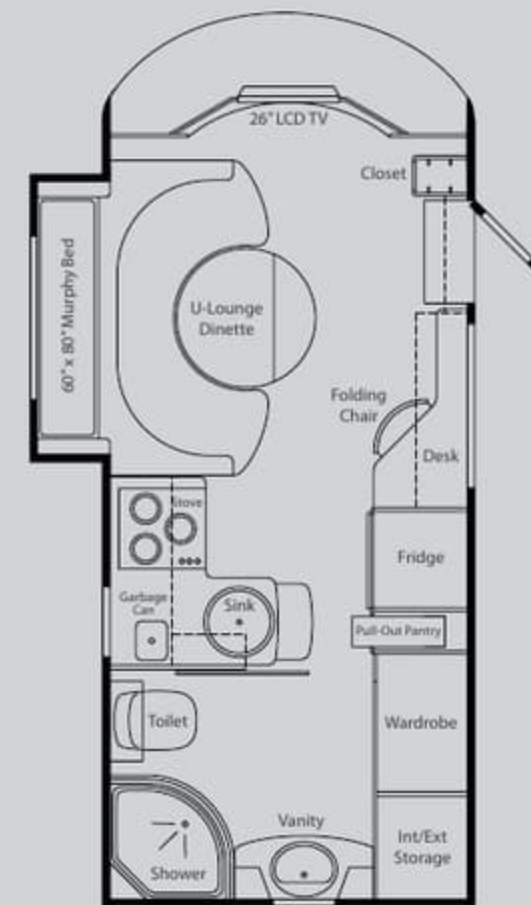

Enjoy the convenience of a coat closet next to the front door, providing easy access to jackets, flashlights, and other items you may want to grab on your way out.

ADVENTURE AWAITS

They say that good things come in small packages, and at 24', this motorhome proves it's true! From front to back, you'll find that every available space has been carefully designed to ensure you maintain all the luxuries of a bigger RV, while offering exceptional maneuverability on the highway or in the city. Treat yourself to the gift of freedom today!



Monochrome Exterior Colour



Shiraz Exterior Colour



Savour the offerings of this fully equipped galley, complete with 3 burner glass top cooktop and convection microwave set in an abundance of cherry finished cabinetry.



Next to the 7.0 cu ft Dometic refrigerator, you'll find a hidden jewel - a large pullout pantry for additional food storage!



The spacious design of the GT24MB is outstanding! The cozy workstation is a great place to surf the net on your laptop, while the luxurious u-lounge dinette provides comfortable dinner seating for 4, accented by tasteful art mounted on the wall behind it.



The washroom just might be the piece de resistance of the GT24MB floorplan! Boasting a large shower with glass doors and skylight, mirrored door medicine cabinet, and more storage space than you could imagine, you'll have to see it to believe it!



A hanging wardrobe assists in keeping your clothes organized and wrinkle-free.



At night, convert the living area to this beautiful sleeping space by lowering the Murphy Bed onto the base created by folding down the dinette. You're sure to enjoy a great night's rest on the comfortable 60" x 80" queen bed.

FLOORPLAN

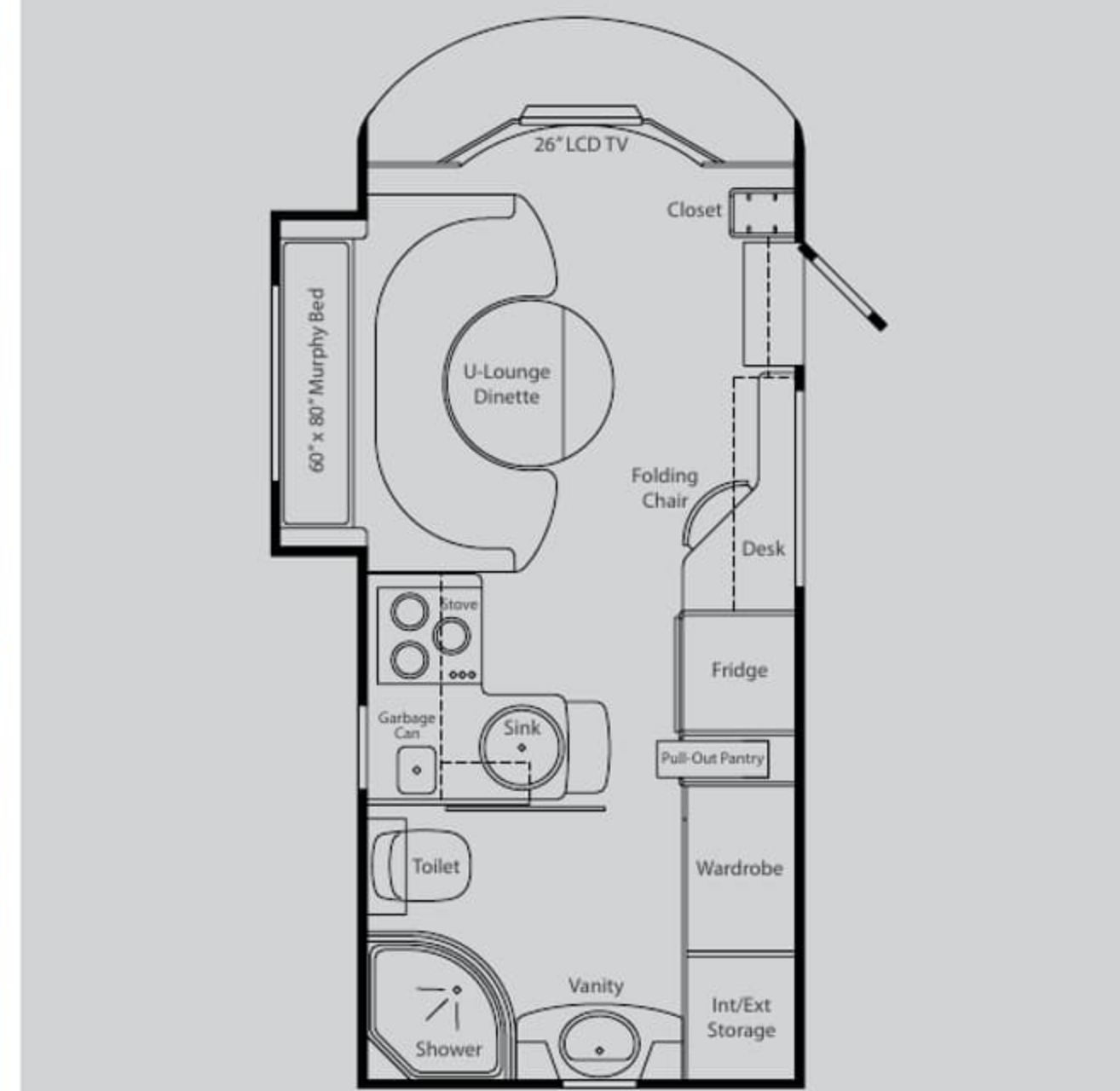

Enjoy the convenience of a coat closet next to the front door, providing easy access to jackets, flashlights, and other items you may want to grab on your way out.

STANDARD AND OPTIONAL EQUIPMENT

Specifications	GT24MB
GWR - lbs. (kg)	14500 (6579)
UVW - lbs. (kg)	10646 (4829)
NCC - lbs. (kg)	3854 (1748)
Wheelbase - in. (mm)	167" (4242)
Length Not Incl. Spare - ft. (mm)	24'6" (7467)
Width - ft. (mm)	7'11" (2420)
Height Incl. A/C - ft. (mm)	10'6.5" (3213)
*Fresh Water Cap. - Gal. (L)	36 (137)
Black Holding Tank Cap. - Gal. (L)	32 (122)
Grey Holding Tank Cap. - Gal. (L)	38 (145)
Fuel Cap. - Gal. (L)	40 (151)
Propane Cap. - Gal. (L)	17.5 (66)
Exterior Storage Capacity	30 CU. FT.
<i>* Includes 6 gal. Water Heater - Add 7" to Length for Spare Tire - All Capacities in U.S. Gallons</i>	
Chassis and Suspension	GT24MB
Air Compressor w/ Individual Gauges (Wireless)	0
Block Heater	S
Chassis - Ford 14,500 GVW, E-450, 6.8L EFI V-10 Triton w/ Gas Generator Ready	S
Concealed Locking Fuel Filler	S
Hitch - Trailer Hitch Receiver w/ wiring - 500/5000 lb	S
Rear Airbag Assist Suspension	S
Spare Tire w/Carrier and Continental Cover	S
Tires - Radial Ply	S
Transmission - Automatic 5 Speed c/w Overdrive and Tow Haul Mode	S
Wheel Simulators	S
Drivers Area Conveniences	GT24MB
Air Conditioning - Chassis	S
Auto Energy Source for Radio	S
Cruise Control and Tilt Steering Wheel	S
Mirror - Interior Rear View Mirror	S
Mirrors - Heated Remote Mirrors	S
Power Windows and Door Locks	S
Radio - In-Dash AM/FM/CD/DVD/GPS Nav./Blue Tooth/Rear View Camera	S
Satellite Radio Prewire - including Antenna	S
Seat - Power Driver's Seat	S
Seat - Ultra Leather Driver's and Passenger's Chairs	S
Wood Grain Dash Trim	S
Vehicular	GT24MB
Jacks - Stabilizer Electric (2 only)	S
Rust Protection	0
Undercoating - Chassis	S
Construction	GT24MB
Floor - Steel Framed Vacuum Bonded Insulated Construction	S
Roof - Domed Vacuum Bonded Aluminum Framed Insulated Kermite FRP	S
Sidewalls - Vacuum Bonded Aluminum Framed Insulated with Thermal Break Gel Coat Fiberglass	S
Windows - Frameless Thermal Tinted All Glass Awning Style	S

Exterior	GT24MB
Doors - Flush Radiused Style Baggage Doors	S
Assist Handle - Monogrammed	S
Light - Scare Light w/ Interior Wall Switch	S
Running Boards and Flares - Fiberglass	S
Ladder	S
Paint - Full Body w/ Clear Coat	S
Large Rear Storage Compartment	S
Interior	GT24MB
Cabinets - Cherry Finished Construction with Contoured Euro Style Doors and Cabinet Ends	S
Ceiling - Flat Padded Vinyl Headliner	S
Detectors - Electronic Smoke, LP and CO	S
Drawers - Full Extension Ball Bearing Tracks	S
Fire Extinguisher - Dry Chemical	S
Flooring - Easy Clean Vinyl Throughout	S
Lighting - Fluorescent and Halogen Accent	S
Privacy Drape - Cab	S
Shades - Pleated Day/Night	S
Skylight - Living Area	S
Furniture	GT24MB
Desk w/ folding chair	S
Murphy Bed with Residential Quality Queen Bed - 60" x 80"	S
U-Lounge Dinette	S
Galley	GT24MB
Blind - Venetian Blind in Galley	S
Convection Microwave - OTR c/w Light & Vent Fan	S
Cooktop 3 Burner Glass Top	S
Countertop - Contoured with Wood Bevel & Laminate Edge	S
Faucet - Brushed Nickel Galley Faucet with Pull out Sprayer	S
Garbage Can - Recessed in Counter Top w/ Flush Lid	S
Range Hood	S
Refrigerator - Dometic Double Door LP/Electric 7 Cu. Ft. w/ Raised Panel Inserts	S
Sink - Large Round Stainless Steel Deep Bowl	S
Lavatory	GT24MB
China Toilet - Foot Flush w/ Sprayer	S
Medicine Cabinets with Swing-Out Double Mirrored Doors	S
Shower c/w Glass Door	S
Sink in Vanity	S
Skylight in Shower	S
Bedroom	GT24MB
Mattress - Queen Innerspring	S
Shades - Pleated Day/Night/Black Out	S

Entertainment	GT24MB
Entertainment Console - Over Cab with 26" LCD Flat Screen AC TV	S
Satellite Dish - Prewire	S
Satellite Dish - Winegard with Electronic Elevation Sensor	0
Stereo - AM/FM/DVD/CD/Tuner Home Theater	S
TV Antenna - Roof Top Retractable Antenna c/w Booster	S
Heating, Ventilating & A/C	GT24MB
Air Conditioner - Low Profile 13,500 BTU Ducted c/w Heat Pump	S
Fan - Non Reversible Thermal Controlled Create A Breeze Fan in Galley or Living Area	S
Furnace - 35,000 BTU	S
Vent - 12 Volt Power Roof Exhaust in Lavatory	S
Electrical	GT24MB
Battery - Second RV Coach (1 Standard)	0
Bi-Directional Isolator Relay Delay (BIRD) Battery Charging	S
Cable TV Hook-up	S
Converter - Power Converter c/w Battery Charger (45 Amp)	S
Cord - 25 Ft. Power Cord	S
Generator - 4.0 KW Onan MicroQuiet* w/ Auto Changeover Switch	S
GFI Receptacle - 110 Volt - Patio, Galley, Lavatory	S
Inverter - 600 watt for Entertainment (requires Second Battery Option)	0
Switch - 12 Volt Battery Disconnect - Manual	S
Plumbing and LP Systems	GT24MB
Black Tank Flush	S
Exterior Shower w/ Shut Off Valves for Winterizing	S
Macerator - RV Sanicon System	0
Monitor Panel - Grey, Black, Fresh Water and Battery Charge	S
Pick Up Kit - Antifreeze Pick Up Kit	S
Valve - Water Heater By-Pass Valve	S
Water Heater - Electronic Ignition LP/ Electric/ Motoraid	S
Awning Packages	GT24MB
Patio Awning - A&E 9000 with Aluminum Weather Shield	S
Slide Topper Awning - 1	0
Other	GT24MB
Factory PDI	0
CSA Certification - Mandatory for Canada	0
RVIA Certification - Mandatory for USA	0

WWW.TRIPLEERV.COM



REGENCY GT GT24MB



ENJOY THE JOURNEY.

Triple E Recreational Vehicles 301 Roblin Boulevard, Winkler, MB, Canada R6W 4C4 Telephone: 204-325-4361 Fax: 204-325-5241

*Product improvement is a continuing process at Triple E RV. Thus we reserve the right to change the specifications on any and all products without prior notice; errors and omissions excepted. Triple E RV is under no obligation to undertake modifications to units manufactured prior to changes in specifications. Units shown with optional equipment. Brochure printed in Canada. 11/2010.

STANDARD AND OPTIONAL EQUIPMENT

Specifications	GT24MB
GWR - lbs. (kg)	14500 (6579)
UVW - lbs. (kg)	10646 (4829)
NCC - lbs. (kg)	3854 (1748)
Wheelbase - in. (mm)	167" (4242)
Length Not Incl. Spare - ft. (mm)	24' 6" (7467)
Width - ft. (mm)	7' 11" (2420)
Height Incl. A/C - ft. (mm)	10' 6.5" (3213)
*Fresh Water Cap. - Gal. (L)	36 (137)
Black Holding Tank Cap. - Gal. (L)	32 (122)
Grey Holding Tank Cap. - Gal. (L)	38 (145)
Fuel Cap. - Gal. (L)	40 (151)
Propane Cap. - Gal. (L)	17.5 (66)
Exterior Storage Capacity	30 CU. FT.
<i>* Includes 6 gal. Water Heater - Add 7" to Length for Spare Tire - All Capacities in U.S. Gallons</i>	
Chassis and Suspension	GT24MB
Air Compressor w/ Individual Gauges (Wireless)	0
Block Heater	S
Chassis - Ford 14,500 GVW, E-450, 6.8L EFI V-10 Triton w/ Gas Generator Ready	S
Concealed Locking Fuel Filler	S
Hitch - Trailer Hitch Receiver w/ wiring - 500/5000 lb	S
Rear Airbag Assist Suspension	S
Spare Tire w/Carrier and Continental Cover	S
Tires - Radial Ply	S
Transmission - Automatic 5 Speed c/w Overdrive and Tow Haul Mode	S
Wheel Simulators	S
Drivers Area Conveniences	
Air Conditioning - Chassis	S
Auto Energy Source for Radio	S
Cruise Control and Tilt Steering Wheel	S
Mirror - Interior Rear View Mirror	S
Mirrors - Heated Remote Mirrors	S
Power Windows and Door Locks	S
Radio - In-Dash AM/FM/CD/DVD/GPS Nav./Blue Tooth/Rear View Camera	S
Satellite Radio Prewire - including Antenna	S
Seat - Power Driver's Seat	S
Seat - Ultra Leather Driver's and Passenger's Chairs	S
Wood Grain Dash Trim	S
Vehicular	
Jacks - Stabilizer Electric (2 only)	S
Rust Protection	0
Undercoating - Chassis	S
Construction	
Floor - Steel Framed Vacuum Bonded Insulated Construction	S
Roof - Domed Vacuum Bonded Aluminum Framed Insulated Kemplite FRP	S
Sidewalls - Vacuum Bonded Aluminum Framed Insulated with Thermal Break Gel Coat Fiberglass	S
Windows - Frameless Thermal Tinted All Glass Awning Style	S

Exterior	GT24MB
Doors - Flush Radiused Style Baggage Doors	S
Assist Handle - Monogrammed	S
Light - Scare Light w/ Interior Wall Switch	S
Running Boards and Flares - Fiberglass	S
Ladder	S
Paint - Full Body w/ Clear Coat	S
Large Rear Storage Compartment	S
Interior	
Cabinets - Cherry Finished Construction with Contoured Euro Style	S
Doors and Cabinet Ends	S
Ceiling - Flat Padded Vinyl Headliner	S
Detectors - Electronic Smoke, LP and CO	S
Drawers - Full Extension Ball Bearing Tracks	S
Fire Extinguisher - Dry Chemical	S
Flooring - Easy Clean Vinyl Throughout	S
Lighting - Fluorescent and Halogen Accent	S
Privacy Drape - Cab	S
Shades - Pleated Day/Night	S
Skylight - Living Area	S
Furniture	
Desk w/ folding chair	S
Murphy Bed with Residential Quality Queen Bed - 60" x 80"	S
U-Lounge Dinette	S
Galley	
Blind - Venetian Blind in Galley	S
Convection Microwave - OTR c/w Light & Vent Fan	S
Cooktop 3 Burner Glass Top	S
Countertop - Contoured with Wood Bevel & Laminate Edge	S
Faucet - Brushed Nickel Galley Faucet with Pull out Sprayer	S
Garbage Can - Recessed in Counter Top w/ Flush Lid	S
Range Hood	S
Refrigerator - Dometic Double Door LP/Electric 7 Cu. Ft. w/ Raised Panel Inserts	S
Sink - Large Round Stainless Steel Deep Bowl	S
Lavatory	
China Toilet - Foot Flush w/ Sprayer	S
Medicine Cabinets with Swing-Out Double Mirrored Doors	S
Shower c/w Glass Door	S
Sink in Vanity	S
Skylight in Shower	S
Bedroom	
Mattress - Queen Innerspring	S
Shades - Pleated Day/Night/Black Out	S

Entertainment	GT24MB
Entertainment Console - Over Cab with 26" LCD Flat Screen AC TV	S
Satellite Dish - Prewire	S
Satellite Dish - Winegard with Electronic Elevation Sensor	0
Stereo - AM/FM/DVD/CD/Tuner Home Theater	S
TV Antenna - Roof Top Retractable Antenna c/w Booster	S
Heating, Ventilating & A/C	
Air Conditioner - Low Profile 13,500 BTU Ducted c/w Heat Pump	S
Fan - Non Reversible Thermal Controlled Create A Breeze Fan in Galley or Living Area	S
Furnace - 35,000 BTU	S
Vent - 12 Volt Power Roof Exhaust in Lavatory	S
Electrical	
Battery - Second RV Coach (1 Standard)	0
Bi-Directional Isolator Relay Delay (BIRD) Battery Charging	S
Cable TV Hook-up	S
Converter - Power Converter c/w Battery Charger (45 Amp)	S
Cord - 25 Ft. Power Cord	S
Generator - 4.0 KW Onan MicroQuiet* w/ Auto Changeover Switch	S
GFI Receptacle - 110 Volt - Patio, Galley, Lavatory	S
Inverter - 600 watt for Entertainment (requires Second Battery Option)	0
Switch - 12 Volt Battery Disconnect - Manual	S
Plumbing and LP Systems	
Black Tank Flush	S
Exterior Shower w/ Shut Off Valves for Winterizing	S
Macerator - RV Sanicon System	0
Monitor Panel - Grey, Black, Fresh Water and Battery Charge	S
Pick Up Kit - Antifreeze Pick Up Kit	S
Valve - Water Heater By-Pass Valve	S
Water Heater - Electronic Ignition LP/ Electric/ Motoraid	S
Awning Packages	
Patio Awning - A&E 9000 with Aluminum Weather Shield	S
Slide Topper Awning - 1	0
Other	
Factory PDI	0
CSA Certification - Mandatory for Canada	0
RVIA Certification - Mandatory for USA	0

WWW.TRIPLEERV.COM



REGENCY GT GT24MB



ENJOY THE JOURNEY.

Triple E Recreational Vehicles 301 Roblin Boulevard, Winkler, MB, Canada R6W 4C4 Telephone: 204-325-4361 Fax: 204-325-5241

*Product improvement is a continuing process at Triple E RV. Thus we reserve the right to change the specifications on any and all products without prior notice; errors and omissions excepted. Triple E RV is under no obligation to undertake modifications to units manufactured prior to changes in specifications. Units shown with optional equipment. Brochure printed in Canada. 11/2010.