

# North Trail

BY HEARTLAND





# North Trail

BY HEARTLAND







32 BUDS



26 LRSS

### Spacious Living Rooms

*Relax, Entertain and Unwind.*

You will appreciate the openness of North Trail's layouts. That gives your whole family room to relax and enjoy the built in entertainment center. Oversized windows let in plenty of natural light and spectacular views of outdoors.



Caliber 32 BUDS





32 BUDS



26 LRSS

### Spacious Living Rooms

*Relax, Entertain and Unwind.*

You will appreciate the openness of North Trail's layouts. That gives your whole family room to relax and enjoy the built in entertainment center. Oversized windows let in plenty of natural light and spectacular views of outdoors.



Caliber 32 BUDS





Caliber 22 FBS

### **Chef's Kitchen**

*For the chef in the family*

While large kitchens like this are typically reserved for coaches costing thousands more, this NORTH TRAIL model provides an efficient wide-open prep area, as well as large base cabinet and overhead storage for that extended vacation. Our three burner range with oven and microwave make meals a snap and huge residential sinks make cleanup a breeze.



### **Dinette**

*Dinner for Four or More.*

Enjoy our freestanding table and chairs or the traditional booth style dinette with a table that you can take outside to your patio. For parties of six choose one of our models that feature the Mega-Booth dinette.







Caliber 22 FBS

## Chef's Kitchen

*For the chef in the family*

While large kitchens like this are typically reserved for coaches costing thousands more, this NORTH TRAIL model provides an efficient wide-open prep area, as well as large base cabinet and overhead storage for that extended vacation. Our three burner range with oven and microwave make meals a snap and huge residential sinks make cleanup a breeze.



## Dinette

*Dinner for Four or More.*

Enjoy our freestanding table and chairs or the traditional booth style dinette with a table that you can take outside to your patio. For parties of six choose one of our models that feature the Mega-Booth dinette.





## Bedroom Suite

### *Comfort and Convenience*

Comfortable sleep is half the point of a vacation and North Trail delivers. Our bedrooms feature queen size beds with room to walk around, nightstands and reading lights. Get a good nights rest for the exciting day ahead.



## Storage Solutions

### *A Place for Everything...*

Look at all the storage possibilities. His and hers wardrobe along with overheads above the bed. In addition, there is Under-bed Storage and dresser drawers in select models.



## Bedroom Suite

### *Comfort and Convenience*

Comfortable sleep is half the point of a vacation and North Trail delivers. Our bedrooms feature queen size beds with room to walk around, night-stands and reading lights. Get a good nights rest for the exciting day ahead.



## Storage Solutions

### *A Place for Everything...*

Look at all the storage possibilities. His and hers wardrobe along with overheads above the bed. In addition, there is Under-bed Storage and dresser drawers in select models.





Caliber 32 BUDS



### Bathroom

*Private and functional.*

Efficiently designed North Trail bathrooms give you the room you need to prepare for the day ahead or clean-up afterwards.



### Family Bunk Rooms

*Designed for family fun.*

North Trail offers many great bunk rooms complete with sofa-beds, kiddie dinettes, bunk beds and even entertainment centers with built in storage for all the kids cloths and gear.







Caliber 32 BUDS



### Bathroom

*Private and functional.*

Efficiently designed North Trail bathrooms give you the room you need to prepare for the day ahead or clean-up afterwards.



### Family Bunk Rooms

*Designed for family fun.*

North Trail offers many great bunk rooms complete with sofa-beds, kiddie dinettes, bunk beds and even entertainment centers with built in storage for all the kids cloths and gear.





# YOUR LAMINATED WORLD...



Some companies stand behind their products. We stand on top of ours. These 21 North Trail employees are so confident in the quality of their own work they eagerly jumped at the opportunity to demonstrate the strength and durability of Heartland's laminated construction.



## LAMINATED FLOOR SYSTEM

NORTH TRAIL's LAMINATED Floor System is one of the **STRONGEST FLOORS** in the industry! Featuring sturdy 2.5" Aluminum Framing; thick Block Foam Insulation; One-Piece Seamless Decking and a Thermo-Board Luan on the bottom. All of this is Laminated together for Maximum Strength and Insulation R Value - virtually eliminating flex in the floor!



**NORTH TRAIL's LAMINATED Floor Construction** easily supported over 1,800 lbs. of Water Jugs in one spot - resulting in less than 1/4" of flex!!

Heartland builds recreational vehicles with as many residential features and construction methods as possible and we are excited to introduce this 3" Laminated Floor System in our King Slide Travel Trailers. Choose Heartland for Maximum Strength; Maximum Insulation Value; and Minimal Flex!!



**OVER 1,500 lbs.!**

While you want to avoid walking on other light weight towables roofs - we were able to easily put this Rhino™ four wheeler with a driver on the roof of the NORTH TRAIL Trailer featuring ALL ALUMINUM trusses with tapered Block Foam Bricks - laminated together for a longer lasting, much **STRONGER** construction!



**HEARTLAND's 3"\***  
**LAMINATED FLOOR**

\* 3" Floor construction on King Slide Travel Trailers.  
2" Floor construction on Travel Trailers.



# YOUR LAMINATED WORLD...



Some companies stand behind their products. We stand on top of ours. These 21 North Trail employees are so confident in the quality of their own work they eagerly jumped at the opportunity to demonstrate the strength and durability of Heartland's laminated construction.



## LAMINATED FLOOR SYSTEM

NORTH TRAIL's LAMINATED Floor System is one of the **STRONGEST FLOORS** in the industry! Featuring sturdy 2.5" Aluminum Framing; thick Block Foam Insulation; One-Piece Seamless Decking and a Thermo-Board Luan on the bottom. All of this is Laminated together for Maximum Strength and Insulation R Value - virtually eliminating flex in the floor!



**NORTH TRAIL's LAMINATED Floor Construction** easily supported over 1,800 lbs. of Water Jugs in one spot - resulting in less than 1/4" of flex!!



**OVER 1,500 lbs.!**

While you want to avoid walking on other light weight towables roofs - we were able to easily put this Rhino™ four wheeler with a driver on the roof of the NORTH TRAIL Trailer featuring ALL ALUMINUM trusses with tapered Block Foam Bricks - laminated together for a longer lasting, much **STRONGER** construction!

Heartland builds recreational vehicles with as many residential features and construction methods as possible and we are excited to introduce this 3" Laminated Floor System in our King Slide Travel Trailers. Choose Heartland for Maximum Strength; Maximum Insulation Value; and Minimal Flex!!



**HEARTLAND's 3"\* LAMINATED FLOOR**

\* 3" Floor construction on King Slide Travel Trailers.  
2" Floor construction on Travel Trailers.



# Strength, Durability & Comfort BEYOND COMPARE!

## LAMINATED ROOF SYSTEM

The combination of these three systems bring you the Strongest and Lightest construction available while also providing unparalleled noise reduction, thermal insulation and durability. Protecting your investment is important to HEARTLAND. Laminated construction provides that protection in addition to offering peace of mind that you will be spending more time enjoying your family and travels than worrying about repairing your RV.



### BEST-IN-CLASS

- INSULATION - R VALUE
- NOISE REDUCTION
- DURABILITY
- STRENGTH
- LOOKS

- RUBBER SKIN
- WOOD DECKING
- BLOCK FOAM INSULATION
- ALUMINUM RIBS & PERIMETER
- DECORATIVE, TEXTURED CEILING VINYL

**3 INCHES - FIVE LAYERS**



## LAMINATED WALL SYSTEM

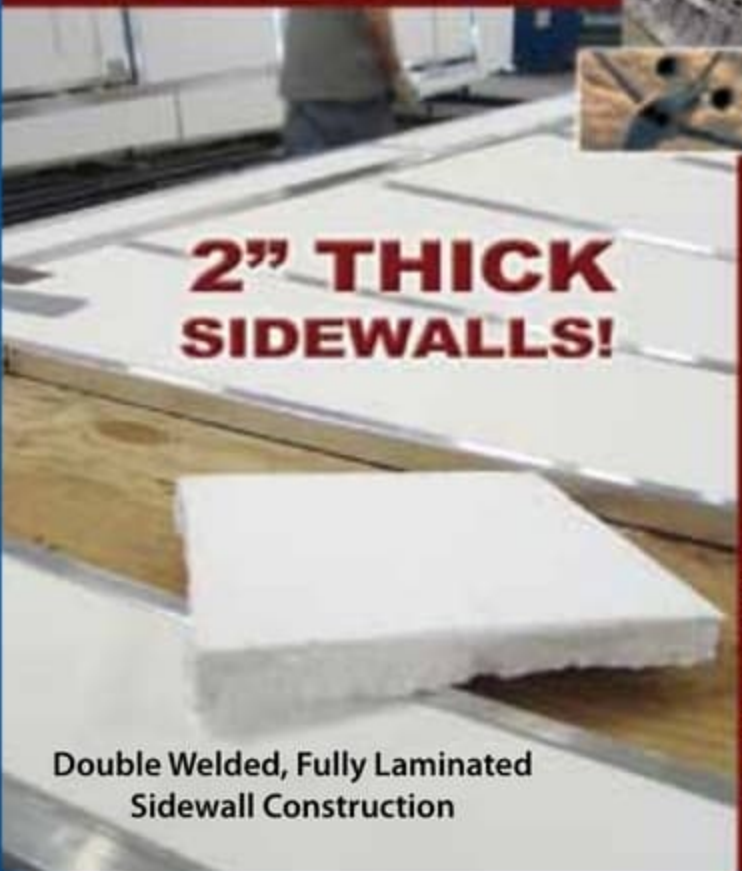

**2" THICK SIDEWALLS!**

Lightweight ALUMINUM



Just an 1/8" thick foam cup protects your hand from scalding hot coffee... imagine what nearly 2" of block foam does for your Laminated Heartland Sidewall!

Double Welded, Fully Laminated Sidewall Construction

# Strength, Durability & Comfort BEYOND COMPARE!

### SOUND BARRIER



### THERMAL EFFICIENT



### SUPER STRENGTH





# Strength, Durability & Comfort BEYOND COMPARE!

## LAMINATED ROOF SYSTEM

The combination of these three systems bring you the Strongest and Lightest construction available while also providing unparalleled noise reduction, thermal insulation and durability. Protecting your investment is important to HEARTLAND. Laminated construction provides that protection in addition to offering peace of mind that you will be spending more time enjoying your family and travels than worrying about repairing your RV.



### BEST-IN-CLASS

- INSULATION - R VALUE
- NOISE REDUCTION
- DURABILITY
- STRENGTH
- LOOKS

- RUBBER SKIN
- WOOD DECKING
- BLOCK FOAM INSULATION
- ALUMINUM RIBS & PERIMETER
- DECORATIVE, TEXTURED CEILING VINYL

**3 INCHES - FIVE LAYERS**



## Strength, Durability & Comfort BEYOND COMPARE!

## LAMINATED WALL SYSTEM



Lightweight ALUMINUM

**2" THICK SIDEWALLS!**



Just an 1/8" thick foam cup protects your hand from scalding hot coffee... imagine what nearly 2" of block foam does for your Laminated Heartland Sidewall!

Double Welded, Fully Laminated Sidewall Construction

### SOUND BARRIER



### THERMAL EFFICIENT



### SUPER STRENGTH







### Large Pass Through Storage With Thick Insulated Doors

Easily store larger items such as this cooler or long fishing poles. Thick, insulated compartment doors and rubber seals protect your cargo.

### Exterior Shower

The perfect solution for messy feet and washing pets. Keep the mess outside.



### Covered LP Tanks

Protect your tanks and have easy access to the valves without removing the cover.

### Exterior Marine Speakers

Enjoy your favorite music or take in the game while relaxing on your patio.

### Large Grab Handle

Assists you going in or out - Safety first.



### Camp Kitchen

Everything you need to entertain family and friends on the patio.

### Strong Safety Glass

Tinted safety glass protects against harmful UV rays and stray baseballs.

### Innovative Rain Gutters

Channel rain water away helping to reduce unsightly stains on sidewalls.



### Exterior Outlet

Handy 110V outdoor outlet GFI protected

### Wide Trax

Virtually glide over bumps and holes in the road with Wide Trax suspension.





### Large Pass Through Storage With Thick Insulated Doors

Easily store larger items such as this cooler or long fishing poles. Thick, insulated compartment doors and rubber seals protect your cargo.

### Exterior Shower

The perfect solution for messy feet and washing pets. Keep the mess outside.



### Covered LP Tanks

Protect your tanks and have easy access to the valves without removing the cover.

### Exterior Marine Speakers

Enjoy your favorite music or take in the game while relaxing on your patio.

### Large Grab Handle

Assists you going in or out - Safety first.



### Camp Kitchen

Everything you need to entertain family and friends on the patio.

### Strong Safety Glass

Tinted safety glass protects against harmful UV rays and stray baseballs.

### Innovative Rain Gutters

Channel rain water away helping to reduce unsightly stains on sidewalls.



### Exterior Outlet

Handy 110V outdoor outlet GFI protected

### Wide Trax

Virtually glide over bumps and holes in the road with Wide Trax suspension.





### Multimedia Player

North Trail is equipped with this AM/FM CD/DVD player with a USB MP3 auxiliary input for hours of personalized music and entertainment.



### Rotating Television

Our rotating TV cabinets add a unique value by saving you the expense of two TVs. You can enjoy one large HD LCD TV in both the living area by day and the bedroom by night simply by rotating.



### Hidden Storage

Everywhere you can imagine, North Trail utilizes every square inch to give you more storage.



### Large Overhead Storage

Extra deep overhead compartments are built to accommodate large serving dishes, hobby and craft containers, camera bags and many many more common items you may take along.

### Sofa Storage

Bedding, blankets, pillows, jackets can all be tucked away neatly in the large, pull-out storage compartment under the sofa. Another example where North Trail maximizes storage possibilities.



### Ball-bearing Slides

Steel ball-bearing drawer guides for added storage space, maximum strength and ease of use. North Trail drawers are strong enough to support even this construction grade cinder block.



### Clever Use of Space

Designed with family in mind, North Trail utilizes every nook of space available so there is a place for everything and everything is in its place keeping your coach neat, clean and free of clutter.

### Fully Extending Drawers

Deep, full extension drawers provide the necessary room for organizers, extra long utensils and long packages of foil. Don't settle for less - choose NORTH TRAIL as the best overall value for your money!







### Multimedia Player

North Trail is equipped with this AM/FM CD/DVD player with a USB MP3 auxiliary input for hours of personalized music and entertainment.



### Rotating Television

Our rotating TV cabinets add a unique value by saving you the expense of two TVs. You can enjoy one large HD LCD TV in both the living area by day and the bedroom by night simply by rotating.



### Hidden Storage

Everywhere you can imagine, North Trail utilizes every square inch to give you more storage.



### Large Overhead Storage

Extra deep overhead compartments are built to accommodate large serving dishes, hobby and craft containers, camera bags and many many more common items you may take along.

### Sofa Storage

Bedding, blankets, pillows, jackets can all be tucked away neatly in the large, pull-out storage compartment under the sofa. Another example where North Trail maximizes storage possibilities.

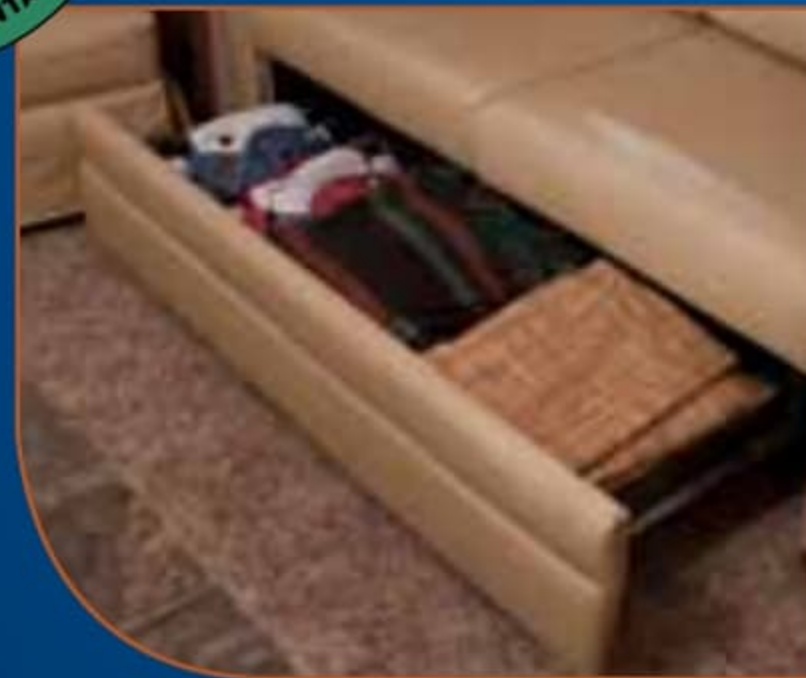

### Ball-bearing Slides

Steel ball-bearing drawer guides for added storage space, maximum strength and ease of use. North Trail drawers are strong enough to support even this construction grade cinder block.



### Clever Use of Space

Designed with family in mind, North Trail utilizes every nook of space available so there is a place for everything and everything is in it's place keeping your coach neat, clean and free of clutter.

### Fully Extending Drawers

Deep, full extension drawers provide the necessary room for organizers, extra long utensils and long packages of foil. Don't settle for less - choose NORTH TRAIL as the best overall value for your money!





# King Slides



Length: 32' 6" Dry: 6,695  
Height: 10' 10" Hitch: 678 GVWR: 8,600

NT 26BRSS



Length: 30' 2" Dry: 5,695  
Height: 10' 10" Hitch: 572 GVWR: 8,600

NT 26 LRSS



Length: 34' 5" Dry: 6,795  
Height: 10' 10" Hitch: 752 GVWR: 8,600

NT 29BUDS



Length: 34' 4" Dry: 6,495  
Height: 10' 10" Hitch: 750 GVWR: 8,600

NT 29LRSS



Length: TBD Dry: TBD  
Height: 10' 10" Hitch: TBD GVWR: 8,600

NT 29BDSS



Length: 36' 9" Dry: 6,995  
Height: 10' 10" Hitch: 788 GVWR: 8,600

NT 30RKDD

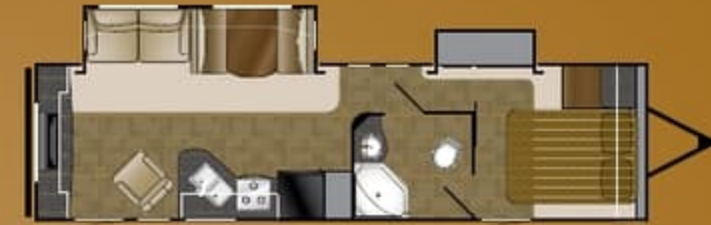

Length: 34' 11" Dry: 6,975  
Height: 10' 10" Hitch: 652 GVWR: 8,600

NT 30REDD



Length: 35' 7" Dry: 6,895  
Height: 10' 10" Hitch: 857 GVWR: 8,600

NT 31QBSS



Length: 35' 10" Dry: 6,995  
Height: 10' 10" Hitch: 814 GVWR: 8,600

NT 32BHDS



Length: 35' 10" Dry: 6,995  
Height: 10' 10" Hitch: 655 GVWR: 8,600

NT 32BUDS

# Lightweight



Length: 26' 6" Dry: 4,450  
Height: 10' 2" Hitch: 390 GVWR: 6,900

NT 21FBS



Length: 29' 7" Dry: 4,695  
Height: 10' 2" Hitch: 325 GVWR: 6,900

NT 22FBS



Length: 28' 8" Dry: 4,595  
Height: 10' 2" Hitch: 352 GVWR: 6,900

NT 24RBS



Length: 27' 4" Dry: 5,483  
Height: 10' 2" Hitch: 466 GVWR: 6,900

NT 25 RKSS



# King Slides



Length: 32' 6" Dry: 6,695  
Height: 10' 10" Hitch: 678 GVWR: 8,600



Length: 30' 2" Dry: 5,695  
Height: 10' 10" Hitch: 572 GVWR: 8,600



Length: 34' 5" Dry: 6,795  
Height: 10' 10" Hitch: 752 GVWR: 8,600



Length: 34' 4" Dry: 6,495  
Height: 10' 10" Hitch: 750 GVWR: 8,600



Length: TBD Dry: TBD  
Height: 10' 10" Hitch: TBD GVWR: 8,600



Length: 36' 9" Dry: 6,995  
Height: 10' 10" Hitch: 788 GVWR: 8,600

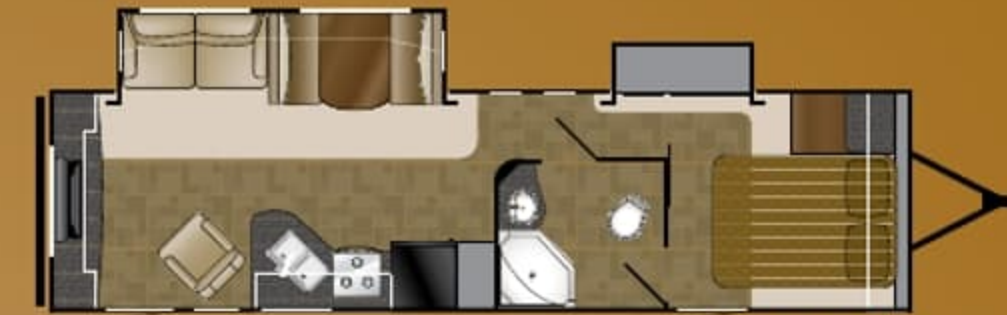

Length: 34' 11" Dry: 6,975  
Height: 10' 10" Hitch: 652 GVWR: 8,600



Length: 35' 7" Dry: 6,895  
Height: 10' 10" Hitch: 857 GVWR: 8,600



Length: 35' 10" Dry: 6,995  
Height: 10' 10" Hitch: 814 GVWR: 8,600



Length: 35' 10" Dry: 6,995  
Height: 10' 10" Hitch: 655 GVWR: 8,600

# Lightweight



Length: 26' 6" Dry: 4,450  
Height: 10' 2" Hitch: 390 GVWR: 6,900



Length: 29' 7" Dry: 4,695  
Height: 10' 2" Hitch: 325 GVWR: 6,900



Length: 28' 8" Dry: 4,595  
Height: 10' 2" Hitch: 352 GVWR: 6,900



Length: 27' 4" Dry: 5,483  
Height: 10' 2" Hitch: 466 GVWR: 6,900



# Trailers



NT 27RBS

Length: 31' 2" Dry: 5,395  
Height: 10' 2" Hitch: 492 GVWR: 6,900



NT 30QOK

Length: 33' 10" Dry: 5,695  
Height: 10' 2" Hitch: 459 GVWR: 7,200



NT 28BRS

Length: 32' 0" Dry: 5,180  
Height: 10' 2" Hitch: 482 GVWR: 6,900



NT 31QBS

Length: 33' 10" Dry: 5,540  
Height: 10' 2" Hitch: 675 GVWR: 6,900



Flooring



Pebble



Truffle



Cafe Mocha



Bistro

## STANDARDS & OPTIONS

### INTERIOR

- Radius Counter Tops
- Smoke Detector
- LP Detector
- Fire Extinguisher
- 8 ft. Wide-Body Design
- 78" Interior Height
- Monitor Panel in Bathroom
- Cable TV Prep
- Dual Ducted 13.5 A/C
- AM/FM CD/DVD Player
- LCD TV
- Raised Panel Overhead Cabinets
- Doors
- TV Antenna w/Booster

### KITCHEN

- Steel Ball-Bearing Drawer Guides
- Full Extension
- Hi-Rise Kitchen Faucet
- Conventional Oven
- 3-Burner Range
- Beauflor Flooring
- Power Range Hood w/Light
- Double Door Refer
- Acrylic Sink with Covers

### BATH AREA

- Shower Skylight
- Tub Surround with Built-in Shelves
- Hardwood Medicine Cabinet
- Bathroom Power Vent w/Wall Switch

### BEDROOM

- 74" Queen Bed, Foam
- Bedroom Night Stands
- Reading Lights
- 120V Outlets on Both Night Stands

### EXTERIOR

- Heated & Enclosed Underbelly
- E-Z Lube Hubs
- 4 Stab Jacks
- 14" Tires T.T. (15" on 5th & King Slide)
- Outside Speakers
- Outside Shower
- Spare Tire
- Exterior 120V Outlet
- Large Assist Entry Handle
- One Piece Rubber Roofing Material
- Radial Tires

### FEATURES

- Diamond Plate
- Front Rock Guard
- 25,000 BTU Furnace
- (35,000 BTU on King Slide Models)
- 6 DSI Gas/Electric Water Heater
- Fresh Water 36 Gal
- Gray/Black 37 Gal
- Electric Slide Outs
- Black Tank Flush System
- NT KITCHEN PACKAGE:
  - Upgraded Oil Rubbed Bronze Hardware
  - Upgraded Decorative Glass Inserts
  - Removable Dinette Table (inside/outside) (most models)
  - Large Viewing Window in Kitchen
  - Full Extension Ball Bearing Drawer Guides
  - Deep Pantry with Removable Shelves (most models)

### OPTIONS

- RVQ Grill
- Aluminum Wheels
- Power Stability Jacks
- 78" Pillow-Top Mattress
- Free Standing Dinette (King Slides)
- 15K A/C
- ToyLok
- Power Awning
- Black Refrigerator Door Insert
- Front Cap
- Caliber Package

### \* Lightweight Strength Package:

- Laminated Crowned Roof System
- Block Foam Brick Insulation
- Aluminum Construction (front, back and side walls, floor, roof)
- Enclosed and Heated Underbelly
- Radius Double Entry Step
- Tinted Safety Glass Windows
- 2" Thick (R-7) Sidewall Construction
- 4 Stabilizer Jacks with Sand Pads
- WIDE-TRAX Axle Placement
- HD Leaf Spring Suspension
- Dual 20 lb. LP Tanks



# Trailers



NT 27RBS

Length: 31' 2" Dry: 5,395  
Height: 10' 2" Hitch: 492 GVWR: 6,900

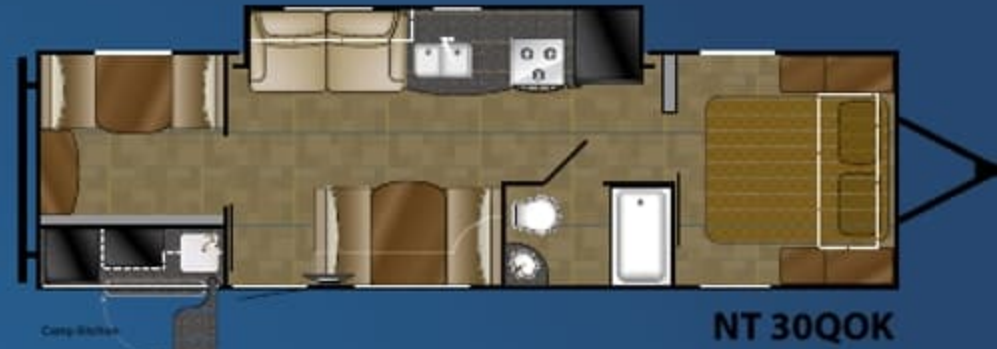

NT 30QOK

Length: 33' 10" Dry: 5,695  
Height: 10' 2" Hitch: 459 GVWR: 7,200



NT 28BRS

Length: 32' 0" Dry: 5,180  
Height: 10' 2" Hitch: 482 GVWR: 6,900



NT 31QBS

Length: 33' 10" Dry: 5,540  
Height: 10' 2" Hitch: 675 GVWR: 6,900



Flooring



Pebble



Truffle



Cafe Mocha



Bistro

## STANDARDS & OPTIONS

### INTERIOR

- Radius Counter Tops
- Smoke Detector
- LP Detector
- Fire Extinguisher
- 8 ft. Wide-Body Design
- 78" Interior Height
- Monitor Panel in Bathroom
- Cable TV Prep
- Dual Ducted 13.5 A/C
- AM/FM CD/DVD Player
- LCD TV
- Raised Panel Overhead Cabinets
- Doors
- TV Antenna w/Booster

### KITCHEN

- Steel Ball-Bearing Drawer Guides - Full Extension
- Hi-Rise Kitchen Faucet
- Conventional Oven
- 3-Burner Range
- Beauflor Flooring
- Power Range Hood w/Light
- Double Door Refer
- Acrylic Sink with Covers

### BATH AREA

- Shower Skylight
- Tub Surround with Built-in Shelves
- Hardwood Medicine Cabinet
- Bathroom Power Vent w/Wall Switch

### BEDROOM

- 74" Queen Bed, Foam
- Bedroom Night Stands
- Reading Lights
- 120V Outlets on Both Night Stands

### EXTERIOR

- Heated & Enclosed Underbelly
- E-Z Lube Hubs
- 4 Stab Jacks
- 14" Tires T.T. (15" on 5th & King Slide)
- Outside Speakers
- Outside Shower
- Spare Tire
- Exterior 120V Outlet
- Large Assist Entry Handle
- One Piece Rubber Roofing Material
- Radial Tires

### FEATURES

- Diamond Plate
- Front Rock Guard
- 25,000 BTU Furnace (35,000 BTU on King Slide Models)
- 6 DSI Gas/Electric Water Heater
- Fresh Water 36 Gal
- Gray/Black 37 Gal
- Electric Slide Outs
- Black Tank Flush System
- NT KITCHEN PACKAGE:
  - Upgraded Oil Rubbed Bronze Hardware
  - Upgraded Decorative Glass Inserts
  - Removable Dinette Table (inside/outside) (most models)
  - Large Viewing Window in Kitchen
  - Full Extension Ball Bearing Drawer Guides
  - Deep Pantry with Removable Shelves (most models)

### OPTIONS

- RVQ Grill
- Aluminum Wheels
- Power Stability Jacks
- 78" Pillow-Top Mattress
- Free Standing Dinette (King Slides)
- 15K A/C
- ToyLok
- Power Awning
- Black Refrigerator Door Insert
- Front Cap
- Caliber Package

### \* Lightweight Strength Package:

- Laminated Crowned Roof System
- Block Foam Brick Insulation
- Aluminum Construction (front, back and side walls, floor, roof)
- Enclosed and Heated Underbelly
- Radius Double Entry Step
- Tinted Safety Glass Windows
- 2" Thick (R-7) Sidewall Construction
- 4 Stabilizer Jacks with Sand Pads
- WIDE-TRAX Axle Placement
- HD Leaf Spring Suspension
- Dual 20 lb. LP Tanks





# North Trail

*Caliber Edition*  
BY HEARTLAND

## CALIBER Edition

Includes Everything on Standard North Trails Plus:

- Solid Surface Countertops
- Stainless Steel Deep 50/50 Sink
- Porcelain Foot Flush Toilet
- Hidden Hinges
- Slam Latch Baggage Doors
- Bumper Pull-Out Bike Rack
- Power Awning
- Power Jacks



### A Step Above Added Value

Caliber Edition builds on the exceptional value of North Trail adding all the features you



see pictured here designed to enhance your camping experience and protect your investment with these valuable features that you will enjoy for years of family camping and making memories.





# North Trail

*Caliber Edition*  
BY HEARTLAND

## CALIBER Edition

Includes Everything on Standard North Trails Plus:

- Solid Surface Countertops
- Stainless Steel Deep 50/50 Sink
- Porcelain Foot Flush Toilet
- Hidden Hinges
- Slam Latch Baggage Doors
- Bumper Pull-Out Bike Rack
- Power Awning
- Power Jacks



### A Step Above Added Value

Caliber Edition builds on the exceptional value of North Trail adding all the features you

see pictured here designed to enhance your camping experience and protect your investment with these valuable features that you will enjoy for years of family camping and making memories.





### Outdoor Upgrades Features to Upgrade Your Trip

Caliber exteriors feature a sleek graphics package including painted, radius metal skirting. A built in, pull-out bumper bike rack perfect for bikes, chairs and coolers. Set the Caliber quickly and easily with one finger and electric stabilizers. Slam-it and forget-it these thick insulated slam baggage doors protect your cargo from the elements. Caliber's large power awning allows you to enjoy more of your outdoor patio time rain or shine you can enjoy relaxing in the great outdoors.







### Outdoor Upgrades Features to Upgrade Your Trip

Caliber exteriors feature a sleek graphics package including painted, radius metal skirting. A built in, pull-out bumper bike rack perfect for bikes, chairs and coolers. Set the Caliber quickly and easily with one finger and electric stabilizers. Slam-it and forget-it these thick insulated slam baggage doors protect your cargo from the elements. Caliber's large power awning allows you to enjoy more of your outdoor patio time rain or shine you can enjoy relaxing in the great outdoors.







# North Trail

BY HEARTLAND

## 7.5 Wide

## Focus Edition



Length: 21' 9"    Dry: 3,780    **FX17**  
 Height: 9' 10"    Hitch: 386    GVWR: 4,900



Length: 21' 2"    Dry: 3,931    **FX18**  
 Height: 9' 10"    Hitch: 344    GVWR: 4,900



Length: 24' 5"    Dry: 4,075    **FX21**  
 Height: 9' 10"    Hitch: 386    GVWR: 5,200



Length: 27' 5"    Dry: 4,630    **FX23**  
 Height: 9' 10"    Hitch: 518    GVWR: 5,800



Length: 27' 3"    Dry: 4,155    **FX235**  
 Height: 9' 10"    Hitch: 816    GVWR: 5,800



Length: 27' 2"    Dry: 4,592    **T225**  
 Height: 9' 10"    Hitch: 476    GVWR: 5,800

## 8' Wide TENT ENDS



Length: 21' 9"    Dry: 4,086    **T19 TENT**  
 Height: 9' 10"    Hitch: 362    GVWR: 6900



Length: 26' 5"    Dry: 4,816    **T20 TENT**  
 Height: 9' 10"    Hitch: 446    GVWR: 6900



Length: 24' 6"    Dry: 4,656    **T22 TENT**  
 Height: 9' 10"    Hitch: 492    GVWR: 6900





# North Trail

BY HEARTLAND

*Focus Edition*

## 7.5 Wide



Length: 21' 9"    Dry: 3,780    **FX17**  
 Height: 9' 10"    Hitch: 386    GVWR: 4,900



Length: 21' 2"    Dry: 3,931    **FX18**  
 Height: 9' 10"    Hitch: 344    GVWR: 4,900



Length: 24' 5"    Dry: 4,075    **FX21**  
 Height: 9' 10"    Hitch: 386    GVWR: 5,200



Length: 27' 5"    Dry: 4,630    **FX23**  
 Height: 9' 10"    Hitch: 518    GVWR: 5,800



Length: 27' 3"    Dry: 4,155    **FX235**  
 Height: 9' 10"    Hitch: 816    GVWR: 5,800



Length: 27' 2"    Dry: 4,592    **T225**  
 Height: 9' 10"    Hitch: 476    GVWR: 5,800



## 8' Wide TENT ENDS



Length: 21' 9"    Dry: 4,086    **T19 TENT**  
 Height: 9' 10"    Hitch: 362    GVWR: 6900



Length: 26' 5"    Dry: 4,816    **T20 TENT**  
 Height: 9' 10"    Hitch: 446    GVWR: 6900



Length: 24' 6"    Dry: 4,656    **T22 TENT**  
 Height: 9' 10"    Hitch: 492    GVWR: 6900





# North Trail

BY HEARTLAND

## Focus Edition



## STANDARDS & OPTIONS

### INTERIOR

- Radius Counter Tops
- Smoke Detector
- LP Detector
- Fire Extinguisher
- 7.5 ft. Wide-Body Design
- 78" Interior Height
- Monitor Panel in Bathroom
- Cable TV Prep
- Dual Ducted 13.5 A/C
- AM/FM CD/DVD Player
- Raised Panel Overhead Cabinets Doors
- TV Antenna w/Booster

### KITCHEN

- Steel Ball-Bearing Drawer Guides -Full Extension
- Hi-Rise Kitchen Faucet
- Conventional Oven
- 3-Burner Range
- Beauflor Flooring
- Power Range Hood w/Light
- Double Door Refer
- Acrylic Sink with Cover

### BATH AREA

- Shower Skylight
- Tub Surround with Built-in Shelves
- Hardwood Medicine Cabinet
- Bathroom Power Vent w/Wall Switch

### BEDROOM

- 74" Queen Bed
- Bedroom Night Stands
- Reading Lights
- 120V Outlets on Both Night Stands

### EXTERIOR

- Heated & Enclosed Underbelly
- E-Z Lube Hubs
- 4 Stab Jacks
- 14" Tires
- Outside Speakers
- Outside Shower
- Spare Tire
- Exterior 120V Outlet
- Large Assist Entry Handle
- One Piece Rubber Roofing Material

### FEATURES

- Diamond Plate Front Rock Guard
- 25,000 BTU Furnace
- 6 DSI Gas/Electric Water Heater
- Fresh Water 36 Gal
- Gray/Black 37 Gal
- Electric Slide Outs
- Black Tank Flush System

### NT KITCHEN PACKAGE:

- Upgraded Oil Rubbed Bronze Hardware
- Upgraded Decorative Glass Inserts
- Removable Dinette Table (inside/outside) (most models)
- Large Viewing Window in Kitchen
- Full Extension Ball Bearing Drawer Guides
- Deep Pantry with Removable Shelves (most models)

### OPTIONS

- RVQ Grill
- 15K A/C
- ToyLok
- LCD TV
- Aluminum Wheels
- Power Stability Jacks
- 78" Pillow-Top Mattress
- Power Awning

### \* Lightweight Strength Package:

- Laminated Crowned Roof System
- Block Foam Brick Insulation
- Aluminum Construction (front, back and side walls, floor, roof)
- Enclosed and Heated Underbelly
- Radius Double Entry Step
- Tinted Safety Glass Windows
- 2" Thick (R-7) Sidewall Construction
- 4 Stabilizer Jacks with Sand Pads
- HD Leaf Spring Suspension
- Dual 20 lb. LP Tanks





# North Trail

BY HEARTLAND

## Focus Edition

## STANDARDS & OPTIONS

### INTERIOR

- Radius Counter Tops
- Smoke Detector
- LP Detector
- Fire Extinguisher
- 7.5 ft. Wide-Body Design
- 78" Interior Height
- Monitor Panel in Bathroom
- Cable TV Prep
- Dual Ducted 13.5 A/C
- AM/FM CD/DVD Player
- Raised Panel Overhead Cabinets Doors
- TV Antenna w/Booster

### KITCHEN

- Steel Ball-Bearing Drawer Guides -Full Extension
- Hi-Rise Kitchen Faucet
- Conventional Oven
- 3-Burner Range
- Beauflor Flooring
- Power Range Hood w/Light
- Double Door Refer
- Acrylic Sink with Cover

### BATH AREA

- Shower Skylight
- Tub Surround with Built-in Shelves
- Hardwood Medicine Cabinet
- Bathroom Power Vent w/Wall Switch

### BEDROOM

- 74" Queen Bed
- Bedroom Night Stands
- Reading Lights
- 120V Outlets on Both Night Stands

### EXTERIOR

- Heated & Enclosed Underbelly
- E-Z Lube Hubs
- 4 Stab Jacks
- 14" Tires
- Outside Speakers
- Outside Shower
- Spare Tire
- Exterior 120V Outlet
- Large Assist Entry Handle
- One Piece Rubber Roofing Material

### FEATURES

- Diamond Plate Front Rock Guard
- 25,000 BTU Furnace
- 6 DSI Gas/Electric Water Heater
- Fresh Water 36 Gal
- Gray/Black 37 Gal
- Electric Slide Outs
- Black Tank Flush System

### NT KITCHEN PACKAGE:

- Upgraded Oil Rubbed Bronze Hardware
- Upgraded Decorative Glass Inserts
- Removable Dinette Table (inside/outside) (most models)
- Large Viewing Window in Kitchen
- Full Extension Ball Bearing Drawer Guides
- Deep Pantry with Removable Shelves (most models)

### OPTIONS

- RVQ Grill
- 15K A/C
- ToyLok
- LCD TV
- Aluminum Wheels
- Power Stability Jacks
- 78" Pillow-Top Mattress
- Power Awning

### \* Lightweight Strength Package:

- Laminated Crowned Roof System
- Block Foam Brick Insulation
- Aluminum Construction (front, back and side walls, floor, roof)
- Enclosed and Heated Underbelly
- Radius Double Entry Step
- Tinted Safety Glass Windows
- 2" Thick (R-7) Sidewall Construction
- 4 Stabilizer Jacks with Sand Pads
- HD Leaf Spring Suspension
- Dual 20 lb. LP Tanks











Heartland Recreational Vehicles  
 1001 All-Pro Drive • Elkhart, IN 46514 • 574-262-5992

### Community. Convenience. Close-to-home.

Where you purchase your recreational vehicle is ultimately your decision but Heartland urges you to consider buying at your local dealer. Dealers are part of your community, providing jobs and contributing to your local economy. These dealers are under obligation to provide warranty service for products they sell, but are not legally required to service products purchased from other dealers. At some point, you may need to return to the dealer you buy from - why not stay close to home? After all, home is where your Heartland is!

### BENEFITS OF PURCHASING YOUR RV LOCALLY:

- You enjoy valuable relationship building with Dealer Representatives, close to your home, who will explain the features and benefits of the product.
- You receive a full product orientation prior to delivery, which includes hands-on directions for many of the coach's systems and functions. You are also introduced to the Dealership's Service/Parts/Warranty personnel who are at the ready to help you with any issues you may encounter, now and in the future.
- You enjoy customer PRIORITY. Dealerships generally service their purchasing customers first - others may experience long delays and miss opportunities to use their RV. What is it worth for you to have a dealership's full attention and motivation to satisfy you when you need service - in a timely manner?
- Valuable TAX dollars and jobs stay in YOUR community which pays for your roads, schools, police and fire departments.

### DON'T UNDERESTIMATE CUSTOMER SERVICE AND PERSONAL CARE!

For Canadian Residents: If you purchase an RV out-of-country, there are additional fees, taxes and inspections that must be met before bringing your product home. Your local Canadian dealers are experts in these provisions.

Your Authorized Heartland Dealer:

www.HEARTLANDRVs.com



Experience: Product Walk-Through Videos • Side By Side Comparisons  
 Feature Videos • Photo Galleries • Virtual 360° Tours  
 Detailed Floor Plans • News • Testimonials • Customer Service  
 Service Locator • Owners Club • More at our Informative Web Site

# North Trail

BY HEARTLAND

**VENDOR DIRECT 800#**  
**CALL DIRECT FOR DIRECT RESULTS!**  
**TOLL FREE & WARRANTY PHONE NUMBERS:**

In an effort to offer the best possible customer service, we are providing you with the warranty phone numbers of our most common vendor partners so you may work directly with them to more quickly resolve warranty issues. Check the correct section of the contact to determine the correct service.

LIPPERT 1-800-624-7121	SEABURAN 1-423-775-2121
DEXTER A&L 1-574-295-7388	DMAN 1-800-228-7838
DOMETIC 1-800-844-4801	B & B 1-574-228-7838
NORCO 1-800-347-3232	FLAIR 1-574-534-2183
SHARFLOW 1-800-854-3218	SEAT TECH 1-800-524-7821
THETFORD 1-800-845-1213	DMAN 1-800-888-8838
KOB 1-800-238-7821	DMPLEX 1-800-888-8838
TREEST TIRE 1-800-443-8987	HAWER 1-877-481-4738
ASA 1-800-838-3123	CAREFREE 1-800-423-3233
PROGRESSIVE 1-208-701-4241	WHEEL POOL/WAFFAC 1-800-845-8383
CHONG 1-877-234-8887	MORECOLD 1-800-843-1218
ATWOOD 1-800-488-3118	

**Call Direct,  
 Fast Results!  
 800# LABEL  
 IN EVERY HEARTLAND**

We provide a convenient sticker in each coach listing the warranty phone numbers of our most common vendor partners so that if you choose to, you may work directly with them to more quickly resolve issues or obtain replacement items.



**HEARTLAND  
 CUSTOMER SERVICE  
 WE'VE GOT YOUR BACK!**

Over 40 men and women located in a dedicated facility servicing our customers every day. With a dealer network of over 400 locations across the U.S. and Canada, you're never far from an authorized Heartland dealer.

Product information is as accurate as possible as of the date of publication of this brochure. Due to Heartland's commitment to continuous product improvement - floorplans, materials, components, features, specifications, options, etc. are subject to change without notice or obligation to Heartland Recreational Vehicles. Product information and specifications apply to coaches beginning with serial number 243428

**Tow Vehicle Caution:** Owners of Heartland recreational vehicles are solely responsible for the selection and proper use of tow vehicles. All customers should consult with a motor vehicle manufacturer or their dealer concerning the purchase and use of suitable tow vehicles for Heartland products. Heartland disclaims any liability or damages suffered as a result of the selection, operation, use or misuse of a tow vehicle. Heartland's limited warranty does not cover damage to the recreational vehicle or the tow vehicle as a result of the selection of the tow vehicle.

See your nearest Heartland dealer to review a current model. 70,000 Litho 9/11