

2012 ALUMA-LITE®



HOLIDAY RAMBLER®

*This is Living®*



*Aluma-Lite®*

800.877.0870 | [www.holidayrambler.com](http://www.holidayrambler.com)





*Aluma-Lite®*

Welcome to the 2012 Holiday Rambler Aluma-Lite®. Luxury of a high-end fifth-wheel without the price tag. The lightweight, ½ ton towable Aluma-Lite® delivers on residential amenities, spacious interiors and the quality and dependability Holiday Rambler has built its reputation on since 1953.





# MODEL 27RLS | NIGHT FALL DECOR WITH TWO-TONE CABINETRY







*Aluma-Lite®*

## EXTERIOR FEATURES



Optional electric patio awning

**NEW!** KEY FOB  
WITH **7** MOTOR  
CONTROLS!



Optional outside grill



Aluminum wheels



Optional power jacks



1) LP tank hook-up 2) Exterior storage with slam latch 3) Outside shower

## INTERIOR FEATURES



Roller bearing drawer guides



Optional free-standing dinette table and chairs with storage under table top



Optional high back solid wood chairs with under cushion storage



Optional Hide-A-Bed sofa with electric air mattress



Large cabinets provide additional storage space



# Lightweight — 1/2 Ton Towable

## 27RLS

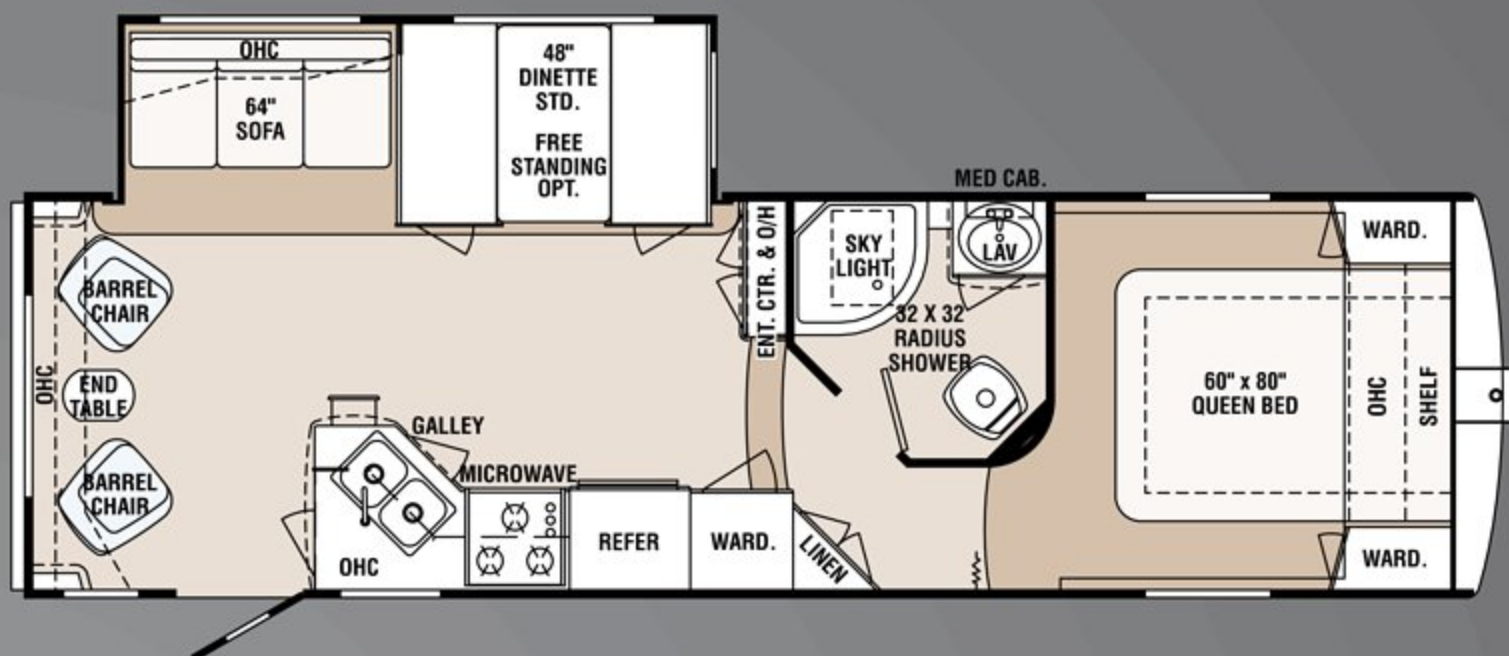

Weights	
Gross Vehicle Weight Rating	9,600
Hitch Weight	1,130
Axle(s) Weight	5,875
Unloaded Vehicle Weight	7,005
Net Carrying Capacity (NCC)	2,595
Tire Size	15"
Tire Load Range	D
Measurements	
Overall Length	28' 11"
Overall Height (Including A/C)	12' 1"
Exterior Width	8'
Tank Capacities	
Water Heater (Gal.)	6
Grey Tank (Gal.)	30
Black Tank (Gal.)	30
Fresh Tank (Gal.)	30
L.P. Tank	S

## 28BHS

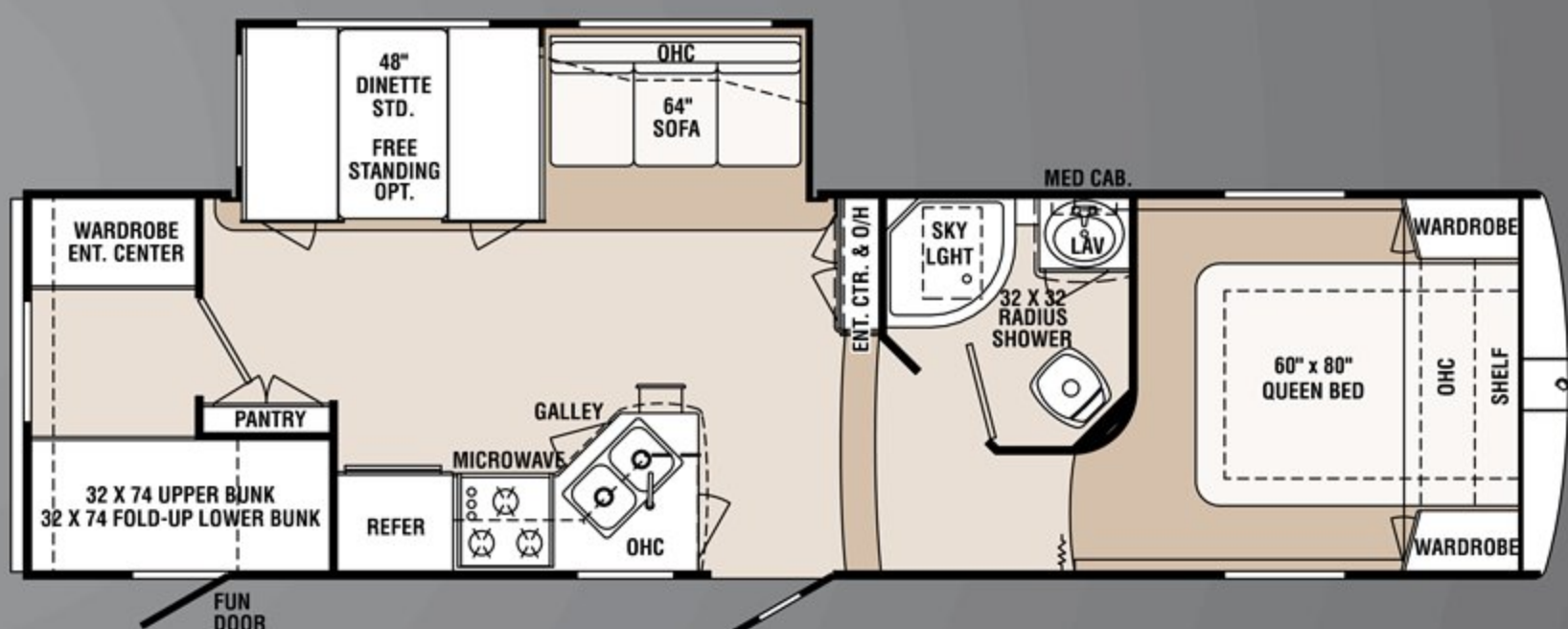

Weights	
Gross Vehicle Weight Rating	9,600
Hitch Weight	1,345
Axle(s) Weight	5,875
Unloaded Vehicle Weight	7,220
Net Carrying Capacity (NCC)	2,380
Tire Size	15"
Tire Load Range	D
Measurements	
Overall Length	31' 10"
Overall Height (Including A/C)	12' 1"
Exterior Width	8'
Tank Capacities	
Water Heater (Gal.)	6
Grey Tank (Gal.)	30
Black Tank (Gal.)	30
Fresh Tank (Gal.)	30
L.P. Tank	S

## 28RKS

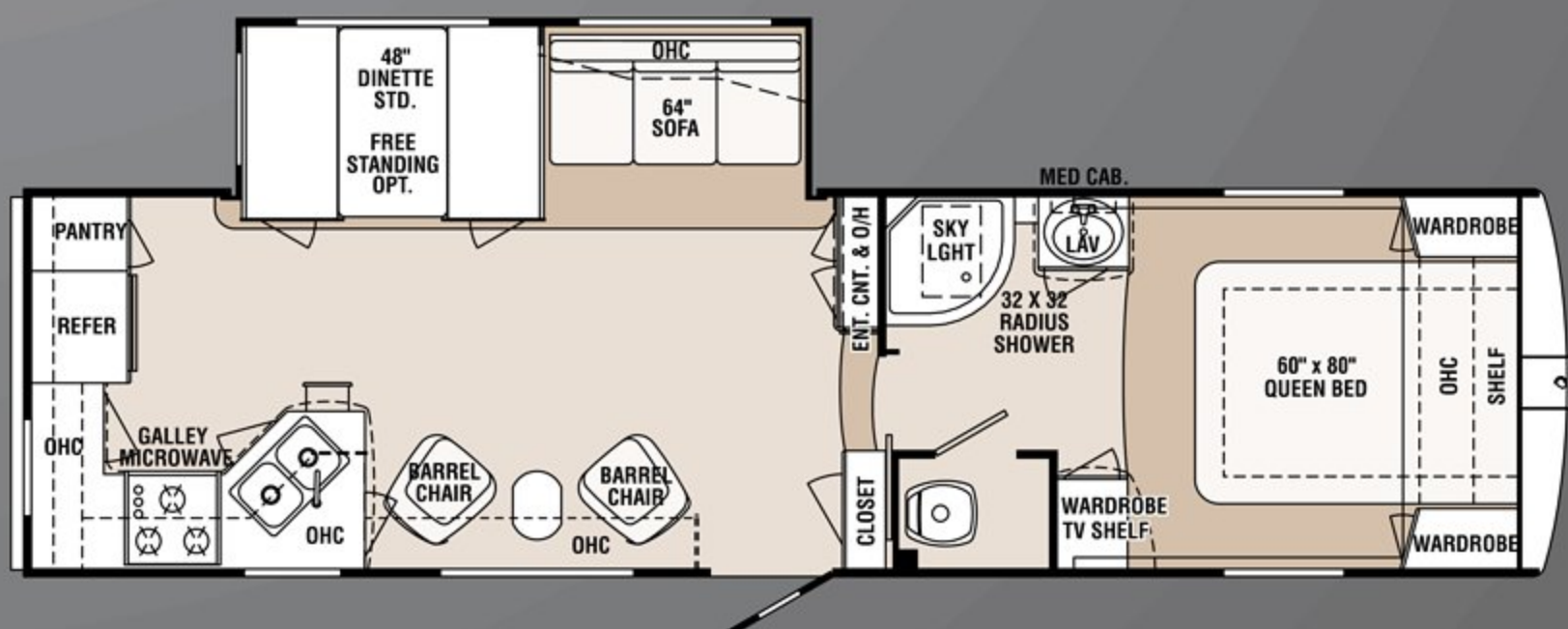

Weights	
Gross Vehicle Weight Rating	9,600
Hitch Weight	TBD
Axle(s) Weight	5,875
Unloaded Vehicle Weight	TBD
Net Carrying Capacity (NCC)	TBD
Tire Size	TBD
Tire Load Range	TBD
Measurements	
Overall Length	TBD
Overall Height (Including A/C)	12' 1"
Exterior Width	8'
Tank Capacities	
Water Heater (Gal.)	6
Grey Tank (Gal.)	30
Black Tank (Gal.)	30
Fresh Tank (Gal.)	30
L.P. Tank	S

\* Weights may vary by options. \*\* Tank manufacturer's listed water capacity (WC). Actual filled LP capacity is 80% of listing due to safety shut off required on tank.





### **BODY CONSTRUCTION: FEATURES**

- › 8" I-Beam Frame Powder Coated
- › 15" Radial Tires
- › Aluminum Wheels
- › Front Jacks Mounted Outside Frame Rails
- › Front Power Landing Jacks
- › Rear Stabilizer Jacks
- › 4,000 Lb. E-Z Lube Tandem Axles with 10" Electric Brakes
- › Linoleum Floor in Alcove Storage Area Under Bath Deck
- › Pass Through Storage Under Bath Deck
- › Heated and Enclosed Under Floor Fresh Water and Holding Tanks
- › Frame Mounted Entry Step (Triple)
- › Laminated Flooring: Two Layers Lauan, Aluminum Frame With Foam, Lauan, and Darco 2"
- › Bath Floor Laminated
- › 1.5 Inch Tube, Laminated Sidewall, Fiberglass Skin, Lauan, Aluminum Frame with Foam, and Wallboard
- › Exterior Walls Should Have Radius at Goose Neck
- › Crowned Roof with Ducted A/C
- › Flat Floor Slide-Out: Main Living Area 5' 7"
- › Radius Exterior Storage Door with Slam Latch
- › Crowned Roof with Ducted A/C
- › Rain Gutters with Downspouts Above Slide-Outs
- › Hard Board Vinyl Ceiling
- › Front Molded Fiberglass Cap
- › Smooth White Fiberglass Exterior Walls
- › Roof Ladder

### **OPTIONS**

- › Equa Flex
- › Power Rear Jacks
- › Spare Tire with ABS Cover
- › Canadian RV Certification

### **APPLIANCES AND ACCESSORIES: FEATURES**

- › 8 Cu. Ft. Refrigerator
- › Apollo 3-Burner Cook-Top With Glass Top
- › Half Time Oven (Black)
- › Range Hood
- › TV Prep Living Area: Mounting Bracket Installed When Necessary
- › TV Prep Bedroom Area
- › TV Prep Bunk Area (28 BHS Only)
- › AM/FM/CD/DVD/I-Pod/MP3 Stereo with 4 Interior Speakers, 2 Exterior Speakers, and Exterior Selector Switch

### **OPTIONS**

- › Exterior Entertainment Center 26" LCD TV, Stereo with 2 Speakers
- › Black Refrigerator Inserts

- › 32" LCD TV with HD Tuner and Mounting Bracket in Living Area
- › 19" LCD TV with Remote Control (Bedroom)
- › Electric Fireplace Below Living Room TV (N/A 27 RLS)
- › Outside Grill

### **INTERIOR: FEATURES**

- › Refrigerator Insert Cherry
- › Square Frame Flat Panel Cabinet Doors
- › Raised Panel Galley Upper Doors
- › Decorative Mirrored Glass in OHC
- › Decorative Mirrored Glass in Sofa OHC
- › Brushed Nickel Cabinet Hardware
- › Metal Roller Bearing Drawer Guides
- › Decorative Wall Board: Mirage Autumn with Matching Trim
- › Wood Grain Panel Refrigerator Insert Doors
- › Wallpaper Border: Main Living Area, Dinette, Kitchen, and Bath
- › Decorative Slide-out Fascia
- › Quarter Round Trim at Ceiling Line
- › Linoleum Throughout
- › Carpet in Front of Slide-Out and in the Bedroom Only
- › Wood Grain Bath Door
- › Hard Wood Grain Door Flat Close-Off Bunks (28 BHS Only)
- › Folding Accordion Door Close-Off to Bedroom
- › Bedspread with Reverse Shams
- › Bunks: Curtain (28 BHS Only)

### **OPTIONS**

- › Interior Fabrics (2): Night Fall and Fascination
- › Cabinets: Fulton Cherry/ Concert Cherry 2 Tone or Newport Cherry

### **FURNITURE: FEATURES**

- › Queen Bed
- › Fabric Covered Fold-Down Sleeper Sofa.
- › Double Bunk Beds (28 BHS Only)
- › (2) Barrel Chairs (N/A 28 BHS)
- › 42" Booth Dinette with Fabric Cushions with Vinyl Backs (N/A 28 BHS)
- › 48" Booth Dinette with Fabric Cushions with Vinyl Backs (28 BHS Only)

### **OPTIONS**

- › Hide-A-Bed Sofa with Air Mattress
- › Free-Standing Dinette Table with Four Wood Chairs



Due to continuous product improvement, please see the website for the latest in standards and options, specifications, and technical data. *Go to [www.holidayrambler.com](http://www.holidayrambler.com).*

### ELECTRICAL SYSTEMS AND LIGHTS: FEATURES

- › Electrical Management System (30 Amp)
- › Detachable 30 Amp Power Cord
- › 55 Amp Converter with Charger
- › Porch Light/Security Light
- › Exterior Hitch Light, Alcove Area
- › Patio Side 120V Exterior Recept
- › Patio Side Cable TV Hook-Up
- › Decorative Dome Light Above Dinette Table

### PLUMBING AND LP SYSTEMS: FEATURES

- › 50/50 Stainless Galley Sink with Single Lever Pull-Out Sprayer
- › Radius Shower with Shower Faucet 4" Diverter with Round Smoked Handles, Hose, and Head in Biscuit (27 RLS Only)
- › Acrylic Shower Door (27 RLS Only)
- › Neo Angle Shower with Shower Faucet 4" Diverter with Round Smoked Handles, Hose, and Head in Biscuit (N/A on 27 RLS)
- › Glass Shower Door (N/A on 27 RLS)
- › Demand Water System
- › 6 Gal. Gas/DSI/Electric Water Heater
- › Water Heater By-Pass
- › Two 30 Lb. L.P. Tanks with Automatic Changeover
- › No-Fuss Flush Holding and Tank Rinsing System

### OPTIONS

- › Glass Shower Door (27 RLS Only)
- › Outside Shower

### HEATING, VENTS AND AIR CONDITIONING: FEATURES

- › A/C 13,500 BTU (Ducted)
- › 30M BTU Hydro Flame Electronic Ignition Furnace
- › Gas Line Hook-Up with Valve at Front of Coach
- › Manual Roof Vent: Rear Vent and Front Bedroom
- › 12V Roof Vent in Bathroom

### OPTIONS

- › A/C 15,000 BTU (Ducted)
- › Fantastic Attic Fan in Bedroom

### WINDOWS, DOORS AND AWNINGS: FEATURES

- › Radius Safety Glass Windows
- › Galley Window
- › Radius Entry Door with Window, Dead Bolt, and Screen Door
- › Sidewall Fun Door with Fold-Up Bunk (28 BHS Only)
- › Slam Latch Baggage Door Handles
- › Skylight in Bathroom
- › Swing Away Entry Door Handle
- › Manual Awning

### OPTIONS

- › Dual Pane Windows Radius with Dark Tint
- › Electric Patio Awning

### SAFETY: FEATURES

- › Fire Extinguisher
- › Deadbolt Lock(s) on Entrance Door(s)
- › 120V GFI Protected Outlets (Kitchen, Bath, Exterior)
- › Breakaway Switch
- › L.P. Gas Detector
- › Smoke Detector
- › CO Detector
- › Egress Window(s)
- › Safety Glass

### POWER PACKAGE OPTION

- › Electric Patio Awning, Power Rear Jacks, and Multi Function 8 Output Receiver with 7 Motor Controls Key Fob

NEWPORT CHERRY  
WOOD OPTION







HOLIDAY RAMBLER®

*This is Living®***BEING DIFFERENT MAKES  
ALL THE DIFFERENCE.**

At Holiday Rambler, it's our goal for all our customers to enjoy their RV experience from the beginning. We have forged strong, reliable relationships with our dealer partners, and we encourage our customers to do the same. We're proud to boast a large network of dealership partners and service centers across North America. We're confident that this relationship will only enhance your RV experience and provide the added peace of mind you desire, so you can focus on the important stuff. After all, we're not just selling a world-class product, we're selling "fun". You can rest assured, Holiday Rambler will be along for the ride, every mile your RV adventure takes you.

**NAVISTAR®****STRONGER THAN EVER.**

When you buy a new Monaco RV, you get all the great things you expect: state-of-the-art products, innovative floorplans and first-class customer service. You also get the confidence that comes with being part of a 175-year-old parent company like Navistar, a world leader in transportation. To learn more about Navistar and its affiliates, visit [navistar.com](http://navistar.com).

**WARRANTY:**

12 month basic limited warranty. 5 year limited structural warranty.

*\*Please review your RV's limited warranty in full for complete terms and conditions.*

The actual overall length of the recreational vehicle may differ from that indicated in the brochure due to variances in the manufacturing process and/or installed components. The actual length may be greater or less than that indicated. Due to the large variety of options and floorplan arrangements available to our customers, actual weights for each unit can differ significantly. Monaco provides a weight sticker on each unit we produce which includes that unit's tank capacities and approximate weight. Consult your local Monaco dealer for unit availability and further information. The information printed in this brochure reflects product design, fabrication, and component parts at the date of printing. The manufacturer reserves the right, at any time, to make changes in product design or material or component specifications as its sole option, without notice. This includes the substitution of components of a different brand or trade name which will result in comparable performance. All information printed in this brochure is subject to change after the date of printing. Some features shown or mentioned in this brochure are optional and may only be available in selected floorplans. Photographs may show props or decorations that are not standard equipment. Monaco, the Monaco logo and its design, are registered trademarks. Other products and company names are trademarks and/or registered trademarks of their respective holders. While the color of the motorhome's exterior and the interior fabrics depicted in this sales brochure are fair and reasonable depictions, the colors depicted may not be an exact match of the actual colors because of the variances in photo-processing and printing. Due to product improvements, changes during the model year and/or transcription errors that may occur, information represented within this brochure may not be accurate at the time of your purchase. If certain information is significant to your purchasing decision, please confirm the information with your dealer. Component part and appliance manufacturers issue limited warranties covering portions of the recreational vehicle not covered under the Limited Warranties issued by Monaco RV, LLC. To learn specific details regarding warranty coverage, please contact your selling dealership or review the warranty packet inside the recreational vehicle.