

2012 AnaliteClassC





DAY OR NIGHT, IT'S OUR
COMFY HOME AWAY FROM HOME.

FAMILY TIME

Holiday Rambler is redefining “family time” with its unwavering reputation for value and affordability. This year you’ll find more family-friendly functionality, stylish details and spacious comfort

than ever before.

Make yourself at home with quality appliances, hardwood cabinet doors and drawers, laminate countertops, durable linoleum flooring throughout, and a 26-inch LCD TV (N/A 23RB). *(Pictured: 31SFD)*

STANDARDS | OPTIONS





The Aluma-Lite Class C presents the perfect living environment for you and your family to relax and really enjoy one another. Personalize your coach with a choice of stylish décors and wood finishes. Nice optional touches include

a leatherette U-shaped booth dinette, convection microwave, 19-inch TV in the bedroom, home theater system and exterior entertainment center. Rediscover "family time"... Holiday Rambler style. *(Pictured: 31SFD)*





**HILLSIDE
CHERRY**
(STANDARD)



**FULTON
CHERRY
GLAZED**

CITYSCAPE



STERLING

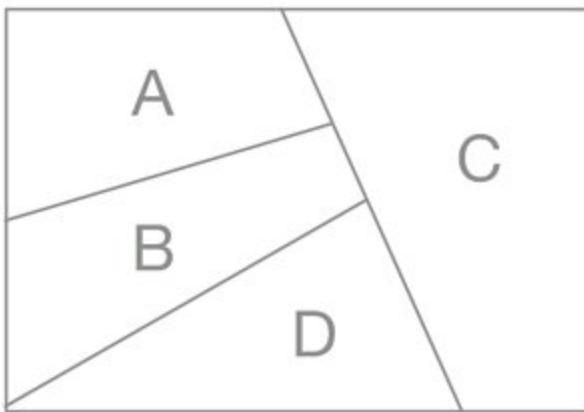
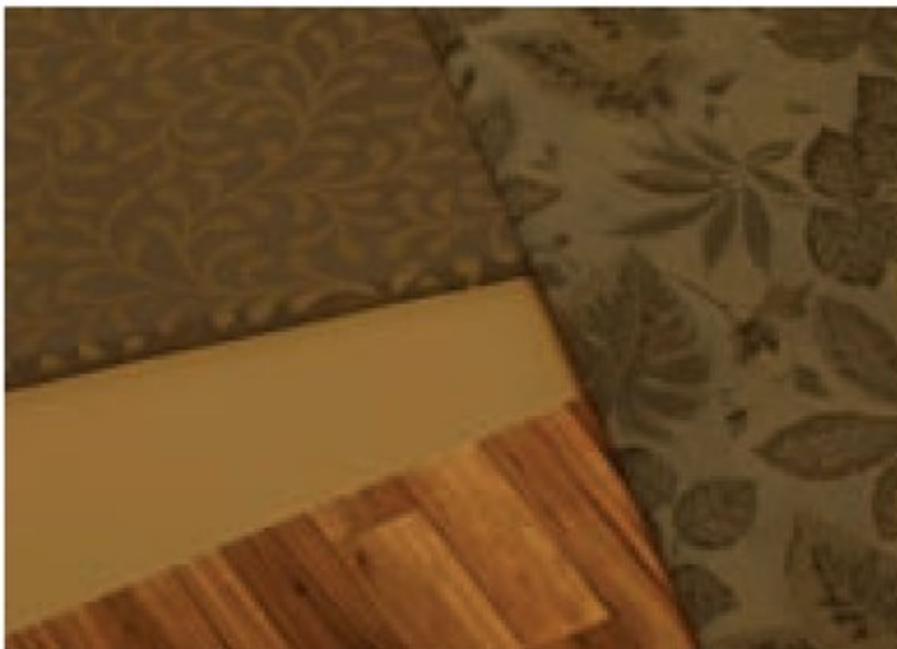

A. BEDSPREAD B. SOFA
C. ACCENT D. LINOLEUM

Note: colors depicted are a reasonable representation though they may not be an exact match of the actual colors due to variances in processing and production.



MAKE IT HOME.

The Aluma-Lite Class C offers a selection of styles and combinations for interior décor, cabinetry and exterior graphics, including standard vinyl graphics or deluxe partial paint with

vinyl graphics. Designed to make your family feel at home... even when you're away from home.



STANDARD GRAPHICS PACKAGE
(Vinyl Graphics)



OPTIONAL GRAPHICS PACKAGE
(Vinyl Graphics with Lower Partial Paint)

WARRANTIES

Enjoy your next RV adventure with the peace of mind that comes with a 12 month/24,000 mile basic limited warranty; and a 5 year/50,000 mile limited structural warranty. Review your coach's limited warranty in full for complete terms and conditions.

AROUND THE CLOCK SERVICE AND SUPPORT

When you take delivery of your new recreational vehicle, it's just the beginning of our exclusive around-the-clock Owner Advantage Program.

We offer an extensive support program with complete roadside assistance and special motor club benefits that follow you wherever your travels take you. We've teamed up with the largest RV emergency road service company in the country to give you immediate access to fast, dependable service when and where you need it. Add our toll-free service appointment assistance, plus a technical assistance hotline, and you have the security of full-time support at your fingertips.

For details, call toll-free 877-211-8135

23RB

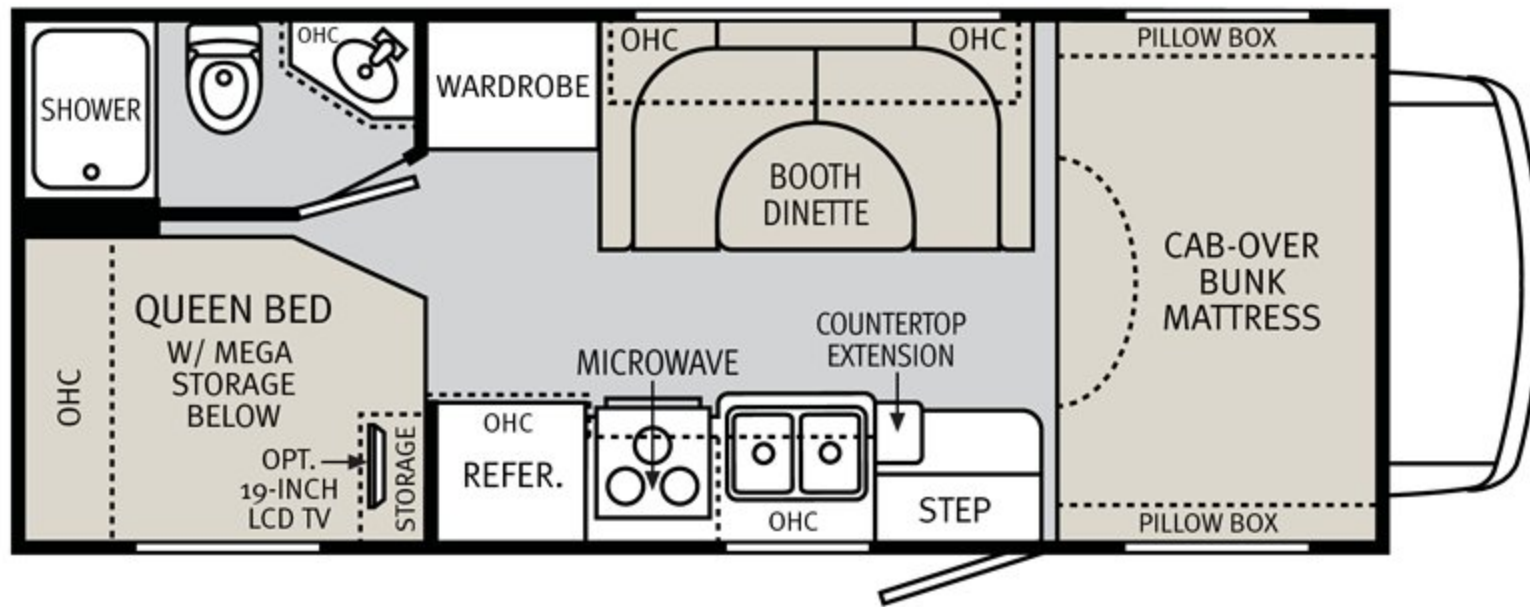

FLOORPLANS FOR LIVING.

Select from 23 and 31-foot floorplan designs, including a single-slide and a full-wall slide with additional bedroom slide, each with uniquely different configurations.

31SFD

FULL-WALL SLIDE

PANA suite

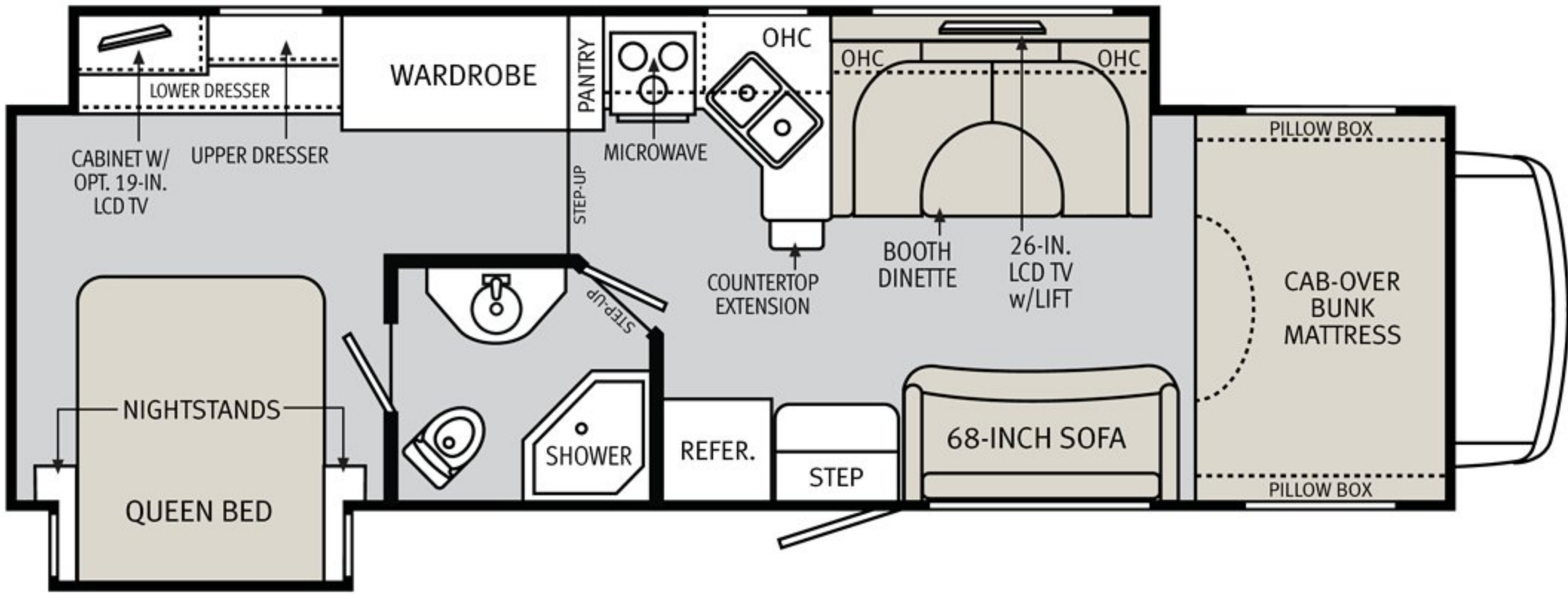

A

31WBS

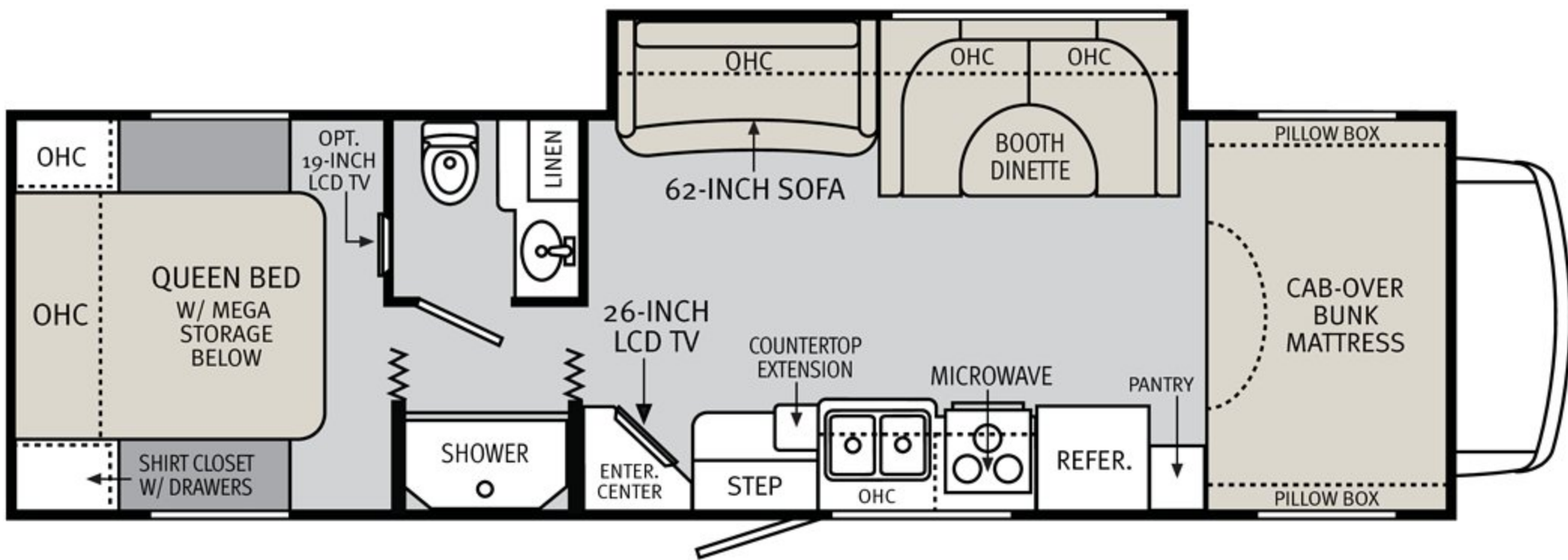

FURNITURE OPTIONS:

HIDE-A-BED SOFA (ROADSIDE)



A

WEIGHTS

Gross Vehicle Weight Rating (Lbs.)

Gross Combined Weight Rating¹ (Lbs.)

Front Gross Axle Weight Rating (Lbs.)

Rear Gross Axle Weight Rating (Lbs.)

MEASUREMENTS

Wheelbase

Overall Length w/o Ladder and Spare Tire

Overall Height, Including AC

Interior Height (on main floor)

Interior Width

Exterior Width

TANK CAPACITIES²

Gray Tank (Gal.) (Two gray tanks on 31SFD and 31WBS)

Black Tank (Gal.)

Fresh Tank (Gal.)

Fuel Tank (Gal.)

LP Tank³ (Lbs./Gal.)

Due to continuous product improvements, please visit us online at holidayrambler.com

¹Towing capacity is limited by GCWR; your vehicle's towing capacity is the difference between the GCWR and the actual vehicle weight, including all water, fuel, passengers and cargo. Your towed vehicle should be equipped with auxiliary brakes if the weight of the towed vehicle exceeds 1,000 lbs. consult your owner's manual for further towing information.

²All tank capacities are estimated based upon calculations provided by the tank manufacturers and represent approximate capacities. The actual "usable capacity" may be greater or less than the estimated capacities based upon fabrication and installation of the tanks.

³Actual filled LP capacity is 80% of listing due to safety shut-off required on tank.

The actual overall length of the recreational vehicle may differ from that indicated in the brochure due to variances in the manufacturing process and/or installed components. The actual length may be greater or less than that indicated. Due to the large variety of options and floorplan arrangements available to our customers, actual weights for each unit can differ significantly. Holiday Rambler provides a weight sticker on each unit we produce which includes that unit's tank capacities and approximate weight. Consult your local Holiday Rambler dealer for unit availability and further information. The information printed in this brochure reflects product design, fabrication, and component parts at the date of printing. The manufacturer reserves the right, at any time, to make changes in product design or material or component specifications as its sole option, without notice.

23RB**31SFD****31WBS**

11,500

14,500

14,500

18,500

20,000

20,000

4,600

5,000

5,000

7,800

9,500

9,500

23RB**31SFD****31WBS**

160"

223"

223"

23' 11"

31' 11"

32' 4"

10' 8"

10' 10"

10' 10"

82"

82"

82"

96"

96"

96"

99"

99"

99"

23RB**31SFD****31WBS**

33

26 / 24

26 / 24

35

26

26

61

51

51

40

55

55

42 / 9.76

42 / 9.76

42 / 9.76

om for the latest in standards, options, specifications and technical data.

This includes the substitution of components of a different brand or trade name which will result in comparable performance. All information printed in this brochure is subject to change after the date of printing. Some features shown or mentioned in this brochure are optional and may only be available in selected floorplans. Photographs may depict a floorplan option that has been discontinued or is no longer available at the time of your purchase. Photographs may show props or decorations that are not standard equipment. Holiday Rambler, the Holiday Rambler logo and its design, are registered trademarks. Other products and company names are trademarks and/or registered trademarks of their respective holders. While the color of the motorhome's exterior and the interior fabrics depicted in this sales brochure are fair and reasonable depictions,

the colors depicted may not be an exact match of the actual colors because of the variances in photo-processing and printing. Due to product improvements, changes during the model year and/or transcription errors that may occur, information represented within this brochure may not be accurate at the time of your purchase. If certain information is significant to your purchasing decision, please confirm the information with your dealer. Component part and appliance manufacturers issue limited warranties covering portions of the recreational vehicle not covered under the Limited Warranties issued by Monaco RV, LLC. To learn specific details regarding warranty coverage, please contact your selling dealership or review the warranty packet inside the recreational vehicle.

STANDARD FEATURES

BODY CONSTRUCTION

- › Laminated Sidewall with Fiberglass Skin
- › Flat, Seamless Laminated Rubber Roof
- › Mega Storage Under Bed (23RB)
- › Large Storage Area Under Bed with Exterior Storage Door Access (31SFD)
- › Large Storage Area Under Bed with 3 Exterior Doors on Sidewall and Rear (31WBS)
- › Radius Exterior Storage Door w/ Door Catch
- › Front Radius Cap Profile
- › 4" Tube Bumper with End Caps
- › Rear Ladder
- › Drop-Down Step Framing at Entry Door for Coach Access
- › Battery Storage Under Second Entry Step
- › Battery Box Framing for 2 Batteries
- › Rear Wheel Mud Flaps
- › Deluxe Graphics Package
- › Aluminum Running Boards

FORD CHASSIS / ENGINE / SUSPENSION

- › Ford E350 11,500 lb. Chassis (23RB)
- › Ford E450 14,500 lb. Chassis (31SFD, 31WBS)
- › 6.8L Triton® V-10 Gasoline Engine w/ Electronic Fuel Injection; 305 HP @ 420 lbs./ft. Torque
- › 5-Speed TorqShift® Automatic Overdrive Transmission with In-Tank Oil Cooler
- › 115 Amp Alternator
- › Rear Axle Ratio 4.10:1 (E350 Chassis)
- › Rear Axle Ratio 4.56:1 (E450 Chassis)
- › Radial Tires (LT225/75R/16E)
- › Stainless Steel Wheel Covers
- › Rear Multi-Leaf Spring Suspension with Stabilizer Bar
- › Hellwig® Helper Springs (31SFD, 31WBS)
- › ABS Braking System
- › One 12V Chassis Battery
- › Hydraulic Leveling Jacks (31SFD)

- › 5,000 lb. Hitch Receiver with 7-Pin Connector
- › Emergency Start Circuit

COCKPIT

- › In-Dash Electronic AM/FM Stereo with Clock
- › Dual Air Bags
- › Multi-Positioned Sun Visors
- › Windshield Privacy Curtain
- › Fabric Pilot and Co-Pilot Cockpit Recliner Seats
- › Dash Heating and AC System with Defrost
- › Power Windows and Door Locks
- › Factory AC, Cruise Control and Tilt Steering Wheel
- › Intermittent Windshield Wipers
- › Map Lights

APPLIANCES AND ACCESSORIES

- › Large Double Door Refrigerator
- › Wedgewood 3-Burner Cook-Top
- › Lighted Power Range Hood
- › Built-In Microwave
- › 26" LCD TV Behind Dinette with Electric Lift (31SFD)
- › 26" LCD TV in Living Area (31WBS)
- › Exterior Hook-Ups for DSS Dish and Cable
- › TV Antenna and Dash Stereo Antenna
- › Interior Cable TV Hook-Up
- › Systems Monitor Panel for Battery Levels, Holding Tank Levels and Water Pump Switch

INTERIOR

- › Hillside Cherry Cabinetry
- › Cabinets with Square Raised-Panel Doors
- › Wood Grain Panel Refrigerator Insert
- › Accent Wall Paneling In Slide-Outs, Endwalls
- › Wallpaper Border in Bath
- › Heavy Duty Ball Bearing Drawer Guides

OPTIONAL FEATURES

BODY CONSTRUCTION

- › Power Heated Exterior Mirrors (Req. Option)
- › Fiberglass Running Boards
- › High-Gloss Fiberglass Walls
- › Lower Partial Paint Package
- › Mega Storage Lid Covers (23RB)
- › Chassis Undercoating

FORD CHASSIS / ENGINE / SUSPENSION

- › Spare Tire
- › Stainless Steel Wheel Inserts
- › Valve Stem Extenders
- › Hydraulic Leveling Jacks (31WBS)

COCKPIT

- › In-Dash Electronic AM/FM/CD Stereo Radio; Sirius Satellite Ready w/ SD Card Slot, USB Port for MP3 Player/Flash Drive, and Weather Band; LCD Back-Up Camera Monitor System with DVD Player
- › Leatherette Cockpit Seats
- › E450 Power Pilot Seat (N/A 23RB)

- › Instrument Panel Appliqué
- › Cab-Over Bunk Ladder

APPLIANCES AND ACCESSORIES

- › 3-Burner Range with Oven
- › Black-Folding Range Cover
- › Kitchen Sink Covers
- › Convection Microwave
- › Home Theater Surround Sound System w/ Sub-Woofer (Req. Back-Up System, Stereo and DVD Player Option)
- › Exterior Entertainment Center, CD Player Radio with 2 Speakers (N/A with Outside TV/Stereo Option)
- › 26" TV Option Available w/ Cab-Over Sleeping
- › Inside/Outside 26" Color LCD TV with Mounting Bracket and Hook-Ups (31SFD)
- › 19" LCD TV - Bedroom

INTERIOR

- › Decors; Cityscape, Sterling
- › Fulton Cherry Glazed Cabinetry
- › Night Shades Throughout Except Kitchen, Bunk Area

- › Laminated Countertops with Wood Grain Edge in Kitchen and Bath
- › Kitchen Countertop Extensions
- › Laminated Dinette Table Top with Wood Grain Edge
- › Decorative Slide-Out Fascia (N/A 23RB)
- › Linoleum Throughout
- › Soft-Touch Ceiling
- › Mirror Wardrobe Doors (N/A 31SFD)
- › Medicine Cabinet with Mirror in Bathroom
- › Mini Blinds Throughout
- › New-Style Wood Grain Headboard
- › New Beadsread w/ Reverse Sham
- › New Style Window Treatments in Living Area, Bedroom

FURNITURE

- › Queen Bed (N/A 23RB)
- › Queen Bed with Angled Corner (23RB)
- › Cab-Over Bunk Mattress
- › Leatherette Jackknife Sofa (N/A 23RB)
- › Fabric/Leatherette U-Shape Booth Dinette

ELECTRICAL SYSTEMS AND LIGHTS

- › 30 Amp 120V Distribution Panel
- › Detachable 30 Amp Power Cord
- › 55 Amp 12V Power Converter
- › Gas Generator
- › Battery Disconnect Switth
- › One 12V House Battery
- › Exterior Storage Lights in Under-Bed Compartment
- › Porch Light, Security Light
- › Patio Side Cable TV Hook-Up

PLUMBING AND LP SYSTEMS

- › Satin Nickel Kitchen Faucet w/ Pull-Out Sprayer
- › Stainless Steel Bath Sink w/ Satin Nickel Faucet

- › 6 Gallon LP Gas Water Heater w/ Electronic Ignition, DSI
- › 12V Water Pump
- › City Water Hook-Up
- › Gravity Water Fill (23RB)
- › Pressure Fill to Fresh Tank (N/A 23RB)
- › Water Heater By-Pass Valve
- › Toilet with Foot-Flush
- › Rectangle Shower w/ Vinyl Curtain (23RB, 31WBS)
- › Neo-Angle Shower w/ Glass Door (31SFD)
- › Contained Storage Area for Sewer Hose

HEATING, VENTS AND AIR CONDITIONING

- › Living Area: 13,500 BTU AC
- › Front Cab-Over Manual Roof Vent
- › Kitchen Manual Roof Vent
- › Bath 12V Power Roof Vent
- › Bedroom Manual Roof Vent (N/A 23RB)

WINDOWS, DOORS AND AWNINGS

- › Radius Entrance Door
- › Exterior and Interior Assist Entry Grab Handles
- › Tinted Radius Corner Windows
- › Skylight in Bathroom
- › Patio Awning
- › Topper Slide-Out Awnings (N/A 23RB)

SAFETY

- › Fire Extinguisher
- › Deadbolt Lock on Entrance Door
- › 120V GFI Protected Circuit, Kitchen, Bath and Exterior
- › LP Gas Detector
- › Smoke Detector
- › Carbon Monoxide Detector
- › Pilot and Co-Pilot Three-Point Seat Belts

- › Hardwood Raised-Panel Refrigerator Front

FURNITURE

- › Leatherette Hide-A-Bed Sofa (31WBS)
- › Leatherette U-Shape Booth Dinette

ELECTRICAL SYSTEMS AND LIGHTS

- › Second Coach House Battery
- › Onan® 4.0 kW Micro-Lite Generator w/ Auto Changeover

PLUMBING AND LP SYSTEMS

- › 6-Gallon Gas/Electric Water Heater with DSI
- › Outside Shower
- › Glass Shower Door (23RB, 31WBS)

HEATING, VENTS AND AIR CONDITIONING

- › Kitchen: 15,000 BTU AC
- › Heat Pads on Holding Tanks
- › Front Cab-Over Fantastic Fan Roof Vent

WINDOWS, DOORS AND AWNINGS

- › Electric Patio Awning
- › Dual-Pane Windows

2012

AnnaliteClassC



NAVISTAR

REVOLUTIONIZING THE RV

Monaco® RV is driven by the same sense of possibilities that makes RV travelers ask, Where To Next?™ That's why we've embarked on a new journey with Navistar® as our partner. With access to Navistar's 175 years of transportation expertise, we've got big ideas

on the drawing board and innovative new RVs rolling off the line. Monaco RV has shaped itself into a leader in the RV industry. In the spirit of pursuing what's next, we'll never stop looking for the next great innovation.