

**Fusion**



**Fusion**

FIFTH WHEEL



TOY HAULERS

Keystone RV  
Company







/// SHOWN HERE IN TITANIUM DECOR /// FZ412 // INTERIOR

Solid-surface countertops in the kitchen and bath are beautiful and durable. The high-rise pull out kitchen faucet allows you to easily fill larger vessels in the sink.



10" SUB WOOFER







*With automotive exterior lines and innovative interior patio door the New Fusion is **"More Than A Garage"**. Boasting a stylish modern interior with custom furniture and cabinetry the Fusion has a look that is unparalleled. One look at the Fusion is enough to get your heart racing. Being the **"Hottest Brand in the Industry"** is a Fusion standard.*



**/// BEDROOM WITH QUEEN SIZE BED SHOWN HERE & FUZION BATHROOM AT RIGHT ///**





LCD TV

**FZ395 // INTERIOR** /// SHOWN HERE IN BRUSHED NICKEL DECOR ///

Fuzion offers more and larger windows than any other RV in its class. And virtually all Fuzion windows open to bring in the fresh air..





/// SHOWN HERE IN SAHARA DECOR ///

FZ315//INTERIOR

Leather wrapped valances and lambrequins with recessed lighting above add to the elegance, and day/night shades provide functionality.

TWELVE CUBIC FOOT  
REFRIGERATOR





**MAN CAVE...  
GREAT FOR TAILGATING  
OR JUST RELAXING**



**IT'S NOT JUST A GARAGE...  
IT'S VERSATILITY...**



**SCREENED IN PORCH FOR  
MAXIMUM COMFORT**



**BUNK HOUSE OFFERS THE COMFORT  
OF HOME ON THE ROAD**



# GARAGE





FZ395 // GARAGE

/// SHOWN HERE IN SAHARA DECOR ///

In addition, you find four opening windows in most of our garages, and five in the 395 and 399 models. Talk about the Fuzion difference!

MINI REFRIGERATOR



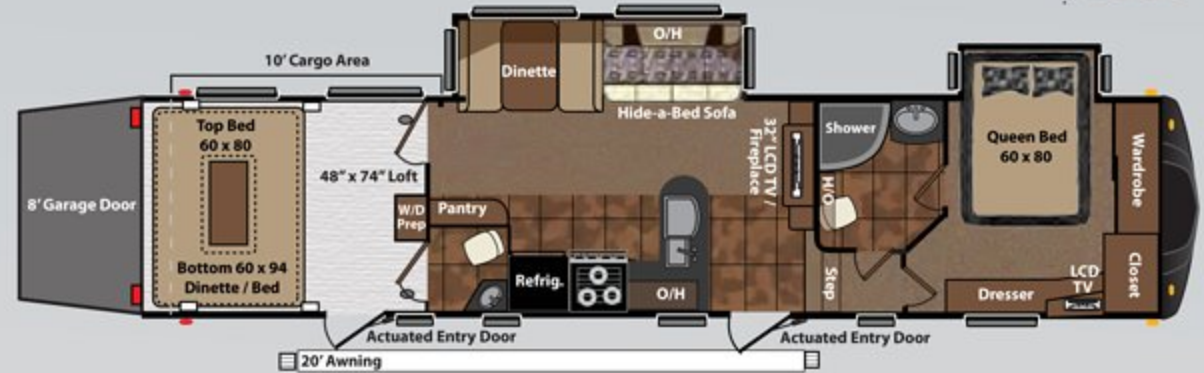

- » 102" WIDE-BODY
- » 10" OR 12" STEEL TWIN I-BEAM FRAME
- » 3/8" DECKING ON ROOF
- » 5/8" ONE-PIECE DECKING IN LIVING AREA
- » 1" ONE-PIECE DECKING IN GARAGE
- » 5" WOOD TRUSSED ROOF, 16" ON CENTER
- » FULL WALK-ON ROOF
- » ALUMINUM FRAMED, FULLY LAMINATED FIBERGLASS SIDEWALLS
- » EXPANDED POLYSTYRENE (EPS) BLOCK FOAM INSULATION IN SIDEWALLS
- » RADIANT-FOIL INSULATION IN SLIDE-OUT FLOORS
- » ALUMINUM FRAME FLOOR JOIST
- » SLAM LATCH BAGGAGE DOORS



35



39



35

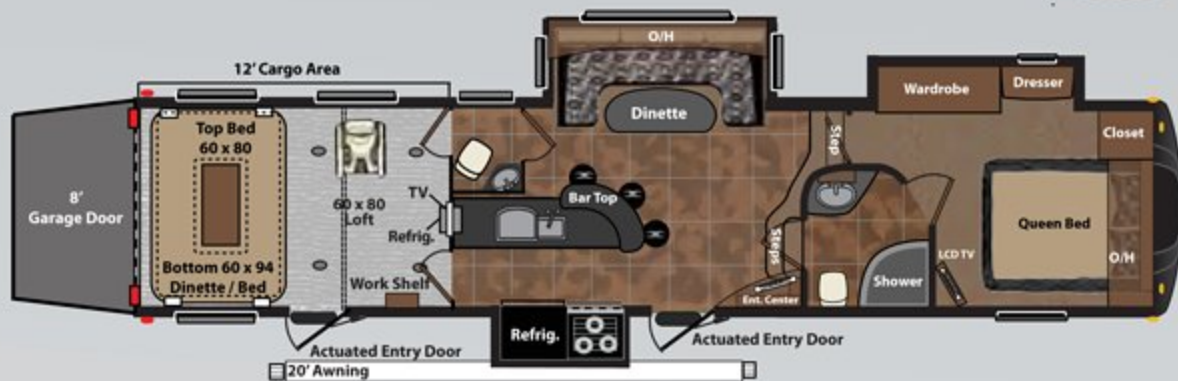

42



# FLOORPLANS

MODEL	310	315	322	360	375	395	399	412
SHIPPING WEIGHT	12,065	12,270	12,015	13,510	TBD	13,750	13,880	14,360
CARRYING CAPACITY	4,435	4,230	4,485	4,490	4,130	4,250	4,120	3,640
HITCH WEIGHT	2,770	3,015	2,895	3,090	TBD	3,100	3,560	3,370
LENGTH	35' 7"	36' 5"	35' 2"	39' 6"	40' 4"	40' 6"	41'	41'
HEIGHT	13' 1"	13' 1"	13' 1"	13' 3"	13' 3"	13' 3"	13' 3"	13' 3"
FRESH WATER	112	112	112	112	112	112	112	112
WASTE WATER	43	43	43	86	43	86	43	43
GRAY WATER	86	86	86	86	86	43	86	86
LPG	90	90	90	90	90	90	90	90

WEIGHTS & MEASUREMENTS

DISCLAIMER: Product information is as accurate as possible as of the date of publication of this brochure. All features, floor plans, and specifications in this brochure are subject to change without notice. Please also consult Keystone's web site at [www.keystonerv.com](http://www.keystonerv.com) for more current product information and specifications. Tow Vehicle Disclaimer. CAUTION: Owners of Keystone recreational vehicles are solely responsible for the selection and proper use of tow vehicles. All customers should consult with a motor vehicle manufacturer or their dealer concerning the purchase and use of suitable tow vehicles for Keystone products. Keystone disclaims any liability or damages suffered as a result of the selection, operation, use or misuse of a tow vehicle. KEYSTONE'S LIMITED WARRANTY DOES NOT COVER DAMAGE TO THE RECREATIONAL VEHICLE OR THE TOW VEHICLE AS A RESULT OF THE SELECTION, OPERATION, USE OR MISUSE OF THE TOW VEHICLE. 02/12



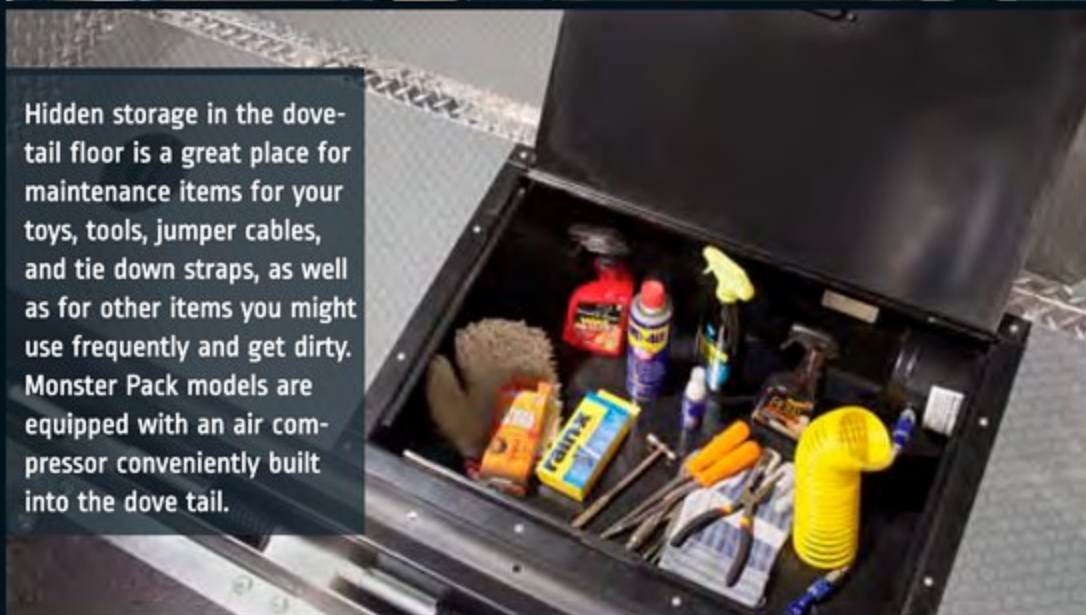
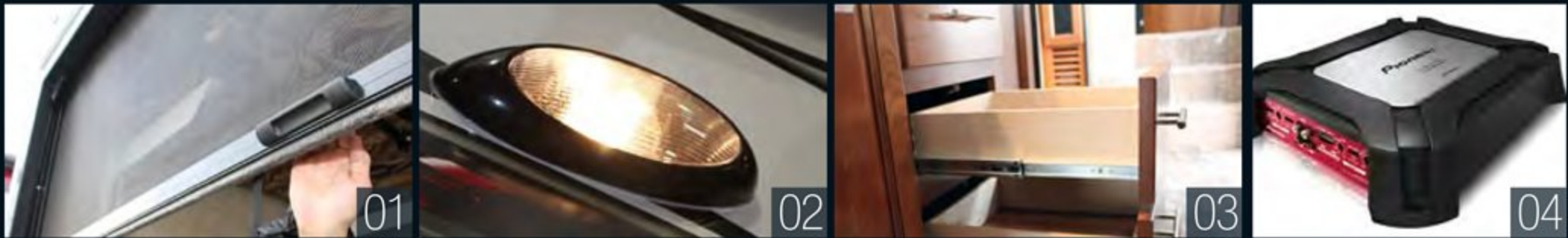

Hidden storage in the dove-tail floor is a great place for maintenance items for your toys, tools, jumper cables, and tie down straps, as well as for other items you might use frequently and get dirty. Monster Pack models are equipped with an air compressor conveniently built into the dove tail.

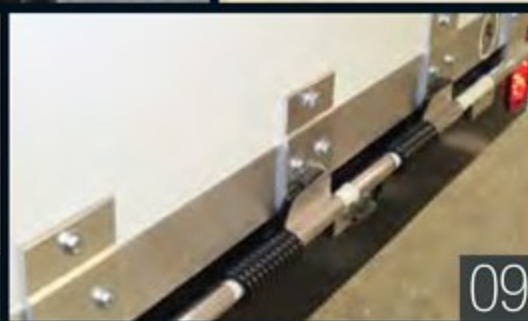

- 01 PULL DOWN SCREEN IN GARAGE
- 02 SECURITY LIGHT
- 03 FULL-EXTENSION BALL BEARING DRAWER GUIDES
- 04 AMPLIFIER
- 05 DYNAMICS 4590 POWER CONVERTER
- 06 ONE-PIECE FIBERGLASS SHOWER SURROUND
- 07 CENTRAL HOOK-UP CONVENIENCE CENTER
- 08 GAS STRUTS ON ENTRY DOORS
- 09 RAMP DOOR SPRING ASSIST
- 10 TOUCH SCREEN STEREO
- 11 TIE DOWNS-WELDED TO FRAME FOR SUPERIOR STRENGTH

In conjunction with these high-lighted features, Fuzion offers two gray water tanks with 86 gallons of capacity, a black tank with 43 gallons of capacity, and 100 gallons of fresh water. For most models, 60 pounds of propane with automatic change over comes standard. Once again, Fuzion is setting the bar.



# STANDARDS & OPTIONS

## INTERIOR //

- 200 Watt Premium Stereo with CD/DVD Player, Flat Panel LCD HDTV, 4 Interior Speakers, 2 All Weather Exterior Speakers, 400 Watt Amplifier, 10" Sub-woofer in Enclosed Speaker Box, A & B Indoor/Outdoor Speaker Switch
- Fuzion Central Command Center
- 12 Volt Disconnect by Entry Door
- Ducted 15,000 BTU A/C with Cold Air Dump
- Wired, Braced, and Ducted for 2nd A/C in Bedroom
- Insulated A/C Ductwork
- Space Saver Microwave with Hood Vent and Filter
- 3 Burner Range Top and 22" Oven
- 8 or 12 Cu. Ft. Refrigerator [per model]
- Raised Solid Wood Refer Panel
- Metal Paper Towel Holder
- Waste Basket
- Professional Bottle Opener with Cap Catch [Bar Models]
- Step Rail on Island [Bar Models]
- Kitchen Sink Covers
- Solid Wood Cabinet Doors
- Lumber-Core Cabinetry
- Screwed Cabinetry - No Staples
- Residential Cabinet Hardware
- Solid Wood Drawer Frames
- 80lb. Rated Full-Extension Ball Bearing Drawer Guides
- Overhead Cargo Netting
- Recessed Puck Lighting
- Custom Furniture with Custom Embroidery
- Hide-a-Bed Sofa with Flip-Down Arm Rest and Built-In Cup Holders [Some Models]
- Huge U-Shaped Dinette with Electric Air Mattress Hide-a-Bed
- Night Shades
- Cross Ventilation Throughout - All Windows Open
- Multiple Sky Windows [Most Models]
- Vinyl Wrapped Hard Window Treatments with Fabric Inlay

- 30" Wide Radius Entry Door with Screen
- Coat Closet by Entry Door with Coat Hooks
- Multiple Cable TV Connections
- Satellite Prep
- Digital Splitters Throughout for HDTV
- TV Antenna with Power Booster
- Exterior Stereo Antenna
- 60" x 80" Residential Size Queen Bed
- Deluxe Innerspring Mattress
- Storage Under Bed
- 2 Windows in Bed Slide - Cross Ventilation
- One Piece Shower Surround
- Residential, Adjustable, Hand-Held Massaging Shower Fixture
- Skylight Over Shower
- Porcelain Toilet with Foot Flush
- Power Exhaust Fan in Commode Room
- Mirrored Medicine Cabinet
- Steel Loft Bunk Ladder [Garage Models]
- 60" x 80" Residential Size Loft Mattress
- LPG Detector
- Carbon Monoxide Detector
- Fire Extinguisher
- GFI Duplex Receptacles

## EXTERIOR //

- Aerodynamic Fiberglass Front Cap with Lights and 30% Improved Turning Radius
- Attic Vents
- Step Light
- Security Lights
- Cargo Ramp Loading Lights
- Compartment Lights
- LED Tail/Brake Lights
- Black Slide-Out End Walls
- Black Clamp Ring Tinted Safety Glass Windows
- Crank Down Spare Tire and Carrier
- Detachable Ladder [Side Mount]
- Folding Entry Assist Handle with Padding
- Hydraulic Front Landing Gear

## GARAGE //

- Safety Glass 5' Patio Door with Screen Privacy Curtain with Tie-Back
- Washer/Dryer Prep
- Diamond Plate Protection on Sidewalls
- Metal RAM Air Vents [2]
- 8' Spring Assisted Ramp Door
- Full Size 30" Wide Entry Door with Screen

- Gas/Oil Resistant Tuff-Ply Flooring
- 2500lb. Rated Recessed D-Rings Welded onto Steel Chassis
- Air Conditioner Duct
- Power Exhaust Vent with Wall Switch
- Clothes Hanger
- Fuel Station with 12V Pump, 30 Gallon Fuel Tank, and Static Line
- Cable TV Jack
- Mini Blinds

## EQUIPMENT //

- 7,000 lb. EZ Lube Axles
- Flipped Axles
- Electric 2" x 12" Brakes on Every Wheel
- 16" Aluminum Wheels
- 16" Load Range "E" Radial Tires
- 12 Gallon Gas / Electric Water Heater with Direct Spark Ignition
- Low-Rise Triple Entrance Step
- Electric One Touch Awning
- Electric Rear Stabilizer Jacks
- Hydraulic Front Jacks
- 50 AMP Service with Detachable Marine Power Cord
- 100 AMP Converter
- Water Heater By-Pass
- Black Tank Flush
- Enclosed Termination Valves
- Outside Shower with Hot and Cold Water
- Generator Prep with Start / Stop Switch, Hour Meter and Fuel Gauge
- 35,000 BTU Furnace
- Heated, Insulated, Enclosed Holding Tanks
- Hydraulic Slide-Out System with Manual Override

## \*OPTIONS //

- 5500 Watt Generator
- Double Electric Beds with Dual Opposing Sofas
- 6pt. Level-Up System
- 2nd A/C with Heat Strip
- Dual Pane Windows
- Rear Ramp Patio with Awning
- 2nd Awning
- Fuzion Full Body Paint

Features Centrally Located  
in Convenience Center





**FZ301//INTERIOR** /// SHOWN HERE IN BRUSHED NICKEL DECOR ///

Kitchen slide, private bath and 10' private garage are just a few of the key features on this highly versatile 301 model.



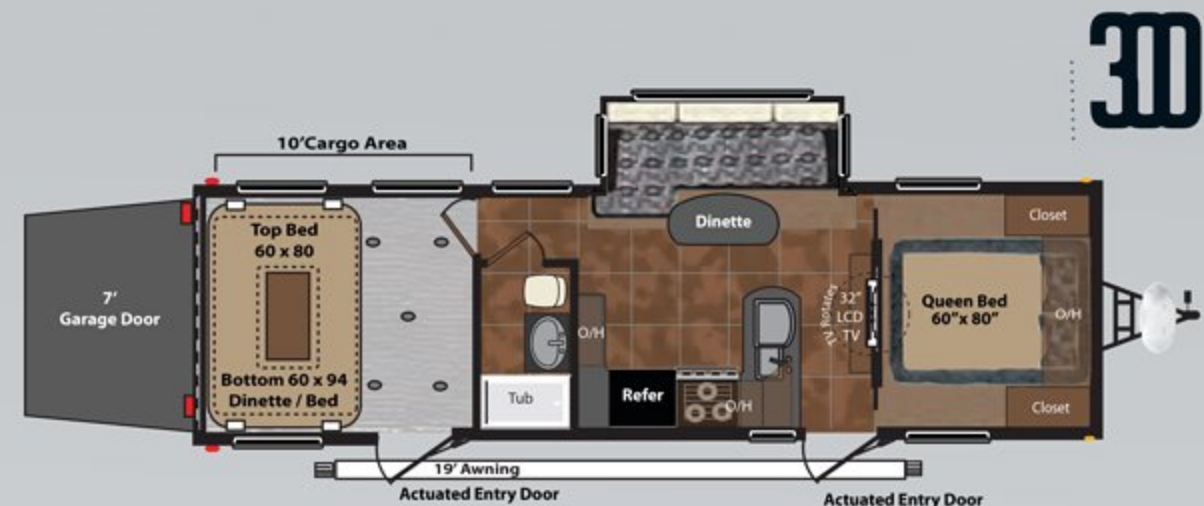

# FLOORPLANS



Under 35-feet in length, these toy haulers are ideal for those looking to explore the backroads. Boasting a full sized 10-foot garage separated from the living area by a vapor door. Fuzion is one of the few smaller toy hauler trailers on the market with these unique features.

MODEL	260	300	301
SHIPPING WEIGHT	6,735	8,445	9,150
CARRYING CAPACITY	4,555	4,555	3,850
HITCH WEIGHT	1,130	1,305	1,380
LENGTH	30' 6"	34' 8"	34' 8"
HEIGHT	12' 2"	12' 2"	12' 2"
FRESH WATER	106	106	106
WASTE WATER	32	32	32
GRAY WATER	32	32	32
LPG	60	60	60





/// SHOWN HERE IN BRUSHED NICKEL DECOR /// FZ301//INTERIOR

Fuzion cabinets feature hidden hinges and solid, raised panel cherry wood. Brushed nickel cabinet door pulls are stylish and functional. Full-extension metal drawer guides are rated to hold 80 pounds.



# STANDARDS & OPTIONS

# FUZION

## INTERIOR

- 32" LCD TV
- CD/DVD Player with MP3 Connection
- 2 Interior, 2 Exterior Speakers and a 10" Sub Woofer
- Amplifier and A/B/C Speaker Switch
- Custom Roll Over Sofa Sleeper
- Residential Queen Sized Mattress in the Bedroom
- Dual Electric Beds with Couch Combo [ 260 ]
- Dual Electric Beds with Picnic Table [ N/A 260 ]
- Night Shades and Mini Blinds
- Microwave Oven
- 3 Burner Cook Stove
- 17" Oven
- Generator Start/Stop Switch with Hour Meter and Fuel Gauge
- 13.5 Btu Ducted Air Conditioner
- Ducted Furnace
- Tuff Ply Flooring in the Cargo Area
- 2 Ram Air Vents in the Cargo Area

## EXTERIOR

- Aluminum Constructed, Fully Laminated Fiberglass Sidewalls
- Heated Enclosed Tanks
- R-9 sidewall, R-9 roof, R9 floor insulation
- 102" Wide Body
- 15" Wheels with 5,200 lb. Axles [ 260 and 295 ]
- 16" Wheels with 7,000 lb. Axles [ 300, 301 ]
- Generator Prep
- Spare Tire with Carrier
- LED Tail and Brake Lights
- Electric Patio Awning
- Aluminum Wheels
- Diamond Plate Rock Guard on the Front
- Exterior Shower with Hot and Cold Water
- 6 Gallon Gas/Electric Water Heater with DSI
- 28 Gallon Fuel Station with Pump

## \*OPTIONAL FEATURES

- Onan 4000 Watt Gasoline Generator
- Dual Pane Safety Glass Windows
- Onan 5500 Watt Gasoline Gen. [ 301 ]
- Dual AC's [ 301 ]
- 15K A/C
- Patio System



Get the free mobile app  
at <http://gettag.mobi>  
and scan this Tag.





Keystone RV  
Company



# FUSION

TRAVEL TRAILER



TOY HAULERS

FUSION



Keystone RV  
Company



Go RVing



WWW.KEYSTONERV.COM | 574.535.2100 | 2642 HACKBERRY DRIVE | P.O. BOX 2000 | GOSHEN, IN 46527