



Bamboo Décor

Basil Décor

Walnut Décor

Standards

- Eurodynamic Front Cap
- Stabilizer Jacks
- Awning with Drip Rail and Spouts
- Microwave with Turn Table
- 13,500 BTU Ducted A/C
- Enclosed Pin Box
- Security Light
- 6 Gallon Gas/Electric DSI Water Heater
- Skylight Over Tub
- Pillows for Sofa
- Wire for Satellite
- Heated Tanks and Enclosed Underbelly
- Tinted Windows
- Black Tank Flush System
- Power Jacks
- 6 Cubic Foot Refrigerator with Raised Panel Wood Insert

32" LCD TV

- Assist Grab Handle
- Night Shades
- AM/FM/CD/DVD Player with USB Port
- Porcelain Toilet
- Outside Speakers
- Innerspring Mattress
- Roller Ball Bearing Drawer Guides
- Dexter **NEV-R-ADJUST™** Brakes
- Gas Struts on Bed Base
- Outside Shower
- Bus Style Slam Latch Baggage Doors
- Decorative Light Above Dinette
- Solid Surface Countertops

Options

- Partial Paint Package
- Solid Surface Countertop Extension
- Hide-A-Bed (Forced on D326RE)
- Table and Chairs with Leaf
- Recliner – 1 or 2
- 2 Barrel Chairs IPO Sofa (D245SB Only)
- 8 Cubic Foot Refrigerator
- Fireplace (N/A on D275RL)
- Dyson® Vacuum
- Fan-Tastic Vent® (Bedroom and Bathroom)
- 15,000 BTU A/C (IPO 13,500 BTU A/C)
- Ladder
- Power Awning
- Aluminum Wheels
- Bike Rack/Cargo Tray
- Dexter E-Z Flex® Heavy Duty Rubber Suspension
- Outside Grill

Spare Tire/Carrier/Cover

- Sidewinder Hitch
- Wardrobe Slide (D245SB and D275RL Only)
- Flip Up Bunk with Jiffy (D296BH Only)
- Entry Door in Bathroom (D296BH Only)
- Katching ZZ's Mattress Upgrade
- Large U-Shape Dinette (IPO Sofa and Dinette)

Road Trip Package

- Aluminum Wheels
- Dexter E-Z Flex® Heavy Duty Rubber Suspension
- Spare Tire/Carrier/Cover
- Ladder
- Power Awning
- 8 Cubic Foot Refrigerator
- Innerspring Mattress

KZ RECREATIONAL VEHICLES
DURANGO 1500



Bike Rack

Cargo Carrier

The optional Bike Rack/Cargo Carrier offers you even greater versatility for those "extra" items you don't want to leave at home.



Optional Dyson® Vac



D326RE Shown in Bamboo Décor

ASK ABOUT OUR 2-YEAR LIMITED WARRANTY!



Dealer Satisfaction Index: Ratings of manufacturers, by dealers, have consistently awarded KZ top honors for excellence of design, reliability, overall quality and value, communications and dealer support.

Dealer:



Portions of this brochure were used with the expressed authority of Dexter Axle, but Dexter Axle is not responsible for the accuracy of the information contained herein.

For more product details and in-depth information, visit us on the web at www.kz-rv.com

0985 N 900 W • Shipshewana, IN 46565
E-mail kz@kz-rv.com • www.kz-rv.com

Due to continual research and advances, manufacturer reserves the right to change specifications, design, price and equipment without notice, and assumes no responsibility for any error in this literature. Some items shown are not included as standard or optional equipment.
©2012KZ | 1/20/12 | 15M



Come home to KZ!

www.kz-rv.com

DURANGO 1500

Light weight and beautifully appointed, there's a model just right for you.





Bamboo Décor

Basil Décor

Walnut Décor

Standards

- Eurodynamic Front Cap
- Stabilizer Jacks
- Awning with Drip Rail and Spouts
- Microwave with Turn Table
- 13,500 BTU Ducted A/C
- Enclosed Pin Box
- Security Light
- 6 Gallon Gas/Electric DSI Water Heater
- Skylight Over Tub
- Pillows for Sofa
- Wire for Satellite
- Heated Tanks and Enclosed Underbelly
- Tinted Windows
- Black Tank Flush System
- Power Jacks
- 6 Cubic Foot Refrigerator with Raised Panel Wood Insert

32" LCD TV

- Assist Grab Handle
- Night Shades
- AM/FM/CD/DVD Player with USB Port
- Porcelain Toilet
- Outside Speakers
- Innerspring Mattress
- Roller Ball Bearing Drawer Guides
- Dexter **NEV-R-ADJUST™** Brakes
- Gas Struts on Bed Base
- Outside Shower
- Bus Style Slam Latch Luggage Doors
- Decorative Light Above Dinette
- Solid Surface Countertops

Options

- Partial Paint Package
- Solid Surface Countertop Extension
- Hide-A-Bed (Forced on D326RE)
- Table and Chairs with Leaf
- Recliner – 1 or 2
- 2 Barrel Chairs IPO Sofa (D245SB Only)
- 8 Cubic Foot Refrigerator
- Fireplace (N/A on D275RL)
- Dyson® Vacuum
- Fan-Tastic Vent® (Bedroom and Bathroom)
- 15,000 BTU A/C (IPO 13,500 BTU A/C)
- Ladder
- Power Awning
- Aluminum Wheels
- Bike Rack/Cargo Tray
- Dexter E-Z Flex® Heavy Duty Rubber Suspension
- Outside Grill

Spare Tire/Carrier/Cover

- Sidewinder Hitch
- Wardrobe Slide (D245SB and D275RL Only)
- Flip Up Bunk with Jiffy (D296BH Only)
- Entry Door in Bathroom (D296BH Only)
- Katching ZZ's Mattress Upgrade
- Large U-Shape Dinette (IPO Sofa and Dinette)

Road Trip Package

- Aluminum Wheels
- Dexter E-Z Flex® Heavy Duty Rubber Suspension
- Spare Tire/Carrier/Cover
- Ladder
- Power Awning
- 8 Cubic Foot Refrigerator
- Innerspring Mattress

KZ RECREATIONAL VEHICLES
DURANGO
1500



Bike Rack

Cargo Carrier

The optional Bike Rack/Cargo Carrier offers you even greater versatility for those "extra" items you don't want to leave at home.



Optional Dyson® Vac



D326RE Shown in Bamboo Décor

ASK ABOUT OUR 2-YEAR LIMITED WARRANTY!



Dealer Satisfaction Index: Ratings of manufacturers, by dealers, have consistently awarded KZ top honors for excellence of design, reliability, overall quality and value, communications and dealer support.

Dealer:



Portions of this brochure were used with the expressed authority of Dexter Axle, but Dexter Axle is not responsible for the accuracy of the information contained herein.

For more product details and in-depth information, visit us on the web at www.kz-rv.com

0985 N 900 W • Shipshewana, IN 46565
E-mail kz@kz-rv.com • www.kz-rv.com

Due to continual research and advances, manufacturer reserves the right to change specifications, design, price and equipment without notice, and assumes no responsibility for any error in this literature. Some items shown are not included as standard or optional equipment.
©2012KZ | 1/20/12 | 15M



Come home to KZ!

www.kz-rv.com

DURANGO
1500

Light weight and beautifully appointed, there's a model just right for you.





Standards

- Eurodynamic Front Cap
- Stabilizer Jacks
- Awning with Drip Rail and Spouts
- Microwave with Turn Table
- 13,500 BTU Ducted A/C
- Enclosed Pin Box
- Security Light
- 6 Gallon Gas/Electric DSI Water Heater
- Skylight Over Tub
- Pillows for Sofa
- Wire for Satellite
- Heated Tanks and Enclosed Underbelly
- Tinted Windows
- Black Tank Flush System
- Power Jacks
- 6 Cubic Foot Refrigerator with Raised Panel Wood Insert

Options

- 32" LCD TV
 - Assist Grab Handle
 - Night Shades
 - AM/FM/CD/DVD Player with USB Port
 - Porcelain Toilet
 - Outside Speakers
 - Innerspring Mattress
 - Roller Ball Bearing Drawer Guides
 - Dexter **NEV-R-ADJUST™** Brakes
 - Gas Struts on Bed Base
 - Outside Shower
 - Bus Style Slam Latch Baggage Doors
 - Decorative Light Above Dinette
 - Solid Surface Countertops
- Options**
- Partial Paint Package
 - Solid Surface Countertop Extension
 - Hide-A-Bed (Forced on D326RE)
 - Table and Chairs with Leaf
 - Recliner – 1 or 2
 - 2 Barrel Chairs IPO Sofa (D245SB Only)
 - 8 Cubic Foot Refrigerator
 - Fireplace (N/A on D275RL)
 - Dyson® Vacuum
 - Fan-Tastic Vent® (Bedroom and Bathroom)
 - 15,000 BTU A/C (IPO 13,500 BTU A/C)
 - Ladder
 - Power Awning
 - Aluminum Wheels
 - Bike Rack/Cargo Tray
 - Dexter E-Z Flex® Heavy Duty Rubber Suspension
 - Outside Grill

Options

- Spare Tire/Carrier/Cover
 - Sidewinder Hitch
 - Wardrobe Slide (D245SB and D275RL Only)
 - Flip Up Bunk with Jiffy (D296BH Only)
 - Entry Door in Bathroom (D296BH Only)
 - Katching ZZ's Mattress Upgrade
 - Large U-Shape Dinette (IPO Sofa and Dinette)
- Road Trip Package**
- Aluminum Wheels
 - Dexter E-Z Flex® Heavy Duty Rubber Suspension
 - Spare Tire/Carrier/Cover
 - Ladder
 - Power Awning
 - 8 Cubic Foot Refrigerator
 - Innerspring Mattress

KZ RECREATIONAL VEHICLES
DURANGO 1500



The optional Bike Rack/Cargo Carrier offers you even greater versatility for those "extra" items you don't want to leave at home.



Optional Dyson® Vac



D326RE Shown in Bamboo Décor

ASK ABOUT OUR 2-YEAR LIMITED WARRANTY!



Dealer Satisfaction Index: Ratings of manufacturers, by dealers, have consistently awarded KZ top honors for excellence of design, reliability, overall quality and value, communications and dealer support.

Dealer:



Portions of this brochure were used with the expressed authority of Dexter Axle, but Dexter Axle is not responsible for the accuracy of the information contained herein.

For more product details and in-depth information, visit us on the web at www.kz-rv.com

0985 N 900 W • Shipshewana, IN 46565
E-mail kz@kz-rv.com • www.kz-rv.com

Due to continual research and advances, manufacturer reserves the right to change specifications, design, price and equipment without notice, and assumes no responsibility for any error in this literature. Some items shown are not included as standard or optional equipment.
©2012KZ | 1/20/12 | 15M



Come home to KZ!

www.kz-rv.com

DURANGO 1500

Light weight and beautifully appointed, there's a model just right for you.





Bamboo Décor

Basil Décor

Walnut Décor

Standards

- Eurodynamic Front Cap
- Stabilizer Jacks
- Awning with Drip Rail and Spouts
- Microwave with Turn Table
- 13,500 BTU Ducted A/C
- Enclosed Pin Box
- Security Light
- 6 Gallon Gas/Electric DSI Water Heater
- Skylight Over Tub
- Pillows for Sofa
- Wire for Satellite
- Heated Tanks and Enclosed Underbelly
- Tinted Windows
- Black Tank Flush System
- Power Jacks
- 6 Cubic Foot Refrigerator with Raised Panel Wood Insert

32" LCD TV

- Assist Grab Handle
- Night Shades
- AM/FM/CD/DVD Player with USB Port
- Porcelain Toilet
- Outside Speakers
- Innerspring Mattress
- Roller Ball Bearing Drawer Guides
- Dexter **NEV-R-ADJUST™** Brakes
- Gas Struts on Bed Base
- Outside Shower
- Bus Style Slam Latch Luggage Doors
- Decorative Light Above Dinette
- Solid Surface Countertops

Options

- Partial Paint Package
- Solid Surface Countertop Extension
- Hide-A-Bed (Forced on D326RE)
- Table and Chairs with Leaf
- Recliner – 1 or 2
- 2 Barrel Chairs IPO Sofa (D245SB Only)
- 8 Cubic Foot Refrigerator
- Fireplace (N/A on D275RL)
- Dyson® Vacuum
- Fan-Tastic Vent® (Bedroom and Bathroom)
- 15,000 BTU A/C (IPO 13,500 BTU A/C)
- Ladder
- Power Awning
- Aluminum Wheels
- Bike Rack/Cargo Tray
- Dexter E-Z Flex® Heavy Duty Rubber Suspension
- Outside Grill

Spare Tire/Carrier/Cover

- Sidewinder Hitch
- Wardrobe Slide (D245SB and D275RL Only)
- Flip Up Bunk with Jiffy (D296BH Only)
- Entry Door in Bathroom (D296BH Only)
- Katching ZZ's Mattress Upgrade
- Large U-Shape Dinette (IPO Sofa and Dinette)

Road Trip Package

- Aluminum Wheels
- Dexter E-Z Flex® Heavy Duty Rubber Suspension
- Spare Tire/Carrier/Cover
- Ladder
- Power Awning
- 8 Cubic Foot Refrigerator
- Innerspring Mattress

KZ RECREATIONAL VEHICLES
DURANGO
1500



Bike Rack

Cargo Carrier

The optional Bike Rack/Cargo Carrier offers you even greater versatility for those "extra" items you don't want to leave at home.



Optional Dyson® Vac



D326RE Shown in Bamboo Décor

ASK ABOUT OUR 2-YEAR LIMITED WARRANTY!



Dealer Satisfaction Index: Ratings of manufacturers, by dealers, have consistently awarded KZ top honors for excellence of design, reliability, overall quality and value, communications and dealer support.

Dealer:



Portions of this brochure were used with the expressed authority of Dexter Axle, but Dexter Axle is not responsible for the accuracy of the information contained herein.

For more product details and in-depth information, visit us on the web at www.kz-rv.com

0985 N 900 W • Shipshewana, IN 46565
E-mail kz@kz-rv.com • www.kz-rv.com

Due to continual research and advances, manufacturer reserves the right to change specifications, design, price and equipment without notice, and assumes no responsibility for any error in this literature. Some items shown are not included as standard or optional equipment.
©2012KZ | 1/20/12 | 15M



Come home to KZ!

www.kz-rv.com

DURANGO
1500

Light weight and beautifully appointed, there's a model just right for you.



2012 Durango 1500 Cut-Away

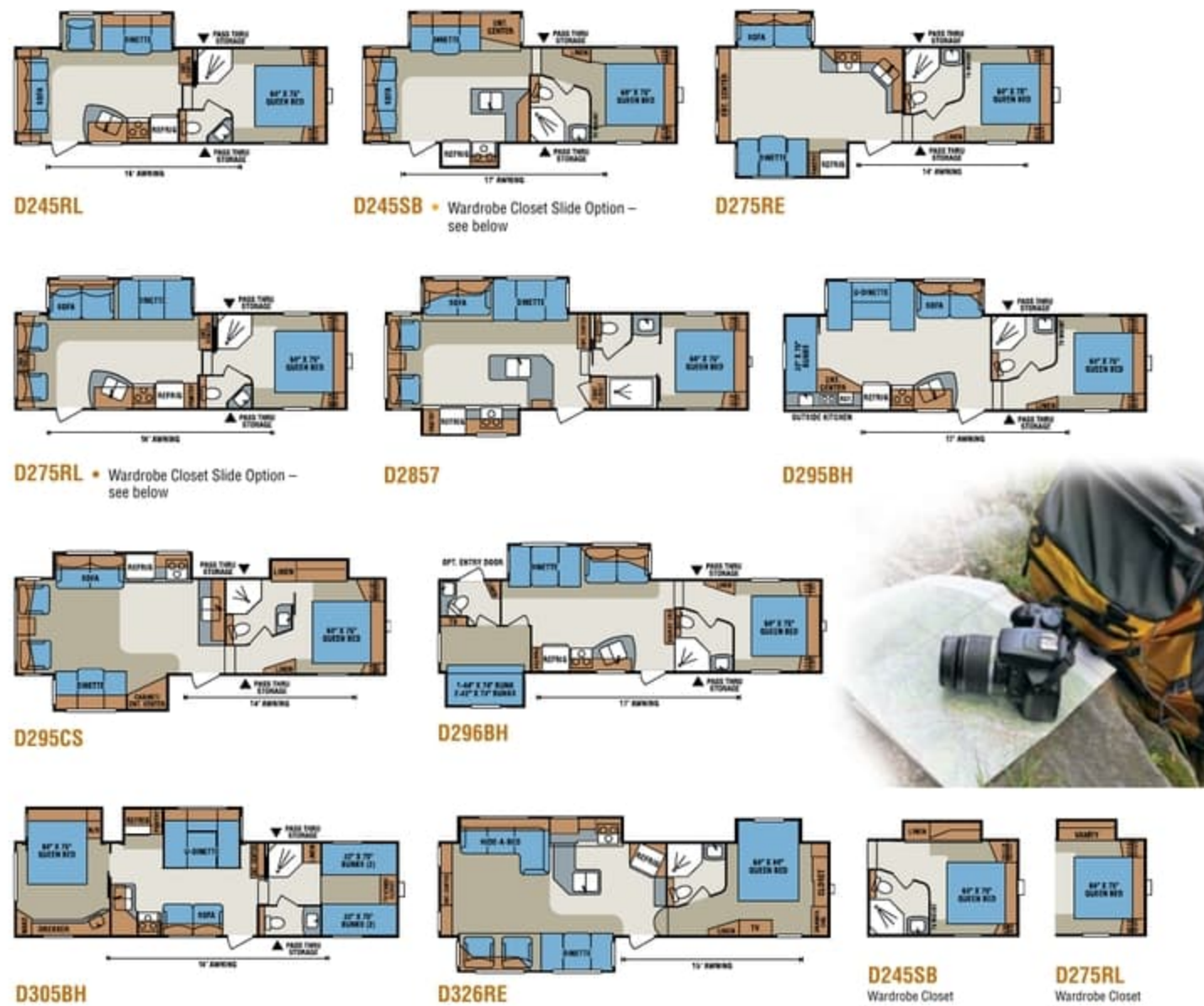

1500 FIFTH WHEELS	D245RL	D245SB	D275RE	D275RL	D2857	D295BH	D295CS	D296BH	D305BH	D326RE
UVW (Unloaded Vehicle Weight)*	6,600	7,153	7,258	7,158	8,220	7,475	8,128	8,158	8,102	9,080
Dry Hitch Weight*	1,320	1,317	1,206	1,105	1,170	1,325	1,375	1,208	1,305	1,720
Dry Axle Weight*	5,280	5,836	6,052	6,053	7,050	6,150	6,753	6,950	6,797	7,360
NCC (Net Carrying Capacity)	2,200	1,647	1,542	1,642	1,780	1,325	1,672	1,642	1,698	1,720
GVWR	8,800	8,800	8,800	8,800	10,000	8,800	9,800	9,800	9,800	10,800
Exterior Height	143"	144"	143"	143"	144"	144"	144"	145"	144"	144"
Exterior Width	96"	96"	96"	96"	96"	96"	96"	96"	96"	96"
Exterior Length	27' 3"	27' 11"	29' 8"	29' 4"	31' 8"	31' 9"	31' 11"	33' 11"	34' 1"	34' 5"
Refrigerator (cu. feet)	6	6	6	6	6	6	6	6	6	6
Water Heater Cap. (gal. G/E w/DSI)	6	6	6	6	6	6	6	6	6	6
Fresh Water Cap. (gal.)	55	55	55	55	55	55	55	55	55	55
Waste Water Cap. (gal.)	32	32	32	32	32	32	32	32	32	32
Gray Water Cap. (gal.)	32	32	32	32	32	32	32	32	32	32
LP Gas Cap. (lbs.)	60	60	60	60	60	60	60	60	60	60
Furnace BTUs (1,000s)	30	30	30	30	30	30	30	30	30	30
Tire Size	15"	15"	15"	15"	15"	15"	15"	15"	15"	15"
Awning	16'	16'	14'	18'	15'	17'	14'	17'	18'	15'

*This weight reflects the rolling average unit weight for each model. Your trailer weight will vary according to optional equipment.

- 1 13,500 BTU A/C
- 2 1 piece seamless roofing material
- 3 3/8" decking
- 4 Vinyl interior ceiling panel
- 5 4 3/8" truss rafter, 16" O.C.
- 6 R-14 batten insulation
- 7 Insulated ductwork
- 8 Exterior clearance and brake lights
- 9 One-piece fiberglass front cap
- 10 Expanded Polystyrene - R-9
- 11 Fiberglass exterior with integrated luan backing
- 12 1/8" luan decorative wall board
- 13 1/8" luan wall board
- 14 3" aluminum framed sidewall
- 15 Residential style ducted heat run in floor
- 16 Darco® moisture barrier
- 17 Large capacity pass-thru storage with bus style slam latch doors
- 18 Heavy duty I-beam frame construction
- 19 R-7 batten insulation
- 20 2x3 floor joist, 16" O.C.
- 21 Heated & enclosed underbelly
- 22 Insulated and heated water tanks
- 23 Fully welded outriggers
- 24 5/8" tongue & groove plywood
- 25 Heavy duty leaf springs
- 26 Heavy duty steel wheels
- 27 Residential style carpet pad
- 28 Rack and pinion electric slide with manual override with 2x2 tube slide out ram
- 29 Residential carpet or linoleum
- 30 Tinted safety glass windows
- 31 Triple sealed slide outs
- 32 Exterior security/Scare lights
- 33 Snap jacks pull pins
- 34 Extra long drip spouts
- 35 Satellite preparation
- 36 Exterior speakers
- 37 Dexter® *NEV-R-ADJUST™* Brakes



D2857 Features a comfortable living room and convenient walk-thru bath. Shown in 40th Anniversary Special Ruby décor.

2012 Durango 1500 Cut-Away

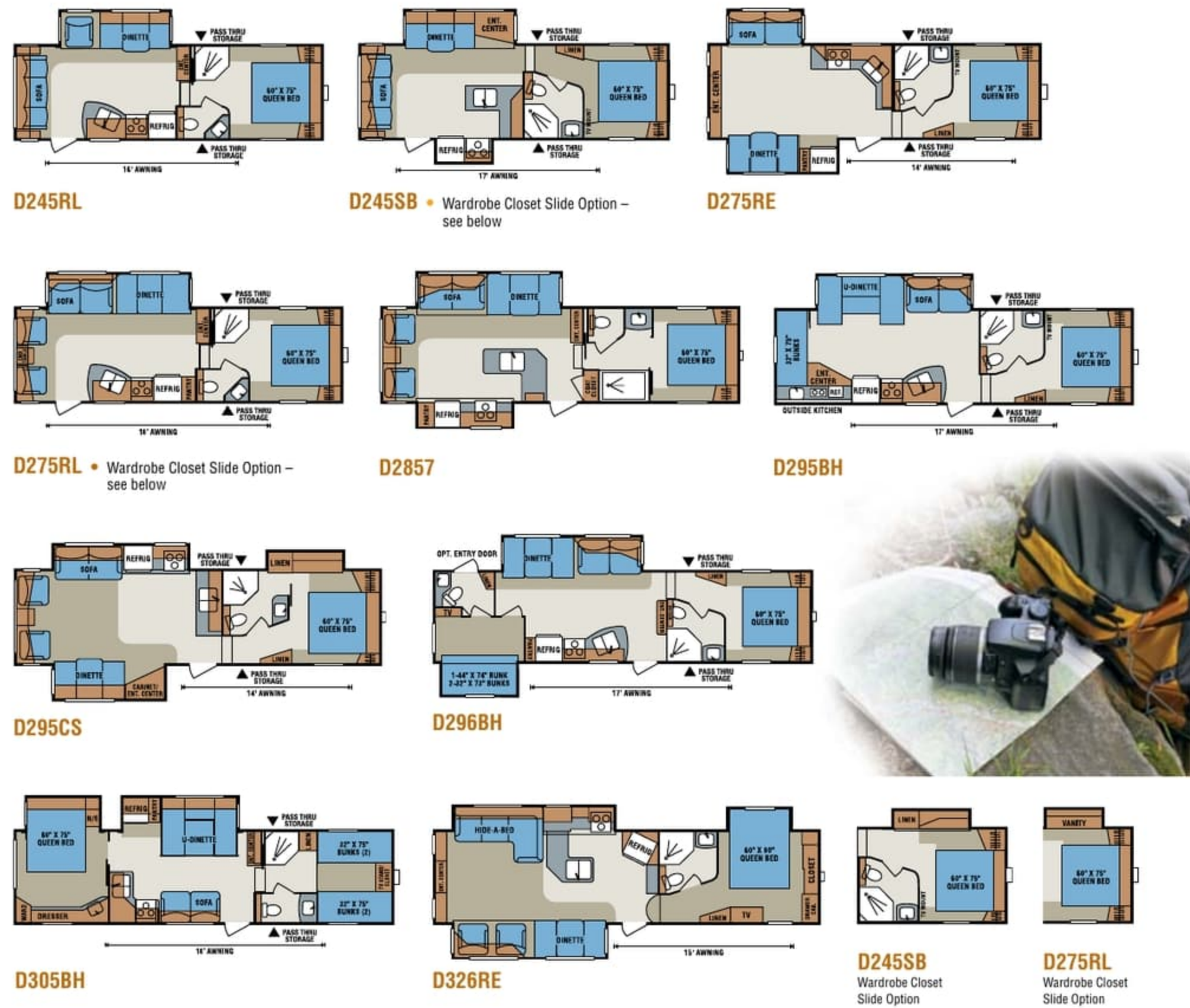

1500 FIFTH WHEELS	D245RL	D245SB	D275RE	D275RL	D2857	D295BH	D295CS	D296BH	D305BH	D326RE
UVW (Unloaded Vehicle Weight)*	6,600	7,153	7,258	7,158	8,220	7,475	8,128	8,158	8,102	9,080
Dry Hitch Weight*	1,320	1,317	1,206	1,105	1,170	1,325	1,208	1,208	1,305	1,720
Dry Axle Weight*	5,280	5,836	6,052	6,053	7,050	6,150	6,753	6,950	6,797	7,360
NCC (Net Carrying Capacity)	2,200	1,647	1,542	1,642	1,780	1,325	1,672	1,642	1,698	1,720
GVWR	8,800	8,800	8,800	8,800	10,000	8,800	9,800	9,800	9,800	10,800
Exterior Height	143"	144"	143"	143"	144"	144"	144"	145"	144"	144"
Exterior Width	96"	96"	96"	96"	96"	96"	96"	96"	96"	96"
Exterior Length	27' 3"	27' 11"	29' 8"	29' 4"	31' 8"	31' 9"	31' 11"	33' 11"	34' 1"	34' 5"
Refrigerator (cu. feet)	6	6	6	6	6	6	6	6	6	6
Water Heater Cap. (gal. G/E w/DSI)	6	6	6	6	6	6	6	6	6	6
Fresh Water Cap. (gal.)	55	55	55	55	55	55	55	55	55	55
Waste Water Cap. (gal.)	32	32	32	32	32	32	32	32	32	32
Gray Water Cap. (gal.)	32	32	32	32	32	32	32	32	32	32
LP Gas Cap. (lbs.)	60	60	60	60	60	60	60	60	60	60
Furnace BTUs (1,000s)	30	30	30	30	30	30	30	30	30	30
Tire Size	15"	15"	15"	15"	15"	15"	15"	15"	15"	15"
Awning	16'	16'	14'	18'	15'	17'	14'	17'	18'	15'

*This weight reflects the rolling average unit weight for each model. Your trailer weight will vary according to optional equipment.



Coach-Net
RV Membership Plans
One Year **FREE** Road Side Assistance courtesy of KZ!

- 1 13,500 BTU A/C
- 2 1 piece seamless roofing material
- 3 3/8" decking
- 4 Vinyl interior ceiling panel
- 5 4 3/8" truss rafter, 16" O.C.
- 6 R-14 batten insulation
- 7 Insulated ductwork
- 8 Exterior clearance and brake lights
- 9 One-piece fiberglass front cap
- 10 Expanded Polystyrene - R-9
- 11 Fiberglass exterior with integrated luan backing
- 12 1/8" luan decorative wall board
- 13 1/8" luan wall board
- 14 3" aluminum framed sidewall
- 15 Residential style ducted heat run in floor
- 16 Darco® moisture barrier
- 17 Large capacity pass-thru storage with bus style slam latch doors
- 18 Heavy duty I-beam frame construction
- 19 R-7 batten insulation
- 20 2x3 floor joist, 16" O.C.
- 21 Heated & enclosed underbelly
- 22 Insulated and heated water tanks
- 23 Fully welded outriggers
- 24 5/8" tongue & groove plywood
- 25 Heavy duty leaf springs
- 26 Heavy duty steel wheels
- 27 Residential style carpet pad
- 28 Rack and pinion electric slide with manual override with 2x2 tube slide out ram
- 29 Residential carpet or linoleum
- 30 Tinted safety glass windows
- 31 Triple sealed slide outs
- 32 Exterior security/Scare lights
- 33 Snap jacks pull pins
- 34 Extra long drip spouts
- 35 Satellite preparation
- 36 Exterior speakers
- 37 Dexter **NEV-R-ADJUST™** Brakes



D326RE
The visual appeal of raised panel, glazed finish, cabinetry is key to this attractive interior. Shown in Bamboo décor with standard 32" LCD TV and large solid surface countertops.



D2857 Features a comfortable living room and convenient walk-thru bath. Shown in 40th Anniversary Special Ruby décor.

2012 Durango 1500 Cut-Away

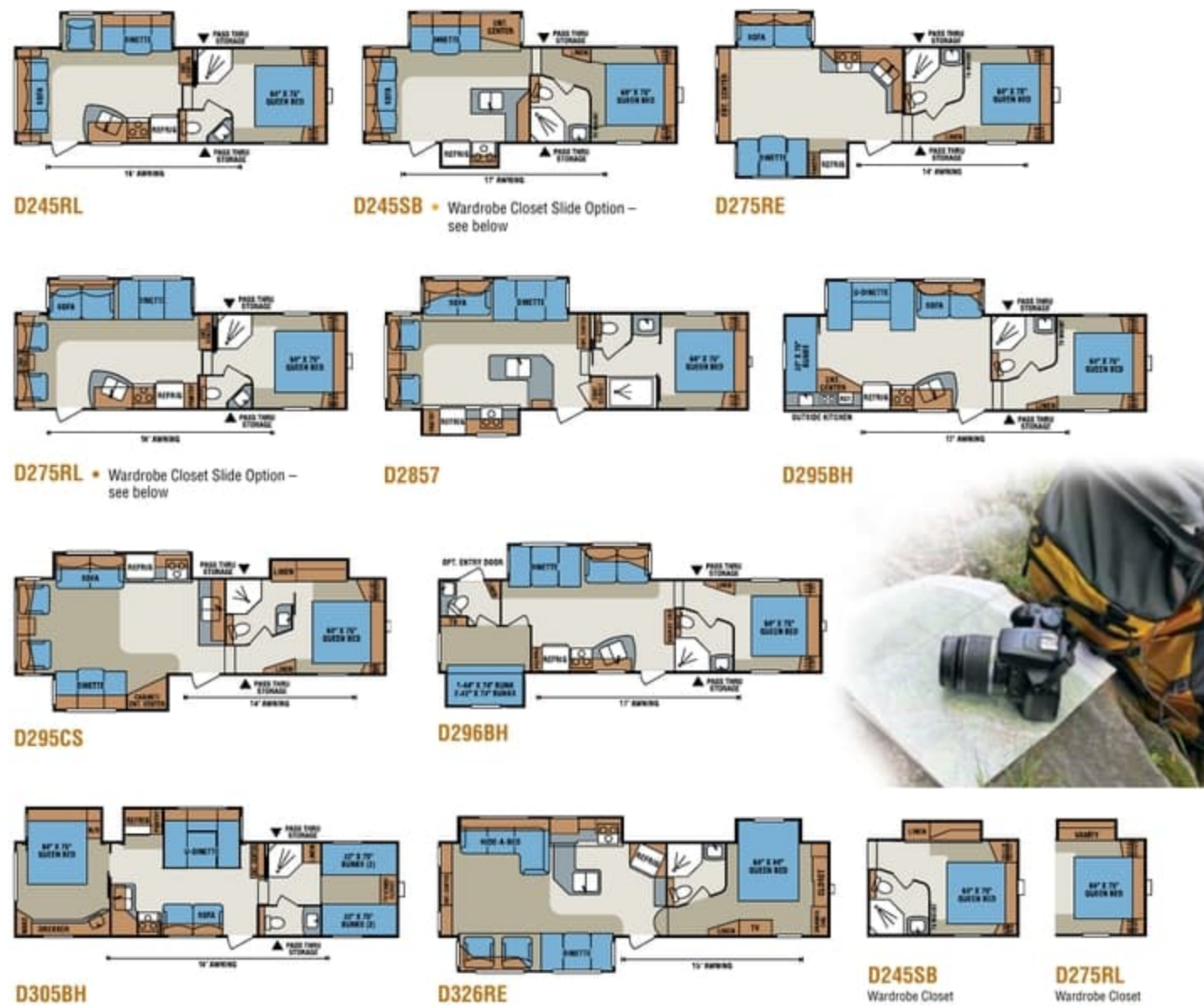

1500 FIFTH WHEELS	D245RL	D245SB	D275RE	D275RL	D2857	D295BH	D295CS	D296BH	D305BH	D326RE
UVW (Unloaded Vehicle Weight)*	6,600	7,153	7,258	7,158	8,220	7,475	8,128	8,158	8,102	9,080
Dry Hitch Weight*	1,320	1,317	1,206	1,105	1,170	1,325	1,375	1,208	1,305	1,720
Dry Axle Weight*	5,280	5,836	6,052	6,053	7,050	6,150	6,753	6,950	6,797	7,360
NCC (Net Carrying Capacity)	2,200	1,647	1,542	1,642	1,780	1,325	1,672	1,642	1,698	1,720
GVWR	8,800	8,800	8,800	8,800	10,000	8,800	9,800	9,800	9,800	10,800
Exterior Height	143"	144"	143"	143"	144"	144"	144"	145"	144"	144"
Exterior Width	96"	96"	96"	96"	96"	96"	96"	96"	96"	96"
Exterior Length	27' 3"	27' 11"	29' 8"	29' 4"	31' 8"	31' 9"	31' 11"	33' 11"	34' 1"	34' 5"
Refrigerator (cu. feet)	6	6	6	6	6	6	6	6	6	6
Water Heater Cap. (gal. G/E w/DSI)	6	6	6	6	6	6	6	6	6	6
Fresh Water Cap. (gal.)	55	55	55	55	55	55	55	55	55	55
Waste Water Cap. (gal.)	32	32	32	32	32	32	32	32	32	32
Gray Water Cap. (gal.)	32	32	32	32	32	32	32	32	32	32
LP Gas Cap. (lbs.)	60	60	60	60	60	60	60	60	60	60
Furnace BTUs (1,000s)	30	30	30	30	30	30	30	30	30	30
Tire Size	15"	15"	15"	15"	15"	15"	15"	15"	15"	15"
Awning	16'	16'	14'	18'	15'	17'	14'	17'	18'	15'

*This weight reflects the rolling average unit weight for each model. Your trailer weight will vary according to optional equipment.

- 1 13,500 BTU A/C
- 2 1 piece seamless roofing material
- 3 3/8" decking
- 4 Vinyl interior ceiling panel
- 5 4 3/8" truss rafter, 16" O.C.
- 6 R-14 batten insulation
- 7 Insulated ductwork
- 8 Exterior clearance and brake lights
- 9 One-piece fiberglass front cap
- 10 Expanded Polystyrene - R-9
- 11 Fiberglass exterior with integrated luan backing
- 12 1/8" luan decorative wall board
- 13 1/8" luan wall board
- 14 3" aluminum framed sidewall
- 15 Residential style ducted heat run in floor
- 16 Darco® moisture barrier
- 17 Large capacity pass-thru storage with bus style slam latch doors
- 18 Heavy duty I-beam frame construction
- 19 R-7 batten insulation
- 20 2x3 floor joist, 16" O.C.
- 21 Heated & enclosed underbelly
- 22 Insulated and heated water tanks
- 23 Fully welded outriggers
- 24 5/8" tongue & groove plywood
- 25 Heavy duty leaf springs
- 26 Heavy duty steel wheels
- 27 Residential style carpet pad
- 28 Rack and pinion electric slide with manual override with 2x2 tube slide out ram
- 29 Residential carpet or linoleum
- 30 Tinted safety glass windows
- 31 Triple sealed slide outs
- 32 Exterior security/Scare lights
- 33 Snap jacks pull pins
- 34 Extra long drip spouts
- 35 Satellite preparation
- 36 Exterior speakers
- 37 Dexter® *NEV-R-ADJUST*™ Brakes



D326RE
The visual appeal of raised panel, glazed finish, cabinetry is key to this attractive interior. Shown in Bamboo décor with standard 32" LCD TV and large solid surface countertops.



D2857 Features a comfortable living room and convenient walk-thru bath. Shown in 40th Anniversary Special Ruby décor.

2012 Durango 1500 Cut-Away



Coach-Net
RV Membership Plans
One Year FREE Road Side Assistance courtesy of KZ!

1500 FIFTH WHEELS	D245RL	D245SB	D275RE	D275RL	D2857	D295BH	D295CS	D296BH	D305BH	D326RE
UVW (Unloaded Vehicle Weight)*	6,600	7,153	7,258	7,158	8,220	7,475	8,128	8,158	8,102	9,080
Dry Hitch Weight*	1,320	1,317	1,206	1,105	1,170	1,325	1,208	1,208	1,305	1,720
Dry Axle Weight*	5,280	5,836	6,052	6,053	7,050	6,150	6,753	6,950	6,797	7,360
NCC (Net Carrying Capacity)	2,200	1,647	1,542	1,642	1,780	1,325	1,672	1,642	1,698	1,720
GVWR	8,800	8,800	8,800	8,800	10,000	8,800	9,800	9,800	9,800	10,800
Exterior Height	143"	144"	143"	143"	144"	144"	144"	145"	144"	144"
Exterior Width	96"	96"	96"	96"	96"	96"	96"	96"	96"	96"
Exterior Length	27' 3"	27' 11"	29' 8"	29' 4"	31' 8"	31' 9"	31' 11"	33' 11"	34' 1"	34' 5"
Refrigerator (cu. feet)	6	6	6	6	6	6	6	6	6	6
Water Heater Cap. (gal. G/E w/DSI)	6	6	6	6	6	6	6	6	6	6
Fresh Water Cap. (gal.)	55	55	55	55	55	55	55	55	55	55
Waste Water Cap. (gal.)	32	32	32	32	32	32	32	32	32	32
Gray Water Cap. (gal.)	32	32	32	32	32	32	32	32	32	32
LP Gas Cap. (lbs.)	60	60	60	60	60	60	60	60	60	60
Furnace BTUs (1,000s)	30	30	30	30	30	30	30	30	30	30
Tire Size	15"	15"	15"	15"	15"	15"	15"	15"	15"	15"
Awning	16'	16'	14'	18'	15'	17'	14'	17'	18'	15'

*This weight reflects the rolling average unit weight for each model. Your trailer weight will vary according to optional equipment.

- 1 13,500 BTU A/C
- 2 1 piece seamless roofing material
- 3 3/8" decking
- 4 Vinyl interior ceiling panel
- 5 4 3/8" truss rafter, 16" O.C.
- 6 R-14 batten insulation
- 7 Insulated ductwork
- 8 Exterior clearance and brake lights
- 9 One-piece fiberglass front cap
- 10 Expanded Polystyrene - R-9
- 11 Fiberglass exterior with integrated luan backing
- 12 1/8" luan decorative wall board
- 13 1/8" luan wall board
- 14 3" aluminum framed sidewall
- 15 Residential style ducted heat run in floor
- 16 Darco® moisture barrier
- 17 Large capacity pass-thru storage with bus style slam latch doors
- 18 Heavy duty I-beam frame construction
- 19 R-7 batten insulation
- 20 2x3 floor joist, 16" O.C.
- 21 Heated & enclosed underbelly
- 22 Insulated and heated water tanks
- 23 Fully welded outriggers
- 24 5/8" tongue & groove plywood
- 25 Heavy duty leaf springs
- 26 Heavy duty steel wheels
- 27 Residential style carpet pad
- 28 Rack and pinion electric slide with manual override with 2x2 tube slide out ram
- 29 Residential carpet or linoleum
- 30 Tinted safety glass windows
- 31 Triple sealed slide outs
- 32 Exterior security/Scare lights
- 33 Snap jacks pull pins
- 34 Extra long drip spouts
- 35 Satellite preparation
- 36 Exterior speakers
- 37 Dexter® *NEV-R-ADJUST*™ Brakes



D326RE
The visual appeal of raised panel, glazed finish, cabinetry is key to this attractive interior. Shown in Bamboo décor with standard 32" LCD TV and large solid surface countertops.



D2857 Features a comfortable living room and convenient walk-thru bath. Shown in 40th Anniversary Special Ruby décor.

2012 Durango 1500 Cut-Away

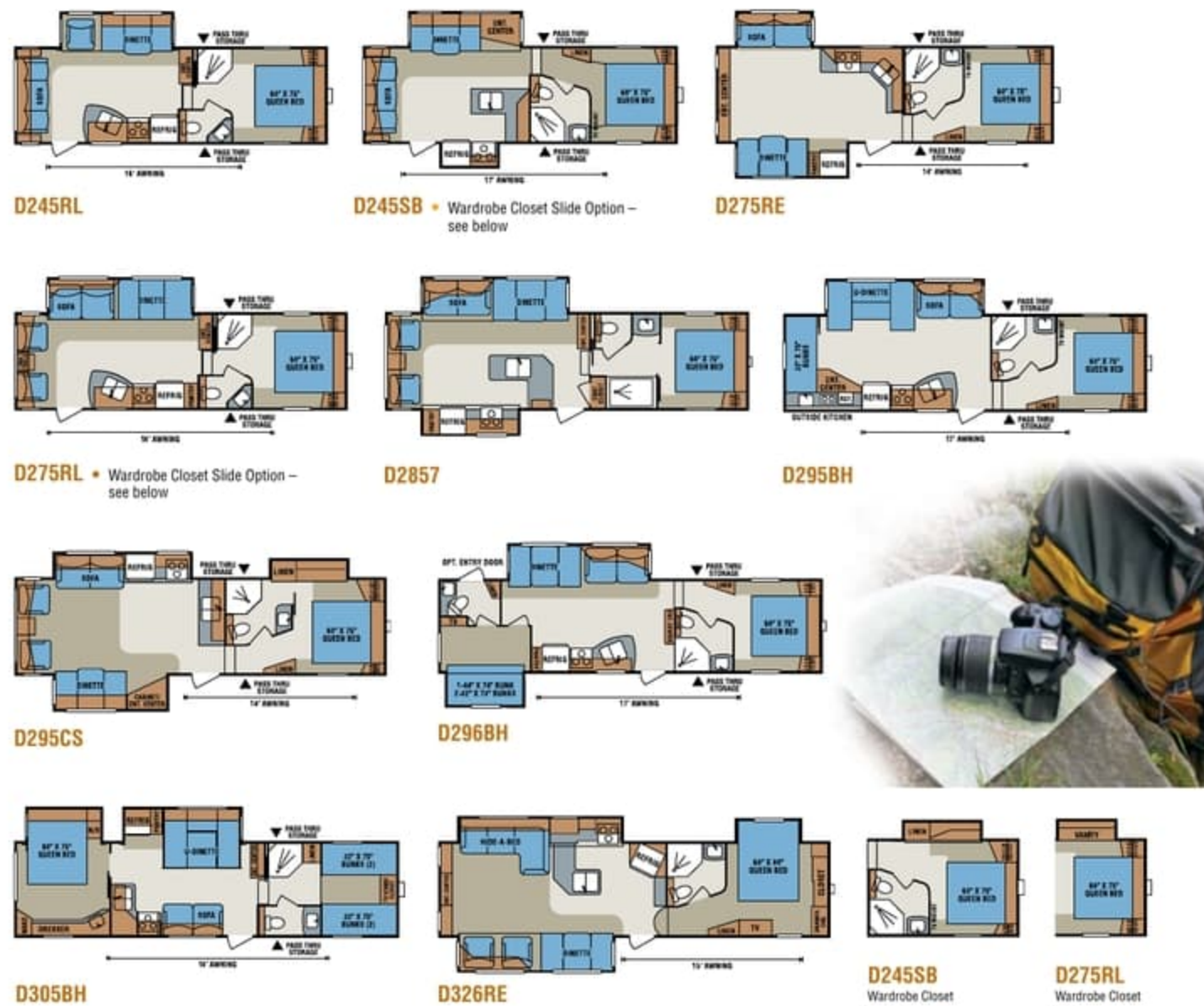

1500 FIFTH WHEELS	D245RL	D245SB	D275RE	D275RL	D2857	D295BH	D295CS	D296BH	D305BH	D326RE
UVW (Unloaded Vehicle Weight)*	6,600	7,153	7,258	7,158	8,220	7,475	8,128	8,158	8,102	9,080
Dry Hitch Weight*	1,320	1,317	1,206	1,105	1,170	1,325	1,375	1,208	1,305	1,720
Dry Axle Weight*	5,280	5,836	6,052	6,053	7,050	6,150	6,753	6,950	6,797	7,360
NCC (Net Carrying Capacity)	2,200	1,647	1,542	1,642	1,780	1,325	1,672	1,642	1,698	1,720
GVWR	8,800	8,800	8,800	8,800	10,000	8,800	9,800	9,800	9,800	10,800
Exterior Height	143"	144"	143"	143"	144"	144"	144"	145"	144"	144"
Exterior Width	96"	96"	96"	96"	96"	96"	96"	96"	96"	96"
Exterior Length	27' 3"	27' 11"	29' 8"	29' 4"	31' 8"	31' 9"	31' 11"	33' 11"	34' 1"	34' 5"
Refrigerator (cu. feet)	6	6	6	6	6	6	6	6	6	6
Water Heater Cap. (gal. G/E w/DSI)	6	6	6	6	6	6	6	6	6	6
Fresh Water Cap. (gal.)	55	55	55	55	55	55	55	55	55	55
Waste Water Cap. (gal.)	32	32	32	32	32	32	32	32	32	32
Gray Water Cap. (gal.)	32	32	32	32	32	32	32	32	32	32
LP Gas Cap. (lbs.)	60	60	60	60	60	60	60	60	60	60
Furnace BTUs (1,000s)	30	30	30	30	30	30	30	30	30	30
Tire Size	15"	15"	15"	15"	15"	15"	15"	15"	15"	15"
Awning	16'	16'	14'	18'	15'	17'	14'	17'	18'	15'

*This weight reflects the rolling average unit weight for each model. Your trailer weight will vary according to optional equipment.

- 1 13,500 BTU A/C
- 2 1 piece seamless roofing material
- 3 3/8" decking
- 4 Vinyl interior ceiling panel
- 5 4 3/8" truss rafter, 16" O.C.
- 6 R-14 batten insulation
- 7 Insulated ductwork
- 8 Exterior clearance and brake lights
- 9 One-piece fiberglass front cap
- 10 Expanded Polystyrene - R-9
- 11 Fiberglass exterior with integrated luan backing
- 12 1/8" luan decorative wall board
- 13 1/8" luan wall board
- 14 3" aluminum framed sidewall
- 15 Residential style ducted heat run in floor
- 16 Darco® moisture barrier
- 17 Large capacity pass-thru storage with bus style slam latch doors
- 18 Heavy duty I-beam frame construction
- 19 R-7 batten insulation
- 20 2x3 floor joist, 16" O.C.
- 21 Heated & enclosed underbelly
- 22 Insulated and heated water tanks
- 23 Fully welded outriggers
- 24 5/8" tongue & groove plywood
- 25 Heavy duty leaf springs
- 26 Heavy duty steel wheels
- 27 Residential style carpet pad
- 28 Rack and pinion electric slide with manual override with 2x2 tube slide out ram
- 29 Residential carpet or linoleum
- 30 Tinted safety glass windows
- 31 Triple sealed slide outs
- 32 Exterior security/Scare lights
- 33 Snap jacks pull pins
- 34 Extra long drip spouts
- 35 Satellite preparation
- 36 Exterior speakers
- 37 Dexter® *NEV-R-ADJUST™* Brakes



D2857 Features a comfortable living room and convenient walk-thru bath. Shown in 40th Anniversary Special Ruby décor.

2012 Durango 1500 Cut-Away

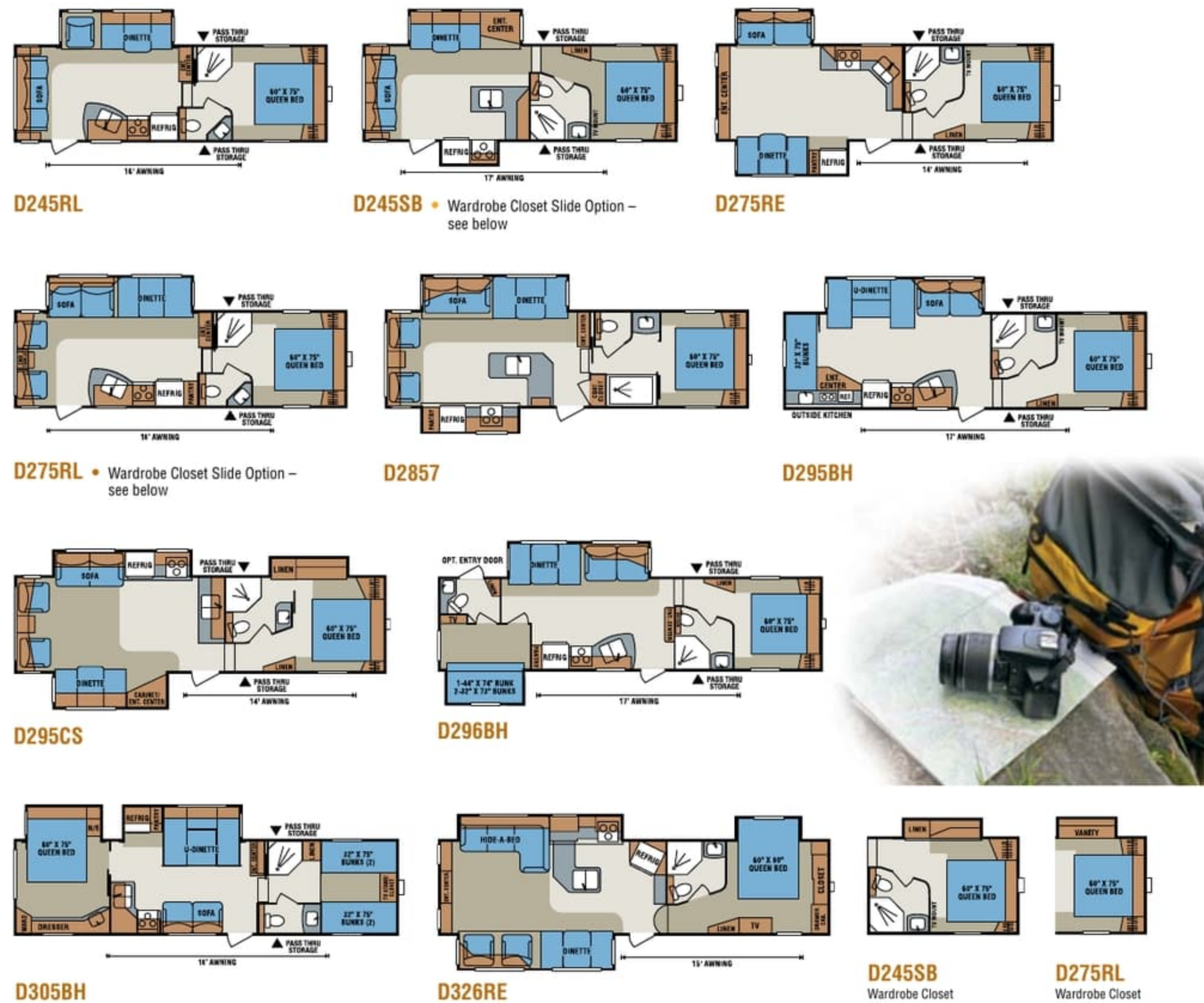

Coach-Net
RV Membership Plans
One Year FREE Road Side Assistance courtesy of KZ!

1500 FIFTH WHEELS	D245RL	D245SB	D275RE	D275RL	D2857	D295BH	D295CS	D296BH	D305BH	D326RE
UVW (Unloaded Vehicle Weight)*	6,600	7,153	7,258	7,158	8,220	7,475	8,128	8,158	8,102	9,080
Dry Hitch Weight*	1,320	1,317	1,206	1,105	1,170	1,325	1,208	1,208	1,305	1,720
Dry Axle Weight*	5,280	5,836	6,052	6,053	7,050	6,150	6,753	6,950	6,797	7,360
NCC (Net Carrying Capacity)	2,200	1,647	1,542	1,642	1,780	1,325	1,672	1,642	1,698	1,720
GVWR	8,800	8,800	8,800	8,800	10,000	8,800	9,800	9,800	9,800	10,800
Exterior Height	143"	144"	143"	143"	144"	144"	144"	145"	144"	144"
Exterior Width	96"	96"	96"	96"	96"	96"	96"	96"	96"	96"
Exterior Length	27' 3"	27' 11"	29' 8"	29' 4"	31' 8"	31' 9"	31' 11"	33' 11"	34' 1"	34' 5"
Refrigerator (cu. feet)	6	6	6	6	6	6	6	6	6	6
Water Heater Cap. (gal. G/E w/DSI)	6	6	6	6	6	6	6	6	6	6
Fresh Water Cap. (gal.)	55	55	55	55	55	55	55	55	55	55
Waste Water Cap. (gal.)	32	32	32	32	32	32	32	32	32	32
Gray Water Cap. (gal.)	32	32	32	32	32	32	32	32	32	32
LP Gas Cap. (lbs.)	60	60	60	60	60	60	60	60	60	60
Furnace BTUs (1,000s)	30	30	30	30	30	30	30	30	30	30
Tire Size	15"	15"	15"	15"	15"	15"	15"	15"	15"	15"
Awning	16'	16'	14'	18'	15'	17'	14'	17'	18'	15'

*This weight reflects the rolling average unit weight for each model. Your trailer weight will vary according to optional equipment.

- 1 13,500 BTU A/C
- 2 1 piece seamless roofing material
- 3 3/8" decking
- 4 Vinyl interior ceiling panel
- 5 4 3/8" truss rafter, 16" O.C.
- 6 R-14 batten insulation
- 7 Insulated ductwork
- 8 Exterior clearance and brake lights
- 9 One-piece fiberglass front cap
- 10 Expanded Polystyrene - R-9
- 11 Fiberglass exterior with integrated luan backing
- 12 1/8" luan decorative wall board
- 13 1/8" luan wall board
- 14 3" aluminum framed sidewall
- 15 Residential style ducted heat run in floor
- 16 Darco® moisture barrier
- 17 Large capacity pass-thru storage with bus style slam latch doors
- 18 Heavy duty I-beam frame construction
- 19 R-7 batten insulation
- 20 2x3 floor joist, 16" O.C.
- 21 Heated & enclosed underbelly
- 22 Insulated and heated water tanks
- 23 Fully welded outriggers
- 24 5/8" tongue & groove plywood
- 25 Heavy duty leaf springs
- 26 Heavy duty steel wheels
- 27 Residential style carpet pad
- 28 Rack and pinion electric slide with manual override with 2x2 tube slide out ram
- 29 Residential carpet or linoleum
- 30 Tinted safety glass windows
- 31 Triple sealed slide outs
- 32 Exterior security/Scare lights
- 33 Snap jacks pull pins
- 34 Extra long drip spouts
- 35 Satellite preparation
- 36 Exterior speakers
- 37 Dexter® *NEV-R-ADJUST*™ Brakes



D326RE
The visual appeal of raised panel, glazed finish, cabinetry is key to this attractive interior. Shown in Bamboo décor with standard 32" LCD TV and large solid surface countertops.



D2857 Features a comfortable living room and convenient walk-thru bath. Shown in 40th Anniversary Special Ruby décor.



Bamboo Décor

Basil Décor

Walnut Décor

Standards

- Eurodynamic Front Cap
- Stabilizer Jacks
- Awning with Drip Rail and Spouts
- Microwave with Turn Table
- 13,500 BTU Ducted A/C
- Enclosed Pin Box
- Security Light
- 6 Gallon Gas/Electric DSI Water Heater
- Skylight Over Tub
- Pillows for Sofa
- Wire for Satellite
- Heated Tanks and Enclosed Underbelly
- Tinted Windows
- Black Tank Flush System
- Power Jacks
- 6 Cubic Foot Refrigerator with Raised Panel Wood Insert

32" LCD TV

- Assist Grab Handle
- Night Shades
- AM/FM/CD/DVD Player with USB Port
- Porcelain Toilet
- Outside Speakers
- Innerspring Mattress
- Roller Ball Bearing Drawer Guides
- Dexter **NEV-R-ADJUST™** Brakes
- Gas Struts on Bed Base
- Outside Shower
- Bus Style Slam Latch Baggage Doors
- Decorative Light Above Dinette
- Solid Surface Countertops

Options

- Partial Paint Package
- Solid Surface Countertop Extension
- Hide-A-Bed (Forced on D326RE)
- Table and Chairs with Leaf
- Recliner – 1 or 2
- 2 Barrel Chairs IPO Sofa (D245SB Only)
- 8 Cubic Foot Refrigerator
- Fireplace (N/A on D275RL)
- Dyson® Vacuum
- Fan-Tastic Vent® (Bedroom and Bathroom)
- 15,000 BTU A/C (IPO 13,500 BTU A/C)
- Ladder
- Power Awning
- Aluminum Wheels
- Bike Rack/Cargo Tray
- Dexter E-Z Flex® Heavy Duty Rubber Suspension
- Outside Grill

Spare Tire/Carrier/Cover

- Sidewinder Hitch
- Wardrobe Slide (D245SB and D275RL Only)
- Flip Up Bunk with Jiffy (D296BH Only)
- Entry Door in Bathroom (D296BH Only)
- Katching ZZ's Mattress Upgrade
- Large U-Shape Dinette (IPO Sofa and Dinette)

Road Trip Package

- Aluminum Wheels
- Dexter E-Z Flex® Heavy Duty Rubber Suspension
- Spare Tire/Carrier/Cover
- Ladder
- Power Awning
- 8 Cubic Foot Refrigerator
- Innerspring Mattress

KZ RECREATIONAL VEHICLES DURANGO 1500



Bike Rack

Cargo Carrier

The optional Bike Rack/Cargo Carrier offers you even greater versatility for those "extra" items you don't want to leave at home.



Optional Dyson® Vac



D326RE Shown in Bamboo Décor

ASK ABOUT OUR 2-YEAR LIMITED WARRANTY!



Dealer Satisfaction Index: Ratings of manufacturers, by dealers, have consistently awarded KZ top honors for excellence of design, reliability, overall quality and value, communications and dealer support.

Dealer:



Portions of this brochure were used with the expressed authority of Dexter Axle, but Dexter Axle is not responsible for the accuracy of the information contained herein.

For more product details and in-depth information, visit us on the web at www.kz-rv.com

0985 N 900 W • Shipshewana, IN 46565
E-mail kz@kz-rv.com • www.kz-rv.com

Due to continual research and advances, manufacturer reserves the right to change specifications, design, price and equipment without notice, and assumes no responsibility for any error in this literature. Some items shown are not included as standard or optional equipment.
©2012KZ | 1/20/12 | 15M



Come home to KZ!

www.kz-rv.com

DURANGO 1500

Light weight and beautifully appointed, there's a model just right for you.





Bamboo Décor

Basil Décor

Walnut Décor

Standards

- Eurodynamic Front Cap
- Stabilizer Jacks
- Awning with Drip Rail and Spouts
- Microwave with Turn Table
- 13,500 BTU Ducted A/C
- Enclosed Pin Box
- Security Light
- 6 Gallon Gas/Electric DSI Water Heater
- Skylight Over Tub
- Pillows for Sofa
- Wire for Satellite
- Heated Tanks and Enclosed Underbelly
- Tinted Windows
- Black Tank Flush System
- Power Jacks
- 6 Cubic Foot Refrigerator with Raised Panel Wood Insert

32" LCD TV

- Assist Grab Handle
- Night Shades
- AM/FM/CD/DVD Player with USB Port
- Porcelain Toilet
- Outside Speakers
- Innerspring Mattress
- Roller Ball Bearing Drawer Guides
- Dexter **NEV-R-ADJUST™** Brakes
- Gas Struts on Bed Base
- Outside Shower
- Bus Style Slam Latch Luggage Doors
- Decorative Light Above Dinette
- Solid Surface Countertops

Options

- Partial Paint Package
- Solid Surface Countertop Extension
- Hide-A-Bed (Forced on D326RE)
- Table and Chairs with Leaf
- Recliner – 1 or 2
- 2 Barrel Chairs IPO Sofa (D245SB Only)
- 8 Cubic Foot Refrigerator
- Fireplace (N/A on D275RL)
- Dyson® Vacuum
- Fan-Tastic Vent® (Bedroom and Bathroom)
- 15,000 BTU A/C (IPO 13,500 BTU A/C)
- Ladder
- Power Awning
- Aluminum Wheels
- Bike Rack/Cargo Tray
- Dexter E-Z Flex® Heavy Duty Rubber Suspension
- Outside Grill

Spare Tire/Carrier/Cover

- Sidewinder Hitch
- Wardrobe Slide (D245SB and D275RL Only)
- Flip Up Bunk with Jiffy (D296BH Only)
- Entry Door in Bathroom (D296BH Only)
- Katching ZZ's Mattress Upgrade
- Large U-Shape Dinette (IPO Sofa and Dinette)

Road Trip Package

- Aluminum Wheels
- Dexter E-Z Flex® Heavy Duty Rubber Suspension
- Spare Tire/Carrier/Cover
- Ladder
- Power Awning
- 8 Cubic Foot Refrigerator
- Innerspring Mattress

KZ RECREATIONAL VEHICLES
DURANGO
1500



Bike Rack

Cargo Carrier

The optional Bike Rack/Cargo Carrier offers you even greater versatility for those "extra" items you don't want to leave at home.



Optional Dyson® Vac



D326RE Shown in Bamboo Décor

ASK ABOUT OUR 2-YEAR LIMITED WARRANTY!



Dealer Satisfaction Index: Ratings of manufacturers, by dealers, have consistently awarded KZ top honors for excellence of design, reliability, overall quality and value, communications and dealer support.

Dealer:



Portions of this brochure were used with the expressed authority of Dexter Axle, but Dexter Axle is not responsible for the accuracy of the information contained herein.

For more product details and in-depth information, visit us on the web at www.kz-rv.com

0985 N 900 W • Shipshewana, IN 46565
E-mail kz@kz-rv.com • www.kz-rv.com

Due to continual research and advances, manufacturer reserves the right to change specifications, design, price and equipment without notice, and assumes no responsibility for any error in this literature. Some items shown are not included as standard or optional equipment.
©2012KZ | 1/20/12 | 15M



Come home to KZ!

www.kz-rv.com

DURANGO
1500

Light weight and beautifully appointed, there's a model just right for you.

