



# SPORTSMEN<sup>TH</sup>



*Come home to KZ!*

[www.kz-rv.com](http://www.kz-rv.com)



# SPORTSMEN<sup>TH</sup>



*Come home to KZ!*

[www.kz-rv.com](http://www.kz-rv.com)

## Travel Trailer Toy Haulers

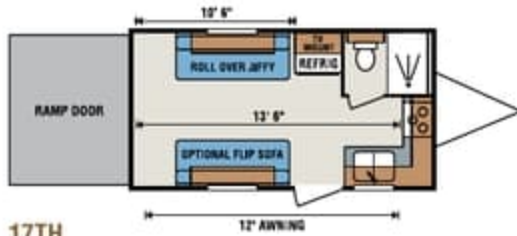

17TH

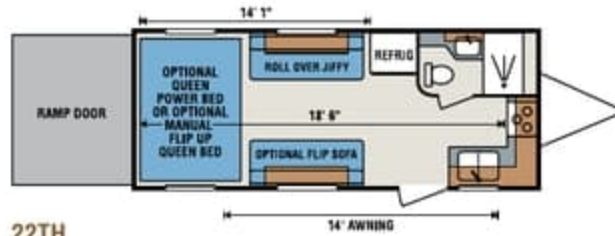

22TH

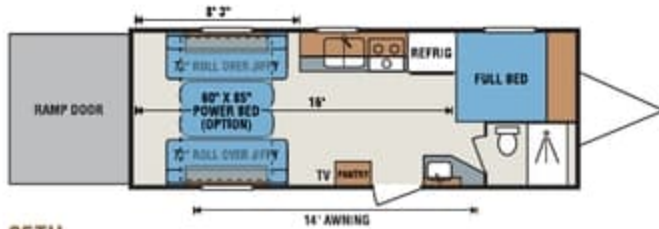

25TH

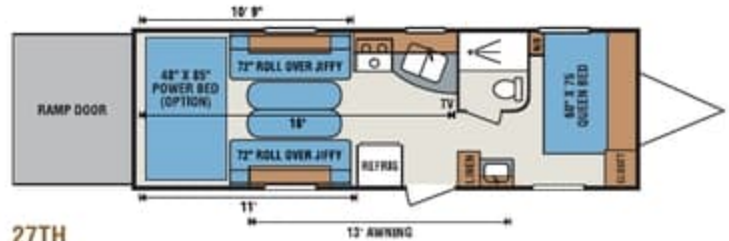

27TH

## Fifth Wheel Toy Hauler

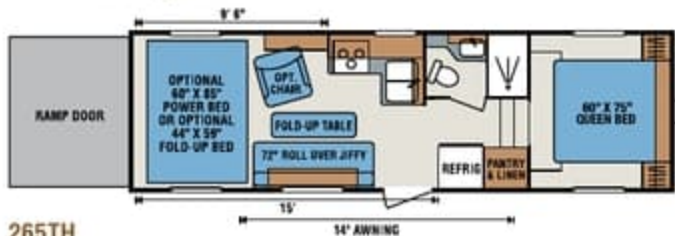

265TH



265TH • 2nd Flip Jiffy Option



315TH

**Coach-Net**

RV Membership Plans

*One Year FREE  
Road Side Assistance  
courtesy of KZ!*

TOY HAULERS	17TH	22TH	25TH	265TH	27TH	315TH
UVW (Unloaded Vehicle Weight) *	3,654	4,248	4,890	6,088	5,303	8,080
Dry Hitch Weight*	676	898	740	1,356	753	1,590
Dry Axle Weight*	2,978	3,350	4,150	4,732	4,550	6,490
NCC (Net Carrying Capacity)	2,346	2,752	3,110	1,912	2,697	2,220
GVWR	6,000	7,000	8,000	8,000	8,000	10,300
Interior Height	78"	78"	78"	91"	82"	91"
Exterior Height	10' 2"	10' 4"	11'	12' 2"	11'	11'
Exterior Width	8'	8'	8'	8'	8'	8'
Exterior Length	19' 5 1/2"	24' 5 1/2"	26' 4"	28' 6"	29' 2"	35' 2"
Refrigerator (cu. feet)	5	5	5	5	5	5
Water Heater Cap. (gal. Gas w/DSI)	6	6	6	6	6	6
Fresh Water Cap. (gal.)	40	40	40	75	75	75
Waste Water Cap. (gal.)	32	32	32	32	32	32
Gray Water Cap. (gal.)	32	32	32	32	32	32
LP Gas Cap. (lbs.)	40	40	40	40	40	40
Furnace BTUs (1,000s)	16	16	20	25	20	25
Tire Size	14"	14"	15"	15"	15"	15"
Awning	12'	14'	14'	15'	13'	17'

\*This weight reflects the rolling average unit weight for each model. Your trailer weight will vary according to optional equipment.

## Travel Trailer Toy Haulers

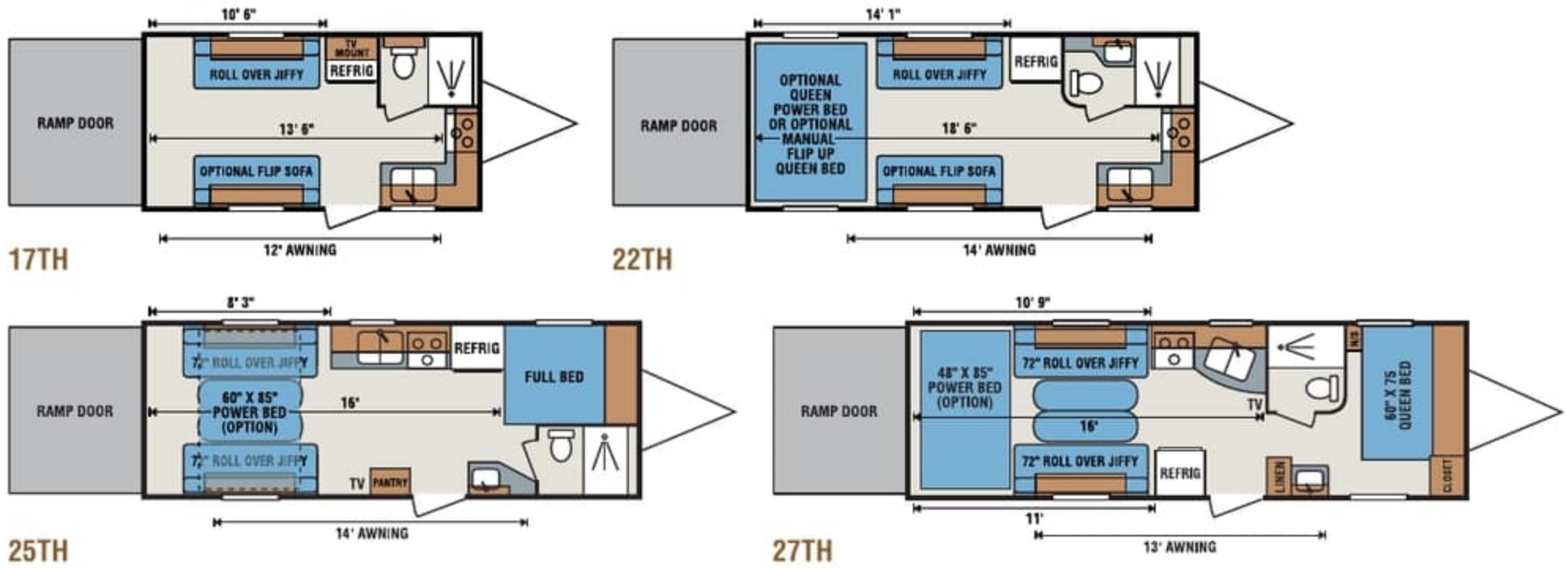

## Fifth Wheel Toy Hauler

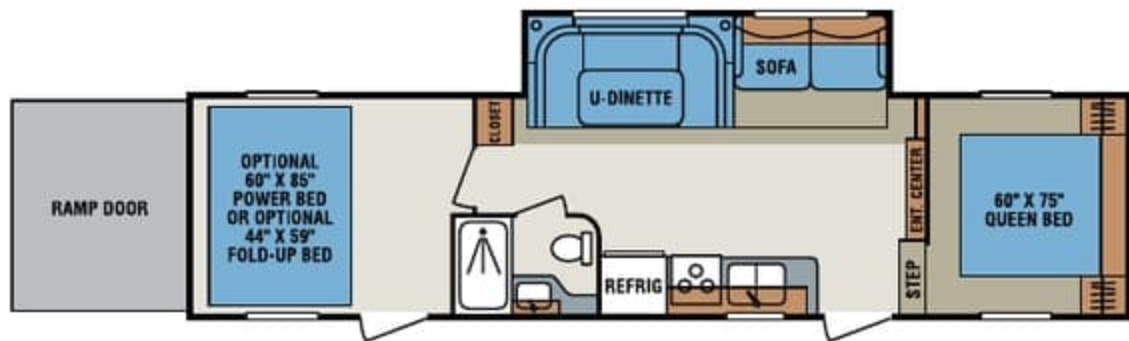

**Coach-Net**  
RV Membership Plans  
*One Year FREE  
Road Side Assistance  
courtesy of KZ!*

TOY HAULERS	17TH	22TH	25TH	265TH	27TH	315TH
UVW (Unloaded Vehicle Weight)*	3,654	4,248	4,890	6,088	5,303	8,080
Dry Hitch Weight*	676	898	740	1,356	753	1,590
Dry Axle Weight*	2,978	3,350	4,150	4,732	4,550	6,490
NCC (Net Carrying Capacity)	2,346	2,752	3,110	1,912	2,697	2,220
GVWR	6,000	7,000	8,000	8,000	8,000	10,300
Interior Height	78"	78"	78"	91"	82"	91"
Exterior Height	10' 2"	10' 4"	11'	12' 2"	11'	11'
Exterior Width	8'	8'	8'	8'	8'	8'
Exterior Length	19' 5 1/2"	24' 5 1/2"	26' 4"	28' 6"	29' 2"	35' 2"
Refrigerator (cu. feet)	5	5	5	5	5	5
Water Heater Cap. (gal. Gas w/DSI)	6	6	6	6	6	6
Fresh Water Cap. (gal.)	40	40	40	75	75	75
Waste Water Cap. (gal.)	32	32	32	32	32	32
Gray Water Cap. (gal.)	32	32	32	32	32	32
LP Gas Cap. (lbs.)	40	40	40	40	40	40
Furnace BTUs (1,000s)	16	16	20	25	20	25
Tire Size	14"	14"	15"	15"	15"	15"
Awning	12'	14'	14'	15'	13'	17'

\*This weight reflects the rolling average unit weight for each model.  
Your trailer weight will vary according to optional equipment.



# SPORTSMEN<sup>TH</sup>

27TH

This versatile toy hauler puts you at the heart of the action! Transport your toys to that secluded destination, or special event, while enjoying the convenience and comfort of this value-packed model. The power bed is a popular option to add more sleep space.





# SPORTSMEN<sup>TH</sup>

27TH

This versatile toy hauler puts you at the heart of the action! Transport your toys to that secluded destination, or special event, while enjoying the convenience and comfort of this value-packed model. The power bed is a popular option to add more sleep space.





## 25TH

A three burner cooktop, microwave with turntable, and range hood with light are all standard.

### Standards

Awning with Drip Rail and Spouts  
 Microwave with Turntable  
 AM/FM/CD Player  
 13,500 BTU AC  
 6 Gallon Gas DSI Water Heater  
 Monitor Panel  
 Power Vent in Bathroom  
 Tinted Windows  
 5 Cubic Foot Refrigerator  
 TV Antenna with Booster  
 Acrylic Sink  
 Solid Wood Framed Mortise and Tenon Cabinet Doors  
 20# Gas Bottles  
 R7 Insulation  
 Patio Door Light  
 Large Overhead Cabinets

Built-In Medicine Cabinet with Mirror in Bathroom  
 Range Hood with 12V Light and Exhaust Fan  
 30 Amp Service  
 3 Burner Cooktop  
 1 Piece Seamless Roof  
 Gas Struts on Bed Base  
 Cable Hook Up  
 Radius Entry Door  
 Mini Blinds  
 Quilted Mattress  
 Roller Ball Bearing Drawer Guides  
 Decorative Border Tape  
 Sink Cover  
 Enclosed Pin Box on Fifth Wheel  
 Box Style Valances  
 Smooth Screwless Baggage Doors

### Options

2nd Flip Jiffy (N/A with Chair)  
 (Standard on 25TH and 27TH)  
 6 Gallon Gas/Electric DSI Water Heater  
 Bottle Cover  
 Chair – 1 or 2 (N/A with Jiffy)  
 Diamond Plate Threshold  
 Flip Up Full Size Bed (N/A on 17TH)  
 (N/A with Power Bed)  
 Power Front Jacks (265TH Only)  
 Pull Down Screen Wall  
 Aluminum Wheels  
 Outside Grill  
 Outside Shower  
 2 Exterior Speakers  
 Spare Tire  
 Stabilizer Jacks – 2 or 4  
 6 Cubic Foot Refrigerator

Power Awning  
 Power Bed (N/A on 17TH)  
 (N/A with Flip Up Bed)  
 Fuel Cell and Pump Station  
 (25TH, 27TH, and 265TH Only)  
 4.0 Generator (Requires Fuel Cell and Pump)  
 Fiberglass Exterior (available on S265TH)  
 (forced on S315TH)

### Standard Run Package

6 Cubic Foot Refrigerator  
 Spare Tire  
 Stabilizer Jacks – 2 or 4  
 30# Gas Bottle with Cover  
 Assist Grab Handle  
 2 Exterior Speakers  
 Gas/Electric DSI Water Heater  
 Outside Shower (Where Available)

### ASK ABOUT OUR 2-YEAR LIMITED WARRANTY!



**Dealer Satisfaction Index:**  
 Ratings of manufacturers, by dealers, have consistently awarded KZ top honors for excellence of design, reliability, overall quality and value, communications and dealer support.

Dealer:



Portions of this brochure were used with the expressed authority of Dexter Axle, but Dexter Axle is not responsible for the accuracy of the information contained herein.

For more product details and in-depth information, visit us on the web at [www.kz-rv.com](http://www.kz-rv.com)

0985 N 900 W • Shipshewana, IN 46565  
 E-mail [kz@kz-rv.com](mailto:kz@kz-rv.com) • [www.kz-rv.com](http://www.kz-rv.com)

*Due to continual research and advances, manufacturer reserves the right to change specifications, design, price and equipment without notice, and assumes no responsibility for any error in this literature. Some items shown are not included as standard or optional equipment.*

©2011KZ | 10/14/11 | 25M



## 25TH

A three burner cooktop, microwave with turntable, and range hood with light are all standard.

### Standards

Awning with Drip Rail and Spouts  
 Microwave with Turntable  
 AM/FM/CD Player  
 13,500 BTU AC  
 6 Gallon Gas DSI Water Heater  
 Monitor Panel  
 Power Vent in Bathroom  
 Tinted Windows  
 5 Cubic Foot Refrigerator  
 TV Antenna with Booster  
 Acrylic Sink  
 Solid Wood Framed Mortise and Tenon Cabinet Doors  
 20# Gas Bottles  
 R7 Insulation  
 Patio Door Light  
 Large Overhead Cabinets

Built-In Medicine Cabinet with Mirror in Bathroom  
 Range Hood with 12V Light and Exhaust Fan  
 30 Amp Service  
 3 Burner Cooktop  
 1 Piece Seamless Roof  
 Gas Struts on Bed Base  
 Cable Hook Up  
 Radius Entry Door  
 Mini Blinds  
 Quilted Mattress  
 Roller Ball Bearing Drawer Guides  
 Decorative Border Tape  
 Sink Cover  
 Enclosed Pin Box on Fifth Wheel  
 Box Style Valances  
 Smooth Screwless Baggage Doors

### Options

2nd Flip Jiffy (N/A with Chair) (Standard on 25TH and 27TH)  
 6 Gallon Gas/Electric DSI Water Heater  
 Bottle Cover  
 Chair – 1 or 2 (N/A with Jiffy)  
 Diamond Plate Threshold  
 Flip Up Full Size Bed (N/A on 17TH) (N/A with Power Bed)  
 Power Front Jacks (265TH Only)  
 Pull Down Screen Wall  
 Aluminum Wheels  
 Outside Grill  
 Outside Shower  
 2 Exterior Speakers  
 Spare Tire  
 Stabilizer Jacks – 2 or 4  
 6 Cubic Foot Refrigerator

Power Awning  
 Power Bed (N/A on 17TH) (N/A with Flip Up Bed)  
 Fuel Cell and Pump Station (25TH, 27TH, and 265TH Only)  
 4.0 Generator (Requires Fuel Cell and Pump)  
 Fiberglass Exterior (available on S265TH) (forced on S315TH)

### Standard Run Package

6 Cubic Foot Refrigerator  
 Spare Tire  
 Stabilizer Jacks – 2 or 4  
 30# Gas Bottle with Cover  
 Assist Grab Handle  
 2 Exterior Speakers  
 Gas/Electric DSI Water Heater  
 Outside Shower (Where Available)

### ASK ABOUT OUR 2-YEAR LIMITED WARRANTY!



**Dealer Satisfaction Index:**  
 Ratings of manufacturers, by dealers, have consistently awarded KZ top honors for excellence of design, reliability, overall quality and value, communications and dealer support.

Dealer:



Portions of this brochure were used with the expressed authority of Dexter Axle, but Dexter Axle is not responsible for the accuracy of the information contained herein.

For more product details and in-depth information, visit us on the web at [www.kz-rv.com](http://www.kz-rv.com)

0985 N 900 W • Shipshewana, IN 46565  
 E-mail [kz@kz-rv.com](mailto:kz@kz-rv.com) • [www.kz-rv.com](http://www.kz-rv.com)

*Due to continual research and advances, manufacturer reserves the right to change specifications, design, price and equipment without notice, and assumes no responsibility for any error in this literature. Some items shown are not included as standard or optional equipment.*

©2011KZ | 10/14/11 | 25M