





Our deluxe RVs are appointed with all of the comforts and amenities you deserve. Why buy a vacation home in one location, when this luxury coach lets you experience so much more? With stainless steel kitchens, rich hardwood accents, tile floors, state-of-the-art entertainment systems, deluxe bathrooms, available with multiple slideouts and more, your Monaco RV is a deluxe residence on wheels. You've earned the right not to sacrifice comfort. That's why Monaco Coach lets you hit the open road in style. So go ahead. Indulge yourself in a Monaco Coach.

Welcome Home.



Our deluxe RVs are appointed with all of the comforts and amenities you deserve. Why buy a vacation home in one location, when this luxury coach lets you experience so much more? With stainless steel kitchens, rich hardwood accents, tile floors, state-of-the-art entertainment systems, deluxe bathrooms, available with multiple slideouts and more, your Monaco RV is a deluxe residence on wheels. You've earned the right not to sacrifice comfort. That's why Monaco Coach lets you hit the open road in style. So go ahead. Indulge yourself in a Monaco Coach.

Welcome Home.





Multiple floorplan options and generous slide-outs allow you to choose a Knight with ample living space in a configuration that's perfect for your unique lifestyle.

EXTERIOR FEATURES

- A** Full length mud flap
- B** Patio, slide-out (and window) awnings
- C** Pass-through storage compartments

- D** Side-hinged baggage doors
- E** Radial tires: 295/80R/22.5
- F** Full chrome exterior mirrors (opt.)

- G** One-piece front windshield
- H** Fog lights
- I** Distinctive new cap design unique to Monaco brand



Multiple floorplan options and generous slide-outs allow you to choose a Knight with ample living space in a configuration that's perfect for your unique lifestyle.

EXTERIOR FEATURES

- | | | |
|--|--|--|
| A Full length mud flap | D Side-hinged baggage doors | G One-piece front windshield |
| B Patio, slide-out (and window) awnings | E Radial tires: 295/80R/22.5 | H Fog lights |
| C Pass-through storage compartments | F Full chrome exterior mirrors (opt.) | I Distinctive new cap design unique to Monaco brand |



Enjoy Knight's exquisite and comfortable dining area, where you'll appreciate the roominess of a booth dinette with a legless, side-slide dinette table or an optional free-standing dinette with two chairs (pictured) and two folding chairs.



Enjoy Knight's exquisite and comfortable dining area, where you'll appreciate the roominess of a booth dinette with a legless, side-slide dinette table or an optional free-standing dinette with two chairs (pictured) and two folding chairs.



Cook up a masterpiece in a kitchen featuring high-end appliances, hardwood cabinetry, Corian® countertops, a decorative tile and glass backsplash, flip-up countertop extension and stainless steel sink.



The comfortable cockpit boasts UltraLeather™ six-way power pilot and copilot seats, in-dash driver message center, 3-camera color rear vision system and available GPS and Sirius Satellite Radio.



Cook up a masterpiece in a kitchen featuring high-end appliances, hardwood cabinetry, Corian® countertops, a decorative tile and glass backsplash, flip-up countertop extension and stainless steel sink.



The comfortable cockpit boasts UltraLeather™ six-way power pilot and copilot seats, in-dash driver message center, 3-camera color rear vision system and available GPS and Sirius Satellite Radio.



An array of luxurious décor and fabric styles, along with a standard queen bed (king available), a 32-inch LCD TV and optional DVD player make the Knight's master bedroom the perfect place to retire at the end of an eventful day.

In the Knight's bathroom, you'll find gorgeous porcelain tile flooring, a Corian® countertop lavatory with integrated bowl and decorative backsplash and a roomy one-piece shower, all standard.



An array of luxurious décor and fabric styles, along with a standard queen bed (king available), a 32-inch LCD TV and optional DVD player make the Knight's master bedroom the perfect place to retire at the end of an eventful day.



In the Knight's bathroom, you'll find gorgeous porcelain tile flooring, a Corian® countertop lavatory with integrated bowl and decorative backsplash and a roomy one-piece shower, all standard.



Make yourself at home with a variety of dinette, recliner and sofa options, as well as desirable amenities like 42-inch LCD flatscreen TV, a home theater system and an optional electric fireplace (pictured).



Make yourself at home with a variety of dinette, recliner and sofa options, as well as desirable amenities like 42-inch LCD flatscreen TV, a home theater system and an optional electric fireplace (pictured).

ITALIAN
SIENNAGLAZED ITALIAN
SIENNA

PLATINUM



NEO CINNABAR



MOCHA SPLENDOR



A. BEDSPREAD B. SOFA C. ACCENT D. TILE

Note: colors depicted are a reasonable representation though they may not be an exact match of the actual colors due to variances in processing and production.

MAKE IT HOME.

Choose from a stunning selection of décor and cabinetry styles and combinations, designed to surround you in comfort and luxury.

AROUND THE CLOCK SERVICE AND SUPPORT

When you take delivery of your new recreational vehicle, it's just the beginning of our exclusive around-the-clock Owner Advantage Program.

We offer an extensive support program that provides complete roadside assistance and special motor club benefits that follow you wherever your travels take you. We've teamed up with

the largest RV emergency road service company in the country to give you immediate access to fast, dependable service when and where you need it. Add our toll-free service appointment assistance, plus a technical assistance hotline, and you have the security of full-time support at your fingertips.

For details, call toll-free 877-211-8135

WARRANTIES

Enjoy your next RV adventure with the peace of mind that comes with a 12 month/24,000 mile basic limited warranty; a 5 year/50,000 mile limited warranty on aluminum or steel frame

structure; and a 3 year/50,000 mile limited warranty on the Roadmaster Chassis. Review your coach's limited warranty in full for complete terms and conditions.



MORE TO STORE.

The Knight features large, pass-through storage bays with side-hinged baggage doors.

ITALIAN
SIENNAGLAZED ITALIAN
SIENNA

PLATINUM



NEO CINNABAR



MOCHA SPLENDOR

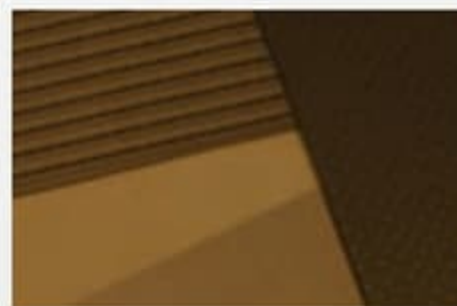

A. BEDSPREAD B. SOFA C. ACCENT D. TILE

Note: colors depicted are a reasonable representation though they may not be an exact match of the actual colors due to variances in processing and production.

AROUND THE CLOCK SERVICE AND SUPPORT

When you take delivery of your new recreational vehicle, it's just the beginning of our exclusive around-the-clock Owner Advantage Program.

We offer an extensive support program that provides complete roadside assistance and special motor club benefits that follow you wherever your travels take you. We've teamed up with

the largest RV emergency road service company in the country to give you immediate access to fast, dependable service when and where you need it. Add our toll-free service appointment assistance, plus a technical assistance hotline, and you have the security of full-time support at your fingertips.

For details, call toll-free 877-211-8135

WARRANTIES

Enjoy your next RV adventure with the peace of mind that comes with a 12 month/24,000 mile basic limited warranty; a 5 year/50,000 mile limited warranty on aluminum or steel frame

structure; and a 3 year/50,000 mile limited warranty on the Roadmaster Chassis. Review your coach's limited warranty in full for complete terms and conditions.



MAKE IT HOME.

Choose from a stunning selection of décor and cabinetry styles and combinations, designed to surround you in comfort and luxury.

MORE TO STORE.

The Knight features large, pass-through storage bays with side-hinged baggage doors.

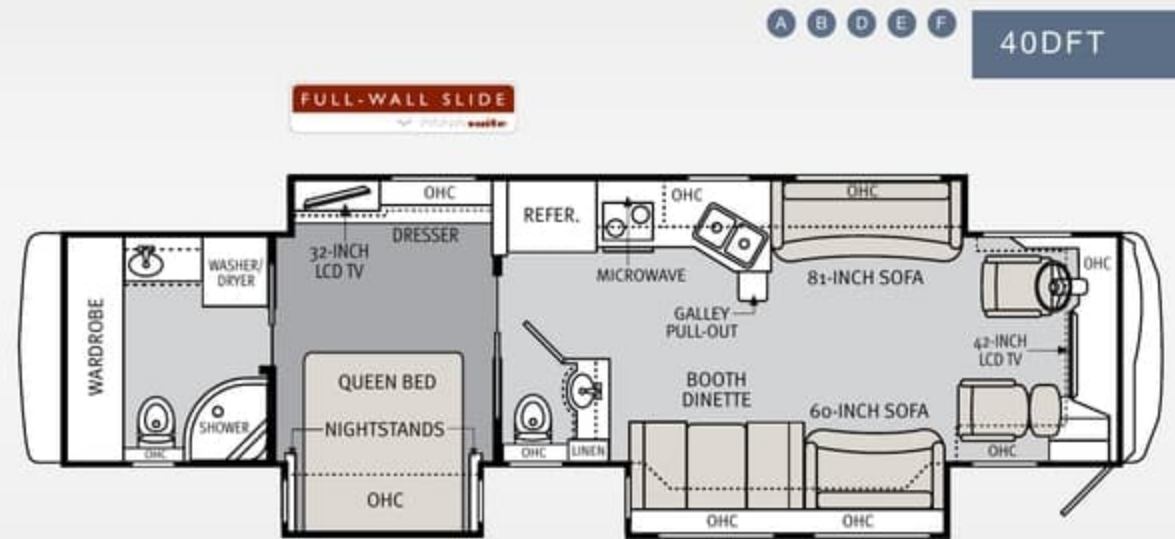
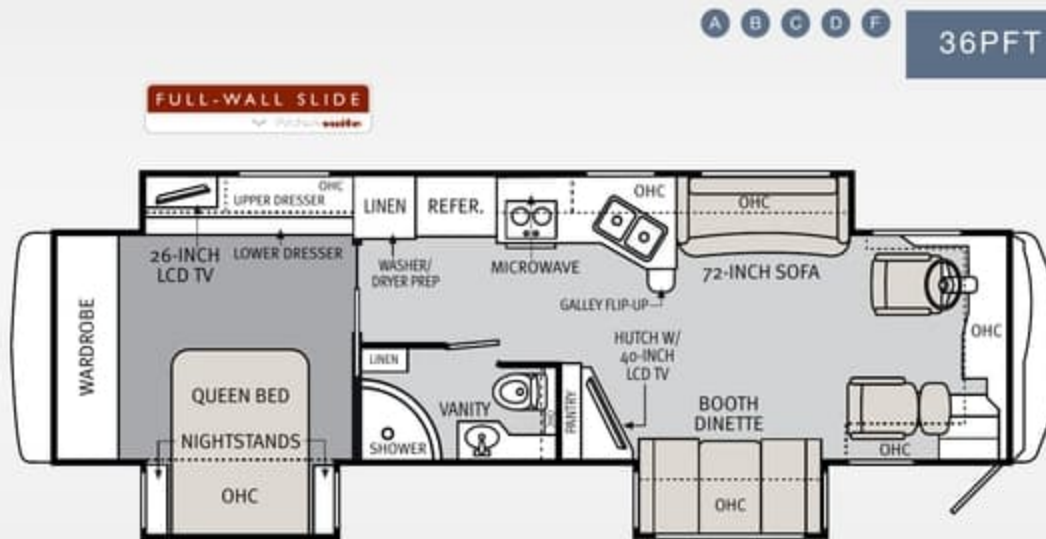

FLOORPLANS FOR LIVING.

Select from three floorplan designs in lengths of 36 and 40 feet, including a quad-slide and two spacious full-wall slides, along with multiple furniture options and configurations.

FURNITURE OPTIONS:

FREE-STANDING DINETTE

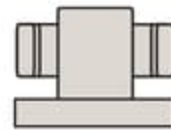

A

FREE-STANDING DINETTE WITH WORKSTATION

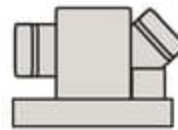

B

U-SHAPED BOOTH DINETTE

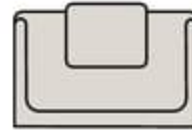

C

EXTENDABLE L-SOFA



D

BOOTH DINETTE ENSEMBLE



E

KING BED

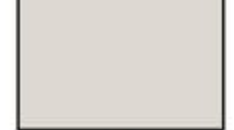

F

A B C D F

36PFT

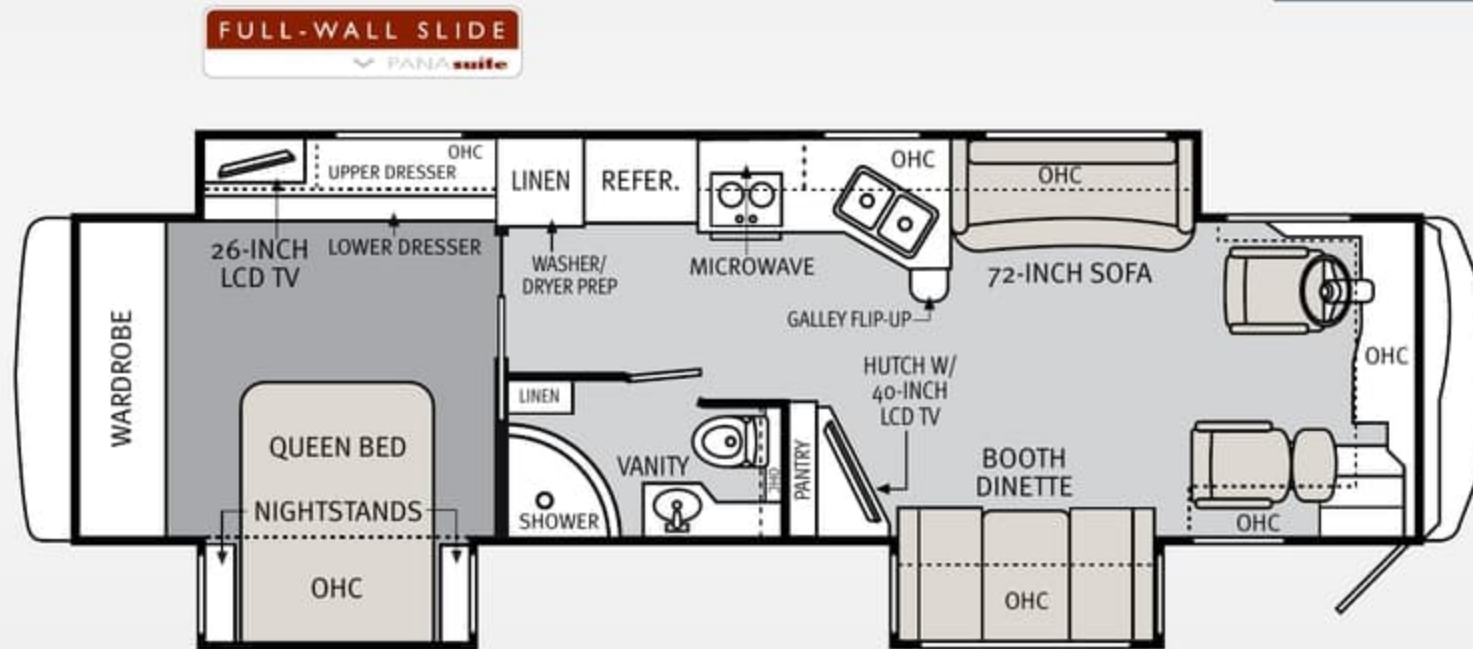

A B D E F

40DFT

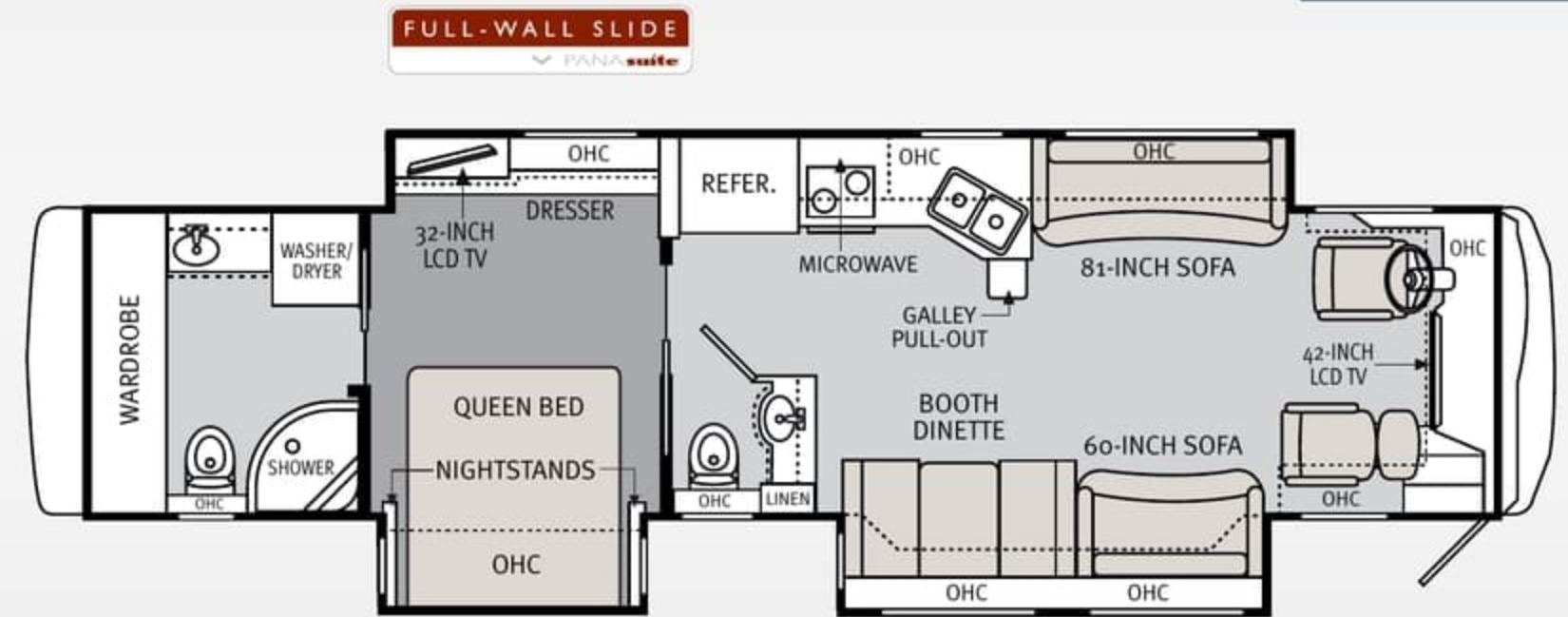

A B D E F

40PDQ

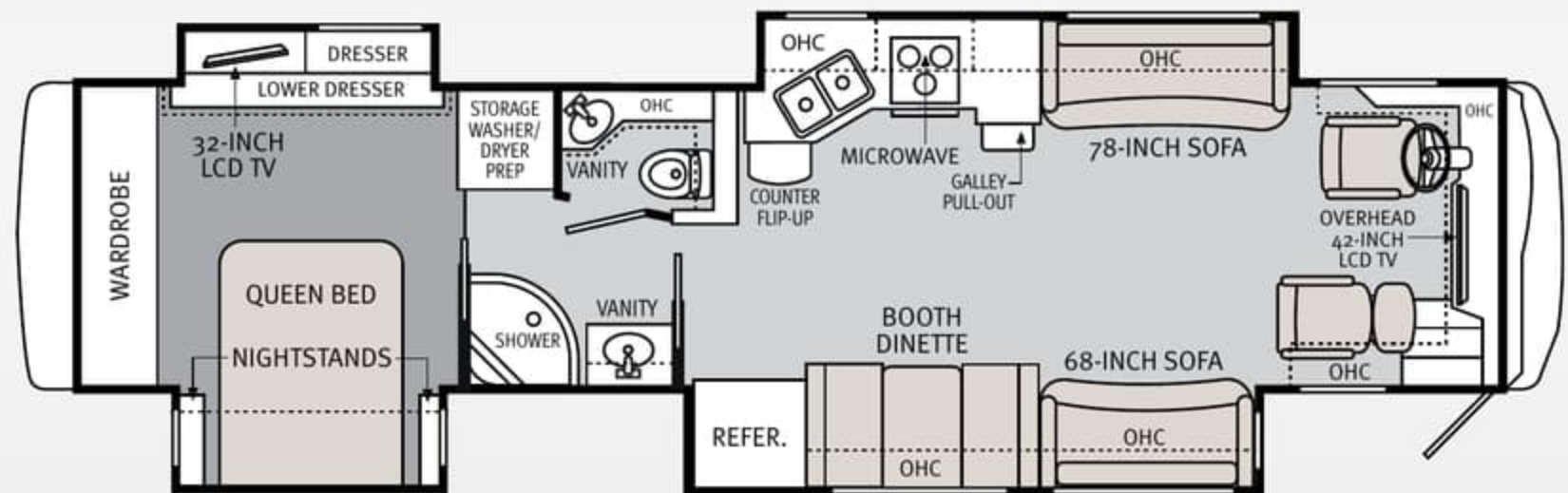

FLOORPLANS FOR LIVING.

Select from three floorplan designs in lengths of 36 and 40 feet, including a quad-slide and two spacious full-wall slides, along with multiple furniture options and configurations.

FURNITURE OPTIONS:

FREE-STANDING DINETTE

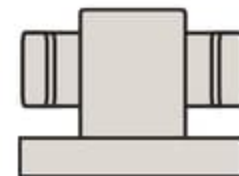

A

FREE-STANDING DINETTE WITH WORKSTATION

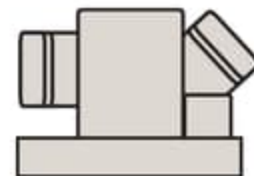

B

U-SHAPED BOOTH DINETTE



C

EXTENDABLE L-SOFA



D

BOOTH DINETTE ENSEMBLE



E

KING BED



F

MAXXFORCE® POWER

The MaxxForce® 10 is built on the same proven I-6 platform as Navistar's legendary and industry-leading DT engine. This I-6 design grew from a big idea: bring to the mid-range diesel market traditional big bore features like wet-sleeve design and in-chassis rebuild capability. This model, which brings increased 9.3-liter displacement by longer stroke, meets the requirements of more demanding applications.

The high-output MaxxForce 10 offers these features plus the performance you would expect from larger heavy-duty engines in a weight-saving medium-duty package.

MaxxForce diesel engines deliver powerful, smooth, and reliable operation without the added hassle of complicated emissions technology. All backed by the largest network of service locations.



ROOF CONSTRUCTION

(top to bottom)

- One-piece peaked fiberglass roof
- Luaun backing
- Thick, tapered bead foam insulation
- Aluminum double I-beam superstructure filled with fiberglass insulation
- Vapor barrier
- Structure foam: thermal insulative barrier
- 1/2" bead foam insulation
- Foam padding for extra insulation
- Padded vinyl ceiling



SIDEWALL CONSTRUCTION

(left to right)

- Wallpaper
- Décor board
- 1-1/2" x 1-1/2" square tubular aluminum frame
- High performance thermal insulation
- Gel coat fiberglass composite sidewall



FLOOR CONSTRUCTION

(top to bottom)

- Structurwood™
- 1-1/2" tube
- High-performance thermal insulation foam
- Luaun
- 3-ply backer

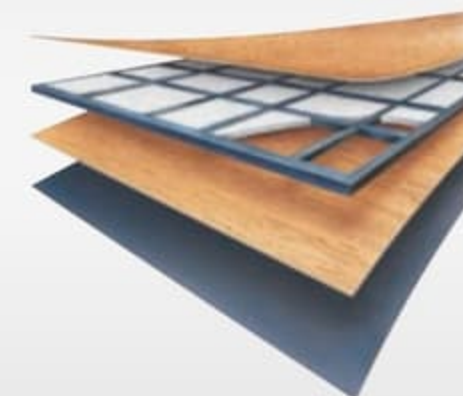

MAXXFORCE® POWER

The MaxxForce® 10 is built on the same proven I-6 platform as Navistar's legendary and industry-leading DT engine. This I-6 design grew from a big idea: bring to the mid-range diesel market traditional big bore features like wet-sleeve design and in-chassis rebuild capability. This model, which brings increased 9.3-liter displacement by longer stroke, meets the requirements of more demanding applications.

The high-output MaxxForce 10 offers these features plus the performance you would expect from larger heavy-duty engines in a weight-saving medium-duty package.

MaxxForce diesel engines deliver powerful, smooth, and reliable operation without the added hassle of complicated emissions technology. All backed by the largest network of service locations.



ROOF CONSTRUCTION

(top to bottom)

- One-piece peaked fiberglass roof
- Luaun backing
- Thick, tapered bead foam insulation
- Aluminum double I-beam superstructure filled with fiberglass insulation
- Vapor barrier
- Structure foam: thermal insulative barrier
- 1/2" bead foam insulation
- Foam padding for extra insulation
- Padded vinyl ceiling



SIDEWALL CONSTRUCTION

(left to right)

- Wallpaper
- Décor board
- 1-1/2" x 1-1/2" square tubular aluminum frame
- High performance thermal insulation
- Gel coat fiberglass composite sidewall



FLOOR CONSTRUCTION

(top to bottom)

- Structurwood™
- 1-1/2" tube
- High-performance thermal insulation foam
- Luaun
- 3-ply backer

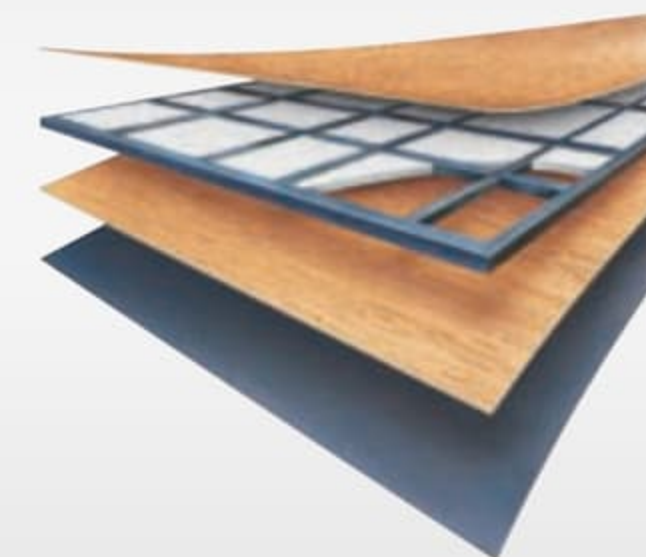

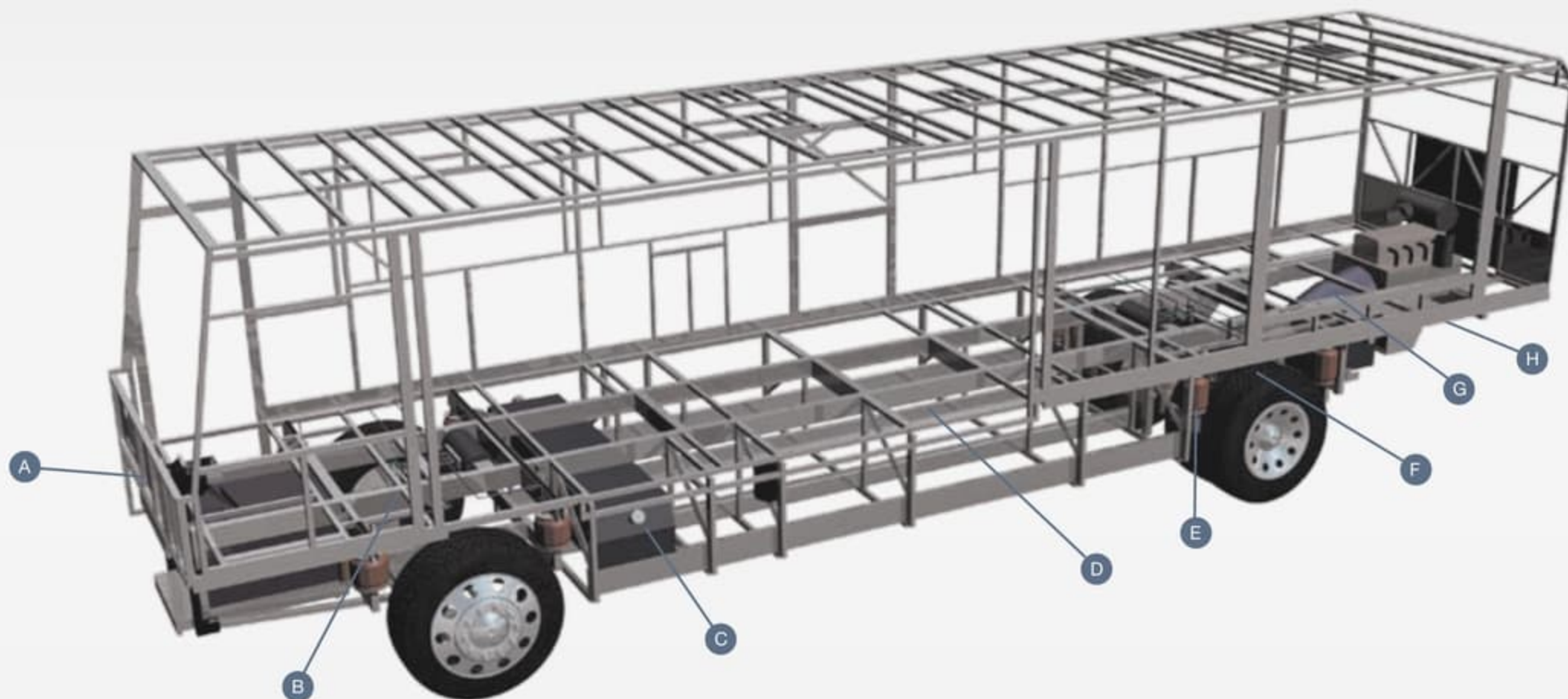

ROADMASTER RR8R RAISED RAIL CHASSIS

The 2012 Knight rides exclusively on the Roadmaster Chassis, custom-built to deliver the very best diesel motorhome experience possible.

FEATURES

- A** Steel firewall
- B** Raised-rail design
- C** Dual fuel fill
- D** Steel truss system
- E** Cushion Air Glide Suspension with 8 outboard-mounted airbags and 8 shock absorbers
- F** Automatic Traction Control (ATC)
- G** Allison® 3000 MH 6-speed transmission
- H** 10,000 lb. tow hitch

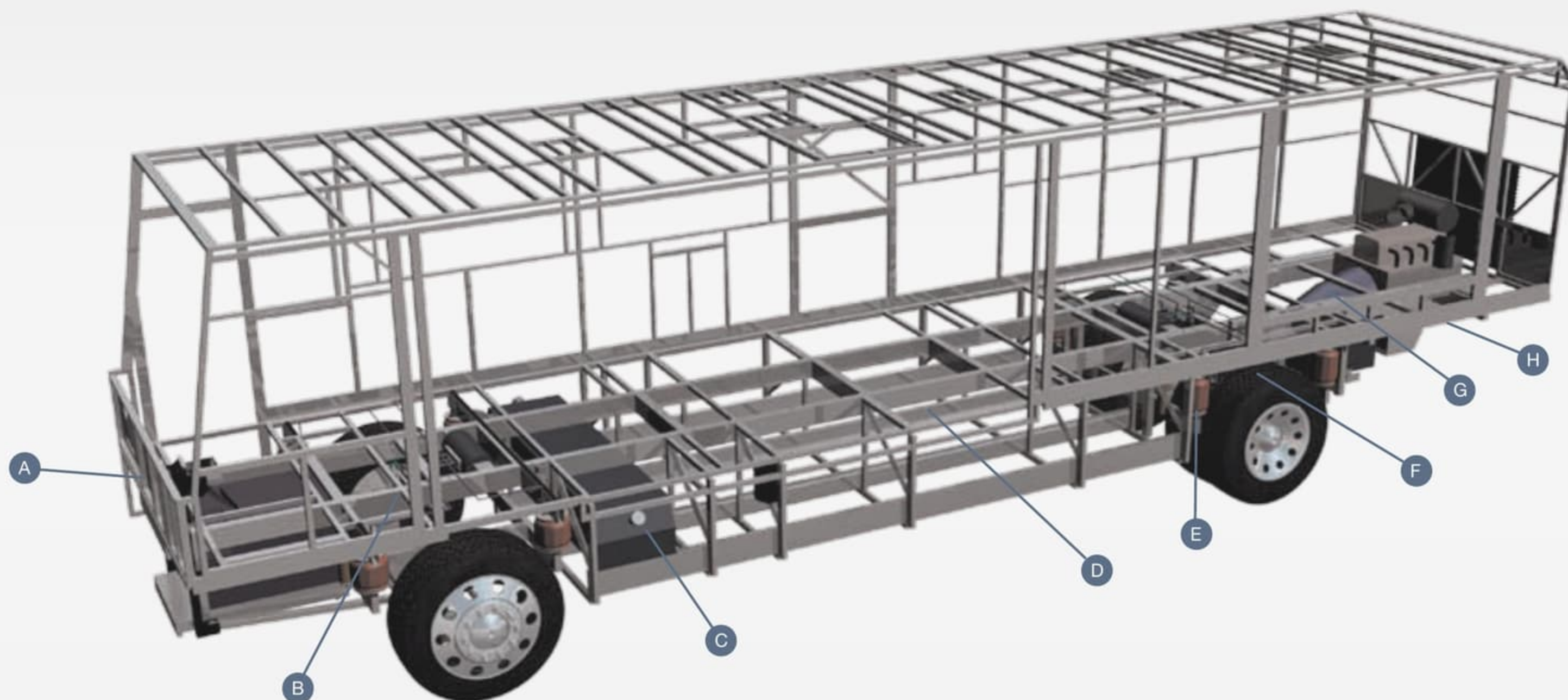

ROADMASTER RR8R RAISED RAIL CHASSIS

The 2012 Knight rides exclusively on the Roadmaster Chassis, custom-built to deliver the very best diesel motorhome experience possible.

FEATURES

- A Steel firewall
- B Raised-rail design
- C Dual fuel fill
- D Steel truss system
- E Cushion Air Glide Suspension with 8 outboard-mounted airbags and 8 shock absorbers
- F Automatic Traction Control (ATC)
- G Allison® 3000 MH 6-speed transmission
- H 10,000 lb. tow hitch

WEIGHTS

36PFT

40PDQ

40DFT

Gross Vehicle Weight Rating (Lbs.)

33,000

33,000

33,000

Gross Combined Weight Rating¹ (Lbs.)

43,000

43,000

43,000

Front Gross Axle Weight Rating (Lbs.)

13,000

13,000

13,000

Rear Gross Axle Weight Rating (Lbs.)

20,000

20,000

20,000

MEASUREMENTS

36PFT

40PDQ

40DFT

Wheelbase

213"

261"

261"

Overall Length

37' 4"

41' 4"

41' 4"

Overall Height with AC

12' 7"

12' 7"

12' 7"

Exterior Width

8' 4"

8' 4"

8' 4"

Interior Height

7' 0"

7' 0"

7' 0"

TANK CAPACITIES²

36PFT

40PDQ

40DFT

Gray Tank (Gal.)

62

62

62

Black Tank (Gal.)

40

40

40

Fresh Tank (Gal.)

100

100

100

Fuel Tank (Gal.)

100

100

100

LP Tank³ (Gal.)

39

39

39

Due to continuous product improvements, please visit us online at monacocoach.com for the latest in standards, options, specifications and technical data.

¹ Towing capacity is limited by GCWR; your vehicle's towing capacity is the difference between the GCWR and the actual vehicle weight, including all water, fuel, passengers and cargo. Your towed vehicle should be equipped with auxiliary brakes if the weight of the towed vehicle exceeds 1,000 lbs. consult your owner's manual for further towing information.

² All tank capacities are estimated based upon calculations provided by the tank manufacturers and represent approximate capacities. The actual "usable capacity" may be greater or less than the estimated capacities based upon fabrication and installation of the tanks.

³ Actual filled LP capacity is 80% of listing due to safety shut-off required on tank.

The actual overall length of the recreational vehicle may differ from that indicated in the brochure due to variances in the manufacturing process and/or installed components. The actual length may be greater or less than that indicated. Due to the large variety of options and floorplan arrangements available to our customers, actual weights for each unit can differ significantly. Monaco provides a weight sticker on each unit we produce which includes that unit's tank capacities and approximate weight. Consult your local Monaco dealer for unit availability and further information. The information printed in this brochure reflects product design, fabrication, and component parts at the date of printing. The manufacturer reserves the right, at any time, to make changes in product design or material or component specifications as its sole option, without notice. This includes the substitution of

components of a different brand or trade name which will result in comparable performance. All information printed in this brochure is subject to change after the date of printing. Some features shown or mentioned in this brochure are optional and may only be available in selected floorplans. Photographs may depict a floorplan option that has been discontinued or is no longer available at the time of your purchase. Photographs may show props or decorations that are not standard equipment. Monaco, the Monaco logo and its design, are registered trademarks. Other products and company names are trademarks and/or registered trademarks of their respective holders. While the color of the motorhome's exterior and the interior fabrics depicted in this sales brochure are fair and reasonable depictions, the colors depicted may not be an exact match of the actual colors because of the variances in

photo-processing and printing. Due to product improvements, changes during the model year and/or transcription errors that may occur, information represented within this brochure may not be accurate at the time of your purchase. If certain information is significant to your purchasing decision, please confirm the information with your dealer. Component part and appliance manufacturers issue limited warranties covering portions of the recreational vehicle not covered under the Limited Warranties issued by Monaco RV, LLC. To learn specific details regarding warranty coverage, please contact your selling dealership or review the warranty packet inside the recreational vehicle.

WEIGHTS

36PFT

40PDQ

40DFT

Gross Vehicle Weight Rating (Lbs.)

33,000

33,000

33,000

Gross Combined Weight Rating¹ (Lbs.)

43,000

43,000

43,000

Front Gross Axle Weight Rating (Lbs.)

13,000

13,000

13,000

Rear Gross Axle Weight Rating (Lbs.)

20,000

20,000

20,000

MEASUREMENTS

36PFT

40PDQ

40DFT

Wheelbase

213"

261"

261"

Overall Length

37' 4"

41' 4"

41' 4"

Overall Height with AC

12' 7"

12' 7"

12' 7"

Exterior Width

8' 4"

8' 4"

8' 4"

Interior Height

7' 0"

7' 0"

7' 0"

TANK CAPACITIES²

36PFT

40PDQ

40DFT

Gray Tank (Gal.)

62

62

62

Black Tank (Gal.)

40

40

40

Fresh Tank (Gal.)

100

100

100

Fuel Tank (Gal.)

100

100

100

LP Tank³ (Gal.)

39

39

39

Due to continuous product improvements, please visit us online at monacocoach.com for the latest in standards, options, specifications and technical data.

¹ Towing capacity is limited by GCWR; your vehicle's towing capacity is the difference between the GCWR and the actual vehicle weight, including all water, fuel, passengers and cargo. Your towed vehicle should be equipped with auxiliary brakes if the weight of the towed vehicle exceeds 1,000 lbs. consult your owner's manual for further towing information.

² All tank capacities are estimated based upon calculations provided by the tank manufacturers and represent approximate capacities. The actual "usable capacity" may be greater or less than the estimated capacities based upon fabrication and installation of the tanks.

³ Actual filled LP capacity is 80% of listing due to safety shut-off required on tank.

The actual overall length of the recreational vehicle may differ from that indicated in the brochure due to variances in the manufacturing process and/or installed components. The actual length may be greater or less than that indicated. Due to the large variety of options and floorplan arrangements available to our customers, actual weights for each unit can differ significantly. Monaco provides a weight sticker on each unit we produce which includes that unit's tank capacities and approximate weight. Consult your local Monaco dealer for unit availability and further information. The information printed in this brochure reflects product design, fabrication, and component parts at the date of printing. The manufacturer reserves the right, at any time, to make changes in product design or material or component specifications as its sole option, without notice. This includes the substitution of

components of a different brand or trade name which will result in comparable performance. All information printed in this brochure is subject to change after the date of printing. Some features shown or mentioned in this brochure are optional and may only be available in selected floorplans. Photographs may depict a floorplan option that has been discontinued or is no longer available at the time of your purchase. Photographs may show props or decorations that are not standard equipment. Monaco, the Monaco logo and its design, are registered trademarks. Other products and company names are trademarks and/or registered trademarks of their respective holders. While the color of the motorhome's exterior and the interior fabrics depicted in this sales brochure are fair and reasonable depictions, the colors depicted may not be an exact match of the actual colors because of the variances in

photo-processing and printing. Due to product improvements, changes during the model year and/or transcription errors that may occur, information represented within this brochure may not be accurate at the time of your purchase. If certain information is significant to your purchasing decision, please confirm the information with your dealer. Component part and appliance manufacturers issue limited warranties covering portions of the recreational vehicle not covered under the Limited Warranties issued by Monaco RV, LLC. To learn specific details regarding warranty coverage, please contact your selling dealership or review the warranty packet inside the recreational vehicle.

BODY CONSTRUCTION

- › Laminated Sidewall Construction
- › Smooth Fiberglass Exterior Walls
- › Peaked One Piece Fiberglass Roof
- › LED Clearance and Side Marker Lights
- › Fog Lights with Black Bezels

- › Chrome Head Exterior Mirrors
- › Side Hinge Access Doors for Engine Fluid Service on Rear Cap
- › One Piece Front Windshield
- › Pull Out Generator Tray with One-Piece Door
- › Side Hinge Baggage Doors
- › One-Piece Polyethylene Pass-through

- › Storage Compartments
- › Deluxe Full Body Paint
- › Dura Shield Front Mask Film
- › Corian® Interior Entry with Bull Nose Tile, Rubber Steps and Storage Bucket
- › Exterior Double Entry Steps with Light
- › Full Length Mud Flap

- › Storage Bay Slide-Out Trays
- › RVIA Certification
- › Canadian RV Certification
- › Transport Canada MVSR
- › Rear Ladder
- › Full Chrome Exterior Mirrors

CHASSIS / ENGINE / SUSPENSION

- › Roadmaster Raised Rail Chassis RR8R
- › MaxxForce® 10-350HP, 2010 EPA Engine with Allison 3000MH 6-Speed World Transmission; Engine Displacement 9.3L/570 cu. in.; Torque: 1150 lbs/ft. Max. Net at 1,200 RPM; Rear Axle Ratio: 4:30:1

- › Three Position Diamond Logic® Engine Compression Brake by Jacobs®
- › Two Speed Horton Fan Clutch
- › 10,000 lb. Hitch Receiver with Dual Connector 4-Pin or 7-Pin
- › Block Heater
- › Dual Fuel Fill
- › 160 Amp Alternator

- › Radial Tires: 295/80R/22.5
- › Stainless Steel Wheel Simulators
- › Cushion Air Glide Suspension with Eight Outboard Mounted Air Bags and Eight Shock Absorbers
- › Anti-Lock Braking System with Full Airbrake
- › Automatic Traction Control
- › Pre-wire for Supplemental Braking System

- › Air Cleaner Restriction Indicator
- › Fuel/Water Separator
- › Remote Transmission Fill
- › Automatic Air Leveling System

- › Polished Aluminum Wheels
- › Automatic Hydraulic Leveling System

COCKPIT

- › Automotive Dash with Oxford Burl Instrumentation Panel
- › Ergonomic Drivers Control Module with Improved Steering Shaft Location
- › One Key Fits All Ignition – Ignition Key Opens Entry Door and Baggage Doors

- › In-Dash 7" LCD Touch Screen AM/FM/CD Stereo Radio with Sirius Ready Compatibility, Auxiliary In Connectivity, SD Card Slot, USB Port for MP3 Player/Flash Drives and Weather Band; Back up Camera Monitor System with DVD player; Auxiliary Audio Input Jack, iPod and Bluetooth Hands-Free
- › Power Windshield and Manual Driver/Pass.

- › Solar Screens w/ Black-Out Shades
- › In-Dash Driver's Message Center
- › Lighted VIP Smartwheel Multiplexed Steering Wheel with Controls for ICC, Radio, Cruise Control and Engine Brake
- › ICC Light Switch on Drivers Side Console
- › Air Horns
- › Molded Pilot and Co-Pilot Side Console, with

- › Two Tier Cup Holder
- › Ultra Leather Six-Way Power Pilot Seat and Co-Pilot Seat with Powered Footrest
- › Carpeted Driver and Passenger Floor Mats

- › Sirius Satellite Radio Tuner with Antenna
- › GPS Navigation System with Dock Station

APPLIANCES / ACCESSORIES

- › 12 cu. ft. 2-Way 4-Door Fridge w/ Ice Maker
- › High-Output Sealed 3-Burner Cooktop without Oven
- › Removable Corian® Range Covers
- › Space Saver Convection Microwave
- › 42" Flat Screen Sharp LCD TV in Front Cockpit Overhead (N/A 36PFT)
- › 42" Flat Screen Sharp LCD TV for Mid-

- › Ship TV Locations (36PFT)
- › 32" LCD Color TV with Remote in Bedroom
- › Home Theater System
- › Washer/Dryer Prep
- › Curbside; Exterior Patio Hook-Ups for Cable and 110V Outlet with Hatch Door to Exterior
- › Digital Satellite System Prep
- › Interior Cable TV Hook-Up Accessories
- › Curbside; Exterior Gas Line Hook-Up Prep for LP Accessories

- › Water Filter
- › LP Tank Gauge

- › 32" LCD Stereo Color TV with Remote Control in Cockpit Overhead (36 PFT)
- › Residential Refrigerator (Requires Auto Generator Start Option)
- › Central Vacuum with Toe Kick Inlet
- › Stackable Washer and Dryer

- › Bedroom DVD Player
- › R5 KVH In-Motion Satellite - Dish Network Only (N/A Canada)
- › Multi-Satellite HD KU/KA Dish -DirecTV Winegard Stationary Operation only (N/A Canada)
- › Winegard Stationary Dish-Star (Canada Only)
- › Exterior Entertainment Center 42" LCD TV with DVD player

STANDARD ☐ OPTIONS ☒

BODY CONSTRUCTION

- › Laminated Sidewall Construction
- › Smooth Fiberglass Exterior Walls
- › Peaked One Piece Fiberglass Roof
- › LED Clearance and Side Marker Lights
- › Fog Lights with Black Bezels

- › Chrome Head Exterior Mirrors
- › Side Hinge Access Doors for Engine Fluid Service on Rear Cap
- › One Piece Front Windshield
- › Pull Out Generator Tray with One-Piece Door
- › Side Hinge Baggage Doors
- › One-Piece Polyethylene Pass-through

- › Storage Compartments
- › Deluxe Full Body Paint
- › Dura Shield Front Mask Film
- › Corian® Interior Entry with Bull Nose Tile, Rubber Steps and Storage Bucket
- › Exterior Double Entry Steps with Light
- › Full Length Mud Flap

- › Storage Bay Slide-Out Trays
- › RVIA Certification
- › Canadian RV Certification
- › Transport Canada MVSR
- › Rear Ladder
- › Full Chrome Exterior Mirrors

CHASSIS / ENGINE / SUSPENSION

- › Roadmaster Raised Rail Chassis RR8R
- › MaxxForce® 10-350HP, 2010 EPA Engine with Allison 3000MH 6-Speed World Transmission; Engine Displacement 9.3L/570 cu. in.; Torque: 1150 lbs/ft. Max. Net at 1,200 RPM; Rear Axle Ratio: 4:30:1

- › Three Position Diamond Logic® Engine Compression Brake by Jacobs®
- › Two Speed Horton Fan Clutch
- › 10,000 lb. Hitch Receiver with Dual Connector 4-Pin or 7-Pin
- › Block Heater
- › Dual Fuel Fill
- › 160 Amp Alternator

- › Radial Tires: 295/80R/22.5
- › Stainless Steel Wheel Simulators
- › Cushion Air Glide Suspension with Eight Outboard Mounted Air Bags and Eight Shock Absorbers
- › Anti-Lock Braking System with Full Airbrake
- › Automatic Traction Control
- › Pre-wire for Supplemental Braking System

- › Air Cleaner Restriction Indicator
- › Fuel/Water Separator
- › Remote Transmission Fill
- › Automatic Air Leveling System

- › Polished Aluminum Wheels
- › Automatic Hydraulic Leveling System

COCKPIT

- › Automotive Dash with Oxford Burl Instrumentation Panel
- › Ergonomic Drivers Control Module with Improved Steering Shaft Location
- › One Key Fits All Ignition – Ignition Key Opens Entry Door and Baggage Doors

- › In-Dash 7" LCD Touch Screen AM/FM/CD Stereo Radio with Sirius Ready Compatibility, Auxiliary In Connectivity, SD Card Slot, USB Port for MP3 Player/Flash Drives and Weather Band; Back up Camera Monitor System with DVD player; Auxiliary Audio Input Jack, iPod and Bluetooth Hands-Free
- › Power Windshield and Manual Driver/Pass.

- › Solar Screens w/ Black-Out Shades
- › In-Dash Driver's Message Center
- › Lighted VIP Smartwheel Multiplexed Steering Wheel with Controls for ICC, Radio, Cruise Control and Engine Brake
- › ICC Light Switch on Drivers Side Console
- › Air Horns
- › Molded Pilot and Co-Pilot Side Console, with

- › Two Tier Cup Holder
- › Ultra Leather Six-Way Power Pilot Seat and Co-Pilot Seat with Powered Footrest
- › Carpeted Driver and Passenger Floor Mats

- › Sirius Satellite Radio Tuner with Antenna
- › GPS Navigation System with Dock Station

APPLIANCES / ACCESSORIES

- › 12 cu. ft. 2-Way 4-Door Fridge w/ Ice Maker
- › High-Output Sealed 3-Burner Cooktop without Oven
- › Removable Corian® Range Covers
- › Space Saver Convection Microwave
- › 42" Flat Screen Sharp LCD TV in Front Cockpit Overhead (N/A 36PFT)
- › 42" Flat Screen Sharp LCD TV for Mid-

- › Ship TV Locations (36PFT)
- › 32" LCD Color TV with Remote in Bedroom
- › Home Theater System
- › Washer/Dryer Prep
- › Curbside; Exterior Patio Hook-Ups for Cable and 110V Outlet with Hatch Door to Exterior
- › Digital Satellite System Prep
- › Interior Cable TV Hook-Up Accessories
- › Curbside; Exterior Gas Line Hook-Up Prep for LP Accessories

- › Water Filter
- › LP Tank Gauge

- › 32" LCD Stereo Color TV with Remote Control in Cockpit Overhead (36 PFT)
- › Residential Refrigerator (Requires Auto Generator Start Option)
- › Central Vacuum with Toe Kick Inlet
- › Stackable Washer and Dryer

- › Bedroom DVD Player
- › R5 KVH In-Motion Satellite - Dish Network Only (N/A Canada)
- › Multi-Satellite HD KU/KA Dish -DirecTV Winegard Stationary Operation only (N/A Canada)
- › Winegard Stationary Dish-Star (Canada Only)
- › Exterior Entertainment Center 42" LCD TV with DVD player

STANDARD ☐ OPTIONS ☒

INTERIOR

- › Hardwood Cabinetry; Italian Sienna
- › Hardwood Raised Panel Doors on Fridge
- › Heavy Duty Ball Bearing Drawer Guides
- › Polished Corian® Countertops Throughout with Decorative Tile with Backsplash in Kitchen and Bath

- › Stainless Steel Kitchen Sink
- › Pull-Out Countertop Extension with Drawer and Corian Top (Only 40PDQ)
- › Flip-Up Countertop Extension (N/A 36PFT)
- › Solid Surface Bath Counter w/ Integrated Bowl
- › Porcelain Tile in Kitchen, Living Room and Bath – 12 X 24 with Accent
- › Carpeting with Pad in Bedroom

- › Soft Touch Padded Vinyl Ceiling
- › Satin Nickel Cabinetry Hardware/Accessories
- › Oversized Rear Wardrobe Closet
- › Bedroom Wardrobe Slide-Out Foot of Bed
- › Blackout Day/Night Pleated Shades in Living Area and in Bedroom
- › Mini Blinds in Kitchen and Bath
- › Soil Repellant on Fabrics

- › Décors: Platinum; Neo Cinnabar; Mocha Splendor
- › Manual Solar Screens with Blackouts Throughout
- › Polished Porcelain Tile
- › Pull-Out Trash Can
- › Wood Choice: Glazed Italian Sienna

FURNITURE

- › Queen Bed with Overhead Cabinet and Nightstands
- › Arched Back Wood Booth Dinette w/ Side Sliding Dinette Table Top with Storage
- › Seat Belts in Booth Dinette in Living Area Slide-Out (N/A 40PDQ)

- › Roadside; Ultra Leather Jack Knife Sofa
- › Curbside; Ultra Leather Jack Knife Sofa (N/A 36PFT)
- › Queen Premier Select Comfort Air Mattress
- › King Bed
- › King Premier Select Comfort Air Mattress
- › Roadside; Ultra Leather Hide-A-Bed with Air

- Mattress
- › Roadside; Ultra Leather Extendable L-Sofa (N/A 36 PFT)
 - › Curbside; Ultra Leather Hide-A-Bed with Air Mattress (Only 40PDQ)
 - › Curbside; Ultra Leather Booth Dinette Ensemble with Hide-A-Bed (N/A 36PFT)
 - › Curbside; Ultra Leather Hide-A-Bed with Air

- Mattress, Removable Arms (Only 40DFT)
- › Curbside; Ultra Leather Booth Dinette Ensemble (Only 36PFT)
 - › Curbside; Ultra Leather U-Dinette with Sleeping (Only 36PFT)
 - › Free-Standing Dinette w/ Work Station
 - › Free-Standing Dinette w/ Two Free-Standing Chairs and Two Folding Chairs

ELECTRICAL SYSTEMS & LIGHTS

- › 50 AMP 120V Distribution Panel and Power Cord
- › Power Control System
- › Onan® 8.0 kW Quiet Diesel Generator
- › 2000-Watt Inverter with Two UL16HC House Batteries

- › Two 12V Heavy Duty Chassis Batteries
- › Battery Disconnect Switch at Front Door
- › Battery Boost Switch in Cockpit
- › 12V & 120V Outlet in Cockpit Area
- › Porch Light
- › Exterior Power Entry Step with Light
- › Interior Step Well Entry Step Lights
- › 120V Outlet in Outside Storage Compartment

- › Roadside; Exterior Hook-Ups for DSS Dish, Phone and Cable with Hatch Cover
- › Under Hood Utility Light
- › Convenience Center in Hallway
- › Lights in Outside Storage Compartments with Switch on Passenger Console
- › Pilot and Co-Pilot Map Lights
- › Decorative Living Room Wall Light

- › Auto Generator Start
- › Power Cord Reel
- › Storage Compartment Tank Monitor Gauge

PLUMBING & LP SYSTEMS

- › Single Lever Kitchen Faucet with Pull-Out Sprayer
- › Stainless Steel Under-Mounted Kitchen Sink
- › Central Water Filtration System with Curbside Access to Water Filter
- › Demand Water System and Water Pump

- › 10 Gallon LP Gas/Electric Water Heater with Electronic Ignition
- › Winterization Valving System
- › Water Heater By-Pass Valving
- › China Toilet w/Sprayer (N/A 36PFT)
- › Tecma Silence Plus China Toilet (36PFT)
- › Holding Tank Rinsing System
- › Insulated Systems Compartment with Easy Access to Hook-Up

- › Hot/Cold Shower in Wet Bay with Shut-Off
- › Gravity and Pressurized Water Fill
- › Sewer Hose Assembly with Sewer Hose Storage
- › One-Piece Round Shower

- › RV Sani-Con System – Holding tank flush System

STANDARD ☐OPTIONS ☒

INTERIOR

- › Hardwood Cabinetry: Italian Sienna
- › Hardwood Raised Panel Doors on Fridge
- › Heavy Duty Ball Bearing Drawer Guides
- › Polished Corian® Countertops Throughout with Decorative Tile with Backsplash in Kitchen and Bath

- › Stainless Steel Kitchen Sink
- › Pull-Out Countertop Extension with Drawer and Corian Top (Only 40PDQ)
- › Flip-Up Countertop Extension (N/A 36PFT)
- › Solid Surface Bath Counter w/ Integrated Bowl
- › Porcelain Tile in Kitchen, Living Room and Bath – 12 X 24 with Accent
- › Carpeting with Pad in Bedroom

- › Soft Touch Padded Vinyl Ceiling
- › Satin Nickel Cabinetry Hardware/Accessories
- › Oversized Rear Wardrobe Closet
- › Bedroom Wardrobe Slide-Out Foot of Bed
- › Blackout Day/Night Pleated Shades in Living Area and in Bedroom
- › Mini Blinds in Kitchen and Bath
- › Soil Repellant on Fabrics

- › Décors: Platinum; Neo Cinnabar; Mocha Splendor
- › Manual Solar Screens with Blackouts Throughout
- › Polished Porcelain Tile
- › Pull-Out Trash Can
- › Wood Choice: Glazed Italian Sienna

FURNITURE

- › Queen Bed with Overhead Cabinet and Nightstands
- › Arched Back Wood Booth Dinette w/ Side Sliding Dinette Table Top with Storage
- › Seat Belts in Booth Dinette in Living Area Slide-Out (N/A 40PDQ)

- › Roadside; Ultra Leather Jack Knife Sofa
- › Curbside; Ultra Leather Jack Knife Sofa (N/A 36PFT)
- › Queen Premier Select Comfort Air Mattress
- › King Bed
- › King Premier Select Comfort Air Mattress
- › Roadside; Ultra Leather Hide-A-Bed with Air

- Mattress**
- › Roadside; Ultra Leather Extendable L-Sofa (N/A 36 PFT)
 - › Curbside; Ultra Leather Hide-A-Bed with Air Mattress (Only 40PDQ)
 - › Curbside; Ultra Leather Booth Dinette Ensemble with Hide-A-Bed (N/A 36PFT)
 - › Curbside; Ultra Leather Hide-A-Bed with Air

- Mattress, Removable Arms (Only 40DFT)**
- › Curbside; Ultra Leather Booth Dinette Ensemble (Only 36PFT)
 - › Curbside; Ultra Leather U-Dinette with Sleeping (Only 36PFT)
 - › Free-Standing Dinette w/ Work Station
 - › Free-Standing Dinette w/ Two Free-Standing Chairs and Two Folding Chairs

ELECTRICAL SYSTEMS & LIGHTS

- › 50 AMP 120V Distribution Panel and Power Cord
- › Power Control System
- › Onan® 8.0 kW Quiet Diesel Generator
- › 2000-Watt Inverter with Two UL16HC House Batteries

- › Two 12V Heavy Duty Chassis Batteries
- › Battery Disconnect Switch at Front Door
- › Battery Boost Switch in Cockpit
- › 12V & 120V Outlet in Cockpit Area
- › Porch Light
- › Exterior Power Entry Step with Light
- › Interior Step Well Entry Step Lights
- › 120V Outlet in Outside Storage Compartment

- › Roadside; Exterior Hook-Ups for DSS Dish, Phone and Cable with Hatch Cover
- › Under Hood Utility Light
- › Convenience Center in Hallway
- › Lights in Outside Storage Compartments with Switch on Passenger Console
- › Pilot and Co-Pilot Map Lights
- › Decorative Living Room Wall Light

- › Auto Generator Start
- › Power Cord Reel
- › Storage Compartment Tank Monitor Gauge

PLUMBING & LP SYSTEMS

- › Single Lever Kitchen Faucet with Pull-Out Sprayer
- › Stainless Steel Under-Mounted Kitchen Sink
- › Central Water Filtration System with Curbside Access to Water Filter
- › Demand Water System and Water Pump

- › 10 Gallon LP Gas/Electric Water Heater with Electronic Ignition
- › Winterization Valving System
- › Water Heater By-Pass Valving
- › China Toilet w/Sprayer (N/A 36PFT)
- › Tecma Silence Plus China Toilet (36PFT)
- › Holding Tank Rinsing System
- › Insulated Systems Compartment with Easy Access to Hook-Up

- › Hot/Cold Shower in Wet Bay with Shut-Off
- › Gravity and Pressurized Water Fill
- › Sewer Hose Assembly with Sewer Hose Storage
- › One-Piece Round Shower

- › RV Sani-Con System – Holding tank flush System

STANDARD ☐OPTIONS ☒

HEATING, VENTS & AC

- › Dual 15M BTU Air Conditioner with Heat Pumps and Ducted Air
 - › Electronic Ignition Furnace
 - › Kitchen Powered 12V Attic Fan with Wall Control of Automatic Dome and Fan Power
- › Bath Powered 12V Attic Fan with Wall Control of Automatic Dome and Fan Power
 - › 12V Heater in Wet Bay
- › Three 15M BTU Air Conditioner with Heat Pumps and Ducted Air (N/A: 36PFT) (Requires 10kW Generator)
 - › 12V Heater in Wet Bay
 - › Electric Fireplace with Remote (36PFT Only)
 - › Ceiling Fan in Bedroom

WINDOWS, DOORS & AWNINGS

- › Radius Flush Mount Dual Pane Safety Glass Dark Tinted Slider Windows
 - › Front Entry Door with Larger Walk-Thru, Clear Glass, Removable Screen and Anti-Skid Steps
 - › Exterior Entry Door Grab Handle
- › 12V Electric Front Door Awning
 - › 12V Electric Patio Awning
 - › Window Awnings on all Slide-Out House Windows, Except Kitchen, Private Bath and Slide-Out Windows Under Patio Awning
 - › Topper Slide-Out Awnings Living Area and Bedroom
 - › Tinted Skylight in Bathroom with Protecta
- › Glaze
 - › Roof Mount Awning Units with Slide-Outs on Curbside at Patio Location

SAFETY

- › Fire Extinguisher
 - › Deadbolt Lock on Entrance Door
 - › 120V GFI Protected Circuit Kitchen, Bath and Exterior
 - › LP Gas Detector
 - › Smoke Detector
- › Carbon Monoxide Detector
 - › Driver and Passenger Three-Point Seat Belts
 - › Third Brake Safety Light
 - › Egress Window

HEATING, VENTS & AC

- › Dual 15M BTU Air Conditioner with Heat Pumps and Ducted Air
- › Electronic Ignition Furnace
- › Kitchen Powered 12V Attic Fan with Wall Control of Automatic Dome and Fan Power

- › Bath Powered 12V Attic Fan with Wall Control of Automatic Dome and Fan Power
- › 12V Heater in Wet Bay

- › Three 15M BTU Air Conditioner with Heat Pumps and Ducted Air (N/A: 36PFT) (Requires 10kW Generator)
- › 12V Heater in Wet Bay
- › Electric Fireplace with Remote (36PFT Only)
- › Ceiling Fan in Bedroom

WINDOWS, DOORS & AWNINGS

- › Radius Flush Mount Dual Pane Safety Glass Dark Tinted Slider Windows
- › Front Entry Door with Larger Walk-Thru, Clear Glass, Removable Screen and Anti-Skid Steps
- › Exterior Entry Door Grab Handle

- › 12V Electric Front Door Awning
- › 12V Electric Patio Awning
- › Window Awnings on all Slide-Out House Windows, Except Kitchen, Private Bath and Slide-Out Windows Under Patio Awning
- › Topper Slide-Out Awnings Living Area and Bedroom
- › Tinted Skylight in Bathroom with Protecta

- Glaze
- › Roof Mount Awning Units with Slide-Outs on Curbside at Patio Location

SAFETY

- › Fire Extinguisher
- › Deadbolt Lock on Entrance Door
- › 120V GFI Protected Circuit Kitchen, Bath and Exterior
- › LP Gas Detector
- › Smoke Detector

- › Carbon Monoxide Detector
- › Driver and Passenger Three-Point Seat Belts
- › Third Brake Safety Light
- › Egress Window



NAVISTAR

REVOLUTIONIZING THE RV

Monaco® RV is driven by the same sense of possibilities that makes RV travelers ask, Where To Next?™ That's why we've embarked on a new journey with Navistar® as our partner. With access to Navistar's 175 years of transportation expertise, we've got big

ideas on the drawing board and innovative new RVs rolling off the line. Monaco RV has shaped itself into a leader in the RV industry. In the spirit of pursuing what's next, we'll never stop looking for the next great innovation.



NAVISTAR

REVOLUTIONIZING THE RV

Monaco® RV is driven by the same sense of possibilities that makes RV travelers ask, Where To Next?™ That's why we've embarked on a new journey with Navistar® as our partner. With access to Navistar's 175 years of transportation expertise, we've got big

ideas on the drawing board and innovative new RVs rolling off the line. Monaco RV has shaped itself into a leader in the RV industry. In the spirit of pursuing what's next, we'll never stop looking for the next great innovation.