

# REYO

2013



## CLICK TO NAVIGATE

[Overview](#)

[Lounge](#)

[Bedroom | Bath](#)

[Exterior](#)

[Chassis](#)

[Interior Décor](#)

[Specifications](#)

[Warranty](#)

[Features](#)

[Kitchen](#)

[Cab](#)

[SuperStructure](#)

[Floorplans](#)

[Graphics & Paint](#)

[WIT Club](#)



# REYO

2013



## CLICK TO NAVIGATE

[Overview](#)

[Lounge](#)

[Bedroom | Bath](#)

[Exterior](#)

[Chassis](#)

[Interior Décor](#)

[Specifications](#)

[Warranty](#)

[Features](#)

[Kitchen](#)

[Cab](#)

[SuperStructure](#)

[Floorplans](#)

[Graphics & Paint](#)

[WIT Club](#)





ON THE COVER: 25T Black Walnut Full-Body Paint

25T Incline with Sunset Cherry Cabinetry

## IT LOOKS UNIQUE BECAUSE IT IS UNIQUE

You may have noticed a new breed of Class A coaches populating campsites. Stylish, more nimble, yet loaded with all the features of a true Class A motor home. Built on the versatile Mercedes-Benz® Sprinter chassis, the Itasca Reyo™ is leading a new revolution in RVing with incredibly impressive fuel efficiency. The Reyo keeps getting better, now offering multiple LCD TVs, a sliding retractable screen door and LED ceiling lights that can reduce energy consumption by up to 70 percent. Choose from innovations such as the Flex Bed system on the 25T, the StudioLoft™ on 25R and 25T and three available floorplans, all built to the quality standards that only our SuperStructure® construction process makes possible. Take a fresh look at Class A luxury in a 2013 Itasca Reyo.

### Why Reyo?

- Mercedes-Benz Sprinter chassis
- LED lighting
- LCD TVs
- Ultraleather™ furniture
- Swivel cab seats
- Flex Bed (25T)
- Fuel-efficient and easy to maneuver
- Class A comfort
- Threshold™ Quiet RV Door
- RV Radio®/rearview monitor
- MCD American Duo® solar/blackout roller shades



**RECOGNIZED QUALITY** The RV Dealers Association annually bestows the Quality Circle Award based on dealer ratings to manufacturers that provide exceptional products, service and support. Only one manufacturer has received this award for sixteen consecutive years: Winnebago Industries®, proud manufacturer of the Itasca Reyo.





ON THE COVER: 25T Black Walnut Full-Body Paint

25T Incline with Sunset Cherry Cabinetry

## IT LOOKS UNIQUE BECAUSE IT IS UNIQUE

You may have noticed a new breed of Class A coaches populating campsites. Stylish, more nimble, yet loaded with all the features of a true Class A motor home. Built on the versatile Mercedes-Benz® Sprinter chassis, the Itasca Reyo™ is leading a new revolution in RVing with incredibly impressive fuel efficiency. The Reyo keeps getting better, now offering multiple LCD TVs, a sliding retractable screen door and LED ceiling lights that can reduce energy consumption by up to 70 percent. Choose from innovations such as the Flex Bed system on the 25T, the StudioLoft™ on 25R and 25T and three available floorplans, all built to the quality standards that only our SuperStructure® construction process makes possible. Take a fresh look at Class A luxury in a 2013 Itasca Reyo.

### Why Reyo?

- Mercedes-Benz Sprinter chassis
- LED lighting
- LCD TVs
- Ultraleather™ furniture
- Swivel cab seats
- Flex Bed (25T)
- Fuel-efficient and easy to maneuver
- Class A comfort
- Threshold™ Quiet RV Door
- RV Radio®/rearview monitor
- MCD American Duo® solar/blackout roller shades



**RECOGNIZED QUALITY** The RV Dealers Association annually bestows the Quality Circle Award based on dealer ratings to manufacturers that provide exceptional products, service and support. Only one manufacturer has received this award for sixteen consecutive years: Winnebago Industries®, proud manufacturer of the Itasca Reyo.



### BEST IN CLASS

See how Winnebago Industries takes motor home design and function to the next level, and why we've earned the right to be called the Most Recognized Name in Motor Homes.®



Click on this icon throughout the brochure to link to more information on the web.



The touch screen **RV Radio** includes a CD player, MP3 input and the monitor for the rearview camera.



Accurately monitor tank levels and other key systems on the **OnePlace® Systems Center**.



Stretch out or enjoy dinner at the **Sofa** with movable pedestal table.



Drawers open wide on **Full-Extension Drawer Slides** for easy access to abundant storage.



You'll never have to track the dirt inside again, thanks to the available **Exterior Wash Station**. Easy access and a lighted pump switch enable you to clean your gear, your kids, even your dog before re-entering the coach.



These available lightweight scratch-resistant **Acrylic Windows** feature built-in screens and shades that pull up from the window base so you can enjoy a cool breeze while maintaining privacy (NA 25R w/optional dinette).



The **Comfort Sofa Sleeper** in the 25Q quickly and easily converts from a sofa into a bed with a self-inflating mattress that features adjustable pressure settings for maximum comfort.



### BEST IN CLASS

See how Winnebago Industries takes motor home design and function to the next level, and why we've earned the right to be called the Most Recognized Name in Motor Homes.®



Click on this icon throughout the brochure to link to more information on the web.



The touch screen **RV Radio** includes a CD player, MP3 input and the monitor for the rearview camera.



Accurately monitor tank levels and other key systems on the **OnePlace® Systems Center**.



Stretch out or enjoy dinner at the **Sofa** with movable pedestal table.



Drawers open wide on **Full-Extension Drawer Slides** for easy access to abundant storage.



You'll never have to track the dirt inside again, thanks to the available **Exterior Wash Station**. Easy access and a lighted pump switch enable you to clean your gear, your kids, even your dog before re-entering the coach.



These available lightweight scratch-resistant **Acrylic Windows** feature built-in screens and shades that pull up from the window base so you can enjoy a cool breeze while maintaining privacy (NA 25R w/optional dinette).



The **Comfort Sofa Sleeper** in the 25Q quickly and easily converts from a sofa into a bed with a self-inflating mattress that features adjustable pressure settings for maximum comfort.





25T Incline with Sunset Cherry Cabinetry

Eat dinner, play cards or just enjoy some pleasant conversation around the movable pedestal table that can be placed in front of the sofa or the cab seats that raise and rotate to become part of the living area. Both the sofa and cab seats offer an excellent view of the LCD TV, which is connected to the stereo system with CD/DVD player. LED lighting is used throughout the coach, which can reduce energy consumption by up to 70%.



Swivel Cab Seats



LCD TV on Sliding Bracket







25T Incline with Sunset Cherry Cabinetry

Eat dinner, play cards or just enjoy some pleasant conversation around the movable pedestal table that can be placed in front of the sofa or the cab seats that raise and rotate to become part of the living area. Both the sofa and cab seats offer an excellent view of the LCD TV, which is connected to the stereo system with CD/DVD player. LED lighting is used throughout the coach, which can reduce energy consumption by up to 70%.



Swivel Cab Seats



LCD TV on Sliding Bracket





There's more than meets the eye in the kitchen where the faucet folds down beneath a glass cover to increase your workspace and the refrigerator features a removable freezer compartment for added cold storage flexibility. You will love the dual-function microwave/convection oven that actually cooks and browns like a conventional oven.



25T Kitchen



Refrigerator with Removable Freezer



Sink/Stove with Covers



There's more than meets the eye in the kitchen where the faucet folds down beneath a glass cover to increase your workspace and the refrigerator features a removable freezer compartment for added cold storage flexibility. You will love the dual-function microwave/convection oven that actually cooks and browns like a conventional oven.



25T Kitchen



Refrigerator with Removable Freezer



Sink/Stove with Covers





25T Flex Bed as Twin Beds



25T Flex Bed as Queen Bed

A slideout offers ample room for a queen bed in the 25R and 25Q. The 25T gets creative with the Flex Bed System that allows you to quickly convert its two twin beds into a giant queen bed. Add the StudioLoft drop-down cab bed to the 25T and 25R and you have an entire second bedroom available in an instant.



25T Bathroom



25T Shower





25T Flex Bed as Twin Beds



25T Flex Bed as Queen Bed

A slideout offers ample room for a queen bed in the 25R and 25Q. The 25T gets creative with the Flex Bed System that allows you to quickly convert its two twin beds into a giant queen bed. Add the StudioLoft drop-down cab bed to the 25T and 25R and you have an entire second bedroom available in an instant.



25T Bathroom



25T Shower





Dash

The Sprinter chassis provides the ultimate Class A driving experience with superior ride and handling, a robust engine and power everything. Ultraleather cab seats enhance the driving experience while the RV Radio or available Infotainment Center/GPS incorporates the rearview monitor and available sideview cameras for improved navigation on and off the campsite.

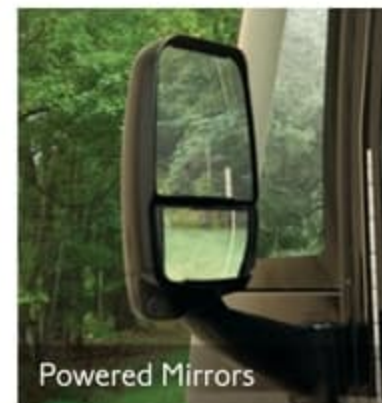

Powered Mirrors



Available Infotainment Center/GPS





Dash

The Sprinter chassis provides the ultimate Class A driving experience with superior ride and handling, a robust engine and power everything. Ultraleather cab seats enhance the driving experience while the RV Radio or available Infotainment Center/GPS incorporates the rearview monitor and available sideview cameras for improved navigation on and off the campsite.

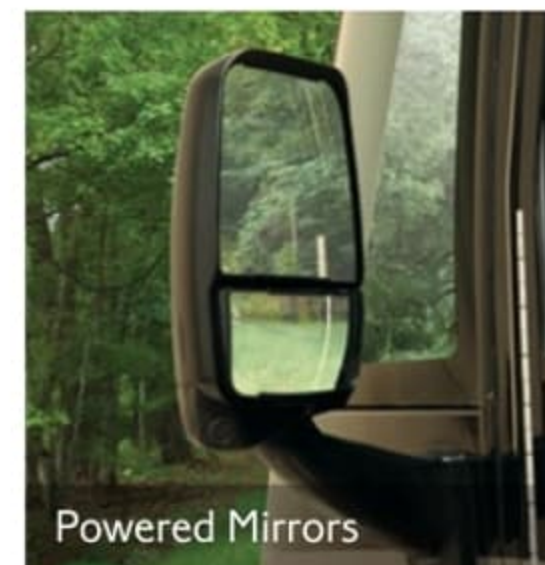

Powered Mirrors



Available Infotainment Center/GPS





Driver Side Storage



Electric Awning

We re-thought everything when creating the Reyo, including the entrance door. After studying airplane door design for inspiration, we crafted the exclusive Threshold™ Quiet RV Door, which employs dual bulb seals that lock out wind and road noise. Then we added a retractable screen door that keeps the pests outside while you enjoy a cool breeze. And, for good measure, we made the electric patio awning standard so you always have a place to enjoy the great outdoors.



Threshold Quiet RV Door



Retractable Screen Door



Dual Bulb Door Seal





Driver Side Storage



Electric Awning

We re-thought everything when creating the Reyo, including the entrance door. After studying airplane door design for inspiration, we crafted the exclusive Threshold™ Quiet RV Door, which employs dual bulb seals that lock out wind and road noise. Then we added a retractable screen door that keeps the pests outside while you enjoy a cool breeze. And, for good measure, we made the electric patio awning standard so you always have a place to enjoy the great outdoors.



Threshold Quiet RV Door



Retractable Screen Door



Dual Bulb Door Seal



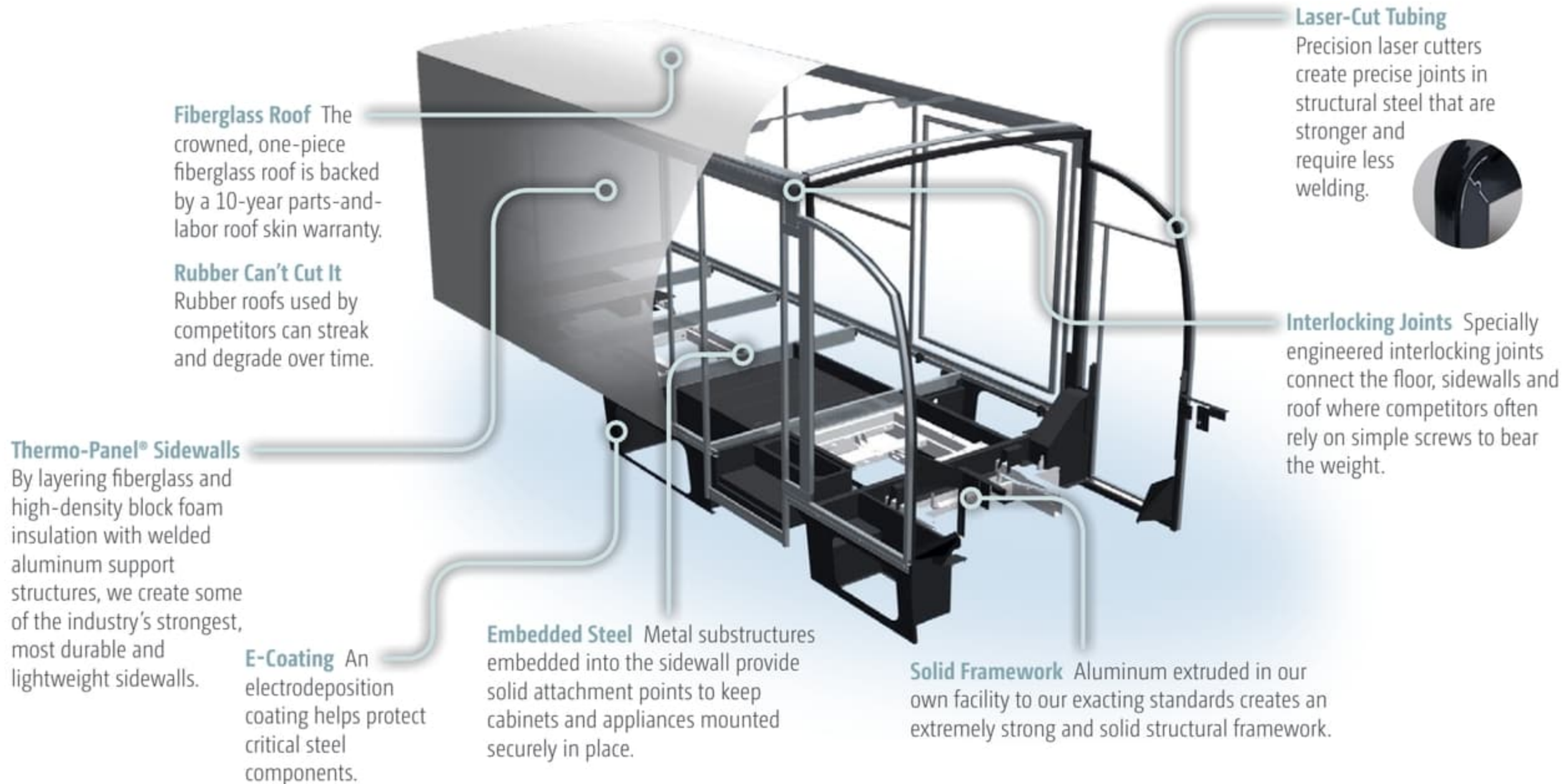

**Fiberglass Roof** The crowned, one-piece fiberglass roof is backed by a 10-year parts-and-labor roof skin warranty.

**Rubber Can't Cut It** Rubber roofs used by competitors can streak and degrade over time.

**Thermo-Panel® Sidewalls** By layering fiberglass and high-density block foam insulation with welded aluminum support structures, we create some of the industry's strongest, most durable and lightweight sidewalls.

**E-Coating** An electrodeposition coating helps protect critical steel components.

**Embedded Steel** Metal substructures embedded into the sidewall provide solid attachment points to keep cabinets and appliances mounted securely in place.

**Solid Framework** Aluminum extruded in our own facility to our exacting standards creates an extremely strong and solid structural framework.

**Laser-Cut Tubing** Precision laser cutters create precise joints in structural steel that are stronger and require less welding.



**Interlocking Joints** Specially engineered interlocking joints connect the floor, sidewalls and roof where competitors often rely on simple screws to bear the weight.

**SUPER  
STRUCTURE**

BUILT TO LAST

Every coach—from our smallest Class C to our largest diesel pusher model—is built to Winnebago Industries'® legendary SuperStructure construction standards. It's a process developed and refined over more than 50 years of building some of the strongest, most durable coaches in the industry.



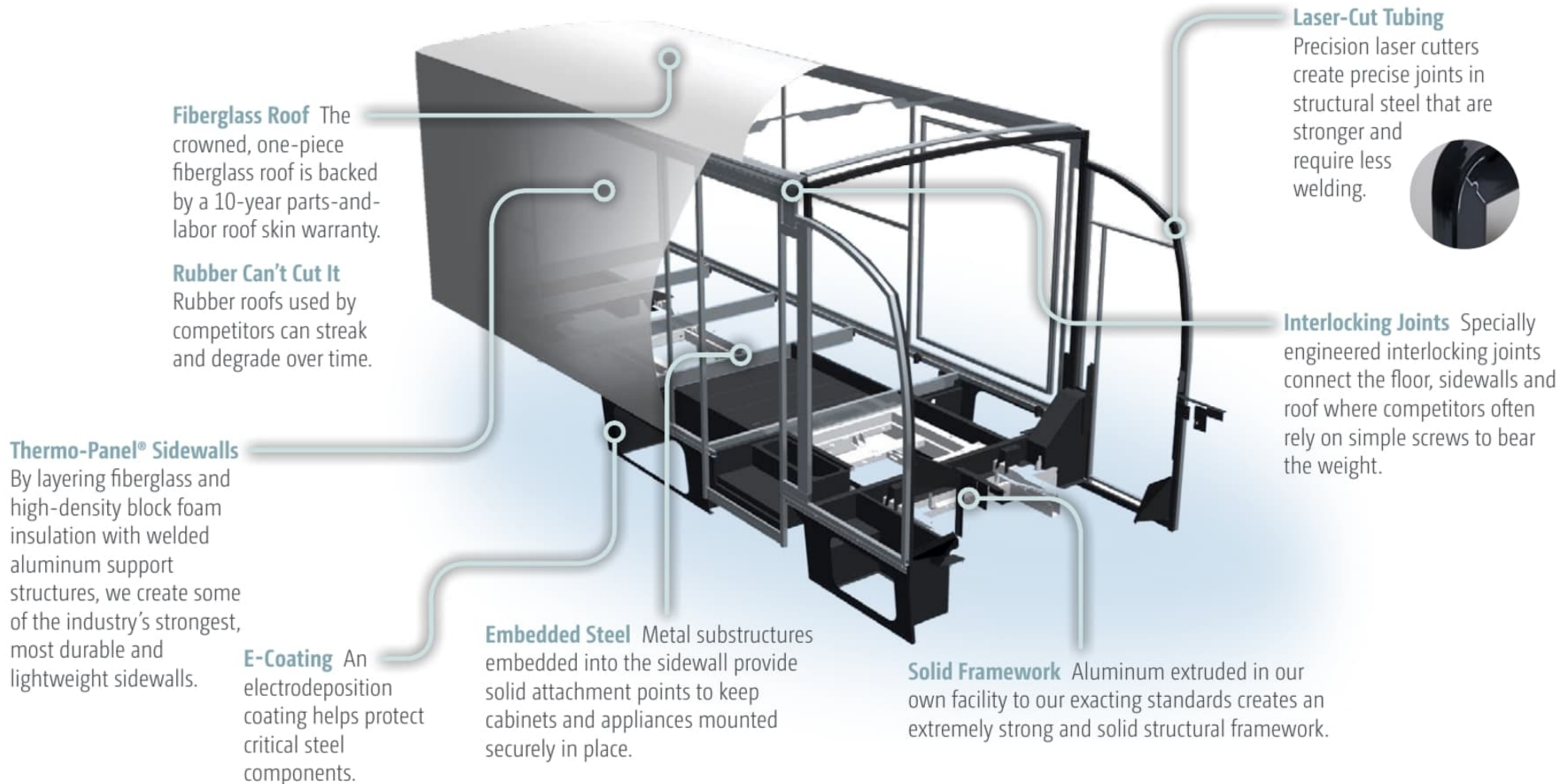

**Fiberglass Roof** The crowned, one-piece fiberglass roof is backed by a 10-year parts-and-labor roof skin warranty.

**Rubber Can't Cut It** Rubber roofs used by competitors can streak and degrade over time.

**Thermo-Panel® Sidewalls** By layering fiberglass and high-density block foam insulation with welded aluminum support structures, we create some of the industry's strongest, most durable and lightweight sidewalls.

**E-Coating** An electrodeposition coating helps protect critical steel components.

**Embedded Steel** Metal substructures embedded into the sidewall provide solid attachment points to keep cabinets and appliances mounted securely in place.

**Solid Framework** Aluminum extruded in our own facility to our exacting standards creates an extremely strong and solid structural framework.

**Laser-Cut Tubing** Precision laser cutters create precise joints in structural steel that are stronger and require less welding.



**Interlocking Joints** Specially engineered interlocking joints connect the floor, sidewalls and roof where competitors often rely on simple screws to bear the weight.

**SUPER  
STRUCTURE**

BUILT TO LAST

Every coach—from our smallest Class C to our largest diesel pusher model—is built to Winnebago Industries'® legendary SuperStructure construction standards. It's a process developed and refined over more than 50 years of building some of the strongest, most durable coaches in the industry.



**TESTING** Before rolling out of our factories, every coach undergoes an extensive 113-point inspection. Each coach also passes a high-pressure water test that simulates rain at a rate of 50-inches per hour to check for leaks. During the design process, computer simulations, our physical testing center and rigorous test track ensure each model is built to last.



**DETAILS** At Winnebago Industries, we treat the features you can't see with the same care as the ones you can. Look in the access panels of some of our competitors' coaches and you'll see loose insulation and wires haphazardly strewn about. Winnebago Industries maintains a clean fit and finish throughout so your coach will last for the long haul.



**BUILT IN-HOUSE** We extrude our own aluminum. We rotocast our own plastic components. In fact, we manufacture most of our own parts so they are designed to fit the space, rather than fitting the space to an awkward off-the-shelf component size.



**SUPER  
STRUCTURE**  
BUILT TO LAST

Visit [BetterBuiltRVs.com](http://BetterBuiltRVs.com) to gain real insight into what goes into a Winnebago Industries motor home.

**TAKE A TOUR** We're proud of our processes, state-of-the-art facilities and the people who make Winnebago Industries number one. We invite you to visit our complex in Forest City, Iowa, for a first-hand look at the dedication and technology behind every motor home we build.





**TESTING**

Before rolling out of our factories, every coach undergoes an extensive 113-point inspection. Each coach also passes a high-pressure water test that simulates rain at a rate of 50-inches per hour to check for leaks. During the design process, computer simulations, our physical testing center and rigorous test track ensure each model is built to last.



**DETAILS**

At Winnebago Industries, we treat the features you can't see with the same care as the ones you can. Look in the access panels of some of our competitors' coaches and you'll see loose insulation and wires haphazardly strewn about. Winnebago Industries maintains a clean fit and finish throughout so your coach will last for the long haul.



**BUILT IN-HOUSE**

We extrude our own aluminum. We rotocast our own plastic components. In fact, we manufacture most of our own parts so they are designed to fit the space, rather than fitting the space to an awkward off-the-shelf component size.



**SUPER  
STRUCTURE**  
BUILT TO LAST

Visit [BetterBuiltRVs.com](http://BetterBuiltRVs.com) to gain real insight into what goes into a Winnebago Industries motor home.

**TAKE A TOUR**

We're proud of our processes, state-of-the-art facilities and the people who make Winnebago Industries number one. We invite you to visit our complex in Forest City, Iowa, for a first-hand look at the dedication and technology behind every motor home we build.





## The Foundation of Fun

The Reyo's revolutionary design starts with the versatile Mercedes-Benz Sprinter F50 chassis. A powerful Mercedes-Benz turbo-diesel engine makes the Reyo a coach that is both fun to drive and a pleasure to call home. Adaptive

ESP® electronic stability control delivers more responsive control with ABS, traction control (ASR) and load adaptive control (LAC) that calculates the vehicle's mass and center of gravity to ensure optimum stability.



Mercedes-Benz® Sprinter F50 Chassis:

- Mercedes-Benz 3.0L Turbo-Diesel Engine
- 5-Speed Automatic Transmission
- 11,030-lb. GVWR
- Adaptive ESP Technology
- 180-amp. Alternator
- 5,000-lb.<sup>5</sup> Hitch
- Available Stylized Aluminum Wheels
- Most fuel-efficient Class A motor home with unparalleled estimated fuel economy of 16+ miles per gallon\*

\*Fuel efficiency will vary with driving conditions and individual driving practices.



## The Foundation of Fun

The Reyo's revolutionary design starts with the versatile Mercedes-Benz Sprinter F50 chassis. A powerful Mercedes-Benz turbo-diesel engine makes the Reyo a coach that is both fun to drive and a pleasure to call home. Adaptive

ESP® electronic stability control delivers more responsive control with ABS, traction control (ASR) and load adaptive control (LAC) that calculates the vehicle's mass and center of gravity to ensure optimum stability.



Mercedes-Benz® Sprinter F50 Chassis:

- Mercedes-Benz 3.0L Turbo-Diesel Engine
- 5-Speed Automatic Transmission
- 11,030-lb. GVWR
- Adaptive ESP Technology
- 180-amp. Alternator
- 5,000-lb.<sup>5</sup> Hitch
- Available Stylized Aluminum Wheels
- Most fuel-efficient Class A motor home with unparalleled estimated fuel economy of 16+ miles per gallon\*

\*Fuel efficiency will vary with driving conditions and individual driving practices.



Dimensions shown are for sleeping space only and may vary due to styling differences. Dashed lines denote overhead storage areas. Floorplans and specifications are also available online at [Goltasca.com](http://Goltasca.com).

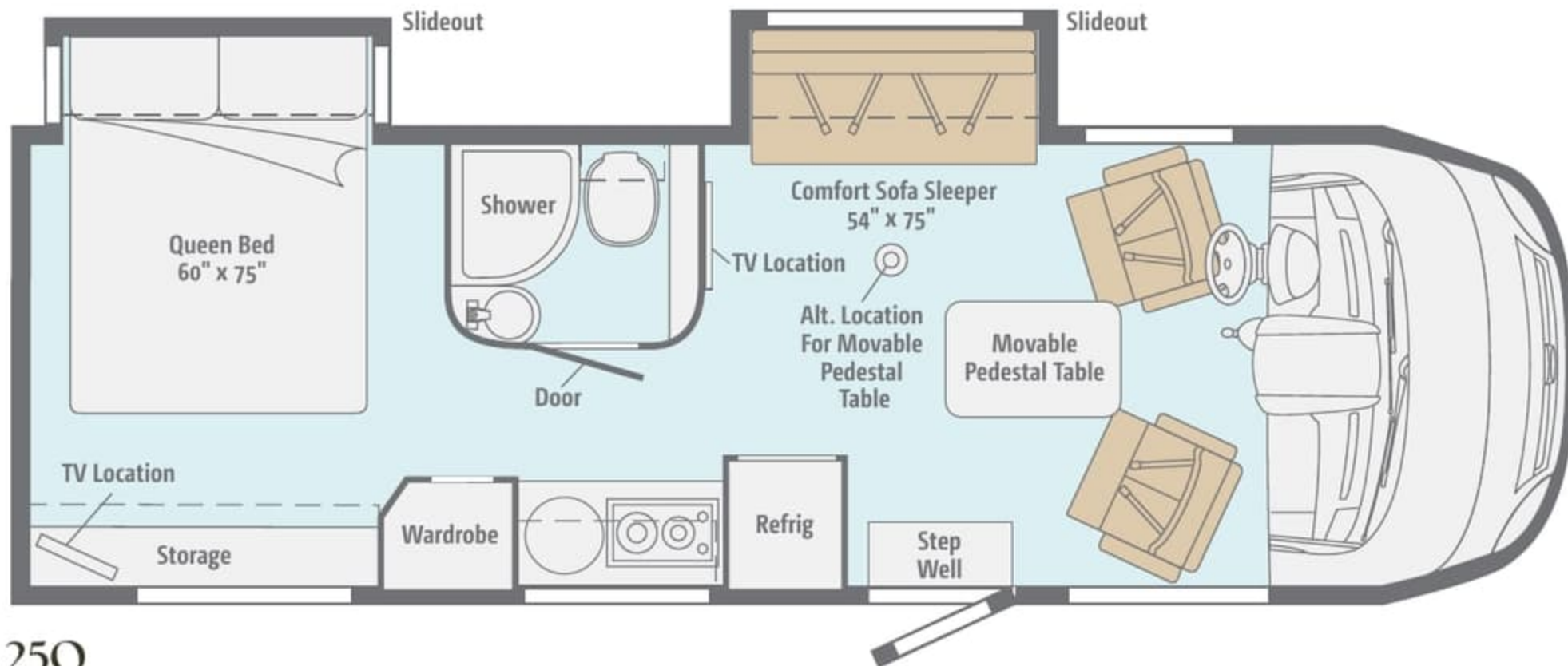

25Q

Slideouts in the lounge and bedroom make way for a walk-around queen bed, a wardrobe and the Comfort Sofa Sleeper.



Dimensions shown are for sleeping space only and may vary due to styling differences. Dashed lines denote overhead storage areas. Floorplans and specifications are also available online at [Goltasca.com](http://Goltasca.com).

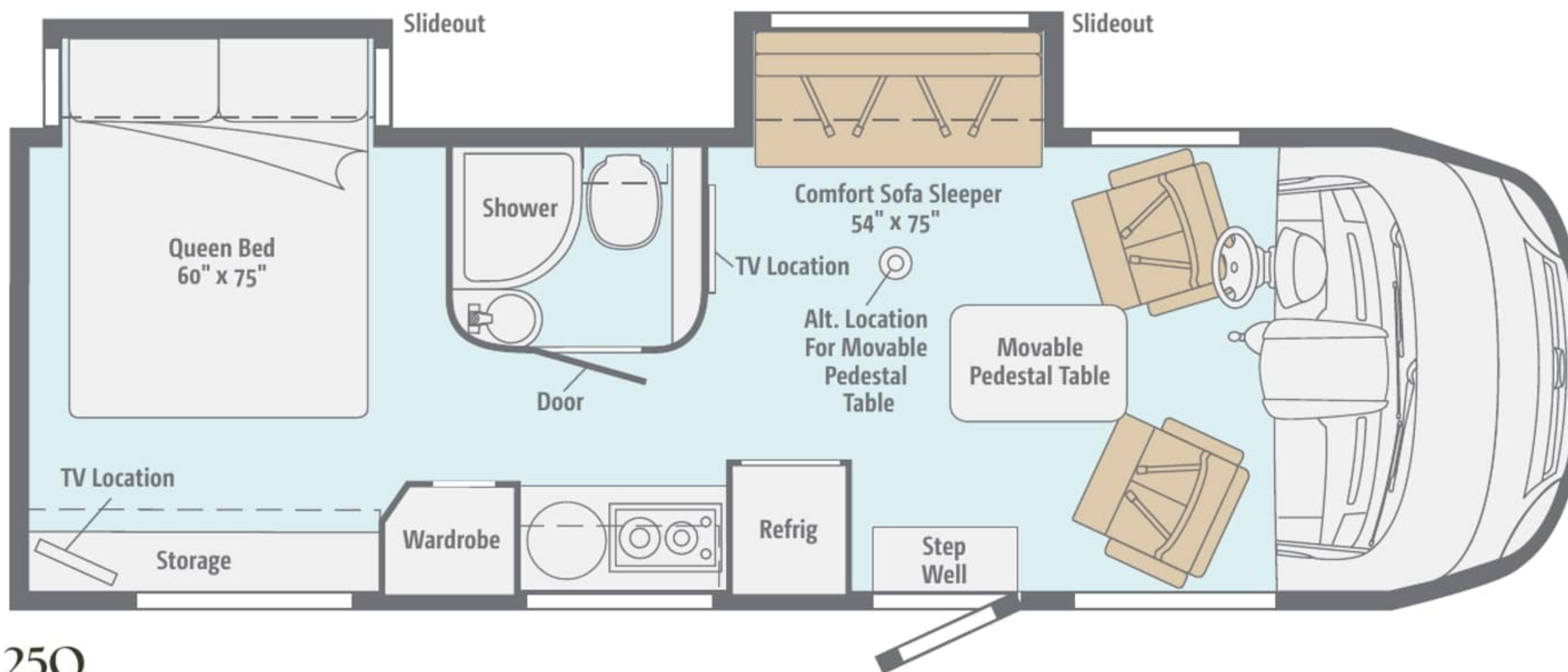

25Q

Slideouts in the lounge and bedroom make way for a walk-around queen bed, a wardrobe and the Comfort Sofa Sleeper.



Dimensions shown are for sleeping space only and may vary due to styling differences. Dashed lines denote overhead storage areas. Floorplans and specifications are also available online at [Goltasca.com](http://Goltasca.com).

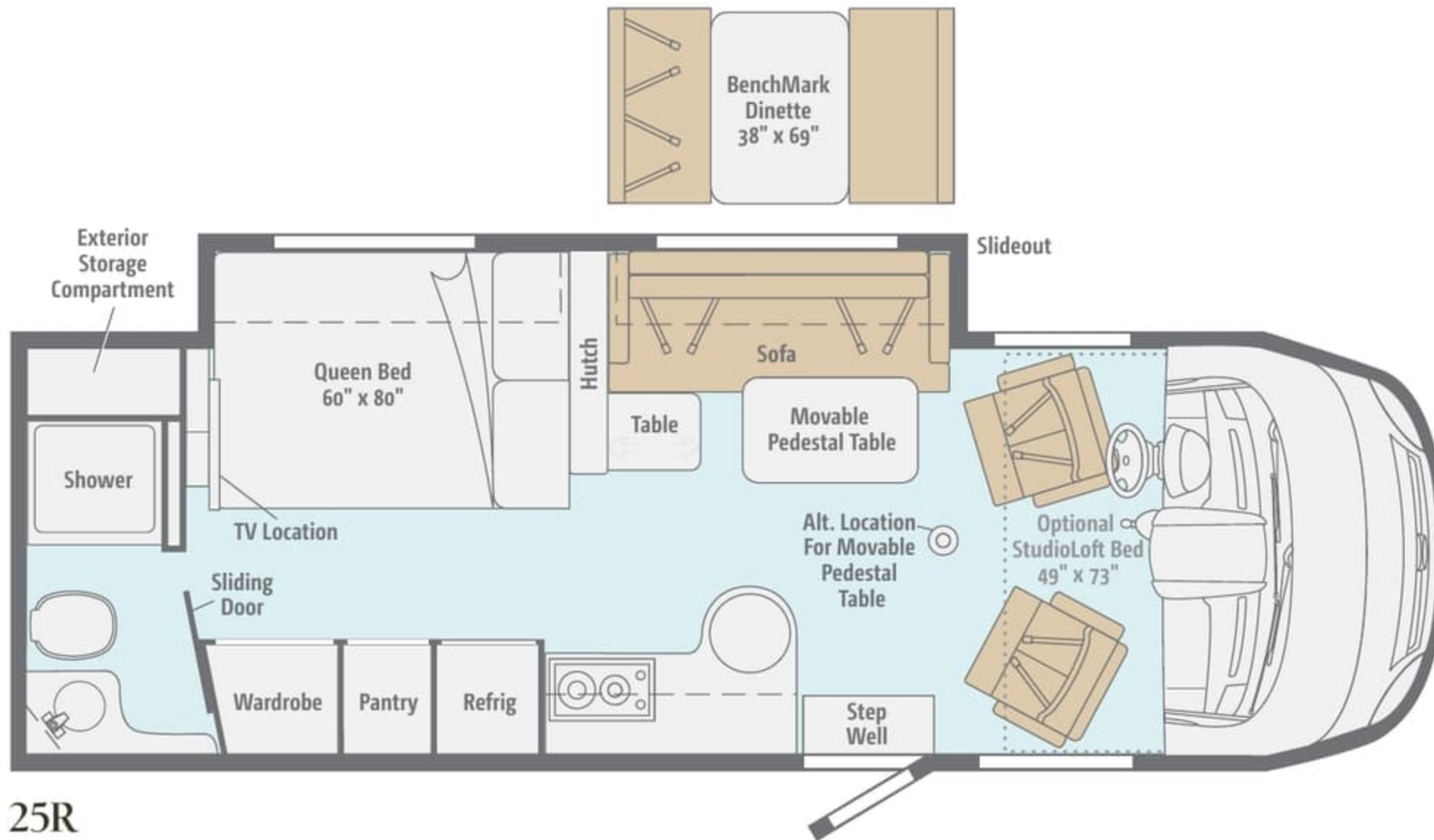

**25R**

The 25R makes the most of the available space with a full-wall slideout containing a queen bed and your choice of a sofa or the BenchMark<sup>®</sup> dinette.



Dimensions shown are for sleeping space only and may vary due to styling differences. Dashed lines denote overhead storage areas. Floorplans and specifications are also available online at [Goltasca.com](http://Goltasca.com).

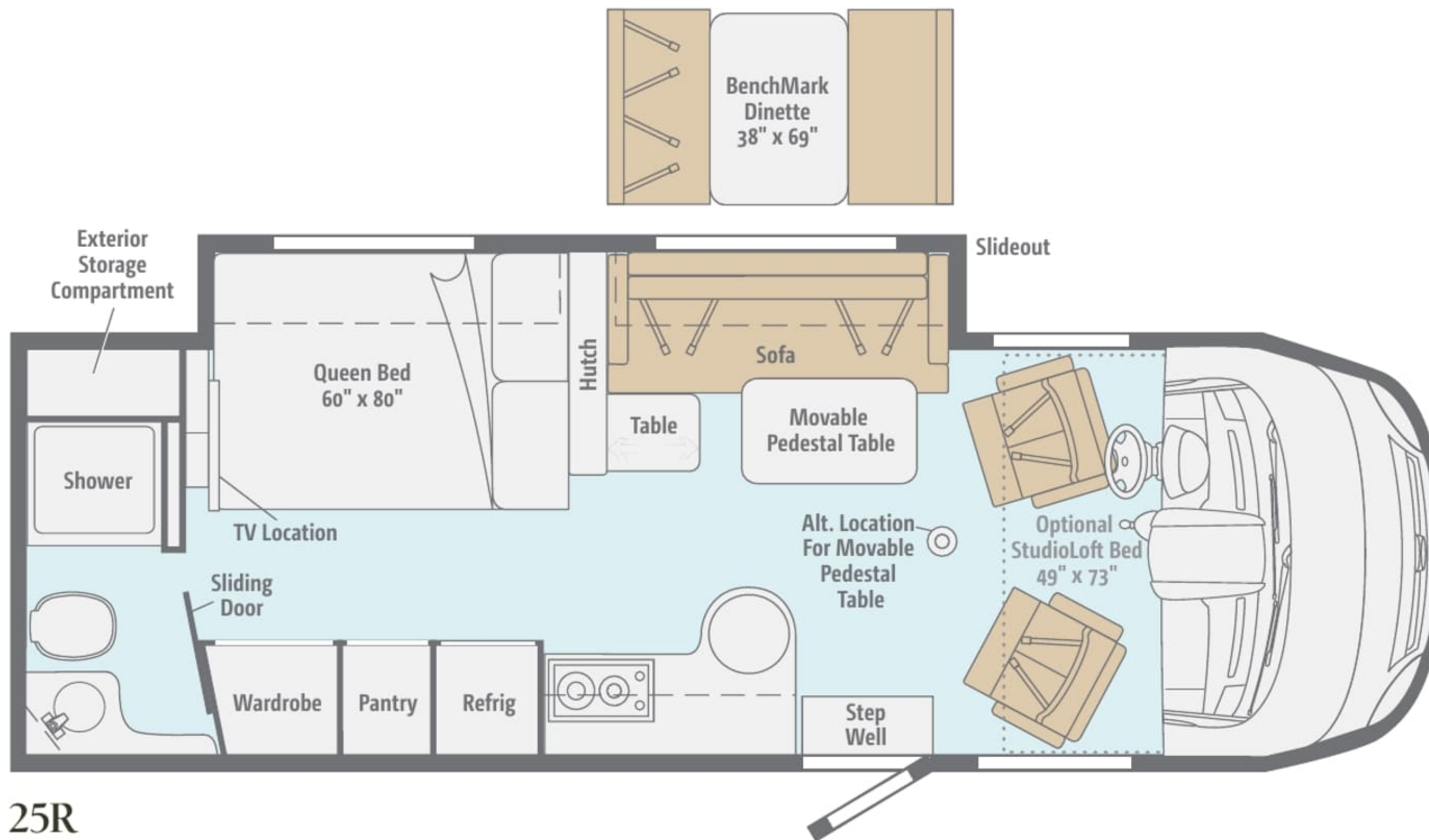

## 25R

The 25R makes the most of the available space with a full-wall slideout containing a queen bed and your choice of a sofa or the BenchMark® dinette.



Dimensions shown are for sleeping space only and may vary due to styling differences. Dashed lines denote overhead storage areas. Floorplans and specifications are also available online at [Goltasca.com](http://Goltasca.com).

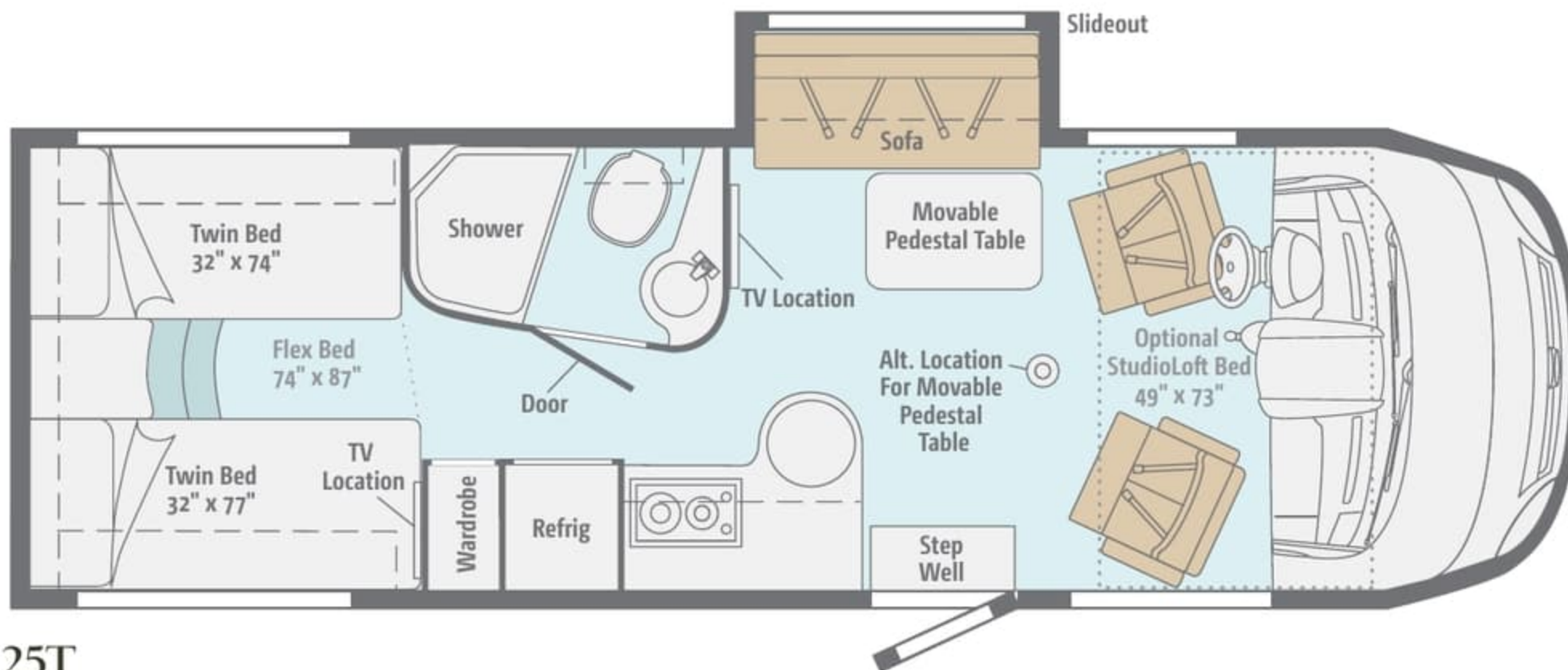

25T

Travel on your terms in this versatile floorplan that includes the Flex Bed System and the available drop-down StudioLoft bed.



Dimensions shown are for sleeping space only and may vary due to styling differences. Dashed lines denote overhead storage areas. Floorplans and specifications are also available online at [Goltasca.com](http://Goltasca.com).

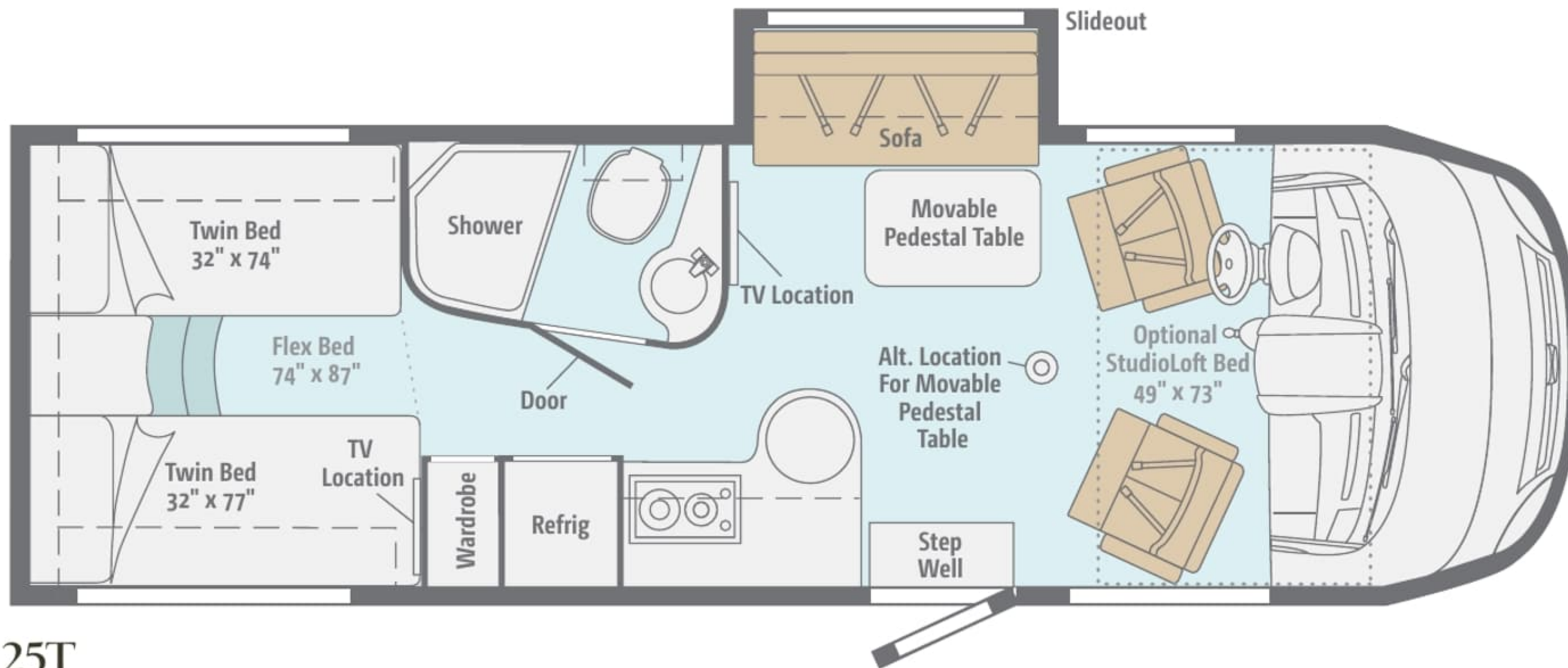

25T

Travel on your terms in this versatile floorplan that includes the Flex Bed System and the available drop-down StudioLoft bed.



Enjoy the soft feel and upscale luxury of Ultraleather™ in the fabric collection of your choice. Beautiful cabinetry in Café Cherry, Mocha Cherry or Sunset Cherry with stylish hardware provides plentiful storage.

**Smoke Screen**



Surfside Ultraleather



Accent



Bedsread



Vinyl



Carpet



Alpine Passage  
Wilsonart Laminate  
Countertop



Driftwood Wall Board



Café Cherry



Mocha Cherry



Sunset Cherry

Fabrics and carpets may change without notice or obligation.



Enjoy the soft feel and upscale luxury of Ultraleather™ in the fabric collection of your choice. Beautiful cabinetry in Café Cherry, Mocha Cherry or Sunset Cherry with stylish hardware provides plentiful storage.

**Smoke Screen**



Surfside Ultraleather



Accent



Bedspread



Vinyl



Carpet

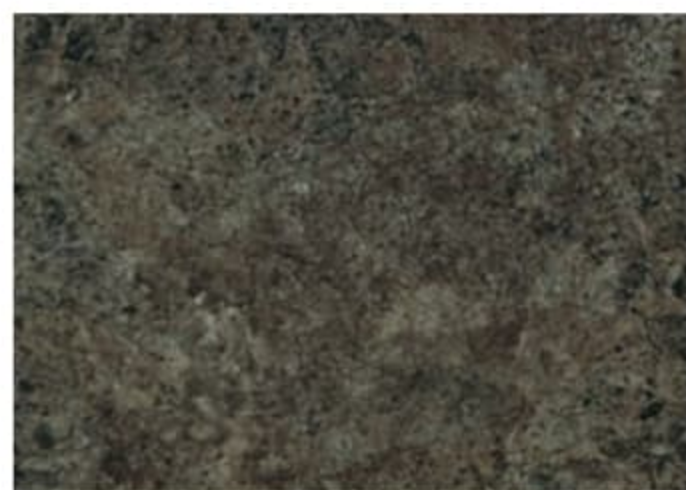

Alpine Passage  
Wilsonart Laminate  
Countertop



Driftwood Wall Board



Café Cherry



Mocha Cherry



Sunset Cherry

Fabrics and carpets may change without notice or obligation.



Enjoy the soft feel and upscale luxury of Ultraleather™ in the fabric collection of your choice. Beautiful cabinetry in Café Cherry, Mocha Cherry or Sunset Cherry with stylish hardware provides plentiful storage.

**Incline**



Manilla Ultraleather



Accent



Bedspread



Vinyl



Carpet

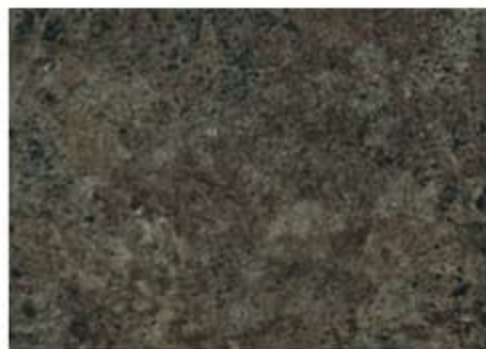

Alpine Passage  
Wilsonart Laminate  
Countertop



Waldorf Sierra Wall Board



Café Cherry



Mocha Cherry



Sunset Cherry

Fabrics and carpets may change without notice or obligation.



Enjoy the soft feel and upscale luxury of Ultraleather™ in the fabric collection of your choice. Beautiful cabinetry in Café Cherry, Mocha Cherry or Sunset Cherry with stylish hardware provides plentiful storage.

**Incline**

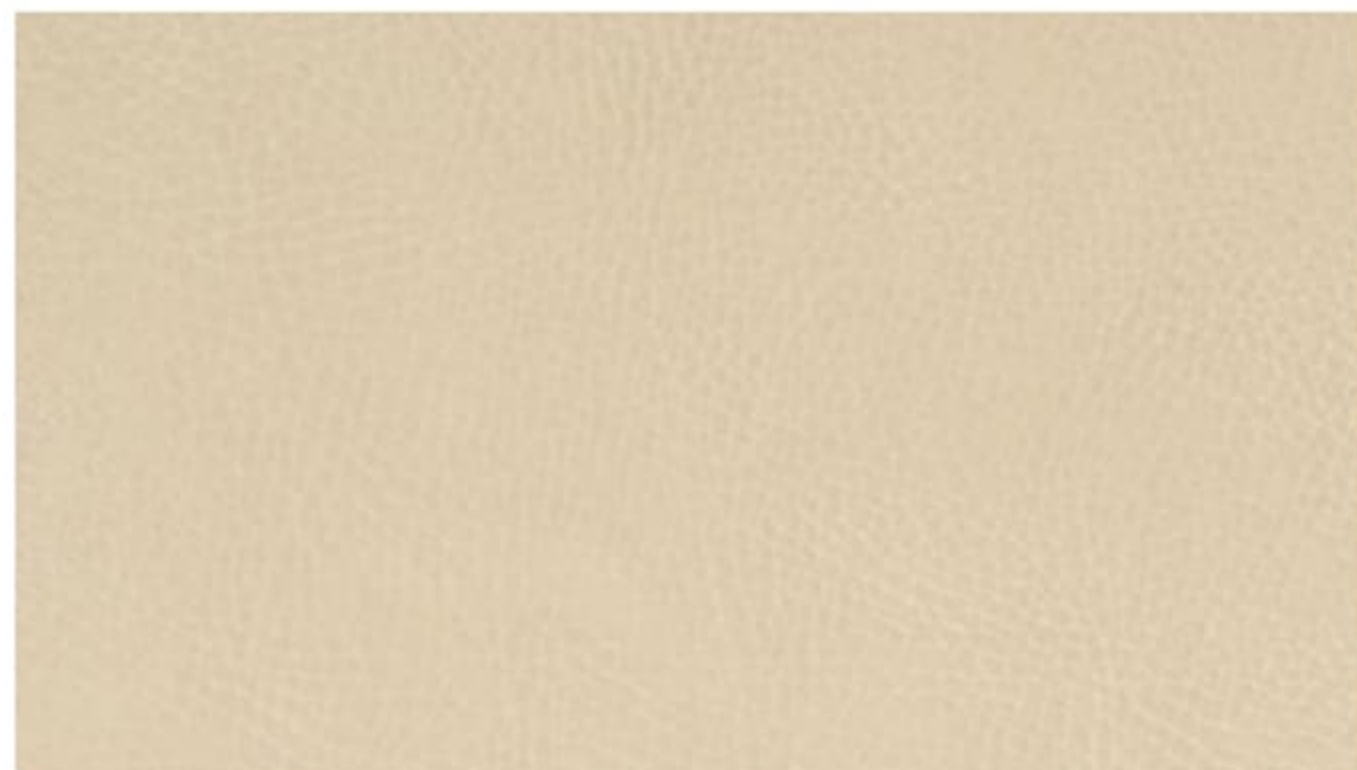

Manilla Ultraleather



Accent



Bedspread



Vinyl



Carpet



Alpine Passage  
Wilsonart Laminate  
Countertop



Waldorf Sierra Wall Board

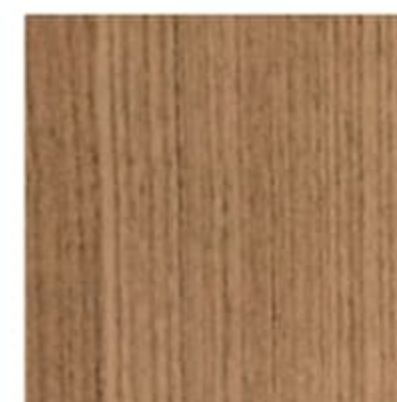

Café Cherry



Mocha Cherry



Sunset Cherry

Fabrics and carpets may change without notice or obligation.



Enjoy the soft feel and upscale luxury of Ultraleather™ in the fabric collection of your choice. Beautiful cabinetry in Café Cherry, Mocha Cherry or Sunset Cherry with stylish hardware provides plentiful storage.

**White Sand**

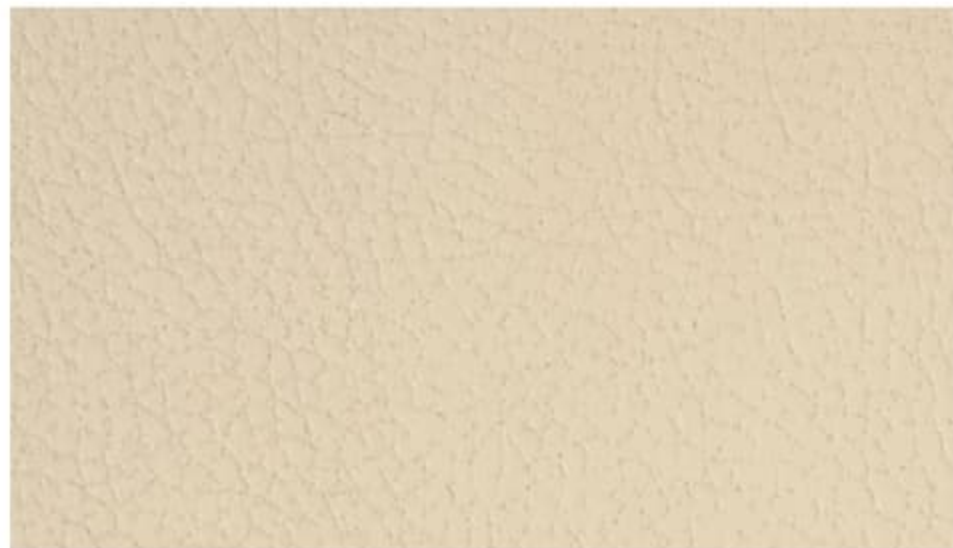

Birch Ultraleather



Accent



Bedspread



Vinyl



Carpet



Deepstar Agate  
Wilsonart Laminate  
Countertop



Mineral Wall Board



Café Cherry



Mocha Cherry



Sunset Cherry

Fabrics and carpets may change without notice or obligation.



Enjoy the soft feel and upscale luxury of Ultraleather™ in the fabric collection of your choice. Beautiful cabinetry in Café Cherry, Mocha Cherry or Sunset Cherry with stylish hardware provides plentiful storage.

**White Sand**



Birch Ultraleather



Accent



Bedspread



Vinyl



Carpet



Deepstar Agate  
Wilsonart Laminate  
Countertop



Mineral Wall Board



Café Cherry



Mocha Cherry



Sunset Cherry

Fabrics and carpets may change without notice or obligation.



Choose from two deluxe graphics packages and four dazzling full-body paint options.



Dark Titanium  
DELUXE GRAPHICS



Antique Sage  
DELUXE GRAPHICS



Choose from two deluxe graphics packages and four dazzling full-body paint options.



Dark Titanium  
DELUXE GRAPHICS



Antique Sage  
DELUXE GRAPHICS



Choose from two deluxe graphics packages and four dazzling full-body paint options.



Black Walnut  
FULL-BODY PAINT



Sage  
FULL-BODY PAINT



Charcoal  
FULL-BODY PAINT



Forest  
FULL-BODY PAINT



Choose from two deluxe graphics packages and four dazzling full-body paint options.



Black Walnut  
FULL-BODY PAINT



Sage  
FULL-BODY PAINT



Charcoal  
FULL-BODY PAINT



Forest  
FULL-BODY PAINT



## Weights & Measures

	25Q	25R	25T
<b>Length</b>	25'5"	25'5"	25'5"
<b>Exterior Height<sup>1</sup></b>	11'	11'	11'
<b>Exterior Width</b>	7'6"	7'6"	7'6"
<b>Exterior Storage<sup>2</sup> (cu. ft.)</b>	39.0	54.0	92.0
<b>Awning Length</b>	16'	16'	16'
<b>Interior Height</b>	6'5"	6'5"	6'5"
<b>Interior Width</b>	7'3"	7'3"	7'3"
<b>Freshwater Capacity w/Heater<sup>3</sup> (gal.)</b>	34	33	34
<b>Holding Tank Capacity - Black/Gray<sup>3</sup> (gal.)</b>	36/36	40/30	36/36
<b>LP Capacity<sup>4</sup> (gal.)</b>	13	13	13
<b>Fuel Capacity (gal.)</b>	26.4	26.4	26.4
<b>GCWR<sup>5</sup> (lbs.)</b>	15,250	15,250	15,250
<b>GVWR (lbs.)</b>	11,030	11,030	11,030
<b>GAWR - Front (lbs.)</b>	4,410	4,410	4,410
<b>GAWR - Rear (lbs.)</b>	7,720	7,720	7,720
<b>Wheelbase</b>	170"	170"	170"

## Cab Conveniences

**RV Radio® Rearview Monitor System** 6.5" LCD touch screen, CD player, weather band, remotes, iPod® interface connector, rear camera w/one-way audio

**Cab Seats** armrest, adjustable lumbar support, power lift, swivel/slide, recline

**Power steering w/tilt and telescoping wheel**

**Power door lock w/remote for main entry door**

**Removable one-piece fitted carpet liner**

**12-volt powerpoints**

**Power mirrors w/defrost and built-in sideview video camera system**

**Dash appliqué package**

**Cruise control**

**Chassis/house battery radio power switch**

**Sunvisors**

**Front wraparound curtain**

### Optional Equipment

Sirius® satellite radio

**Infotainment Center/GPS** voice navigation, 7" LCD touch screen w/PIP, Bluetooth™, remote, AM/FM/CD/DVD radio, iPod interface connector, Sirius satellite ready

## Interior

**OnePlace® Systems Center**

**Key-activated slideroom master lock switch**

**Soft vinyl ceiling**

**Privacy curtain**

**Stereo System** AM/FM, alarm clock, CD/DVD player, input jack

**26" LCD TV (25T, 25Q)**

**32" LCD TV (25R)**

**Satellite system ready**

## CHASSIS

### Mercedes-Benz® Sprinter F50 Chassis

**188-hp Mercedes-Benz 3.0L 6-cylinder turbo-diesel engine**

**5-speed automatic transmission w/ Tip Shift technology to allow manual shifting**

**Hydraulic brakes w/ABS**

**Adaptive ESP® technology**

**180-amp. alternator**

**Trailer Hitch<sup>5</sup> 5,000-lb. drawbar/ 500-lb. maximum vertical tongue weight w/7-pin connector**

**Stainless steel wheel liners**

### Optional Equipment

Stylized aluminum wheels



Mercedes-Benz®  
Sprinter F50 Chassis



## Weights & Measures

	25Q	25R	25T
<b>Length</b>	25'5"	25'5"	25'5"
<b>Exterior Height<sup>1</sup></b>	11'	11'	11'
<b>Exterior Width</b>	7'6"	7'6"	7'6"
<b>Exterior Storage<sup>2</sup> (cu. ft.)</b>	39.0	54.0	92.0
<b>Awning Length</b>	16'	16'	16'
<b>Interior Height</b>	6'5"	6'5"	6'5"
<b>Interior Width</b>	7'3"	7'3"	7'3"
<b>Freshwater Capacity w/Heater<sup>3</sup> (gal.)</b>	34	33	34
<b>Holding Tank Capacity - Black/Gray<sup>3</sup> (gal.)</b>	36/36	40/30	36/36
<b>LP Capacity<sup>4</sup> (gal.)</b>	13	13	13
<b>Fuel Capacity (gal.)</b>	26.4	26.4	26.4
<b>GCWR<sup>5</sup> (lbs.)</b>	15,250	15,250	15,250
<b>GVWR (lbs.)</b>	11,030	11,030	11,030
<b>GAWR - Front (lbs.)</b>	4,410	4,410	4,410
<b>GAWR - Rear (lbs.)</b>	7,720	7,720	7,720
<b>Wheelbase</b>	170"	170"	170"

## Cab Conveniences

**RV Radio® Rearview Monitor System** 6.5" LCD touch screen, CD player, weather band, remotes, iPod® interface connector, rear camera w/one-way audio

**Cab Seats** armrest, adjustable lumbar support, power lift, swivel/slide, recline

**Power steering w/tilt and telescoping wheel**

**Power door lock w/remote for main entry door**

**Removable one-piece fitted carpet liner**

**12-volt powerpoints**

**Power mirrors w/defrost and built-in sideview video camera system**

**Dash appliqué package**

**Cruise control**

**Chassis/house battery radio power switch**

**Sunvisors**

**Front wraparound curtain**

### Optional Equipment

**Sirius® satellite radio**

**Infotainment Center/GPS** voice navigation, 7" LCD touch screen w/PIP, Bluetooth™, remote, AM/FM/CD/DVD radio, iPod interface connector, Sirius satellite ready

## Interior

**OnePlace® Systems Center**

**Key-activated slideroom master lock switch**

**Soft vinyl ceiling**

**Privacy curtain**

**Stereo System** AM/FM, alarm clock, CD/DVD player, input jack

**26" LCD TV (25T, 25Q)**

**32" LCD TV (25R)**

**Satellite system ready**

## CHASSIS

### Mercedes-Benz® Sprinter F50 Chassis

**188-hp Mercedes-Benz 3.0L 6-cylinder turbo-diesel engine**

**5-speed automatic transmission w/ Tip Shift technology to allow manual shifting**

**Hydraulic brakes w/ABS**

**Adaptive ESP® technology**

**180-amp. alternator**

**Trailer Hitch<sup>5</sup> 5,000-lb. drawbar/ 500-lb. maximum vertical tongue weight w/7-pin connector**

**Stainless steel wheel liners**

### Optional Equipment

**Stylized aluminum wheels**



Mercedes-Benz®  
Sprinter F50 Chassis



**Tinted windows****LED ceiling lights** (coach)**MCD American Duo® solar/blackout roller shades****Amplified digital TV antenna system****Powered roof vent** (kitchen, 25Q only)**Roof vent w/power ventilator fan** (bath)*Optional Equipment***StudioLoft™ and powered sunvisor** (25R, 25T)  
(NA w/optional driver's door)**Satellite TV antenna system w/elevation sensing unit****Dual-pane windows w/built-in screen and shade** (NA 25R w/optional dinette)**Kitchen****Microwave/convection oven****Vented range hood** (25R, 25T)**2-burner range top w/glass cover****Refrigerator w/removable freezer compartment****Stainless steel sink w/glass cover and folding faucet****Laminate countertops****Decorative backsplash****Water filtration system w/cold water faucet****Bath****Flexible showerhead****Retractable self-cleaning shower door** (25R, 25T)**Shower curtain** (25Q)**Skylight****Bedroom****Flex Bed System** twin beds/queen bed w/foam mattress pillows w/shams and access to storage below (25T)**Queen bed** w/expandable base, foam mattress, pillows, shams (25R)**Queen bed** w/headboard, innerspring mattress, pillows, shams, bedspread and access to storage below (25Q)**22" LCD TV** (25Q, 25T)**Exterior****Premium high-gloss skin****16' electric patio awning****Threshold RV™ entrance door****Retractable screen door****Automatic entrance door steps****Lighted storage compartment****Mud flaps** (rear)**Porch light****Stepwell light***Optional Equipment***Driver's door w/power lock and power window** (NA w/StudioLoft)**Lower front protective mask****Heating & Cooling System****13,500 BTU roof-mount air conditioner w/heat pump****20,000 BTU low-profile furnace***Optional Equipment***14,800 BTU roof-mount air conditioner w/heat pump****Electrical System****Service Center** cable TV input, 30-amp. power cord, portable satellite dish hook-up**AC/DC load center, 45-amp. converter/charger****Auxiliary start circuit****Battery disconnect system** (coach)**2 deep-cycle, Group 24 RV batteries****Automatic dual-battery charge control****3,600-watt Cummins Onan® MicroQuiet™ LP generator****1,000-watt DC/AC Inverter****Exterior TV jack and AC duplex***Optional Equipment***3,200-watt Cummins Onan diesel generator****Plumbing System****Service Center** color-coded labels, city water hookup/tank diverter fill, drainage valves, 10' sewer hose, exterior wash station w/lighted pump switch**TrueLevel™ holding-tank monitoring system****6-gallon water heater w/electric ignition, 110 V/LP****Winterization Package** water heater bypass valve and siphon tube**On-demand water pump****Permanent-mount LP tank w/remote fill****Heated drainage system****Water tank fill w/lockable door****Safety****Seat belts****Child seat tether anchor** (25R)**LP, smoke and carbon monoxide detectors****10 BC fire extinguisher****Ground fault interrupter****High-mount brake lamps****Daytime running lamps****Fog lamps****Warranty<sup>6</sup>****12-month/15,000-mile basic warranty<sup>7</sup>****36-month/36,000-mile limited warranty on structure<sup>7</sup>****10-year limited parts-and-labor warranty on roof skin<sup>7</sup>**

- The height of each model is measured to the top of the tallest standard feature and is based on the curb weight of a typically equipped unit. The actual height of your vehicle may vary by several inches depending on chassis or equipment variations. Please contact your dealer for further information.
- The load capacity of your motor home is designated by weight, not by volume, so you cannot necessarily use all available space when loading your motor home.
- Capacities are based on measurements prior to tank installation. Slight capacity variations can result due to installation applications.
- Capacities shown are tank manufacturer's listed water capacity (W.C.) Actual filled LP capacity is 80% of listing due to overfilling prevention device on tank.
- Actual towing capacity is dependent upon your particular loading and towing circumstances, which includes the GVWR, GAWR and GCWR as well as adequate trailer brakes. Please refer to the Operator's Manual of your vehicle for further towing information.
- See separate chassis warranty.
- See your dealer for complete warranty information.

NA Not Available

Not all items available in combination. See dealer for details.

Winnebago Industries'® continuing program of product improvement makes specifications, equipment, model availability, and prices subject to change without notice. Comparisons to other motor homes are based on the most recent information available at printing.



**Tinted windows****LED ceiling lights** (coach)**MCD American Duo® solar/blackout roller shades****Amplified digital TV antenna system****Powered roof vent** (kitchen, 25Q only)**Roof vent w/ powered ventilator fan** (bath)*Optional Equipment***StudioLoft™ and powered sunvisor** (25R, 25T)  
(NA w/optional driver's door)**Satellite TV antenna system w/elevation sensing unit****Dual-pane windows w/built-in screen and shade** (NA 25R w/optional dinette)**Kitchen****Microwave/convection oven****Vented range hood** (25R, 25T)**2-burner range top w/glass cover****Refrigerator w/removable freezer compartment****Stainless steel sink w/glass cover and folding faucet****Laminate countertops****Decorative backsplash****Water filtration system w/cold water faucet****Bath****Flexible showerhead****Retractable self-cleaning shower door** (25R, 25T)**Shower curtain** (25Q)**Skylight****Bedroom****Flex Bed System** twin beds/queen bed w/ foam mattress pillows w/shams and access to storage below (25T)**Queen bed** w/expandable base, foam mattress, pillows, shams (25R)**Queen bed** w/headboard, innerspring mattress, pillows, shams, bedspread and access to storage below (25Q)**22" LCD TV** (25Q, 25T)**Exterior****Premium high-gloss skin****16' electric patio awning****Threshold RV™ entrance door****Retractable screen door****Automatic entrance door steps****Lighted storage compartment****Mud flaps** (rear)**Porch light****Stepwell light***Optional Equipment***Driver's door w/power lock and power window** (NA w/StudioLoft)**Lower front protective mask****Heating & Cooling System****13,500 BTU roof-mount air conditioner w/heat pump****20,000 BTU low-profile furnace***Optional Equipment***14,800 BTU roof-mount air conditioner w/heat pump****Electrical System****Service Center** cable TV input, 30-amp. power cord, portable satellite dish hook-up**AC/DC load center, 45-amp. converter/charger****Auxiliary start circuit****Battery disconnect system** (coach)**2 deep-cycle, Group 24 RV batteries****Automatic dual-battery charge control****3,600-watt Cummins Onan® MicroQuiet™ LP generator****1,000-watt DC/AC Inverter****Exterior TV jack and AC duplex***Optional Equipment***3,200-watt Cummins Onan diesel generator****Plumbing System****Service Center** color-coded labels, city water hookup/tank diverter fill, drainage valves, 10' sewer hose, exterior wash station w/lighted pump switch**TrueLevel™ holding-tank monitoring system****6-gallon water heater w/electric ignition, 110 V/LP****Winterization Package** water heater bypass valve and siphon tube**On-demand water pump****Permanent-mount LP tank w/remote fill****Heated drainage system****Water tank fill w/lockable door****Safety****Seat belts****Child seat tether anchor** (25R)**LP, smoke and carbon monoxide detectors****10 BC fire extinguisher****Ground fault interrupter****High-mount brake lamps****Daytime running lamps****Fog lamps****Warranty<sup>6</sup>****12-month/15,000-mile basic warranty<sup>7</sup>****36-month/36,000-mile limited warranty on structure<sup>7</sup>****10-year limited parts-and-labor warranty on roof skin<sup>7</sup>**

1 The height of each model is measured to the top of the tallest standard feature and is based on the curb weight of a typically equipped unit. The actual height of your vehicle may vary by several inches depending on chassis or equipment variations. Please contact your dealer for further information.

2 The load capacity of your motor home is designated by weight, not by volume, so you cannot necessarily use all available space when loading your motor home.

3 Capacities are based on measurements prior to tank installation. Slight capacity variations can result due to installation applications.

4 Capacities shown are tank manufacturer's listed water capacity (W.C.) Actual filled LP capacity is 80% of listing due to overfilling prevention device on tank.

5 Actual towing capacity is dependent upon your particular loading and towing circumstances, which includes the GVWR, GAWR and GCWR as well as adequate trailer brakes. Please refer to the Operator's Manual of your vehicle for further towing information.

6 See separate chassis warranty.

7 See your dealer for complete warranty information.

NA Not Available

Not all items available in combination. See dealer for details.

Winnebago Industries® continuing program of product improvement makes specifications, equipment, model availability, and prices subject to change without notice. Comparisons to other motor homes are based on the most recent information available at printing.



## GOITASCA.COM HAS GONE MOBILE



Learn more about the 2013 Reyo on your computer, smartphone or tablet. Visit [GoItasca.com/Reyo](http://GoItasca.com/Reyo) for the complete Reyo experience.

## PREFERRED CARE PROGRAM

We back our motor homes with best-in-class support both before and after the sale:

- 12-month/15,000-mile basic limited warranty
- 36-month/36,000-mile warranty on structure
- 10-year standard limited parts-and-labor roof skin warranty
- Complimentary 24-hour roadside assistance program



**TRIP**Saver  
FAST TRACK PARTS

- TripSaver® Fast Track Parts guarantees that in-stock warranty parts ship directly to your dealer within 24 hours
- National dealer service network

## JOIN THE CLUB, JOIN THE FUN

As an Itasca motor home owner, you are invited to join the WIT Club. It's a great way to take full advantage of your new coach and meet fun-loving WIT Club members from across the country who make motor home adventures a way of life.



### Members enjoy:

- Caravans and rallies
- Newsletters
- Local and state group activities
- RV travel benefits

For more information, visit [WITclub.com](http://WITclub.com).



### Grand National Rally

Each year, thousands of Winnebago Industries motor home owners descend upon Forest City, Iowa, for the Grand National Rally. Rally goes connect with old friends and enjoy concerts, tours, activities and more in a weeklong celebration of the motor home lifestyle. Join us in July for a week you'll never forget.





# GOITASCA.COM HAS GONE MOBILE



Learn more about the 2013 Revo on your computer, smartphone or tablet. Visit [Goltasca.com/Revo](http://Goltasca.com/Revo) for the complete Revo experience.

## **PREFERRED CARE PROGRAM**

We back our motor homes with best-in-class support both before and after the sale:

- 12-month/15,000-mile basic limited warranty
- 36-month/36,000-mile warranty on structure
- 10-year standard limited parts-and-labor roof skin warranty
- Complimentary 24-hour roadside assistance program



**TRIP Saver**  
FAST TRACK PARTS

- TripSaver® Fast Track Parts guarantees that in-stock warranty parts ship directly to your dealer within 24 hours
- National dealer service network

## JOIN THE CLUB, JOIN THE FUN

As an Itasca motor home owner, you are invited to join the WIT Club. It's a great way to take full advantage of your new coach and meet fun-loving WIT Club members from across the country who make motor home adventures a way of life.



### Members enjoy:

- Caravans and rallies
- Newsletters
- Local and state group activities
- RV travel benefits

For more information, visit [WITclub.com](http://WITclub.com).



### Grand National Rally

Each year, thousands of Winnebago Industries motor home owners descend upon Forest City, Iowa, for the Grand National Rally. Rally goers connect with old friends and enjoy concerts, tours, activities and more in a weeklong celebration of the motor home lifestyle. Join us in July for a week you'll never forget.

