

adventure, inspired by  
**AIRSTREAM**



Bunks? Dinette? Extra built-in storage? Whatever makes your life on the road a pleasure, and whatever lengths we need to go to – from 19 thru 30 – there's a Flying Cloud model just right for you.

Functional and flexible, lightweight and liberating, rugged and reliable – the Flying Cloud goes above and beyond to make you feel at home on the road.

*The popular Flying Cloud bunk option is now available on the Flying Cloud 19!*



Cashew Ultra leather with Golden Night Décor

#### 19 FLYING CLOUD WITH BUNK OPTION



Bunks? Dinette? Extra built-in storage? Whatever makes your life on the road a pleasure, and whatever lengths we need to go to – from 19 thru 30 – there's a Flying Cloud model just right for you.

Functional and flexible, lightweight and liberating, rugged and reliable – the Flying Cloud goes above and beyond to make you feel at home on the road.

*The popular Flying Cloud bunk option is now available on the Flying Cloud 19!*



*Cashew Ultraleather with Golden Night Décor*

**19 FLYING CLOUD WITH BUNK OPTION**





**SPECIFICATIONS**

19

Exterior Length	19' 2"
Exterior Width	8'
Interior Width	7' 7"
Exterior Height with A/C	9' 5"
Interior Height with A/C	6' 4.5"
Hitch Weight (w/LP & w/o options, water & cargo) (lbs.)	550
Unit Base Weight (w/LP & w/o options, water & cargo) (lbs.)	3,852
Gross Vehicle Weight Rating (lbs.)	4,500
Net Carrying Capacity (NCC=GWR-UBW) (lbs.)	648
Fresh Water Tank (gal.)	23
Gray Water Tank (gal.)	21
Black Water Tank (gal.)	18
Water Heater w/electronic ignition (gal.) (XT)	6
A/C w/heat pump (BTU)	13,500
Furnace (BTU)	16,000
LP (2 - 30 lb. steel tanks)	60
Deep Cycle Battery (lead acid) Group 24	2
Sleeping Capacity	5



Cashew Ultraleather with Golden Night Decor



**Axle**



**GVWR**  
4,500 lbs



**Length**  
19'2"



**Sleeps**

Please visit [www.airstream.com](http://www.airstream.com) to see a full set of model specifications, floor plans, features and options.

**Interior Décor's**

- Mica
- Golden Night
- Cashew Ultraleather™ with Mica
- Cashew Ultraleather™ with Golden Night
- Black Ultraleather™ with Golden Night



Airstream, Inc.  
 419 West Pike Street  
 P.O. Box 629  
 Jackson Center, OH 45334 USA  
 937-596-6111

Airstream is a subsidiary of Thor Industries, Inc.

Product information, specifications, and photography were as accurate as possible at time of printing. Photographs may contain some features that are optional. Since we continually strive to improve our products, actual products may differ. Prices and specifications are subject to change without notice. All capacities are approximate and dimensions are nominal. Some features or options may be different or unavailable in Canada.

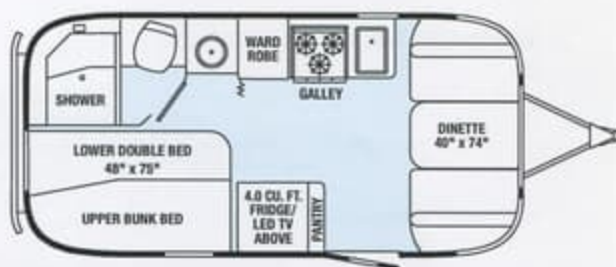

**SPECIFICATIONS**

19

Exterior Length	19' 2"
Exterior Width	8'
Interior Width	7' 7"
Exterior Height with A/C	9' 5"
Interior Height with A/C	6' 4.5"
Hitch Weight (w/LP & w/o options, water & cargo) (lbs.)	550
Unit Base Weight (w/LP & w/o options, water & cargo) (lbs.)	3,852
Gross Vehicle Weight Rating (lbs.)	4,500
Net Carrying Capacity (NCC=GVWR-UBW) (lbs.)	648
Fresh Water Tank (gal.)	23
Gray Water Tank (gal.)	21
Black Water Tank (gal.)	18
Water Heater w/electronic ignition (gal.) (XT)	6
A/C w/heat pump (BTU)	13,500
Furnace (BTU)	16,000
LP (2 - 30 lb. steel tanks)	60
Deep Cycle Battery (lead acid) Group 24	2
Sleeping Capacity	5



Cashew Ultraleather with Golden Night Décor



**Axle**



**GVWR**  
4,500 lbs



**Length**  
19'2"



**Sleeps**

Please visit [www.airstream.com](http://www.airstream.com) to see a full set of model specifications, floor plans, features and options.

**Interior Décor**

- Mica
- Golden Night
- Cashew Ultraleather™ with Mica
- Cashew Ultraleather™ with Golden Night
- Black Ultraleather™ with Golden Night

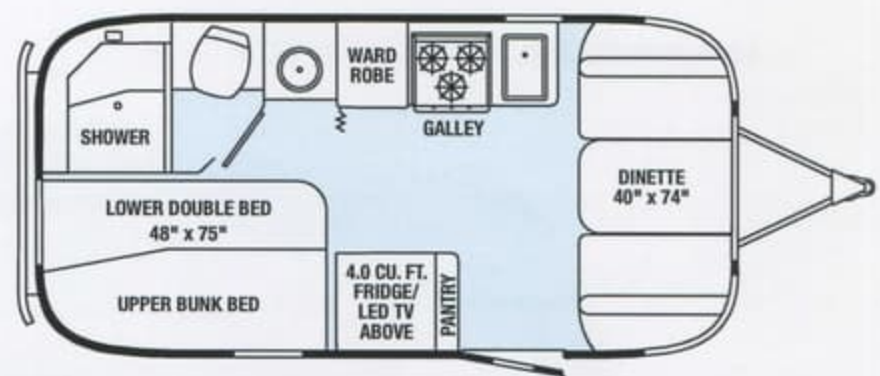

Airstream, Inc.  
 419 West Pike Street  
 P.O. Box 629  
 Jackson Center, OH 45334 USA  
 937-596-6111

Airstream is a subsidiary  
 of Thor Industries, Inc.

Product information, specifications, and photography were as accurate as possible at time of printing. Photographs may contain some features that are optional. Since we continually strive to improve our products, actual products may differ. Prices and specifications are subject to change without notice. All capacities are approximate and dimensions are nominal. Some features or options may be different or unavailable in Canada.

All content and images  
 © Airstream 2014 & 2015  
 FC Bunk Show Flyer  
 200 11/14