

PREMIER

ULTRA LITE BY BULLET



INDUSTRY FIRST
LUXURY LIGHTWEIGHT

www.keystonerv.com/Premier

PREMIER

ULTRA LITE BY BULLET

Premier luxury surrounds you with “at home” comfort.



From floorplan layout to interior and exterior styling, Premier is in a class by itself.



32BHPR | Outdoor Kitchen





26RBPR | MAIN LIVING AREA

Shown with saddle decor

www.keystonerv.com/Premier

PREMIER

ULTRA LITE BY BULLET



30R1PR | KITCHEN



32BHPR | Large entertainment center | Saddle Decor



31BHPR | Bunk room



Electric adjustable awning



Stor-mor dinette drawers



Mullion doors

Largest pass-thru storage in its class

Laundry chute in master bedroom

Frameless tinted windows



Progressive interior lighting in master bedroom



Tri-fold sofa



Max depth slideout room is 36" deep

COMPARE PREMIER'S DINETTE TO THE COMPETITION

PREMIER

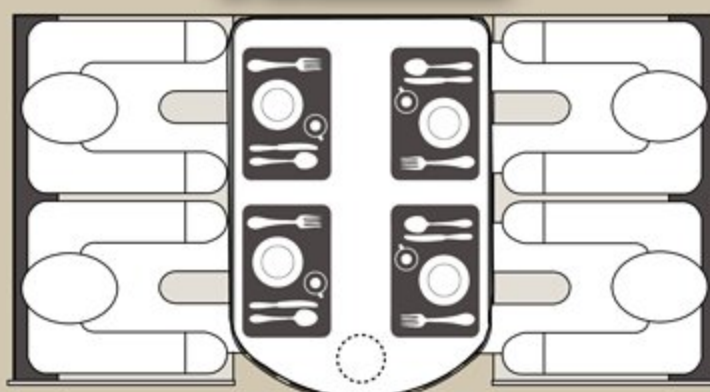

**LARGE RADIUS
DINETTE
(N/A 19FB & 22RB)**

**COMFORTABLY
SEATS 4 ADULTS**

- PLENTY OF ROOM FOR 4 PLACEMATS
- ONLY NEEDS ONE TABLE SUPPORT
- CONVERTS TO 80" BED

COMPETITION

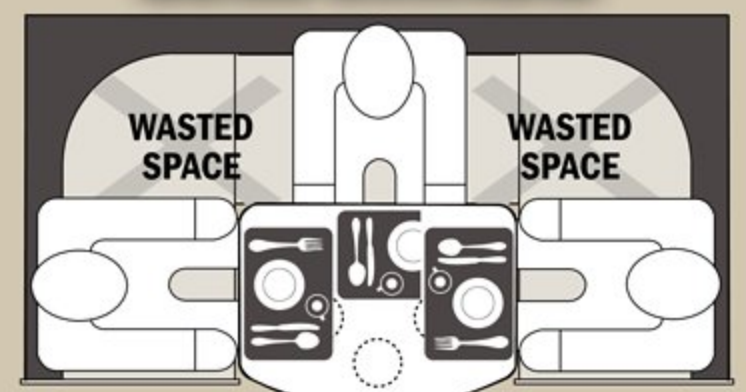

**DON'T BE FOOLED!
ONLY SEATS 3 ADULTS**

- ONLY ENOUGH ROOM FOR 2.5 PLACEMATS
- 3 PEDESTAL SUPPORTS REDUCE LEG ROOM
- ALSO CONVERTS TO 80" BED

PREMIER

ULTRA LITE BY BULLET

Premier has **LUXURY FEATURES** that matter most in Ultra-Lites.



8 cu. ft. refrigerator



Retractable kitchen faucet

CD/DVD/AM/FM/MP3 stereo



Slam latch pass thru storage doors



Storage underneath the queen bed



Rolled roof edge promotes increased water runoff



LED Puck ceiling lights



Raised panel cabinetry



Bullet is the only ultra lite travel trailer to offer the following climate control features in all floorplans:

| PREMIER | COMPETITION |
|--|-----------------------------|
| Enclosed underbelly | Exposed Tanks |
| 2" pipe off of furnace with forced air into underbelly | Radiant Heat Only |
| 30,000 BTU Furnace | 20,000 - 25,000 BTU Furnace |
| Ducted Heat and A/C | Non Ducted Heat and A/C |

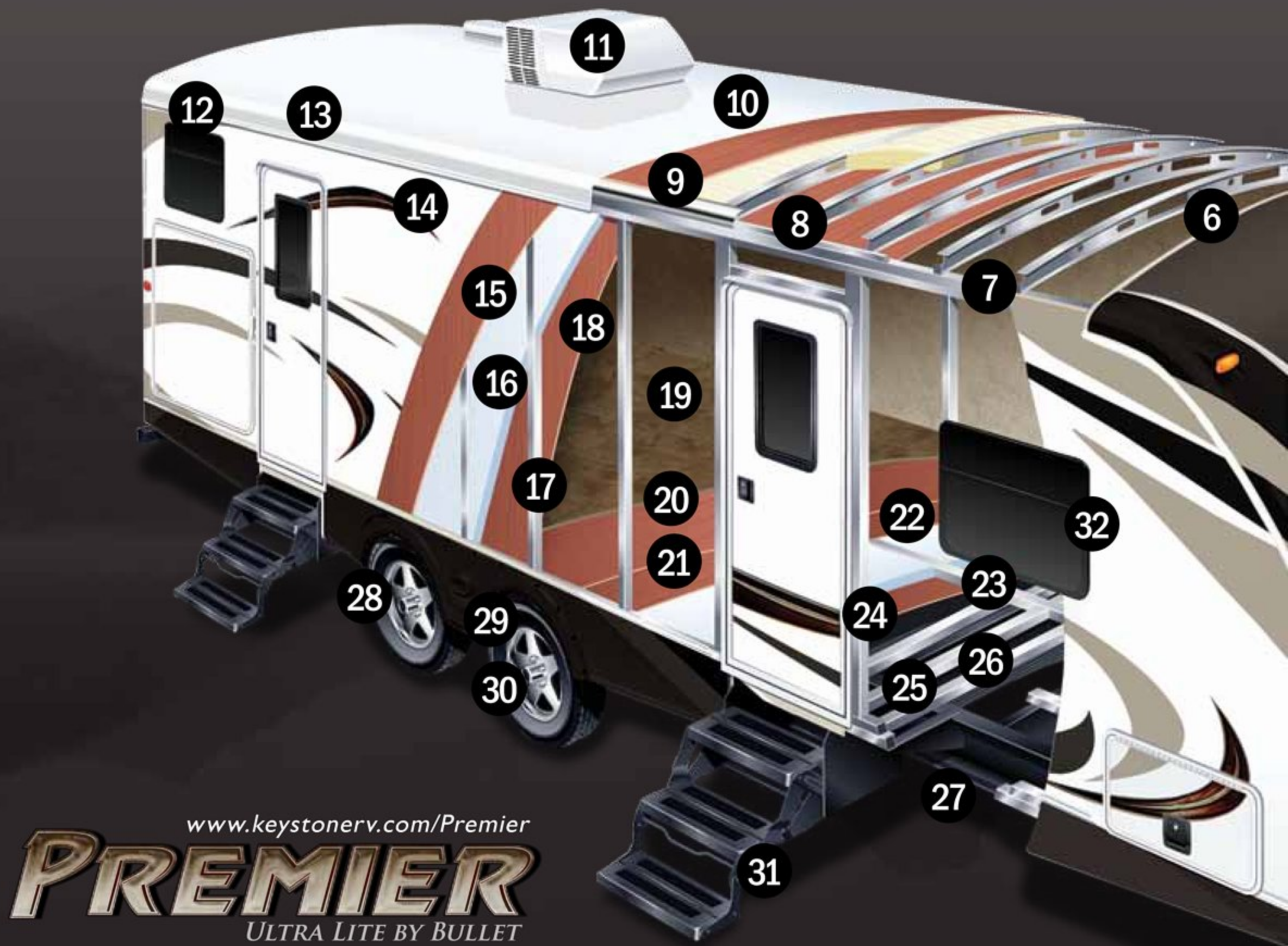

www.keystonerv.com/Premier

PREMIER

ULTRA LITE BY BULLET

BENEFITS OF A MOLDED GEL COAT FIBERGLASS FRONT CAP



PREMIER vs.



1/4" Thick molded gel coat fiberglass won't cold crack and is strong enough to hold up to rock damage unlike competitors ABS panels.



High gloss finish eliminates the fading that happens over time on ABS panels.



Molded over edges of front end of trailer to prevent leaks



Radius shape vertically and also side to side for superior aerodynamics

COMPETITION



Lightweight Solid CONSTRUCTION



1. Power Tongue Jack
2. Quick Access LP Cover
3. Integrated Dual Battery Tray
4. LED Docking Lights
5. Dual Radius Fiberglass Front Cap
6. 5" Radius Galvanized Stamped Steel Roof Trusses
7. Hurricane Straps
8. Fully Insulated Roof
9. Durable Roof Decking
10. One Piece TPO Roof
11. 13.5 Quick Cool Air Conditioning
12. Full Length Rain Gutter and 4" Drip Spouts
13. Rolled Roof Edge
14. Smooth Fiberglass Exterior
15. 1/8" Luan Wall Backing
16. Hi-Density Block Foam Insulation
17. 1 1/2" Box Welded Aluminum Frame Structure
18. Decorative Interior Wall Board
19. Residential Stain Resistant Linoleum
20. 1st Layer Floor Decking
21. 2nd Layer Floor Decking
22. Hi-Density In Floor Block Foam Insulation
23. Welded Aluminum Floor Joists
24. 3rd Layer Floor Decking
25. 6.5" – 10" Steel I-Beam Frame
26. Darco Vapor Barrier Wrap
27. Enclosed Underbelly
28. Radial Tires with Electric Brakes (4)
29. 43" Wide Stance Axles
30. Easy Lube Axles
31. Radius Entry Steps
32. Frameless Tinted Windows

BEST TOWING TRAVEL TRAILER IN THE INDUSTRY

Increased MPG and Easier to tow



The rear departure angle increases efficiency of windflow underneath and behind the trailer.



The enclosed underbelly eliminates turbulence caused by exposed frame members, holding tanks, plumbing etc.

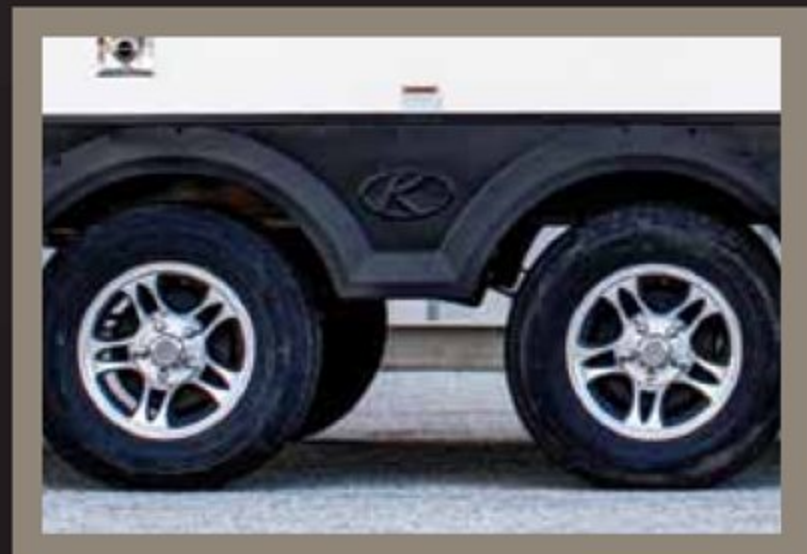

43" wide stance axle greatly reduces sway and bouncing

TRAVEL TRAILER FLOORPLANS

You'll find a Premier floorplan to fit your lifestyle perfectly.

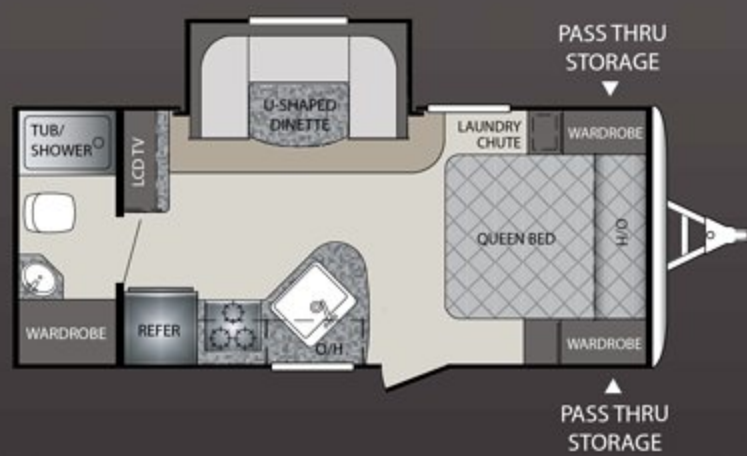

19FBPR

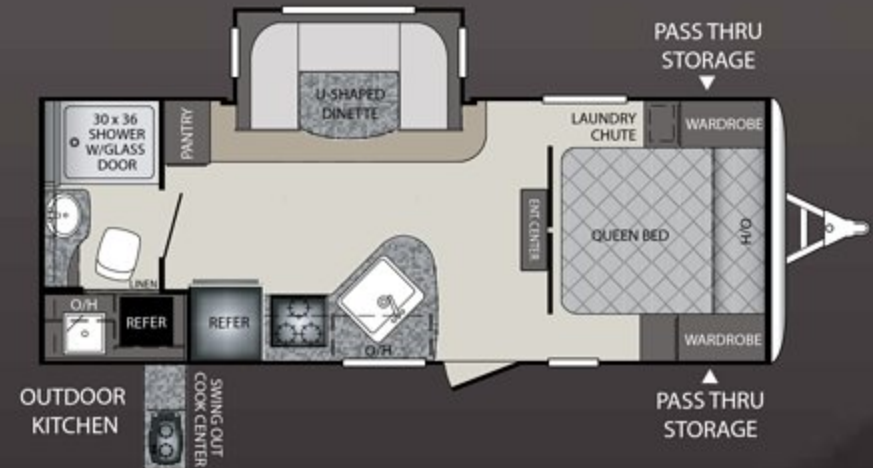

22RBPR



30REPR



30RIPR

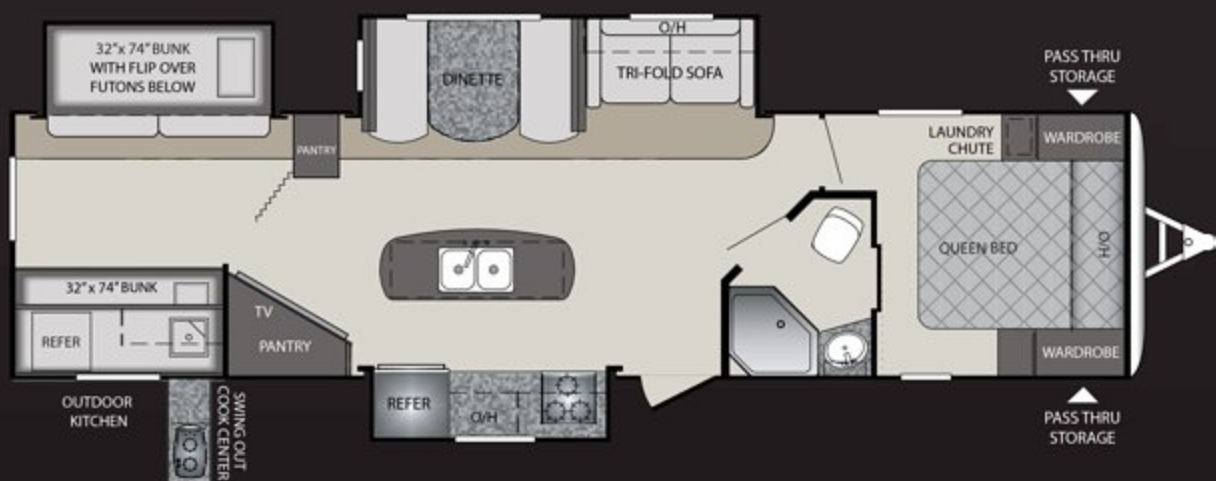

34BHPR

Product information is as accurate as possible at the date of publication of this brochure. Features, floor plans, and specifications are subject to change without notice. Please also consult Keystone's web site at keystonerv.com for more current product information and specifications. Tow Vehicle Disclaimer. CAUTION: Owners of Keystone recreational vehicles are solely responsible for the selection and proper use of tow vehicles. All customers should consult with a motor vehicle manufacturer or their dealer concerning the purchase and use of suitable tow vehicles for Keystone products. Keystone disclaims any liability or damages suffered as a result of the selection, operation, use or misuse of a tow vehicle. KEYSTONE'S LIMITED WARRANTY DOES NOT COVER DAMAGE TO THE RECREATIONAL VEHICLE OR THE TOW VEHICLE AS A RESULT OF THE SELECTION, OPERATION, USE OR MISUSE OF THE TOW VEHICLE.

PREMIER

ULTRA LITE BY BULLET



26RBPR

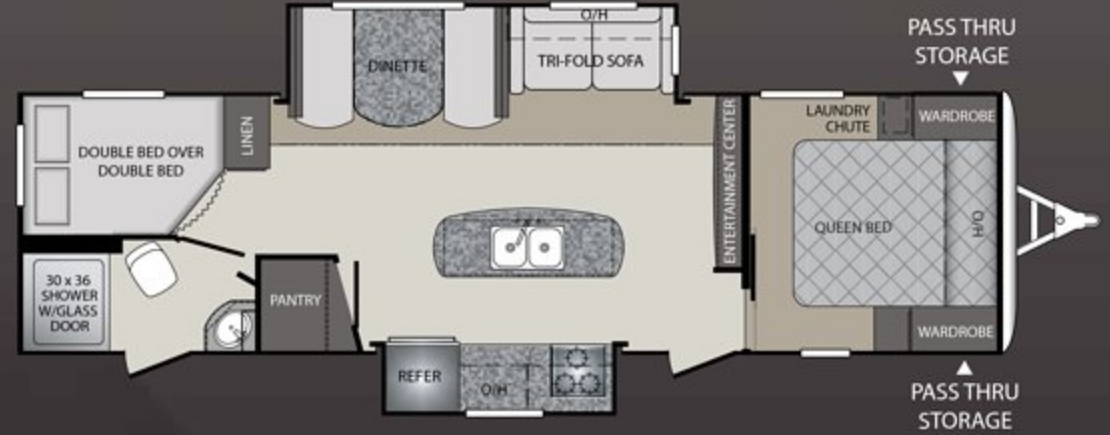

29BHPR



31BHPR



32BHPR

WEIGHTS & MEASUREMENTS

| TRAVEL TRAILERS | 19FBPR | 22RBPR | 26RBPR | 29BHPR | 30REPR | 30RIPR | 31BHPR | 32BHPR | 34BHPR |
|-----------------------|---------|---------|---------|---------|---------|---------|---------|---------|--------|
| SHIPPING WEIGHT | 4206 | 4690 | 5788 | 6260 | 6463 | 6632 | 6482 | 6257 | 7079 |
| CARRYING CAPACITY | 2294 | 4820 | 1712 | 1490 | 1537 | 1368 | 1518 | 1343 | 1721 |
| HITCH WEIGHT | 410 | 500 | 835 | 835 | 745 | 725 | 795 | 735 | 845 |
| EXTERIOR LENGTH | 23' 2" | 25' 6" | 30' 6" | 33' 8" | 34' 11" | 34' 6" | 35' 4" | 34' 9" | 37' 0" |
| EXTERIOR WIDTH | 8' | 8' | 8' | 8' | 8' | 8' | 8' | 8' | 8' |
| EXT. HEIGHT - A/C TOP | 10' 11" | 10' 11" | 10' 11" | 10' 11" | 10' 11" | 10' 11" | 10' 11" | 10' 11" | 11' 0" |
| FRESH WATER (GAL.) | 43 | 43 | 43 | 43 | 43 | 43 | 43 | 43 | 43 |
| WASTE WATER (GAL.) | 30 | 30 | 30 | 30 | 30 | 30 | 30 | 30 | 30 |
| GRAY WATER (GAL.) | 30 | 30 | 60 | 60 | 30 | 60 | 30 | 60 | 60 |
| LP CAPACITY (LBS.) | 40 | 40 | 40 | 40 | 40 | 40 | 40 | 40 | 40 |

STANDARDS & OPTIONS

CONSTRUCTION STANDARDS

- Aggressive Front Profile for Increased Towability
- Aluminum Framed Front, End and Side Walls
- Laminated Fiberglass Exterior Side Walls
- 2" Thick Laminated Aluminum Floor
- In Frame Fresh, Grey, and Black Water Tanks
- 6.5" - 10" Steel I-Beam with Full-Length Welded Outrigger
- 1/4" ABS Enclosed Underbelly
- Darco Moisture Barrier
- One Piece TPO Roof
- E-Z Lube Axles
- Electric Brake System (4 wheels)
- R-11 Insulation in Floor
- R-7 Insulation in Sidewalls
- R-11 Insulation in Roof

EXTERIOR CAMPING PACKAGE

- Wide Stance E-Z Lube Axles
- 6 Gallon Gas/Electric DSI Water Heater
- Radius Entry Door with Gas Strut
- Outside Speakers
- Outside Shower (Hot and Cold Water)
- 4 Stabilizer Jacks
- TV Antenna and Cable Hook-Up
- Electric Awning with Adjustable Arms
- Radial Tires

EXTERIOR FEATURES

- Outdoor Kitchen (22RB, 30RI, 31BH, 32BH, 34BH)
- Aluminum Wheels
- Dual Propane Tanks with Cover
- In Frame Dual Battery Rack
- Oversized Exterior Pass Thru Storage with Lighting
- LP Quick Connect
- Amber Patio Light
- Spare Tire
- Oversized Grab Handle (main door)
- Triple Entry Steps
- Slam Baggage Doors

INTERIOR CAMPING PACKAGE

- 13.5 BTU Ducted A/C
- Night Shades
- CD/DVD/AM/FM Stereo with Aux and I-Pod Hookup
- 32" LCD TV
- Microwave
- 8 cu./ft. Double Door Refrigerator
- 3 Burner High Output Range
- Retractable Faucet
- All Raised Panel Hardwood Cabinet Doors
- Foot Flush Toilet
- Tub Surround with Shelves
- Full Extension Drawer Glides
- Tri-Fold Sofa (select models)
- Stainless Steel Sink

INTERIOR FEATURES

- 6' 11" Vaulted Ceiling
- Flexible Fiberglass Reinforced Flooring
- Swivel Rockers
- Upgraded Residential Furniture
- Night Shades in Living Area
- 17" Oven
- Decorative Wall Border
- Stor-mor dinette
- Retractable Kitchen Faucet

BATHROOM

- Oversized Showers w/GlassDoor (N/A on 19FB, 31BH)
- Power Vent Fan
- Solid Wood Medicine Cabinet
- Linen Storage

MASTER BEDROOM

- Upgraded Memory Foam Mattress
- Mirrored Wardrobes
- Laundry Chute
- Under Bed Storage
- Individual Reading Lights
- Accent Wallboard

SAFETY EQUIPMENT

- Carbon Monoxide Detector
- Smoke Alarm
- Fire Extinguisher
- Electric Brakes
- Safety Chains
- Frameless Tinted Safety Glass Windows, Egress Windows (Fire Escape)
- GFI Receipts

OPTIONS

- Bumper Mounted Aussie Grill
- 15K A/C
- 50 AMP Service w/Wire and Brace for second A/C (N/A 19FB, 22RB)

THERMAL PACKAGE

- Heated and Enclosed Underbelly
- 2" Pipe off of Furnace to Underbelly
- 30K BTU Furnace and Residential Heat Ducts



PREMIER PACKAGE

- Aerodynamic Fiberglass Front Cap
- Vaulted Ceiling System
- Frameless Tinted Windows
- Power Tongue Jack
- Tri-Fold Sofa
- Max Depth Slides
- LED Flush Mounted Puck Lighting
- Upgraded Exterior Graphics Package
- Black Tank Flush

DUNE



SADDLE



CHARCOAL



YOUR LOCAL DEALER:



Go RVing
Life's A Trip



www.keystonerv.com

www.keystonerv.com/Premier

PREMIER
ULTRA LITE BY BULLET

2642 Hackberry Drive | PO Box 2000
Goshen, IN 46527-2000
(574) 535-2100

March 2014