

SPORTSMEN[®]



Fifth Wheels & Travel Trailers



Available in both travel trailers and fifth wheels, Sportsmen models are value packed with innovative features at a great price. This bunkhouse provides a large living room with U-dinette, sofa and entertainment center. The kids will love the rear bunkhouse with trundle beds for friends, their own entertainment center and optional jiffy sofa. Front queen bed is a great place for the parents to rest and relax. Spacious storage throughout for camping made easy!



S331BH
Bramblewood Décor



S331BH Convertible U-dinette and sofa offer sleeping space for family and friends.



S331BH Padded headboard and standard innerspring mattress. Pillow top mattress upgrade available.





S241RKS
Bramblewood Décor

Beautiful L-shaped kitchen comes equipped with residential backsplash, 5 cu. ft. refrigerator, microwave with turntable, deep sink with covers and plenty of storage, which continues with overhead cabinetry above jiffy and dinette.



S241RKS Mirrored closets provide extra storage.

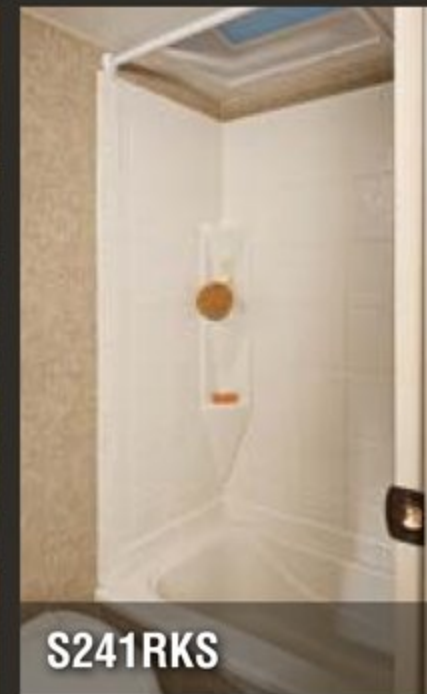

S241RKS



S241RKS



S241RKS Jiffy sofa offers extra sleep space.

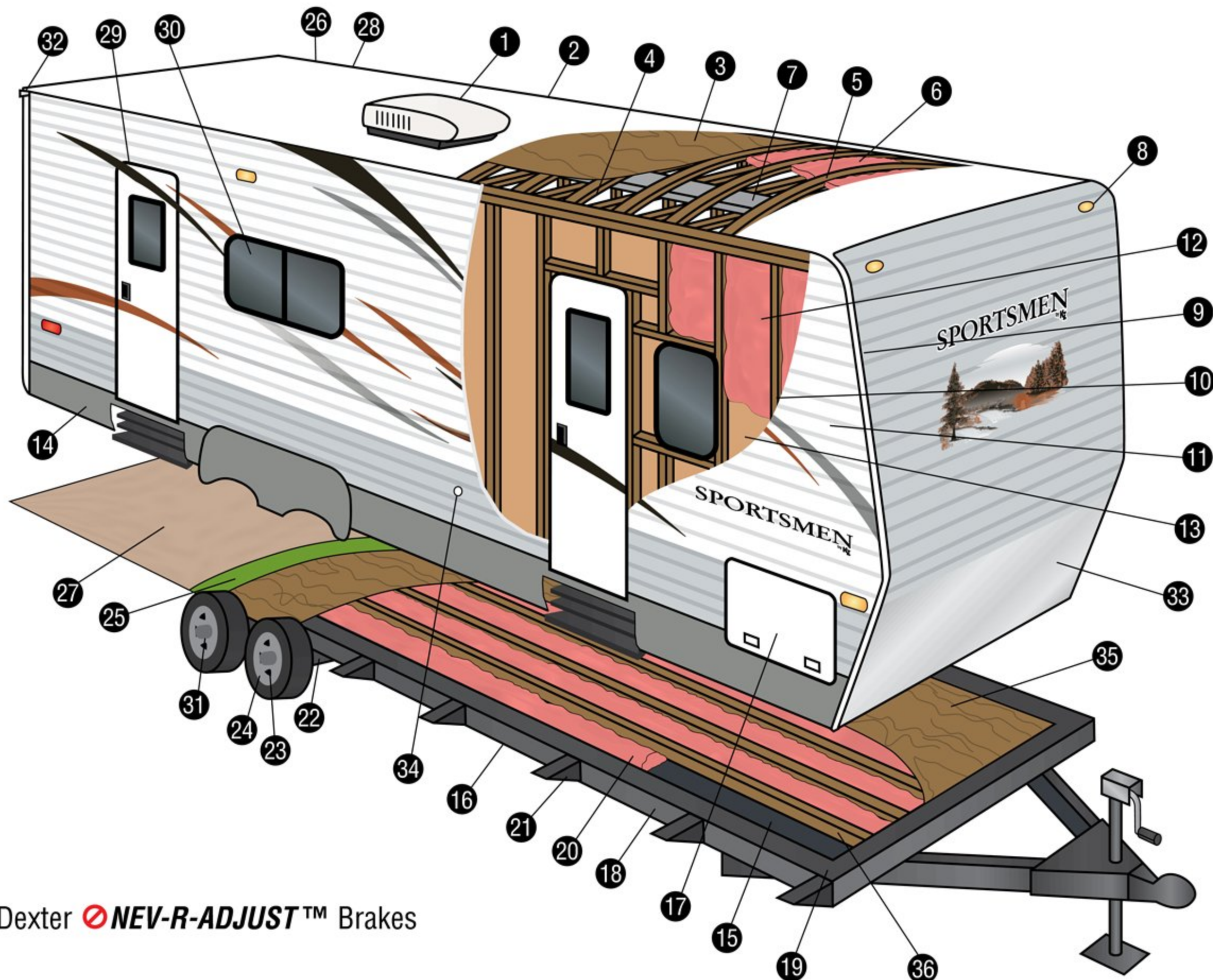

Dexter  **NEV-R-ADJUST™** Brakes

- | | | |
|---|---|--|
| 1 13,500 BTU A/C | 13 Decorative Luan Wall Board | 25 Residential Style Carpet Pad |
| 2 Seamless 1-Piece Roof with SuperFlex Roofing Material | 14 Exterior Brake Lights | 26 Rack and Pinion Electric Slide with Manual Override |
| 3 3/8" Decking | 15 Darco® Moisture Barrier Underbelly | 27 Residential Carpet or Linoleum |
| 4 Vinyl Interior Ceiling Panel | 16 Enclosed Underbelly with Heated Freshwater Tank | 28 Triple Sealed Slide Outs |
| 5 4 1/2" Wood Truss Rafters, 16" O.C. | 17 Extra-Large Radius Exterior Baggage Doors | 29 Radius Entrance Door |
| 6 R-7 Batten Insulation | 18 Heavy Duty I-beam Frame Construction | 30 Tinted Windows |
| 7 Insulated Ductwork | 19 Norco/BAL Huck Bolted Frame (E-Coated) and A-Frame (Epoxy Painted) | 31 Easy-Lube Axles |
| 8 Exterior Clearance Lights | 20 R-7 Batten Insulation | 32 Extra Long Drip Spouts |
| 9 2x2 Wood Frame Front and End Walls | 21 Fully Welded Out Riggers | 33 Diamond Plate Front Plate Rock Guard |
| 10 2x2 Wood Studs, 16" O.C. | 22 Heavy Duty Leaf Spring Axles | 34 Cable Hook Up |
| 11 Extra-Thick .024 Metal Siding | 23 Dexter NEV-R-ADJUST™ Brakes | 35 Plywood Floors |
| 12 R-7 Batten Insulation | 24 Heavy Duty Steel Wheels | 36 Floor Joists, 16" O.C. |

Travel Trailers

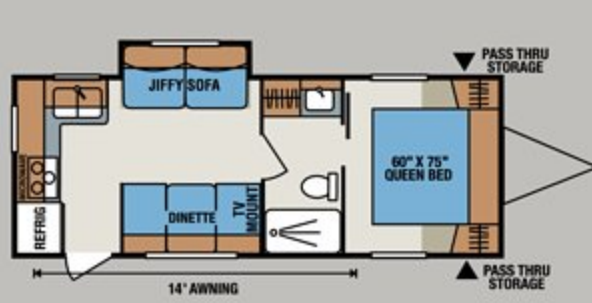

S241RKS

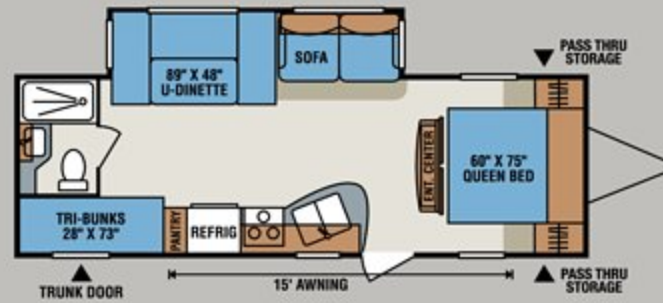

S260BH

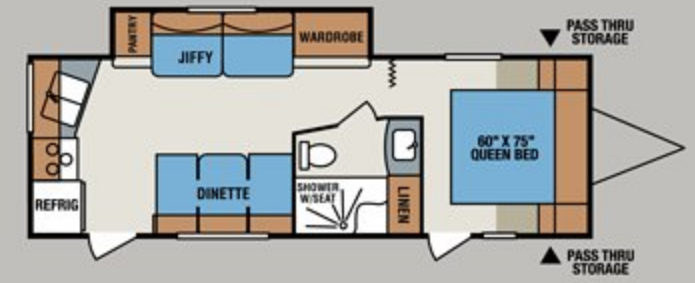

S262RK

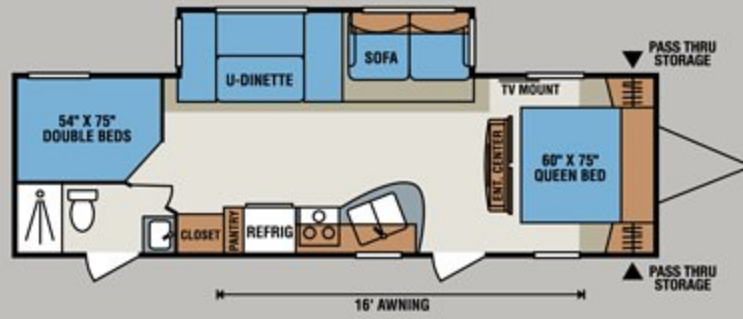

S301BH



S314BH

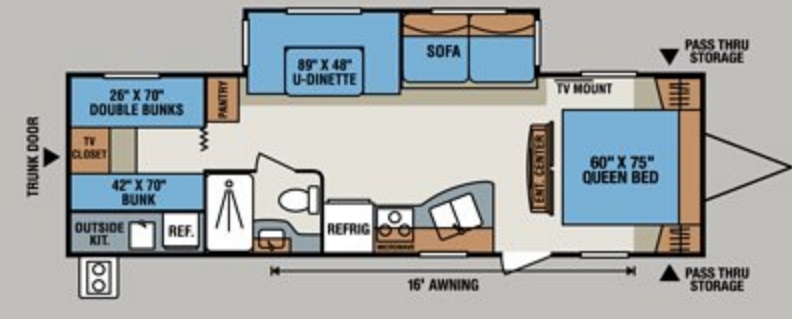

S314BHK

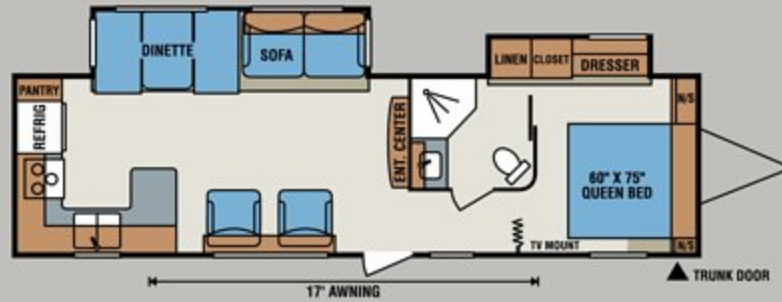

S321RKS

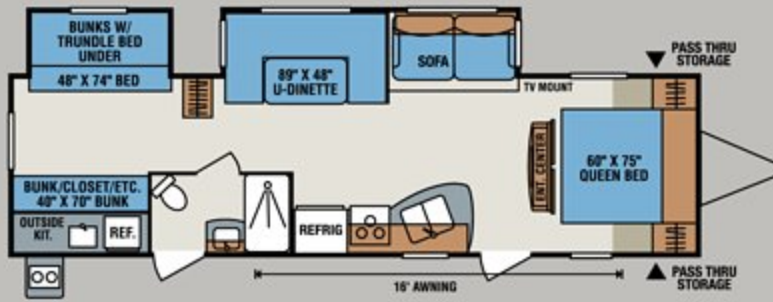

S322BHK

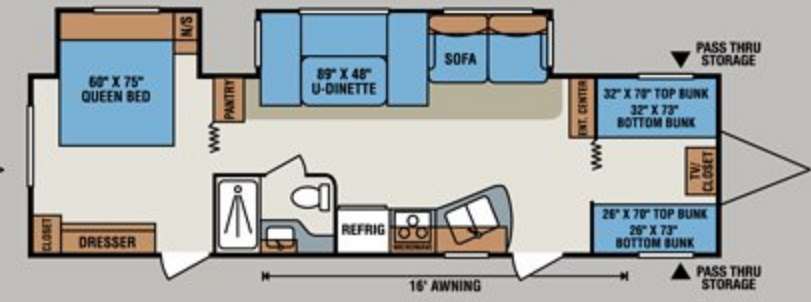

S330BH

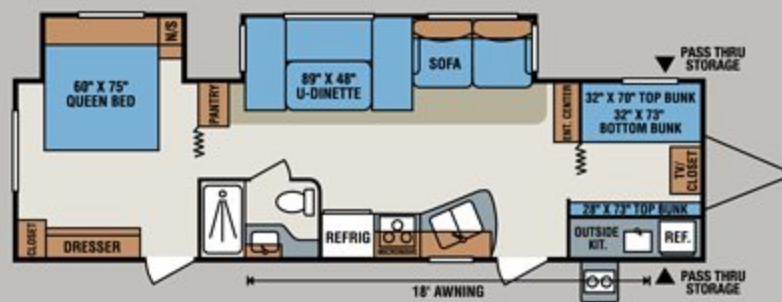

S330BHK

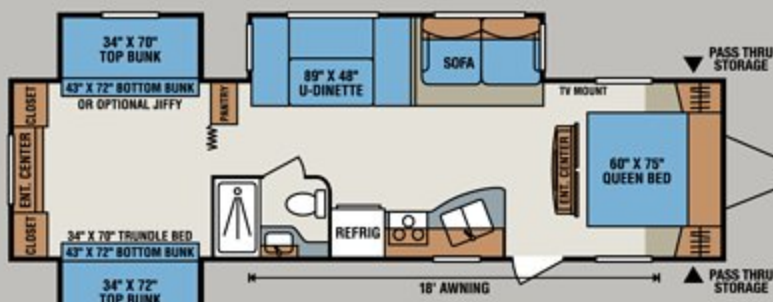

S331BH

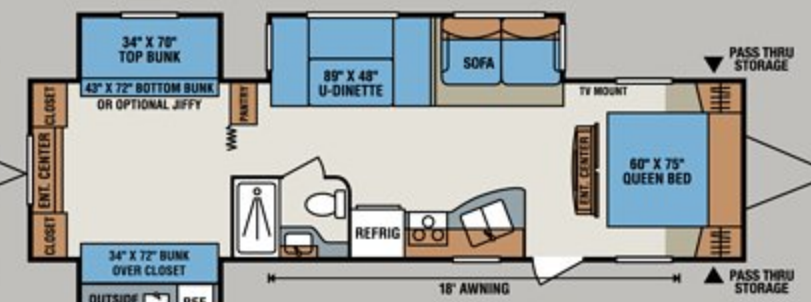

S331BHK

Travel Trailers	S241RKS	S260BH	S262RK	S301BH	S314BH	S314BHK	S321RKS	S322BHK	S330BH	S330BHK	S331BH	S331BHK
UVW (Unloaded Vehicle Weight)*	4,575	5,590	5,470	6,280	6,222	6,510	6,730	7,060	7,115	7,190	7,550	7,680
Dry Hitch Weight*	502	520	580	760	684	589	780	600	773	980	760	700
Dry Axle Weight*	4,073	5,070	4,890	5,520	5,538	5,921	5,950	6,460	6,342	6,210	6,790	6,980
NCC (Net Carrying Capacity)	1,425	1,410	1,530	1,720	1,778	1,490	2,070	1,740	1,685	1,610	1,250	1,120
GVWR	6,000	7,000	7,000	8,000	8,000	8,000	8,800	8,800	8,800	8,800	8,800	8,800
Interior Height	78"	82"	82"	82"	82"	82"	82"	82"	82"	82"	82"	82"
Exterior Height w/ A/C	10' 1"	11' 2"	11' 2"	11' 4"	11' 1"	11' 1"	11' 4"	11' 2"	11' 1"	11' 1"	11' 4"	11' 4"
Exterior Width	96"	96"	96"	96"	96"	96"	96"	96"	96"	96"	96"	96"
Exterior Length	26'	29' 3"	28' 5"	32' 6"	33'	33'	34' 3"	34' 5"	35' 2"	35' 2"	35' 6"	35' 6"
Refrigerator (cu. feet)	5	5	5	5	5	5	5	5	5	5	5	5
Water Heater Cap. (gal. G/E w/DSI)	6	6	6	6	6	6	6	6	6	6	6	6
Fresh Water Cap. (gal.)	38	40	40	38	38	38	40	40	38	38	38	38
Waste Water Cap. (gal.)	32	32	32	32	32	32	32	32	32	32	32	32
Gray Water Cap. (gal.)	32	32	64	32	32	32	32	32	32	47	32	32
LP Gas Cap. (lbs.)	40	40	40	40	40	40	40	40	40	40	40	40
Furnace BTUs (1,000s)	20	25	25	30	30	30	30	30	30	30	30	30
Tire Size	14"	14"	14"	15"	15"	15"	15"	15"	15"	15"	15"	15"
Awning	14'	15'	16'	16'	16'	16'	17'	16'	18'	18'	18'	16'

*This weight reflects the rolling average unit weight for each model. Your trailer weight will vary according to optional equipment.

Fifth Wheels

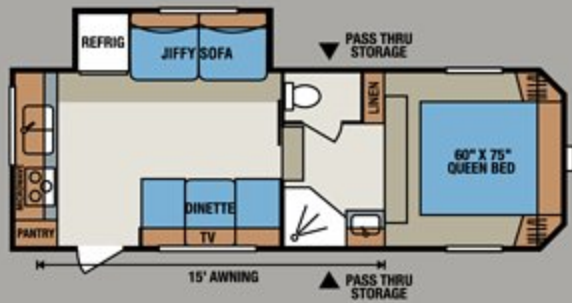

S235RK

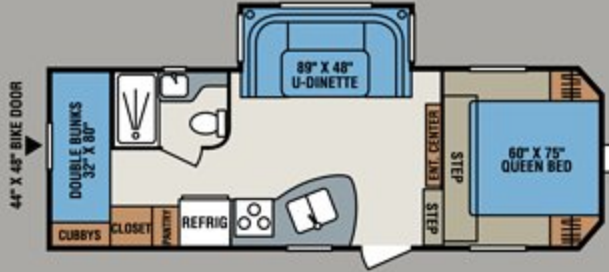

S245BH

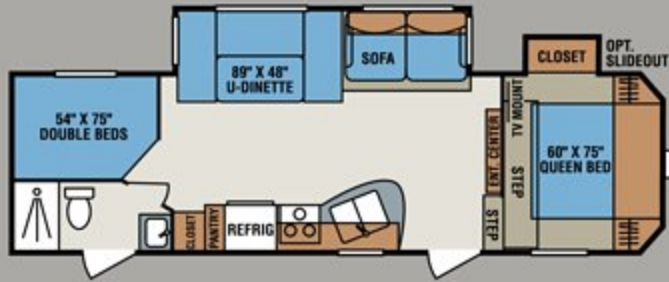

S265BH

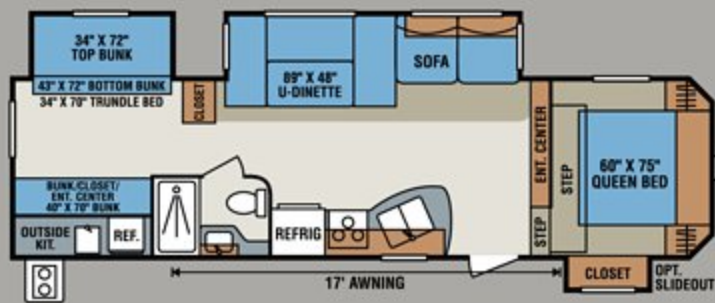

S315BHK



Reversible Cushions



Optional Deluxe Sleeper Sofa



Optional Night Shades



5 cu. ft. Refrigerator (Standard)
8 cu. ft. Refrigerator (Optional)



Optional 32" LCD TV



Standard AM/FM CD Player
Optional DVD Player



Fifth Wheels	S235RK	S245BH	S265BH	S315BHK
UVW (Unloaded Vehicle Weight)*	5,925	6,110	7,130	7,830
Dry Hitch Weight*	860	1,210	1,440	1,420
Dry Axle Weight*	5,065	4,900	5,690	6,410
NCC (Net Carrying Capacity)	1,075	1,490	1,670	970
GVWR	7,000	7,600	8,800	8,800
Interior Height	90"	90"	92"	91"
Exterior Height w/ A/C	11' 8"	12' 1"	12' 4"	11' 11"
Exterior Width	96"	96"	96"	96"
Exterior Length	25' 3"	26' 9"	30'	33' 1"
Refrigerator (cu. feet)	5	5	5	5
Water Heater Cap. (gal. G/E w/DSI)	6	6	6	6
Fresh Water Cap. (gal.)	38	38	40	38
Waste Water Cap. (gal.)	57	32	32	32
Gray Water Cap. (gal.)	89	32	32	32
LP Gas Cap. (lbs.)	40	40	40	40
Furnace BTUs (1,000s)	25	25	25	30
Tire Size	14"	14"	15"	15"
Awning	15'	16'	14'	17'

*This weight reflects the rolling average unit weight for each model. Your trailer weight will vary according to optional equipment.

Bramblewood Décor

Sedona Décor

Legacy Cherry

Standards

- 1 Piece Seamless Roof with SuperFlex Roofing Material
- 13,500 BTU A/C
- 20 lb. Gas Bottles
- 3 Burner Cook Top
- 30 Amp Service
- 5 Cubic Foot Refrigerator
- 6 Gallon Gas DSI Water Heater
- Acrylic Sink
- AM/FM CD Player
- Awning with Drip Rail and Spouts
- Bedspread
- Built-In Medicine Cabinet with Mirror in Bath
- Cable Hook Up
- Custom Wall Border
- Decorative Kitchen Backsplash
- Decorative Light Above Dinette in Slide-Out
- Decorative Pillows on Jiffy Sofa (Where Available)
- Dexter **NEV-R-ADJUST**® Brakes
- Diamond Plate Rock Guard – Front (TT)
- Enclosed Pin Box (Fifth Wheel)
- Enclosed Underbelly
- Heated Fresh Water Tank
- Innerspring Mattress
- Large Overhead Cabinets
- Microwave with Turntable
- Mini Blinds
- Monitor Panel

- New Aerodynamic Front Profile
- Norco/BAL Huck Bolted Frame (E-Coated) and A-Frame (Epoxy Painted)
- Padded Headboard
- Patio Door Light
- Power Vent in Bath
- Radius Entry Door
- Range Hood with 12V Light and Exhaust Fan
- Rear Bumper with Sewer Hose Storage
- Reversible Jiffy Pillow Back Sofa
- Roller Ball Bearing Drawer Guides
- Roof Vent in Main Bedroom
- Sink Cover
- Smooth Screwless Baggage Doors
- Solid Wood Framed Mortise and Tenon Glazed Cabinet Doors
- Tinted Windows
- Tub Surround
- TV Antenna with Booster

Options

- 15,000 BTU A/C Upgrade
- 8 Cubic Foot Refrigerator
- Black Tank Flush
- Bunk/Dinette (S330BH)
- Bunk Ladder and Railing (Where Available)
- Closet Slide (S265BH and S315BHK)
- Deluxe Sleeper Sofa
- Flip Up Bike Rack/Tray (Adds 8")

- Jiffy in Bunk Slide (S331BH ODS)
- Katching ZZ's Mattress Upgrade
- Ladder
- LCD TV 32"
- LED Lighted Power Awning
- Master Vent Fan
- Night Shades
- Outside Grill
- Power Tongue Jack
- Queen Bed IPO Bunks (S330BH)
- Recliner – 1 or 2
- Stereo with DVD Player
- Table and Chairs with Leaf
- Wired for 2nd A/C with 50 Amp Service

Standard Run Package

- 2 Exterior Speakers
- 2/4 Stabilizer Jacks
- 30# Gas Bottle with Cover
- 6 Cubic Foot Refrigerator
- AM/FM CD Player
- Assist Grab Handle
- Gas/Electric DSI Water Heater
- Outside Shower (N/A with Outside Kitchen)
- Oven
- Skylight Over Tub
- Spare Tire/Carrier/Cover
- Windows at End of Slideout (Where Available)
- Winter Bypass Kit



Optional LED Lighted Awning



Optional Bottle Cover and Power Tongue Jack



Optional Ladder



Dealer Satisfaction Index:
Ratings of manufacturers, by dealers, have consistently awarded KZ top honors for excellence of design, reliability, overall quality and value, communications and dealer support.



Portions of this brochure were used with the expressed authority of Dexter Axle, but Dexter Axle is not responsible for the accuracy of the information contained herein.



Dealer:



Join our Family Forum at www.kzfamilyforum.com

ASK ABOUT OUR 2-YEAR LIMITED WARRANTY!

For more product details and in-depth information, visit us at www.kz-rv.com



0985 N 900 W • Shipshewana, IN 46565
E-mail kz@kz-rv.com • www.kz-rv.com



Due to continual research and advances, manufacturer reserves the right to change specifications, design, price and equipment without notice, and assumes no responsibility for any error in this literature. Some items shown are not included as standard or optional equipment. ©2014KZ | 4/10/14 | 15M