



**Ultra Light
Conventional Travel Trailer**



Viking Ultra Light Conventional Travel Trailer



Viking, redefining value in towable RV's. Created with the budget conscious family in mind, the Viking travel trailers provide an affordable family camping alternative without compromising the quality and comforts of the full size units. Weighing in at around 2,500 lbs., the Viking is a breeze to tow and allows you to breeze by more gas stations than full size units. The Viking truly redefines Value when it comes to camping.

Viking Travel Trailers... a product by campers for campers!

SPECIFICATIONS	14R	15FL	15RB	16B	16FB	17BH	17FQ
Hitch Weight	312 lbs	322 lbs	251 lbs	290 lbs	318 lbs	406 lbs	298 lbs
Unloaded Vehicle Weight ¹	2335 lbs	2605 lbs	2553 lbs	2421 lbs	2503 lbs	2818 lbs	2731 lbs
GVWR	3532 lbs	3542 lbs	3471 lbs	3510 lbs	3538 lbs	3626 lbs	3518 lbs
Cargo Carrying Capacity ¹	1180 lbs	920 lbs	901 lbs	1072 lbs	1018 lbs	791 lbs	770 lbs
Exterior length (add 10-1/4" for Spare)	16'-8"	18'-7"	17'-8"	17'-9"	18'-8"	21'-8"	21'-8"
Exterior Width	88"	88"	88"	88"	88"	88"	88"
Exterior Height*	9'-8"	9'-8"	9'-8"	9'-8"	9'-8"	9'-8"	9'-8"
Interior Height	76"	76"	76"	76"	76"	76"	76"
Fresh Water Capacity**	33 gal	33 gal	33 gal	33 gal	33 gal	33 gal	33 gal
Grey Water Capacity	25 gal	25 gal	25 gal	25 gal	25 gal	25 gal	25 gal
Black Water Capacity	25 gal	25 gal	25 gal	25 gal	25 gal	25 gal	25 gal
Tire Size (Radial)	13"	13"	13"	13"	13"	13"	13"
Coupler Size	2-5/16"	2-5/16"	2-5/16"	2-5/16"	2-5/16"	2-5/16"	2-5/16"

* With Air Conditioner **Including Water Heater
¹Estimated Average based on standard build optional equipment.

Floorplans

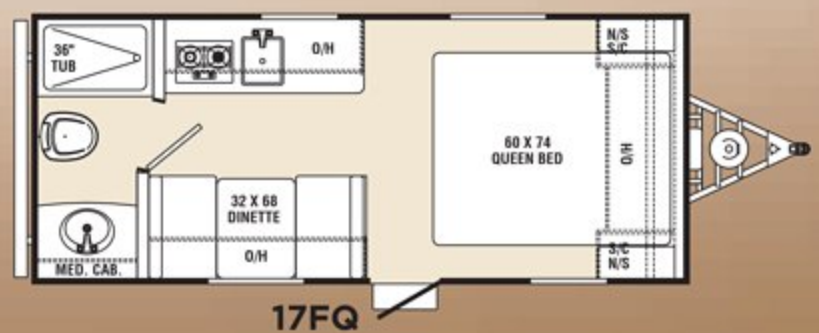
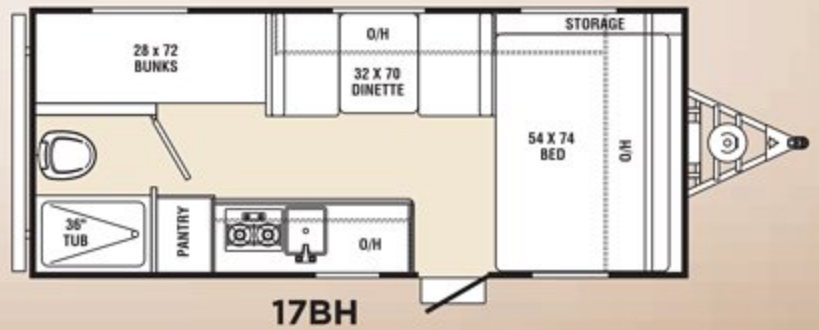
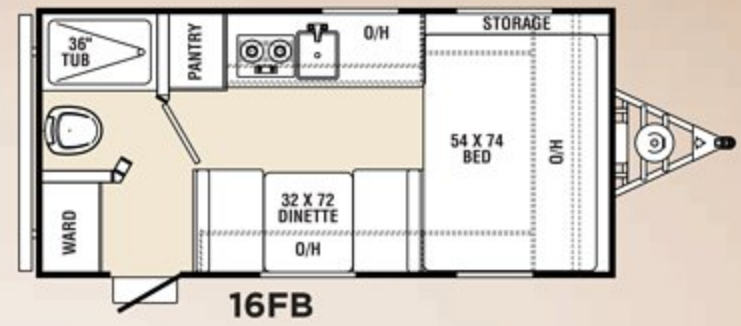
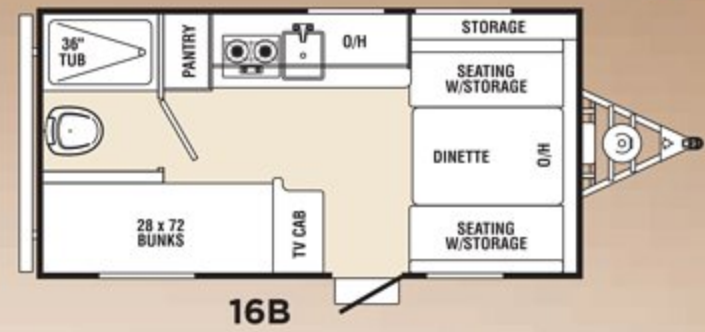
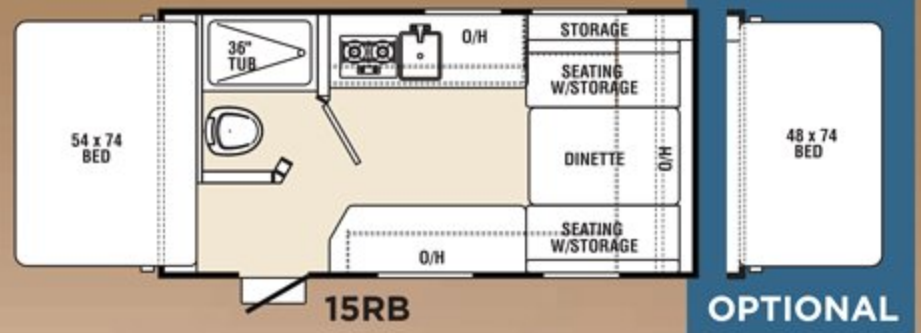
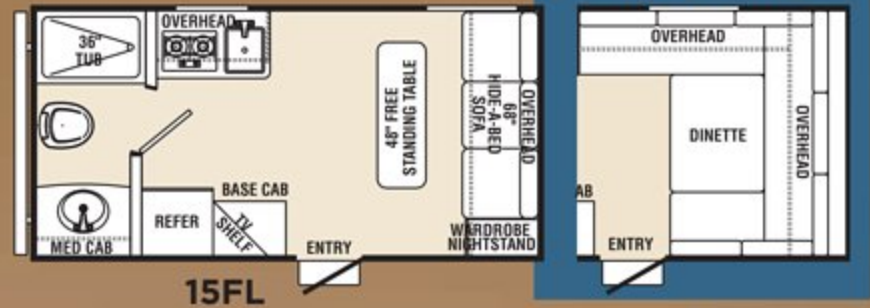
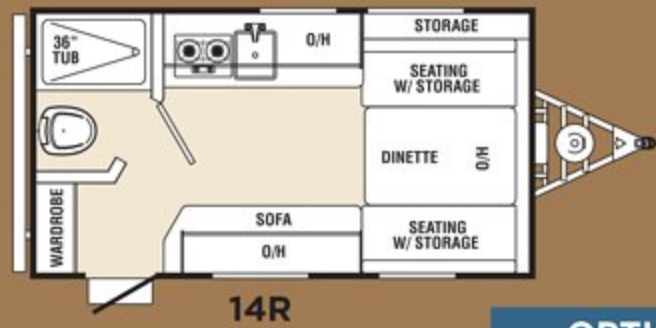

Viking Ultra Light Conventional Travel Trailer



TRAVEL EASY™ ROADSIDE ASSISTANCE

RVing is easier with Coachmen's Travel Easy™ Roadside Assistance provided FREE the first year of ownership to those who purchase a New Coachmen RV. Administered by Coach-Net, this service provides you with 24/7 operational, technical and emergency road service coverage. Also included is towing, fuel delivery, jump starts, lockout service, tire changes, mobile mechanic and unlimited technical assistance. Anywhere. Anytime. Travel Easy™ is the security of knowing that help is an easy phone call away.



FREE ONE YEAR MEMBERSHIP - COACHMEN OWNERS ASSOCIATION!

Coachmen is proud to sponsor the largest manufacturer sponsored camping club in North America ... Coachmen Owners' Association (COA). COA provides you a world of ways to enjoy your RV. This is FUN ON OVERDRIVE and provides: Free Trip Routing, Exciting Tours & Rallies, Free Campground Directory, Local/State Club Activities, Easy RVing Magazine Free, Theme Park Discounts, Fuel Discounts, Free onebigplanet® Memberships with discounts at 180,000 merchants and Much More! Every new Coachmen RV buyer is eligible for a 1 Year FREE membership in the Coachmen Owners' Association. It all adds up to an easy ownership experience!



Forest River, Inc. encourages our customers to purchase their Forest River products from a local dealership whenever possible for the following reasons:

- 1) Forest River, Inc. dealers are independently owned and operated businesses so priority service and scheduling is at their discretion and is often provided to customers that purchased their unit at that dealership.
- 2) Purchasing locally allows customers to establish meaningful relationships with a dealer, enhancing the RV experience through assistance with product questions, user tips or RV regulations for your state or country, and much more!
- 3) Canadian customers must meet requirements to bring an RV purchased out of the country to their home. These requirements may involve additional inspections and certifications, taxes and fees. Your local Canadian Dealer is a professional at meeting these requirements.
- 4) Scheduling timely warranty repairs and adjustments through a local dealership provides far greater flexibility and convenience to you, the customer!

It is the goal of Forest River, Inc. that all of our RV owners fully enjoy the RV experience and that customer satisfaction meets or exceeds their expectations!

STANDARD FEATURES

Chassis

- Powder Coated I-Beam Frame
- Ultra Lube Leaf Spring Axles
- E-Z Crank Tongue Jack
- Dual Battery Rack
- Heavy Duty Safety Chains
- Radial Tires
- Tube Style Storage Bumper
- Galvanized Wheel Wells

Exterior

- Front Window w/Rock Guard
- .024 Mesa Aluminum Exterior
- .030 Rock Guard
- Diamond Plate Front Wall Protector
- 1 Piece Radius Door w/Window
- Radius Tinted Safety Glass Windows
- Patio Light
- 110V Exterior Recept
- Radius Locking Baggage Door
- Radius Trussed Roof
- 1 Piece Rubber Roof
- 6 Sided R-7 Insulation
- Exterior Speakers
- Bike Storage Door (16B, 17BH)

Interior

- Residential Grade Flooring
- Lumbercore Cabinetry
- Deep Maple Cabinetry
- Mortise and Tenon Cabinet Doors
- High Pressure Laminated Countertops
- High Neck Sink Faucet
- Extra Deep Kitchen Sink
- Microwave
- Lighted Range Hood

- 2 Burner LP Range
- Monitor Panel
- TV Antenna w/Booster
- HDTV Cable Hook-up
- Mini Blinds
- Window Valances
- LP/CO2 Detector
- Fire Extinguisher
- Smoke Detector
- Power Bath Fan

Towable Essentials Package (Mandatory)

- 3 Cu. Ft. Dometic® Refrigerator
- 13,500 BTU A/C
- Spare Tire
- 20,000 BTU Furnace
- 6 Gal. DSI Water Heater
- 4 Crank Down Scissor Style Jacks
- AM/FM/MP3/ USB Stereo
- A & E Awning
- Electric Brakes

Options

- U-Lounge ILO Hide a Bed (15FL only)
- Front Expandable Bed (15RB only)
- Zamp 40 Watt Portable Solar Panel
- Zamp 80 Watt Portable Solar Panel

Deluxe Package

- Aluminum Wheels
- Lend a Hand Assist Handle
- Sony AM/FM/CD Player
- Pleated Night Shades
- Stainless Steel Appliances
- Tub Surround and Bath Door Mirror

VIKING

Viking Recreational Vehicles,

A Forest River Company

580 West Burr Oak Street,

P.O. Box 549, Centreville, MI 49032

www.vikingrv.com 269.467.6321

All information contained in this brochure is believed to be accurate at the time of publication. However, during the model year, it may be necessary to make revisions and Viking reserves the right to make all such changes without notice, including changes in prices, colors, materials, equipment and specifications, as well as the addition of new models and the discontinuance of models shown in this brochure. Therefore, please consult with your Viking dealer and confirm the existence of any materials, design or specifications that are material to your purchase decision.



Learn More
Scan this barcode using
a QR Reader on your
smart phone to learn
more about Forest River.



A Berkshire Hathaway company.

Your Dealer: