

# SUNDANCE



**DSI**  
Annual RVDA DEALER  
SATISFACTION INDEX  
AWARD WINNER

# XLT

Visit HEARTLAND on:

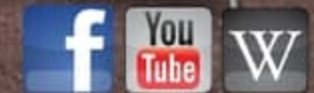

# SUNDANCE



**DSI**  
Annual RVDA DEALER  
SATISFACTION INDEX  
AWARD WINNER

# XLT

Visit HEARTLAND on:





**CURVILINEAR CEILING**



*Affordable Luxury*



Model 3280 RES in London Decor

SUNDANCE by Heartland Recreational Vehicles combines luxury, comfort and spaciousness to provide you with a high end fifth wheel at a mid profile price! Wide-open layouts are enhanced by our curvilinear ceiling giving you and your family a taller, more open, residential living space to relax and enjoy.



**CURVILINEAR CEILING**



*Affordable Luxury*



Model 3280 RES in London Decor

SUNDANCE by Heartland Recreational Vehicles combines luxury, comfort and spaciousness to provide you with a high end fifth wheel at a mid profile price! Wide-open layouts are enhanced by our curvilinear ceiling giving you and your family a taller, more open, residential living space to relax and enjoy.

## *Spacious Interiors*

Choose from a variety of multiple slide-out floor plans, including six different triple-slides and two Quad-slides featuring curvilinear ceilings offering the ultimate in interior spaciousness. Whether you need to entertain guests, prepare a large meal, or just want to enjoy camping without feeling confined, SUNDANCE provides the answer time and time again!

## *Luxurious Interiors*

SUNDANCE allows you to take all the luxuries of home with you on the road as we introduce residential designed entertainment cabinets in Walnut wood, LED lighting and large slide-out rooms with loads of storage in our overhead cabinetry with frosted glass panel doors.



*Model 3380 RL in London Decor*



*Model 3380 RL*



*Optional Theater Seating*



*Tahoe Decor*

## *Spacious Interiors*

Choose from a variety of multiple slide-out floor plans, including six different triple-slides and two Quad-slides featuring curvilinear ceilings offering the ultimate in interior spaciousness. Whether you need to entertain guests, prepare a large meal, or just want to enjoy camping without feeling confined, SUNDANCE provides the answer time and time again!

## *Luxurious Interiors*

SUNDANCE allows you to take all the luxuries of home with you on the road as we introduce residential designed entertainment cabinets in Walnut wood, LED lighting and large slide-out rooms with loads of storage in our overhead cabinetry with frosted glass panel doors.



Model 3380 RL in London Decor



Model 3380 RL



Optional Theater Seating



Tahoe Decor

# SUNDANCE

BY HEARTLAND



Model 3280 RES



# SUNDANCE

BY HEARTLAND



Model 3280 RES







## Seating for Four

Whether you choose a standard booth dinette or our optional free standing table and chairs, SUNDANCE brings comfort and a great look to your dining experience. SUNDANCE features new Walnut cabinetry with loads of storage for all your goods! Be sure to check out the hidden hinge cabinetry that all SUNDANCE models have to offer!



Model 3280-RES



## Beautiful Kitchens

SUNDANCE kitchens focus on large areas for food preparation and entertaining. Paired with our true solid surface counter tops and residential Beauflor flooring, you can count on a durable kitchen which will look great for years to come!

## Camp Kitchen

Maximize your time in the great outdoors on the patio while serving up great outdoor treats from the convenience of the outdoor camp kitchen available on select models. The camp kitchen's oversized compartment door provides added shade and shelter. The camp kitchen serves as an Outdoor Party Center.



Kitchen Storage



## Seating for Four

Whether you choose a standard booth dinette or our optional free standing table and chairs, SUNDANCE brings comfort and a great look to your dining experience. SUNDANCE features new Walnut cabinetry with loads of storage for all your goods! Be sure to check out the hidden hinge cabinetry that all SUNDANCE models have to offer!



Model 3280 RES



## Beautiful Kitchens

SUNDANCE kitchens focus on large areas for food preparation and entertaining. Paired with our true solid surface counter tops and residential Beauflor flooring, you can count on a durable kitchen which will look great for years to come!

## Camp Kitchen

Maximize your time in the great outdoors on the patio while serving up great outdoor treats from the convenience of the outdoor camp kitchen available on select models. The camp kitchen's oversized compartment door provides added shade and shelter. The camp kitchen serves as an Outdoor Party Center.



Kitchen Storage



**CURVILINEAR ROOF**



Model 3380 RL



**CURVILINEAR ROOF**



Model 3380 RL

## *Roomy Slide-Out Bedrooms*

SUNDANCE mid-profile fifth wheels feature a roomy 60" X 80" queen bed room with either a huge wardrobe slide or bed slide with built in wardrobe in the front of the bedroom. You will love the way SUNDANCE maximizes ALL storage possibilities through smart engineering and utilizing every square inch of the coach to provide you with more room for your belongings.

Included with all interior décor choices for your new SUNDANCE, you will receive our luxurious new bedroom suite décor. Our fabulous new look and attention to every detail is sure to please and make your vacation more enjoyable in your home away from home.

SUNDANCE features select floor plans with bunks for your convenience. Whether it is a half bath, or a bunk house with a huge outside camp kitchen, SUNDANCE has the answer for families of all shapes and sizes!



*Washer/Dryer Prep Available on Most Models*



## Roomy Slide-Out Bedrooms

SUNDANCE mid-profile fifth wheels feature a roomy 60" X 80" queen bed room with either a huge wardrobe slide or bed slide with built in wardrobe in the front of the bedroom. You will love the way SUNDANCE maximizes ALL storage possibilities through smart engineering and utilizing every square inch of the coach to provide you with more room for your belongings.

Included with all interior décor choices for your new SUNDANCE, you will receive our luxurious new bedroom suite décor. Our fabulous new look and attention to every detail is sure to please and make your vacation more enjoyable in your home away from home.

SUNDANCE features select floor plans with bunks for your convenience. Whether it is a half bath, or a bunk house with a huge outside camp kitchen, SUNDANCE has the answer for families of all shapes and sizes!



No Step-up Between the Bedroom and Bathroom



Washer/Dryer Prep Available on Most Models



SUNDANCE FIFTH WHEELS

# SUNDANCE

BY HEARTLAND

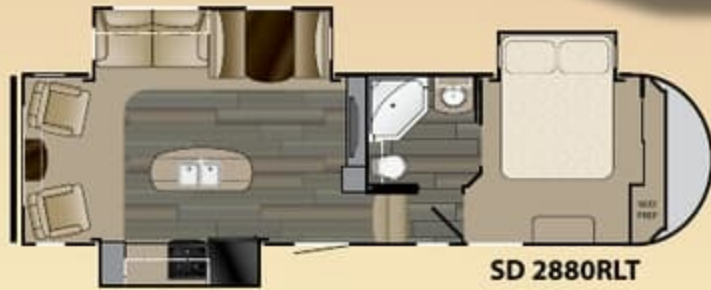

SD 2880RLT

Length: 32' 3"  
 Height: 12' 4"  
 Dry: 9,750  
 GVWR: 13,800  
 Hitch: 2,220  
 Tanks: 53<sup>F</sup> 80<sup>G</sup> 40<sup>B</sup>



SD 3000CK

Length: 32' 8"  
 Height: 12' 4"  
 Dry: 9,245  
 GVWR: 13,800  
 Hitch: 1,960  
 Tanks: 53<sup>F</sup> 80<sup>G</sup> 40<sup>B</sup>



SD 3270RES

Length: 36' 11"  
 Height: 12' 4"  
 Dry: 10,715  
 GVWR: 13,800  
 Hitch: 2,265  
 Tanks: 53<sup>F</sup> 80<sup>G</sup> 40<sup>B</sup>



SD 3280RES

Length: 36' 11"  
 Height: 12' 4"  
 Dry: 10,740  
 GVWR: 13,800  
 Hitch: 2,270  
 Tanks: 53<sup>F</sup> 80<sup>G</sup> 40<sup>B</sup>



SD 3300CK

Length: 36' 10"  
 Height: 12' 4"  
 Dry: 10,700  
 GVWR: 13,920  
 Hitch: 2,165  
 Tanks: 53<sup>F</sup> 80<sup>G</sup> 40<sup>B</sup>



SD 3310MKS

Length: 37' 3"  
 Dry: 10,600  
 GVWR: 13,800  
 Height: 12' 4"  
 Hitch: 1,945  
 Tanks: 53<sup>F</sup> 80<sup>G</sup> 40<sup>B</sup>

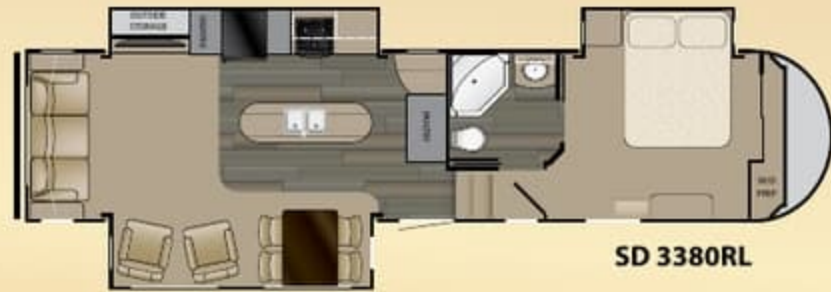

SD 3380RL

Length: 37' 6"  
 Dry: 10,996  
 GVWR: 13,800  
 Height: 12' 4"  
 Hitch: 2,115  
 Tanks: 53<sup>F</sup> 80<sup>G</sup> 40<sup>B</sup>



SD 3400QB

Length: 38' 3"  
 Dry: 11,232  
 GVWR: 13,800  
 Height: 12' 4"  
 Hitch: 1,745  
 Tanks: 53<sup>F</sup> 80<sup>G</sup> 80<sup>B</sup>



SD 3600QB

Length: 41' 7"  
 Dry: TBD  
 GVWR: 12,860  
 Height: 12' 6"  
 Hitch: TBD  
 Tanks: 53<sup>F</sup> 80<sup>G</sup> 80<sup>B</sup>

Note: Length defined as tow point (Ball coupler for travel trailers / King pin for 5th wheel trailers) to rear bumper. It does not include the rear ladder. Add 9" w/ Extended Pin Box

SUNDANCE FIFTH WHEELS

# SUNDANCE

BY HEARTLAND

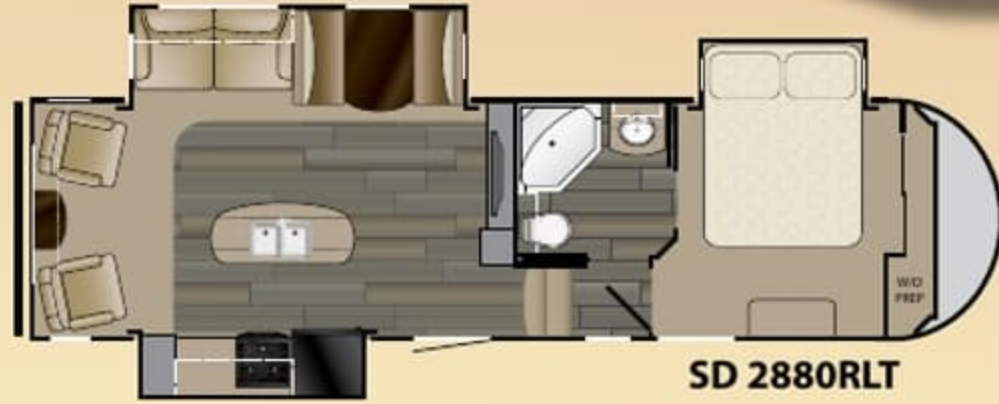

**SD 2880RLT**

Length: 32' 3"  
 Height: 12' 4"  
 Dry: 9,750  
 GVWR: 13,800  
 Hitch: 2,220  
 Tanks: 53<sup>F</sup> 80<sup>G</sup> 40<sup>B</sup>

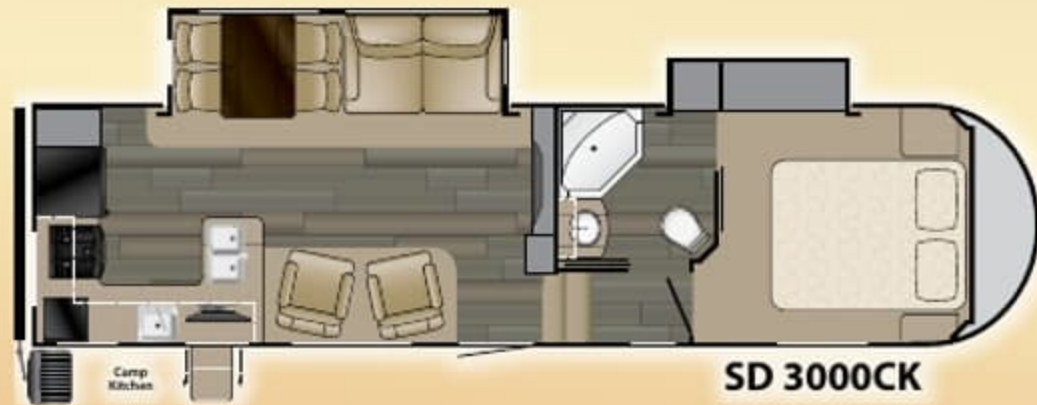

**SD 3000CK**

Length: 32' 8"  
 Height: 12' 4"  
 Dry: 9,245  
 GVWR: 13,800  
 Hitch: 1,960  
 Tanks: 53<sup>F</sup> 80<sup>G</sup> 40<sup>B</sup>



**SD 3270RES**

Length: 36' 11"  
 Height: 12' 4"  
 Dry: 10,715  
 GVWR: 13,800  
 Hitch: 2,265  
 Tanks: 53<sup>F</sup> 80<sup>G</sup> 40<sup>B</sup>



**SD 3280RES**

Length: 36' 11"  
 Height: 12' 4"  
 Dry: 10,740  
 GVWR: 13,800  
 Hitch: 2,270  
 Tanks: 53<sup>F</sup> 80<sup>G</sup> 40<sup>B</sup>



**SD 3300CK**

Length: 36' 10"  
 Height: 12' 4"  
 Dry: 10,700  
 GVWR: 13,920  
 Hitch: 2,165  
 Tanks: 53<sup>F</sup> 80<sup>G</sup> 40<sup>B</sup>



**SD 3310MKS**

Length: 37' 3"  
 Dry: 10,600  
 GVWR: 13,800  
 Height: 12' 4"  
 Hitch: 1,945  
 Tanks: 53<sup>F</sup> 80<sup>G</sup> 40<sup>B</sup>

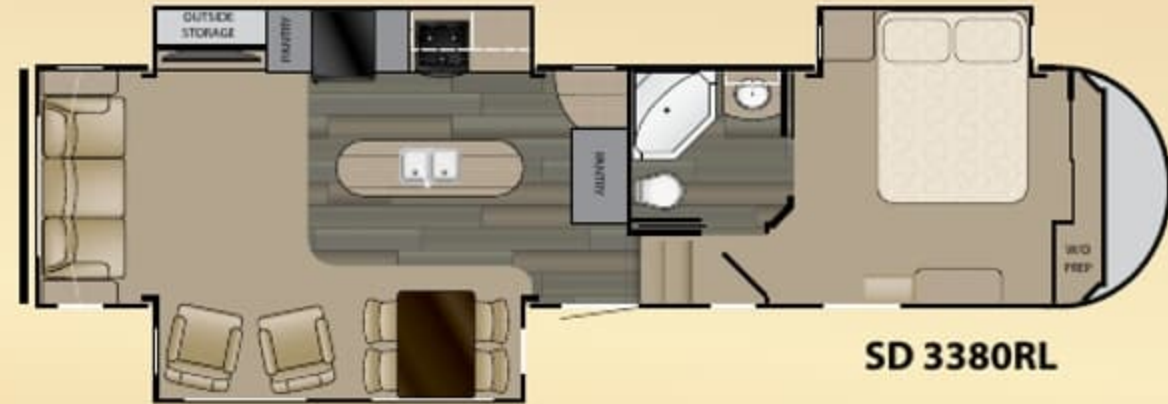

**SD 3380RL**

Length: 37' 6"  
 Dry: 10,996  
 GVWR: 13,800  
 Height: 12' 4"  
 Hitch: 2,115  
 Tanks: 53<sup>F</sup> 80<sup>G</sup> 40<sup>B</sup>

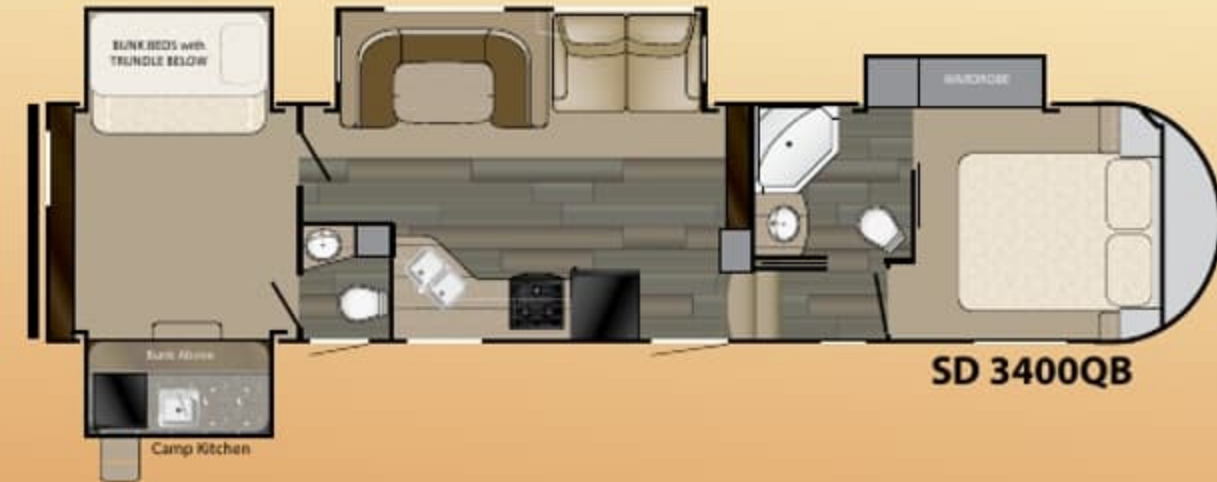

**SD 3400QB**

Length: 38' 3"  
 Dry: 11,232  
 GVWR: 13,800  
 Height: 12' 4"  
 Hitch: 1,745  
 Tanks: 53<sup>F</sup> 80<sup>G</sup> 80<sup>B</sup>

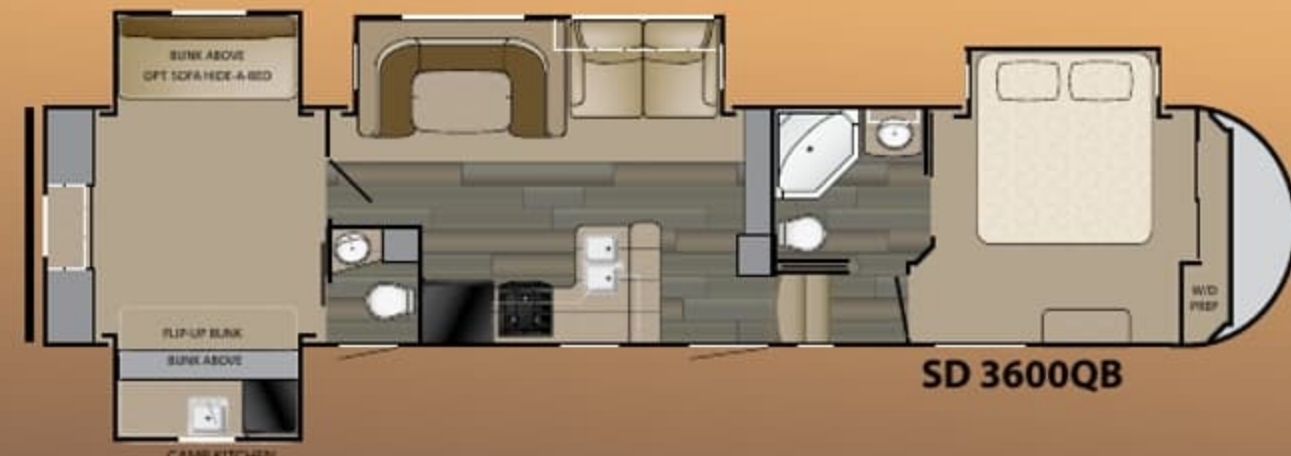

**SD 3600QB**

Length: 41' 7"  
 Dry: TBD  
 GVWR: 12,860  
 Height: 12' 6"  
 Hitch: TBD  
 Tanks: 53<sup>F</sup> 80<sup>G</sup> 80<sup>B</sup>

Note: Length defined as tow point (Ball coupler for travel trailers / King pin for 5th wheel trailers) to rear bumper. It does not include the rear ladder. Add 9" w/ Extended Pin Box



## STANDARD FEATURES

### EXTERIOR

- 5" curvilinear galvanized roof trusses
- Universal docking center
- E-Z lube hubs
- Equa-Flex suspension
- Electric patio awning with LED light
- Factory installed roof ladder (most models)
- Easy access electric outlet for awning lights
- Exterior stereo speakers
- 1-Piece ABS underbelly
- FLEXFOIL insulation in underbelly
- FLEXFOIL insulation on bath/bed deck
- One-piece rubber roofing material
- Large assist entry handle
- Dual 30 lb. LP tanks
- Exterior propane quick connect
- 30" radius entry door
- Water heater bypass
- 50 Amp electrical service (FW only)
- Security light
- Forced air heated and enclosed holding tanks and valves (FW only)
- Painted aerodynamic fiberglass front cap with LED marker lighting
- Triple entry step (FW only)
- Electric powered front jacks (FW only)
- Spare tire
- Outside shower
- Aluminum wheels with dexter axles

- "Correct Track" alignment system
- Frameless windows

### PREMIER KITCHEN

- Solid surface countertops
- Glazed walnut cabinetry
- Deep 50/50 kitchen sink
- Full extension ball-bearing drawer guides
- Pull-out kitchen faucet
- Premium beauflor residential flooring
- 22" oven with igniter (FW only)
- 8 Cu. Ft. refrigerator (FW only)

### BATH

- Large bathtub (3270RES, 3310MKS, 3280RES)
- Power roof vent
- Large medicine cab. with mirror and lights
- Porcelain toilet with foot flush
- Heat duct and A/C vents

### BEDROOM

- Up to 6'-4" bedroom ceiling height
- Flush floor bed and bath upper deck
- Lift-up, finished bed storage (FW only)
- Shoe rack in closet (bed slide models)
- Second A/C prep
- Washer dryer prep (most FW models)

### LIVING AREA

- Quick recovery gas/electric DSI hot water heater

- High-end push back recliners (some models)
- Coat closet (most models)
- Flush floor slide-outs
- Adjustable A/C vents for improved air flow
- Sofa bed
- Over the slide room 9"x36" window (FW only)

### POPULAR FEATURES:

- LED interior lighting
- Black tank flush system
- 12V AM/FM CD/DVD with Bluetooth
- 60" x 80" Queen bed
- 70" x 80" King bed (3270RES, 3310MKS, 3280RES)
- Spring loaded hidden hinges
- Snap jack pins for landing gear (FW only)
- 35,000 BTU high capacity furnace
- Tinted safety glass windows

### Travel Trailer FEATURES

- High gloss fiberglass
- Painted front cap
- Solid surface countertops
- 60x74" Queen bed
- 4 Electric stabilizer jacks
- 4 Point hydraulic Level-Up option

## OPTIONS:

- Countertop extension (where available)
- Electric rear jacks (FW only)
- Fireplace (where available)
- Free standing dinette chairs and table with storage in both
- U-shape dinette (3400QB & 3600QB only)
- Swivel glider recliners
- 15,000 BTU A/C
- Dual pane windows
- 32" TV option
- 40" TV option (most models)
- 2nd AC in bedroom
- 12 cu. ft. refrigerator (3000CK, 3380RL)
- Theater seating (3380RL, 3280RES)
- 50 Amp with 2nd A/C option (TT only)
- Fantastic fan in living room (FW only)

## PLATINUM PACKAGES

### Fifth Wheel PLATINUM PACKAGE:

- High gloss taupe colored fiberglass
- Fully painted metallic front fiberglass cap
- Solid surface on rear entertainment center
- Electric rear jacks

### Travel Trailer PLATINUM PACKAGE:

- High gloss taupe colored fiberglass
- Fully painted metallic front fiberglass cap

# TRAVEL TRAILERS



SD 288RLS

Length: 31' 11"  
 Height: 11'5"  
 Dry: 7,470  
 GVWR: 10,500  
 Hitch: 1,028  
 Tanks: 53<sup>F</sup> 80<sup>G</sup> 40<sup>B</sup>



SD 322RES

Length: 35' 5"  
 Height: 11'7"  
 Dry: 8,750  
 GVWR: 10,500  
 Hitch: 950  
 Tanks: 53<sup>F</sup> 40<sup>G</sup> 40<sup>B</sup>

## STANDARD FEATURES

### EXTERIOR

- 5" curvilinear galvanized roof trusses
- Universal docking center
- E-Z lube hubs
- Equa-Flex suspension
- Electric patio awning with LED light
- Factory installed roof ladder (most models)
- Easy access electric outlet for awning lights
- Exterior stereo speakers
- 1-Piece ABS underbelly
- FLEXFOIL insulation in underbelly
- FLEXFOIL insulation on bath/bed deck
- One-piece rubber roofing material
- Large assist entry handle
- Dual 30 lb. LP tanks
- Exterior propane quick connect
- 30" radius entry door
- Water heater bypass
- 50 Amp electrical service (FW only)
- Security light
- Forced air heated and enclosed holding tanks and valves (FW only)
- Painted aerodynamic fiberglass front cap with LED marker lighting
- Triple entry step (FW only)
- Electric powered front jacks (FW only)
- Spare tire
- Outside shower
- Aluminum wheels with dexter axles

- "Correct Track" alignment system
- Frameless windows

### PREMIER KITCHEN

- Solid surface countertops
- Glazed walnut cabinetry
- Deep 50/50 kitchen sink
- Full extension ball-bearing drawer guides
- Pull-out kitchen faucet
- Premium beauflor residential flooring
- 22" oven with igniter (FW only)
- 8 Cu. Ft. refrigerator (FW only)

### BATH

- Large bathtub (327ORES, 3310MKS, 3280RES)
- Power roof vent
- Large medicine cab. with mirror and lights
- Porcelain toilet with foot flush
- Heat duct and A/C vents

### BEDROOM

- Up to 6'-4" bedroom ceiling height
- Flush floor bed and bath upper deck
- Lift-up, finished bed storage (FW only)
- Shoe rack in closet (bed slide models)
- Second A/C prep
- Washer dryer prep (most FW models)

### LIVING AREA

- Quick recovery gas/electric DSI hot water heater

- High-end push back recliners (some models)
- Coat closet (most models)
- Flush floor slide-outs
- Adjustable A/C vents for improved air flow
- Sofa bed
- Over the slide room 9"x36" window (FW only)

### POPULAR FEATURES:

- LED interior lighting
- Black tank flush system
- 12V AM/FM CD/DVD with Bluetooth
- 60" x 80" Queen bed  
70" x 80" King bed (327ORES, 3310MKS, 3280RES)
- Spring loaded hidden hinges
- Snap jack pins for landing gear (FW only)
- 35,000 BTU high capacity furnace
- Tinted safety glass windows

### OPTIONS:

- Countertop extension (where available)
- Electric rear jacks (FW only)
- Fireplace (where available)
- Free standing dinette chairs and table with storage in both
- U-shape dinette (3400QB & 3600QB only)
- Swivel glider recliners
- 15,000 BTU A/C
- Dual pane windows
- 32" TV option
- 40" TV option (most models)
- 2nd AC in bedroom
- 12 cu. ft. refrigerator (3000CK, 3380RL)
- Theater seating (3380RL, 3280RES)
- 50 Amp with 2nd A/C option (TT only)
- Fantastic fan in living room (FW only)

### PLATINUM PACKAGES

#### Fifth Wheel PLATINUM PACKAGE:

- High gloss taupe colored fiberglass
- Fully painted metallic front fiberglass cap
- Solid surface on rear entertainment center
- Electric rear jacks

#### Travel Trailer PLATINUM PACKAGE:

- High gloss taupe colored fiberglass
- Fully painted metallic front fiberglass cap

### Travel Trailer FEATURES

- High gloss fiberglass
- Painted front cap
- Solid surface countertops
- 60x74" Queen bed
- 4 Electric stabilizer jacks
- 4 Point hydraulic Level-Up option

# TRAVEL TRAILERS

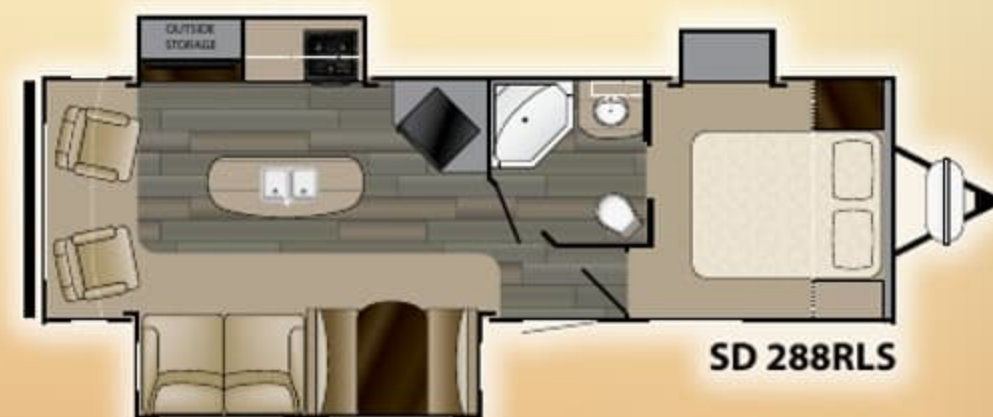

Length: 31' 11"  
Height: 11'5"  
Dry: 7,470  
GVWR: 10,500  
Hitch: 1,028  
Tanks: 53<sup>F</sup> 80<sup>G</sup> 40<sup>B</sup>



Length: 35' 5"  
Height: 11'7"  
Dry: 8,750  
GVWR: 10,500  
Hitch: 950  
Tanks: 53<sup>F</sup> 40<sup>G</sup> 40<sup>B</sup>

# XLT



Model 278 TS

# XLT



Model 278 TS



Londen Decor



Tahoe Decor



## *Lighter Weight. Full Featured.*

Whether you are looking for a 1/2 ton towable or are just tired of hauling around and maintaining a larger luxury unit, XLT answers the call by providing you the luxury amenities of our top selling SUNDANCE in a smaller, lighter, easily manageable, fully laminated, fifth wheel. From single slide couples coaches to triple slide units with bedroom slides, XLT provides multiple possibilities to meet your exact camping and travel needs.



Model 285 TS



Londen Decor



Tahoe Decor



# Lighter Weight. Full Featured.

Whether you are looking for a 1/2 ton towable or are just tired of hauling around and maintaining a larger luxury unit, XLT answers the call by providing you the luxury amenities of our top selling SUNDANCE in a smaller, lighter, easily manageable, fully laminated, fifth wheel. From single slide couples coaches to triple slide units with bedroom slides, XLT provides multiple possibilities to meet your exact camping and travel needs.



Model 285 TS





Model 278 TS



Model 285 TS



Model 278 TS



Model 285 TS





# Strength, Durability and Comfort **BEYOND COMPARE!**

These three laminated systems bring you the Strongest and Lightest construction available. Combined they also provide unparalleled thermal insulation, noise reduction and long term durability. Protecting your investment is important to HEARTLAND. Laminated construction provides that protection.

**YOUR LAMINATED WORLD...**



## Laminated **ROOF** System

- Seamless Rubber Roof Skin
- Wood Decking
- Block Foam Insulation
- Aluminum Ribs and Perimeter
- Decorative, Textured Ceiling Vinyl

## Laminated **SIDEWALL** System

- Lightweight Aluminum Structure
- Double Welded
- 1½" Thick Block Foam Insulation
- Two Inches Thick Overall
- High Gloss Fiberglass Skin



A 1/8" thin coffee cup can protect your hand from scalding hot coffee - consider the protection Heartland's sidewalls offer featuring 1.5" block foam insulation



## Laminated **FLOOR** System

- Sturdy Aluminum Framing
- Thick Block Foam Insulation
- Seamless Decking on Top
- Thermo-Board Luan Underneath.

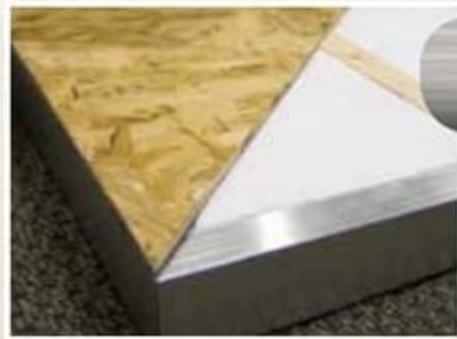

Heartland's laminated floor construction easily supported over 1,800 lbs. of water jugs in one spot - resulting in less flex!!



# Strength, Durability and Comfort **BEYOND COMPARE!**

These three laminated systems bring you the Strongest and Lightest construction available. Combined they also provide unparalleled thermal insulation, noise reduction and long term durability. Protecting your investment is important to HEARTLAND. Laminated construction provides that protection.

**YOUR LAMINATED WORLD...**



## Laminated **ROOF** System

- Seamless Rubber Roof Skin
- Wood Decking
- Block Foam Insulation
- Aluminum Ribs and Perimeter
- Decorative, Textured Ceiling Vinyl

## Laminated **SIDEWALL** System

- Lightweight Aluminum Structure
- Double Welded
- 1½" Thick Block Foam Insulation
- Two Inches Thick Overall
- High Gloss Fiberglass Skin



A 1/8" thin coffee cup can protect your hand from scalding hot coffee - consider the protection Heartland's sidewalls offer featuring 1.5" block foam insulation



## Laminated **FLOOR** System

- Sturdy Aluminum Framing
- Thick Block Foam Insulation
- Seamless Decking on Top
- Thermo-Board Luan Underneath.

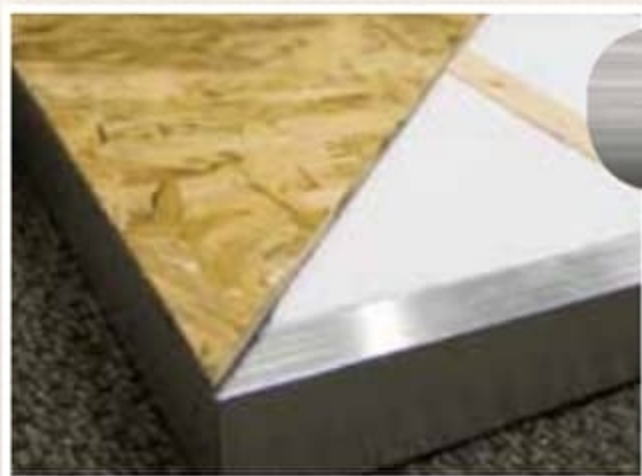

Heartland's laminated floor construction easily supported over 1,800 lbs. of water jugs in one spot - resulting in less flex!!

# SUPERIOR CONSTRUCTION AND DESIGN TRANSLATE INTO A SUPERIOR VALUE!

## XLT



STUNNING FRONT CAP DESIGN

**Perfect for Short-Bed, Extended-Cab Trucks**



AM/FM CD/DVD Stereo with zone control for outdoor, bedroom or living areas. control the stereo from your Bluetooth enabled smart phone, stream music from your smart phone through the Wireless Link system.



Flex-Foil Insulation:

An insulated blanket of double, flex-foil insulation is laid the full length of the underbelly, bedroom/bathroom deck providing maximum energy efficiency.



2° of Slope assists in removal of any sediment buildup when emptying the black tank.



Length: 26' 4"  
Height: 11' 10"  
Dry: 6,354  
GVWR: 9,900  
Hitch: 1,135  
Tanks: 53<sup>F</sup> 40<sup>G</sup> 40<sup>B</sup>



SD XLT 245 RL

Length: 28' 5"  
Height: 11' 10"  
Dry: 6,778  
GVWR: 9,900  
Hitch: 1,270  
Tanks: 53<sup>F</sup> 80<sup>G</sup> 40<sup>B</sup>



SD XLT 265RK

Length: 28' 3"  
Height: 11' 10"  
Dry: 7,262  
GVWR: 9,900  
Hitch: TBD  
Tanks: 53<sup>F</sup> 40<sup>G</sup> 40<sup>B</sup>



SD XLT 267RL

## XLT



SD XLT 23 SDS

Length: 26' 11"  
Dry: 5,300

# SUPERIOR CONSTRUCTION AND DESIGN TRANSLATE INTO A SUPERIOR VALUE!

# XLT



STUNNING FRONT CAP DESIGN  
**Perfect for Short-Bed, Extended-Cab Trucks**



AM/FM CD/DVD Stereo with zone control for outdoor, bedroom or living areas. control the stereo from your Bluetooth enabled smart phone, stream music from your smart phone through the Wireless Link system.



Flex-Foil Insulation:

An insulated blanket of double, flex-foil insulation is laid the full length of the underbelly, bedroom/bathroom deck providing maximum energy efficiency.



2° of Slope assists in removal of any sediment buildup when emptying the black tank.



Length: 26' 4"  
Height: 11' 10"  
Dry: 6,354  
GVWR: 9,900  
Hitch: 1,135  
Tanks: 53<sup>F</sup> 40<sup>G</sup> 40<sup>B</sup>



SD XLT 245 RL

Length: 28' 5"  
Height: 11' 10"  
Dry: 6,778  
GVWR: 9,900  
Hitch: 1,270  
Tanks: 53<sup>F</sup> 80<sup>G</sup> 40<sup>B</sup>

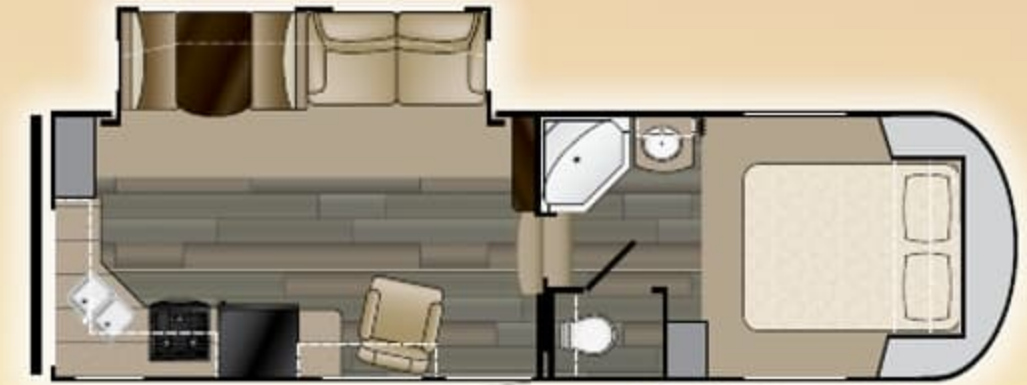

SD XLT 265RK

Length: 28' 3"  
Height: 11' 10"  
Dry: 7,262  
GVWR: 9,900  
Hitch: TBD  
Tanks: 53<sup>F</sup> 40<sup>G</sup> 40<sup>B</sup>



SD XLT 267RL

# XLT

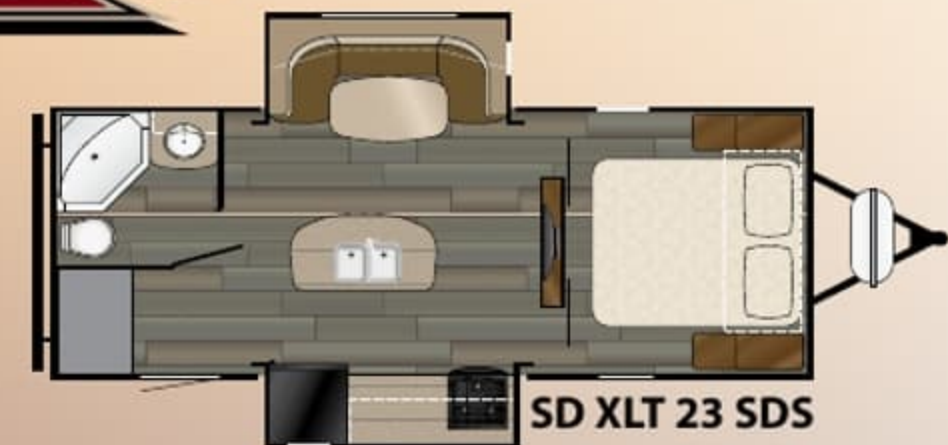

SD XLT 23 SDS  
Length: 26' 11"  
Dry: 5,300

Length: 31' 4"  
 Height: 11' 10"  
 Dry: 8,616  
 GVWR: 9,900  
 Hitch: 1,640  
 Tanks: 53<sup>F</sup> 40<sup>G</sup> 40<sup>B</sup>

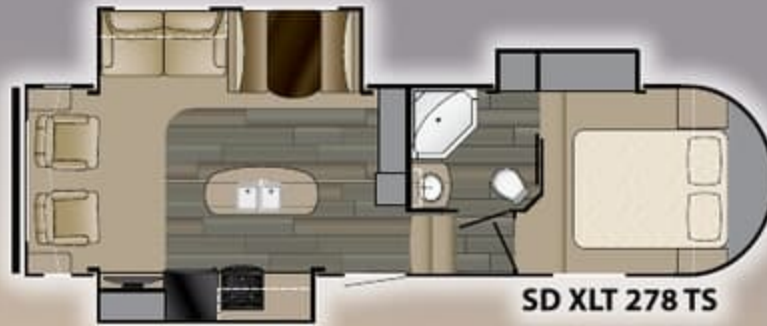

SD XLT 278 TS

Length: 31' 4"  
 Height: 11' 10"  
 Dry: 7,770  
 GVWR: 9,900  
 Hitch: 1,660  
 Tanks: 53<sup>F</sup> 40<sup>G</sup> 40<sup>B</sup>



SD XLT 285 TS

Length: 33' 11"  
 Height: 11' 10"  
 Dry: 8,810  
 GVWR: 9,900  
 Hitch: 1,750  
 Tanks: 53<sup>F</sup> 80<sup>G</sup> 40<sup>B</sup>



SD XLT 298BH

## STANDARDS

### INTERIOR

- Solid surface residential counter tops
- 78" interior height (FW only)
- Ducted 13.5 A/C
- 12 Volt AM/FM CD/DVD player with Bluetooth
- Glazed walnut cabinets
- Sofa bed (N/A 245RL, 267RL)

### KITCHEN

- Full extension ball-bearing drawer guides
- Pull-out kitchen faucet
- Oven and microwave
- Residential quality Beauflor
- Double door refrigerator
- 8 cu. ft. refrigerator (278TS, 285TS only)
- Large dual basin sink

### BEDROOM / BATH AREA

- 60" x 80" Queen bed mattress (FW only)
- Bedroom night stands
- Cable TV hook-up
- Shower skylight
- Large medicine cabinet
- Power vent in bathroom
- Porcelain foot flush toilet (FW only)

### EXTERIOR

- One-piece ABS underbelly
- Dexter axles with E-Z lube hubs
- 15" tires and aluminum wheels
- Outside speakers
- Outside shower
- Electric patio awning with LED light (opt. TT)
- Spare tire (opt. TT)
- One-piece rubber roofing material
- Fiberglass front cap (FW only)

### FEATURES

- LED interior lighting
- 30,000 BTU furnace
- Universal Docking Center (U.D.C.)
- Quick recovery gas/electric DSI water heater
- Enclosed Underbelly (FW only)
- Electric Slide Outs (FW only)
- Black Tank Flush System (FW only)
- Slam Baggage Doors (FW only)

### OPTIONS

- 15K BTU A/C (FW only)
- 50 Amp w/ 2nd A/C
- 32" TV
- Freestanding Dinette & Chairs (Forced 285TS) (most models)

### LITE-WEIGHT STRENGTH PKG (FW only)

- Laminated Crowned Roof
- Block Foam Brick Insulation
- Aluminum Construction (front, back and side walls, floor, roof)
- Enclosed Underbelly
- Triple Entry Step
- Tinted Safety Glass Windows
- 2" Thick Sidewall Construction
- 2 Rear Stabilizer Jacks
- HD Leaf Spring Suspension
- Two 30 lb. Dual LP Tanks

### Platinum Package (FW only)

- Fully Painted Metallic Front Cap
- High Gloss Taupe Colored Fiberglass
- ABS Hitch Cover

# ULTRA-LITE TRAVEL TRAILERS



SD XLT 24BHSS

Length: 27' 11"  
 Dry: 5,500



SD XLT 27 SSRL

Length: 30' 2"  
 Dry: 5,700



SD XLT 32 BHSS

Length: 36' 10"  
 Dry: 7,595

Length: 31' 4"  
 Height: 11' 10"  
 Dry: 8,616  
 GVWR: 9,900  
 Hitch: 1,640  
 Tanks: 53<sup>F</sup> 40<sup>G</sup> 40<sup>B</sup>

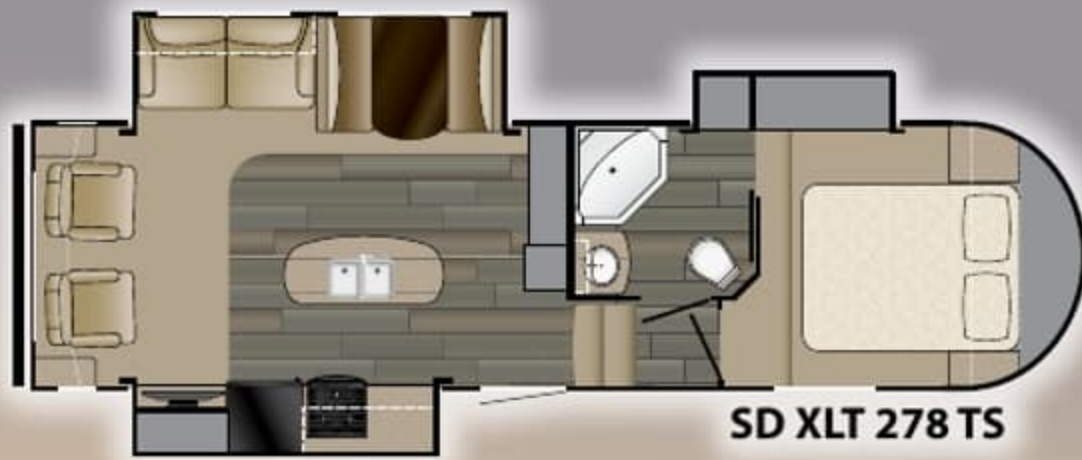

SD XLT 278 TS

Length: 31' 4"  
 Height: 11' 10"  
 Dry: 7,770  
 GVWR: 9,900  
 Hitch: 1,660  
 Tanks: 53<sup>F</sup> 40<sup>G</sup> 40<sup>B</sup>



SD XLT 285 TS

Length: 33' 11"  
 Height: 11' 10"  
 Dry: 8,810  
 GVWR: 9,900  
 Hitch: 1,750  
 Tanks: 53<sup>F</sup> 80<sup>G</sup> 40<sup>B</sup>



SD XLT 298BH

## STANDARDS

### INTERIOR

- Solid surface residential counter tops
- 78" interior height (FW only)
- Ducted 13.5 A/C
- 12 Volt AM/FM CD/DVD player with Bluetooth
- Glazed walnut cabinets
- Sofa bed (N/A 245RL, 267RL)

### KITCHEN

- Full extension ball-bearing drawer guides
- Pull-out kitchen faucet
- Oven and microwave
- Residential quality Beauflor
- Double door refrigerator
- 8 cu. ft. refrigerator (278TS, 285TS only)
- Large dual basin sink

### BEDROOM / BATH AREA

- 60" x 80" Queen bed mattress (FW only)
- Bedroom night stands
- Cable TV hook-up
- Shower skylight
- Large medicine cabinet
- Power vent in bathroom
- Porcelain foot flush toilet (FW only)

### EXTERIOR

- One-piece ABS underbelly
- Dexter axles with E-Z lube hubs
- 15" tires and aluminum wheels
- Outside speakers
- Outside shower
- Electric patio awning with LED light (opt. TT)
- Spare tire (opt. TT)
- One-piece rubber roofing material
- Fiberglass front cap (FW only)

### FEATURES

- LED interior lighting
- 30,000 BTU furnace
- Universal Docking Center (U.D.C.)
- Quick recovery gas/electric DSI water heater
- Enclosed Underbelly (FW only)
- Electric Slide Outs (FW only)
- Black Tank Flush System (FW only)
- Slam Baggage Doors (FW only)

### OPTIONS

- 15K BTU A/C (FW only)
- 50 Amp w/ 2nd A/C
- 32" TV
- Freestanding Dinette & Chairs (Forced 285TS) (most models)

### LITE-WEIGHT STRENGTH PKG (FW only)

- Laminated Crowned Roof
- Block Foam Brick Insulation
- Aluminum Construction (front, back and side walls, floor, roof)
- Enclosed Underbelly
- Triple Entry Step
- Tinted Safety Glass Windows
- 2" Thick Sidewall Construction
- 2 Rear Stabilizer Jacks
- HD Leaf Spring Suspension
- Two 30 lb. Dual LP Tanks

### Platinum Package (FW only)

- Fully Painted Metallic Front Cap
- High Gloss Taupe Colored Fiberglass
- ABS Hitch Cover

# ULTRA-LITE TRAVEL TRAILERS

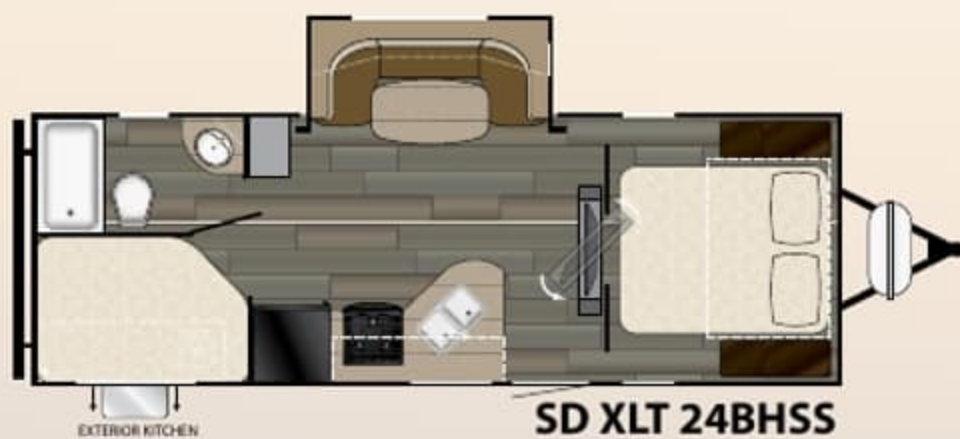

SD XLT 24BHSS

Length: 27' 11"  
 Dry: 5,500



SD XLT 27 SSRL

Length: 30' 2"  
 Dry: 5,700



SD XLT 32 BHTS

Length: 36' 10"  
 Dry: 7,595



Heartland Recreational Vehicles  
2831 Dexter Drive • Elkhart, IN 46514 • 574-262-5992

### Community. Convenience. Close-to-home.

Where you purchase your recreational vehicle is ultimately your decision but Heartland urges you to consider buying at your local dealer. Dealers are part of your community, providing jobs and contributing to your local economy. These dealers are under obligation to provide warranty service for products they sell, but are not legally required to service products purchased from other dealers. At some point, you may need to return to the dealer you buy from - why not stay close to home? After all, home is where your Heartland is!

### BENEFITS OF PURCHASING YOUR RV LOCALLY:

- You enjoy valuable relationship building with Dealer Representatives, close to your home, who will explain the features and benefits of the product.
- You receive a full product orientation prior to delivery, which includes hands-on directions for many of the coach's systems and functions. You are also introduced to the Dealership's Service/Parts/Warranty personnel who are at the ready to help you with any issues you may encounter, now and in the future.
- You enjoy customer PRIORITY. Dealerships generally service their purchasing customers first - others may experience long delays and miss opportunities to use their RV. What is it worth for you to have a dealership's full attention and motivation to satisfy you when you need service - in a timely manner?
- Valuable TAX dollars and jobs stay in YOUR community which pays for your roads, schools, police and fire departments.

### DON'T UNDERESTIMATE CUSTOMER SERVICE AND PERSONAL CARE!

For Canadian Residents: If you purchase an RV out-of-country, there are additional fees, taxes and inspections that must be met before bringing your product home. Your local Canadian dealers are experts in these provisions.

Visit HEARTLAND on:



Your Authorized Heartland Dealer:

HEARTLAND PROUDLY PARTNERS WITH THE HIGHEST QUALITY VENDORS  
in manufacturing our recreational vehicles:



# SUNDANCE

BY HEARTLAND

# XLT



## HEARTLAND CUSTOMER SERVICE

### WE'VE GOT YOUR BACK!

Over 40 men and women located in a dedicated facility servicing our customers every day. With a dealer network of over 400 locations across the U.S. and Canada, you're never far from an authorized Heartland dealer.

Product information is as accurate as possible as of the date of publication of this brochure. Due to Heartland's commitment to continuous product improvement - floorplans, materials, components, features, measurements, specifications, options, etc. are subject to change at any time without notice or obligation. In certain conditions some additional equipment may be needed. Photos may show optional equipment or props used for photography purposes only.

Heartland has listed the approximate base weight of the trailer without the option equipment included. Option equipment will impact the weight of the trailer. Please locate the weight sticker attached to the trailer you are considering for the most accurate trailer weight.

Tow Vehicle Caution: Owners of Heartland recreational vehicles are solely responsible for the selection and proper use of tow vehicles. All customers should consult with a motor vehicle manufacturer or their dealer concerning the purchase and use of suitable tow vehicles for Heartland products. Heartland disclaims any liability or damages suffered as a result of the selection, operation, use or misuse of a tow vehicle. Heartland's limited warranty does not cover damage to the recreational vehicle or the tow vehicle as a result of the selection of the tow vehicle.

Product information and specifications apply to coaches beginning with serial number 291923

50,000 Litho 12/14

www.HEARTLANDRVs.com



#### Experience:

- Product Walk-Through Videos
- Side By Side Comparisons
- Feature Videos - Photo Galleries
- Virtual 360° Tours
- Detailed Floor Plans
- News - Testimonials
- Dealer Locator - Owners Club
- Customer Service - Service Locator
- and More at our Informative Web Site





Heartland Recreational Vehicles

2831 Dexter Drive • Elkhart, IN 46514 • 574-262-5992

### Community. Convenience. Close-to-home.

Where you purchase your recreational vehicle is ultimately your decision but Heartland urges you to consider buying at your local dealer. Dealers are part of your community, providing jobs and contributing to your local economy. These dealers are under obligation to provide warranty service for products they sell, but are not legally required to service products purchased from other dealers. At some point, you may need to return to the dealer you buy from - why not stay close to home? After all, home is where your Heartland is!

### BENEFITS OF PURCHASING YOUR RV LOCALLY:

- You enjoy valuable relationship building with Dealer Representatives, close to your home, who will explain the features and benefits of the product.
- You receive a full product orientation prior to delivery, which includes hands-on directions for many of the coach's systems and functions. You are also introduced to the Dealership's Service/Parts/Warranty personnel who are at the ready to help you with any issues you may encounter, now and in the future.
- You enjoy customer PRIORITY. Dealerships generally service their purchasing customers first - others may experience long delays and miss opportunities to use their RV. What is it worth for you to have a dealership's full attention and motivation to satisfy you when you need service - in a timely manner?
- Valuable TAX dollars and jobs stay in YOUR community which pays for your roads, schools, police and fire departments.

### DON'T UNDERESTIMATE CUSTOMER SERVICE AND PERSONAL CARE!

For Canadian Residents: If you purchase an RV out-of-country, there are additional fees, taxes and inspections that must be met before bringing your product home. Your local Canadian dealers are experts in these provisions.

Visit HEARTLAND on:



Your Authorized Heartland Dealer:

HEARTLAND PROUDLY PARTNERS WITH THE HIGHEST QUALITY VENDORS in manufacturing our recreational vehicles:



# SUNDANCE

BY HEARTLAND

## XLT



### HEARTLAND CUSTOMER SERVICE WE'VE GOT YOUR BACK!

Over 40 men and women located in a dedicated facility servicing our customers every day. With a dealer network of over 400 locations across the U.S. and Canada, you're never far from an authorized Heartland dealer.

Product information is as accurate as possible as of the date of publication of this brochure. Due to Heartland's commitment to continuous product improvement - floorplans, materials, components, features, measurements, specifications, options, etc. are subject to change at any time without notice or obligation. In certain conditions some additional equipment may be needed. Photos may show optional equipment or props used for photography purposes only.

Heartland has listed the approximate base weight of the trailer without the option equipment included. Option equipment will impact the weight of the trailer. Please locate the weight sticker attached to the trailer you are considering for the most accurate trailer weight.

Tow Vehicle Caution: Owners of Heartland recreational vehicles are solely responsible for the selection and proper use of tow vehicles. All customers should consult with a motor vehicle manufacturer or their dealer concerning the purchase and use of suitable tow vehicles for Heartland products. Heartland disclaims any liability or damages suffered as a result of the selection, operation, use or misuse of a tow vehicle. Heartland's limited warranty does not cover damage to the recreational vehicle or the tow vehicle as a result of the selection of the tow vehicle.

Product information and specifications apply to coaches beginning with serial number 291923

50,000 Litho 12/14

www.HEARTLANDRVs.com



#### Experience:

- Product Walk-Through Videos
- Side By Side Comparisons
- Feature Videos • Photo Galleries
- Virtual 360° Tours
- Detailed Floor Plans
- News • Testimonials
- Dealer Locator • Owners Club
- Customer Service • Service Locator
- and More at our Informative Web Site

