

ENDEAVOR

2016 | CLASS A DIESEL

*Your
adventure
awaits.*



ENDEAVOR
2016 | CLASS A DIESEL



HOLIDAY RAMBLER®

ENDEAVOR



ENDEAVOR 40FX SHOWN IN CITY LOFT DÉCOR WITH HILLSIDE CHERRY WOOD CABINETRY

TOP FEATURES

- New High-Gloss 6" x 24" Porcelain Floor Tile Pattern
- TV & A/V Electronics
- Polished Solid Surface Countertops
- 84" Interior Ceiling Height
- Power Awning w/LED Light Strip
- Frameless Flush Mount Windows
- Hardwood Cabinets, Face Frames, Doors & Drawers

- Interlocking Floors, Walls & Ceiling
 - Precision Welding w/5-Point Build System
 - Freightliner® XC-M Chassis – 380 HP & 1150 ft-lb Torque
 - Roadmaster™ B380 Chassis
 - Power Water Hose Reel
 - King Bed w/Memory Foam
- OPTIONAL
- King Air Mattress

40FX



CITY LOFT



DESERT MIRAGE

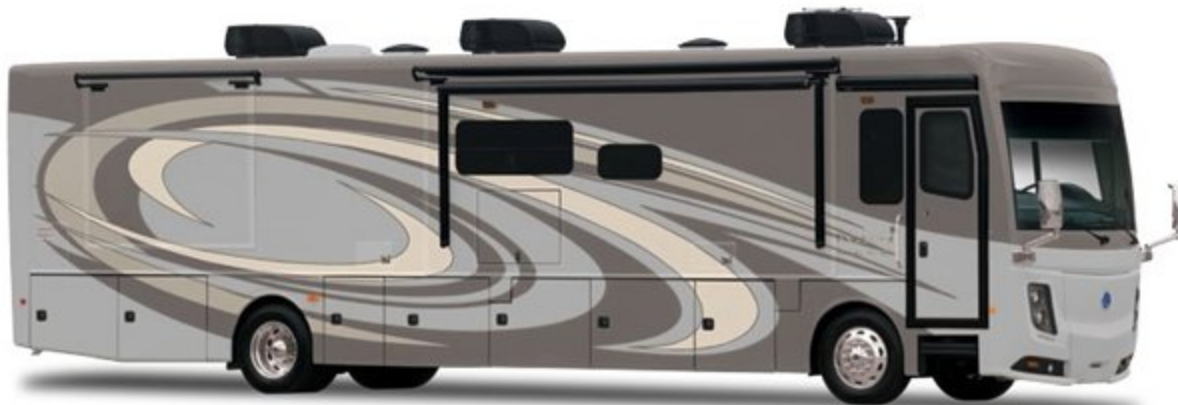

SAVVY STEEL

AVAILABLE OPTIONS:

- 087 Front 32" LED TV
- 113 3-Burner Cooktop w/Oven
- 131 Stackable Washer/Dryer
- 191 Sofa-L Transformer Ultraleather
- 635 U-Shaped Dinette/Sofa
- 830 Facing Dinette
- 856 King Bed w/Air 72" x 80"

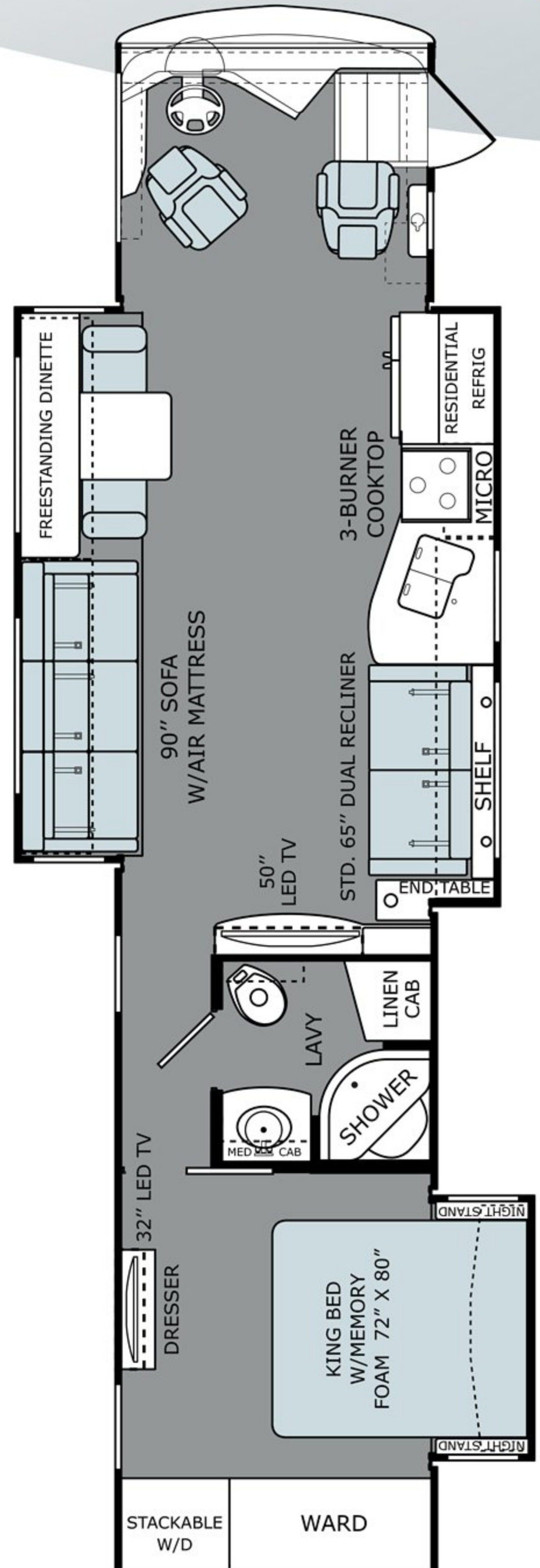



HOLIDAY RAMBLER®

ENDEAVOR

2016 CLASS A DIESEL



WEIGHTS & MEASUREMENTS

MODELS	40FX
Wheelbase (inches)	276"
GVWR (lbs) ¹	33,400
Front GAWR (lbs) ²	12,400
Rear GAWR (lbs) ²	21,000
GCWR (lbs) ³	43,400
Hitch Rating Weight (lbs) ^{†, ††}	10,000
Tongue Weight (lbs) [†]	1,000
Fuel Capacity (gal)	100

ROADMASTER™ B380 CHASSIS

Model: Freightliner® XCM Series Alternator: Delco Remy 160 Amp
 Engine: Cummins® ISL9 Torque: 1,150 lb-ft @ 1,400 RPM
 Transmission: Allison® 3000 MH Horsepower: 380HP
 6-Speed w/Electronic Shifter

DIMENSIONS & CAPACITIES

MODELS	40FX
Overall Length ⁴	41' 4"
Overall Height (with A/C)	12' 10"
Overall Width (maximum) ^{5, 6}	102"
Interior Height (maximum)	84"
Interior Width (maximum)	96"
Patio Awning Width	14' 6"
Interior Storage (cu. ft.)	197
Exterior Storage (cu. ft.)	208
Fresh Water Holding Tank (gal)	100
Grey Water Holding Tank (gal)	75
Black Water Holding Tank (gal)	50
Appliance Propane Tank (gal) (WC) ⁷	38.7
Water Heater Tank (gal)	10

Addendums

1. GVWR (Gross Vehicle Weight Rating) is the maximum permissible weight of this fully loaded motorhome. The GVWR is equal to or greater than the sum of the (UVW) unloaded vehicle weight plus the (OCCC) occupant cargo-carrying capacity*.

2. GAWR (Gross Axle Weight Rating) is the maximum permissible loaded weight a specific axle is designed to carry.

3. GCWR (Gross Combined Weight Rating) is the value specified by the motorhome manufacturer as the maximum allowable loaded weight of this motorhome with its towed vehicle. Towing and braking capacities may be different. Refer to Holiday Rambler and chassis manufacturer's manuals for complete information.

4. Length measured from front bumper to rear bumper (excludes accessories).

5. Excludes safety equipment and awnings.

6. Motorhomes feature a body width over 96" which will restrict your access to certain roads. Before purchasing, you should research any state and/or province road laws which may affect your usage.

7. Tank manufacturer's listed water capacity (WC). Actual propane capacity is 80% of water listing as required by the safety code.

† The chassis manufacturer recommends the installation of a supplemental brake control system to activate the brakes on the vehicle or trailer you are towing. Hitch receiver ratings expressed are maximum for the hitch receiver installed and may require the purchase of additional equipment that is dependent on the weight of the towed load. Consult with hitch receiver manufacturer for further information.

* UVW and OCCC are found on the label containing the federal certification tag in each RV.

†† The Minimum Towable Load of this vehicle is the available weight capacity, up to GCWR, when the coach is fully loaded to maximum GVWR. However, if the coach is loaded to something less than maximum GVWR, that extra available weight capacity can be added to your Towable Load. For example, if your coach is loaded to 1000lbs less than maximum GVWR, your Towable Load increases accordingly. Do not exceed the hitch rating weight, GVWR or GCWR.

IMPORTANT—PLEASE READ

Product information, photography and illustrations included in this publication were as accurate as possible at the time of printing. For further product information and changes, please visit our website at www.holidayrambler.com or contact your local Holiday Rambler dealer. Prices, materials, design and specifications are subject to change without notice. All weights, fuel, liquid capacities and dimensions are approximate. Holiday Rambler has designed its recreational vehicles to provide a variety of uses for customers. Each vehicle features optimal seating, sleeping, storage and fluid capacities. The user is responsible for selecting the proper combination of loads (i.e., occupants, equipment, fluids, cargo, etc.) to ensure that the vehicle's capacities are not exceeded.

WARRANTY INFORMATION:

Enjoy your next RV adventure with the peace of mind that comes with a 12 month/24,000 mile basic limited warranty; a 5 year/50,000 mile limited warranty on aluminum or steel frame structure. Review your coach's limited warranty in full for complete terms and conditions.

CONTACT US

To locate a dealer near you, visit our website at www.holidayrambler.com or call 1-877-466-6226. We can also be contacted at Holiday Rambler Customer Relations, P.O. Box 1007, Decatur, IN 46733.

ALLIED RECREATION GROUP.



©2015 Allied Recreation Group, Inc. Printed in USA.
 Inventory Control Number AUG_AUGLX16B2, 4/15. Model Year 2016, Second Edition.