

SCEPTER

SCEPTER

2016 HOLIDAY RAMBLER | CLASS A DIESEL



2016 CLASS A DIESEL



HOLIDAY RAMBLER

Your new family room





The Holiday Rambler Scepter is a divine fusion of exceptional beauty, style and comfort. With a luxurious design and spacious layout, every layer of your adventurous spirit is enriched with pure sophistication. Begin your journey with a story of elegance.... a story that can only be told with Holiday Rambler.

Scepter Top Features

- Roadmaster™ B450 Chassis
- Polished Solid Surface Countertops Throughout
- Vanity w/Dual Solid-Surface Sinks
- Multiplex Electrical System
- Villa® Ultraleather™ Furniture
- Aqua-Hot® Heating System
- Premium Sand & Buff 4-Color Full-Body Paint
- Sony® Exterior LED TV
- Hardwood Doors, Face Frames, and Moldings

SCEPTER 43DF SHOWN IN VAPOR MIST DÉCOR WITH GLAZED DARK CHERRY WOOD CABINETS

Standard Features and Options

INTERIOR THROUGHOUT

- 12V LED Ceiling & Task Lighting
- 84" Interior Ceiling Height
- Adjustable Shelves Throughout
- Aqua-Hot® Heating System 50,000 Btu/h (House & Water)
- Auto Generator Start
- Central Vacuum System
- Complete PEX Plumbing System
- Countertop Decorative Edge Treatment
- Crown Molding w/Decorative Corner Caps
- Decorative Soffits w/Crown Molding
- Demand Water Pump w/Filter
- Deluxe Roller Bearing, Full-Extension Drawer Guides & Transit-Ship Locks
- Fan-Tastic® Power Roof Vent w/Wall Switch (Multiple Locations)
- Fully Concealed & Adjustable Cabinet Door Hinges
- Hardwood Cabinet Doors/Drawers
- Hardwood Window Treatments
- Integrated Latch Hardware in Pocket Doors
- Inverter & Battery Monitor
- Lined Cabinet Interiors
- Manual Double Roller Shades
- Polished Porcelain Tile Floor w/Accent Inlays
- Roof-Mounted, High-Efficiency A/C & Bedroom Heat Pump
- Solid Wood Face Frame Cabinets
- Soft Touch Padded Ceiling w/Decorative Trim
- Wall Switches (Includes Switches for Ceiling Lights & Vents)
- Water Pump Switch (Multiple Locations)
- Whole Coach Water Filtration System

Optional

- CSA Package (Canadian Specs)**
- Heated Tile Floor
- Winegard In Motion Satellite System
- Winegard® Stationary DSS System

DRIVERS CONVENIENCE

- (2) 12V Power Outlets at Dash
- 110V Power Outlet at Dash
- Adjustable 3-Point Seatbelts at Driver & Front Passenger Seats (w/Adjustable Shoulder Straps)
- Air Horns
- Automotive Wrap-Around Dash
- Auxiliary Start Circuit
- Auxiliary Fog Lamps
- Backlit Switches & Gauges
- Battery Disconnect System
- Color Rear & Side-Vision Cameras
- Color Back-Up Monitor
- Cruise Control
- Denso® High-Output Auto A/C Heater Combo
- Driver & Passenger LED Reading Lights
- Driver Left-Console w/Lower Storage Bin
- Dual-Dash Monitor Design
- Multiple Auxiliary 12-Volt Dash Receptacles
- Powered Windshield Privacy Blinds & Shades
- Manual Driver/Passenger Roller Shades/Blinds
- Passenger Armrest
- Passenger Seat Power Footrest & Adjustable Arm
- Power Entry Step Cover
- Radio Switch Main/Auxiliary Power
- Remote/Heated Chrome Rear-View Mirrors w/Turn Signals & Sideview Cameras
- Smart Wheel w/ Tilt/Telescoping Steering Wheel
- Solid-Surface Entry-Step w/LED Accent Lights
- USB Charger (Driver Side)
- Villa® Ultraleather™ Driver/Front Passenger Captain's Chairs w/ Reclining Back/Slide Controls/Power/Heated/Adjustable Arms
- Windshield Wipers w/Wet Arm
- Xite® Touch Screen Dash Radio w/GPS Navigation

Optional

- Satellite Radio (Subscription Required)

LIVING AREA

- 50" LED HDTV Mid-Ship
- Blu-ray DVD Player
- Dual Euro Recliners (43SF)
- Expandable L-Sofa Jackknife (43SF)
- Sofa w/Hide-A-Bed (43DF)
- Sound Bar
- TV Antenna
- Villa Residential Seat Styling

Optional

- Dual Euro Recliners (43DF)
- Facing Dinette
- Front 32" LED HDTV in Front Overhead
- Electric Fireplace
- Hide-A-Bed Sofa w/Air Mattress (43SF)
- Jackknife Sofa (43DF)

GALLEY

- Adjustable Cabinet Shelves (Select Cabinets)
- Decorative Backsplash
- Flush-Mount Electric 2-Burner Induction Cooktop
- French Door Residential Refrigerator w/Icemaker In Door
- High-Rise Single-Level Galley Faucet w/Sprayer
- Large, Double Solid-Surface Sink
- Polished Solid-Surface Countertops & Sink Covers

- Pull-Out Counter Extension
- Under-Galley Shelving & Wastebasket
- Whirlpool® 1.9 cu.ft. Convection Stainless Steel Microwave Oven w/Built-in Range Hood & Lights

Optional

- Dishwasher

BEDROOM

- Bedroom Entertainment Center w/32" LED HDTV
- Bedspread w/Decor Pillows
- Hardwood 6-Panel Doors
- Lift-Up Bed w/Under-Bed Storage
- Mirrored Wardrobe Doors
- Overhead Cabinetry Above Bed
- Polished Solid-Surface Counter & Nightstand Tops
- Power Roller Shade & Privacy Blind
- Queen Memory Foam Mattress

- Rear Wardrobe w/Cedar Lining, Carpeted Floor & Wire Organizer
- Remote Generator Start Switch
- Stackable Washer & Dryer
- Two-Speed Ceiling Fan
- Wardrobe Lighting

Optional

- King Air Mattress 72" x 80"
- King Bed W/Memory Foam 72" x 80"
- Queen Bed W/Air 60" x 75"

BATHROOM

- A/C Venting
- Cabinet Toe Kicks
- Decorative Custom Tile Backsplash
- Hardwood Bath Door/Trims
- LED Light Over Sink
- Molded Grani-Coat Shower Enclosure w/Skylight (43DF)
- Porcelain Vacuum Flush Toilet

- Spa Shower (43SF)
- Vanity w/Dual Solid-Surface Sinks & Make-Up Bench

SAFETY/CONVENIENCE

- 3-Point Integrated Seat Belts at Driver & Passenger Seats
- Carbon Monoxide Detector/Alarm
- Central Electrical Panel
- Energy Management System (EMS) w/Soft Start
- Fire Extinguisher
- Multiple Seatbelt Locations
- Neutral Loss Protection
- Smoke Detector/Alarm

Optional

- Emergency Exit Door (43SF)

EXTERIOR THROUGHOUT

- 10.0 kW Onan® Quiet Diesel Generator w/Power Slide
- 120V/12V AC/DC Converter
- 2,800-Watt Pure Sine Wave Inverter w/Remote 50-Amp Service
- Aluminum Wheels
- Automatic 4-Point Dual (Hydraulic) Leveling System
- Automatic Generator Start System
- Awning Rail/Drip Molding (Both Sides)
- Chrome Luggage Door Handles
- Continuous One-Piece Compartment Bulb Seal
- Custom Tuned Sachs® Shocks (6)
- Doorside Patio Receptacle
- Dual High-Flow Fuel Fill w/Locking Doors
- Easy-Access Remote Filter Location
- Electrical Outlets in Luggage Compartments
- Engine Block Heater (1500 Watt)
- Fiberglass Front Quarter Panels
- Fiberglass Front/Rear Caps w/High Mounted Taillights
- Fiberglass Wheel Well Trims
- Four 6V/Deep-Cycle House 6 Batteries
- Frameless Flush Mount Windows
- Front Air Disc Brakes & Rear Drum Brakes
- Full-Body Paint
- Full-Width Rear Rock Guard w/Stainless Logo Panel
- Gravity & Pressurized Fresh Water Fill
- Heat Pump on Rear AC Unit
- Heated Water & Holding Tank Compartments
- Heavy-Duty E-Coated Steel Roadmaster™ Bridge
- Hidden, Stainless Steel Latch Rods
- High-Mounted Third Brake Light
- Holding Tank San-T-Flush™ System
- Insulated Aluminum Luggage Doors w/Single Paddle Metal Latches & Powercoat Steel Hinges
- Keyless Entry Remote
- Lighted Luggage Compartments
- Molded Fiberglass Roof
- Mud Flaps
- Neway® Air Suspension w/Large Volumetric Air Bags (6)
- Park Cable Receptacle
- Pass-Through Storage
- Polished Aluminum Wheels (6) 22.5 x 9
- Porch Light
- Power Awning w/LED Light Strip & Wind Sensor React
- Protective Front Mask
- Protective Spray-On Undercoating
- Remote Air System Connection w/Hose & Fittings
- Side Docking Lamps
- Side Turn Signal Indicators
- Side Swinging Luggage Doors
- Sony Exterior 32" LED TV
- Tag Axle w/Air Dump Control
- Tire Valve Extenders
- Touch Sensor Tank Monitoring System
- Two 1900 CCA Maintenance-Free Chassis Batteries
- Utility Compartment w/Exterior Shower
- ZF® Independent Front Suspension w/60-Degree Steering Angle

EXTERIOR THROUGHOUT (CONTINUED)

Optional

- 1st Full Bay 90" S/O Tray
- 1st Full Bay 36"/54" S/O Tray
- 2nd Full Bay 90" S/O Tray
- 2nd Full Bay 36"/54" S/O Tray
- 2nd Full Bay 54" S/O Tray
- Additional Window Awning Pkg (Charcoal)
- Additional Window Awning Pkg (Linen)
- Custom Exterior Paint Color Request
- Tag-Axle Suspension w/Passive Steering
- Power Water Hose Reel
- Solar Electrical Panel
- Two-Piece Aluminum Rear Ladder
- Waste Management Pump
- Waste Management Pump w/Power Water Hose Reel

SAFETY/CONVENIENCE

- 20' Sewer Hose
- Anti-Lock Brake System (ABS)
- Automotive Safety Glass
- Automatic Traction Control
- Daytime Running Lights
- Deadbolt Lock on Entry Door
- Easy Sweep Flooring at Entry Step
- Emergency Egress Window
- Entry Door w/Screen Door & Deadbolt Lock
- Front & Mid-Coach Docking Lights
- Lighted Entry Assist Handle
- LED Clearance Lights
- Power Entry Step
- Underhood Utility Light

BODY STRUCTURE

- 5-Layer Floor w/3" Foam Insulation
- 6-Layer Radius Roof with up to 5" Foam Insulation
- Acoustic Absorption Material in Front, Rear & Engine Compartment
- Aluminum-Framed Wall, Roof & Floor Construction
- Full Fiberglass Front & Rear Caps
- Gel Coat Fiberglass Sidewalls w/No Wood Substrate
- Insulated Strut-Assisted Side-Hinged Luggage Doors
- Large One-Piece Bonded-in Windshield
- Molded Fiberglass Fenders
- One-Piece Molded Fiberglass Roof
- Premium Sand & Buff 4-Color Full-Body Paint
- Reinforced Interlocking Aluminum Connections at Roof, Sidewall & Floor
- Roadmaster Chassis
- Seamless Cap to Sidewall Transitions
- Vacu-bond® Sidewall, Roof, Floor & Rear Wall

Not all options are available on all floor plans. See your Holiday Rambler dealer for details.**CSA standards may require substitution or deletion to achieve conformance.

Go to holiday Rambler.com and build your own Scepter!



DESERT MIRAGE



MANHATTAN BRONZE II



VAPOR MIST

Inside and out, Scepter offers a wide selection of colors, styles, and finishes. From the moment you lay eyes on Scepter, the high-style graphics and décor collections welcome you with gracious beauty and contemporary design. We've paid attention to every detail. Wherever you are, you'll feel right at home.

MANHATTAN BRONZE II

CABINETRY

SOFA

ACCENT

BEDSPREAD

COUNTERTOP

FLOORING

CARPET

GLAZED DARK CHERRY

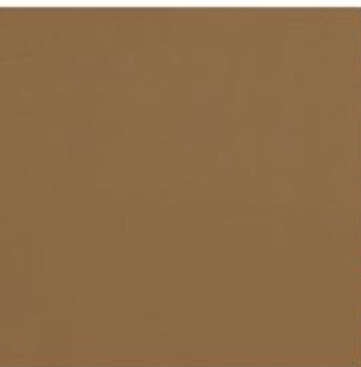

VAPOR MIST

GLAZED ITALIAN SIENNA

SOFA

ACCENT

BEDSPREAD

COUNTERTOP

FLOORING

CARPET

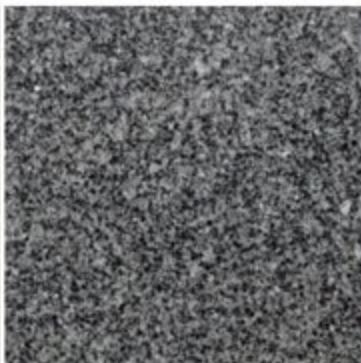
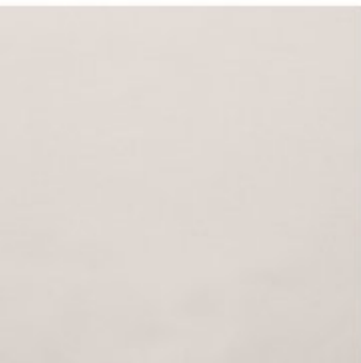

WEIGHTS & MEASUREMENTS

MODELS	43DF	43SF	43SG
GVWR (lbs)1	44,600	44,600	44,600
Front GAWR (lbs)2	14,600	14,600	14,600
Rear GAWR (lbs)2	20,000	20,000	20,000
Tag Axle GAWR (lbs) 2	10,000	10,000	10,000
GCWR (lbs)3	59,700	59,700	59,700
Hitch Rating (lbs)††	15,000	15,000	15,000
Tongue Weight (lbs)†	1,500	1,500	1,500
Fuel Capacity (gal)	150	150	150

ROADMASTER™ B450

Model: Freightliner® XCM Series Alternator: 160 Amp Leece-Neville
 Engine: Cummins® ISL9 Torque: 1,250 lb-ft @ 1,400 RPM
 w/2-Stage Engine Brake Horsepower: 450 HP
 Transmission: Allison® 3000 MH 6-Speed w/Electronic Shift
 Tires: 295/80R 22.5" Michelin® Radial (8)

DIMENSIONS & CAPACITIES

MODELS	43DF	43SF	43SG
Wheelbase (inches)	302"	302"	302"
Overall Length ⁴	43' - 10"	43' - 10"	43' - 5"
Overall Height (with A/C)	12' - 11"	12' - 11"	12' - 11"
Overall Width (maximum) 5, 6	102"	102"	102"
Interior Height (maximum)	84"	84"	84"
Interior Width (maximum)	96"	96"	96"
Fresh Water Holding Tank (gal)	100	100	100
Grey Water Holding Tank (gal)	60	60	60
Black Water Holding Tank (gal)	40	40	40

FLOOR PLAN OPTIONS

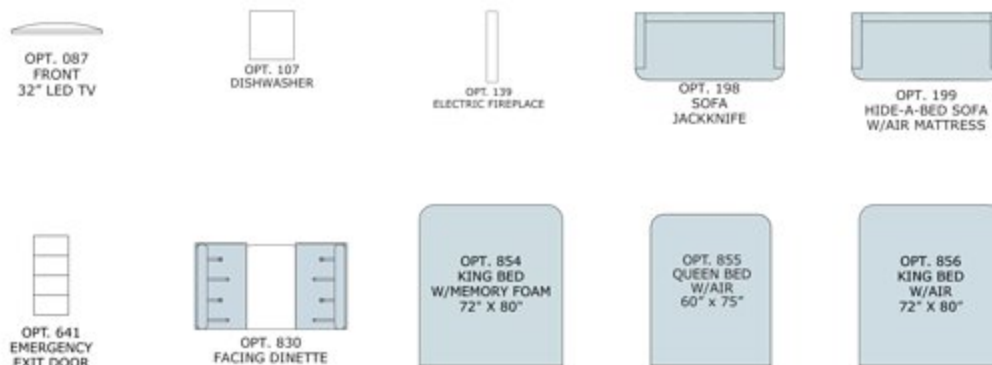

43DF

AVAILABLE OPTIONS: 087, 107, 139, 198, 830, 854, 855, 856

43SF

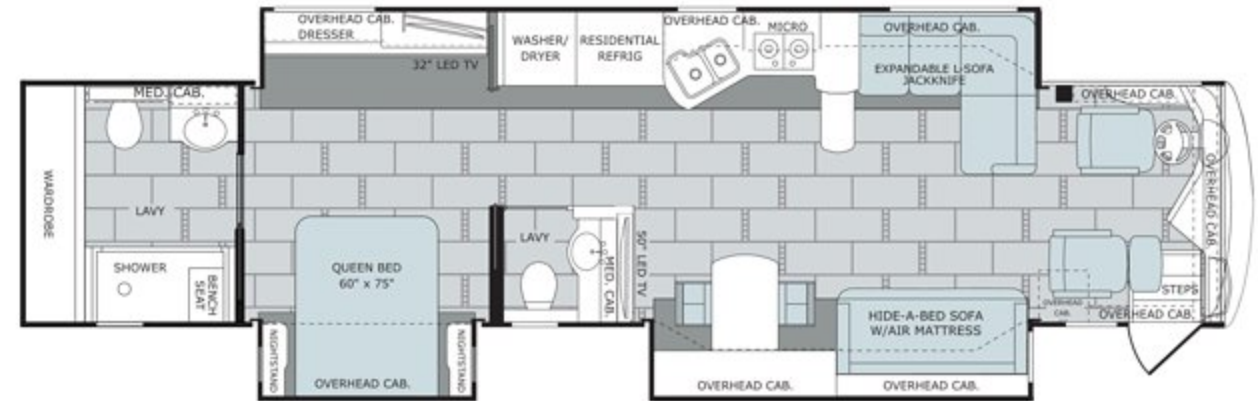

AVAILABLE OPTIONS: 087, 107, 139, 198, 199, 641, 830, 854, 855, 856

43SG

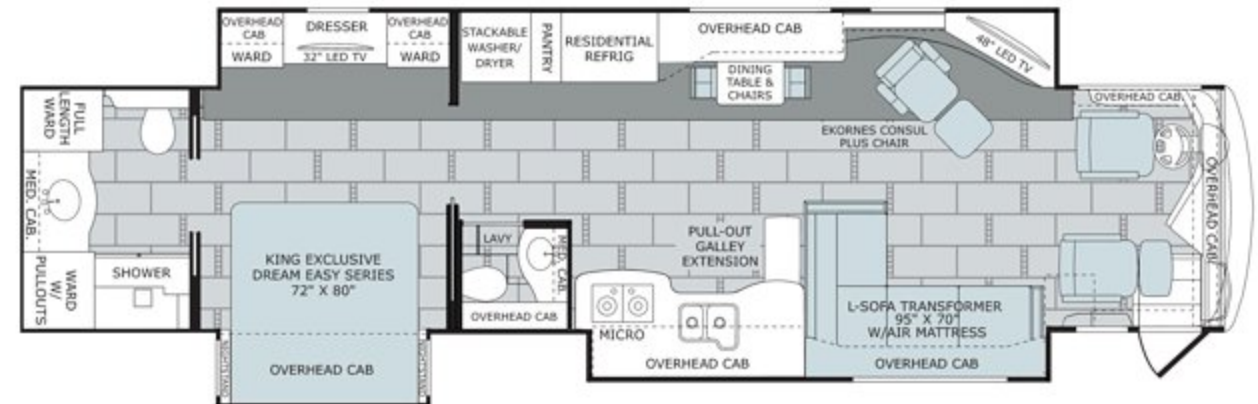

AVAILABLE OPTIONS: 087, 107, 139, 641



HOLIDAY RAMBLER

WARRANTY INFORMATION:

Enjoy your next RV adventure with the peace of mind that comes with a 12 month/24,000 mile basic limited warranty; a 5 year/50,000 mile limited warranty on aluminum or steel frame structure. Review your coach's limited warranty in full for complete terms and conditions.

CONTACT US

To locate a dealer near you, visit our website at www.holidayrambler.com or call (877) 466-6226. We can also be contacted at Holiday Rambler Customer Relations, P.O. Box 1007, Decatur, IN 46733.

IMPORTANT—PLEASE READ: Product information, photography and illustrations included in this publication were as accurate as possible at the time of printing. For further product information and changes, please visit our website at www.holidayrambler.com or contact your local Holiday Rambler dealer. Prices, materials, design and specifications are subject to change without notice. All weights, fuel, liquid capacities and dimensions are approximate. Holiday Rambler has designed its recreational vehicles to provide a variety of uses for its customers. Each vehicle features optimal seating, sleeping, storage and fluid capacities. The user is responsible for selecting the proper combination of loads (i.e., occupants, equipment, fluids, cargo, etc.) to ensure that the vehicle's capacities are not exceeded.

Addendums

1. GVWR (Gross Vehicle Weight Rating) is the maximum permissible weight of this fully loaded motorhome. The GVWR is equal to or greater than the sum of the (UVW) unloaded vehicle weight plus the (OCCC) occupant cargo-carrying capacity.*
2. GAWR (Gross Axle Weight Rating) is the maximum permissible loaded weight a specific axle is designed to carry.
3. GCWR (Gross Combined Weight Rating) is the value specified by the motorhome manufacturer as the maximum allowable loaded weight of this motorhome with its towed vehicle. Towing and braking capacities may be different. Refer to Holiday Rambler and chassis manufacturer's manuals for complete information.
4. Length measured from front bumper to rear bumper (excludes accessories).
5. Excludes safety equipment and awnings.
6. Motorhomes feature a body width over 96" which will restrict your access to certain roads. Before purchasing, you should research any state and/or province road laws which may affect your usage.
7. Tank manufacturer's listed water capacity (WC). Actual propane capacity is 80% of water listing as required by the safety code.

† The chassis manufacturer recommends the installation of a supplemental brake control system to activate the brakes on the vehicle or trailer you are towing. Hitch receiver ratings expressed are maximum for the hitch receiver installed and may require the purchase of additional equipment that is dependent on the weight of the towed load. Consult with hitch receiver manufacturer for further information.

†† Minimum Towable Load is the available weight, up to GCWR, when the coach is fully loaded to maximum GVWR. However, if the coach is loaded to something less than maximum GVWR, that extra available weight can be added to your Towable Load. For example, if your coach is loaded to 1000lbs less than maximum GVWR, your Towable Load increases accordingly.

* UVW and OCCC are found on the label containing the federal certification tag in each RV.

ALLIED RECREATION GROUP.

**YOUR LOCAL HOLIDAY RAMBLER DEALER IS:**