

# WHY BUY DESTINATION



**STANDARD**



**MERLOT**



**WATERFALL**



**SANDSTONE**

## KEY FEATURES

- Drop Frame Chassis
- Hydraulic Front Jacks
- Power Rear Stabilizer Jacks
- Trail Air Rubber Suspension
- Aluminum Wheels
- Undermount Spare Tire and Carrier
- Recessed 3 Burner Range w/21" Oven
- Hard Surface Range Cover
- 30" Microwave
- 20 cu ft Residential Refrigerator
- 1200 Watt Inverter
- 10 gal DSI Gas Electric Water Heater
- 15M BTU Tru Air Cooling System
- Bedroom A/C Prep
- Washer/Dryer Prep
- 50 AMP Service
- High Gloss Gel Coat Fiberglass Walls
- Painted Fiberglass Front Cap
- Radius Interior Ceiling
- Hydraulic Main Floor Slides
- 30" x 78" Entry Door w/ Vented Window
- Dark Tinted Frameless Windows
- Electric Awning w/ LED Lights
- LED Interior Lights, Ceiling Fan w/ Light (select models)
- Hard Wood Cherry Cabinet Stiles
- Free Standing Table and Two Chairs
- Hard Surface Galley Countertops
- Stainless Steel Sink
- Large One Piece Fiberglass Shower
- 60" x 80" Mattress
- Large Screen LED TV
- Correct Track Alignment System
- Everpedic Memory Foam Mattress

*Premium Travel Trailers & Fifth Wheels*

**WINNEBAGO**  
TOWABLES™

# FLOORPLANS

# SPECIFICATIONS



**36RL**

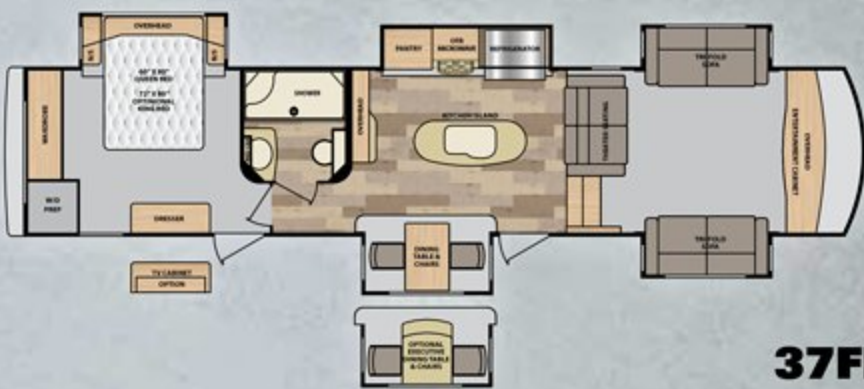

**37FL**

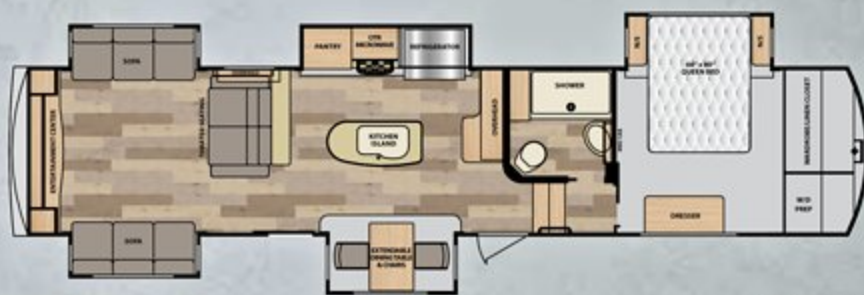

**37RD**



**39FB**

	<b>36RL</b>	<b>37FL</b>	<b>37RD</b>	<b>39FB</b>
Exterior Length (Pin to Rear Bumper)	38' 0"		41' 0"	40' 5"
Exterior Height (ft.) (Including A/C)	13' 3"		13' 3"	13' 3"
Exterior Width (ft.) (Fenders/Body)	8' 4"		8' 4"	8' 4"
Interior Height (ft.)	8' 9"		8' 9"	8' 9"
GVWR (lbs.)	15,500		15,500	15,500
Dry Weight (lbs.)	12,320		13,120	12,940
Dry Hitch Weight (lbs.)	2,820		2,560	2,700
Axles (lbs.)	2@7,000		2@7,000	2@7,000
GAWR (lbs.)	7,000		7,000	7,000
Tire Size	ST235/80R16E		ST235/80R16E	ST235/80R16E
Fresh Water (Tank Only) (gal.)	100		100	100
Black Tank Capacity (gal.)	28		28	28
Grey Tank Capacity (gal.)	60		60	60
LP Capacity (lbs.)	60		60	60
LP Capacity with Upgrade (lbs.)	N/A		N/A	N/A
Awning Length (ft.)	13.5		20	14
Slide-outs	3		3	3
<b>Sleeps</b>				
Furnace (BTU)	35,000		35,000	35,000
Water Heater (gal.)	10		10	10



**Winnebago Towables**  
 201 14th Street, P.O. Box 2001  
 Middlebury, IN 46540 (574) 825-5250  
[www.winnebagotowables.com](http://www.winnebagotowables.com)

