

# Apex

By Coachmen

Reaching New Heights



 **Coachmen**  
Recreational Vehicles  
A Division of Forest River, Inc.

LIGHTWEIGHT • *Easy to Tow* • CONTEMPORARY STYLING • RUGGED CONSTRUCTION!







# Apex

By Coachmen

*These Ultra Lite Travel Trailers are designed for towing with today's half-ton trucks, minivans and SUVs, with weights ranging from under 3,000 to 6,000 lbs.*







LIGHT AND EASY • *Friends & Family* • LEISURE STYLE • CHILDHOOD MEMORIES • SUMMER FUN!



**289TBSS** This comfortable bunk house features seamless countertops, a double bowl Stonecast sink, a large dinette, plenty of windows for natural light and hard bedroom privacy doors. Shown in Espresso decor.

## Perfect for Smaller Tow Vehicles

Pack up, back up, hitch up and go. Apex Ultra Lites are perfect for towing with half ton trucks, minivans and SUVs for fuel efficiency. All Apex floor plans are designed with rich, warm interiors, contemporary cabinetry, fabrics and flooring. Apex travel trailers and hybrid expandables are incredibly lightweight and durable, with fully laminated, aluminum framed sidewalls, floor and roof.



The **215RBK** has a convertible dinette, spacious kitchen, ample counter space, bathroom with plenty of storage and a large stand up shower with a glass door.







THE BEST OF TIMES • *Play Time* • EXPERIENCE NATURE • REFLECT AND RELAX

**7-1/2 FT. MODELS**

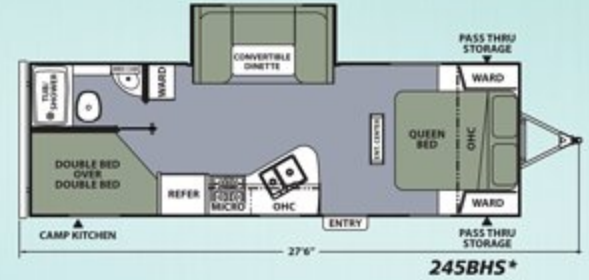

**8 FT. MODELS**

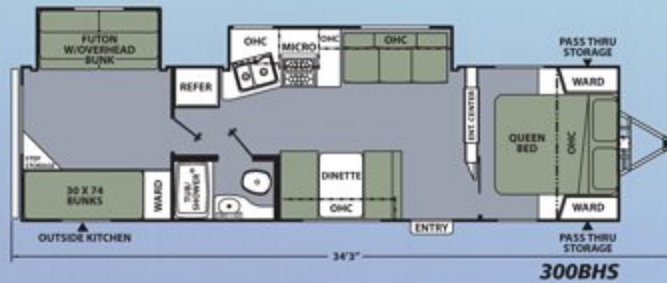
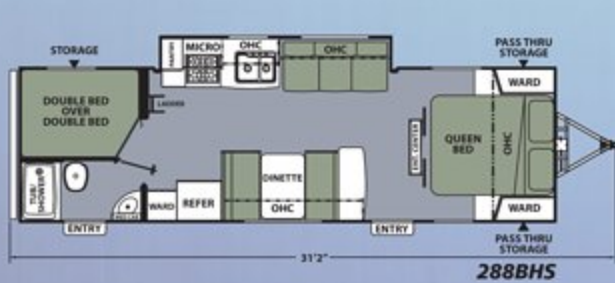
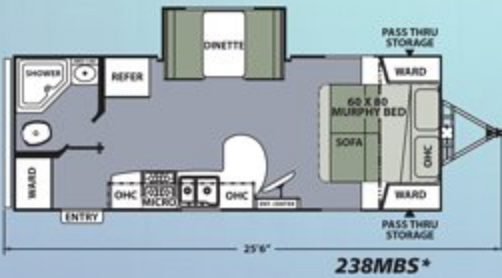

**Apex**  
By Coachmen





## 8 FT. DEEP SLIDE MODELS

# Lightweight Construction with Style



232RBS\*

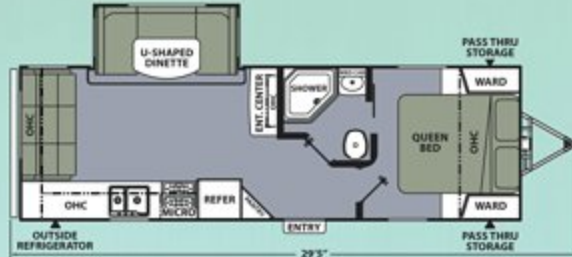

250RLS



259BHS

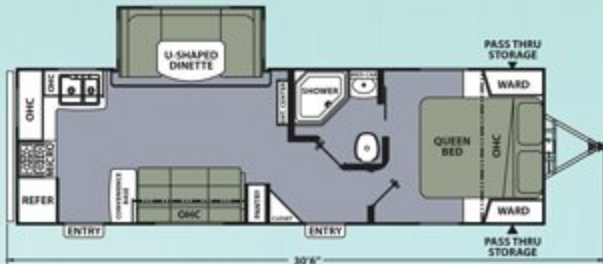

267RKS\*

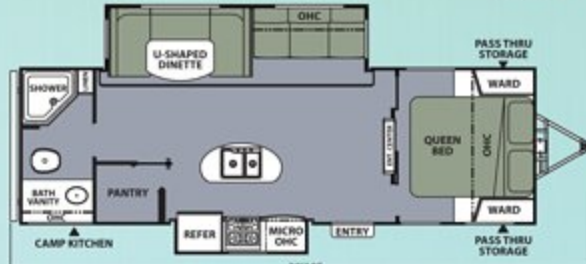

269BKS\*



275BHS\*



276BHS

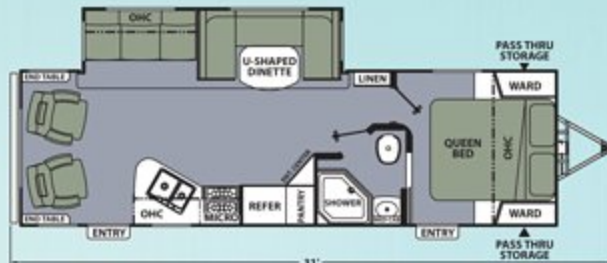

279RLSS



289TBSS\*

\*60" x 80" Queen bed

APEX	7.5' WIDE MODELS			8' WIDE MODELS				8' WIDE DEEP SLIDES								
	212RB	215RBK	245BHS	238MBS	249RBS	288BHS	300BHS	232RBS	250RLS	259BHS	267RKS	269BKS	275BHS	276BHS	279RLSS	289TBSS
UVW	4068	4365	4546	4474	4770	4882	5977	4863	5210	5370	5415	5590	5780	5700	5490	5720
Hitch Weight	410	446	578	563	480	585	672	501	550	680	732	720	706	740	620	715
Carrying Capacity	1932	2135	2003	2026	2230	2118	1623	2137	1790	2130	2185	2010	1820	1900	2110	1880
GVWR	6000	6500	6500	6500	7000	7000	7600	7000	7000	7500	7600	7600	7600	7600	7600	7600
Ext. Length	24'6"	25'4"	27'6"	25'6"	28'3"	31'2"	34'3"	26'9"	29'5"	28'	30'6"	29'10"	30'11"	30'11"	31'	32'4"
Ext. Height w/AC	10'2"	10'2"	10'2"	10'2"	10'2"	10'2"	10'4"	10'8"	10'8"	10'8"	10'8"	10'8"	10'8"	10'8"	10'8"	10'8"
Fresh Water	30 GAL	30 GAL	30 GAL	50 GAL	50 GAL	50 GAL	50 GAL	50 GAL	50 GAL	50 GAL	50 GAL	50 GAL	50 GAL	50 GAL	50 GAL	50 GAL
Grey Water	30 GAL	30 GAL	30 GAL	35 GAL	35 GAL	35 GAL	35 GAL	35 GAL	35 GAL	35 GAL	70 GAL	35 GAL	35 GAL	70 GAL	35 GAL	35 GAL
Waste Water	30 GAL	30 GAL	30 GAL	35 GAL	35 GAL	35 GAL	35 GAL	35 GAL	35 GAL	35 GAL	35 GAL	35 GAL	35 GAL	35 GAL	35 GAL	35 GAL





Ultra Lite Travel Trailers are designed for towing by today's half-ton trucks, minivans



This convenient camp kitchen keeps cold drinks and hot snacks close by! Available on 245BHS, 275BHSS, 276BHSS and 289TBSS.



This convenient outside kitchen has a Coleman grill, large refrigerator, plumbed sink, gooseneck faucet and additional storage for outdoor grilling at its best! It's standard on 215RBK and 300BHS models.

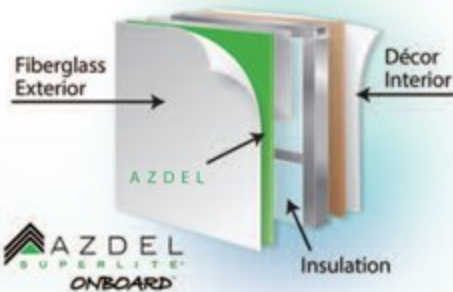

**APEX IS CONSTRUCTED WITH AZDEL VACUUM BONDED COMPOSITE PANELS.** AZDEL is 50% lighter than wood, increases insulation value, and won't rot, mold or sustain water damage for years of trouble free camping.

**AVAILABLE FIBERGLASS FRONT CAP**

- ▲ Wrap around design (Better aerodynamics and towability with a high end look)
- ▲ Painted not infused
- ▲ LED marker lights

**VACUUM BONDED SIDEWALLS, ROOF AND FLOOR**

- ▲ Stronger construction
- ▲ Lighter weight

**APEX IS CERTIFIED GREEN TRA GOLD LEVEL RATED.**

As a Certified Green RV, APEX utilizes effective production techniques in combination with healthy materials, plus efficient usage of energy and water to produce a high quality RV with less environmental impact.



**STONECAST SINK (N/A Nano models)**

- ▲ Double bowl
- ▲ Stain resistant
- ▲ Heat resistant up to 500°



**LED INTERIOR LIGHTING**

- ▲ Energy efficient
- ▲ Long lasting



**ONE-PIECE SEAMLESS COUNTERTOP**

- ▲ Stain resistant
- ▲ Lighter weight
- ▲ No T-mold (Helps prevent water damage)



**WELDED ALUMINUM FRAMING (Including front cage)**

- ▲ All cutouts – windows, compartments, doors and vents
- ▲ Lighter weight
- ▲ Will not rot

**POWER AWNING**

- ▲ Available on all APEX models
- ▲ Long-lasting LED lights



**ALUMINUM REINFORCED LAMINATED ROOF**

- ▲ Even insulation that will not deteriorate
- ▲ Durable, walk-on roof
- ▲ Less weight
- ▲ Motorhome type construction

*Lightweight Durability!*  
**APEX CONSTRUCTION**



**LOWER CENTER OF GRAVITY FOR BETTER TOWABILITY**



and SUVs. From 18' to 34' – All units are available under 6,000 lbs.



**MAGNETIC DOOR CLOSURES (Elite Package)**

- ▲ Holds door up and out of the way while accessing storage

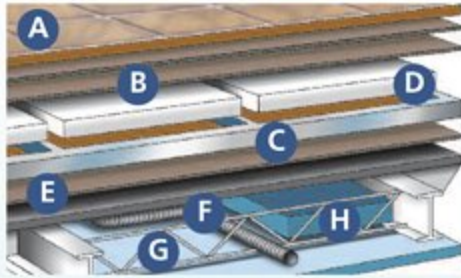

**SIX LAYER BONDED FLOOR**

- A Residential durable insulated floor covering
- B Double layer Luan plywood top decking
- C Welded aluminum frame
- D Block foam structural insulation
- E Luan plywood bottom decking
- F Darco waterproof floor wrap
- G Cross member support
- H Holding tanks

**CONSTRUCTION FEATURES**

- 3M breathable graphics
- Tinted, safety glass windows
- Welded Aluminum structure, vacuum-bonded sidewalls, floor and roof
- Aluminum reinforced laminated roof
- EDPM rubber roofing
- Azdel composite sidewall panels
- Aerodynamic front profile (Shown with painted front cap - Summit Pkg.)
- Dual 20 lb. LP gas tanks
- Insulated slam latch doors with magnetic hold ups (Elite Package)
- Smooth exterior fiberglass skin
- Aluminum framed openings
- Fully enclosed, heated under belly (8' wide models)
- Fully welded tubular aluminum floor structure
- Schwintek™ and rack and pinion slide systems (Deep slides)
- Congoleum flooring
- Powder E-coated, welded I-beam frame
- Dexter® E-Z Lube® axle hubs
- Nitrogen filled radial tires

**INTERIOR AND DÉCOR**

- ▲ Ambrosia Ash cabinetry
- ▲ Overhead bedroom cabinets
- ▲ Sealed edge countertops
- ▲ Congoleum flooring
- ▲ Mini-blinds – throughout
- ▲ Pedestal dinette table
- ▲ Large oversized booth – U-shaped dinette
- ▲ 68" Residential sofa (Most models)
- ▲ Energy efficient LED interior lighting
- ▲ Hardwood mortise & tenon cabinet door frames
- ▲ Stile & rail cabinet front construction
- ▲ LP leak alarm
- ▲ Fire extinguisher
- ▲ Smoke alarm
- ▲ Carbon monoxide detector

**ELECTRICAL/HEATING/AC**

- ▲ Furnace – forced air/ducts per floorplan
- ▲ 55 Amp power center
- ▲ Outside receptacle GFI
- ▲ TV antenna with cable TV hookups
- ▲ AM/FM/Bluetooth stereo
- ▲ 2 Outside speakers with LED lights
- ▲ Ducted air conditioner (8' Wides)
- ▲ Detachable marine style power cord

**GALLEY**

- ▲ Stainless steel microwave
- ▲ Stainless steel 3-burner cooktop with oven

**▲ APEX ELITE PACKAGE (MANDATORY ON 8' WIDES)**

- Hard valances with side curtains
- Night shades
- Dual sink cover
- AM/FM/CD/DVD/Bluetooth stereo
- 24" LED TV (7-1/2' Wides)
- 32" LED TV (8' Wides with entertainment center)
- USB charging station
- Access doors under dinette
- Ground effects (Metal skirting & ABS fender skirts)
- Step with LED light

*Standard Features*

- ▲ Stainless steel double door refrigerator
- ▲ Power/lighted range hood
- ▲ Brushed nickel hardware
- ▲ Stonecast double bowl sink

**BATH AND WATER**

- ▲ Power bath vent
- ▲ 6 Gal. gas/elec. DSI hot water heater
- ▲ Water heater bypass valve
- ▲ Demand water pump
- ▲ Medicine cabinet
- ▲ Below floor low point drains
- ▲ Foot flush toilet
- ▲ Tub surround
- ▲ Glass shower door – 34" neo-angle showers

**SLEEPING**

- ▲ Residential plush comforter
- ▲ Evergreen sleep mattress
- ▲ Bunk shelves – double over double
- ▲ Bedroom vent (28' and up)

**EXTERIOR/CONSTRUCTION**

- ▲ 13.5 Roof A/C
- ▲ Power awning with LED lights
- ▲ Spare tire and carrier
- ▲ 4 Stabilizer jacks
- ▲ LP port
- ▲ Double 20# LP tanks
- ▲ Solar prep
- ▲ Step light

- ▲ Fully laminated aluminum framed radius rubber roof – R-11 (7-1/2' wides), R-14 (8' Wides)
- ▲ Vacuum bond Azdel/fiberglass sidewalls (Additional R-2)
- ▲ Laminated aluminum framed fully insulated sidewalls – R-9
- ▲ Laminated aluminum framed floor – R-11
- ▲ Gutter rail
- ▲ Dead bolt lock
- ▲ Tinted safety glass radius windows
- ▲ Radius entrance door
- ▲ Radius thumb latch baggage doors
- ▲ I-beam chassis construction
- ▲ Corrosion resistant powder coated frame
- ▲ Dual battery tray
- ▲ Heated/enclosed holding tanks (8' Wides)
- ▲ Break away switch
- ▲ Schwintek slide room system (N/A Deep slides)
- ▲ Pass-thru storage with motion sensor lighting
- ▲ Double/triple entry step
- ▲ Dexter® E-Z Lube® axles
- ▲ Nitro filled radial tires
- ▲ Gray exterior sidewalls
- ▲ Aztec gray front and rear walls
- ▲ Exterior door side cable hook-up
- ▲ Aluminum rims

*Optional Features*

- Slam latch doors at pass thru
- Black tank flush
- Magnetic door catches
- Stone guard
- Hot/cold outside shower
- Bottle covers
- Apex fleece blanket – Sofa models
- ▲ **SUMMIT PACKAGE\***
- Painted fiberglass front cap with LED lighting
- Power tongue jack with light
- Swing-away assist handle at main entry
- Backsplash behind stove

- Hi-rise kitchen faucet with pull-out sprayer
- Crown molding with LED uplighting in kitchen (N/A 259BHSS, 269RBKS, 276BHSS)
- Built-in headboard shelf with LED light and USB ports

**ADDITIONAL OPTIONS**

- ▲ Frameless dark tint windows
- ▲ 15,000 BTU roof air conditioner
- ▲ Tri-fold Destination Hide-a-Bed sofa (Deep slide models)
- ▲ 50 Amp service with second forced A/C (28' and above)



CAYENNE SHADOW



ESPRESSO



PEBBLE

\*The Apex Elite Package is required with the Summit Package.





This storage friendly super-lightweight Nano **187RB** features a dual crowned ceiling, large kitchen counter space, pantry, double bowl sink, walk-around bed, full length wardrobes, plus a generous bathroom wardrobe. Shown in Cayenne Shadow decor.

**Apex**  
NANO

CHILDHOOD MEMORIES • QUALITY TIME • *Life's Simple Pleasures* • OUTDOOR FUN!





The super-lightweight **Nano 17X** is a comfortable home base for memorable family outings in the fresh air! Features include large windows, a double entry step, a 12' power awning and 14" tires. Shown in Pebble decor.



Apex Nano Expandables are the perfect lightweight solution for families on the go. They're easy to tow – and easy to set up for years of fun-filled outdoor adventure.



*Expand Your Horizons*





# Apex

NANO

APEX NANO	15X	17X	185BH	187RB	191RBS	193BHS	213RDS
UVW	2920	3710	2850	3034	3335	3370	3806
Hitch Weight	360	456	350	316	382	406	467
Carrying Capacity	880	2290	950	766	1365	1430	2194
GVWR	3800	6000	3800	3800	4600	4600	6000
Ext. Length	18'7"	20'7"	20'6"	21'4"	21'10"	22'1"	25'
Ext. Height w/AC	9'10"	9'10"	9'7"	9'7"	9'9"	9'9"	9'10"
Fresh Water	30 GAL	30 GAL	30 GAL	30 GAL	30 GAL	30 GAL	30 GAL
Grey Water	30 GAL	30 GAL	30 GAL	30 GAL	30 GAL	30 GAL	30 GAL
Waste Water	30 GAL	30 GAL	30 GAL	30 GAL	30 GAL	30 GAL	30 GAL

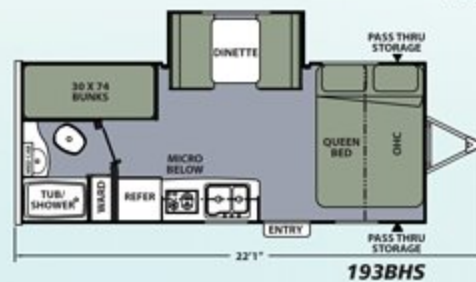
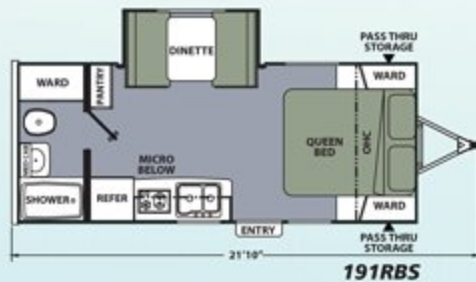
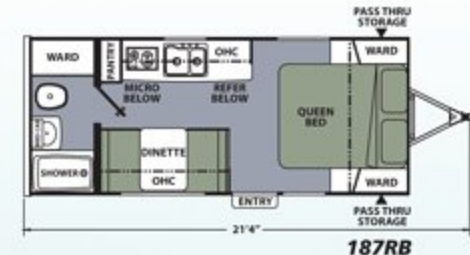
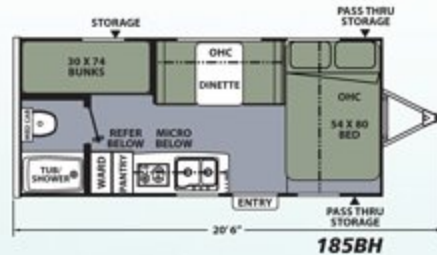
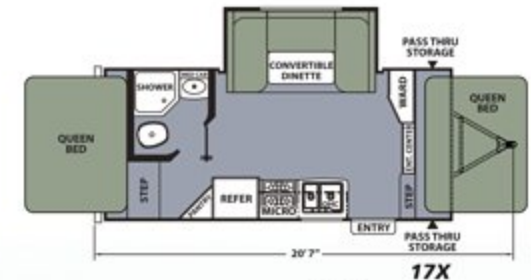
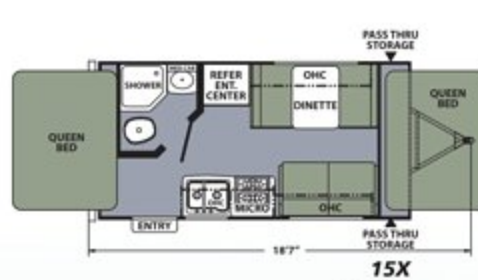

## Standard Features

### INTERIOR AND DÉCOR

- ▲ Ambrosia Ash cabinetry
- ▲ Overhead bedroom cabinets
- ▲ Congoleum flooring
- ▲ Mini-blinds throughout
- ▲ Pedestal dinette table
- ▲ Large oversized booth/U-shaped dinette
- ▲ Hardwood mortise and tenon cabinet door frames
- ▲ Residential plush comforter (Select models)
- ▲ Stile and rail cabinet front construction
- ▲ 2" Thick insulated floor
- ▲ LP leak alarm
- ▲ Fire extinguisher
- ▲ Smoke alarm
- ▲ Carbon monoxide detector

### ELECTRICAL/HEATING/AC

- ▲ Outside receptacle GFI
- ▲ Detachable marine style power cord

### GALLEY

- ▲ Double sink bowl
- ▲ One piece seamless countertops
- ▲ Brushed nickel hardware

### BATH AND WATER

- ▲ Power bath vent
- ▲ Water heater bypass valve
- ▲ Demand water pump
- ▲ Hand-crafted wood medicine cabinet
- ▲ Below floor low point drains
- ▲ Foot flush toilet

### EXTERIOR/CONSTRUCTION

- ▲ 20# LP tank
- ▲ Rubber roof
- ▲ Gutter rail
- ▲ Dead bolt lock
- ▲ Tinted safety glass radius windows
- ▲ Radius entrance door with window
- ▲ Radius thumb latch baggage doors
- ▲ Corrosion resistant powder coated frame
- ▲ Dual battery tray
- ▲ Break away switch
- ▲ Stone guard
- ▲ Pass-thru storage
- ▲ Double entry step
- ▲ Dexter® E-Z Lube® axles
- ▲ Nitro filled radial tires

Apex Nano Expandable







BUILT FOR FUN • *Reliable Construction* • RELAX AND TAKE IT EASY!

## *Built To Last* APEX NANO CONSTRUCTION



## *Nano Package (MANDATORY)*

- ▲ Vacuum bond Azdel fiberglass sidewalls
- ▲ Vacuum bond laminated crowned roof/ceiling
- ▲ Aluma-cage construction
- ▲ Welded aluminum framed floor
- ▲ Schwintek slide room system
- ▲ Insulated floor with seamless decking
- ▲ High efficiency LED interior lighting
- ▲ 2 Outside speakers with LED lights
- ▲ Stabilizer jacks (4)
- ▲ TV antenna with cable hookups
- ▲ 6 Gal. DSI water heater
- ▲ Stainless steel microwave
- ▲ 3.0 Cu. ft. 2-way refrigerator (4.0 cu. ft. - 15X)
- ▲ Double door refrigerator (17X, 191RBS, 193BHS, 213RDS)
- ▲ 2-Burner cooktop
- ▲ AM/FM/Bluetooth Stereo
- ▲ Skylight in bath
- ▲ Evergreen sleep mattress
- ▲ Gray exterior fiberglass
- ▲ LP port
- ▲ Solar prep

## *Optional Features*

- ▲ **COMFORT PACKAGE**
- 20,000 BTU direct vent furnace
- Power awning with LED lights

- ▲ **ADDITIONAL OPTIONS**
- ▲ 13.5 BTU roof air conditioner
- ▲ Spare tire and carrier

## CONSTRUCTION FEATURES

1. 3M breathable graphics
2. Tinted, safety glass windows
3. Welded Aluminum structure, vacuum-bonded sidewalls and roof
4. Dual crowned laminated roof
5. EDPM rubber roofing
6. Azdel Composite Panels (Sidewalls)
7. Aerodynamic front profile
8. 20 lb. LP gas tank
9. Smooth exterior fiberglass skin
10. Aluminum framed openings
11. Fully welded tubular aluminum floor structure
12. Schwintek™ slide system
13. Congoleum flooring
14. Powder E-coated, welded frame
15. Dexter® E-Z Lube® axle
16. Nitrogen filled radial tires







BREATHE IN THE FRESH AIR • *Get Up and Go In Style!* • ENJOY YOUR SPIRIT OF ADVENTURE



**BIG BENEFITS FOR NEW OWNERS**

FREE One Year Membership – Coachmen Owners Association! Coachmen is proud to sponsor the largest manufacturer sponsored camping club in North America...Coachmen Owners' Association (COA). COA provides you a world of ways to enjoy your RV. This is FUN ON OVERDRIVE and provides: Free Trip Routing, Exciting Tours & Rallies, Free Campground Directory, Local/State Club Activities, Easy RVing Magazine Free, Theme Park Discounts, Fuel Discounts, Free onebigplanet® Memberships with discounts at 180,000 merchants and Much More! Every new Coachmen RV buyer is eligible for a 1 Year FREE membership in the Coachmen Owners' Association. It all adds up to an easy ownership experience!



**COACHMEN INTERACTIVE MOBILE MANUALS**

Download your Coachmen mobile app or visit our dynamic online manual to enhance your ownership experience. These interactive options provide incredible ease and insight into use, maintenance and enjoyment of your Coachmen product. Ranging from "How-To" videos, pictures and illustrations of various components, systems and features to fully searchable content and downloadable PDFs for individual component owner's manuals, answers are always just a click away.



**TRAVEL EASY™ ROADSIDE ASSISTANCE**

RVing is easier with Coachmen's Travel Easy™ Roadside Assistance provided FREE the first year of ownership to those who purchase a New Coachmen RV. Administered by Coach-Net, this service provides you with 24/7 operational, technical and emergency road service coverage. Also included is towing, fuel delivery, jump starts, lockout service, tire changes, mobile mechanic and unlimited technical assistance. Anywhere. Anytime. Travel Easy™ is the security of knowing that help is an easy phone call away.



Learn More  
Scan this barcode using a QR Reader on your smart phone to learn more about Forest River.



A Berkshire Hathaway company.



[www.ForestRiverBuyLocal.com](http://www.ForestRiverBuyLocal.com)

*Your Apex Dealer*



423 N. Main Street ■ P.O. Box 30  
Middlebury, IN 46540

To learn more about Coachmen RV and our products and see how Coachmen is making the easy life easier, visit [www.coachmenrv.com](http://www.coachmenrv.com)



All information contained in this brochure is believed to be accurate at the time of publication. However, during the model year, it may be necessary to make revisions and Forest River, Inc., reserves the right to make all such changes without notice, including prices, colors, materials, equipment and specifications as well as the addition of new models and the discontinuance of models shown in this brochure. Therefore, please consult with your Forest River dealer and confirm the existence of any materials, design or specifications that are material to your purchase decision.  
©2016 Coachmen RV a Division of Forest River, Inc., A Berkshire Hathaway company. All Rights Reserved. 12/16