

Prism ELITE

By Coachmen

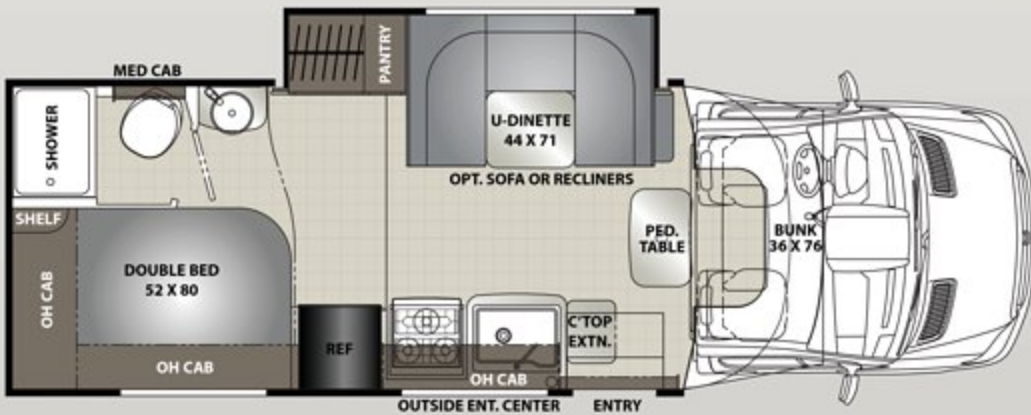
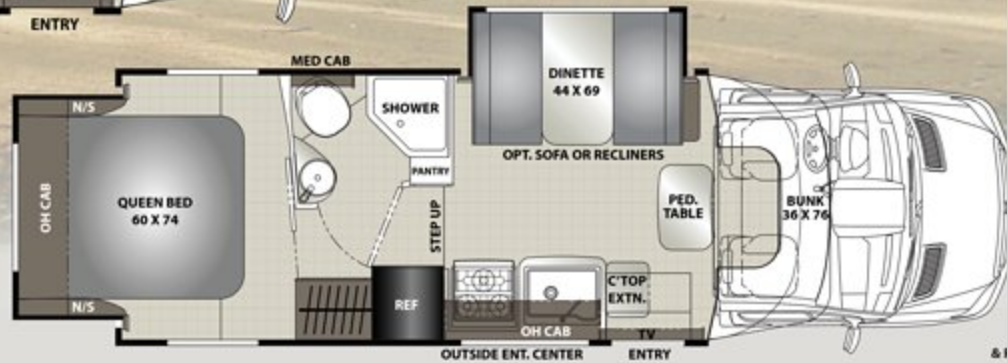
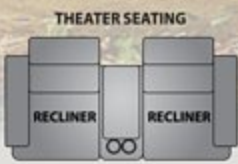
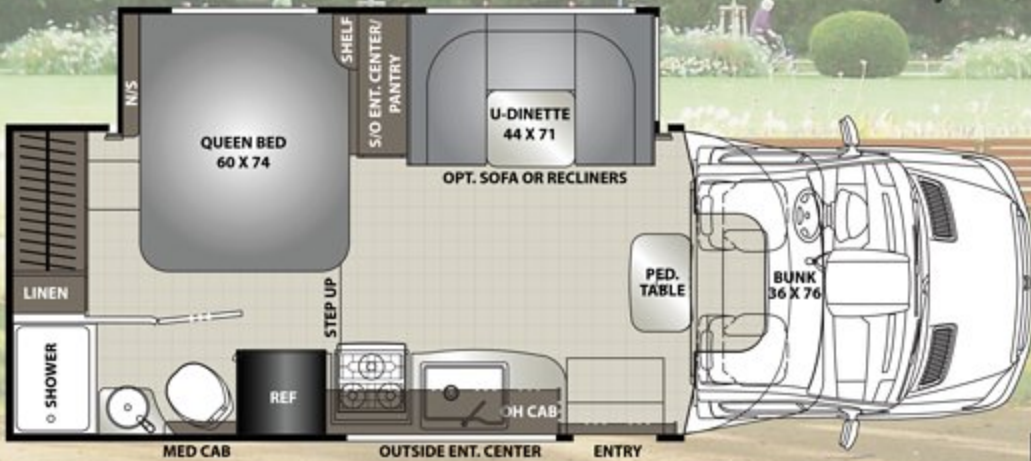

SPECIFICATIONS

MODEL	24EF	24EG	24EJ
CHASSIS	Sprinter 3500	Sprinter 3500	Sprinter 3500
ENGINE	3.0L	3.0L	3.0L
HORSE POWER	188	188	188
TORQUE	325	325	325
WHEEL BASE	170"	170"	170"
GVWR* (LBS.)	11,030	11,030	11,030
GCWR* (LBS.)	15,250	15,250	15,250
CW* (APPROX. LBS.)	9,750	9,750	9,750
GAWR FRONT (LBS.)	4,410	4,410	4,410
CCC (LBS.)	1,170	1,160	TBD
GAWR REAR (LBS.)	7,720	7,720	7,720
INTERIOR HEIGHT	6' 7"	6' 7"	6' 7"
EXTERIOR WIDTH	7' 10"	7' 10"	7' 10"
EXTERIOR HEIGHT (W/ A/C)	12' 9"	12' 9"	12' 9"
EXTERIOR LENGTH (W/ HITCH)	24' 11"	24' 11"	24' 11"
HITCH WEIGHT (LBS.)	3,500	3,500	TBD
FUEL CAPACITY (GAL.)	26	26	26
LP CAPACITY (LBS.)	85	85	85
FRESH WATER CAPACITY (GAL.)	35	30	30
WATER HEATER CAPACITY (GAL.)	6	6	6
GREY TANK CAPACITY (GAL.)	28	32	32
BLACK TANK CAPACITY (GAL.)	32	32	32
EXTERIOR STORAGE (CU. FT.)	37	43	TBD
AWNING LENGTH (FT.)	14'	14'	TBD

SEE WHAT'S NEW!

GVWR (Gross Vehicle Weight Rating) is the maximum permissible weight of the unit when fully loaded. It includes all weights, inclusive of all fluids, occupants, cargo, optional equipment and accessories. For safety and product performance do NOT exceed the GVWR.

GCWR (Gross Combined Weight Rating) is the maximum permissible loaded weight of your motor home and any towed trailer or towed vehicle. Actual GCWR of this vehicle may be limited by the sum of the GVWR and the installed hitch receiver maximum capacity rating; see hitch rating label for detail.

GAWR (Gross Axle Weight Rating) is the maximum permissible weight, including cargo, fluids, optional equipment and accessories that can be safely supported by each axle.

UVW (Unloaded Vehicle Weight) * is the typical weight of the unit as manufactured at the factory. It includes all weight at the unit's axle(s), including full fuel, all fluids and LP Gas. The UVW does not include cargo, fresh potable water, additional optional equipment or dealer installed accessories.

* Estimated Average based on standard build optional equipment.

CCC (Cargo Carrying Capacity) ** is the amount of weight available for fresh potable water, cargo, passengers, additional optional equipment and accessories. CCC is equal to GVWR minus UVW. Available CCC should accommodate fresh potable water (8.3 lbs per gallon). Before filling the fresh water tank, empty the black and gray tanks to provide for more cargo capacity.

** Estimated average based on standard build optional equipment.

Each Forest River RV is weighed at the manufacturing facility prior to shipping. A label identifying the unloaded vehicle weight of the actual unit and the cargo carrying capacity is applied to every Forest River RV prior to leaving our facilities.

The load capacity of your unit is designated by weight, not by volume, so you cannot necessarily use all available space when loading your unit.

Actual towing capacity is dependent upon your particular loading and towing circumstances, which includes the GVWR, GAWR and GCWR as well as adequate trailer brakes. Please refer to the Operator's Manual of your vehicle for further towing information.

PRISM ELITE

PRISM ELITE STANDARD FEATURES

INTERIOR EQUIPMENT

- 32" 12Volt/110 TV with Stereo and Furrion Sound Bar (24F)
- Powered Jack Wing Antenna
- Pre-wired for Satellite Dish thru Coax Input
- Bedroom LCD TV Backer and Connections
- Convection Oven
- Composite Undermount Single Bowl Kit Sink w/Cover
- Stainless Steel Range Cabinet Guard over Stover Top
- Residential High Hoop Kitchen Faucet w/Sprayer
- Ceramic Tile Sink Backsplash
- Residential Style Vessel Lavatory Sink
- Residential Grade Lavatory Faucet
- Residential Grade Shower Head and Faucet
- Glass Shower Door
- Simulated Granite Shower Surround
- Porcelain Foot Flush Toilet
- (3) Speed Coach Power Vent Fan w/Maxxair Cover
- Black Curved Bar Grab Handle at Entrance Door
- Vinyl Soft Touch Ceiling

EXTERIOR EQUIPMENT

- Outside Shower
- Water Panel w/City/Tank/Winterize/Waste Tank Flush
- Heated Holding Tanks
- Automatic Transfer Switch
- Lighted Exterior Grab Handle at Entrance Door
- Heavy Duty, All Metal, Automotive Slam Latch Trunk Doors
- Slide Out Awnings (Where applicable)
- Full Fiberglass Front Cap w/ Integrated Front Wall
- Hellwig Swaybar - Enhanced Stability
- Towing Hitch w/7-way Plug

CONSTRUCTION

- 2" Laminated Walls
- 2" Steel Laminated Floor
- Laminated Crowned TPO Roof
- Even Cool A/C Duct System

LEAD DOG VALUE PACKAGE (MANDATORY)

EXTERIOR - High Gloss Color Infused Fiberglass Sidewalls, Fiberglass Front Cap, Aluminum Rims, 3.6 Onan LP Generator w/Auto Transfer Switch, Armless Power Awning w/LED Light Strip, LED Entry Door Light, Power Entry Step, Exterior Entertainment Center w/ Stereo and DVD Player, Solar Ready, LED Exterior Lights, Manual Rear Stabilizers, Exterior Privacy Windshield Cover

INTERIOR - 12V Coach LED TV/DVD, Touchscreen Multiplex Electrical Management System, Touchscreen Radio w/ Color Backup Camera, Rotating/ Reclining Two Tone Pilot/Co-Pilot Seats, Carbon Fiber Dash Applique, Recessed Cooktop w/Glass Lid, Lit Kitchen Backsplash, Euro Style 3-way Refer, Upgraded Kitchen Countertops and Sink Cover, Full Extension Roller Bearing Drawer Guides, Pop-up Power Tower, Day/Night Roller Window Shades, Tint Windows, Child Safety Tether, LED Interior Lights

STAND ALONE OPTIONS

TV & Entertainment

- Navigation
- 24" Bedroom LCD TV (N/A ON 24EF)

Interior

- Upgrade Serta Mattress (24J)
- Upgrade Folding Mattress (24G/24F)

Exterior

- Exterior Camp Kitchen Table
- Camping Cozy Package - Dual Pane Tinted Windows, Tank Pads, Upper Tank Valves
- 15K Low Profile Ducted A/C w/Heat Pump
- 3.2 KW Diesel Generator (Onan w/Auto Transfer)
- Heated Tank Pads
- Side View Cameras
- 4-point Hydraulic Automatic Levelers



Coach-Net®
RV Technical & Roadside Assistance



Coachmen®
Recreational Vehicles

423 N. Main Street • P.O. Box 30
Middlebury, IN 46540

www.coachmenrv.com

YOUR LOCAL DEALER



All information contained in this brochure is believed to be accurate at the time of publication. However, during the model year, it may be necessary to make revisions and Forest River, Inc., reserves the right to make all such changes without notice, including prices, colors, materials, equipment and specifications as well as the addition of new models and the discontinuance of models shown in this brochure. Therefore, please consult with your Forest River, Inc., dealer and confirm the existence of any materials, design or specifications that are material to your purchase decision. 11/16

©Copyright 2016 Coachmen RV a Division of Forest River Inc - All Rights Reserved.

PRISM ELITE