

# DURANGO GOLD

*Fulltime Luxury Fifth Wheels*





The wide open luxurious space of the Durango Gold 370RLT is a fulltimer's dream! Main living spaces offer plush furniture including dual swivel rocker recliners and a deluxe hide-a-bed sofa, LED lighting throughout, plush 22-ounce residential carpeting and an entertainment system that includes a radio, Bluetooth and two speaker zones, and an HD LED TV on a swing arm.

Kitchens include stainless steel appliances, a high-arching pullout faucet and stainless steel double-bowl sink, generous solid surface counters, and upper and lower storage cabinets with hidden hinges and large grab handles. Drawers offer heavy-duty 100-pound drawer glides. Island kitchen floorplans offer additional storage and work surfaces. The dinette has a table extension leaf, under-chair storage and two additional folding chairs for extra seating. 370RLT is shown with optional upgraded roller shades.





Bedrooms include an enormous closet with tons of door and drawer storage, including a shoe cubby, king-sized upgraded mattress (on most models) with bedspread and pillow shams, and a standard HD flat-panel bedroom TV.

Baths offer accent lighting, a one-piece fiberglass shower stall with glass doors and built-in seat, a porcelain foot-flush toilet, and extra-large solid surface bath vanity with stainless steel sink.





The 6-point leveling controls are located in the sealed battery storage compartment (no battery boxes required).

Durango's convenience center includes controls for the hot/cold exterior shower, cable/satellite hookups, city water connection, black tank flush control, winterizations center and color-coded instructions.

The drop frame allows for large pass-through storage – up to 180 cubic feet on some models!

G370RLT

G370RLT

G370RLT

G370RLT

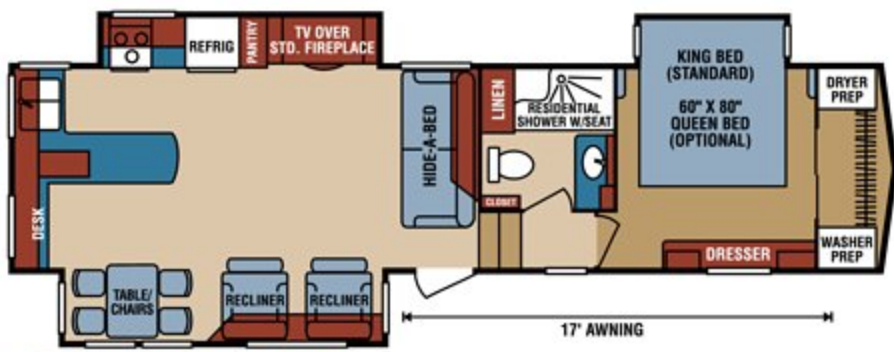

G353RKT

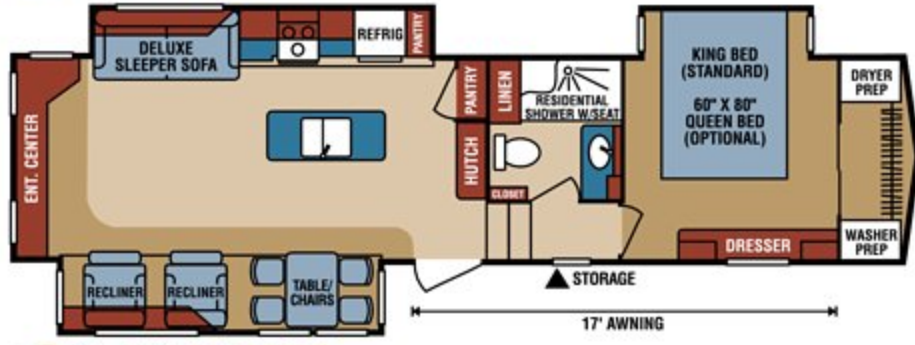

G359RET

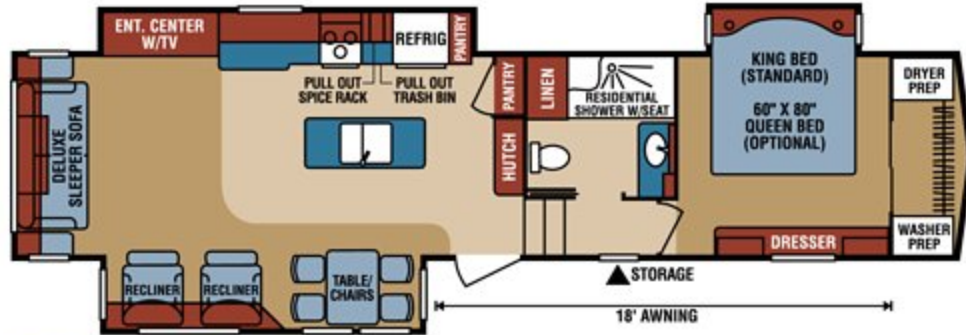

G370RLT

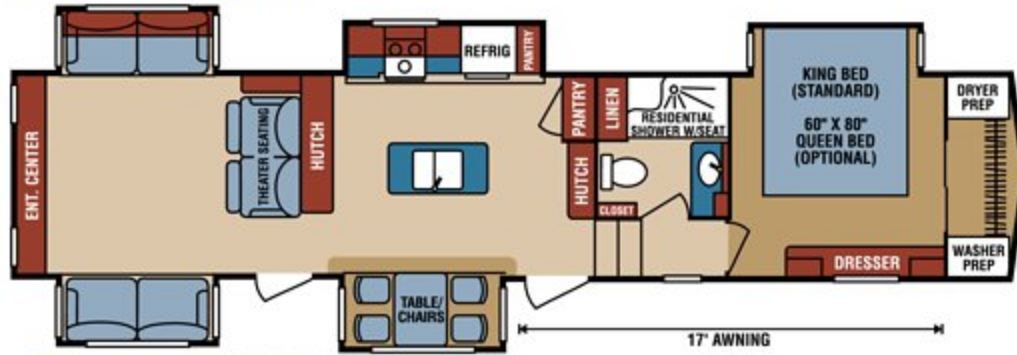

G381REF

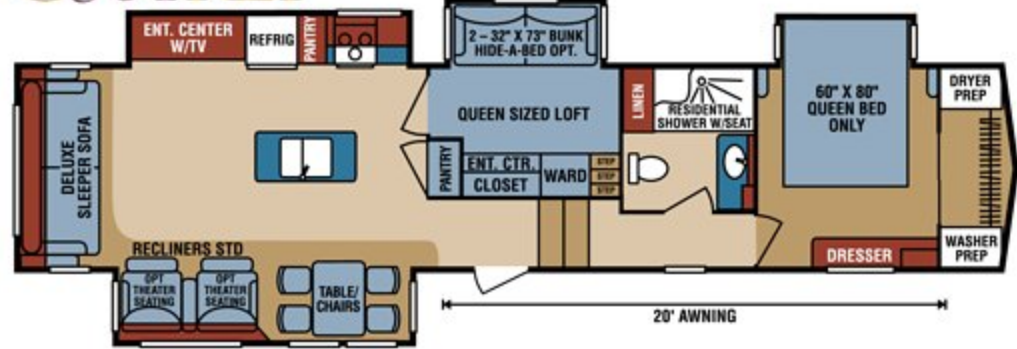

G383MBQ

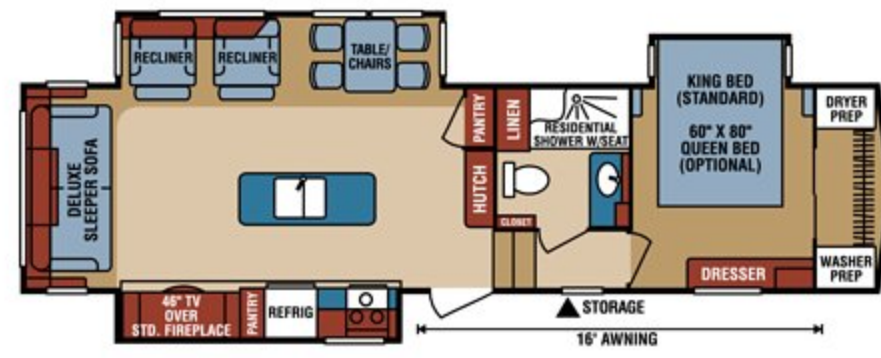

G355RLT

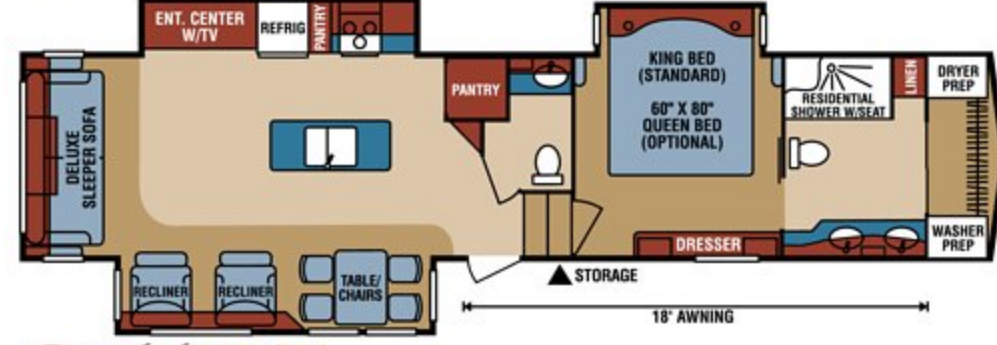

G366FBT

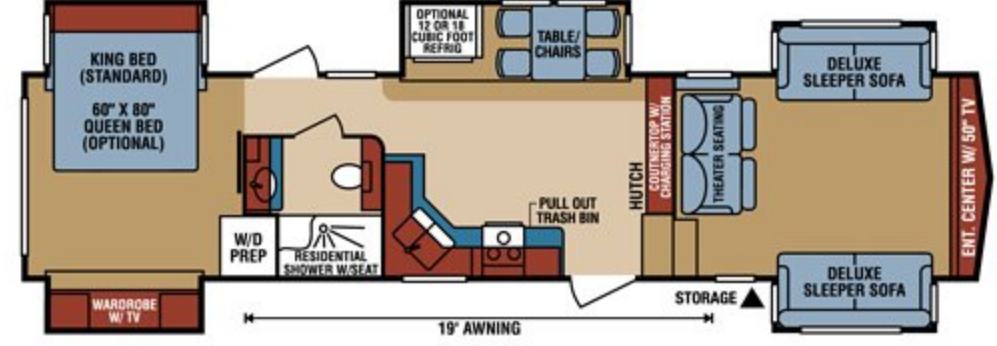

G380FLF

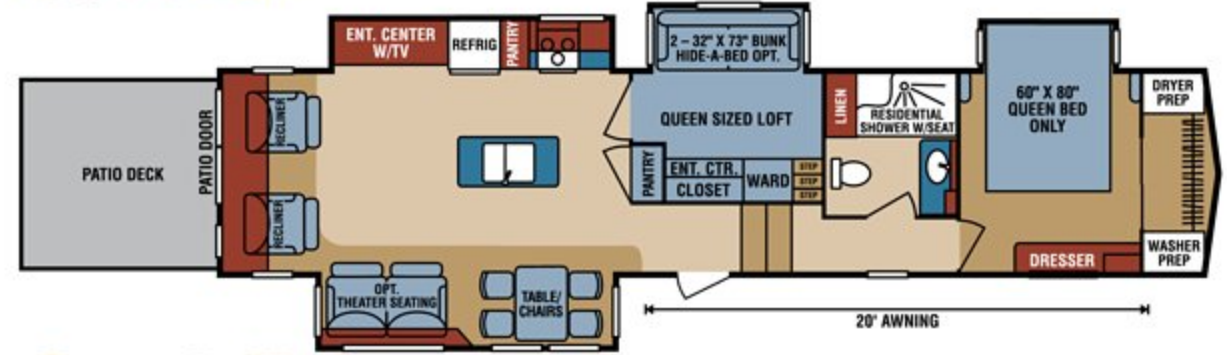

G382MBQ

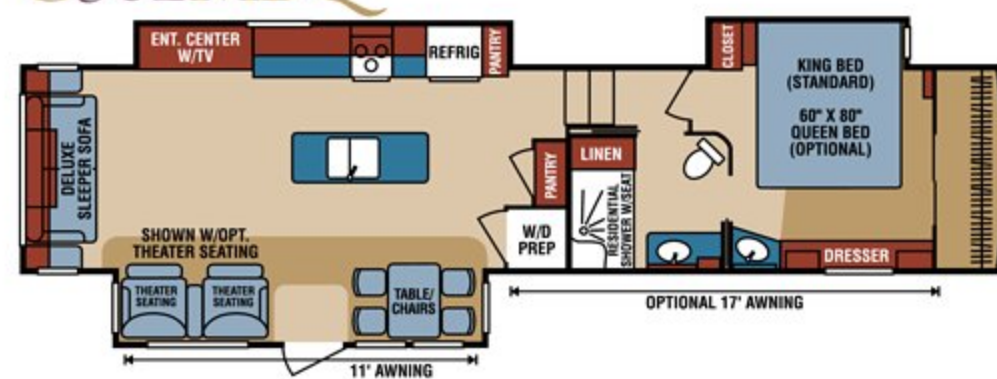

G384RLT

Fifth Wheels	G353RKT	G355RLT	G359RET	G366FBT	G370RLT	G380FLF	G381REF	G382MBQ	G383MBQ	G384RLT
UWV (Unloaded Vehicle Weight)*	11,090	10,900	10,640	11,470	11,686	12,580	12,120	13,330	12,600	12,250
Dry Hitch Weight*	2,130	2,290	2,190	2,240	2,250	2,250	2,250	2,120	2,200	2,530
Dry Axle Weight*	8,960	8,610	8,450	9,230	9,436	10,330	9,870	11,210	10,400	9,720
NCC (Net Carrying Capacity)	2,910	2,900	2,960	3,030	2,814	2,415	2,875	2,270	2,395	2,750
GVWR	14,000	13,800	13,800	14,500	14,500	14,995	14,995	15,600	14,995	14,995
Interior Height	76"	76"	76"	76"	76"	76"	76"	76"	76"	76"
Exterior Height w/ A/C	13'	13'	13'	12' 11"	12' 11"	13'	13'	13'	13'	13' 3"
Exterior Width	101"	101"	101"	101"	101"	101"	101"	101"	101"	101"
Exterior Length	36' 5"	36' 1"	36' 5"	39' 6"	39' 6"	40' 6"	41' 2"	40' 4"	40' 8"	40' 4"
Refrigerator (Cubic Feet)	8	8	8	8	8	8	8	8	8	8
Water Heater Cap. (Gal. G/E w/DSI)	12	12	12	12	12	12	12	12	12	12
Fresh Water Cap. (Gal.)**	67	67	67	74	67	67	67	67	67	67
Waste Water Cap. (Gal.)	57	57	57	57	57	57	57	57	57	57
Gray Water Cap. (Gal.)	97	97	97	97	97	57	97	97	97	97
LP Gas Cap. (Lbs.)	60	60	60	60	60	60	60	60	60	60
Furnace BTUs (1,000s)	35	35	35	35	35	35	35	35	35	35
Tire Size	16"	16"	16"	16"	16"	16"	16"	16"	16"	16"
Awning	17'	16'	17'	18'	18'	19'	17'	20'	20'	11' w/17'opt

\*This weight reflects the rolling average unit weight for each model. Your trailer weight will vary according to optional equipment. \*\*Including water heater capacity

## CONSTRUCTION FEATURES

- 101" Wide Body Construction
- 6-Sided 100% Aluminum Frame
- Extra-Reinforced Heavy-Duty Front Fiberglass Cap
- Radius Front Cap (for maximum turning radius on short bed trucks)
- 2" x 3" Welded Aluminum Fore & Aft Floor Joists
- 2" x 2" Welded Aluminum Sidewall Framing
- 5" Welded Aluminum Roof Trusses
- LCI® Hydraulic Slide System w/ Selector Valves
- Steel Powder Coated I-Beam w/ Drop-Frame Pass-Thru Storage (offering 160-180 CU FT, F/P specific)
- Lamilux® High-Gloss Ivory-Colored Fiberglass
- All Weather Insulation PKG (roof, floor, ceiling, endcaps & tanks to R-38)
- R-11 2" Sidewalls (w/EGS metal backing strips to hold all int. cabinets)
- One-Piece ABS Slideroom Bottoms; Slideroom Floors Insulated to R-24
- Walk-On Superflex® TPO Roof Membrane
- 45 Degree Aluminum Roof Edge & Fully-Vented Attic System
- Additional Outside Frame-to-Wall Floor Insulation
- 3/8" Roof Decking
- 5/8" Tongue & Groove, Screwed & Glued Plywood Floor Decking
- Full Drop-Frame Aluminum Skirt on Doorside
- Pex® In-Floor Heated Waterlines & Kitchen Gray Pipes (all waterlines & drainlines are located above all insulation)
- Fully Heated & Enclosed Underbelly
- Double Insulated & Heated Holding Tanks (R-38 above & below tanks)

## EXTERIOR FEATURES

- 7,000 LB Dexter® Axles w/Self Adjusting Brakes & Height Adjusting Hangers
- 8-Lug Heavy-Duty Aluminum Rims w/16" E-Range Radial Tires
- EZ Flex® Rubberized Suspension
- 4-Step Entry Step w/LED Light
- Roto-Flex® Hitch Pin

- 100% Exterior LED Running Lights & Taillights
- Carefree® Electric Awning w/LED Awning Lightbar (& illuminated reminder switch)
- Propane Bottles on same Side of Coach for Easy Access (30 lb. each)
- Sealed Battery Storage Compartment on Side of Coach (no battery boxes required)
- Dual Front Baggage Doors
- Slam Latch Baggage Doors w/Gas Strut Lifts (where applicable) & Dual Locks
- 50 AMP Service w/Marine Power Cord
- Painted Front Cap w/LED Accent Lights
- Frameless Windows
- Dual 15,000 BTU "Quiet Cool" Ducted A/C System
- 3" x 14" In-Floor Straight Line Heating System w/35,000 BTU Furnace
- 12 GAL Gas/Electric Hot Water Heater
- LED Entry Door Floodlight
- LED Docking Light & Sewer Hookup Light
- Swing-Away Assist Grab Handle
- Underneath Spare Tire w/Hoist & Roof Ladder
- Deluxe Heated Water Convenience Center (incl. black tank flush, power fresh tank water fill, winterizing system, outside shower & dry camping water siphon system)
- Fully-Finished, Heated & Sealed Basement Storage Compartment
- Heated & Enclosed Dump Valves
- Battery Disconnect
- Outside Speakers & Pre-Wire for Exterior TV
- Satellite Pre-Wire (roof & ground)

## EXTERIOR OPTIONS

- 6-Point Hydraulic Auto Leveling System
- 2nd Lighted Power Awning (N/A 355, 380)
- Slideout Awning PKG (N/A if 2nd awning is optioned)
- Tailgate Storage System w/Bike Rack
- Dual-Pane Frameless Windows
- Generator Prep & OPT Onan® 5500 LP Generator

- Trailair® Flex Air® Pin Box Upgrade
- G-Range Tires

## LIVING ROOM/KITCHEN FEATURES

- Solid Surface Countertops w/Sink Covers w/Large Handholds
- Large Residential Double Bowl Stainless Steel Sink\*
- High Arch Pullout Sprayer Faucet
- Residential Size Pullout Trashcan in Kitchen
- Pullout Spice Rack (most models)
- Dual Pullout Pots & Pans Drawers under Refrigerator & Stove
- Removable Silverware Tray
- Storage Shelf under Kitchen Sink
- All Kitchen OH Cabinets have Shelf & Extra-Tall Slide Lips
- Heavy-Duty 100 LB Drawer Glides on Every Drawer
- Baltic Birch Drawer Boxes
- LED-Lighted Kitchen Cabinet Toe Kicks (most models)
- Flush-Mounted Glass Folding Stove Cover
- Large Dining Table w/Removable Leaf & 2 Heavy-Duty Storage Seat Chairs & 2 Folding Chairs
- Kitchen Window (most models)
- Hidden Cabinet Door Hinges
- 5" Stainless Steel Cabinet Hardware
- Window Shades Throughout
- 3/8" Re-Bond Carpet Pad w/22 OZ Residential Carpet
- 30" Microwave above Range
- XL Light Switches (N/A 384RLT)
- Faux Vinyl Soft Touch Ceiling
- Power Vent Kitchen Fan
- Power Vent Fan in Second Bath (366FBT)
- XL Ceiling Crown Molding
- All LED Ceiling & Cabinet Lights w/ Multiple On/Off Switches
- 39" - 50" HD LED TV on Swing Arm w/built-in storage behind TV (most models)
- 12V Entertainment System (Radio) w/Bluetooth, 2 Speaker Zones
- Dual Residential Swivel Rocker Recliners
- Deluxe Hide-a-Bed Sofa
- Electric Fireplace

## LIVING ROOM/KITCHEN OPTIONS

- Theater Seat IPO Dual Recliners
- Booth Dinette IPO Free-Standing Table & 4 Chairs (N/A 381, 380)
- 18 CU FT 120V Residential Refrigerator w/1000W Inverter or 18 CU FT 4-Door RV Refrigerator
- Power Vent Bath & Bedroom Fan w/ Remote Controls
- Central Vacuum System
- Single Bowl Sink in place of Double
- Dishwasher (requires single bowl sink) (N/A 380, 381, 382, 383)
- Day/Night Roller Shades

## BATHROOM/BEDROOM FEATURES

- Residential One-Piece Fiberglass Shower Stall w/Built-In Seat & Glass Doors
- Shower Skylight
- XL Solid Surface Bath Vanity w/ Stainless Steel Sink
- Porcelain Foot-Flush Toilet
- All LED Lights in Bed & Bath w/ Multiple Switches
- Heavy-Duty 100 LB Drawer Glides on all Drawers
- Extra-Wide Bed & Bath Hallway (most models)
- Pocket Door from Hall to Bath (most models)
- Bath Towel Bar & Towel Loop (where applicable)
- 12V Fan
- XL Bath Linen Closet
- XL Deep Bedroom Walk-In Closet
- Dual Washer & Dryer Prep
- XL Under-Bed Storage
- Luxurious Bedspread & Pillow Shams
- HD Flat Panel Bedroom TV
- 72" x 80" King-Size Upgraded Mattress (N/A 382, 383)

## BATHROOM/BEDROOM OPTIONS

- 60" x 80" Queen-Size Upgraded Mattress (std. 382, 383)
- Power Vent Fan

## Bonus FEATURES

2-Year limited warranty (see flyer)

Lightest high-profile, wide body, luxury fifth wheels in the industry (average weight under 12,000 LBS)

K-Z RV has received the Dealer Satisfaction Index Award for 16 years

K-Z's 44 years of stable, dedicated manufacturing experience, coupled with its predominant Amish workforce, heritage and commitment to superb quality, allow us to produce the lowest-priced luxury fifth wheel available.

*\*Due to continual research and advances, manufacturer reserves the right to change specifications, design, price and equipment without notice, and assumes no responsibility for any error in this literature. Some items shown are not included as standard or optional equipment.*

Alabaster Décor

Aurora Décor

Galaxy Décor

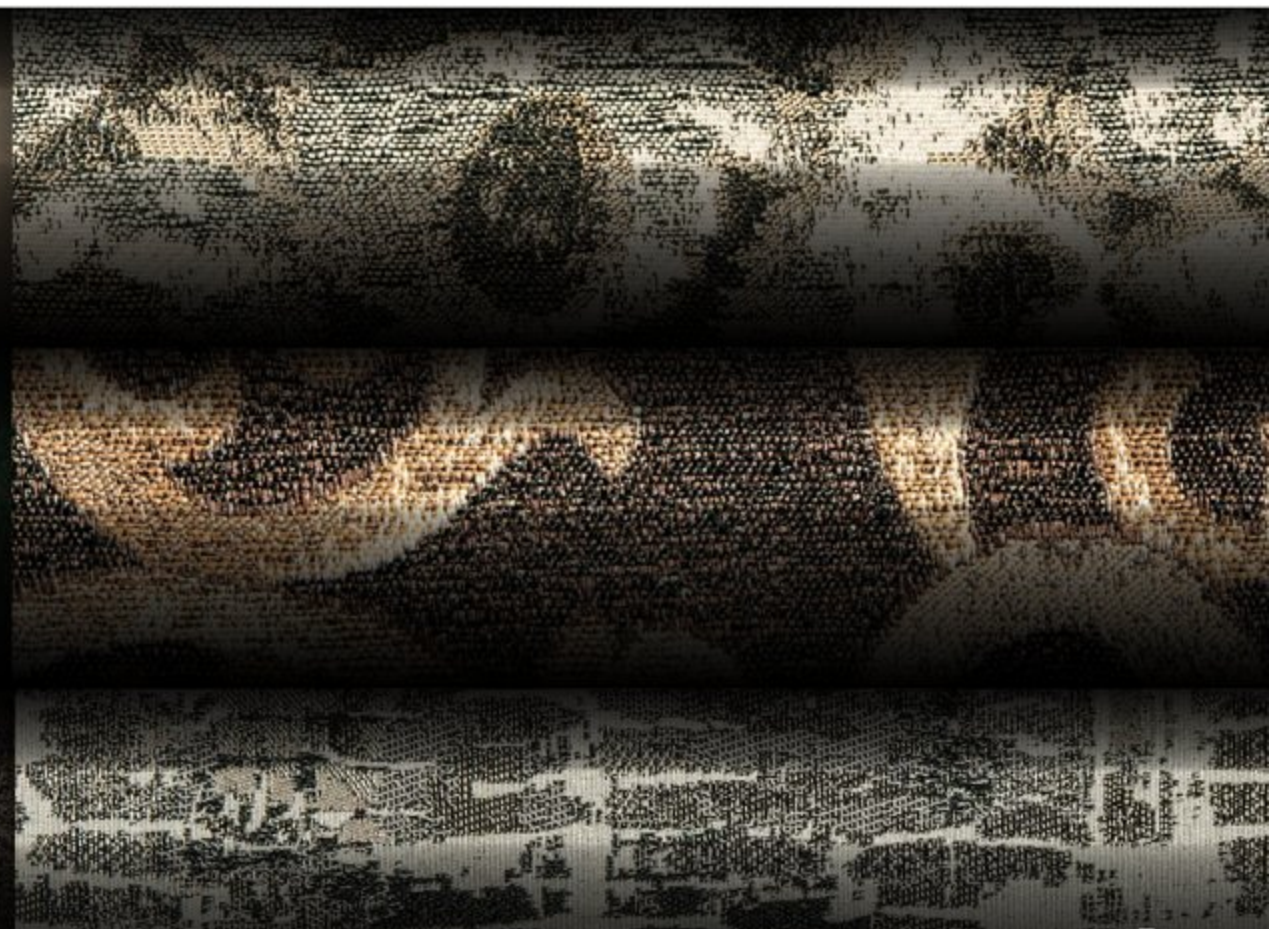

# BEAUTY that's more than SKIN DEEP



Outside, Durango maintains its striking good looks with a Lamilux® high-gloss colored gelcoat fiberglass front cap and smooth fiberglass sidewalls. Underneath that outer skin, you'll find 6-sided 100% aluminum-framed construction, an all-weather insulation package, a fully-enclosed and heated underbelly and water system, and a huge fully-finished, heated and sealed pass-through storage compartment. Down below, Durango Gold offers top-of-the-line Dexter® axles with auto-adjusting brakes and height-adjusting hangers, and the EZ Flex® rubberized suspension.

All in all, we believe that any model you choose of the Durango Gold line of quality full-time luxury fifth wheels is sure to offer the perfect getaway home.

Visit your local dealer and see for yourself.



**RVIA**



Portions of this brochure were used with the expressed authority of Dexter Axle, but Dexter Axle is not responsible for the accuracy of the information contained herein.

985 N 900 W • Shipshewana, IN 46565  
E-mail [kz@kz-rv.com](mailto:kz@kz-rv.com)  
[www.kz-rv.com](http://www.kz-rv.com)

K-Z strongly encourages our retail customers to purchase from their local dealership whenever possible.

Dealer: