

# FREEDOM EXPRESS BLAST

Whether you're hauling mini-bikes or motocross, four wheelers or Fat Boys, there's a Freedom Express Toy Hauler for you. The 271 BL has a front walk-around queen bed, large bathroom with abundant storage and a 10' open garage to haul all of your toys. The Deep Slide 301 BLDS has a 10' enclosed garage with a slider patio door. Both models have raised roof lines and a beavertail ramp transition.



301 BLDS



DECOR



## Blast Toy Hauler Standards

- Frame Mounted Tie-Down D-Rings In Floor
- Adjustable High/Low Fresh Air Vents
- Zippered Roll-up Screen Wall with Privacy Panels at Ramp Door
- Two Jackknife Sofas in Cargo Area
- Large Indoor/Outdoor Folding Table
- Raised Roof Line - 90" Interior Cargo Height
- Beavertail Ramp Transition
- Sliding Patio Door Between Cargo and Living Areas (301 BLDS Only)
- Helmet/Gear Storage in Cargo Area
- Hinge Mounted Spring Assist Ramp Door System
- Integrated Bar and Latch Locking System on Ramp Door
- A-Frame Mounted Generator/Storage Rack (N/A on Liberty/Maple Leaf Editions)

## Freedom Value Package (Required)

- ¾ Gel Coated Fiberglass Front Cap with LED Lights
- Aluminum Wheels
- Spare Tire Kit

- Detachable Power Cord
- Power Awning with LED Rope Light
- Magnetic Catches for Compartment Doors
- Tinted Safety Glass Windows
- Front Diamond Plate
- TV & Radio Antenna with Booster
- E-Z Lube® Axles
- Spread Axle Design
- Heated Enclosed Underbelly
- Solar Port
- Folding Entry Assist Handle
- Exterior Shower Station
- Winterize Ready Kit
- Black Tank Flush
- 2 Exterior Speakers, 4 Interior Speakers
- Ducted Furnace
- Ducted Ceiling Air Conditioning
- AM/FM/CD/DVD/Bluetooth
- LED TV's
- Satellite Ready
- LED Interior Lighting
- Night Shades
- Congoleum Designer Carefree Flooring
- Mortise and Tenon Cabinet Doors
- Stonecast Sink
- Sink Cover
- Microwave

- Oven with 3 Burner Cooktop
- Butcher Block Stove Cover
- 6 Cu. Ft. Two Door Refrigerator
- Silverware Drawer (Select models)
- 60" x 80" Queen Bed
- Skylight in Bath
- RVIA
- 12" LED Step Light
- LED Light Strip in Pass-through Storage
- 24" x 48" Resin Outdoor Table
- Multiple USB Locations
- Porcelain Toilet with Foot Flush

## Options

- Freedom Toy Hauler Party Deck
- Electric Track Queen Bed
- WIFI + 4G LTE Extender
- 8 Cu. Ft. Refrigerator
- Radiant Barrier Pack
- Outdoor Grill Station
- 15K BTU Roof AC
- 50 AMP Service with Second AC Prep
- Frameless Windows
- Power Tongue Jack
- RV Eye Cameras
- Canadian Compliance

Note: Some features and options listed are not available on 17 BLSE.



This multi-purpose fold down sofa can be used on or off of the wall track, and converts to a sleeping area. The 60" x 80" queen overhead bunk shown is optional.



FREEDOM TO EXPLORE



# FREEDOM EXPRESS BLAST

17 BLSE



- 50% Lighter than wood
- No rot, mold or water damage
- R-2 thermal insulation
- Odorless, no formaldehyde
- Sound and energy absorbing
- Impact and puncture resistant
- Made in USA

Freedom Express Blast	17 BLSE	271 BL	301 BLDS	301 BLDSLE
UVW*	3,576	5,806	6,819	6,993
Hitch Weight	426	799	901	953
Carrying Capacity	2,324	3,194	3,081	2,907
Exterior Length (Bumper to Hitch)	20' 4"	30' 11"	33' 7"	33' 7"
Exterior Height (Includes A/C)	10' 3"	11' 9"	11' 10"	11' 10"
Interior Height (Coach)	81"	90"	90"	90"
Awning Length	12'	20'	18'	18'
Fresh/Grey/Waste Water Capacity (gal.)	49/33/33	98/33/33	98/33/33	98/33/33
Tire Size	ST205/75R14C	ST225/75R15D	ST225/75R15D	ST225/75R15D

\*Unloaded vehicle weights do not include options. See below for definitions of chart descriptions.

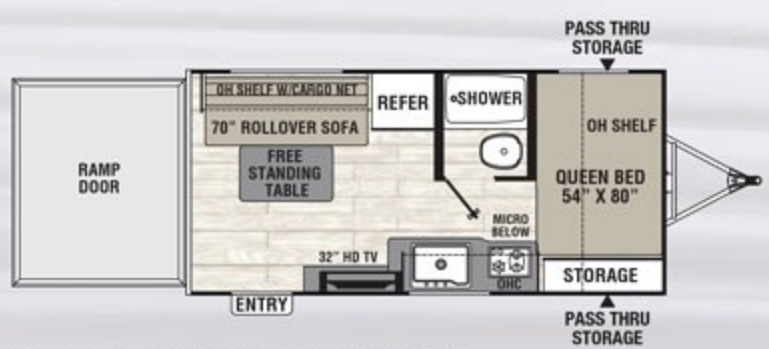

17 BLSE / Exterior Length 20' 4"

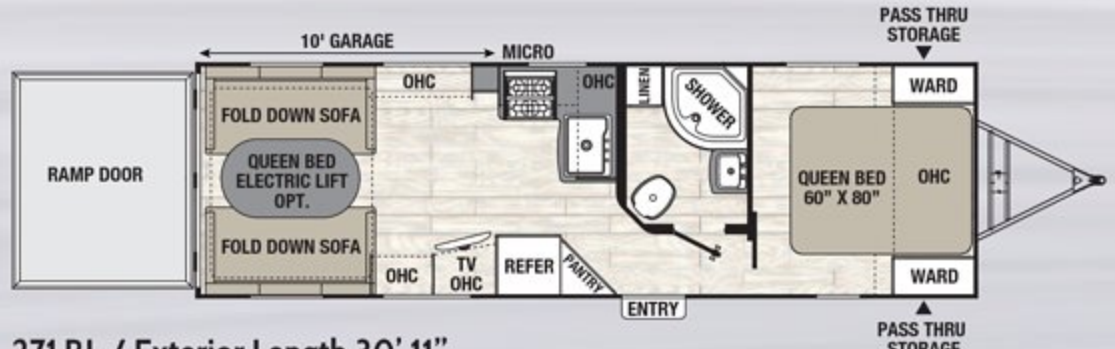

271 BL / Exterior Length 30' 11"

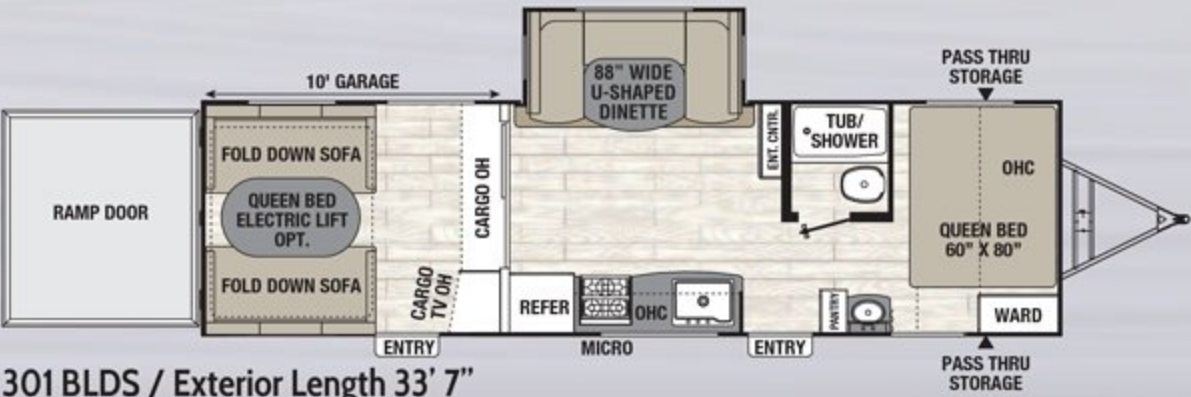

301 BLDS / Exterior Length 33' 7"

The 17 BLSE shown here is our value added Toy Hauler. Please see Select Value Package and Options for this floorplan



Your Freedom Express Dealer

423 N. Main Street ■ P.O. Box 30 ■ Middlebury, IN 46540  
 To learn more about Coachmen RV and our products and see how Coachmen is making the easy life easier, visit [www.coachmenrv.com](http://www.coachmenrv.com) or call 1.800.353.7383.

**GVWR (Gross Vehicle Weight Rating)** - is the maximum permissible weight of the unit when fully loaded. It includes all weights, inclusive of all fluids, cargo, optional equipment and accessories. For safety and product performance do NOT exceed the GVWR.

**GAWR (Gross Axle Weight Rating)** - is the maximum permissible weight, including cargo, fluids, optional equipment and accessories that can be safely supported by a combination of all axles.

**UVW (Unloaded Vehicle Weight)\*\*** - is the typical weight of the unit as manufactured at the factory. It includes all weight at the unit's axle(s) and tongue or pin and LP Gas. The UVW does not include cargo, fresh potable water, additional optional equipment or dealer installed accessories.

\*Estimated Average based on standard build optional equipment.

**CCC (Cargo Carrying Capacity)\*\*** - is the amount of weight available for fresh potable water, cargo, additional optional equipment and accessories. CCC is equal to GVWR minus UVW. Available CCC should accommodate fresh potable water (8.3 lbs per gallon). Before filling the fresh water tank, empty the black and gray tanks to provide for more cargo capacity.

\*\* Estimated average based on standard build optional equipment

Each Forest River RV is weighed at the manufacturing facility prior to shipping. A label identifying the unloaded vehicle weight of the actual unit and the cargo carrying capacity is applied to every Forest River RV prior to leaving our facilities.

The load capacity of your unit is designated by weight, not by volume, so you cannot necessarily use all available space when loading your unit.

All information contained in this brochure is believed to be accurate at the time of publication. However, during the model year, it may be necessary to make revisions and Forest River, Inc., reserves the right to make all such changes without notice, including prices, colors, materials, equipment and specifications as well as the addition of new models and the discontinuance of models shown in this brochure. Therefore, please consult with your Forest River dealer and confirm the existence of any materials, design or specifications that are material to your purchase decision.

©2017 Freedom Express by Coachmen, a Division of Forest River, Inc., a Berkshire Hathaway company. All Rights Reserved. 9/17

Learn More  
Scan this barcode using a QR Reader on your smart phone to learn more about Forest River.

Find us on Facebook



[www.ForestRiverBuyLocal.com](http://www.ForestRiverBuyLocal.com)