

# PRISM & PRISM ELITE

CLASS C MOTORHOMES

# Prism

By Coachmen

# Prism ELITE

By Coachmen



UNIQUE STYLING IN A MULTI-USE TOURING VEHICLE.



# PRISM ELITE EXTERIOR FEATURES

## PRISM ELITE

### Top Features

- 1 The Mercedes Sprinter chassis is easy on fuel and on the eyes. It also delivers the great ride and drivability Mercedes is famous for.
- 2 Molded Fiberglass Cabover Bunk with LED lights allows sleek aerodynamic appearance along with added utility.
- 3 Integrated Curved wing walls reduce wind resistance and add polished automotive styling.
- 4 One Touch "Armless" power awning is effortless, efficient and durable. Equipped with an LED light strip to safely enjoy the outdoors.
- 5 Beneath the stars or the full length awning, enjoy your favorite movies and/or music and fresh air at the same time with the outside entertainment system.
- 6 Exterior lighted grab handle makes locating the entry easier and safer at night.
- 7 Exterior Storage compartments upgraded with heavy duty, pre-fabricated, hinged luggage doors equipped with easy access slam latches.
- 8 The aluminum electric entry step, low center of gravity construction and a lit grab bar make entry and exit easier than ever!
- 9 Prepare meals while enjoying the family at the same time using the exterior camp table. (Optional)
- 10 Sleep comfortably with the added privacy, increased safety and efficient climate control benefits of the exterior windshield cover.
- 11 Control your Prism Elite right inside the door with the convenience of the touch of a finger on the lighted touch panel and via bluetooth application.

Not Pictured: 20-gallon (85 lbs.) LP tank is larger than the competition.

## FULL BODY PAINT OPTIONS



Desert Sand



Burgundy



Titanium



Color-infused high gloss fiberglass with Azdel™ Superlite substrate sidewalls are lightweight, durable and resistant to moisture. Virtually eliminates de-lamination.





## PRISM ELITE INTERIOR FEATURES

Immerse yourself into any adventure with the brand new Prism Elite series. At Coachmen, we pride ourselves in providing you with an RV that offers the most standard feature content on the market, creating the perfect combination of versatility and practicality. You can now travel without limitations, while still enjoying the luxuries you demand.

- Two Tone Cabinetry Throughout
- Upgraded Leather Pilot Chairs
- Carbon Fiber Dash Appliqué
- Congoleum Designer Carefree Flooring
- Coachmen EvenCool Air Conditioning and Ductwork system
- Soft Touch Ceiling
- Power Vent Fan in Living Area
- "My RV" Touchscreen Control Panel easily operates lights, slides, awning, and generator
- Upgraded furniture and fabrics
- Color Back Up Monitor with 1-Way Audio
- Slow Rise Day/Night Shades
- Countertops outfitted with Solid Surface Edge
- Recessed Cook Top with Glass Cover
- Undermount sink equipped with Residential Faucet with Sprayer
- Convection Microwave
- 110V and 12V USB port on "Power Tower" in Kitchen
- Ample Seating with Safety Belts and Child Safety tether at forward facing dinette.



24EF shown with Platinum décor



## PRISM MOTORHOMES

Whether exploring on a weekend getaway or traveling across the country, Prism gets you there in style. It's the perfect marriage between experience, dependability and value from the Industry's premier maker with the economy and prestige of the Mercedes diesel chassis. The Prism is a luxurious, easy to drive, multi-use touring vehicle that provides unique styling and amenities. From the interior's thoughtfully designed floorplans, residential cabinetry, designer flooring and versatile interior storage and multiple access doors for exterior storage space, LED running lights, tinted windows and stylish fiberglass wrap; the Prism is ideal for short or long trips. As one of the top selling brands in the nation, Coachmen has been providing generations a product they have relied on for over 50 years.



## PRISM Top Features

- 1 The Mercedes Sprinter chassis is easy on fuel and on the eyes. It also delivers the great ride and drivability Mercedes is famous for.
- 2 A power entry step automatically deploys and retracts when opening or closing the door allowing for easy entry and exit.
- 3 The One Touch full-length power awning is easy to open and close and comes with adjustable arms for more shade or rain water run off.
- 4 Slide room awnings protect your slides from the elements and keeps them free of debris.
- 5 3.6 KW Onan LP generator provides full power for tailgating or while dry camping.
- 6 Watch your favorite movies while still enjoying the fresh air with the outside entertainment system. (Optional)
- 7 The "warehouse" exterior storage provides you with industry-leading exterior space that is great for both long and short term stays.
- 8 Sleep safely and peacefully with the exterior privacy windshield cover. (Optional)
- 9 Superior fresh water capacity – on average 20% more than the competition.

Not Pictured: 20-gallon (85 lbs.) LP tank is larger than the competition.





## PRISM INTERIOR FEATURES

With the Prism series, you get all the standard features that Coachmen has built a reputation for at an unbeatable value. Equipped with the amenities experienced travelers expect, the Prism affords you the opportunity to explore any adventure with comfort and convenience.

Large Overhead Bunk with Child Safety Net

Rotate and recline pilot and passenger seats

Back-up Camera and Monitor

LED lighting throughout

Congoleum Designer Carefree Flooring

Coachmen EvenCool Air Conditioning and Ductwork system

Hardwood Cabinet Doors

3 Burner Cook top with Oven

Residential Size Microwave

2-way RV refrigerator

Deep double bowl kitchen sink with lid

Sturdy pedestal table

Ample seating with safety belts

Child safety tether at forward facing dinette

Kitchen and Bed areas 110V & 12V charging stations



2150 shown with Graphite décor



2150 shown with Graphite décor



2200 shown with Nickel décor



# PRISM ELITE FLOOR PLANS / STANDARDS & OPTIONS

## 24EF

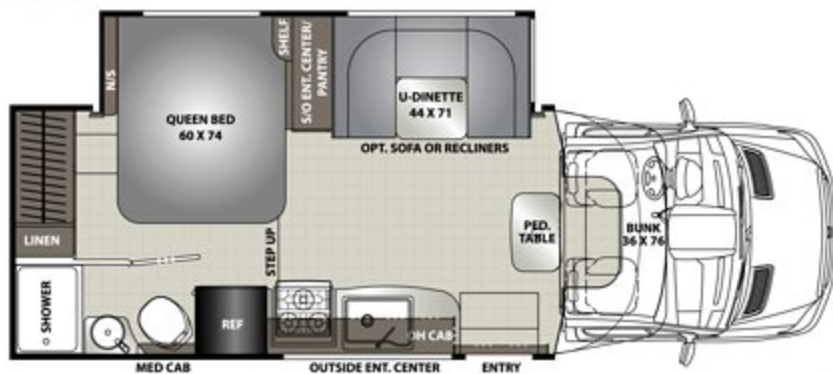

## 24EG



## 24EJ

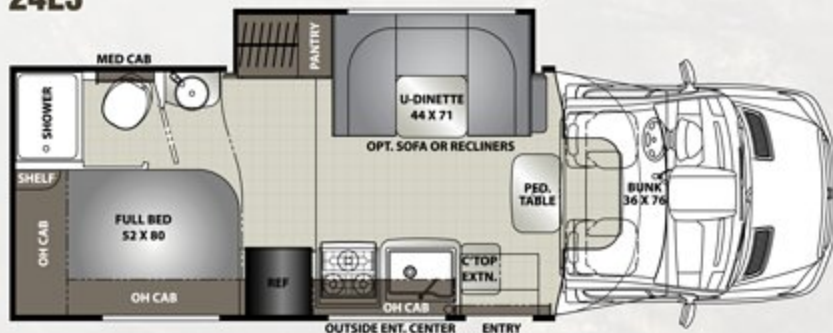

### Optional Sofa



### Optional Recliner



### Standard Driver/Passenger Swivel Seats



## STANDARD

### WARRANTY

Motorhome – 12 Month/  
12,000 Mile Limited Warranty  
Chassis Warranty – See Chassis  
Owners Manual  
Travel Easy Roadside Assistance

### EXTERIOR/CONSTRUCTION/ CHASSIS

26-Gallon Fuel Tank  
3.0 liter V-6 Turbo Diesel  
Driver & Passenger Air Bags  
Cruise Control  
Tilt Steering Wheel  
Dash Air Conditioning  
Power Windows & Locks  
Exterior Mirrors w/Remote  
3500# Towing Hitch w/7-Way Plug  
Vacuum Bonded Aluminum 2" Floor  
Vacuum Bonded Aluminum  
2" Sidewalls  
Crowned, Laminated TPO Roof  
Steel Entry Step w/Battery Storage  
Carmel Exterior Moldings  
Carmel Slam Latch Trunk Doors  
Carmel 80" Radius Ent Door  
w/Window, Deadbolt & Strut  
Carmel Lamilux 4000 Sidewalls  
& Rear Wall  
Vinyl Graphics  
Roto Mold Rear Trunk Box/  
Plasti-Cote Metal side Boxes  
Fiberglass Rear Cap  
Fiberglass Front Cap  
w/Door Step Lights  
Fiberglass Running Boards  
Fiberglass Wheel Skirts  
Aluminum Rims  
Black Armless Awning w/LED Lights  
Smooth Exterior Range Vent  
Black Rear Ladder (N/A 24EJ)  
Exterior LED Lights w/Center Bar  
LED Accent Strip Lights in Front Cap  
Spare Tire  
Slide Out Awnings (where applicable)  
Power Single Step  
Trunk Door Magnet Holders

### INTERIOR APPOINTMENTS

Two Tone Cabinetry Throughout  
Satin Nickel Hardware  
Kitchen Countertop  
w/Solid Surface Edge  
Congoleum Designer  
Carefree Flooring  
Vinyl Soft Touch Ceiling

Roller Bearing Metal Drawer  
Guides throughout  
Poplar Drawers  
Day/Night Window Shades  
& Valance Topper  
Tinted Radius Slider Windows  
Rotate/Recline 2-Tone Pilot &  
Passenger Seats  
U-Dinette (24EJ/24EF)  
Booth Dinette (24EG)  
Single Child Tether at Forward  
Facing Dinette  
Shaker House Type Bath Door  
Black Receipts/Rotaires/Switches  
Black Curved Bar Grab Handle at  
Entrance Door  
Vinyl Padded Up & Angle Pads  
Vinyl Padded Headnocker  
Magazine Rack above Entrance  
Door (N/A 24EJ)  
Carbon Fiber Dash Appliques

### INTERIOR EQUIPMENT

Passenger & Driver Swivel Seats  
Powered Jack Wing Antenna  
LP Leak Alarm  
Smoke Detector  
Carbon Monoxide Detector  
Fire Extinguisher  
Touch Screen Radio & Color  
Backup Camera Monitor  
w/Dash Speakers  
Bedroom LCD TV Backer  
& Connections  
12V Coach LCD TV/ASA DVD,  
Speakers & Subwoofer  
(N/A 24EF)  
Pre-wired for Satellite Dish  
through Coax Input  
12V 32" TV Stereo/Sound Bar  
(24EF)

### GALLEY

Convection Oven – Black  
Euro Style 3-Way Refrigerator  
Undermount Single Bowl Kitchen  
Sink w/Cover  
Stainless Steel Range Cabinet Guard  
Recessed Suburban Cooktop  
w/Glass Lid  
Satin Nickel High Hoop Kitchen  
Faucet w/Spray  
Kitchen Flip-Up Countertop  
Extension (24EG/24EJ)  
Lit Kitchen Backsplash  
Dream Dinette (24EG)  
Silver Table Base (24EF/24EJ)

## BATH AND WATER

Water Panel w/City/Tank/Winterize/  
Waste Tank Flush  
Low Point Drain & Winterize Valve  
at Fresh Tank  
Outside Shower  
Power Bath Vent  
Demand Water Pump  
Tile Sink Backsplash  
Vessel Lavatory Sink  
Satin Nickel Vessel Style  
Lavatory Faucet  
Satin Nickel Shower Head & Faucet  
Lavatory Mirror  
Glass Shower Door  
Satin Nickel Towel Ring/TP Holder/  
Robe Hooks  
Calcutta Gold Sentrel  
Shower Surround  
ABS Molded Shower Pan  
Porcelain Foot Flush Toilet  
6-Gallon Gas E.I. Water Heater  
Skylight Over Shower  
Trunk Door at Termination

## SLEEPING

Queen Bed 60" x 74" (24EF/24EG)  
Queen Bed 52" x 80" (24EJ)  
Cab Over Bunk 36" x 76"  
(Fabric Covered)  
Bedsprad  
Windshield Privacy Cover  
Nightstands  
Bedroom Privacy Curtain w/Track  
Padded Headboard (24EF/24EJ)

## ELECTRICAL/HEATING/AC

30 Amp Power Cord  
55 Amp Electronic Converter  
Dual Auxiliary Battery  
Detachable Power Cord  
Auto Transfer Switch  
3.6 KW LP Generator (Onan)  
GFI Circuit  
Black Manual Auxiliary Battery  
Disconnect  
18,000 BTU E.I. Ducted Furnace  
13,500 Low Profile Ducted A/C  
Recept & Coax Connection  
under Awning  
LED Interior Lights  
Exterior Entertainment Center  
(24" TV/Stereo/DVD/HDMI/  
Speakers)  
Lighted Exterior Grab Handle  
at Entrance Door  
MY RV System Command Center  
Exterior Rear Compartment Light – LED  
Heated Holding Tanks

Pop-Up Kitchen Recept  
Exterior Solar Panel Plug in  
Connection (by Entry Door)  
Bed Area 110V CPAP Ready Area  
& 12V/USB Charging Station  
Coach Power Vent Fan  
w/Maxxair Cover

## OPTIONAL

### STAND ALONE OPTIONS

Bedroom 24" LCD TV (N/A 24EF)  
Exterior Camp Kitchen Table  
Upgrade Serta Mattress (24EJ)  
Upgrade Folding Mattress (24EF/24EG)  
15K Low Profile Ducted AC  
w/Heat Pump  
Onan 3.2 KW Diesel Generator  
**Camping Cozy Package**  
Dual Pane Tinted Windows  
& Extra Knife Valves  
Heated Tank Pads  
Side View Cameras  
Full Body Paint – Titanium  
Full Body Paint – Desert Sand  
Full Body Paint – Burgundy  
Painted Cab  
Navigation Capable Radio and  
Backup Monitor Interface  
4 Point Hydraulic Jacks  
Sofa Option  
Dual Recliner Option

## DÉCOR OPTIONS



PLATINUM

GARNET

*Due to continuous improvement,  
Standards and Options subject  
to change without notice.*



2150



2250

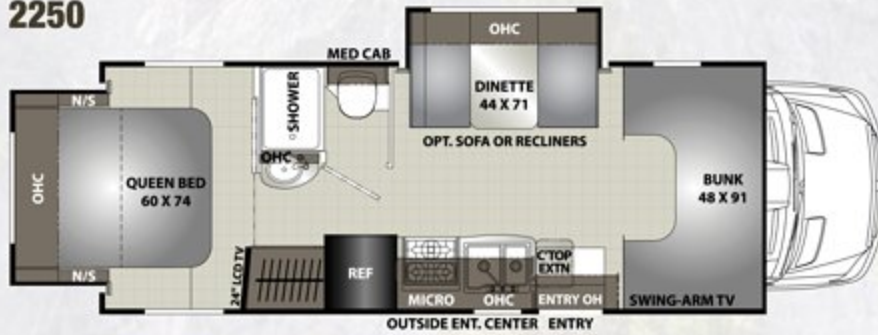

2200

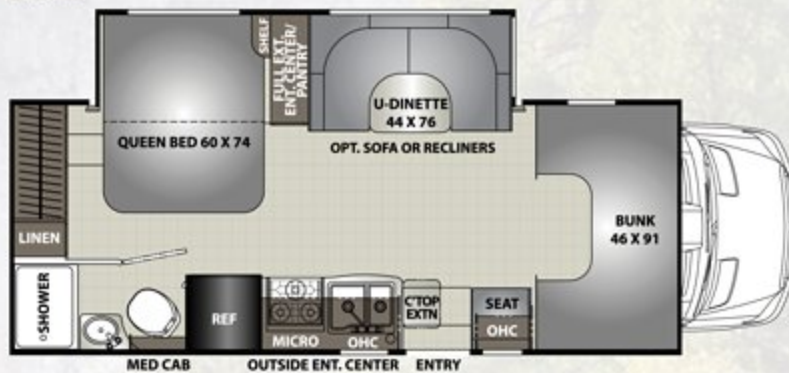

Optional Sofa



Optional Recliner



Standard Driver/Passenger Swivel Seats



## STANDARD

### WARRANTY

Motorhome – 12 Month/  
12,000 Mile Limited Warranty  
Chassis Warranty – See Chassis  
Owners Manual  
Travel Easy Roadside Assistance

### EXTERIOR/CONSTRUCTION/ CHASSIS

26-Gallon Fuel Tank  
Driver & Passenger Air Bags  
Deluxe Chassis Package  
Cruise Control  
Tilt Steering Wheel  
Roto Cast Rear Trunk Box/Metal  
Side Boxes  
Dash Air Conditioning  
3,500 lb. Towing Hitch  
w/7-Way Plug  
2" Steel Vacuum Bonded Floor  
2" Aluminum Vacuum Bonded  
Sidewalls with Lamilux 4000  
Color Infused Fiberglass  
Crowned, Laminated TPO Roof  
Power Double Entrance Step  
Steel Entry Step box  
Rubber Entry Step Treads  
Dead Bolt Lock Entrance Door  
Carmel 80" Radius Entrance Door  
w/ Built-in Strut  
Black Arm Power Patio Awning  
Black Slide Out Awnings  
Power Windows & Locks  
Spare Tire  
Stainless Steel Wheel Inserts  
Carmel High Gloss Sidewalls  
& Rearwall  
Rear Steel Tube Bumper  
Smooth Exterior Range Vent  
Exterior TV Ready Area  
Underhood DEF Tank  
Vinyl Graphics  
Thumb Lock Trunk Doors  
All Aluminum Walls  
Aluminum Bunk Floor  
Low Roof Chassis Cab  
Black Rear Ladder (N/A 2250)  
Exterior LED Marker Lights

### INTERIOR APPOINTMENTS

Serenity Ash Cabinet Doors  
Black Hardware (3-3/4" Spread)  
Vinyl Padded Up & Angle Pads  
Countertops Throughout  
Roller Bearing Drawer Guides  
Throughout  
Poplar Drawers  
Roller Shades & Ascot Valances

Tinted Radius Slider Windows  
Rotate/Recline Pilot & Passenger  
Seats  
U-Dinette (2150/2200)  
Booth Dinette (2250)  
Single Child Tether at Forward  
Facing Dinette  
Hardwood Doors – Raised Panel  
Uppers/Flat Panel Lowers  
Hardwood Slab Drawer Fronts  
Shaker Diplomat 3P House Type  
Bath Door  
Black Receipts/Rotaires/Switches  
Interior Safety Grab Handle  
by Entrance Door

### INTERIOR EQUIPMENT

Passenger & Driver Swivel Seats  
Jack Wing TV Antenna  
LP Leak Alarm  
Smoke Detector  
Carbon Monoxide Detector  
Fire Extinguisher  
Bedroom TV Jack & Backer  
for LCD TV (N/A 2200)  
Touch Screen Radio & Backup  
Monitor w/Dash Speakers  
Color Backup Camera  
Power Sliding/Rotating 12V 32" TV/  
Stereo/Soundbar/Pantry (2200)

### GALLEY

Residential Size Microwave Oven  
Flush Mount, Double Door  
Refrigerator  
Paneling Refer Inserts  
Monitor Panel Command Center  
Composite Undermount Double  
Bowl Kitchen Sink w/Lid  
Black Power, Lighted Range Hood  
Black 3-Burner Cooktop w/Oven  
Flip-up Countertop Extension  
Standard Satin Nickel  
Kitchen Faucet  
Kitchen Tile Wall Border  
Black Sure Fit Dinette Table Posts  
(2250)  
Springfield HD Silver Table Base  
(2150/2200)

### BATH AND WATER

Water Panel w/City/Tank/Winterize/  
Waste Tank Flush  
Low Point Drain & Winterize Valve  
at Fresh Tank  
Exterior Shower  
Power Bath Vent  
Demand Water Pump  
Lavatory Faucet w/Round Knobs  
Shower Head & Faucet  
Medicine Cabinet

Skylight Over Shower  
Satin Nickel Shower Door  
One-Piece ABS Shower Surround  
Black Robe/Towel Hooks  
6-Gallon Gas E.I. Water Heater  
Composite Foot Flush Toilet

### SLEEPING

Full Bed 54" x 80" (2150)  
Queen Bed 60" x 74" Flip Over  
(2250/2200)  
Bedsprad  
Privacy Drape – Lower Cab  
Privacy Drape & Track Cover  
– Bedroom (2150/2200)  
Bedroom Slider Door (2250)  
Cab Over Bunk 48" x 90"  
Child Safety Ladder  
w/Bunk Velcro Restraints  
Child Restraint Net System  
Bedroom Window

### ELECTRICAL/HEATING/AC

30 Amp Power Cord  
55 Amp Electronic Converter  
Auxiliary Battery  
GFI Circuit  
Manual Battery Disconnect  
Outside 120V Receptacle (DS)  
Awning LED Strip Light  
Wall Mounted Thermostat  
Outside Cable TV Hookup  
18,000 BTU Ducted Furnace  
13,500 BTU Ducted Roof A/C  
Onan 3.6KW LP Generator  
Automatic Generator Changeover  
Exterior Solar Plug-in Connection  
LED Lights Throughout  
Pop-Up Kitchen Recept  
Bed Area 110V CPAP Ready Area  
& 12V/USB Charging Station

## OPTIONAL

### STAND ALONE OPTIONS

24" LCD TV w/DVD –  
Coach (N/A 2200)  
Onan 3.2KW Diesel Generator  
& Automatic Transfer Switch  
Dual Auxiliary Battery Upgrade  
13.5" Bedroom TV w/built-in DVD  
Player (N/A 2200)

### Camping Cozy Package

Dual pane Tinted Windows,  
Tank Pads, Extra Knife Valve,  
at Tank Gate Vales  
Convection Microwave  
Tank Heat Pads  
Cabover Power Vent Fan  
w/Maxxair Cover  
Front Entertainment Center  
(32" TV, Stereo & 2 Speakers)  
(N/A 2200)  
Sofa & Table  
Side Cabover Window Delete  
Exterior 24" TV w/DVD Player  
& 2 Speakers  
Recliners & Table  
Upgrade Serta Mattress (2150)  
Upgrade Folding Mattress  
(2250/2200)  
Exterior Windshield Cover  
Painted Cab  
Navigation Capable Radio  
& Backup Monitor Interface  
4-Point Hydraulic Jacks  
Upgrade Pilot/Passenger Seats  
Side View Cameras  
Carbon Fiber Dash Insert  
Aluminum Wheels

## DÉCOR OPTIONS



NICKEL



GRAPHITE

*Due to continuous improvement,  
Standards and Options subject  
to change without notice.*



# PRISM SPECIFICATIONS

MODEL	24EF	24EG	24EJ	2150	2200	2250
Chassis	3500 Sprinter	3500 Sprinter	3500 Sprinter	3500 Sprinter	3500 Sprinter	3500 Sprinter
Engine	V6 3.0L	V6 3.0L	V6 3.0L	V6 3.0L	V6 3.0L	V6 3.0L
Horse Power	188	188	188	188	188	188
Torque	325	325	325	325	325	325
Wheel Base	170"	170"	170"	170"	170"	170"
GVWR (lbs.)	11,030	11,030	11,030	11,030	11,030	11,030
GCWR (lbs.)	15,250	15,250	15,250	15,250	15,250	15,250
UVW (approx. lbs.)	9,858	9,868	TBD	9,645	9,834	9,757
CCC (approx. lbs.)	1,170	1,160	TBD	1,385	1,196	1,273
GAWR Front (lbs.)	4,410	4,410	4,410	4,410	4,410	4,410
GAWR Rear (lbs.)	7,720	7,720	7,720	7,720	7,720	7,720
Interior Height	6' 9"	6' 9"	6' 9"	6' 10"	6' 10"	6' 10"
Exterior Width	7' 10"	7' 10"	7' 10"	7' 11"	7' 11"	7' 11"
Exterior Height (with A/C)	10' 9"	10' 9"	10' 9"	11' 7"	11' 7"	11' 7"
Exterior Length (with Hitch)	24' 11"	24' 11"	24' 11"	25' 0"	25' 0"	25' 0"
Hitch Weight (lbs.)	3,500	3,500	3,500	3,500	3,500	3,500
Fuel Capacity (gal.)	26	26	26	26	26	26
LP Capacity (lbs.)	85	85	85	85	85	85
Fresh Water Capacity (gal.)	35	30	30	50	38	43
Water Heater Capacity (gal.)	6	6	6	6	6	6
Grey Tank Capacity (gal.)	28	32	32	28	28	29
Black Tank Capacity (gal.)	32	35	32	28	28	27
Exterior Storage (cu. ft.)	37	43	TBD	88	52	52
Awning Length	14'	14'	TBD	16'	16'	16'



**Travel Easy™  
Roadside Assistance**

RVing is easier with Coachmen's Travel Easy™ Roadside Assistance provided FREE the first year of ownership to those who purchase a New Coachmen RV. Administered by Coach-Net, this service provides you with 24/7 operational, technical and emergency road service coverage. Also included is towing, fuel delivery, jump starts, lockout service, tire changes, mobile mechanic and unlimited technical assistance. Anywhere. Anytime. Travel Easy™ is the security of knowing that help is an easy phone call away.



**FREE MEMBERSHIP**  
[www.coachmenowners.com](http://www.coachmenowners.com)

GVWR (Gross Vehicle Weight Rating) is the maximum permissible weight of the unit when fully loaded. It includes all weights, inclusive of all fluids, occupants, cargo, optional equipment and accessories. For safety and product performance do NOT exceed the GVWR.

GCWR (Gross Combined Weight Rating) is the maximum permissible loaded weight of your motor home and any towed trailer or towed vehicle. Actual GCWR of this vehicle may be limited by the sum of the GVWR and the installed hitch receiver maximum capacity rating; see hitch rating label for detail.

GAWR (Gross Axle Weight Rating) is the maximum permissible weight, including cargo, fluids, optional equipment and accessories that can be safely supported by each axle.

UVW (Unloaded Vehicle Weight) \* is the typical weight of the unit as manufactured at the factory. It includes all weight at the unit's axle(s), including full fuel, all fluids and LP Gas. The UVW does not include cargo, fresh potable water, additional optional equipment or dealer installed accessories.

\*Estimated Average based on standard build optional equipment.

CCC (Cargo Carrying Capacity) \*\* is the amount of weight available for fresh potable water, cargo, passengers, additional optional equipment and accessories. CCC is equal to GVWR minus UVW. Available CCC should accommodate fresh potable water (8.3 lbs per gallon). Before filling the fresh water tank, empty the black and gray tanks to provide for more cargo capacity.

\*\* Estimated average based on standard build optional equipment

Each Coachmen motorhome is weighed at the manufacturing facility prior to shipping. A label identifying the unloaded vehicle weight of the actual unit and the cargo carrying capacity is applied to every Coachmen motorhome prior to leaving our facilities.

The load capacity of your unit is designated by weight, not by volume, so you cannot necessarily use all available space when loading your unit.

Actual towing capacity is dependent upon your particular loading and towing circumstances, which includes the GVWR, GAWR and GCWR as well as adequate trailer brakes. Please refer to the Operator's Manual of your vehicle for further towing information.



AVAILABLE ON THE  
App Store

GET IT ON  
Google play

## Coachmen Owner "Digital Kit" App

Now you can have your Owner's Manual with you wherever you are. Download our FREE App from the App Store or Google Play and you'll have the information right at your fingertips.

## Your PRISM Dealer



**Learn More**  
Scan this barcode using a QR Reader on your smart phone to learn more about Forest River.



A Berkshire Hathaway company.

All information contained in this brochure is believed to be accurate at the time of publication. However, during the model year, it may be necessary to make revisions and Coachmen reserves the right to make all such changes without notice, including prices, colors, materials, equipment and specifications as well as the addition of new models and the discontinuance of models shown in this brochure. Therefore, please consult with your Coachmen dealer and confirm the existence of any materials, design or specifications that are material to your purchase decision. 07/17

©Copyright 2017 Coachmen RV a Division of Forest River Inc -- All Rights Reserved.

## CUSTOMER SATISFACTION



[www.ForestRiverBuyLocal.com](http://www.ForestRiverBuyLocal.com)



**Coachmen**  
Leader to the Great Outdoors.

423 N. Main Street • P.O. Box 30  
Middlebury, IN 46540

To learn more about Coachmen RV and our products and see how Coachmen is making the easy life easier, call us toll free at **(800) 353-7383**, or visit [www.coachmenrv.com](http://www.coachmenrv.com)