

Flagstaff

WE'RE  YOUR
LIGHT WEIGHT
SPECIALISTS
EST. 1974

V-LITE, CLASSIC SUPER LITE TRAVEL TRAILERS AND FIFTH WHEELS

Flagstaff V-LITE, CLASSIC SUPER LITE TRAVEL TRAILERS & FIFTH WHEELS





We're building a legacy.

FLAGSTAFF HAS EMERGED AS AN INDUSTRY LEADER IN THE MANUFACTURING OF LIGHT WEIGHT TRAVEL TRAILERS, FIFTH WHEELS AND CAMPING TRAILERS. For over 25 years, Flagstaff has been committed to being the market's "light weight" specialist. With a focus on providing travel trailers to meet the weight requirements of the vehicles our customers own, we have built a tradition of providing superior value and service while remaining in tune with our customer's needs. As a result, Flagstaff has become one of the most versatile product lines in the light weight trailer market, proudly showcasing more innovative floor plans, appealing features and refined interior appointments than any others in its class.





TODAY, FLAGSTAFF REMAINS COMMITTED TO INSURING THAT OUR CUSTOMERS ENJOY THEIR CAMPING EXPERIENCES. Through the utilization of our experienced work force, “state of the art” lamination facility, modern production plants and detailed assembly processes, we continue to provide our customers with the best built product possible at an unmatched value.



THE TRADITIONAL FLAGSTAFF V-LITE. CLASSIC SUPER LITE TRAVEL TRAILERS AND FIFTH WHEELS CONTINUE TO PROVIDE UNSURPASSED VALUE AND COMFORT.

Flagstaff models are loaded with features that add value to your investment. Our polished alloy wheels and Nitro filled radial tires are mounted to Dexter Torflex torsion axles. The Torflex axles provide a smooth, safe ride with their independent wheel suspension and self dampening action that are sure to protect your investment for years to come. We also utilize a fully enclosed underbelly to keep the underside of your trailer clean and protected from the many road hazards along the way. All of this leads to added value not commonly found in todays market.



Optional Champagne Exterior

Featuring aluminum framing, vacuum bonded walls and roof, eye appealing exteriors and deluxe graphics, the Classic Super Lite and V-Lites are among the best constructed and most well insulated trailer available on the market today.



Optional Champagne Exterior



832BHIKWS

SPOKANE / MAPLE

Flagstaff Fifth Wheel models are loaded with features like the Reese Revolution hitch, power stabilizer jacks, and slam latches on most storage doors and much more.





30WRLIKSV

SPOKANE / MAPLE



Optional Champagne Exterior

The Tradition Continues!

Flagstaff offers a group of appealing features to enhance the appearance of the Classic Super Lite & V-Lite series. Flagstaff now offers more standard features like raised panel cabinet doors, solid surface kitchen counter tops and under mount stainless steel sinks, plus residential drawer guides. Need head room? We raised the bar. All travel trailers are now three inches taller.

Other exciting "Standards" include entertainment centers with larger TV's, upgraded sound systems and app controllable radios - No need to find the remote!

Glossy white fiberglass is standard with the Champagne exterior as an option. Both have "Standards" including bonded frameless windows, polished alloy wheels, a colored keyed roof and a soft mocha front cap. Don't forget about the automotive front windshields on most Travel Trailers... There is style and value in all we do!

FLAGSTAFF

V-Lite

INNOVATION AND VALUE, REDESIGNED WITH THE ADDED VALUE AND QUALITY YOU WOULD EXPECT FROM FLAGSTAFF. Thanks to its "V" nose design, every possible space is used for interior room and storage. The aerodynamic, aluminum framed and vacuum bonded exterior can be towed by a wide variety of vehicles on the market. A variety of standards and options gives extensive customization potential for each individual consumer.



30WRLIKSV

SPOKANE / MAPLE



Optional Champagne Exterior





SUPER SLIDE OPTIONS



MODEL NUMBER	26VFKS	27VRL	30WTBSV	30WFKSV	30WRLIKSV
UNLOADED VEHICLE WEIGHT *	6540	7040	7629	7433	8203
BASE DRY HITCH WEIGHT	727	914	930	882	921
BASE DRY AXLE WEIGHT	5754	6067	6640	6492	7223
CARGO CAPACITY	1187	1874	1301	1449	1518
LENGTH (HITCH TO BUMPER)	29' 9"	31' 10"	34' 7"	34' 7"	35'
WIDTH	96"	96"	96"	96"	96"
HEIGHT WITH A/C	136"	136"	136"	136"	136"
INTERIOR HEIGHT	83"	83"	83"	83"	83"
FRESH WATER CAPACITY	43 gal	43 gal	43 gal	43 gal	43 gal
GRAY WATER CAPACITY	90 gal	82 gal	90 gal	75 gal	45 gal
BLACK WATER CAPACITY	45 gal	37 gal	45 gal	45 gal	45 gal

The Unloaded Vehicle Weight (UVW) listed represents the weight of one trailer with that model's standard equipment including the content of specified option packages.
* See back cover for further specification definitions.

FLAGSTAFF

Travel Trailers

BEAUTIFUL SPACIOUS INTERIORS COME STANDARD. The Classic series has many outstanding features to enhance your camping experience. The open floorplans and generous storage space allows extra room for those extra things you want to bring along. Sleeping on the comfortable Serta bed, you'll forget you were in the great outdoors. The spacious interior and picturesque view through the many windows enable you to experience your surroundings in the comfort of your Classic Super Lite travel trailer.



8320KBS

REGAL / DRIFTWOOD



Standard White Exterior





831BHWSS



832FLBS



832BHDS



832BHIKWS



832OKBS



832IKBS



832RKBS



831CLBSS

SUPER SLIDE OPTIONS



MODEL NUMBER	831BHWSS	832FLBS	832BHDS	832BHIKWS	832OKBS	832IKBS	832RKBS	831CLBSS
UNLOADED VEHICLE WEIGHT *	8386	8621	8509	8640	8803	8219	8989	8105
BASE DRY HITCH WEIGHT	1109	1401	883	1146	1136	980	1158	1205
BASE DRY AXLE WEIGHT	7218	7161	7567	7435	7608	7180	7772	6841
CARGO CAPACITY	1523	1580	2374	1306	2333	1561	2169	1900
LENGTH (HITCH TO BUMPER)	34'-9"	35' 5"	35'-11"	35'-5"	35'-5"	34'-9"	35' 11"	35' 11"
WIDTH	96"	96"	96"	96"	96"	96"	96"	96"
HEIGHT WITH A/C	136"	136"	136"	136"	136"	136"	136"	136"
INTERIOR HEIGHT	83"	83"	83"	83"	83"	83"	83"	83"
FRESH WATER CAPACITY	43 gal	43 gal	43 gal	43 gal	43 gal	43 gal	43 gal	43 gal
GRAY WATER CAPACITY	45 gal	45 gal	63 gal	90 gal	108	45 gal	90 gal	90 gal
BLACK WATER CAPACITY	45 gal	45 gal	45 gal	45 gal	45 gal	45 gal	45 gal	45 gal

The Unloaded Vehicle Weight (UVW) listed represents the weight of one trailer with that model's standard equipment including the content of specified option packages. * See back cover for further specification definitions.

FLAGSTAFF

Fifth Wheels

FULL SIZE COMFORTS IN A LIGHT WEIGHT FIFTH WHEEL.

The ample counter top space, large cabinets and plush furniture bring the feeling of home to life on the road. The Flagstaff Classic Super Lite, making camping a memorable experience. All Flagstaff Fifth Wheels come standard with the Reese Revolution Hitch allowing you to tow with almost any size truck bed.

8528BHOK

BOULDER / MAPLE



Optional Champagne Exterior





1/2 Bath in Bunkhouse on 8528BHOK



8529RLWS
SPOKANE / MAPLE



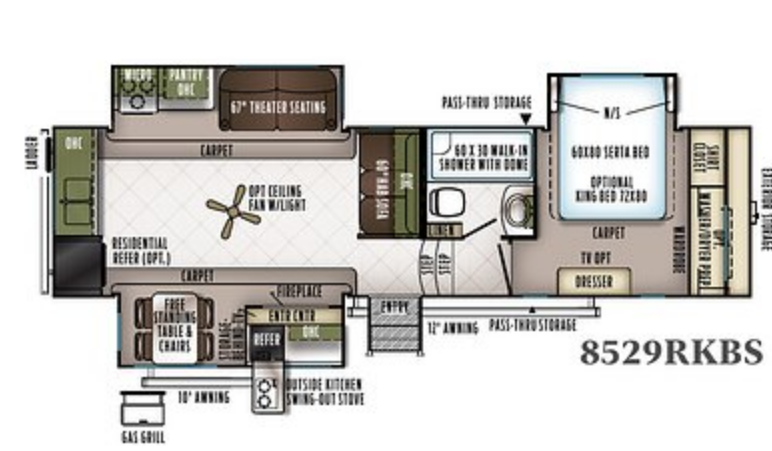

SUPER SLIDE OPTIONS



MODEL	8528CKWSA	8528IKWS	8529RKBS	8529BRWS	8529FLS	8529RLWS	8529IKBS	8528BHOK
UNLOADED VEHICLE WEIGHT *	8539	8866	9591	8966	9167	8584	9505	9345
BASE DRY HITCH WEIGHT	1530	1420	1712	1337	1395	1290	1581	1422
BASE DRY AXLE WEIGHT	6950	7387	7820	7570	7713	7235	7865	7864
CARGO CAPACITY	1391	1354	2121	2371	2228	1506	2076	2077
LENGTH (HITCH TO BUMPER)	31' 11"	31'-11"	33'-10"	33'-6"	33' 10"	33'-6"	33'-10"	33'-6"
WIDTH	96"	96"	96"	96"	96"	96"	96"	96"
HEIGHT WITH A/C	156"	156"	156"	156"	156"	156"	156"	156"
FRESH WATER CAPACITY	43 gal	43 gal	43 gal	43 gal	43 gal	43 gal	43 gal	43 gal
GRAY WATER CAPACITY	75 gal	90 gal	90 gal	90 gal	45 gal	45 gal	90 gal	108 gal
BLACK WATER CAPACITY	45 gal	45 gal	45 gal	45 gal	45 gal	45 gal	45 gal	90 gal

The Unloaded Vehicle Weight (UVW) listed represents the weight of one trailer with that model's standard equipment including the content of specified Option Packages. * See back cover for further specification definitions.



With the Reese Revolution standard on all Flagstaff Fifth Wheel models, you can tow with almost any size truck bed and have more free space to carry your camping gear.

Popular Features

FEATURES THAT MAKE YOUR TRIPS FEEL LIKE HOME. Flagstaff takes careful consideration to each feature added into each product produced. Every detail is considered ranging from extra sleeping room, storage, comfort and convenience. Take time to review the features listed below and match them with the competition's products. We're confident you'll discover Flagstaff is the superior choice.



- A** Power Awning with tilt adjustment and LED indirect lighting
- B** 55", 42", 32" LCD TV (where applicable) and a stereo system with Bluetooth technology and a DVD player. Electric Fireplace / Heater (Std./Opt. on select models).
- C** Radius Glass Door Shower (N/A Models with Tub Bases)
- D** Free-standing chair with seat storage and table with extension (Opt./Std. select models)
- E** Deluxe Tri-Fold Sleeper Sofa on select models
- F** Deluxe Tri-Fold Sofa w/ Comfortable, easy set-up bed. (Per floorplan)

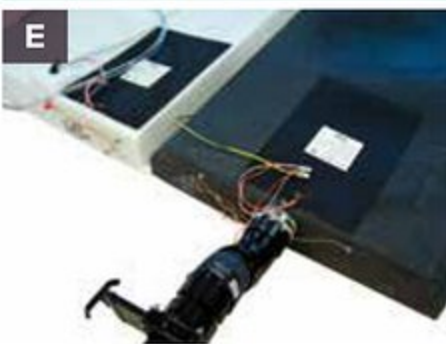

A Rear camera prep. (Std. all models) The Furrion observation camera system with digital wireless technology is sold separately.

B State-of-the-art control panel with available App for download on the App store and Google Play. (N/A V-Lite)

C WIFI Ranger WIFI booster, for a secure WIFI connection.

D The Reese Revolution pin box provides:
1) Full 90 degree worry free turning,
2) Eliminates the need for a slider hitch on most trucks,
3) Greatly enhances maneuverability www.reeseprod.com (Std.)

E Heated holding tanks with 12 Volt heat pads secured to the bottom. No need to use the furnace to heat tanks when traveling. (Std.)

F Solar panel prep (Std. all models) The Zamp 40 amp. portable solar panel shown is sold separately.

G 60" Heated theatre seating. Fabric matched to decor.

H Standard push back recliner. Fabric matched to decor. (Per floorplan)

I Lazy Boy swivel recliner. Fabric matched to decor. (Opt. Available ILO all units with standard push back recliner)

J 67" Heated theatre seating per plan where available. Fabric matched to decor. (Per floorplan)

SOFA



CURTAINS

Boulder

SOFA & DINETTE CUSHIONS



CURTAINS

Regal

SOFA LEATHER APPEARANCE, DINETTE BACK INSERT, VALANCE ARMS & ACCESSORIES



CURTAINS

Spokane

PILLOWS & VALANCES



DINETTE CUSHIONS, VALANCE ARMS & ACCESSORIES

PILLOWS, VALANCES, & DINETTE BACK INSERT



VALANCE ARMS & ACCESSORIES

PILLOWS & VALANCE TOPS



DINETTE CUSHIONS



DRIFTWOOD DÉCOR STANDARD



MAPLE DÉCOR OPTION



STANDARD FLOOR COVERING



OPTIONAL FLOOR COVERING



CARPET

Quality Construction

THE DETAILS ARE WHAT MAKE ALL THE DIFFERENCE. Flagstaff takes pride in constructing the very best products possible in each price point. From our entry level units to our top of the line products, no short cuts are taken to achieve excellence. From the all-steel I-beams to the residential interior amenities to the vacuum-bonded exteriors, Flagstaff products are quality built from the ground-up.



- 1 Glued and screwed wood cabinetry
- 2 Aluminum dinette frames for added strength and weight savings
- 3 5/8" Tongue and Groove Plywood sub-floor glued and screwed down
- 4 Extra large dinette storage drawers and full extension metal drawer guides in the kitchen
- 5 Dexter Torflex Axles:
 - Independent wheel suspension and self-damping action
 - Rubber cushioning eliminates metal-to-metal contact.
 - Forged torsion arm for maximum strength

Models are also equipped with E-Z Lube® System and Nev-R-Adjust® Brakes.

- 6 Enclosed underbelly protects trailer components as well as increasing aerodynamics
- 7 Aluminum Frame Construction with high gloss fiberglass exterior and deluxe graphics



ROOF CONSTRUCTION



Vacuum-bonded radius roof with vaulted ceiling providing superior insulation and more interior height.



4" thick roof with built in insulated A/C ducts



Built strong to enable you to conveniently perform periodic roof maintenance.

WALL STRENGTH



Structurally engineered materials makes our vacuum-bonded walls some of the strongest in the industry.

VACUUM-BONDED LAMINATED CONSTRUCTION



Flagstaff is one of only a few manufacturers with six sided aluminum framing. Vacuum bonded walls and roof to ensure a well-insulated, light weight, strong structural trailer.

Standards & Options

	V	TT	FW		V	TT	FW		V	TT	FW
STANDARD PACKAGES	PKG. F	PKG. B	PKG. A								
Painted Fiberglass Front Cap w/ Automotive Windshield (Pkg. B Only) (Windshield N/A on FW)	--	S	S	Multi Zone Stereo w/ DVD/CD/AM/FM and Bluetooth Control	S	S	S	110V Ceiling Fan	--	--	0
Fiberglass Exterior w/ Glossy Finish	S	S	S	Touch Button Control Panel w/ App Control	--	S	S	Carbon Monoxide Detector	S	S	S
Aluminum Bed and Dinette Base	S	S	S	Thermostatically Controlled Heated Holding Tanks	S	S	S	12 Volt Power Plug With USB Charging Port	S	S	S
6 Sided Aluminum Cage Construction	S	S	S	Torsion Axle, Rubber-Ryde Suspension	S	S	S	CSA	0	0	0
Vacuum Laminated 1 Piece Roof and Walls	S	S	S	Polished Alloy Wheels	S	S	S	Wifi Ranger Wifi Booster	S	S	S
Tinted Bonded Frameless Windows	S	S	S	Spare Tire Carrier & Cover	S	S	S	Battery Disconnect Switch	S	S	S
Power Awning w/ Adjustable Rain Dump and LED Light Strip	S	S	S	Nitro Filled Tires	S	S	S	55 Amp Converter With Charger	S	S	S
Enclosed Underbelly	S	S	S	Slam Latch Baggage Doors and Magnetic Door Holds	S	S	S	LED 12 Volt Interior Lighting	S	S	S
Reese Revolution Pin Box Hitch (Pkg. A Only)	--	--	S	Rear Observation Camera Prep w/ Molded Mounting Plate	S	S	S	Flush Mount Ceiling LED 12 Volt Interior Lighting w/ Multiple Switches	S	S	S
Power Landing Legs & Stabilizer Jacks (Pkg.A Only)	--	--	S	Solar Panel Prep	S	S	S	Interior Floor Light by Entrance Door	S	S	S
4 Frame Mounted Stabilizer Jacks (Pkg. B and C Only)	S	S	--	Rear Ladder	S	S	S	Directional Reading LED Lights on Most Sofa Slides	S	S	S
13,500 BTU Ducted A/C	S	S	S	Black Tank Flush	S	S	S	Residential Dome Style LED Lights Over Sofa and Table	S	S	S
Upgraded 22" Gas Oven	S	S	S					Upgraded LED Lighting Around Medicine Cabinet	S	S	S
Microwave Oven	S	S	S	INTERIOR FEATURES				Digital AM/FM/DVD w/ "Bluetooth" Technology	S	S	S
Recessed Cooktop and Oven w/ Flush Mount Cover	S	S	S	Driftwood Interior	S	S	S	2nd Digital AM/FM/DVD (30WTBSV and 831BHWSS only)	S*	S*	--
Hidden Hinge Cabinet Doors	--	S	S	Maple (w/ Solid Maple Glaze Finished Cabinet Doors) Interior	0	0	0	MP3 Player Hook-Up	S	S	S
Residential Full Extension Metal Soft Close Drawer Guides	--	S	S	Decorative Slide Out Fascia	S	S	S	LCD TV Mounted in Bedroom With Outside Mounting Bracket (Std. on TT Models w/ Center Entertainment Only)	S*/0*	S*/0*	0
Extra Large Double Door 2 Way Refrigerator	S	S	S	Decroitive Cove Trim Along Ceiling and Overhead Cabinets	S	S	S	LCD TV Mounted in Bunk Room (Std. 30WTBSV, 831BHWSS)	S*	S*/0*	0*
Solid Surface Corian Kitchen Countertops	--	S	S	Screwed and Glued Cabinetry	S	S	S	Jack Knife Sofa (Std. 832BHDS 2nd Sofa, 8529BRWS)	--	S*	S*
Solid Surface Kitchen Countertops	S	--	--	Solid Wood and Raised Panel Doors and Drawers	S	S	S	Deluxe Tri-Fold Sleeper Sofa w/ Storage (Per Floorplan)	S*	S/0*	S*
Kitchen Backsplash	S	S	S	Upgraded Cabinetry Hardware	S	S	S	Push Back Recliner (Per Floorplan)	S*	S*	S*
Flush Mount Stainless Steel Sinks With "High Rise" Lift-Off	S	S	S	Engineered Mold and				Lazy Boy Swivel Recliner Option: Available ILO All Units			
6 Gallon Quick Recovery Auto Ignition Gas/Electric Water Heater	S	S	S	Mildew Resistant Floor Covering	S	S	S	With Standard Pushback Recliner	0*	0*	0*
Residential Serta Mattress Upgrade	S	S	S	Bedroom Carpet	0	0	S	Lazy Boy Swivel Recliner Option: ILO			
Outside Speakers	S	S	S	Floor Ducted Furnace	S	S	S	Theater Seating (8320KBS only)	--	0*	--
LLCD TV With Upgraded Sound Bar Speaker System and Multi-directional Antenna	S	S	S	15,000 BTU Ducted Roof Air	0	0	0	Theater Seating/Theatre Seating Available ILO			
				2nd Roof A/C w/ Chill Chaser Heat Strip in Bedroom and 50 Amp Service and Digital Dual Thermostat	0	0	0	Standard Recliner (Per floorplan)	0*	S*/0*	S*/0*
				Fireplace (Per Floorplan)	0*	S*/0*	0*	Day/Night Shades	S	S	S

STANDARDS & OPTIONS ARE SUBJECT TO CHANGE.



	V	TT	FW
Day/Night Roller Shades	--	0	0
Deluxe Interior Window Treatment	S	S	S
44" Family Style Dinette (Per Floorplan)	S*	S*	S*
48" X 84" Spacious King-U-Style Dinette (Per Floorplan)	S*/0*	0*	0*
Free Standing High Pressure Laminated Table With Swing Level Leg	S	S	S
Free Standing Table and Chairs (Per Floorplan)	0*	S*/0*	S*/0*
Stainless Steel Appliances	0	0	0
Raised Refrigerator Panels (N/A 8529IKBS and 832RKBS)	0	0*	0*
Large Auto Gas/Electric Refrigerator	S	S	S
12 Cubic Foot Auto Gas/Electric Refrigerator W/ Stainless Steel Panels (8529IKBS and 832RKBS only)	S*	--	S*
22 Cubic Foot Residential Refrigerator w/ Inverter (Opt. 831CLBSS, 8528BH0K, 8529RLWS)	--	0*	0*
12 Cubic Foot Residential Refrigerator w/ Inverter (Opt. 8529RKBS)	--	--	0*
Three Burner High Output Gas Range with Glass Top Cover	S	S	S
Water-Pur Filtration System	S	S	S
Counter Top Extension (Per Floorplan)	S*	S*	S*
Trash Can in Kitchen (Most Models)	S	S	S
Tub Surround	S	S	S
Radius Glass Door Shower (N/A 30WTBSV)	S*	S	S
Large Shower w/ Sliding Glass Door (Std. 30WFKSS, 8529RKBS)	S*	--	S*
Bathroom Skylight	S	S	S
Interior Gas and Electric Switches	S	S	S
Water Heater By-Pass Kit	S	S	S
Residential Style Porcelain Bowl Foot Flush Toilet	--	S	S
Maxxair® Ventilation Fan and Vent Cover	S	S	S
Maxxair® Ventilation Fan w/ Power Lid and Vent Cover	--	--	S
Extra Maxxair® Ventilation and Vent Cover	0	0	0

King Bed Slide (Std. 831CLBSS, Opt on Most Bed Slides)
(NA on 30WTBSV, 832FLBS)
Washer / Dryer Prep (Opt. 8529IKBS, 8529RKBS)

EXTERIOR FEATURES

Fully Aluminum Frame (Floor, Sidewall, & Roof)
Insulation Factors R-7 Side Wall, R-12 Floor and R-14 Roof
Radius Roof With Vaulted 83" Interior Ceilings
One Piece Seamless Roofing Membrane
TV Antenna w/ Cable & Satellite Hook-Up
Rear Ladder
Bike Rack Ladder Attachment
Tongue Mount Bike Rack
Rear Bike Deck (350 lbs. Max Load) (8529IKBS, 8529RKBS Only)
Laminated Fiberglass Sidewalls
Laminated Champagne Color Fiberglass Sidewalls and Color Keyed Roof
Electric Slide-Out(s)
Decorative Frame Skirting
Distinctive Black Exterior Trim
Power Awning With Adjustable Rain Dump and LED Lighting
Shielded Awning Covers
Awning Slide Topper
30" Primary Entrance Door (Most Models)
Friction Hinge Entrance Door
Sliding Glass Patio Door (831CLBSS Only)
Lighted Entry Step
Large Grab Handles
Tinted Bonded Frameless Windows

	V	TT	FW
King Bed Slide (Std. 831CLBSS, Opt on Most Bed Slides) (NA on 30WTBSV, 832FLBS)	0*	S*/0*	0*
Washer / Dryer Prep (Opt. 8529IKBS, 8529RKBS)	--	--	0*
Fully Aluminum Frame (Floor, Sidewall, & Roof)	S	S	S
Insulation Factors R-7 Side Wall, R-12 Floor and R-14 Roof	S	S	S
Radius Roof With Vaulted 83" Interior Ceilings	S	S	S
One Piece Seamless Roofing Membrane	S	S	S
TV Antenna w/ Cable & Satellite Hook-Up	S	S	S
Rear Ladder	S	S	S
Bike Rack Ladder Attachment	0	0	0
Tongue Mount Bike Rack	0	0	--
Rear Bike Deck (350 lbs. Max Load) (8529IKBS, 8529RKBS Only)	--	--	0*
Laminated Fiberglass Sidewalls	S	S	S
Laminated Champagne Color Fiberglass Sidewalls and Color Keyed Roof	0	0	0
Electric Slide-Out(s)	S	S	S
Decorative Frame Skirting	S	S	S
Distinctive Black Exterior Trim	S	S	S
Power Awning With Adjustable Rain Dump and LED Lighting	S	S	S
Shielded Awning Covers	--	0	0
Awning Slide Topper	0	0	0
30" Primary Entrance Door (Most Models)	S	S	S
Friction Hinge Entrance Door	S	S	S
Sliding Glass Patio Door (831CLBSS Only)	--	0*	--
Lighted Entry Step	S	S	S
Large Grab Handles	S	S	S
Tinted Bonded Frameless Windows	S	S	S

Thermo Pane Window Upgrade
Vista Slide Windows w/ Free Standing Table and Chairs
Outside Gas Grill and Worktable
Outside Grill Prep w/ LP Hookup and Backer
Outside Shower
Front Outside "Trunk" Storage Separated From Heated
Pass Thru Storage Compartment
Outside Antifreeze Inlet for Convenient Winterizing
Slam Latches on Most Exterior Storage Doors
Magnetic Storage Door Latches
Two 30 lb Gas Bottles
Molded Bottle Cover
Enclosed Gas Bottles w/ Storage Door Access
Surface Coated Steel I-Beam Frame
Power Front Jack
4.0 Leveling Jacks
Easy Lube Axles
MORryde Strut Assist Fold-Out Steps

	V	TT	FW
Thermo Pane Window Upgrade	0	0	0
Vista Slide Windows w/ Free Standing Table and Chairs	S*/0*	S*/0*	S*/0*
Outside Gas Grill and Worktable	S	0	0
Outside Grill Prep w/ LP Hookup and Backer	S	S	S
Outside Shower	S	S	S
Front Outside "Trunk" Storage Separated From Heated			
Pass Thru Storage Compartment	--	--	S
Outside Antifreeze Inlet for Convenient Winterizing	S	S	S
Slam Latches on Most Exterior Storage Doors	S	S	S
Magnetic Storage Door Latches	S	S	S
Two 30 lb Gas Bottles	S	S	S
Molded Bottle Cover	--	S	--
Enclosed Gas Bottles w/ Storage Door Access	S	--	S
Surface Coated Steel I-Beam Frame	S	S	S
Power Front Jack	0	0	S
4.0 Leveling Jacks	--	0	0
Easy Lube Axles	S	S	S
MORryde Strut Assist Fold-Out Steps	--	S	S

V = VLITE, TT = CLASSIC SUPER LITE TRAVEL TRAILER, FW = CLASSIC SUPER LITE FIFTH WHEEL, S = STANDARD, 0 = OPTIONAL, -- NOT AVAILABLE, * = SELECTED MODELS

FREE MEMBERSHIP
to Forest River Owners' Group

www.forestriverfrog.com



CUSTOMER SATISFACTION



www.ForestRiverBuyLocal.com



PRE-DELIVERY INSPECTION FACILITY

20,000 square feet of quality assurance. The bare essentials for a premium product. This state-of-the-art facility gives immediate daily feedback to production for quality assurance in every unit built.

24/7 EMERGENCY ROADSIDE ASSISTANCE

For a worry-free ownership experience

Forest River includes one year of Coach-Net RV Technical & Roadside Assistance with each RV purchase. Whether new to the RV lifestyle or an experienced RV enthusiast, Forest River owners have 24/7 access to technical, operational and emergency road service coverage throughout the US & Canada. Coach-Net's fast, dependable service is just a phone call away.

Coach-Net[®]

RV Technical & Roadside Assistance

LOOK FOR OUR OTHER POPULAR LINES OF FLAGSTAFF CAMPING TRAILERS.



Flagstaff E-Pro Travel Trailers



Flagstaff MAC, SE, Classic, High Wall & Hard Side Camping Trailers



Flagstaff Micro Lite & Shamrock Side Camping Trailers



Flagstaff Super Lite Travel Trailers & Fifth Wheels

Specification Definitions

GVWR (Gross Vehicle Weight Rating) - is the maximum permissible weight of the unit when fully loaded. It includes all weights, inclusive of all fluids, cargo, optional equipment and accessories. For safety and product performance do NOT exceed the GVWR.

GAWR (Gross Axle Weight Rating) - is the maximum permissible weight, including cargo, fluids, optional equipment and accessories that can be safely supported by a combination of all axles.

UVW (Unloaded Vehicle Weight)* - is the typical weight of the unit as manufactured at the factory. It includes all weight at the unit's axle(s) and tongue or pin and LP Gas. The UVW does not include cargo, fresh potable water, additional optional equipment or dealer installed accessories.

*Estimated average based on standard build optional equipment.

CCC (Cargo Carrying Capacity)** - is the amount of weight available for fresh potable water, cargo, additional optional equipment and accessories. CCC is equal to GVWR minus UVW. Available CCC should accommodate fresh potable water (8.3 lbs per gallon). Before filling the fresh water tank, empty the black and gray tanks to provide for more cargo capacity.

** Estimated average based on standard build optional equipment

Each Forest River RV is weighed at the manufacturing facility prior to shipping. A label identifying the unloaded vehicle weight of the actual unit and the cargo carrying capacity is applied to every Forest River RV prior to leaving our facilities.

The load capacity of your unit is designated by weight, not by volume, so you cannot necessarily use all available space when loading your unit.

FLAGSTAFF

Warranty

FOR DETAILS ON FLAGSTAFF'S COMPLETE WARRANTY PROGRAM, SEE YOUR FLAGSTAFF DEALER. When it comes to backing products with the same quality and commitment it does when it begins the manufacturing process, the only name you have to remember when you're looking for a recreational vehicle is Flagstaff. Flagstaff offers the following additional limited warranties to the original purchasers. Consult written warranty for details.

1. Twelve-year vinyl roof warranty,
2. Two-year fiberglass warranty,
3. Ten-year Torflex[®] axle warranty,
4. One-year bumper to bumper warranty



Learn More
Scan this barcode using a QR Reader on your smart phone to learn more about Forest River.



A Berkshire Hathaway company.



201 WEST ELM MILLERSBURG, IN 46543 WWW.FORESTRIVERINC.COM/FLAGSTAFF 574.642.2640

YOUR FLAGSTAFF DEALER

All information contained in this brochure is believed to be accurate at the time of publication. However, during the model year, it may be necessary to make revisions and Forest River, Inc., reserves the right to make all such changes without notice, including prices, colors, materials, equipment and specifications as well as the addition of new models and the discontinuance of models shown in this brochure. Therefore, please consult with your Forest River dealer and confirm the existence of any materials, design or specifications that are material to your purchase decision. Litho. U.S.A. FOR 1478 W: 2017.12.11