

DURANGO

2500



DURANGO 2500 FULL PROFILE LUXURY FIFTH WHEELS



DURANGO

2500



DURANGO 2500 FULL PROFILE LUXURY FIFTH WHEELS



DURANGO

2500

Whether on a weekend getaway or an extended stay, the Durango 2500 bathes you in luxury. The stunning interior pampers your senses with rich furnishings and easy-living features like the sound bar entertainment center and residential appliances that include a 22-inch, high output oven with broiler and 30-inch microwave over the range. The accent in the ceiling and slideout adds a touch of opulence, while the single roller shades at the windows provide privacy with style. Besides all the standard features, optional enhancements are available to customize to your tastes and lifestyle.



Standard Exterior Steps Lightweight, rustproof aluminum, with strong steel linkages and frame.



Under-Mount Spare Out of the way, easy crank-down, doesn't interfere with bike rack or rear hitch.



DURANGO

2500

Whether on a weekend getaway or an extended stay, the Durango 2500 bathes you in luxury. The stunning interior pampers your senses with rich furnishings and easy-living features like the sound bar entertainment center and residential appliances that include a 22-inch, high output oven with broiler and 30-inch microwave over the range. The accent in the ceiling and slideout adds a touch of opulence, while the single roller shades at the windows provide privacy with style. Besides all the standard features, optional enhancements are available to customize to your tastes and lifestyle.



Standard Exterior Steps Lightweight, rustproof aluminum, with strong steel linkages and frame.



Under-Mount Spare Out of the way, easy crank-down, doesn't interfere with bike rack or rear hitch.



D325RLT | Eclipse décor



all images | D325RLT



50 AMP Service
Satisfies all your electrical needs.



Key-Alike Locks
Increased security and ease of use.



LP Quick-Connect
Allows for additional LP appliances.



Industry's first self-contained, lightweight and adjustable ground-stable step that provides secure footing (optional).



D325RLT | Eclipse décor



all images | D325RLT



50 AMP Service
Satisfies all your electrical needs.



Key-Alike Locks
Increased security and ease of use.



LP Quick-Connect
Allows for additional LP appliances.



Industry's first self-contained, lightweight and adjustable ground-stable step that provides secure footing (optional).

DURANGO

2500

Once you settle into Durango's deluxe residential-style furniture and cue up your favorite television show, you may not want to leave. With its 4-inch, high-density foam dinette cushions, wood-topped booth dinette and optional wide-view fireplace, this might just be better than home! Add to that Durango's solid surface kitchen countertops, heavy-duty 100-pound drawer glides on every Baltic birch drawer box, plus pots and pans storage drawers under each booth dinette, and you are in for a real vacation, my friend.



Rear Observation Camera Prep
Optional backup camera increases ease and safety while backing.



Exterior Battery Disconnect
A turn of the knob keeps your battery from discharging.

DURANGO

2500

Once you settle into Durango's deluxe residential-style furniture and cue up your favorite television show, you may not want to leave. With its 4-inch, high-density foam dinette cushions, wood-topped booth dinette and optional wide-view fireplace, this might just be better than home! Add to that Durango's solid surface kitchen countertops, heavy-duty 100-pound drawer glides on every Baltic birch drawer box, plus pots and pans storage drawers under each booth dinette, and you are in for a real vacation, my friend.



D315RKD | Eclipse décor



Rear Observation Camera Prep
Optional backup camera increases ease and safety while backing.



Exterior Battery Disconnect A turn of the knob keeps your battery from discharging.



D315RKD | Eclipse décor



Standard on all Durango 2500s, the all-weather insulation package includes upgrades to roof, floor, ceiling, endcaps and tanks to R-38, allowing you to enjoy your fifth wheel all year long.



Off The Grid solar package with 160W solar panel offers the freedom to unplug while you're away (optional).



Durango 2500 comes standard with 3" x 14" foam-core in-floor straight-line heating system with 35,000 BTU furnace and 15,000 BTU ducted roof air conditioner.



My RV gives you command of your fifth wheel from one location, with the touch of your finger. This allows you to control the awning, landing gear, and slideouts, as well as access to troubleshooting videos and your owners manual (included with optional leveling system).



3,000 Pound rear towing hitch is standard on all Durango fifth wheels!



Outside Speakers
Standard on all Durangos.



Heated Water Convenience Center
Includes black tank flush, power fresh tank water fill, winterizing system and outside shower.



Portions of this brochure were used with the expressed authority of Dexter Axle, but Dexter Axle is not responsible for the accuracy of the information contained herein.



D315RKD | Eclipse décor



Standard on all Durango 2500s, the all-weather insulation package includes upgrades to roof, floor, ceiling, endcaps and tanks to R-38, allowing you to enjoy your fifth wheel all year long.



Off The Grid solar package with 160W solar panel offers the freedom to unplug while you're away (optional).



Durango 2500 comes standard with 3" x 14" foam-core in-floor straight-line heating system with 35,000 BTU furnace and 15,000 BTU ducted roof air conditioner.



My RV gives you command of your fifth wheel from one location, with the touch of your finger. This allows you to control the awning, landing gear, and slideouts, as well as access to troubleshooting videos and your owners manual (included with optional leveling system).



3,000 Pound rear towing hitch is standard on all Durango fifth wheels!



Outside Speakers
Standard on all Durangos.



Heated Water Convenience Center
Includes black tank flush, power fresh tank water fill, winterizing system and outside shower.



Portions of this brochure were used with the expressed authority of Dexter Axle, but Dexter Axle is not responsible for the accuracy of the information contained herein.

DURANGO 2500
FULL PROFILE LUXURY FIFTH WHEELS

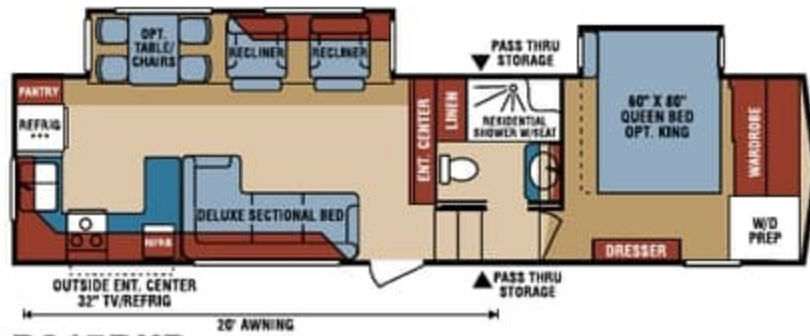

D315RKD

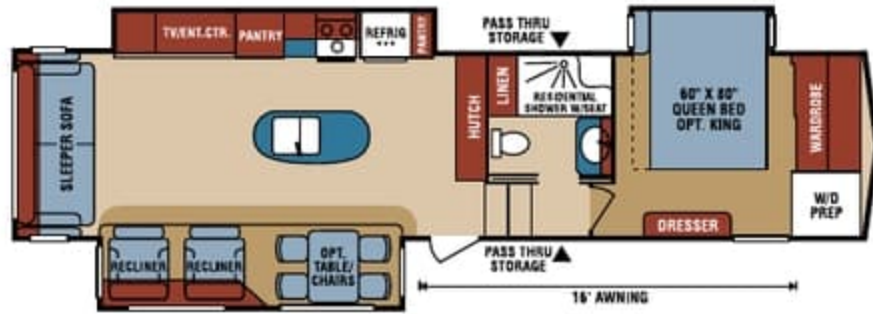

D325RLT



D340FLT

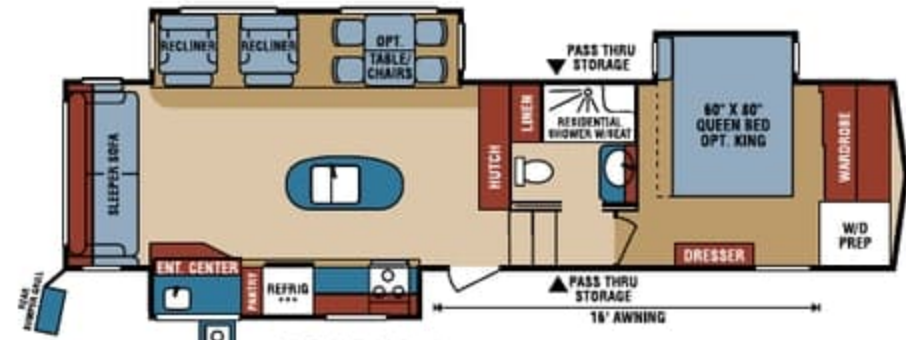

D318RLT

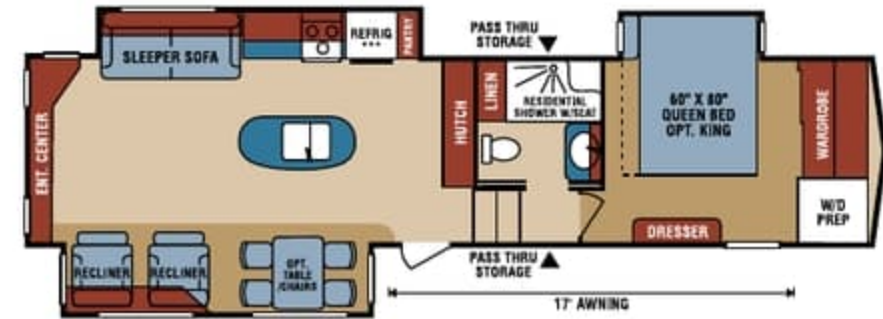

D337RET



D343MBQ

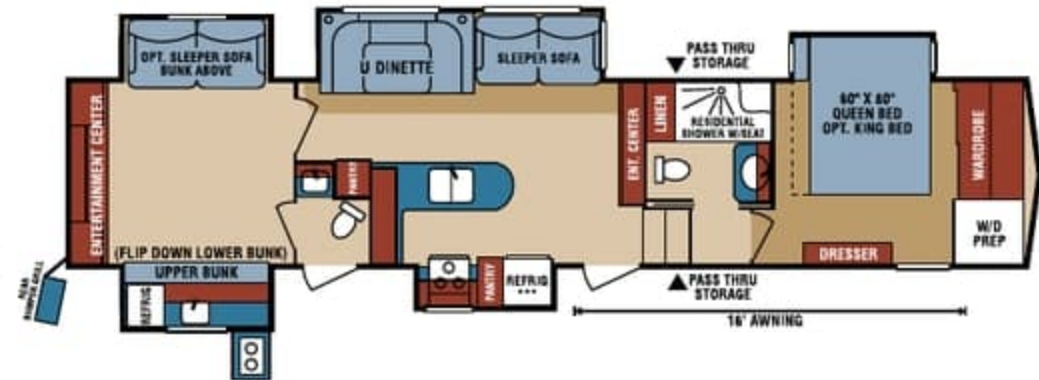

D347BHF

FIFTH WHEELS	D315RKD	D318RLT	D325RLT	D337RET	D340FLT	D343MBQ	D347BHF
UVW (Unloaded Vehicle Weight)*	10,100	10,360	10,290	10,750	10,570	11,790	12,440
Dry Hitch Weight*	1,920	2,030	2,100	2,050	1,780	2,300	2,110
Dry Axle Weight*	8,180	8,330	8,190	8,700	8,790	9,490	10,330
NCC (Net Carrying Capacity)	2,400	2,640	2,710	1,750	2,430	2,710	2,060
GVWR	12,500	13,000	13,000	12,500	13,000	14,500	14,500
Exterior Height	12' 8"	12' 9"	12' 9"	12' 10"	12' 9"	12' 10"	12' 10"
Exterior Width	96"	96"	96"	96"	96"	96"	96"
Exterior Length**	34' 6"	34' 11"	36' 8"	35' 4"	38' 11"	40' 7"	40' 6"
Refrigerator (cu. feet)***	8	8	8	8	8	8	8
Water Heater Cap. (gal. G/E w/DSI)	12	12	12	12	12	12	12
Fresh Water Cap. (gal.) (inc. WH cap.)	67	67	67	67	67	67	67
Waste Water Cap. (gal.)	57	57	57	57	57	57	77
Gray Water Cap. (gal.)	97	57	57	57	97	57	57
1/2 Bath Cap.	N/A	N/A	N/A	N/A	N/A	N/A	57****
LP Gas Cap. (lbs.)	60	60	60	60	60	60	60
Furnace BTUs (1,000s)	35	35	35	35	35	35	35
Tire Size	16"	16"	16"	16"	16"	16"	16"
Awning	20'	16'	16'	17'	17' w/11' opt.	17'	16'

*This weight reflects the rolling average unit weight for each model. Your trailer weight will vary according to optional equipment.
 **Exterior length is measured from the center of the hitch pin to the rear bumper.
 ***Optional 12 or 14 CU FT RV refrigerator – all models. Optional 18 CU FT residential refrigerator – all models except 318RLT & 347BHF.
 ****Also includes kitchen.

DURANGO 2500
FULL PROFILE LUXURY FIFTH WHEELS

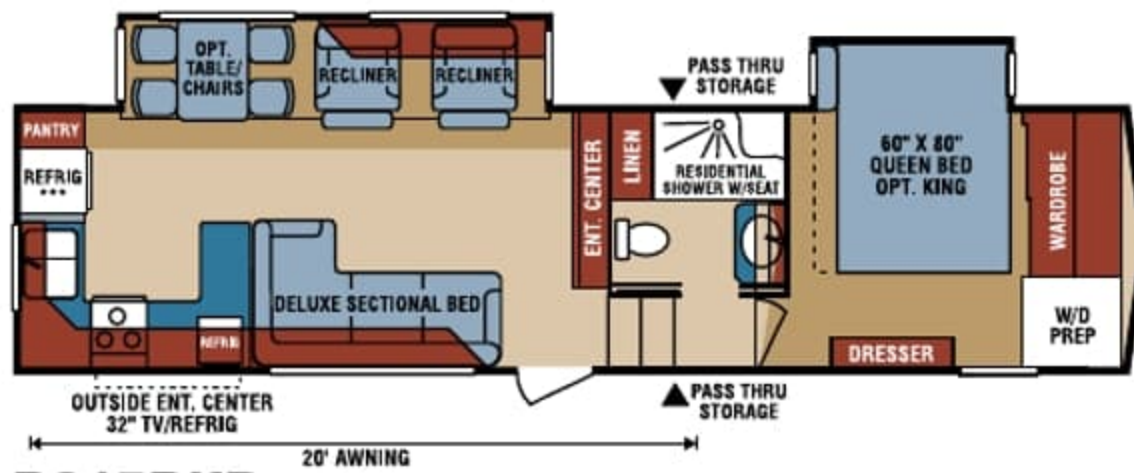

D315RKD

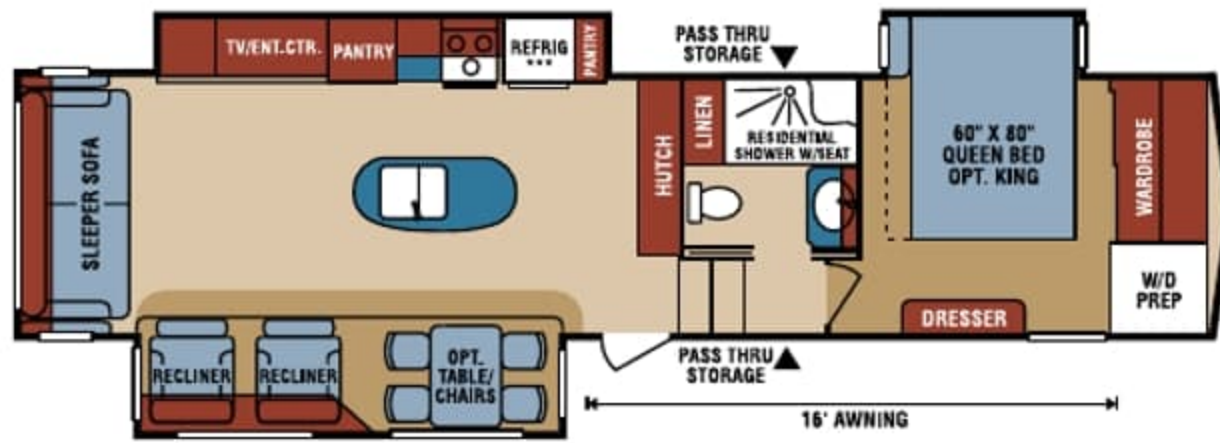

D325RLT

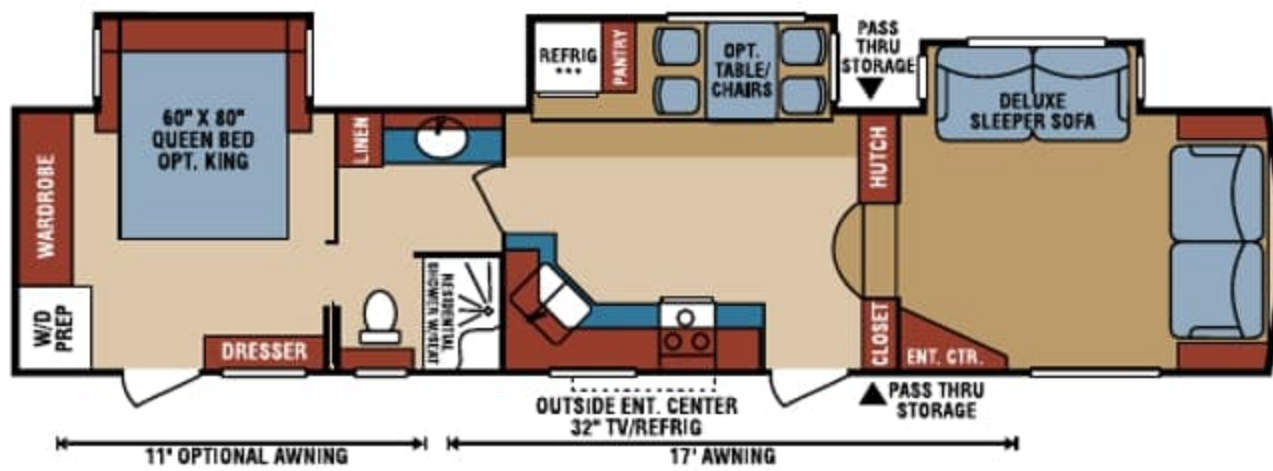

D340FLT

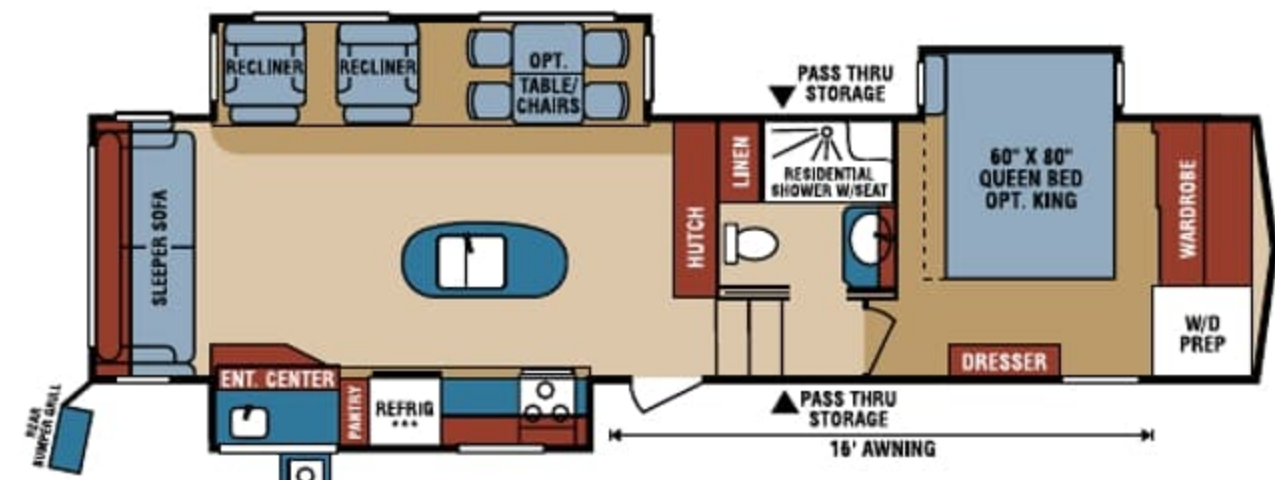

D318RLT

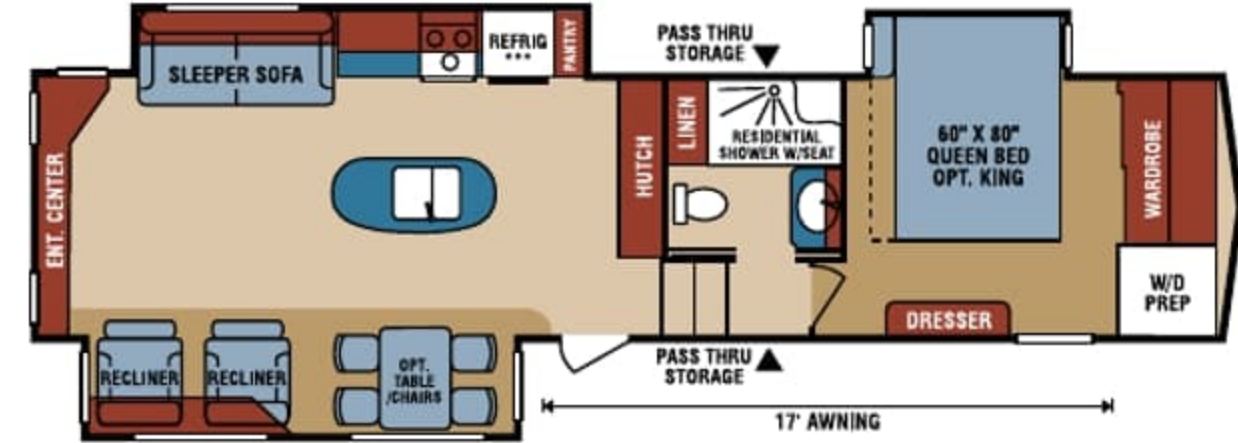

D337RET



D343MBQ

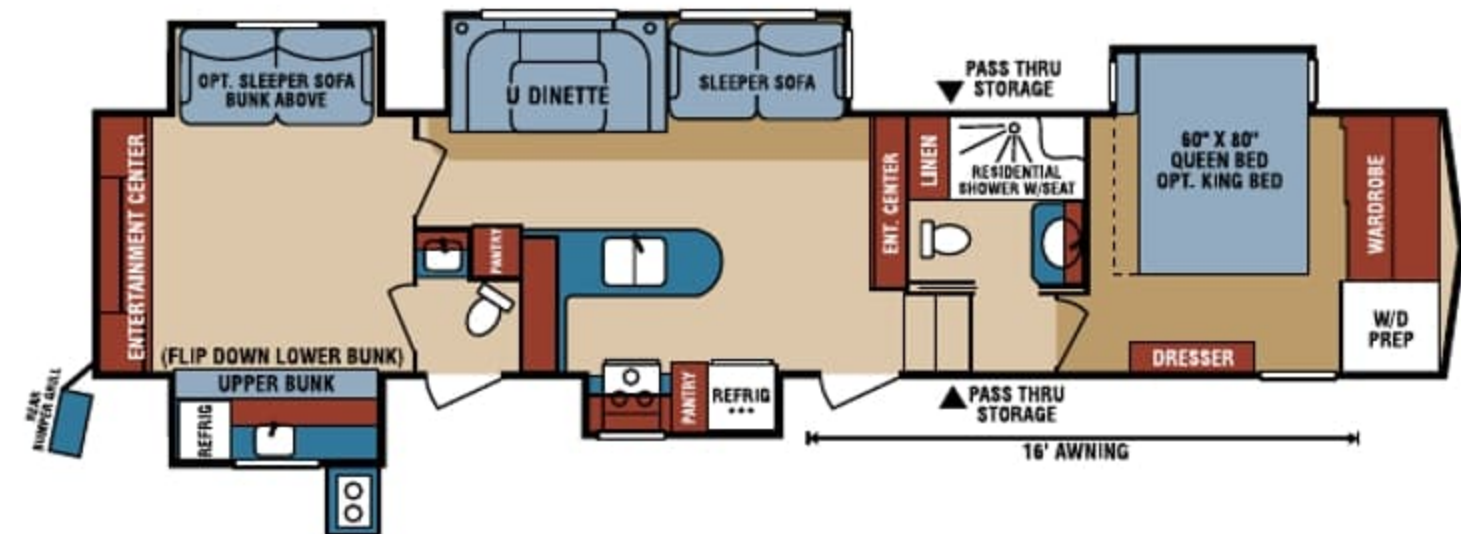

D347BHF

FIFTH WHEELS	D315RKD	D318RLT	D325RLT	D337RET	D340FLT	D343MBQ	D347BHF
UVW (Unloaded Vehicle Weight)*	10,100	10,360	10,290	10,750	10,570	11,790	12,440
Dry Hitch Weight*	1,920	2,030	2,100	2,050	1,780	2,300	2,110
Dry Axle Weight*	8,180	8,330	8,190	8,700	8,790	9,490	10,330
NCC (Net Carrying Capacity)	2,400	2,640	2,710	1,750	2,430	2,710	2,060
GVWR	12,500	13,000	13,000	12,500	13,000	14,500	14,500
Exterior Height	12' 8"	12' 9"	12' 9"	12' 10"	12' 9"	12' 10"	12' 10"
Exterior Width	96"	96"	96"	96"	96"	96"	96"
Exterior Length**	34' 6"	34' 11"	36' 8"	35' 4"	38' 11"	40' 7"	40' 6"
Refrigerator (cu. feet)***	8	8	8	8	8	8	8
Water Heater Cap. (gal. G/E w/DSI)	12	12	12	12	12	12	12
Fresh Water Cap. (gal.) (inc. WH cap.)	67	67	67	67	67	67	67
Waste Water Cap. (gal.)	57	57	57	57	57	57	77
Gray Water Cap. (gal.)	97	57	57	57	97	57	57
1/2 Bath Cap.	N/A	N/A	N/A	N/A	N/A	N/A	57****
LP Gas Cap. (lbs.)	60	60	60	60	60	60	60
Furnace BTUs (1,000s)	35	35	35	35	35	35	35
Tire Size	16"	16"	16"	16"	16"	16"	16"
Awning	20'	16'	16'	17'	17' w/11' opt.	17'	16'

*This weight reflects the rolling average unit weight for each model. Your trailer weight will vary according to optional equipment.
 **Exterior length is measured from the center of the hitch pin to the rear bumper.
 ***Optional 12 or 14 CU FT RV refrigerator – all models. Optional 18 CU FT residential refrigerator – all models except 318RLT & 347BHF.
 ****Also includes kitchen.

CONSTRUCTION FEATURES

- 6-Sided 100% Aluminum Frame
- Steel Powder Coated I-Beam w/Drop-Frame Pass-Thru Storage
- R-11 2" Block Foam Bonded Sidewalls w/EGS Metal Backing Strips (to support all int. cabinets)
- Lamilux® Gelcoat High-Gloss-Colored Fiberglass Exterior
- Fully-Insulated Sliderooms
- Walk-On Superflex® TPO Roof Membrane
- 5/8" Tongue & Groove, Screwed & Glued Plywood Floor Decking
- Fully-Vented Attic System
- Completely Heated Water System
- Pex® In-Floor Heated Waterlines & Kitchen Gray Pipes (all waterlines & drainlines are located above all insulation)
- Fully Heated & Enclosed Underbelly
- Radius Front Cap (for increased turning radius on short bed trucks)
- Extra-Reinforced Heavy-Duty Front Fiberglass Cap
- All Weather Insulation PKG (upgrades roof, floor, ceiling, endcaps & tanks to R-38)

EXTERIOR FEATURES

- Off the Grid Solar Package (160W solar panel)
- Front Electric Jacks
- Dexter® Axles w/Self Adjusting Brakes & Height Adjusting Hangers
- 8-Lug Heavy-Duty Aluminum Rims w/16" E-Range Nitrogen-Filled Radial Tires
- Equa-Flex® Rubberized Suspension
- 100% Exterior LED Running Lights & Taillights
- LED Front Docking Light & Sewer Hookup Light
- Electric Power Awning w/LED Light Strip
- (2) 30 lb. Propane Bottles on Same Side of Coach for Easy Access
- Side-Mounted Sealed Battery Compartment
- Partially Painted Front Cap
- Frameless Windows
- 50 AMP Service w/Marine Power Cord
- 15,000 BTU Ducted Roof AC w/Pre-Wire for Optional 13,500 BTU Bedroom AC

- 3" x 14" Foam-Core In-Floor Straight-Line Heating System w/35,000 BTU Furnace
- Deluxe Heated Water Convenience Center (incl. black tank flush, power fresh tank water fill, winterizing system, outside shower)
- Fully-Finished, Heated & Sealed Basement Storage Compartment
- 12 GAL Gas/Electric/DSI Hot Water Heater
- Swing-Away Assist Grab Handle
- Roof Ladder
- No-Slide Rubberized Basement Flooring
- Dual Lock Basement Storage Slam Latches
- Satellite Pre-Wire (roof & ground)
- Outside Speakers & Pre-Wire for Exterior TV
- Full-Perimeter Rain Gutter System (incl. rear & additional gutters over sliderooms)
- Battery Disconnect
- Rear Camera Prep
- Solar Prep Roof
- LP Quick Connect
- Aluminum Steps
- Keyed Alike Baggage Doors
- Rear Towing Hitch
- Under-Mount Spare Tire

EXTERIOR OPTIONS

- Generator Prep & OPT Onan® 5500 LP Generator
- Flip-Down Bike Rack IPO Hitch
- 4-Point Automatic Leveling System (includes MyRV multifunction touch panel)
- Dual-Pane Frameless Windows
- Roto-Flex® Rubberized Pin Box
- 2nd Patio Awning (340 only)
- Rear Observation Camera
- Flip-Out Entry Step (main entrance only)

LIVING ROOM/KITCHEN FEATURES

- Solid Surface Kitchen Countertops & Sink Covers w/Large Handholds
- Double Bowl Residential Stainless Steel Sinks
- Pullout High Arching Faucet

- Storage Shelf under Kitchen Sink
- Heavy-Duty 100 LB Drawer Glides on Every Drawer
- Baltic Birch Drawer Boxes
- 8 CU FT Refrigerator
- 22" High-Output Oven w/Broiler
- 30" OTR Microwave
- Kitchen Window (most models)
- All-Wood Lumber Core Screwed Cabinets w/Hardwood Doors
- 5" Brushed Nickel Cabinet Hardware
- Window Shades Throughout
- 3/8" Re-Bond Carpet Pad w/22 OZ Residential Carpet Throughout
- XL Toggle Light Switches
- Faux Vinyl Ceiling
- Large Ceiling Crown Molding
- All LED Ceiling & Cabinet Lights w/Multiple On/Off Switches
- Deluxe Residential-Style Furniture
- HD Flat Panel TV w/Swing Arm Bracket & Storage behind TV (most models)
- Sound Bar Entertainment Center & DVD Player
- Adjustable Pantry Shelves (where applicable)
- All Kitchen OH Cabinets incl. Shelf & Extra-Tall Slide Lips
- Wood-Top Booth Dinette Tables
- 4" High Density Foam Cushions on all Booth Dinettes
- Dual Pots & Pans Drawers in all Booth Dinette Seats
- Ceiling Fan (where applicable)
- Dual Residential Swivel Rocker Recliners
- Deluxe Sleeper Sofa
- 12V/USB Power Charging Station
- Motion Lights – Closet & Pass Thru Storage Area

LIVING ROOM/KITCHEN OPTIONS

- Upgraded Side-by-Side RV Refrigerator
- 18 CU FT 120V Residential Refrigerator & Inverter (N/A 318, 347)
- Power Vent Fan w/Remote Controls (kitchen, living room, bath, bedroom)
- Free Standing Table w/Leaf & 4 Chairs

- Wide View Fireplace
- DVD Player
- Central Vacuum System
- Single Bowl Sink in place of Double Bowl
- Convection Microwave

BATHROOM/BEDROOM FEATURES

- Residential One-Piece Fiberglass Shower Stall w/Built-In Seat & Glass Doors
- Shower Skylight
- Porcelain Foot-Flush Toilet
- All LED Lights in Bed & Bath w/Multiple Large Switches
- Vent Fan in all Baths
- Heavy-Duty 100 LB Drawer Glides on all Drawers
- Large Linen Closet in Every Bathroom
- One-Level, Full-Height Bedrooms
- Motion Light – Bathroom
- Padded Headboard w/Power Outlet Near Bed
- XL Under-Bed Storage
- Luxurious Bedspread & Pillow Shams
- Dual Drawers, Large Hanging Space & Washer & Dryer Prep in Front Closet
- Bedroom TV Pre-Wire
- 60" x 80" Queen Bed

BATHROOM/BEDROOM OPTIONS

- 72" x 80" King-Size Bed (limited space on 318)
- Upgraded Mattress
- HD Flat Panel Bedroom TV w/Swing Arm Bracket
- 13,500 BTU Ducted Bedroom AC

BONUS FEATURES

- 2-Year Limited Warranty (see flyer)
- K-Z has received the Dealer Satisfaction Index Award for 17 years
- K-Z's 46 years of stable, dedicated manufacturing experience, coupled with its predominant Amish workforce, heritage and commitment to superb quality, allow us to produce the lowest-priced luxury fifth wheel available.

CONSTRUCTION FEATURES

- 6-Sided 100% Aluminum Frame
- Steel Powder Coated I-Beam w/Drop-Frame Pass-Thru Storage
- R-11 2" Block Foam Bonded Sidewalls w/EGS Metal Backing Strips (to support all int. cabinets)
- Lamilux® Gelcoat High-Gloss-Colored Fiberglass Exterior
- Fully-Insulated Sliderooms
- Walk-On Superflex® TPO Roof Membrane
- 5/8" Tongue & Groove, Screwed & Glued Plywood Floor Decking
- Fully-Vented Attic System
- Completely Heated Water System
- Pex® In-Floor Heated Waterlines & Kitchen Gray Pipes (all waterlines & drainlines are located above all insulation)
- Fully Heated & Enclosed Underbelly
- Radius Front Cap (for increased turning radius on short bed trucks)
- Extra-Reinforced Heavy-Duty Front Fiberglass Cap
- All Weather Insulation PKG (upgrades roof, floor, ceiling, endcaps & tanks to R-38)

EXTERIOR FEATURES

- Off the Grid Solar Package (160W solar panel)
- Front Electric Jacks
- Dexter® Axles w/Self Adjusting Brakes & Height Adjusting Hangers
- 8-Lug Heavy-Duty Aluminum Rims w/16" E-Range Nitrogen-Filled Radial Tires
- Equa-Flex® Rubberized Suspension
- 100% Exterior LED Running Lights & Taillights
- LED Front Docking Light & Sewer Hookup Light
- Electric Power Awning w/LED Light Strip
- (2) 30 lb. Propane Bottles on Same Side of Coach for Easy Access
- Side-Mounted Sealed Battery Compartment
- Partially Painted Front Cap
- Frameless Windows
- 50 AMP Service w/Marine Power Cord
- 15,000 BTU Ducted Roof AC w/Pre-Wire for Optional 13,500 BTU Bedroom AC

- 3" x 14" Foam-Core In-Floor Straight-Line Heating System w/35,000 BTU Furnace
- Deluxe Heated Water Convenience Center (incl. black tank flush, power fresh tank water fill, winterizing system, outside shower)
- Fully-Finished, Heated & Sealed Basement Storage Compartment
- 12 GAL Gas/Electric/DSI Hot Water Heater
- Swing-Away Assist Grab Handle
- Roof Ladder
- No-Slide Rubberized Basement Flooring
- Dual Lock Basement Storage Slam Latches
- Satellite Pre-Wire (roof & ground)
- Outside Speakers & Pre-Wire for Exterior TV
- Full-Perimeter Rain Gutter System (incl. rear & additional gutters over sliderooms)
- Battery Disconnect
- Rear Camera Prep
- Solar Prep Roof
- LP Quick Connect
- Aluminum Steps
- Keyed Alike Baggage Doors
- Rear Towing Hitch
- Under-Mount Spare Tire

EXTERIOR OPTIONS

- Generator Prep & OPT Onan® 5500 LP Generator
- Flip-Down Bike Rack IPO Hitch
- 4-Point Automatic Leveling System (includes MyRV multifunction touch panel)
- Dual-Pane Frameless Windows
- Roto-Flex® Rubberized Pin Box
- 2nd Patio Awning (340 only)
- Rear Observation Camera
- Flip-Out Entry Step (main entrance only)

LIVING ROOM/KITCHEN FEATURES

- Solid Surface Kitchen Countertops & Sink Covers w/Large Handholds
- Double Bowl Residential Stainless Steel Sinks
- Pullout High Arching Faucet

- Storage Shelf under Kitchen Sink
- Heavy-Duty 100 LB Drawer Glides on Every Drawer
- Baltic Birch Drawer Boxes
- 8 CU FT Refrigerator
- 22" High-Output Oven w/Broiler
- 30" OTR Microwave
- Kitchen Window (most models)
- All-Wood Lumber Core Screwed Cabinets w/Hardwood Doors
- 5" Brushed Nickel Cabinet Hardware
- Window Shades Throughout
- 3/8" Re-Bond Carpet Pad w/22 OZ Residential Carpet Throughout
- XL Toggle Light Switches
- Faux Vinyl Ceiling
- Large Ceiling Crown Molding
- All LED Ceiling & Cabinet Lights w/Multiple On/Off Switches
- Deluxe Residential-Style Furniture
- HD Flat Panel TV w/Swing Arm Bracket & Storage behind TV (most models)
- Sound Bar Entertainment Center & DVD Player
- Adjustable Pantry Shelves (where applicable)
- All Kitchen OH Cabinets incl. Shelf & Extra-Tall Slide Lips
- Wood-Top Booth Dinette Tables
- 4" High Density Foam Cushions on all Booth Dinettes
- Dual Pots & Pans Drawers in all Booth Dinette Seats
- Ceiling Fan (where applicable)
- Dual Residential Swivel Rocker Recliners
- Deluxe Sleeper Sofa
- 12V/USB Power Charging Station
- Motion Lights – Closet & Pass Thru Storage Area

LIVING ROOM/KITCHEN OPTIONS

- Upgraded Side-by-Side RV Refrigerator
- 18 CU FT 120V Residential Refrigerator & Inverter (N/A 318, 347)
- Power Vent Fan w/Remote Controls (kitchen, living room, bath, bedroom)
- Free Standing Table w/Leaf & 4 Chairs

- Wide View Fireplace
- DVD Player
- Central Vacuum System
- Single Bowl Sink in place of Double Bowl
- Convection Microwave

BATHROOM/BEDROOM FEATURES

- Residential One-Piece Fiberglass Shower Stall w/Built-In Seat & Glass Doors
- Shower Skylight
- Porcelain Foot-Flush Toilet
- All LED Lights in Bed & Bath w/Multiple Large Switches
- Vent Fan in all Baths
- Heavy-Duty 100 LB Drawer Glides on all Drawers
- Large Linen Closet in Every Bathroom
- One-Level, Full-Height Bedrooms
- Motion Light – Bathroom
- Padded Headboard w/Power Outlet Near Bed
- XL Under-Bed Storage
- Luxurious Bedspread & Pillow Shams
- Dual Drawers, Large Hanging Space & Washer & Dryer Prep in Front Closet
- Bedroom TV Pre-Wire
- 60" x 80" Queen Bed

BATHROOM/BEDROOM OPTIONS

- 72" x 80" King-Size Bed (limited space on 318)
- Upgraded Mattress
- HD Flat Panel Bedroom TV w/Swing Arm Bracket
- 13,500 BTU Ducted Bedroom AC

BONUS FEATURES

- 2-Year Limited Warranty (see flyer)
- K-Z has received the Dealer Satisfaction Index Award for 17 years
- K-Z's 46 years of stable, dedicated manufacturing experience, coupled with its predominant Amish workforce, heritage and commitment to superb quality, allow us to produce the lowest-priced luxury fifth wheel available.

FULL PROFILE LUXURY

for your ideal **FAMILY GETAWAY**



True 2-Year Limited Warranty!
K-Z's 24-month hitch-to-bumper limited warranty umbrella is the best 2-year warranty in the business, covering more than 1,500 operations codes for a full two years (approved for fulltime living), and protects your investment while you enjoy your new RV.



DSI stands for dealer satisfaction index. Our dealer body consistently rates K-Z highly, and the RV Dealer Association has awarded K-Z their top honor Quality Circle Award for excellence of design, reliability, overall quality and value, communications and dealer support. K-Z has been honored with the DSI award for more years in a row than any other towable manufacturer!



trailers. And 20 employees. Then fifth wheels. Over the years, as the product selection grew, so did the headcount. Today, the K-Z campus covers 530,000 square feet, includes over 600 employees (one of the largest employers in our area), and hosts 20 product lines that offer close to 200 floorplans.

K-Z is headquartered in Shipshewana, Indiana, and was founded in 1972 on the principles of quality, fairness and integrity. Today, K-Z produces several widely-recognized brands of towables, including Durango, Sidewinder and Venom.

The first RV K-Z offered was a truck camper, and was designed, fabricated and assembled by two employees. Then 12 employees. Then we added travel

People make a difference, and at K-Z, our employees make all the difference in the world. As you'll discover when you communicate with K-Z, you'll always be speaking with someone who takes you seriously and treats you with respect. Quality products and business integrity are a way of life at K-Z. Thank you for considering K-Z, and we'd like to welcome you to our world-wide family of satisfied customers!



K-Z proudly supports our veterans and active military. Thank you for your service!

RVIA

K-Z strongly encourages our retail customers to purchase from their local dealership whenever possible.



985 N 900 W • Shipshewana, IN 46565
E-mail kz@kz-rv.com • www.kz-rv.com

Due to continual research and advances, manufacturer reserves the right to change specifications, design, price and equipment without notice, and assumes no responsibility for any error in this literature. Some items shown are not included as standard or optional equipment.
©2017KZ | 12/22/17 | 60M

Dealer:

FULL PROFILE LUXURY

for your ideal **FAMILY GETAWAY**



True 2-Year Limited Warranty!
K-Z's 24-month hitch-to-bumper limited warranty umbrella is the best 2-year warranty in the business, covering more than 1,500 operations codes for a full two years (approved for fulltime living), and protects your investment while you enjoy your new RV.



DSI stands for dealer satisfaction index. Our dealer body consistently rates K-Z highly, and the RV Dealer Association has awarded K-Z their top honor Quality Circle Award for excellence of design, reliability, overall quality and value, communications and dealer support. K-Z has been honored with the DSI award for more years in a row than any other towable manufacturer!



K-Z is headquartered in Shipshewana, Indiana, and was founded in 1972 on the principles of quality, fairness and integrity. Today, K-Z produces several widely-recognized brands of towables, including Durango, Sidewinder and Venom.

The first RV K-Z offered was a truck camper, and was designed, fabricated and assembled by two employees. Then 12 employees. Then we added travel

trailers. And 20 employees. Then fifth wheels. Over the years, as the product selection grew, so did the headcount. Today, the K-Z campus covers 530,000 square feet, includes over 600 employees (one of the largest employers in our area), and hosts 20 product lines that offer close to 200 floorplans.

People make a difference, and at K-Z, our employees make all the difference in the world. As you'll discover when you communicate with K-Z, you'll always be speaking with someone who takes you seriously and treats you with respect. Quality products and business integrity are a way of life at K-Z. Thank you for considering K-Z, and we'd like to welcome you to our world-wide family of satisfied customers!



K-Z proudly supports our veterans and active military. Thank you for your service!



K-Z strongly encourages our retail customers to purchase from their local dealership whenever possible.



985 N 900 W • Shipshewana, IN 46565
E-mail kz@kz-rv.com • www.kz-rv.com

Due to continual research and advances, manufacturer reserves the right to change specifications, design, price and equipment without notice, and assumes no responsibility for any error in this literature. Some items shown are not included as standard or optional equipment.
©2017KZ | 12/22/17 | 60M

Dealer: