

DURANGO GOLD



DURANGO GOLD FULLTIME LUXURY FIFTH WHEELS



DURANGO

GOLD



DURANGO GOLD FULLTIME LUXURY FIFTH WHEELS



DURANGO GOLD

Thoughtfully designed, beautifully livable, these luxury fifth wheels set the gold standard for fulltime RVing. Stroll through the interior and notice the many easy living features that add style, convenience, and most importantly, comfort. Plush residential furnishings, well planned kitchens, accent lighting, and even a 40" wide view fireplace are just a few of the many reasons you'll find life so easy in a Durango Gold.



Standard Exterior Steps Lightweight, rustproof aluminum, with strong steel linkages and frame.



Under-Mount Spare Out of the way, easy crank-down, doesn't interfere with bike rack or rear hitch.

DURANGO GOLD

Thoughtfully designed, beautifully livable, these luxury fifth wheels set the gold standard for fulltime RVing. Stroll through the interior and notice the many easy living features that add style, convenience, and most importantly, comfort. Plush residential furnishings, well planned kitchens, accent lighting, and even a 40" wide view fireplace are just a few of the many reasons you'll find life so easy in a Durango Gold.



Standard Exterior Steps Lightweight, rustproof aluminum, with strong steel linkages and frame.



Under-Mount Spare Out of the way, easy crank-down, doesn't interfere with bike rack or rear hitch.



G384RLT | Travertine décor



50 AMP Service
Satisfies all your electrical needs.



Key-Alike Locks
Increased security and ease of use.



LP Quick-Connect
Allows for additional LP appliances.



Industry's first self-contained, lightweight and adjustable ground-stable step that provides secure footing (optional).



G384RLT | Travertine décor



50 AMP Service
Satisfies all your electrical needs.



Key-Alike Locks
Increased security and ease of use.



LP Quick-Connect
Allows for additional LP appliances.



Industry's first self-contained, lightweight and adjustable ground-stable step that provides secure footing (optional).

DURANGO GOLD

When you're full-timing it, nowhere is comfort more important than the bedroom and bath. King size beds are standard, along with extra large deep walk-in closets and additional cabinet space. Bathrooms feature a residential size shower with built-in seat and glass doors.



Rear Observation Camera Prep
Optional backup camera increases ease and safety while backing.



DURANGO GOLD

When you're full-timing it, nowhere is comfort more important than the bedroom and bath. King size beds are standard, along with extra large deep walk-in closets and additional cabinet space. Bathrooms feature a residential size shower with built-in seat and glass doors.



Rear Observation Camera Prep
Optional backup camera increases ease and safety while backing.





G353RKT | Eclipse décor



Standard on all Durango Gold, the all-weather insulation package includes upgrades to roof, floor, ceiling, endcaps and tanks to R-38, allowing you to enjoy your fifth wheel all year long.



Off The Grid solar package with 160W solar panel offers the freedom to unplug while you're away (optional).



Durango Gold comes standard with 3" x 14" foam-core in-floor straight-line heating system with 35,000 BTU furnace and 15,000 BTU ducted roof air conditioner.



My RV gives you command of your fifth wheel from one location, with the touch of your finger. This allows you to control the awning, landing gear, and slideouts, as well as access to troubleshooting videos and your owners manual (included with optional leveling system).



3,000 Pound rear towing hitch is standard on all Durango fifth wheels!



Exterior Battery Disconnect A turn of the knob keeps your battery from discharging.



Outside Speakers Standard on all Durangos.



Heated Water Convenience Center Includes black tank flush, power fresh tank water fill, winterizing system and outside shower.



Portions of this brochure were used with the expressed authority of Dexter Axle, but Dexter Axle is not responsible for the accuracy of the information contained herein.



G353RKT | Eclipse décor



Standard on all Durango Gold, the all-weather insulation package includes upgrades to roof, floor, ceiling, endcaps and tanks to R-38, allowing you to enjoy your fifth wheel all year long.



Off The Grid solar package with 160W solar panel offers the freedom to unplug while you're away (optional).



Durango Gold comes standard with 3" x 14" foam-core in-floor straight-line heating system with 35,000 BTU furnace and 15,000 BTU ducted roof air conditioner.



My RV gives you command of your fifth wheel from one location, with the touch of your finger. This allows you to control the awning, landing gear, and slideouts, as well as access to troubleshooting videos and your owners manual (included with optional leveling system).



3,000 Pound rear towing hitch is standard on all Durango fifth wheels!



Exterior Battery Disconnect A turn of the knob keeps your battery from discharging.



Outside Speakers Standard on all Durangos.



Heated Water Convenience Center Includes black tank flush, power fresh tank water fill, winterizing system and outside shower.



Portions of this brochure were used with the expressed authority of Dexter Axle, but Dexter Axle is not responsible for the accuracy of the information contained herein.

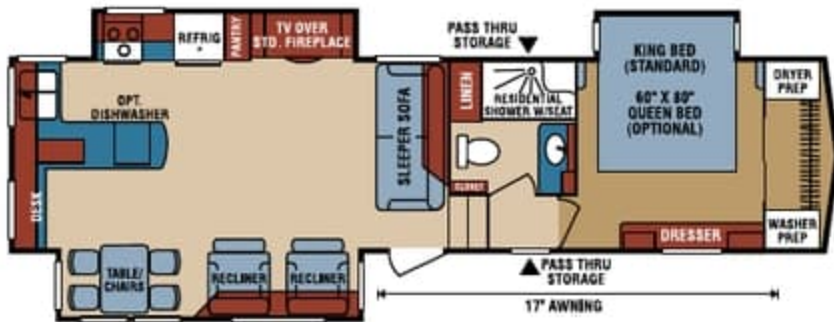

G353RKT

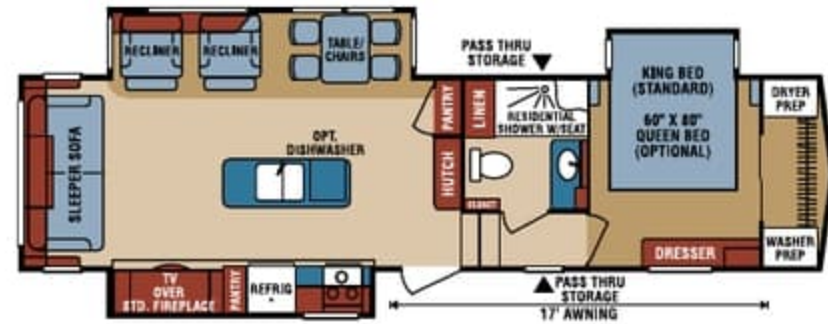

G355RLT

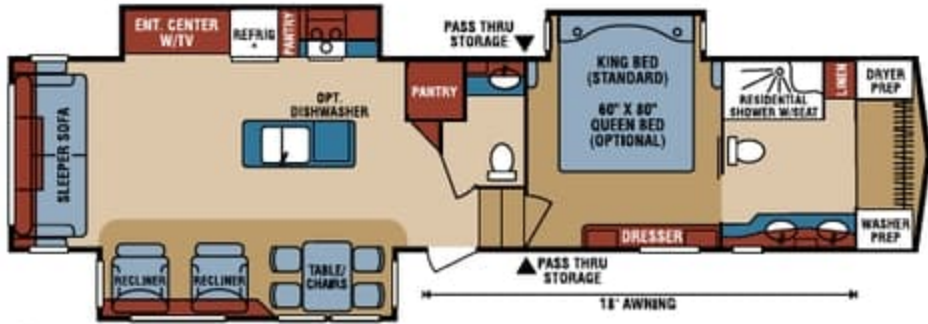

G366FBT



G371RLT

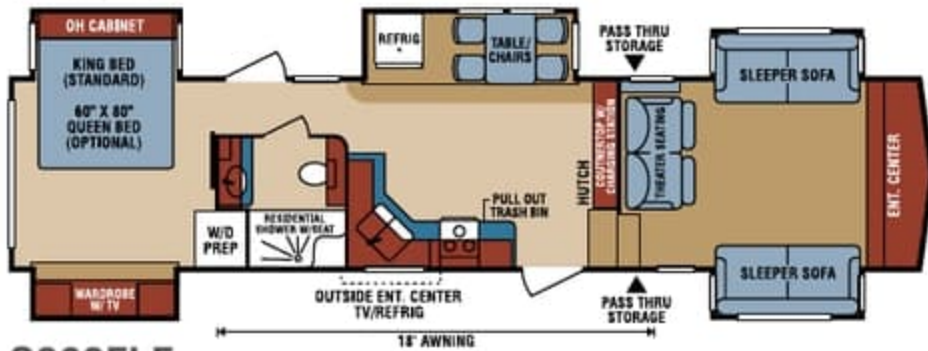

G380FLF

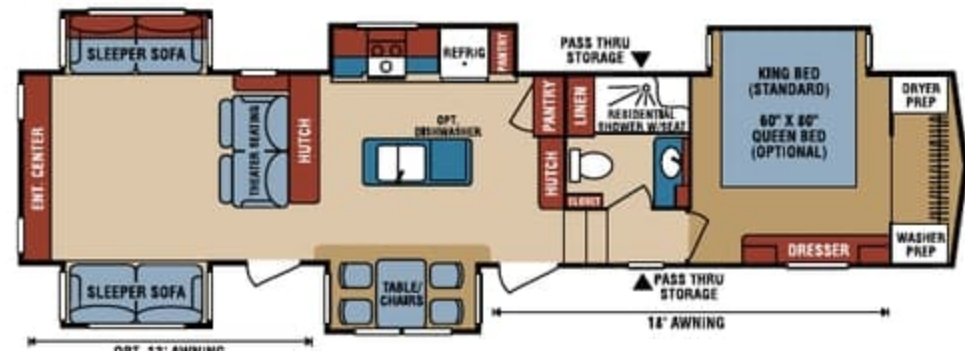

G381REF



G382MBQ

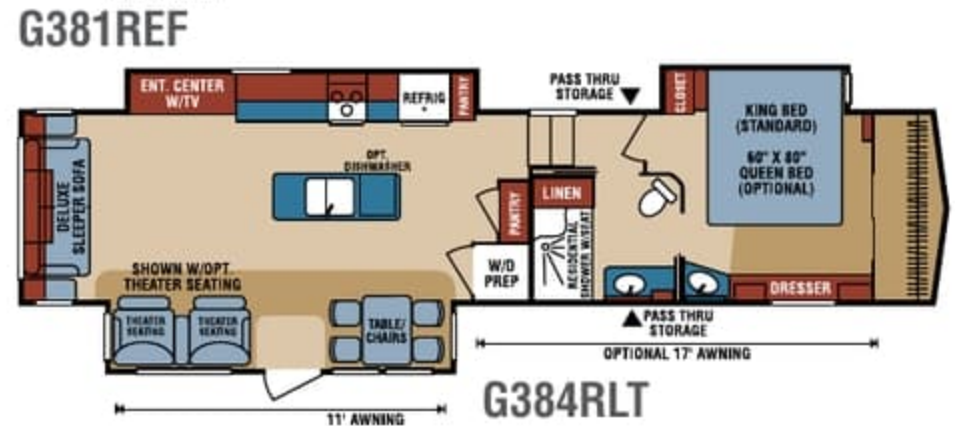

G384RLT



G385FLF

*18 CU FT 120V Residential Refrigerator w/Inverter or 18 CU FT 4-Door RV Refrigerator



G384RLT Shown in optional full paint package.

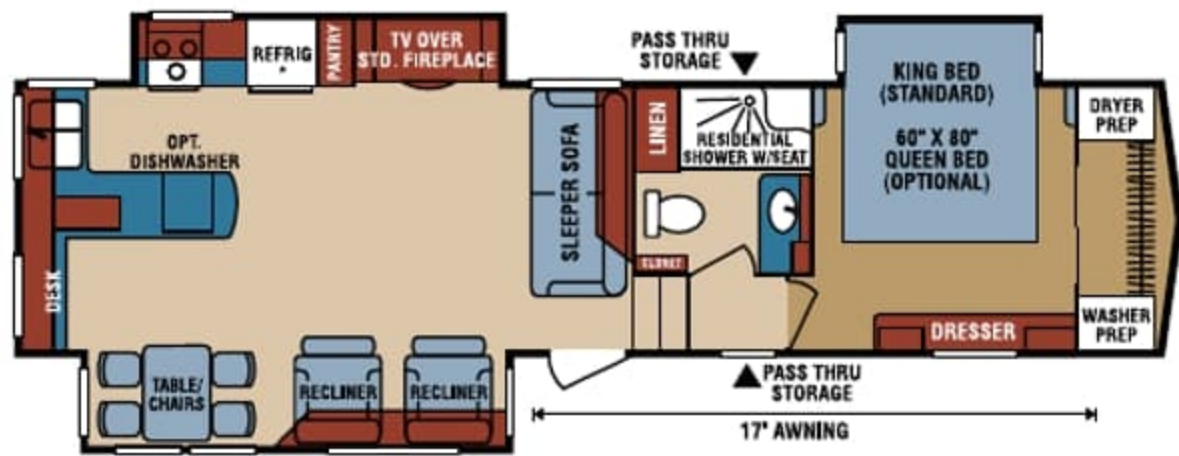

G353RKT

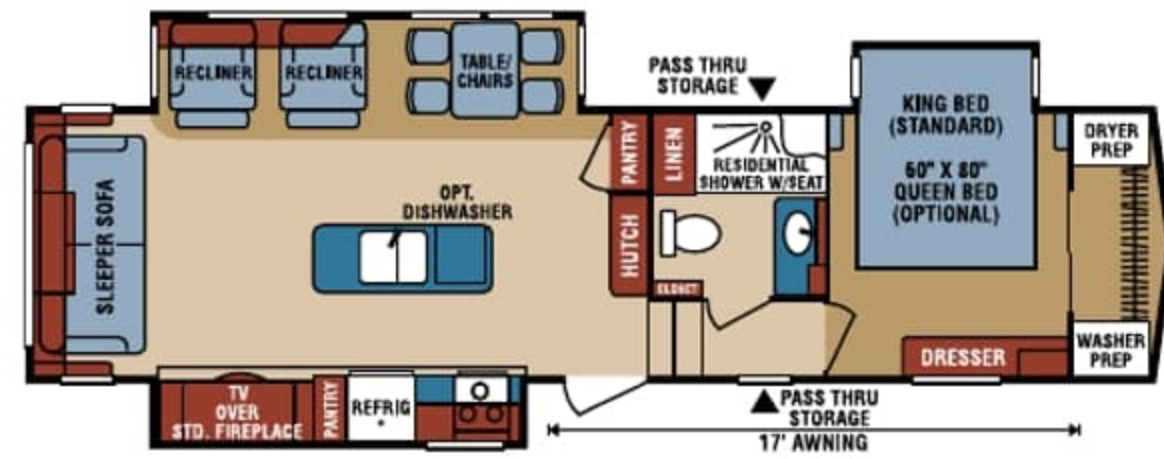

G355RLT

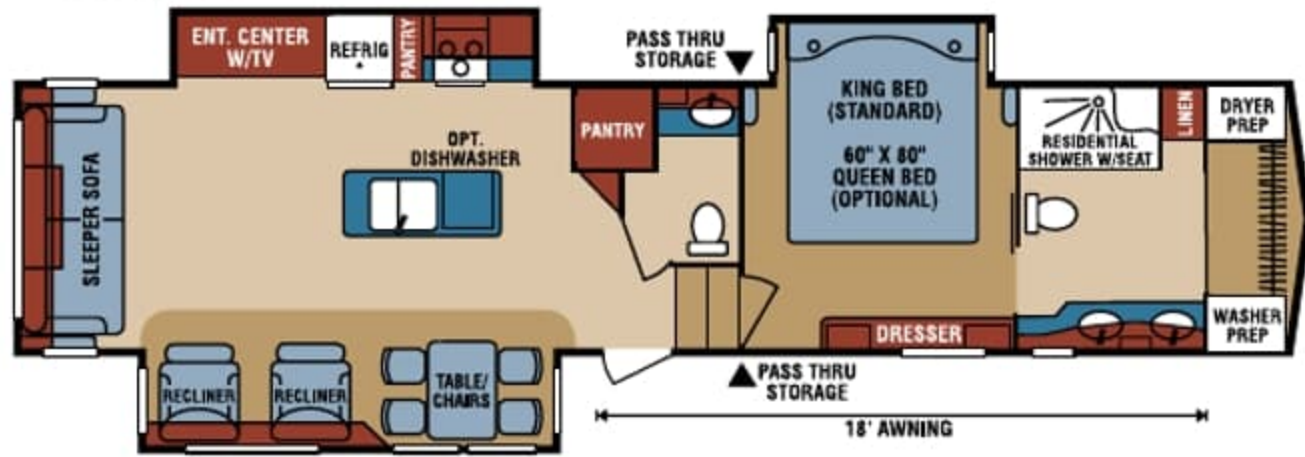

G366FBT

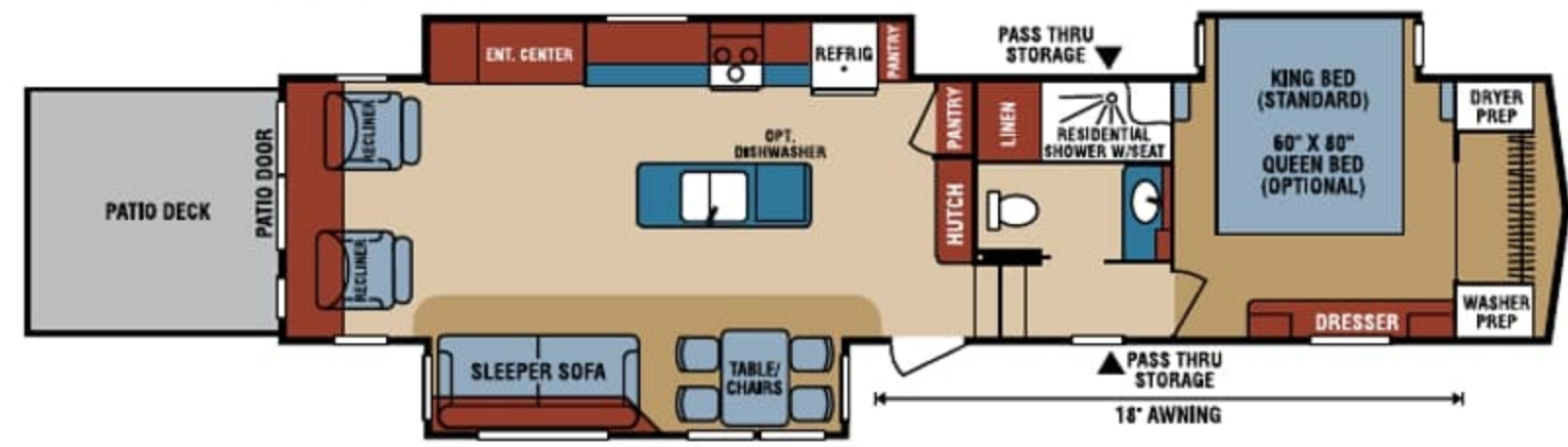

G371RLT

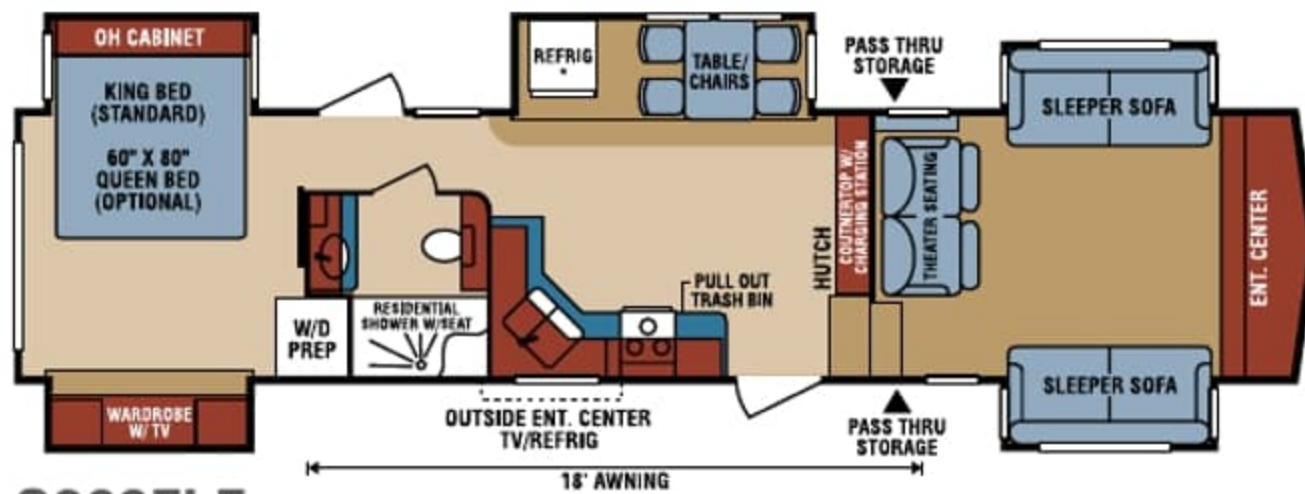

G380FLF

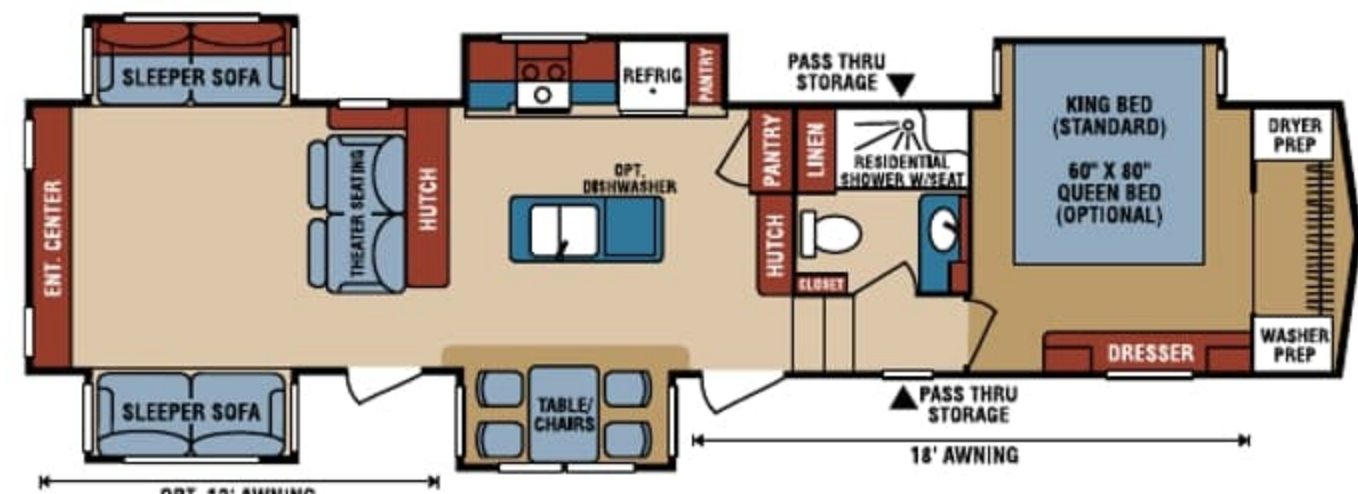

G381REF

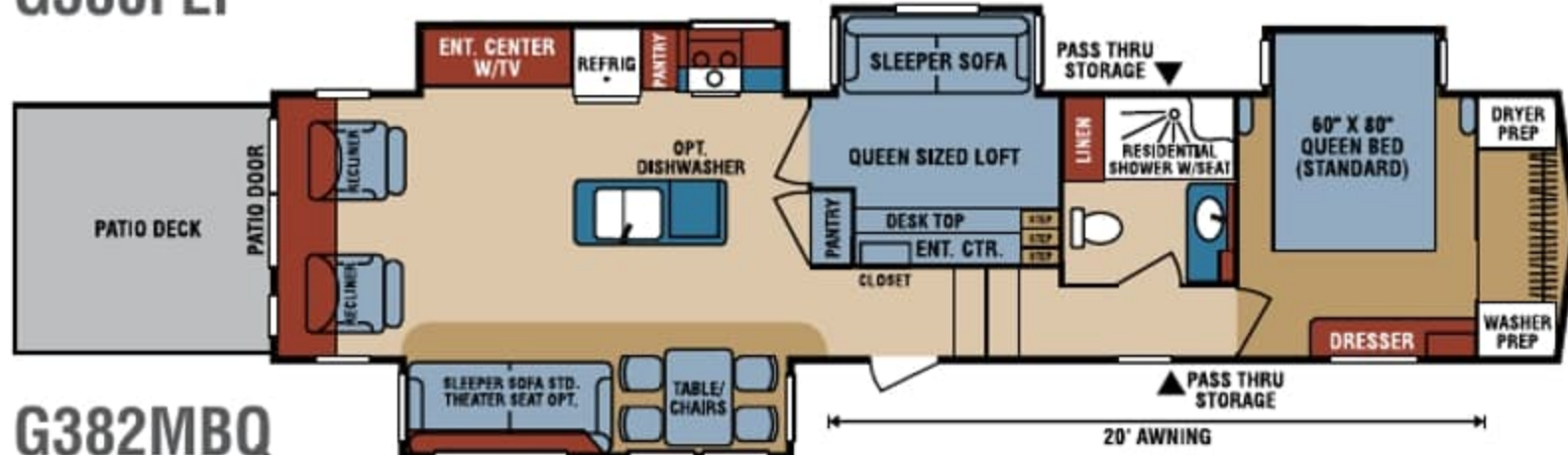

G382MBQ

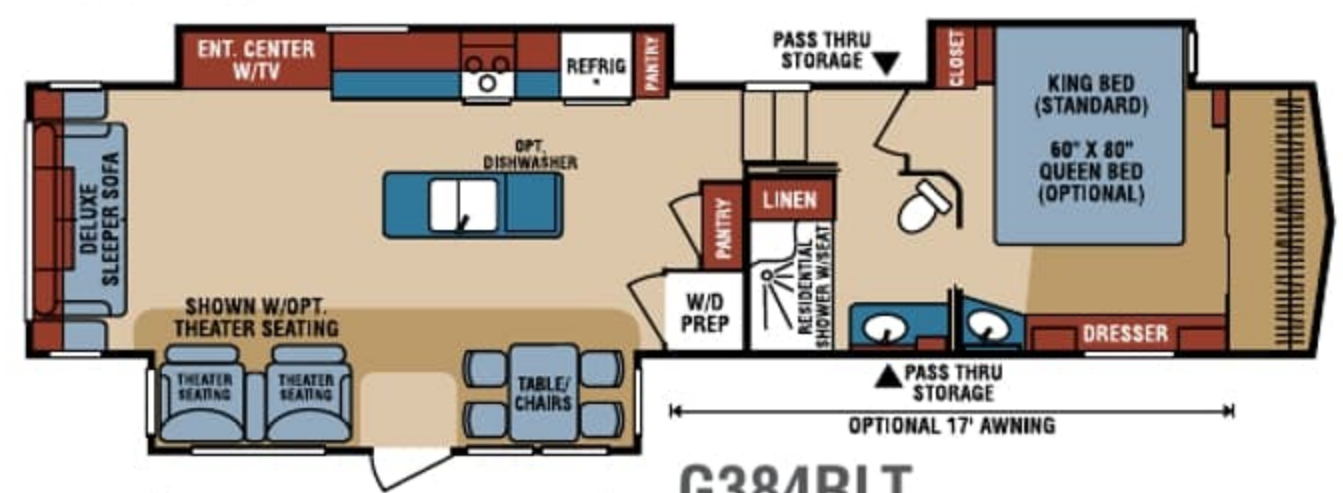

G384RLT

*18 CU FT 120V Residential Refrigerator w/Inverter or 18 CU FT 4-Door RV Refrigerator

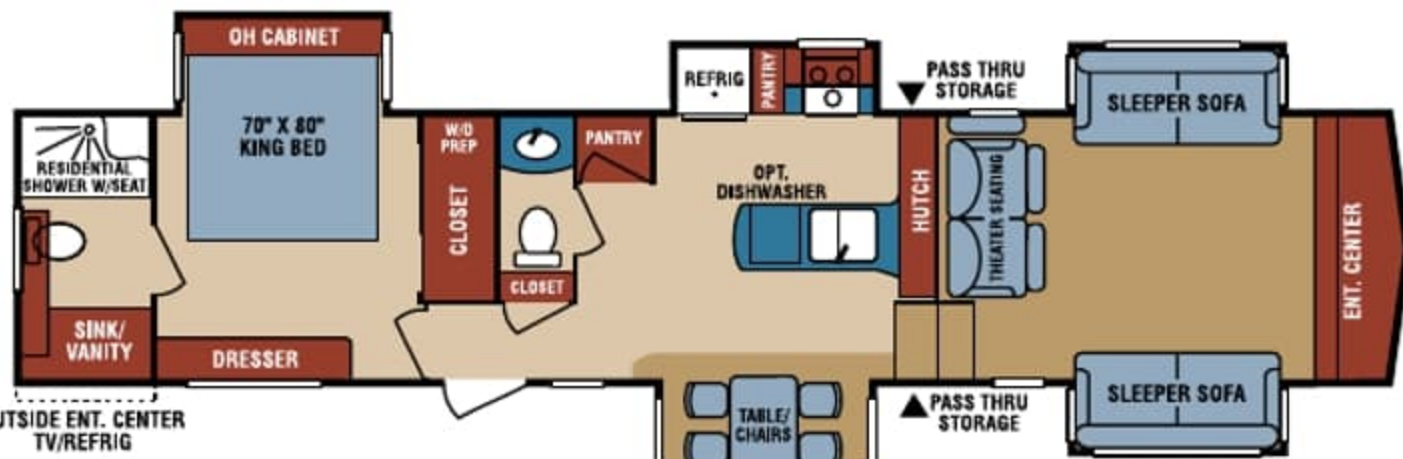

G385FLF



G384RLT Shown in optional full paint package.

CONSTRUCTION FEATURES

- 101" Wide Body Construction
- 6-Sided 100% Aluminum Frame
- Extra-Reinforced Heavy-Duty Front Fiberglass Cap
- Radius Front Cap (for increased turning radius on short bed trucks)
- 2" x 3" Welded Aluminum Fore & Aft Floor Joists
- 2" x 2" Welded Aluminum Sidewall Framing
- 5" Welded Aluminum Roof Trusses
- LCI® Hydraulic Slide System w/Selector Valves
- Steel Powder Coated I-Beam w/Drop-Frame Pass-Thru Storage (offering 160-180 CU FT, F/P specific)
- Lamilux® High-Gloss Ivory-Colored Fiberglass
- All Weather Insulation PKG (roof, floor, ceiling, endcaps & tanks to R-38)
- R-11 2" Sidewalls (w/EGS metal backing strips to hold all int. cabinets)
- One-Piece ABS Slideroom Bottoms; Slideroom Floors Insulated to R-24
- Walk-On Superflex® TPO Roof Membrane
- 45 Degree Aluminum Roof Edge
- Fully-Vented Attic System
- 3/8" Roof Decking
- 5/8" Tongue & Groove, Screwed & Glued Plywood Floor Decking
- Full Drop-Frame Aluminum Skirt on Doorside
- Pex® In-Floor Heated Waterlines & Kitchen Gray Pipes (all waterlines & drainlines are located above all insulation)
- Fully Heated & Enclosed Underbelly
- Double Insulated & Heated Holding Tanks (R-38 above & below tanks)

EXTERIOR FEATURES

- 7,000 LB Dexter® Axles w/Self Adjusting Brakes & Height Adjusting Hangers
- 8-Lug Heavy-Duty Aluminum Rims w/16" G-Range Radial Tires
- EZ Flex® Rubberized Suspension
- 4-Step Aluminum Entry Step w/LED Light
- Roto-Flex® Hitch Pin
- 100% Exterior LED Running Lights & Taillights
- Electric Awning w/Light Strip
- Propane Bottles on same Side of Coach for Easy Access (2 x 30 lb. each)
- Sealed Battery Storage Compartment on Side of Coach (no battery boxes required)
- Dual Front Baggage Doors
- Slam Latch Baggage Doors w/Gas Strut Lifts (where applicable) & Dual Locks
- 50 AMP Service w/Marine Power Cord
- Partially Painted Front Cap w/LED Accent Lights
- Frameless Windows
- Dual 15,000 BTU "Quiet Cool" Ducted A/C System
- 3" x 14" In-Floor Straight Line Heating System w/35,000 BTU Furnace
- 12 GAL Gas/Electric Hot Water Heater
- LED Docking Light & Sewer Hookup Light
- Swing-Away Assist Grab Handle
- Underneath Spare Tire w/Hoist
- Roof Ladder
- Deluxe Heated Water Convenience Center (incl. black tank flush, power fresh tank water fill, winterizing system, outside shower & dry camping water siphon system)
- Fully-Finished, Heated & Sealed Basement Storage Compartment

- Battery Disconnect
- LED Lighted Outside Speakers
- Pre-Wire for Exterior TV
- Satellite Pre-Wire (roof & ground)
- Solar Prep – Roof
- LP Quick Connect
- Rear Camera Prep
- Keyed Alike Baggage Doors
- Rear Towing Hitch (rated at 3,000 LBS)
- 7" MyRV Wall Control - (included w/ optional 6-point leveling)

EXTERIOR OPTIONS

- 6-Point Hydraulic Auto Leveling System
- 2nd Lighted Power Awning (N/A 355, 380, 385)
- Slideout Awning PKG (N/A if 2nd awning is optioned)
- Flip-Down Bike Rack/Tailgate Storage System IPO Rear Towing Hitch
- Dual-Pane Frameless Windows
- Generator Prep & OPT Onan® 5500 LP Generator
- Trailair® Flex Air® Pin Box Upgrade
- Rear Observation Camera
- Full Body Paint PKG
- Off-the-Grid Solar PKG
- Flip Out Entry Steps (main entrance only) (STD on 384, 385)

LIVING ROOM/KITCHEN FEATURES

- Solid Surface Countertops w/Sink Covers w/Large Handholds
- Large Residential Double Bowl Stainless Steel Sink
- High Arch Pullout Sprayer Faucet
- Residential Size Pullout Trashcan in Kitchen

- Pullout Spice Rack (most models)
- Dual Pullout Pots & Pans Drawers under Refrigerator & Stove (where available)
- Removable Silverware Tray
- Storage Shelf under Kitchen Sink
- All Kitchen OH Cabinets have Shelf & Extra-Tall Slide Lips
- Heavy-Duty 100 LB Drawer Glides on Every Drawer
- Baltic Birch Drawer Boxes
- LED-Lighted Kitchen Cabinet Toe Kicks (most models)
- Flush-Mounted Glass Folding Stove Cover
- Large Dining Table w/Removable Leaf & 2 Storage Seat Chairs & 2 Folding Chairs
- Kitchen Window (most models)
- Hidden Cabinet Door Hinges
- 5" Cabinet Hardware
- 3/8" Re-Bond Carpet Pad w/22 OZ Residential Carpet
- 30" Microwave above Range
- XL Toggle Light Switches
- Faux Vinyl Soft Touch Ceiling
- Power Vent Kitchen Fan
- Power Vent Fan in Second Bath (366FBT & 385FLF)
- All LED Ceiling & Cabinet Lights w/Multiple On/Off Switches
- 48" – 50" HD LED TV on Swing Arm w/built-in storage behind TV (most models)
- 12V Entertainment System (Radio) w/Bluetooth, Sound Bar & DVD
- Dual Residential Swivel Rocker Recliners
- Deluxe Sleeper Sofa
- Wide View Electric Fireplace
- Barn Door Panels on Island
- Night Roller Shades
- Ceiling Fan (where applicable)

LIVING ROOM/KITCHEN OPTIONS

- Theater Seat IPO Dual Recliners (380, 381, 385)
- Theater Seat IPO Hide A Bed Sofa (382MBQ)
- Booth Dinette IPO Free-Standing Table & 4 Chairs (N/A 381, 380, 385)
- 18 CU FT 120V Residential Refrigerator w/Inverter or 18 CU FT 4-Door RV Refrigerator
- Power Vent Bath & Bedroom Fan w/Remote Controls
- Central Vacuum System
- Single Bowl Sink in place of Double
- Dishwasher (requires single bowl sink) (N/A 380)
- Day/Night Roller Shades
- Convection Microwave

BATHROOM/BEDROOM FEATURES

- Residential One-Piece Fiberglass Shower Stall w/Built-In Seat & Glass Doors
- Shower Skylight
- XL Solid Surface Bath Vanity w/Stainless Steel Sink
- Porcelain Foot-Flush Toilet

- All LED Lights in Bed & Bath w/Multiple Switches
- Heavy-Duty 100 LB Drawer Glides on all Drawers
- Extra-Wide Bed & Bath Hallway (most models)
- Pocket Door from Hall to Bath (most models)
- Bath Towel Bar & Towel Loop (where applicable)
- 12V Fan
- XL Bath Linen Closet
- XL Deep Bedroom Walk-In Closet
- Dual Washer & Dryer Prep
- XL Under-Bed Storage
- Luxurious Bedspread & Pillow Shams
- HD Flat Panel Bedroom TV
- 72" x 80" King-Size Upgraded Mattress (now available on 382 *Attn: makes bedroom tight)
- Motion Lights – Closet & Bathroom

BATHROOM/BEDROOM OPTIONS

- 60" x 80" Queen-Size Upgraded Mattress (std. 382)
- Power Vent Fan

K-Z EZ CAMPING GOLD PACKAGE (MANDATORY)

- LP Quick Connect
- 40" Fireplace
- Decorative Slideout Ceiling Fixture
- 7" My RV One Touch Control Panel
- Under-Mount Spare Tire
- Power Awning w/LED Lights
- Keyed A-Like Baggage Doors
- Roof-Mounted Solar Prep
- Rear Towing Hitch
- Rear Camera Prep
- Decorative Barn Doors & Finished End Panels on Kitchen Islands
- Motion Sensor Lights (closet, bath, basement)
- Roller Nightshades
- Lighted Exterior Speakers
- Upgraded Electronics Package (sound bar, subwoofer, DVD player)
- 12V/USB Charging Station
- Decorative Mullion Closet Doors
- G-Rated Tires
- Ducted 2nd 15K A/C w/Quiet Cool
- Free-Standing Dinette w/2 Chairs & 2 Folding Chairs

BONUS FEATURES

- 2-Year Limited Warranty (see flyer)
- Lightest high-profile, wide body, luxury fifth wheels in the industry (average weight is 12,000 LBS)
- K-Z has received the Dealer Satisfaction Index Award for 17 years
- K-Z's 46 years of stable, dedicated manufacturing experience, coupled with its predominant Amish workforce, heritage and commitment to superb quality, allow us to produce the best value luxury fifth wheel available.

FIFTH WHEELS	G353RKT	G355RLT	G366FBT	G371RLT	G380FLF	G381REF	G382MBQ	G384RLT	G385FLF
UVW (Unloaded Vehicle Weight)*	11,090	11,200	11,470	12,730	12,580	12,700	13,330	12,250	12,860
Dry Hitch Weight*	2,130	2,350	2,240	1,820	2,250	2,200	2,120	2,530	2,320
Dry Axle Weight*	8,960	8,850	9,230	10,910	10,330	10,500	11,210	9,720	10,540
NCC (Net Carrying Capacity)	2,910	2,600	3,030	2,870	2,415	2,295	2,270	2,745	2,740
GVWR	14,000	13,800	14,500	15,600	14,995	14,995	15,600	14,995	15,600
Interior Height	76"	76"	76"	76"	76"	76"	76"	76"	76"
Exterior Height	13'	13'	12' 11"	12' 11"	13'	13'	13'	13' 3"	13' 3"
Exterior Width	101"	101"	101"	101"	101"	101"	101"	101"	101"
Exterior Length***	36' 1"	36' 1"	39' 6"	39' 9"	40' 6"	41' 2"	40' 4"	40' 4"	42' 4"
Refrigerator (cu. feet)	8	8	8	8	8	8	8	8	8
Water Heater Cap. (gal. G/E w/DSI)	12	12	12	12	12	12	12	12	12
Fresh Water Cap. (gal.) (inc. WH cap.)	67	67	67	67	67	67	67	67	67
Waste Water Cap. (gal.)	57	57	57	57	57	57	57	57	40
Gray Water Cap. (gal.)	97	97	57	97	57	97	97	97	57
1/2 Bath Cap. (gal.)	N/A	N/A	57	N/A	N/A	N/A	N/A	N/A	57**
LP Gas Cap. (lbs.)	60	60	60	60	60	60	60	60	60
Furnace BTUs (1,000s)	35	35	35	35	35	35	35	35	35
Tire Size	16"	16"	16"	16"	16"	16"	16"	16"	16"
Awning	17'	17'	18'	18'	18'	18' w/12' opt.	20'	11' w/17' opt.	18'

*This weight reflects the rolling average unit weight for each model. Your trailer weight will vary according to optional equipment. **Also includes kitchen.

*** Exterior length is measured from the center of the hitch pin to the rear bumper.

CONSTRUCTION FEATURES

- 101" Wide Body Construction
- 6-Sided 100% Aluminum Frame
- Extra-Reinforced Heavy-Duty Front Fiberglass Cap
- Radius Front Cap (for increased turning radius on short bed trucks)
- 2" x 3" Welded Aluminum Fore & Aft Floor Joists
- 2" x 2" Welded Aluminum Sidewall Framing
- 5" Welded Aluminum Roof Trusses
- LCI® Hydraulic Slide System w/Selector Valves
- Steel Powder Coated I-Beam w/Drop-Frame Pass-Thru Storage (offering 160-180 CU FT, F/P specific)
- Lamilux® High-Gloss Ivory-Colored Fiberglass
- All Weather Insulation PKG (roof, floor, ceiling, endcaps & tanks to R-38)
- R-11 2" Sidewalls (w/EGS metal backing strips to hold all int. cabinets)
- One-Piece ABS Slideroom Bottoms; Slideroom Floors Insulated to R-24
- Walk-On Superflex® TPO Roof Membrane
- 45 Degree Aluminum Roof Edge
- Fully-Vented Attic System
- 3/8" Roof Decking
- 5/8" Tongue & Groove, Screwed & Glued Plywood Floor Decking
- Full Drop-Frame Aluminum Skirt on Doorside
- Pex® In-Floor Heated Waterlines & Kitchen Gray Pipes (all waterlines & drainlines are located above all insulation)
- Fully Heated & Enclosed Underbelly
- Double Insulated & Heated Holding Tanks (R-38 above & below tanks)

EXTERIOR FEATURES

- 7,000 LB Dexter® Axles w/Self Adjusting Brakes & Height Adjusting Hangers
- 8-Lug Heavy-Duty Aluminum Rims w/16" G-Range Radial Tires
- EZ Flex® Rubberized Suspension
- 4-Step Aluminum Entry Step w/LED Light
- Roto-Flex® Hitch Pin
- 100% Exterior LED Running Lights & Taillights
- Electric Awning w/Light Strip
- Propane Bottles on same Side of Coach for Easy Access (2 x 30 lb. each)
- Sealed Battery Storage Compartment on Side of Coach (no battery boxes required)
- Dual Front Baggage Doors
- Slam Latch Baggage Doors w/Gas Strut Lifts (where applicable) & Dual Locks
- 50 AMP Service w/Marine Power Cord
- Partially Painted Front Cap w/LED Accent Lights
- Frameless Windows
- Dual 15,000 BTU "Quiet Cool" Ducted A/C System
- 3" x 14" In-Floor Straight Line Heating System w/35,000 BTU Furnace
- 12 GAL Gas/Electric Hot Water Heater
- LED Docking Light & Sewer Hookup Light
- Swing-Away Assist Grab Handle
- Underneath Spare Tire w/Hoist
- Roof Ladder
- Deluxe Heated Water Convenience Center (incl. black tank flush, power fresh tank water fill, winterizing system, outside shower & dry camping water siphon system)
- Fully-Finished, Heated & Sealed Basement Storage Compartment

- Battery Disconnect
- LED Lighted Outside Speakers
- Pre-Wire for Exterior TV
- Satellite Pre-Wire (roof & ground)
- Solar Prep – Roof
- LP Quick Connect
- Rear Camera Prep
- Keyed Alike Baggage Doors
- Rear Towing Hitch (rated at 3,000 LBS)
- 7" MyRV Wall Control - (included w/ optional 6-point leveling)

EXTERIOR OPTIONS

- 6-Point Hydraulic Auto Leveling System
- 2nd Lighted Power Awning (N/A 355, 380, 385)
- Slideout Awning PKG (N/A if 2nd awning is optioned)
- Flip-Down Bike Rack/Tailgate Storage System IPO Rear Towing Hitch
- Dual-Pane Frameless Windows
- Generator Prep & OPT Onan® 5500 LP Generator
- Trailair® Flex Air® Pin Box Upgrade
- Rear Observation Camera
- Full Body Paint PKG
- Off-the-Grid Solar PKG
- Flip Out Entry Steps (main entrance only) (STD on 384, 385)

LIVING ROOM/KITCHEN FEATURES

- Solid Surface Countertops w/Sink Covers w/Large Handholds
- Large Residential Double Bowl Stainless Steel Sink
- High Arch Pullout Sprayer Faucet
- Residential Size Pullout Trashcan in Kitchen

- Pullout Spice Rack (most models)
- Dual Pullout Pots & Pans Drawers under Refrigerator & Stove (where available)
- Removable Silverware Tray
- Storage Shelf under Kitchen Sink
- All Kitchen OH Cabinets have Shelf & Extra-Tall Slide Lips
- Heavy-Duty 100 LB Drawer Glides on Every Drawer
- Baltic Birch Drawer Boxes
- LED-Lighted Kitchen Cabinet Toe Kicks (most models)
- Flush-Mounted Glass Folding Stove Cover
- Large Dining Table w/Removable Leaf & 2 Storage Seat Chairs & 2 Folding Chairs
- Kitchen Window (most models)
- Hidden Cabinet Door Hinges
- 5" Cabinet Hardware
- 3/8" Re-Bond Carpet Pad w/22 OZ Residential Carpet
- 30" Microwave above Range
- XL Toggle Light Switches
- Faux Vinyl Soft Touch Ceiling
- Power Vent Kitchen Fan
- Power Vent Fan in Second Bath (366FBT & 385FLF)
- All LED Ceiling & Cabinet Lights w/Multiple On/Off Switches
- 48" – 50" HD LED TV on Swing Arm w/ built-in storage behind TV (most models)
- 12V Entertainment System (Radio) w/ Bluetooth, Sound Bar & DVD
- Dual Residential Swivel Rocker Recliners
- Deluxe Sleeper Sofa
- Wide View Electric Fireplace
- Barn Door Panels on Island
- Night Roller Shades
- Ceiling Fan (where applicable)

LIVING ROOM/KITCHEN OPTIONS

- Theater Seat IPO Dual Recliners (380, 381, 385)
- Theater Seat IPO Hide A Bed Sofa (382MBQ)
- Booth Dinette IPO Free-Standing Table & 4 Chairs (N/A 381, 380, 385)
- 18 CU FT 120V Residential Refrigerator w/Inverter or 18 CU FT 4-Door RV Refrigerator
- Power Vent Bath & Bedroom Fan w/ Remote Controls
- Central Vacuum System
- Single Bowl Sink in place of Double
- Dishwasher (requires single bowl sink) (N/A 380)
- Day/Night Roller Shades
- Convection Microwave

BATHROOM/BEDROOM FEATURES

- Residential One-Piece Fiberglass Shower Stall w/Built-In Seat & Glass Doors
- Shower Skylight
- XL Solid Surface Bath Vanity w/Stainless Steel Sink
- Porcelain Foot-Flush Toilet

- All LED Lights in Bed & Bath w/Multiple Switches
- Heavy-Duty 100 LB Drawer Glides on all Drawers
- Extra-Wide Bed & Bath Hallway (most models)
- Pocket Door from Hall to Bath (most models)
- Bath Towel Bar & Towel Loop (where applicable)
- 12V Fan
- XL Bath Linen Closet
- XL Deep Bedroom Walk-In Closet
- Dual Washer & Dryer Prep
- XL Under-Bed Storage
- Luxurious Bedspread & Pillow Shams
- HD Flat Panel Bedroom TV
- 72" x 80" King-Size Upgraded Mattress (now available on 382 *Attn: makes bedroom tight)
- Motion Lights – Closet & Bathroom

BATHROOM/BEDROOM OPTIONS

- 60" x 80" Queen-Size Upgraded Mattress (std. 382)
- Power Vent Fan

K-Z EZ CAMPING GOLD PACKAGE (MANDATORY)

- LP Quick Connect
- 40" Fireplace
- Decorative Slideout Ceiling Fixture
- 7" My RV One Touch Control Panel
- Under-Mount Spare Tire
- Power Awning w/LED Lights
- Keyed A-Like Baggage Doors
- Roof-Mounted Solar Prep
- Rear Towing Hitch
- Rear Camera Prep
- Decorative Barn Doors & Finished End Panels on Kitchen Islands
- Motion Sensor Lights (closet, bath, basement)
- Roller Nightshades
- Lighted Exterior Speakers
- Upgraded Electronics Package (sound bar, subwoofer, DVD player)
- 12V/USB Charging Station
- Decorative Mullion Closet Doors
- G-Rated Tires
- Ducted 2nd 15K A/C w/Quiet Cool
- Free-Standing Dinette w/2 Chairs & 2 Folding Chairs

BONUS FEATURES

- 2-Year Limited Warranty (see flyer)
- Lightest high-profile, wide body, luxury fifth wheels in the industry (average weight is 12,000 LBS)
- K-Z has received the Dealer Satisfaction Index Award for 17 years
- K-Z's 46 years of stable, dedicated manufacturing experience, coupled with its predominant Amish workforce, heritage and commitment to superb quality, allow us to produce the best value luxury fifth wheel available.

FIFTH WHEELS	G353RKT	G355RLT	G366FBT	G371RLT	G380FLF	G381REF	G382MBQ	G384RLT	G385FLF
UVW (Unloaded Vehicle Weight)*	11,090	11,200	11,470	12,730	12,580	12,700	13,330	12,250	12,860
Dry Hitch Weight*	2,130	2,350	2,240	1,820	2,250	2,200	2,120	2,530	2,320
Dry Axle Weight*	8,960	8,850	9,230	10,910	10,330	10,500	11,210	9,720	10,540
NCC (Net Carrying Capacity)	2,910	2,600	3,030	2,870	2,415	2,295	2,270	2,745	2,740
GVWR	14,000	13,800	14,500	15,600	14,995	14,995	15,600	14,995	15,600
Interior Height	76"	76"	76"	76"	76"	76"	76"	76"	76"
Exterior Height	13'	13'	12' 11"	12' 11"	13'	13'	13'	13' 3"	13' 3"
Exterior Width	101"	101"	101"	101"	101"	101"	101"	101"	101"
Exterior Length***	36' 1"	36' 1"	39' 6"	39' 9"	40' 6"	41' 2"	40' 4"	40' 4"	42' 4"
Refrigerator (cu. feet)	8	8	8	8	8	8	8	8	8
Water Heater Cap. (gal. G/E w/DSI)	12	12	12	12	12	12	12	12	12
Fresh Water Cap. (gal.) (inc. WH cap.)	67	67	67	67	67	67	67	67	67
Waste Water Cap. (gal.)	57	57	57	57	57	57	57	57	40
Gray Water Cap. (gal.)	97	97	57	97	57	97	97	97	57
1/2 Bath Cap. (gal.)	N/A	N/A	57	N/A	N/A	N/A	N/A	N/A	57**
LP Gas Cap. (lbs.)	60	60	60	60	60	60	60	60	60
Furnace BTUs (1,000s)	35	35	35	35	35	35	35	35	35
Tire Size	16"	16"	16"	16"	16"	16"	16"	16"	16"
Awning	17'	17'	18'	18'	18'	18' w/12' opt.	20'	11' w/17' opt.	18'

*This weight reflects the rolling average unit weight for each model. Your trailer weight will vary according to optional equipment. **Also includes kitchen.

*** Exterior length is measured from the center of the hitch pin to the rear bumper.

FULL TIME LUXURY

for your **HOME ON THE ROAD**



True 2-Year Limited Warranty!
K-Z's 24-month hitch-to-bumper limited warranty umbrella is the best 2-year warranty in the business, covering more than 1,500 operations codes for a full two years (approved for fulltime living), and protects your investment while you enjoy your new RV.



DSI stands for dealer satisfaction index. Our dealer body consistently rates K-Z highly, and the RV Dealer Association has awarded K-Z their top honor Quality Circle Award for excellence of design, reliability, overall quality and value, communications and dealer support. K-Z has been honored with the DSI award for more years in a row than any other towable manufacturer!



K-Z is headquartered in Shipshewana, Indiana, and was founded in 1972 on the principles of quality, fairness and integrity. Today, K-Z produces several widely-recognized brands of towables, including Durango, Sidewinder and Venom.

The first RV K-Z offered was a truck camper, and was designed, fabricated and assembled by two employees. Then 12 employees. Then we added travel

trailers. And 20 employees. Then fifth wheels. Over the years, as the product selection grew, so did the headcount. Today, the K-Z campus covers 530,000 square feet, includes over 600 employees (one of the largest employers in our area), and hosts 20 product lines that offer close to 200 floorplans.

People make a difference, and at K-Z, our employees make all the difference in the world. As you'll discover when you communicate with K-Z, you'll always be speaking with someone who takes you seriously and treats you with respect. Quality products and business integrity are a way of life at K-Z. Thank you for considering K-Z, and we'd like to welcome you to our world-wide family of satisfied customers!



K-Z proudly supports our veterans and active military. Thank you for your service!

RVIA

K-Z strongly encourages our retail customers to purchase from their local dealership whenever possible.



985 N 900 W • Shipshewana, IN 46565
E-mail kz@kz-rv.com • www.kz-rv.com

Due to continual research and advances, manufacturer reserves the right to change specifications, design, price and equipment without notice, and assumes no responsibility for any error in this literature. Some items shown are not included as standard or optional equipment.
©2017KZ | 12/22/17 | 60M

Dealer:

FULL TIME LUXURY

for your **HOME ON THE ROAD**



True 2-Year Limited Warranty!
K-Z's 24-month hitch-to-bumper limited warranty umbrella is the best 2-year warranty in the business, covering more than 1,500 operations codes for a full two years (approved for fulltime living), and protects your investment while you enjoy your new RV.



DSI stands for dealer satisfaction index. Our dealer body consistently rates K-Z highly, and the RV Dealer Association has awarded K-Z their top honor Quality Circle Award for excellence of design, reliability, overall quality and value, communications and dealer support. K-Z has been honored with the DSI award for more years in a row than any other towable manufacturer!



K-Z is headquartered in Shipshewana, Indiana, and was founded in 1972 on the principles of quality, fairness and integrity. Today, K-Z produces several widely-recognized brands of towables, including Durango, Sidewinder and Venom.

The first RV K-Z offered was a truck camper, and was designed, fabricated and assembled by two employees. Then 12 employees. Then we added travel

trailers. And 20 employees. Then fifth wheels. Over the years, as the product selection grew, so did the headcount. Today, the K-Z campus covers 530,000 square feet, includes over 600 employees (one of the largest employers in our area), and hosts 20 product lines that offer close to 200 floorplans.

People make a difference, and at K-Z, our employees make all the difference in the world. As you'll discover when you communicate with K-Z, you'll always be speaking with someone who takes you seriously and treats you with respect. Quality products and business integrity are a way of life at K-Z. Thank you for considering K-Z, and we'd like to welcome you to our world-wide family of satisfied customers!



K-Z proudly supports our veterans and active military. Thank you for your service!



K-Z strongly encourages our retail customers to purchase from their local dealership whenever possible.



985 N 900 W • Shipshewana, IN 46565
E-mail kz@kz-rv.com • www.kz-rv.com

Due to continual research and advances, manufacturer reserves the right to change specifications, design, price and equipment without notice, and assumes no responsibility for any error in this literature. Some items shown are not included as standard or optional equipment.
©2017KZ | 12/22/17 | 60M

Dealer: