

SIDEWINDER[®]



SIDEWINDER FIFTH WHEEL TOY HAULERS



SIDEWINDER[®]



SIDEWINDER FIFTH WHEEL TOY HAULERS



SIDEWINDER®

Sidewinder makes the good times even better with its wide body design and open interior spaces to bring the toys and family along. Flexible floorplans are packed with inventive, easy-living features like fully functional stainless steel kitchens and quality residential furnishings throughout, plus abundant storage. Add the All-Weather Insulation Package and extend the season of fun.

3914TK | Nighthawk décor



Standard Exterior Steps Lightweight, rustproof aluminum, with strong steel linkages and frame.



Under-Mount Spare Out of the way, easy crank-down.

SIDEWINDER®

Sidewinder makes the good times even better with its wide body design and open interior spaces to bring the toys and family along. Flexible floorplans are packed with inventive, easy-living features like fully functional stainless steel kitchens and quality residential furnishings throughout, plus abundant storage. Add the All-Weather Insulation Package and extend the season of fun.

3914TK | Nighthawk décor



Standard Exterior Steps Lightweight, rustproof aluminum, with strong steel linkages and frame.



Under-Mount Spare Out of the way, easy crank-down.



3914TK | Nighthawk décor



3914TK | Nighthawk décor



50 AMP Service
Satisfies all your electrical needs.



Key-Alike Locks
Increased security and ease of use.



LP Quick-Connect
Allows for additional LP appliances.



Industry's first self-contained, lightweight and adjustable ground-stable step that provides secure footing (optional).



3914TK | Nighthawk décor



3914TK | Nighthawk décor



50 AMP Service
Satisfies all your electrical needs.



Key-Alike Locks
Increased security and ease of use.



LP Quick-Connect
Allows for additional LP appliances.



Industry's first self-contained, lightweight and adjustable ground-stable step that provides secure footing (optional).

SIDEWINDER[®]

An extra wide hallway leads to the master bedroom and bath which includes large wardrobes, linen closet, and added vanity space along with a glass enclosed residential size shower. In the cargo area, choose the three-season patio door and deck to create enjoyable outdoor living space.



all images | 3517DK | Nighthawk décor



Rear Observation Camera Prep
Optional backup camera increases ease and safety while backing.



SIDEWINDER®

An extra wide hallway leads to the master bedroom and bath which includes large wardrobes, linen closet, and added vanity space along with a glass enclosed residential size shower. In the cargo area, choose the three-season patio door and deck to create enjoyable outdoor living space.



all images | 3517DK | Nighthawk décor



Rear Observation Camera Prep
Optional backup camera increases ease and safety while backing.





Optional on all Sidewinder, the all-weather insulation package includes upgrades to roof, floor, ceiling, endcaps and tanks to R-38, allowing you to enjoy your fifth wheel all year long.



Off The Grid solar package with 160W solar panel offers the freedom to unplug while you're away (optional).



Sidewinder comes standard with 3" x 14" foam-core in-floor straight-line heating system with 35,000 BTU furnace and 15,000 BTU ducted roof air conditioner.



My RV gives you command of your fifth wheel from one location, with the touch of your finger. This allows you to control the awning, landing gear, and slideouts, as well as access to troubleshooting videos and your owners manual.



Exterior Battery Disconnect A turn of the knob keeps your battery from discharging.



Outside Speakers



Heated Water Convenience Center Includes black tank flush, fresh water fill, winterizing system and outside shower.



Portions of this brochure were used with the expressed authority of Dexter Axle, but Dexter Axle is not responsible for the accuracy of the information contained herein.



Optional on all Sidewinder, the all-weather insulation package includes upgrades to roof, floor, ceiling, endcaps and tanks to R-38, allowing you to enjoy your fifth wheel all year long.



Off The Grid solar package with 160W solar panel offers the freedom to unplug while you're away (optional).



Sidewinder comes standard with 3" x 14" foam-core in-floor straight-line heating system with 35,000 BTU furnace and 15,000 BTU ducted roof air conditioner.



My RV gives you command of your fifth wheel from one location, with the touch of your finger. This allows you to control the awning, landing gear, and slideouts, as well as access to troubleshooting videos and your owners manual.



Exterior Battery Disconnect A turn of the knob keeps your battery from discharging.



Outside Speakers



Heated Water Convenience Center Includes black tank flush, fresh water fill, winterizing system and outside shower.



Portions of this brochure were used with the expressed authority of Dexter Axle, but Dexter Axle is not responsible for the accuracy of the information contained herein.

SIDEWINDER FIFTH WHEEL TOY HAULERS

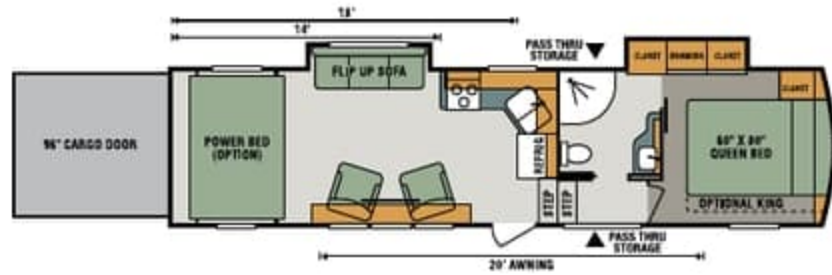

3214DK

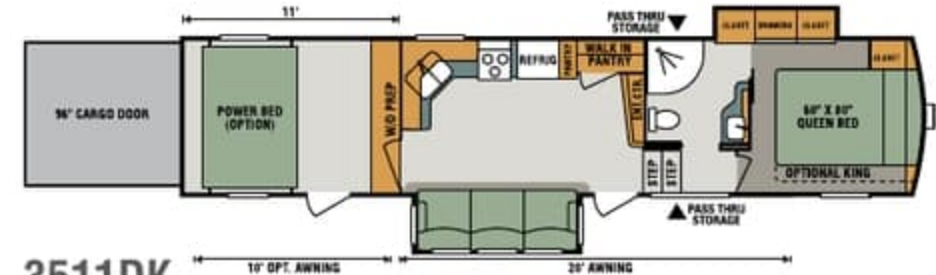

3511DK

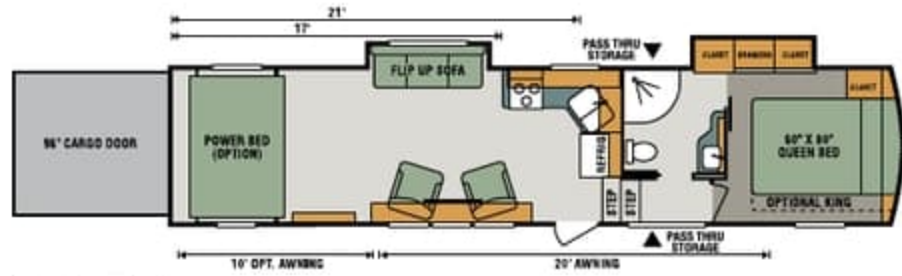

3517DK



3610DK

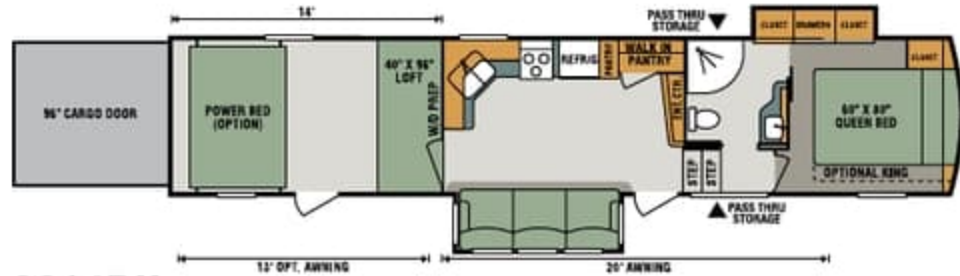

3814DK

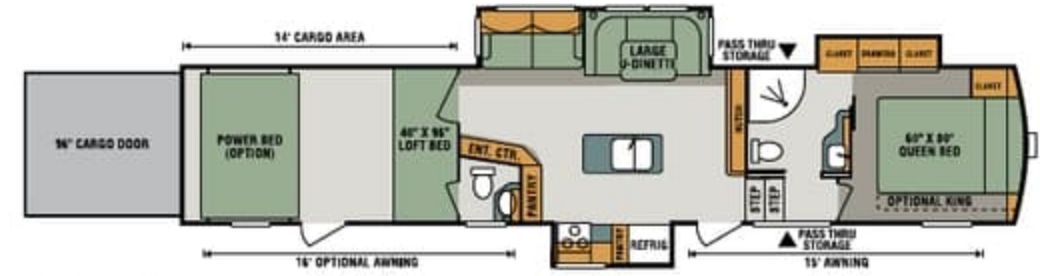

3914TK

FIFTH WHEEL TOY HAULERS	3214DK	3511DK	3517DK	3610DK	3814DK	3914TK
UVW (Unloaded Vehicle Weight)*	10,470	11,370	10,780	11,640	12,430	13,500
Dry Hitch Weight*	2,780	2,390	2,640	2,430	2,620	2,600
Dry Axle Weight*	7,690	8,980	8,140	9,210	9,810	10,900
NCC (Net Carrying Capacity)	4,525	3,625	4,215	3,355	4,570	3,500
GVWR	14,995	14,995	14,995	14,995	17,000	17,000
Interior Height	102"	102"	102"	102"	102"	102"
Exterior Height	13' 4"	13' 4"	13' 4"	13' 4"	13' 4"	13' 4"
Exterior Width	101"	101"	101"	101"	101"	101"
Exterior Length**	34' 11"	38' 4"	37' 11"	38' 11"	41' 4"	46' 6"
Refrigerator (cu. feet)	8	8	8	8	8	8
Water Heater Cap. (gal. G/E w/DSI)	12	12	12	12	12	12
Fresh Water Cap. (gal.) (inc. water heater cap.)	116	116	116	116	116	116
Waste Water Cap. (gal.)	57	57	57	57	57	57
Gray Water Cap. (gal.)	57	97	57	57	57	57
1/2 Bath Cap. (gal.)	N/A	N/A	N/A	N/A	N/A	40
LP Gas Cap. (lbs.)	60	60	60	60	60	60
Furnace BTUs (1,000s)	35	35	35	35	35	35
Tire Size	16"	16"	16"	16"	16"	16"
Awning	20'	20'	20'	18'	20'	15'
Optional 2nd Awning	N/A	10'	10'	16'	13'	16'

*This weight reflects the rolling average unit weight for each model. Your trailer weight will vary according to optional equipment.

**Exterior length is measured from the center of the hitch pin to the bumper



SIDEWINDER FIFTH WHEEL TOY HAULERS

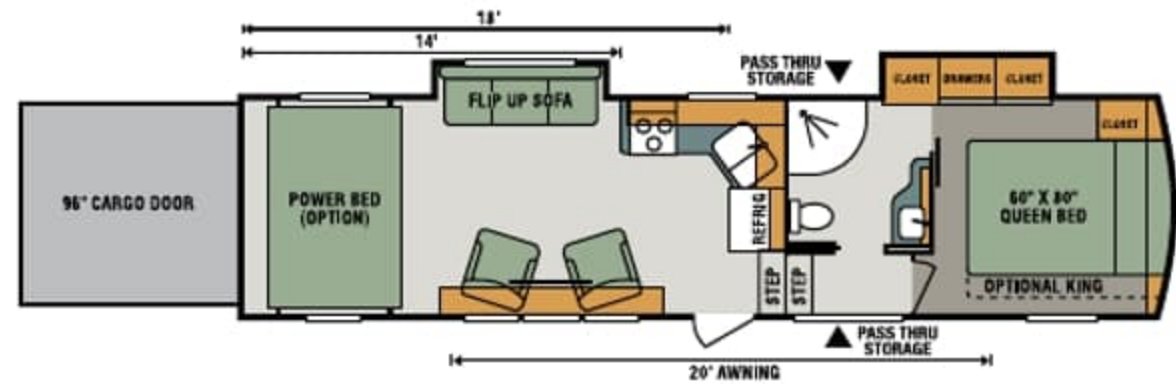

3214DK

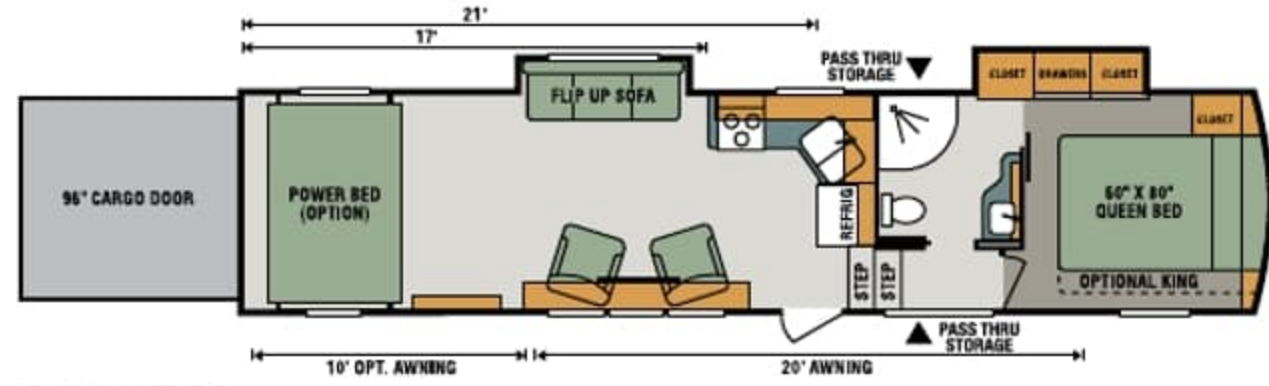

3517DK

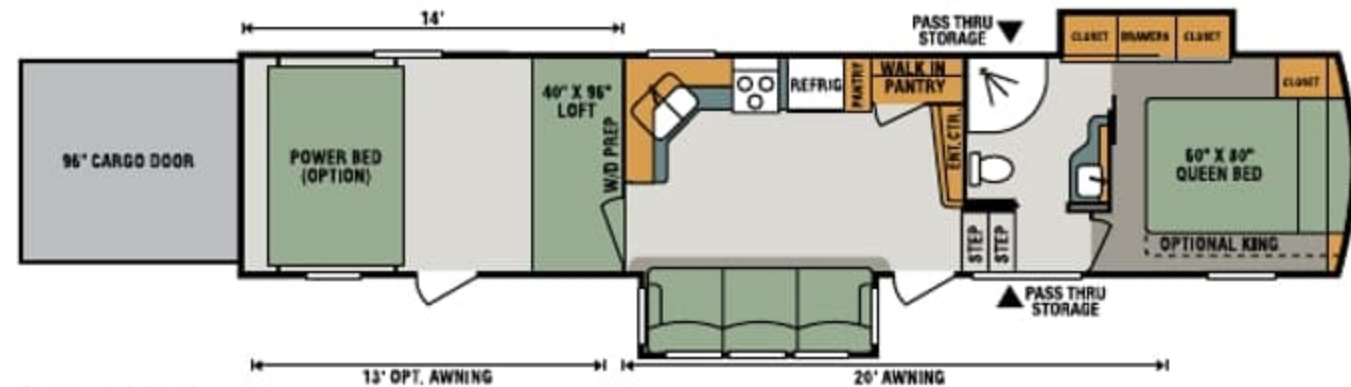

3814DK

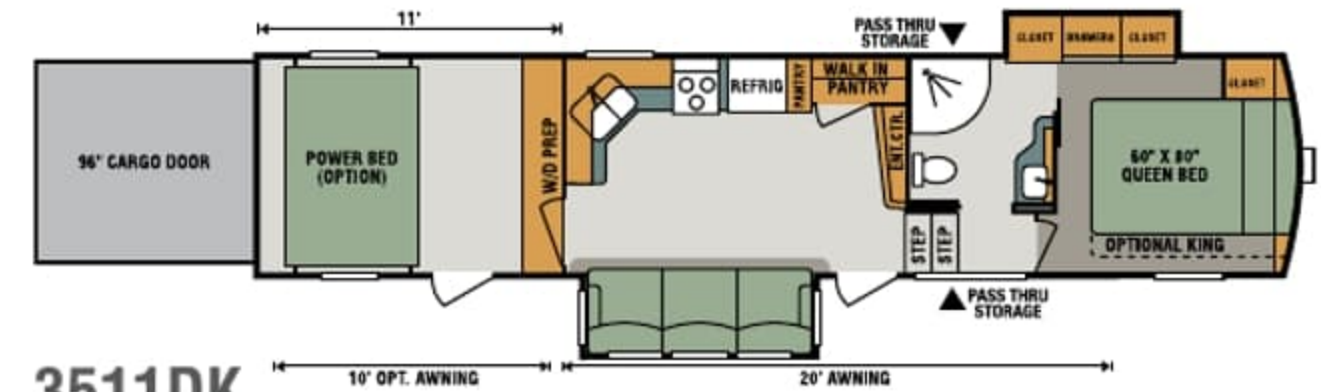

3511DK

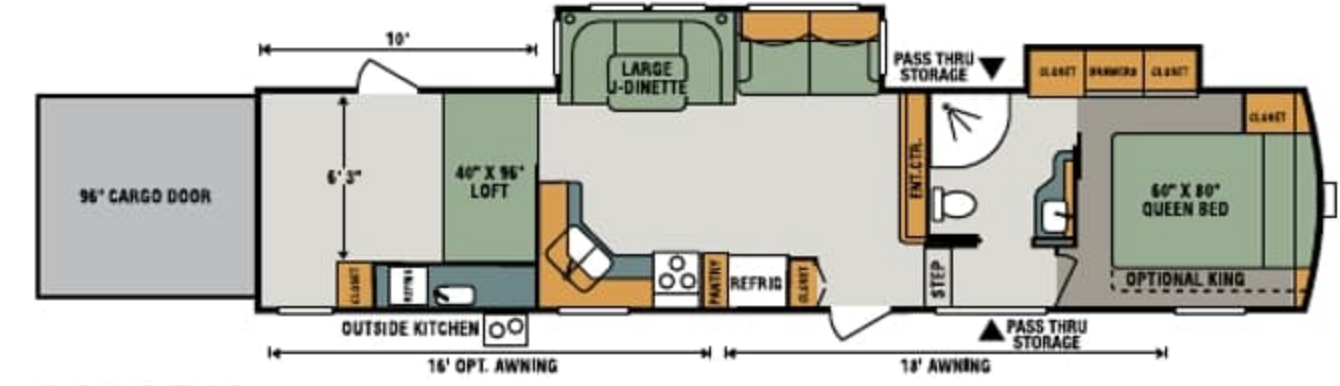

3610DK

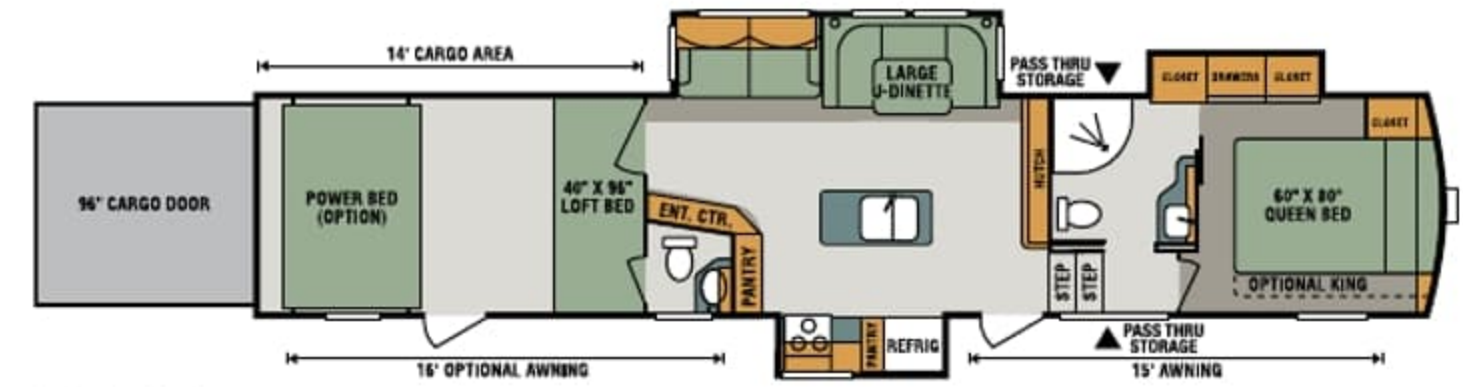

3914TK



FIFTH WHEEL TOY HAULERS

	3214DK	3511DK	3517DK	3610DK	3814DK	3914TK
UVW (Unloaded Vehicle Weight)*	10,470	11,370	10,780	11,640	12,430	13,500
Dry Hitch Weight*	2,780	2,390	2,640	2,430	2,620	2,600
Dry Axle Weight*	7,690	8,980	8,140	9,210	9,810	10,900
NCC (Net Carrying Capacity)	4,525	3,625	4,215	3,355	4,570	3,500
GVWR	14,995	14,995	14,995	14,995	17,000	17,000
Interior Height	102"	102"	102"	102"	102"	102"
Exterior Height	13' 4"	13' 4"	13' 4"	13' 4"	13' 4"	13' 4"
Exterior Width	101"	101"	101"	101"	101"	101"
Exterior Length**	34' 11"	38' 4"	37' 11"	38' 11"	41' 4"	46' 6"
Refrigerator (cu. feet)	8	8	8	8	8	8
Water Heater Cap. (gal. G/E w/DSI)	12	12	12	12	12	12
Fresh Water Cap. (gal.) (inc. water heater cap.)	116	116	116	116	116	116
Waste Water Cap. (gal.)	57	57	57	57	57	57
Gray Water Cap. (gal.)	57	97	57	57	57	57
1/2 Bath Cap. (gal.)	N/A	N/A	N/A	N/A	N/A	40
LP Gas Cap. (lbs.)	60	60	60	60	60	60
Furnace BTUs (1,000s)	35	35	35	35	35	35
Tire Size	16"	16"	16"	16"	16"	16"
Awning	20'	20'	20'	18'	20'	15'
Optional 2nd Awning	N/A	10'	10'	16'	13'	16'

*This weight reflects the rolling average unit weight for each model. Your trailer weight will vary according to optional equipment.

**Exterior length is measured from the center of the hitch pin to the bumper

CONSTRUCTION FEATURES

- 101" Wide-Body Construction
- Extra-Reinforced, Heavy Duty, High-Gloss Front Cap
- Radius Aerodynamic Front Cap (provides better turning radius & increased fuel economy)
- 2" x 3" Fully Welded Aluminum Floor Joists
- 2" x 2" Fully Welded Aluminum Sidewall Framing
- Lamilux® 4000 High-Gloss Fiberglass
- Double-Insulated & Heated Holding Tanks (R-38 above & below tanks)
- R-11 2" Sidewalls (w/EGS metal backing strips to hold up all interior cabinets)
- Superflex® Roof Membrane w/12-Year Limited Warranty (a hybrid between TPO & rubber)
- Fully Vented Attic System
- 3/8" Roof Decking (fully walkable)
- 5/8" Tongue & Groove, Screwed & Glued Plywood Floor Deck
- Pex® In-Floor Heated Waterlines & Kitchen Gray Pipes (all waterlines & drains are located above all insulation)
- Fully-Enclosed & Heated Underbelly w/Directly Heated Holding Tanks

CONSTRUCTION OPTIONS

- All-Weather Insulation PKG (roof, floor, ceiling, garage floor, end caps & tanks to R-38)
- 6-Point Electric Leveling (includes MyRV System)
- Power Rear Stabilizer Jacks

EXTERIOR FEATURES

- 7,000# Dexter® Axles w/Auto-Adjusting Brakes
- 8-Lug Heavy-Duty Aluminum Rims w/16" G-Range Nitro-Filled Radial Tires
- EZ Flex® Rubberized Suspension
- 4-Step Aluminum Entry Step
- 100% Exterior LED Running Lights, Taillights & Backup Lights
- Electric Power Awning w/LED Lights
- Propane Bottles (2 x 30 lbs.) on Same Side of Coach for Easy Access

- Side Slam Latch Baggage Doors (where applicable) w/Magnet Catches for Full Access to Storage
- 50A Service w/Detachable Marine Power Cord
- 15,000 BTU Ducted Roof A/C
- 3" x 14" In-Floor Straight Line Heating System w/35,000 BTU Furnace
- 12 GAL Gas/Electric Hot Water Heater
- Ramp Door LED Lighting
- LED Docking Light & Sewer Hookup Light
- Dual Swing-Away Assist Grab Handle
- Underneath Spare Tire w/Hoist
- Roof Ladder
- Heated Water Convenience Center (includes black tank flush, power fresh tank water fill, winterizing system, outside shower)
- Fully-Finished, Heated & Sealed Basement Storage Compartment (only available w/All-Weather Insulation Pkg)
- Heated & Enclosed Dump Valves
- Battery Disconnect
- Satellite Pre-Wire in Both the Convenience Center & Roof
- LED Lighted Outside Speakers
- Generator Prep
- 30 GAL Fuel Station w/Electric Pump
- Solar Prep – Roof
- LP Quick Connect
- Rear Camera Prep
- Keyed Alike Baggage Doors

EXTERIOR OPTIONS

- Roto-Flex® Upgraded Hitch Pin
- 2nd 15,000 BTU Air Conditioner
- 2nd Lighted Patio Awning (N/A on 3214DK)
- Onan® 5500 Gas Generator
- Dual-Pane Windows
- Slideout Cover PKG
- Rear Observation Camera
- "Off the Grid" PKG (includes 160W solar panel, inverter & monitor panel)
- Toy Lock
- MORryde Flip-Out Steps (main entrance only)

LIVING ROOM/KITCHEN FEATURES

- Solid-Surface Countertops
- Large residential Double-Bowl Stainless Steel Sink
- Pull-Out Sprayer Faucet
- Built-In Silverware Drawer
- Storage Shelf under Kitchen Sink
- All Kitchen OH Cabinets have Shelf & Extra-Tall Slide Lips
- Heavy-Duty 100# Drawer Glides on Every Drawer
- Baltic Birch Drawer Boxes
- Decorative Lighting above Many Cabinets
- Window in Kitchen (in most models)
- 5" Stainless Steel Cabinet Hardware
- Window Shades Throughout
- 3/8" Re-Bond Carpet Pad w/22 OZ Residential Carpet
- Stainless Steel Appliances
- Extra-Large Light Switches
- Faux Leather Vinyl Soft-Touch Ceiling
- Ceiling Crown Molding
- 100% LED Ceiling & Cabinet Lights w/Multiple On/Off Switches
- Deluxe Residential-Style Furniture
- Living Room HD Flat Panel TV on Bracket (includes exterior mount)
- 30" OTR Microwave

LIVING ROOM/KITCHEN OPTIONS

- Solid-Surface Matching Sink Covers
- Power Vent Fan (location varies)
- 12/14 CU FT Refrigerator Upgrade (floorplan specific)
- Folding Table

GARAGE/RAMP AREA FEATURES

- Pull-Down Screen Wall
- Multiple D-Rings to Tie Down Cargo
- Built-in Dovetail
- Garage Entry Door (model specific)
- (2) Garage Ceiling Speakers

- Outside Garage Speaker Switches

GARAGE/RAMP AREA OPTIONS

- 3-Season Patio Door IPO Screen Wall
- Removable, Edged Carpet Kit (10' x 8')
- Happijac® Electric Bed & Rollover Sofas w/Table
- Ramp Door Patio Rails

BATHROOM/BEDROOM FEATURES

- Large Radius Shower w/Glass Door Enclosure
- Skylight Over Shower
- Porcelain Foot-Flush Toilet
- Extra-Wide Hall (going up into bedroom & pocket door from hall into the bathroom – most models)
- Towel Bar in Bathroom (where applicable)
- 12V Fan in Bathroom
- Extra-Large Under-Bed Storage
- Luxurious Bedspread & Pillow Shams
- Padded Headboard w/Hidden Storage
- Motion Light Bathroom

BATHROOM/BEDROOM OPTIONS

- HD Flat Panel TV – Bedroom
- King-Size Bed Upgrade
- Upgraded Mattress

BONUS FEATURES

- 2-year Limited Warranty (see flyer)
- One of the lightest weight high profile, wide body, luxury Toy Hauler fifth wheels in the industry
- KZ RV has won the coveted DSI award 17 years.
- KZ RV's 46 years of building experience, coupled with its stable and dedicated Amish workforce and commitment to superb quality and low overhead, allows us to produce the lowest-priced fully featured fifth wheel available.

CONSTRUCTION FEATURES

- 101" Wide-Body Construction
- Extra-Reinforced, Heavy Duty, High-Gloss Front Cap
- Radius Aerodynamic Front Cap (provides better turning radius & increased fuel economy)
- 2" x 3" Fully Welded Aluminum Floor Joists
- 2" x 2" Fully Welded Aluminum Sidewall Framing
- Lamilux® 4000 High-Gloss Fiberglass
- Double-Insulated & Heated Holding Tanks (R-38 above & below tanks)
- R-11 2" Sidewalls (w/EGS metal backing strips to hold up all interior cabinets)
- Superflex® Roof Membrane w/12-Year Limited Warranty (a hybrid between TPO & rubber)
- Fully Vented Attic System
- 3/8" Roof Decking (fully walkable)
- 5/8" Tongue & Groove, Screwed & Glued Plywood Floor Deck
- Pex® In-Floor Heated Waterlines & Kitchen Gray Pipes (all waterlines & drains are located above all insulation)
- Fully-Enclosed & Heated Underbelly w/Directly Heated Holding Tanks

CONSTRUCTION OPTIONS

- All-Weather Insulation PKG (roof, floor, ceiling, garage floor, end caps & tanks to R-38)
- 6-Point Electric Leveling (includes MyRV System)
- Power Rear Stabilizer Jacks

EXTERIOR FEATURES

- 7,000# Dexter® Axles w/Auto-Adjusting Brakes
- 8-Lug Heavy-Duty Aluminum Rims w/16" G-Range Nitro-Filled Radial Tires
- EZ Flex® Rubberized Suspension
- 4-Step Aluminum Entry Step
- 100% Exterior LED Running Lights, Taillights & Backup Lights
- Electric Power Awning w/LED Lights
- Propane Bottles (2 x 30 lbs.) on Same Side of Coach for Easy Access

- Side Slam Latch Baggage Doors (where applicable) w/Magnet Catches for Full Access to Storage
- 50A Service w/Detachable Marine Power Cord
- 15,000 BTU Ducted Roof A/C
- 3" x 14" In-Floor Straight Line Heating System w/35,000 BTU Furnace
- 12 GAL Gas/Electric Hot Water Heater
- Ramp Door LED Lighting
- LED Docking Light & Sewer Hookup Light
- Dual Swing-Away Assist Grab Handle
- Underneath Spare Tire w/Hoist
- Roof Ladder
- Heated Water Convenience Center (includes black tank flush, power fresh tank water fill, winterizing system, outside shower)
- Fully-Finished, Heated & Sealed Basement Storage Compartment (only available w/All-Weather Insulation Pkg)
- Heated & Enclosed Dump Valves
- Battery Disconnect
- Satellite Pre-Wire in Both the Convenience Center & Roof
- LED Lighted Outside Speakers
- Generator Prep
- 30 GAL Fuel Station w/Electric Pump
- Solar Prep – Roof
- LP Quick Connect
- Rear Camera Prep
- Keyed Alike Baggage Doors

EXTERIOR OPTIONS

- Roto-Flex® Upgraded Hitch Pin
- 2nd 15,000 BTU Air Conditioner
- 2nd Lighted Patio Awning (N/A on 3214DK)
- Onan® 5500 Gas Generator
- Dual-Pane Windows
- Slideout Cover PKG
- Rear Observation Camera
- "Off the Grid" PKG (includes 160W solar panel, inverter & monitor panel)
- Toy Lock
- MORryde Flip-Out Steps (main entrance only)

LIVING ROOM/KITCHEN FEATURES

- Solid-Surface Countertops
- Large residential Double-Bowl Stainless Steel Sink
- Pull-Out Sprayer Faucet
- Built-In Silverware Drawer
- Storage Shelf under Kitchen Sink
- All Kitchen OH Cabinets have Shelf & Extra-Tall Slide Lips
- Heavy-Duty 100# Drawer Glides on Every Drawer
- Baltic Birch Drawer Boxes
- Decorative Lighting above Many Cabinets
- Window in Kitchen (in most models)
- 5" Stainless Steel Cabinet Hardware
- Window Shades Throughout
- 3/8" Re-Bond Carpet Pad w/22 OZ Residential Carpet
- Stainless Steel Appliances
- Extra-Large Light Switches
- Faux Leather Vinyl Soft-Touch Ceiling
- Ceiling Crown Molding
- 100% LED Ceiling & Cabinet Lights w/Multiple On/Off Switches
- Deluxe Residential-Style Furniture
- Living Room HD Flat Panel TV on Bracket (includes exterior mount)
- 30" OTR Microwave

LIVING ROOM/KITCHEN OPTIONS

- Solid-Surface Matching Sink Covers
- Power Vent Fan (location varies)
- 12/14 CU FT Refrigerator Upgrade (floorplan specific)
- Folding Table

GARAGE/RAMP AREA FEATURES

- Pull-Down Screen Wall
- Multiple D-Rings to Tie Down Cargo
- Built-in Dovetail
- Garage Entry Door (model specific)
- (2) Garage Ceiling Speakers

- Outside Garage Speaker Switches

GARAGE/RAMP AREA OPTIONS

- 3-Season Patio Door IPO Screen Wall
- Removable, Edged Carpet Kit (10' x 8')
- Happijac® Electric Bed & Rollover Sofas w/Table
- Ramp Door Patio Rails

BATHROOM/BEDROOM FEATURES

- Large Radius Shower w/Glass Door Enclosure
- Skylight Over Shower
- Porcelain Foot-Flush Toilet
- Extra-Wide Hall (going up into bedroom & pocket door from hall into the bathroom – most models)
- Towel Bar in Bathroom (where applicable)
- 12V Fan in Bathroom
- Extra-Large Under-Bed Storage
- Luxurious Bedspread & Pillow Shams
- Padded Headboard w/Hidden Storage
- Motion Light Bathroom

BATHROOM/BEDROOM OPTIONS

- HD Flat Panel TV – Bedroom
- King-Size Bed Upgrade
- Upgraded Mattress

BONUS FEATURES

- 2-year Limited Warranty (see flyer)
- One of the lightest weight high profile, wide body, luxury Toy Hauler fifth wheels in the industry
- KZ RV has won the coveted DSI award 17 years.
- KZ RV's 46 years of building experience, coupled with its stable and dedicated Amish workforce and commitment to superb quality and low overhead, allows us to produce the lowest-priced fully featured fifth wheel available.

SIDEWINDER

LUXURY FEATURES for your toy-hauling ADVENTURES



True 2-Year Limited Warranty!
K-Z's 24-month hitch-to-bumper limited warranty umbrella is the best 2-year warranty in the business, covering more than 1,500 operations codes for a full two years (approved for fulltime living), and protects your investment while you enjoy your new RV.



K-Z proudly supports our veterans and active military. Thank you for your service!



K-Z is headquartered in Shipshewana, Indiana, and was founded in 1972 on the principles of quality, fairness and integrity. Today, K-Z produces several widely-recognized brands of towables, including Durango, Sidewinder and Venom.

The first RV K-Z offered was a truck camper, and was designed, fabricated and assembled by two employees. Then 12 employees. Then we added travel

trailers. And 20 employees. Then fifth wheels. Over the years, as the product selection grew, so did the headcount. Today, the K-Z campus covers 530,000 square feet, includes over 600 employees (one of the largest employers in our area), and hosts 20 product lines that offer close to 200 floorplans.

People make a difference, and at K-Z, our employees make all the difference in the world. As you'll discover when you communicate with K-Z, you'll always be speaking with someone who takes you seriously and treats you with respect. Quality products and business integrity are a way of life at K-Z. Thank you for considering K-Z, and we'd like to welcome you to our world-wide family of satisfied customers!

RVIA

K-Z strongly encourages our retail customers to purchase from their local dealership whenever possible.



985 N 900 W • Shipshewana, IN 46565
E-mail kz@kz-rv.com • www.kz-rv.com

Due to continual research and advances, manufacturer reserves the right to change specifications, design, price and equipment without notice, and assumes no responsibility for any error in this literature. Some items shown are not included as standard or optional equipment.

©2018KZ | 01/03/18 | 60M

Dealer:

SIDEWINDER®

LUXURY FEATURES for your toy-hauling ADVENTURES



True 2-Year Limited Warranty!
K-Z's 24-month hitch-to-bumper limited warranty umbrella is the best 2-year warranty in the business, covering more than 1,500 operations codes for a full two years (approved for fulltime living), and protects your investment while you enjoy your new RV.



K-Z proudly supports our veterans and active military. Thank you for your service!



K-Z is headquartered in Shipshewana, Indiana, and was founded in 1972 on the principles of quality, fairness and integrity. Today, K-Z produces several widely-recognized brands of towables, including Durango, Sidewinder and Venom.

The first RV K-Z offered was a truck camper, and was designed, fabricated and assembled by two employees. Then 12 employees. Then we added travel

trailers. And 20 employees. Then fifth wheels. Over the years, as the product selection grew, so did the headcount. Today, the K-Z campus covers 530,000 square feet, includes over 600 employees (one of the largest employers in our area), and hosts 20 product lines that offer close to 200 floorplans.

People make a difference, and at K-Z, our employees make all the difference in the world. As you'll discover when you communicate with K-Z, you'll always be speaking with someone who takes you seriously and treats you with respect. Quality products and business integrity are a way of life at K-Z. Thank you for considering K-Z, and we'd like to welcome you to our world-wide family of satisfied customers!

RVIA

K-Z strongly encourages our retail customers to purchase from their local dealership whenever possible.



985 N 900 W • Shipshewana, IN 46565
E-mail kz@kz-rv.com • www.kz-rv.com

Due to continual research and advances, manufacturer reserves the right to change specifications, design, price and equipment without notice, and assumes no responsibility for any error in this literature. Some items shown are not included as standard or optional equipment.
©2018KZ | 01/03/18 | 60M

Dealer: