

CATALINA

TRAILBLAZER



Coachmen
Leader to the Great Outdoors.

29THS



Who would have thought taking your adventures to the next level would be so easy, and look so good! Without question, the Trail Blazer line-up from Coachmen Catalina provides the most affordable, versatile, and best looking toy haulers designed for any outdoor enthusiast. A huge selection of features, spread across three different lengths, weights, and price points create endless possibilities for your camping needs!

MOCHA DECOR





OPTIONAL PATIO KIT

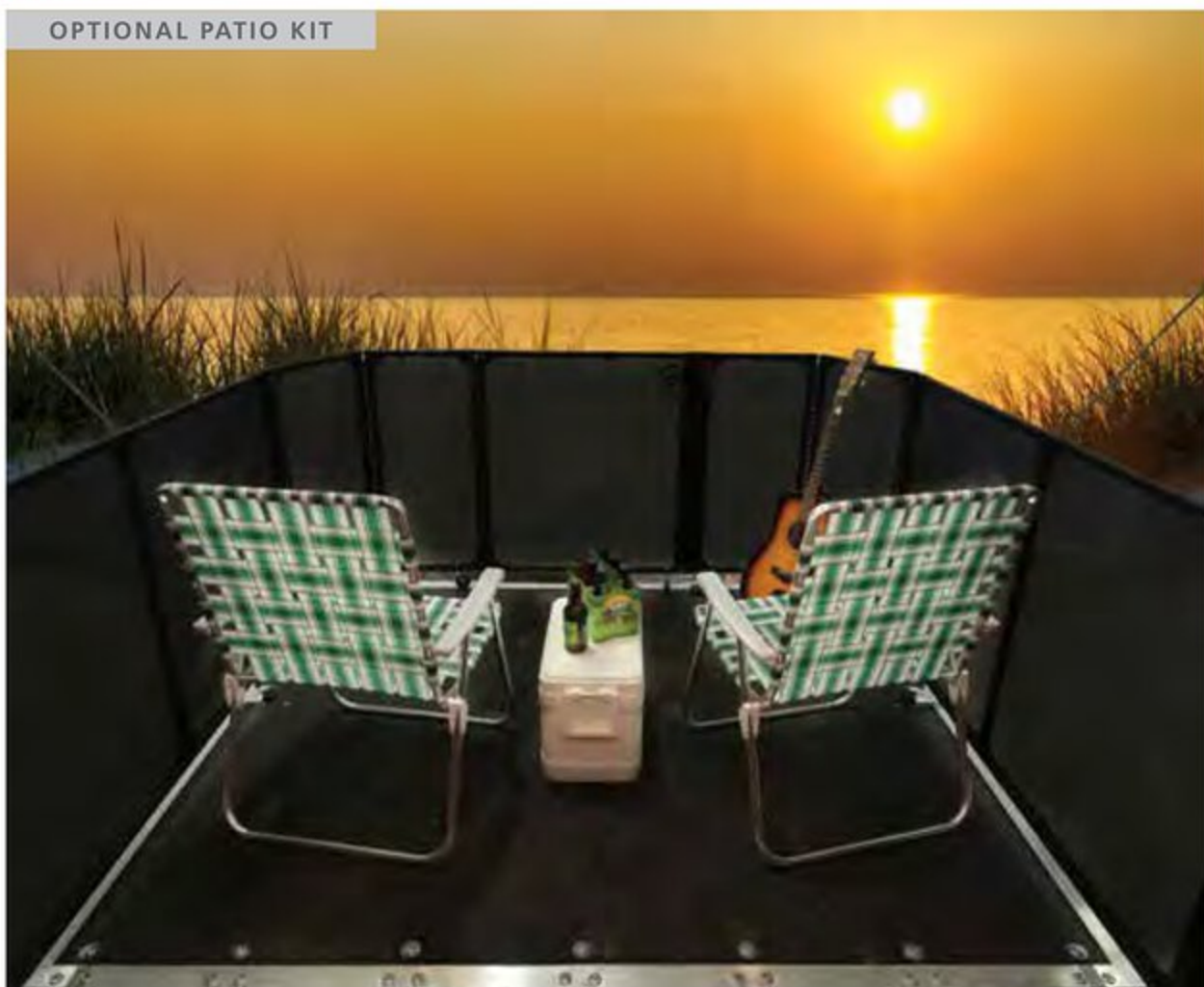

26TH

Who would have thought taking your adventures to the next level would be so easy, and look so good! Without question, the Trail Blazer line-up from Coachmen Catalina provides the most affordable, versatile, and best looking toy haulers designed for any outdoor enthusiast. A huge selection of features, spread across three different lengths, weights, and price points create endless possibilities for your camping needs!

BISCOTTI DECOR



NEW FACTORY SPECIAL 2019

FREE!

PREMIUM EXTERIOR PACKAGE

- Enclosed Underbelly
- Power Tongue Jack
- Black Tank Flush
- Hot/Cold Outside Shower
- XL Grab Handle at Main Entrance
- Aluminum Fender Skirts
- E-Coat Sport Style Wheel Package
- Exterior TV Hookups
- Back-Up Camera Prep

RETAIL VALUE \$1,115



FREE!

TRAILBLAZER VALUE PACKAGE



- Skylight above Tub/Shower
- LED Interior Lighting
- Front Diamond Plate
- Gas/Electric DSI Water Heater
- Quilted Designer Comforter
- ABS Shower/Tub Surround
- 5/8" Tongue and Groove Plywood Flooring
- All-In-One Monitor System

RETAIL VALUE \$425

FREE!

DESIGNER KITCHEN PACKAGE



- Residential Pull Down Faucet, Waterfall Edge Thermofoil Countertops
- Deep Basin Undermount 50/50 Sink
- Reversible Refer Inserts
- Furrion Range Oven w/ Blue LED Accent Lighting and Flush Mounted Glass Top
- Styled Mosaic Tile Backsplash

RETAIL VALUE \$515

FREE!

HOME ENTERTAINMENT PACKAGE



- 32" Sansui Flat Screen Living Room TV
- Swing Arm TV Bracket
- Furrion DVD/mp3/FM Stereo w/ Bluetooth and USB Charging Port
- Upgraded In-Wall Speaker System

RETAIL VALUE \$665

FREE!

STARLIGHT SYSTEM PACKAGE



- Power Awning w/ Blue LED Light
- Outdoor Speakers with Blue LED Lights
- Blue LED Underbody Lighting Door-Side

RETAIL VALUE \$480

EXTREME ADVENTURE PACKAGE

FREE!



- Rear Loading Cargo Door w/ 3000lb Capacity
- Drive On Steel Reinforced Interior Wheel Wells
- 500lb. Tie-Downs (10 to 12 per Floor Plan)
- 15 ft. ToyLok Steel Cable
- Black-Out Screen Wall w/ Zip Walk-Thru

RETAIL VALUE \$960

STANDARDS + OPTIONS

CONSTRUCTION AND EQUIPMENT FEATURES

CAMBERED STRUCTURAL STEEL I-BEAM FRAME	S
FULL LENGTH FRAME OUT RIGGERS	S
ENCLOSED UNDERBELLY	P
3/8" FULLY DECKED WALK-ON ROOF	S
SEAMLESS ROOF MEMBRANE WITH 12 YEAR WARRANTY	S
2"X3" FLOOR JOISTS ON APPROXIMATELY 12" CENTERS	S
5/8" TONGUE & GROOVE PLYWOOD FLOOR DECKING	P
81" CEILING HEIGHT	S
EASY-TRAC RACK AND PINION SLIDE-OUT (29THS)	S
R-7 FIBERGLASS INSULATION THROUGHOUT	S
GAS/ELECTRIC DSI WATER HEATER	P
WATER HEATER BYPASS WINTERIZATION KIT	S
30,000 BTU AUTO IGNITION FURNACE W/WALL THERMOSTAT	S
12V DEMAND WATER PUMP	P
PLATINUM .024" ALUMINUM EXTERIOR SKIN W/.030 SKIRT METAL	S
DEXTER EZ LUBE AXLES W/LEAF SPRING SUSPENSION	S
SELF ADJUSTING BRAKES	S
ROTOCAST HOLDING TANKS	S
30 AMP ELECTRICAL SERVICE W/ 100V 45 AMP POWER CONVERTER	S

EXTERIOR FEATURES

POWER TONGUE JACK	P
TWO 20LB. LP BOTTLES W/ ABS COVER	S
FLUSH MOUNT BAGGAGE DOORS W/RADIUS CORNERS	S
SMOOTH METAL RADIUS FRONT	S
DIAMOND PLATE ROCK GUARD	P
BLUE LED UNDERBODY LIGHTING ON THE DOOR SIDE	P
FOUR STABILIZER JACKS	S
G20 TINTED WINDOWS	S
POWER AWNING W/LED LIGHTING	P
TWO MARINE GRADE EXTERIOR SPEAKERS W/LED LIGHTING	P
RADIUS CORNERED FIBERGLASS ENTRY DOOR	S
ENTRY DOOR SAFETY WINDOW	S
ALUMINUM FENDER SKIRTS	P
E-COAT SPORT STYLE WHEELS	P
EXTERIOR 110V G.F.C.I PROTECTED RECEPTACLE	P
EXTERIOR RG-6 COAX CABLING AND SATELLITE PREP	P
RAIN GUTTERS WITH DRIP SPOUTS	S
RADIUS ENTRY STEPS	S

EXTERIOR FEATURES (CONTINUED)

XL SWING ARM GRAB HANDLE	P
OUTSIDE SHOWER W/HANDLE HOLD	P
BLACK TANK FLUSH	P
REAR VIEW CAMERA PREP	P
15' TOY LOC CABLE	P
LOCKABLE RAMP DOOR LATCHES	S
REAR LED LOADING LIGHTS	S

INTERIOR FEATURES

DROP EDGE THERMOFOIL SEAMLESS COUNTER TOPS	P
SCREWED CABINET CONSTRUCTION W/POCKET BORED LUMBER CORE STILES	S
CONGOLEUM WOODPLANK LINOLEUM FLOORING	S
SALVAGED LIGHT OAK CABINETS	S
ALL-IN-ONE MONITOR PANEL	P
BLUETOOTH STEREO AND DVD PLAYER W/CD,MP3, USB AND AM/FM RADIO	P
32" FLATSCREEN TV MOUNTED ON SWING ARM TV BRACKET	P
IN-WALL MOUNTED INTERIOR SPEAKERS	P
DEEP UNDERMOUNT DUAL BASIN 50/50 SINK	P
RESIDENTIAL PULL DOWN SPRAYER FAUCET	P
FULL LENGTH BALL-BEARING KITCHEN DRAWER GUIDES	S
3 BURNER RANGE W/FLUSH MOUNT GLASS TOP	P
OVEN WITH BLUE LED ACCENT LIGHTING	P
RANGE HOOD	S
SILVERWARE KITCHEN DRAWER	S
MOSAIC TILE BACKSPLASH	P
MICROWAVE	S
7 CU. FT. GAS/ELECTRIC RV REFRIGERATOR	S
REVERSIBLE REFER FRONT INSERTS	P
13,500 BTU DUCTED A/C	S
EASY ACCESS BOOTH DINETTE STORAGE DOORS (29THS ONLY)	S
DUCTED HEAT	S
LED INTERIOR LIGHTING	P
ROLLOVER FLIP UP SOFA'S	S
SOFA DECORATIVE THROW PILLOWS	S
70" SLIDE OUT ROOM HEIGHT	S
HARD VALANCE WINDOW TREATMENT W/DECORATIVE LAMBREQUINS	S
PLEATED NIGHT WINDOW SHADES	S
PEDESTAL THERMOFOIL DINETTE TABLE (29THS ONLY)	S
EXTRA LARGE FOLDING TABLE	S
DINETTE STORAGE UNDER BENCHES (29THS ONLY)	S

INTERIOR FEATURES (CONTINUED)

MARINE TOILET WITH FOOT FLUSH	S
ABS TUB/SHOWER SURROUND	P
SKYLIGHT ABOVE TUB/SHOWER	P
MEDICINE CABINET WITH MIRROR	S
SOLID MASTER BEDROOM DOOR(S)	S
FULL LENGTH NIGHT STANDS WITH RECEPES (N/A 19TH)	S
MIRRORED WARDROBES IN MASTER BEDROOM	S
MASTER BEDROOM OVERHEAD CABINETS	S
UNDERBED STORAGE W/SEPARATION FROM OUTSIDE PASS THROUGH STORAGE	S
QUILTED DESIGNER BEDSPREAD	P
500 LB. TIE DOWNS	P
REAR LOADING CARGO DOOR W/3000LB. CAPACITY	P
BLACK OUT SCREEN WALL W/ZIP WALK-THRU DRIVE ON STEEL REINFORCED INTERIOR WHEEL WELLS (19TH & 26TH ONLY)	P

SAFETY FEATURES

SMOKE ALARM	S
LP/CO2 GAS DETECTOR	S
FIRE EXTINGUISHER	S
FIRE ESCAPE WINDOWS	S
DEAD-BOLT LOCK ON ENTRY DOOR	S

OPTIONS

15,000 BTU DUCTED A/C IPO 13.5 A/C	O
50 AMP SERVICE W/2ND A/C PREP (29THS)	O
50 AMP SERVICE W/2ND 13.5K BTU A/C (29THS)	O
30LB. LP BOTTLES W/COVER	O
KITCHEN SINK COVERS	O
SOLIDSTEP ENTRANCE STEPS IPO FLIP-DOWN STEPS (MAIN ENTRANCE ONLY)	O
RAMP PATIO DOOR SYSTEM	O
CSA STANDARDS	O
TRI FOLD HIDE-A-BED SOFA IPO DINETTE (29THS ONLY)	O

KEY: S - STANDARD O - OPTION P - PACKAGE FEATURE

FLOORPLANS + SPECIFICATIONS

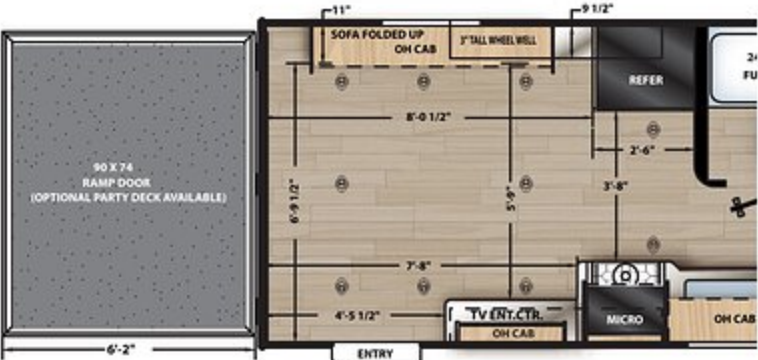

19TH GARAGE DIMENSIONS



19TH

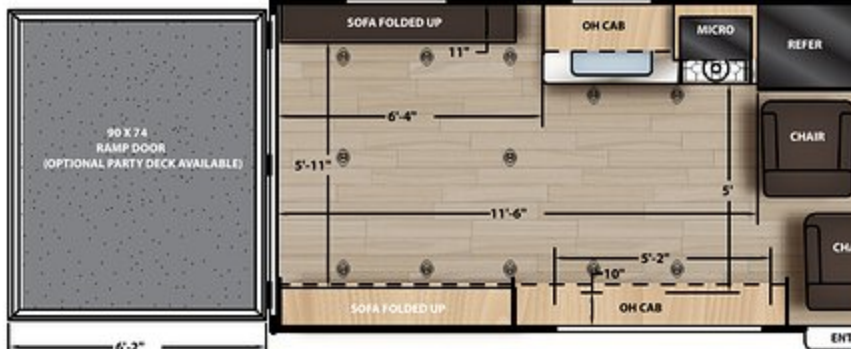

26TH GARAGE DIMENSIONS

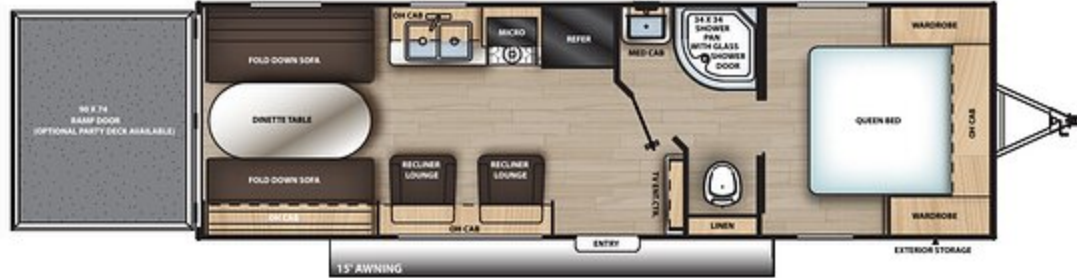

26TH

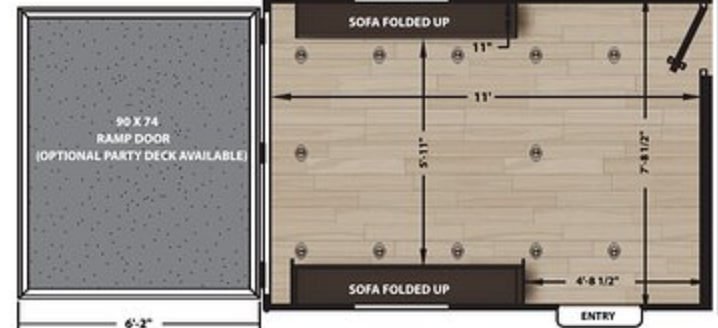

29THS GARAGE DIMENSIONS



29THS

CATALINA

LEGACY EDITION SBX TRAILBLAZER DESTINATION



**24/7 EMERGENCY
ROADSIDE ASSISTANCE
WITH VEHICLE PURCHASE**

TO WING JUMP-STARTS TIRE CHANGES FLUID DELIVERY LOCKOUT SERVICE	WINCH-OUT MOBILE MECHANIC TECHNICAL SUPPORT DEALER LOCATOR SERVICES
--	--

**SAFERIDERV
MOTOR CLUB**

VALID FOR 1 YEAR FROM DATE OF PURCHASE

All information contained in this brochure is believed to be accurate at the time of publication. However, during the model year, it may be necessary to make revisions and Forest River, Inc., reserves the right to make all such changes without notice, including prices, colors, materials, equipment and specifications as well as the addition of new models and the discontinuance of models shown in this brochure. Therefore, please consult with your Forest River, Inc., dealer and confirm the existence of any materials, design or specifications that are material to your purchase decision.

For more details including videos, 360 views, photos and to see how Coachmen is leading the great outdoors, visit www.coachmenrv.com

Coachmen Industries 423 N. Main St., Middlebury, IN 46540
Phone: 574-825-5821

GVWR (Gross Vehicle Weight Rating) - is the maximum permissible weight of the unit when fully loaded. It includes all weights, inclusive of all fluids, cargo, optional equipment and accessories. For safety and product performance do NOT exceed the GVWR.

GAWR (Gross Axle Weight Rating) - is the maximum permissible weight, including cargo, fluids, optional equipment and accessories that can be safely supported by a combination of all axles.

UVW (Unloaded Vehicle Weight)* - is the typical weight of the unit as manufactured at the factory. It includes all weight at the unit's axle(s) and tongue or pin and LP Gas. The UVW does not include cargo, fresh potable water, additional optional equipment or dealer installed accessories.

*Estimated Average based on standard build optional equipment.

CCC (Cargo Carrying Capacity)** - is the amount of weight available for fresh potable water, cargo, additional optional equipment and accessories. CCC is equal to GVWR minus UVW. Available CCC should accommodate fresh potable water (8.3 lbs per gallon). Before filling the fresh water tank, empty the black and gray tanks to provide for more cargo capacity.

** Estimated average based on standard build optional equipment

Each Forest River RV is weighed at the manufacturing facility prior to shipping. A label identifying the unloaded vehicle weight of the actual unit and the cargo carrying capacity is applied to every Forest River RV prior to leaving our facilities. The load capacity of your unit is designated by weight, not by volume, so you cannot necessarily use all available space when loading your unit.



COACHMEN OWNERS ASSOCIATION

FREE MEMBERSHIP
www.coachmenowners.com

CUSTOMER SATISFACTION

FOREST RIVER
encourages you to

BUY LOCAL

PREFERENTIAL SERVICE | PRODUCT INFORMATION

www.ForestRiverBuyLocal.com

2019 CATALINA TRAIL BLAZER

	19TH	26TH	29THS
SHIPPING WEIGHT	4,384	5,427	7,170
CARRYING CAPACITY	2,556	2,413	2,570
UVW	4,444	5,487	7,230
GVWR	7,000	7,900	9,800
HITCH WEIGHT	750	957	1,232
EXTERIOR HEIGHT (INCLUDES A/C)	10' 7"	10' 7"	11' 1"
FRESH WATER CAPACITY (GAL.)	44	44	44
GREY WATER CAPACITY (GAL.)	40	40	40
WASTE WATER CAPACITY (GAL.)	30	30	30
AWNING LENGTH	15'	15'	15'
WHEEL SIZE	15"	15"	15"
EXTERIOR LENGTH (INCLUDES BUMPER TO HITCH)	22' 9"	29' 10"	35' 6"
EXTERIOR WIDTH	96"	96"	96"
INTERIOR HEIGHT (COACH)	81"	81"	81"
AXLES	3500 lbs.	3500 lbs.	5100 lbs.

YOUR CATALINA DEALER

We are proud of our Coachmen Families. Share your memories at:



#coachmencatalina



Coachmen Recreational
Vehicles



Learn More
Scan this barcode using
a QR Reader on your
smart phone to learn
more about Forest River.



A Berkshire Hathaway company.