

EVO TRAVEL TRAILERS

NORTHWEST

EVO

BY FOREST RIVER

YOUR JOURNEY STARTS HERE.



PANORAMIC WINDOWS



ASPEN INTERIOR COLOR



ASPEN INTERIOR COLOR

INTERIOR COLORS AND EQUIPMENT MAY VARY



**SUPER SLIDE
WITH U-DINETTE**

DRIFTWOOD INTERIOR COLOR



DRIFTWOOD INTERIOR COLOR

SPACIOUS KITCHEN WITH SOLID SURFACE COUNTERTOPS

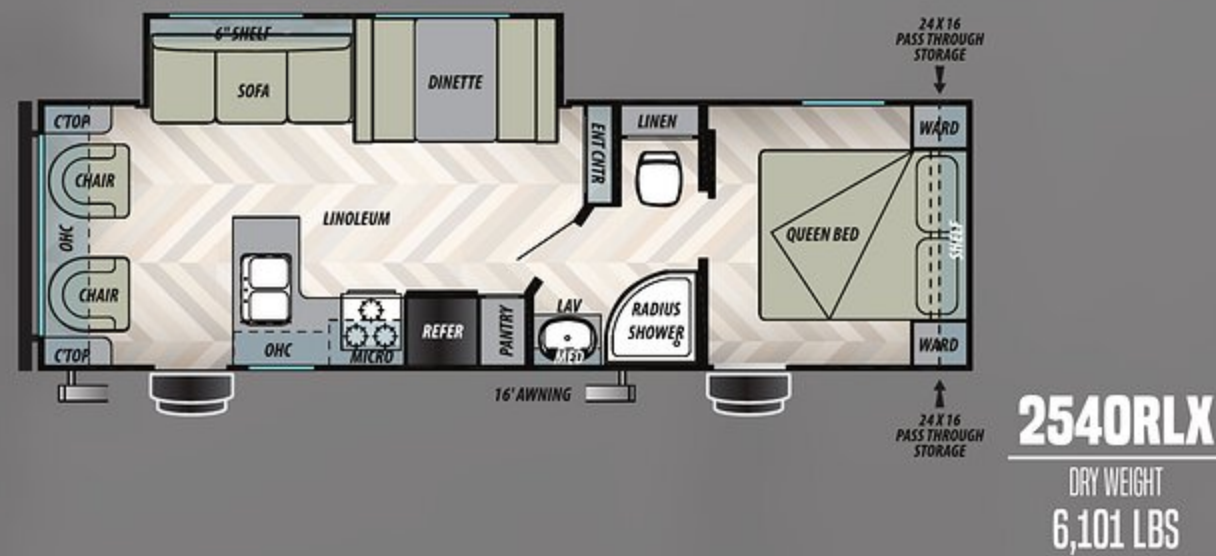
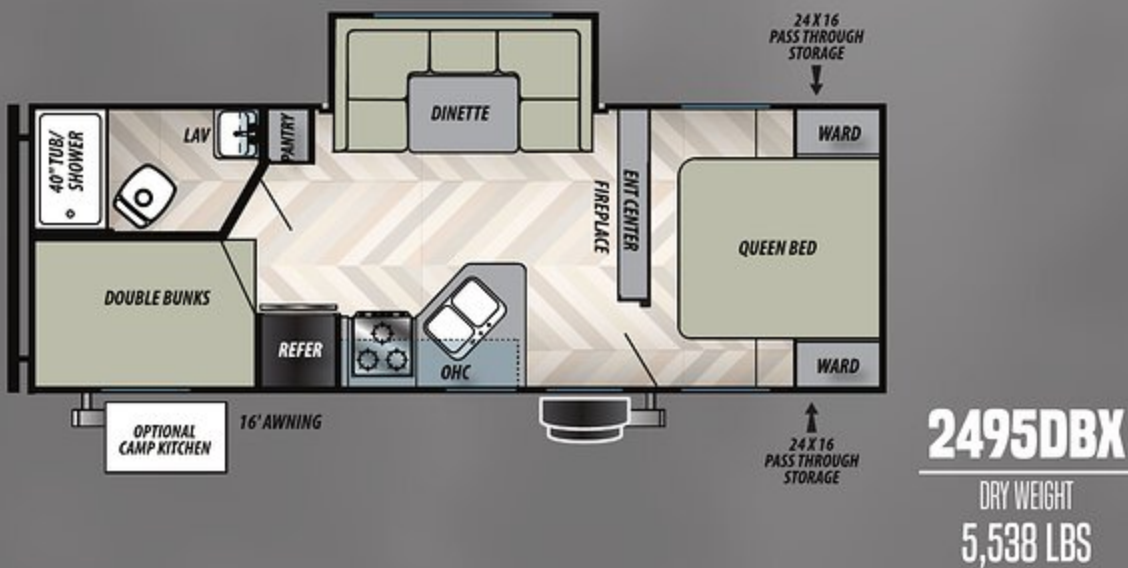
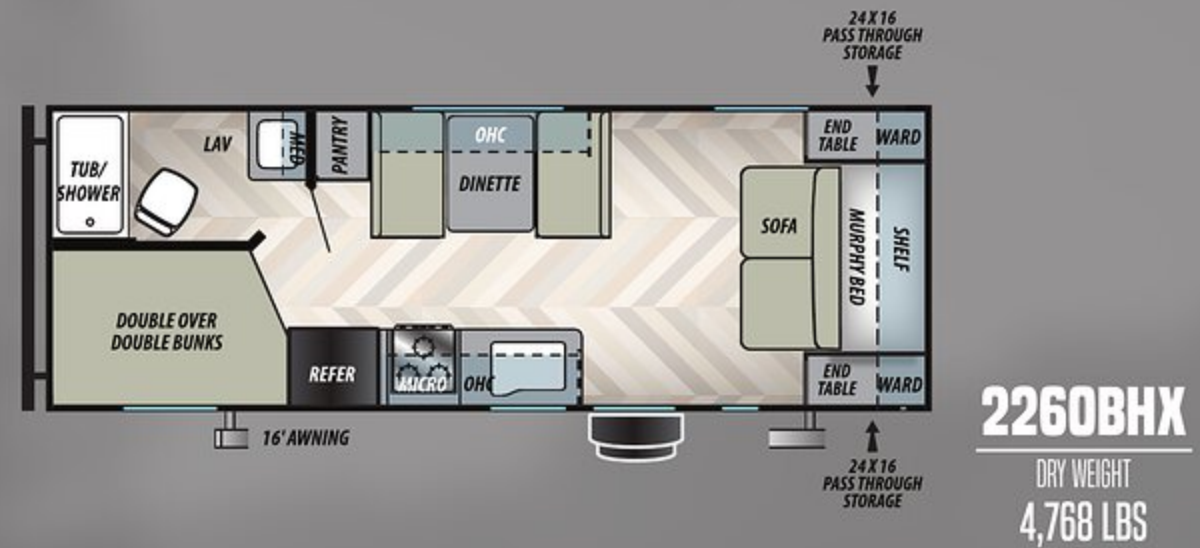
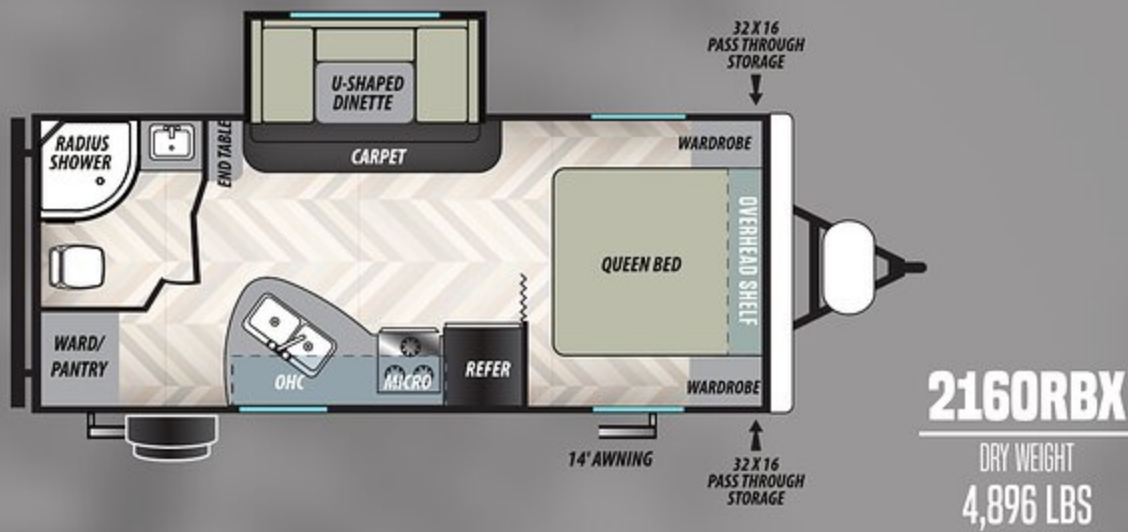

FLOORPLAN KEY

OHC

OVERHEAD CABINET

WARD

WARDROBE

MICRO

MICROWAVE

REFER

REFRIGERATOR

SPECIFICATIONS

HITCH WEIGHT:

GVWR:

UVW:

CCC:

EXTERIOR LENGTH:

EXTERIOR HEIGHT:

EXTERIOR WIDTH:

FRESH WATER:

GRAY WATER:

BLACK WATER:

AWNING SIZE:

EVO LITES

T2160RBX

T2260BHX

T2495DBX

T2540RLX

T2700BHX

T2750QBX

T2990QBX

T2110RTX

T2510RTX

590 LB.

590 LB.

738 LB.

743 LB.

794 LB.

749 LB.

785 LB.

694 LB.

735 LB.

7590 LB.

7590 LB.

7738 LB.

7743 LB.

7794 LB.

8549 LB.

8585 LB.

8494 LB.

8535 LB.

4896 LB.

4768 LB.

5538 LB.

6101 LB.

6254 LB.

6737 LB.

6737 LB.

5494 LB.

5803 LB.

2694 LB.

2822 LB.

2200 LB.

1642 LB.

1540 LB.

1812 LB.

1848 LB.

3000 LB.

2732 LB.

25' 2"

27' 8"

28' 2"

30' 8"

31' 11"

33' 8"

33' 4"

27' 5"

29' 5"

10' 3"

10' 3"

10' 3"

10' 3"

10' 3"

10' 3"

10' 3"

11' 8"

11' 8"

96"

96"

96"

96"

96"

96"

96"

96"

96"

61 GAL.

42 GAL.

61 GAL.

61 GAL.

61 GAL.

61 GAL.

61 GAL.

61 GAL.

61 GAL.

42 GAL.

60 GAL.

60 GAL.

32 GAL.

74 GAL.

32 GAL.

32 GAL.

28 GAL.

28 GAL.

32 GAL.

32 GAL.

32 GAL.

42 GAL.

32 GAL.

42 GAL.

42 GAL.

32 GAL.

32 GAL.

14'

12'

12'

16'

16'

16'

16'

18'

18'

EFFECTIVE UNITS BUILT AFTER 9/1/19

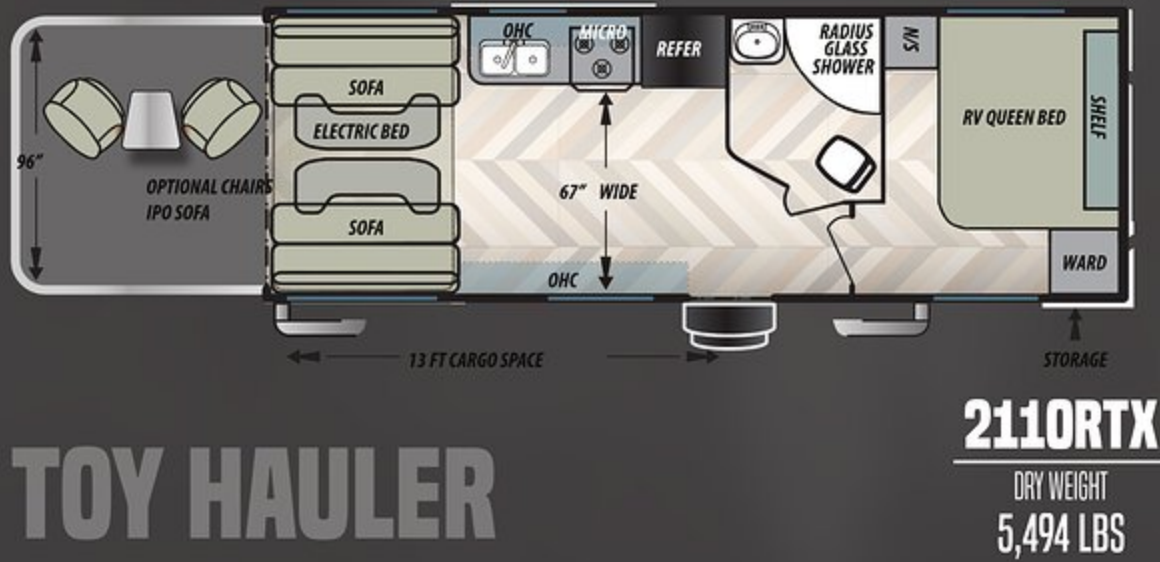
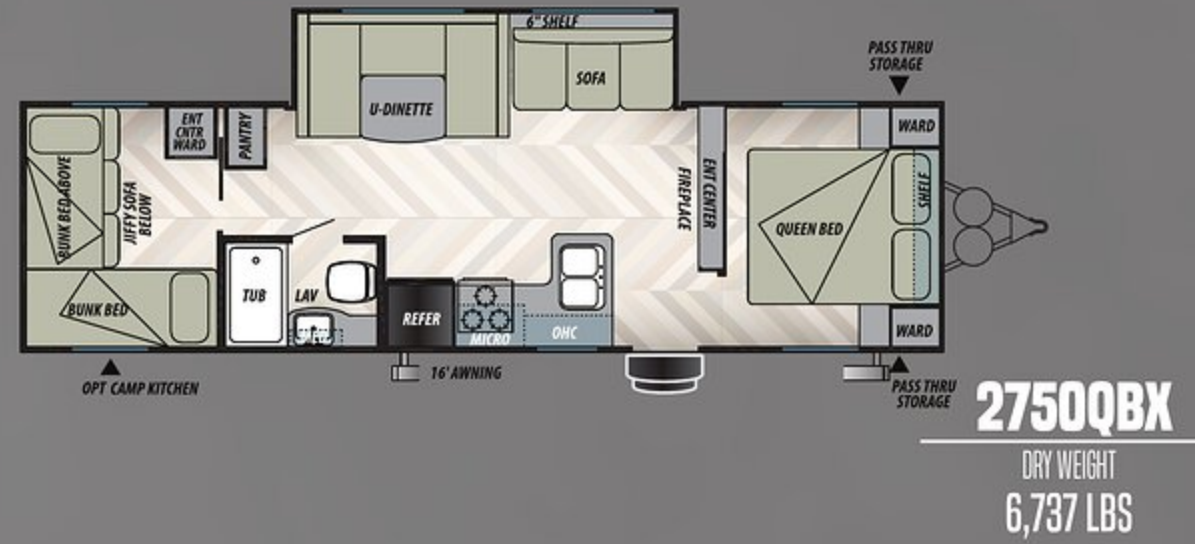
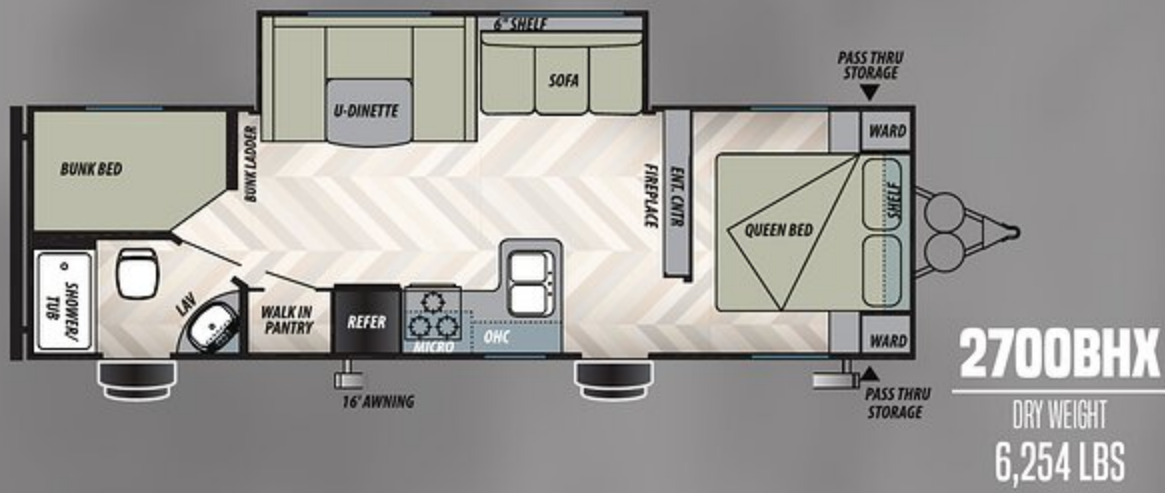

TOY HAULER

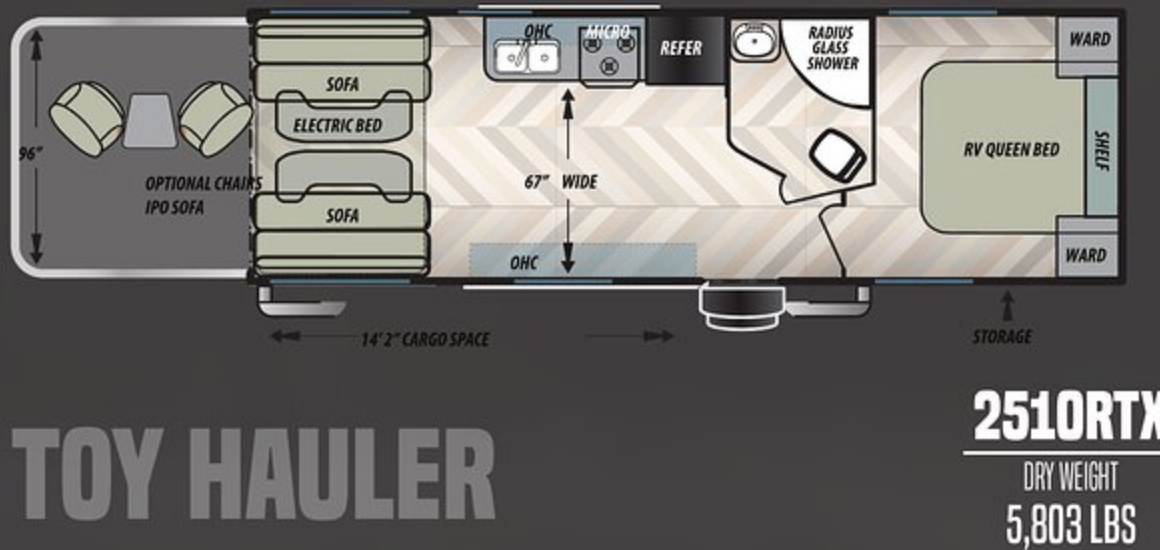
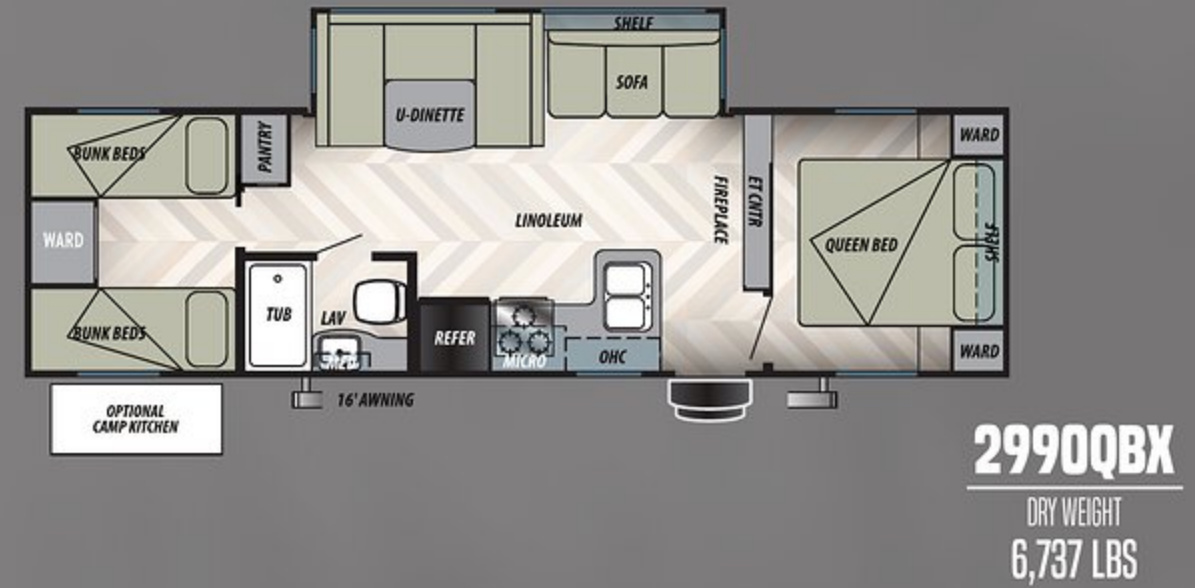

TOY HAULER



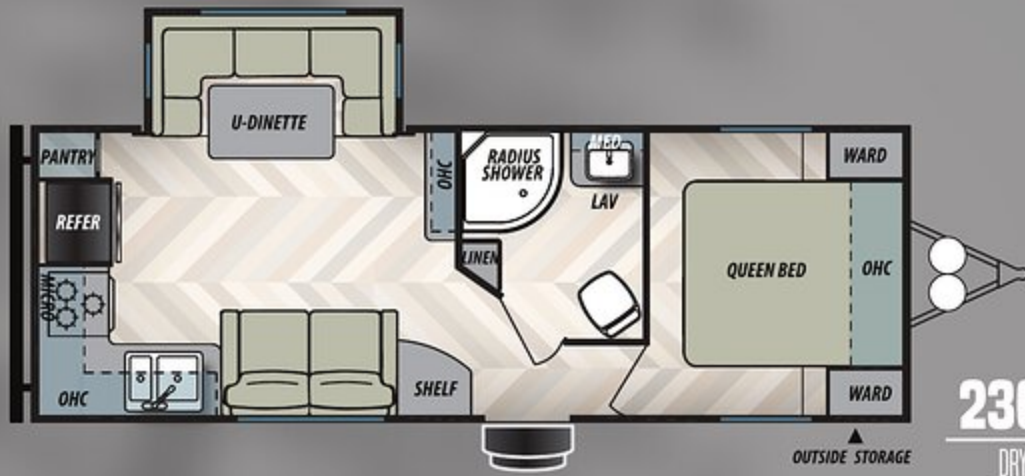

DRY WEIGHT
5,780 LBS

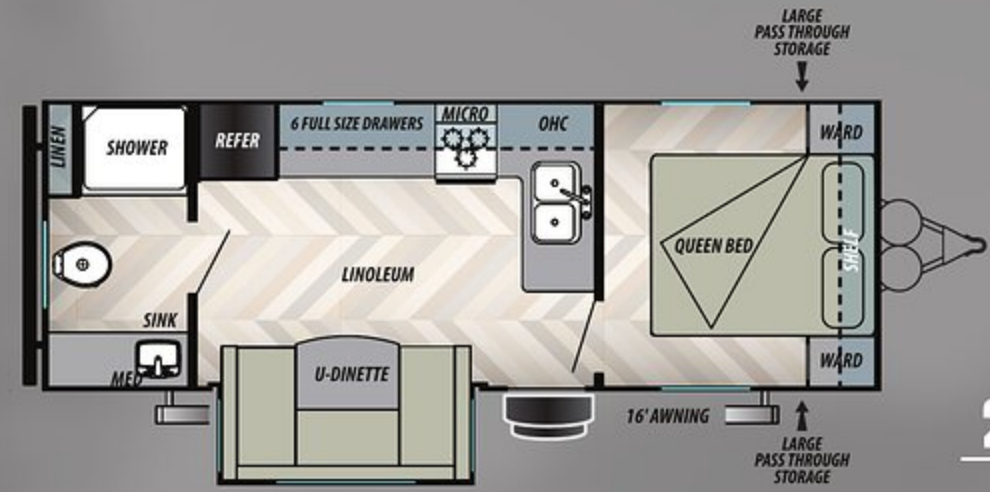

DRY WEIGHT
5,421 LBS

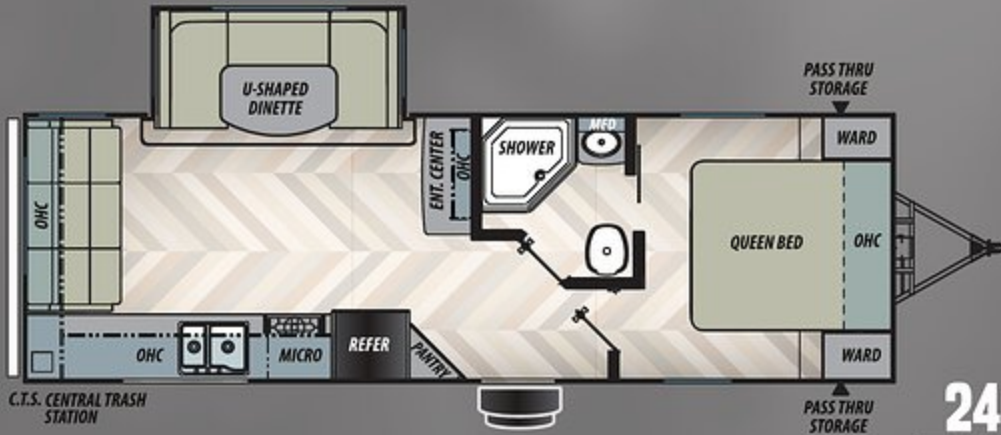

DRY WEIGHT
6,087 LBS

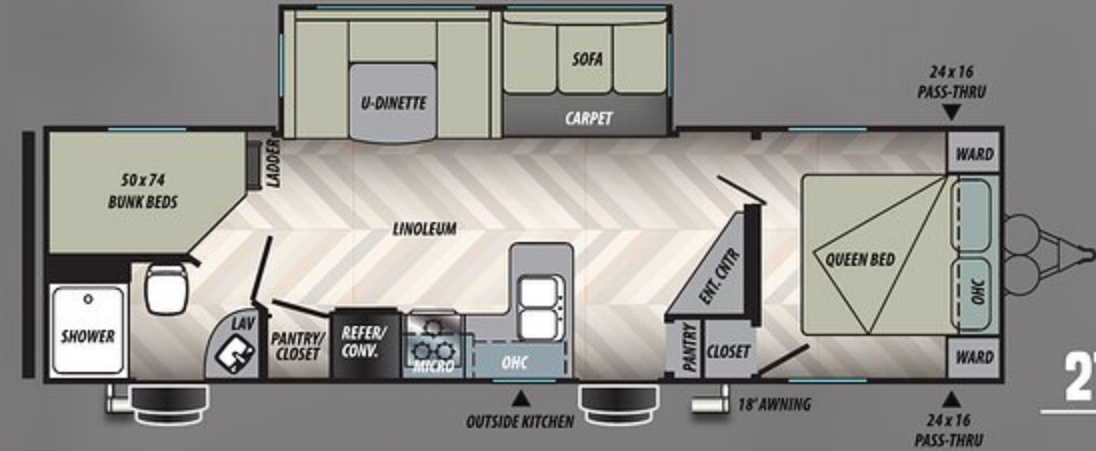

DRY WEIGHT
7,008 LBS

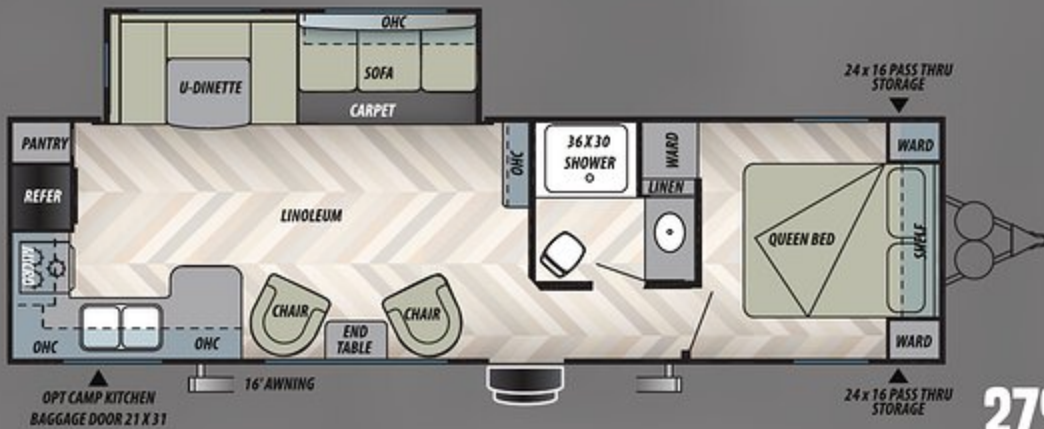

DRY WEIGHT
7,228 LBS



DRY WEIGHT
8,228 LBS

STANDARDS AND OPTIONS

EVO ELITE BUILD STANDARD FEATURES

- POT & PAN DRAWER UNDER ONE DINETTE SEAT
- 13.5 DUCTED AC W/ QUICK COOL
- XL GRAB HANDLE
- HEATED & ENCLOSED FRESH WATER TANK
- E-Z LUBE AXLES
- SELF-ADJUSTING BRAKES
- FULL EXTENSION BALL BEARING DRAWER GUIDES
- CENTRAL SWITCH COMMAND CENTER
- (2) OUTSIDE SPEAKERS
- RADIUS ENTRY DOOR
- 6 GAL G/E DSI WATER HEATER
-

LUXURY PACKAGE

- 2 POTS & PANS DRAWERS (N/A ON SOME MODELS)
- SINK COVER
- FLIP-UP COUNTERTOP EXTENSION (N/A ON SOME MODELS)
- FOOT FLUSH TOILET
- SKYLIGHT OVER TUB
- COAT RACK
- CABLE TV HOOKUP
- LP QUICK DISCONNECT
- BLACK TANK FLUSH
- RADIAL TIRES
- SPARE TIRE & CARRIER
- OUTSIDE SHOWER
- TEDDY BEAR BUNK MATS (N/A ON NON-BUNK MODELS)
- UPGRADED HIDDEN HINGES
- BATTERY DISCONNECT

PARAMOUNT PACKAGE

- EXTRA LARGE PANORAMIC WINDOW PACKAGE IN MAIN SLIDE
- 8 CU FT GAS/ELECTRIC REFRIGERATOR
- POWER AWNING W/ADJUSTABLE LEGS
- POWER TONGUE JACK
- SOLIDSTEP TRIPLE STEP (MAIN ENTRANCE ONLY)
- STABILIZER JACKS
- EXTERNAL LED STRIP LIGHTING
- EXTERIOR CONVENIENCE PACKAGE (FRICTION HINGE ENTRY DOOR & MAGNETIC LATCHES ON BAGGAGE DOORS)
- GREEN PACKAGE (SOLAR PREP & LED INTERIOR LIGHTING)
- SOLID SURFACE COUNTERTOP W/UNDERMOUNT SINK
- USB PORT PACKAGE
- BLUETOOTH STEREO
- UPGRADED PILLOWTOP MATTRESS
- UPGRADED APPLIANCE PACKAGE
- DESIGNER SPRING FAUCET
- ELECTRIC FIREPLACE W/CRYSTALS (NOT AVAILABLE ON ALL MODELS)
- MODERN CLOTH ROLLER SHADES W/AUTOSTOP (LIVING ROOM & BEDROOM)
- ASTRO FOIL (CEILING & FLOOR)

NORTHWEST PACKAGE

- HEATED ENCLOSED TANKS WITH 12V HEAT STRIPS IN ADDITION ASTRO FOIL CEILING & FLOOR

EVO LITE STANDARD FEATURES

- E-Z LUBE AXLES
- SELF-ADJUSTING BRAKES
- FULL EXTENSION BALL BEARING DRAWER GUIDES
- CENTRAL SWITCH COMMAND CENTER
- (2) OUTSIDE SPEAKERS
- RADIUS ENTRY DOOR
- WATER HEATER GAS DSI 6 GAL
- LUXURY PACKAGE
- RANGE WITH OVEN IPO COOKTOP
- 2 POTS & PANS DRAWERS (N/A ON SOME MODELS)
- SINK COVER
- FLIP-UP COUNTERTOP EXTENSION (N/A ON SOME MODELS)
- FOOT FLUSH TOILET
- SKYLIGHT OVER TUB
- COAT RACK
- CABLE TV HOOKUP
- LP QUICK DISCONNECT
- BLACK TANK FLUSH
- RADIAL TIRES
- SPARE TIRE & CARRIER
- OUTSIDE SHOWER
- TEDDY BEAR BUNK MATS (N/A ON NON-BUNK MODELS)
- UPGRADED HIDDEN HINGES
- BATTERY DISCONNECT

PARAMOUNT PACKAGE

- EXTRA LARGE PANORAMIC WINDOW PACKAGE IN MAIN SLIDE
- 8 CU FT GAS/ELECTRIC REFRIGERATOR
- POWER AWNING W/ADJUSTABLE LEGS
- POWER TONGUE JACK
- SOLIDSTEP DOUBLE STEP (MAIN ENTRANCE ONLY)
- STABILIZER JACKS
- EXTERNAL LED STRIP LIGHTING
- EXTERIOR CONVENIENCE PACKAGE (FRICTION HINGE ENTRY DOOR & MAGNETIC LATCHES ON BAGGAGE DOORS)
- GREEN PACKAGE (SOLAR PREP & LED INTERIOR LIGHTING)
- SOLID SURFACE COUNTERTOP W/UNDERMOUNT SINK
- USB PORT PACKAGE
- BLUETOOTH STEREO
- UPGRADED APPLIANCE PACKAGE
- ELECTRIC FIREPLACE W/CRYSTALS (NOT AVAILABLE ON ALL MODELS)
- MODERN CLOTH ROLLER SHADES W/AUTOSTOP (LIVING ROOM & BEDROOM)

NORTHWEST PACKAGE

- ENCLOSED HEATED TANKS WITH 12V HEAT STRIPS

EVO TOYHAULER STANDARD FEATURES

- E-Z LUBE AXLES
- SELF-ADJUSTING BRAKES
- FULL EXTENSION BALL BEARING DRAWER GUIDES
- RADIUS ENTRY DOOR
- WATER HEATER GAS DSI 6 GAL
-

LUXURY PACKAGE

(178RT FALLS UNDER SELECT OPTIONS)

- RANGE WITH OVEN IPO COOKTOP
- SINK COVER
- FOOT FLUSH TOILET
- SKYLIGHT OVER TUB
- COAT RACK
- CABLE TV HOOKUP
- LP QUICK DISCONNECT
- BLACK TANK FLUSH
- RADIAL TIRES
- SPARE TIRE & CARRIER
- OUTSIDE SHOWER
- TEDDY BEAR BUNK MATS (N/A ON NON-BUNK MODELS)
- UPGRADED HIDDEN HINGES
- BATTERY DISCONNECT

SPECIFICATIONS

	T2360RK	T2445RB	T2465RL	T2740BH	T2791RK	T3250BH
HITCH WEIGHT:	577 LB.	658 LB.	625 LB.	834 LB.	726 LB.	955 LB.
GVWR:	7577 LB.	7658 LB.	7625 LB.	9634 LB.	9526 LB.	11155 LB.
UVW:	5780 LB.	5421 LB.	6087 LB.	7008 LB.	7228 LB.	8228 LB.
CCC:	1797 LB.	2237 LB.	1538 LB.	2626 LB.	2298 LB.	2927 LB.
EXTERIOR LENGTH:	29' 1"	26' 8"	30' 9"	33' 8"	33' 8"	36' 7"
EXTERIOR HEIGHT:	11' 3"	10' 8"	11' 0"	11' 2"	11' 2"	11' 5"
EXTERIOR WIDTH:	96"	96"	96"	96"	96"	96"
FRESH WATER:	61 GAL.	61 GAL.	61 GAL.	61 GAL.	61 GAL.	61 GAL.
GRAY WATER:	66 GAL.	74 GAL.	66 GAL.	75 GAL.	75 GAL.	60 GAL.
BLACK WATER:	42 GAL.	32 GAL.	42 GAL.	32 GAL.	33 GAL.	32 GAL.
AWNING SIZE:	16'	18'	18'	18'	16'	18'

EFFECTIVE UNITS BUILT AFTER 9/1/19

EVO SELECT SERIES





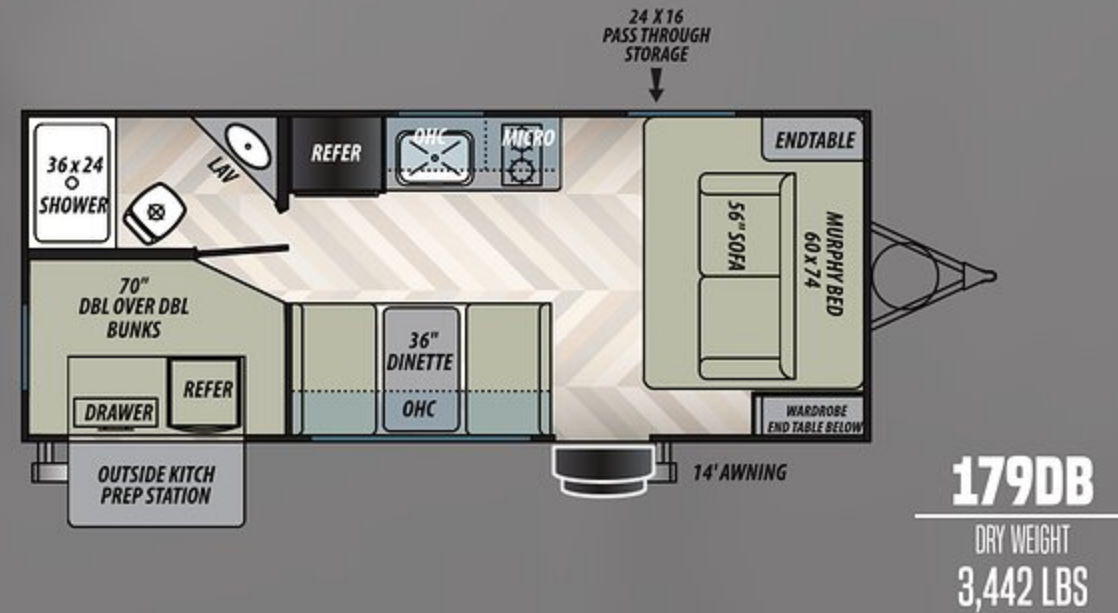
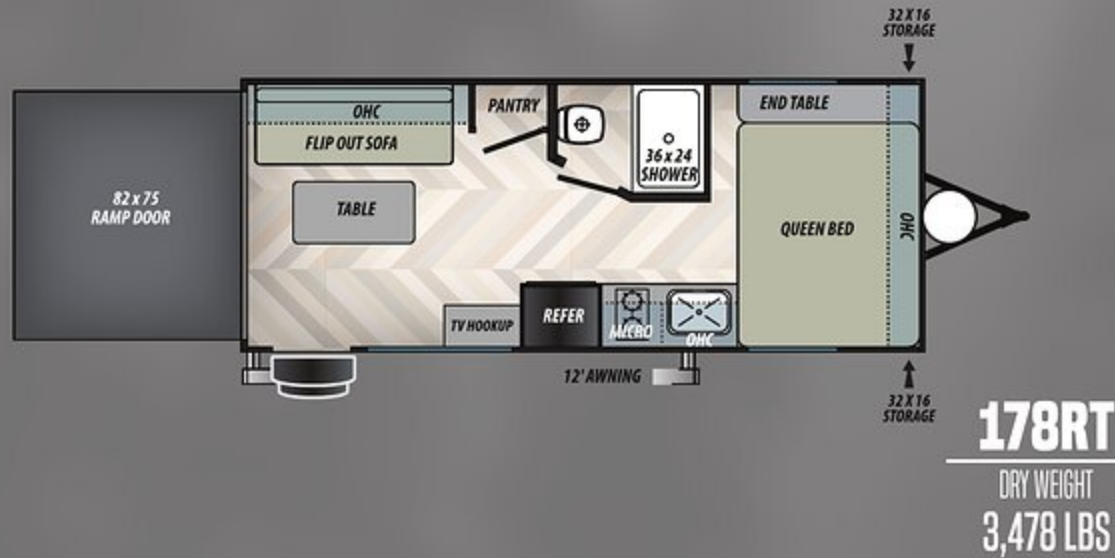
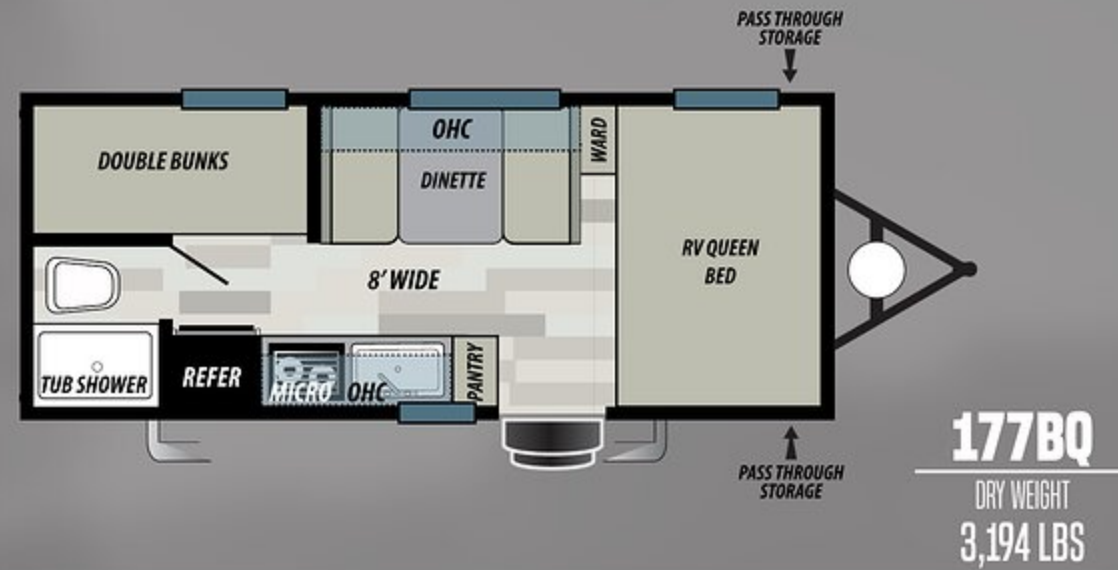
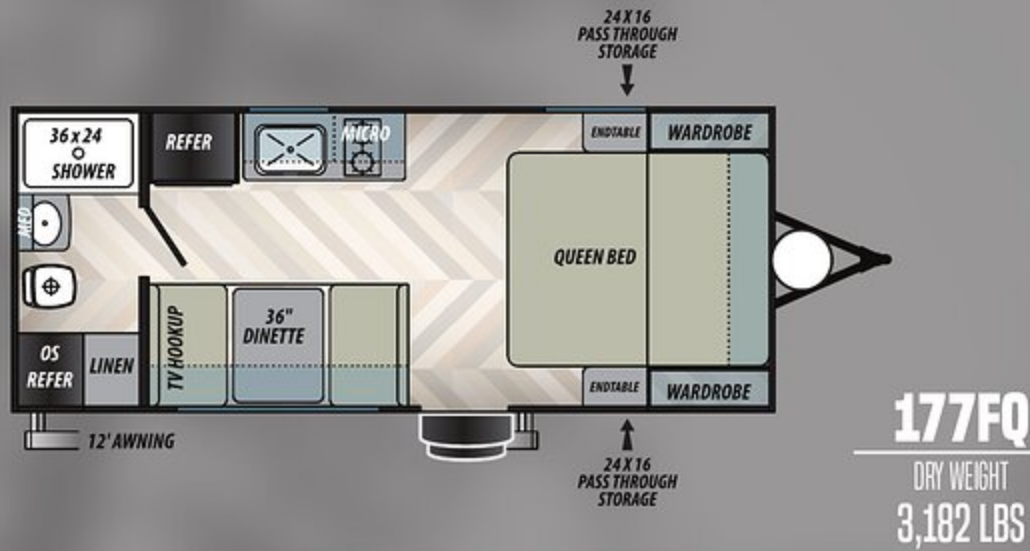

SPECIFICATIONS

	T177FQ	T177BQ	T180SS	T179DB	T178RT
HITCH WEIGHT:	428 LB.	393 LB.	465 LB.	489 LB.	510 LB.
GVWR:	4328 LB.	4293 LB.	4865 LB.	4889 LB.	4910 LB.
UVW:	3182 LB.	3194 LB.	3787 LB.	3442 LB.	3478 LB.
CCC:	1146 LB.	1099 LB.	1078 LB.	1447 LB.	1432 LB.
EXTERIOR LENGTH:	22' 3"	22'	22' 7"	22' 6"	21' 9"
EXTERIOR HEIGHT:	10' 2"	10' 2"	10' 4"	10' 2"	10' 2"
EXTERIOR WIDTH:	90"	90"	90"	90"	90"
FRESH WATER:	38 GAL.	38 GAL.	38 GAL.	38 GAL.	38 GAL.
GRAY WATER:	30 GAL.	30 GAL.	30 GAL.	30 GAL.	30 GAL.
BLACK WATER:	30 GAL.	30 GAL.	30 GAL.	30 GAL.	28 GAL.
AWNING SIZE:	12'	12'	12'	14'	12'

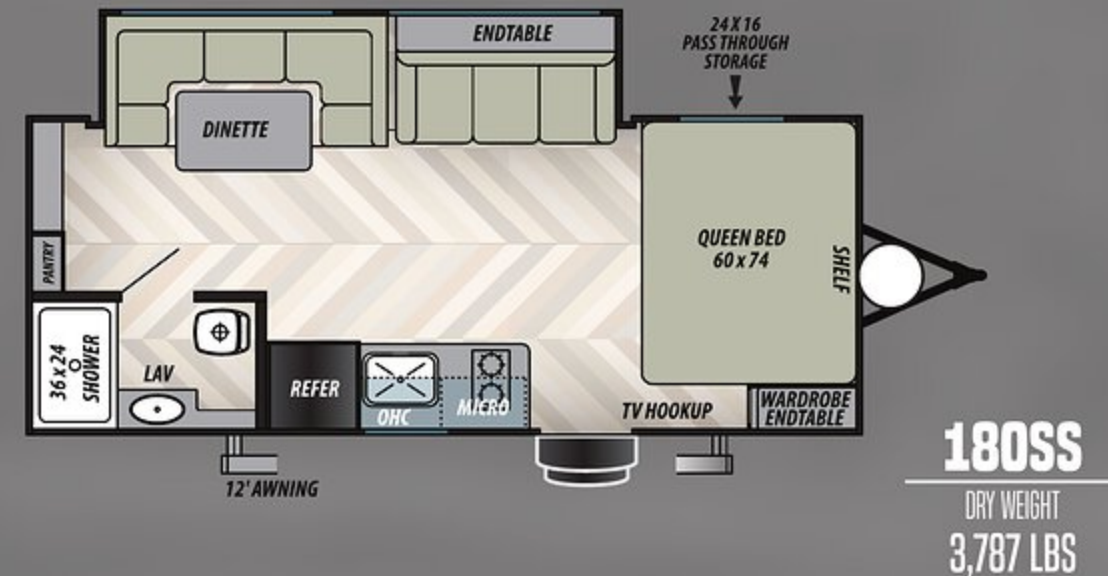

STANDARDS AND OPTIONS

EVO SELECT STANDARD FEATURES

- E-Z LUBE AXLES
- 7.5' WIDE FOR EZ TOWING
- 78" INTERIOR HEIGHT
- 38/30/30 F/G/B HOLDING TANKS
- UPGRADED TUFFCOAT ALUMINUM EXTERIOR
- DIAMOND-PLATED ROCK GUARD ON FRONT
- 26" ENTRY DOORS (IPO 22" STANDARD)
- UPGRADED LARGE 32"X16" BAGGAGE DOORS
- ROLLER SHADES
- HIGH RISE KITCHEN FAUCET
- SOLID WOOD DRAWER SIDES W/BALL BEARING GUIDES
- 6 GALLON DSI GAS WATER HEATER
- TV BACKER WITH HOOKUPS
- 30 AMP SERVICE
- 1 X 20# LP TANK
- 20K BTU FURNACE
- MICROWAVE
- 2 BURNER COOKTOP
- ROADSIDE ASSISTANCE

SELECT LUXURY PACKAGE

- A/C 13.5
- CABLE SATELLITE TV READY
- DOUBLE DOOR 6 CU FT RV REFER
- FOOT FLUSH TOILET
- POWER VENT
- RADIAL TIRES
- SPARE TIRE & CARRIER
- TUB SURROUND
- TV ANTENNA W/ BOOSTER

SELECT PARAMOUNT PACKAGE

- EXTERIOR CONVENIENCE PACKAGE
(DOUBLE ENTRY STEP, FRICTION HINGE ENTRY DOOR,
MAGNETIC LATCHES ON BAGGAGE DOORS & XL GRAB HANDLE)
- EXTERNAL LED STRIP LIGHTING
- GREEN PACKAGE (SOLAR PREP & LED INTERIOR LIGHTING)
- PORTABLE FM/BLUETOOTH STEREO
- POWER AWNING W/ADJUSTABLE LEGS
- SEAMLESS COUNTERTOP
- UPGRADED APPLIANCE PACKAGE
- MATTRESS
- USB PORT PACKAGE





<https://www.facebook.com/EVOadventures>

FREE MEMBERSHIP
to Forest River Owners' Group



www.forestriverfrog.com



Learn More
Scan this barcode using
a QR Reader on your
smart phone to learn
more about Forest River.



A Berkshire Hathaway company.

FOREST RIVER INC., 255 S PEPPER AVE RIALTO, CA 92376 | (909) 873-3777
WWW.FORESTRIVERINC.COM/EVO | WWW.FORESTRIVERACCESSORIES.COM
EFFECTIVE UNITS BUILT AFTER 9/1/2019

CUSTOMER SATISFACTION

FOREST RIVER
encourages you to

BUY LOCAL



PREFERENTIAL SERVICE **PRODUCT INFORMATION**

www.ForestRiverBuyLocal.com

YOUR EVO DEALER

Specification Definitions

GVWR (Gross Vehicle Weight Rating) - is the maximum permissible weight of the unit when fully loaded. It includes all weights, inclusive of all fluids, cargo, optional equipment and accessories. For safety and product performance do NOT exceed the GVWR.

GAWR (Gross Axle Weight Rating) - is the maximum permissible weight, including cargo, fluids, optional equipment and accessories that can be safely supported by a combination of all axles.

UVW (Unloaded Vehicle Weight)* - is the typical weight of the unit as manufactured at the factory. It includes all weight at the unit's axle(s) and tongue or pin and LP Gas. The UVW does not include cargo, fresh potable water, additional optional equipment or dealer installed accessories.
*Estimated average based on standard build optional equipment.

CCC (Cargo Carrying Capacity)** - is the amount of weight available for fresh potable water, cargo, additional optional equipment and accessories. CCC is equal to GVWR minus UVW. Available CCC should accommodate fresh potable water (8.3 lbs per gallon). Before filling the fresh water tank, empty the black and gray tanks to provide for more cargo capacity.
** Estimated average based on standard build optional equipment

Each Forest River RV is weighed at the manufacturing facility prior to shipping. A label identifying the unloaded vehicle weight of the actual unit and the cargo carrying capacity is applied to every Forest River RV prior to leaving our facilities. The load capacity of your unit is designated by weight, not by volume, so you cannot necessarily use all available space when loading your unit.

All information contained in this brochure is believed to be accurate at the time of publication. However, during the model year, it may be necessary to make revisions and Forest River, Inc., reserves the right to make all such changes without notice, including prices, colors, materials, equipment and specifications as well as the addition of new models and the discontinuance of models shown in this brochure. Therefore, please consult with your Forest River dealer and confirm the existence of any materials, design or specifications that are material to your purchase decision. Litho. U.S.A. FOR 1748 W: 2019.5.18